



42E12NE0048 V0450.00208 VINCENT

BYRON'S VEIN

Byron's Vein is an iron formation containing in places abundant arsenopyrite and magnetite with minor pyrite in mafic volcanics. Previous work in 1993-94 showed good gold values in surface sampling i.e. 23.67g au. We blasted a 5' long trench in 8" pops as we didn't want to blow away too much material. Panning is very difficult because of the arsenopyrite present but the sludge from the rock drill showed a tail. An assay from a sample as shown with heavy arsenopyrite showed a $\frac{1}{2}$ oz. of gold. Two different companies have shown an interest in our showings so we will wait for their reactions as to an option agreement and further sampling by them.

Submitted by,

A handwritten signature in cursive script, appearing to read 'Neil R. Maki'.

Neil R. Maki

BYRONS VEIN.

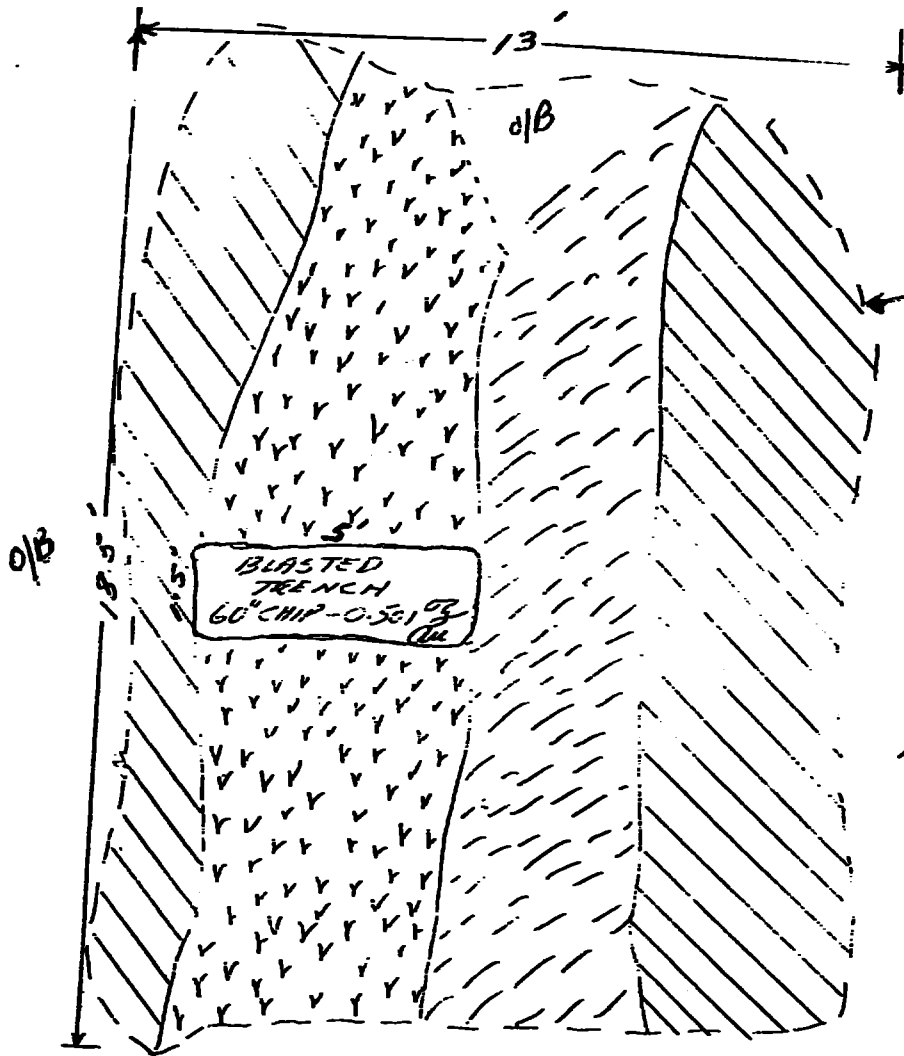

← previously stripped area



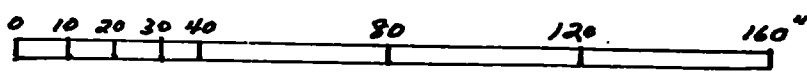

Hours worked.
 A.MAKI Sept 1, 2, 3, 1994
 N.MAKI Sept 1, 2, 3, 1994
 B.MAKI Sept 1, 2.
 3 mon days @
 8 hrs each day
 3 days @ \$150.00/day
 = \$1,200.00 C.R.

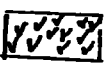

SCALE 1: 40

LEGEND

-  chloritized mafic volcanics
-  rusty weathered silicate Fe.
variable amounts of apy, po, magnetite - 5 - 10%
-  Recrystallized chert-saccharoidal



ACCURASSAY LABORATORIES

A DIVISION OF ASSAY LABORATORY SERVICES INC.

1070 LITHIUM DRIVE, UNIT 2
THUNDER BAY, ONTARIO P7B 6G3
PHONE (807) 623-6448
FAX (807) 623-6820

Page 1

NEIL MAKI
R.R. #14
Thunder Bay, Ontario
P7B 5E5

September 19, 1994

Job #9441010

Accurassay	Sample #	Customer	Gold ppb	Gold Oz/t
	1	K-94-1	125563	3.663
	2	K-94-2	5258	0.153
	3	STR-1-94-1	791	0.023
	4	STR-1-94-2	493	0.014
	5	SNB-1-94-1	1632	0.048
	6	SNB-1-94-2	2079	0.061
	7	<u>BY-94-1</u>	17184	<u>0.501</u>
8 Check		<u>BY-94-1</u>	16500	0.481

*BYRONS
UETA*

Certified By: _____

Neil Maki

VINCENT TWP.
6-163.

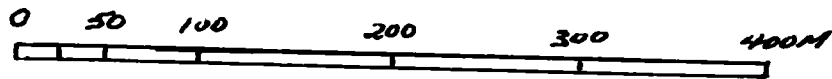
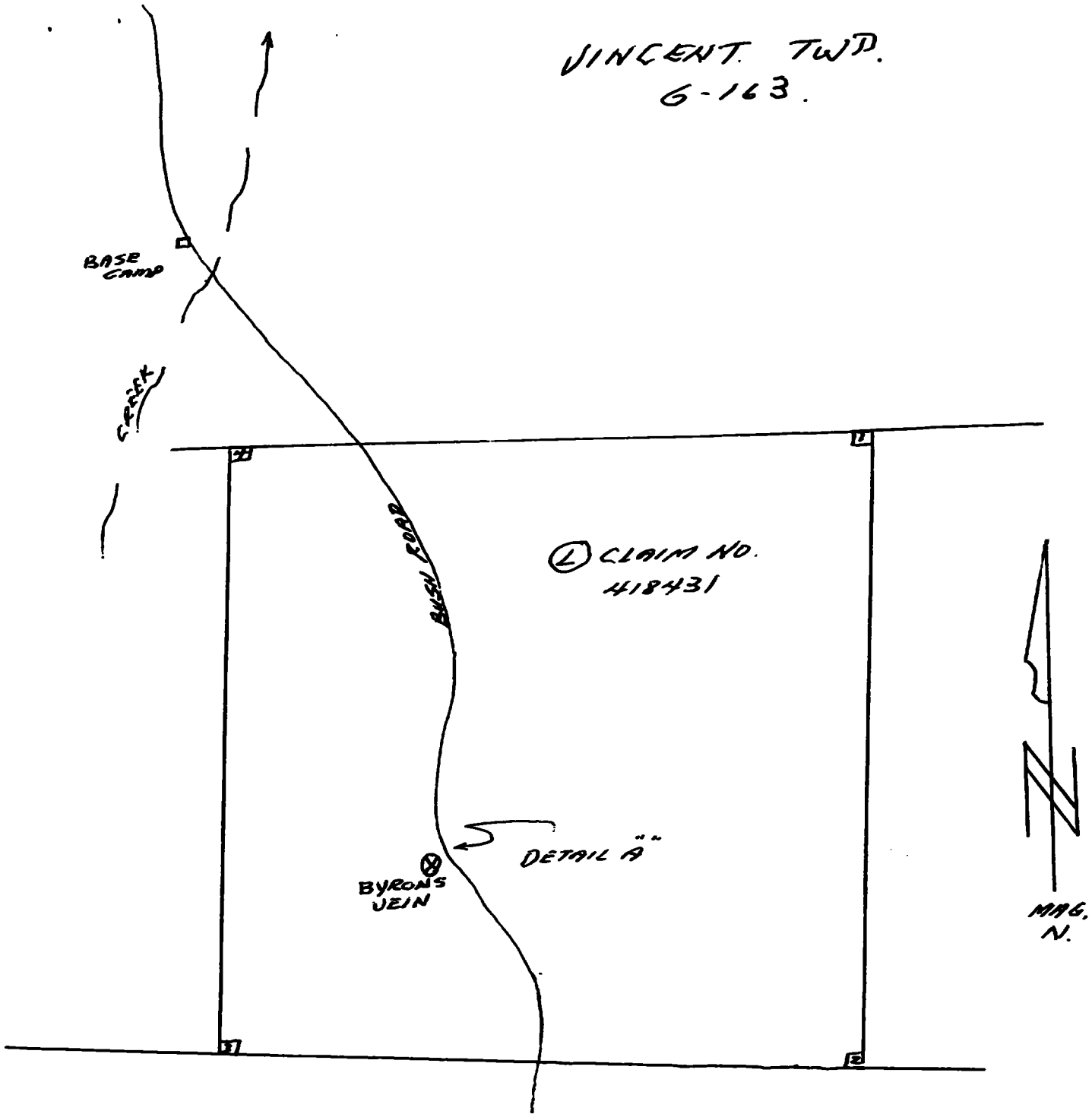

SCALE 1:4000

WORK DONE BY.

A. MAKI - SEPT 1, 2, 3, 4

N.R. MAKI - SEPT 1, 2, 3, 4

8 MAN DAYS @ ^{\$}150⁰⁰ per day = \$1200.00

(Signature)



Report of Work Conducted After Recording Claim

Mining Act

Transaction Number

W9540-208

Personal information collected on this form is obtained under the authority this collection should be directed to the Provincial Manager, Mining Law Sudbury, Ontario, P3E 6A5, telephone (705) 670-7264.

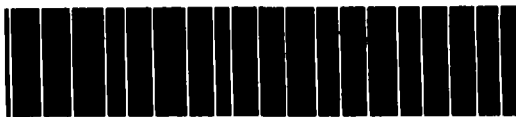

42E12NE0048 W9450.00208 VINCENT

900

- Instructions:**
- Please type or print and submit in duplicate
 - Refer to the Mining Act and Regulations for requirements of mining assessment work or consult the Mining Recorder.
 - A separate copy of this form must be completed for each Work Group.
 - Technical reports and maps must accompany this form in duplicate.
 - A sketch, showing the claims the work is assigned to, must accompany this form.

Recorded Holder(s) <i>NEIL R. MAKI</i>		Client No. <i>163774</i>
Address <i>RR14 THUNDER BAY ONTARIO</i>		Telephone No. <i>767-2194</i>
Mining Division <i>THUNDER BAY</i>	Township/Area <i>VINCENT</i>	M or G Plan No. <i>6163</i>
Dates Work Performed From: <i>SEPT. 1-194</i>		To: <i>SEPT. 4/94</i>

Work Performed (Check One Work Group Only)

Work Group	Type
Geotechnical Survey	<i>W20 P...</i>
Physical Work, Including Drilling	<i>CORR ROCK DRILL & BIAST - CLEAN OUT TRENCHES & STRIPPED AREA PAN SLUDGE</i>
Rehabilitation	
Other Authorized Work	
Assays	
Assignment from Reserve	

Total Assessment Work Claimed on the Attached Statement of Costs \$ *1200⁰⁰*

Note: The Minister may reject for assessment work credit all or part of the assessment work submitted if the recorded holder cannot verify expenditures claimed in the statement of costs within 30 days of a request for verification.

Persons and Survey Company Who Performed the Work (Give Name and Address of Author of Report)

Name	Address
<i>ALLI MAKI</i>	<i>RR14 THUNDER BAY ONT. P7B5E5</i>
<i>NEIL MAKI</i>	<i>RR14 THUNDER BAY ONT. P7B5E5</i>

(attach a schedule if necessary)

Certification of Beneficial Interest * See Note No. 1 on reverse side

I certify that at the time the work was performed, the claims covered in this work report were recorded in the current holder's name or held under a beneficial interest by the current recorded holder.	Date <i>AUG 24/95</i>	Recorded Holder or Agent (Signature) <i>Neil Maki</i>
--	--------------------------	--

Certification of Work Report

I certify that I have a personal knowledge of the facts set forth in this Work report, having performed the work or witnessed same during and/or after its completion and annexed report is true.		
Name and Address of Person Certifying <i>NEIL R. MAKI RR14 THUNDER BAY ONT. P7B5E5</i>		
Telephone No. <i>767-2194</i>	Date <i>AUG 24/95</i>	Certified By (Signature) <i>Neil Maki</i>

For Office Use Only

Total Value Cr. Recorded <i>1200</i>	Date Recorded <i>AUG 25/95</i>	Mining Recorder <i>E J Allen</i>	Received Stamp <i>21 12 PM 25 AUG 95</i> MINING DIVISION THUNDER BAY RECEIVED
	Deemed Approval Date	Date Approved <i>Aug 20/95</i>	
	Date Notice for Amendments Sent		

Work Report Number for Applying Reserve	Claim Number (see Note 2)	Number of Claim Units
	418431 (2)	1
	1197034	2
	1197107	1
Total Number of Claims		5

Value of Assessment of Work Done on this Claim	Value Applied to this Claim
1200.00	800.00
	400.00
Total Value Work Done	Total Value Work Applied
1200.00	1200.00

Value Assigned from this Claim	Reserve: Work to be Claimed at a Future Date
1200.00	
Total Assigned From	Total Reserve
1200.00	

Credits you are claiming in this report may be cut back. In order to minimize the adverse effects of such deletions, please indicate from which claims you wish to prioritize the deletion of credits. Please mark (✓) one of the following:

- Credits are to be cut back starting with the claim listed last, working backwards.
- Credits are to be cut back equally over all claims contained in this report of work.
- Credits are to be cut back as prioritized on the attached appendix.

In the event that you have not specified your choice of priority, option one will be implemented.

Note 1: Examples of beneficial interest are unrecorded transfers, option agreements, memorandum of agreements, etc., with respect to the mining claims.

Note 2: If work has been performed on patented or leased land, please complete the following:

I certify that the recorded holder had a beneficial interest in the patented or leased land at the time the work was performed.	Signature <i>Huelmabe</i>	Date <i>Aug 24/95</i>
---	---------------------------	-----------------------



Ministry of
Northern Development
and Mines

Ministère du
Développement du Nord
et des mines

**Statement of Costs
for Assessment Credit**

**État des coûts aux fins
du crédit d'évaluation**

Mining Act/Loi sur les mines

Transaction No./N° de transaction
19540-208

Personal information collected on this form is obtained under the authority of the Mining Act. This information will be used to maintain a record and ongoing status of the mining claim(s). Questions about this collection should be directed to the Provincial Manager, Minings Lands, Ministry of Northern Development and Mines, 4th Floor, 159 Cedar Street, Sudbury, Ontario P3E 6A5, telephone (705) 670-7284.

Les renseignements personnels contenus dans la présente formule sont recueillis en vertu de la Loi sur les mines et serviront à tenir à jour un registre des concessions minières. Adresser toute question sur la collecte de ces renseignements au chef provincial des terrains miniers, ministère du Développement du Nord et des Mines, 159, rue Cedar, 4^e étage, Sudbury (Ontario) P3E 6A5, téléphone (705) 670-7284.

1. Direct Costs/Coûts directs

Type	Description	Amount Montant	Totals Total global
Wages Salaires	Labour Main-d'oeuvre	\$1200 ⁰⁰	1200.00
	Field Supervision Supervision sur le terrain		
Contractor's and Consultant's Fees Droits de l'entrepreneur et de l'expert- conseil	Type		
Supplies Used Fournitures utilisées	Type		
Equipment Rental Location de matériel	Type		
Total Direct Costs Total des coûts directs			1200⁰⁰

2. Indirect Costs/Coûts indirects

** Note: When claiming Rehabilitation work Indirect costs are not allowable as assessment work.
Pour le remboursement des travaux de réhabilitation, les coûts indirects ne sont pas admissibles en tant que travaux d'évaluation.

Type	Description	Amount Montant	Totals Total global
Transportation Transport	Type		
Food and Lodging Nourriture et hébergement			
Mobilization and Demobilization Mobilisation et démobilisation			
Sub Total of Indirect Costs Total partiel des coûts indirects			
Amount Allowable (not greater than 20% of Direct Costs) Montant admissible (n'excédant pas 20 % des coûts directs)			
Total Value of Assessment Credit (Total of Direct and Allowable indirect costs)		Valeur totale du crédit d'évaluation (Total des coûts directs et indirects admissibles)	1200⁰⁰

Note: The recorded holder will be required to verify expenditures claimed in this statement of costs within 30 days of a request for verification. If verification is not made, the Minister may reject for assessment work all or part of the assessment work submitted.

Note : Le titulaire enregistré sera tenu de vérifier les dépenses demandées dans le présent état des coûts dans les 30 jours suivant une demande à cet effet. Si la vérification n'est pas effectuée, le ministre peut rejeter tout ou une partie des travaux d'évaluation présentés.

Filing Discounts

1. Work filed within two years of completion is claimed at 100% of the above Total Value of Assessment Credit.
2. Work filed three, four or five years after completion is claimed at 50% of the above Total Value of Assessment Credit. See calculations below:

Total Value of Assessment Credit	Total Assessment Claimed
x 0.50 =	

Remises pour dépôt

1. Les travaux déposés dans les deux ans suivant leur achèvement sont remboursés à 100 % de la valeur totale susmentionnée du crédit d'évaluation.
2. Les travaux déposés trois, quatre ou cinq ans après leur achèvement sont remboursés à 50 % de la valeur totale du crédit d'évaluation susmentionné. Voir les calculs ci-dessous.

Valeur totale du crédit d'évaluation	Evaluation totale demandée
x 0,50 =	

Certification Verifying Statement of Costs

I hereby certify:
that the amounts shown are as accurate as possible and these costs were incurred while conducting assessment work on the lands shown on the accompanying Report of Work form.

that as RECORDED HOLDER I am authorized
(Recorded Holder, Agent, Position in Company)

to make this certification

Attestation de l'état des coûts

J'atteste par la présente :
que les montants indiqués sont le plus exact possible et que ces dépenses ont été engagées pour effectuer les travaux d'évaluation sur les terrains indiqués dans la formule de rapport de travail ci-joint.

Et qu'à titre de _____ je suis autorisé
(titulaire enregistré, représentant, poste occupé dans la compagnie)

à faire cette attestation.

Signature <u>A. L. ...</u>	Date <u>Sept 21/95</u>
-------------------------------	---------------------------

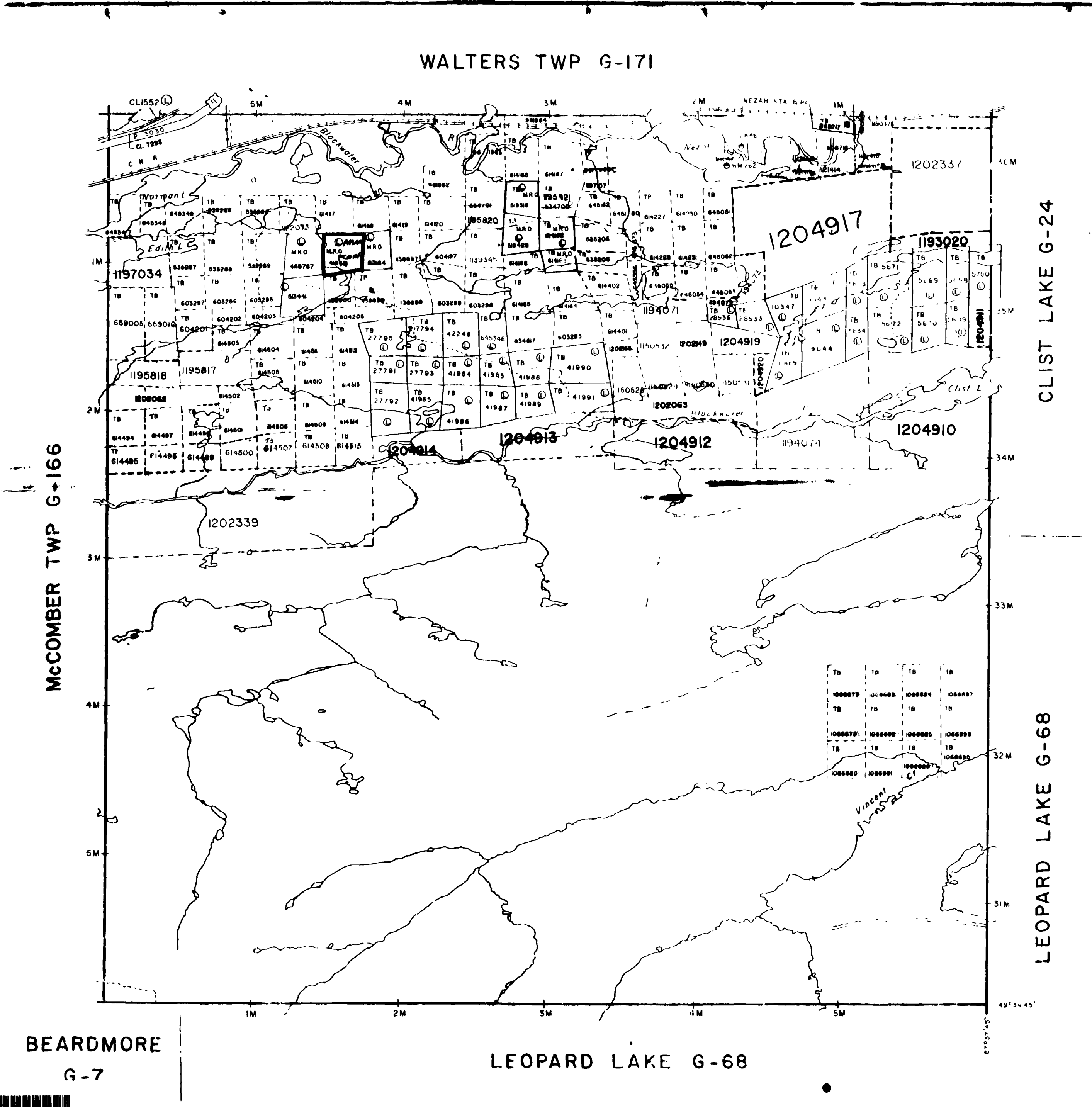

TCWNSHIP
VINCENT
 M.N.R. ADMINISTRATIVE DISTRICT
NIPIGON
 MINING DIVISION
THUNDER BAY
 LAND TITLES REGISTRY DIVISION
THUNDER BAY

THE INFORMATION THAT APPEARS ON THIS MAP HAS BEEN COMPILED FROM VARIOUS SOURCES AND ACCURACY IS NOT GUARANTEED. THOSE WISHING TO STAKE MINING CLAIMS SHOULD CONSULT WITH THE MINING RECORDER, MINISTRY OF NORTHERN DEVELOPMENT AND MINES, FOR ADDITIONAL INFORMATION ON THE STATUS OF THE LANDS SHOWN HEREON.

LEGEND

PATENTED LAND	
PATENTED FOR SURFACE RIGHTS ONLY	
LEASE	
LICENSE OF OCCUPATION	L.C.
CROWN LAND SALES	C.S.
LOCATED LAND	Loc.
CANCELLED	C.
MINING RIGHTS ONLY	M.R.O.
SURFACE RIGHTS ONLY	S.R.O.
HIGHWAY & ROUTE NO	
POADS	
TRAILS	
RAILWAYS	
POWERLINES	
MARSH OR MUSKEG	
MINES	

LAND USE PERMITS FOR COMMERCIAL TOURISM, OUTPOST CAMPING, used only with summer resort locations or when space is limited.

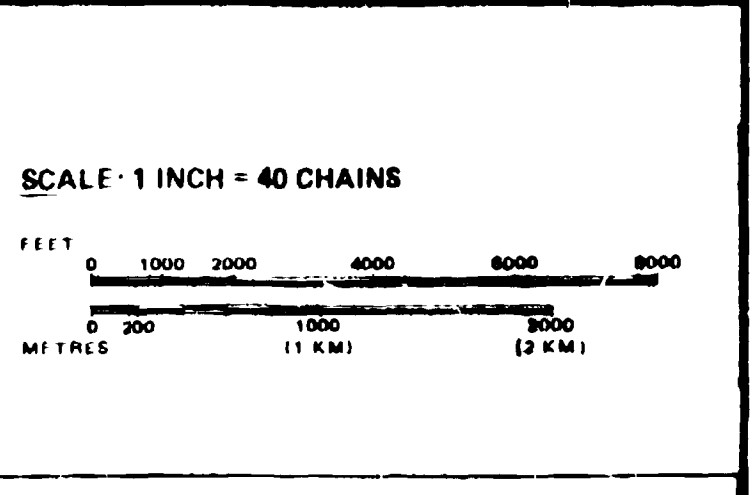

Ministry of Land Management
 Natural Resources Branch
 Ontario
 APRIL 29, 1988
 Date FEBRUARY 16th, 1981 Number
G-163

