

TECHNICAL REPORT
FINAL SUBMISSION

OPAP FILE 1

OP91-309 PAPER COPY

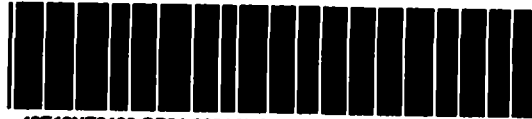

010

THIS REPORT IS TO COVER THE WORK DONE ON
"THE MAKI PROPERTY" IN VINCENT TWP. THUNDER
BAY MINING DIVISION.

ON THE WHOLE THE SUMMER PROGRAM WAS
SUCCESSFUL AS WE ENHANCED OUR SHOWINGS
FROM LAST YEAR, AS WELL AS LOCATING A NEW
ZONE WHICH LOOKS TO BE ONE OF CONSIDERABLE
MERIT. THE FOLLOWING SYNOPSIS OF DIFFERENT
AREAS WORKED IS AS FOLLOWS.

SHEET #1 THE MOOSEHORN-KIM AREA WAS BLASTED IN SEVERAL
PLACES FOR SAMPLING WHICH WAS DONE BY
HOMESTAKE CANADA LTD. THE BLASTED SECTIONS
SHOWED INCREASED MINERALIZATION, MAINLY
GALENA IN THE MOOSEHORN SECTOR, WHICH IS
ASSOCIATED WITH GOLD HERE AND IN THE DISCOVERY
AREA. ASSAYS SHOW CONSISTENT GOOD GOLD VALUES.
AT THIS WRITING VERBAL ASSAY RESULTS ONLY OBTAINED
THE TELEPHONE WERE GIVEN TO THE WRITER
BY THE HOMESTAKE CANADA LTD. GEOLOGIST, AND
ARE INCORPORATED ON THE ENCLOSED MAPS.
UPON RECEIPT OF ACTUAL ASSAY SHEETS WILL BE
FORWARDED TO THE OPAP OFFICE. NO NORA
AS TO A DEFINITE OPTION HAS BEEN DISCUSSED.
JOHN MASON'S (MINDM) VALUES FROM LAST YEAR ALONG
WITH HOMESTAKES CERTAINLY MAKE THIS SHOWING VERY
PROMISING FOR CONTINUED WORK THERE NEXT
SUMMER BY US OR THEN IN AN OPTION AGREEMENT
WITH SOME MINING COMPANY.

SHEET 2 THE KIM VEIN ALSO INCREASED MERIT WITH CONTINUING

GOOD VALUES BY HOMESTAKE CANADA LTD.

SHEET 3 THE BIG PIT AREA NEST UP TO THE SKIDDER TRENCH

WAS EXTENDED AS OLD REPORTS INDICATE GOLD SIGHTINGS WERE MADE IN THIS AREA (DR. PYE'S FIELD NOTES) NO U.G. WAS NOTED BY US, ALTHOUGH UPON STRIPPING ETC. THE QUARTZ VEIN IS PERSISTENT. NO GOLD WAS NOTED UPON PANNING. -BLASTING AND MORE STRIPPING SHOULD BE DONE NEXT SUMMER.

I WILL AT THIS POINT MENTION THE DIFFICULTY IN PROCURING STICK DYNAMITE WHICH ENTAILS RESTRICTIONS ON USAGE AND STORAGE. WE WERE TO BE IN A POSITION NEXT SUMMER TO HAVE THE PROPER FACILITIES AS REQUIRED. THERE IS ALSO A TIME LIMIT FOR USING THE DYNAMITE, ALL WHICH MADE IT PRACTICALLY IMPOSSIBLE FOR US TO DO THE BLASTING AS PROGRAMMED. THE BLASTING WE DONE WAS WITH MAGNAPAK WHICH IN MY OPINION IS NOT AS EFFECTIVE AS STICK DYNAMITE FOR OUR TYPE OF REQUIREMENTS.

SHEET 4 STRIPPING WAS DONE EAST OF THE LAKE SHORE END AND SHOWS A CONTINUATION OF THE GALENA RICH QUARTZ VEINING. THIS WAS NOT BLASTED DUE TO ABOVE MENTIONED DYNAMITE PROBLEMS. BARREN QUARTZ WAS SAMPLED WITH NEGATIVE RESULTS.

MORE WORK HERE IS REQUIRED.

SHEET 5 THE BOUNDARY SHOWING SHOWED NEGATIVE CONTINUATION OF THE QUARTZ GREENSTONE SHEARING PREVIOUSLY REPORTED. A FEW HOURS OF STRIPPING WAS DONE HERE AND WAS CARRIED ON THE LAKE SHORE LEG.

SHEET 5 PROSPECTING EAST OF THE BOUNDARY SHOWING ON THE KEY CLAIM LOCATED SEVERAL OUTCROPS OF MAFIC

TO INTRUSIVE ROCKS (GABRO?). THE ZONE OF ALTERATION WAS FOLLOWED UP TO THE EAST BOUNDARY OF THE KEY CLAIM. NO GOLD WAS NOTED UPON PANNING. NO STRIPPING WAS DONE HERE AS THE ZONE WAS ONLY 10M FROM A SMALL LAKE AND WATER COURSE. (NO WORK TO BE DONE WITHIN 30M OF A WATER COURSE; MIN. RESTRICTIONS)

SHEET 5 WE PROSPECTED ALONG STRIKE OF THE STRANDBERY VEIN EAST TO THE CLAIM BOUNDARY HOPING TO UNCOVER QUARTZ CARBONATE ALTERATION ON A STRONG IRON FORMATION UP TO 3M WIDE - FAIR PANNING WAS NOTED ON EAST END IN A RUSTY BAKERITE O/C. NO TIME WAS AVAILABLE FOR STRIPPING (RIVER CROSSING RESTRICTIONS)

SHEET 5 COLLECTING ROCK FROM THE KEY CLAIM WAS CONTINUED FROM LAST YEAR'S BLASTING AND STRIPPING. THIS WAS TRANSPORTED TO CAMP FOR CRUSHING AND CONCENTRATING. IT APPEARS CONTINUED WORK ON THE KEY CLAIM SHOWING (V.G. IN QUARTZ) WOULD LEAD TO A PROFITABLE SMALL SCALE MINING VENTURE.

MINOR BLASTING WAS DONE ON THE DISCOVERY

SHEET 6 EAST EXTENSION WHICH WAS STRIPPED LAST SUMMER. ONE SAMPLE BY HOMESTAKE OF THE QUARTZ EXPOSURE WAS TAKEN (SEE BASE MAP). MORE WORK SHOULD BE DONE HERE.

SHEET 7 THE AD. VEIN IS A NEW SHOWING WHICH WAS FOUND BY PROSPECTING NEAR A KNOWN Banded IRON FORMATION DYKE WHICH WE HAD BLASTED, SAMPLED (NEGATIVE '01) AND WALKED OVER FOR SEVERAL YEARS TO GET TO

SANORA'S PIT. WE NOTED A SMALL SLASH OF QUARTZ ON THE SOUTH SIDE OF THE DYKE WHEN WE WERE GRUBBING THERE. WHEN THE SHOOPER STARTED STRIPPING THIS A 2 TO 3 M WIDE ZONE OF SULPHIDE RICH FOLDED QUARTZ CARBONATE WAS UNCOVERED. HEAVY RUSTY MATERIAL WAS PANNED AND SHOWED VERY GOOD GOLD. WE FELT THIS WAS AN IMPORTANT FIND SO WE DONE MOST OF THE STRIPPING & TRENCHING ON THIS NEW SHOWING. EVERY SPOT WE PANNED SHOWED GOLD IN THE PAN. ASSAY RESULTS BY HOMESTAKE PROVED THE PRESENCE OF GOLD, AND GERRY WHITES (MNR) SAMPLING SHOWED SOME VALUES ^{SOME OF} ABOVE THE BEST PLACES WERE NOT SAMPLED. THE PRESENCE OF GOLD IN A GOOD GEOLOGICAL SETTING ALONG STRIKE IS VERY ENCOURAGING. WE ALSO FEEL THIS AREA COULD TIE INTO SANORA'S PIT. DISCUSSING THE PROPERTY WITH "CAMERO" A VISIT TO THE PROPERTY BY THEM IS CONTEMPLATED. AT THIS WRITING, ALTHO WEATHER CONDITIONS COULD MAKE A PROPERTY EXAMINATION IMPOSSIBLE UNTIL NEXT SPRING. THE WRITER IS WANTING TO HEAR FROM BOTH "HOMESTAKE" AND "CAMERO" THIS DAY (OCTOBER 30, 1991).

AGAIN WE THANK OPAP FOR THE FUNDING TO MAKE OUR WORK PROGRAM A SUCCESS.

ANY ADDITIONAL INFORMATION REGARDING "HOMESTAKE" AND/ OR "CAMERO" WILL BE FORWARDED TO THE OPAP OFFICE

SUBMITTED BY
 Wili M. Mokiwha
 NEIL & ANI MAKI



Ontario

Ministry of
Northern Development
and Mines

Ministère du
Développement du Nord
et des Mines

October 29, 1991

Mr. Neil Maki
R. R. #14
3rd Conc. Road
Thunder Bay, Ontario
P7B 5E5

Dear Neil:

The following are gold assay results for four samples that John Mason and myself collected on October 8 while visiting your Vincent Township property. All samples are from the "AM" Zone.

<u>Sample No.</u>	<u>Au (oz/ton)</u>
91-MNM-2 (east end - 3+00W, 0+35N)	nil
91-MNM-3 (3+75W, 0+35N)	.008
91-MNM-4 (L4+40W, bottom of pit)	.108
91-MNM-5 (L4+40W, south banded IF)	trace (<.001)

Sincerely,

Gerry White, Staff Geologist
Beardmore-Geraldton District
Client Services Branch
Ontario Geological Survey
Ministry of Northern Development and Mines
P. O. Box 5000
Thunder Bay, Ontario P7C 5G6
Tel. (807)475-1331

GW/clk

MOOSEHORN

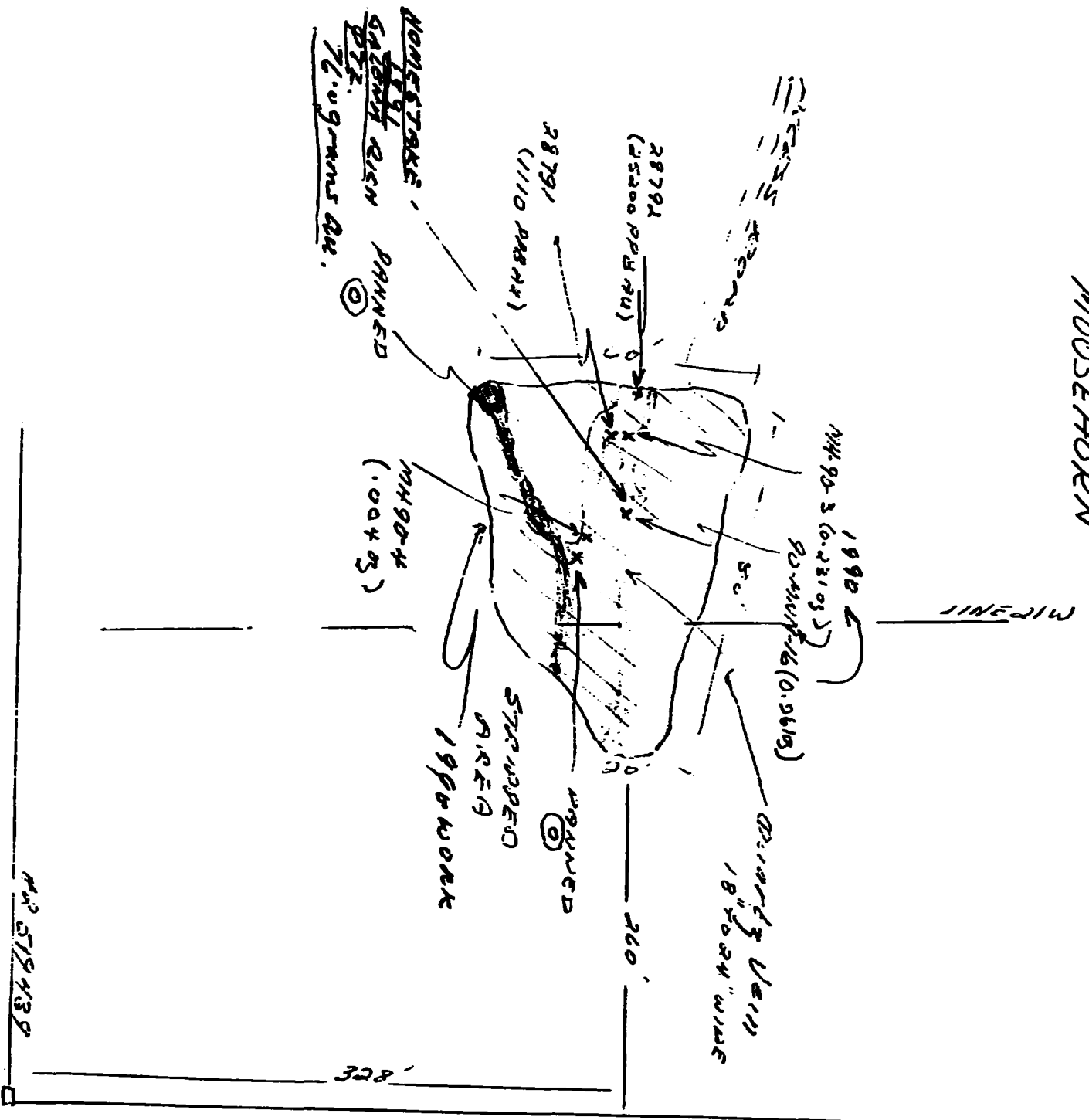

(2)

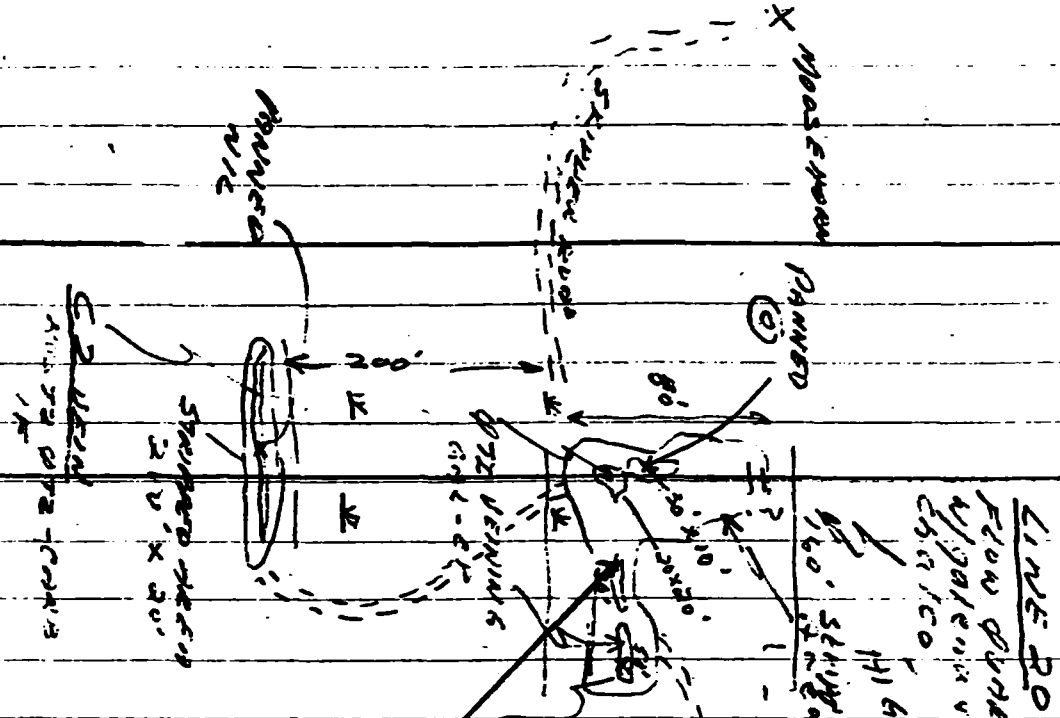

LINE 20

LINE 19

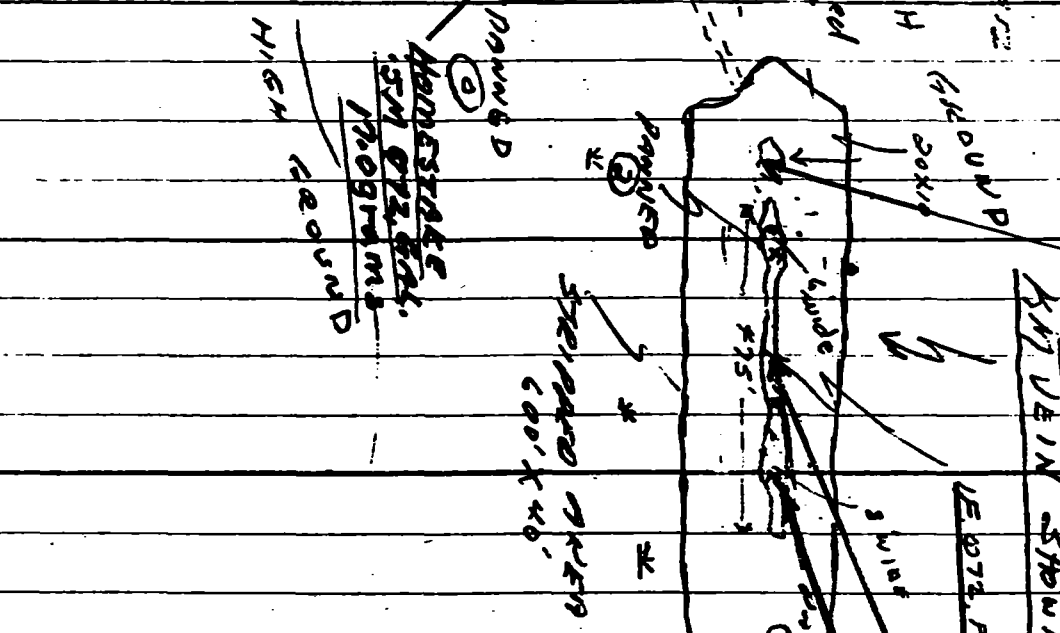

LINE 18

LINE 17

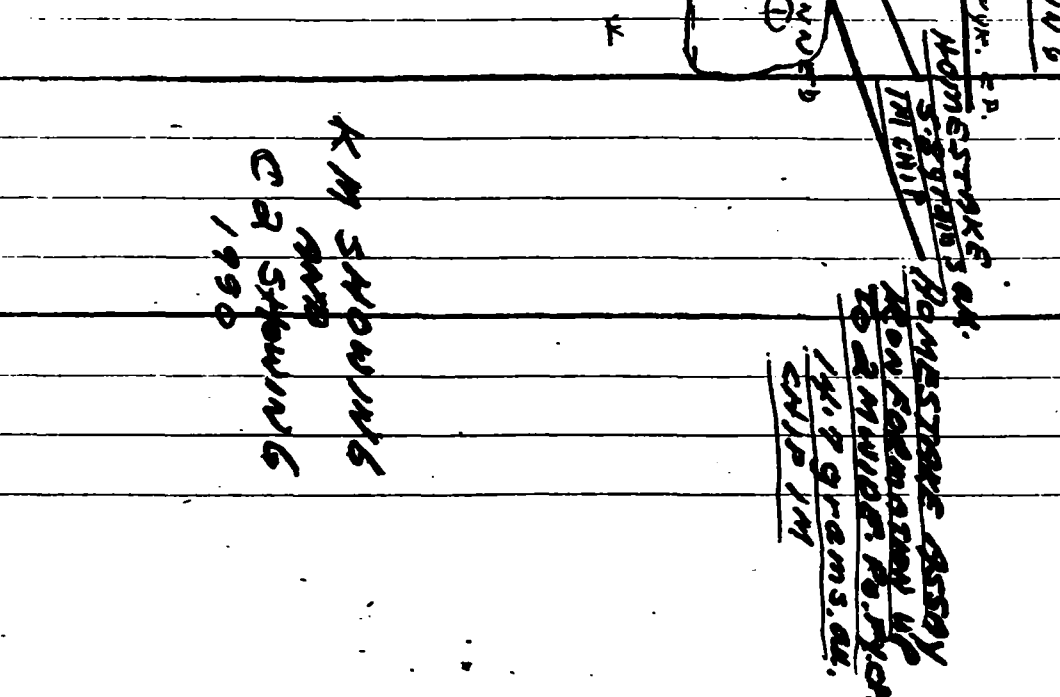

LINE 16

EAST LINE

K.M. SHOWING
C2 SHOWING
1990

HOMESTEAD ASSAY
KON FARMINGTON W.P.
TO A MURDER P.B. PLOT
14.8 Grams. Au.
C2 USED IN

3

DAND - SKIDDER TRAIL
11055' E ND PRESS
1990 WORK
1991 WORK
SHOWAN TRAILS

SW

W

NE

SE

SE

SE

Striped area
30' x 30'
Blocky
13611 gts
4' wide

Striped area
30' x 30'
COND

Striped area
30' x 30' NW
Striped area
30' x 30' NW
Striped area
30' x 30' NW
Striped area
30' x 30' NW

X
SYSTEMS
VEIN

SKIDDER
RD

Striped area
30' x 40'
COND

BIG PIT

Striped area
10' x 10'
COND
Striped area
10' x 10'
COND

Striped area
100' x 30'

Striped area
100' x 30'

Striped area
100' x 30'

Striped area
100' x 30'

Striped area
Quartz veining
3-4" in
over galena
PIT

Baseline

BIG PIT PRESS

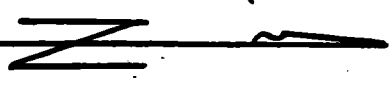

4

COPY

BIRDS WEST
1990

ADJUSTABLE
GALV. SHEET PILING

1991 WORK SHOWN THUS.

LAKES

LAKESHORE UTILITY

old trenches

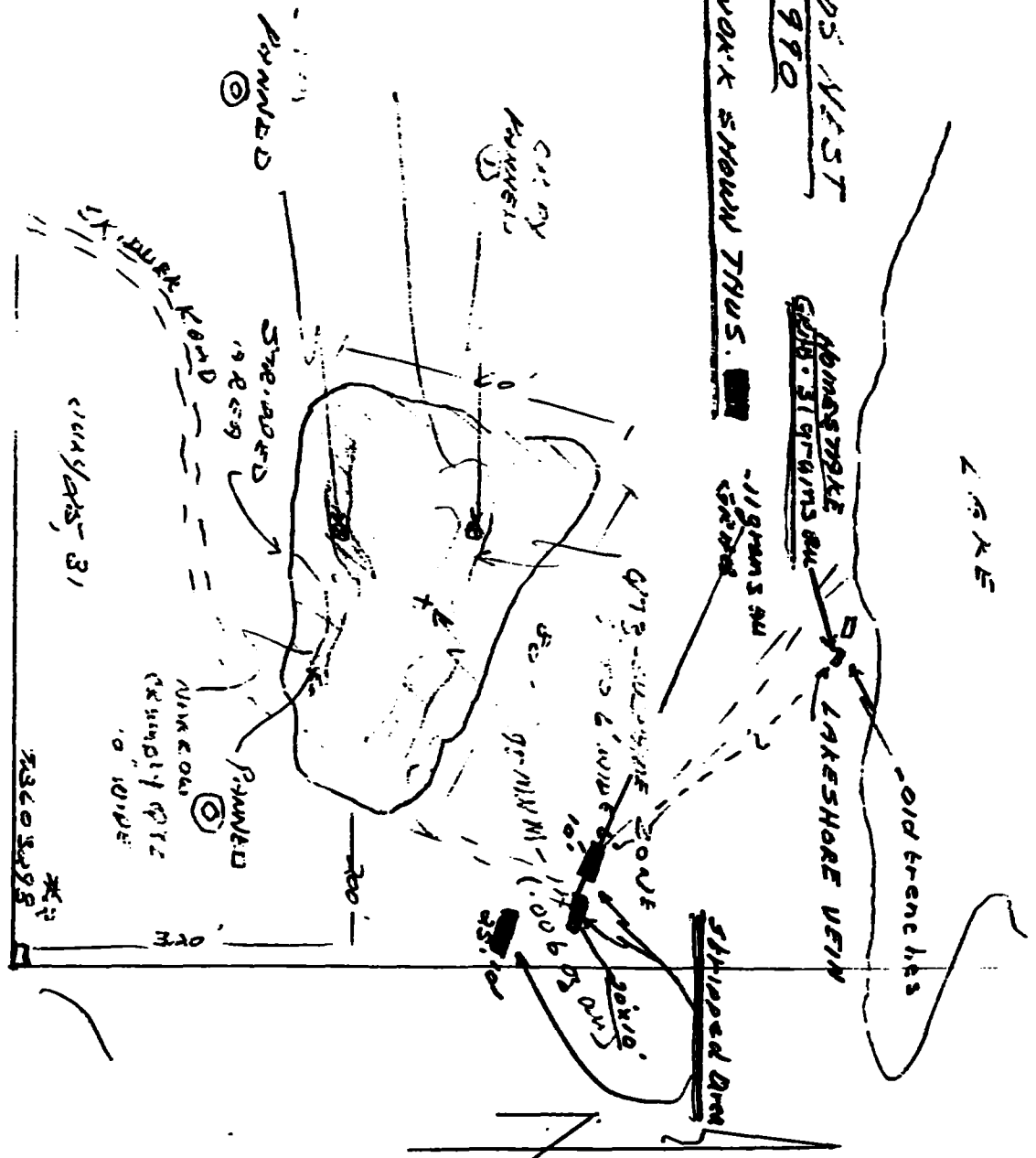

5

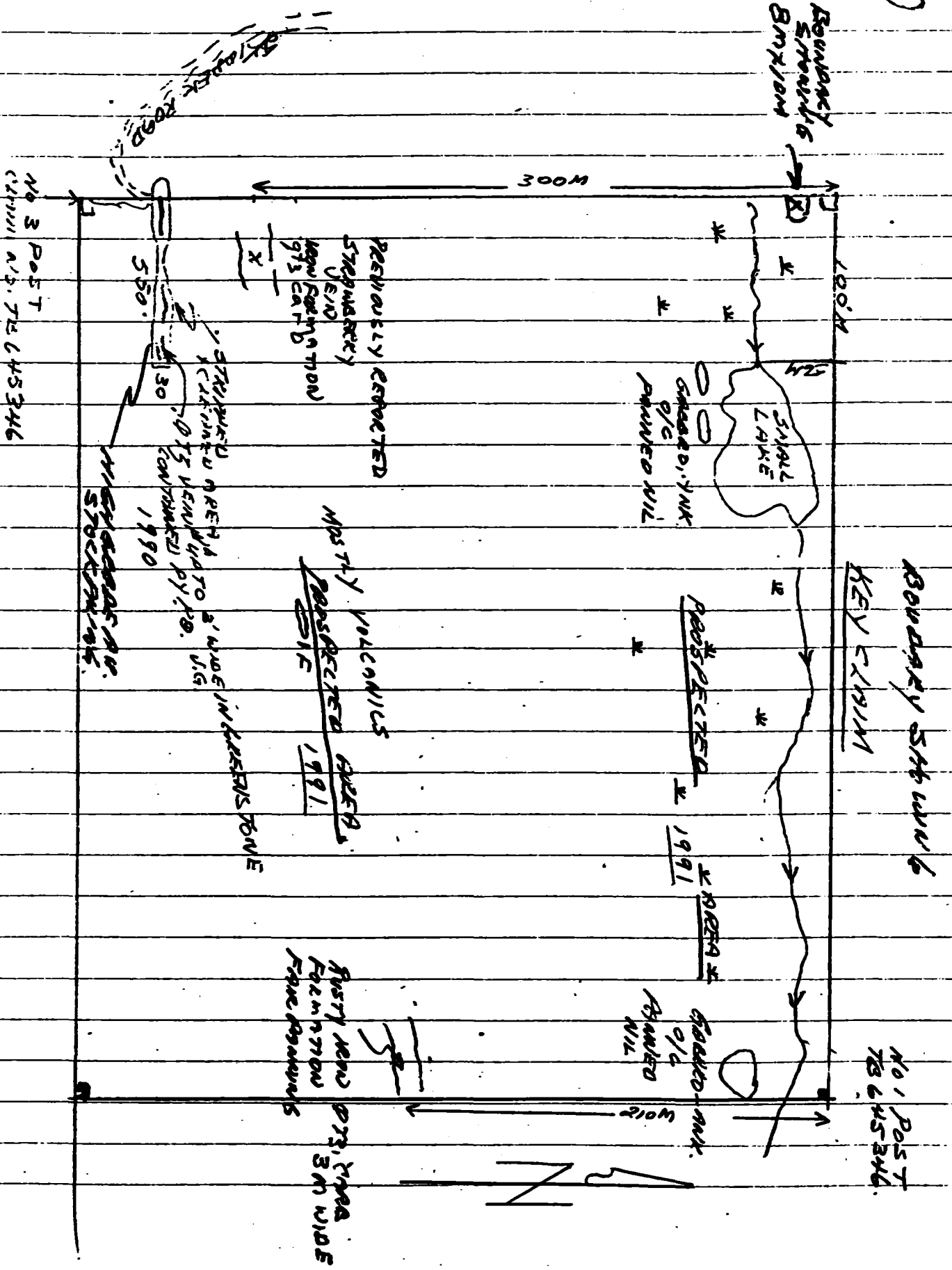

②

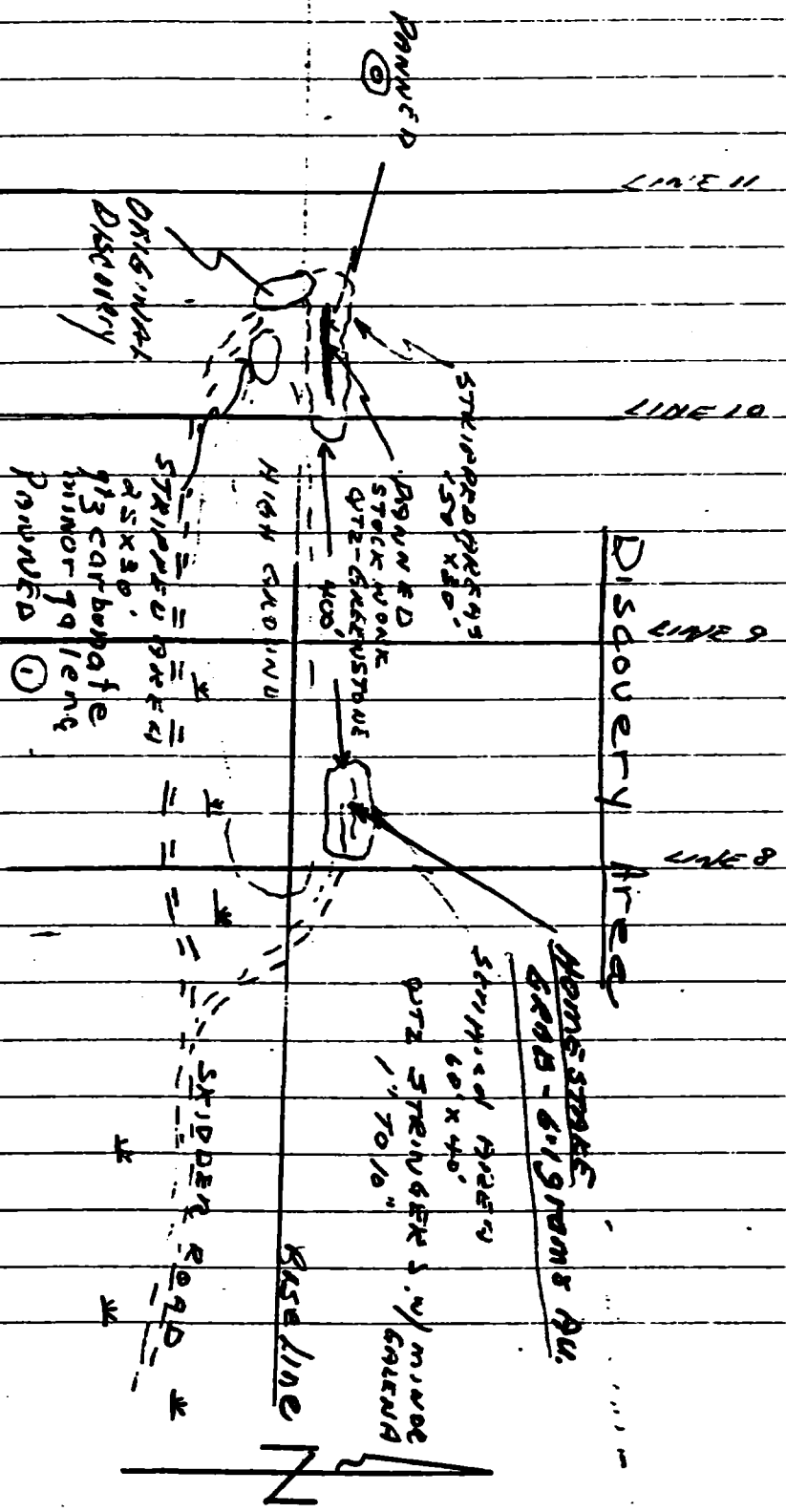

SCALE AS SHOWN

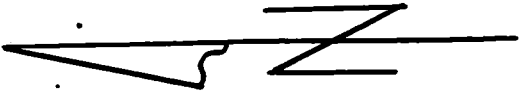

• Panning location

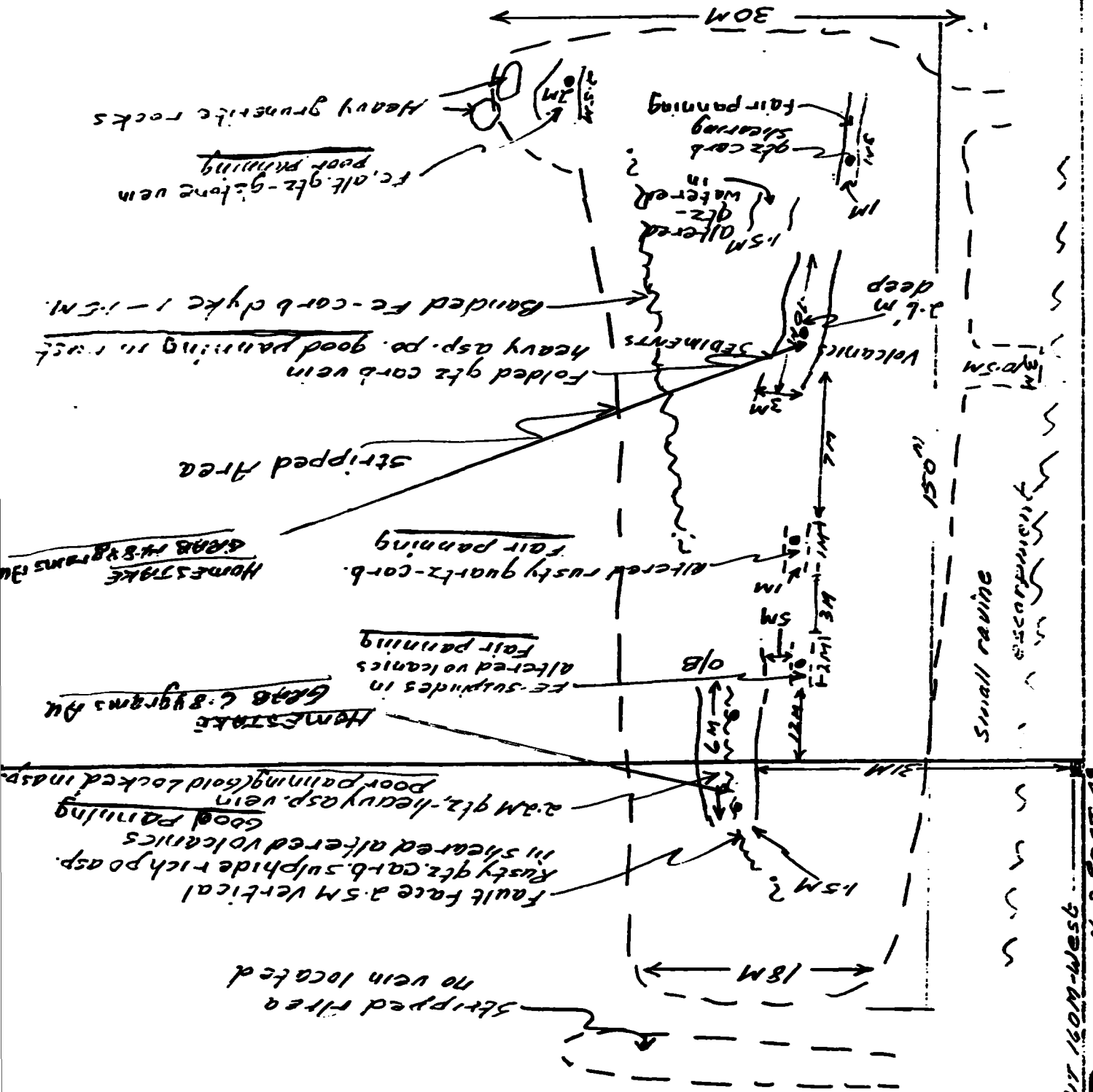

A.M. SHOWING 1991

TRINIDAD PIT 150M-West
No. 2 POST-1
7B 459787





Swastika Laboratories

A Division of Assayers Corporation Ltd.

Established 1928

Assaying - Consulting - Representation

MAK1

Geochemical Analysis Certificate

1W-3973-RG1

Company: **HOMESTAKE CANADA**
Project: **5600 VINCENT**
Attn: **G. YULE**

Date: **SEP-30-91**
Copy 1. P.O. BOX 290, TIMMINS, ONT. P4N 7N6
2. 2116-120 ADELAIDE ST. W. TORONTO M5H 1T1
3. FAX TO 267-2866

We hereby certify the following Geochemical Analysis of 18 ROCK samples submitted SEP-16-91 by G. YULE.

Sample Number	Au ppb	Au check ppb	Au 2nd ppb	Ag ppm	As ppm	As %	Cu ppm	Pb ppm
A-102	14400	15703	14537					
A-103	5795							
A-104	507							
A-105	17006			119.7			3800	10900
A-106	75429	77486		546.0			5740	72100
A-107	555							
A-108	1680					4		
A-109	24				140			
A-110	309			1.1				
A-111	113							
A-112	10							
A-113	14880				>10000	5.5		
A-114	6891				>10000	6.0		
A-115	12617	12412			>10000	1.7		
A-116	6103							
A-117	75							
A-118	823				>10000	7.0		
A-119	34				80			

Certified by *Donna Gardner*

P.O. Box 10, Swastika, Ontario P0K 1T0
Telephone (705) 642-3244 FAX (705) 642-3300

Vincent91

MAKI PROPERTY VISIT
Vincent Township

NTS# 42E/12
September 11, 1991

Sample #	Location	Au* (gm/t)	Sample Type	Host Lithology	Mineralization
A 102	Moosehorn Vein, 250m E	14.79 ✓	1.0 m chip	Oxide IF	Sugar qtz; tr py, mag
A 103	Moosehorn Vein, 220m E	5.80 ✓	1.0 m chip	Oxide IF	Sugar qtz; tr po, py
A 104	Moosehorn Vein, 150m E	0.51 ✓	0.3 m chip	Cherty IF	1-2% diss po
A 105	Moosehorn Vein, 150m E	17.01 ✓	Grab	Quartz vn	0.5m vein; 5% cpy, gal
A 106	Moosehorn Vein	76.46 ✓	Grab	Quartz vn	0.5m vein; 5% gal, cpy
A 107	Moosehorn Vein	0.56 ✓	Grab	Quartz vn	0.5 m (TW) vein; tr py
A 108	Strawberry Zone	1.68	1.0 m chip	Oxide IF	20% qv, tr py
A 109	Strawberry Zone	0.02	Grab	cb mafic wallrock; tr py	
A 110	Lakeshore Vein	0.31 ✓	Grab (15m)	Quartz vn	2-3% cpy, gal
A 111	Lakeshore Vein	0.11 ✓	1.5 m chip	Quartz vn	0.5% cpy, gal, py
A 112	Birds/Nest Vein	0.01 ✓	2.5 m chip	Quartz vn	Tr cpy
A 113	A.M. Zone	14.88 ✓	Grab	Oxide IF	5-8% bands Aspy
A 114	A.M. Zone (Duplicate Samp)	6.89 ✓		Oxide IF	5-8% bands Aspy
A 115	Sandra Zone (200mW of AM)	12.51 ✓	0.5 m chip	Oxide IF	Grunerite, 3% aspy, po, py
A 116	Discovery East Extension	6.10 ✓	Grab	Quartz vn	0.5m qv; Tr cpy, gal
A 117	A.M. East (50m E A113)	0.08 ✓	Grab	Quartz vn	Tr-1% sulphides
A 118	A.M. East (100m E A113)	0.82 ✓	Grab	Oxide IF	Wallrx of A117, 30% cg Aspy
A 119	A.M. East (175m E A113)	0.03 ✓	Grab	Oxide IF	Sugar qtz; 1-3% aspy, mag

Refer to: Swastika Geochemical Analysis Certificate # 1W-3973-RG1
Dated: September 24, 1991

Signed:

Gord Yule

Gord Yule
Senior Project Geologist,
Homestake Canada Ltd.

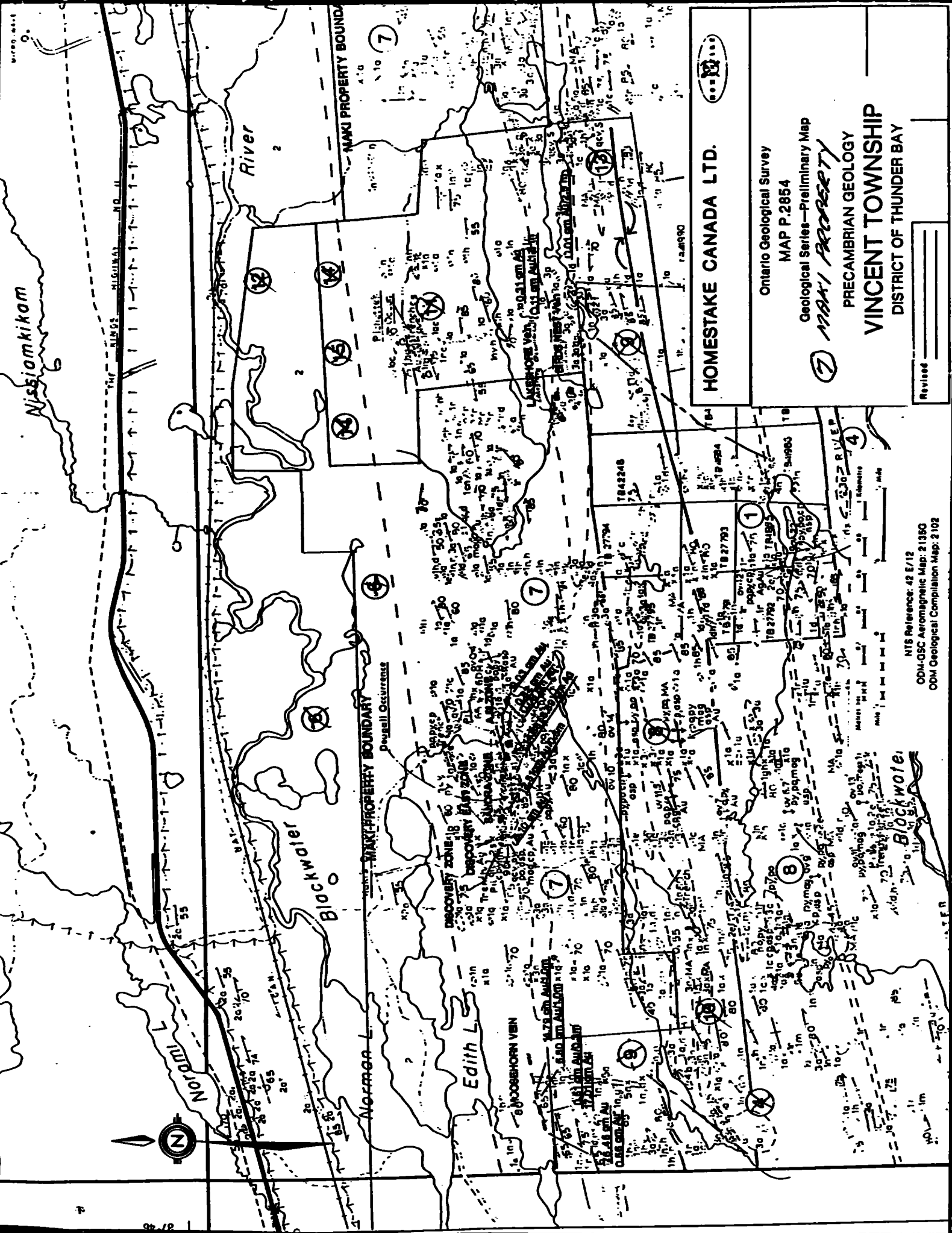

HOMESTAKE CANADA LTD.

Ontario Geological Survey
MAP P.2854

Geological Series—Preliminary Map

PRECAMBRIAN GEOLOGY
VINCENT TOWNSHIP
DISTRICT OF THUNDER BAY

⑦

MAKI PROPERTY

Revised

NTS Reference: 42 E/12
ODM-GSC Aeromagnetic Map: 21350
ODM Geological Compilation Map: 2102

Nissiomikom River

Blackwater River

Edith Lake

Norman

MAKI PROPERTY BOUNDARY

MAKI PROPERTY BOUNDARY

Discovery Zone

BOOSBORN VEN

WATER DIVISION

WATER DIVISION

WATER DIVISION

WATER DIVISION

WATER DIVISION

WATER DIVISION

WATER DIVISION

WATER DIVISION

WATER DIVISION

WATER DIVISION

WATER DIVISION

WATER DIVISION

WATER DIVISION

WATER DIVISION

WATER DIVISION





Swastika I

A Division of Assay

Assaying - Consulti

Established 1928

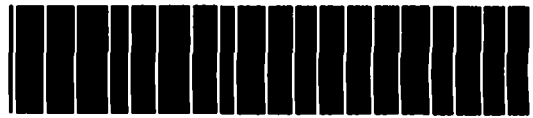

42E12NE0160 OP91-308 VINCENT

020

Geochemical Analysis Certificate

1W-3973-RG1

Company: **HOMESTAKE CANADA**
Project: **5600 VINCENT**
Attn: **G. YULE**

~~1W-3973-46-1~~ Date: **SEP-30-91**
Copy 1. P.O. BOX 290, TIMMINS, ONT. P4N 7N6
2. 2116-120 ADELAIDE ST. W. TORONTO M5H 1T1
3. FAX TO 267-2866

We hereby certify the following Geochemical Analysis of 18 ROCK samples submitted SEP-16-91 by G. YULE.

Sample Number	Au ppb	Au check ppb	Au 2nd ppb	Ag ppm	As ppm	As %	Cu ppm	Pb ppm
A-102	14400	15703	14537					
A-103	5795							
A-104	507							
A-105	17006			119.7			3800	10900
A-106	75429	77486		546.0			5740	72100
A-107	555							
A-108	1680				4			
A-109	24				140			
A-110	309			1.1				
A-111	113							
A-112	10							
A-113	14880				>10000	5.5		
A-114	6891				>10000	6.0		
A-115	12617	12412			>10000	1.7		
A-116	6103							
A-117	75							
A-118	823				>10000	7.0		
A-119	34				80			

Certified by Donna Gardner

P.O. Box 10, Swastika, Ontario P0K 1T0
Telephone (705) 642-3244 FAX (705) 642-3300

Vincent91

MAKI PROPERTY VISIT
Vincent Township

NTS# 42E/12
September 11, 1991

Sample #	Location	Au* (gm/t)	Sample Type	Host Lithology	Mineralization
A 102	Moosehorn Vein, 250m E	14.79	1.0 m chip	Oxide IF	Sugar qtz;tr py, mag
A 103	Moosehorn Vein, 220m E	5.80	1.0 m chip	Oxide IF	Sugar qtz; tr po, py
A 104	Moosehorn Vein, 150m E	0.51	0.3 m chip	Cherty IF	1-2% diss po
A 105	Moosehorn Vein, 150m E	17.01	Grab	Quartz vn	0.5m vein; 5% cpy, gal
A 106	Moosehorn Vein	76.46	Grab	Quartz vn	0.5m vein; 5% gal, cpy
A 107	Moosehorn Vein	0.56	Grab	Quartz vn	0.5 m (TW) vein; tr py
A 108	Strawberry Zone	1.68	1.0 m chip	Oxide IF	20% qv, tr py
A 109	Strawberry Zone	0.02	Grab	cb mafic wallrock; tr py	
A 110	Lakeshore Vein	0.31	Grab (15m)	quartz vn	2-3% cpy, gal
A 111	Lakeshore Vein	0.11	1.5 m chip	quartz vn	0.5% cpy, gal, py
A 112	Birds/Nest Vein	0.01	2.5 m chip	quartz vn	Tr cpy
A 113	A.M. Zone	14.88	Grab	Oxide IF	5-8% bands Aspy
A 114	A.M. Zone (Duplicate Samp)	6.89		Oxide IF	5-8% bands Aspy
A 115	Sandra Zone(200m of AM)	12.51	0.5 m chip	Oxide IF	Grunerite, 3% aspy, po, py
A 116	Discovery East Extension	6.10	Grab	quartz vn	0.5m qv; Tr cpy, gal
A 117	A.M. East (50m E A113)	0.08	Grab	quartz vn	Tr-1% sulphides
A 118	A.M. East (100m E A113)	0.82	Grab	Oxide IF	Wallrx of A117, 30% cg Aspy
A 119	A.M. East (175m E A113)	0.03	Grab	Oxide IF	Sugar qtz;1-3% aspy, mag

Refer to: Swastika Geochemical Analysis Certificate # 1W-3973-RG1
Dated: September 24, 1991

Signed:

A. Yule

Gord Yule
Senior Project Geologist,
Homestake Canada Ltd.

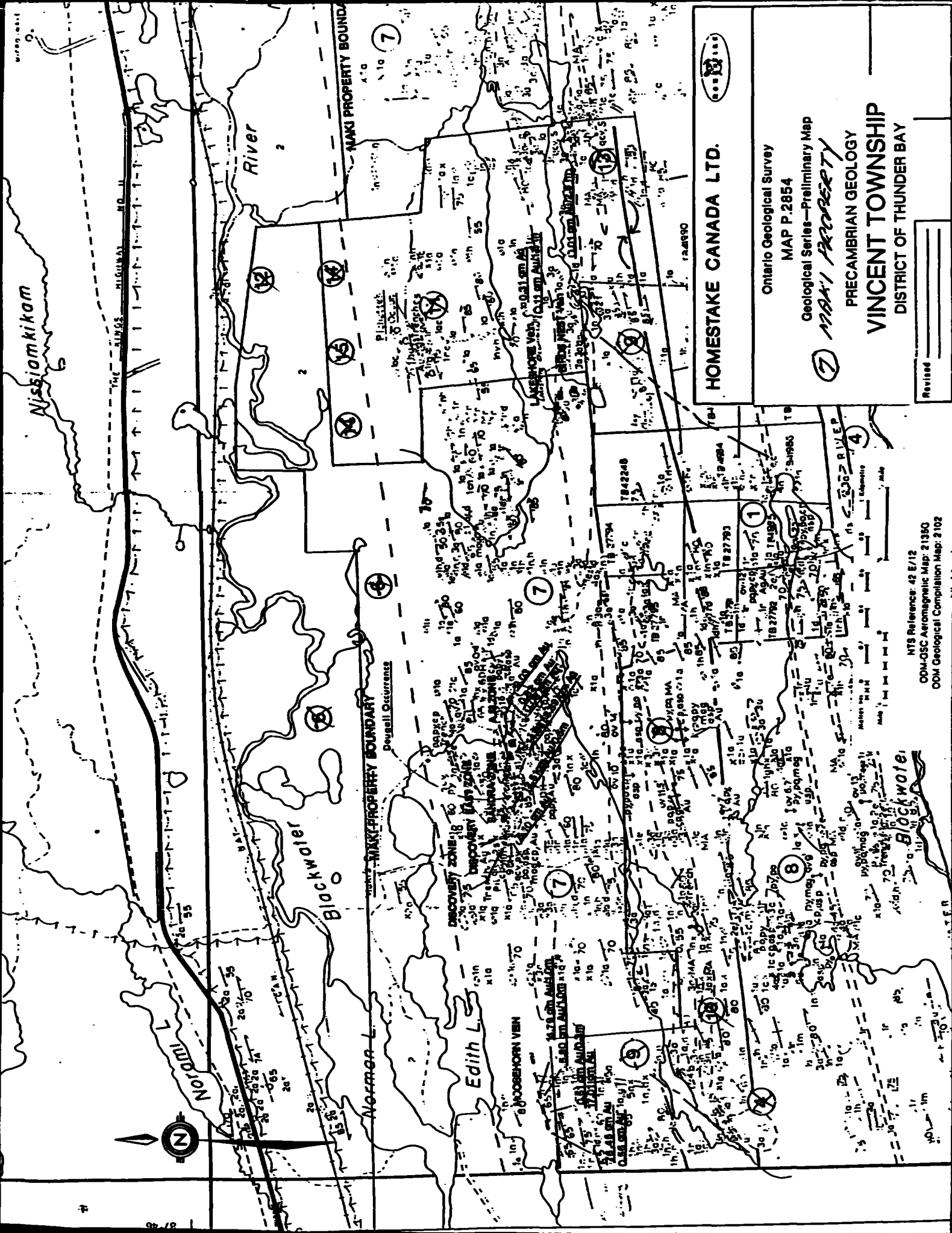

HOMESTAKE CANADA LTD.

Ontario Geological Survey
MAP P.2854

Geological Series—Preliminary Map

MAKI PROPERTY

PRECAMBRIAN GEOLOGY

VINCENT TOWNSHIP

DISTRICT OF THUNDER BAY

Revised _____

NTS Reference: 42 E/12
OOM-QSC Aeromagnetic Map: 2 1350
OOM Geological Compilation Map: 2 102

Blockwater

MAKI PROPERTY BOUNDARY

Blockwater

Norman

Edith L.

MOOSEHORN VEIN

LAKESHORE VEIN

Discovery Zone

Peaseall Occurrences

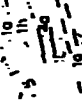

M.N.R. ADMINISTRATIVE DISTRICT

THUNDER BAY

MINING DIVISION

THUNDER BAY

LAND TITLES / REGISTRY DIVISION

THUNDER BAY

SUMMER RESORT LOCATIONS NOT OPEN FOR STAKING (SEC.30C)

PLEASE REFER TO THE APPROPRIATE RECORDS FOR THE LOCATION OF THESE LOCATIONS

THE INFORMATION THAT APPEARS ON THIS MAP HAS BEEN COMPILED FROM VARIOUS SOURCES AND ACCURACY IS NOT GUARANTEED. THOSE WISHING TO STAKE MINING CLAIMS SHOULD CONSULT WITH THE MINING RECORDER, MINISTRY OF NORTHERN DEVELOPMENT AND MINES, FOR ADDITIONAL INFORMATION ON THE STATUS OF THE LANDS SHOWN HEREON. INFO SERVICE DIV. 22/84

LEGEND

- PATENTED LAND (P or M)
- PATENTED FOR SUBSIDIARY RIGHTS ONLY (S)
- LEASE MRO (M) RCAMRO (R)
- LICENSE OF OCCUPATION (L.O.)
- GRANT LAND SALES (C.S.)
- LOCATED LAND (Loc.)
- CANCELLED (C)
- MINING RIGHTS ONLY (M.R.O.)
- SUBSIDIARY RIGHTS ONLY (S.R.O.)
- REGISTRY & ROUTE NO. (R)
- ROADS (—)
- RAILS (—)
- RAILWAYS (—)
- POWER LINES (—)
- MARSH OR MUCKLE (—)
- MINES (—)

SCALE 1 INCH = 40 CHAINS

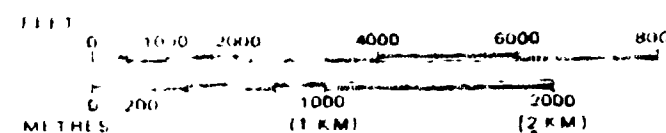

Ministry of Natural Resources Ontario Land Management Branch

Date FEBRUARY 10th, 1981

Number

G-166

SUMMERS TWP G-165

VINCENT TWP G-163

91 APR 18 AM 11:22

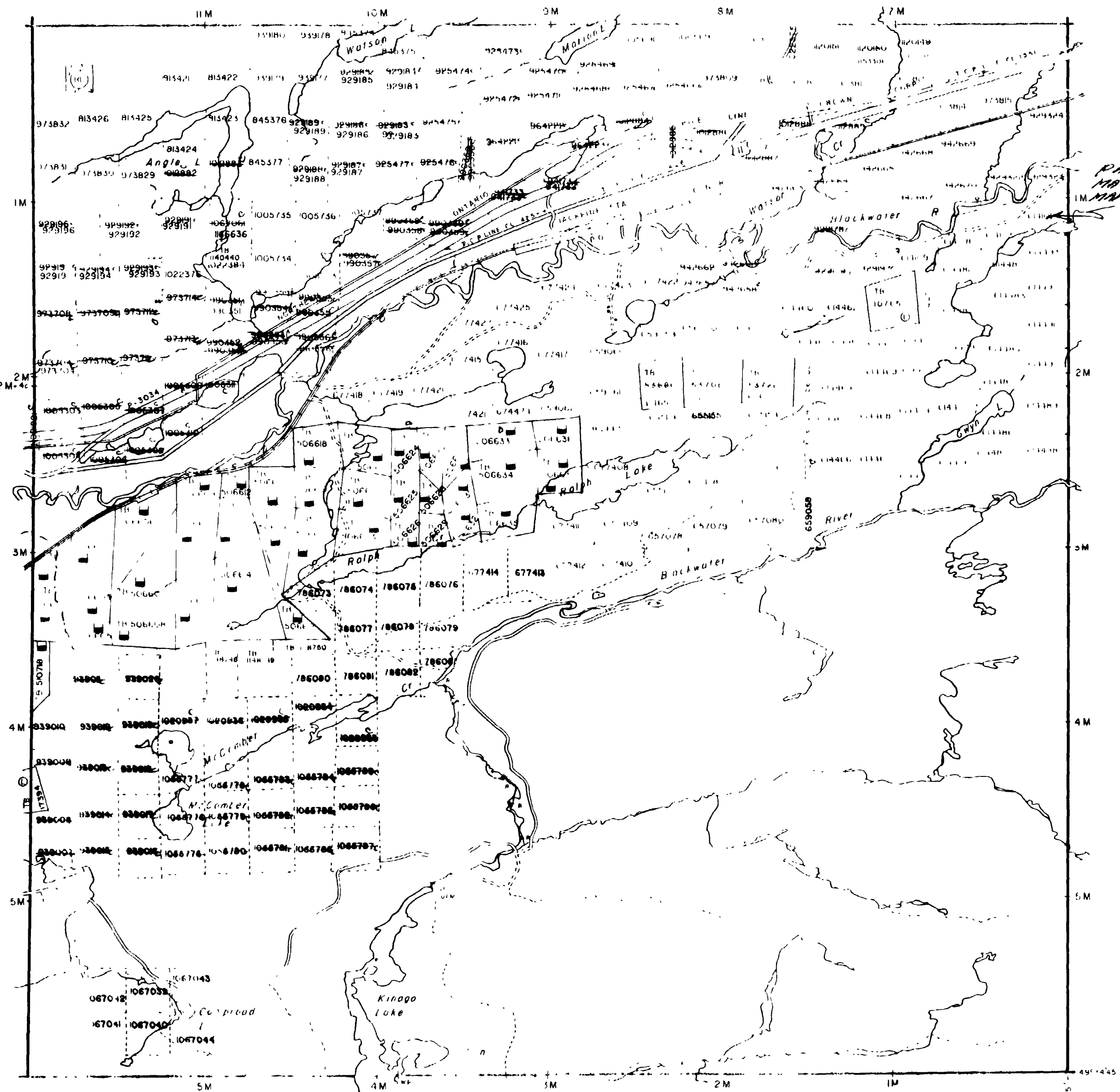

BEAUFORT AREA G-7



42E12NE0160 OP#1-308 VINCENT

WALTERS TWP G-171

17 18

VINCENT

M. N. R. ADMINISTRATIVE DISTRICT

NIPIGON

MINING DIVISION

THUNDER BAY

LAND TITLES REGISTRY DIVISION

THUNDER BAY

R. M. O. Leitch, owner of Block 1039/88 and Vincent Twp. 163 Landroll

THE INFORMATION THAT APPEARS ON THIS MAP HAS BEEN COMPILED FROM VARIOUS SOURCES AND ACCURACY IS NOT GUARANTEED. THOSE WISHING TO STAKE MINING CLAIMS SHOULD CONSULT WITH THE MINING RECORDER, MINISTRY OF NORTHERN DEVELOPMENT AND MINES FOR ADDITIONAL INFORMATION ON THE STATUS OF THE LANDS SHOWN HEREON.

CLIST LAKE G-24

LEOPARD LAKE G-68

McCOMBER TWP G-166

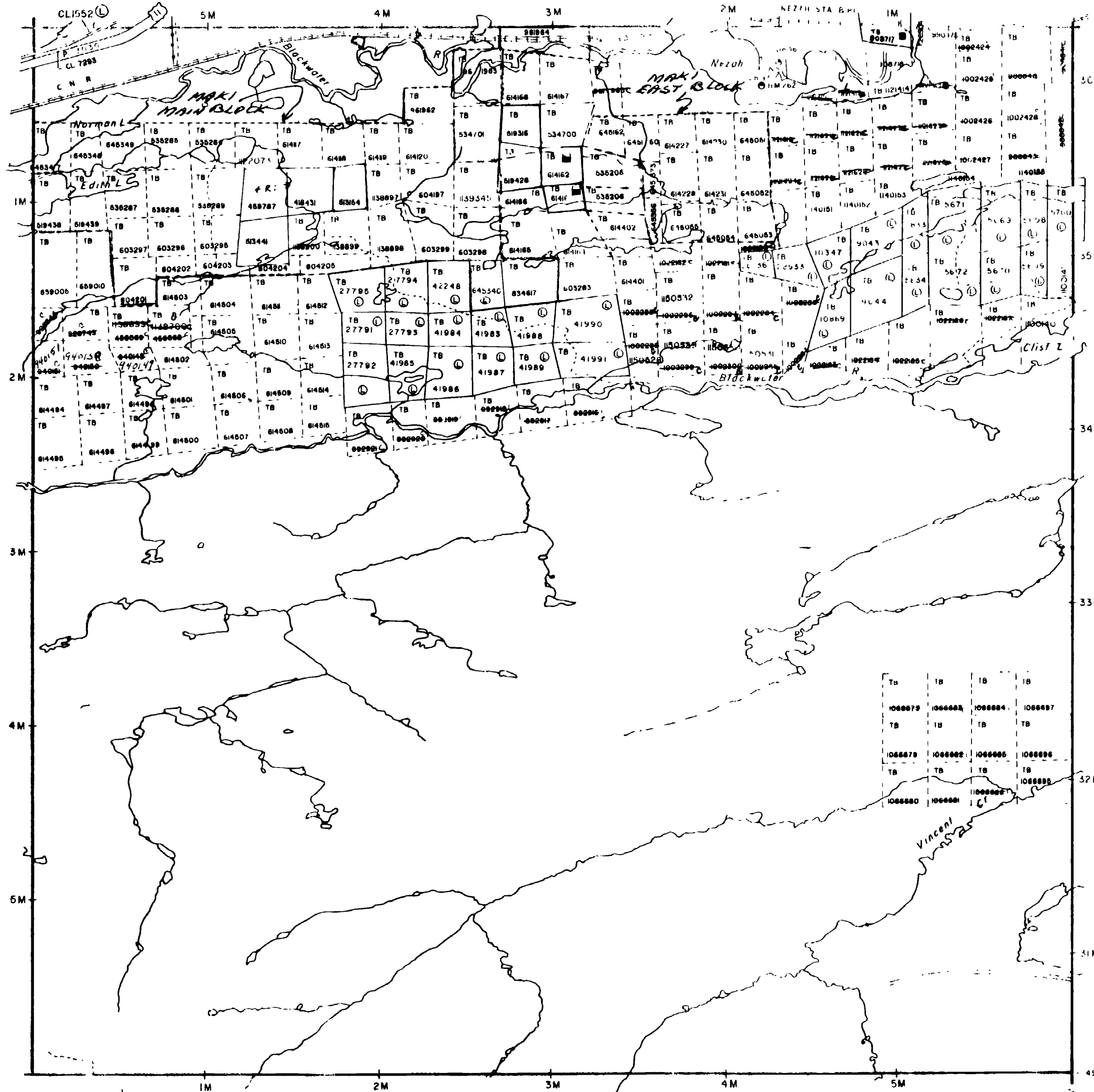

LEGEND

- PATENTED LAND (P or ●*)
 - PATENTED FOR SURFACE RIGHTS ONLY (●)
 - LEASE (L)
 - LICENSE OF OCCUPATION (L.O.)
 - CROWN LAND SALES (C.S.)
 - LOCATED LAND (Loc.)
 - CANCELLED (C.)
 - MINING RIGHTS ONLY (M.R.O.)
 - SURFACE RIGHTS ONLY (S.R.O.)
 - HIGHWAY & ROUTE NO. (Hwy/Route symbol)
 - ROADS (Road symbol)
 - TRAILS (Trail symbol)
 - RAILWAYS (Railway symbol)
 - POWER LINES (Power line symbol)
 - MARSH OR MUSKEG (Marsh/Muskeg symbol)
 - MINES (Mines symbol)
- *used only with summer resort locations or when space is limited

SCALE: 1 INCH = 40 CHAINS

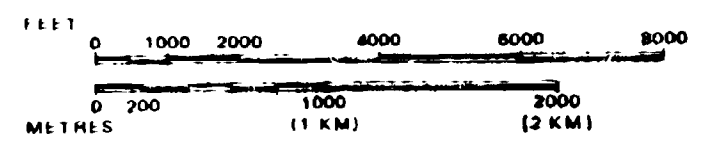

Ministry of Land Management
Natural Resources Branch
Ontario

Date FEBRUARY 16th, 1981

Number G-163

BEARDMORE G-7



210

LEOPARD LAKE G-68

91 MAR 18 AM 11 21

TRUNK LANDING NORMAN LAKE

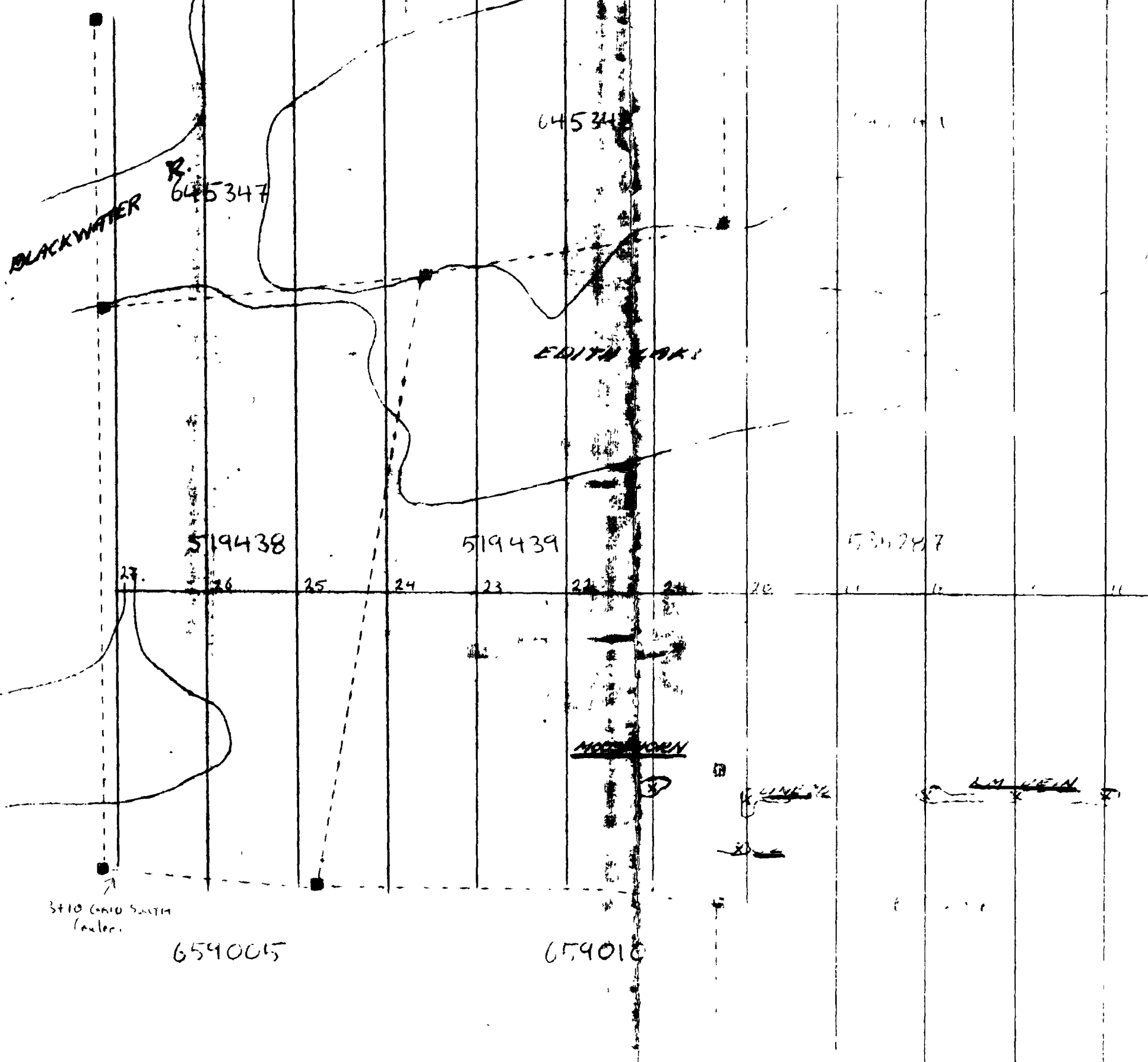

SCALE 1:5000

LOCATION MAP ONLY

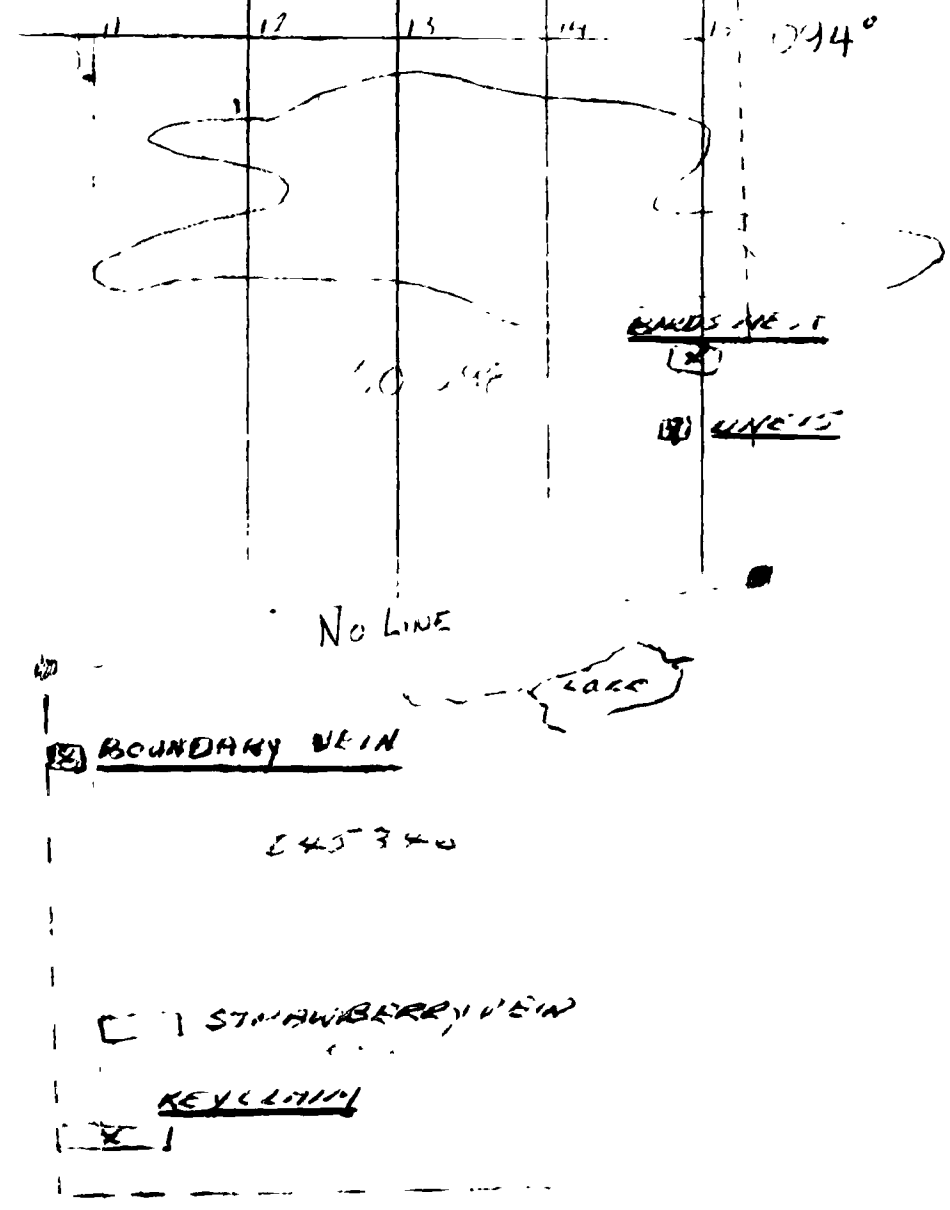
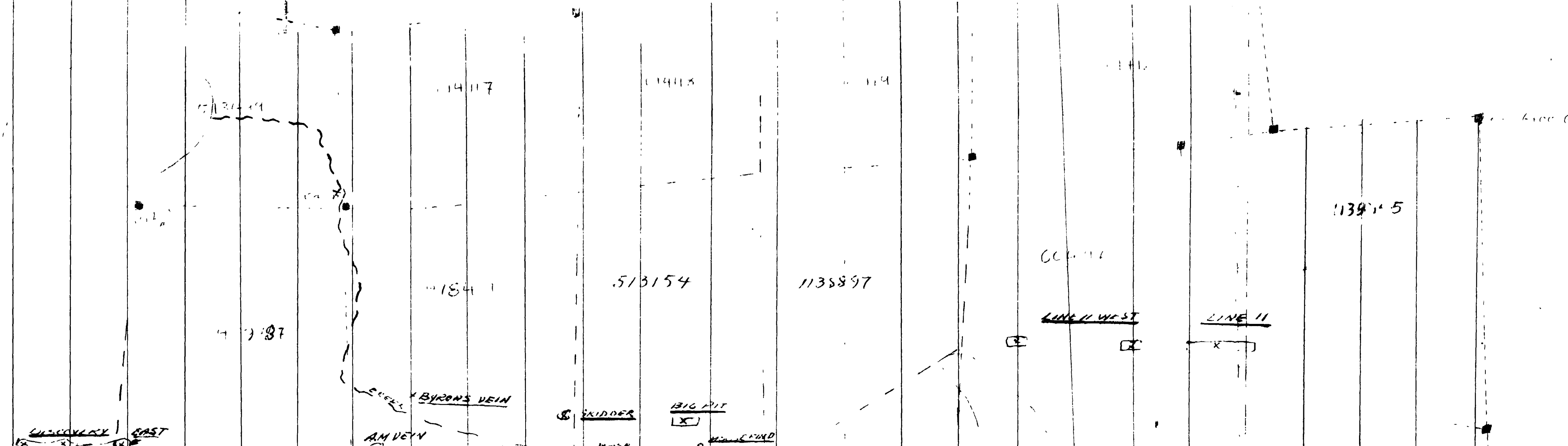

STRAWBERRY VEIN

KEY LIME