



REPORT ON 1984 DRILLING PROGRAM: TENACITY OPTION, VINCENT TOWNSHIP, ONTARIO.
 OMEP OM 83-4-C-360

G. DOUGLAS

Feb. 7, 1985

INTRODUCTION

Craskie Mines Limited controls a block of 64 unpatented and 15 leased mining claims in Vincent and M^CComber Townships. During the winter of 1983 a portion of these claims were covered with magnetic and electro-magnetic surveys. At this time seven samples were collected and heap leaching tests were conducted to evaluate the amenability of the ore to recovery by this method of extraction. The results of these tests suggested that fairly good recovery of gold could be expected from the iron formation. In 1984 the Craskie management elected to test strike extensions of a gold bearing zone which had been located by diamond drilling in 1974.

LOCATION AND ACCESS

The northern boundary of the claim group lies approximately one mile south of Highway 11 and it straddles the Vincent-M^CComber Township line. This township line is located about 10 miles east of Beardmore. Access to the property may be gained by following overgrown roads south from Norman Lake. In winter snowmobiles and tracked vehicles are the most appropriate method of transportation while in summer the best means of access is by canoe. Rolland Lake near Jellicoe provides a convenient jumping off point for canoe travel up the Blackwater River to the southern boundary of the claim group.

CLAIMS

All of the claims are held by Craskie Mines, Limited, P.O. Box 28, Toronto Dominion Centre, Toronto, Ontario M5K 1B8. The unpatented mining claims are numbered:

-in Vincent Tp.

T.B. 614494 - 614515 inclusive

T.B. 627682 - ~~627684~~ inclusive

T.B. 659005

T.B. 659010

T.B. 685401 - 685403 inclusive

-and in M^CComber Tp.

T.B. 614460 - 614493 inclusive

Leased mining claims held by Craskie are located in Vincent township and they are numbered:

T.B. 27791 - 27795 inclusive

T.B. 41983 - 41991 inclusive

T.B. 42248

PREVIOUS WORK

Trenching and diamond drilling on the property has been carried out in the past. Major trenching was conducted on the Vega zones (located on claims T.B. 614507 & 614508) during the 1930's. In the late 1940's M^{aC}Leod Cockshutt Gold Mines carried out trenching and diamond drilling on the leased claims. Tombill Mines Limited carried out additional trenching and drilling in the early 1950's.

Geochemical, geophysical (E.M.-16) and geological surveys were carried out by Tombill Mines Limited in 1973. Tombill and Craskie completed a diamond drill program on the property in the winter and spring of 1974. This work was carried out on the leased claims as well as on claims presently

numbered T.B. 614500 to T.B. 614515 inclusive.

Craskie aquired, by option, 58 claims from Tenacity Mines Limited late in 1982. During the winter of 1983 magnetic and electromagnetic (E.M.-16) surveys were carried out over claims not covered by the 1973 surveys. Heap leach tests were also carried out on material from the Vega zone.

GENERAL GEOLOGY

The claim group is underlain by steeply dipping, ENE to E-W striking metavolcanics and metasediments. Quartz and quartz - carbonate veins are commonly found. A quartz porphyry plug has been mapped on the claims and veins of this material have also been located on the property. Bands of iron formation consisting of interbanded magnetite , sugary quartz and chlorite have been exposed by trenching. Important accessory minerals occurring with the iron formation include: pyrite, pyrrhotite, chalcopyrite and arsenopyrite. In some trenches and diamond drill holes visible gold has been reported. Intrusive quartz blow-outs have also been reported in the iron formation.

Gold distribution in the iron formation is very irregular and the amount of sampling which has been completed is insufficient to establish any trends in the mineralization.

PRESENT PROGRAM

In the 1974 program four holes, numbered 74-5, 74-6, 74-22, 74-23, returned gold assays. All of these holes were drilled along EM conductor 21. Gold and arsenic geochemical anomalies are associated with this conductor. Craskie elected to investigate the western strike extension of this conductor in 1984. Geophysical data from the 1983 survey suggested that EM conductor 21 extends westward into McComber township. Drilling, however, was carried out in the vicinity of the 1974 drilling since adverse claim ownership covered a portion of the conductor.

On March 12, 1984 a crew of drillers contracted from Kenora Diamond Drilling arrived on the property. A total of 641 feet of BQ core drilling was completed by March 30, 1984 when the project was completed. Core was logged and sampled on site by G. Douglas and W. Wade. Assays were provided by Technical Service Laboratory of Toronto.

RECOMMENDATIONS

The diamond drilling program failed to intersect any iron formation carrying appreciable gold values. The continuity of the EM-16 conductor was established and further work along this zone is required.

A caterpillar trenching and stripping program is recommended to investigate the potential of this zone at a relatively low cost per intersection. An all inclusive figure of about \$2500 to \$3000 per trench is anticipated. Following the completion of this program diamond drilling of areas containing significant gold mineralization is recommended to test for down plunge extensions of the mineralized areas.



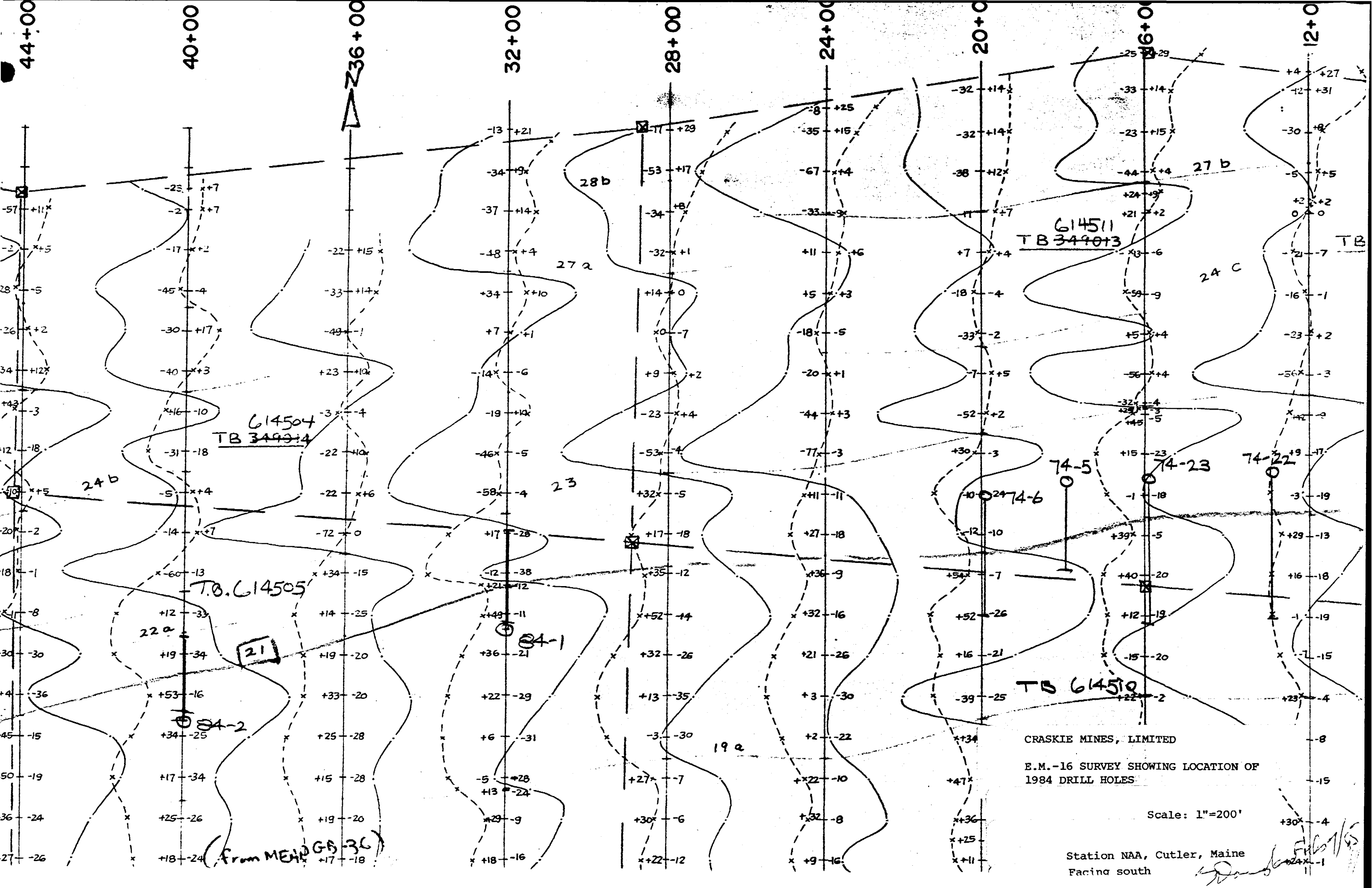

44+00

40+00

36+00

32+00

28+00

24+00

20+00

16+00

12+00



614504
TB 349014

T.B. 614505

21

24-2

(From MEAD GS-36)

614511
TB 349013

TB 614510

CRASKIE MINES, LIMITED

E.M.-16 SURVEY SHOWING LOCATION OF
1984 DRILL HOLES

Scale: 1"=200'

Station NAA, Cutler, Maine
Facing south

Handwritten signature and date: *[Signature]* 1/15

FIGURE 1

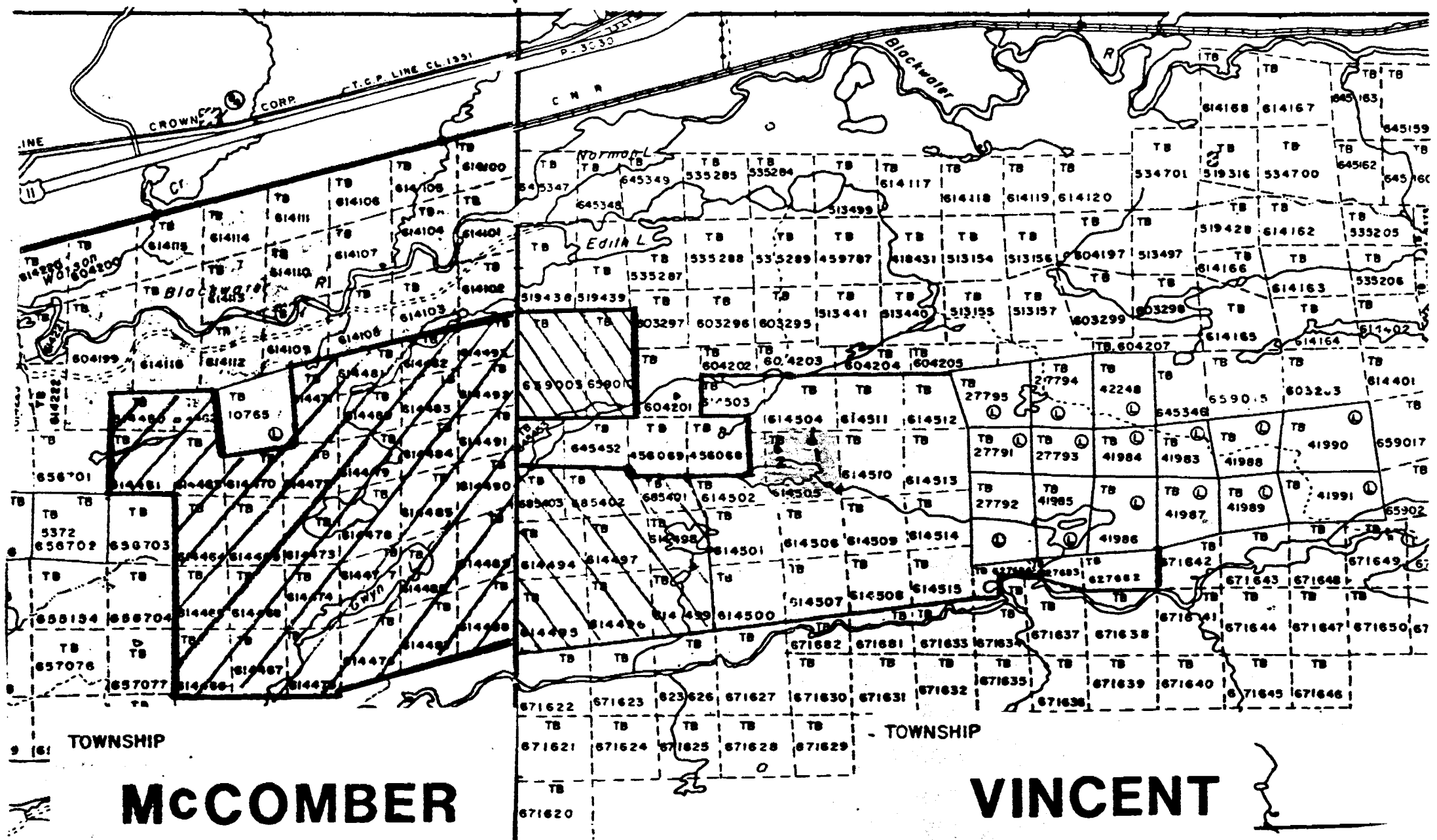

McCOMBER

VINCENT

1" = 2640'

CRASKIE MINES LTD

MAP SHOWING LOCATION OF DIAMOND DRILL HOLES 84-1 & 84-2

Handwritten signature
 1/25/78

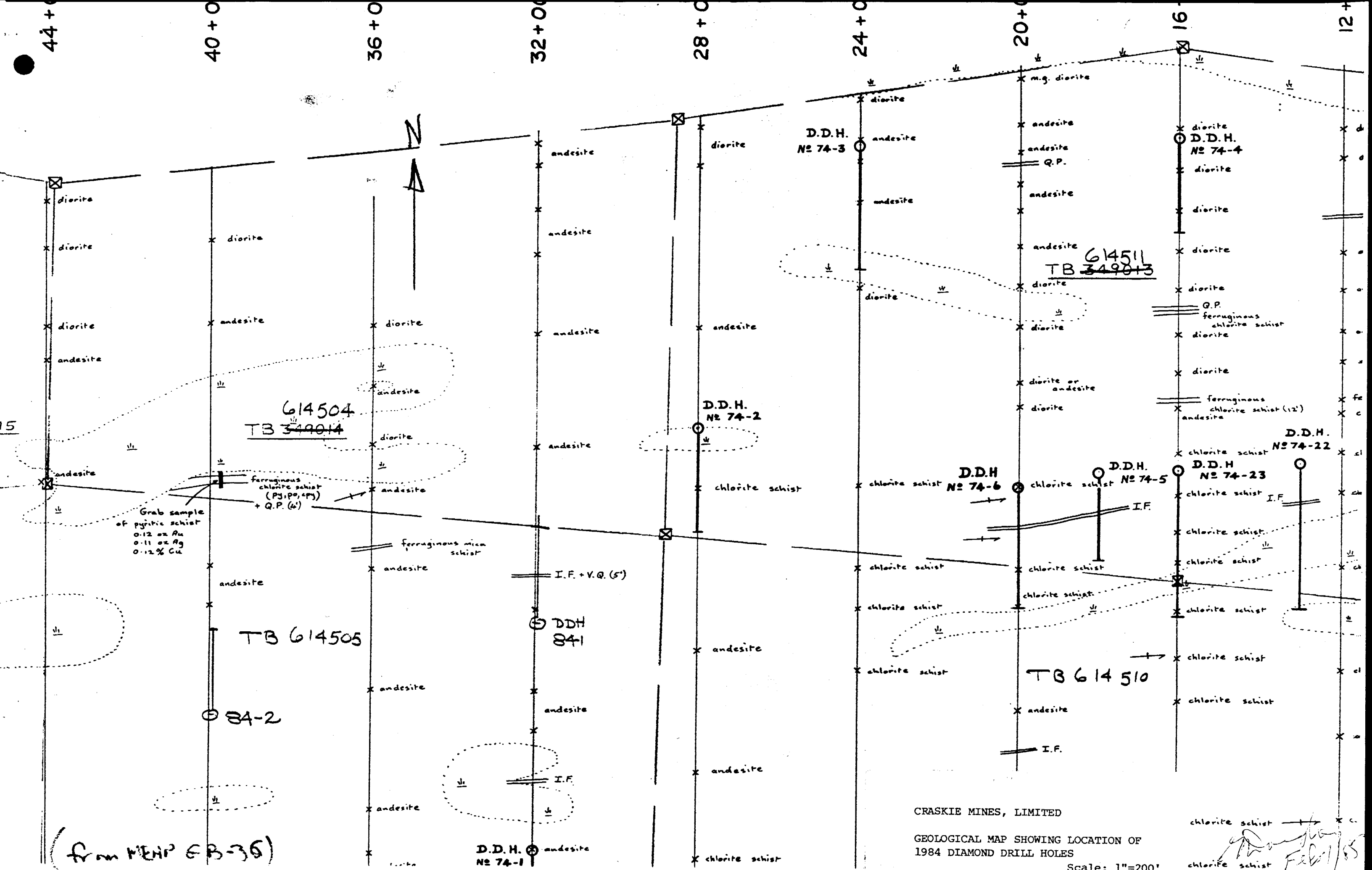

44 + 0 40 + 0 36 + 0 32 + 0 28 + 0 24 + 0 20 + 0 16 12 + 0



Grab sample of pyritic schist
 0.12 oz Au
 0.11 oz Ag
 0.12% Cu

614504
 TB 349014

TB 614505

84-2

D.D.H. No 74-1

D.D.H. No 74-2

D.D.H. No 74-3

D.D.H. No 74-6

D.D.H. No 74-5

D.D.H. No 74-23

D.D.H. No 74-22

TB 614510

614511
 TB 349013

CRASKIE MINES, LIMITED

GEOLOGICAL MAP SHOWING LOCATION OF
 1984 DIAMOND DRILL HOLES

Scale: 1"=200'

chlorite schist
 chlorite schist
 Feb 11/85

(from MEMO EB-36)



CRASKIE MINES, LIMITED

PROPOSAL TO TEST EM ZONE No 21 WITH TWO DRILL HOLES, VEGA CLAIMS, VINCENT TOWNSHIP

A gold bearing iron formation was intersected during the diamond drill program conducted during the winter and spring of 1974. Gold values were returned in drill holes 74-5, 74-6, 74-22 and 74-23. The location of these holes are shown on the attached Figures; 1 through 4 which show Geology, EM-16 Survey, Arsenic Soil Geochemistry and Gold Soil Geochemistry respectively.

Inspection of Figures 3 and 4 shows that gold and arsenic form narrow and elongated anomalies parallel to EM conductor 21 which is highlighted in Figure 2. At the south end of the claim group arsenic and gold geochemical anomalies are associated with the VEGA ZONES which have been trenched extensively. These iron formations are mineralized with gold and arsenopyrite and the soil geochemical anomalies for these elements are also narrow and elongated parallel to the strike. The discontinuous nature of the EM-21 soil anomalies is attributed to errors in the estimation of the location of the zone during soil sampling since pace-and compass methods were used for survey control between lines. Survey control over the Vega Zones was facilitated by sampling between the old trenches.

It is recommended that the old lines on the western part of EM conductor No 21 be located and cleaned out for resurveying. Two diamond drill holes are recommended to test for westward extensions of this zone.

G. Douglas

February 16, 1984

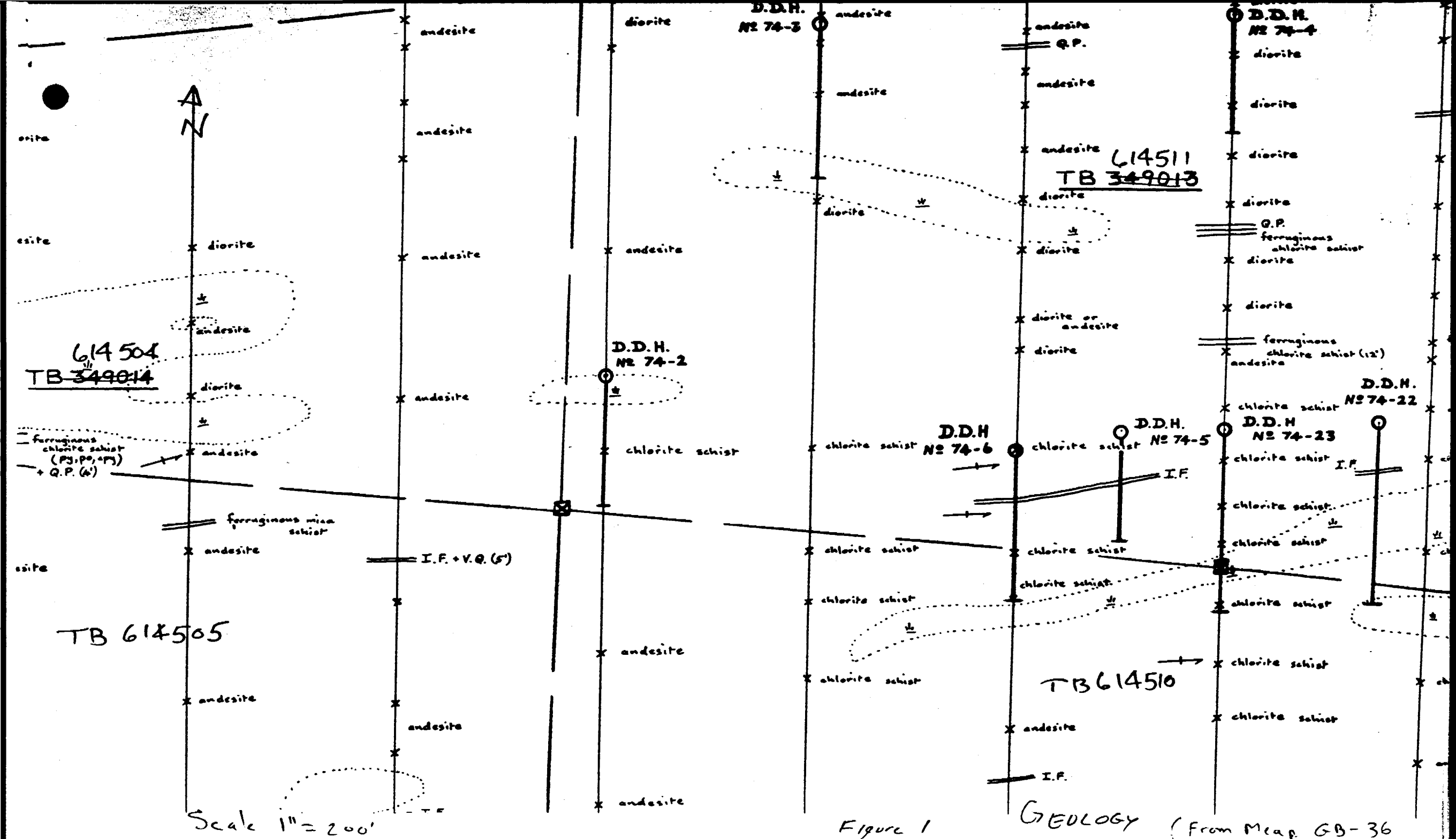
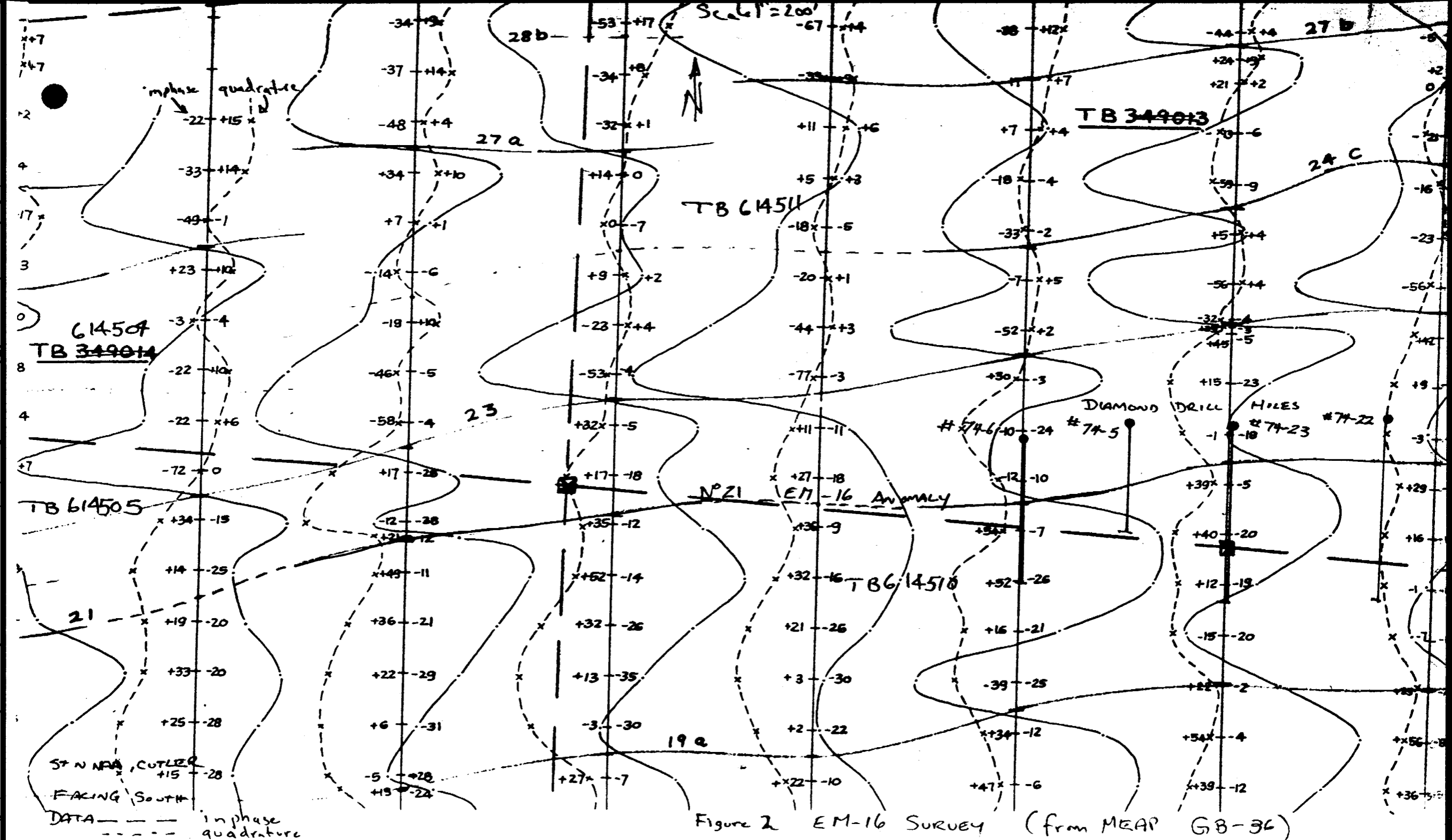

Figure 1

GEOLOGY (From Map GB-36)



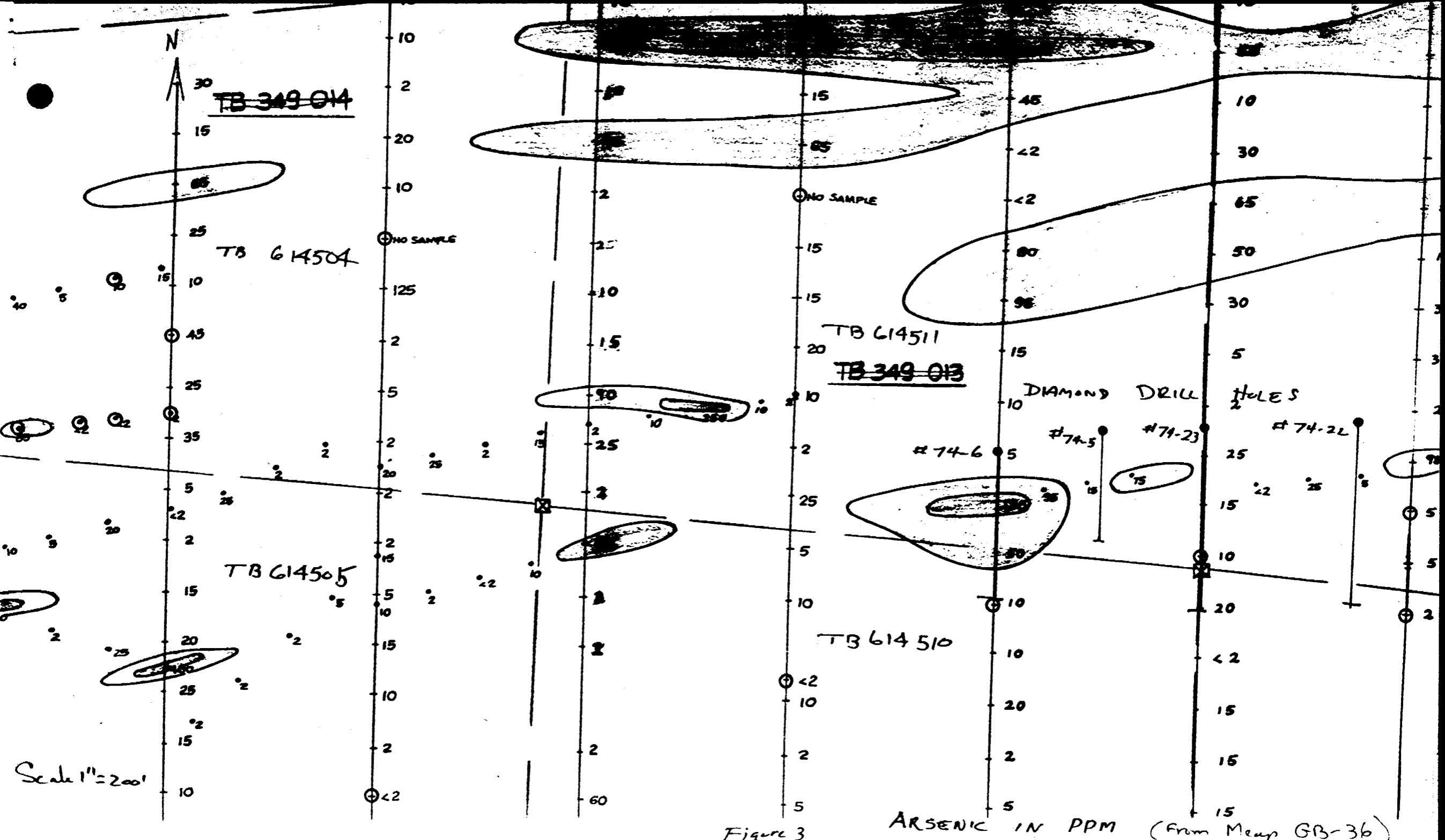

Figure 3

ARSENIC IN PPM (from Meup GB-36)

~~TB 349 014~~

T.B. 614504

~~TB 349 013~~

614511

DIAMOND DRILL HOLES
#74-23

#74-22

#74-6

#74-5

614505

614510

Scale 1" = 200'

Figure 4. GOLD IN PPM (From Map GB-36)

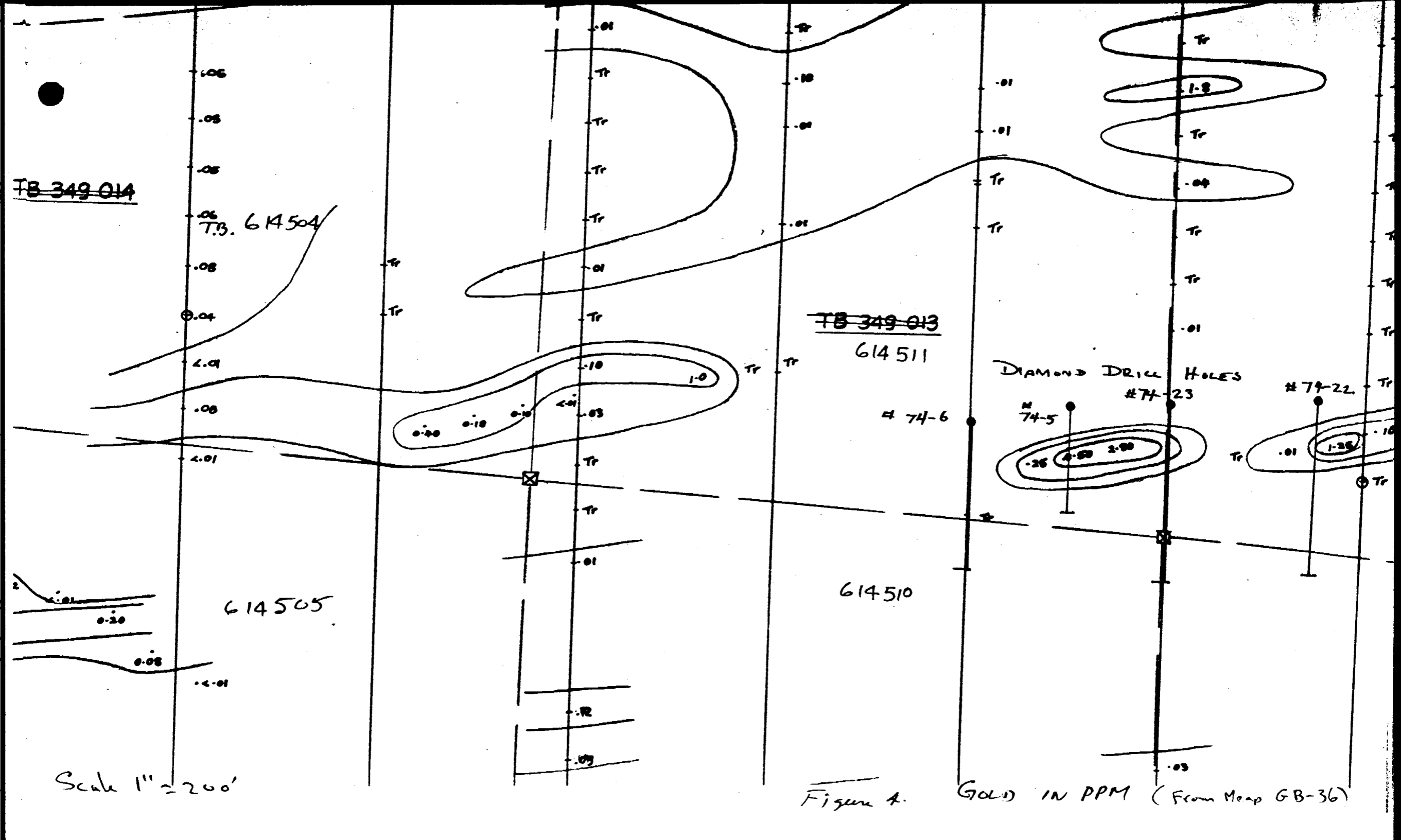

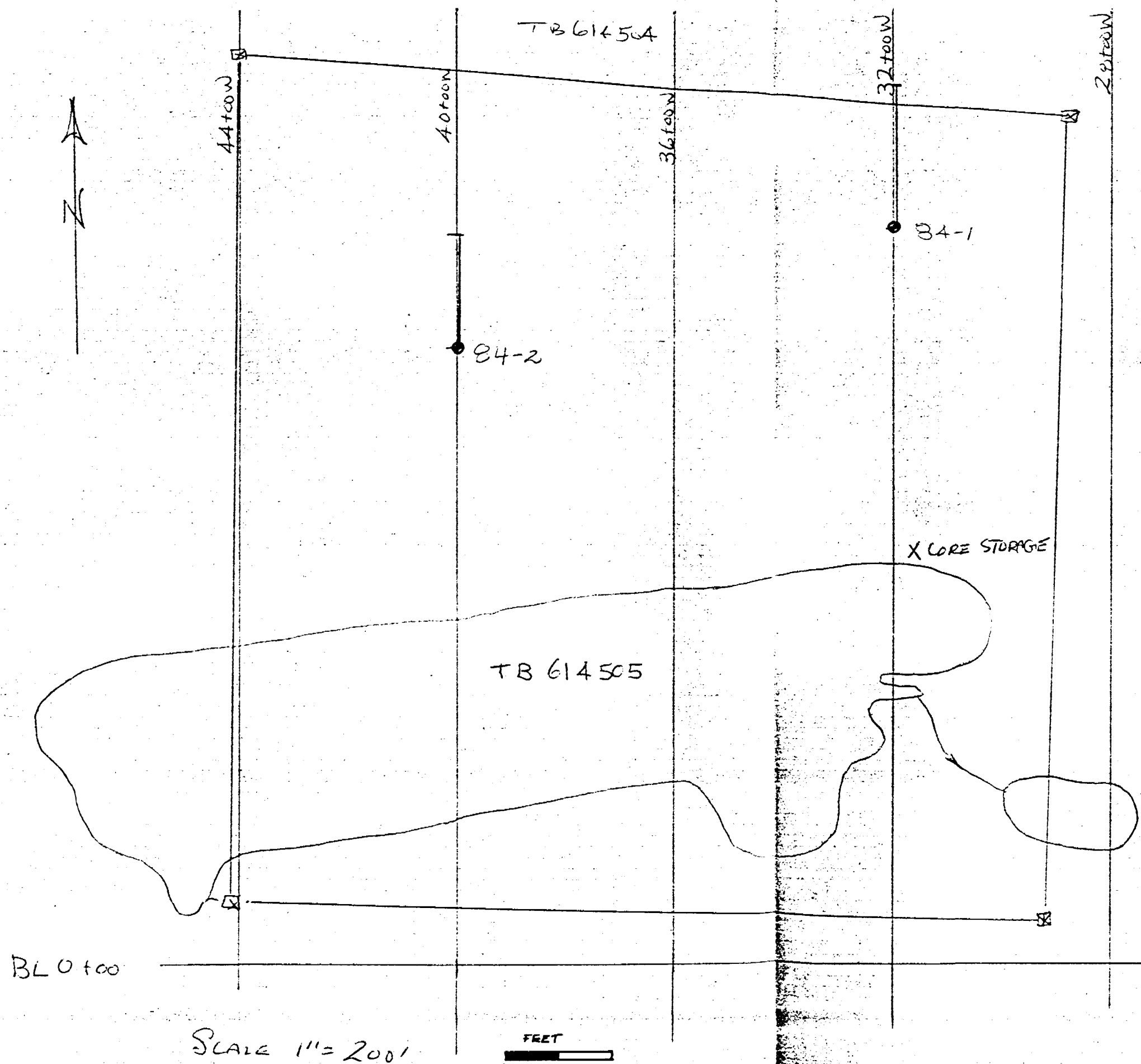
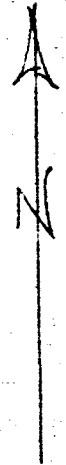

BL 0+00

SCALE 1" = 200'

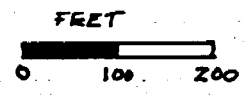

CRASKIE MINES, LIMITED
VINCENT TOWNSHIP, ONTARIO
PLAN SHOWING LOCATIONS OF
DIAMOND DRILL HOLES 84-1 & 84-2
Dwg By G. Douglas Ag 2/84

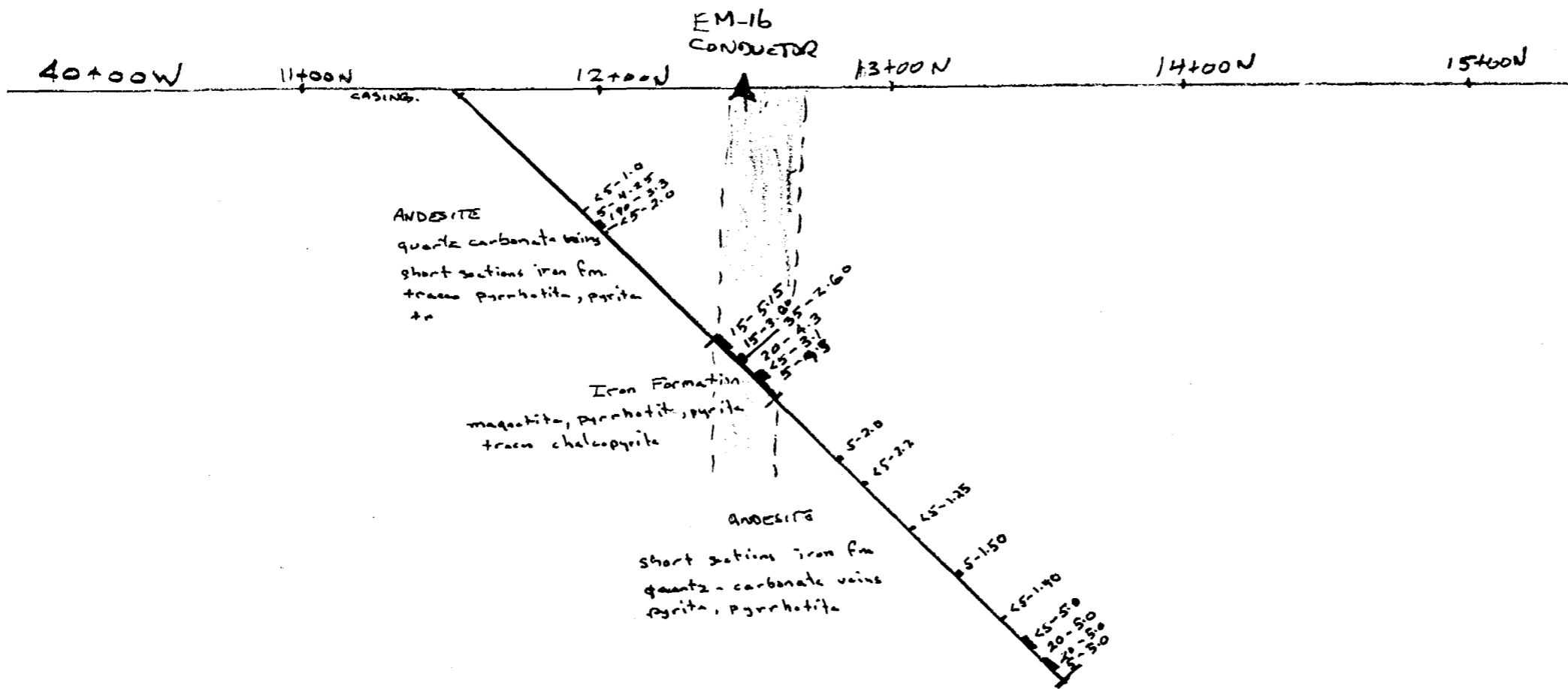

Assays: Gold in ppb - sample length in feet.

CRASKIE MINES LTD	
CROSS SECTION DDH 84-2	
VEGA PROJECT	VINCENT TRANT
FACING WEST	
Scale 1" = 50'	Oct 17, 1984
DWG BY	G. Dougan

Dougan NOV 11 1984

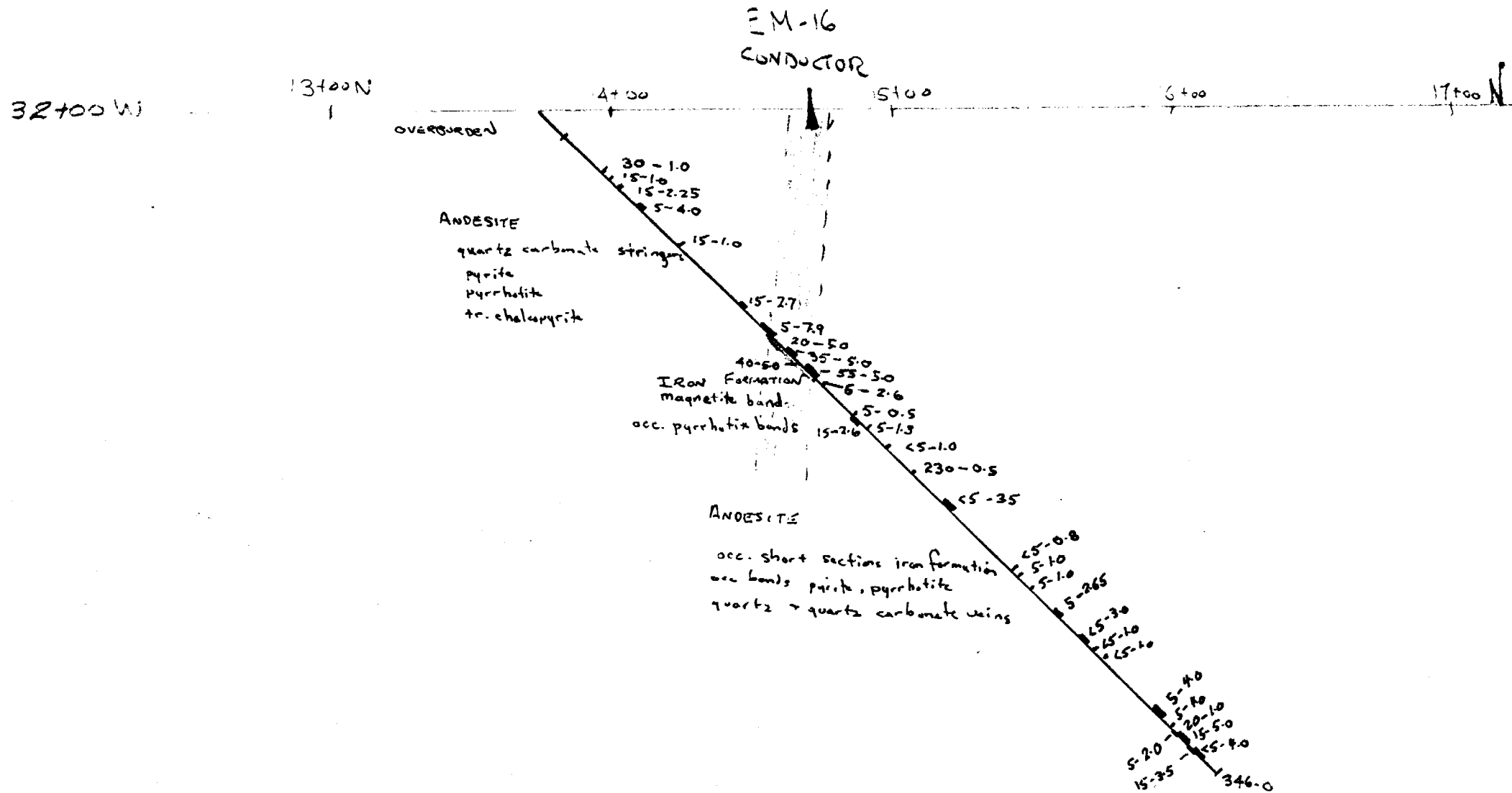

Assays : Gold in ppb. - sample length in feet.

G Douglas Nov 17/84

CRASKIE MINES LTD	
CROSS SECTION DDH 94-1	
VEGA PROJECT	VINCENT TP, ONT
FACING WEST	
Scale 1" = 50'	Oct 16, 1984
DWG. BY G Douglas	

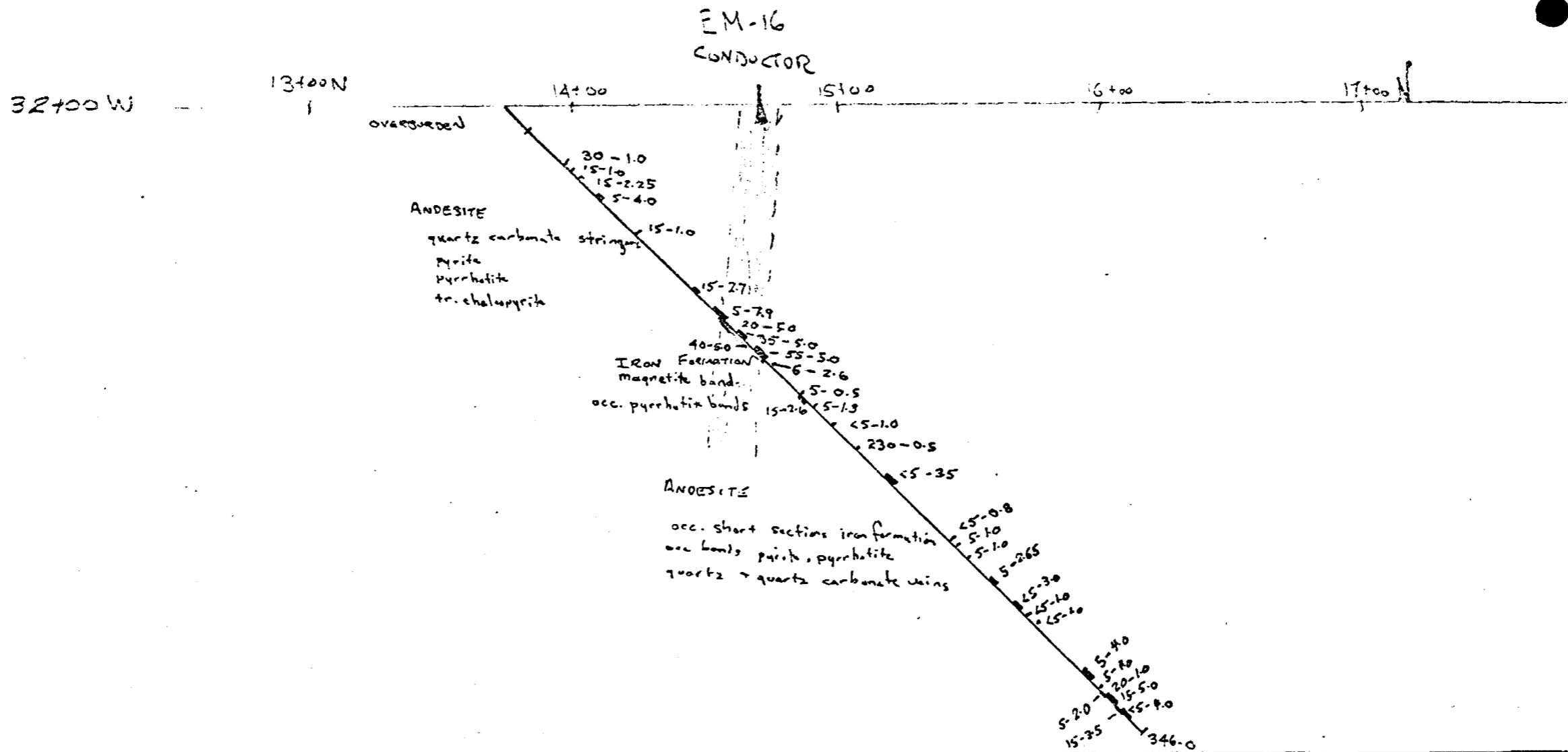

Assays : Gold in ppb. - sample length in feet.

J. Douglas
Nov 19/84

CRASKIE MINES LTD	
CROSS SECTION DDH 94-1	
VEGA PROJECT	VINCENT TP. ONT
FACING WEST	-
Scale 1" = 50'	Oct 16, 1984
DWG. BY J. Douglas	

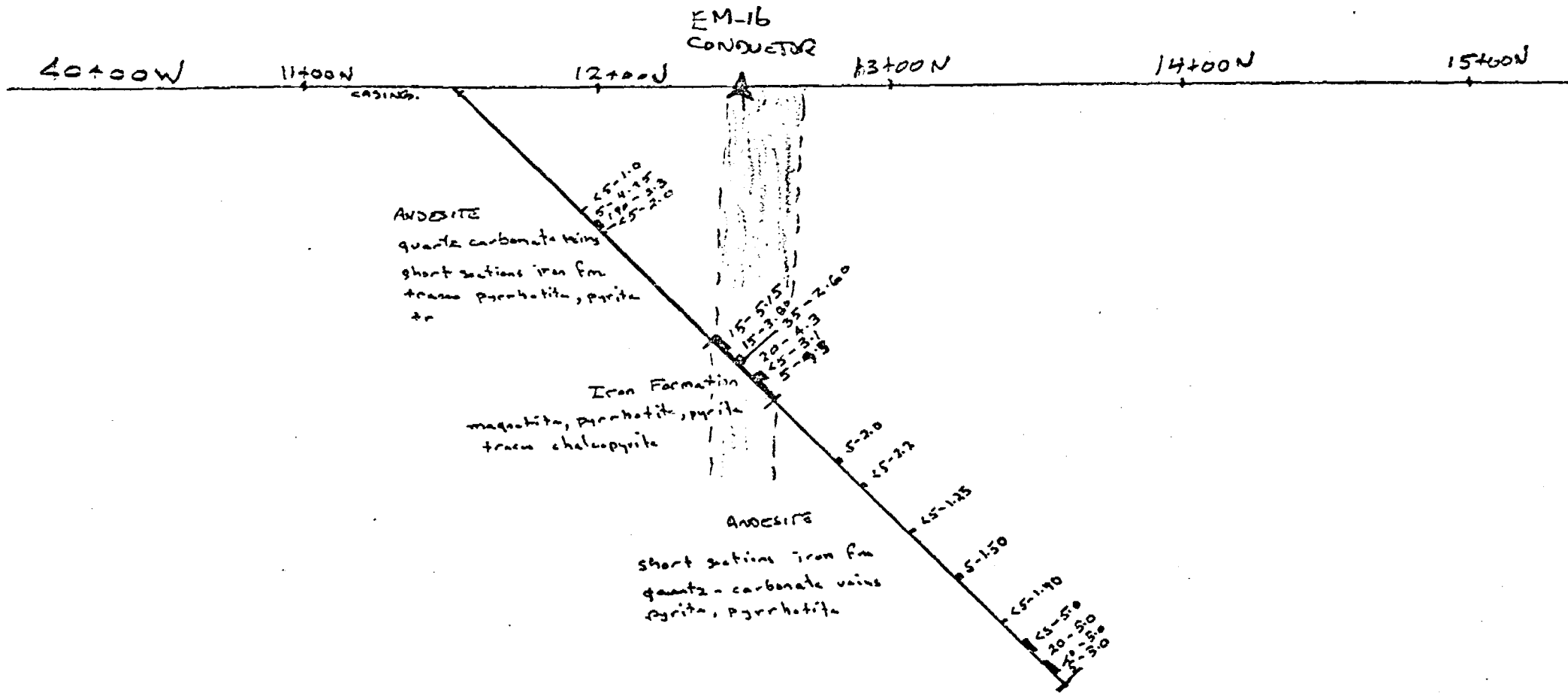

Assays: Gold in ppb - sample length in feet.

CRASKIE MINES LTD
CROSS SECTION DDH 84-2
VEGA PROJECT VINCEN TR INT
FACING WEST
Scale 1" = 50' Oct 17, 1984
DWG BY G. Douglas

Douglas
Nov 19/84