

Report on mineral exploration of Neil R. Maki and  
Partners 1984 - OMEP Designation OM84-4-P-52

When our work program started on May 28, 1984 we had hoped to do considerable more prospecting and trenching than we did on our east block of claims. (see location map) We had taken several samples from various zones of interest we had located in our prospecting. Subsequent trenching uncovered several zones of iron stained quartz - carbonate alongside and within a sheared volcanic rock, chloritized and rust stained with sulphides mostly pyrite and minor chalcopyrite. We took samples to the M.N.R. office which they sent out for assay. We were hopeful for a two week assay return but it took several months to get the results back. We felt we shouldn't do too much work in this area until the assay results came back, as we had to go by vehicle and boat as well as walk over swampy ground to reach our working areas, this slowed down our work for the east block. We did not count travel time on our time sheet. However, we did do some more prospecting and trenching and did find probable continuations of iron formations from the west as noted on attached map.

Our main block of claims which we optioned to Eldor Resources in the fall of 1982 was dropped by them in July of 1984. Eldor had done considerable work in this block consisting of line cutting, geophysical surveys, geology and diamond drilling. We were able to do follow up work from all their excellent data. However, we felt Eldor did not fully examine areas on either side of their main drilling area and we began a program to prospect and evaluate the ground to the north and south of their drilling. We located several zones carrying appreciable amounts of gold both to the north and south of Eldors work. I contacted Eldor Resources and told them of our new discoveries but they were no further interested. We then concentrated on these new zones by stripping, trenching and cobra rock-drill work. Our efforts proved fruitfull. Assays of trace up to .45 oz. gold were received on these new zones. We had to conclude our work in Vincent Twp. due to cold weather setting in.

We had a percentage interest in two patent claims in Gorham Twp., just north east of Thunder Bay, which I had noted in my OMEP application. Unfortunately the major owner of the claims did not want any work done on his claims as he was hoping to sell the block to another party. However, we had staked claims tied onto his group and on one of these we were able to do some stripping and trenching with a back-hoe and by hand. We uncovered a zone 80 feet wide running east-west consisting of sheared grey-green, silicified volcanic rock with ankerite, and vitreous white quartz lenses, containing pyrite up to 2%. Further work is planned for these claims next summer.

Thanks to our persistence and the help from OMEP this past season we were again able to option all our claims in Vincent Township to Highland Crow Resources Ltd. a progressive junior exploration company. This optioning was due to our renewed efforts in locating auriferous zones alongside former work (Eldor). These new findings influenced Highland Crow to take over all our ground (62 claims) and it appears we will have a substantial work program on the property this coming summer. All our work is shown on attached maps and verifies the prospector is an important member of any exploration program. Our group concentrates on opening up zones of interest on our own efforts (stripping, trenching, blasting) to enable mining companies to have a well exposed trench and showings for a geologists examination and evaluation.

Hopefully we can apply for an OMEP grant again in 1985 on other ground we will have this summer.

Respectfully submitted,

Neil R. Maki

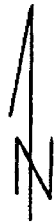

①

meta-diorite

stripped area

Banded qtz carbonate zone with arsenopyrite + magnetite (3-5%) interlaced with grunerite (not sampled)

meta-diorite

②

low ground

Ridge

qtz vein  
banded qtz

qtz vein in part iron stained-carbonated with specs of galena + arsenopyrite

alongside banded qtz stringers 1/4" - 1/2" in andesite

stripped area  
qtz vein

qtz vein 2' wide in part carbonated with specs of galena

③

stripped area

Banded qtz carbonate zone with arseno magnetite, scattered chalco + pyrite 3-5% grunerite bands 1" wide within

④

stripped area  
andesite-chlorite schist  
qtz veins 1/2" - 2"

qtz vein with chalco - 5%

qtz veins 1/2" - 2"

iron stained qtz carbonated with chalco, galena 5-10%

carbonated qtz vein - 15" wide vein iron stained qtz with arsenopyrite within qtz vein .05 au.

andesite

stripped qtz o/c

meta-diorite  
chlorite schist o/c's

road

greenstone ridge

scale - 1" = 8'



5

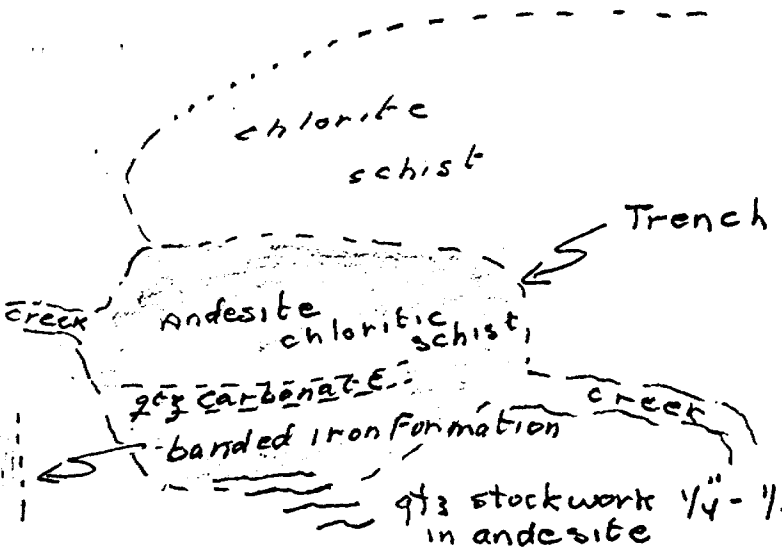

grunerite  
in banded qtz  
carb. magnetite

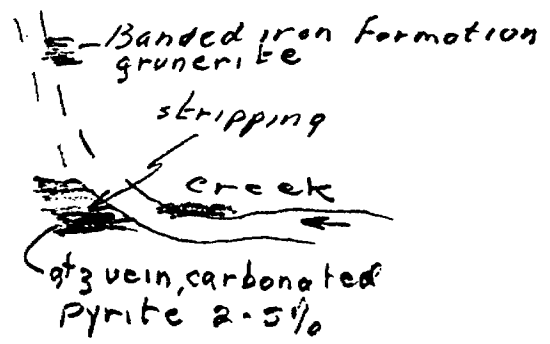

6

Decomposed  
carbonated  
qtz - v. G.

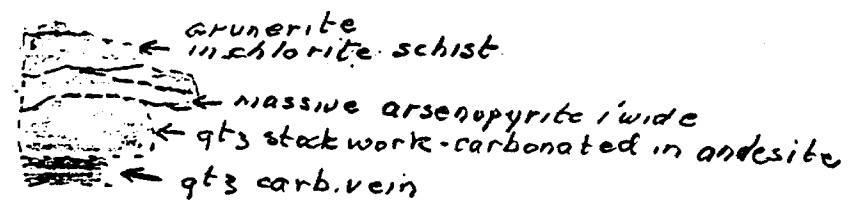

Banded iron formation  
magnetite - qtz carbonate

scale 1" = 8'

7

mostly andesite  
o/c

andesite

Baren qtz vein

iron stained  
qtz - minor  
galena  
south side of  
pit - qtz stockwork  
in chlorite schist

pond

Beaver

300

Drift covered

meta  
diorite  
o/c

Rusty qtz - carbonate  
with pyrite - 5-10%



scale 1" = 8'  
or as shown

8

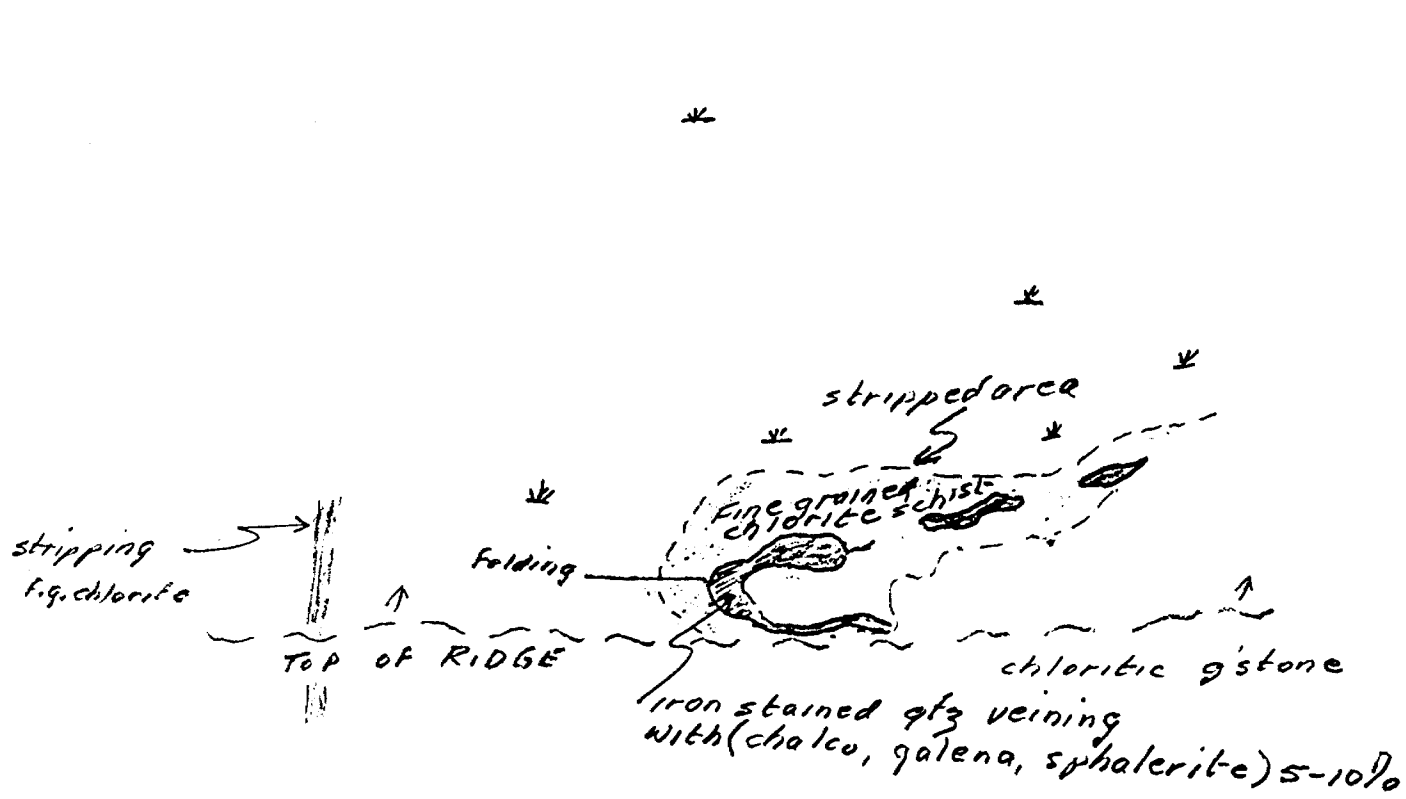

10



2. Trenches

IRON STAINED Qtz  
CHLORITIC - MINOR PYRITE 42%

HIGH GROUND  
NO OUTCROPS.

9

OVERBURDEN

CHERT SEDIMENTS PYRITE  
STRIPPED AREA GRANITE 1"-4" WIDE  
ANDESITE  
IRON STAINED Qtz  
ANDESITE

OVERBURDEN

1" = 20'

11

FRACTURED CHLORITE SCHIST  
INCLUSIONS OF Qtz, HOENGBLENDE

IRON STAINED  
Qtz.

SHEARED MAFIC  
ROCK

REPRESENTATIVE OF  
ALL PITS AS SHOWN  
ON BASE PLAN

1" = 8'

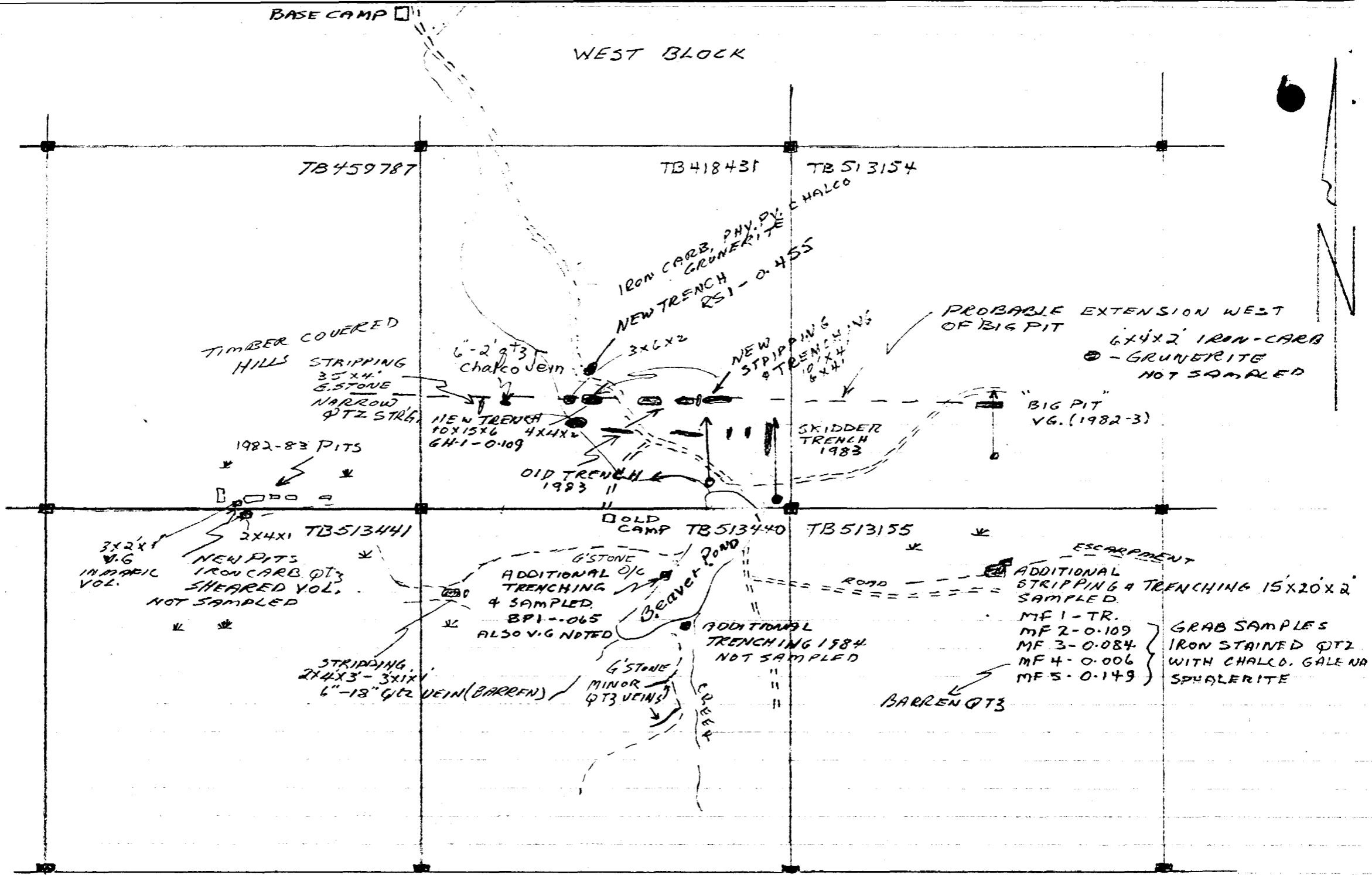

(REFER TO MAP SUBMITTED OMEP 1982)

SCALE 1" = 400' OR AS SHOWN



EAST BLOCK.

NEZAH

LAKE

SKIDDER ROAD CONSTRUCTED 1983

TB 614226 (DROPPED)  
SAND FLATS

TB 614229 (DROPPED)

TB 614227 TB 614230

SAND FLATS  
HEAVY LACKPINE GROWTH

1983 TRENCH  
CLEANED OUT  
60' X 15'

SULPHIDES  
UNCOVERED

MORE WORK PLANNED

TIMBER COVERED  
LOW HILLS

g' STONE  
O/C

CONTROL LINE

OLD  
TRENCHES

TB 614228 TB 614231

65'  
NEW TRENCHES  
3X4' X 2'  
IRON STAINED  
QTZ & GREENSTONE  
84-MNW-15, 16

TIMBER COVERED LOW HILLS

PIT NO. 1, 84-MNW-17B

NEZAH 2 NO 2 VEIN  
OCCURRENCE

LOW HILLS g' STONE O/C

OLD PITS CLEANED OUT AV. 8' X 8' X 6'  
SAMPLED BY MNK.

SHIPPED VOL. ROCK IRON STAINED QTZ.

SAMPLE NO'S 84-MNW-8 TO 14.

SCALE 1" = 400' OR AS SHOWN

EAST BLOCK



BLACKWATER R

WALTERS TWP  
C. N. R.

TB 45161

Heavily  
Wooded  
Area  
No o/c

\* \*

TRENCH  
4'x4'x2'  
IRON STAINED  
QTZ.  
SHEARED  
Vol.  
84 MM 5 1/2

g'stone o/c's TB 645166

WOODED ROLLING HILLS

SCALE 1" = 400'  
OR AS SHOWN

NEZAH L



Ontario

Ministry of  
Natural  
Resources



42E12NE0199 63.4437 VINCENT

900

September 24, 1984

Neil Maki  
R.R. #14  
Thunder Bay, Ontario  
P7B 5E5

Dear Neil:

This letter is to inform you of the gold geochemical results for samples collected from the Nezah Showing - No. 2 Vein south (claim 614228), Vincent Township (84-MNM-8 to 84-MNM-15) and one sample (84-MNM-15) from a new showing in Gorham Township. All samples returned trace amounts of gold with the exception of 84-MNM-8 which analyzed .013 oz/ton.

Sincerely,

Gerry White  
Resource Geologist  
Ontario Government Building  
Regional Mineral Resources Co-ordinator's Office  
Ministry of Natural Resources  
P.O. Box 5000  
Thunder Bay, Ontario  
P7C 5G6

Telephone: (807) 475-1331



October 9, 1984

Neil Maki  
R.R.#14  
Thunder Bay, Ontario  
P7B 5E5

Dear Neil:

The following assay results and descriptions are from six samples collected on May 31, 1984 from your Eldor and Maki East Occurrences. These samples were originally collected as a suite for the office, however, we decided to send examples of each in our last batch. (ppb = parts per billion).

<u>Sample Number</u>	<u>Description</u>	<u>Au Assay (oz/ton)</u>
84-MWM-1 Eldor Option Big Pit #1	Banded cherty carbonate-rich iron formation. <1% pyrite	Trace (<0.01) (15 ppb)
84-MWM-2 Eldor Option Big Pit #2	Fractured quartz vein and sheared andesitic volcanics, sericite. No visible sulphides.	Trace (<0.01) (7 ppb)
84-MWM-3 Eldor Option Big Pit #2	Band chert iron formation with 5% arsenopyrite	0.01 (500 ppb)
84-MWM-4 Eldor Option Sandra's Pit	Banded sugary magnetite chert iron formation. 5% arsenopyrite	.09 (3200 ppb)
84-MWM-5 Maki East Occurrence	Banded chert-grunerite iron formation. Minor rust. No visible sulphides.	Trace (<0.01) (100 ppb)
84-MWM-6 Maki East Occurrence	Same as 84-MWM-5	Trace (<0.01) (45 ppb)

NEZAH  
LAKE  
CUMING NO  
TR 45161

Ministry of  
Natural  
Resources

Temiskaming  
Testing  
Laboratories

P.O. Box 799  
Presley St.  
Cobalt, Ontario

Tel: 679-8313

Report Number

CB 8117

Laboratory Report

Date Sept. 5, 1984.

Addressed To: Mr. Neil Maki, R.R. #14, Thunder Bay, Ont. P7B 5E5

Sample Number	Gold Oz. Per Ton	Gold Value Per Ton	Silver Oz. Per Ton	
BP-1	0.065	12.000		
P-1	Trace	Trace		
P-2	Trace	Trace		

Coupons Received Charged 3 coupons card #0675

D. L. Larkie  
Manager



Ministry of  
Natural  
Resources

Temiskaming  
Testing  
Laboratories

P.O. Box 799  
Presley St.  
Cobalt, Ontario

Tel: 679-8313

*REVISED*

Report Number

CB 8150

Laboratory Report

Date Sept. 17, 1984.

Issued To: Mr. N. R. Maki, R.R. #14, Thunder Bay, Ont. P7B 5E5

Sample Number	Gold Oz. Per Ton	Gold Value Per Ton	Silver Oz. Per Ton	
MF - 1	Trace			
MF - 2	0.109			
MF - 3	0.084			

Fees Received Charged 3 coupons card #0675

*D. L. L...*  
Manager

Except by special permission, reproduction of these results must include any  
qualifying remarks made by this ministry with reference to any sample.



Ministry of  
Natural  
Resources

Temiskaming  
Testing  
Laboratories

P.O. Box 799  
Presley St.  
Cobalt, Ontario

Tel: 679-8313

Report Number

CB 8343

Laboratory Report

Date Nov. 23, 1984.

Submitted To: Mr. Neil Maki, R.R. #14, Thunder Bay, Ont. P7B 5E5

Sample Number	Gold Oz. Per Ton	Gold Value Per Ton	Silver Oz. Per Ton
G-H-1	0.109		
R-S-1	0.455		
M-F-4	0.006		
M-F-5	0.149		

Notes Received Charged 4 coupons card #0675.

*D.L. Karabie*  
Manager

Except by special permission, reproduction of these results must include any  
qualifying remarks made by this ministry with reference to any sample.

WEST BLOCK

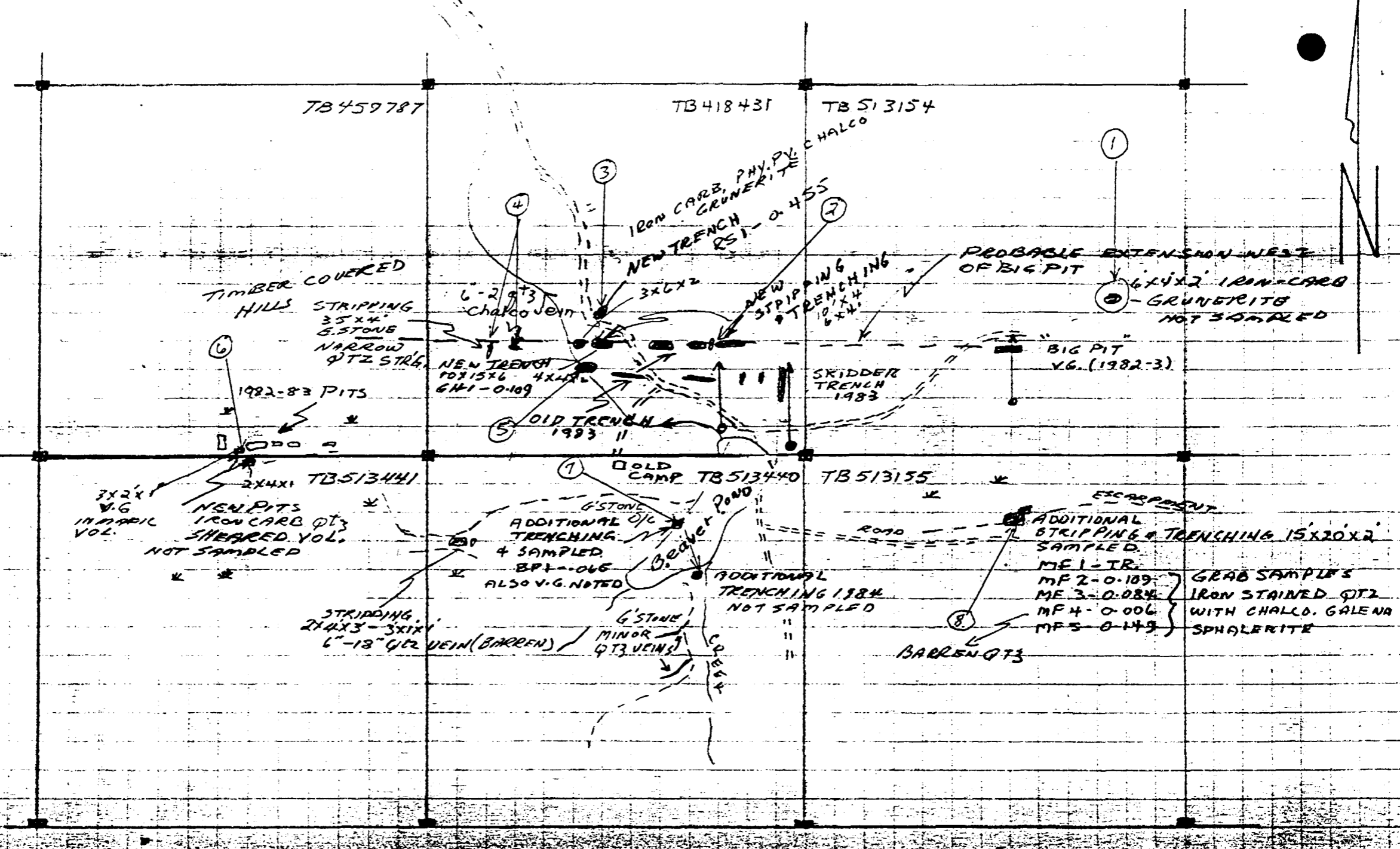

(REFER TO MAP SUBMITTED 6 MAR 1902)

SCALE 1" = 400' OR AS SHOWN



EAST BLOCK

SKIDDER ROAD CONSTRUCTED 1983

NEZAH

LAKE

TB 614226 (DROPPED)  
SAND FLATS

TB 614229 (DROPPED)

TB 614227 TB 614230

SAND FLATS  
HEAVY JACKPINE GROWTH

1983 TRENCH  
CLEANED OUT  
60'x15'

SULPHIDES  
UNCOVERED

MORE WORK PLANNED

TIMBER COVERED  
LOW HILLS

9' STONE  
O/C

CONTROL LINE  
OLD  
TRENCH

TB 614228

TB 614231

NEW TRENCHES  
3'x4'x2'  
IRON STAINED  
QTZ & GREENSTONE  
84-MNW-15, 16

TIMBER COVERED LOW HILLS

PIT NO. 1, 84-MNW-17B

NEZAH 2  
OCCURENCE

NO. 2 VEIN

LOW HILLS 9' STONE O/C

SELF  
EXPLANATORY

OLD PITS CLEANED OUT BY 8'x8'x6'  
SAMPLED BY MNA.

SHEARED UO.A. ROCK IRON STAINED QTZ

SAMPLE NO'S 84-MNW-8 TO 14.

SCALE 1" = 400' OR AS SHOWN

TRANSCANADA PIPE LIN.

Post No. 1  
TB 730719

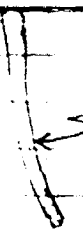

TRENCH  
AV. WIDTH 5'  
AV. DEPTH 3'  
120' LONG

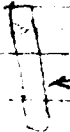

TRENCH  
AV. WIDTH 7'  
AV. DEPTH 2'  
LENGTH 80'



TEST PIT 6'x4'x8'

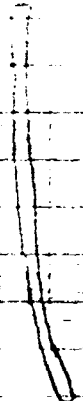

TRENCH  
AV. WIDTH 4'  
AV. DEPTH 6'  
LENGTH 210'



60' HIGH TOWER