

Key Claim

An irregular formation consisting of quartz stringers varying in width from 4" to 36" meandering in a banded sediment consisting mainly of cherty material alternating with volcanics. The zone is well brecciated and small veinlets of later quartz run through it. Visible gold is found in the quartz veins and control panning along the vein shows from very fine to coarse gold. Ankerite has been injected with the quartz along with hornblende. Some banding occurs which is well brecciated carbonated and mineralized with pyrrhotite, chalcopyrite and arsenopyrite and pyrite.

South Showing

After cleaning out winters debris from trenches we drilled several pop holes and blasted them to get fresh samples. We broke up the bigger pieces and transported them to camp for further testing. The visiting geologist took only one sample from the west end.

Snowball Showing

We cut down trees and stripped the overburden exposing a blocky type of iron formation in sediments, injected with minor pyrite and magnetite. We got a good tail on panning but assaying 1 section showed only 432PPB.au. This showing is 60m east of the original showing. We also stripped smaller areas 20m and 30 metres east of the new showing. No samples were taken from these.

Strawberry Showing

We cleaned and brushed out the east end of the strawberry vein. One grab sample in the iron formation containing minor pyrite and magnetite and some quartz showed 35PPB. au.

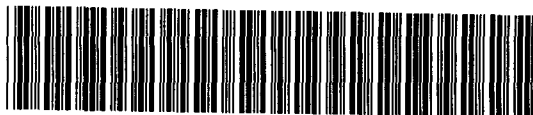

42E12NE0241 2.17837 VINCENT

NO 3 POST.

KEY CLAIM

645346 (L)

CAMP LINE

SEE DETAIL C

STRIPPED AREA

SEE DETAIL "B"

STRIPPED AREA

SEE DETAIL "A"

STRIPPED AREA

STRIPPED AREA

DRY TRAIL



MAGNETIC NORTH

NO 2 POST
645346 (L)

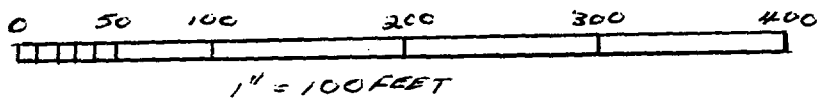

DETAIL "C"

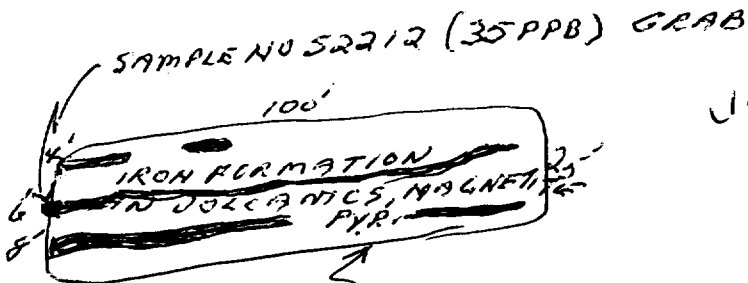

JULY 23/97 A. MAKI
N. MAKI
S. MAKI

1 1/2 MANDAYS @ 1600⁰⁰ DAY \$ 240⁰⁰

STRAWBERRY VEIN
PREVIOUSLY STRIPPED

SNOWBALL SNOWING DETAIL "B"

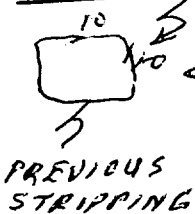

SAMPLE NO 52213 (432 PPB) GRAB

A. MAKI - JULY 24, 25, 26/97
N. MAKI - JULY 24, 25, 26/97
S. MOORE - JULY 24, 25, 26/97

9 MANDAYS @ 1600⁰⁰ DAY - 1440⁰⁰
8 HRS DAILY

SNOWBALL EXTENSION (NEW)

BLACKY RUSTY G'S STONE
MINOR PTZ - PYR. - 8' WIDE

MAGNETIC NORTH

DETAIL "A"

SAMPLE NO. 52214 (4800 PPB) GRAB

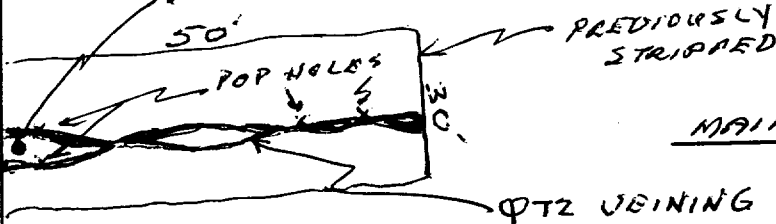

MAIN SHOWING (SOUTH)

x POP HOLES

A. MAKI - JULY 16, 17, 18, 1997
N. MAKI - JULY 16, 17, 18, 1997
S. MOORE - JULY 16, 17, 18, 1997

A. MAKI JULY 29, 30, 31, 1997
N. MAKI JULY 29, 30, 31, 1997
S. MOORE JULY 29, 30, 31, 1997

9 MANDAYS @ 1600⁰⁰ DAY - 1440⁰⁰
8 HRS DAILY

9 MANDAYS @ 1600⁰⁰ DAY 1440⁰⁰
8 HRS DAILY

Moosehorn, Line 20 and KM Vein

We cleaned out trenches of winter debris and fallen trees and put in several pop holes for sampling as shown. The Moosehorn, Line 20 and KM Veins on the west end of the claim group are two parallel structures, the Moosehorn being a flow type of formation with folding and an irregular strike and pattern, consisting of quartz with galena and chalco giving good gold values. Dip is uncertain, but the strike is easterly. A few 40m holes in a grid pattern may establish some continuity. The KM Vein is a regular vein structure with grunerite, chalco, arseno and magnetite.

MOOSEHORN - LINE 20 - KM VEIN

WORK DONE BY

AILI MAKI - AUG 12, 13, 14, 1997
NEIL MAKI - AUG 12, 13, 14, 1997
BYRON MAKI - AUG 12, 13, 14, 1997
ROBERT COUSINEAU - AUG 12, 13, 14, 1997

12 MANDAYS @ 160° DAY #1920.00
8 HRS EACH DAY

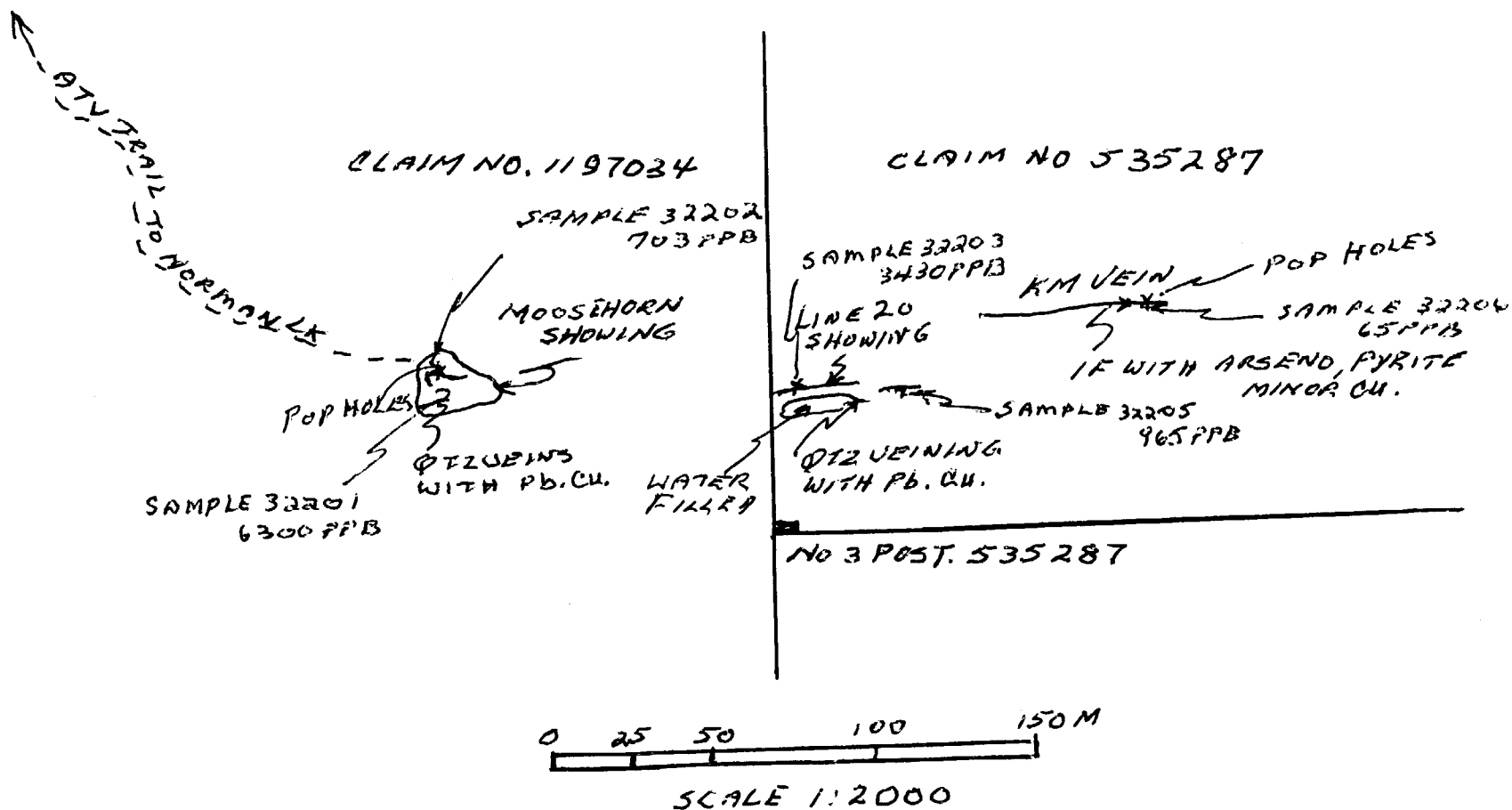

A.M. Vein and Sandra's Pit

A.M. Vein

As the water table was low we were able to dewater the trenches by hand. We cleaned all areas of excess rock and debris and blow-down trees. We put in several pop holes to get fresh samples for mining company geologists who may be visiting our property. The A.M. Vein consists of a banded iron formation ranging from 3' to 14' wide with $\frac{1}{2}$ " to 1" bands of arsenopyrite and in places heavy rusted arsenopyrite and magnetite associated with the injected quartz. Sediments lie just to the north of the showing and volcanics to the south. Extensive stripping and trenching was done in 1992. In the central part of the vein structure of quartz and heavy arsenopyrite slope into a water filled trench 6' deep, 10' wide and 30' long as shown.

Sandra's Pit

Sandra's Pit consists mostly of heavy arsenopyrite across 5 feet with grunerite prevelant. The south section is 7 feet wide consisting of a rusty iron fromation injected with quartz, magnetite, minor arsenopyrite and pyrite.

CLAIM NO
ON W167D
⑦ 48654

CLAIM NO
ON W167D
⑦ 14814

A.M. UEIN
WORK DONE BY

A. MAKI }
N. MAKI } AUG. 6, 7, 8, 1997
B. MAKI }
S. MOORE }

8 HRS WORKED EACH DAY

A.M. UEIN
9 MANDAYS @ 160⁰⁰ DAY - \$1440.00

SANDRAS PIT
3 MANDAYS @ 160⁰⁰ DAY 480.00
\$1920.00

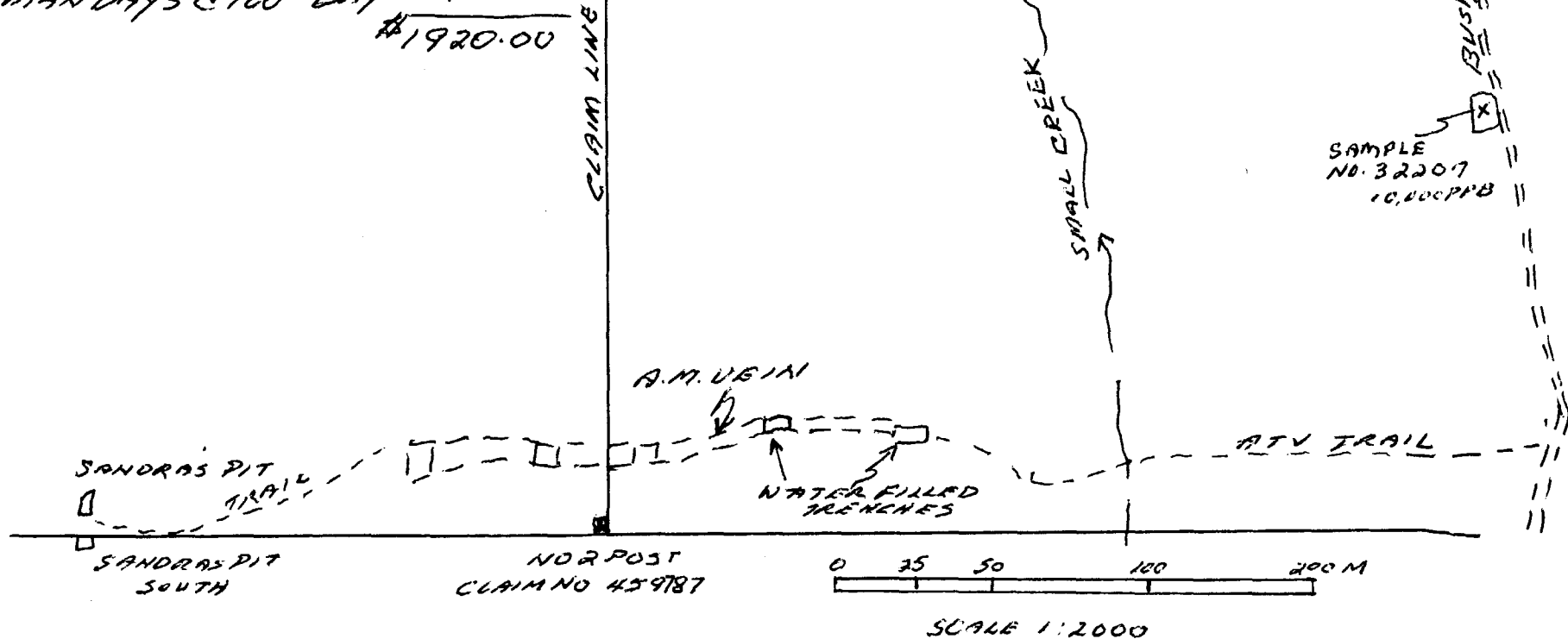

CLAIM NO 459787 (L)

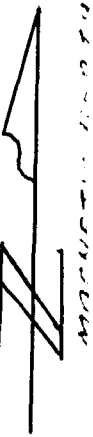

DETAIL B.

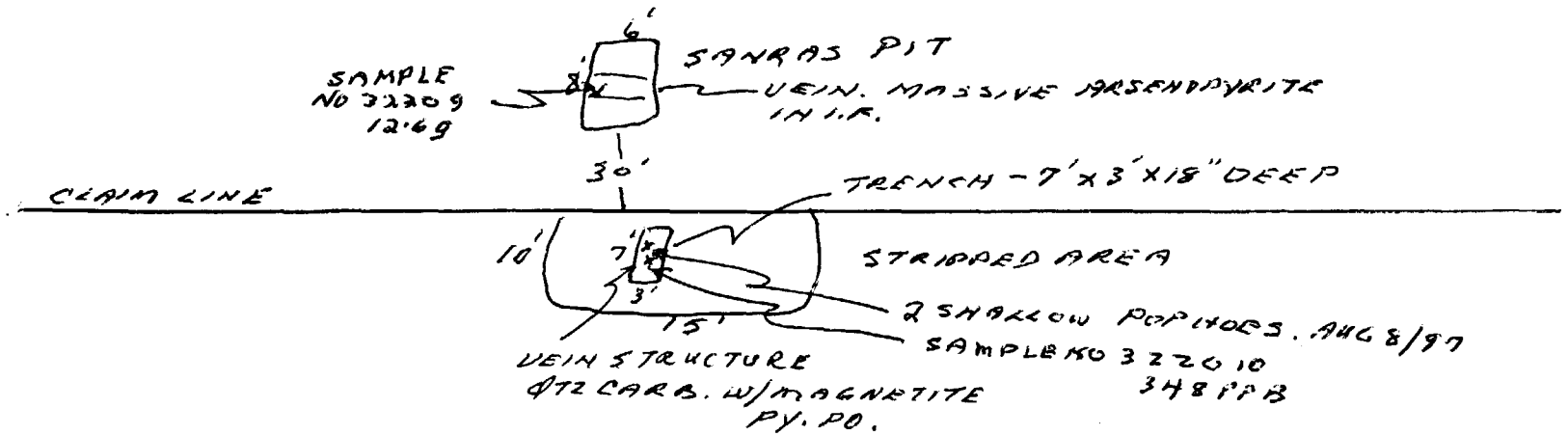

SCALE AS SHOWN

CLAIM NO
459789 (L)

CLAIM NO
418431 (L)

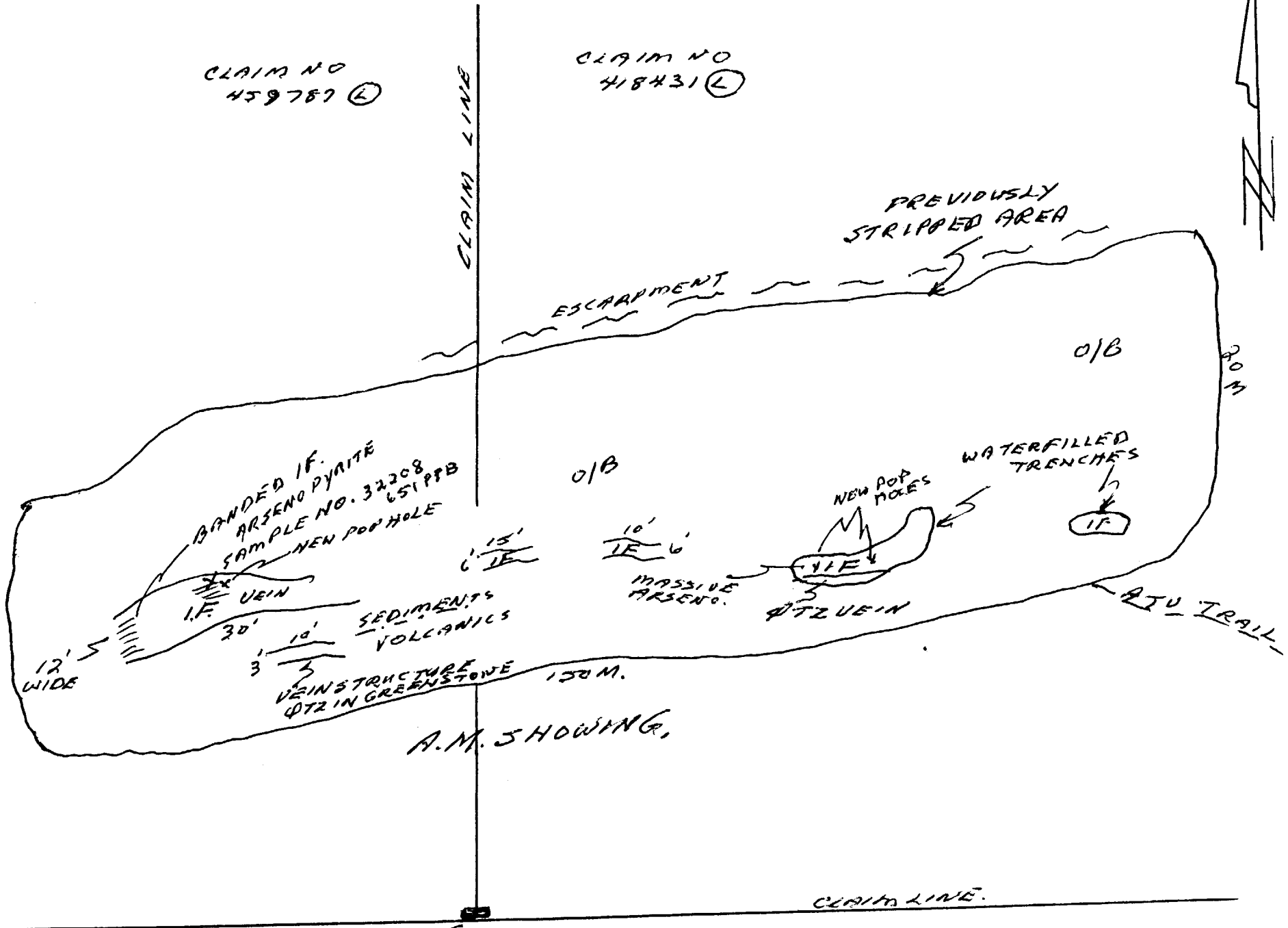

A.M. SHOWING,

CLAIM LINE.

NO POST
TO 459789

SCALE AS SHOWN

Line 11

We spent 1 day walking to the Line 11 showing which is a banded iron formation with magnetite and quartz. The east end shows a 4' section of greenstone shearing with rusty spots and a 6' showing of quartz alongside. This was cleaned out for inspection but visiting geologist didn't visit the showing. Previous sampling showed up to 0.34oz. au.

LINE 11 SHOWING

SEE DETAIL A^{21 10}

ATV TRAIL

16 IN 6' STONE

WATER FILLED
TRENCH

WORK DONE BY

A. MAKI - JULY 11, 1997

B. MAKI - JULY 11, 1997

B. MAKI - JULY 11, 1997

3 MANDAYS AT 160° DAY - 480°
8 HRS EACH

CLAIM LINE

NO 2 POST
604197

MAGNETIC
NORTH



SCALE 1:2000

LINE 11 SHOWING.

DETAIL A.

MAGNETIC NORTH

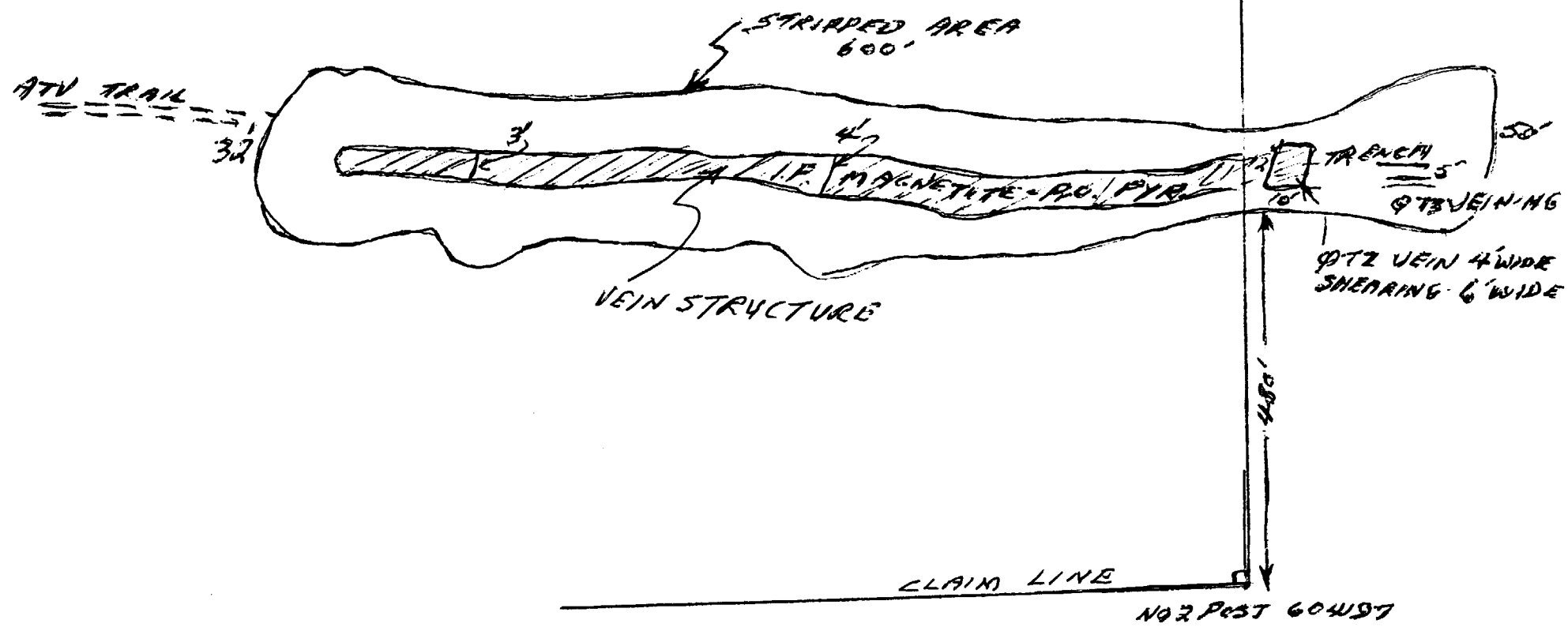



XRAL Laboratories
A Division of SGS Canada Inc.

Work Order: 016792

Date: 25/08/97

PRELIMINARY

Page 1 of 1

| Element. Method. Det.Lim. Units. | Au FA30/5 | Au FAG30 |
|-------------------------------------------|--------------|--------------|
| | 1 ppb | 0.03 g/mt |
| 52201 | 6030 | N.A. |
| 52202 | 703 | N.A. |
| 52203 | 3430 | N.A. |
| 52205 | 965 | N.A. |
| 52206 | 65 | N.A. |
| 52207 | > 10000 | 40.7 |
| 52208 | 651 | N.A. |
| 52209 | > 10000 | 12.6 |
| 52210 | 348 | N.A. |
| 52211 | 68 | N.A. |
| 52212 | 35 | N.A. |
| 52213 | 432 | N.A. |
| 52214 | 4800 | N.A. |
| *Dup 52201 | 6210 | N.A. |
| *Dup 52214 | 5080 | N.A. |

2.17837

RECEIVED
OCT 21 1997
GEOSCIENCE ASSESSMENT



Declaration of Assessment Work Performed on Mining Land

Mining Act, Subsection 65(2) and 66(3), R.S.O. 1990

Transaction Number (office use) W.9740-00961 Assessment Files Research Imaging

Personal information collected under the Access to Information Act, the Information Privacy Act, and the Freedom of Information Act. Questions about this information should be directed to the Information Access and Privacy Officer, Northern Development and Mines, 6th Floor, 933 Ramsey Lake Rd.



900

Under section 8 of the Mining Act, Under section 8 of the Mining Act, work and correspond with the mining land holder. Northern Development and Mines, 6th Floor.

Original

Thunder Bay Mining Division

Instructions: - Please type or print in ink. ... Crown Lands before recording a claim, use form 0240.

2.17837

OCT 21 1997

RECEIVED

1. Recorded holder(s) (Attach a list if necessary)

Form with fields for Name, Address, Client Number, Telephone Number, and Fax Number for two individuals: NEIL R. MAKI and MARK A. MAKI.

2. Type of work performed: Check (✓) and report on only ONE of the following groups for this declaration.

- Geotechnical: prospecting, surveys, assays and work under section 18 (regs)
Physical: drilling, stripping, trenching and associated assays
Rehabilitation

Work Type: PHYSICAL - HAND STRIPPING AND TRENCHING - DEWATER TRENCHES COBRA ROCK DRILL & BLAST. BREAK UP ROCK. Office Use, Dates Work Performed, Global Positioning System Data, Township/Area, Mining Division, Resident Geologist District.

Please remember to: - obtain a work permit from the Ministry of Natural Resources as required; - provide proper notice to surface rights holders before starting work; - complete and attach a Statement of Costs, form 0212; - provide a map showing contiguous mining lands that are linked for assigning work; - include two copies of your technical report.

3. Person or companies who prepared the technical report (Attach a list if necessary)

Form with fields for Name, Address, Telephone Number, and Fax Number for Neil R. Makai.

4. Certification by Recorded Holder or Agent

I, NEIL R. MAKI, do hereby certify that I have personal knowledge of the facts set forth in this Declaration of Assessment Work having caused the work to be performed or witnessed the same during or after its completion and, to the best of my knowledge, the annexed report is true.

Signature of Recorded Holder or Agent, Date, Agent's Address, Telephone Number, Fax Number.

RECORDED OCT 21 1997

OCT 23 1997 GEOSCIENCE ASSESSMENT OFFICE

JANUARY 19 1998

the mining land where work was performed, at the time work was performed. A map showing the contiguous claims must accompany this form.

W-9740-0096

| Mining Claim Number. Or if work was done on other eligible mining land, show in this column the location number indicated on the claim map. | | Number of Claim Units. For other mining land, list hectares. | Value of work performed on this claim or other mining land. | Value of work applied to this claim. | Value of work assigned to other mining claims. | Bank. Value of work to be distributed at a future date. |
|---------------------------------------------------------------------------------------------------------------------------------------------|------------|--------------------------------------------------------------|-------------------------------------------------------------|--------------------------------------|------------------------------------------------|---------------------------------------------------------|
| eg | TB 7827 | 16 ha | \$26,825 | N/A | \$24,000 | \$2,825 |
| eg | 1234567 | 12 | 0 | \$24,000 | 0 | 0 |
| eg | 1234568 | 2 | \$8,892 | \$4,000 | 0 | \$4,892 |
| 1 | 645346 (L) | ✓ 1 | \$6253.00 | | | |
| 2 | 418431 (L) | ✓ 1 | \$2706.00 | | | |
| 3 | 453787 (L) | ✓ 1 | \$802.00 | | | |
| 4 | 604197 | ✓ 1 | \$827.00 | | | |
| 5 | 1197034 | ✓ 2 | \$2912.00 | | | |
| 6 | 1122073 | 1 | | \$800.00 | | |
| 7 | 1138897 | 1 | | \$600.00 | | |
| 8 | 1138898 | 1 | | \$800.00 | | |
| 9 | 1138899 | 1 | | \$800.00 | | |
| 10 | 1138900 | 1 | | \$800.00 | | |
| 11 | 1197034 | 1 | | \$1000.00 | | |
| 12 | 535287 | 1 | | \$800.00 | | |
| 13 | 535288 | 1 | | \$800.00 | | |
| 14 | 535289 | 1 | | \$800.00 | | |
| 15 | 603295 | 1 | | \$800.00 | | |
| Column Totals | | | \$13,200.00 | \$8000.00 | | |

I, _____, do hereby certify that the above work credits are eligible under subsection 7 (1) of the Assessment Work Regulation 6/96 for assignment to contiguous claims or for application to the claim where the work was done.

Signature of Recorded Holder or Agent Authorized in Writing: *[Signature]* Date: *Oct 20/97*

6. Instructions for cutting back credits that are not approved.

Some of the credits claimed in this declaration may be cut back. Please check (✓) in the boxes below to show how you wish to prioritize the deletion of credits:

- 1. Credits are to be cut back from the Bank first, followed by option 2 or 3 or 4 as indicated.
- 2. Credits are to be cut back starting with the claims listed last, working backwards; or
- 3. Credits are to be cut back equally over all claims listed in this declaration; or
- 4. Credits are to be cut back as prioritized on the attached appendix or as follows (describe):

Note: If you have not indicated how your credits are to be deleted, credits will be cut back from the Bank first, followed by option number 2 if necessary.

For Office Use Only
RECEIVED
[Signature] OCT 23 1997
 GEOSCIENCE ASSESSMENT OFFICE

| | |
|-------------------------------------------------------|--------------------------------|
| Deemed Approved Date | Date Notification Sent |
| Date Approved | Total Value of Credit Approved |
| Approved for Recording by Mining Recorder (Signature) | |

the mining land where work was performed, at the time work was performed. A map showing the contiguous link must accompany this form.

W 9740.0096

| Mining Claim Number. Or if work was done on other eligible mining land, show in this column the location number indicated on the claim map. | Number of Claim Units. For other mining land, list hectares. | Value of work performed on this claim or other mining land. | Value of work applied to this claim. | Value of work assigned to other mining claims. | Bank. Value of work to be distributed at a future date. |
|---------------------------------------------------------------------------------------------------------------------------------------------|--------------------------------------------------------------|-------------------------------------------------------------|--------------------------------------|------------------------------------------------|---------------------------------------------------------|
| eg TB 7827 | 16 ha | \$26,825 | N/A | \$24,000 | \$2,825 |
| eg 1234567 | 12 | 0 | \$24,000 | 0 | 0 |
| eg 1234568 | 2 | \$8,892 | \$4,000 | 0 | \$4,892 |
| 1 FORWARD. | | \$13,200.00 | \$800.00 | | |
| 2 603296 | | | \$800.00 | | |
| 3 603297 | | | \$800.00 | | |
| 4 834617 | | | \$800.00 | | |
| 5 603299 | | | \$800.00 | | |
| 6 603298 | | | \$800.00 | | |
| 7 804197 | | | \$400.00 | | |
| 8 1139345 | | | \$400.00 | | |
| 9 614120 | | | \$400.00 | | |
| 10 | | | | | |
| 11 | | | | | |
| 12 | | | | | |
| 13 | | | | | |
| 14 | | | | | |
| 15 | | | | | |
| Column Totals | | \$13,200.00 | \$13,200.00 | | |

2.17837

I, NEIL R. MAKI (Print Full Name), do hereby certify that the above work credits are eligible under subsection 7 (1) of the Assessment Work Regulation 6/96 for assignment to contiguous claims or for application to the claim where the work was done.

RECORDED

Signature of Recorded Holder or Agent Authorized in Writing

Neil R. Maki
Neil R. Maki

OCT 21 1997

Date

OCT. 20/97
OCT 20/97

6. Instructions for cutting back credits that are not approved:

Some of the credits claimed in this declaration may be cut back. Please check (✓) in the boxes below to show how you wish to prioritize the deletion of credits:

- 1. Credits are to be cut back from the Bank first, followed by option 2 or 3 or 4 as indicated.
- 2. Credits are to be cut back starting with the claims listed last, working backwards; or
- 3. Credits are to be cut back equally over all claims listed in this declaration; or
- 4. Credits are to be cut back as prioritized on the attached appendix or as follows (describe):

Note: If you have not indicated how your credits are to be deleted, credits will be cut back from the Bank first, followed by option number 2 if necessary.

For Office Use Only

Received Stamp

RECEIVED
OCT 23 1997
GEOSCIENCE ASSESSMENT OFFICE

Deemed Approved Date

Date Notification Sent

Date Approved

Total Value of Credit Approved

Approved for Recording by Mining Recorder (Signature)

Personal information collected on this form is obtained under the authority of subsection 6(1) of the Assessment Work Regulation 6/96. Under section 8 of the Mining Act, the information is a public record. This information will be used to review the assessment work and correspond with the mining land holder. Questions about this collection should be directed to the Chief Mining Recorder, Ministry of Northern Development and Mines, 6th Floor, 933 Ramsey Lake Road, Sudbury, Ontario, P3E 6B5.

| Work Type | Units of Work Depending on the type of work, list the number of hours/days worked, metres of drilling, kilometres of grid line, number of samples, etc. | Cost Per Unit | Total Cost |
|---------------------------------------------------------------------------|------------------------------------------------------------------------------------------------------------------------------------------------------------|---------------|---------------------|
| PHYSICAL | 55.5 DAYS | \$16000/DAY | \$888000 |
| | | 2 170 37 | |
| Associated Costs (e.g. supplies, mobilization and demobilization). | | | |
| | GAS & OIL | | \$12400 |
| | MOBILIZATION AND DEMOBILIZATION | | |
| | 8 MAN DAYS @ 16000/DAY | | \$1,280,000 |
| Transportation Costs | | | |
| | 3 TRIP - THUNDER BAY TO CLAIMS & RETURN | | \$105000 |
| | 3 X 452 KM @ 30 KM | | |
| Food and Lodging Costs | | | |
| | 68 MAN DAYS @ 200/DAY | | \$133600 |
| Total Value of Assessment Work | | | \$13,200,000 |

RECORDED
OCT 21 1997

Calculations of Filing Discounts:

Work filed within two years of performance is claimed at 100% of the above Total Value of Assessment Work. If work is filed after two years and up to five years after performance, it can only be claimed at 50% of the Total Value of Assessment Work. If this situation applies to your claims, use the calculation below:

TOTAL VALUE OF ASSESSMENT WORK $\times 0.50 =$ Total \$ value of worked claimed.

Note:

Work older than 5 years is not eligible for credit. A recorded holder may be required to verify expenditures claimed in this statement of costs within 45 days of a request for verification and/or correction/clarification. If verification and/or correction/clarification is not made, the Minister may reject all or part of the assessment work submitted.

Certification verifying costs:

NEIL R. MAKI (please print full name), do hereby certify, that the amounts shown are as accurate as may reasonably be determined and the costs were incurred while conducting assessment work on the lands indicated on the accompanying Declaration of Work form as RECORDED HOLDER I am authorized (recorded holder, agent, or state company position with signing authority)

make this certification.

RECEIVED
OCT 23 1997
GEOSCIENCE ASSESSMENT OFFICE

Signature: Neil Maki Date: Oct 20/97

February 24, 1998

NEIL R. MAKI
R.R. #14
THUNDER BAY, Ontario
P7B-5E5

Geoscience Assessment Office
933 Ramsey Lake Road
6th Floor
Sudbury, Ontario
P3E 6B5

Telephone: (888) 415-9846
Fax: (705) 670-5881

Dear Sir or Madam:

Submission Number: 2.17837

Status

Subject: Transaction Number(s): W9740.00961 Approval After Notice

We have reviewed your Assessment Work submission with the above noted Transaction Number(s). The attached summary page(s) indicate the results of the review. **WE RECOMMEND YOU READ THIS SUMMARY FOR THE DETAILS PERTAINING TO YOUR ASSESSMENT WORK.**

If the status for a transaction is a 45 Day Notice, the summary will outline the reasons for the notice, and any steps you can take to remedy deficiencies. The 90-day deemed approval provision, subsection 6(7) of the Assessment Work Regulation, will no longer be in effect for assessment work which has received a 45 Day Notice.

Please note any revisions must be submitted in **DUPLICATE** to the Geoscience Assessment Office, by the response date on the summary.

If you have any questions regarding this correspondence, please contact Lucille Jerome by e-mail at jeromel2@epo.gov.on.ca or by telephone at (705) 670-5858.

Yours sincerely,



ORIGINAL SIGNED BY
Blair Kite
Supervisor, Geoscience Assessment Office
Mining Lands Section

Work Report Assessment Results

Submission Number: 2.17837

Date Correspondence Sent: February 24, 1998

Assessor: Lucille Jerome

| Transaction Number | First Claim Number | Township(s) / Area(s) | Status | Approval Date |
|---------------------------|---------------------------|------------------------------|-----------------------|----------------------|
| W9740.00961 | 645346 | VINCENT | Approval After Notice | February 23, 1998 |

Section:

10 Physical PMAN

Assessment work credit has been approved as outlined on the Declaration of Assessment Work Form accompanying this submission.

Assessment work credit has been redistributed, as outlined on the attached Distribution of Assessment Work Credit sheet, to better reflect the location of the work.

Correspondence to:

Resident Geologist
Thunder Bay, ON

Recorded Holder(s) and/or Agent(s):

NEIL R. MAKI
THUNDER BAY, Ontario

Assessment Files Library
Sudbury, ON

Distribution of Assessment Work Credit

The following credit distribution reflects the value of assessment work performed on the mining land(s).

Date: February 24, 1998

Submission Number: 2.17837

Transaction Number: W9740.00961

| <u>Claim Number</u> | <u>Value Of Work Performed</u> |
|---------------------|--------------------------------|
| 645346 | 6,230.00 |
| 418431 | 2,470.00 |
| 459787 | 800.00 |
| 604197 | 800.00 |
| 1197034 | 1,450.00 |
| 535287 | 1,450.00 |
| | <hr/> |
| Total: \$ | 13,200.00 |
