



42E12NE2006 2.19069 VINCENT

010

February 9, 1999

Geoscience Assessment Office
933 Ramsay Lake Road, 6th Floor,
Sudbury, Ontario
P3E 6B5

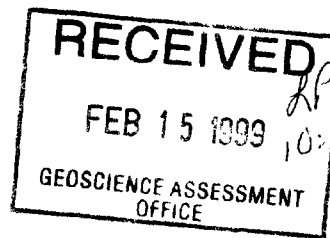

Dear Sirs:

In my Declaration of Assessment Work for 1998 I noted assay results would follow.

The mining company representative who visited our property late October took only two (2) samples as he will be returning next summer to do more detail geology and sampling, etc. However, he gave me the two assay results over the telephone, as follows.

Sandra's showing 72.0 gm Au

Key claim-Qtz vein 23.0 gm Au

Thank-you

Yours Truly

Neil R. Maki
Client No. 163774

LINE 11

2.19069

The line 11 showing is an iron formation with banded magnetite and quartz veining injected. In the east end of the exposed vein a 10' long trench has 6' of quartz veins and 4' of volcanics with minor sulphides and magnetite. Previous assays range from 0.14 to 0.34 oz.Au. Our 1998 program was to keep the main water filled trench bailed out and the rest of the showing clean for inspection.

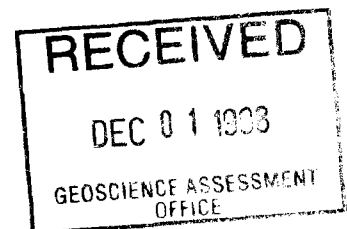

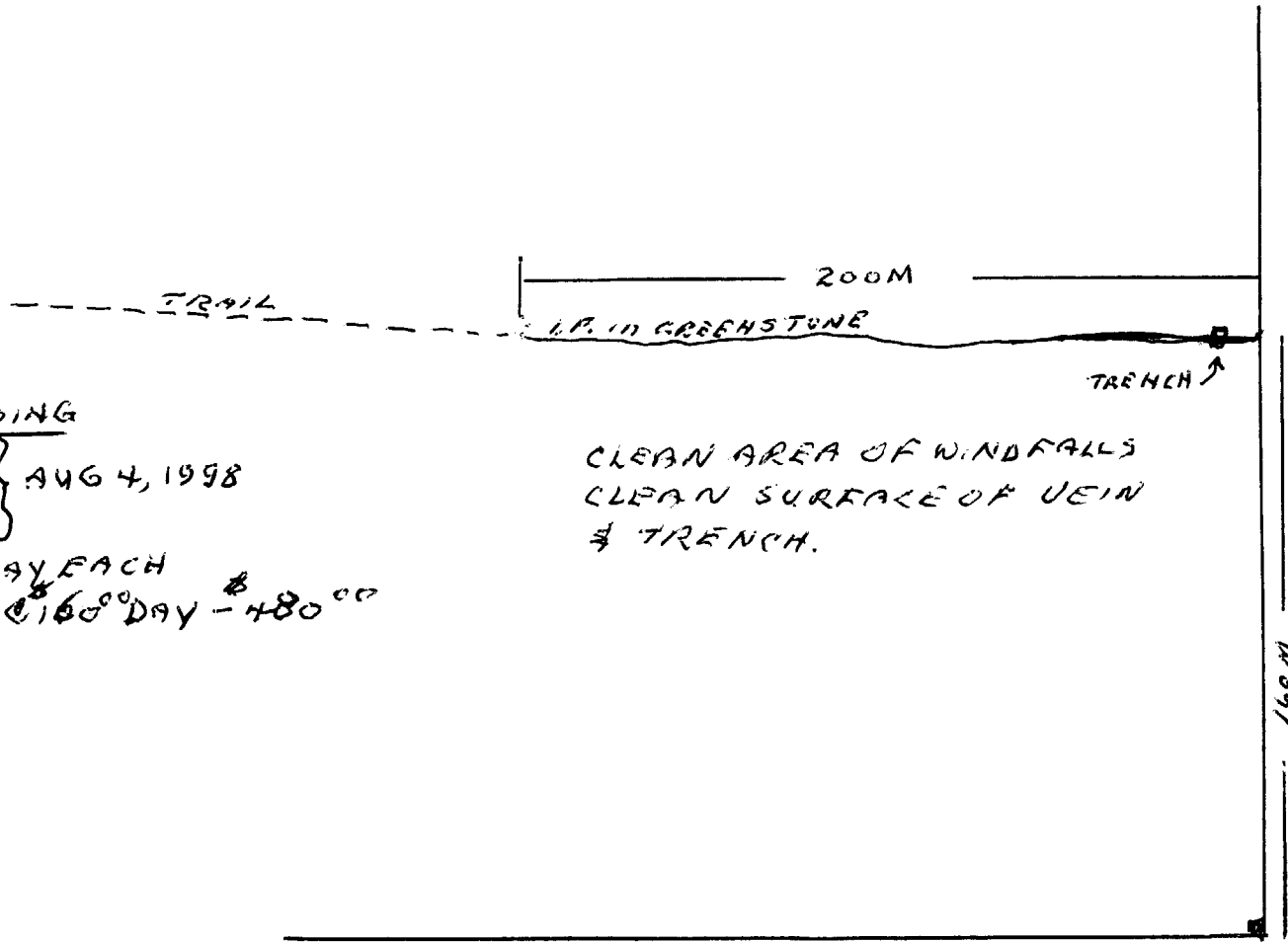

LINE II SHOWING

AILI MAKI
 NEIL MAKI } AUG 4, 1998
 SANDRA MUORE }

LABOUR. 1 DAY EACH
 3 MAN DAYS @ 160⁰⁰ DAY - 480⁰⁰

CLEAN AREA OF WINDFALLS
 CLEAN SURFACE OF VEIN
 & TRENCH.

NO 2 POST 604197



LINE 11 SHOWING

MAG. NORTH

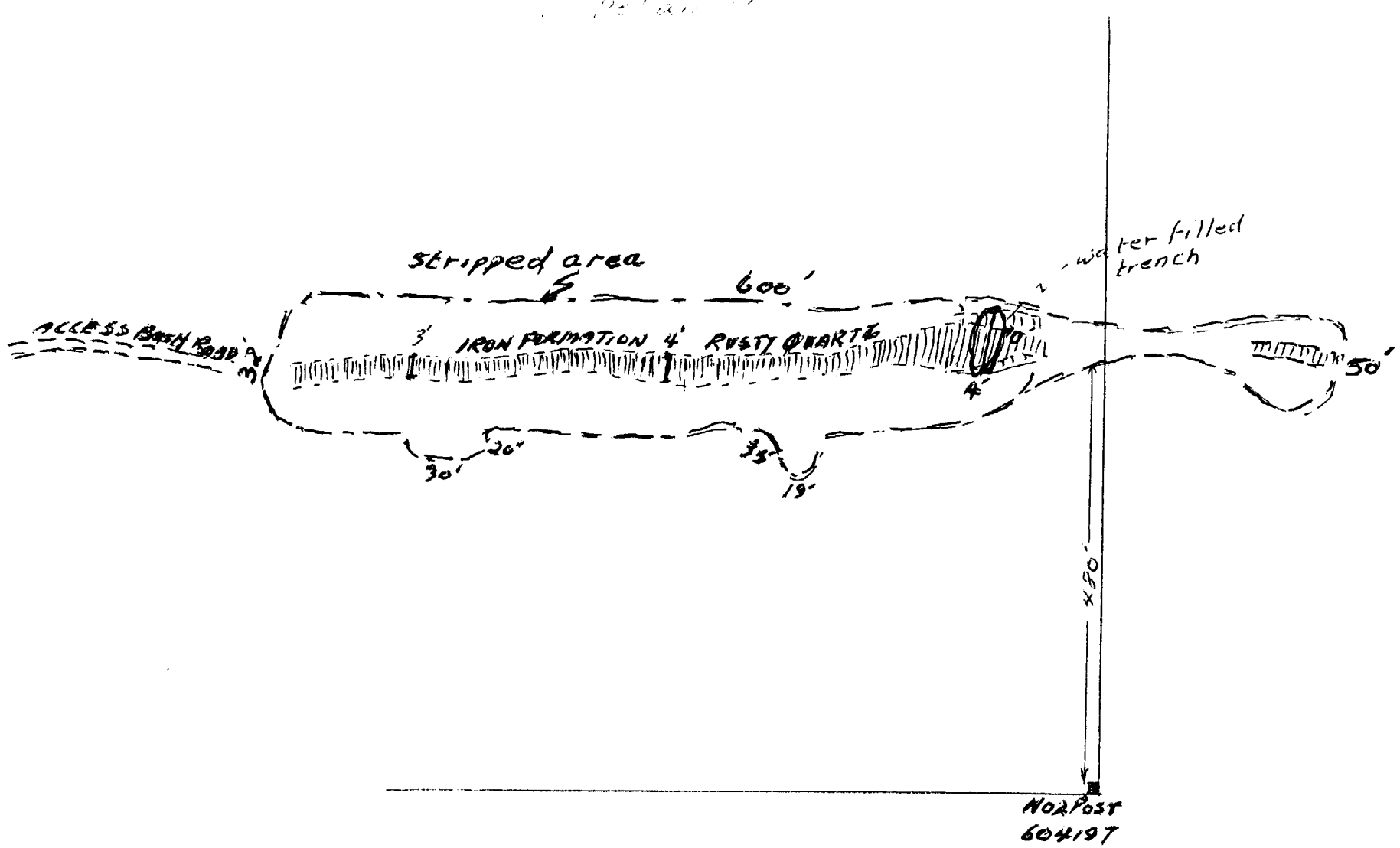

MOOSEHORN, LINE 20 AND KM VEIN

We cleaned out trenches of winter debris and fallen trees. We put in several pop holes for sampling as shown. The Moosehorn, Line 20 and KM veins on the west end of the claim group are two parallel structures, the Moosehorn and Line 20 are a flow type of formation with folding and an irregular strike and pattern, consisting of quartz with galena and chalco giving good gold values. Dip is uncertain, but the strike is easterly. The KM vein is a regular vein structures with grunerite, chalco, arseno and magnetite.

MOOSEHORN SHOWING
 AILI MAKI - JUNE 29 - 1998
 NEIL MAKI - JUNE 29 - 1998
 BYRON MAKI - JUNE 29 - 1998
 LABOUR - 3 MAN DAYS
 @ 160⁰⁰ DAY
 8 HRS EACH DAY - \$480⁰⁰

LINE 20 4 KM SHOWINGS

AILI MAKI - }
 NEIL MAKI - } JUNE 30, 1998
 BYRON MAKI - }
 LABOUR - 3 MAN DAYS @ 160⁰⁰ DAY - \$480⁰⁰

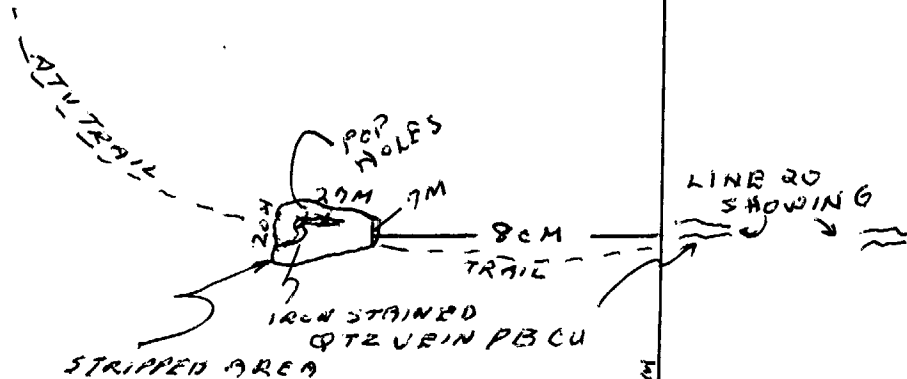

KMUEIN

IRON FORMATION
 PY PO, MAGNETITE



A.M. AND SANDRA'S SHOWINGS

We cleaned all areas of excess rock and debris and blown down trees. We put in several pop holes to get fresh samples for mining company geologists who may be visiting our property. The A.M. vein consists of a banded iron formation ranging from 3' to 14' wide, with 1/2" to 1" bands of arsenopyrite and in places heavily rusted arsenopyrite and magnetite associated with the injected quartz. Sediments lie just to the north of the showing and volcanics to the south. Extensive stripping and trenching was done in 1992.

Sandra's pit consists mostly of heavy arsenopyrite across 5' with grunerite prevalent. The south section is 7' wide consisting of a rusty iron formation injected with quartz, magnetite minor arsenopyrite and pyrite.

AMUEIN

WORK DONE BY

AILI MAKI

NEIL MAKI

SANDRA MOORE

JULY 23, 23, 24, 1998

LABOUR - 8 HRS EACH DAY

9 MON DAYS @ 160⁰⁰ DAY \$ 1440⁰⁰

SANDRAS SHOWING

AILI MAKI

NEIL MAKI

SANDRA MOORE

JULY 25, 1998

LABOUR 1/2 DAY EACH

1 1/2 MON DAYS @ 160⁰⁰ DAY \$ 240⁰⁰

CLAIM NO 455789
1548M ON W/173

RECEIVED
DEC 01 1998
GEO SCIENCE ASSESSMENT
OFFICE

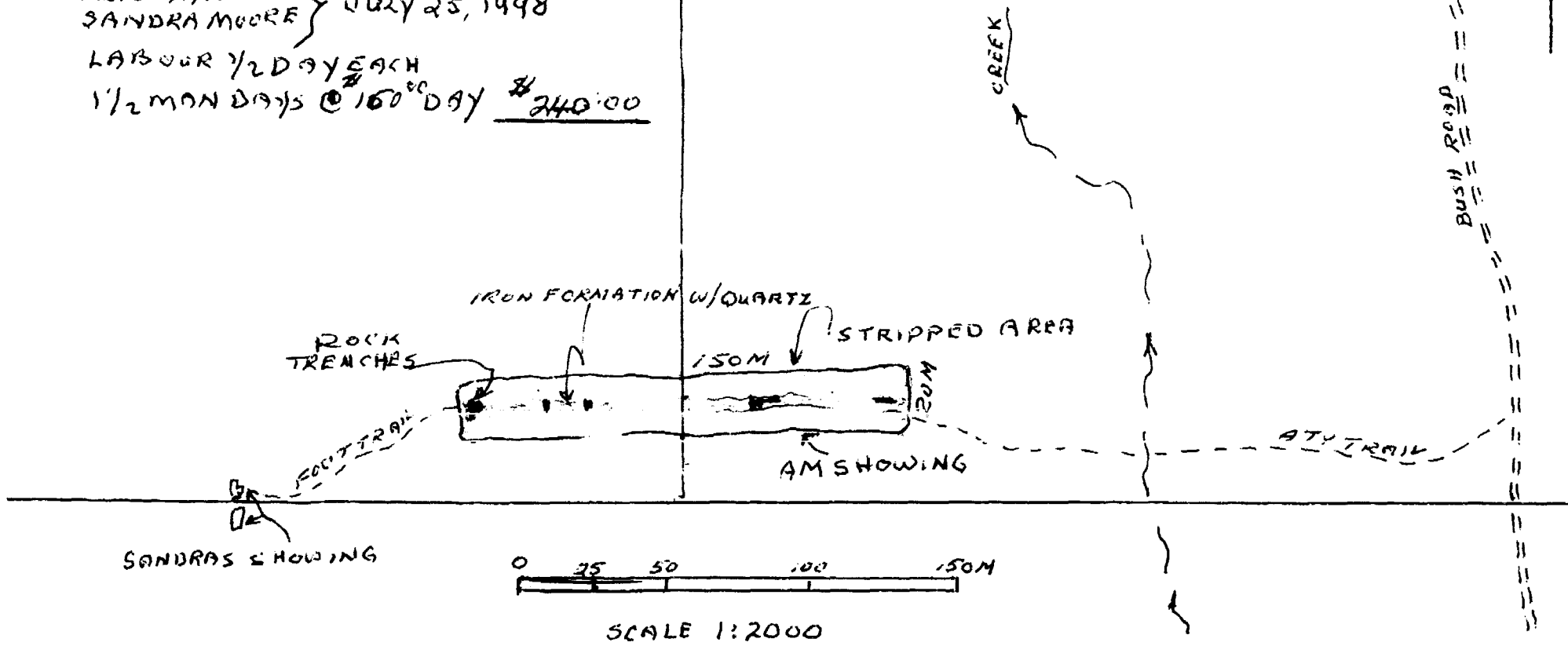

CLAIM NO
459787 (L)

CLAIM NO
418431 (L)



CLAIM LINE

PREVIOUSLY
STRIPPED AREA

ESCARPMENT

O/B

20 M

BANDED IF.
ARSENOPYRITE

O/B

WATERFILLED
TRENCHES

NEW POOHOLE
1998

15'
IF

10'
IF

NEW POH
1998

IF VEIN

MASSIVE
ARSENOPYRITE

IF

NEW POH
1998

12'
WIDE

30'

SEDIMENTS
VOLCANICS

IF VEIN

VEIN STRUCTURE
QTZ IN GREENSTONE

150 M.

STU TRAIL

A.M. SHOWING

CLAIM LINE

NO POST
T3 459787

SCALE AS SHOWN

KEY CLAIM

An irregular formation consisting of quartz stringers varying in width from 4" to 36" meandering in a banded sediment consisting mainly of cherty material alternating with volcanics. The zone is well brecciated and small veinlets of later quartz run through it. Visible gold is found in the quartz veins and control panning along the vein shows from very fine to coarse gold. Ankerite has been injected with the quartz along with hornblende. Some banding occurs which is well brecciated, carbonated and mineralized with pyrrhotite, chalcopyrite and arsenopyrite and pyrite.

SOUTH SHOWING

After cleaning out winters debris from the trenches we drilled several pop holes and blasted them to get fresh samples. We broke up the bigger pieces and transported them to camp for further testing.

SNOWBALL SHOWING

The showing is a blocky type of iron formation in sediments, injected with miner pyrite and magnetite. We put several pop holes in the west and central trenches as shown. We cleaned and brushed out the strawberry showing and broke up the previously blasted rock which is in a iron formation containing
g
miner pyrite, magnetite and quartz.

*P.S. ASSAY RESULTS TAKEN BY A MINING COMPANY
END OF OCTOBER WILL FOLLOW WHEN RECEIVED*

NEIL R. MAKI.



STRAWBERRY SHOWING
SNOWBALL SHOWING

STRAWBERRY

STRIPPED AREAS

SNOWBALL

KEY CLAIM SOUTH

STRIPPED AREAS

SMALL
PIT

NO 3 POST
645346 (L)

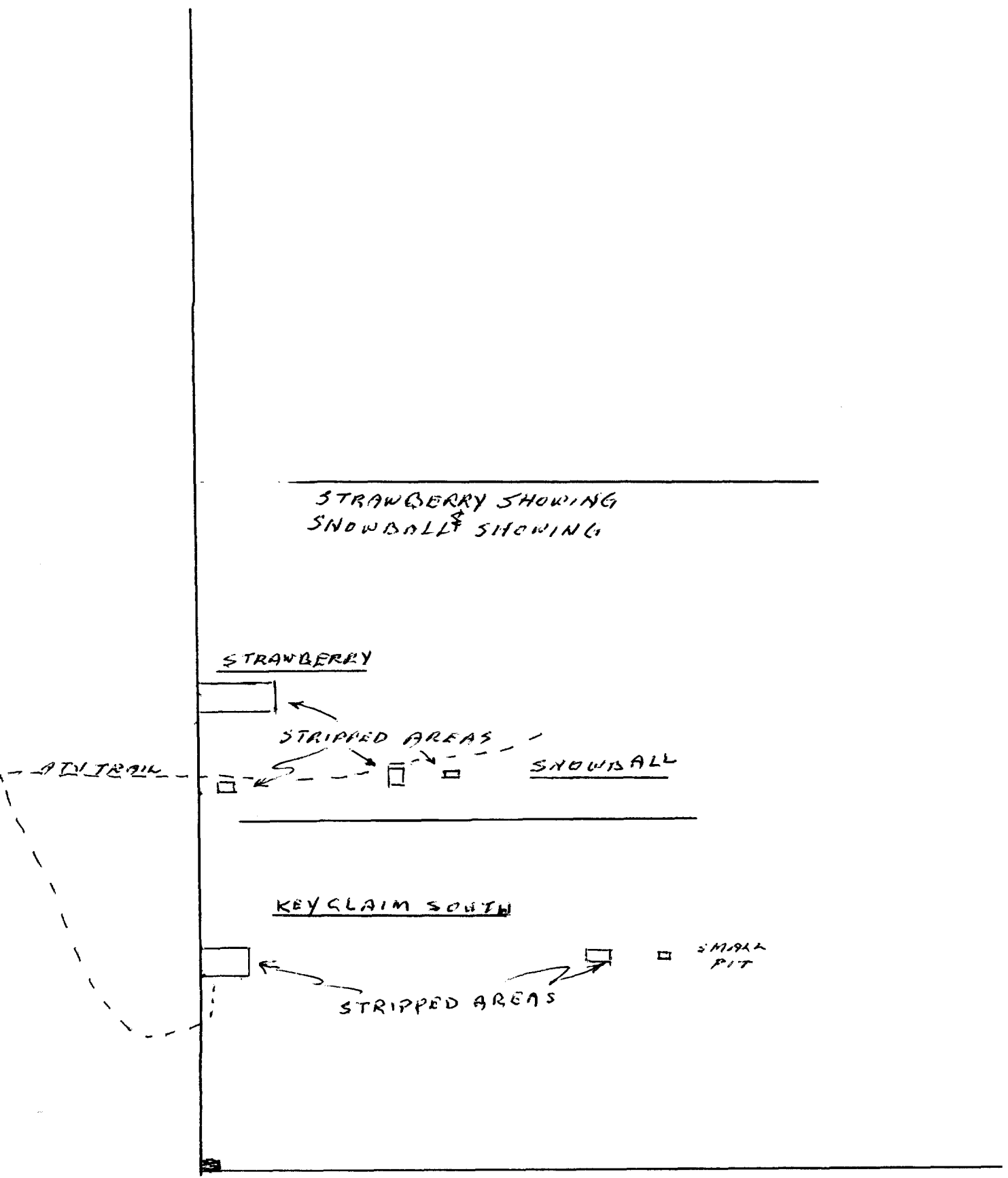

STRAWBERRY SHOWING

CLEAN SURFACE SHOWING
TAKE SAMPLES. CLEAN UP.

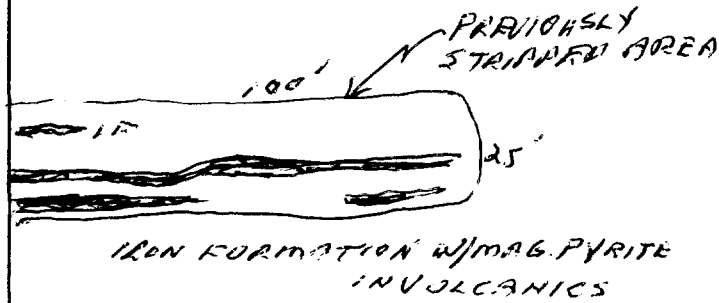

AILI MAKI - JULY 12, 1998
 NEIL MAKI - JULY 12
 BYRON MAKI - JULY 12
 LABOUR - 3 MANDAYS
 @ 160⁰⁰ DAY - 480⁰⁰
 8 HRS DAILY

20 M

SNOWBALL SHOWING

DRILL, BLAST,
CLEAN UP

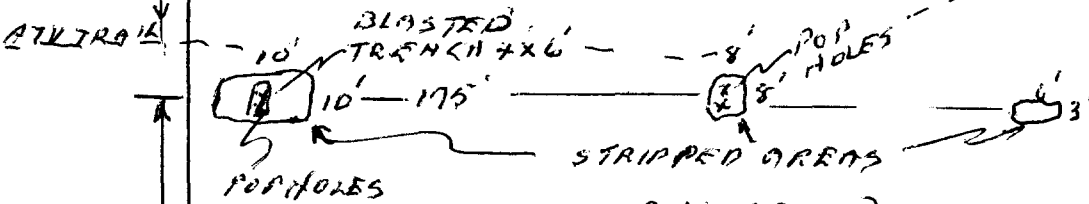

AILI MAKI }
 NEIL MAKI } JULY, 9, 10, JULY 11, 1998
 BYRON MAKI }
 LABOUR 4 MANDAYS @ 160⁰⁰ DAY #
 8 HRS DAILY

60 M

PREVIOUSLY STRIPPED AREAS

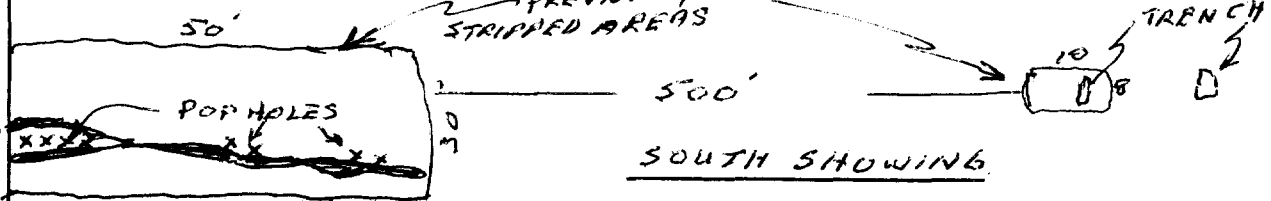

SOUTH SHOWING

BAIL OUT TRENCHES
DRILL & BLAST - CLEAN
OUT & BREAK ROCK,
STOCK PILE ROCK.

AILI MAKI } 9, 10, 11, 12, 13, 14 } 1998
 NEIL MAKI }
 SANDRA MOORE } 18, 19, 20, 21 }

8 HRS EACH DAY
 LABOUR 27 MANDAYS @ 160⁰⁰ DAY - 4320⁰⁰

75 M

NO 3 POST
TB 645346

SCALE AS SHOWN

Gold Showings

- ① Moosehorn
- ② Line 20
- ③ K.M
- ④ Discovery
- ⑤ Sandras
- ⑥ A.M
- ⑦ Byrons
- ⑧ Roadside
- ⑨ Crystal
- ⑩ skidder
- ⑪ Big Pit
- ⑫ Moose Scare
- ⑬ Line 11
- ⑭ Pond
- ⑮ Birds Nest
- ⑯ Lakeshore
- ⑰ Snowball
- ⑱ Strawberry
- ⑲ Key Claim



Ministry of Northern Development and Mines

Declaration of Assessment Work Performed on Mining Land

Mining Act, Subsection 65(2) and 66(3), R.S.O. 1990

Transaction Number (office use) W9840.00662
Assessment Files Research Imaging



P 42E12NE2006 2.19069 VINCENT 900

subsections 65(2) and 66(3) of the Mining Act. Under section 8 of the Act the assessment work and correspond with the mining land holder. Recorder, Ministry of Northern Development and Mines, 6th Floor.

Instructions: - For work performed on Crown Lands before recording a claim, use form 0240.
- Please type or print in ink.

Thunder Bay Mining Division

NOV 30 1998

RECEIVED

1. Recorded holder(s) (Attach a list if necessary)

Name NEIL R. MAKI	Client Number 163774
Address RR14 THUNDER BAY	Telephone Number 767-2194
ONTARIO P705E5	Fax Number
Name	Client Number
Address	Telephone Number
	Fax Number

2. Type of work performed: Check (✓) and report on only ONE of the following groups for this declaration.

- Geotechnical: prospecting, surveys, assays and work under section 18 (regs) Physical: drilling, stripping, trenching and associated assays Rehabilitation

Work Type HAND STRIPPING & TRENCHING - DRAINAGE TRENCHES - COBRA ROCK DRILL & BLAST BREAK UP ROCK.	Office Use
	Commodity
	Total \$ Value of Work Claimed \$ 13,600
Dates Work Performed From 21 06 98 To 18 09 98	NTS Reference
Global Positioning System Data (if available)	Mining Division Thunder Bay
Township/Area VINCENT	Resident Geologist District Thunder Bay
M or G-Plan Number G 163	

Please remember to: - obtain a work permit from the Ministry of Natural Resources as required;
- provide proper notice to surface rights holders before starting work;
- complete and attach a Statement of Costs, form 0212;
- provide a map showing contiguous mining lands that are linked for assigning work;
- include two copies of your technical report.

3. Person or companies who prepared the technical report (Attach a list if necessary)

Name NEIL R. MAKI	Telephone Number 807-767-2194
Address RR14 THUNDER BAY ONT P705E5	Fax Number
Name	Telephone Number
Address	Fax Number
Name	Telephone Number
Address	Fax Number

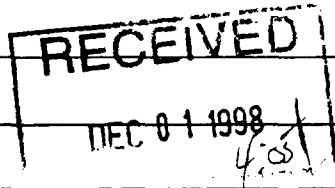

4. Certification by Recorded Holder or Agent

I, NEIL R. MAKI (Print Name), do hereby certify that I have personal knowledge of the facts set forth in this Declaration of Assessment Work having caused the work to be performed or witnessed the same during or after its completion and, to the best of my knowledge, the annexed report is true.

Signature of Recorded Holder or Agent <i>Neil Maki</i>	Date NOV 18, 1998
Agent's Address Neil Maki 1999	Telephone Number 767-2194
	Fax Number

5. Work to be recorded and distributed. Work can only be done on the mining land where work was performed, at the time work was performed. A map showing the contiguous link must accompany this form.

Mining Claim Number. Or if work was done on other eligible mining land, show in this column the location number indicated on the claim map.	Number of Claim Units. For other mining land, list hectares.	Value of work performed on this claim or other mining land.	Value of work applied to this claim.	Value of work assigned to other mining claims.	Bank. Value of work to be distributed at a future date.
eg TB 7827	16 ha	\$26,825	N/A	\$24,000	\$2,825
eg 1234567	12	0	\$24,000	0	0
eg 1234568	2	\$ 8,892	\$ 4,000	0	\$4,892
600268 1 418431(2)	1	\$1475.00			
2 459787(2)	1	\$1580.00			
600320 3 645346(2)	1	\$9020.00			
4 603297	1	\$ 480.00			
5 604197	1	\$ 565.00			
6 1197034	2	\$ 480.00			
7 1122073			\$ 600.00		
8 1138897			400.00		
9 1138898			600.00		
10 1138899			600.00		
11 1138900			600.00		
12 1129345			600.00		
13 1197034			1400.00		
14 525287			800.00		
15 525288			800.00		
Column Totals		\$13,600.00	\$ 6400.00		

2.19069

I, NEIL R. MAKI (Print Full Name), do hereby certify that the above work credits are eligible under subsection 7 (1) of the Assessment Work Regulation 6/96 for assignment to contiguous claims or for application to the claim where the work was done.

Signature of Recorded Holder or Agent Authorized in Writing: [Signature] Date: NOV 18, 1998

6. Instructions for cutting back credits that are not approved.

Some of the credits claimed in this declaration may be cut back. Please check (✓) in the boxes below to show how you wish to prioritize the deletion of credits:

- 1. Credits are to be cut back from the Bank first, followed by option 2 or 3 or 4 as indicated.
- 2. Credits are to be cut back starting with the claims listed last, working backwards; or
- 3. Credits are to be cut back equally over all claims listed in this declaration; or
- 4. Credits are to be cut back as prioritized on the attached appendix or as follows (describe):

Thunder Bay Mining Division

NOV 3 1998

RECEIVED

Note: If you have not indicated how your credits are to be deleted, credits will be cut back from the Bank first, followed by option number 2 if necessary.

For Office Use Only

Received Stamp	Deemed Approved Date	Date Notification Sent
	Date Approved	Total Value of Credit Approved
Approved for Recording by Mining Recorder (Signature)		

5. Work to be recorded and distributed. Work can only be assigned to claims that are contiguous to the mining land where work was performed, at the time work was performed. A map showing the contiguous link must accompany this form.

wa 840.00 662

Mining Claim Number. Or if work was done on other eligible mining land, show in this column the location number indicated on the claim map.	Number of Claim Units. For other mining land, list hectares.	Value of work performed on this claim or other mining land.	Value of work applied to this claim.	Value of work assigned to other mining claims.	Bank. Value of work to be distributed at a future date.
eg TB 7827	16 ha	\$26,825	N/A	\$24,000	\$2,825
eg 1234567	12	0	\$24,000	0	0
eg 1234568	2	\$8,892	\$4,000	0	\$4,892
1 FORWARD		13600.00	6400.00		
2 535289			800.00		
3 603295			800.00		
4 603296			800.00		
5 603297			800.00		
6 603298			800.00		
7 603299			800.00		
8 604197			800.00		
9 614120			800.00		
10 834617			800.00		
11					
12					
13					
14					
15					
Column Totals		\$13,600.00	\$13,600.00		

19069

I, NEIL R. MAKI (Print Full Name), do hereby certify that the above work credits are eligible under subsection 7 (1) of the Assessment Work Regulation 6/96 for assignment to contiguous claims or for application to the claim where the work was done.

Signature of Recorded Holder or Agent Authorized in Writing: [Signature] Date: NOV 18, 1998

6. Instructions for cutting back credits that are not approved:

Some of the credits claimed in this declaration may be cut back. Please check (✓) in the boxes below to show how you wish to prioritize the deletion of credits:

- 1. Credits are to be cut back from the Bank first, followed by option 2 or 3 or 4 as indicated.
- 2. Credits are to be cut back starting with the claims listed last, working backwards; or
- 3. Credits are to be cut back equally over all claims listed in this declaration; or
- 4. Credits are to be cut back as prioritized on the attached appraisal or as follows (describe):

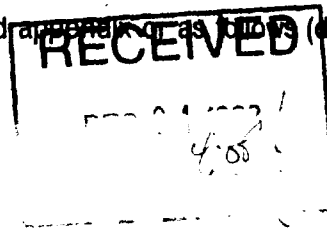

Note: If you have not indicated how your credits are to be deleted, credits will be cut back from the Bank first, followed by option number 2 if necessary.

For Office Use Only

Received Stamp	Deemed Approved Date	Date Notification Sent
	Date Approved	Total Value of Credit Approved
Approved for Recording by Mining Recorder (Signature)		

Geoscience Assessment Office
933 Ramsey Lake Road
6th Floor
Sudbury, Ontario
P3E 6B5

Telephone: (888) 415-9846
Fax: (877) 670-1555

February 25, 1999

NEIL R. MAKI
R.R. #14
THUNDER BAY, Ontario
P7B-5E5

Visit our website at:
www.gov.on.ca/MNDM/MINES/LANDS/mlsmnpge.htm

Dear Sir or Madam:

Submission Number: 2.19069

Status

Subject: Transaction Number(s): W9840.00662 Approval

We have reviewed your Assessment Work submission with the above noted Transaction Number(s). The attached summary page(s) indicate the results of the review. WE RECOMMEND YOU READ THIS SUMMARY FOR THE DETAILS PERTAINING TO YOUR ASSESSMENT WORK.

If the status for a transaction is a 45 Day Notice, the summary will outline the reasons for the notice, and any steps you can take to remedy deficiencies. The 90-day deemed approval provision, subsection 6(7) of the Assessment Work Regulation, will no longer be in effect for assessment work which has received a 45 Day Notice. Allowable changes to your credit distribution can be made by contacting the Geoscience Assessment Office within this 45 Day period, otherwise assessment credit will be cut back and distributed as outlined in Section #6 of the Declaration of Assessment work form.

Please note any revisions must be submitted in DUPLICATE to the Geoscience Assessment Office, by the response date on the summary.

If you have any questions regarding this correspondence, please contact Lucille Jerome by e-mail at lucille.jerome@ndm.gov.on.ca or by telephone at (705) 670-5858.

Yours sincerely,



ORIGINAL SIGNED BY
Blair Kite
Supervisor, Geoscience Assessment Office
Mining Lands Section

Work Report Assessment Results

Submission Number: 2.19069

Date Correspondence Sent: February 25, 1999

Assessor: Lucille Jerome

Transaction Number	First Claim Number	Township(s) / Area(s)	Status	Approval Date
W9840.00662	418431	VINCENT	Approval	February 25, 1999

Section:

10 Physical PMAN

Correspondence to:

Resident Geologist
Thunder Bay, ON

Recorded Holder(s) and/or Agent(s):

NEIL R. MAKI
THUNDER BAY, Ontario

Assessment Files Library
Sudbury, ON

WALTERS TWP G-171

TOWNSHIP

VINCENT

M.N.R. ADMINISTRATIVE DISTRICT

NIPICOM

MINING DIVISION

THUNDER BAY

LAND TITLES REGISTRY DIVISION

THUNDER BAY

DATE OF ISSUE
APR 08 1999

PROVINCIAL RECORDING
OFFICE - SUDBURY

THE INFORMATION SHOWN
HEREIN IS THE PROPERTY OF
THE PROVINCE OF ONTARIO
AND IS NOT TO BE USED FOR
ANY OTHER PURPOSE WITHOUT
THE WRITTEN PERMISSION OF
THE MINISTER OF LANDS
AND FORESTRY.

LEGEND

- PATENTED LAND
- PATENTED FOR SURFACE RIGHTS ONLY
- LEASE
- LICENSE OF OCCUPATION
- CROWN LAND SALES
- LOCATED LAND
- CANCELLED
- MINING RIGHTS ONLY
- SURFACE RIGHTS ONLY
- HIGHWAY & ROUTE NO.
- ROADS
- TRAILS
- RAILWAYS
- POWER LINES
- MARSH OR MUSKEG
- MINES

SCALE: 1 INCH = 40 CHAINS

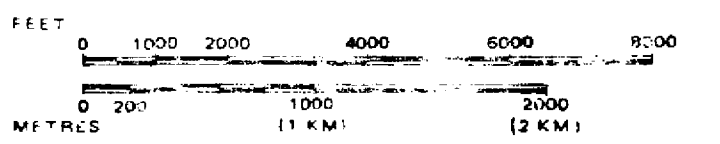

Ministry of Land
Natural Resources Management
Branch

Date FEBRUARY 16th, 1999

Number

G-163

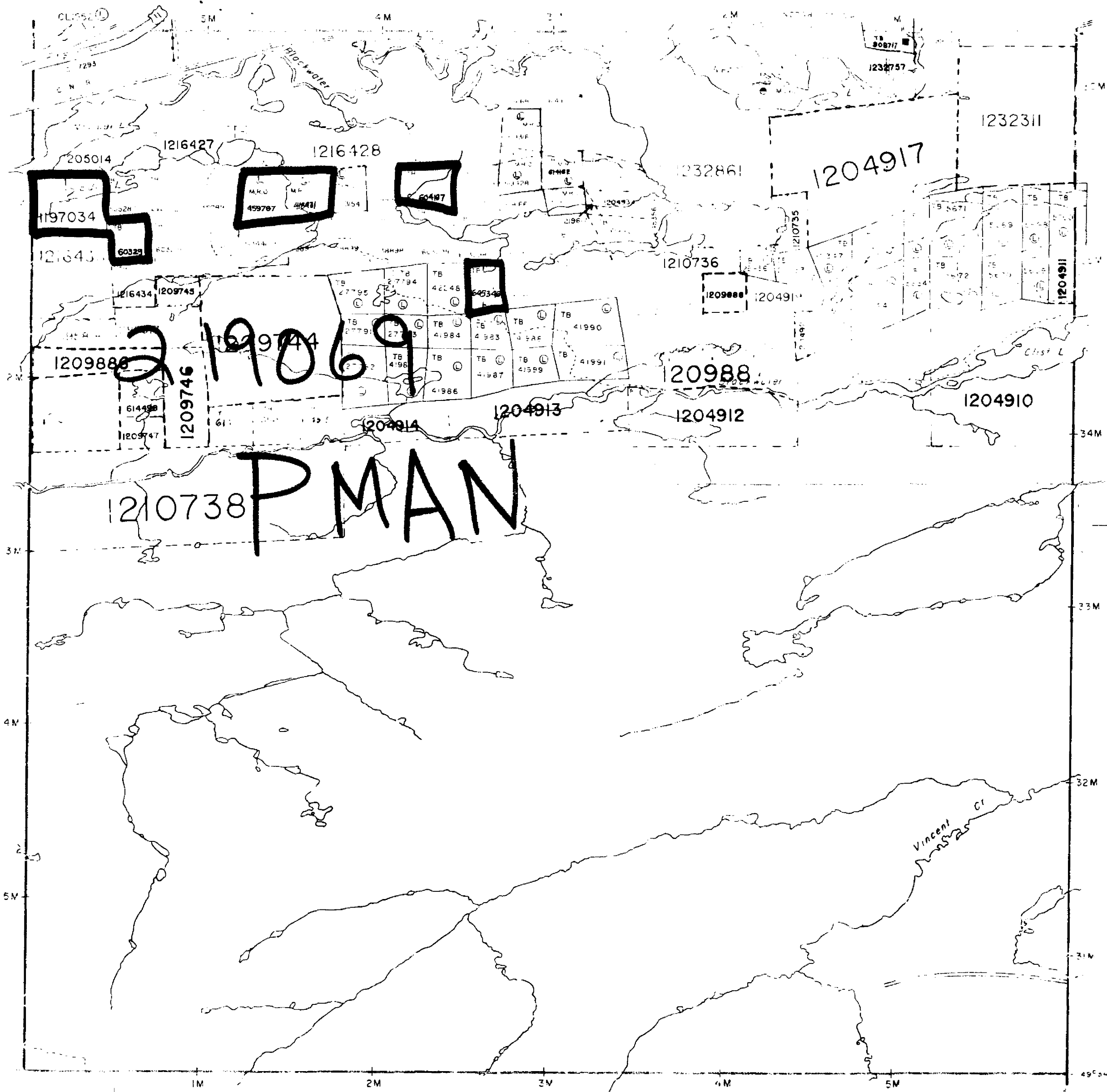

CLIST LAKE G-24

LEOPARD LAKE G-68

McCOMBER TWP G-166

BEARDMORE
G-7

LEOPARD LAKE G-68



42E12NE206 2.19069 VINCENT 200

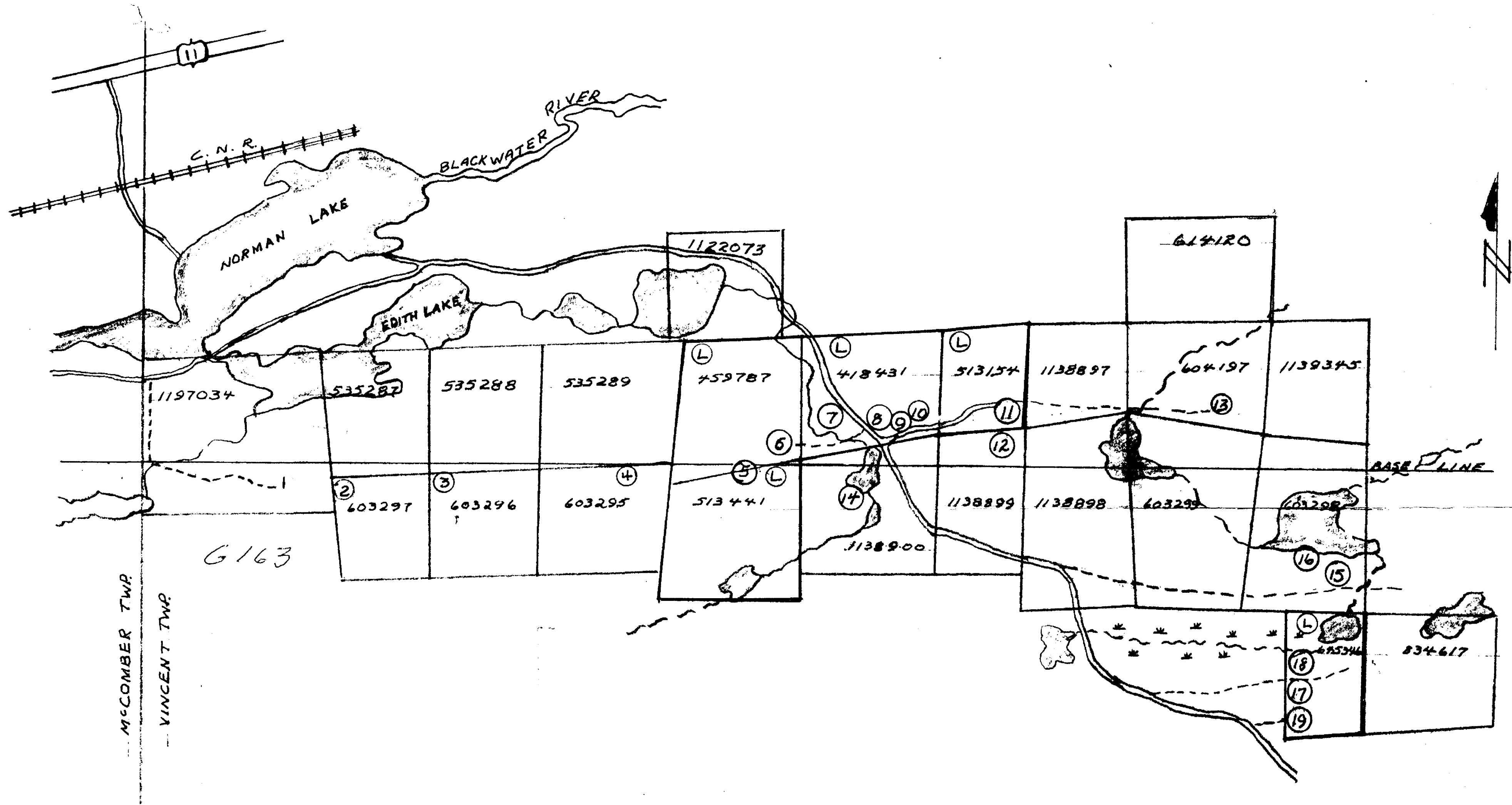

42E12NE2006 2.19069 VINCENT