

YEAR 2003 ASSESSMENT WORK REPORT  
ON THE MAKI CLAIM GROUP

2 . 2734 4

Our claim group consists of twenty-three (23) mineral claims, of which five (5) are leased, all in good standing and situated in Vincent Township (map G163) Thunder Bay Mining Division.

Our work for the 2003 prospecting program was mostly to keep the many showings clear of last winters debris and blown down trees as we fully expected two different mining companies to visit our claims for a personal examination of our showings with a possible option agreement on our claim group.

We were unable to go to some of our showings because of high water and beaver dams blocking our A.T.V. access.

This coming spring we will be contacting other mining companies on the merits of our showings (i.e. good assays, v.g., access, etc.) as the possible strike length, along with gold carrying veins extend from the Moosehorn area right thru easterly to the Discovery area, AM vein, Big Pit to the Line 11 east showing.

The Strawberry vein has been traced for over 1200 feet east with good panning in several spots. Noranda drilled one hole on the extreme west end with minor results across 12 - 15 feet. Surface sampling showed .15 oz. and .25 oz. au at same location.

We are confident a program of more back-hoe stripping, sampling followed by diamond drilling, although the past summer was more or less a waiting situation for mining companies to visit our property. We are confident the summer of 2004 will prove to be a summer of very encouraging results especially with an uptrend in gold prices.

Submitted by,



Neil R. Maki



42E12NE2020 2.27344 VINCENT

2 . 2734 4

Our claim group consists of twenty-three (23) mineral claims, of which five (5) are leased, all in good standing and situated in Vincent Township (Map G163) Thunder Bay Mining Division.

The Moosehorn Showing is readily reached by A.T.V. from Norman Lake. Line 20 and the KM Vein 100 and 150m east respectively are reached by a foot trail or by a skidder road continuing from the Moosehorn.

1) & 2) The Moosehorn Showing consists of locally folded quartz veining from narrow veinlets to 2m wide "bulges" carrying galena and chalcopyrite in iron stained quartz. The galena and chalcopyrite are indicators of gold values which range up to 76.0g. au and 200g. ag. The flow pattern appears to strike 10 degrees N of E and in my opinion ties in with Line 20 which has the same geological environment as the Moosehorn. A sample of grab across 2m on Line 20 assayed .40oz. au.

3) The KM Vein strikes as above and consists of an iron formation up to 2m wide and has been stripped and exposed for 200m east containing magnetite, arsenopyrite and minor chalcopyrite. The KM showing lines about 40m north of the furthest easterly exposed outcrops of Line 20. Assays of 5.9g to 14.89g au have been noted along the KM Vein.

4) Sandra's Showing is very much the same geological structure as the A.M. Vein with massive arsenopyrite along side quartz veining. Vg. was noted in two places. Assays range from .02 to .50 oz. au.

5) The A.M. Showing is an iron formation in places 4m+ wide consisting of banded arsenopyrite and magnetite. Assays range from .02 to .40 oz. au. Massive quartz veins with abundant arsenopyrite is prevalent in places alongside the iron formation and assays up to .16 oz. au. are noted. A X-Ray diamond drill hole in the forties located on the east end of the AM Vein intersected gold values as shown on accompanying map. Another hole 131 was reported by the drill owner and not published and intersected a 3m wide iron formation assaying .25 oz. au. and a similar quartz vein carrying visible gold alongside the iron formation.

6) Byron's Vein is an iron formation containing in places abundant arsenopyrite and magnetite with minor pyrite in mafic volcanics. Previous work in 1993-94 showed good gold values in surface sampling i.e. 23.667g au. Plan attached.

7) Rachel's Showing is an iron formation in volcanics exposing a 75m x 1.5m wide quartz carrying po. asp. and magnetite. A sample taken from an old trench (1940's) on west end showed 2.5 oz. au along strike. Samples

taken in 2000 and 2001 gave assays of 0.01 to 0.05 oz. au. Latest assay from east end showed 0.329 oz. au. over 2m.

8) Skidder Trench is a continuation of the AM, Rachel's Showing. Vg was noted in a 10" side o/c on south side of showing in sugary quartz. One drill hole by Eldor Resources showed .25 oz. au over 1m+.

9) Big Pit is also a continuation of AM, Rachel's Skidder Showings. This is an old trench (40's) and where we first noted plenty of vg. One drill hole by Eldor showed .08 oz. au over 1.5m.

10) Line 11 Showing is an iron formation with banded magnetite and quartz veining injected. In the east end of the exposed vein a 10' long trench has 6' of quartz veins and 4' of volcanics with minor sulphides and magnetite. Previous assays range from 0.14 to 0.34 oz. au.

11) Snowball Showing is a blocky type of iron formation in sediments with pyrite and magnetite. One sample taken gave an assay of .06 oz. au over 1m.

12) Strawberry Vein is an iron formation up to 6m wide in places carrying py and po in quartz. Surface samples on one section showed 0.13 and 0.20+ oz. au (1983). Noranda drilled one hole on the west end (1988) with minor values in gold (0.04g). A 20' sulphide showing 1200' west panned moderate gold.

13) The Key Claim is an irregular formation consisting of quartz stringers varying in width from 4" to 36" meandering in a banded sediment consisting mainly of cherty material alternating with volcanics. The zone is well beciated and small veinlets of later quartz run through it. Visible gold is found in the quartz veins and control panning along the vein shows from very fine to coarse gold. Ankerite has been injected with the quartz along with hornblende. One drill hole in 1983 on the west end showing gave .25 oz. au over 2'. Noranda drilling in 1988 failed to come up with gold values as the gold in the formation is erratic.

GOLD SHOWINGS

2 . 2734 A

- 1) Moosehorn Showing
- 2) Line 20 W
- 3) K.M. Vein
- 4) Sandra's Showing
- 5) A.M. Vein
- 6) Byron's Vein
- 7) Rachel's Showing
- 8) Skidder Trench
- 9) Big Pit
- 10) Line 11
- 11) Snowball Showing
- 12) Strawberry Vein
- 13) Key Claim

CLEAN UP WINTERS DEBRIS & BLOW DOWN

ALU MAKI JULY 8/03 1 DAY @ 150<sup>00</sup> DAY \* 150<sup>00</sup>  
NEIL MAKI - 44Y 8/03 1 DAY @ 150<sup>00</sup> DAY \* 150<sup>00</sup>  
SANDRA MOORE - 44Y 8/03 1 DAY @ 150<sup>00</sup> DAY \* 150<sup>00</sup>

TOTAL MAN DAYS @ 150<sup>00</sup> DAY \* 450<sup>00</sup>

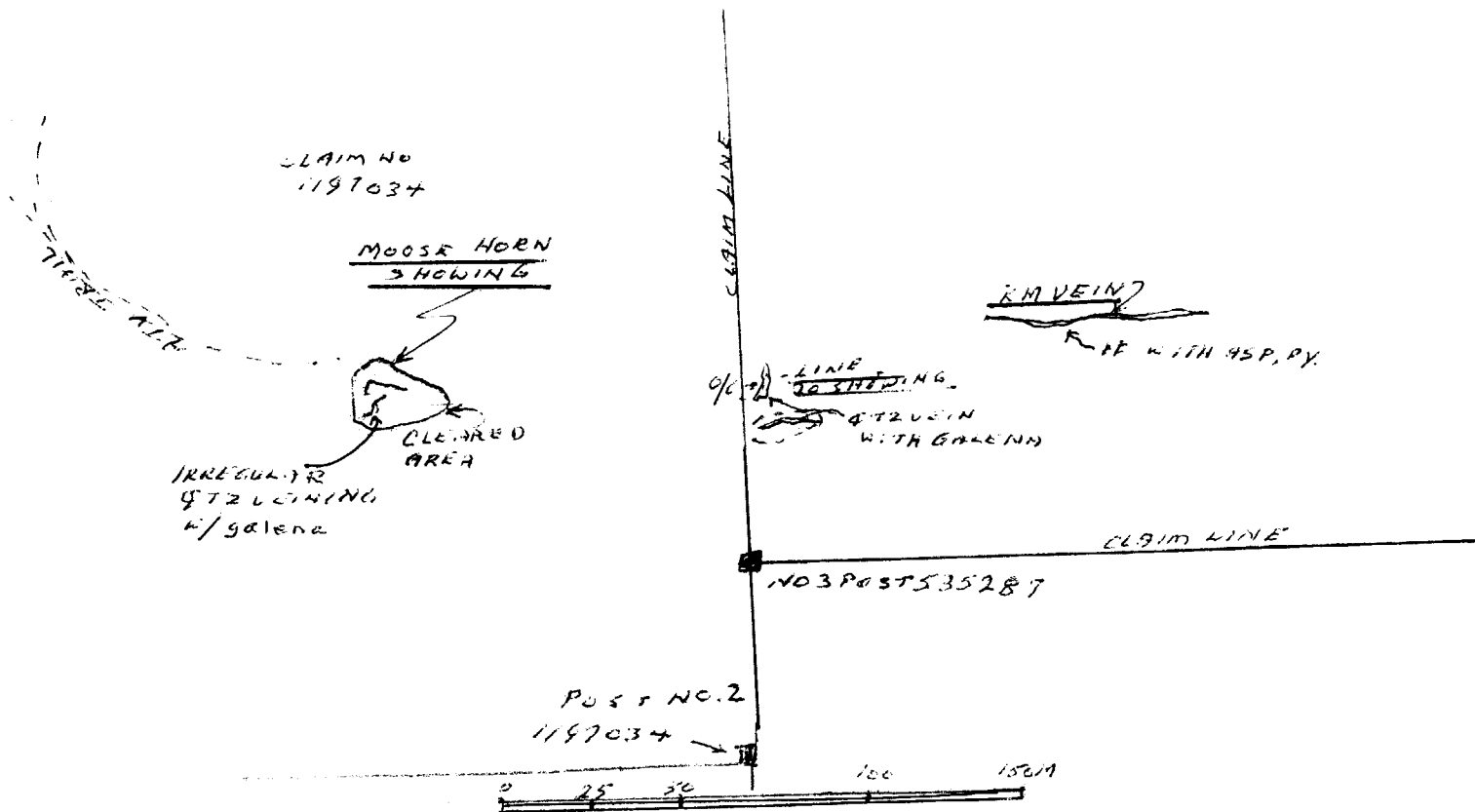

AM VEIN  
SANDRAS SHOWING

CLEAN UP WINTERS DEBRIS & BLOW DOWNS IN TRENCH  
BREAK UP & COLLECT VEIN MATERIAL FOR  
CRUSHING & PROCESSING

MIAMI JULY 6/03 - 1 DAY @ 150.00 = 150.00

NEIL MAKI JULY 6/03 - 1 DAY @ 150.00 = 150.00

SANDRA MOORE JULY 6/03 - 1 DAY @ 150.00 = 150.00

TOTAL 3 MAN DAYS @ 150.00 = 450.00

CLAIM NO  
418431

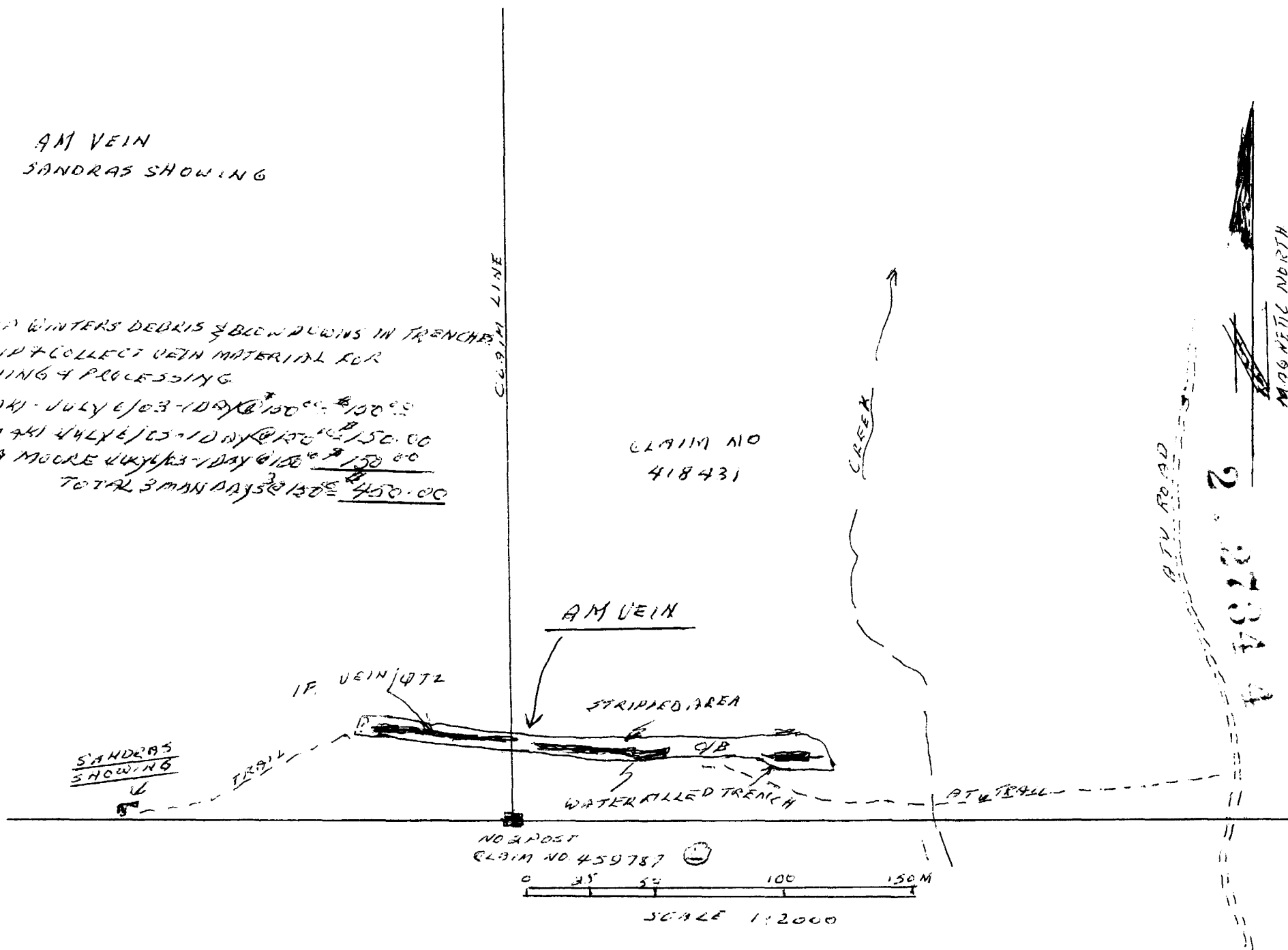

CLEAN UP TRENCHES OF WINTER'S  
DEBRIS AND BLOW DOWNS

RILI MAKI - JULY 21/03 - 1 DAY @ \$150<sup>00</sup> DAY — \$150<sup>00</sup>  
NEIL MAKI - JULY 21/03 - 1 DAY @ \$150<sup>00</sup> DAY — \$150<sup>00</sup>  
SANDRA MOORE - JULY 21/03 - 1 DAY @ \$150<sup>00</sup> DAY — \$150<sup>00</sup>  
TOTAL MANHOURS - 3 @ \$150<sup>00</sup> DAY \$450<sup>00</sup>

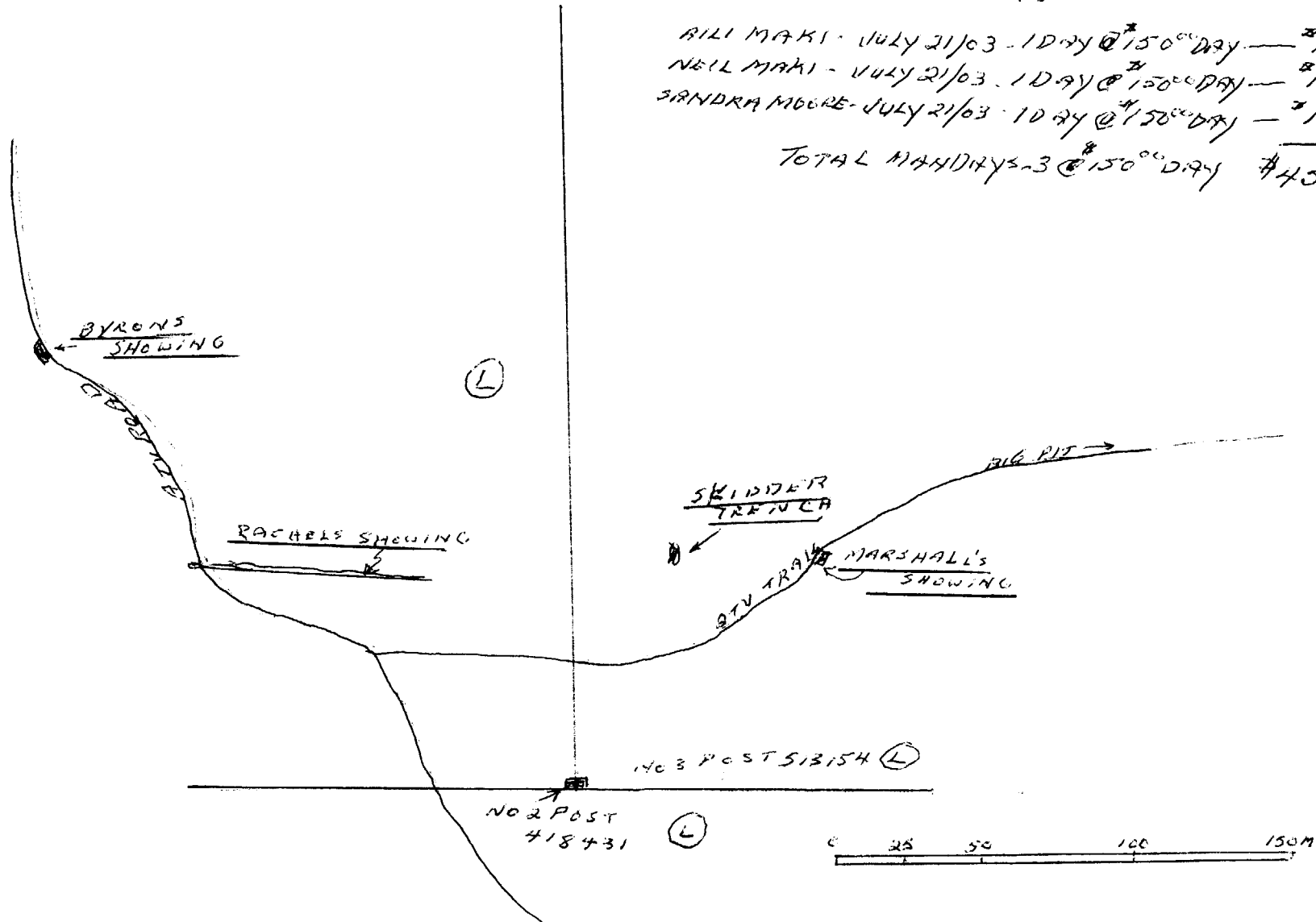

MAGNETIC NORTH

NO. 1 POST  
5131546



2.27344

BYRENS VEIN EXTENSION  
BIG PIT & EXTENSION

CLEAN UP WINTERS DEBRIS & BLOW DOWNS  
AILI MAKI - JULY 7/03 1 DAY @ \$150/DAY = \$150.00  
NEIL MAKI - JULY 7/03 1 DAY @ \$150/DAY = \$150.00  
SANDRA MOORE - JULY 7/03 1 DAY @ \$150/DAY = \$150.00

3 MAN DAYS @ \$150/DAY \$450.00

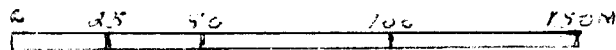
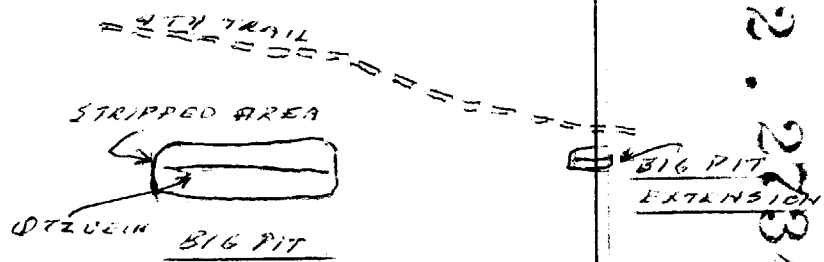
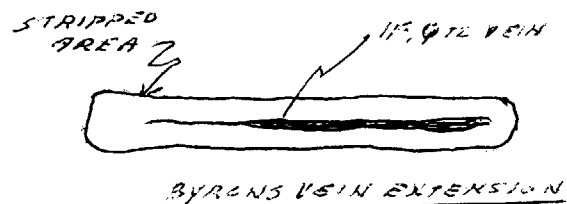

SCALE 1:2000



CLEAN UP WINTERS DEBRIS & BLOW DOWNS  
FROM SHORING

AILI MAKI JULY 23/03 1 DAY @ 150<sup>00</sup> \$ 150.00  
NEIL MAKI JULY 23/03 1 DAY @ 150<sup>00</sup> \$ 150.00  
JANDRA MOORE JULY 23-1 DAY @ 150<sup>00</sup> \$ 150.00

TOTAL MAN DAYS - 3 @ 150<sup>00</sup> DAY \$ 450.00

LINE 11 SHORING

IF IN GREENSTONE

MAGNETIC NORTH

NO 2 POST 401197



SCALE 1:7000

2. 2734 4

CLEAN UP WINTERS DEBRIS AND BLEND-DOWNS  
FROM TRENCHES.

ALI MAKI - JULY 22/03 - 1 DAY @ \$150<sup>00</sup> DAY = \$150<sup>00</sup>  
NEIL MAKI - JULY 22/03 - 1 DAY @ \$150<sup>00</sup> DAY = \$150<sup>00</sup>  
SANDRAMORE JULY 22/03 - 1 DAY @ \$100<sup>00</sup> DAY = \$100<sup>00</sup>

TOTAL MAN DAYS - 3 @ \$150<sup>00</sup> DAY = \$450.00

STRAWBERRY VEIN

SNOWBALL VEIN

KEY CLAIM SHOWING.

NO 3 POST  
645346 (L)



SCALE 1 - 2000

MAGNETIC NORTH.



Date: 2004-MAR-18

GEOSCIENCE ASSESSMENT OFFICE  
933 RAMSEY LAKE ROAD, 6th FLOOR  
SUDBURY, ONTARIO  
P3E 6B5

NEIL R. MAKI  
R.R. #14  
THUNDER BAY, ONTARIO  
P7B 5E5 CANADA

Tel: (888) 415-9845  
Fax: (877) 670-1555

**Submission Number:** 2.27344  
**Transaction Number(s):** W0440.00412

Dear Sir or Madam

**Subject: Approval of Assessment Work**

We have approved your Assessment Work Submission with the above noted Transaction Number(s). The attached Work Report Summary indicates the results of the approval.

At the discretion of the Ministry, the assessment work performed on the mining lands noted in this work report may be subject to inspection and/or investigation at any time.

If you have any question regarding this correspondence, please contact STEVEN BENETEAU by email at [steve.beneteau@ndm.gov.on.ca](mailto:steve.beneteau@ndm.gov.on.ca) or by phone at (705) 670-5855.

Yours Sincerely,



Ron C. Gashinski  
Senior Manager, Mining Lands Section

**Cc:** Resident Geologist

Neil R. Maki  
(Claim Holder)

Assessment File Library

Neil R. Maki  
(Assessment Office)

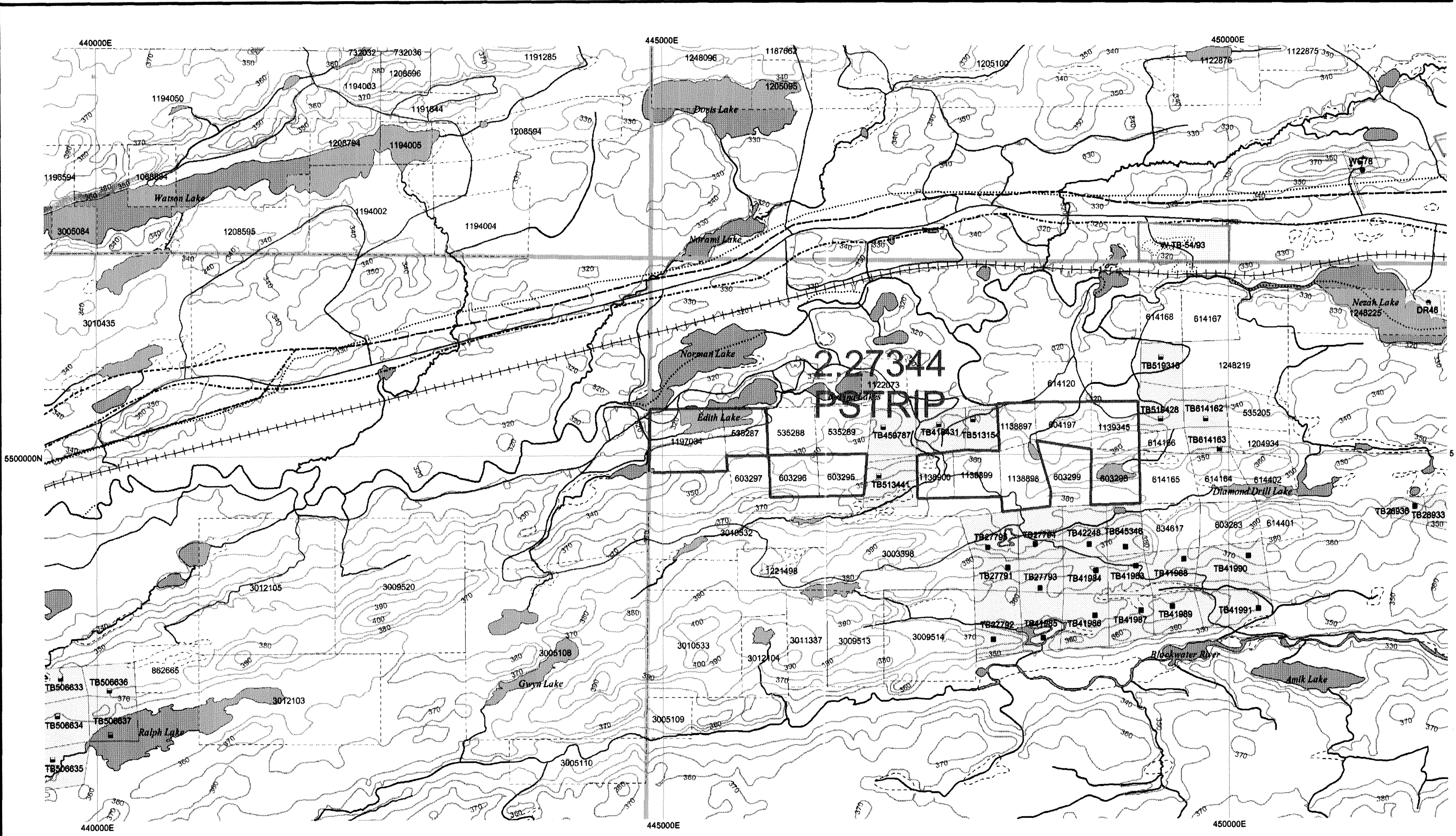

UTM Zone 16  
5000m grid



42E12NE2020 2.27344 VINCENT

