

63.3253



42E12NW0097 63.3253 IRWIN

010

FINAL REPORT  
EXPLORATION ASSISTANCE CONTRACT GB - 50  
IRWIN TOWNSHIP  
LYNX-CANADA EXPLORATIONS LIMITED

Toronto, Ontario  
February, 1975

M. I. Watson, P. Eng.

ONTARIO GOVERNMENT BUILDING  
RESIDENT GEOLOGISTS OFFICE  
MINISTRY OF NORTHERN DEVELOPMENT & MINES  
P.O. BOX 5000  
THUNDER BAY, ONTARIO P7C 5G6

63.3253

## I N T R O D U C T I O N

This report describes briefly the work carried out by Lynx-Canada Explorations Limited during the 1974 field season on the property optioned from Brookbank-Sturgeon Mines Limited in the Beardmore area of Northwestern Ontario.

## Table of Contents

Introduction	
Location	Page 1
Access	Page 1
History	Page 1
Geology - General	Page 1
Geology - Economic	Page 2
Work Program - 1974	Page 2
Results and Conclusions	Page 3
Recommendations	Page 3

### Location

The property is located in Irwin Township in the Beardmore area of Northwestern Ontario.

It consists of 18 patented mining claims, numbers TB 29025 - TB 29042 inclusive.

### Access

An all weather gravel road starts at a point on Highway 11 approximately 10 miles east of Beardmore and extends northward  $7\frac{1}{2}$  miles to the property.

The Canadian National Railway, and electric power lines are at Highway 11.

### History

Gold was found by Len Brookbank in 1934 and staked for Connell Exploration. Considerable rock trenching and a few short holes were drilled that year. Values proved erratic, though some lenses of ore grade were indicated.

In 1944, Noranda Mines Limited drilled 40 diamond drill holes for a total footage of 6094 feet. This drilling covered a 2500' length on No. 1 zone crossing claim 29038 and was confined to a shallow depth.

Nothing had been done on the property since, until Lynx-Canada optioned it in June, 1974.

### Geology - General

The property is in a belt of volcanic and sedimentary rocks extending from Long Lac to Lake Nipigon, a distance of 70 miles.

The claims lie in a  $\frac{3}{4}$  mile wide volcanic band between Point Lake and the Windikogan sedimentary bands. The northern claims are underlain by the Point Lake sediments, and the southern part of the property is underlain by intermediate to basic Keewatin lavas of fine to coarse grained composition.

....page 2....

The contact between the sediments and lavas enters the property from the west with a strike of N70°E and continues on this bearing for approximately 5700 feet to the southeast corner of Claim 29027 where it swings sharply to the south and strikes S70°E for 4500 feet to the east boundary.

The northeast trending section of the contact is heavily sheared and carbonated and carries considerable reddish silicification and pyrite mineralization.

#### Geology - Economic

The Noranda drilling investigated the sheared and altered contact area for a length of 2500 feet across Claims 29038 and adjoining points of 29037 and 29039 known as the No. 1 zone. This work together with surface trenching showed numerous gold values, associated with pyrite mineralization and reddish silification.

#### Work Program - 1974

Prospecting by Lynx-Canada prospectors David Thorsteinson and Nolan Cox discovered a gold bearing brecciated siliceous iron formation on Claim 29030. This zone is about 1200 feet east of the east end of the No. 1 original Brookbank zone. Gold was also found in numerous other areas further east, close to the sediment volcanic contact.

2. A bulldozer was engaged to strip as much as possible of the favourable contact zone.
3. Linecutting was done over a strike length of one mile of the favourable contact area.
4. A magnetometer survey was completed over the contact area
5. Geological mapping was carried out over the grid.
6. Diamond Drilling.

A Winkie diamond drill was used to sample the area of interest. Six holes were drilled before freeze up.

Results and Conclusions

Prospecting and stripping has resulted in the discovery of new gold bearing zones in a reddish silicified brecciated iron formation close to the volcanic sedimentary contact but within the volcanics.

The magnetometer survey has shown that the favourable zones are magnetic and future prospecting can use this as a guide.

Three holes, BW - 1, BW - 2, and BW - 6, intersected ore grade sections over significant widths.

Recommendations

It is recommended that a large drill be brought in to explore the area between BW - 1 and BW - 6. Holes should be drilled at 50 foot intervals and a minimum 2000 foot contract should be let.

Future prospecting on the claim group should be concentrated along the volcanic sedimentary contact.

Respectfully submitted,

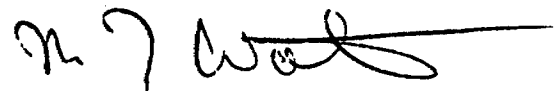

---

M. I. Watson, P. Eng.

# LYNX CANADA EX. (OLD BROOKBANK CLAIMS)

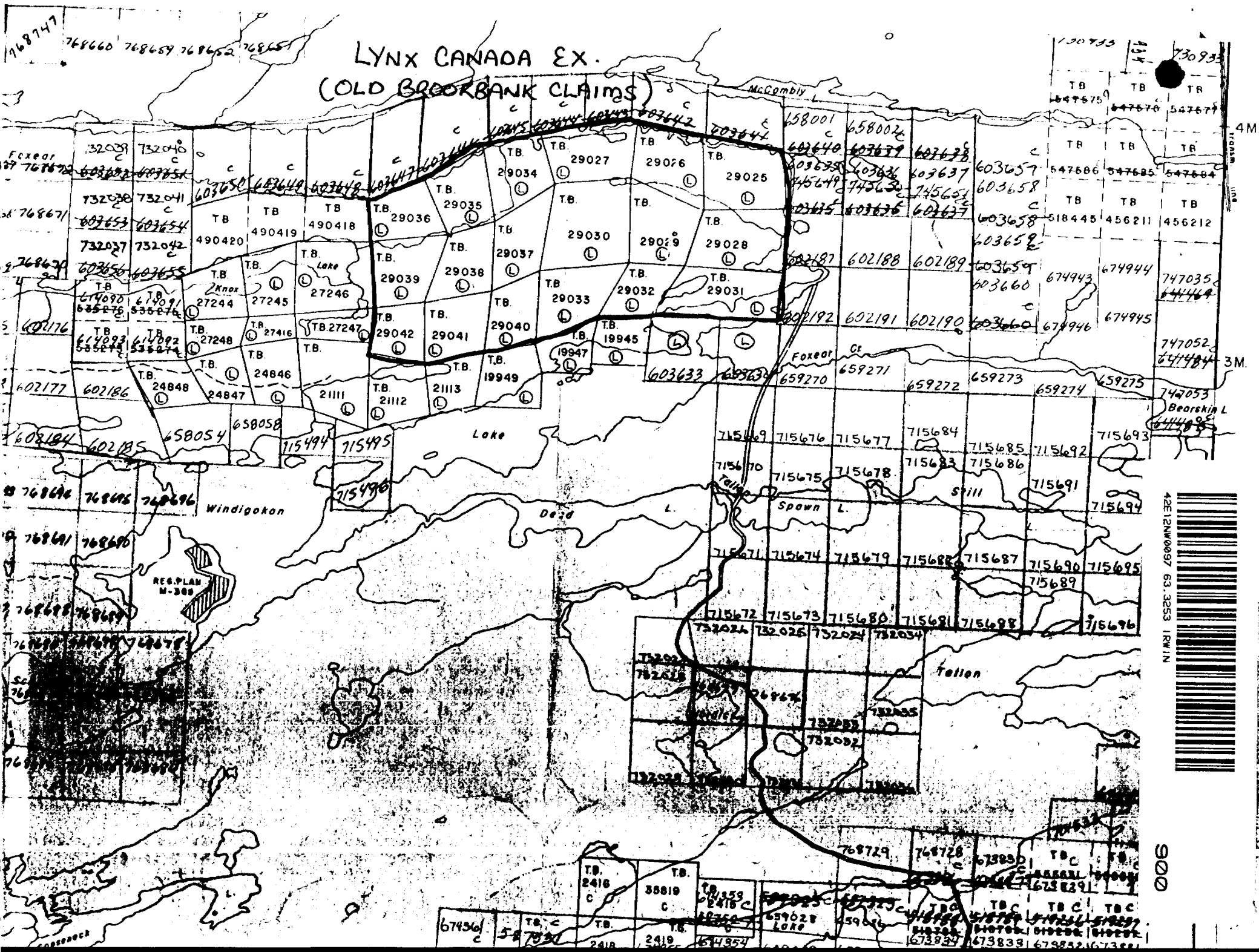

900







LYNX - CANADA EXPL. LTD.

BROOKBANK PROPERTY

MAGNETOMETER SURVEY

DATE 8/11/74  
63-323

SCALE 1" = 100'

SURVEY BY M. I. WATSON  
V. G. PARENTZIAN

DRAWN BY V. G. PARENTZIAN

ONTARIO GOVERNMENT BUILDING  
RESOURCES DEVELOPMENT DIVISION  
MINISTRY OF NATURAL RESOURCES & FORESTRY  
THUNDERBAY, ONTARIO L7R 6P6

LEGEND

- DDH
- AREA UNCOVERED BY BULLDOZER
- OLD PIT / TRENCH
- 55 GAMMAS

N. MAG.