



42E12NW2011 2.20416

McCOMBER

010

PROSPECTING REPORT

On the

SKALESKY PROPERTY
(claim # TB862665)

McCOMBER TOWNSHIP
42 E 12/NW

June 25, 2000

Daniel G Courtney BSc

9 20416

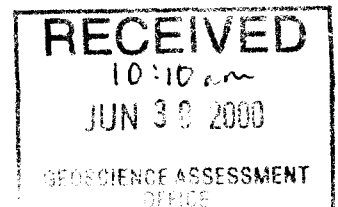

INTRODUCTION

At the request of the property owners, two days were spent prospecting claim TB862665 in McComber township, by myself and prospector George Daniels. This work was done on May 24 and May 25, 2000. The property covers the gold showings historically known as the Kondrat zone. The Skalesky property is in NTS block 42e 12/NW at approx. 87° 45' 55" longitude and 49° 34' 55". The property is located 12 kilometers northeast of Beardmore in Northern Ontario, and is accessed via the old Jackpine siding of the C.N.R. A bridge crosses the Blackwater river and old logging roads continue south to an abandoned logging camp on a small pond. From there the claim was accessed by foot approximately 600m south of this logging site across one swamp and one steep ridge. One day was spent prospecting the southern third of the claim, and one day on the northern third of the claim in an attempt to discover any parallel zones -as is suggested in the south by previous geophysical VLF-EM and magnetometer surveys.

RESULTS

As can be seen in the accompanying sketch, no outcrop was discovered in the southern third of the claim, as this area is mostly covered with swamp and low ground. Diamond drilling is recommended to test this geophysical target. In the northern third of the claim, two main rock types predominate:

- 1 – mafic metavolcanics which are dark green fine grained, and typically foliated with a 65 degree trend that parallels the known showings and iron formation in the center of the claim. This foliation ranges from weak to very strong and dips very steeply south. With the foliation is associated chlorite alteration which ranges from weak to very strong. Locally fracture related carbonate and weak pyrite mineralization was encountered. Also locally in the more massive outcrops pillowed flows were observed with bleached cores.
- 2 – Greywacke with minor intercalated argillite. This material is fine to medium grained, and is typically crudely bedded with a similar 65 degree trend and steeply dipping. Nothing of economic interest was discovered at this point, however stripping of more outcrop is recommended given the local intensity of chlorite alteration.

CERTIFICATE OF QUALIFICATIONS

I, Daniel G Courtney do hereby certify that I:

-reside at RR# 1 Kaministiquia Ont., P0T 1X0

-have been active in mineral exploration since 1984

-am a graduate with a BSc geology degree from Lakehead University

-I have not received, directly or indirectly, or expect to receive any interest in the company and its properties.

Signature: Dan Courtney

Name: Daniel G. Courtney

Date June 27, 2000

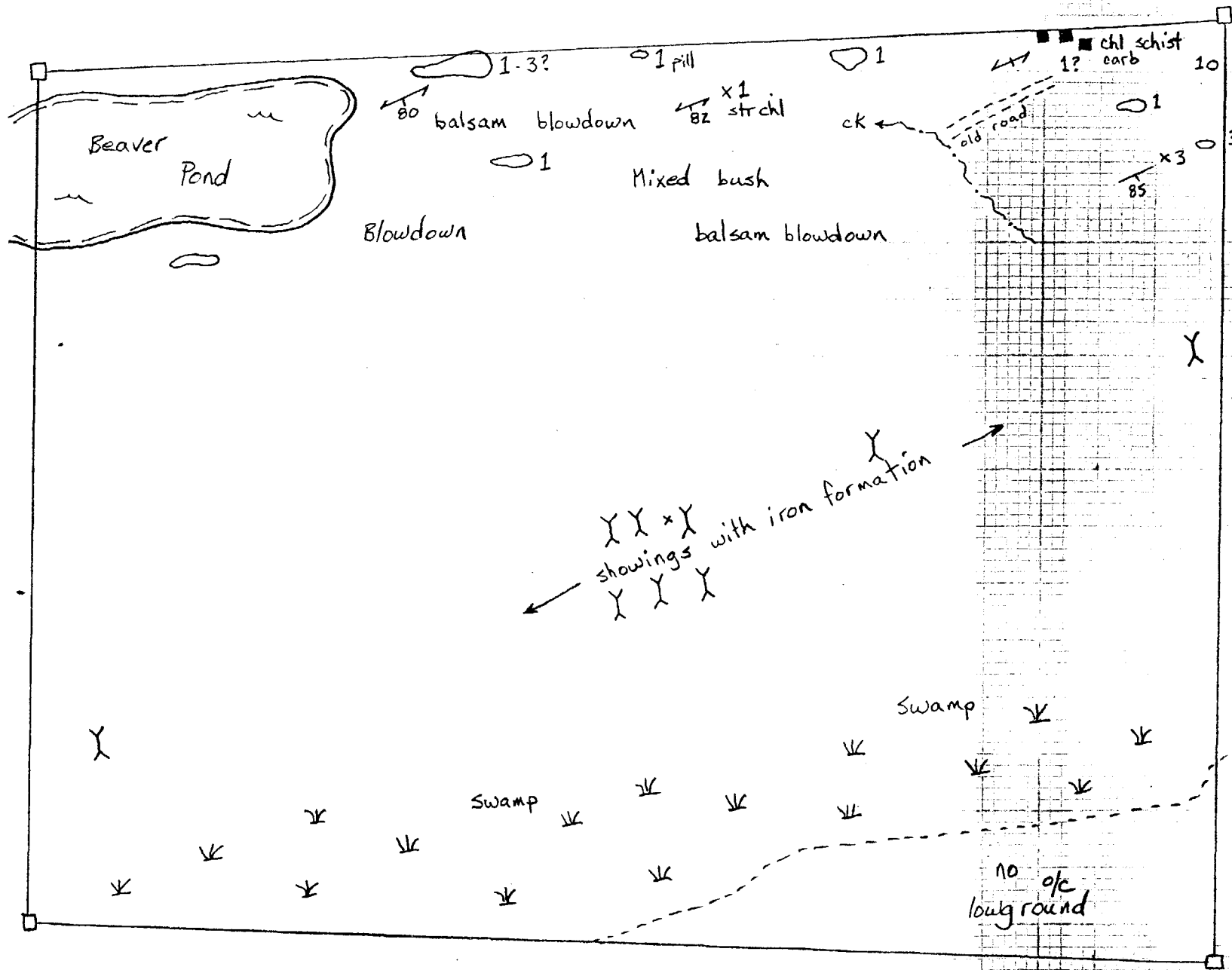

- 1: Mafic metavolcanic
 - dk green, fgr
 - wk → str chlorite
 - +/- fracture related
 - foliated carbonate
 - locally pillowed
- 3: Metasediments
 - bedded/laminated
 - Grey wacke
 - +/- argillite

- ↔ foliation
- + bedding
- Y trench
- pit
- ∇ swamp

0 25 50 100 meters
1:2500

D.G. Courtney
May, 2000

Declaration of Assessment Work Performed on Mining Land

Mining Act, Subsection 65(2) and 66(3), R.S.O. 1990

Transaction Number (office use) 00040.00192 Assessment Files Research Imaging



42E12NW2011 2.20416 McCOMBER 900

ions 65(2) and 66(3) of the Mining Act. Under section 8 of the assessment work and correspond with the mining land holder. Ministry of Northern Development and Mines, 6th Floor,

Thunder Bay Mining Division 3:15pm JUN 27 2000

RECEIVED

- uctions: - For work performed on Crown Lands before recording a claim, use form 0240. - Please type or print in ink.

Recorded holder(s) (Attach a list if necessary)

Client Number 194862 Telephone Number 807-622-0991 EA 2210 Walnut St. Thunder Bay

2.20416

Type of work performed: Check (✓) and report on only ONE of the following groups for this declaration.

- Geotechnical: prospecting, surveys, assays and work under section 18 (regs) [checked] Physical: drilling, stripping, trenching and associated assays [checked] Rehabilitation [unchecked]

Type Prospecting Office Use Commodity Gold Total \$ Value of Work Claimed 873.00 Work performed From 24/05/2000 To 25/06/2000 NTS Reference 42 E 12/Nw1

- ase remember to: - obtain a work permit from the Ministry of Natural Resources as required; - provide proper notice to surface rights holders before starting work; - complete and attach a Statement of Costs, form 0212; - provide a map showing contiguous mining lands that are linked for assigning work; - include two copies of your technical report.

Person or companies who prepared the technical report (Attach a list if necessary)

Daniel Courtney Telephone Number 807-933-0013 RR#1 Kaminstiquia Ontario George Daniels Telephone Number 807-825-9097 Terrace Bay

RECEIVED 10:10am JUN 29 2000 GEOSCIENCE ASSESSMENT OFFICE

Certification by Recorded Holder or Agent

Daniel Courtney (Print Name), do hereby certify that I have personal knowledge of the facts set forth in this Declaration of Assessment Work having caused the work to be performed or witnessed the same during and after its completion and, to the best of my knowledge, the annexed report is true.

Signature of Recorded Holder or Agent Dan Courtney Date June 27, 2000 Address RR#1 Kaminstiquia Telephone Number 807-933-0013

5. Work to be recorded and distributed. Work can only be assigned to claims that are contiguous (adjoining) to the mining land where work was performed, at the time work was performed. A map showing the contiguous link must accompany this form.

eg	Mining Claim Number. Or if work was done on other eligible mining land, show in this column the location number indicated on the claim map.	Number of Claim Units. For other mining land, list hectares.	Value of work performed on this claim or other mining land.	Value of work applied to this claim.	Value of work assigned to other mining claims.	Bank. Value of work to be distributed at a future date.
eg	TB 7827	16 ha	\$26, 825	N/A	\$24,000	\$2,825
eg	1234567	12	0	\$24,000	0	0
eg	1234568	2	\$ 8, 892	\$ 4,000	0	\$4,892
1	TB 862665	1	\$ 873	\$ 873		
2						
3						
4						
5						
6						2.20416
7						
8						
9						
10						
11						
12						
13						
14						
15						
Column Totals						

RECEIVED
 10:10am
 JUN 30 2000
 GEOSCIENCE ASSESSMENT
 OFFICE

I, Daniel Courtney (Print Full Name), do hereby certify that the above work credits are eligible under subsection 7 (1) of the Assessment Work Regulation 6/96 for assignment to contiguous claims or for application to the claim where the work was done.

Signature of Recorded Holder or Agent Authorized in Writing: Dan Courtney Date: June 27, 2000

6. Instructions for cutting back credits that are not approved.

Some of the credits claimed in this declaration may be cut back. Please check (✓) in the boxes below to show how you wish to prioritize the deletion of credits:

- 1. Credits are to be cut back from the Bank first, followed by option 2 or 3 or 4 as indicated.
- 2. Credits are to be cut back starting with the claims listed last, working backwards; or
- 3. Credits are to be cut back equally over all claims listed in this declaration; or
- 4. Credits are to be cut back as prioritized on the attached appendix or as follows (describe):

Note: If you have not indicated how your credits are to be deleted, credits will be cut back from the Bank first, followed by option number 2 if necessary.

For Office Use Only

Received Stamp Thunder Bay Mining Division JUN 27 2000 RECEIVED	Deemed Approved Date	Date Notification Sent
	Date Approved	Total Value of Credit Approved
	Approved for Recording by Mining Recorder (Signature)	

Geoscience Assessment Office
933 Ramsey Lake Road
6th Floor
Sudbury, Ontario
P3E 6B5

Telephone: (888) 415-9845
Fax: (877) 670-1555

August 11, 2000

ANN SKALESKY
30-1741 EAST MOODIE ST.
THUNDER BAY, Ontario
P7E-4Z1

Visit our website at:
www.gov.on.ca/MNDM/MINES/LANDS/mlsmnpge.htm

Dear Sir or Madam:

Submission Number: 2.20416

Status

Subject: Transaction Number(s): W0040.00192 Approval

We have reviewed your Assessment Work submission with the above noted Transaction Number(s). The attached summary page(s) indicate the results of the review. **WE RECOMMEND YOU READ THIS SUMMARY FOR THE DETAILS PERTAINING TO YOUR ASSESSMENT WORK.**

If the status for a transaction is a 45 Day Notice, the summary will outline the reasons for the notice, and any steps you can take to remedy deficiencies. The 90-day deemed approval provision, subsection 6(7) of the Assessment Work Regulation, will no longer be in effect for assessment work which has received a 45 Day Notice. Allowable changes to your credit distribution can be made by contacting the Geoscience Assessment Office within this 45 Day period, otherwise assessment credit will be cut back and distributed as outlined in Section #6 of the Declaration of Assessment work form.

Please note any revisions must be submitted in DUPLICATE to the Geoscience Assessment Office, by the response date on the summary.

If you have any questions regarding this correspondence, please contact JIM MCAULEY by e-mail at james.mcauley@ndm.gov.on.ca or by telephone at (705) 670-5880.

Yours sincerely,

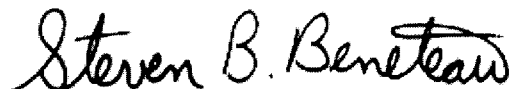

ORIGINAL SIGNED BY
Steve B. Beneteau
Acting Supervisor, Geoscience Assessment Office
Mining Lands Section

Work Report Assessment Results

Submission Number: 2.20416

Date Correspondence Sent: August 11, 2000

Assessor: JIM MCAULEY

General Comment:

Please note, in subsequent submissions of this kind, please include traverse lines on the prospecting map.

Transaction Number	First Claim Number	Township(s) / Area(s)	Status	Approval Date
W0040.00192	862665	MCCOMBER	Approval	August 11, 2000

Section:

9 Prospecting PROSP

At the discretion of the Ministry, the assessment work performed on the mining lands noted in this work report may be subject to inspection and/or investigation at any time.

Correspondence to:

Resident Geologist
Thunder Bay, ON

Recorded Holder(s) and/or Agent(s):

Daniel Courtney
KAMINISTQUIA, ONTARIO, CANADA

Assessment Files Library
Sudbury, ON

ANN SKALESKY
THUNDER BAY, Ontario

IRWIN TWP G-164

TOWNSHIP
McCOMBER
 M.N.R. ADMINISTRATIVE DISTRICT
NIPIGON
 MINING DIVISION
THUNDER BAY
 LAND TITLES / REGISTRY DIVISION
THUNDER BAY

SUMMER RESORT LOCATIONS NOT OPEN FOR STAGING
 RI SEC.36/80 W.29/83 20/10/83 S.R.O. FILE 188828
 See Gathering Lake Landroll

THE INFORMATION THAT APPEARS ON THIS MAP HAS BEEN COMPILED FROM VARIOUS SOURCES, AND ACCURACY IS NOT GUARANTEED. THOSE WISHING TO STAKE MINING CLAIMS SHOULD CONSULT WITH THE MINING RECORDER, MINISTRY OF NORTHERN DEVELOPMENT AND MINES, FOR ADDITIONAL INFORMATION ON THE STATUS OF THE LANDS SHOWN HEREON.
 INTO SERVICE NOV. 22/88

LEGEND

FATENTED LAND	OR	
FATENTED FOR SURFACE RIGHTS ONLY	OR	
LEASE	M.R.O.	S.R.O./M.R.O.
LICENSE OF OCCUPATION		L.O.
CROWN LAND SALES		C.S.
LOCAL TD LAND		Loc.
CANCELLED	OR	C.
MINING RIGHTS ONLY		M.R.C.
SURFACE RIGHTS ONLY		S.R.O.
HIGHWAY & ROUTE NO.		
ROADS		
TRAILS		
RAILWAYS		
POWER LINES		
MARSH OR MUCKED		
MINES		
LAND USE PERMITS FOR COMMERCIAL TOURISM, OUTPOST CAMPS		
*used only with summer resort locations or when space is limited		

SURFACE RIGHTS LYING WITHIN 40' OF THE CENTER LINE OF THE TRANS CANAL ARE...
 DE WAY ARE WITHIN 100' FROM STATION...
 EXPECTING SALE OR LEASE BY ORDER OF...
 DATED SEPT 20 1988 SECTION 31 MINING...
 ENERGY ACT APPLIES TO THIS AREA

SCALE: 1 INCH = 40 CHAINS

FEET 0 1000 2000 4000 6000 8000
 METRES 0 200 1000 2000 (1 KM) (2 KM)

 Ministry of Natural Resources
 Land Management Branch

Date FEBRUARY 10th, 1981
 Number **G-166**

SUMMERS TWP G-165

VINCENT TWP G-163

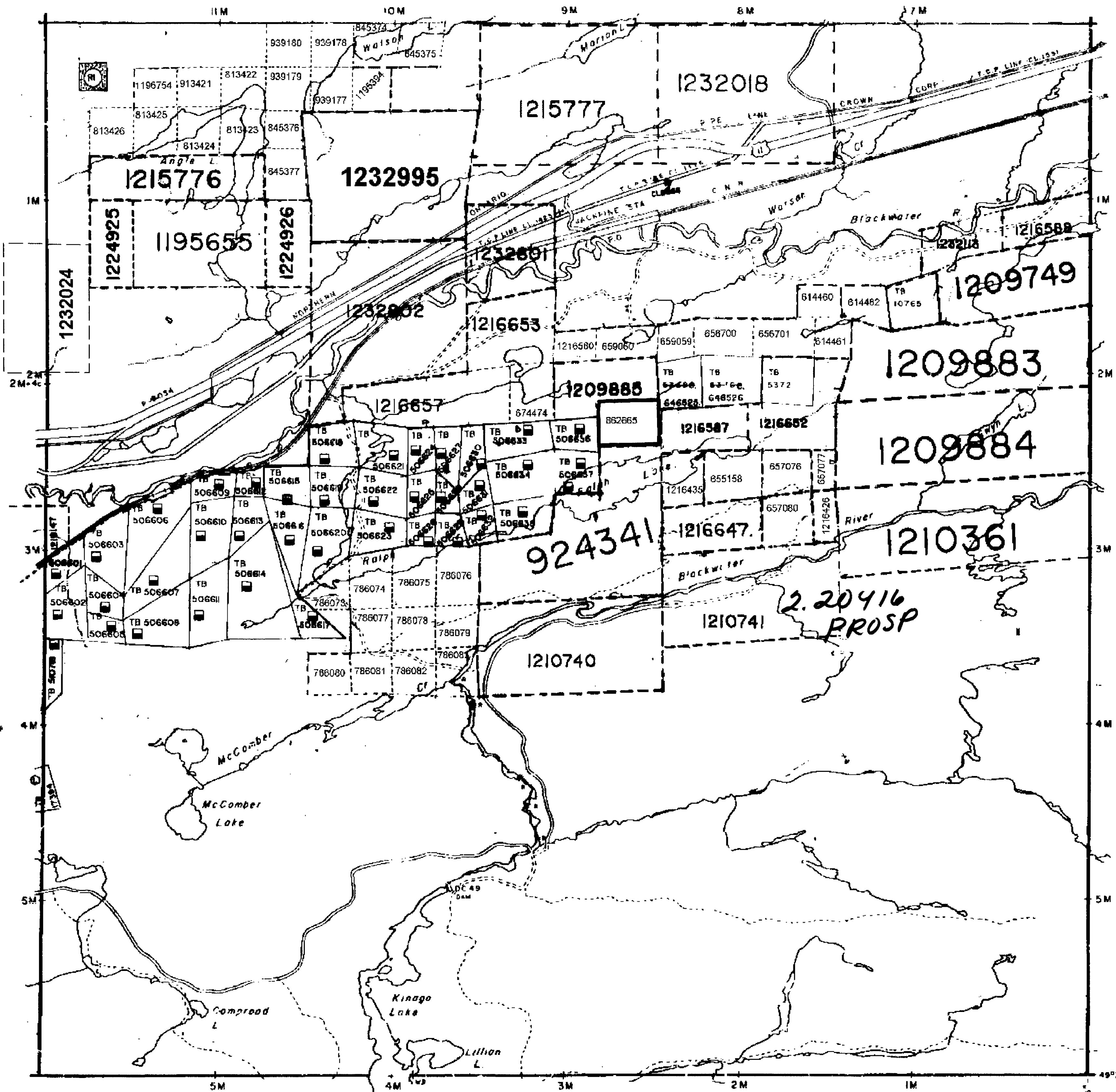

BEARDMORE AREA G-7

