



ACCURASSAY LABORATORIES

ENVIRONMENTAL, CHEMISTRY, METALS, MINERAL ASSAYING
Box 223, Ingersoll, Ont. Canada P2N 3J1
Tel: (519) 867-4444 Fax: (519) 868-8342



42E12SW0002 2.15926 SUMMERS

010

31926

FILE HOLT
Box 223
Seardmore, Ontario
POT 1G0

2.15926

DATE	August 22, 1994
CUSTOMER ORDER No	
WORK ORDER No	Job# 944758
DATE SUBMITTED	

Net 30 days, 1.5% per month on overdue accounts

QUANTITY	DESCRIPTION	PRICE	AMOUNT
5	Sample Prep	\$4.25	\$21.25
5	Gold	\$8.95	\$44.75
1	Report Charge	\$5.00	\$5.00

Subtotal \$71.00
 7% G.S.T. #R100294768 \$4.97
 Amount Due Before September 23, 1994 \$75.97

Thank You!

TPC-5474

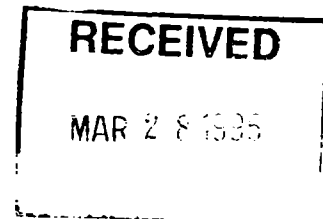

I. F.

Plogger Trench.

Sample Location.

Scale.

5 cm = 1 m.

163 m. N.

134 m. E.

of post # 3

of Claim #

406090

203306
Plogger Trench

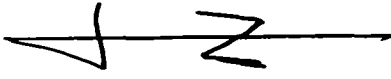
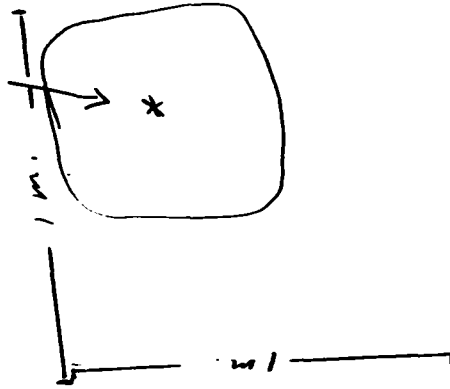

2 . 159 2 6

RECEIVED
 MAR 28 1995
 MINING LANDS BRANCH

Sample Location.

Seale
I.F.
Old French
115 m. N.
+
34 m. W.
of Post # 2
Claim # 406091

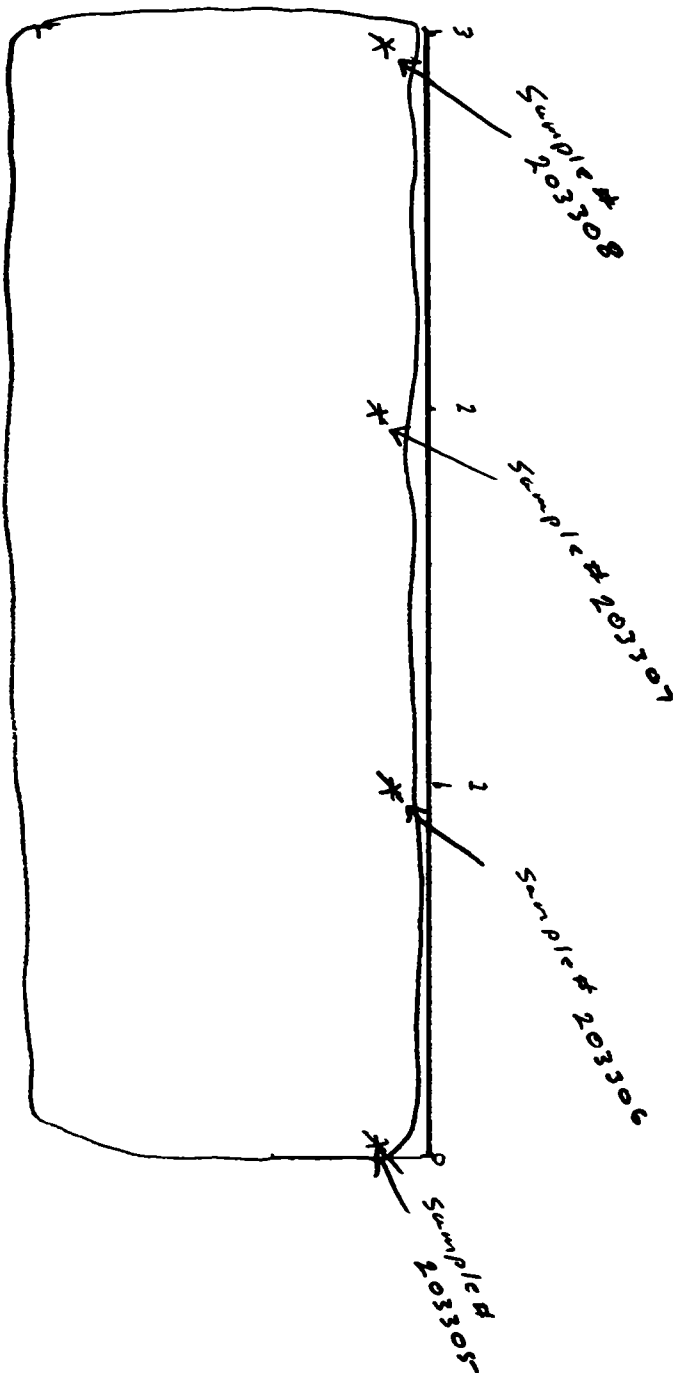

2 . 15926

RECEIVED
MAR 28 1995

(27)



Ontario

Ministry of
Northern Development
and Mines

Ministère du
Développement du Nord
et des Mines

2 . 15926

August 22, 1994

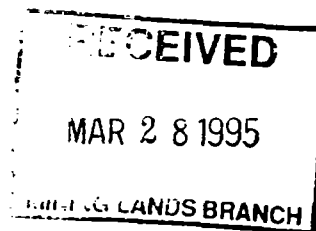

Mr. Lyle Holt
P.O. Box 223
Beardmore, Ontario
P0T 1G0

Dear Lyle:

The following are gold and base metal results for nine samples that we received from you in June and July of this year.

<u>Sample No.</u>	<u>Au</u> <u>(oz/ton)</u>	<u>Cu</u> <u>(PPM)</u>	<u>Mo</u> <u>(PPM)</u>	<u>Zn</u> <u>(PPM)</u>	
94-MLH-7 (No. 203243)	<0.01	29.83	<6	260.6	McCambly
94-MLH-15 (No. 203306)	<0.01	--	--	--	-- Summers old tr. 7 meter from S. end.
94-MLH-16 (No. 203307)	<0.01	--	--	--	-- Summers old tr. 2 meters fr. S. end.
94-MLH-17 (No. 203309)	<0.01	--	--	--	-- Summers plussor tr 50 m west of main showings.
94-MLH-18 (No. 203312)	.19 (Check -.23)	--	--	--	-- Summers Main showings. 16 m. W.
94-MLH-19 (No. 203314)	<0.01 (.009)	--	--	--	-- Augmitto
94-MLH-20 (No. 203315)	<0.01	999.7 (1%)	--	--	-- Augmitto

.../2

(28)

-2-

94-MLH-21 (No. 203316)	.04	14,190 (1.4%)	--	--	<i>Ausmitto</i>
94-MLH-22 (No. 203317)	.58	11,190 (1.1%)	--	--	<i>Ausmitto</i>

Sincerely,

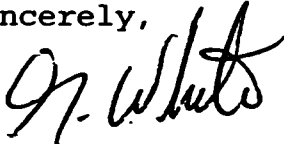

Gerry White
Staff Geologist
Beardmore-Geraldton District
Mines and Minerals Division
Ministry of Northern Development and Mines
Suite B002, 435 S. James Street
Thunder Bay, ON P7E 6E3
Tel. (807)475-1331

2 . 15926

GW/klf

RECEIVED
MAR 28 1995
MINING LANDS BRANCH



ACCURASSAY LABORATORIES

A DIVISION OF ASSAY LABORATORY SERVICES INC.

1070 LITHIUM DRIVE, UNIT 2
THUNDER BAY, ONTARIO P7B 6G3
PHONE (807) 623-6448
FAX (807) 623-6820

Page 1

LYLE HOLT
Box 223
Beardmore, Ontario
POT 1G0

August 5, 1994

Job #944758

Accurassay	Sample #	Customer	Gold ppb	Gold Oz/t
1	203305	Summers. old tr. S. end.	10	<0.001
2	203308	Summers old tr. N end.	5	<0.001
3	203310	Summers main showing	2119	0.062
4	203311	near wafer end. 31 m.w.	2535	0.074
5	203313	Summers main showing 6 m.w.	203	0.006
6	Check	203313	143	0.004

2.1592 g

RECEIVED
MAR 28 1995
MINING LANDS BRANCH

Certified By: _____

Chris Bever

Sample Location

Scale.
1 CM = 2 m.

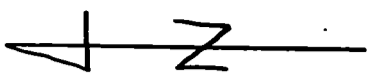

Banded F.F.
Main Showings.
180 m. North
190 m East
of # 2 post
Claim # 406090

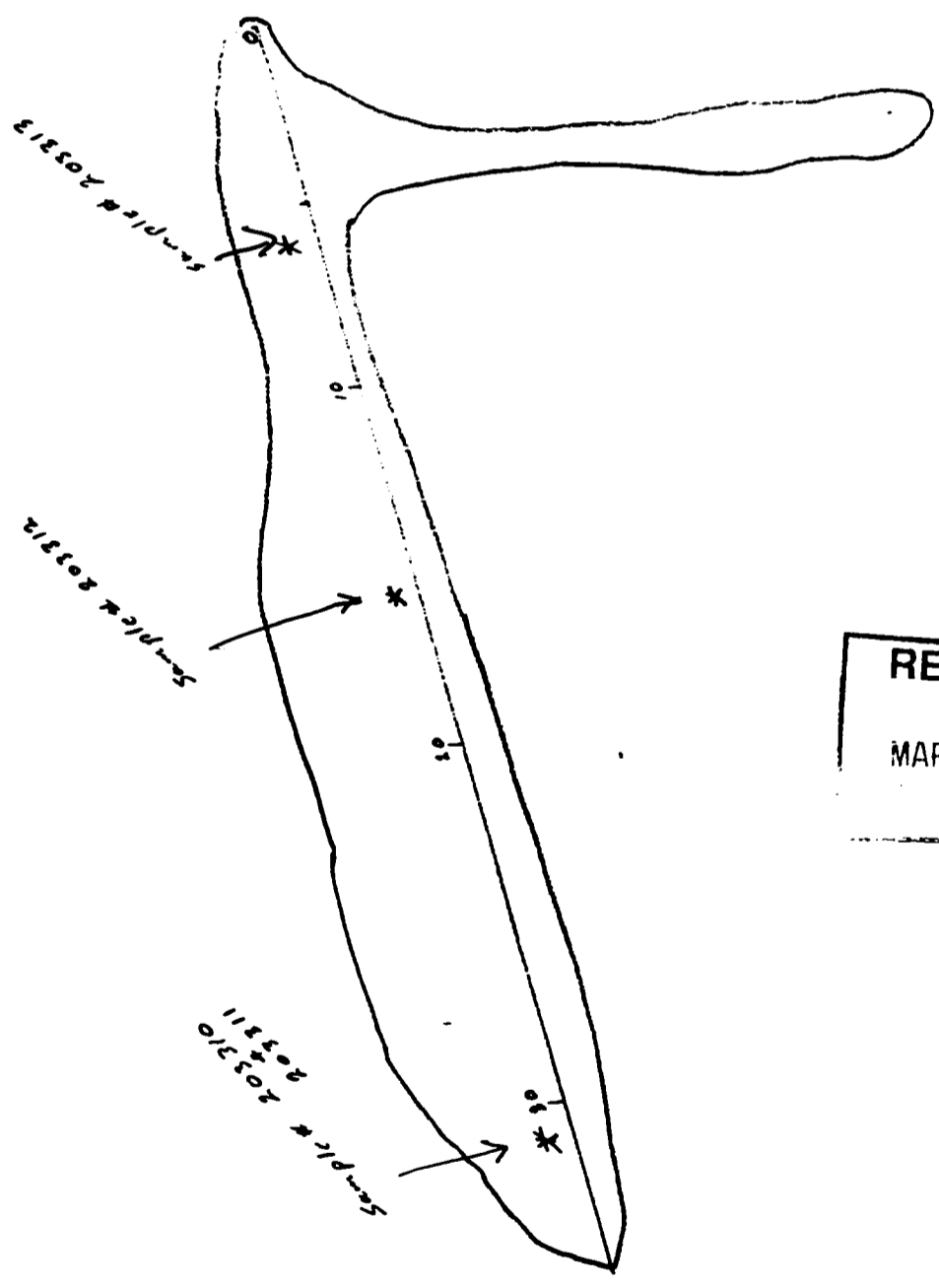

2 15926

RECEIVED
MAR 28 1925



Report of Work Conducted After Recording Claim

Mining Act

Transaction Number
W9540-00040

Personal information collected on this form is obtained under the authority of the Mining Act. This information will be used for correspondence. Questions about this collection should be directed to the Provincial Manager, Mining Lands, Ministry of Northern Development and Mines, Fourth Floor, 159 Cedar Street, Sudbury, Ontario, P3E 6A5, telephone (705) 670-7264.

- Instructions:**
- Please type or print and submit in duplicate.
 - Refer to the Mining Act and Regulations for recording of claims to the Recorder.
 - A separate copy of this form must be complete
 - Technical reports and maps must accompany it
 - A sketch, showing the claims the work is assigned to, must be submitted.

2.15926



42E12SW0002 2.15926 SUMMERS

900

Recorded Holder(s) Mona Holt (1) Melody MacIsaac (2)	Client No. (1) 145592 (2) 163132
Address Box 223 Beardmore Ont, P0T1G0	Telephone No. 807 875 2434
Mining Division Thunder Bay	M or G Plan No. G-165
Date Work Performed From: July 22/94	To: July 25/94

Work Performed (Check One Work Group Only)

Work Group	Type
Geotechnical Survey	
Physical Work, including Drilling	
Rehabilitation	
Other Authorized Work	
Assays <input checked="" type="checkbox"/>	<i>Prospecting + physical work previously submitted.</i>
Assignment from Reserve	<i>is document # W9440-208 + 209</i>

RECEIVED
 MAR 28 1995
 MINING LANDS BRANCH

Total Assessment Work Claimed on the Attached Statement of Costs \$ 76.21

Note: The Minister may reject for assessment work credit all or part of the assessment work submitted if the recorded holder cannot verify expenditures claimed in the statement of costs within 30 days of a request for verification.

Persons and Survey Company Who Performed the Work (Give Name and Address of Author of Report)

Name	Address
ACCURASSAY LABORATORIES	Thunder Bay Ont

(attach a schedule if necessary)

Certification of Beneficial Interest * See Note No. 1 on reverse side

I certify that at the time the work was performed, the claims covered in this work report were recorded in the current holder's name or held under a beneficial interest by the current recorded holder.	Date Feb/13/95	Recorded Holder or Agent (Signature) <i>Mona Holt</i>
--	--------------------------	--

Certification of Work Report

I certify that I have a personal knowledge of the facts set forth in this Work report, having performed the work or witnessed same during and/or after its completion and annexed report is true.	
Name and Address of Person Certifying Lyle Holt Box 223 Beardmore Ont P0T1G0.	
Telephone No. 807 875 2434	Date Feb 13/95
FAX 807 875 2552	Certified By (Signature) <i>Lyle Holt</i>

For Office Use Only

76	Total Value Cr. Recorded	Date Recorded	Mining Recorder <i>L. Fallon</i>	RECEIVED THUNDER BAY MINING DIVISION FEB 13 1995
	Deemed Approval Date May 15/95	Date Approved		
	Date Notice of Amendments Sent			



Ministry of
Northern Development
and Mines

Ministère du
Développement du Nord
et des mines

**Statement of Costs
for Assessment Credit**

**État des coûts aux fins
du crédit d'évaluation**

Mining Act/Loi sur les mines

Transaction No./N° de transaction
W9540-00040

2.15926

Personal information collected on this form is obtained under the authority of the Mining Act. This information will be used to maintain a record and ongoing status of the mining claim(s). Questions about this collection should be directed to the Provincial Manager, Minings Lands, Ministry of Northern Development and Mines, 4th Floor, 159 Cedar Street, Sudbury, Ontario P3E 6A5, telephone (705) 670-7264.

Les renseignements personnels contenus dans la présente formule sont recueillis en vertu de la Loi sur les mines et serviront à tenir à jour un registre des concessions minières. Adresser toute question sur la collecte de ces renseignements au chef provincial des terrains miniers, ministère du Développement du Nord et des Mines, 159, rue Cedar, 4^e étage, Sudbury (Ontario) P3E 6A5, téléphone (705) 670-7264.

1. Direct Costs/Coûts directs

Type	Description	Amount Montant	Totals Total global
Wages Salaires	Labour Main-d'oeuvre		
	Field Supervision Supervision sur le terrain		
Contractor's and Consultant's Fees Droits de l'entrepreneur et de l'expert- conseil	Type		
Supplies Used Fournitures utilisées	Type Assays	75 97	
Equipment Rental Location de matériel	Type		
Total Direct Costs Total des coûts directs			75 97

2. Indirect Costs/Coûts indirects

** Note: When claiming Rehabilitation work Indirect costs are not allowable as assessment work.
Pour le remboursement des travaux de réhabilitation, les coûts indirects ne sont pas admissibles en tant que travaux d'évaluation.

Type	Description	Amount Montant	Totals Total global
Transportation Transport	Type		
Food and Lodging Nourriture et hébergement			
Mobilization and Demobilization Mobilisation et démobilisation			
Sub Total of Indirect Costs Total partiel des coûts indirects			
Amount Allowable (not greater than 20% of Direct Costs) Montant admissible (n'excédant pas 20 % des coûts directs)			
Total Value of Assessment Credit (Total of Direct and Allowable indirect costs)		Valeur totale du crédit d'évaluation (Total des coûts directs et indirects admissibles)	75 97

Note: The recorded holder will be required to verify expenditures claimed in this statement of costs within 30 days of a request for verification. If verification is not made, the Minister may reject for assessment work all or part of the assessment work submitted.

Note : Le titulaire enregistré sera tenu de vérifier les dépenses demandées dans le présent état des coûts dans les 30 jours suivant une demande à cet effet. Si la vérification n'est pas effectuée, le ministre peut rejeter tout ou une partie des travaux d'évaluation présentés.

Filing Discounts

1. Work filed within two years of completion is claimed at 100% of the above Total Value of Assessment Credit.
2. Work filed three, four or five years after completion is claimed at 50% of the above Total Value of Assessment Credit. See calculations below:

Total Value of Assessment Credit	Total Assessment Claimed
	x 0.50 =

Remises pour dépôt

1. Les travaux déposés dans les deux ans suivant leur achèvement sont remboursés à 100 % de la valeur totale susmentionnée du crédit d'évaluation.
2. Les travaux déposés trois, quatre ou cinq ans après leur achèvement sont remboursés à 50 % de la valeur totale du crédit d'évaluation susmentionné. Voir les calculs ci-dessous.

Valeur totale du crédit d'évaluation	Evaluation totale demandée
	x 0,50 =

Certification Verifying Statement of Costs

I hereby certify:
that the amounts shown are as accurate as possible and these costs were incurred while conducting assessment work on the lands shown on the accompanying Report of Work form.

that as Mara Holt I am authorized
(Recorded Holder) Agent, Position in Company

to make this certification

Attestation de l'état des coûts

J'atteste par la présente :
que les montants indiqués sont le plus exact possible et que ces dépenses ont été engagées pour effectuer les travaux d'évaluation sur les terrains indiqués dans la formule de rapport de travail ci-joint.

Et qu'à titre de _____ je suis autorisé
(titulaire enregistré, représentant, poste occupé dans la compagnie)

à faire cette attestation.

Signature <u>Mara Holt</u>	Date <u>Feb 13/15</u>
-------------------------------	--------------------------



Ministry of
Northern Development
and Mines

Ministère du
Développement du Nord
et des Mines

Geoscience Approvals Office
933 Ramsey Lake Road
6th Floor
Sudbury, Ontario
P3E 6B5

Telephone: (705) 670-5853
Fax: (705) 670-5863

April 3, 1995

Our File: 2.15926
Transaction #: W9540.00040

Mining Recorder
Ministry of Northern Development & Mines
435 James Street South
Suite B003
Thunder Bay, Ontario
P7E 6E3

Dear Mr. Weirmeir:

**Subject: APPROVAL OF ASSESSMENT WORK CREDITS ON MINING CLAIMS
406090 & 406091 IN SUMMERS TOWNSHIP**

Assessment work credits have been approved as outlined on the report of work form. The credits have been approved under Section 17 (Assays) of the Mining Act Regulations.

The approval date is March 29, 1995.

If you have any questions regarding this correspondence, please contact Steven Beneteau at (705) 670-5858.

ORIGINAL SIGNED BY:

A handwritten signature in cursive script that reads "Ron C. Gashinski".

Ron C. Gashinski
Senior Manager, Mining Lands Section
Mining and Land Management Branch
Mines and Minerals Division

SBB/jl
Enclosure:

cc: Resident Geologist
Thunder Bay, Ontario

Assessment Files Library
Sudbury, Ontario

AREAS WITHDRAWN FROM DISPOSITION

M.R.O. - MINING RIGHTS ONLY
 S.R.O. - SURFACE RIGHTS ONLY
 M. & S. - MINING AND SURFACE RIGHTS

Description	Order No.	Date	Disposition	File
Withdrawn from staking				59282
Withdrawn from staking Sect. 46 (1880-80) of the Mining Act				59408
Withdrawn from staking				

Surface rights only withdrawn from staking order W-78-36 (25) 1978
 02/08/87 to accommodate a gas care storage facility for 5000.

SANDRA TOWNSHIP

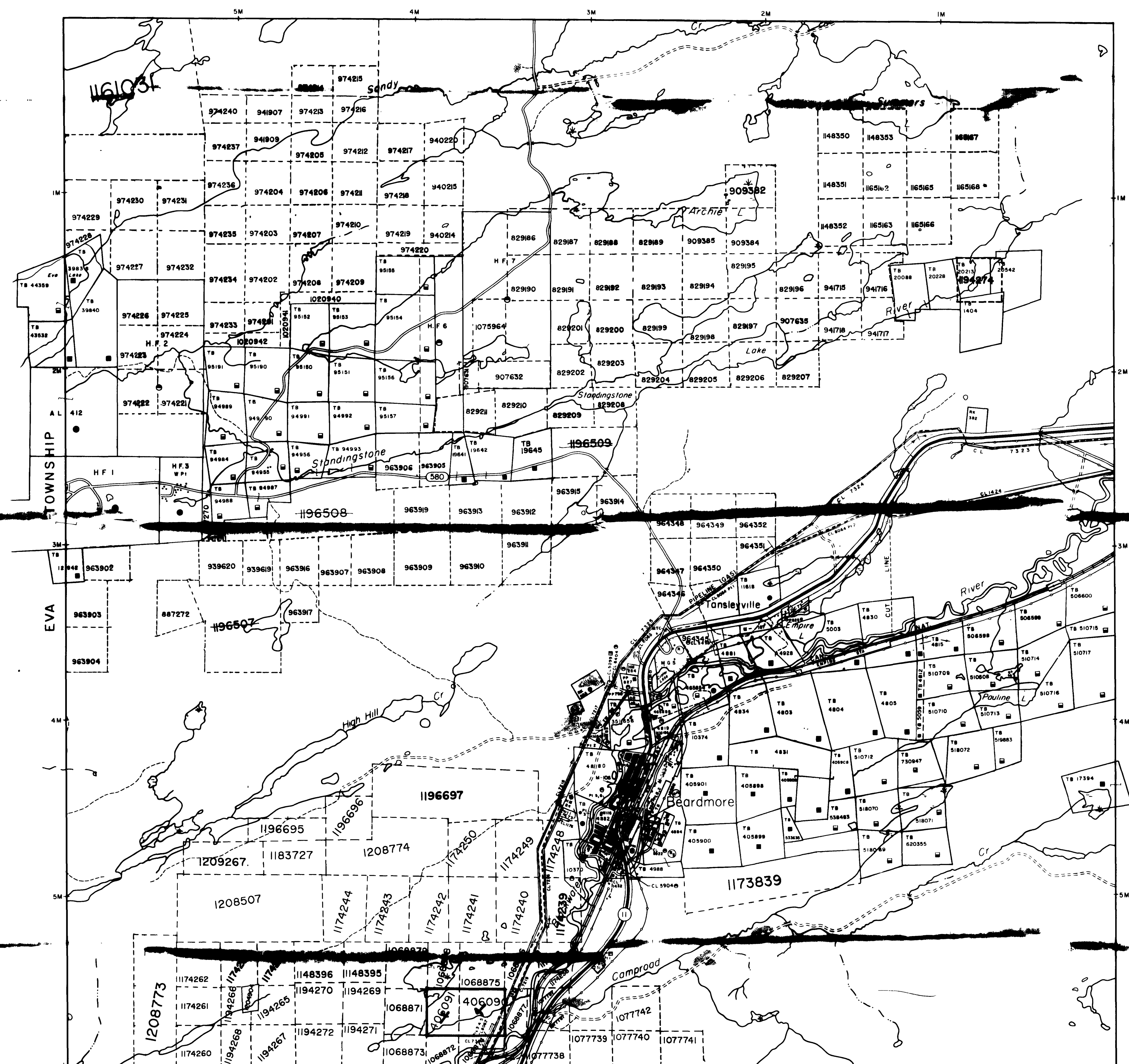

LEGEND

- HIGHWAY AND ROUTE No.
- OTHER ROADS
- TRAILS
- SURVEYED LINES
- TOWNSHIP BASE LINES ETC.
- LOTS, MINING CLAIMS, PARCELS ETC.
- UNSURETY KEY LINES
- UNIT LOTS
- PATENT BOUNDARY
- MINING CLAIMS ETC.
- RAILWAY AND RIGHT OF WAY
- UTILITY LINES
- PERMANENT STREAM
- FLOODING OR FLOODING RIGHTS
- SUBMISSION OR COMPOSITE PLAN
- RESERVATIONS
- ORIGINAL SHORELINE
- MARSH OR MUSKEG
- MINES
- TRAVERSE MONUMENT

DISPOSITION OF CROWN LANDS

TYPE OF DOCUMENT	SYMBOL
PATENT SURFACE & MINING RIGHTS	
SURFACE RIGHTS ONLY	
MINING RIGHTS ONLY	
LEASE SURFACE & MINING RIGHTS	
SURFACE RIGHTS ONLY	
MINING RIGHTS ONLY	
LICENCE OF OCCUPATION	
ORDER IN COUNCIL	
RESERVATION	
CANCELLED	
SAND & GRAVEL	

LAND USE PERMITS FOR COMMERCIAL TOURISM, OUTDOOR CAMPING, ETC.
 NOTE: MINING RIGHTS IN PARCELS PATENTED BY THE PUBLIC LANDS ACT R.S.O. 1970 CHAP. 380 SEC. 63 SUBSEC. 1

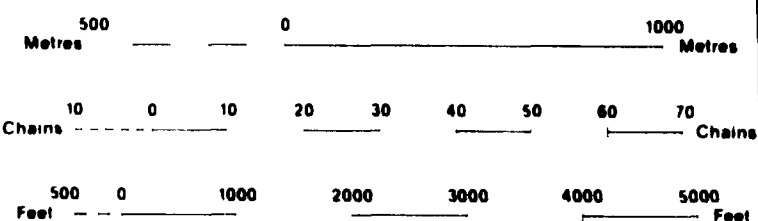

SCALE 1:20 000

THE SURFACE RIGHTS LYING WITHIN 40.25 M. OF THE CENTRE-LINE OF THE TRANS-CANADA PIPELINE RIGHT-OF-WAY ARE WITHDRAWN FROM STAKING OUT, PROSPECTING, SALE OR LEASE BY ORDER W/O/10/87, DATED SEPT. 20, 1986, SECTION 82 OF THE NATIONAL ENERGY ACT APPLIES TO THIS AREA.

TOWNSHIP
SUMMERS
 M. N. R. ADMINISTRATIVE DISTRICT
NIPIGON
 MINING DIVISION
THUNDER BAY
 LAND TITLES / REGISTRY DIVISION
THUNDER BAY

Ministry of Natural Resources Ontario
 Ministry of Northern Development and Mines

Date: SEPTEMBER, 1986
 Number: **G-165**
 In Service Dec. 22/94.

NOTICE: The information that appears on this map has been compiled from various sources and accuracy is not guaranteed. Those wishing to stake MINING CLAIMS should consult with the Mining Recorder, Ministry of Northern Development and Mines, for additional information on the status of the lands shown hereon.

2.15926
 (ASSAY) BEARDMORE AREA

RECEIVED
 MAR 2 8 1995
 MINING LANDS BRANCH

2.15926

