

Report for Ministry of
Natural Resources



42E12SW0075 2.7201 SUMMERS

010

1984 POWER STRIPPING AND
ROCK CHIP SAMPLING
ON THE PANCONTINENTAL BEARDMORE
CLAIM BLOCK, NORTHWESTERN ONTARIO

RECEIVED

OCT 18 1984

MINING LANDS SECTION

By: H.R. Lahti, Ph.D.

August, 1984



42E12SW0075 2.7201 SUMMERS

010C

TABLE OF CONTENTS

	<u>Page No.</u>
List of Appendices	ii
List of Figures	iii
List of Tables	iv
1.0 INTRODUCTION	1
1.1 Objectives	1
1.2 Location of Trenches and Stripping	1
1.3 Duration of Program	1
1.4 Scope of Report	1
2.0 TRENCHING AND STRIPPING	3
2.1 Trenching on Claims 465854 and 465855 (Figure #2)	3
2.2 Claim 538483 (Figure #3)	3
2.3 Claim 620355 (Figure #4)	6
2.4 Claims 518072 and 519883 (Figures #5 and #6)	6
2.5 Claim 518070 (Figure #7)	10
3.0 ASSAY RESULTS	12
4.0 STATUS OF CLAIMS	13

LIST OF APPENDICES

Appendix I

Sample Locations in Claims

Appendix II

List and Description of Alluvial and
Rock Chip Samples

Appendix III

Assay Data

LIST OF FIGURES

		<u>Page No.</u>
Figure #1	Claim Location Map	2
Figure #2	Claim 565854 and Location of Trenches	4
Figure #3	Claim 538483 and Trench	5
Figure #4	Claim 620355 and Trenches	7
Figure #5 & #6	Claims 518072 and 519883 and Trench	8 & 9
Figure #7	Claim 518070 and Trench	11

In Appendix I

Figure #8	Sample Locations in Claim 465854	15
Figure #9	Sample Locations in Claim 538483	16
Figure #10 & #11	Sample Locations in Claim 620355	17 & 18
Figure #12	Sample Locations in Claims 518072 and 519883	19
Figure #13	Sample Location in Claim 518070	20

LIST OF TABLES

Table I Assay Results (located in Appendix III)

1.0 INTRODUCTION

1.1 Objectives

In order to bring the following claims to survey status, a program of power stripping was done on claims 465854 - 465855; 538483; 620355; 518061 - 518072; and 519883. A John Deer 455D Loader was used to trench and strip off overburden to expose the bedrock to be mapped and sampled. Samples were assayed for Au, Ag, Cu, Pb and Zn. Extensions of known mineralized zones were explored as were some areas with no known mineralization.

1.2 Location of Trenches and Stripping

Figure #1 shows the location of the claims the work was done on and the location of the trenching and stripping. Individual claim maps with trench locations are also presented in this report. The alluvial sand and rock chip sample sites are found in the Appendix I in Figures #8 - #13 inclusive.

1.3 Duration of Program

The program lasted from July 24th to August 2nd. Two additional days were allowed for mobilization/demobilization.

1.4 Scope of Report

This report summarizes all the work done associated with the power trenching and stripping program. A brief description and list of rock chip samples is given in Appendix II, and the assay results are included in Appendix III.

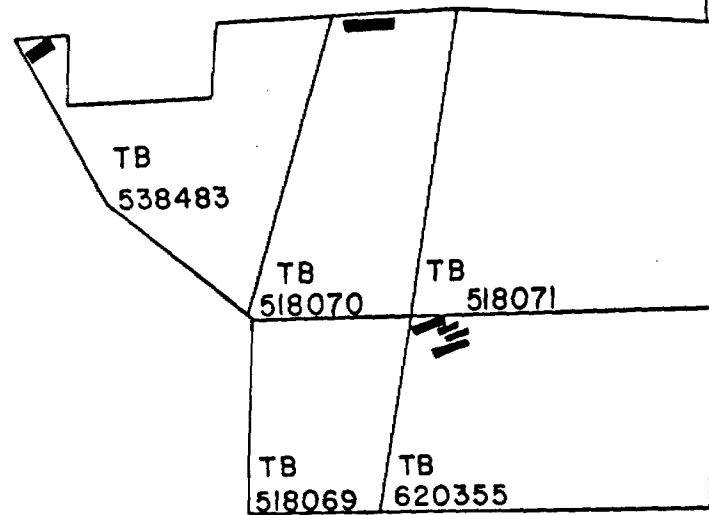
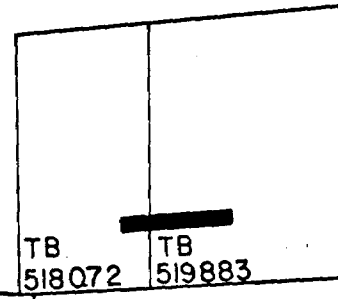
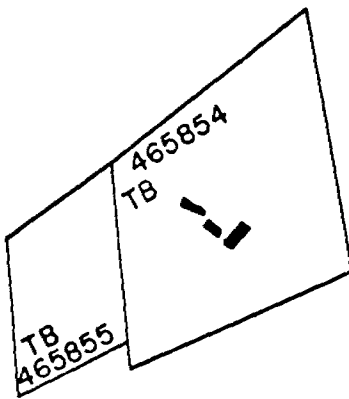

Summers
Twp.

— Stripping or Trench

Scale: 1" = 1/4 mile

Thunder Bay Mining Division
Note: from M.N.R. claim map 21/4/83

 **PANCONTINENTAL MINING (CANADA) LTD.**
TORONTO - ONTARIO

Location
CLAIM MAP

Scale	Date	Geology	Drawn	Dwg. No.
As Shown	Aug./84	M.L.		Fig. 1

2.0 TRENCHING AND STRIPPING

2.1 Trenching on Claims 465854 and 465855 (Figure #2)

Two days of trenching was done on Claim 465854, but due to the extensive overburden no bedrock was reached. The material encountered consisted of well sorted alluvial river sand (Black River). A total of three trenches were excavated and six large (2 kg.) samples were taken and assayed for Au, Ag, Cu, Pb and Zn (sample location see Figure #8). Because the trenches are proximal to the town community centre, once the samples were taken, the trenches were filled in and the ground re-levelled.

All trenching was done on Claim 465854 because the community centre and parking lot occupied most of the 465855 claim area, and damages to the town property was to be avoided.

2.2 Claim 538483 (Figure #3)

An approximately 30 metre long area of bedrock was stripped of overburden and scrub trees. The excavation exposed a 0.3 metre wide black graphitic zone. This and other rocks in the trench were sampled. Samples Bd-43-84 to Bd-48-84 were taken from the trench and assayed for Au, Ag, and other base metals. (See Figure #9 for sample location).

The graphitic zone pinches and swells along strike and locally has trace pyrite. This unit is enclosed in vol-sediments of andesitic composition and fine-grained carbonate rich sediments. All these rocks have been metamorphosed to the greenschist facies. No visible Au or Ag was observed.



Claim 465854

Pond

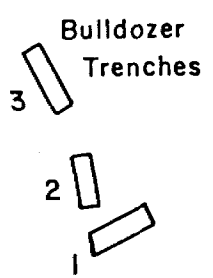

Power Line

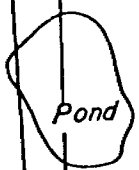



Old Road

C.N.R.

SUMMERS TWP.

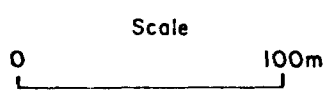
Claim 465855



 PANCONTINENTAL MINING (CANADA) LTD. TORONTO - ONTARIO				
<h2>CLAIM 465854</h2>				
Scale As Shown	Date Aug./84	Geology M.L.	Drawn	Dwg No Fig. 2

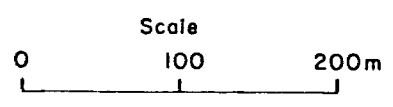
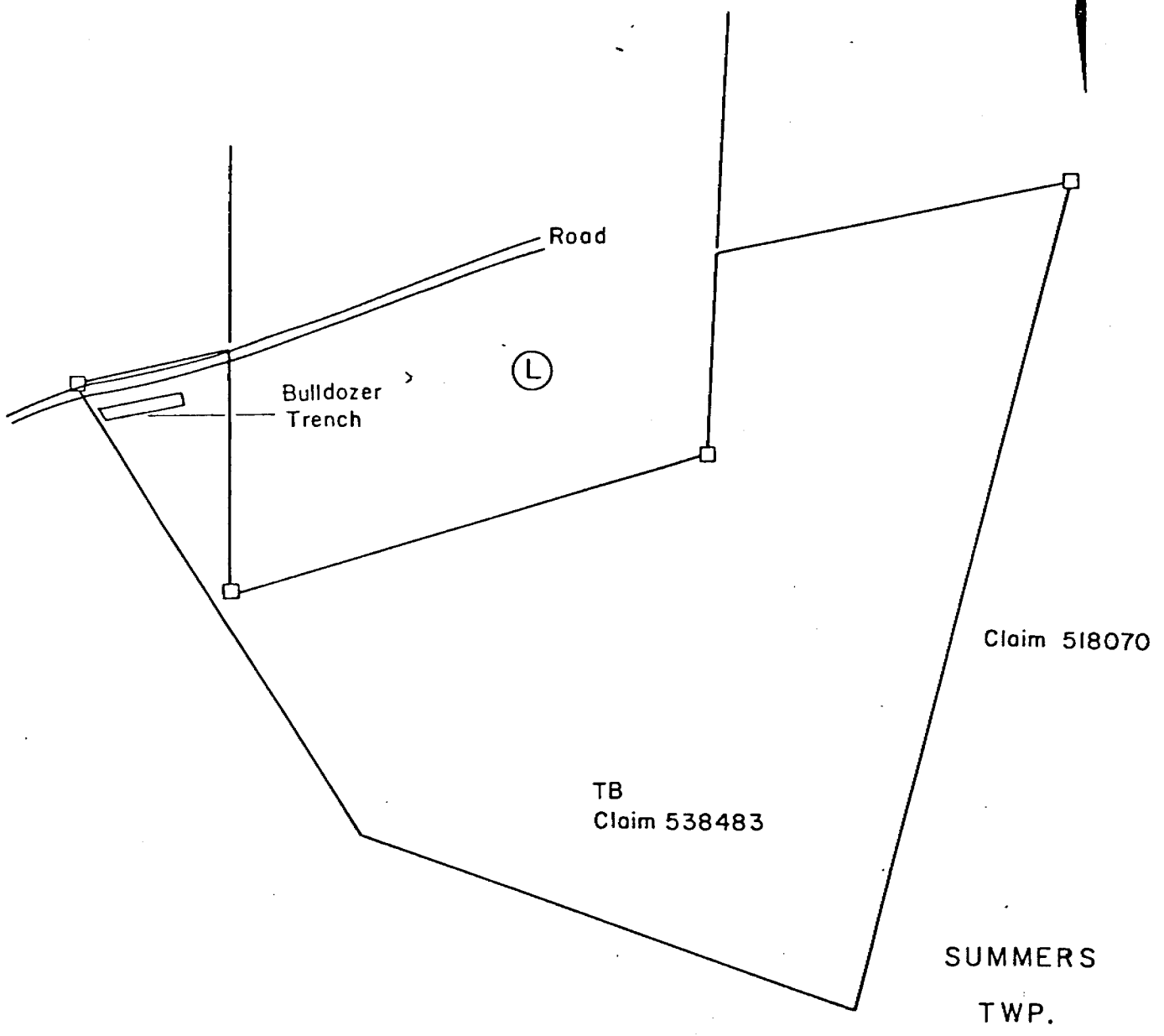

		PANCONTINENTAL MINING (CANADA) LTD. PANCON TORONTO - ONTARIO		
<h2>CLAIM 538483</h2>				
Scale	Date	Geology	Drawn	Dwg. No.
AS SHOWN	JUG /84		H L	Fig. 3

2.3 Claim 620355 (Figure #4)

This claim is in a very remote part of the Pancon claim group, in an area with numerous swamps and high rocky ridges. An old bush road to the McWilliams Shaft and on to the South-East Zone (Atkins 1981) was improved to the state where a four wheel drive vehicle can use the road. From the end of this road a bulldozer road was made to the claim site, where the trenches were excavated and some outcrop areas stripped of the thin overburden and vegetation.

The rocks exposed by the trenching consist of basalts, andesites and possibly tuffs and sediments, all sheared and metamorphosed to the Greenschist facies. No economic minerals were observed, but several samples were collected to confirm the visual inspection (see Figure #10 and #11 for sample locations).

2.4 Claims 518072 and 519883 (Figures #5 and #6)

Access to these two claims is by a four-wheel drive road improved in 1984. A long 200+ metre x 10 m area was stripped. The area cleared of overburden and vegetation is the eastern part of the South-East Zone (Atkins, 1981) and extends from Claim 518072 into 519883.

The local geology is quite complex with numerous quartz stringers interbedded with volcanic and sedimentary rocks, some of which are high in carbonate. The carbonate rich beds show excellent plastic-flow type folds. Some of the thin beds appear to be high in ankerite, an iron carbonate facies of Iron Formation.

Old trenches blasted into the bedrock indicate that the earlier (1940's) workers were prospecting quartz rich zones with accessory arsenopyrite, pyrite and minor gold. Twenty rock chip samples across the interesting zones were taken, and have been sent in for assay for Au, Ag, and base metals Cu, Pb and Zn (see Figure #12). No significant zones of mineralization were observed.

Lake

New Bulldozer Road



Bulldozer
Trenches

Claim 620355

L6+00E

SUMMERS
TWP.

Old Bush Road

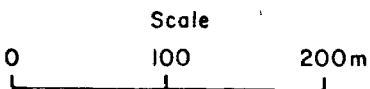

 PANCONTINENTAL MINING (CANADA) LTD.
PANCON TORONTO - ONTARIO

CLAIM 620355

Scale	Date	Geology	Drawn	Dwg No.
As Shown	Aug./84	M.L.		Fig. 4



L14 +00 E

Road to
McWilliams
Shaft

Claim
518072

New Trench (Bulldozer)

old
trenches

SUMMERS
TWP.

Lake

Scale

0 100 200m

1D PANCONTINENTAL MINING (CANADA) LTD.
PANCON TORONTO - ONTARIO

CLAIM 518072

Scale As Shown	Date Aug/84	Geology M.L.	Drawn	Dwg No Fig. 5
-------------------	----------------	-----------------	-------	------------------

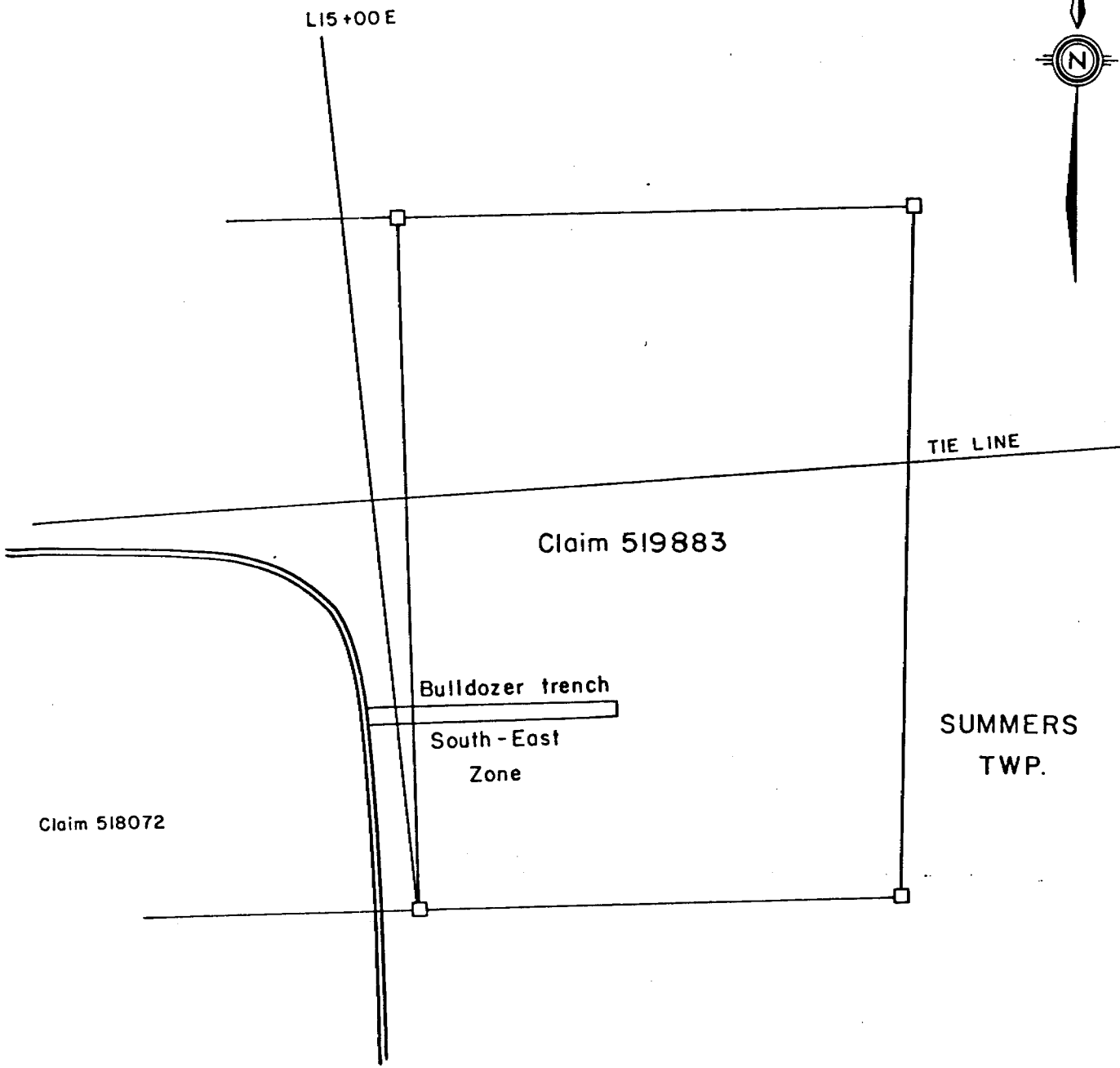

Claim 518072

L15+00 E

TIE LINE

Claim 519883

Bulldozer trench

South-East
Zone

SUMMERS
TWP.

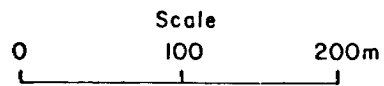

 PANCONTINENTAL MINING (CANADA) LTD.
PANCON TORONTO - ONTARIO

CLAIM 519883

Scale As Shown	Date Aug./84	Geology H L.	Drawn	Dwg No Fig. 6
-------------------	-----------------	-----------------	-------	------------------

2.5 Claim 518070 (Figure #7)

A 30 - 40 metre x 10 metre area of ground was stripped of overburden and vegetation across the strike of the local geology. An attempt was made to see if the mineralized rocks east of the South-East Zone extend this far to the west. None of the carbonate rich sediments or quartz stringers were found. Several samples were collected to verify the visual inspection of the rock. Sample locations are found in Appendix I in Figure #13).

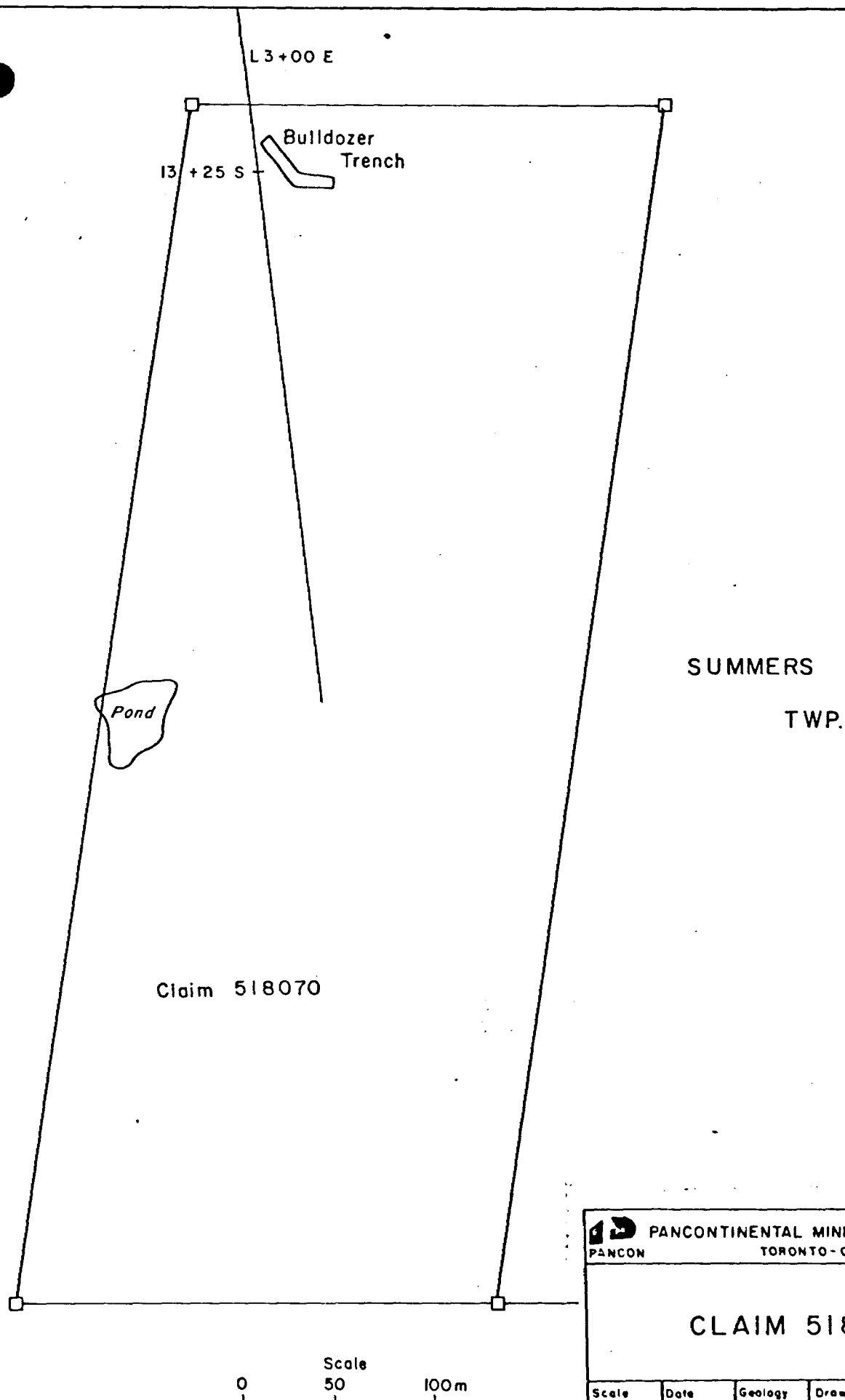

Claim 518070

SUMMERS

TWP.

 PANCONTINENTAL MINING (CANADA) LTD.
 PANCON TORONTO - ONTARIO

CLAIM 518070

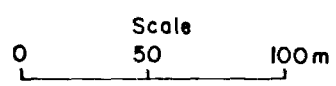

Scale	Date	Geology	Drawn	Dwg No.
As Shown	Aug./84	M.L.		

Fig. 7

3.0 ASSAY RESULTS

No significant new mineralization was located during the trenching and stripping program. Further work will be required to determine if these claims contain economic concentration of Au, Ag, Cu, Pb or Zn.

4.0

STATUS OF CLAIMS

With the completion of 10 days of power stripping the following claims should be brought to survey status:

<u>Claim No.</u>	<u>Mandays Due</u>	<u>Date Due</u>	<u>Comments</u>
465854	56.6	August 31/84	To survey status
465855	56.6	August 31/84	To survey status
538483	60.0	August 14/84	To survey status
620355	140.0	August 25/85	To survey status
518069-72 plus 519883	300.0	January 2/85	To survey status

Note: Claims 538483, 620355, 518069 - 072
and 519883 are contiguous.

APPENDIX I

SAMPLE LOCATIONS IN CLAIMS

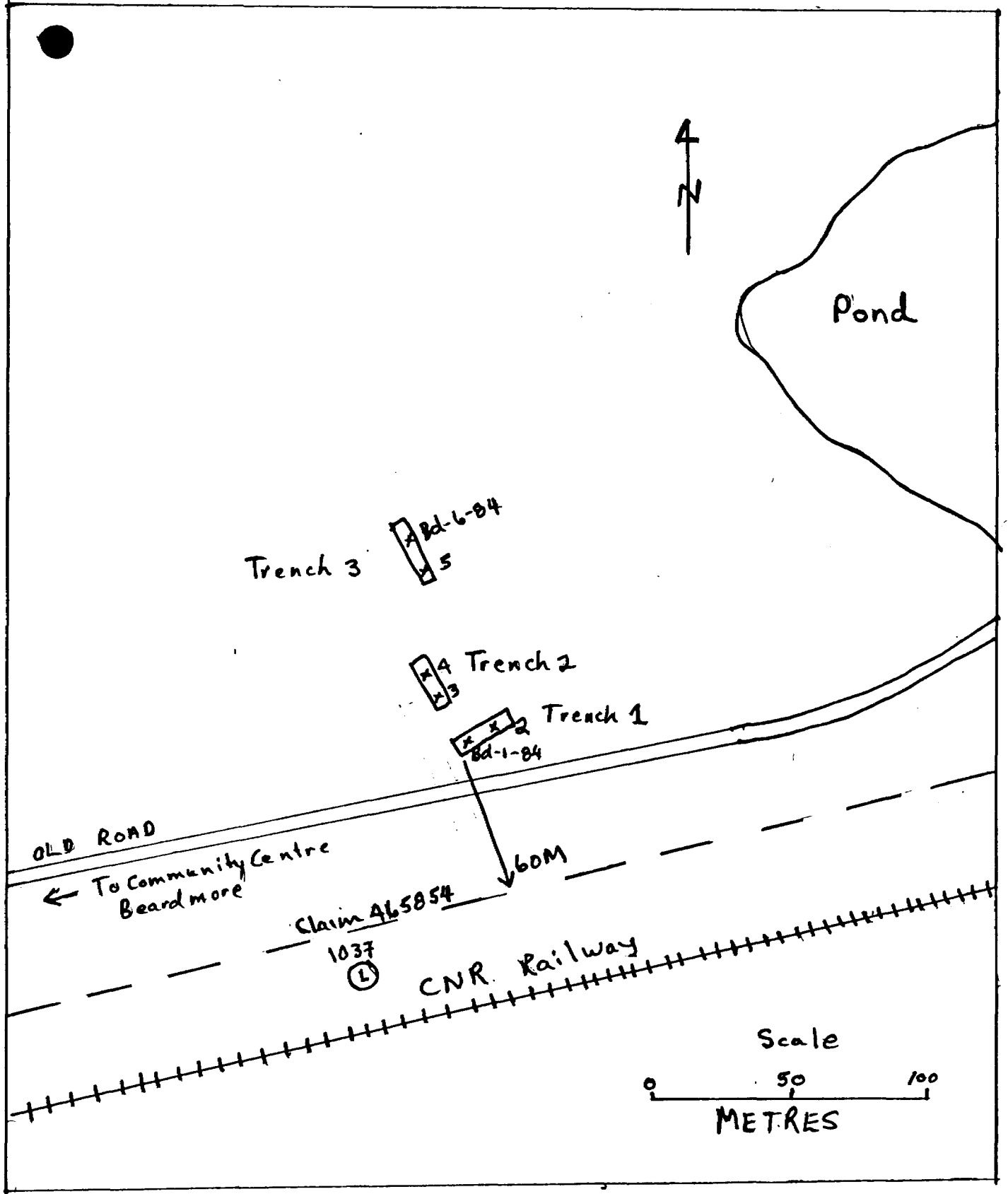

Figure #8 Sketch Map Showing Location of Alluvial Samples from Trenches

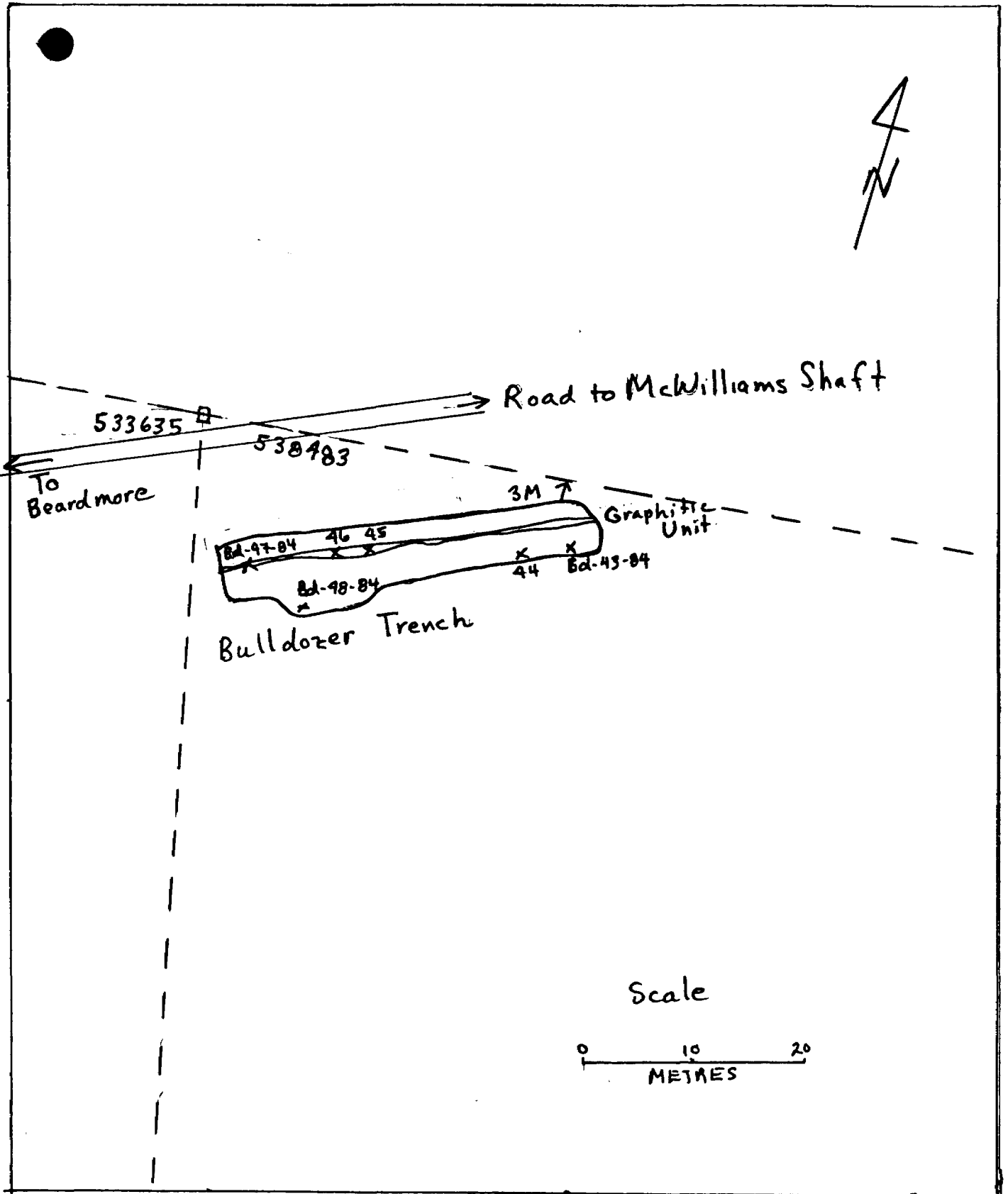

Figure #9 Sketch Map Showing Location of Rock Chip Sample Site in Claim 538483

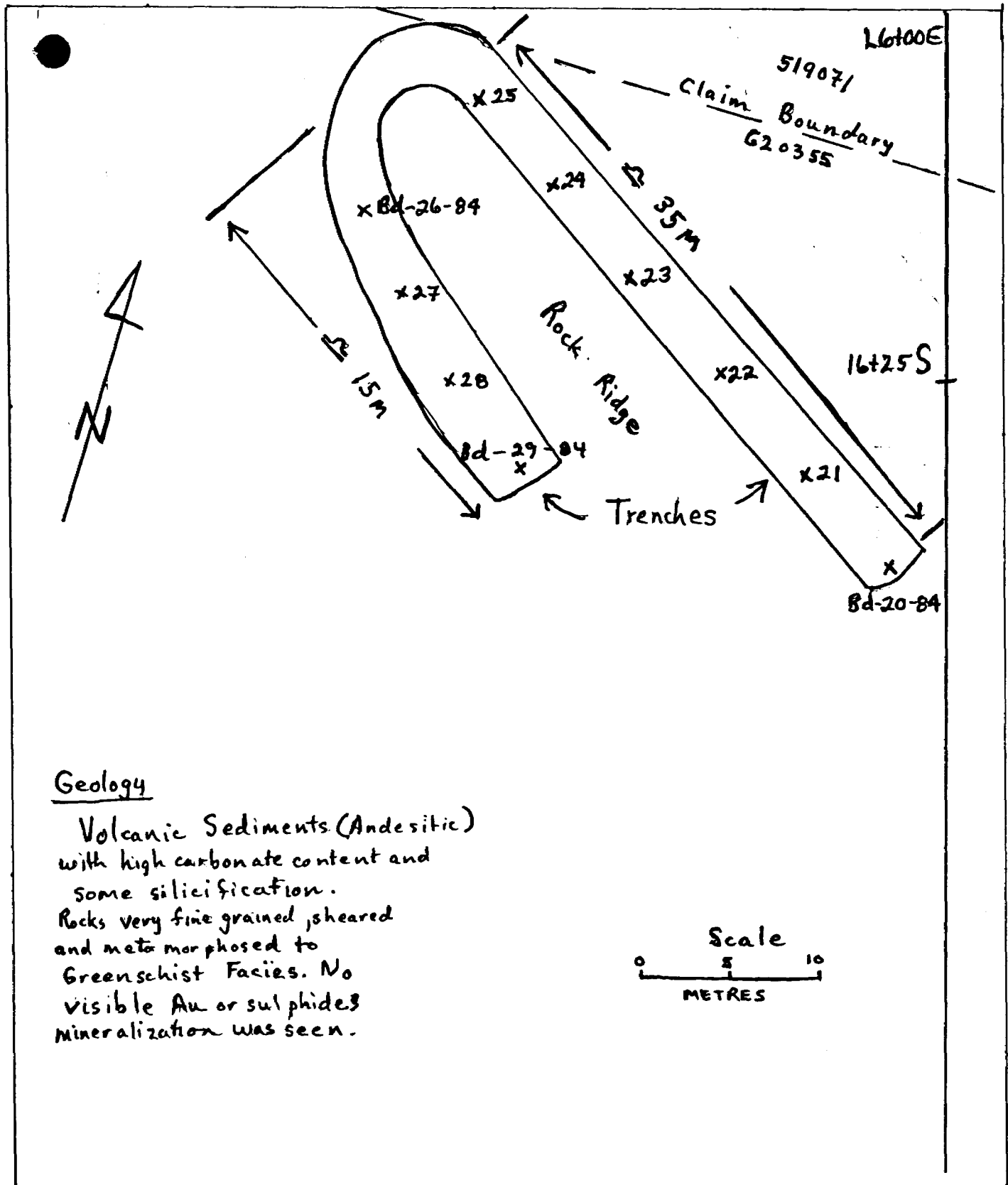

Figure #10 Sketch Map Showing Sample Location of Rock Chip Samples Claim 620355

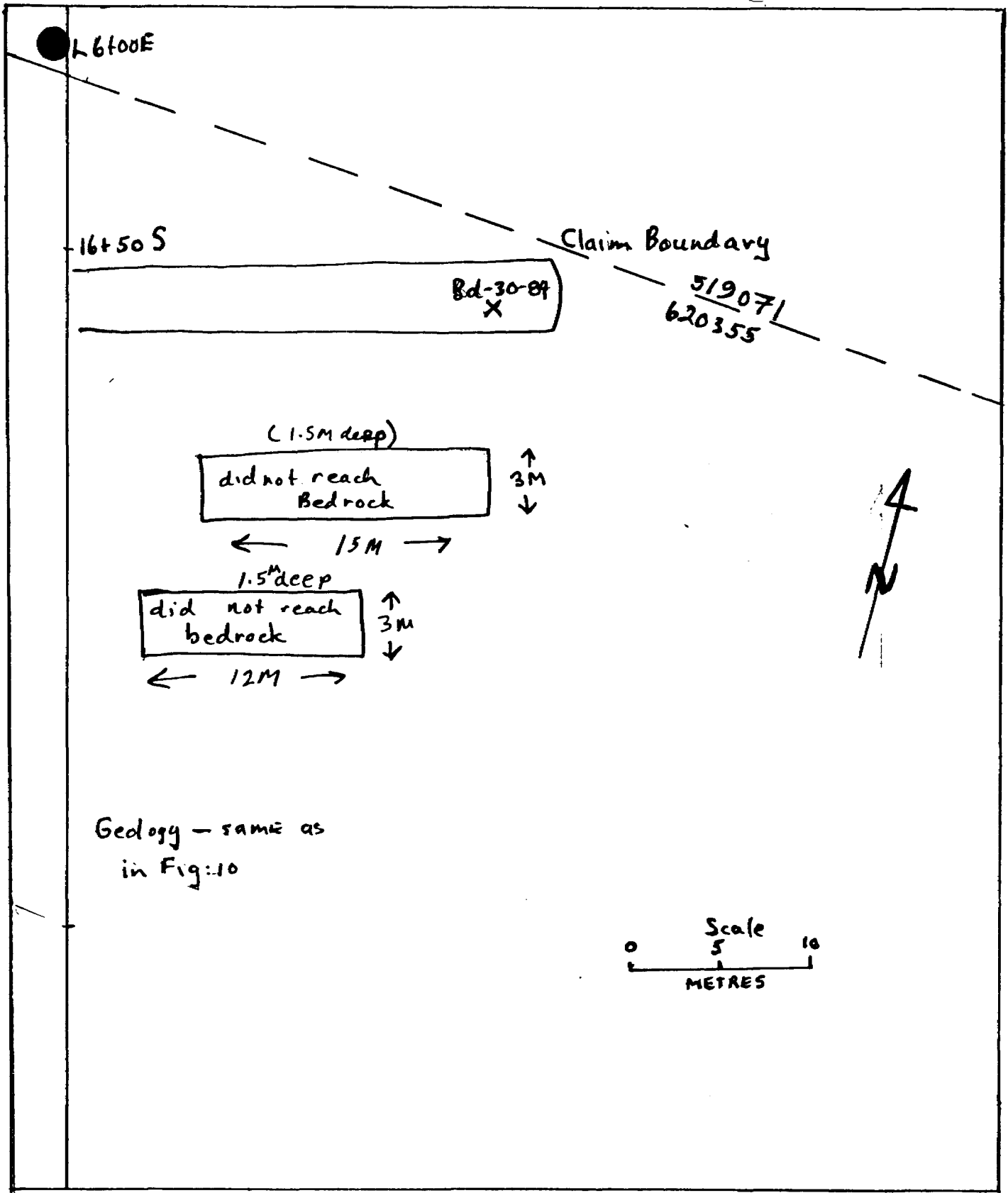

Figure #11 Sketch Map Showing Location of Rock Chip Samples in Claim 620355

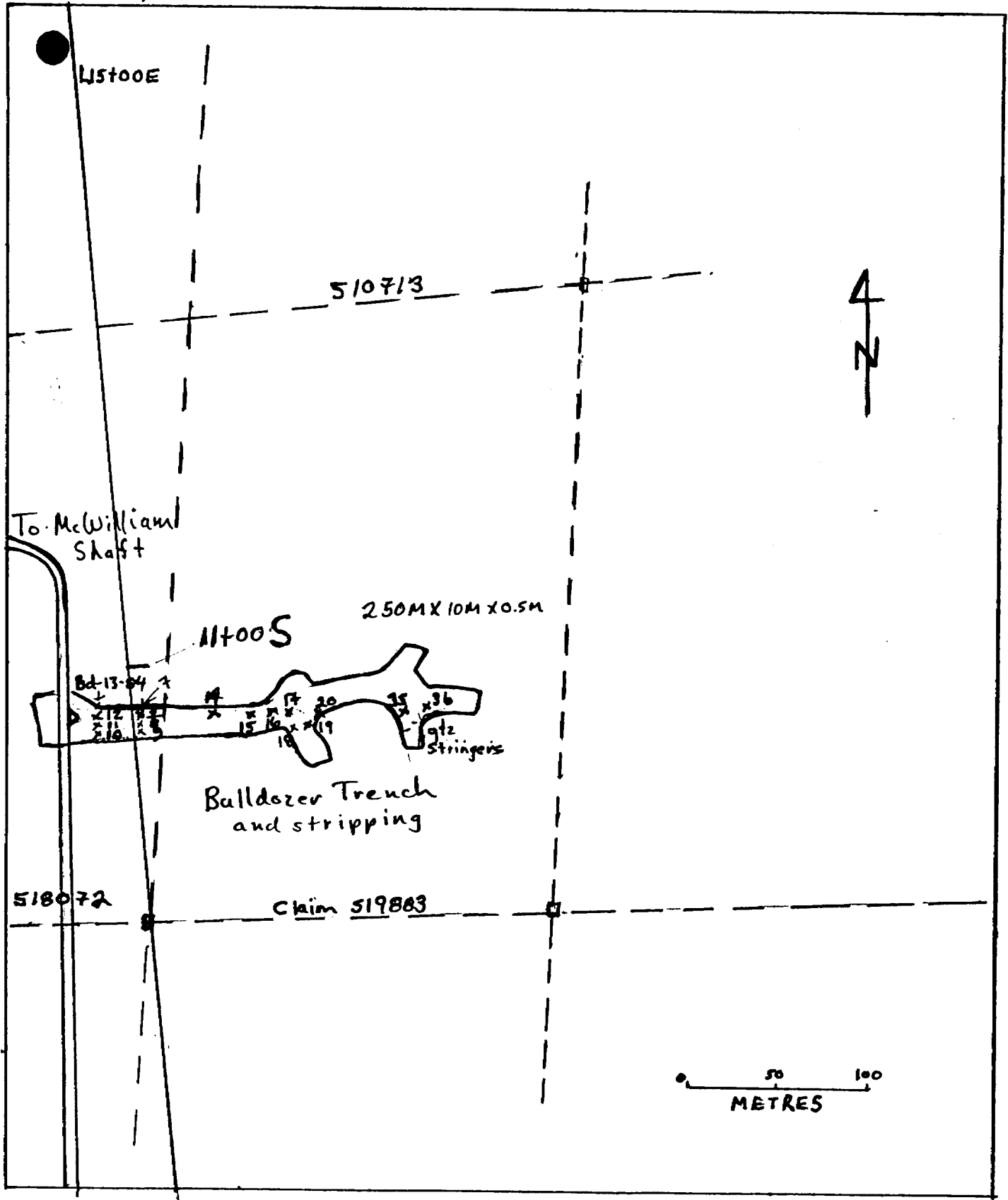

Figure #12 Sketch Map Showing Location of Rock Chip Sample Sites in Claims 518072 and 519883

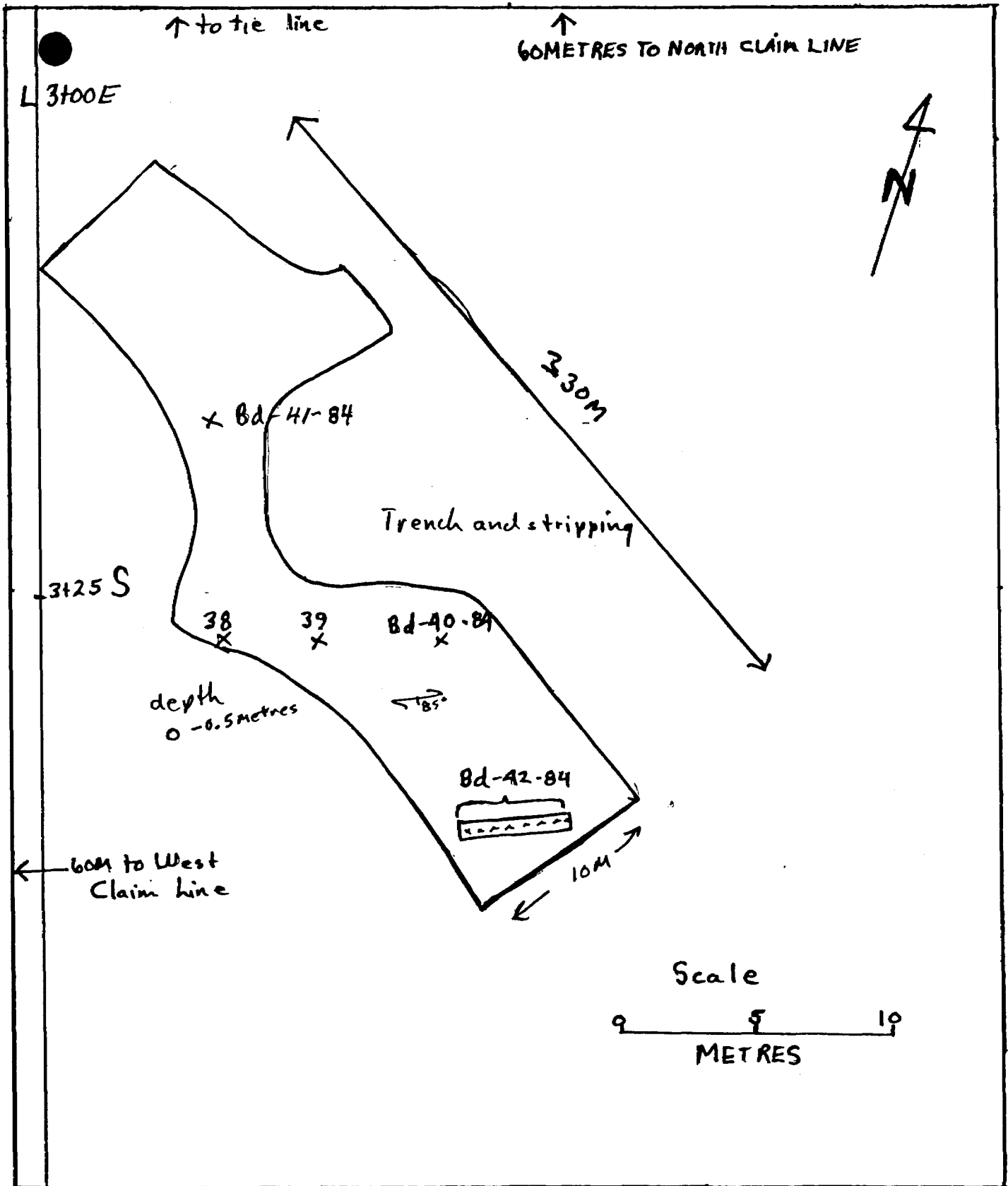

Figure #13 Sketch Map Showing Location of Rock Chip Samples on Claim 518070

LIST AND DESCRIPTION OF
ALLUVIAL AND ROCK CHIP SAMPLES

Bd- 1-84	Claim 465854	Well washed alluvial sand
2-84	" "	Well washed alluvial sand
3-84	" "	Well washed alluvial sand
4-84	" "	Well washed alluvial sand
5-84	" "	Well washed alluvial sand
6-84	" "	Well washed alluvial sand
Bd- 7-84	Claim 518072	And. tuff. and carbonate rich seds
8-84	" "	IF. Ankerite, seds, tuff.
9-84	" "	IF. Ankerite, seds, tuff.
10-84	" "	And. tuff. and carbonate rich seds
11-84	" "	Quartz stringer
12-84	" "	And. tuff. and carbonate rich seds
13-84	" "	Well banded silica-carbonate - tuff. band with ankerite
Bd-14-84	Claim 519883	Same as 13
15-84	" "	Vol. - seds - tuff. with qtz. stringers
16-84	" "	Quartz stringer
17-84	" "	Quartz stringer
18-84	" "	Quartz and seds vol. And.
19-84	" "	Quartz stringer
20-84A	" "	Iron Formation, Andesite, trace sulfides
Bd-20-84B	Claim 620355	Silicified And., f. grained sheared, chloritic
21-84	" "	As above
22-84	" "	As above
23-84	" "	As above
24-84	" "	Parts phyllite + And.
25-84	" "	Chloritized And. tuff.
26-84	" "	Carbonate rich seds derived from And. vol, tuffs.

Appendix II

Bd-27-84	Claim 620355	Same as Bd-26-84
28-84	" "	As above
29-84	" "	As above
30-84	" "	Silified And. tuff?
31-34		(Not Used)
Bd-35-84	Claim 519883	Chloritic seds. carbonate rich, some ankerite
36-84	" "	As above
37-84		(Not Used)
Bd-38-84	Claim 518070	Andesite to basalt - some tuff. and possibly tuffaceous sediments
39-84	" "	As above
40-84	" "	As above
41-84	" "	As above
42-84	" "	As above
Bd-43-84	Claim 538483	Spotted chl. schist - Andesite composition possibly sedimentary
44-84	" "	Phyllite - green - derived from And. tuff.?
45-84	" "	Graphite Zone \approx 0.3m thick, pinches and swells along strike
46-84	" "	As above
47-84	" "	As above
48-84	" "	Phyllitic sed.

ASSAY DATA

PAN CONTINENTAL MINING (H. LATHI)

WO NO: 84-0501A

PAGE: 1

SAMPLE ID	AU OZ/TON	AG OZ/TON	CU PPM	ZN PPM	PB PPM
24. 84-BD-1	TRACE	<.05	6	24	8
84-BD-2	TRACE	<.05	8	23	8
84-BD-3	TRACE	<.05	5	18	5
84-BD-4	TRACE	<.05	6	40	5
84-BD-5	TRACE	<.05	5	21	8
84-BD-6	TRACE	<.05	6	25	5
84-BD-7	TRACE	<.05	56	130	8
84-BD-8	TRACE	<.05	75	130	<2
84-BD-9	TRACE	<.05	67	160	<2
84-BD-10	TRACE	<.05	98	140	<2
84-BD-11	TRACE	<.05	9	10	<2
84-BD-12	TRACE	<.05	57	105	<2
84-BD-13	TRACE	<.05	28	35	<2
84-BD-14	TRACE	<.05	15	35	<2
84-BD-15	TRACE	<.05	26	18	<2
84-BD-16	TRACE	<.05	12	8	<2
84-BD-17	TRACE	<.05	14	23	<2
84-BD-18	TRACE	<.05	30	58	<2
84-BD-19	TRACE	<.05	14	29	<2
84-BD-20	TRACE	<.05	84	83	<2
84-BD-21	TRACE	<.05	73	88	<2
84-BD-22	TRACE	<.05	71	75	<2
84-BD-23	TRACE	<.05	99	75	<2
84-BD-24	TRACE	<.05	135	75	<2
84-BD-25	TRACE	<.05	59	90	<2

FAN CONTINENTAL MINING (H. LATHI)

WO NO: 84-0501A

PAGE: 2

25. SAMPLE ID	AU	AG	CU	ZN	PB
	OZ/TON	OZ/TON	PPM	PPM	PPM
84-BD-26	TRACE	<.05	54	93	<2
84-BD-27	TRACE	<.05	64	85	<2
84-BD-28	TRACE	<.05	68	93	<2
84-BD-29	TRACE	<.05	86	91	<2
84-BD-30	TRACE	<.05	75	100	<2
84-BD-31	TRACE	<.05	67	106	<2
84-BD-35	TRACE	<.05	15	28	<2
84-BD-36	TRACE	<.05	64	120	<2
84-BD-37	TRACE	<.05	82	110	<2
84-BD-38	TRACE	<.05	135	110	<2
84-BD-39	TRACE	<.05	83	85	<2
84-BD-40	TRACE	<.05	45	98	<2
84-BD-41	TRACE	<.05	89	50	<2
84-BD-42	TRACE	<.05	95	125	<2
84-BD-43	TRACE	<.05	90	95	<2
84-BD-44	TRACE	<.05	89	145	<2
84-BD-45	TRACE	<.05	130	825	<2
84-BD-46	TRACE	<.05	115	600	<2
84-BD-47	TRACE	<.05	105	300	<2
84-BD-48	TRACE	<.05	95	115	<2

.005<TRACE>.001

W 2404. 00447



Report of Work
(Geophysical, Geological,
Geochemical and Expenditures)



42E12SW0075 2.7201 SUMMERS

900

File: 465854

The Min

Do not use shaded areas below.

Type of Survey(s) ASSAYING	Township or Area SUMMERS TP G-165
Claim Holder(s) Pancontinental Mining (Canada) Ltd	Prospector's Licence No. T 903 6466
Address 365 Bay St Suite 705 Toronto Ont M5H 2V1	
Survey Company Consultant Howard R. Lahti Ph.D.	Date of Survey (from & to) 24 7 84 2 8 84 Day Mo. Yr. Day Mo. Yr.
Name and Address of Author (of Geo-Technical report) Howard Lahti RR#1 Mattawa Ont P0H 1V0	

Credits Requested per Each Claim in Columns at right

Special Provisions	Geophysical	Days per Claim
For first survey: Enter 40 days. (This includes line cutting)	- Electromagnetic	
	- Magnetometer	
For each additional survey: using the same grid: Enter 20 days (for each)	- Radiometric	
	- Other	
	Geological	
	Geochemical	

Man Days	Geophysical	Days per Claim
Complete reverse side and enter total(s) here	- Electromagnetic	
	- Magnetometer	
	- Radiometric	
	- Other	
	Geological	
	Geochemical	

Airborne Credits	Geophysical	Days per Claim
Note: Special provisions credits do not apply to Airborne Surveys.	Electromagnetic	
	Magnetometer	
	Radiometric	

Mining Claims Traversed (List in numerical sequence)

Mining Claim		Expend. Days Cr.	Mining Claim		Expend. Days Cr.
Prefix	Number		Prefix	Number	
TB	465854	15.8			
	465855	17.8			
	620355	17.8			
	518069	17.8			
	518070	17.8			
	518071	17.8			
	518072	17.8			
	519883	17.8			

RECEIVED
SEP 20 1984
MINING CLAIMS SECTION

Expenditures (excludes power stripping)

Type of Work Performed
Assaying

Performed on Claim(s)
465854, 620355, 518070, 518072, and 519883

Calculation of Expenditure Days Credits

Total Expenditures	Total Days Credits
\$ 1604.25	15
= 107	

Instructions
Total Days Credits may be apportioned at the claim holder's choice. Enter number of days credits per claim selected in columns at right.

* maximum credits requested

Total number of mining claims covered by this report of work. **186**

Date **Sept 4/84** Recorded Holder or Agent (Signature) **Howard Lahti**

For Office Use Only

Total Days Credits Recorded **107** Date Recorded **SEPT. 7, 1984** **Michael M. Hayler**
Date Approved by Inspector **84.10.24**

I hereby certify that I have a personal and intimate knowledge of the facts set forth in the Report of Work annexed hereto, having performed the work or witnessed same during and/or after its completion and the annexed report is true.

Name and Postal Address of Person Certifying
Howard Lahti RR#1 Mattawa Ont

Date Certified **Sept 4/84** Certified by (Signature) **Howard Lahti**

2.7201

PANCONTINENTAL MINING (CANADA) LTD.

RECEIVED	
Land Management Branch	
CIRCULATE	<input type="checkbox"/>
COMMENTS PLEASE	<input type="checkbox"/>
BY	
OCT 22 1984	
S. E. YUNDT	<input type="checkbox"/>
J. R. MORTON	<input type="checkbox"/>
J. C. SMITH	<input type="checkbox"/>
W. L. GOOD	<input type="checkbox"/>
H. J. HOGAN	<input type="checkbox"/>
W. P. BROOK	<input type="checkbox"/>
RECEIVED BY	R. 0043



October 16, 1984

Miss Susan Hurst,
Land Management Branch,
Ministry of Natural Resources,
Whitney Block, Room 6643,
Queen's Park,
Toronto, Ontario.
M7A 1W3

Dear Miss Hurst,

Your File: 2.7201
Assaying submitted on Mining Claims
TB 465854 et al in Summers Township

Further to your letter dated October 10th, and our telephone conversation on October 15th, I am attaching two copies of our cancelled cheque #5781, in the amount of \$1,604.25, made payable to Barringer Magenta Limited. This cheque was issued for assaying performed on the above claim block.

As mentioned during our telephone conversation, we submitted duplicate copies of the assay results and sample location plans as part of our report to the Thunder Bay Office. If you need additional copies, please let me know.

I trust the above is satisfactory, and if you need more information please contact this office.

Yours sincerely,

PANCONTINENTAL MINING (CANADA) LTD.

Mrs. Sheila D. Woods.

October 10, 1984

File: 2.7201

Pancontinental Mining (Canada) Ltd
Suite 705
365 Bay Street
Toronto, Ontario
M5H 2V1

Dear Sir:

RE: Data for Assaying submitted on Mining
Claims TB 465854 et al in Summers Township

In order to complete the above-mentioned submission,
please provide the following in duplicate:

- 1) receipts or cancelled cheques as proof of
payment for the \$1604.25 expenditure credits
claimed
- 2) assay results
- 3) sample location plan showing assay values

When submitting this material, please quote file 2.7201.

For further information, please contact Susan Hurst
at (416)965-4888.

Yours sincerely,

S.E. Yundt
Director
Land Management Branch

Whitney Block, Room 6643
Queen's Park
Toronto, Ontario
M7A 1W3
Phone: (416)965-4888

S. Hurst:mc

cc: Mining Recorder
Thunder Bay, Ontario

1984 10 01

Your File: 447
Our File: 2.7201

Mining Recorder
Ministry of Natural Resources
P.O. Box 5000
Thunder Bay, Ontario
P7C 5G6

Dear Madam:

We have received Data for Assaying on September 20, 1984, submitted under Section 77(19) of The Mining Act R.S.O. 1980 for Mining Claims TB 620355 et al in the Township of Summers.

This material will be examined and assessed and a statement of assessment work credits will be issued.

Yours sincerely,

S.E. Yundt
Director
Land Management Branch

Whitney Block, Room 6643
Queen's Park
Toronto, Ontario
M7A 1W3
Phone: (416)965-6918

A.Barr:sc

cc: Pancontinental Mining (Canada) Limited
365 Bay Street
Suite 705
Toronto, Ontario
M9H 2V1

cc: Howard Lahti
R.R. #1
Mattawa, Ontario
POH 1V0



Ministry of
Natural
Resources

RECEIVED	
Land Management Branch	
CIRCULATE <input type="checkbox"/>	
COMMENTS PLEASE <input type="checkbox"/>	
BY	
OCT 18 1984	
S. E. YUNDT	
J. R. MORTON	
J. C. SMITH	
W. L. GOOD	
I. J. HOGAN	
W. P. BROOK	
R. 8643	

October 16, 1984

MEMORANDUM TO:

Director
Land Management Branch
Ministry of Natural Resources
6643 Whitney Block
TORONTO, Ontario.
M7A 1W3

Att'n: Susan HURST

SUBJECT: PANCONTINENTAL MINING (CANADA) LTD.
Assay Reports TB538483 et al

Enclosed herewith please find reports as above referred.

Yours very truly

Audrey M. HAYES
Mining Recorder
Thunder Bay Mining Division
Ontario Government Building
435 S. James Street
P.O. Box 5000
THUNDER BAY, Ontario.
P7C 5G6

Telephone: (807)475-1311

AMH:1
Encls.

RECEIVED
OCT 18 1984
MINING LANDS SECTION

Mining Lands Section

File No 2.7201

Control Sheet

TYPE OF SURVEY GEOPHYSICAL
 GEOLOGICAL
 GEOCHEMICAL
 EXPENDITURE

MINING LANDS COMMENTS:

LD

Dorsey
Signature of Assessor

24/10/84
Date

PANCONTINENTAL MINING
(CANADA) LTD.
365 BAY ST., STE. 705
TORONTO, ONTARIO M5H 2V1

No. 5781

Aug 28 1984

PAY TO THE
ORDER OF

BARRINGER MAGENTA LIMITED

\$ 1604.25

THE SUM I 604 DOLS 25 CTS

100 DOLLARS

PANCONTINENTAL MINING
(CANADA) LTD.

THE TORONTO-DOMINION BANK
CITY HALL BRANCH
394 BAY ST. & QUEEN ST. W.
TORONTO, ONTARIO M5H 2Y3

PER

J. D. Woods

⑆ 2162 004⑆ 0670 0789364⑆

⑆0000160425⑆

11 1 1984

LESISTRE

REGENT DOMINION BANK
TORONTO DATA CENTER
TORONTO, ONTARIO

SE 18. 04

THE 2047 00 0000 0000 00

FOR DEPOSIT ONLY
TO THE CREDIT OF
BARRINGER MAGENTA LIMITED



AUG 22 1984

304 CARLINGVIEW DRIVE
 METROPOLITAN TORONTO
 REXDALE, ONTARIO
 CANADA M9W 5G2
 PHONE: 416-675-3870
 TELEX: 06-989183

SERVICES FOR THE EARTH AND ENVIRONMENTAL SCIENCES

• Pan Continental Mining
 • Suite 600, 365 Bay Street
 • TORONTO, Ontario
 • M5H 2V9

DATE: August 22, 1984

PROJECT: 100.41

PERIOD COVERED:

SALES ORDER:

PROGRESS BILLING:

SHIPPING REPORT:

WORK REPORT: 84-501

FED. SALES TAX: N/A

ONT. SALES TAX: N/A

TERMS: NET 30 days

AUTHORITY: H. Lathi

TO: ANALYSIS

45 Rock & Soil Samples

Prep	@ 3.40 each	153.00
Au/Ag - Fire Assay	@ 11.00 each	495.00
Cu Assay	@ 6.25 each	281.25
Zn Assay	@ 7.75 each	348.75
Pb Assay	@ 7.25 each	<u>326.25</u>

TOTAL INVOICE

\$1,604.25
 =====



BANCON

Payment Date _____

Ext. & Adds. _____

Account Code _____

APPROVALS

Originator H. Lathi

Manager Harold Lathi

A/P

INTEREST AT 2% PER MONTH PAYABLE ON
 OVERDUE ACCOUNTS

INVOICE No 11084

SANDRA JWP G-167

DISPOSITION OF CROWN LANDS

TYPE OF DOCUMENT	SYMBOL
PATENT, SURFACE & MINING RIGHTS	●
SURFACE RIGHTS ONLY	○
MINING RIGHTS ONLY	○
LEASE, SURFACE & MINING RIGHTS	○
SURFACE RIGHTS ONLY	○
MINING RIGHTS ONLY	○
LICENCE OF OCCUPATION	○
ORDER IN COUNCIL	○
RESERVATION	○
CANCELLED	○
SAND & GRAVEL	○

NOTE: MINING RIGHTS IN PARCELS PATENTED PRIOR TO MAY 8, 1912, VESTED IN ORIGINAL PATENTEES BY THE PUBLIC LANDS ACT, R.S.O. 1970, CHAP. 300, SEC. 63, SUBSEC. 1.

LEGEND

PATENTED AND CROWN LAND SALE	CS
LEASES	OC
LOCATED LAND	OC
LICENCE OF OCCUPATION	OC
MINING RIGHTS ONLY	M.R.O.
SURFACE RIGHTS ONLY	R.O.
ROADS	—
IMPROVED ROADS	—
KING'S HIGHWAYS	—
RAILWAYS	—
POWER LINES	—
MARSH OR MUSKEG	—
MINES	—
CANCELLED	—

NOTES

Township of Summers lies within Beardmore Improvement District.

SAND AND GRAVEL

- ① M.T.C. Gravel Pit 916
- ② Gravel File 59506
- ③ M.T.C. Gravel Pit 2 C-1
- ④ M.T.C. Gravel Pit 547 File 59506
- ⑤ M.T.C. Gravel Pit 1159
- ⑥ Gravel File 59506
- ⑦ Quarry Permit

AREAS WITHDRAWN FROM DISPOSITION

SR - SURFACE RIGHTS	MR - MINING RIGHTS
① Withdrawn from staking File 59262	
② Withdrawn from staking Sec 42(R.S.O. '60) of the Mining Act File 59459	
③ Withdrawn from staking	

DATE OF ISSUE

OCT 24 1984

Ministry of Natural Resources
TORONTO

SCALE 1 INCH = 20 CHAINS

SUMMERS

NIPIGON

THUNDER BAY

THUNDER BAY

Ministry of Natural Resources
Land Management Branch

DATE FEBRUARY 11th, 1981
NUMBER AUGUST 2/84

G-165

G-80 & G-116
EVA TWP

MCCOMBER TWP. G-166

BEARDMORE AREA G-7