

ONTARIO PROSPECTORS ASSISTANCE PROGRAM (OPAP) FINAL SUBMISSION FORM 1997

INSTRUCTIONS: Please read the guidebook before completing form. Please type or print.
Submit completed form and supporting documentation
by January 31, 1998 to:

OPAP, Mines Group
Ministry of Northern Development & Mines
4th Floor, 933 Ramsey Lake Rd., Sudbury, Ontario P3E 6B5

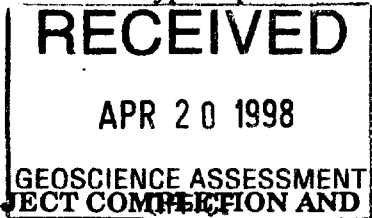

TO BE COMPLETED BY SUCCESSFUL GRANTEES AFTER PROJECT COMPLETION AND ACCOMPANIED BY WRITTEN REPORTS, MAPS, ETC.

2.18413

Applicant Herb. G. Goodman File Number OP97-085

Proposed project area(s) (Twp. or claim map name, latitude and longitude) Completed?

1. Morgan Extension Property, Summers Twp., Beardmore Area, Lat. 49°36' N Yes No
 2. _____ Long. 87°59' W Yes No

Changes to proposed project(s) (if any)
additional stripping locations.

List other co-owners of the property with OPAP grants that worked on project
None

I. WORK PERFORMED BY APPLICANT (Summary of Section IV)

1. Project #1 area/name	<u>Morgan Extension Property, South</u>	No. days worked by applicant (that's only you)	
Traditional prospecting	No. of samples <u>30</u>		<u>6</u>
Geological surveys	Scale _____		
Geophysical surveys	Type _____ Miles/km _____		
Geochemical surveys	Type _____ No. of samples _____		
Drilling	Type _____ Ft/m _____		
Stripping/Trenching	Method <u>manual</u>		<u>6</u>
Other	Type _____		
		TOTAL	<u>12</u>

Form filled out by Applicant Other (please specify) _____
 Report prepared by Applicant Other (please specify) _____
 Technical report Filed for Assessment Work Yes No



I. WORK PERFORMED BY APPLICANT (Continued)

2. Project #2 area/name _____		No. days worked by applicant _____
Traditional prospecting	No. of samples _____	_____
Geological surveys	Scale _____	_____
Geophysical surveys	Type _____ Miles/km _____	_____
Geochemical surveys	Type _____ No. of samples _____	_____
Drilling	Type _____ Ft./m _____	_____
Stripping/Trenching	Method _____	_____
Other	Type _____	_____
	TOTAL	<u>0</u>
TOTAL DAYS (ALL PROJECTS)	A	<u>12</u>

(Attach additional sheets for additional project areas as required)

II. EXPENDITURES (total of all projects) - Summary of I and II

1. Number of working days by applicant		
(A) x \$100/day		\$ <u>1200</u>
2. Number of report preparation days by applicant x \$100/day		\$ <u>300</u>
3. Analyses/Assay costs		\$ <u>501</u>
4. Equipment rentals		
<i>tractor-mechanical stripping</i> \$ <u>8025</u>		
..... \$ _____		\$ <u>8025</u>
5. Consumable Supplies <i>explosives</i>		\$ <u>100</u>
6. Contract services (state type)		
# of workers	\$ _____	
# of days worked	\$ _____	\$ _____
.....	\$ _____	\$ _____
7. Travel (state method: road, air, etc.)		
<i>road</i>	\$ <u>18</u>	
.....	\$ _____	\$ <u>18</u>
.....	\$ _____	
8. Food and Accommodation		\$ <u>120</u>
9. Other expenses (specify, e.g. typing, printing, shipping of supplies)		
typing	\$ 55	
.....	\$ _____	\$ 55
10. Helpers		
# of helpers	\$ _____	\$ _____
# of days worked		
	TOTAL EXPENDITURES	\$ <u>10,264⁰⁰</u>

DAILY LOG

<u>DATE</u>	<u>WORK PERFORMED</u>
Oct. 25/97 to Nov. 5/97	mechanical stripping, manual stripping, directing operator, prospecting
Nov. 6/97 to Nov. 7/97	blasting, sampling, mapping
Nov. 12/97 to Nov. 14/97	report

V. SIGNIFICANT RESULTS (please complete)

Project Area	New Showings and/or Anomalies	Commodity	Best Analyses
<u>Morgan Extension Property - South</u>	<u>Area # B</u>	<u>Au</u>	<u>0.153 oz/ton Au</u>

VI. CLAIMS STAKED DURING/AFTER PROSPECTING ACTIVITY (please complete)

Project Area	Claim Numbers	Number of Claim Units
<u>None</u>		

VII. OPTION AGREEMENTS RESULTING FROM OPAP PROJECT (please complete) Dollar Value of

Optionee	Property/Claims	Work Commitment
<u>None as yet.</u>		

The Ministry of Northern Development and Mines may verify all statements related to and made herein this application.

- I am the person named in the Final Submission Form under the Ontario Prospectors Assistance Program.
- I am ordinarily a resident of Canada.
- I have complied with all the requirements of the said program.
- I understand that it is an offence under the Ontario Mineral Exploration Act, R.S.O. 1990, to make a false or misleading statement and that all statements and all other information submitted in support of the said application are true and correct.
- I was not employed by the Mines and Minerals Division of the Ministry while in receipt of the OPAP grant.
- I am aware that any other Provincial or Federal Government financial assistance received for said application will be deducted from the amount of incurred "Total Eligible Expenses".

It is an Offence under subsection 8(1)(A) of the Ontario Mineral Exploration Act, R.S.O. 1990 to knowingly furnish false or misleading information.

Personal information on this form is obtained under the authority of the Ontario Mineral Exploration Act, R.S.O. 1990, sections 2, 3 and 4 and the Ontario Prospectors Assistance Program Regulation, sections 4, 5 and 6. The financial and technical information will be used for the purpose of determining the eligibility of the applicant to

have a program designated for financial assistance and the amount of such assistance. Other information, such as statistical information about the individual projects will be used for the purpose of determining the overall effectiveness of the program. It may be disclosed for those purposes and I consent to its disclosure for such

purposes. Questions about this collection should be directed to Senior Manager, Mines Group, Ministry of Northern Development and Mines, 5th Floor, 933 Ramsey Lake Road, Sudbury, Ontario P3E 6B5, Toll free 1-800-265-0834.

Signature of Applicant Herb. G. Goodman Date Nov. 14/97
 Name (print) Herb. G. Goodman

FINAL SUBMISSION

**Morgan South Extension Project
Beardmore-Geraldton Area
Thunder Bay Mining Division
Summers Township
Claim Sheet G-165
N.T.S. Sheet 42 E34 D/4
49°36 N. Lat., 87°59 W. Long**

**Herb G. Goodman
Nov. 14, 1997**

LIST OF CLAIMS

Five mineral claims situated in Summers Township, Thunder Bay Mining Division, Ontario, described as follows:

<u>Claim #</u>	<u>Units</u>
1196695	2
1196696	1
1196697	3
1183727	1
1208939	1
1210729	4
1210730	3
7 claims	15 units

LOCATION, ACCESS AND CLAIM INFORMATION

The Morgan Extension property is located in the southwest section of Summers Township, approximately 2 km due west of Beardmore, Ontario. Beardmore is on Highway 11 some 200 km northeast of Thunder Bay. Summers Township appears on N.T.S. Sheet 42E/NW and the approximate centre of the property is the Princess Creek chain of Lakes just to the north. Access to the property is provided by a 4x4 trail that leaves Highway 11 at a point about 0.5 km north of Beardmore and extends across the north boundary of the claim block, and by another bush road that branches off the north road and traverses south through property, then west along the southern boundary of the property..

The property consists of 15 claim units with 7 mineral claims. The claims are in the Beardmore-Geraldton Resident Geologist's area of Thunder Bay Mining Division and appears on the M.N.R. claim sheet G-165. The claims are held 100% by myself, Herb G. Goodman Jr. of Beardmore, Ontario.

REGIONAL GEOLOGY

The property lies within the area of the Beardmore-Geraldton Greenstone Belt, a subdivision of the Precambrian Wabigoon Subprovince of the Canadian Shield. The belt is described as an east-trending, isoclinally folded sequence of mainly metasediments interlayered with mafic to intermediated metavolcanics. On its north boundary, the belt is separated from the Onaman-Tashota Metavolcanic Belt by the Paint Lake Fault system and on its south boundary by the Keewatin sequence of metasediments located south of the main Beardmore-Geraldton belt.

The property is situated along a major tectonic break, known as the Empire Fault, in the far southwest part of the Beardmore-Geraldton Greenstone Belt. The Empire Fault cuts through the property from the southwest to the northeast corner and separates a belt of metavolcanic rock to the south from a belt of metasedimentary rocks to the north.

On the property the metasediments consist of weakly to strongly foliated greywacke interbedded with mudstone. Reminent bedding, dipping 80 S, is observed locally and is parallel to the regional foliation, at 70 E azimuth. The unit generally lacks any significant alteration, sulphide mineralization or quartz-carbonate veining. Carbonate alteration associated with narrow quartz-carbonate stringers and minor (up to 1%) pyrite and arsenopyrite mineralization occurs locally. The metavolcanics consist predominantly of massive basaltic flows which strike a 065 azimuth and dip 80 S. In places the flows are sheared, silicified, carbonated and mineralized and commonly grade along strike into tuffaceous units.

SPECIFIC GEOLOGY

The geology from the work done for this project was comprised from three different stripping locations, termed areas A, B, and C. Area "A" revealed an exposed area of generally massive, siliceous metavolcanic flows containing minor sulphide mineralization. This area lacks any significant alteration, shearing or any deposit of any favourable gold bearing structure. The magnetic anomaly outlined in my proposal was not located and may exist deeper than expected.

Geology from the work done at the area "B" location was successful in locating a gold bearing structure. This structure which is a continuation of the work done along strike of past exploration work (OP-94). Stripping here revealed a quartz veined and lenses system hosted in moderately sheared, altered, siliceous, pillowed metavolcanics. The quartz vein and lenses matter is crack seal in character and blue-grey in colour, contained abundant arsenopyrite, pyrite and lesser chalcopyrite. The sulfides are disseminated throughout the quartz, but is more concentrated along the host metavolcanics contact. These contacts are highly sheared with mineralization and silicification found penetrating the metavolcanics up to a foot on either side. Alteration in the form of chlorite and sericite is found throughout the zone as well as in any metavolcanic seams found in the quartz.

Geology from the work done at the area "C" location, which also is an extension of previous work (OP-95), is relatively the same as the area "B" location. This parallel structure contains the similar altered, silicified metavolcanics but less quartz veining and lenses were uncovered. Veins uncovered were much narrower but still continuous and mineralized with pyrite and arsenopyrite. In the middle of exposure a outcrop of massive magnetite iron formation was exposed. This iron formation contains roughly 1% pyrite and is more massive rather than banded deposit.

WORK DONE

As mentioned three areas termed A' B' and C were stripped. A total area of 150,000 square feet was uncovered. Areas of outcrop exposure that warranted it were blasted and sampled. A total of 30 samples were taken.

RESULTS AND RECOMMENDATIONS

Results from the work done on The Morgan Extension Property (OP-97) can be termed as mildly encouraging. The work, from this OPAP and previous OPAP's (namely OP-95), has outlined that two parallel structures that have considerable length and contain areas of good gold deposition. Further mining companies will be made aware of this fact and hopefully now an option can be reached. I recommend no further OPAP funds be used for this property, as enough has been done from this and previous OPAP. Perhaps the high grade quartz veins can be mined on a smaller and personal level if no deal can be reached. I thank the OPAP for their funding help for this and other properties.

SAMPLES

SAMPLE #	TYPE	DESCRIPTION	ASSAY RESULTS Au (OZ./ TON)
1	rock	blue-grey quartz vein matter narrow seams of sericite-chlorite altered (metavolcanics within quartz, minor pyrite and arsenopyrite.)	0.001
2	rock	blue-grey quartz, pyrite in narrow seams and blotches, arsenopyrite blotches, sulphide content 2%.	0.084
3	rock	same as # 2 not in seams.	0.028
4	rock	dark greyish quartz, abundant arsenopyrite and pyrite with minor chalcopyrite, sulphide content 5%.	0.122
5	rock	whitish quartz with darker blue quartz with arsenopyrite rich seams, also abundant pyrite in both quartz types, 3-4 % sulphide.	0.153
6	rock	blue-grey quartz , disseminated arsenopyrite and pyrite, 3 % sulphide.	0.006
7	rock	same as # 6.	0.006
8	rock	blue-grey quartz with narrow seams of arsenopyrite, attached piece of dark grey quartz with mainly pyrite pyrrhite, 3 % sulphide.	0.037
9	rock	blue-grey quartz and darker grey quartz inclusions, mixture of pyrite, arsenopyrite and pyrite, 2-3 5 sulphide.	0.062
10	rock	dark greyish quartz, abundant pyrrhite with lesser arsenopyrite and pyrite, 3 % sulphide.	0.008
11	rock	sheared siliceous metavolcanics, minor pyrite and arsenopyrite.	0.001

12	rock	blue-grey quartz and highly siliceous, sheared metavolcanics, cross-cutting whitish quartz veinlets in volcanics, disseminated pyrite and pyrrhite, 1-2 % sulphide.	0.001
13	rock	same as # 12	0.001
14	rock	blue-grey quartz 1 % pyrrhite with minor arsenopyrite and pyrite.	0.001
15	rock	whitish, well fractured quartz, 1 % coarse pyrite.	0.001
16	rock	rusty, sheared metavolcanics, minor sulphide	0.001
17	rock	same as # 16.	0.001
18	rock	magnetite iron formation, massive magnetite, minor pyrite.	0.001
19	rock	same as # 18	0.001
20	rock	sheared, siliceous metavolcanics adjacent to iron formation, minor sulphide.	0.001
21	rock	sheared, gossaned, recrystallized quartz within mafic metavolcanics, narrow seams within quartz containing minor pyrite or possible magnetite.	0.003
22	rock	siliceous metavolcanics, minor sulphide.	0.001
23	rock	whitish well fractured quartz with minor chunks of adjacent wallrock, quartz rather barren, wallrock mineralized with pyrite and pyrrhite with minor chalcopyrite.	Lost sample
24	rock	banded, sugary, recrystallized quartz iron formation, 1 % magnetite, minor pyrite.	0.002
25	rock	same as # 24	0.006
26	rock	blue-grey quartz, disseminated pyrite and arsenopyrite, 2 % sulphide.	0.012
27	rock	same as # 26.	0.036
28	rock	whitish, well fractured quartz, minor pyrite and arsenopyrite.	0.001

29	rock	same as # 28	0.001
30	rock	highly gossaned, sheared, cooked metavolcanics.	0.001

JOBS CREATED

1. Mechanical stripping

F& M Contracting
Beardmore, On
100 hrs. - 10 days
\$ 75.00/hr.

EXPENDITURES

DATE	PAYEE	EXPLANATION	AMOUNT (\$)
Oct. 25/97- Nov. 5/97	F & M Contracting	Mechanical stripping 100 hrs. \$ 75.00/hr.	8 025.00
Oct. 25/97- Nov. 7/97	Herb G. Goodman	stripping, blasting, sampling, mapping	1 200.00
Oct. 25/97- Nov. 7/97	Herb G. Goodman	travel	18.00
Oct. 25/97- Nov. 7/97	Herb G. Goodman	food	120.00
Nov. 5 /97	Herbert K. Goodman	explosives	100.00
Nov. 10/97	Accurassay Labs	analysis	501.00
Nov. 13/97	Herb G. Goodman	report	300.00

TOTAL (\$) **10,264.00**

Morgan Extension Property
 North and South Zones
 Summers Township

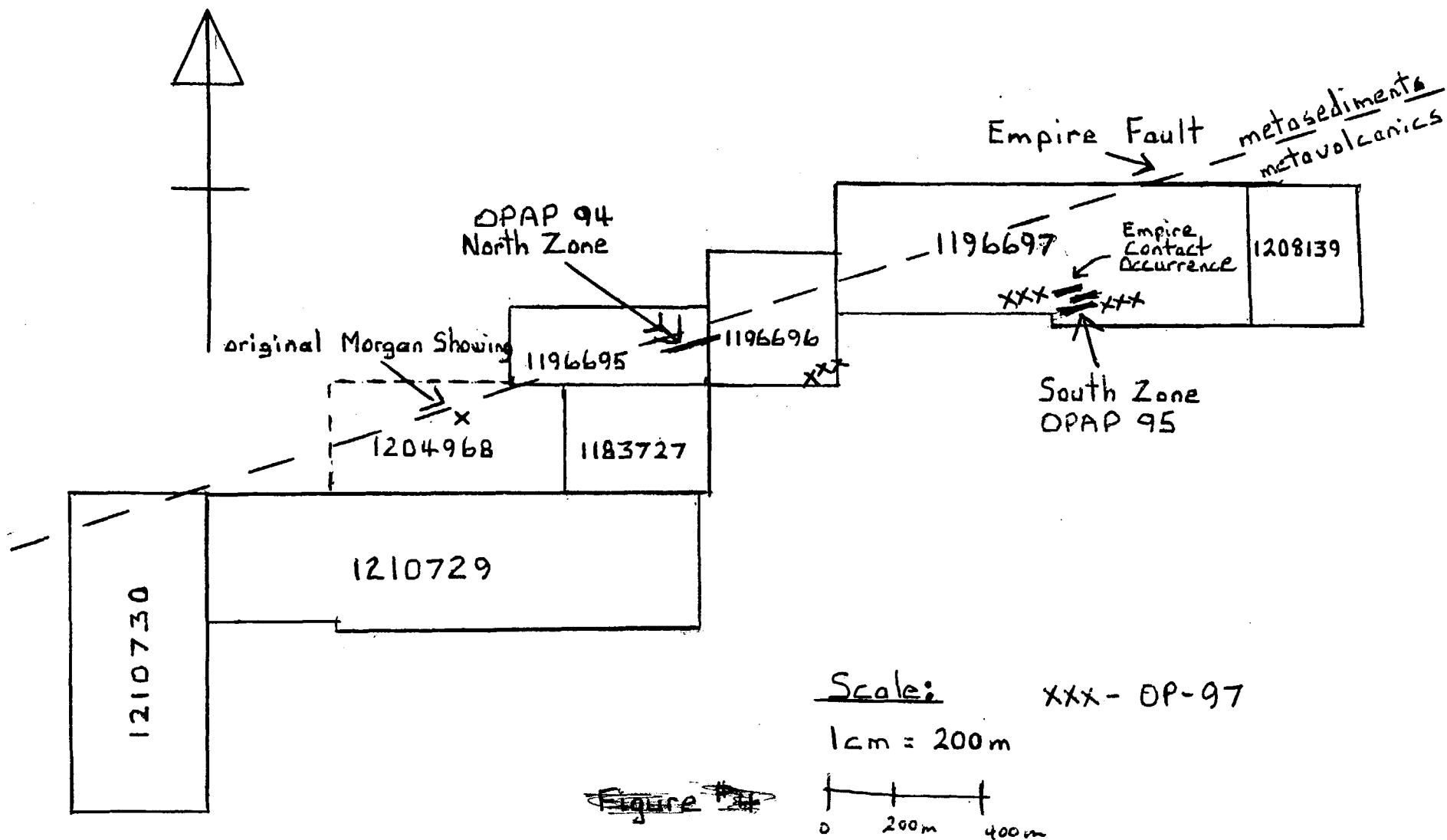

Morgan Extension Property
Summers Township
Area A

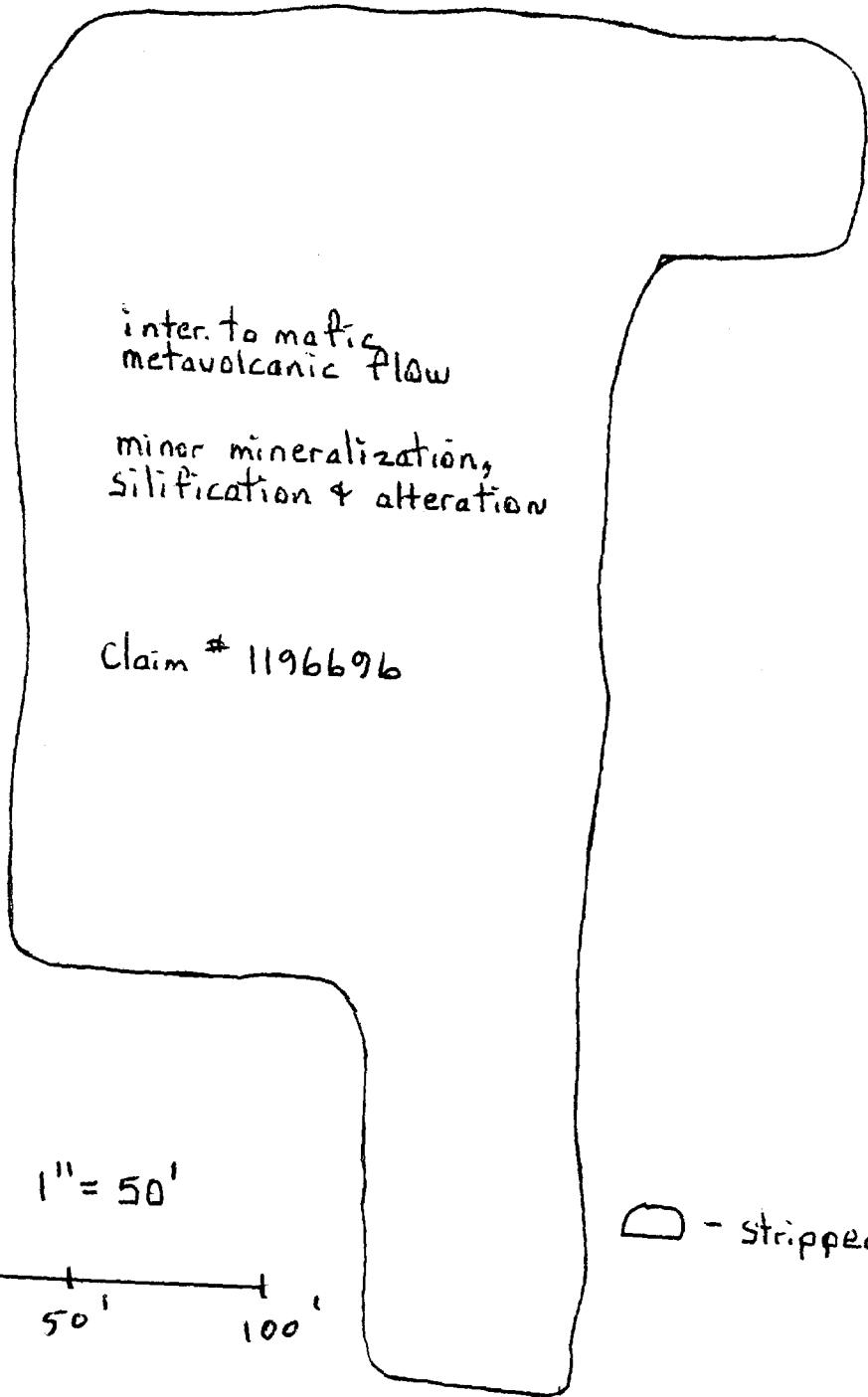



inter. to mafic
metavolcanic flow

minor mineralization,
silification & alteration

Claim # 1196696

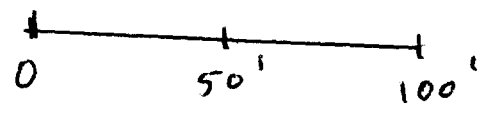
Scale: 1" = 50'



 - stripped area

Morgan Extension Property
Summers Township
Area B

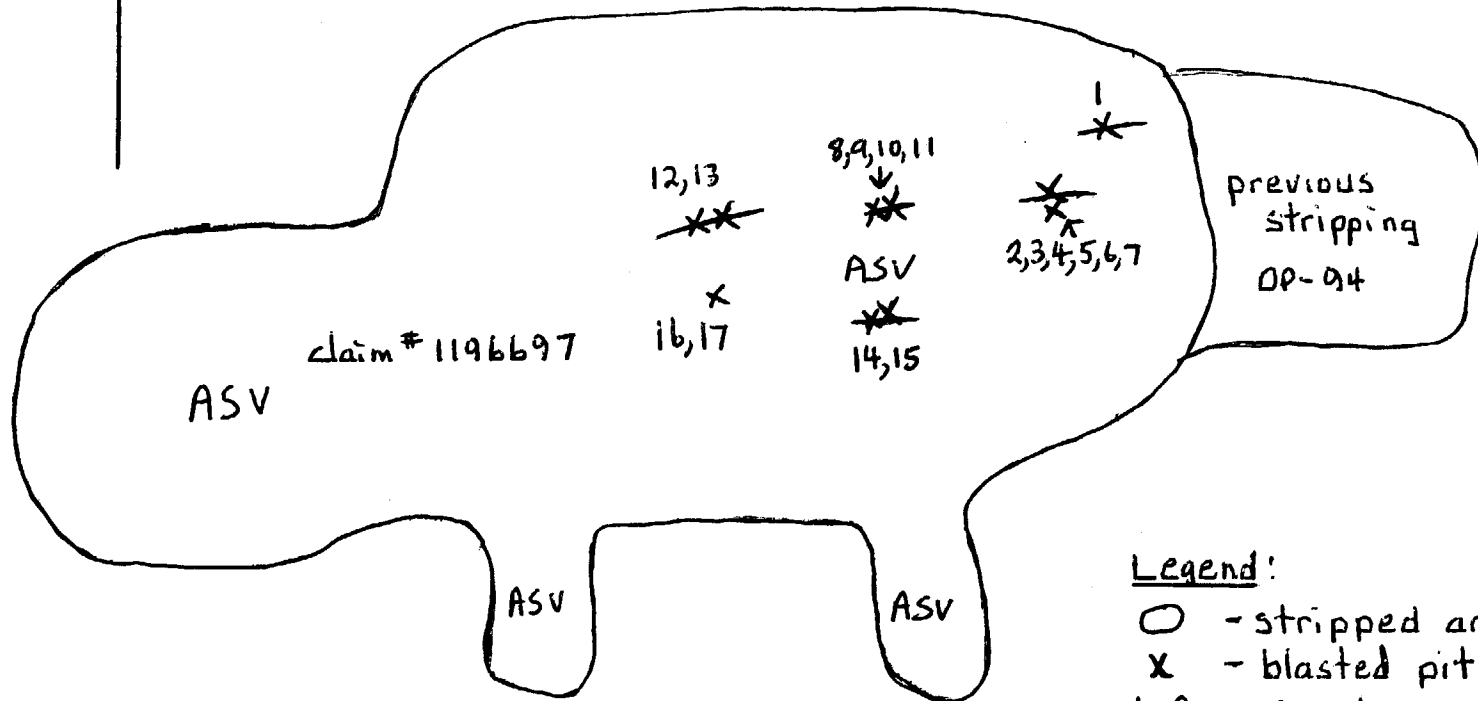
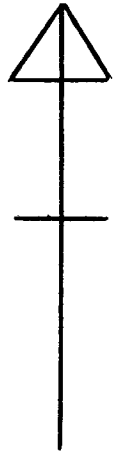

Legend:

- - stripped area
- X - blasted pit
- 1, 2 - sample number
- ASV - altered, siliceous vol's.
- - quartz vein or lense

Scale: 1" = 50'

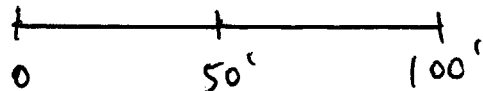

Morgan Extension Property
 Summers Township
 Area C

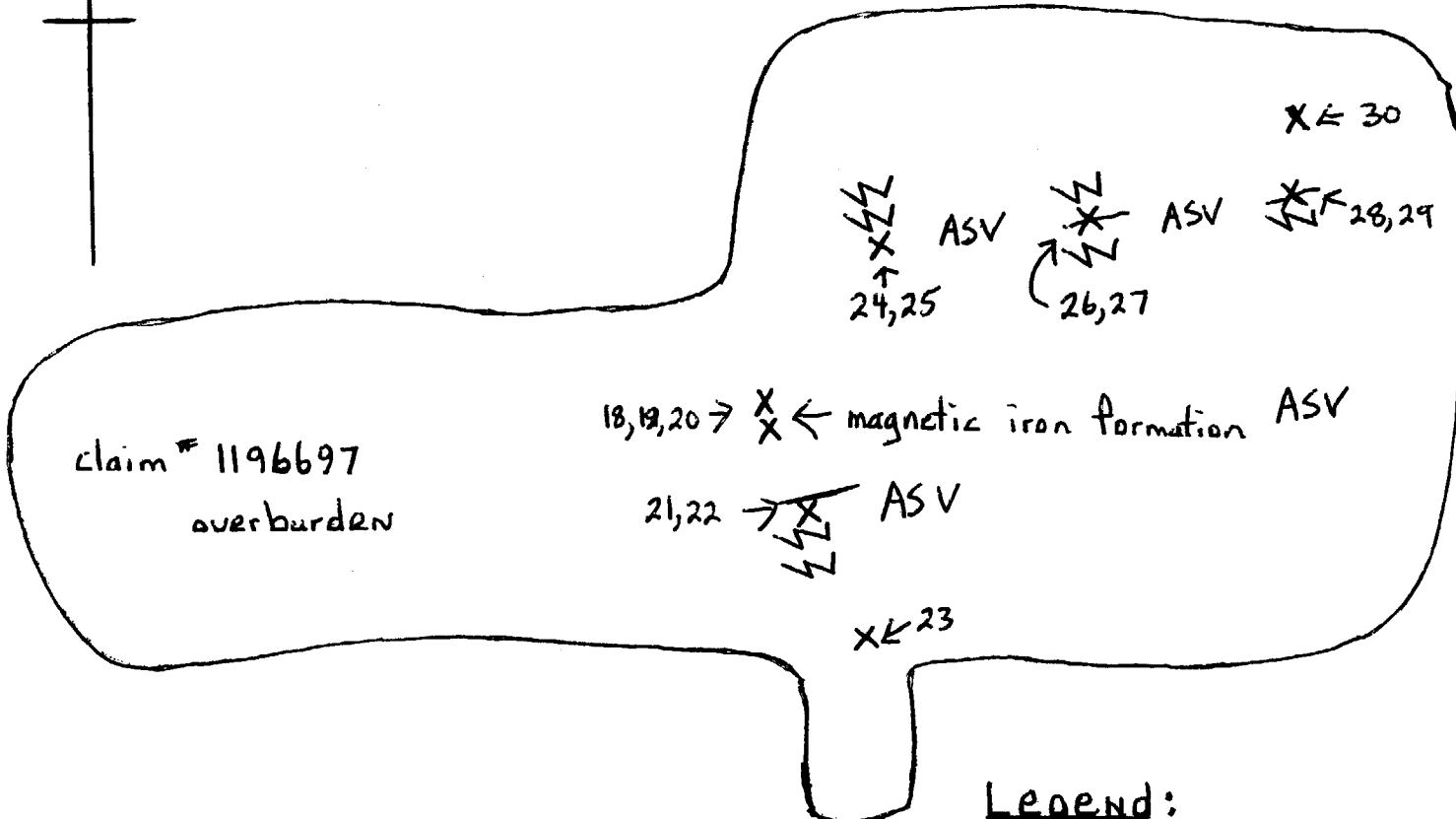

Scale: 1" = 50'

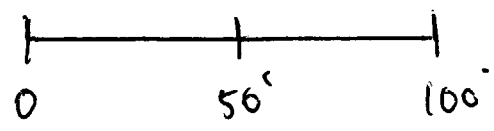

- Legend:**
- - stripped area
 - X - blasted pit
 - 1, 2 - sample number
 - ASV - altered, siliceous vol's
 - - quartz vein or lense
 - ∩ - shearing



ACCURASSAY LABORATORIES

A DIVISION OF ASSAY LABORATORY SERVICES INC.

1070 LITHIUM DRIVE, UNIT 2
THUNDER BAY, ONTARIO P7B 6G3
PHONE (807) 623-6448
FAX (807) 623-6820

Page 1

ERB GOODMAN
P.O. BOX 216
HEARDMORE, ONTARIO
K0T 1G0

Nov 11, 1997

Job# 9741024

Accurassay	SAMPLE # Customer	Gold ppb	Gold Oz/t
1	1	11	<0.001
2	2	2891	0.084
3	3	947	0.028
4	4	4166	0.122
5	5	5228	0.153
6	6	192	0.006
7	7	208	0.006
8	8	1272	0.037
9	9	2119	0.062
10	10	168	0.005
11 Check	10	267	0.008
12	11	21	<0.001
13	12	42	0.001
14	13	7	<0.001
15	14	<5	<0.001
16	15	<5	<0.001
17	16	7	<0.001
18	17	<5	<0.001
19	18	6	<0.001
20	19	11	<0.001
21 Check	19	11	<0.001
22	20	<5	<0.001
23	21	107	0.003
24	22	31	<0.001
25	23	SAMPLE NOT RECEIVED	
26	24	75	0.002
27	25	221	0.006
28	26	426	0.012
29	27	1245	0.036

Certified By: _____



ACCURASSAY LABORATORIES

A DIVISION OF ASSAY LABORATORY SERVICES INC.

1070 LITHIUM DRIVE, UNIT 2
THUNDER BAY, ONTARIO P7B 6G3
PHONE (807) 623-6448
FAX (807) 623-6820

Page 2

HERB GOODMAN
P.O. BOX 216
BEARDMORE, ONTARIO
P0T 1G0

Nov 11, 1997

Job# 9741024

Accurassay	SAMPLE # Customer		Gold ppb	Gold Oz/t
	30	28	9	<0.001
	31 Check	28	8	<0.001
	32	29	<5	<0.001
	33	30	19	<0.001
	34	30	7.8	0.002

Certified By: _____



Ministry of Northern Development and Mines

Declaration of Assessment Work Performed on Mining Land

Mining Act, Subsection 65(2) and 66(3), R.S.O. 1990

Transaction Number (office use) <i>W. 9844-00413</i>
Assessment Files Research Imaging

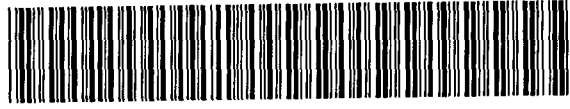

42E12SW2002 2.18413 SUMMERS

900

of subsections 65(2) and 66(3) of the Mining Act. Under section 8 of the to review the assessment work and correspond with the mining land holder. 1g Recorder, Ministry of Northern Development and Mines, 6th Floor.

Thunder Bay Mining Division

2.18413

APR 15 1998 *4:20 pm*

RECEIVED

Instructions: - For work performed on Crown Lands before recording a claim, use form 0240
- Please type or print in ink.

1. Recorded holder(s) (Attach a list if necessary)

Name <i>Herbert G. Goodman</i>	Client Number <i>138141</i>
Address <i>P.O. Box 216, 46 McKenzie St., Beardmore, On P0T1G0</i>	Telephone Number <i>807-875-2233</i>
	Fax Number
Name	Client Number
Address	Telephone Number
	Fax Number

RECORDED
APR 15 1998

2. Type of work performed: Check (✓) and report on only ONE of the following groups for this declaration.

Geotechnical: prospecting, surveys, assays and work under section 18 (regs) Physical: drilling, stripping, trenching and associated assays Rehabilitation

Work Type <i>stripping prospecting sampling</i>	Office Use
	Commodity
Dates Work Performed From <i>25 10 97</i> To <i>17 11 97</i>	Total \$ Value of Work Claimed <i>10,264</i>
Global Positioning System Data (if available)	NTS Reference
Township/Area <i>Summers</i>	Mining Division <i>Thunder Bay</i>
M or G-Plan Number <i>G-165</i>	Resident Geologist District <i>Thunder Bay</i>

Please remember to: - obtain a work permit from the Ministry of Natural Resources as required;
- provide proper notice to surface rights holders before starting work;
- complete and attach a Statement of Costs, form 0212;
- provide a map showing contiguous mining lands that are linked for assigning work;
- include two copies of your technical report.

3. Person or companies who prepared the technical report (Attach a list if necessary)

Name <i>Herb G. Goodman</i>	Telephone Number <i>807-875-2233</i>
Address <i>P.O. Box 216, Beardmore, On P0T1G0</i>	Fax Number
Name	Telephone Number
Address	Fax Number
Name	Telephone Number
Address	Fax Number

RECEIVED
APR 20 1998 *10 am*
GEOSCIENCE ASSESSMENT OFFICE

4. Certification by Recorded Holder or Agent

I, *Herb G. Goodman* (Print Name), do hereby certify that I have personal knowledge of the facts set forth in this Declaration of Assessment Work having caused the work to be performed or witnessed the same during or after its completion and, to the best of my knowledge, the annexed report is true.

Signature of Recorded Holder or Agent <i>Herb G. Goodman</i>	Date <i>April 15/98</i>
Agent's Address	Telephone Number <i>807-875-2233</i>
	Fax Number

D. 1 1 0.100 10.00

5. Work to be recorded and distributed. Work can only be assigned to claims that are contiguous (adjoining) to the mining land where work was performed, at the time work was performed. A map showing the contiguous link, must accompany this form.

W-9840-00403

Mining Claim Number: Or if work was done on other eligible mining land, show in this column the location number indicated on the claim map.	Number of Claim Units. For other mining land, list hectares.	Value of work performed on this claim or other mining land.	Value of work applied to this claim.	Value of work assigned to other mining claims.	Bank. Value of work to be distributed at a future date.
eg TB 7827	16 ha	\$26,825	N/A	\$24,000	\$2,825
eg 1234567	12	\$24,000		0	0
eg 1234568	2	\$8,892	\$4,000	0	\$4,892
1 1196697	3	10,264	2400	7864	
2 1210729			9600 7864	0	
3 1210730					
4					
5					
6					
7					
8					
9					
10					
11					
12					
13					
14					
15					
Column Totals		10,264	10,264	7864	0

I, _____, do hereby certify that the above work credits are eligible under subsection 7 (1) of the Assessment Work Regulation 6/96 for assignment to contiguous claims or for application to the claim where the work was done.

(Print Full Name)

Signature of Recorded Holder or Agent Authorized in Writing

Date

Paul G. Goodman

April 15 / 98

6. Instructions for cutting back credits that are not approved.

Some of the credits claimed in this declaration may be cut back. Please check (✓) in the boxes below to show how you wish to prioritize the deletion of credits:

- 1. Credits are to be cut back from the Bank first, followed by option 2 or 3 or 4 as indicated.
- 2. Credits are to be cut back starting with the claims listed last, working backwards; or
- 3. Credits are to be cut back equally over all claims listed in this declaration; or
- 4. Credits are to be cut back as prioritized on the attached appendix or as follows (describe):

Thunder Bay Mining Division

APR 15 1998

RECEIVED

RECEIVED
APR 20 1998
GEOSCIENCE ASSESSMENT OFFICE

Note: If you have not indicated how your credits are to be deleted, credits will be cut back from the Bank first, followed by option number 2 if necessary.

For Office Use Only

Received Stamp

RECORDED
APR 15 1998

Deemed Approved Date	Date Notification Sent
Date Approved	Total Value of Credit Approved
Approved for Recording by Mining Recorder (Signature)	

Geoscience Assessment Office
933 Ramsey Lake Road
6th Floor
Sudbury, Ontario
P3E 6B5

June 29, 1998

HERB GARRY GOODMAN
46 McKenzie St.
P.O. BOX 216
Beardmore, Ontario
P0T-1G0

Telephone: (888) 415-9846
Fax: (705) 670-5881

Visit our website at:
www.gov.on.ca/MNDM/MINES/LANDS/mlsmnpge.htm

Dear Sir or Madam:

Submission Number: 2.18413

Status

Subject: Transaction Number(s): W9840.00403 Deemed Approval

We have reviewed your Assessment Work submission with the above noted Transaction Number(s). The attached summary page(s) indicate the results of the review. **WE RECOMMEND YOU READ THIS SUMMARY FOR THE DETAILS PERTAINING TO YOUR ASSESSMENT WORK.**

If the status for a transaction is a 45 Day Notice, the summary will outline the reasons for the notice, and any steps you can take to remedy deficiencies. The 90-day deemed approval provision, subsection 6(7) of the Assessment Work Regulation, will no longer be in effect for assessment work which has received a 45 Day Notice. Allowable changes to your credit distribution can be made by contacting the Geoscience Assessment Office within this 45 Day period, otherwise assessment credit will be cut back and distributed as outlined in Section #6 of the Declaration of Assessment work form.

Please note any revisions must be submitted in DUPLICATE to the Geoscience Assessment Office, by the response date on the summary.

If you have any questions regarding this correspondence, please contact Steve Beneteau by e-mail at benetest@epo.gov.on.ca or by telephone at (705) 670-5855.

Yours sincerely,



ORIGINAL SIGNED BY
Blair Kite
Supervisor, Geoscience Assessment Office
Mining Lands Section

Work Report Assessment Results

Submission Number: 2.18413

Date Correspondence Sent: June 29, 1998

Assessor: Steve Beneteau

Transaction Number	First Claim Number	Township(s) / Area(s)	Status	Approval Date
W9840.00403	1196697	SUMMERS	Deemed Approval	June 23, 1998

Section:

10 Physical PSTRIIP

Correspondence to:

Resident Geologist
Thunder Bay, ON

Recorded Holder(s) and/or Agent(s):

HERB GARRY GOODMAN
Beardmore, Ontario

Assessment Files Library
Sudbury, ON

AREAS WITHDRAWN FROM DISPOSITION

- M.R.O. - MINING RIGHTS ONLY
- S.R.O. - SURFACE RIGHTS ONLY
- M.+S. - MINING AND SURFACE RIGHTS

Description	Order No.	Date	Disposition	File
Withdrawn from staking A178 Parcel 104				59262
Withdrawn from staking Sect. 42 (R.S.O. '80) of the Mining Act				59409
Withdrawn from staking				

Surface rights only withdrawn from staking order W-78-56/93 NWR 93/05/97 to accommodate a 400 acre storage facility for MDM.

NOTICE:
The information that appears on this map has been compiled from various sources and accuracy is not guaranteed. Those wishing to stake MINING CLAIMS should consult with the MINING RECORDER, Ministry of Northern Development and Mines, for additional information on the status of the lands shown hereon.

SANDRA TOWNSHIP

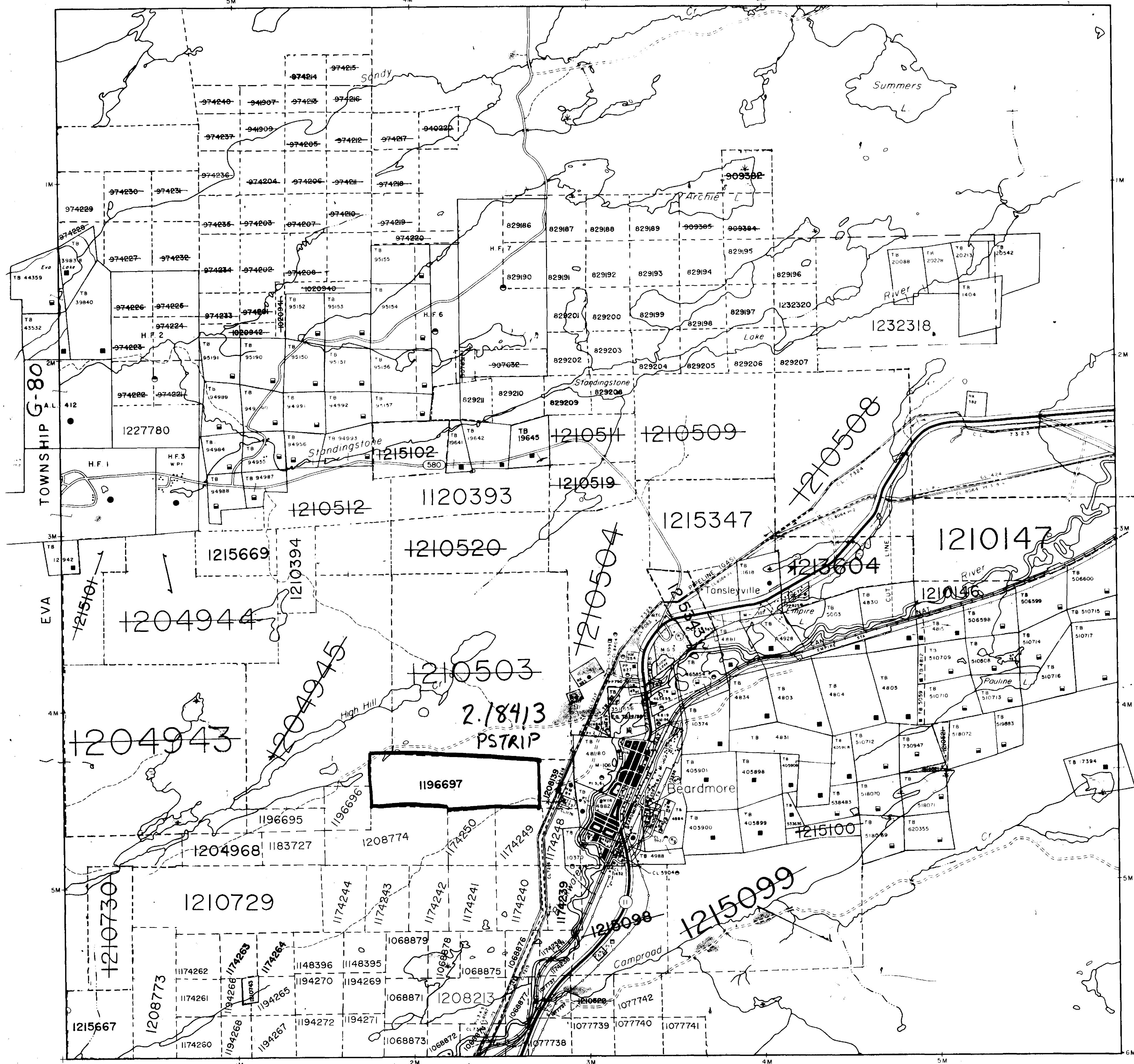

BEARDMORE AREA

LEGEND

- HIGHWAY AND ROUTE NO.
- OTHER ROAD
- TRAIL
- SURVEYED LINES
- TOWNSHIP, RANGE LINES, ETC.
- 100% MINING CLAIM, PATENT, ETC.
- MINING CLAIMS
- PARCEL BOUNDARY
- MINE CLAIMS, ETC.
- RAILWAY AND RIGHT OF WAY
- STREET LINES
- NON-PERMANENT STREAM
- FLOODING OR FLOODING RIGHTS
- SUBDIVISION OR COMPOSITE PLAN
- RESERVATIONS
- ORIGINAL SHORELINE
- MAHSH OR MUSKEG
- MINES
- TRAVERSE MONUMENT

DISPOSITION OF CROWN LANDS

TYPE OF DOCUMENT	SYMBOL
PATENT, SURFACE & MINING RIGHTS	●
SURFACE RIGHTS ONLY	○
MINING RIGHTS ONLY	◐
LEASE, SURFACE & MINING RIGHTS	◑
SURFACE RIGHTS ONLY	◒
MINING RIGHTS ONLY	◓
LICENCE OF OCCUPATION	◔
ORDER IN COUNCIL	○
RESERVATION	○
CANCELLED	○
SAND & GRAVEL	○

LAND USE PERMITS FOR COMMERCIAL TOURISM, OUTPOST CAMPS
NOTE: MINING RIGHTS IN PARCELS PATENTED PRIOR TO 1913 & 1913 VESTED IN ORIGINAL PATENTEE BY THE PUBLIC LANDS ACT, R.S.O. 1910, CHAP. 180, SEC. 63, SUBSEC. 1.

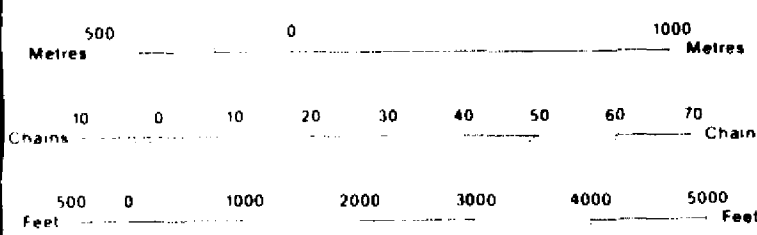

SCALE 1:20 000

THE SURFACE RIGHTS LYING WITHIN 40.25 M. OF THE CENTRE-LINE OF THE TRANS-CANADA PIPELINE RIGHT-OF-WAY ARE WITHDRAWN FROM STAKING OUT, PROSPECTING, SALE OR LEASE BY ORDER W01/91/JWT, DATED SEPT. 20, 1991. SECTION 82 OF THE NATIONAL ENERGY ACT APPLIES TO THIS AREA.

DATE OF ISSUE

JUN 26 1998

PROVINCIAL RECORDING OFFICE SUBURBY

TOWNSHIP SUMMERS

M.N.R. ADMINISTRATIVE DISTRICT
NIPIGON
MINING DIVISION
THUNDER BAY
LAND TITLES / REGISTRY DIVISION
THUNDER BAY

Ministry of Natural Resources Ontario
Ministry of Northern Development and Mines

Date: SEPTEMBER, 1986
Number: **G-165**
In Service Dec. 22/94.

