

ONTARIO PROSPECTORS ASSISTANCE PROGRAM (OPAP) FINAL SUBMISSION FORM 1998

42E13SE2008 2.19405 ELMHIRST 010



INSTRUCTIONS : Please read the guidebook before completing form
Please type or print
Submit completed form and supporting documentation by February 1, 1999 to:
OPAP, Mines Group
Ministry of Northern Development and Mines
4th floor, 933 Ramsey Lake Road, Sudbury, Ontario P3E 6B5

To be completed by successful grantees after completion of project(s) and accompanied by 2 copies of all reports and maps for each project including recent copies of claim maps with area(s) of work outlined.

****Attach your receipts to this form when you have completed it. Submit this form and attached receipts separately from your technical reports.****

Applicant FRANK HOUGHTON File Number OP98-105

Proposed project area(s) (Twp. or claim name, latitude and longitude) MUD LAKE ALL-PROPERTY
Completed?
1. ELMHIRST TWP. G-162 LAT. 49° 46' 20" LONG. 87° 39' (Yes) No
2. _____ Yes No

Changes to proposed project(s) (if any)

List other co-owners of the property with OPAP grants that worked on project
PHILIP HOUGHTON OP98-107
LEROY CLARKE OP98-106

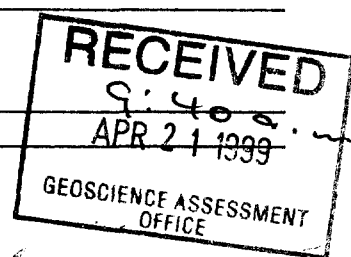

I. WORK PERFORMED BY APPLICANT (Summary of Section IV)

1. Project #1 area/name	<u>MUD LAKE ALL PROPERTY</u>	No. days worked by applicant	
Traditional prospecting	No. of samples <u>25</u>		<u>25</u>
Geological surveys	Scale _____		
Geophysical surveys	Type _____ Miles/km _____		
Geochemical surveys	Type _____ # of samples _____		
Drilling	Type _____ Ft./m _____		
Stripping/Trenching	Method <u>DOZER + BACKHOLE</u>		<u>10</u>
Other	Type <u>POWER WASHING, DRILLING + BLASTING</u>		<u>12</u>
	Report _____		<u>3</u>
TOTAL			<u>50</u>

Form filled out by Applicant Other (please specify) _____
Report filled out by Applicant Other (please specify) _____

I. WORK PERFORMED BY APPLICANT (continued))

2. Project #2 area/name _____	No. days worked by applicant _____
Traditional prospecting No. of samples _____	_____
Geological surveys Scale _____	_____
Geophysical surveys Type _____ Miles/km _____	_____
Geochemical surveys Type _____ # of samples _____	_____
Drilling Type _____ Ft./m _____	_____
Stripping/Trenching Method _____	_____
Other Type _____	_____
TOTAL _____	

TOTAL DAYS (ALL PROJECTS) A. _____
 (Attach additional sheets for additional project areas as required)

II. EXPENDITURES (total of all projects) – Summary of I and II

1. Number of working days by applicant (A) x \$100/day <u>47</u>	\$ <u>4700.00</u>
2. Number of report preparation days by applicant x \$100/day <u>3</u>	\$ <u>300.00</u>
3. Analyses/Assay costs.....	\$ _____
4. Equipment rentals <u>3X4 BIV 20.00/0.05 \$ 400.00</u> <u>BACIA HOE 75.00/hr \$ 2775.00</u> <u>D7 DOZER 80.00/hr \$ 1360.00</u>	\$ <u>5225.70</u>
5. Consumable Supplies <u>657.289.15</u> <u>Float 401.25</u>	\$ _____
6. Contract services (state type) \$ _____ \$ _____	\$ _____
# of workers _____ # of mandays worked _____	
7. Travel (state method: road, air, etc.) <u>ROAD. 4136 km \$ 1240.80</u>	\$ <u>1240.80</u>
8. Food and Accommodation	\$ _____
9. Other expenses (specify, e.g. typing, printing, shipping of supplies) \$ _____ \$ _____	\$ _____
10. Helpers # of helpers <u>1</u> # of mandays worked _____	\$ _____
TOTAL EXPENDITURES \$ <u>11,466.50</u>	

IV. DAILY REPORTS (Summarize work activity in Section I)

Day	Project Area	Date	Work Performed
1	ELMHIRST TWP. ^{MUD LK} PROPERTY	MAY 16 th 1998	PROSPECTING
2	" " "	17 th	" "
3	" " "	18 th	" "
4	" " "	19 th	" "
5	" " "	20 th	" "
6	" " "	21	CLEAN OUT OLD PITS, CUT CONTROL LINE.
7	" " "	22	" " "
8	" " "	23	" " "
9	" " "	24	" " "
10	" " "	25	" " "
11	" " "	26	PROSPECTING
12	" " "	27	" "
13	" " "	28	" "
14	" " "	29	" "
15	" " "	30	" "
16	ELMHIRST TWP ^{MUD LK} PROPERTY	JUNE 1 st	PROSPECTING, LINE CUT, CLEAN OUT OLD PITS
17	" " "	2	" " "
18	" " "	3	" " "
19	" " "	4	" " "
20	" " "	5	" " "
21	" " "	6	PROSPECTING
22	" " "	7	" "
23	" " "	8	" "
24	" " "	9	" "
25	" " "	10	" "
26	" " "	JUNE 28	MECHANICAL STRIPPING
27	" " "	29	" "
28	" " "	30	" "
29	" " "	JULY 1	" "
30	" " "	2	" "
31	" " "	6	" "
32	" " "	7	" "
33	" " "	8	" "
34	" " "	9	" "
35	" " "	10	" "
36	" " "	JULY 11	POWER WASHING + DRILLING + BLASTING
37	" " "	12	" " "
38	" " "	13	" " "
39	" " "	14	" " "
40	" " "	15	" " "
41	" " "	16	" " "
42	" " "	17	" " "

(Attach additional sheets as required)

<u>Day</u>	<u>Prospect area</u>	<u>Date</u>	<u>Work Performed</u>
43	Elmhirst Twp Mud Lake Property	July 20	Power washing, drilling, blasting
44	“ ”	21	“ ”
45	“ ”	22	“ ”
46	“ ”	23	“ ”
47	“ ”	24	“ ”
48	“ ”	Jan. 9	Report
49	“ ”	10	“ ”
50	“ ”	11	“ ”

2 . 1945

Reçu de
Received from FRANK HOUGHTON JULY 30 19 98

Four Hundred 00 100 Dollars
4x4 ATV Rental

GLENN ENDERS
\$ 400.00 No. Glenn Enders

No. d'enrg. taxe
Tax Reg. No:

2.19405

F + M Contracting

P.O. Box 123

Beardmore Ont.

POT 160

807-875-2329

TAX REG. NO.

SOLD TO

F HOUGHTON

SHIP TO

Elmhurst Twp.

ADDRESS

Bulldozer + Backhoe Rental

OUR NUMBER	29741
DATE	10 July 98
CUSTOMER'S ORDER	
SALESMAN	
TERMS	
F.O.B.	

INVOICE

QUANTITY	DESCRIPTION	PRICE	AMOUNT
076	Bulldozer		
0676'	8'0		
0776'	9'0		
	17.0 hrs @ \$80/hr		1360 00
	Backhoe Rental		775 00
0676'	8'0		
0776'	9'0		
	657 R 122 485311		789 45
08"	8'0		
09"	4'0		
10"	8'0		
	Total Owning		4424 45
	37.0 hrs @ \$75/hr		

BLUENINE D 31

2.19405

Partial
July 14/98
Cheque # 257

STATEMENT / ÉTAT DE COMPTE

July 6 19 98

Mr. Frank Houghton

In Account With
Doit A

Lavalley & Sons

DATE	DESCRIPTION	INVOICE #, PARTICULARS, ETC. NUMÉRO DE FACTURE, PARTICULARITÉS, ETC.	DEBIT DÉBIT	CREDIT CRÉDIT
July 5/98	Flooded Backhoe & Dozer 5hrs			375 ⁰⁰
		gst		26 ²⁵
		Paid July 7/98 cheque # 245		

TERMS / CONDITIONS

BALANCE 401 25

BALANCE PAST DUE
BALANCE PASSÉ DUE

2 19 98

V. SIGNIFICANT RESULTS (please complete)

Project Area	New Showings and/or Anomalies	Commodity	Best Analyses GRAM/TONNE
<u>ELMHIRST TWP</u>	<u>3</u>	<u>GOLD</u>	<u>9.87, 20.06, 66.86,</u> <u>58.85, 18.52, 33.98</u>
			<u>BY M.N.D.M. -- 33.0, 42.0</u>

} OF APPLICANTS

VI. CLAIMS STAKED DURING/AFTER PROSPECTING ACTIVITY (please complete)

Project Area	Claim Numbers	Number of Claim Units
<u>ADDITIONAL CLAIMS TO BE STAKED IN THE SPRING.</u>		

VII. OPTION AGREEMENT RESULTING FROM OPAP PROJECT (please complete)

Optionee	Property/Claims	Work Commitment
<u>UNDER NEGOTIATION WITH A.D.P. EXPLORATIONS.</u>		

The Ministry of Northern Development and Mines may verify all statements related to and made herein this application.

1. I am the person named in the Final Submission form under the Ontario Prospectors Assistance Program.
2. I am ordinarily a resident of Canada.
3. I have complied with all requirements of the said program.
4. I understand that it is an offence under the Ontario Mineral Exploration Program Act, R.S.O. 1990, to make a false or misleading statement and that all statements and all other information submitted in support of the said application are true and correct.
5. I was not employed by the Mines and Minerals Division of the Ministry while in receipt of an OPAP grant.
6. I am aware that any other Provincial or Federal Government financial assistance received for the said application will be deducted from the amount of incurred "Total Eligible Expenses".

It is an Offence under subsection 8(1)(A) of the Ontario Mineral Exploration Program Act, R.S.O. 1990 to knowingly furnish false or misleading information.

Personal information collected on this form is obtained under the authority of the Ontario Mineral Exploration Program Act, R.S.O. 1990, Sections 2, 3 and 4 and the Ontario Prospectors Assistance Program Regulation, sections 4, 5 and 6. It will be used for the purpose of determining the eligibility of the applicant to have a program designated for financial assistance. It may be disclosed for this purpose and I consent to its disclosure for such a purpose. Questions about this collection should be directed to Senior Manager, Mines Group, Ministry of Northern Development and Mines, 4th floor, 933 Ramsey Lake Road, Sudbury, Ontario P3E 6B5, Toll free 1-800-265-0834.

Signature of Applicant Frank Houghton Date JAN 15 1999

Name (print) FRANK HOUGHTON

**ONTARIO PROSPECTORS ASSISTANCE PROGRAM (OPAP)
FINAL SUBMISSION FORM 1998**

42E13SE2008 2.19405 ELMHIRST



020

INSTRUCTIONS : Please read the guidebook before completing form
Please type or print
Submit completed form and supporting documentation by February 1, 1999 to:
OPAP, Mines Group
Ministry of Northern Development and Mines
4th floor, 933 Ramsey Lake Road, Sudbury, Ontario P3E 6B5

To be completed by successful grantees after completion of project(s) and accompanied by 2 copies of all reports and maps for each project including recent copies of claim maps with area(s) of work outlined.

****Attach your receipts to this form when you have completed it. Submit this form and attached receipts separately from your technical reports.****

Applicant LEROY CLARKIE File Number OP98-106

Proposed project area(s) (Twp. or claim name, latitude and longitude) MUD LAKE AD. PROPERTY

1. <u>ELMHIRST TWP. 6-162 LAT. 49° 46' 20" LONG. 87° 39'</u>	<input checked="" type="checkbox"/> Yes	<input checked="" type="checkbox"/> No
2. _____	<input type="checkbox"/> Yes	<input type="checkbox"/> No

Changes to proposed project(s) (if any)

List other co-owners of the property with OPAP grants that worked on project

FRANK HOUGHTON OP98-105

PHILIP HOUGHTON OP98-107

I. WORK PERFORMED BY APPLICANT (Summary of Section IV)

1. Project #1 area/name	<u>MUD LAKE AD. PROPERTY</u>	No. days worked by applicant
Traditional prospecting	No. of samples <u>25</u>	<u>25</u>
Geological surveys	Scale _____	_____
Geophysical surveys	Type _____ Miles/km	_____
Geochemical surveys	Type _____ # of samples	_____
Drilling	Type _____ Ft./m	_____
Stripping/Trenching	Method <u>DOZER, BACKHOE</u>	<u>10</u>
Other	Type <u>POWER WASHING, DRILLING, BLASTING</u>	<u>12</u>
	<u>REPORT</u>	<u>3</u>
	TOTAL	<u>50</u>

Form filled out by Applicant Other (please specify) _____

Report filled out by Applicant Other (please specify) _____

I. WORK PERFORMED BY APPLICANT (continued))

2. Project #2 area/name _____	No. days worked by applicant _____
Traditional prospecting No. of samples _____	_____
Geological surveys Scale _____	_____
Geophysical surveys Type _____ Miles/km _____	_____
Geochemical surveys Type _____ # of samples _____	_____
Drilling Type _____ Ft./m _____	_____
Stripping/Trenching Method _____	_____
Other Type _____	_____
TOTAL _____	

TOTAL DAYS (ALL PROJECTS) A. _____
 (Attach additional sheets for additional project areas as required)

II. EXPENDITURES (total of all projects) – Summary of I and II

1. Number of working days by applicant (A) x \$100/day <u>47</u>		\$ <u>4700.00</u>
2. Number of report preparation days by applicant x \$100/day <u>3</u>		\$ <u>300.00</u>
3. Analyses/Assay costs..... <u>60 SAMPLES</u>		\$ <u>785.31</u>
4. Equipment rentals <u>BACK HOE @ 15.00/HR.</u> \$ <u>3798.50</u> <u>INCLUDING FLOAT</u> \$ _____		\$ <u>3798.50</u>
5. Consumable Supplies		\$ _____
6. Contract services (state type) \$ _____ \$ _____		\$ _____
# of workers _____ # of mandays worked _____		
7. Travel (state method: road, air, etc.) <u>ROAD 4136 KM</u> \$ <u>1240.80</u> \$ _____		\$ <u>1240.80</u>
8. Food and Accommodation		\$ _____
9. Other expenses (specify, e.g. typing, printing, shipping of supplies) <u>MAP PHOTO CORRECT</u> \$ <u>85.00</u> <u>Typing</u> \$ <u>130.00</u>		\$ <u>215.00</u>
10. Helpers # of helpers _____ # of mandays worked _____		\$ _____
TOTAL EXPENDITURES		\$ <u>11,032.11</u>

IV. DAILY REPORTS (Summarize work activity in Section I)

Day	Project Area	Date	Work Performed
1			
2			
3			
4			
5			
6			
7			
8			
9			
10			
11			
12			
13			
14			
15			
16			
17			
18			
19			
20			
21			
22			
23			
24			
25			
26			
27			
28			
29			
30			
31			
32			
33			
34			
35			
36			
37			
38			
39			
40			
41			
42			

(Attach additional sheets as required)

IV. DAILY REPORTS (Summarize work activity in Section I)

Day	Project Area	Date	Work Performed
1	ELMHIRST TWP. ^{MUD LK} PROPERTY	MAY 16 th 1998	PROSPECTING
2	" " "	17 th	"
3	" " "	18 th	"
4	" " "	19 th	"
5	" " "	20 th	"
6	" " "	21	CLEAN OUT OLD PITS, CUT CONTROL LINE.
7	" " "	22	" " "
8	" " "	23	" " "
9	" " "	24	" " "
10	" " "	25	" " "
11	" " "	26	PROSPECTING
12	" " "	27	"
13	" " "	28	"
14	" " "	29	"
15	" " "	30	"
16	ELMHIRST TWP ^{MUD LK} PROPERTY	JUNE 1 st	PROSPECTING, LINE CUT, CLEAN OUT OLD V
17	" " "	2	" " "
18	" " "	3	" " "
19	" " "	4	" " "
20	" " "	5	" " "
21	" " "	6	PROSPECTING
22	" " "	7	"
23	" " "	8	"
24	" " "	9	"
25	" " "	10	"
26	" " "	JUNE 28	MECHANICAL STRIPPING
27	" " "	29	" "
28	" " "	30	" "
29	" " "	JULY 1	" "
30	" " "	2	" "
31	" " "	6	" "
32	" " "	7	" "
33	" " "	8	" "
34	" " "	9	" "
35	" " "	10	" "
36		JULY 11	POWER WASHING + DRILLING + Blasting
37		12	" " "
38		13	" " "
39		14	" " "
40		15	" " "
41		16	" " "
42		17	" " "

(Attach additional sheets as required)

DAY	PROJECT AREA	MUD LAISE PROPERTY	DATE	WORK PERFORMED
43	ELMHIRST TWP		July 20	Power washing, drilling, blasting
44	"	"	21	" " " "
45	"	"	22	" " " "
46	"	"	23	" " " "
47	"	"	24	" " " "
48	"	"	JAN. 9	REPORT
49	"	"	10	"
50	"	"	11	"

V. SIGNIFICANT RESULTS (please complete)

Project Area	New Showings and/or Anomalies	Commodity	Best Analyses GRAM/TONNE
ELMHIRST TWP	3	GOLD	9.87, 20.06, 66.86, 58.85, 18.52, 33.98
			BY M.N.D.M. 33.0, 42.0

} OF APPLICANT

VI. CLAIMS STAKED DURING/AFTER PROSPECTING ACTIVITY (please complete)

Project Area	Claim Numbers	Number of Claim Units
ADDITIONAL GROUND TO BE STAKED IN THE SPRING.		

VII. OPTION AGREEMENT RESULTING FROM OPAP PROJECT (please complete)

Optionee	Property/Claims	Work Commitment
UNDER NEGOTIATION WITH A.D.R. EXPLORATIONS.		

The Ministry of Northern Development and Mines may verify all statements related to and made herein this application.

- I am the person named in the Final Submission form under the Ontario Prospectors Assistance Program.
- I am ordinarily a resident of Canada.
- I have complied with all requirements of the said program.
- I understand that it is an offence under the Ontario Mineral Exploration Program Act, R.S.O. 1990, to make a false or misleading statement and that all statements and all other information submitted in support of the said application are true and correct.
- I was not employed by the Mines and Minerals Division of the Ministry while in receipt of an OPAP grant.
- I am aware that any other Provincial or Federal Government financial assistance received for the said application will be deducted from the amount of incurred "Total Eligible Expenses".

It is an Offence under subsection 8(1)(A) of the Ontario Mineral Exploration Program Act, R.S.O. 1990 to knowingly furnish false or misleading information.

Personal information collected on this form is obtained under the authority of the Ontario Mineral Exploration Program Act, R.S.O. 1990, Sections 2, 3 and 4 and the Ontario Prospectors Assistance Program Regulation, sections 4, 5 and 6. It will be used for the purpose of determining the eligibility of the applicant to have a program designated for financial assistance. It may be disclosed for this purpose and I consent to its disclosure for such a purpose. Questions about this collection should be directed to Senior Manager, Mines Group, Ministry of Northern Development and Mines, 4th floor, 933 Ramsey Lake Road, Sudbury, Ontario P3E 6B5, Toll free 1-800-265-0834.

Signature of Applicant Leroy Clarke Date June 15th 1999
 Name (print) LEROY CLARKE

Leroy

OP98-106 WORK SUMMARY AND COSTS

PROSPECTING: MAY 16-30th 15 DAYS @ 100.00 = \$ 1500.00
JUNE 1-10th 10 DAYS @ 100.00 = 1000.00

Mechanical stripping JUNE 28-30th 3 DAYS @ 100.00 300.00
JULY 1-2 2 DAYS @ 100.00 200.00
JULY 6-10th 5 DAYS @ 100.00 500.00

Power washing, Drilling, Blasting JULY 11-17 7 days @ 100.00 700.00
JULY 20-24 5 days @ 100.00 500.00

EQUIPMENT RENTAL: BACKHOE
JUNE 28-30 28 hrs. @ 75.00 = 2100.00
JULY 1-2 14 hrs @ 75.00 1050.00
FLOAT 400.00
GST 248.50

Typing x photocopying 215.00

ASSAY COSTS 785.31

TRAVEL 4136 KM @ 30¢ KM = 1240.80

REPORT: JAN 9-11 3 DAYS @ 100.00 300.00

TOTAL 11,032.11

LEROY CHARKE OP98-106

Leroy Clarke

APRIL 12/99

JAN. 20 / 99

RECEIVED FROM LEROY CLARKE, ONE HUNDRED THIRTY
DOLLARS \$130.00 FOR TYPING SERVICES CP98-106

SHEENA HOUGHTON

Sheena Houghton

JAN. 20 / 99

RECEIVED FROM LEROY CLARKE, ONE HUNDRED THIRTY
DOLLARS \$130.00 FOR TYPING SERVICES

SHEENA HOUGHTON

Sheena Houghton.

JAN. 20 / 99

RECEIVED FROM LEROY CLARKE, ONE HUNDRED THIRTY

DOLLARS \$130.00 FOR TYPING SERVICES

SHEENA HOUGHTON

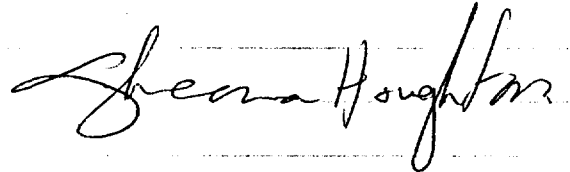
A handwritten signature in cursive script that reads "Sheena Houghton". The signature is written in black ink and is positioned below the printed name.

F+M Contracting
 P.O. Box 123
 Beardmore Ont.
 P0T160

INVOICE

OUR NUMBER	947508
DATE	04 Jul 98
CUSTOMER'S ORDER	

SOLD TO	F Houghton
ADDRESS	Beardmore Ont. Mud Lake Prospect.

SHIP TO	
ADDRESS	

TAX REG. NO.	SALESMAN	F.O.B.	TERMS	VIA
--------------	----------	--------	-------	-----

QUANTITY	DESCRIPTION	PRICE	AMOUNT
	Mechanical Stripping Backhoe Rental MS 120 Backhoe		
28 June 10.0			
29 June 10.0			
30 June 8.0			
01 Jul 8.0			
02 Jul 6.0			
	42.0 hrs @ \$75/hr		\$ 3150.00
	Float charges to + from worksite		400.00
	GST R 122385411		248.50
	Paid in Full FAC		3798.50

F + M Contracting
 P.O. Box 123
 Beardmore Ont
 P0T1B0

INVOICE

OUR NUMBER	947508
DATE	04 Jul 98
CUSTOMER'S ORDER	

SOLD TO	F Houghton
ADDRESS	Beardmore Ont Mud Lake Prospect.

SHIP TO	
ADDRESS	

TAX REG. NO.	SALESMAN	F.O.B	TERMS	VIA
--------------	----------	-------	-------	-----

QUANTITY	DESCRIPTION	PRICE	AMOUNT
	Mechanical Stripping Backhoe Rental MS 120 Backhoe		
28 June 10.0			
29 June 10.0			
30 June 8.0			
01 Jul 8.0			
02 Jul 6.0			
	42.0 hrs @ \$75/hr		\$ 3150.00
	Floot charges to + from worksite		400.00
	GST R 122385411		248.50
	Paid in Full A/C		3798.50

**ONTARIO PROSPECTORS ASSISTANCE PROGRAM (OPAP)
FINAL SUBMISSION FORM 1998**

42E135E2008 2.19405 ELMHIRST



030

INSTRUCTIONS: Please read the guidebook before completing form

Please type or print

Submit completed form and supporting documentation by February 1, 1999 to:

OPAP, Mines Group

Ministry of Northern Development and Mines

4th floor, 933 Ramsey Lake Road, Sudbury, Ontario P3E 6B5

To be completed by successful grantees after completion of project(s) and accompanied by 2 copies of all reports and maps for each project including recent copies of claim maps with area(s) of work outlined.

****Attach your receipts to this form when you have completed it. Submit this form and attached receipts separately from your technical reports.****

Applicant PHILIP HOULTON File Number OP98-107

Proposed project area(s) (Twp. or claim name, latitude and longitude)

1. <u>ELMHIRST TWP. 6-162 LAT. 49°46'20" LONG. 87°39'</u>	Completed?
	<input checked="" type="checkbox"/> Yes <input type="checkbox"/> No
2. _____	<input type="checkbox"/> Yes <input type="checkbox"/> No

Changes to proposed project(s) (if any)

List other co-owners of the property with OPAP grants that worked on project

FRANK HOULTON OP98-105
LEROY CLARKE OP98-106

I. WORK PERFORMED BY APPLICANT (Summary of Section IV)

1. Project #1 area/name	<u>HUNTAKE AN. PROPERTY</u>	No. days worked by applicant
Traditional prospecting	No. of samples <u>27</u>	<u>23</u>
Geological surveys	Scale _____	_____
Geophysical surveys	Type <u>LINE CUTTING</u> Miles/km <u>0.6 KM</u>	<u>2</u>
Geochemical surveys	Type _____ # of samples _____	_____
Drilling	Type _____ Ft./m _____	_____
Stripping/Trenching	Method <u>DOZER, BACKHOE</u>	<u>10</u>
Other	Type <u>POWER WASHING, DRILLING, BLASTING</u>	<u>12</u>
	<u>REPORTS</u>	<u>3</u>
	TOTAL	<u>50</u>

Form filled out by Applicant Other (please specify) _____

Report filled out by Applicant Other (please specify) _____

I. WORK PERFORMED BY APPLICANT (continued))

2. Project #2 area/name _____	No. days worked by applicant _____
Traditional prospecting No. of samples _____	_____
Geological surveys Scale _____	_____
Geophysical surveys Type _____ Miles/km _____	_____
Geochemical surveys Type _____ # of samples _____	_____
Drilling Type _____ Ft./m _____	_____
Stripping/Trenching Method _____	_____
Other Type _____	_____
TOTAL	_____

TOTAL DAYS (ALL PROJECTS) A. _____
 (Attach additional sheets for additional project areas as required)

II. EXPENDITURES (total of all projects) – Summary of I and II

1. Number of working days by applicant (A) x \$100/day <u>47</u>	\$ <u>4700.00</u>
2. Number of report preparation days by applicant x \$100/day <u>3</u>	\$ <u>300.00</u>
3. Analyses/Assay costs.....	\$ _____
4. Equipment rentals <u>RUBBER PUMPS, HOSES</u> \$ <u>2280.00</u> \$ _____	\$ <u>2280.00</u>
5. Consumable Supplies <u>DYNAMITE, FUSE, B/LINE FUEL, OIL,</u>	\$ <u>850.00</u>
6. Contract services (state type) \$ _____ \$ _____	\$ _____
# of workers _____ # of mandays worked _____	
7. Travel (state method: road, air, etc.) <u>ROAD 4136 KM</u> \$ <u>1240.80</u> \$ _____	\$ <u>1240.80</u>
8. Food and Accommodation	\$ _____
9. Other expenses (specify, e.g. typing, printing, shipping of supplies) <u>Shipping</u> \$ <u>73.35</u> \$ _____	\$ <u>73.35</u>
10. Helpers # of helpers <u>ONE</u> # of mandays worked <u>10</u> <u>STEVE FINDLAY</u>	\$ <u>1000.00</u>
TOTAL EXPENDITURES	\$ <u>10,444.15</u>

III. DETAILED LIST OF EXPENDITURES (Summarize in Section II)

Date	Recipient of Payment	Explanation	Amount
JUNE 11 th /98	STEVE FINDLAY	LABOUR	\$ 1000.00
AUG. 10/98	J. P. EQUIPMENT SERVICES.	GAS PULLER RENTAL. RENTAL OF WATAX PUMPS + HOSES	\$ 2280.00
AUG. 15/98	J. P. EQUIPMENT SERVICES	DYNAMITE, FUSES, BLINE.	600.00
	GARAGES	FUEL, ^{oil} Mix oil, OIL, GASOLINE	150.00
	SHIPPING	SWASTIKA LAB GREYHOUND BUS LINE	73.35
		APPLICANTS WAGES	5000.00

Mileage rate claimed 4136 km at 30¢/km for use of own vehicle 1240.80
 TOTAL \$ 10,344.15

(Attach additional sheets as required)

IV. DAILY REPORTS (Summarize work activity in Section I)

Day	Project Area	Date	Work Performed
1			
2			
3			
4			
5			
6			
7			
8			
9			
10			
11			
12			
13			
14			
15			
16			
17			
18			
19			
20			
21			
22			
23			
24			
25			
26			
27			
28			
29			
30			
31			
32			
33			
34			
35			
36			
37			
38			
39			
40			
41			
42			

(Attach additional sheets as required)

IV. DAILY REPORTS (Summarize work activity in Section I)

Day	Project Area	Date	Work Performed
1	ELMHIRST TWP. ^{MUD LK} PROPERTY	MAY 16 th 1998	PROSPECTING
2	" " "	17 th	"
3	" " "	18 th	"
4	" " "	19 th	"
5	" " "	20 th	"
6	" " "	21	CLEAN OUT OLD PITS, CUT CONTROL LINE.
7	" " "	22	" " "
8	" " "	23	" " "
9	" " "	24	" " "
10	" " "	25	" " "
11	" " "	26	PROSPECTING
12	" " "	27	"
13	" " "	28	"
14	" " "	29	"
15	" " "	30	"
16	ELMHIRST TWP ^{MUD LK} PROPERTY	JUNE 1 st	PROSPECTING, LINE CUT, CLEAN OUT OLD V.
17	" " "	2	" " "
18	" " "	3	" " "
19	" " "	4	" " "
20	" " "	5	" " "
21	" " "	6	PROSPECTING
22	" " "	7	"
23	" " "	8	"
24	" " "	9	"
25	" " "	10	"
26	" " "	JUNE 28	MECHANICAL STRIPPING
27	" " "	29	" "
28	" " "	30	" "
29	" " "	JULY 1	" "
30	" " "	2	" "
31	" " "	6	" "
32	" " "	7	" "
33	" " "	8	" "
34	" " "	9	" "
35	" " "	10	" "
36	" " "	JULY 11	POWER WASHING + DRILLING + Blasting
37	" " "	12	" " "
38	" " "	13	" " "
39	" " "	14	" " "
40	" " "	15	" " "
41	" " "	16	" " "
42	" " "	17	" " "

(Attach additional sheets as required)

DAY	PROJECT AREA	MUD LAKE PROPERTY	DATE	WORK PERFORMED
43	ELMHIRST TWP		JULY 20	Power washing, drilling, blasting
44	"	"	21	" " " "
45	"	"	22	" " " "
46	"	"	23	" " " "
47	"	"	24	" " " "
48	"	"	JAN. 9	Report
49	"	"	10	"
50	"	"	11	"

V. SIGNIFICANT RESULTS (please complete)

Project Area	New Showings and/or Anomalies	Commodity	Best Analyses GRAM/TONNE
ELMHURST TWP	3	GOLD	9.87, 20.06, 66.86, 58.85, 18.52, 33.98 } OF APPLICANT
			BY M.N.D.M. ... 33.0, 42.0

VI. CLAIMS STAKED DURING/AFTER PROSPECTING ACTIVITY (please complete)

Project Area	Claim Numbers	Number of Claim Units
	ADDITIONAL CLAIMS TO BE STAKED IN THE SPRING.	

VII. OPTION AGREEMENT RESULTING FROM OPAP PROJECT (please complete)

Optionee	Property/Claims	Work Commitment
	UNDER NEGOTIATION WITH A.D.R. EXPLORATIONS.	

The Ministry of Northern Development and Mines may verify all statements related to and made herein this application.

- I am the person named in the Final Submission form under the Ontario Prospectors Assistance Program.
- I am ordinarily a resident of Canada.
- I have complied with all requirements of the said program.
- I understand that it is an offence under the Ontario Mineral Exploration Program Act, R.S.O. 1990, to make a false or misleading statement and that all statements and all other information submitted in support of the said application are true and correct.
- I was not employed by the Mines and Minerals Division of the Ministry while in receipt of an OPAP grant.
- I am aware that any other Provincial or Federal Government financial assistance received for the said application will be deducted from the amount of incurred "Total Eligible Expenses".

It is an Offence under subsection 8(1)(A) of the Ontario Mineral Exploration Program Act, R.S.O. 1990 to knowingly furnish false or misleading information.

Personal information collected on this form is obtained under the authority of the Ontario Mineral Exploration Program Act, R.S.O. 1990, Sections 2, 3 and 4 and the Ontario Prospectors Assistance Program Regulation, sections 4, 5 and 6. It will be used for the purpose of determining the eligibility of the applicant to have a program designated for financial assistance. It may be disclosed for this purpose and I consent to its disclosure for such a purpose. Questions about this collection should be directed to Senior Manager, Mines Group, Ministry of Northern Development and Mines, 4th floor, 933 Ramsey Lake Road, Sudbury, Ontario P3E 6B5, Toll free 1-800-265-0834.

Signature of Applicant Philip Houghton Date JAN 15 1999
 Name (print) PHILIP HOUGHTON

Philip

OP98-107 WORK SUMMARY AND COSTS.

PROSPECTING: MAY 16-30 15 days @ 100.00 Per day = \$ 1500.00
JUNE 1-10 10 days @ 100.00 Per day = 1000.00

MECHANICAL STRIPPING JUNE 28-30 3 days @ 100.00 300.00
JULY 1-2 2 days @ 100.00 200.00
JULY 6-10 5 days @ 100.00 500.00

POWER WASHING, MILLING, BLASTING: JULY 11-17 7 days @ 100.00 700.00
JULY 20-24 5 days @ 100.00 500.00

EQUIPMENT RENTAL:

PUMP + HOSES: JULY 11-17 7 days @ 125.00 = 875.00
JULY 20-24 5 days @ 125.00 = 625.00

PULLER JULY 11-17 7 days @ 65.00 = 455.00
JUL 20-24 5 days @ 65.00 = 310.00

TRAVEL: 4136 KM @ 30¢ KM = 1240.80
CONSUMABLES: 850.00
SHIPPING: 73.35

LABOURER: STEVE FINDLAY MAY 21-25 5 days @ 100. 500.00
JUNE 1-5 5 days @ 100.00 = 500.00

REPORT: JAN. 9-11 3 days @ 100.00 Per day = 300.00
TOTAL = 10,344.15

PHILIP HOUGHTON OP98-107

Philip Houghton

APRIL 12/99

AUG. 10 1998

J. P. EQUIPMENT SERVICES
(JOHN PAUL)

RECEIVED FROM PHILIP HOUGHTON \$2280.00
TWO THOUSAND TWO HUNDRED EIGHTY DOLLARS
FOR 2 WAJAX PUMPS, 20 NOSES, AND ONE PULLER
RENTAL FEES

JOHN PAUL.

John Paul

AUG. 15 1998

J. P. EQUIPMENT SERVICES
(JOHN PAUL)

RECEIVED FROM PHILIP HOUGHTON \$600.00
SIX HUNDRED DOLLARS FOR PURCHASE OF
DYNAMITE, FUSES, B LINE.

JOHN PAUL.

John Paul

JUNE 11th 1998

STEVE FINDLAY

RECEIVED FROM PHILIP HOUGHTON \$1000.00
ONE THOUSAND DOLLARS FOR 10 DAYS LABOUR
ON OP98-107 PROJECT.

STEVE FINDLAY.

Steve Findlay

LOCATION AND ACCESS

LOCATION: Thunder Bay Mining Division. Beardmore-Geraldton District.
Sturgeon River Gold Belt. South west Elmhirst Twp. G-162
NTS map sheet 42E/13SE
Latitude 49° 46' 20" Longitude 87° 30'

ACCESS: Travel east from Beardmore Ontario, on Highway 11 for 23km,
then north on Highway 801 for 14km. Turn east on south side of
the Sturgeon River and drive 8km. Now turn south and drive 1km
on the access road. Total 46km.

PROPERTY: Consists of 3 block claims comprising 17 units.
Claim 1205012 (3 units). Claim 1210760 (12 units),
and claim 1232680 (2 units)

WORK PERFORMED: Prospecting was carried out over parts of the property. Other
work performed consisted of mechanical stripping and trenching,
power washing, drilling, blasting, manual stripping, trenching, VLF
prospecting, control line cutting, rock sawing, sampling, mapping,
and property visits.

GEOLOGY: Elmhirst Twp. This township lies within the Wabigoon Belt
of the Superior Structural province of the Precambrian Shield.
In the Beardmore-Geraldton District, Sturgeon River Gold Belt.
Elmhirst Twp. is largely underlain by the Coyle Lake Granodiorite
Stock. Meta volcanic's flank this intrusive. Most of the volcanic's
lie to the east. Some porphyry dykes outcrop to the N.E.

PROPERTY GEOLOGY: Prospecting this year has verified that the property areas
examined are underlain by granodiorites and tuffaceous meta
volcanic's. The volcanic's in some areas host numerous porphyry
dykes. The south western claims 1205012, and 1232680 are underlain
by granodiorites. The block claim, No. 1210760 to the N.E., is
mainly underlain by felsic to intermediate volcanic's. Granodiorite
outcrops in the south west part of this claim (1210760) the eastern
and north eastern metavolcanic's in this claim host numerous porphyry
intrusive's or dykes. Often the porphyry's will host numerous cross-
cutting barren white quartz veins ranging from 3cm to 90cm in width.
The margins of the porphyry and shear sometimes contain up to 20%
pyrite.



PROPERTY GEOLOGY: The metavolcanic's are largely tuffs and are fairly massive in most places. Some of the volcanic's are tightly foliated and even schistose near parallel striking quartz veins. These volcanic's carry only minor pyrite.

The property is cut by quite a few faults or lineaments with one main fault. Locally named the Elmhirst Fault striking generally north east across most of the property.

The granodiorites in the south west part of the property are largely massive. Except along Elmhirst fault and some of the lineaments. Here the granodiorite tends to become foliated and altered consisting of carbonate, quartz, silicification, and sericite ankerite is evident as well.

ZONE # 1:

This Zone on cl. 1210760 has a narrow quartz vein and several narrow discontinuous splays. The vein trends N.20°E. cutting obliquely across a N.60°E. Striking Shear Zone lying between porphyritic material on the North side. The white quartz vein system has been opened up for 125 metres. The first 30 metres from the north east has a general width of 10 to 12 centimetres, the vein is of banded crack seal nature and is mineralized up to 15% pyrite. The next 20 metres along strike the vein system, it widens out and ranges from 60cm down to 25cm. The quartz is a banded, crack seal vein heavily mineralized up to 15% with chalcopyrite. It is in this 20 metre section and for the next 15 metres that the vein splits into 2 veins and also this is where the narrow splays occur.

For the next 40 metres the banded, sugary vein narrows again ranging from 6 to 15cm mineralization stays at about 15% pyrite and some chalcopyrite.

For the next 25 metres the vein begins to break up into multiple veinlets hosted by a 1m wide shear zone within a much wider shear. Along side this metre wide veinlet impregnated shear, two 10cm wide quartz veins run parallel. Mineralization is about 5 to 7% pyrite and minor chalcopyrite. Water flooding prevented proper mapping or sampling. The system heads off into spruce swamp.

High grade gold assays have been obtained all along the 125 metres of the exposed zone. Values from 3.65 grams to 74.0 grams per ton were obtained by grab sampling.

Zone No.1, is the old minefinders showing that lead to the claims being patented (1934). A series of old pits, cross trenches and trenches along strike for 160 metres were found here. (1998)

ZONE # 2:

GEOLOGY.

This zone crosses over from Edda Resources Ground into our claim 1205012. No.2 zone will be a parallel zone to No.3 zone in all likelihood. No major work other than over burden blasting, manual trenching and some washing right at the claim boundary, was done here this season. Zone No.2 on Mud Lake Au's Property is actually a projected strike extension of Edda Resources Gold Showing that was traced by mechanical stripping to within 20 metres of our west boundary in 1995. Edda Resources has termed the showing on their side of the property No.2 zone extension.

The work we did has exposed chlorite-carbonate alteration with quartz veining and pyrite mineralization at our boundary, the same as Edda Resources exposed 25 metres south west of the boundary.

Included with this report is an excerpt of Edda Resources report (1995). With a map showing projected strike extensions of the zones.

Grab sampling at our boundary gave values up to 3.33 grams per tonne.

PROPERTY GEOLOGY:

ZONE # 3:

On claim 1205012 a series of old pits and trenches were found and subsequent stripping and trenching has exposed a wide alteration zone of granodiorite that hosts a system of quartz veins, and silicified granodiorites that are well mineralized. There is a heavily sheared and altered volcanic xenolith that occurs here to. The entire system strikes about N.50 E. actually the quartz veins are hosted by the volcanic's as well as the granodiorites. The best mineralized zone of shearing, quartz veins, and silicified veins of granodiorite range from 1.5m to 5.0m within a wider zone 3.0m to 10.5m wide. This zone has been exposed for the 125 metres along strike. The volcanic and granodiorite shearing along the zone is made up of ankerite, sericite, carbonate, quartz, and silicified granodiorite vein material. The granodiorite host rock near the shear is carbonated, hemaetized, and grades into quartz diorite. Mineralization ranges form minor on the margins up to a narrow zone of 15% in the centre of the system.

Gold values by grabs run from trace up to 40 grams.

Gold values by chip, run ~~12.0~~ 14.89 grams across 2 metres and 34.0 grams across 0.33 metres.

STRIPPING AND TRENCHING

ZONE # 1.

Claim 1210760

Stripped Area: 160 metres long and from 15 metres to 60 metres wide.
6 back hoe cross trenches. 2 metres wide up to 34 metres long and from 1 metre to 4 metres deep.

- Rock Trenches:** 14 old trenches cleaned out.
- No.1: Drilled and blasted 1m x 4m x .50m deep.
Sheared volcanic's minor py.
Quartz vein 12cm wide 20% py.
- No.2: Drilled and blasted 1m x 3m x .65m deep.
Sheared volcanic's minor py.
Banded qtz. vein. 50cm wide cpy. py. 20%
- No.3: Drilled and blasted 1m x 6m x 0.65m deep.
Schistose volcanic's on hanging wall. Minor py.
Foliated volcanic's on foot wall Barren.
Banded qtz. vein. 15% to 20% py.
- No.4: Drilled and blasted 1m x 1m x 0.50m deep
Schistose volcanic's. Minor py.
Qtz. vein 24cm 15% py.
- No.5: Drilled and blasted 1m x 2m x 0.60m deep
Schistose volcanic's. Minor py.
- No.6: Drilled and blasted 1m x 1m x 0.50m deep
Schistose volcanic's. Minor py.
Qtz. vein 15cm wide 10% py.
- No.7: Drilled and blasted 1m x 2m x 0.65m deep
Schistose volcanic's. Minor py.
Qtz. vein 17cm wide 10 % py. 2% cpy.
- No.8: Drilled and blasted 1m x 2m x 0.65m deep
Schistose volcanic's with multiple qtz. veinlets
1 metre wide 5% py.
2 qtz. veins paralleling above shear each 10cm wide with 5% py.

STRIPPING AND TRENCHING**ZONE # 3:**

Claim 1205012

- Stripped Area:** 160m long and from 12m to 40m wide.
14 old trenches located
- Drilling and Blasting**
- Rock trench No.1:** 1m x 3m x 0.50m deep
Schistose meta volcanic's, qtz. veinlets, sericite, ankerite
carbonate. Up to 7% py.
- Rock Tr. No.2:** 1m x 3m x 0.50m deep
Schistose volcanic's, qtz. vein, qtz. carb veins, ankerite
carbonate, sericite up to 7% py.
- Rock Tr. No.3:** 1m x 3m x 0.50m deep
Schistose volcanic's, ankerite, carb. py. 2 metres
Schistose volcanic's, qtz. veins qtz. carb. veins carb.
sericite, ankerite, 7% py.
- Rock Tr. No.4:** 1m x 3m x 0.50m deep
Sheared, silicified, carbonated, ankerite, sericitic
granodiorite and qtz. veins up to 10% py.
- Rock Tr. No.5:** 1m x 3m x 0.50m deep
Altered, silicified, sheared granodiorite containing qtz. veins
and carb. veins up to 10% py.
- Rock Tr. No.6:** 1m x 4m x 0.50m deep
Same as No.5.
- Rock Tr. No.7:** 1m x 2m x 0.50m deep
Same as #'s 5 and 6
- Rock Tr. No.8:** 1m x 5m x 0.50m deep
Strong system of qtz. veins, qtz carb. veins in
sheared granodiorites containing ankerite, sericite,
carbonate, up to 10% py.

**Mud Lake Au. Property
OP98**

Days Dates	Daily Log	Elmhirst Project
April 25 th : Start of Project	Found 14 old pits on claim 1205012 Zone No.3 17 samples taken	
(1) May 16 th : (3 Men)	Prospected north and north west Cl.1205012. Around the new Au. showing out crops along the showing indicate a mix of altered mafic volcanic's, altered granodiorite and qtz. diorites. 8 samples taken west and north west of Zone No.3.	
(2) May 17 -18: (3 Men)	Prospected on strike of the showing on claim 1205012. The area to the N.E. is covered by Spruce Swamp then sand with Jackpine and Poplar. The draw to the S.W. is covered by thick moss and Spruce and Cedar.	
(2) May 19-20: (3 Men)	Prospected west of Zone No.3 the rocks in the NW part of Cl.1205012 are granodiorites. A lot of it is fairly massive. A number of qtz. veins with minor py. and cpy. were located in the north west part of the claim. The quartz usually has reddish haematite staining.	
(5) May 21-25: (4 Men)	Spent 5 days doing manual work on claim1205012. One day to cut a control b/l along Zone #3 for 300 metres. Then 4 days cleaning trees, debris, "etc" from the old pits and trenches. (14) Over 125m strike length. Hired one helper.	
(5) May 26-30 th : (3 Men)	Prospected the N.E. part of the claim 1210760 found the old minefinders occurrence (Zone No.1) sampled the veins. The outcrops in this area are felsic meta volcanic's with a substantial number of porphyritic rocks and feldspar porphyries.	

Nearly every porphyry outcrop as well as some of the volcanic's have large numbers (as many as 15 observed) of barren qtz. veins cutting across the structure. Some of the margins of the volcanic's and porphyries are foliated to schistose with up to 15% pyrite sulphide's present. 6 samples taken on Zone No.1.

(5) June 1st-5th : Two men spent 5 days on Zone No.1 Cl.1210760 cleaning out some 12 old pits and trenches and cutting a 300m control B/L along strike. Two more men went back to claim 1205012 and prospected south of Zone No.3 in the area where Edda Resources No.2 extension zone crosses our west boundary of Cl.1205012. The draw is covered by wet ground mass, moss, Spruce, and Cedar. The outcrop on the sides are altered granodiorite, slightly carbonatized and foliated. Hired one helper. 1 sample taken on Zone No.2.

Days Dates

- (5) June 6th -10th: Three men prospected the southern part of Cl.1210760. One claim north of Mud Lake on the west boundary we located an old trench. 4 samples were taken. There were 4 more old trenches on strike to the west off our ground. The Elmhirst Fault cuts through this area and the volcanic- granodiorite contact was observed here. Two hundred metres east we found a porphyry outcrop with a carbonated, shear with minor gossan and pyrite. 4 samples were taken 400 metres east of this Zone we uncovered porphyries containing up to 15% py. South of this pyritized porphyry we encountered granodiorite outcrops and south east of the granodiorites we found 3 more porphyry dykes with sheared margins containing 15 to 20% pyrite. 6 samples were taken. 5 more samples taken on Zone No.1.
(3Men)
- (3) June28th -30th: Moved the MS 120 back hoe to the Mud Lake Property. On claim 1210760, 560 metres south of No.1 post and 20 metres west we stripped an area 40m x 60m then moved 40m west and stripped an area 80m x 120m and cleaned out 4 old trenches. This is Cerro Mining's 1972 Copper Showing. We exposed the cpy. and py. mineralization but failed to find additional copper. 15 samples taken.
(3 Men)
- (2) July 1st - 2: Finished stripping the 80m x 120m area and moved west 160m and dug an exploration cross trench 2m x 120m x 2m. Failed to find any mineralization.
(3 Men) The exposed outcrop areas are felsic intermediate meta volcanic's. A large porphyry dyke parallels the cpy. py. cu. mineralization.
- (1) July 6th: Moved the D-7 dozer and excavator to the property. The back hoe started stripping a small just off the main road while the dozer went west 200m then south 150m to the No.1 Zone on Cl.1210760 at this location the dozer opened up an area 165m long and 70m at its widest. The hoe began digging cross trenches and exposing the No.1 vein system.
(3 Men)
- (3) July 7th - 9th: We moved the dozer and hoe west and south to Cl1205012 on to Zone No.3. The dozer opened up an area 160m long and up to 40 m wide. The hoe dug along strike of the No.3 Zone and exposed the Zone for 125m. 11 samples taken.
- (1) July 10th: We moved the hoe back to No.1 Zone on Cl.120760 and finished cross trenching and exposing No.1 Zone along strike for 125 metres.

Days Dates

- (7) July 11th-17th: Moved water pumps and 500 metres of hose on to Zone No.3 Cl. 1205012. Set up a 300m long water line and power washed the No.3 Zone for 125m of strike length. Rented a plugger and started drilling and blasting to deepen some of the old trenches for fresh exposure. Rented 4 x 4 ATV to move equipment around. Mapped the Zone and area. Blasted 2 new trenches. Deepened 6 old trenches.
- (5) July 20th-24th: Moved the pumps, hoses, plugger and other equipment to Zone No.1 on claim 1210760. Power washed this zone and drilled and blasted 4 new trenches and deepened 4 old trenches. Mapped the Zone and area.
- (3) Jan 9th-11th: Report.

SUMMARY:

Prospecting this season (1998) shows that the North Eastern part of the claim group is largely underlain by felsic to intermediate meta volcanic's of a tuffaceous nature. In places porphyry dykes intrude. Some granodiorite outcrops as well.

The south west part of the claim group is underlain by granodiorites. There is a strong volcanic inclusion where Zone No.3 is situated on Cl. 1205012.

The faults and lineaments strike generally N.E. as does much of the Bedrock Geology. Zone No.1 on claim 1210760 is a Qtz. vein system striking N.20°E across a N.60°E striking shear in meta volcanic's. Zone No.3 on Cl. 1205012 is N.60°E striking shear Zone in altered granodiorites and sheared altered mafic volcanic's. The copper Zone on Cl. 1210760 is a N.50°E striking discontinuous tight shear and Qtz. veining system.

One labourer was hired for 10 days. Steve Findlay

RESULTS: This years program was successful in that 2 gold showing were re-discovered and one new gold showing was found in the west boundary of the property. An old copper showing was examined as well. 3 other areas of interest were prospected also.

ASSAYS: Gold values of economic interest was found in 3 out of 7 locations. Some of the better assay results are as follows:

Gram/Tonne

No. 1 Zone: 26.50, 52.53, 65.83, 58.05, 8.19, 17.93, 9.19

No. 2 Zone: 3.33

Gram/Tonne

No. 3 Zone: 9.87, 8.64, 9.46, 20.06, 14.40, 33.98, 8.40, 8.43

Resident Geologists and staff Geologists from the M.N.D.M, Thunder Bay office made 3 visits to the property. Gerry White, Mark O'Brien, Allison Waldon and, Ryan Tuomi made one trip and sampled No.1 and No.3 Zones. John Mason made one trip.

Then Gerry White made a second trip in order to do a yearly write up on the property, and sampled No.1 and No.3 Zones.

FreeWest Resources did a property visit and sampled No.3 Zone.

Mike Smith of GoldMint Expl. visited and sampled the No.1 and No.3 Zones.

Colin Bowdidge of A.D.R. Expl. visited the property twice and did V.L.F. reconnaissance over No.1 and No.3 Zones.

RECOMMENDATIONS:

- 1) Numbers one, two, and three Zones should be opened up on strike.
- 2) Vlf., Mag., and, Ip. surveys should be carried out over the property.
- 3) The Bull Pine Zone should be mechanically stripped as it has some potential.
- 4) The old trench Zone on the west boundary of Cl. 1210760 should be mechanically trenched.
- 5) Land acquisition is called for to enhance strike extension of the known Au. Zones. Also to cover some known Au. showings just outside the property boundary.
- 6) This property can easily sustain another round of OPAP grants.

ZONESZONE:

No. 1:	Shown on map No. 3
No. 2:	Shown on map No. 1
No. 3:	Shown on map No. 2
Cu. Zone:	Shown on map No. 1
Bull Pine:	Shown on map No. 1
West Boundary:	Shown on map No. 1
Porphyry:	Shown on map No. 1

MUD LAKEOP98SAMPLE DESCRIPTIONSELMHIRST PROJECTZONE NO. 1 Cl. 1210760

<u>Sample No.</u>	<u>Location</u>	<u>Type</u>	<u>Description</u>	<u>Gram/Tonne Results</u>
7126	Zone No.1 map 3	grab	banded, white, sugary 15cm qtz. vein 15% py.	26.50 g/t
7127	Zone No.1 map 3	grab	volcanic shear minor py.	0.09 g/t
7128	Zone No.1 map 3	grab	banded, white, 60cm Qtz. vein 10% py.	52.53 g/t
7129	Zone No.1 map 3	grab	folded, banded, white 5% cpy. Qtz. vein, tourmaline 15% py.	66.86 g/t
7130	Zone No.1 map3	grab	schistose volcanic's, minor pyrite	0.37 g/t
7131	Zone No.1 map 3	grab	banded, sugary, qtz. vein 17cm wide 15% pyrite	58.05 g/t
7147	Zone No.1 map 3	grab	banded, sugary 10cm white, qtz. vein 5% py.	8.19 g/t
7148	Zone No.1 map 3	grab	white, 20cm qtz. vein 2% py.	1.79 g/t
7149	Zone No.1 map 3	grab	white, 17cm qtz. vein 2%cpy./4%py.	17.93 g/t
7150	Zone No.1 map 3	grab	schistose volcanic's minor py.	0.34 g/t
16951	Zone No.1 map 3	grab	1m wide volcanic shear with multiple qtz. veinlets 5% py.	9.19 g/t
7101	Zone No.3	grab	mafic volcanic shear 2% py.	0.62 g/t
7102	Zone No.3	grab	sericite, carb., volc. shear 2% py.	0.55 g/t
7103	Zone No.3	grab	sericite, qtz. vein, volc. shear 2% py.	1.75 g/t
7104	Zone No.3	grab	sericite, volc. shear, qtz. veinlet 4% py.	3.12 g/t

<u>Sample No.</u>	<u>Location</u>	<u>Type</u>	<u>Description</u>	<u>Results g/t</u>
7105	Zone No.3	grab	qtz. carb. vein 20cm 5% py.	4.42 g/t
7106	Zone No.3	grab	white, qtz. vein 17cm 5% py.	4.94
7107	Zone No.3	grab	mixed volc. shear, qtz. carb. vein 10cm white, qtz. vein 10cm 10% py.	9.87
7108	Zone No.3	grab	mafic volc. shear <1% py.	0.24
7109	Zone No.3	grab	volcanic shear, sericite carb. qtz. veinlets ankerite 5% py.	8.64
7110	Zone No.3	grab	granodiorite shear carb. 2% py.	1.82
7111	Zone No.3	grab	granodiorite shear, qtz. stringers <1% py.	0.72
7112	Zone No.3	grab	granodiorite shear, carb. sericite ankerite qtz. 3% py.	1.85
7113	Zone No.3	grab	granodiorite qtz. veinlet	0.99
7114	Zone No.3	grab	silicified granodiorite vein 20cm 7% py.	9.46
7115	Zone No.3	grab	granodiorite shear, carb. ankerite sericite 20% py.	20.06
7116	Zone No.3	grab	silicified granodiorite vein 7% py.	6.62
7117	Zone No.3	grab	granodiorite shear carb. ankerite sericite some qtz. 5% py.	2.19
7153	Zone No.3	chip 50cm	qtz. stringers, granodiorite shear, ankerite carb., sericite. 7% py.	14.40
7154	Zone No.3	chip 50cm	qtz. breccia, grano. shear ankerite 2% py.	1.06
7155	Zone No.3	chip 50cm	mix of qtz. vein and silicious grano. 15% py.	33.98
7156	Zone No.3	chip 50cm	qtz. carb. vein, granodiorite shear 3% py.	0.12

141.89 g/t
ACROSS 2 metres

<u>Sample No.</u>	<u>Location</u>	<u>Type</u>	<u>Description</u>		<u>Results g/t</u>
7157	Zone No.3	grab	qtz. carb. veinlet	3% py.	0.03 g/t
7158	Zone No.3	grab	silicified granodiorite	3% py.	1.80
7159	Zone No.3	grab	silicified granodiorite vein	8% py.	6.07
16989	Zone No.3	grab	volcanic shear ankerite	<1% py.	0.99
16990	Zone No.3	chip	ankerite, sericite, volc. shear, qtz.		
		50cm	veinlets, carb.	10% py.	8.40
16991	Zone No3	chip	ankerite, carb. sericite, qtz. veinlets		
		50cm	volcanic shear	10% py.	8.43
16992	Zone No.3	chip	volcanic shear, sericite ankerite	4% py.	4.32
		50cm			
7118	North West AREA				
	cl.1205012	grab	10cm qtz. vein milky white	1% py.	NIL
7119	" "	" "	10cm qtz. vein haematite stain	<1% py.	NIL
7120	" "	" "	10cm qtz. vein white minor cpy.	py.	0.01
7121	" "	" "	18cm qtz. vein white minor cpy.	py.	0.01
7122	" "	" "	18cm qtz. vein white minor py.		0.02
7123	" "	" "	15cm qtz. vein haematite	1% py.	NIL
7124	" "	" "	15cm qtz. vein grey	1% py.	0.01
7125	" "	" "	15cm qtz. vein grey	2% cpy. py.	0.01
7132	West boundary				
	cl.1210760	grab	silicious altered granodiorite	<1% py.	0.22
7133	" "	" "	impure qtz. vein	<1% py.	0.18
7134	^{cl.} 1205012 No.2 Zone	grab	banded, qtz. vein, ankerite carb.	4% py.	3.33 g/t
7135	^{cl.} 1210760 West boundary	" "	impure qtz. vein	2% py.	0.59
7136	" "	" "	silicified altered granodiorite	1% py.	0.01
7137	Bull Pine Zone				
	Cl.1210760	grab	porphyritic shear minor gossan	<1% py.	0.01
7138	" "	" "	porphyritic shear minor gossan	<1% py.	0.03
7139	" "	" "	carbonate shear porphyry	1% py.	0.01
7140	" "	" "	carbonate shear porphyry	1% py.	NIL

7.05 g/t
across 1.5 metres

<u>Sample No.</u>	<u>Location</u>	<u>Type</u>	<u>Description</u>	<u>Results g/t</u>
7141	Porphyry Zone cl.1210760	grab	sheared porphyry, volc. contact 15% py.	0.08
7142	" "	"	shear, porphyry volc. contact 15% py.	0.03
7143	" "	"	porphyry shear 15% py.	0.14
7144	" "	"	porphyritic volcanic shear 10% py.	0.02
7145	" "	"	porphyry shear 10% py.	0.03
7146	" "	"	porphyry with minor qtz. veinlets 7% py.	0.11
7160	Cu. Zone Cl.1210760	grab	cpy. stringer 4% in metavolcanic	0.04
7161	" "	"	4% cpy. stringer in metavolcanic	0.01
7162	" "	"	10cm qtz. vein in volcanic's 3% cpy.	0.01
7163	" "	"	metavolcanic's, foliated, silicious, 3% py.	0.09
7164	" "	"	metavolcanic's, foliated, silicious, 2% py.	NIL
7165	" "	"	qtz. and metavolcanic's 2% cpy. 2% py.	0.02
7166	" "	"	20cm qtz. vein white 3% cpy. 2% py.	0.03
7167	" "	"	20cm qtz. vein white 4% cpy.	0.25
7168	" "	"	10% cpy. stringer alongside qtz. vein	0.02
7169	" "	"	7% cpy. stringer alongside qtz. vein	NIL
7170	" "	"	metavolcanic's, foliated with 7-10% py.	0.01
7171	" "	"	7-10% py. in qtz. and metavolcanic's	0.14
7172	" "	"	qtz. vein white 15cm 3% py. , cpy.	0.02
7173	" "	"	qtz. vein whit 15cm 3% py. , cpy.	0.02
7174	" "	"	10% py. and cpy. stringer in volcanic's	635 ppm. Cu.

Fren K

OP98WORK SUMMARY AND COSTSPROSPECTING:

May 16 th - 30 th	15 days @ 100.00	=	\$1500.00
June 1 st - 10 th	10 days @ 100.00	=	1000.00

MECHANICAL STRIPPING:

June 28 th - 30 th	3 days @ 100.00	=	300.00	} Invoice
July 1 - 2	2 days @ 100.00	=	200.00	
July 6 th - 10 th	5 days @ 100.00	=	500.00	

POWER WASHING, DRILLING AND BLASTING:

July 11 th - 17 th	7 days @ 100.00	=	700.00	} Invoice
July 20 th - 24 th	5 days @ 100.00	=	500.00	

EQUIPMENT RENTAL:

D7G Bulldozer:	July 6 th - 7 th	17hrs. @ 80.00	=	\$1360.00
Track Back Hoe:	July 6 th - 10 th	37hrs. @ 100.00	=	2775.00
		GST	=	289.45
		Float charges	=	375.00
		GST	=	26.25
4 x 4 A.T.V.	July 1 st - 20 th	20 days @ 20.00	=	400.00
Travel:		4136km @ 30 ¢ km	=	1240.00
Report:	Jan 9 th - 11 th	3 days @ 100.00	=	<u>300.00</u>
		Total		\$11,466.50

F. Houghton April 12/99
 Frank Houghton

OP98 - 105**APPLICANT:**

Frank Houghton

Phone 1 - 807- 875 - 2604

Fax 1 - 807- 875 - 2604

ADDRESS:Box 164
136 Pauline St.
Beardmore, Ontario
P0T 1G0



Established 1928

Swastika Laboratories

A Division of TSL/Assayers Inc.

Assaying - Consulting - Representation

Assay Certificate

9W-0136-RA1

Company: F. HOUGHTON

Date: JAN-19-99

Project:

Attn: F. Houghton

We hereby certify the following Assay of 3 Grab samples submitted JAN-17-99 by .

Sample Number	Au		Au Check	
	g/tonne	oz/ton	g/tonne	oz/ton
7416	20.91	.610	-	-
7417	23.04	.672	23.73	.692
7418	35.28	1.029	35.04	1.022

One assay ton portion used.

Certified by

1 Cameron Ave., P.O. Box 10, Swastika, Ontario P0K 1T0
 Telephone (705)642-3244 Fax (705)642-3300

INTRODUCTION:

7

The 1998 Field Exploration Program was carried out in order to thoroughly examine the gold showing that was found by F. Houghton last spring on claim 1205012. Prospecting was also done in order to re-locate the old Mine Finders Au. showing on resent claim 1210760. This years program was set up to prospect the claims around the Au. showings and on strike in order to extend and/or to find parallel ones. This was a successful season.

SUMMARY:

1.	Traditional Prospecting	25 days
2.	Mechanical stripping and washing	10 days
3.	Drilling and blasting and washing	12 days
4.	Power washing	12 days
5.	Two Au showings found and opened up	
6.	One Au showing located, not opened up	
7.	One Au showing opened up	
8.	Sampling done	
9.	Labourer hired	10 days
10.	Report	3 days



XRAL Laboratories
A Division of SGS Canada Inc.

Work Order: 053308

Date: 08/12/98

FINAL

Page 1 of 1

Element.	Au	Au	Pt	Pd	Co	Ni	Cu
Method.	FA301	FAG30	FA301	FA301	ICP70	ICP70	ICP70
Det.Lim.	1	0.03	10	1	1	1	0.5
Units.	ppb	g/mt	ppb	ppb	ppm	ppm	ppm
FMC2501	297	n.a.	829	401	79	2260	5900
FMC2502	504	n.a.	892	472	130	4040	7020
AL9801	5350	n.a.	n.a.	n.a.	n.a.	n.a.	n.a.
AL9802	21	n.a.	n.a.	n.a.	n.a.	n.a.	n.a.
AL9803	23	n.a.	n.a.	n.a.	n.a.	n.a.	n.a.
AL9804	1300	n.a.	n.a.	n.a.	n.a.	n.a.	n.a.
AL9805	272	n.a.	n.a.	n.a.	n.a.	n.a.	n.a.
AL9806	230	n.a.	n.a.	n.a.	n.a.	n.a.	n.a.
AL9807	> 10000	24.3	n.a.	n.a.	n.a.	n.a.	n.a.
ML9801	> 10000	31.3	n.a.	n.a.	n.a.	n.a.	n.a.
ML9802	> 10000	52.9	n.a.	n.a.	n.a.	n.a.	n.a.
ML9803	> 10000	73.4	n.a.	n.a.	n.a.	n.a.	n.a.
ML9804	> 10000	14.4	n.a.	n.a.	n.a.	n.a.	n.a.
ML9805	4420	n.a.	n.a.	n.a.	n.a.	n.a.	n.a.
ML9806	5380	n.a.	n.a.	n.a.	n.a.	n.a.	n.a.
ML9807	306	n.a.	n.a.	n.a.	n.a.	n.a.	n.a.
ML9808	8500	n.a.	n.a.	n.a.	n.a.	n.a.	n.a.
*Dup FMC2501	284	n.a.	782	386	78	2270	5900
*Dup ML9804	> 10000	n.a.	n.a.	n.a.	n.a.	n.a.	n.a.

zone 1

zone 3

MICHAEL D. SMITH, F.G.A.C.
Consulting Geologist

70 - 23rd Street
Elobicoke, Ontario
M8V 3N2

FAXMEMO

NUMBER
of pages: 1 of 3

Date: _____

To: FRANK HOUGHTON
name

From: MIKE SMITH
name

company

company

Fax no.: [807] 875-2604

[416] 253-9934
fax number

Subject: MUD LAKE - 1998 SAMPLE LOCATIONS # ASSAYS.

Message: FRANK,

Here are the sample locations per your verbal direction plus some later checking on actual trench numbers back at the School in Beardmore.

MUD LAKE ML 9801 - TR #1 - Northeast end, Northside - in saw cut, 45cm sample width

1 ML 9802 - TR #5 - Sample #2, taken from saw cut/trench #5, 35cm width

ZONE ML 9803 - ML #1 - MUCK GRAB SAMPLE FROM South side of open cut, 10m S of 9802

MUD LAKE #3 zone

ML 9804 - TRENCH/SAWCUT 1 - SAMPLE #1 - rock chip over 1.0m sample width

ML 9805 - TRENCH/SAWCUT #9 - SAMPLE S-1, 1m sample width, NE side of pit.

ML 9806 - TRENCH/SAWCUT 9 - S-2, contiguous to S-1 above, 40cm width

ML 9807 - " " 9; S-3 - contiguous to S-2, S side of pit, 40cm width

ML 9808 - TRENCH/SAWCUT #10; SAMPLE S-1, across gtz-corb, width 1m.

If you can't read or understand any of this pls give me a call.

Here's hoping for work for both of us at Ashmore in 1999.
Mike

TRIED TO FAX THIS 4 TIMES, COULDN'T
GET IT THRU SO FORWARDED BY MAIL.

1/19/99.



Swastika Laboratories

A Division of Assayers Corporation Ltd.

Assaying - Consulting - Representation

Established 1928

Assay Certificate

8W-1003-RA1

Company: **F. HOUGHTON**

Date: APR-28-98

Project:

Attn: F. Houghton

We hereby certify the following Assay of 9 Rock samples submitted APR-26-98 by .

Sample Number	Au		Au	
	oz / ton	Au Check oz / ton	g / tonne	Au Check g / tonne
7101	0.018	0.016	0.62	0.55
7102	0.016	-	0.55	-
7103	0.051	-	1.75	-
7104	0.091	-	3.12	-
7105	0.129	-	4.42	-
7106	0.144	-	4.94	-
7107	0.286	0.288	9.81	9.87
7108	0.007	-	0.24	-
7109	0.251	0.252	8.61	8.64

One assay ton portion used.

Certified by

42E13SE2008 2.19405 ELMHIRST



050



Swastika Laboratories

A Division of Assayers Corporation Ltd.

Assaying - Consulting - Representation

Established 1928

Assay Certificate

8W-1004-RA1

Company: **F. HOUGHTON**

Date: APR-30-98

Project:

Att: F. Houghton

We hereby certify the following Assay of 8 Rock samples submitted APR-27-98 by .

Sample Number	Au		Au	
	oz/ton	Au Check oz/ton	g/tonne	Au Check g/tonne
7110	0.051	0.053	1.75	1.82
7111	0.021	-	0.72	-
7112	0.054	-	1.85	-
7113	0.029	-	0.99	-
7114	0.276	0.265	9.46	9.09
7115	0.563	0.585	19.30	20.06
7116	0.193	-	6.62	-
7117	0.064	-	2.19	-

One assay ton portion used.

Certified by



Swastika Laboratories

A Division of Assayers Corporation Ltd.

Assaying - Consulting - Representation

Established 1928

Assay Certificate

8W-1251-RA1

Company: **F. HOUGHTON**

Date: MAY-20-98

Project:

Attn: **F. Houghton**

We hereby certify the following Assay of 8 Rock samples submitted MAY-16-98 by .

Sample Number	Au g/tonne	Au oz/ton	Au Check g/tonne	Au Check oz/ton
7118	Nil		-	-
7119	Nil		Nil	-
7120	0.01	.001	-	-
7121	0.01	.001	-	-
7122	0.02	.001	-	-
7123	Nil		-	-
7124	0.01	.001	-	-
7125	0.01	.001	0.01	.001

One assay ton portion used.

Certified by *Dennis Chantre*



Swastika Laboratories

A Division of Assayers Corporation Ltd.

Assaying - Consulting - Representation

Established 1928

Assay Certificate

8W-1437-RA1

Company: F. HOUGHTON

Date: JUN-04-98

Project:

Attn: F. Houghton

We hereby certify the following Assay of 6 Rock samples submitted JUN-02-98 by .

Sample Number	Au g/tonne	Au g/tonne
7126	26.50	-
7127	0.09	-
7128	52.53	52.22
7129	65.83	66.86
7130	0.37	-
7131	58.05	-

One assay ton portion used.

Certified by Denis Chantre



Established 1928

Swastika Laboratories

A Division of Assayers Corporation Ltd.

Assaying - Consulting - Representation

Assay Certificate

8W-1511-RA1

Company: **F. HOUGHTON**

Date: JUN-10-98

Project:

Attn: F. Houghton

We hereby certify the following Assay of 9 Rock samples submitted JUN-08-98 by .

Sample Number	Au		Au Check	
	g/tonne	oz/ton	g/tonne	oz/ton
7132	0.22	.006	-	-
7133	0.18	.005	-	-
7134	3.33	.097	2.74	.080
7135	0.59	.017	-	-
7136	0.01	.001	-	-
7137	0.01	.001	-	-
7138	0.03	.001	0.04	.001
7139	0.01	.001	-	-
7140	Nil			

One assay ton portion used.

Certified by



Established 1928

Swastika Laboratories

A Division of Assayers Corporation Ltd.

Assaying - Consulting - Representation

Assay Certificate

8W-1641-RA1

Company: **F. HOUGHTON**

Date: JUN-19-98

Project:

Anal: F. Houghton

We hereby certify the following Assay of 11 Rock samples submitted JUN-15-98 by .

Sample Number	Au g/tonne	Au oz/ton	Au Check g/tonne	Au Check oz/ton	Au 2nd g/tonne	Au 2nd oz/ton	Ag g/tonne
7141	0.08	.002	-	-	-	-	-
7142	0.03	.001	-	-	-	-	-
7143	0.14	.004	-	-	-	-	-
7144	0.02	.001	-	-	-	-	-
7145	0.03	.001	-	-	-	-	-
7146	0.11	.003	-	-	-	-	-
7147	8.19	.239	8.02	.234	-	-	2.5
7148	1.71	.050	-	-	-	-	1.5
7149	17.93	.523	17.62	.514	18.52	.540	9.6
7150	0.34	.010	-	-	-	-	0.2
16951	8.85	.258	9.19	.268	-	-	4.3

One assay ton portion used.

Certified by



Established 1928

Swastika Laboratories

A Division of TSL/Assayers Inc.

Assaying - Consulting - Representation

Assay Certificate

8W-2604-RA1

Company: F. HOUGHTON

Date: SEP-10-98

Project:

Aun: F. Houghton

We hereby certify the following Assay of 15 Rock samples submitted SEP-04-98 by .

Sample Number	Au g/tonne	Au check g/tonne	Cu PHM	Ni PHM	Pt g/tonne	Pd g/tonne
7160	0.04	-	-	-	-	-
7161	0.01	-	-	-	-	-
7162	0.01	-	-	-	-	-
7163	0.09	0.08	-	-	-	-
7164	Nil	-	-	-	-	-
7165	0.02	-	-	-	-	-
7166	0.03	-	-	-	-	-
7167	0.25	0.25	-	-	-	-
7168	0.02	-	-	-	-	-
7169	Nil	-	-	-	-	-
7170	0.01	-	-	-	-	-
7171	0.14	0.15	-	-	-	-
7172	0.02	-	-	-	-	-
7173	0.02	-	-	-	-	-
7174	-	-	635	93	<0.005	<0.005

One assay ton portion used.

Certified by



Established 1928

Swastika Laboratories

A Division of TSI/Assayers Inc.

Assaying - Consulting - Representation

Assay Certificate

8W-2624-RA1

Company: F. HOUGHTON

Date: SEP-11-98

Project:

Attn: F. Houghton

We hereby certify the following Assay of 11 Grab/Chip samples submitted SEP-07-98 by .

Sample Number	Au g/tonne	Au Check g/tonne	Au 2nd g/tonne
7153	13.13	14.40	-
7154	1.06	-	-
7155	32.02	31.41	33.98
7156	0.12	-	-
7157	0.03	-	-
7158	1.70	1.80	-
7159	6.07	-	-
16989	0.99	-	-
16990	8.40	-	-
16991	8.30	8.43	-
16992	4.32	-	-

One assay ton portion used.

Certified by Dennis Chantre

W. 99/10.00/02

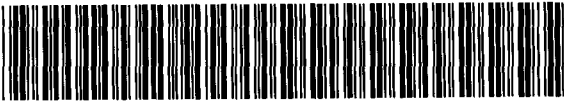

42E13SE2008 2.19405 ELMHIRST 900

Sections 65(2) and 66(3) of the Mining Act. Under section 8 of the Mining Act, assessment work and correspond with the mining land holder. Questions about this form Development and Mines, 3rd Floor, 933 Ramsey Lake Road, Sudbury.

F.H. Attach ~~to~~ F. Houghton

- Instructions: - For work performed on Crown Lands before recording a claim, use form 0240.
- Please type or print in ink.

1. Recorded holder(s) (Attach a list if necessary)

Name: FRANK HOUGHTON	Client Number: 146058
Address: Box 164 138 PAULINE ST. BEARDMORE, ONT. P.O. 160	Telephone Number: (807) 875-2604
	Fax Number: 1-807-875-2604
Name: PHILIP HOUGHTON / LEROY CLARKE	Client Number: 146061 / 118802
Address: Box 85 139 TAMARACK ST. / Box 53 BEARDMORE ONT. P.O. 160	Telephone Number: /
	Fax Number: /

2. Type of work performed: Check (✓) and report on only ONE of the following groups for this declaration.

Geotechnical: prospecting, surveys, assays and work under section 18 (regs) ✓	Physical: drilling stripping, trenching and associated assays	Rehabilitation
Work Type: PROSPECTING	Office Use	
Dates Work Performed: From 16 MAY 98 To 24 JULY 98	Commodity	Total \$ Value of Work Claimed
Global Positioning System Data (if available): Township/Area ELMHIRST M or G-Plan Number 6-162	NTS Reference	Mining Division
	Resident Geologist District	

- Please remember to:
- obtain a work permit from the Ministry of Natural Resources as required;
 - provide proper notice to surface rights holders before starting work;
 - complete and attach a Statement of Costs, form 0212;
 - provide a map showing contiguous mining lands that are linked for assigning work;
 - include two copies of your technical report.

Thunder Bay Mining Division
 APR 16 1999 4:10pm J.
RECEIVED

3. Person or companies who prepared the technical report (Attach a list if necessary)

Name: FRANK HOUGHTON	Telephone Number: (807) 875-2604
Address: Box 164 138 PAULINE ST. BEARDMORE ONT. P.O. 160	Fax Number: 1-807-875-2604
Name:	Telephone Number:
Address:	Fax Number:
Name:	Telephone Number:
Address:	Fax Number:

RECEIVED
 9:40 a.m.
 APR 21 1999
 GEOSCIENCE ASSESSMENT OFFICE

4. Certification by Recorded Holder or Agent

I, FRANK HOUGHTON, do hereby certify that I have personal knowledge of the facts set forth in this Declaration of Assessment Work having caused the work to be performed or witnessed the same during or after its completion and, to the best of my knowledge, the annexed report is true

Signature of Recorded Holder or Agent: Frank Houghton	Date: APR 12 / 99
Agent's Address: Box 164 138 PAULINE ST. BEARDMORE ONT. P.O. 160	Telephone Number: (807) 875-2604
	Fax Number: (807) 875-2604

0241 (01/97) Deemed July 20/99

5. Work to be recorded and distributed. Work can only be assigned to claims that are contiguous (adjoining) to the mining land where work was performed, at the time work was performed. A map showing the contiguous link must accompany this form.

W 9940-00102

Mining Claim Number. Or if work was done on other eligible mining land, show in this column the location number indicated on the claim map.	Number of Claim Units. For other mining land, list hectares.	Value of work performed on this claim or other mining land.	Value of work applied to this claim.	Value of work assigned to other mining claims.	Bank. Value of work to be distributed at a future date
eg TB 7827	16 ha	\$26,825	N/A	\$24,000	\$2,825
eg 1234567	12	0	\$24,000	0	0
eg 1234568	2	\$ 8,892	\$ 4,000	0	\$4,892
1 TB 121 0760	12	8667	8667		
2 TB 12 ^{FH} 05012	4	2889	2889		
3 TB 123 2680	2	1444	1444		
4					
5					
6					
7					
8					
9					
10					
11					
12					
13					
14					
15					
Column Totals	18	13,000	13000		

I, Frank Houghton (Print Full Name), do hereby certify that the above work credits are eligible under subsection 7 (1) of the Assessment Work Regulation 6/96 for assignment to contiguous claims or for application to the claim where the work was done.

Signature of Recorded Holder or Agent Authorized in Writing <u>Frank Houghton</u>	Date April 12, 1999
--	------------------------

6. Instructions for cutting back credits that are not approved.

Some of the credits claimed in this declaration may be cut back. Please check (✓) in the boxes below to show how you wish to prioritize the deletion of credits:

- 1. Credits are to be cut back from the Bank first, followed by option 2 or 3 or 4 as indicated.
- 2. Credits are to be cut back starting with the claims listed last, working backwards; or
- 3. Credits are to be cut back equally over all claims listed in this declaration; or
- 4. Credits are to be cut back as prioritized on the attached appendix or as follows (describe):

Note: If you have not indicated how your credits are to be deleted, credits will be cut back from the Bank first followed by option number 2 if necessary.

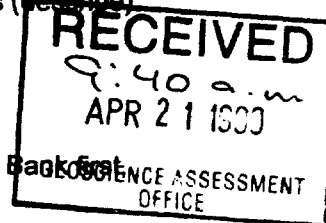

For Office Use Only

Received Stamp	Deemed Approved Date	Date Notification Sent
	Date Approved	Total Value of Credit Approved
Approved for Recording by Mining Recorder (Signature)		

0241 (03/97)

Thunder Bay Mining Division

APR 16 1999
RECEIVED



Personal information collected on this form is obtained under the authority of subsection 6 (1) of the Assessment Work Regulation 6/96. Under section 8 of the Mining Act, this information is a public record. This information will be used to review the assessment work and correspond with the mining land holder. Questions about this collection should be directed to a Provincial Mining Recorder, Ministry of Northern Development and Mines, 3rd Floor, 933 Ramsey Lake Road, Sudbury, Ontario, P3E 6B5.

Table with 4 columns: Work Type, Units of work, Cost Per Unit of work, Total Cost. Includes entries for PROSPECTING (75 man days x \$150 = \$11,250), Transportation Costs (1250), and Food and Lodging Costs (500).

RECEIVED 9:40 a.m. APR 21 1993 GEOSCIENCE ASSESSMENT OFFICE

Total Value of Assessment Work 13,000

Calculations of Filing Discounts:

- 1. Work filed within two years of performance is claimed at 100% of the above Total Value of Assessment Work.
2. If work is filed after two years and up to five years after performance, it can only be claimed at 50% of the Total Value of Assessment Work.

TOTAL VALUE OF ASSESSMENT WORK x 0.50 = Total \$ value of worked claimed.

Note: - Work older than 5 years is not eligible for credit. - A recorded holder may be required to verify expenditures claimed in this statement of costs within 45 days of a request for verification and/or correction/clarification.

Certification verifying costs:

I, Frank Houghton, do hereby certify, that the amounts shown are as accurate as may reasonably be determined and the costs were incurred while conducting assessment work on the lands indicated on the accompanying Declaration of Work form as recorded holder I am authorized to make this certification.

Thunder Bay Mining Division

Signature: Frank Houghton Date: April 12, 1999

APR 16 1999

RECEIVED

2.19405

W.9940-00103

ORIGINAL

Personal information collected on this form is obtained under the authority of subsections 65(2) and 66(3) of the Mining Act. Under section 8 of the Mining Act, this information is a public record. This information will be used to review the assessment work and correspond with the mining land holder. Questions about this collection should be directed to a Provincial Mining Recorder, Ministry of Northern Development and Mines, 3rd Floor, 933 Ramsey Lake Road, Sudbury, Ontario, P3E 6B5.

FFA ~~ALL~~ Philip Houghton
FRANK HOUGHTON
F.A. ~~LEWIS~~

Instructions: - For work performed on Crown Lands before recording a claim, use form 0240.
- Please type or print in ink.

Recorded holder(s) (Attach a list if necessary)

Name: F.A. FRANK HOUGHTON	Client Number: 046058
Address: BOX 164 138 PAULINE ST. BEARDMORE ONT. POT 160	Telephone Number: (807) 875-2604
	Fax Number: 1-807-875-2604
Name: PHILIP HOUGHTON/LEROY CLARKE	Client Number: 146061 / 118802
Address: BOX 85 129 TAMARACK ST./BOX 53 BEARDMORE ONT. POT 160/BEARDMORE ONT. POT 160	Telephone Number: (807) 875-2368
	Fax Number: /

2. Type of work performed: Check (✓) and report on only ONE of the following groups for this declaration.

Geotechnical: prospecting, surveys, assays and work under section 18 (regs) Physical: drilling stripping, trenching and associated assays Rehabilitation

Work Type: STRIPPING, TRENCHING, ASSAYS, POWER WASHING, BLASTING, SAMPLING	Office Use
	Commodity
	Total \$ Value of Work Claimed: 29,928. ⁰⁰
Dates Work Performed: From 28 JUNE 98 To 24 JULY 98	NTS Reference
Global Positioning System Data (if available)	Mining Division: Thunder Bay
Township/Area: ELMHURST	Resident Geologist District
M or G-Plan Number: G-162	

Please remember to: - obtain a work permit from the Ministry of Natural Resources as required;
- provide proper notice to surface rights holders before starting work;
- complete and attach a Statement of Costs, form 0119;
- provide a map showing contiguous mining lands that are linked for assigning work;
- include two copies of your technical report.

RECORDED
APR 19 1999

Thunder Bay Mining Division
APR 16 1999 4:10 pm
RECEIVED

3. Person or companies who prepared the technical report (Attach a list if necessary)

Name: FRANK HOUGHTON 138 PAULINE ST.	Telephone Number: (807) 875-2604
Address: BOX 164 BEARDMORE ONT. POT 160	Fax Number: 1-807-875-2604
Name:	Telephone Number:
Address:	Fax Number:
Name:	Telephone Number:
Address:	Fax Number:

RECEIVED
9:40 am
APR 21 1999
GEOSCIENCE ASSESSMENT OFFICE

4. Certification by Recorded Holder or Agent

I, FRANK HOUGHTON (Print Name), do hereby certify that I have personal knowledge of the facts set forth in this Declaration of Assessment Work having caused the work to be performed or witnessed the same during or after its completion and, to the best of my knowledge, the annexed report is true.

Signature of Recorded Holder or Agent: Frank Houghton	Date: APRIL 12/99
Agent's Address: Box 164 138 Pauline St	Telephone Number: (807) 875-2604
	Fax Number: 1-807-875-2604

0241 (03/97) BEARDMORE ONT. POT 160

Deemed July 20/99

78-1940-5

5. **Work to be recorded and distributed.** Work can only be assigned to claims (adjoining) to the mining land where work was performed, at the time work was performed. A map showing the contiguous link must accompany this form.

Mining Claim Number. Or if work was done on other eligible mining land, show in this column the location number indicated on the claim map.	Number of Claim Units. For other mining land, list hectares.	Value of work performed on this claim or other mining land.	Value of work applied to this claim.	Value of work assigned to other mining claims.	Bank. Value of work to be distributed at a future date
eg TB 7827	16 ha	\$26,825	N/A	\$24,000	\$2,825
eg 1234567	12	0	\$24,000	0	0
eg 1234568	2	\$ 8,892	\$ 4,000	0	\$4,892
1 TB 1210760	12	15333	15333		
2 F.M. TB 1205012	4	14595	5111	2556	6928
3 TB 123 2680	2	0	2556		
4					
5					
6					
7					
8					
9					
10					
11					
12					
13					
14					
15					
Column Totals	18 F.M.	29,928	23000	2556	6928

RECORDED
APR 19 1999

I, FRANK ADUENSON, do hereby certify that the above work credits are eligible under subsection 7 (1) of the Assessment Work Regulation 6/96 for assignment to contiguous claims or for application to the claim where the work was done.

Signature of Recorded Holder or Agent Authorized in Writing: Frank Aduenson Date: April 12, 1999

6. Instructions for cutting back credits that are not approved.

Some of the credits claimed in this declaration may be cut back. Please check (✓) in the boxes below to show how you wish to prioritize the deletion of credits:

- 1. Credits are to be cut back from the Bank first, followed by option 2 or 3 or 4 as indicated.
- 2. Credits are to be cut back starting with the claims listed last, working backwards; or
- 3. Credits are to be cut back equally over all claims listed in this declaration; or
- 4. Credits are to be cut back as prioritized on the attached appendix or as follows (describe):

RECEIVED
APR 21 1999
GEOSCIENCE ASSESSMENT OFFICE

Note: If you have not indicated how your credits are to be deleted, credits will be cut back from the Bank first, followed by option number 2 if necessary.

For Office Use Only

Received Stamp	Deemed Approved Date	Date Notification Sent
	Date Approved	Total Value of Credit Approved
	Approved for Recording by Mining Recorder (Signature)	

0241 (03/97)

Thunder Bay Mining Division
APR 16 1999
RECEIVED

2.19405

Personal information collected on this form is obtained under the authority of subsection 6 (1) of the Assessment Work Regulation 6/96. Under section 8 of the Mining Act, this information is a public record. This information will be used to review the assessment work and correspond with the mining land holder. Questions about this collection should be directed to a Provincial Mining Recorder, Ministry of Northern Development and Mines, 3rd Floor, 933 Ramsey Lake Road, Sudbury, Ontario, P3E 6B5.

Work Type	Units of work Depending on the type of work, list the number of hours/days worked, metres of drilling, kilometres of grid line, number of samples, etc.	Cost Per Unit of work	Total Cost
Mechanical stripping	30 man days X	150/day	4500
knocking sampling			
F. Houghton, P. Houghton, L. Clarke			
Power Washing work	12 days 3 men = 36 X	150/day	5400
Powerwashing Equipment	12 days (rental) X	190/day	2280
Bulldozer (includes operator)	17 hrs X	80/hr	1360
Backhoe (includes operator)	79 hrs X	75/hr	5925
Hired Labour	16 days X	150/day	1500
Associated Costs (e.g. supplies, mobilization and demobilization).			
Report Work			900
Shipping samples			222
ATV Rental			400
Plunger Rental			765
Assays			785
Transportation Costs			3720
Mobe + Demobe			795
Food and Lodging Costs			500
GST			876
Total Value of Assessment Work			29928

RECORDED
APR 19 1999

RECEIVED
9:40 a.m.
APR 21 1999
GEOSCIENCE ASSESSMENT OFFICE

Calculations of Filing Discounts:

1. Work filed within two years of performance is claimed at 100% of the above Total Value of Assessment Work.
2. If work is filed after two years and up to five years after performance, it can only be claimed at 50% of the Total Value of Assessment Work. If this situation applies to your claims, use the calculation below:

TOTAL VALUE OF ASSESSMENT WORK $\times 0.50 =$ Total \$ value of worked claimed.

Note:

- Work older than 5 years is not eligible for credit.
- A recorded holder may be required to verify expenditures claimed in this statement of costs within 45 days of a request for verification and/or correction/clarification. If verification and/or correction/clarification is not made, the Minister may reject all or part of the assessment work submitted.

Certification verifying costs:

I, Frank Houghton, do hereby certify, that the amounts shown are as accurate as may reasonably be determined and the costs were incurred while conducting assessment work on the lands indicated on the accompanying

Declaration of Work form as FRANK HOUGHTON (recorded holder) I am authorized to make this certification.
(recorded holder, agent, or state company position with signing authority)

Thunder Bay Mining Division

APR 16 1999

RECEIVED

Signature: Frank Houghton Date: Apr. 17, 1999

Geoscience Assessment Office
933 Ramsey Lake Road
6th Floor
Sudbury, Ontario
P3E 6B5

July 12, 1999

FRANKLIN ALFRED HOUGHTON
BOX 164
138 Pauline Street
BEARDMORE, Ontario
P0T-1G0

Telephone: (888) 415-9846
Fax: (877) 670-1555

Visit our website at:
www.gov.on.ca/MNDM/MINES/LANDS/mlsmnpge.htm

Dear Sir or Madam:

Submission Number: 2.19405

Status

Subject: Transaction Number(s): W9940.00102 Approval
W9940.00103 Approval

We have reviewed your Assessment Work submission with the above noted Transaction Number(s). The attached summary page(s) indicate the results of the review. **WE RECOMMEND YOU READ THIS SUMMARY FOR THE DETAILS PERTAINING TO YOUR ASSESSMENT WORK.**

If the status for a transaction is a 45 Day Notice, the summary will outline the reasons for the notice, and any steps you can take to remedy deficiencies. The 90-day deemed approval provision, subsection 6(7) of the Assessment Work Regulation, will no longer be in effect for assessment work which has received a 45 Day Notice. Allowable changes to your credit distribution can be made by contacting the Geoscience Assessment Office within this 45 Day period, otherwise assessment credit will be cut back and distributed as outlined in Section #6 of the Declaration of Assessment work form.

Please note any revisions must be submitted in DUPLICATE to the Geoscience Assessment Office, by the response date on the summary.

If you have any questions regarding this correspondence, please contact Lucille Jerome by e-mail at lucille.jerome@ndm.gov.on.ca or by telephone at (705) 670-5858.

Yours sincerely,



ORIGINAL SIGNED BY
Blair Kite
Supervisor, Geoscience Assessment Office
Mining Lands Section

Work Report Assessment Results

Submission Number: 2.19405

Date Correspondence Sent: July 12, 1999

Assessor: Lucille Jerome

Transaction Number	First Claim Number	Township(s) / Area(s)	Status	Approval Date
W9940.00102	1210760	ELMHIRST	Approval	July 12, 1999

Section:

9 Prospecting PROSP

10 Physical PMAN

Transaction Number	First Claim Number	Township(s) / Area(s)	Status	Approval Date
W9940.00103	1210760	ELMHIRST	Approval	July 12, 1999

Section:

10 Physical PSTRIIP

10 Physical PTRNCH

Work Report Assessment Results

Submission Number: 2.19405

Correspondence to:

Resident Geologist
Thunder Bay, ON

Assessment Files Library
Sudbury, ON

Recorded Holder(s) and/or Agent(s):

FRANKLIN ALFRED HOUGHTON
BEARDMORE, Ontario

PHILIP FRANKLYN HOUGHTON
BEARDMORE, Ontario

FRANKLIN ALFRED HOUGHTON
BEARDMORE, Ontario

PHILIP FRANKLYN HOUGHTON
BEARDMORE, Ontario

LEROY RICHARD CLARKE
BEARDMORE, Ontario

Notes

AREAS WITHDRAWN FROM DISPOSITION

M.R.O. - MINING RIGHTS ONLY
 S.R.O. - SURFACE RIGHTS ONLY
 M+S. - MINING AND SURFACE RIGHTS

NOTICE-
 The information that appears on this map has been compiled from various sources and accuracy is not guaranteed. Those wishing to make MINING CLAIMS should consult with the MINING RECORDER, Ministry of Northern Development and Mines, for additional information on the status of the lands shown hereon.

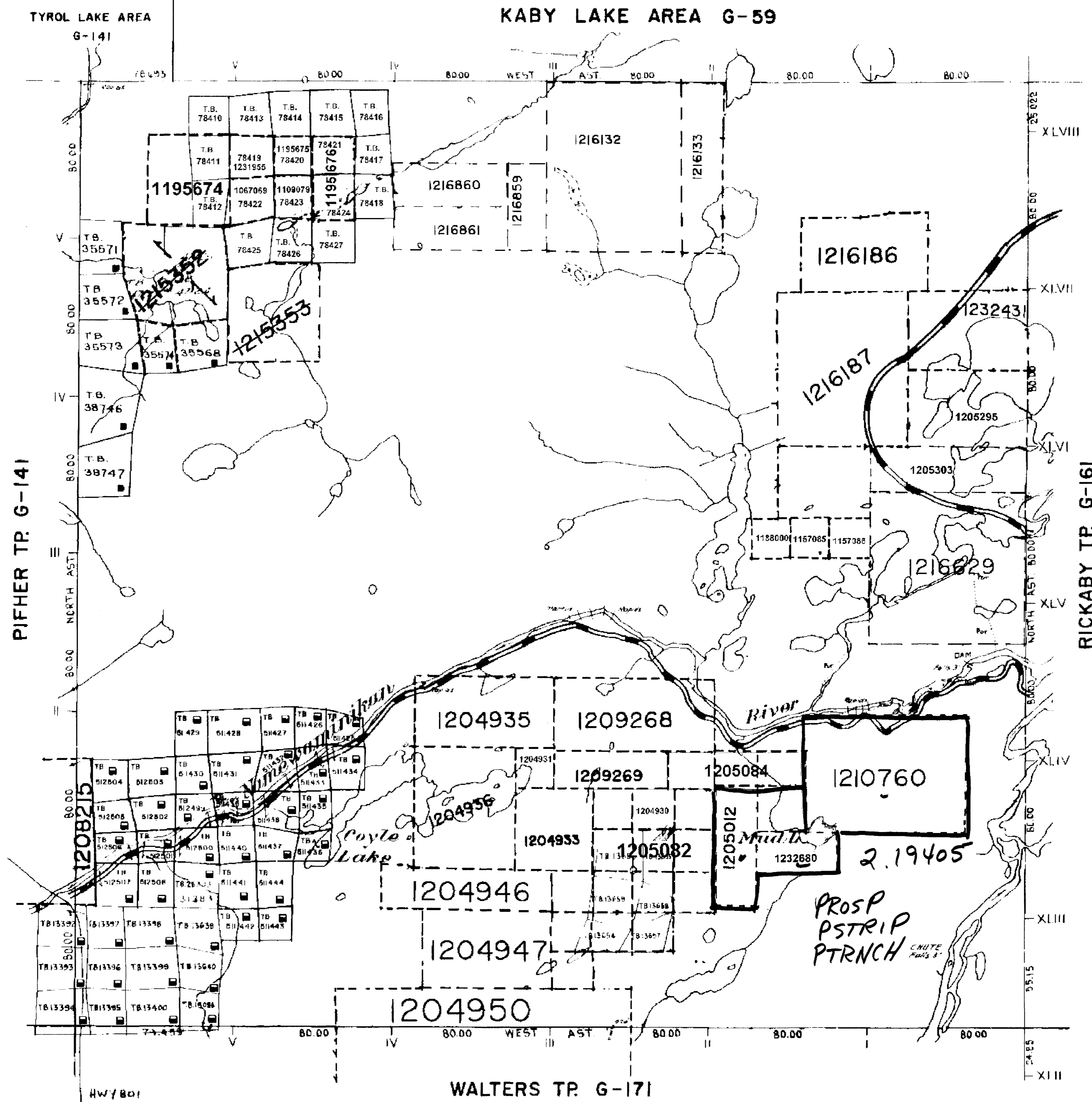

DISPOSITION OF CROWN LANDS

TYPE OF DOCUMENT	SYMBOL
PATENT, SURFACE & MINING RIGHTS	●
" SURFACE RIGHTS ONLY	○
" MINING RIGHTS ONLY	◐
LEASE, SURFACE & MINING RIGHTS	■
" SURFACE RIGHTS ONLY	□
" MINING RIGHTS ONLY	◑
LICENCE OF OCCUPATION	○
ORDER IN COUNCIL	OC
RESERVATION	○
CANCELLED	○
SAND & GRAVEL	○
LAND USE PERMITS FOR COMMERCIAL TOURISM, OUTPOST CAMPS	○

NOTE: MINING RIGHTS IN PARCELS PATENTED PRIOR TO MAY 6 1913, VESTED IN ORIGINAL PATENTEE BY THE PUBLIC LANDS ACT, R.S.O. 1970, CHAP. 380, SEC. 63, SUBSEC 1

LEGEND

HIGHWAY AND ROUTE No.	—+—
OTHER ROADS	—
TRAILS	- - -
SURVEYED LINES	—
TOWNSHIPS, BASE LINES, ETC.	—
LOTS, MINING CLAIMS, PARCELS, ETC.	—
UNSURVEYED LINES	- - -
LOT LINES	—
PARCEL BOUNDARY	—
MINING CLAIMS ETC.	—
RAILWAY AND RIGHT OF WAY	—+—
UTILITY LINES	—
NON-PERENNIAL STREAM	—
FLOODING OR FLOODING RIGHTS	—
SUBDIVISION OR COMPOSITE PLAN	—
RESERVATIONS	—
ORIGINAL SHORELINE	—
MARSH OR MUSKEG	—
MINES	✕
TRAVERSE MONUMENT	+

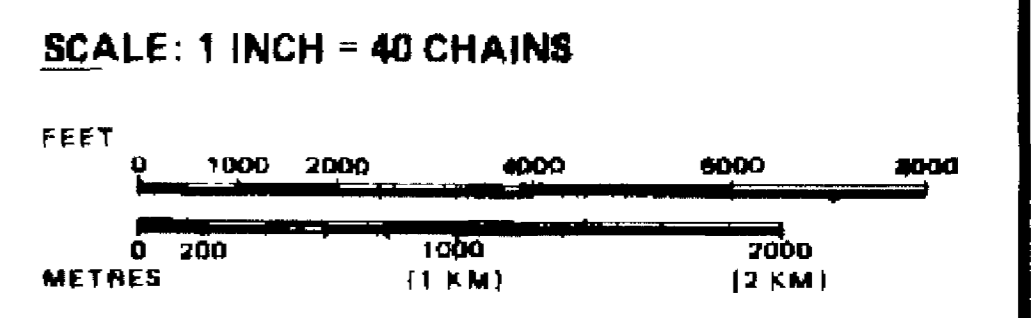

TOWNSHIP
ELMHIRST
 M.N.R. ADMINISTRATIVE DISTRICT
NIPIGON
 MINING DIVISION
THUNDER BAY
 LAND TITLES / REGISTRY DIVISION
THUNDER BAY

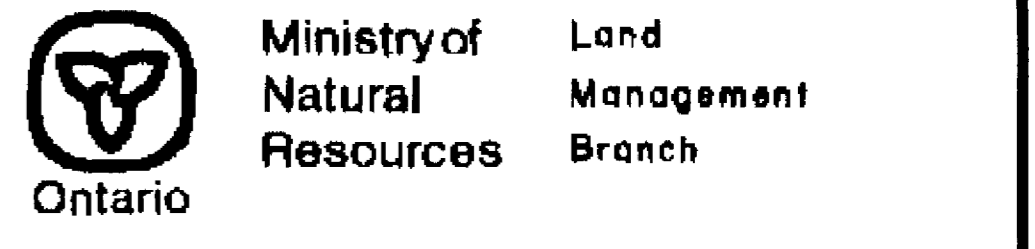

Date **JANUARY 28th, 1981** Number
 In Service Nov. 20/95. (LA) **G-162**

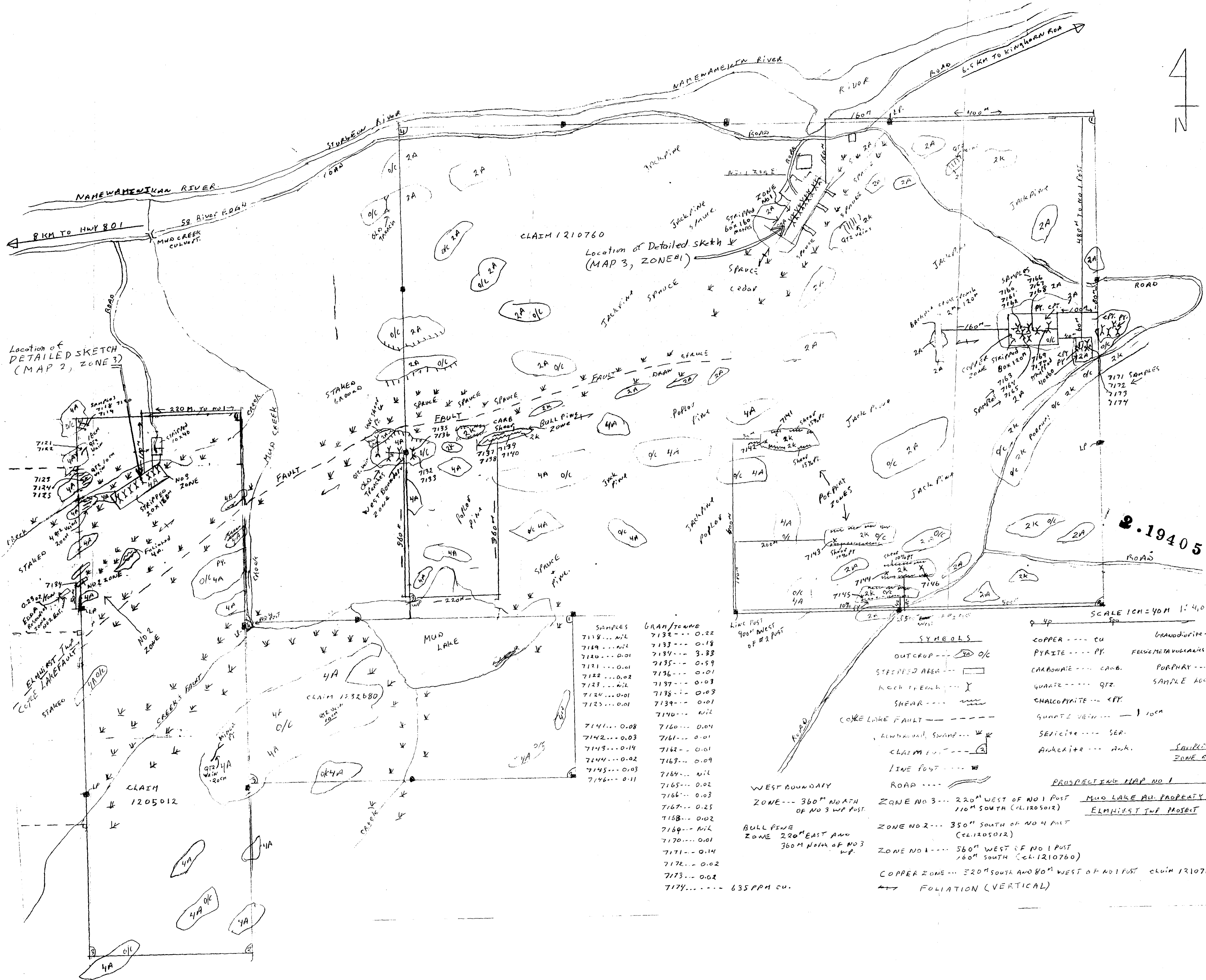

SAMPLES	GRAN/TENNE
7118... nil	7132... 0.22
7119... nil	7133... 0.18
7120... 0.01	7134... 3.33
7121... 0.01	7135... 0.59
7122... 0.02	7136... 0.01
7123... nil	7137... 0.03
7124... 0.01	7138... 0.03
7125... 0.01	7139... 0.01
	7140... nil
7141... 0.08	7160... 0.04
7142... 0.03	7161... 0.01
7143... 0.14	7162... 0.01
7144... 0.02	7163... 0.09
7145... 0.03	7164... nil
7146... 0.11	7165... 0.02
	7166... 0.03
	7167... 0.25
	7168... 0.02
	7169... nil
	7170... 0.01
	7171... 0.14
	7172... 0.02
	7173... 0.02
	7174... 635 PPM CU.

- SYMBOLS**
- OUTCROP --- 4A O/C
 - STRIPPED AREA --- [rectangle with diagonal lines]
 - ROCK FENCE --- [line with 'X' marks]
 - SHEAR --- [wavy line]
 - COKE LAKE FAULT --- [dashed line]
 - LOWLAND SWAMP --- [wavy line with 'W']
 - CLAIM --- [number in a box]
 - LINE POST --- [short vertical line]
 - ROAD --- [double line]

- COPPER --- CU
- PYRITE --- PY.
- CARBONATE --- CARB.
- QUARTZ --- QTZ.
- CHALCOPYRITE --- CPY.
- QUARTZ VEIN --- [line with 'Q']
- SERICITE --- SER.
- ANKERITE --- ANK.
- GRANODIORITE --- 4A
- FELIC METAVOLCANIC --- 2A
- PORPHYRY --- 2K.
- SAMPLE LOCATION --- 7115 X

SCALE 1CM = 40M 1:40,000

PROSPECTING MAP NO. 1

MUD LAKE AU. PROPERTY
ELMHIRST TWP PROJECT

WEST BOUNDARY
ZONE NO 3 --- 360' NORTH OF NO 3 WP POST

BULL PINE ZONE 220' EAST AND 360' NORTH OF NO 3 WP.

ZONE NO 2 --- 350' SOUTH OF NO 4 POST (CL. 1205012)

ZONE NO 1 --- 560' WEST OF NO 1 POST 160' SOUTH (CL. 1210760)

COPPER ZONE --- 520' SOUTH AND 80' WEST OF NO 1 POST CLAIM 1210760

FOLIATION (VERTICAL)

RECEIVED
APR 21 1999
GEOLOGICAL ASSESSMENT
OFFICE

SPRUCE

SPRUCE

SPRUCE + CEDAR

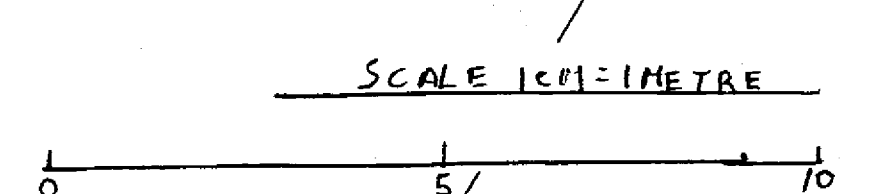

MAP NO. 2
CLAIM 1205012

ZONE NO. 3

AREA STRIPPED 72" TO 45" wide and 160' long
ZONE NO. 3 IS 220' WEST AND 110' SOUTH OF NO. 1 POST
CLAIM 1205012

LEGEND DETAILED SKETCH (MAP 2, ZONE 3)

- ANKERITE ---- ANK.
- CARBONATE ---- CARB.
- SERICITE ---- SER.
- SHEAR ---- SH.
- QTZ VEINS ---- QTZ
- MAGIC VOLCANIC ---- 1A
- BRANDIDORITE ---- 4A
- FOLDED QTZ VEINS ---- QTZ
- QUARTZ ---- QTZ
- PHYLLITE ---- PY.
- CALCOPRITE ---- CP.
- OLD TRENCH ----
- NEW TRENCH ----
- OVER BURDEN ---- O/B

2.19405 RECEIVED
APR 21 1999
GEOLOGICAL ASSESSMENT OFFICE

SAMPLES. GRAM/TONS		g/t Au	
7101	0.55	7153	74.40
7102	0.55	7154	1.06
7103	1.75	7155	33.98
7104	3.12	7156	0.12
7105	4.42	7157	0.03
7106	4.94	7158	1.90
7107	9.87	7159	6.07
7108	0.24	16989	0.99
7109	8.64	16990	8.40
7110	1.82	16991	8.43
7111	0.72	16992	4.32
7112	1.85		
7113	0.99		
7114	9.46		
7115	20.06		
7116	6.62		
7117	2.19		

1.5 M OF 16.48 G/T AU.
1.5 M OF 7.05 G/T AU.

50cm chip }
50cm chip }
50cm chip }

Mike Solberg chip samples
ML9804 1 metre 14.40 G/T
ML9805 1 metre 4.42 G/T
ML9806 40cm 5.38 G/T
ML9807 40cm 0.30 G/T
ML9808 1 metre 8.50 G/T

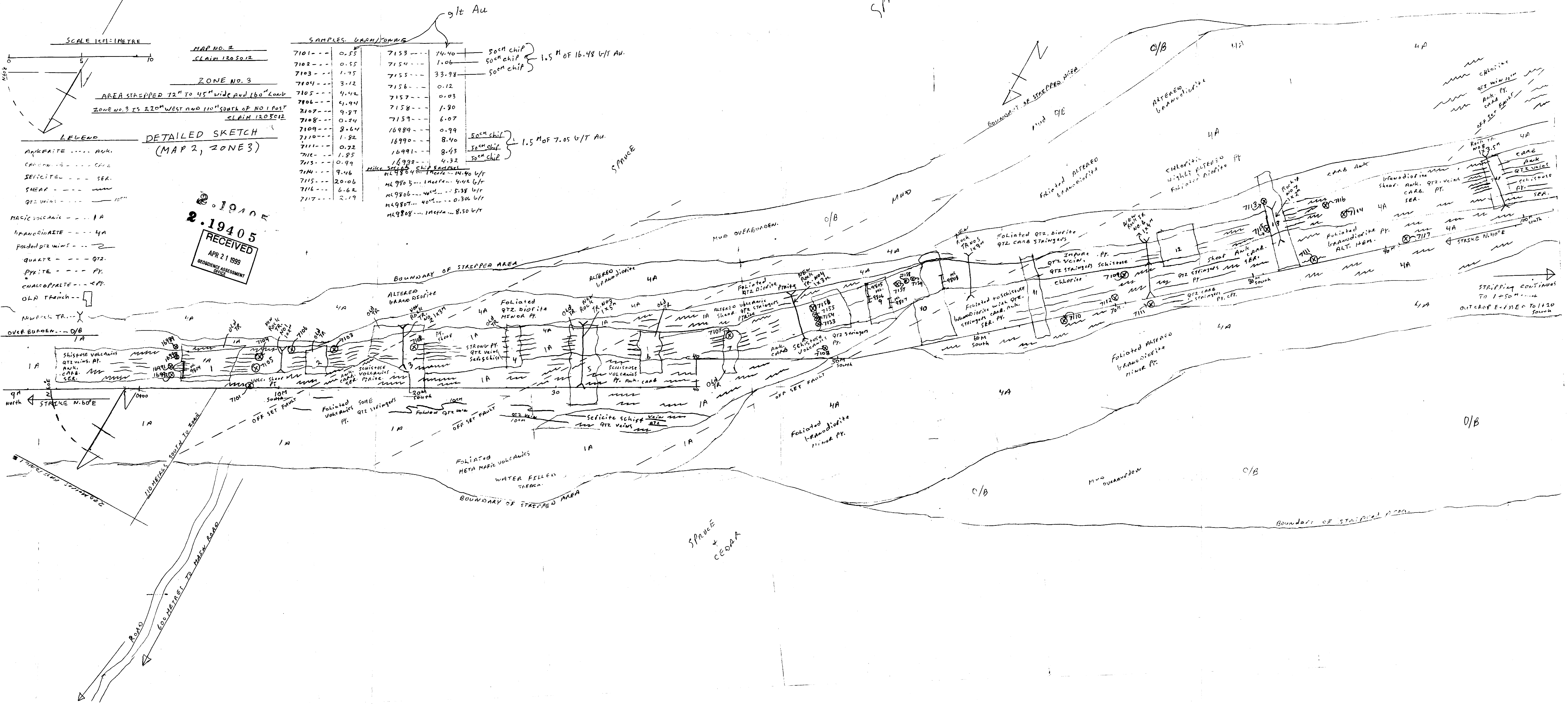



MAP NO 3 NO 1 ZONE
CLAIM 1210760

ZONE NO 1
560 METRES WEST
AND 160 METRES SOUTH
OF NO 1 POST CL 1210760

RECEIVED
APR 21 1999
GEOENGINEERING ASSESSMENT OFFICE

SAMPLES FOUND	ZONE NO 1 IS STRIPPED FROM 10M TO 60M WEST AND 160M SOUTH	DETAILED SKETCH (MAP #3, ZONE #1)	LEGEND
7.26 --- 26.50			VOLCANIC --- 2A
7127 --- 0.09			PERHAPS VOLCANIC --- 2A
7128 --- 52.53			FOLIATED --- 2A
7129 --- 66.86			SHEAR --- ---
7130 --- 0.37			CR. VEIN --- ---
7131 --- 58.05			CROSS CUTTING CR. VEIN ---
7147 --- 8.19			STRIPPED AREA ---
7148 --- 1.79			OLD TR. ---
7149 --- 17.93			NEW TR. ---
7150 --- 0.34			FR. ---
7151 --- 9.19			SMALL CR. ---
7152 --- 20.41			
7153 --- 23.73			
7154 --- 35.28			