



42F045E0003 11 MCGRAW LAKE

010

DIAMOND DRILLING

Area: McGrow lake

Report No: 11

WORK PERFORMED FOR: Norhada Inc. (Geco Division)

RECORDED HOLDER: SAME AS ABOVE [x]

: OTHER []

<u>CLAIM NO.</u>	<u>HOLE NO.</u>	<u>FOOTAGE</u>	<u>DATE</u>	<u>NOTE</u>
TB 864113	S-322	937'	Mar/87	(1)
	S-323	797'	April/87	(1)
TB 864120	S-324	967'	April/87	(1)
TB 864105	S-325	927'	April/87	(1)

NOTES: (1) #195-87 (filed in August/87)

DIAMOND DRILL HOLE LOG

S - 325 CONTINUED

HOLE NO.	S	325	CONTINUED	DESCRIPTION	FOOTAGE		ASSAY							
					FROM	TO	TOTAL	NUM.	%	CU	%	ZN	%	AU
				BLEACHED, RESEMBLES QUARTZ DIORITE FELDSPATHIC, SHEARED CONTACT.										
				210.0-211.5 QUARTZ-FELDSPAR-BIOTITE GNEISS, AS ABOVE.	217.0	218.0	1.0	81603	.00	.00	.00	.00	.000	
				214.5-216.0 QUARTZ-FELDSPAR-BIOTITE GNEISS, AS ABOVE.	231.0	233.0	2.0	81604	.00	.00	.00	.00	.000	
				231.0-240.5 HORNBLLENDE CHLORITE SCHIST, BLEACHED, FRAGMENTAL, ABUNDANT LAUMONTITE, FINE GRAINED.	238.0	239.0	1.0	81605	.00	.00	.00	.00	.000	
				245.0 WEAKLY FOLIATED AT 80 DEGREES TO CORE.	250.0	251.0	1.0	81606	.00	.00	.00	.00	.000	
				250.0-251.0 MOTTLED ANORTH.	255.0	257.0	2.0	81607	.00	.00	.00	.00	.000	
				255.0-257.0 HORNBLLENDE FELDSPAR GNEISS, AS ABOVE, 1-3% PYRITE.	258.5	259.5	1.0	81608	.00	.00	.00	.00	.000	
				258.5-259.5 QUARTZ STRINGERS WITH ILMENITE.										
				260.5-262.0 HORNBLLENDE CHLORITE SCHIST, VERY FINE GRAINED, DARK GREEN, DISCORDANT CONTACTS.										
267.0				307.0 HORNBLLENDE FELDSPAR SCHIST, FINE GRAINED, DARK GREEN TO BLACK.										
				270.0-272.0 QUARTZ-FELDSPAR-BIOTITE GNEISS, RESEMBLES QUARTZ DIORITE FELDSPATHIC.	290.0	291.0	1.0	81609	.00	.00	.00	.00	.000	
				282.0-290.0 HORNBLLENDE FELDSPAR SCHIST, DARK GREEN CHLORITE, SLIGHTLY SERICITIC, SHEARED CONTACT.	302.0	303.0	1.0	81610	.00	.00	.00	.00	.000	
				290.0-291.0 SMALL QUARTZ STRINGERS WITH PYRITE.										
				302.0-303.0 HORNBLLENDE FELDSPAR SCHIST, AS ABOVE, 1-3% PYRITE, PYRRHOTITE.										
307.0				361.0 HORNBLLENDE FELDSPAR GNEISS, MEDIUM GRAINED, WEAKLY FOLIATED, DARK GREEN TO BLACK, MAY BE A GABBRO.										
				314.0-323.0 HORNBLLENDE FELDSPAR SCHIST, FINE GRAINED, DARK GREEN.										
				315.0 5" FINE GRAINED QUARTZ-FELDSPAR-BIOTITE GNEISS.										
				318.0-320.0 QUARTZ-FELDSPAR-BIOTITE GNEISS, FINE GRAINED, PLATY, SLIGHTLY RESEMBLES A GECO QUARTZ DIORITE PLATY, LIGHT GREY TO BROWNISH.										
				326.0-330.0 QUARTZ-FELDSPAR-BIOTITE GNEISS, AS ABOVE, RESEMBLES A SEDIMENT.										
				342.0-343.0 QUARTZ-FELDSPAR-BIOTITE GNEISS, AS ABOVE, RESEMBLES A SEDIMENT.										
				354.0-361.0 FELDSPAR HORNBLLENDE GNEISS, COARSE GRAINED, MAY BE A MOTTLED ANORTHOSITE.										
361.0				455.0 HORNBLLENDE FELDSPAR GNEISS, MEDIUM TO FINE GRAINED, WEAKLY FOLIATED, 1-3% PYRITE, PYRRHOTITE.	364.0	365.0	1.0	81611	.00	.00	.00	.00	.000	
				385.0-387.0 HORNBLLENDE FELDSPAR GNEISS, WITH QUARTZ STRINGERS, MOTTLED, 5-8% PYRITE.	376.0	377.0	1.0	81612	.00	.00	.00	.00	.000	
				388.0-391.0 HORNBLLENDE FELDSPAR GNEISS, WITH QUARTZ STRINGERS, 1-3% PYRITE.	385.0	387.0	2.0	81613	.00	.00	.00	.00	.000	
				389.5 1" QUARTZ VEIN WITH PURPLE ANHYDRITE.	388.0	389.5	1.5	81614	.00	.00	.00	.00	.000	
				394.0-395.0 HORNBLLENDE FELDSPAR GNEISS, AS ABOVE, WITH 1/2" QUARTZ STRINGERS WITH PYRITE.	389.5	391.0	1.5	81615	.00	.00	.00	.00	.000	
				409.0-411.0 HORNBLLENDE FELDSPAR SCHIST, FINE GRAINED.	394.0	395.0	1.0	81616	.00	.00	.00	.00	.000	
				414.0-416.0 HORNBLLENDE FELDSPAR SCHIST, FINE GRAINED.										
				418.0-418.5 MASSIVE QUARTZ, POSSIBLE ANHYDRITE ALONG CONTACTS.	416.0	418.5	2.5	81617	.00	.00	.00	.00	.000	
				426.0-427.0 HORNBLLENDE FELDSPAR SCHIST, FINE GRAINED.										
				427.0-428.0 HORNBLLENDE FELDSPAR GNEISS, COARSE GRAINED, MINOR PYRITE.										
				433.0-436.5 FELDSPAR HORNBLLENDE GNEISS, VERY COARSE GRAINED, MOTTLED GABBRO, 1-3, LOCALLY 5-8% PYRITE, PYRRHOTITE.	436.0	438.5	2.5	81618	.00	.00	.00	.00	.000	

DIAMOND DRILL HOLE LOG

HOLE NO. S - 325 CONTINUED

FOOTAGE FROM	TO	DESCRIPTION	FOOTAGE FROM	TO	TOTAL NUM.	%	CU	%	ZN	%	AG	%	AU	ASSAY
615.0	632.0	607.0 2" QUARTZ STRINGERS. 608.0-615.0 HORNBLENDE CHLORITE BIOTITE GNEISS, MEDIUM GRAINED, INTERBEDDED WITH MEDIUM GRAINED FELDSPAR HORNBLENDE GNEISS.												
632.0	927.0	GABBRO, 50% PLAGIOCLASE, 50% HORNBLENDE, MINOR BIOTITE, QUARTZ, MEDIUM TO COARSE GRAINED, MASSIVE TEXTURE. GRANITE, MASSIVE, MEDIUM TO COARSE GRAINED, FRACTURED APPROX EVERY 5 TO 10', FRACTURES HAVE POTASSIUM FELDSPAR AND HEMATITE ENRICHMENT, GREY, LOCALLY SLIGHTLY PINK. 633.0-634.5 GRANITE WITH VERY COARSE GRAINED LATHS OF HORNBLENDE. 634.5 5" ZONE WITH 5-8% PYRITE. 706.0 SMALL 1/4" CALCITE STRINGERS. 723.0-1/2" HEMATITE CALCITE STRINGERS. 787.0-817.0 GRANITE, AS ABOVE, MORE FRACTURED, FRACTURED EVERY 1-2												
927.0		END OF HOLE.												

DIP TESTS:	FOOTAGE	ETCHED DIP	CORRECTED DIP
	200	65.0	58.0
	400	66.0	59.0
	600	66.0	59.0
	800	64.0	57.0

DIAMOND-DRILL HOLE LOG

HOLE J. S - 325 CONTINUED

FOOTAGE FROM	TO	DESCRIPTION	FOOTAGE		ASSAY					
			FROM	TO	CU %	ZN %	AG OZ/TN	AU OZ/TN		
		CHALCOPYRITE. 446.0-447.0 1" PEGMATITE VEIN.								
455.0	487.5	GABBRO, MOTTLED, VERY COARSE GRAINED, WEAKLY FOLIATED, 50% PLAGIOCLASE, 50% HORNBLLENDE, 1% SULPHIDES, LOCAL SMALL PEGMATITIC STRINGERS. 467.5 4" HORNBLLENDE SCHIST. 467.5-470.0 HORNBLLENDE BIOTITE SCHIST, FINE GRAINED. 470.0-472.0 GABBRO, ALTERED WITH BIOTITE STRINGERS, AT 470.0 3" BLEACHED ZONE. 477.0-478.0 BLEACHED, WITH EPIDOTE, SILICIFIED, MINOR FLUORAPATITE?.	458.5	459.5	1.0	81619	.00	.00	.00	.000
487.5	507.0	HORNBLLENDE CHLORITE BIOTITE SCHIST, FINE GRAINED, GREEN, WITH SERICITE. 487.5-490.0 QUARTZ FELDSPAR HORNBLLENDE BIOTITE GNEISS, LIGHT GREY. 503.0	490.0	493.0	3.0	81622	.00	.00	.00	.000
507.0	615.0	DIATREME BRECCIA; HORNBLLENDE BIOTITE GNEISS WITH LARGE FRAGMENTS OR REMNANTS OF COUNTRY ROCK, FRAGMENTS UP TO 4". 511.0-515.0 HORNBLLENDE BIOTITE FELDSPAR GNEISS, MASSIVE TEXTURE. 515.0-520.0 QUARTZ-FELDSPAR-BIOTITE GNEISS WITH HORNBLLENDE, FINE GRAINED, MASSIVE TEXTURE. 520.0-533.0 DIATREME BRECCIA, MOST OF MATRIX APPEARS TO BE QUARTZ FELDSPAR HORNBLLENDE BIOTITE GNEISS, MEDIUM GRAINED, FRAGMENTS ARE PREDOMINANTLY HORNBLLENDE CHLORITE SCHIST. 531.0-532.0 QUARTZ FELDSPAR HORNBLLENDE BIOTITE GNEISS, MEDIUM GRAINED. 533.0-542.0 HORNBLLENDE BIOTITE SCHIST, FINE GRAINED, WITH MINOR FRAGMENTS OF THE SAME. 533.0-534.5 QUARTZ FELDSPAR HORNBLLENDE BIOTITE GNEISS, AS ABOVE, SHEARED, SLIGHTLY SERICITIC. 534.5-535.0 3-5% PYRITE. 542.0-555.0 DIATREME BRECCIA, FELDSPAR HORNBLLENDE CHLORITE GNEISS MATRIX WITH HORNBLLENDE CHLORITE SCHIST FRAG UP TO 1", CLOSELY SPACED RESEMBLES A FRAGMENTAL. 545.0-1/2" EPIDOTE STRINGERS. 555.0-566.0 QUARTZ-FELDSPAR-BIOTITE GNEISS, COARSE GRAINED, MASSIVE TEXTURE, RESEMBLES GREY GRANITE. 563.0-564.0 HORNBLLENDE CHLORITE SCHIST REMNANT. 566.0-578.0 SIMILAR TO 542.0-555.0, SLIGHTLY MORE PLAGIOCLASE. 568.5 1/2" PYRITE, MAGNETITE STRINGERS. 578.0-588.0 FRAGMENTAL, AS ABOVE, BUT MORE PLAGIOCLASE, FRAG TO 1.5". 588.0-594.0 HORNBLLENDE BIOTITE GNEISS, CONTORTED FOLIATION. 594.0-608.0 DIATREME BRECCIA, FELDSPAR HORNBLLENDE BIOTITE MATRIX WITH HORNBLLENDE BIOTITE SCHIST FRAG, THERE ARE RELATIVELY FEW FRAGMENTS, FRAGMENTS UP TO 2". 602.0-602.5 HORNBLLENDE CHLORITE SCHIST. 603.5-608.0 FELDSPAR BIOTITE HORNBLLENDE GNEISS, MASSIVE, LIGHT GREY, MEDIUM GRAINED.	533.0	534.5	1.5	81626	.00	.00	.00	.000
			534.5	535.0	.5	81627	.00	.00	.00	.000
			547.0	549.0	2.0	81629	.00	.00	.00	.000
			563.0	564.0	1.0	81630	.00	.00	.00	.000
			568.0	569.0	1.0	81631	.00	.00	.00	.000

DIAMOND DRILL HOLE LOG

HOLE J. S - 325

CLAIM NO: 19-864105

CORE SIZE: 80

AREA: MCGRAW LAKE AREA (G-602)

COMMENCED: 12/04/87

CLAIM GROUP: 86-1

COMPLETED: 16/04/87

LOCATION:

LOGGED BY: F. BARKER

DIP: 60 DEG.

AZIMUTH: 240

LENGTH: 927 FT.

FOOTAGE FROM	TO	DESCRIPTION	FOOTAGE FROM	TO	TOTAL	NUM.	%	CU	ZN	AG	AU	
0	37.0	OVERBURDEN.										
37.0	44.0	SHEARED GABBRO, CHLORITE, ACTINOLITE?, HORNBLLENDE (SERPENTINIZED). 37.0-37.5 HORNBLLENDE FELDSPAR GNEISS. 37.5-38.5 QUARTZ-FELDSPAR-BIOTITE GNEISS, LIGHT GREY.										
44.0	267.0	HORNBLLENDE FELDSPAR GNEISS, COARSE GRAINED, DARK GREEN TO BLACK, MAY BE A MOTTLED GABBRO, WEAKLY FOLIATED. 49.0-50.0 QUARTZ-FELDSPAR-BIOTITE GNEISS, RESEMBLES QUARTZ-DIORITE FELDSPATHIC. 59.0-69.0 HORNBLLENDE FELDSPAR GNEISS, BLEACHED, SLIGHTLY SERICITIC, 1% SULPHIDES, TRACE CHALCOPYRITE. 72.0-74.0 BIFURCATED QUARTZITE, RESEMBLES BARREN IRON FORMATION. SEVERAL SMALL PYRITE, PYRRHOTITE, CHALCOPYRITE STRINGERS. 77.0-80.5 HORNBLLENDE CHLORITE GNEISS, VERY FINE GRAINED, SHEARED CONTACTS, LOCAL EPIDOTE FRACTURES. 80.5-82.0 CHLORITE SERICITE SCHIST, APPEARS TALCOSE, PROBABLE SHEAR ZONE. 82.0-83.5 QUARTZ-FELDSPAR-BIOTITE GNEISS, DARK WITH FELDSPAR EYES, RESEMBLES QUARTZ DIDRITE FELDSPATHIC. 83.5-85.0 HORNBLLENDE CHLORITE SCHIST. 102.0-103.0 QUARTZ-FELDSPAR-BIOTITE GNEISS, FINE GRAINED, LIGHT GREY. 103.0-105.0 QUARTZ FELDSPAR HORNBLLENDE BIOTITE GNEISS. 109.0-112.0 INTERBEDDED QUARTZ-FELDSPAR-BIOTITE GNEISS AND HORNBLLENDE FELDSPAR GNEISS. 117.0-120.0 HORNBLLENDE CHLORITE SCHIST, 1-3% PYRITE, PYRRHOTITE. 120.0-123.0 QUARTZ-FELDSPAR-BIOTITE GNEISS, RESEMBLES QUARTZ DIORITE FELDSPATHIC. 127.0 6" PEGMATITE WITH LAUMONTITE, CALCITE. 133.0-134.0 HORNBLLENDE FELDSPAR SCHIST, FINE GRAINED, BLACK. 135.5-190.0 DIABASE, FINE GRAINED, CONTACT APPEARS TO BE 50 DEGREES TO CORE. 135.5-136.0 CHILLED MARGIN, CONTACT AT 190.0 IS 25 DEGREES TO CORE. 203.0-205.5 QUARTZ-FELDSPAR-BIOTITE GNEISS, PALE GREY, EPIDOTE,	72.0	74.0	2.0	61601	0.00	0.00	0.00	0.00	0.00	0.000

all assays pending

ONTARIO GEOLOGICAL SURVEY
 ASSESSMENT FILES
 RESEARCH OFFICE
 MAY 27 1987
 RECEIVED

DIAMOND DRILL HOLE LOG

HOLE NO. S - 324 CONTINUED

FOOTAGE FROM	TO	DESCRIPTION	FOOTAGE				ASSAY								
			FROM	TO	TOTAL	NUM.	%	CU	ZN	AG	AU				
		DISCORDANT CONTACTS.													
		707.0-708.0 QUARTZ DIORITE FELDSPATHIC.													
		709.5-710.5 HORNBLLENDE FELDSPAR GNEISS, COARSE GRAINED WITH EPIDOTE PYRITE STRINGERS.	709.5	710.5	1.0	81597	.00	.00	.00	.00	.000				
		712.0-716.0 PEGMATITE, COARSE GRAINED, PINK.													
		719.5-721.0 PEGMATITE, COARSE GRAINED, WHITE.													
		721.5-722.0 QUARTZ-FELDSPAR-BIOTITE GNEISS, FINE GRAINED.													
		722.0-726.0 HORNBLLENDE FELDSPAR BIOTITE GNEISS, WITH FELDSPAR PHENOCRYSTS, COARSE GRAINED, DARK GREEN TO BLACK.													
		726.0-732.0 HORNBLLENDE FELDSPAR GNEISS, COARSE GRAINED, MASSIVE.													
		738.0-740.0 QUARTZ FELDSPAR HORNBLLENDE BIOTITE GNEISS, FINE GRAINED, GREY.													
		747.5-748.0 MASSIVE QUARTZITE OR APLITE.													
		748.0-750.5 HORNBLLENDE FELDSPAR GNEISS, FINE GRAINED, WITH LARGE FELDSPAR PHENOCRYSTS, RESEMBLES HEMLO PORPHYRY SILL. 749.5 4" CHLORITE SHEAR.													
		750.5-755.0 HORNBLLENDE FELDSPAR GNEISS, AA, WITH INTERBEDDED PEGMATITE.													
		755.0-759.5 PEGMATITE, COARSE GRAINED, PINK, MINOR MAGNETITE. 757.0 5" HORNBLLENDE FELDSPAR GNEISS, SHEARED.													
		765.5-767.5 PEGMATITE, FINE TO COARSE GRAINED, WHITE, LOCAL QUARTZ DIORITE FELDSPATHIC. 766.5 PEGMATITE WITH HORNBLLENDE CHLORITE SCHIST.													
		767.5-771.0 HORNBLLENDE FELDSPAR GNEISS. 769.0 2" BIOTITE SERICITE STRINGERS. 770.0 2" CHLORITE SHEAR.													
		771.0-776.0 PEGMATITE, COARSE GRAINED, PINK.													
776.0	819.5	HORNBLLENDE FELDSPAR SCHIST, LOCAL FRAGMENTS, LOCALLY CHLORITIC. 780.0-781.5 ANORTHOSITE?, PEGMATITIC. 782.5-783.5 BIOTITIC QUARTZITE. 796.0-797.0 ANORTHOSITE, WHITE WITH UNKNOWN HARD BLACK METALLIC MINERAL, POSSIBLY ILMENITE, WITH ALTERATION HALO SIMILAR TO 478.0. 799.5-800.5 ANORTH, WHITE. 801.5-804.5 ANORTH, GRADES TO PINKY COARSE GRAINED PEGMATITE. 810.0-812.0 HORNBLLENDE CHLORITE SCHIST, ALTERED, 30-50% MAGNETITE, 3-5% PYRITE. 814.0-817.0 GABBRO, MEDIUM GRAINED, GREEN, MASSIVE TEXTURE. 817.0-818.0 ANORTHOSITE/GABBRO, 3-5% PYRITE, POSSIBLE TRACE CHALCOPYRITE.	796.0	796.5	.5	81598	.00	.00	.00	.000					
819.5	849.0	ANORTHOSITE, VERY COARSE GRAINED, LARGE FELDSPAR PHENOCRYSTS, RARE GARNET, LOCALLY PEGMATITIC, LIGHT GREY TO WHITE, MINOR CHLORITE HORNBLLENDE STRINGERS. 824.0 5" HORNBLLENDE CHLORITE SHEAR. 833.0-835.5 CHLORITE SHEAR, LOCALLY SERPENTINIZED, COARSE GRAINED, LARGE SILIMANITIC OR FELDSPAR WISPS. 841.0-842.0 PEGMATITE, FINE TO MEDIUM GRAINED, PINK, SHEARED WITH ZEULITE. 842.0-843.0 HORNBLLENDE BIOTITE SCHIST. 848.0 4" HORNBLLENDE CHLORITE SHEAR.	817.0	818.0	1.0	81599	.00	.00	.00	.000					

DIAMOND DRILL HOLE LOG

HOLE NO. S - 324 CONTINUED

FOOTAGE TO FROM 849.0 876.5

DESCRIPTION

ANORTH, MEDIUM GRAINED, MOTTLED, FELDSPAR XTALS IN A HORNBLENDE CHLORITE GROUND MASS.
 857.0-858.0 QUARTZ-FELDSPAR-BIOTITE GNEISS, FINE GRAINED.
 862.5-863.0 QUARTZ-FELDSPAR-BIOTITE GNEISS, FINE GRAINED.
 865.5-868.5 QUARTZ-FELDSPAR-BIOTITE GNEISS, BIOTITIC QUARTZITE, FINE GRAINED.
 870.0-870.5 QUARTZ-FELDSPAR-BIOTITE GNEISS, FINE GRAINED.
 875.0-882.5 QUARTZ-FELDSPAR-BIOTITE GNEISS, SLIGHTLY RESEMBLES DARK QUARTZ DIORITE FELDSPATHIC.
 875.5-876.5 QUARTZ-FELDSPAR-BIOTITE GNEISS, DARK GREY.

876.5 899.0 ANORTH, WHITE TO BUFF, VERY COARSE GRAINED, ABUNDANT QUARTZ STRINGERS.
 894.0-896.0 QUARTZ-FELDSPAR-BIOTITE GNEISS.
 897.0-898.0 QUARTZ-FELDSPAR-BIOTITE GNEISS.

899.0 944.0 QUARTZ-FELDSPAR-BIOTITE GNEISS, MASSIVE TO COARSE GRAINED, LOCAL FELDSPAR EYES, LIGHT GREY, ABUNDANT SMALL PEGMATITE STRINGERS.
 900.0-901.0 ANORTH.
 904.5-905.5 PEGMATITE, COARSE GRAINED, PINK.
 907.0-908.0 ANORTH, BUFF, COARSE GRAINED.
 926.0-927.0 QUARTZ FELDSPAR HORNBLENDE BIOTITE GNEISS, RESEMBLES MEMLO PORPHYRY SILL.
 928.0-928.5 ANORTH, BUFF COLOURED.
 932.0-933.5 QUARTZ-FELDSPAR-BIOTITE GNEISS, PLATY, RESEMBLES QUARTZ DIORITE PLATY.
 933.5-935.5 ANORTH, SHEARED WITH PEGMATITE STRINGERS.
 937.0 FOLIATION 85 DEGREES TO CORE.
 940.5-943.0 SHEAR ZONE, HIGHLY CONFORMED CHLORITE SLIST WITH QUARTZ-FELDSPAR-BIOTITE GNEISS FRAGMENTS.

944.0 967.0 ANORTH, WHITE TO BUFF COLOURED, COARSE GRAINED.
 944.0-945.0 ANORTH, LARGE PYRITE XTAL.
 948.0-957.0 QUARTZ-FELDSPAR-BIOTITE GNEISS, RESEMBLES QUARTZ DIORITE FELDSPATHIC.
 959.0-962.0 QUARTZ-FELDSPAR-BIOTITE GNEISS, FINE GRAINED.
 960.0-961.0 HORNBLENDE FELDSPAR GNEISS.
 963.0-963.5 QUARTZ-FELDSPAR HORNBLENDE BIOTITE GNEISS.

967.0 .0 END OF HOLE.

FOOTAGE TO FROM TOTAL NUM. % ZN % AG AU

----- ASSAY -----

944.0 945.0 1.0 81600 .00 .00 .000

DIP TESTS:	FOOTAGE	ETCHED DIP	CORRECTED DIP
	200	67.0	60.0
	400	67.5	61.0
	600	68.0	61.5
	800	66.5	59.5
	967	66.0	59.0

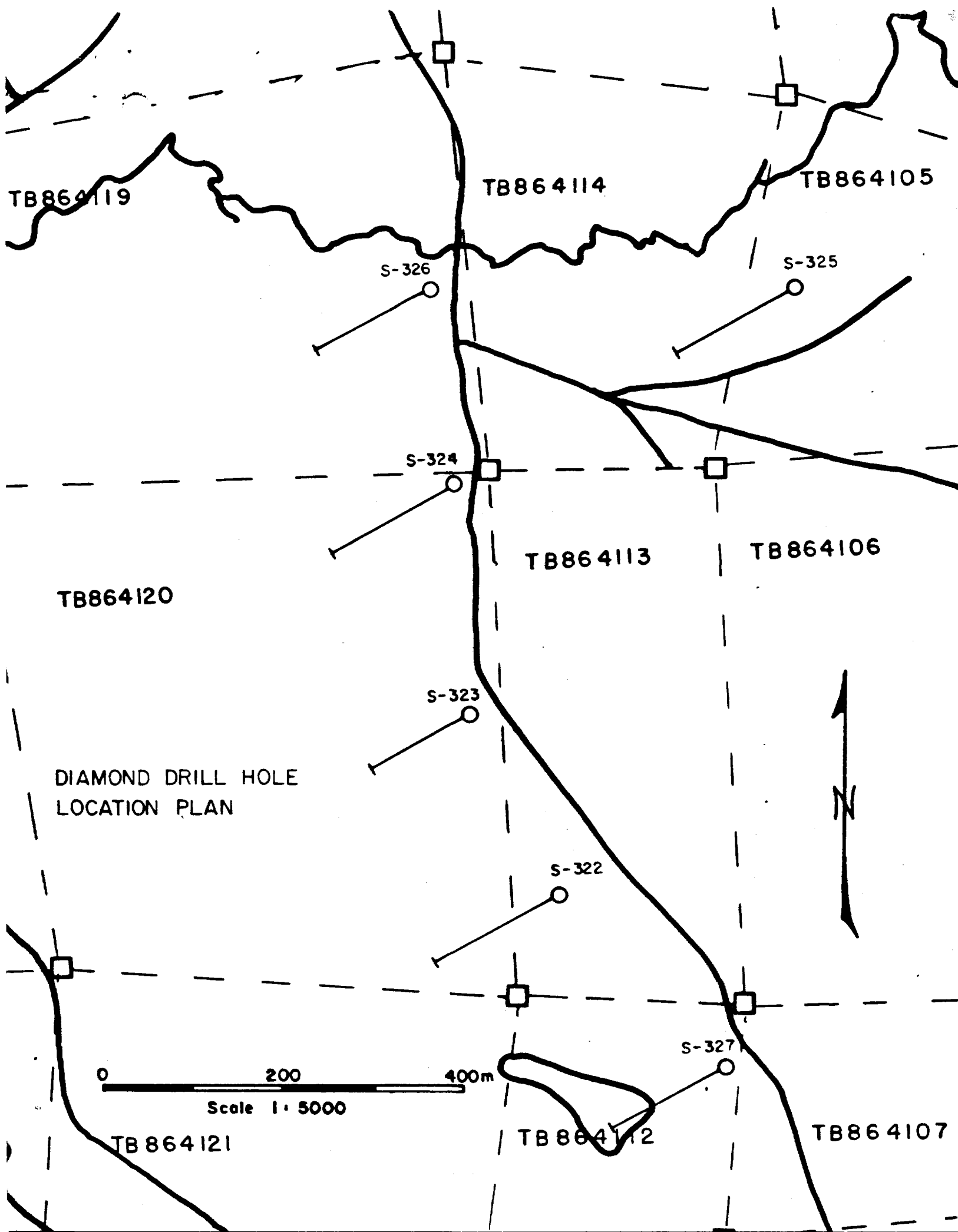

20/05/87

NORANDA INC. (GECO DIVISION)

PAGE 1

DIAMOND DRILL HOLE LOG

HOLE NO. S - 324

CLAIM NO. TB-864120

CORE SIZE: 39

AREA: MCGRAW LAKE AREA (G-6021)

COMMENCED: 5/04/87

CLAIM GROUP: 86-1

COMPLETED: 11/04/87

LOCATION:

LOGGED BY: F. BAKKER

DIP: 60 DEG.

AZIMUTH: 240

LENGTH: 967 FT.

FOOTAGE FROM	TO	DESCRIPTION
0	3.0	OVERBURDEN CASING DRIVEN TO 12'
3.0	71.5	FRAGMENTAL (AS MAPPED IN THE FIELD), INTERBEDDED QUARTZ-FELDSPAR-BIOTITE GNEISS LIGHT GREY AND QUARTZ FELDSPAR HORNBLLENDE BIOTITE GNEISS DARK, ABUNDANT FELDSPAR EYES THROUGHOUT, TRACE TO MINOR SULPHIDES.
71.5	140.0	QUARTZ-FELDSPAR-BIOTITE GNEISS, DARK GREY, DIRTY, ABUNDANT FELDSPAR EYES, NOT FOLIATED, PROBABLY MAPPED IN THE FIELD AS A GRANITE OR DIRTY SEDIMENT.
140.0	109.0	QUARTZ-FELDSPAR-BIOTITE GNEISS, FELDSPAR EYES, RESEMBLES QUARTZ DIORITE FELSPATHIC.
109.0	81.5	QUARTZ-FELDSPAR-BIOTITE GNEISS, SHEARED DARK GREY.
81.5	83.0	FRAGMENTAL, AS ABOVE.
83.0	83.0	QUARTZ-FELDSPAR-BIOTITE GNEISS, DARK GREY, MINOR HORNBLLENDE.
83.0	105.5	QUARTZ-FELDSPAR-BIOTITE GNEISS, HORNBLLENDE STRINGERS, SLIGHTLY SERICITIC.
105.5	107.0	QUARTZ-FELDSPAR-BIOTITE GNEISS, HORNBLLENDE STRINGERS, SLIGHTLY SERICITIC.
107.0	109.0	QUARTZ-FELDSPAR-BIOTITE GNEISS WITH FELDSPAR EYES.
109.0	110.0	QUARTZ-FELDSPAR-BIOTITE GNEISS AS IN 105.5-107.0.
110.0	127.0	QUARTZ-FELDSPAR-BIOTITE GNEISS AS IN 105.5-107.0.
127.0	134.0	QUARTZ-FELDSPAR HORNBLLENDE BIOTITE GNEISS, RESEMBLES QUARTZ DIORITE PLATY.

FOOTAGE FROM	TO	TOTAL	NUM.	CU %	ZN %	AG OZ/TN	AU OZ/TN

ASSAY

All assays pending

RECEIVED BY
 ENGINEERING DIVISION
 MAY 22 1987

2010133210000000

HOLE NO. S - 324 CONTINUED

DIAMOND-DRILL HOLE LOG

FOOTAGE

DESCRIPTION

FROM TO TOTAL NUM. % CU % ZN % AG % AU

----- ASSAY -----

FROM TO

140.0 172.5 QUARTZ-FELDSPAR-BIOTITE GNEISS, SIMILAR TO PREVIOUS, DARKER GREY, MINOR FELDSPAR EYES, MINOR HORNBLENDE STRINGERS.

FROM TO TOTAL NUM. % CU % ZN % AG % AU

140.0 4" QUARTZ-FELDSPAR-BIOTITE GNEISS RESEMBLES QUARTZ DIORITE FELDSPATHIC.

141.0-143.0 QUARTZ-FELDSPAR HORNBLENDE-BIOTITE GNEISS WITH HORNBLENDE STRINGERS, MINOR PYRITE.

146.5-147.5 QUARTZ-FELDSPAR-BIOTITE GNEISS WITH SOME HORNBLENDE, FINE GRAINED, BLACK, RESEMBLES QUARTZ DIORITE FELDSPATHIC.

155.5-156.5 QUARTZ DIORITE DENSE, AS ABOVE.

172.5 180.0

IRON FORMATION, SILICEOUS, HORNBLENDE, BIOTITE, MINOR FELDSPAR, 5-8% PYRRHOTITE, PYRITE, WITH MASSIVE STRINGERS OF MAGNETITE.

172.5 177.5 5.0 81551 .00 .00 .00 .000

177.0-180.0 NEAR MASSIVE MAGNETITE IN IRON FORMATION.

177.5 180.0 2.5 81552 .00 .00 .00 .000

180.0 192.0

QUARTZ-FELDSPAR-BIOTITE GNEISS, WITH MINOR HORNBLENDE, VERY DARK, ABUNDANT FELDSPAR EYES, RESEMBLES QUARTZ DIORITE FELDSPATHIC.

181.0 5" QUARTZ-FELDSPAR-BIOTITE GNEISS, DARK, RESEMBLES FINE GRAINED QUARTZ DIORITE DENSE.

187.0-189.0 QUARTZ-FELDSPAR HORNBLENDE-BIOTITE GNEISS, VERY FINE GRAINED, BLACK.

192.0 225.0

HORNBLENDE-BIOTITE-FELDSPAR-SCHIST, FINE GRAINED, DARK GREEN TO BLACK, BARREN TO MINOR SULPHIDES.

192.0-196.0 QUARTZ-FELDSPAR-BIOTITE GNEISS, LOCALLY WITH HORNBLENDE, LIGHT GREY, FINE GRAINED, RESEMBLES GECO 80, MINOR MAGNETITE.

202.5-204.0 QUARTZ-FELDSPAR-BIOTITE GNEISS, COARSE GRAINED WITH FELDSPAR EYES, RESEMBLES QUARTZ DIORITE FELDSPATHIC.

213.0-215.0 QUARTZ-FELDSPAR-BIOTITE GNEISS, AS ABOVE.

217.0-218.0 QUARTZ-FELDSPAR-BIOTITE GNEISS, FINE GRAINED, LIGHT GREY, MINOR HORNBLENDE STRINGERS, 1/2" MASSIVE PYRRHOTITE, PYRITE STRINGERS AT 218.0, FOLIATION 35 DEGREES TO CORE.

218.0-219.0 HORNBLENDE-BIOTITE FELDSPAR SCHIST, AS ABOVE, BUT WITH POSSIBLE SILLIMANITE BLENDS, 3-5% PYRRHOTITE, PYRITE, CHALCOPYRITE.

219.0-220.0 QUARTZ-FELDSPAR-BIOTITE GNEISS, COARSE GRAINED, VERY SMALL CHALCOPYRITE STRINGERS.

220.0-225.0 HORNBLENDE-BIOTITE FELDSPAR SCHIST, WITH SILLIMANITIC KNOTS, DARK GREEN TO BLACK.

225.0 275.0

QUARTZ-FELDSPAR-BIOTITE GNEISS, DARK, FELDSPAR EYES, SOMEWHAT RESEMBLES A DARK QUARTZ DIORITE FELDSPATHIC, ABUNDANT EPIDOTE FILLED SHEARS, TRACE TO MINOR SULPHIDES.

225.0-234.0 QUARTZ-FELDSPAR-BIOTITE GNEISS, FINE GRAINED, AS ABOVE, BUT WITH FEWER FELDSPAR EYES INCREASING TOWARDS 234.0.

247.0-248.0 QUARTZ-FELDSPAR-BIOTITE GNEISS, AS ABOVE, SLIGHTLY BLEACHED.

254.0 SMALL PYRITE STRINGERS WITH MOLYBDENITE.

254.5 2" QUARTZ-FELDSPAR STRINGERS WITH 3-5% PYRITE, CHALCOPYRITE.

254.5-263.0 QUARTZ-FELDSPAR-BIOTITE GNEISS, AS ABOVE, WITH 1-3% PYRRHOTITE, PYRITE, TRACE CHALCOPYRITE, LOCALLY UP TO 3-5%.

254.0 254.5 .5 81555 .00 .00 .00 .000

254.5 258.0 3.5 81556 .00 .00 .00 .000

258.0 258.5 .5 81557 .00 .00 .00 .000

HOLE J. S - 324 CONTINUED

DIAMOND DRILL HOLE LOG

FOOTAGE FROM TO

FOOTAGE FROM TO TOTAL NUM. % CU % ZN % AG % AU

----- ASSAY -----

258.0 4" ZONE WITH 3-5% PYRRHOTITE, PYRITE, LARGE BLOB OF MASSIVE PYRRHOTITE, MINDR CHALCOPYRITE.
258.0-263.0 QUARTZ-FELDSPAR-BIOTITE GNEISS, DARK, AS ABOVE, 1% PYRRHOTITE, PYRITE, MOSTLY IN SMALL STRINGERS.

263.0	313.0	QUARTZ-FELDSPAR-BIOTITE GNEISS WITH LESSER HORNBLENDE, GRADES TO BIOTITE QUARTZ FELDSPAR HORNBLENDE GNEISS, BLEACHED APPEARANCE, LIGHT GREY TO DARK GREY, VERY WEAKLY FOLIATED, OVERALL MASSIVE APPEARANCE, RESEMBLES AN ALTERED QUARTZ DIORITE DENSE, ABUNDANT FRACTURES AT 90 DEGREES TO CORE AND 45 DEGREES TO CORE.	271.0	273.0	2.0	81558	.00	.00	.00	.00	.000
304.0	306.0	QUARTZ-FELDSPAR-BIOTITE GNEISS WITH HORNBLENDE, AS ABOVE, SLIGHTLY MORE BLEACHED, MINDR SERICITE.	304.0	306.0	2.0	81559	.00	.00	.00	.00	.000
306.0	312.0	1" BLUE QUARTZ VEIN WITH MINDR CHALCOPYRITE.	306.0	312.0	6.0	81560	.00	.00	.00	.00	.000

313.0	412.0	IRON FORMATION, SILICEOUS, VERY MAGNETIC, CHLORITIC, HORNBLENDE BEARING SERICITE SURROUNDS MANY OF THE MAGNETIC BANDS LOGGALLY CONTORTED, LOCAL PYRRHOTITE, PYRITE, STRINGERS WITH TRACE CHALCOPYRITE, OVERALL UNIFORM APPEARANCE, BEDDING FOR THE MOST PART IS 80 DEGREES TO CORE, LOGGALLY INTERBEDDED WITH HORNBLENDE CHLORITE SCHIST, WHICH IS DARK GREEN, FINE GRAINED, WEAKLY MAGNETIC.	313.0	314.5	1.5	81560	.00	.00	.00	.00	.000
			314.5	316.5	2.0	81561	.00	.00	.00	.00	.000
			316.5	319.0	2.5	81562	.00	.00	.00	.00	.000
			319.0	320.0	1.0	81563	.00	.00	.00	.00	.000

314.5	316.5	QUARTZ-FELDSPAR-BIOTITE GNEISS, COARSE GRAINED, RESEMBLES QUARTZ DIORITE FELDSPATHIC.	322.0	322.0	2.0	81564	.00	.00	.00	.00	.000
316.5	319.0	HORNBLENDE CHLORITE SCHIST, AS ABOVE.	322.0	327.0	5.0	81565	.00	.00	.00	.00	.000
319.0	320.0	QUARTZ-FELDSPAR-BIOTITE GNEISS, RESEMBLES QUARTZ DIORITE FELDSPATHIC, AS ABOVE.	327.0	331.0	4.0	81566	.00	.00	.00	.00	.000
320.0	322.0	HORNBLENDE CHLORITE SCHIST, AS ABOVE.	331.0	332.0	1.0	81567	.00	.00	.00	.00	.000
322.0	325.0	5" QUARTZ-FELDSPAR-BIOTITE GNEISS, RESEMBLES QUARTZ DIORITE FELDSPATHIC.	332.0	335.0	3.0	81568	.00	.00	.00	.00	.000
331.0	332.0	IRON FORMATION, AS ABOVE, WITH 15% PYRRHOTITE.	335.0	339.5	4.5	81569	.00	.00	.00	.00	.000
335.0	339.5	QUARTZ-FELDSPAR-BIOTITE GNEISS, RESEMBLES QUARTZ DIORITE FELDSPATHIC.	339.5	344.5	5.0	81570	.00	.00	.00	.00	.000
340.0	343.0	HORNBLENDE CHLORITE SCHIST, AS ABOVE.	344.5	349.5	5.0	81571	.00	.00	.00	.00	.000
345.0	347.0	CONTORTED FOLIATION.	349.5	354.5	5.0	81572	.00	.00	.00	.00	.000
349.0	350.5	HORNBLENDE CHLORITE SCHIST, AS ABOVE.	354.5	359.5	5.0	81573	.00	.00	.00	.00	.000
353.0	355.0	IRON FORMATION, CONTORTED.	359.5	360.5	1.0	81574	.00	.00	.00	.00	.000
356.0	357.0	IRON FORMATION, AS ABOVE, 15-20% PYRRHOTITE, TRACE CHALCOPYRITE.	360.5	363.0	2.5	81575	.00	.00	.00	.00	.000
359.5	360.5	INTERBEDDED IRON FORMATION AND HORNBLENDE SCHIST, 10% PYRRHOTITE, SMALL PYRRHOTITE CHALCOPYRITE STRINGERS.	363.0	364.0	1.0	81576	.00	.00	.00	.00	.000
361.5	363.0	HORNBLENDE CHLORITE SCHIST AND BIOTITE SCHIST.	364.0	369.0	5.0	81577	.00	.00	.00	.00	.000
363.0	364.0	IRON FORMATION, AS ABOVE WITH 5% PYRITE, PYRRHOTITE, CHALCOPYRITE.	369.0	374.0	5.0	81578	.00	.00	.00	.00	.000
368.0	370.0	BIOTITE HORNBLENDE SCHIST.	374.0	379.0	5.0	81579	.00	.00	.00	.00	.000
373.0	374.0	4" HORNBLENDE CHLORITE SCHIST.	379.0	384.0	5.0	81580	.00	.00	.00	.00	.000
379.0	387.0	CONTORTED FOLIATION.	384.0	389.0	5.0	81581	.00	.00	.00	.00	.000
407.0	409.0	SMALL 1/2" QUARTZ STRINGERS WITH PYRRHOTITE.	389.0	394.0	5.0	81582	.00	.00	.00	.00	.000
			394.0	399.0	5.0	81583	.00	.00	.00	.00	.000
			399.0	404.0	5.0	81584	.00	.00	.00	.00	.000
			404.0	407.0	3.0	81585	.00	.00	.00	.00	.000
			407.0	407.5	.5	81586	.00	.00	.00	.00	.000

HOLE NO. S - 324 CONTINUED

DIAMOND DRILL HOLE LOG

FOOTAGE FROM TO

DESCRIPTION

FOOTAGE FROM	FOOTAGE TO	TOTAL NUM.	CU %	ZN %	AG OZ/TN	AU OZ/TN
407.5	412.0	4.5	81587	.00	.00	.00

----- ASSAY -----

412.0 452.0 HORNBLENDE CHLORITE BIOTITE FELDSPAR QUARTZ SCHIST, DARK GREEN TO BLACK, SMALL POSSIBLY SILLIMANITE WISPS, FINE GRAINED.

~~412.5 1.5m QUARTZ KNOT WITH PYRITE, PYRRHOTITE.~~

~~416.0 4m QUARTZ-FELDSPAR-BIOTITE GNEISS.~~

~~417.0-422.0 QUARTZ FELDSPAR HORNBLENDE BIOTITE GNEISS, DARK GREY, FINE GRAINED.~~

~~425.0-427.5 QUARTZ-FELDSPAR-BIOTITE GNEISS, FINE GRAINED, LIGHT GREY.~~

~~434.5 4m PEGMATITE, COARSE GRAINED, WHITE.~~

~~441.0 1m SHEARED PEGMATITE, ABUNDANT MOLYBDENITE.~~

~~447.0 FOLIATION 85 DEGREES TO CORE.~~

441.0 441.5 .5 81588 .00 .00 .00 .000

452.0 464.0 HORNBLENDE BIOTITE FELDSPAR GNEISS, MINOR FELDSPAR EYES, MEDIUM GRAINED, DARK GREY TO BLACK.

~~462.0 1.5m QUARTZ STRINGERS.~~

464.0 472.5 IRON FURMATION, SILICEOUS, ABUNDANT HORNBLENDE CHLORITE STRINGERS, 20-25% MAGNETITE.

467.5 6m HORNBLENDE CHLORITE SCHIST.

469.5 6m HORNBLENDE CHLORITE SCHIST, 3-8% PYRRHOTITE.

~~470.5-471.0 IRON FORMATION, AS ABOVE, 25% PYRRHOTITE, TRACE CHALCOPYRITE.~~

~~471.0-472.5 HORNBLENDE BIOTITE QUARTZITE, RESEMBLES IRON FORMATION WITHOUT THE SULPHIDES OR MAGNETITE.~~

464.0 467.0 3.0 81589 .00 .00 .00 .000
467.0 470.5 3.5 81590 .00 .00 .00 .000
470.5 471.0 .5 81591 .00 .00 .00 .000
471.0 472.5 1.5 81592 .00 .00 .00 .000

472.5 522.0 HORNBLENDE BIOTITE FELDSPAR SCHIST, SLIGHTLY SERICITIC, FINE GRAINED, DARK GREEN, LIGHT BROWN ALTERATION, 1-3% PYRITE, PYRRHOTITE, POSSIBLE TRACE CHALCOPYRITE.

478.0 UNKNOWN BLACK MINERAL WITH ALTERATION HALO, POSSIBLY ILMENITE.

492.0-501.0 HORNBLENDE CHLORITE FELDSPAR SCHIST, MEDIUM GRAINED, ABUNDANT SILLIMANITIC WISPS, DARK TO MEDIUM GREEN.

~~496.0 2m QUARTZ STRINGERS.~~

503.0-504.0 PEGMATITE, COARSE GRAINED, WHITE.

512.0-517.0 HORNBLENDE CHLORITE SCHIST, AS ABOVE IN 492.0-501.0.

522.0 537.0 HORNBLENDE CHLORITE SCHIST, FINE GRAINED, ALTERED, LOCALLY MOTTLED TEXTURE, BLEACHED APPEARANCE.

~~525.0 QUARTZ VEIN.~~

532.0-537.0 QUARTZ-FELDSPAR-BIOTITE GNEISS, RESEMBLES QUARTZ DIORITE FELDSPATHIC.

537.0 537.0 HORNBLENDE CHLORITE SCHIST, FINE GRAINED, ALTERED, LOCALLY MOTTLED TEXTURE, BLEACHED APPEARANCE.

~~525.0 QUARTZ VEIN.~~

532.0-537.0 QUARTZ-FELDSPAR-BIOTITE GNEISS, RESEMBLES QUARTZ DIORITE FELDSPATHIC.

537.0 578.0 HORNBLENDE CHLORITE SCHIST, FINE GRAINED, ALTERED, MOTTLED, LOCALLY FRAGMENTAL APPEARANCE, BLEACHED, 1-3% PYRRHOTITE, PYRITE WITH TRACE CHALCOPYRITE, LOCALLY 3-5%.

~~540.0 1 LARGE FELDSPAR XTAL 3/4".~~

~~554.0-555.0 3-5% PYRRHOTITE, PYRITE, MINOR CHALCOPYRITE.~~

~~555.0-555.5 HORNBLENDE SCHIST, 10-15% PYRRHOTITE, PYRITE, MINOR CHALCOPYRITE, 1 FLAKE MOLYBDENITE.~~

~~555.5-556.0 QUARTZ DIORITE FELDSPATHIC.~~

554.0 555.5 1.5 81593 .00 .00 .00 .000

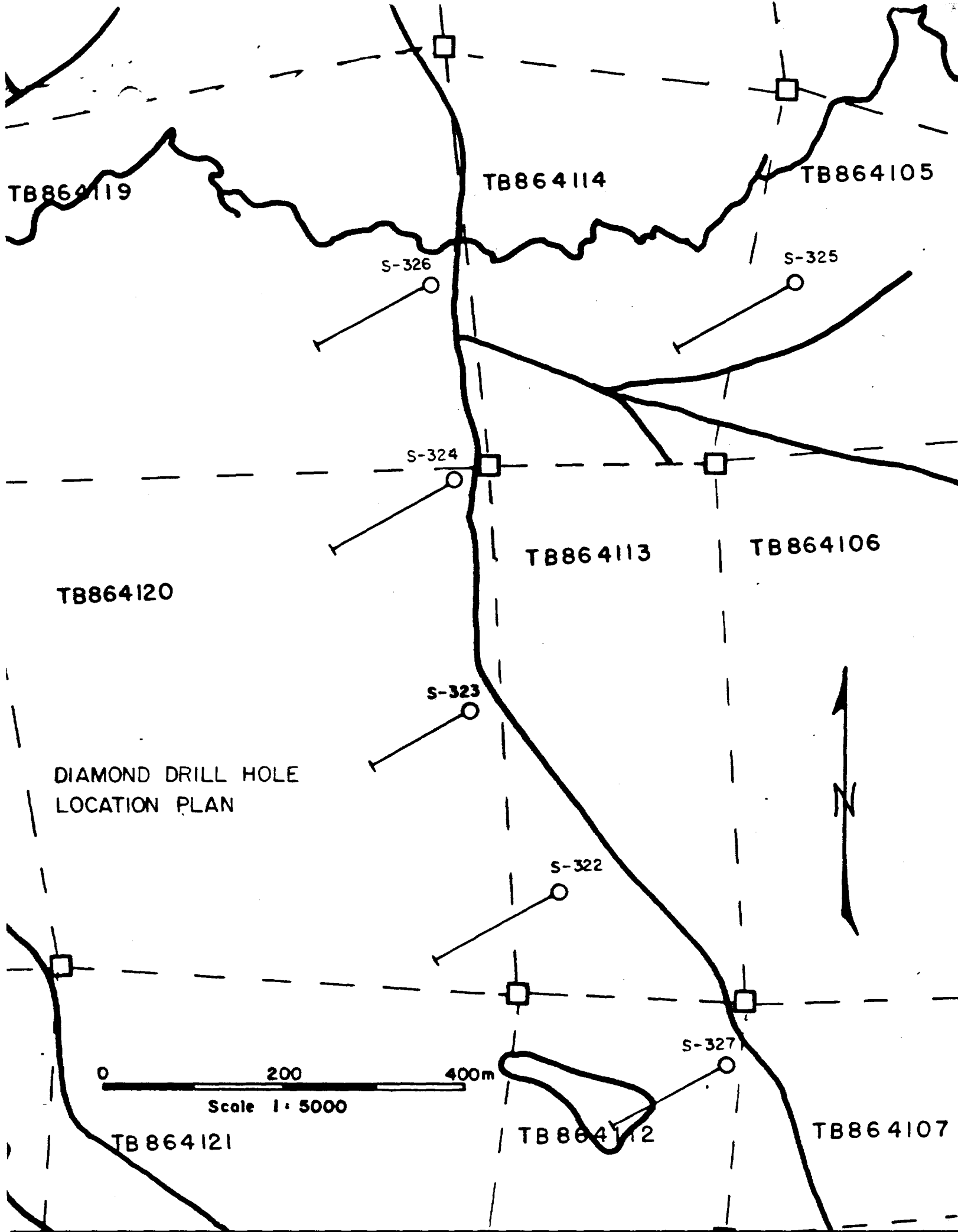

DIAMOND DRILL HOLE LOG

HOLE NO. S - 323 CONTINUED

FOOTAGE FROM	TO	DESCRIPTION	FOOTAGE FROM	TO	TOTAL NUM.	CU %	ZN %	AG OZ/TN	AU OZ/TN
590.0	605.0	HORNBLLENDE BIOTITE FELDSPAR GNEISS, BLEACHED TO A GREY GREEN GNEISS, MOTTLED. 593.5-595.0 PEGMATITE, GRANITE, POTASSIUM FELDSPAR ENRICHED, PLUS CALCITE. 597.0 6" PEGMATITE, COARSE GRAINED, WHITE. 600.0 FOLIATION 85 DEGREES TO CORE. 600.0-601.5 HORNBLLENDE BIOTITE FELDSPAR GNEISS, VERY COARSE GRAINED, ALTERED. 601.5-5" PEGMATITE, COARSE GRAINED, WHITE. 603.0 3" PEGMATITE, WHITE, COARSE GRAINED, MINOR MAGNETITE.							
605.0	624.5	HORNBLLENDE BIOTITE QUARTZ FELDSPAR SCHIST, FINE GRAINED, MOTTLED, INTERBEDS, POSSIBLE FRAGMENTAL, TRACE SULPHIDES. 608.5-609.5 QUARTZ-FELDSPAR-BIOTITE GNEISS, MINOR GARNET. 620.0-621.0 QUARTZ-FELDSPAR-BIOTITE GNEISS, SLIGHTLY SERICITIC, DISCORDANT TO COUNTRY ROCKS. 623.5-624.5 INTERBEDDED HORNBLLENDE GNEISS AND PEGMATITE, ABUNDANT ZEOLITE.							
624.5	647.0	HORNBLLENDE (BIOTITE) FELDSPAR SCHIST, DARK GREEN TO BLACK, SLIGHTLY MOTTLED, ABUNDANT QUARTZ STRINGERS, TRACE SULPHIDES. 627.0-627.5 PEGMATITE, MEDIUM GRAINED, WHITE. 630.0 PLAGIOCLASE PHENOCRYSTS, UP TO 1/4". 631.0-636.0 HORNBLLENDE BIOTITE GNEISS, AS ABOVE, BUT BLEACHED. 637.5 SMALL CHALCOPYRITE STRINGERS. 639.0-644.0 PEGMATITE, WHITE, MEDIUM GRAINED, GRADES TO QUARTZ-DIOKITE-FELDSPATHIC. 639.5-640.5 HORNBLLENDE SCHIST, COARSE GRAINED, ALTERED. 644.0-645.0 HORNBLLENDE FELDSPAR GNEISS, VERY COARSE GRAINED. 647.0-6" PEGMATITE, MEDIUM TO COARSE GRAINED, WHITE.							
647.0	683.5	HORNBLLENDE (BIOTITE) FELDSPAR SCHIST, DARK GREEN TO BLACK, MOTTLED, POSSIBLE FRAGMENTAL, LOCAL CHLORITIC HORNBLLENDE KNOTS, MINOR SULPHIDES. 664.0 2" PEGMATITE. 667.0 4" CHLORITIC SHEARED WITH SERICITE. 668.0-669.0 PEGMATITE, MEDIUM TO COARSE GRAINED, WHITE. 670.5 2" ZONE WITH 10% PYRRHOTITE, PYRITE. 675.5-676.5 PEGMATITE, COARSE GRAINED, WHITE. 681.5-683.5 QUARTZ-FELDSPAR-BIOTITE GNEISS, FINE GRAINED, GRADES TO BIOTITIC QUARTZITE, SERICITIC NEAR CONTACTS.							
683.5	708.0	HORNBLLENDE CHLORITE FELDSPAR SCHIST, MEDIUM GRAINED WITH LOTS OF MASSIVE HORNBLLENDE AND CHLORITE. 683.5-686.0 INTERBEDDED HORNBLLENDE CHLORITE SCHIST AND FINE GRAINED QUARTZ-FELDSPAR-BIOTITE GNEISS. 687.0-688.0 HORNBLLENDE GNEISS, VERY COARSE GRAINED, MINOR SERICITE.							

DIAMOND DRILL HOLE L96

HOLE NO. S - 323

CLAIM NO: JB-864113

CORE SIZE: 80

AREA: MCGRAW LAKE (G-602)

COMMENCED: 1/04/87

CLAIM GROUP: 86-1

COMPLETED: 4/04/87

LOCATION:

LOGGED BY: BAKKER/GAGNON

DIP: 60 DEG.

John Ferguson

AZIMUTH: 240

LENGTH: 797 FT.

FOOTAGE FROM	TO	DESCRIPTION	FOOTAGE		TOTAL		ASSAY								
			FROM	TO	NUM.	%	CU	ZN	AG	AU					
0.0	5.0	OVERBURDEN, CASING DRIVEN TO 12.													
5.0	23.0	INTERBEDDED QUARTZ-FELDSPAR-BIOTITE GNEISS AND HORNBLende GNEISS, POSSIBLY FRAGMENTAL, OVERALL MOTTLED, DARK GREY TO BLACK, FINE GRAINED. 6.0-8.5 AS ABOVE, BUT WITH FELDSPAR EYES.	22.0	22.5	.5	81510	.00	.00	.00	.00	.00	.00	.00	.00	.00
23.0	47.0	QUARTZ BIOTITE GNEISS, RESEMBLES GECO BIOTITIC QUARTZITE, DIRTY GREY, 10-15% PYRRHOTITE, PYRITE (CPY), GRADES TO IRON FORMATION, LOCALLY VERY MAGNETIC. 23.5-24.5 HORNBLende FELDSPAR DIKE, COARSE GRAINED, DARK GREEN. 26.0 3" ZONE OF NEAR MASSIVE GARNET AND MAGNETITE. 34.0-36.0 HORNBLende BIOTITE SCHIST, FINE GRAINED, DARK GREEN TO BLACK.	22.5	24.0	1.5	81511	.00	.00	.00	.00	.00	.00	.00	.00	.00
			24.0	29.0	5.0	81512	.00	.00	.00	.00	.00	.00	.00	.00	.00
			29.0	34.0	5.0	81513	.00	.00	.00	.00	.00	.00	.00	.00	.00
			34.0	36.0	2.0	81514	.00	.00	.00	.00	.00	.00	.00	.00	.00
			36.0	39.0	3.0	81515	.00	.00	.00	.00	.00	.00	.00	.00	.00
			39.0	41.0	2.0	81516	.00	.00	.00	.00	.00	.00	.00	.00	.00
			41.0	45.0	4.0	81517	.00	.00	.00	.00	.00	.00	.00	.00	.00
			45.0	47.0	2.0	81518	.00	.00	.00	.00	.00	.00	.00	.00	.00
47.0	82.5	QUARTZ-FELDSPAR-BIOTITE GNEISS, FINE GRAINED, DARK GREY, RESEMBLES QUARTZ DIORITE DENSE AND PLATY, LOCAL FELDSPAR EYES. 47.0-56.0 QUARTZ DIORITE FELDSPATHIC OR QUARTZ-FELDSPAR-BIOTITE GNEISS, VERY COARSE GRAINED, ABUNDANT ALTERED EPIDOTE SHEARS. 56.0-58.5 HORNBLende FELDSPAR GNEISS, COARSE GRAINED, DARK GREEN TO BLACK, ABUNDANT SILLIMANITIC EYES (PROBABLY FSPR). 62.0-64.0 HORNBLende FELDSPAR GNEISS, AS ABOVE. 67.0-71.0 HORNBLende FELDSPAR GNEISS, AS ABOVE.													
82.5	111.0	FRAGMENTAL?, INTERBEDDED HORNBLende BIOTITE GNEISS AND QUARTZ-FELDSPAR-BIOTITE GNEISS. 92.0-97.0 FRAGMENTAL, GRADES TO IRON FORMATION, 15-20% PYRRHOTITE, PYRITE, (CPY), MAGNETITE. 97.0-102.5 HORNBLende SCHIST, DARK GREEN, FRACTURED. 101.0 CHALCOPYRITE FILLED SHEARS. 102.5-107.5 QUARTZ-FELDSPAR-BIOTITE GNEISS, RESEMBLES	92.0	97.0	5.0	81519	.00	.00	.00	.00	.00	.00	.00	.00	.00
			97.0	102.0	5.0	81520	.00	.00	.00	.00	.00	.00	.00	.00	.00

all assays pending

RECEIVED
MAY 29 1987

DIAMOND DRILL HOLE LOG

HOLE NO. S - 323 CONTINUED

FOOTAGE FROM	TO	DESCRIPTION	FOOTAGE				ASSAY			
			FROM	TO	TOTAL	NUM.	%	CU	ZN	AG
						OZ/TN				
690.0-690.5		HORNBLLENDE GARNET GNEISS, VERY CHLORITIC.								
690.5-691.0		PEGMATITE, FINE TO MEDIUM GRAINED, WHITE, GRADES TO FOLIATED GRANITE.								
692.0-694.0		HORNBLLENDE FELDSPAR GNEISS, VERY COARSE GRAINED.								
696.5-697.5		HORNBLLENDE FELDSPAR GNEISS, AS ABOVE, GARNETIFEROUS.								
699.0-700.0		PEGMATITE, MEDIUM TO COARSE GRAINED, WHITE TO PINK.								
700.0-703.0		HORNBLLENDE CHLORITE SCHIST, VERY COARSE GRAINED, 15-20% MAGNETITE, LOCALLY MASSIVE, 3-5% PYRRHOTITE, PYRITE, CHALCOPYRITE STRINGERS.	700.0	704.0	4.0	81544	.00	.00	.00	.000
700.5		2" MASSIVE MAGNETITE.	704.0	708.0	4.0	81545	.00	.00	.00	.000
702.0		2" MASSIVE MAGNETITE.	708.0	711.0	3.0	81546	.00	.00	.00	.000
702.0		4" PEGMATITE, MEDIUM TO COARSE GRAINED, WHITE TO PINK.	711.0	714.5	3.5	81547	.00	.00	.00	.000
702.5-703.0		50% MAGNETITE.								
704.0-708.0		PEGMATITE, MEDIUM TO COARSE GRAINED, WHITE TO PINK.								
706.0		4" HORNBLLENDE CHLORITE SCHIST REMNANT.								
708.0	714.5	HORNBLLENDE CHLORITE (SERICITIC) SCHIST, SHEARED, ALTERED, OCCASIONAL FELDSPAR EYES ALTERED TO EPIDOTE?, ABUNDANT QUARTZ AND PYRITE FILLED TENSION GASHES.								
711.0		4" QUARTZ-FELDSPAR-BIOTITE GNEISS, SHEARED.								
711.0-712.5		CHLORITE SHEAR, BADLY BROKEN.								
712.5-713.5		GRANITIZED QUARTZ-FELDSPAR-BIOTITE GNEISS.								
714.5		4" QUARTZ-FELDSPAR-BIOTITE GNEISS.								
714.5	748.0	ANDRTHOSITE?, DARK, COARSE GRAINED, HORNBLLENDE CHLORITE FELDSPAR GNEISS, LOCAL SERICITIC STRINGERS, ABUNDANT CHLORITE ALTERATION, GREY TO TAN TO DIRTY WHITE.								
714.5-716.5		ANDRTHOSITE, AS ABOVE WITH SERICITIC STRINGERS.								
716.5-718.0		QUARTZ-FELDSPAR-HORNBLLENDE-BIOTITE GNEISS, FINE GRAINED, RESEMBLES QUARTZ DIORITE DENSE, OCCASIONAL CHALCOPYRITE FLECKS.								
718.0-719.0		PEGMATITE, COARSE GRAINED, WHITE, GRADES TO GRANITE, VERY MINOR GARNET.								
719.0-723.5		ANDRTHOSITE, AS ABOVE, WITH SERICITIC STRINGERS.								
723.5-725.0		QUARTZ-FELDSPAR-BIOTITE GNEISS, FINE GRAINED, DARK GREY, RARE GARNET.								
724.0		4" PEGMATITE, WITH GARNET.								
727.5-729.5		GARNETIFEROUS QUARTZ-FELDSPAR-BIOTITE GNEISS, FINE GRAINED, ABUNDANT EPIDOTE ALTERATION.								
729.5-730.0		PEGMATITE, MEDIUM TO COARSE GRAINED, WHITE.								
730.0-732.0		QUARTZ-FELDSPAR-BIOTITE GNEISS, DARK GREY, RESEMBLES QUARTZ DIORITE DENSE.								
732.0-733.5		ANDRTHOSITE, VERY COARSE GRAINED, LARGE HORNBLLENDE XTALS, ONE 1/2" MOLYBDENITE XTAL, MINOR SMALL XTALS OF MOLYBDENITE, 3% PYRITE.	732.0	733.5	1.5	81548	.00	.00	.00	.000
733.5-739.0		QUARTZ-FELDSPAR-BIOTITE GNEISS, FINE GRAINED, DARK GREY, RESEMBLES QUARTZ DIORITE DENSE.								
739.0-739.5		CHLORITE SCHIST, 3% PYRITE, VUGGY.	739.0	739.5	.5	81549	.00	.00	.00	.000
739.5-740.5		QUARTZ DIORITE DENSE.								
740.5-741.5		FINE GRAINED HORNBLLENDE-BIOTITE SCHIST.								
743.0-743.5		QUARTZ-FELDSPAR-BIOTITE GNEISS, FINE GRAINED.								
744.5-745.0		ANDRTHOSITE WITH QUARTZ STRINGERS, 1-3% MOLYBDENITE.	744.0	745.0	1.0	81550	.00	.00	.00	.000

DIAMOND DRILL HOLE LOG

HOLE NO. J. S - 323 CONTINUED

FOOTAGE FROM	TO	TOTAL NUM.	%	CU	%	ZN	%	AG	AU
748.0	797.0								

DESCRIPTION

MOLYBDENITE XTALS UP TO 1/3".
 748.0-747.0 QUARTZ-FELDSPAR-BIOTITE GNEISS, COARSE GRAINED.
 747.0-746.0 HORNBLENDE BICITITE FELDSPAR GNEISS.
 748.0-797.0 QUARTZ-FELDSPAR-BIOTITE GNEISS, COARSE GRAINED, WEAKLY FOLIATED, LIGHT GREY, ABUNDANT FELDSPAR EYES, (MAY HAVE BEEN MAPPED AS GRANITE ON SURFACE), LOCAL FINE GRAINED PHASES.
 749.5-750.0 PEGMATITE, COARSE GRAINED, PINK.
 750.0 2" ANDRTHOSITE.
 753.0-754.0 PEGMATITE, MEDIUM TO COARSE GRAINED, WHITE.
 759.0-760.0 QUARTZ-FELDSPAR-BIOTITE GNEISS, VERY FELSIC, GRADES TO PEGMATITE.
 762.0-763.0 QUARTZ-FELDSPAR-BIOTITE GNEISS, FINE GRAINED, RESEMBLES QUARTZ-DIORITE DENSE.
 767.0 6" QUARTZ DIORITE DENSE.
 772.0 6" ANDRTH.
 776.0-777.0 HORNBLENDE BICITITE FELDSPAR QUARTZ GNEISS.
 787.0-787.5 PEGMATITE, VERY COARSE GRAINED, PINK.
 787.5-789.0 QUARTZ-FELDSPAR-BIOTITE GNEISS, VERY FINE GRAINED, RESEMBLES BICITITIC QUARTZITE.

797.0 .0 END OF HOLE.

DIP TESTS:	FOOTAGE	ETCHED DIP	CORRECTED DIP
	200	67.0	60.0
	400	65.0	58.0
	600	66.0	59.0
	797	64.0	57.0

DIAMOND DRILL HOLE LOG

HOLE NO. 5 - 323 CONTINUED

FOOTAGE TO FROM TO TOTAL NUM. % CU % ZN % AG AU OZ/TN OZ/TN

----- ASSAY -----

748.0 797.0 QUARTZ-FELDSPAR-BIOTITE GNEISS, COARSE GRAINED, WEAKLY FOLIATED,

LIGHT GREY, ABUNDANT FELDSPAR EYES, (MAY HAVE BEEN MAPPED AS

GRANITE ON SURFACE), LOCAL FINE GRAINED PHASES.

749.5-750.0 PEGMATITE, COARSE GRAINED, PINK.

750.0 2" ANORTHOISITE.

753.0-754.0 PEGMATITE, MEDIUM TO COARSE GRAINED, WHITE.

759.0-760.0 QUARTZ-FELDSPAR-BIOTITE GNEISS, VERY FELSIC, GRADES

TO PEGMATITE.

762.0-763.0 QUARTZ-FELDSPAR-BIOTITE GNEISS, FINE GRAINED,

RESEMBLES QUARTZ DIORITE DENSE.

767.0 6" QUARTZ DIORITE DENSE.

772.0 6" ANORTH.

776.0-777.0 HORNBLENDE BIOTITE FELDSPAR QUARTZ GNEISS.

787.0-787.5 PEGMATITE, VERY COARSE GRAINED, PINK.

787.5-789.0 QUARTZ-FELDSPAR-BIOTITE GNEISS, VERY FINE GRAINED,

RESEMBLES BIFURCATED QUARTZITE.

797.0 .0 END OF HOLE.

DIP TESTS: FOOTAGE ETCHED DIP CORRECTED DIP

200 67.0 60.0

400 65.0 58.0

600 66.0 59.0

797 64.0 57.0

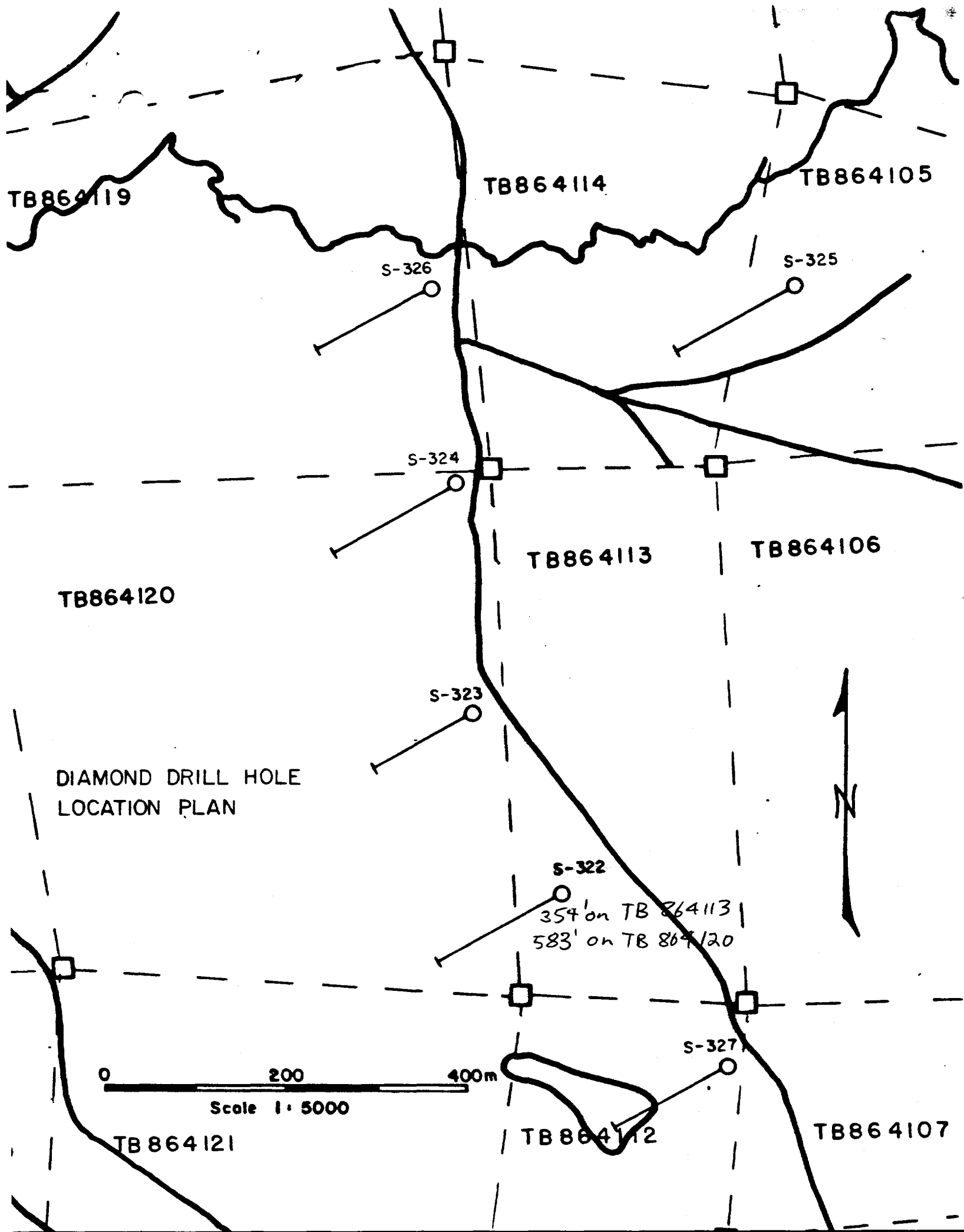

DIAMOND DRILL HOLE LOG

HOLE NO. S - 322 CONTINUED

FOOTAGE FROM TO TOTAL NUM. % CU % ZN % AG % AU % OZ/TN OZ/TN

DESCRIPTION

884.0-886.0 HORNBLENDE SCHIST, FINE GRAINED, DARK GREEN.
 892.0-894.0 QUARTZ-FELDSPAR-BIOTITE GNEISS, RESEMBLES QUARTZ DIORITE FELDSPATHIC.
 895.0-896.0 CHLORITE SCHIST, ZEOLITE, CALCITE ALONG CONTACTS.
 896.0-902.0 QUARTZ-FELDSPAR-HORNBLENDE-BIOTITE GNEISS, GRADES TO QUARTZ FELDSPAR HORNBLENDE GNEISS, FINE GRAINED, DARK GREY.
 902.0-904.0 QUARTZ-FELDSPAR-BIOTITE GNEISS, RESEMBLES QUARTZ-DIORITE FELDSPATHIC.
 904.0-907.0 QUARTZ-FELDSPAR-BIOTITE GNEISS, COARSE GRAINED, LIGHT GREY.
 907.0-911.0 PEGMATITE, COARSE GRAINED, WHITE.
 911.0-912.0 QUARTZ-FELDSPAR-BIOTITE GNEISS, RESEMBLES QUARTZ DIORITE FELDSPATHIC.
 912.0-914.0 QUARTZ-FELDSPAR-BIOTITE GNEISS, COARSE GRAINED, LIGHT GREY.
 917.0-918.0 QUARTZ-FELDSPAR-BIOTITE GNEISS, COARSE GRAINED, LIGHT GREY.

922.0 937.0 QUARTZ-FELDSPAR-BIOTITE GNEISS, MEDIUM TO COARSE GRAINED, LIGHT GREY, LOCALLY WITH HORNBLENDE.
 922.5 MINOR PYRITE, CHALCOPYRITE.
 923.0-924.0 PEGMATITE, COARSE GRAINED, WHITE.
 924.0-926.0 HORNBLENDE SCHIST, DARK GREEN.
 926.0-931.0 QUARTZ-FELDSPAR-BIOTITE GNEISS, VERY FINE GRAINED, GRADES TO MASSIVE QUARTZITE.
 933.0-4" HORNBLENDE SCHIST.
 934.0 FOLIATION 85 DEGREES TO CORE.

937.0 0.0 END OF HOLE.

DIP TESTS:	FOOTAGE	ETCHED DIP	CORRECTED DIP
	200	66.0	59.0
	400	64.0	57.0
	600	64.0	57.0
	800	64.0	57.0
	927	63.0	56.0

DIAMOND DRILL HOLE LOG

HOLE ...J. S - 322 CONTINUED

FOOTAGE TU FROM TO TOTAL NUM. % CU ZN % OZ/TN AG AU OZ/TN

DESCRIPTION

646.0-647.5 PEGMATITE, COARSE GRAINED, WHITE.
 653.0-657.0 GRANITE, FINE GRAINED, VERY SILICEOUS, RESEMBLES A MASSIVE QUARTZITE, MINOR PYRITE, GARNETIFEROUS.
 663.0-663.5 QUARTZ-FELDSPAR-BIOTITE GNEISS REMNANT.
 664.0-664.5 QUARTZ-FELDSPAR-BIOTITE GNEISS REMNANT.
 665.5-669.0 HORNBLENDE FELDSPAR GNEISS.

672.0 750.0 HORNBLENDE SCHIST, FINE GRAINED, BLACK, LOCAL FELDSPAR.

673.0 4" PEGMATITE, FINE TO MEDIUM GRAINED, PINK.

684.0 4" PEGMATITE, AS ABOVE, ALTERED.

686.0 4" PEGMATITE, AS ABOVE.

686.0-687.5 QUARTZ-FELDSPAR-BIOTITE GNEISS, RESEMBLES QUARTZ DIORITE FELDSPATHIC.

690.0-690.5 PEGMATITE, MEDIUM TO COARSE GRAINED, PINK.

690.5-691.5 HORNBLENDE SCHIST, LARGE FELDSPAR PHENOCRYSTS.

691.5-692.0 PEGMATITE, MEDIUM TO COARSE GRAINED, PINK.

699.0 5" PEGMATITE, COARSE GRAINED, WHITE.

700.0 FOLIATION 85 DEGREES TO CORE.

706.0-711.5 QUARTZ-FELDSPAR-BIOTITE GNEISS, RESEMBLES QUARTZ DIORITE FELDSPATHIC, MINOR PYRITE.

713.0-715.0 QUARTZ-FELDSPAR-BIOTITE GNEISS, AS ABOVE.

713.5-714.0 HORNBLENDE SCHIST, MINOR PYRITE.

715.5-718.0 PEGMATITE, FINE TO MEDIUM GRAINED, PINK WITH HORNBLENDE SCHIST REMNANTS.

718.0-719.0 QUARTZ-FELDSPAR-BIOTITE GNEISS WITH FELDSPAR EYES, RESEMBLES QUARTZ DIORITE FELDSPATHIC.

721.0-723.0 QUARTZ-FELDSPAR-BIOTITE GNEISS, AS ABOVE.

724.5-726.0 PEGMATITE, FINE TO MEDIUM GRAINED, PINK, SHEARED, ABUNDANT ZEBLITE.

726.0-735.0 HORNBLENDE FELDSPAR GNEISS.

732.0 4" PEGMATITE.

739.0-739.5 QUARTZ-FELDSPAR-BIOTITE GNEISS, RESEMBLES QUARTZ DIORITE FELDSPATHIC.

740.5-741.0 QUARTZ-FELDSPAR-BIOTITE GNEISS, RESEMBLES QUARTZ DIORITE FELDSPATHIC.

742.5-745.5 QUARTZ-FELDSPAR-BIOTITE GNEISS, GRADES TO COARSE GRAINED BIOTITIC QUARTZITE.

743.5 5" SHEAR, ABUNDANT ZEBLITE, CALCITE.

747.5-748.5 COARSE GRAINED QUARTZ-FELDSPAR-BIOTITE GNEISS.

748.5 4" WITH 5% PYRITE, PYRRHOTITE, MINOR CHALCOPYRITE.

750.0 793.0 QUARTZ FELDSPAR BIOTITE (HORNBLENDE) GNEISS, COARSE GRAINED, INTERBEDDED WITH OTHER UNITS, ABUNDANT FELDSPAR EYES.

750.0-752.0 QUARTZ-FELDSPAR-BIOTITE GNEISS, RESEMBLES QUARTZ DIORITE FELDSPATHIC.

754.5-756.0 PEGMATITE, COARSE GRAINED, WHITE.

756.0-757.5 HORNBLENDE SCHIST.

760.0-761.0 PEGMATITE, COARSE GRAINED, WHITE.

761.0-766.5 HORNBLENDE BIOTITE GNEISS, COARSE GRAINED, LARGE CHLORITE KNOTS.

766.5-767.5 PEGMATITE, COARSE GRAINED, WHITE.

748.0 748.5 .5 81507 .08 .09 .11 .000

DIAMOND DRILL HOLE LOG

HOLE NO. S - 322 CONTINUED

FOOTAGE TO FROM	DESCRIPTION	TOTAL NUM.	ASSAY				
			CU %	ZN %	AG OZ/TN	AU OZ/TN	
	370.5-372.0 HORNBLNDE GNEISS, GARNETIFEROUS, MASSIVE, DARK GREEN, FINE GRAINED, SCATTERED GARNET UP TO 1/8 INCH IN DIAMETER.						
	374.0-376.5 POSSIBLE ALTERED QUARTZ-FELDSPAR-BIOTITE GNEISS, FINE GRAINED, LIGHT TO MEDIUM GREY, MASSIVE, BLEACHED, ABUNDANT CALCITE IN FRACTURES AND STRINGERS, MINOR PYRITES, CHALCOPYRITE.						
	386.0 5" PEGMATITE, WHITE, CONTACTS 80 DEGREES TO CORE.						
	394.0 4" PEGMATITE, WHITE, CONTACTS 80 DEGREES TO CORE.						
	397.0-405.0 HAS A VAGUE FRAGMENTAL TEXTURE.						
	408.0-413.0 HORNBLNDE FELDSPAR GNEISS, WITH ABUNDANT WISPS OF SILLIMANITE LIKE MINERAL.						
	409.0 1" CALCITE ZEOLITE SHEAR.						
	419.0-420.0 HORNBLNDE FELDSPAR GNEISS, AS ABOVE, 1% SULPHIDES.						
	429.0-431.0 QUARTZ-FELDSPAR-BIOTITE GNEISS, RESEMBLES QUARTZ DIORITE FELDSPATHIC.						
431.0	489.0 HORNBLNDE FELDSPAR GNEISS, DARK GRANITE TO BLACK, LOCALLY CHEOKITIC, POSSIBLE SILLIMANITE.						
	432.0 2" PEGMATITE COARSE GRAINED, WHITE.						
	436.0, 437.0 438.5 SMALL ZEOLITE FILLED SHEARS, AT 40 DEGREES TO CORE.						
	434.5-435.5 PEGMATITE, FINE TO MEDIUM GRAINED, SHEARED WITH ZEOLITE INFILLING.						
	448.0-452.0 QUARTZ-FELDSPAR-BIOTITE GNEISS, WEAKLY RESEMBLES QUARTZ DIORITE FELDSPATHIC.						
	462.0-464.5 HORNBLNDE GNEISS, ABUNDANT SILLIMANITE LIKE MINERAL.						
	464.5 6" BIOTITIC QUARTZITE.						
	466.0-469.5 QFBH, ABUNDANT FELDSPAR PHENOCRYSTS, SHEARED CONTACTS.						
	470.0-471.0 QUARTZ-FELDSPAR-BIOTITE GNEISS, RESEMBLES QUARTZ-BIOTITE-FELDSPATHIC.						
	475.0-476.0 QUARTZ STRINGERS.						
	481.0-483.5 MASSIVE QUARTZITE, PINK, GRADES TO QUARTZ-FELDSPAR-BIOTITE GNEISS.						
	486.0 FOLIATION 85 DEGREES TO CORE.						
489.0	672.0 GRANITE, COARSE GRAINED, PINK, ABUNDANT FELDSPAR EYES, WEAKLY FOLIATED, LOCALLY PEGMATITIC, ABUNDANT HEMATITE, LOCAL MAGNETITE.						
	489.0-497.0 FAULT, SHEARED CONTACT, GREY TO BROWN, ABUNDANT CALCITE FILLED SHEARS.						
	497.0-504.0 GRANITE, BADLY SHEARED, ABUNDANT CALCITE.						
	507.0-508.5 HORNBLNDE FELDSPAR GNEISS REMNANT.						
	521.0-532.0 HORNBLNDE FELDSPAR GNEISS REMNANT, IRREGULAR CONTACTS.						
	525.0 2" HORNBLNDE GNEISS, 15% PYRITE.	524.5	525.5	1.0	81506	.05 .05 .11 .000	
	530.0 3" ZEOLITE CALCITE SHEAR.						
	532.0 1/2" EPIDOTE.						
	560.0-561.0 QUARTZ-FELDSPAR-BIOTITE GNEISS.						
	572.0-577.0 GRANITE, SHEARED, VUGGY, ABUNDANT HEMATITE, CALCITE, CLAY.						
	598.0 1/2" BIOTITE CHLORITE SHEAR AT 30 DEGREES TO CORE.						
	605.0-606.0 GRANITE, FINE GRAINED, GREY TO RED.						
	608.0 1/2" HEMATITE SHEAR.						
	609.0-610.0 QUARTZ-FELDSPAR-BIOTITE GNEISS REMNANT.						
	628.5-630.0 QUARTZ-FELDSPAR-BIOTITE GNEISS.						

DIAMOND DRILL HOLE LOG

S - 322 CONTINUED

FOOTAGE FROM	TO	DESCRIPTION	FOOTAGE				ASSAY			
			FROM	TO	TOTAL	NUM.	CU	ZN	AG	AU
		OCCASIONAL LIGHT TO MEDIUM GREY SILICEOUS BANDS AND LENSES, MINOR SERICITIC ALTERATION, VAGUE FRAGMENTAL TEXTURE.	253.5	258.5	5.0	81485	.05	.03	.03	.000
		260.0-271.5 HORNBLende FELDSPAR GNEISS, DARK GREEN, FINE GRAINED, MASSIVE, WEAKLY FOLIATED, HOMOGENEOUS, POSSIBLE INTRUSIVE, OCCASIONAL BLEBS OF PYRITE.	258.5	260.0	1.5	81486	.03	.03	.03	.000
		260.0-264.0	260.0	264.0	4.0	81487	.03	.07	.06	.000
		271.5-281.5 HORNBLende FELDSPAR GNEISS, DARK GREEN, FINE GRAINED, LOCALLY REDDISH POTASSIUM FELDSPAR ENRICHED, OCCASIONALLY HAS VAGUE FRAGMENTAL TEXTURE, OCCASIONAL BLEBS OF PYRITE.	264.0	268.0	4.0	81488	.03	.05	.02	.000
		268.0-271.5	268.0	271.5	3.5	81489	.03	.04	.04	.000
		273.0-274.0 PEGMATITE, COARSE GRAINED, WHITE, CONTACTS 80 DEGREES TO CORE.	271.5	276.5	5.0	81490	.03	.06	.07	.000
		278.0-279.0 PORPHYRITIC QUARTZ-FELDSPAR-BIOTITE GNEISS, RESEMBLES QUARTZ DIORITE FELDSPATHIC.	276.5	281.5	5.0	81491	.02	.04	.07	.000
		280.0-281.0 AS ABOVE, INTERBEDDED HORNBLende FELDSPAR GNEISS.								
		281.5-285.0 SILICEOUS IRON FORMATION, VERY SILICEOUS, MODERATELY MAGNETIC, VERY WELL BANDED, 10-20% PYRRHOTITE, PYRITE, LOCALLY MASSIVE.	281.5	282.0	.5	81492	.09	.02	.04	.000
			282.0	282.5	.5	81493	.05	.02	.10	.000
		282.0-3 rd BAND OF MASSIVE PYRRHOTITE, PYRITE.	282.5	285.0	2.5	81494	.09	.00	.09	.000
		282.0-282.5 QUARTZ VEIN, LARGE BLEBS OF PYRITE AND PYRRHOTITE, MASSIVE VEINLETS OF PYRITE AT MARGINS.	285.0	290.0	5.0	81495	.05	.05	.01	.000
		285.0-290.0	290.0	295.0	5.0	81496	.08	.00	.01	.000
		285.0-323.0 ESSENTIALLY A HORNBLende FELDSPAR GNEISS, DARK GREEN, FINE TO MEDIUM GRAINED, WEAKLY TO MODERATELY MAGNETIC, ZONES WITH UP TO 20% SULPHIDES, LOCALLY WITH VAGUE FRAGMENTAL TEXTURE, 3-5% DISSEMINATED PYRRHOTITE, PYRITE, OCCASIONALLY AS SMALL STRINGERS.	295.0	300.0	5.0	81497	.07	.02	.02	.000
		290.0-297.0 CONTAINS NUMEROUS WHITE, WISPY XTALS WHICH RESEMBLES SILLIMANITE, PYRRHOTITE AND CHALCOPYRITE STRINGERS AT 290.5 AND 291.5.	300.0	305.0	5.0	81498	.03	.01	.03	.000
			305.0	310.0	5.0	81499	.06	.04	.04	.000
		297.0-298.0 MAFIC DIKE, FINE GRAINED, DARK GREEN, MASSIVE, SHARP CONTACTS.	310.0	315.0	5.0	81500	.11	.05	.05	.000
			315.0	320.0	5.0	81501	.07	.04	.07	.000
		298.0-298.0	320.0	323.0	3.0	81502	.12	.04	.05	.000
		298.0-300.0 PYRITE-PYRRHOTITE VEINS AND STRINGERS, MINOR CHALCOPYRITE.	323.0	328.0	5.0	81503	.06	.04	.01	.000
		302.0-305.0 QUARTZ-FELDSPAR-BIOTITE GNEISS, LIGHT GREY, FINE GRAINED, FOLIATION 60 DEGREES TO CORE.	328.0	330.5	2.5	81504	.05	.05	.07	.000
		305.0-306.0 INTERBEDDED QUARTZ-FELDSPAR-BIOTITE GNEISS, HORNBLende FELDSPAR GNEISS, FRAGMENTAL TEXTURE.	330.5	333.5	3.0	81505	.05	.03	.05	.000
		309.0-312.0 UP TO 20% PYRRHOTITE, PYRITE, OCCASIONAL CHALCOPYRITE STRINGERS, PYRRHOTITE LOCALLY NEAR MASSIVE.								
		313.5-315.0 UP TO 10% PYRRHOTITE, PYRITE WITH MINOR CHALCOPYRITE.								
		321.0-323.0 5-10% PYRRHOTITE, PYRITE WITH OCCASIONAL SMALL CHALCOPYRITE STRINGERS.								

323.0 431.0 HORNBLende FELDSPAR GNEISS, DARK GREEN, FINE TO MEDIUM GRAINED, LOCALLY HAS A FRAGMENTAL TEXTURE, MINOR PYRITE STRINGERS, POSSIBLE MINOR SILLIMANITE.
 328.0-330.5 QUARTZ VEIN, WITH OCCASIONAL BLEBS OF PYRRHOTITE, PYRITE, CHALCOPYRITE, MASSIVE VEINS OF PYRRHOTITE AT MARGINS WITH OCCASIONAL BLEBS OF CHALCOPYRITE.
 336.0-337.0 ANORTHC STRINGERS, MOTTLY WHITE GREEN, COARSE GRAINED, OCCASIONAL BLEBS OF MAGNETITE, POSSIBLE SILLIMANITE.
 363.5-365.0 DIKE, RESEMBLES QUARTZ-FELDSPAR-BIOTITE GNEISS, SLIGHTLY PORPHYRITIC, CONTACTS WITH HORNBLende FELDSPAR GNEISS ARE DISCORDANT.

DIAMOND DRILL HOLE LOG

HOLE NO. S - 322 CONTINUED

FOOTAGE FROM	TO	DESCRIPTION	FOOTAGE			ASSAY					
			FROM	TO	TOTAL	NUM.	%	CU	ZN	AG	AU
61.5-67.0	75.5-81.0	HORNBLLENDE BIOTITE GNEISS, FINE GRAINED, DARK GREY GREEN, FLUORITE, CALCITE, ZEOLITE IN FRACTURES. HORNBLLENDE BIOTITE GNEISS, AS ABOVE. ANORTHOSITE, SHEARED, ALTERED, CHLORITIC, CALCITE EPIDOTE VEINING.									
81.0	137.0	QUARTZ-FELDSPAR-BIOTITE GNEISS, LIGHT TO MEDIUM GREY, GENERALLY COARSE GRAINED, RESEMBLES QUARTZ DIORITE FELDSPATHIC OR QUARTZ DIORITE PLATY, LOCALLY FINE GRAINED. 89.0-98.0 CHLORITE SCHIST, SHEARED, MODERATELY TO HIGHLY MAGNETIC, MOTTLED APPEARANCE, RESEMBLES A SHEARED GABBRO, ALSO SERPENTINIZED. 98.0-112.0 HORNBLLENDE BIOTITE GNEISS, DARK GREEN, FINE GRAINED, MASSIVE. 107.0 HEMATITE FILLED SHEAR. 109.0-111.0 FRACTURED ZONE, CALCITE ZEOLITE VEINING. 112.0-4" CHLORITIC SHEAR.									
137.0	180.0	INTERBEDDED HORNBLLENDE CHLORITE SCHIST AND FINE GRAINED QUARTZ-FELDSPAR-BIOTITE GNEISS, RESEMBLES A FRAGMENTAL, FOLIATION 80 DEGREES TO CORE, LOCALLY GARNETIFEROUS. 139.5-144.0 HORNBLLENDE CHLORITE SCHIST WITH OCCASIONAL INTERBEDDED QUARTZ-FELDSPAR-BIOTITE GNEISS, 3-5% PYRITE, PYRRHOTITE, CHALCOPYRITE. 171.0 GARNET ALONG FINE GRAINED, DARK GREEN HORNBLLENDE RICH STRINGERS.	139.5	144.0	4.5	81476	.06	.05	.08	.000	
180.0	197.0	PORPHYRITIC QUARTZ-FELDSPAR-BIOTITE GNEISS, AS BEFORE, RESEMBLES GECO QUARTZ DIORITE FELDSPATHIC.	144.0	146.0	2.0	81477	.03	.11	.11	.000	
197.0	216.5	QUARTZ-FELDSPAR-BIOTITE GNEISS, VERY FINE GRAINED, LIGHT GREY, LOCALLY VERY WELL BANDED, NUMEROUS INTERBEDDED HORNBLLENDE FELDSPAR GNEISS BANDS, LOCALLY HAS A VAGUE FRAGMENTAL TEXTURE, MINOR DISSEMINATED PYRITE, MINOR ZEOLITE AND CALCITE FILLED FRACTURES. 204.0-206.5 PORPHYRITIC QUARTZ-FELDSPAR-BIOTITE GNEISS, AS ABOVE, OCCASIONAL ZEOLITE FRACTURES, CONTACTS CONCORDANT 65 DEGREES TO CORE. 210.0 4" PORPHYRITIC QUARTZ-FELDSPAR-BIOTITE GNEISS, AS ABOVE. 210.5 DISCORDANT CONTACT BETWEEN HORNBLLENDE FELDSPAR GNEISS AND FINE GRAINED QUARTZ-FELDSPAR-BIOTITE GNEISS.									
216.5	323.0	IRON FORMATION, SILICEOUS, LIGHT TO MEDIUM GREY, WELL BANDED, HIGHLY MAGNETIC, 25-50% MAGNETITE, LOCALLY 10-15% SULPHIDES, MAINLY PYRITE AND PYRRHOTITE WITH MINOR CHALCOPYRITE. 218.0-241.5 DIABASE, MEDIUM GREY, FINE TO COARSE GRAINED, MASSIVE, LOCALLY FRACTURED. 233.0-236.0 CONTAINS UP TO 10% LARGE PYRRHOTITE BLEBS, MINOR CHALCOPYRITE ALONG FRACTURES. 241.5-258.5 SILICEOUS IRON FORMATION, HIGHLY MAGNETIC, OCCASIONAL PYRITE LAMINAE, BANDING AT 60 DEGREES TO CORE. 258.5-260.0 HORNBLLENDE FELDSPAR GNEISS, DARK GREEN, FINE GRAINED,	216.5	218.0	1.5	81478	.04	.05	.08	.000	
			230.0	233.0	3.0	81479	.04	.02	.04	.000	
			233.0	236.0	3.0	81480	.14	.06	.02	.010	
			236.0	239.0	3.0	81481	.08	.13	.06	.000	
			241.5	245.5	4.0	81482	.04	.08	.01	.000	
			245.5	249.5	4.0	81483	.04	.08	.02	.000	
			249.5	253.5	4.0	81484	.04	.04	.01	.000	

HOLE NO. S - 322

DIAMOND DRILL HOLE LOG

CLAIM NO: TB 86413

CORE SIZE: 89

AREA: MCGRW LAKE AREA (G-602)

COMMENCED: 24/03/87

CLAIM GROUP: 66-1

COMPLETED: 30/03/87

LOCATION:

LOGGED BY: BAKKER/GAGNON.

DIP: 60 DEG.

John Magnum

AZIMUTH: 240

LENGTH: 937 FT.

FOOTAGE - FROM TO

DESCRIPTION

FOOTAGE - FROM TO TOTAL

ASSAY - CU % ZN % AG OZ/TN AU OZ/TN

0 1.0 OVERBURDEN, CASING DRIVEN TO 12.

1.0 25.0 ANORTHOITE, MOTTLED TEXTURE, WHITISH GREEN, COARSE GRAINED, MASSIVE, LOCALLY BLEACHED BUFF COLOURED, TRACE TO MINOR PYRITE, PYRRHOTITE, CHALCOPYRITE, LOCALLY UP TO 2-3% OVER NARROW WIDTHS. 1.5-3.5 BIOTITE SCHIST, VERY FINE GRAINED, MASSIVE, DARK GREY TO BLEACHED, OCCASIONAL ANORTHOITIC STRINGERS.

4.0 4.0 SHEARED WITH MASSIVE HORNBLende XTALS.

5.0-6.0 ANORTH, AS ABOVE, 3-5% PYRITE, CHALCOPYRITE.

6.0-7.0 BIOTITE SCHIST, ANORTHOITIC STRINGERS.

14.5-16.0 ANORTHOITE, AS ABOVE, WITH 5-8% PYRITE, CHALCOPYRITE, MAGNETITE.

4.0	5.0	1.0	81471	.02	.02	.06	.000
5.0	6.0	1.0	81472	.02	.03	.04	.000
14.5	16.0	1.5	81473	.09	.01	.14	.000
16.0	18.0	2.0	81474	.04	.03	.07	.000
18.0	19.0	1.0	81475	.01	.05	.08	.000

20.5-21.0 CHLORITE BIOTITE SCHIST.

25.0 53.0 HORNBLende BIOTITE GNEISS, FINE GRAINED, MASSIVE, DARK GREENISH TO BLACKISH, 1-2% DISSEMINATED PYRITE.

25.0-33.5 CHLORITIC, SERPENTINIZED, LOCALLY VERY SLIGHTLY SERICITIC, ZEOLITE CALCITE STRINGERS.

33.5-35.0 MOTTLED ANORTHOITE, SLIGHTLY DARKER THAN BEFORE.

35.0 1.5" CHLORITIC KNOT WITH LIGHT BROWN ALTERATION HALO.

37.0 VAGUE FRAGMENTAL TEXTURE.

37.5-40.0 HORNBLende BIOTITE GNEISS, ALTERED, ABUNDANT ZEOLITE, EPIDOTE, 3-5% PYRITE.

41.0-42.0 HORNBLende BIOTITE GNEISS, AS ABOVE.

46.0-49.0 QUARTZ-FELDSPAR-BIOTITE GNEISS, MASSIVE, LIGHT GREY, MEDIUM GRAINED, FELDSPAR PORPHYRITIC, STRONGLY RESEMBLES GECO QUARTZ DIOKITE FELDSPATHIC, MINOR TO LOCALLY 2% FINE DISSEMINATED PYRITE WITH TRACE CHALCOPYRITE.

49.0-51.0 ANORTHOITE, COARSE GRAINED, DARK GREEN, FELDSPAR PHENOCRYSTS UP TO 1/2".

51.0-52.0 HORNBLende CHLORITE SCHIST, POSSIBLY A DIKE, CONTACTS 45 DEGREES TO CORE TRUNCATES FOLIATION IN COUNTRY ROCK WHICH IS 80 DEGREES TO CORE.

53.0 81.0 ANORTHOITE, DARK GREENISH, COARSE GRAINED, CHLORITIC WITH ABUNDANT LARGE FELDSPAR PHENOCRYSTS.

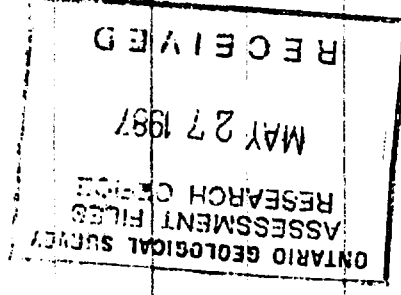

WINDY BAY
MAY 27 1987

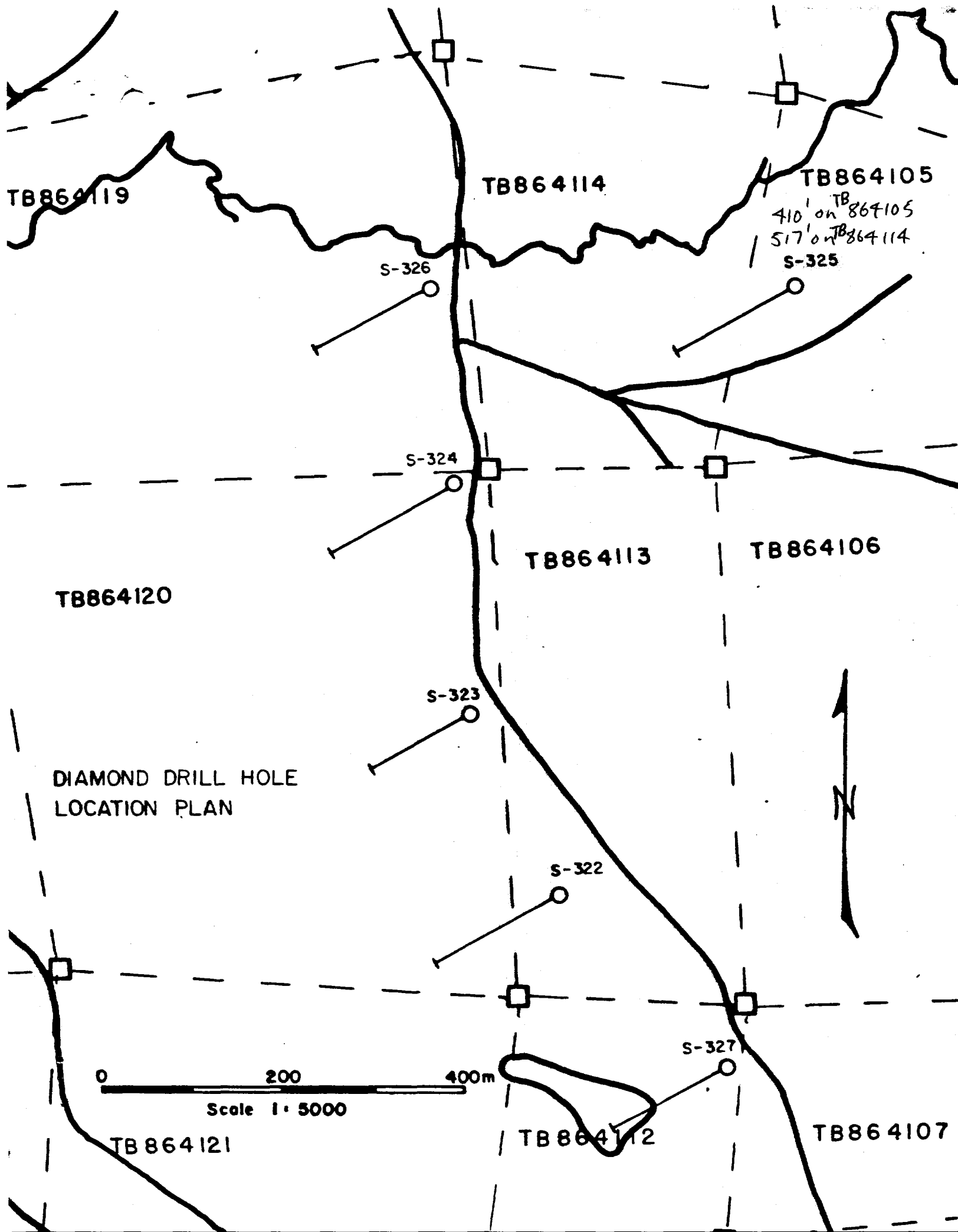



Ministry of Northern Affairs and Mines

Report of Work

#195

Instructions: Supply required data on a separate form for each type of work to be recorded (see table below).
- For Geo-technical work use form no. 1367 "Report"

Name and Postal Address of Recorded Holder
Noranda Inc. (Geco Division)
P.O. Box 100, Manitowadge, Ontario.



42F04SE0003 11 MCGRAW LAKE

900

Summary of Work Performance and Distribution of Credits

Total Work Days Cr. claimed 3628	Mining Claim		Work Days Cr.	Mining Claim		Work Days Cr.	Mining Claim		Work Days Cr.
	Prefix	Number		Prefix	Number		Prefix	Number	
for Performance of the following work. (Check one only)	See Attached List								
<input type="checkbox"/> Manual Work									
<input type="checkbox"/> Shaft Sinking Drifting or other Lateral Work.									
<input type="checkbox"/> Compressed Air, other Power driven or mechanical equip.									
<input type="checkbox"/> Power Stripping									
<input checked="" type="checkbox"/> Diamond or other Core drilling									
<input type="checkbox"/> Land Survey									

All the work was performed on Mining Claim(s): **TB 864113, [REDACTED], 864105, 864114**

Required Information eg: type of equipment, Names, Addresses, etc. (See Table Below)

D.D.H. S-322: Length **937** ft., AZ 240, Dip -60, Core Size BQ, drilled between March 24/87 and March 30/87 (Incl.)

D.D.H. S-323: Length **797** ft., AZ 240, Dip -60, Core Size BQ, drilled between Apr. 1/87 and Apr. 4/87 (Incl.)

D.D.H. S-324: Length 967 ft., AZ 240, Dip -60, Core Size BQ, drilled between Apr. 5/87 and Apr, 11/87 (Incl.)

D.D.H. S-325: Length 927 ft., AZ 240, Dip -60, Core Size BQ, drilled between Apr. 12/87 and Apr. 16/87 (Incl.)

Total: 3628 CREDITS
3220 CREDITS USED
408 CREDIT BALANCE

Above holes were drilled by N. Morissette Diamond Drilling Ltd., Haileybury, Ont.

See attached THUNDER BAY MINING DIVISION RECEIVED MAY 12 1987

For **F. Bakker**
 Date of Report: **May 11, 1987**
 Recorded Holder of Claim (Signature): **John Lagron**

Certification Verifying Report of Work
 I hereby certify that I have a personal and intimate knowledge of the facts set forth in the Report of Work annexed hereto, having performed the work or witnessed same during and after its completion and the annexed report is true.

Name and Postal Address of Person Certifying
F. Bakker, Noranda Minerals Inc.-Geco Division, Box 100, Manitowadge, Ontario, B0T 2C0

Date Certified: **May 11, 1987**
 Certified by (Signature): **John Lagron**

Table of Information/Attachments Required by the Mining Recorder

Type of Work	Other information (Common to 2 or more types)	Attachments
Manual Work	Names and addresses of men who performed manual work/operated equipment, together with dates and hours of employment.	Work Sketch: these are required to show the location and extent of work in relation to the nearest claim post.
Shaft Sinking, Drifting or other Lateral Work		
Compressed air, other power driven or mechanical equip.	Names and addresses of owner or operator together with dates when drilling/stripping done.	Work Sketch (as above) in duplicate
Power Stripping		
Diamond or other core		

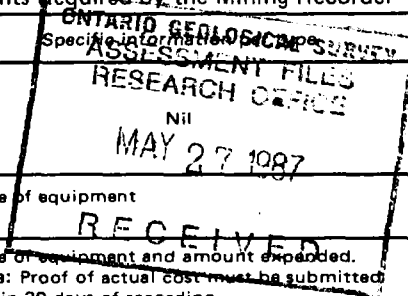

CLAIMS LIST

<u>Claim No.</u>	<u>Days</u>	<u>Claim No.</u>	<u>Days</u>
TB 864101	60	TB 974651	20
864102	60	974652	20
864103	60	974653	20
864104	60	974654	20
864105	60	974655	20
864106	60	974656	20
864107	60	974657	20
864108	60	974658	20
864109	60	974659	20
864110	60	974660	20
864111	60	974661	20
864112	60	974662	20
864113	60	974663	20
864114	60	974664	20
864115	60	974665	20
864116	60	974666	20
864117	60	974667	20
864118	60	974668	20
864119	60	974669	20
864120	60	974080	20
864121	60	974081	20
864122	60	974082	20
864123	60	974083	20
864124	60	974084	20
864125	60	974085	20
864126	60	974086	20
864127	60	974087	20
864128	60	974088	20
864129	60	974089	20
864130	60	974090	20
908480	60	974091	20
908481	60	974092	20
908482	60	974093	20
908483	60	974094	20
908484	60	974095	20
908485	60		
908486	60		
908487	60		
908488	60		
908489	60		
908490	60		
908491	60		

More Assignments:

TB 864113 - 1091 days - Bal. 279
 TB 864119 - NIL
 TB 864105 - 350 days - Bal. 3650
 TB 864120 - 1490 days - Bal. 2510
 TB 864114 - 457 days - Bal. 3543

42

35
 77 items

THUNDER BAY
 MINING DIVISION
RECEIVED
 MAY 12 1987
 AM 7|8|9|10|11|12|1|2|3|4|5|6 PM

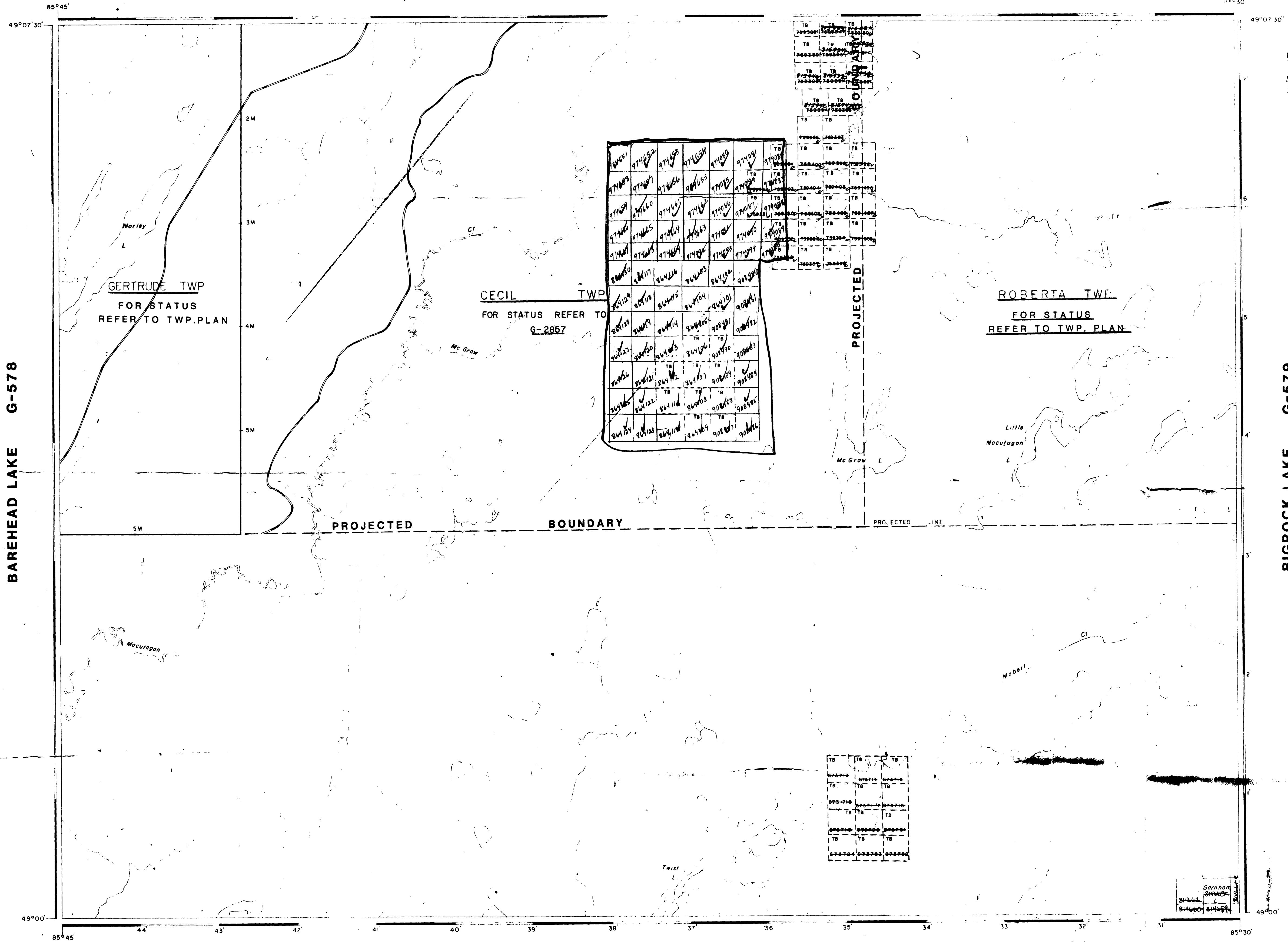

M. Owen

LEGEND

- HIGHWAY AND ROUTE NO.
- OTHER ROADS
- TRAILS
- SURVEYED LINE
- TOWNSHIP, BAY LINES ETC.
- LOTS MINING CLAIMS PARCELS ETC.
- UNSURVEYED LINE
- LOT LINES
- PARCEL BOUNDARY
- MINING CLAIMS ETC.
- RAILWAY AND RIGHT OF WAY
- UTILITY LINES
- NON PERENNIAL STREAM
- FLOODING OR FLOODING RIGHTS
- SUBDIVISION OR COMPOSITE PLAN
- RESERVATIONS
- ORIGINAL SHORELINE
- MARSH OR MUSKELG
- MINES
- TRAVERSE MONUMENT

DISCONTINUED SURVEY LINES

- | TYPE OF DOCUMENT | SYMBOL |
|---------------------------------|--------|
| PATENT, SURFACE & MINING RIGHTS | ● |
| SURFACE RIGHTS ONLY | ○ |
| MINING RIGHTS ONLY | ◐ |
| LEASE, SURFACE & MINING RIGHTS | ◑ |
| SURFACE RIGHTS ONLY | ◒ |
| MINING RIGHTS ONLY | ◓ |
| LICENCE OF OCCUPATION | ◔ |
| ORDER IN COUNCIL | OC |
| RESERVATION | ⊙ |
| CANCELLED | ⊘ |
| SAND & GRAVEL | ⊙ |
- NOTE: MINING RIGHTS IN PARCELS PATENTED PRIOR TO MAY 6 1913 VESTED IN ORIGINAL PATENTEE BY THE PUBLIC LANDS ACT, R.S.O. 1910 CHAP. 380 SEC. 63, SUBSEC. 1

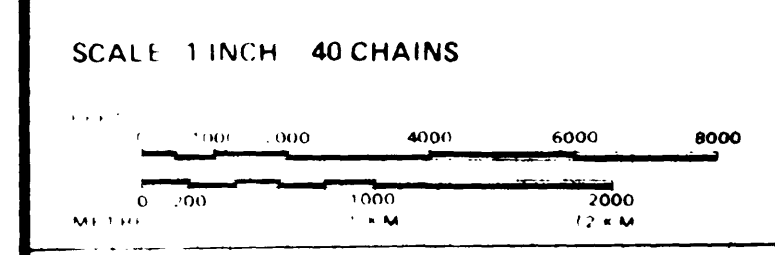

AREA
MC GRAW LAKE
 M.N.R. ADMINISTRATIVE DISTRICT
TERRACE BAY
 MINING DIVISION
THUNDER BAY
 LAND TITLES / REGISTRY DIVISION
THUNDER BAY

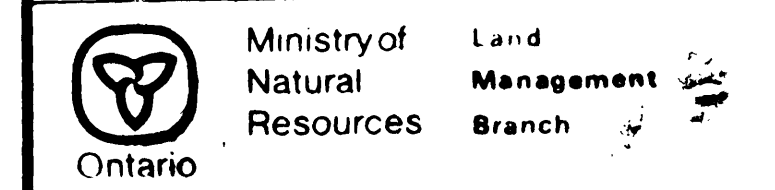

Date: August 3/84
 Number: **G-602**

