

KEN CULHANE

RE: OPAP #

OP90-351



42F05SE0003 63.5911 OLIE LAKE

010

Summary Report for OPAP Grant

I hope this Summary will help to clarify any questions regarding my Prospecting Projects in 1990.

I had applied for the Grant to help cover expenses on several projects.

The 1st project was to pursue & claim an area that was found & set in the fall of 1989. I will refer to this as the Sunrise Project which is in the Pontiac Township & borders Ossian Township.

I returned in the Spring of 1990 to sample & set more claims. I had time to cut line & set a grid every 150' for an EM survey. I also sampled the area to the west & north of the main claim, finding Quartz Veins & Granite showings. In the fall of 1990 I returned with the intent of bordering the main claim because of the results from previous sampling. When I returned, the area to the west & north had been recently staked as shown on the new map of Pontiac Township. I did set 3 new claims to the north of the 1st claims & I did find more favourable samples to the south of Sunrise Lake. Because of the encouraging samples & the intense staking in this area I feel there is lots of potential for sale. However before I try to promote or sell these claims, I feel more claims to the south of the first claim, which is south & east of Sunrise Lake & an EM survey on these claims will show a potential for this area.

The biggest drawback with these claims is the distance I have to travel to complete the work

required before any sales are reasonable. I do feel the showings in this area are promising.

The 2nd. Project that had good showings is referred to as the HUSAK claims. These 4 claims are in the Everest Lake & Allie Lake townships & line with the Husak road running right thru the centre of them. The original showings & outcrops had a lot of iron formation & sulphites. After a few encouraging samples I had 3 large areas stripped of overburden for sampling & viewing the bedrock. From here I had 2 long trenches blasted in the iron formation & had a Geologist from Noranda on site looking at any possibilities of copper or zinc in this area. He would not commit himself to mapping the area, but he did find 2 more outcrops & he did recommend that I rent a high pressure pump to wash the blasted & stripped areas for a better mapping of these showings. He also recommended that I have Claude Larouche, a contractor from Thunder Bay do a complete Geophysics survey in this area. These claims are in line with other new claims & showings in this area. This area had been staked in the early 1950's for gold, however my hopes are aimed at base metals.

A 3rd. Project was to restake some old claims off the White River, west of Hickeral Bay. These claims were open in the Spring of 1989 & Lac Minerals showed interest in this area. When I went down the river in the Spring of 1990 Lac Minerals had staked the upper portion of the entire area. I then attempted to stake south of these claims by coming up White River but the rapids in the river and the unpredictability of travelling on Lake Superior was just too risky to complete any work south of Hickeral Bay.

The 4th. Project was to prospect throughout a new cut over area north of Abs Lake in Martin Township. This was also a carry over from 1989 which did not turn out very successful. Perhaps if I had more time to spend there it might be different.

In reference to selling claims, I was in a joint partnership with 3 other prospectors who pooled 16 claims in the Shabotic Township & optioned them to Noranco from North Bay. This option was over a 3 year period @ \$10,000.00 per year, and they were to complete \$500,000. worth of work in order to retain these claims. After the 1st year they drilled 5 holes 200' deep & did a very intense mapping of the claims. They then chose to return the claims to us. The contract also had Noranco turn over any adjoining claims which left the 4 of us with 52 claims in good standing. These are now for sale.

* SAMPLES

OTTER LAKE CREEK

CLEAN OVER BURDEN

CLEAN OVER BURDEN

*2F
*2G

MAGNETIC IRON SHOWING

40x5x2 TRENCH *2E

CLAIM # 1165071

IRON FORMATION
CLINIC ST

CLAIM # 1166784

40x5x3 TRENCH *2D

CLEAN OVER BURDEN

*2A *2B

*2I
*2J

*2K

*2L

POND

BEVER P

CLAIM # 1166785

CLAIM # 1166786

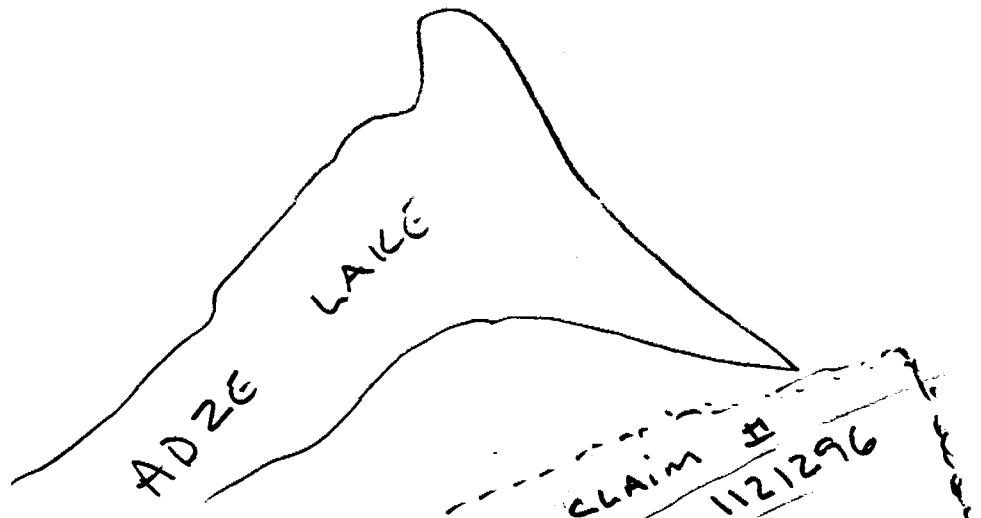

HUSAIC ROAD

SAMPLES # 3A TO 3G is from TRENCH # 1 AFTER BLASTING

SAMPLES # 3H TO 3N is from TRENCH # 2 AFTER BLASTING

NORAN MINES LIMITED
(MINE DIVISION)

Husak

G-45

ASSAY SHEET

Date Nov 23/90 19__

Sample No.	Lab. No.	Description	% Cu	% Zn	Oz/Ton Ag	Oz/Ton Au	% Pb	% FeS ₂	% Fe ₂ S ₃
2A		Cullhane	0.06	0.06	0.01	ND			
2B		CULLHANE	0.00	0.01	0.00	0.02			
2C			0.01	0.03	0.00	ND			
2D			0.01	0.01	0.00	ND			
2E			0.00	0.02	0.00	ND			
2F			0.01	0.02	0.00	ND			
2G			0.00	0.07	0.00	ND			
2H			0.00	0.03	0.00	ND			
2I			0.02	0.08	0.00	ND			
2K			0.01	0.04	0.00	ND			
2L			0.00	0.04	0.00	ND			
2J			0.01	0.03	0.00	ND			
3A			0.03	0.00	0.00	ND			
3B			0.01	0.01	0.00	ND			
3C			0.01	0.01	0.02	ND			
3D			0.02	0.01	0.05	ND			
3E			0.01	0.00	0.03	ND			
3F			0.01	0.01	0.05	ND			
3G			0.01	0.02	0.04	ND			
3H			0.00	0.01	0.03	ND			
3I			0.01	0.01	0.04	ND			
3J			0.01	0.01	0.04	ND			
3K			0.76	0.01	0.23	ND			
3L			0.03	0.01	0.04	ND			
3M			0.10	0.01	0.05	ND			
3N			0.03	0.01	0.04	ND			

5075
16

5075
12

TRIM #1

TRIM #2

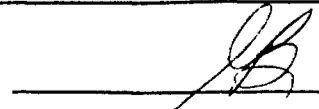

Chief Chemist

NORANDA MINES LIMITED
(GECO DIVISION)

G-45

ASSAY SHEET

Date May 26/90 1990

Sample No.	Lab. No.	Description	% Cu	% Zn	Oz/Ton Ag	Oz/Ton Au	% Pb	% FeS ₂	% Fe ₁₂ S ₁₃
A		Kenny	0.01	0.07	0.02	0.005			
B			0.03	0.08	0.04	0.01			
C			0.00	0.01	0.00	0.005			
D			0.05	0.02	4.85	24.16			
E			0.01	0.03	0.03	ND			
F			0.01	0.00	0.11	0.12			
G			0.01	0.02	0.00	0.01			
H			0.00	0.01	0.05	0.01			
I			0.00	0.02	0.60	2.86			
J			0.01	0.02	0.06	ND			
K			0.00	0.00	0.02	0.01			
L			0.01	0.00	0.01	0.005			

*← Assay Reported
BAD READING.*

NORANDA MINES LIMITED
(GECO DIVISION)

SUNRISE
Aug 26 - SEPT 9

G-45

ASSAY SHEET

Date September 20, 1990 19__

Sample No.	Lab. No.	Description	% Cu	% Zn	Oz/Ton Ag	Oz/Ton Au	% Pb	% FeS ₂	Pg
1		VEN CURRY	0.01	0.02	ND	0.01			
2			0.00	0.01	0.00	ND			
3			0.00	0.01	0.00	ND			
4			0.01	0.03	0.01	ND			
5			0.03	0.07	0.02	0.12			
6			0.00	0.01	0.04	0.005			
7			0.01	0.00	0.19	0.01			
8			0.00	0.00	0.01	0.01			
9			0.00	0.02	0.00	0.01			
10			0.01	0.00	0.01	0.005			
11			0.00	0.00	0.02	ND			
12			0.05	0.02	0.00	ND			
13			0.00	0.00	0.01	ND			
14			0.02	0.01	0.01	ND			
15			0.03	0.04	0.06	0.01			
16			0.01	0.04	0.50	1.85			
17			0.00	0.01	0.02	ND			
18			0.00	0.07	0.04	0.01			
19			0.00	0.02	0.10	ND			
20			0.02	0.08	0.02	ND			

CLAIM
1165024

65061
1165025

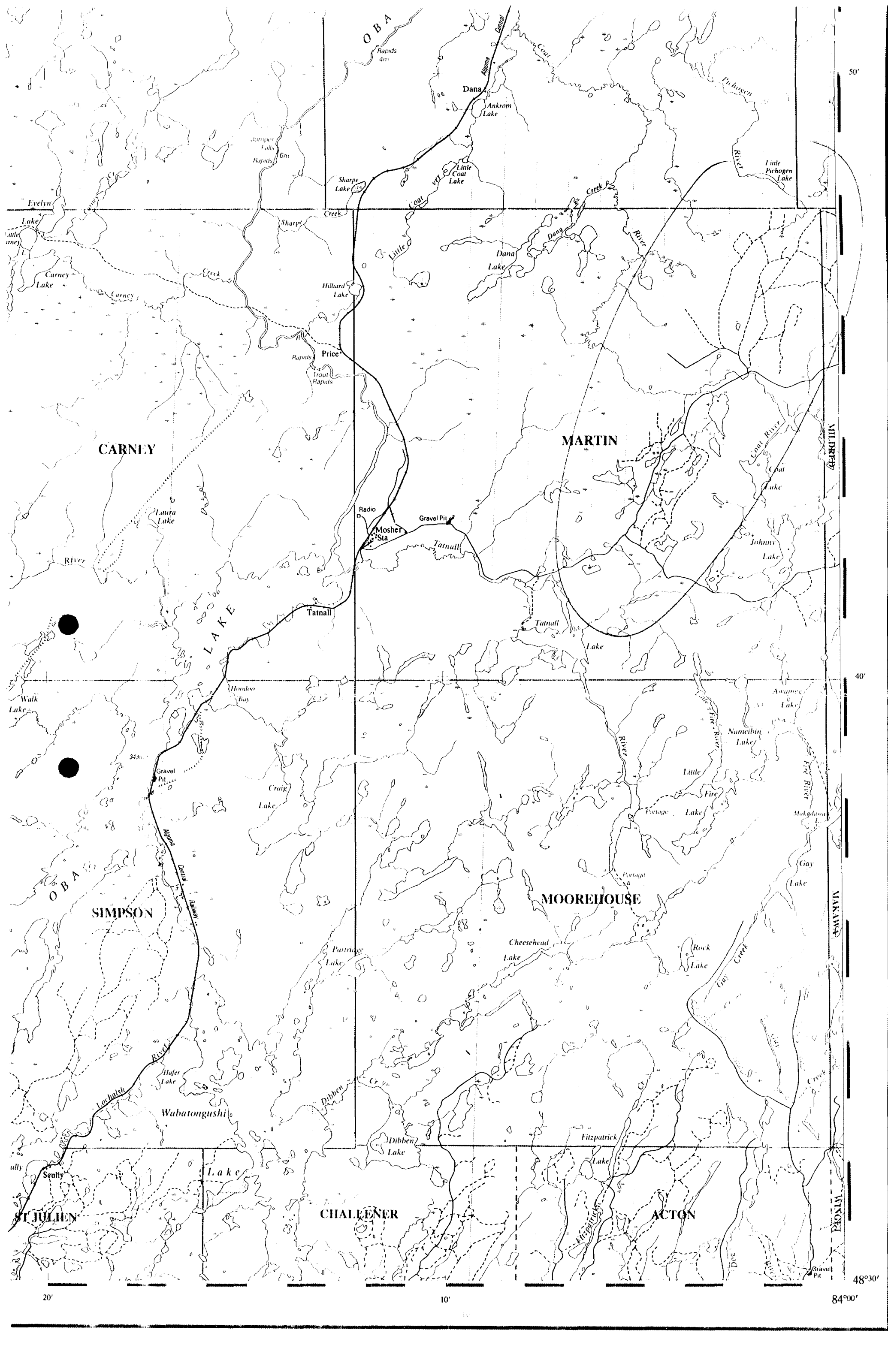

50°

40°

48°30'

20'

10'

84°00'

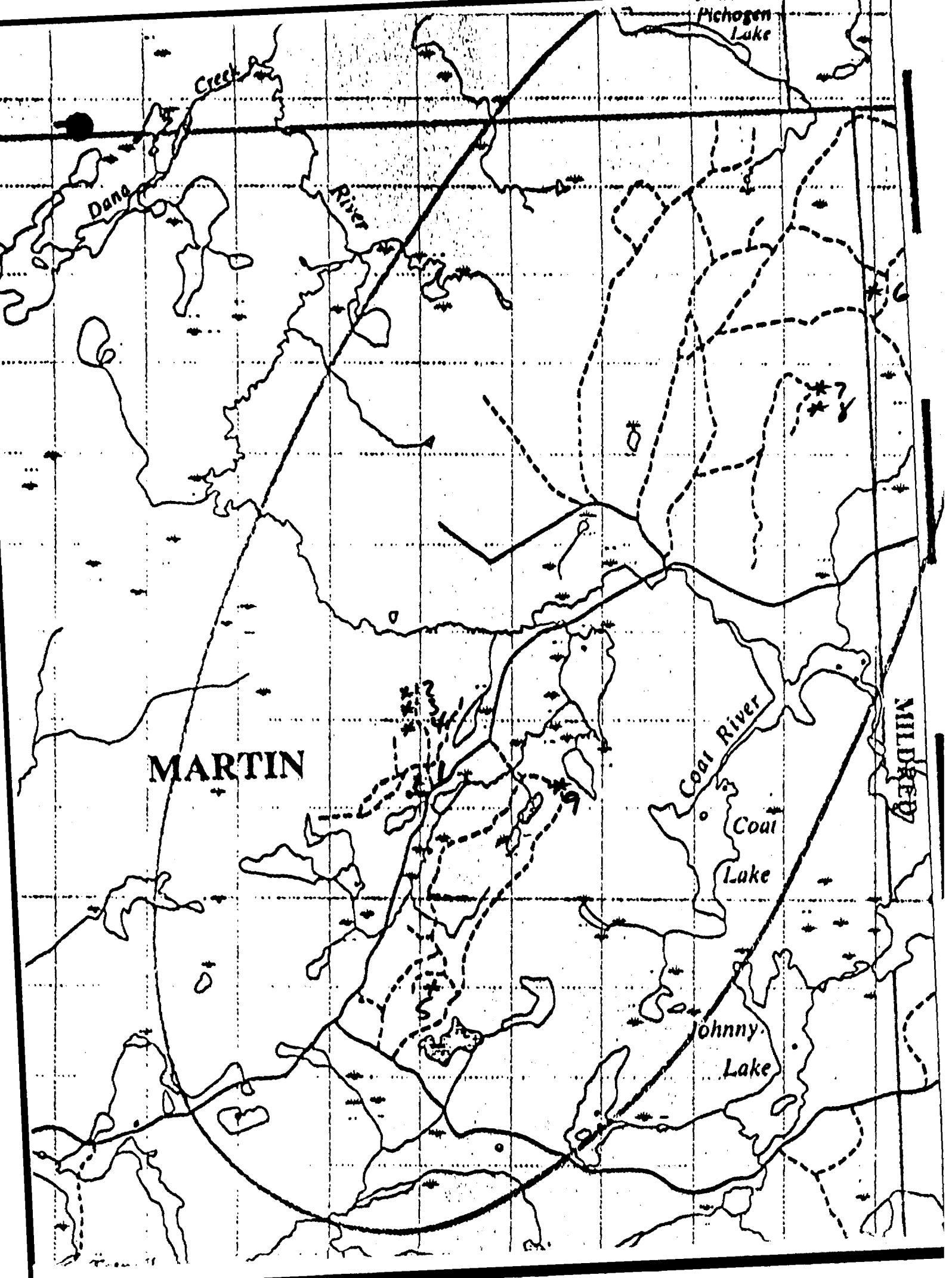

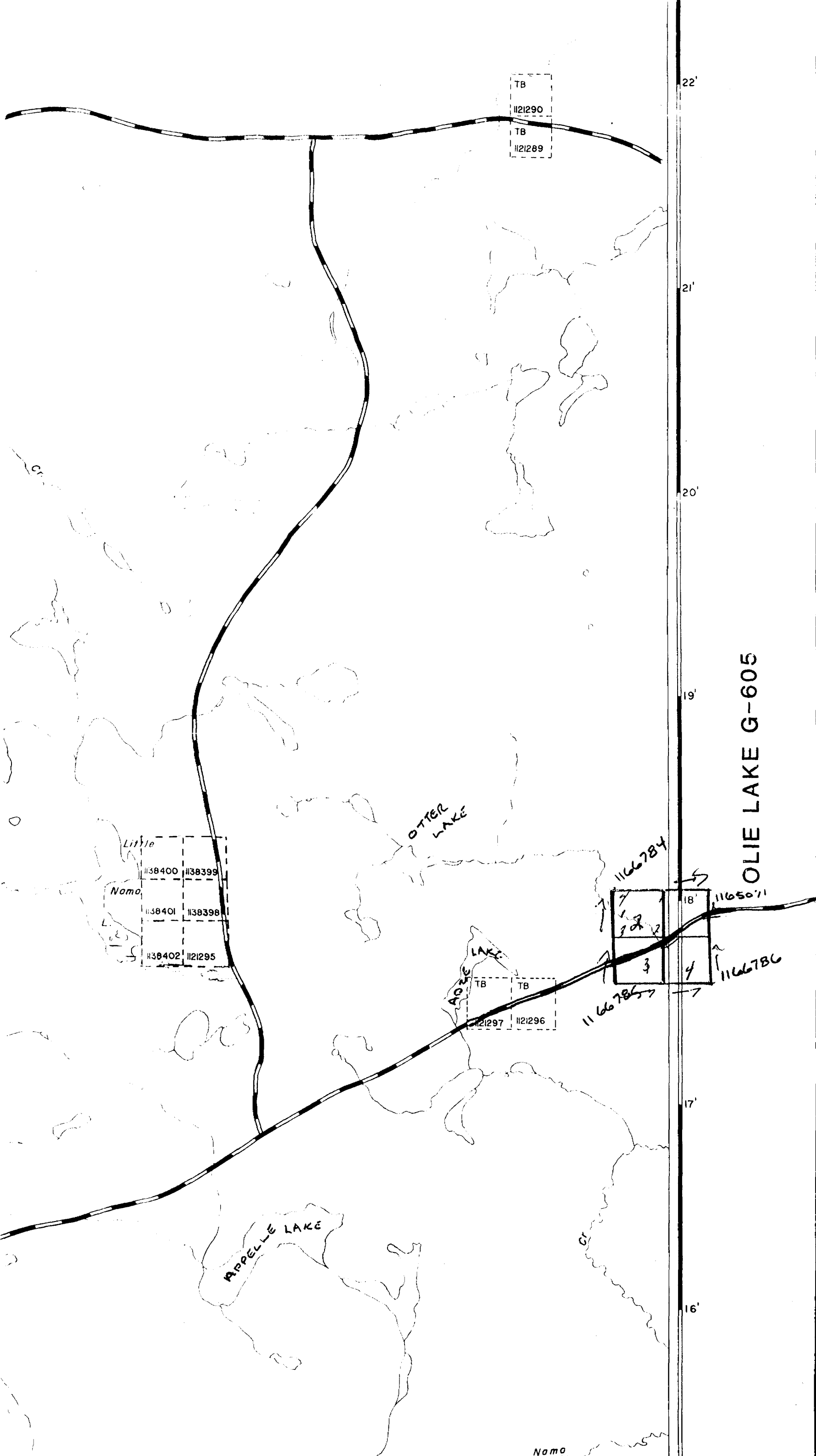

THE INFORMATION
 APPEARS TO
 HAVE BEEN
 OBTAINED FROM
 VARIOUS SOURCES
 AND ACCURACY
 IS NOT GUARANTEED
 WITHOUT LIABILITY
 TO THE USER
 FOR ANY DAMAGE
 RESULTING FROM
 THE USE OF THIS
 INFORMATION ON THE
 LANDS SHOWN

HIGHWAY AND ROUTE
 OTHER ROADS
 TRAILS
 SURVEYED LINES:
 TOWNSHIPS, BASE
 LOTS, MINING CLAIMS
 UNSURVEYED LINES:
 LOT LINES
 PARCEL BOUNDARIES
 MINING CLAIMS
 RAILWAY AND HIGHWAY
 UTILITY LINES
 NON PERENNIAL STREAMS
 FLOODING OR FLOODPLAIN
 SUBDIVISION OR CONVEYANCE
 RESERVATIONS
 ORIGINAL SHORELINE
 MARSH OR MUSKEG
 MINES
 TRAVERSE MONUMENTS

DISPOSITION

TYPE OF DOCUMENT

- PATENT, SURFACE & MINING RIGHTS
- " SURFACE RIGHTS
- " MINING RIGHTS
- LEASE, SURFACE & MINING RIGHTS
- " SURFACE RIGHTS
- " MINING RIGHTS
- LICENCE OF OCCUPATION
- ORDER-IN-COUNCIL
- RESERVATION
- CANCELLED
- SAND & GRAVEL

NOTE: MINING RIGHTS
 1913, VESTED IN
 LANDS ACT, R.S.

SCALE: 1 INCH = 4000 FEET

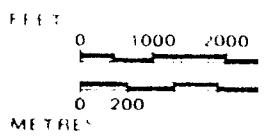

AREA

EVE

M.N.R. ADMINISTRATION
 TERRITORY
 MINING DIVISION
 THUNDER BAY
 LAND TITLES / RIGHTS
 THUNDER BAY

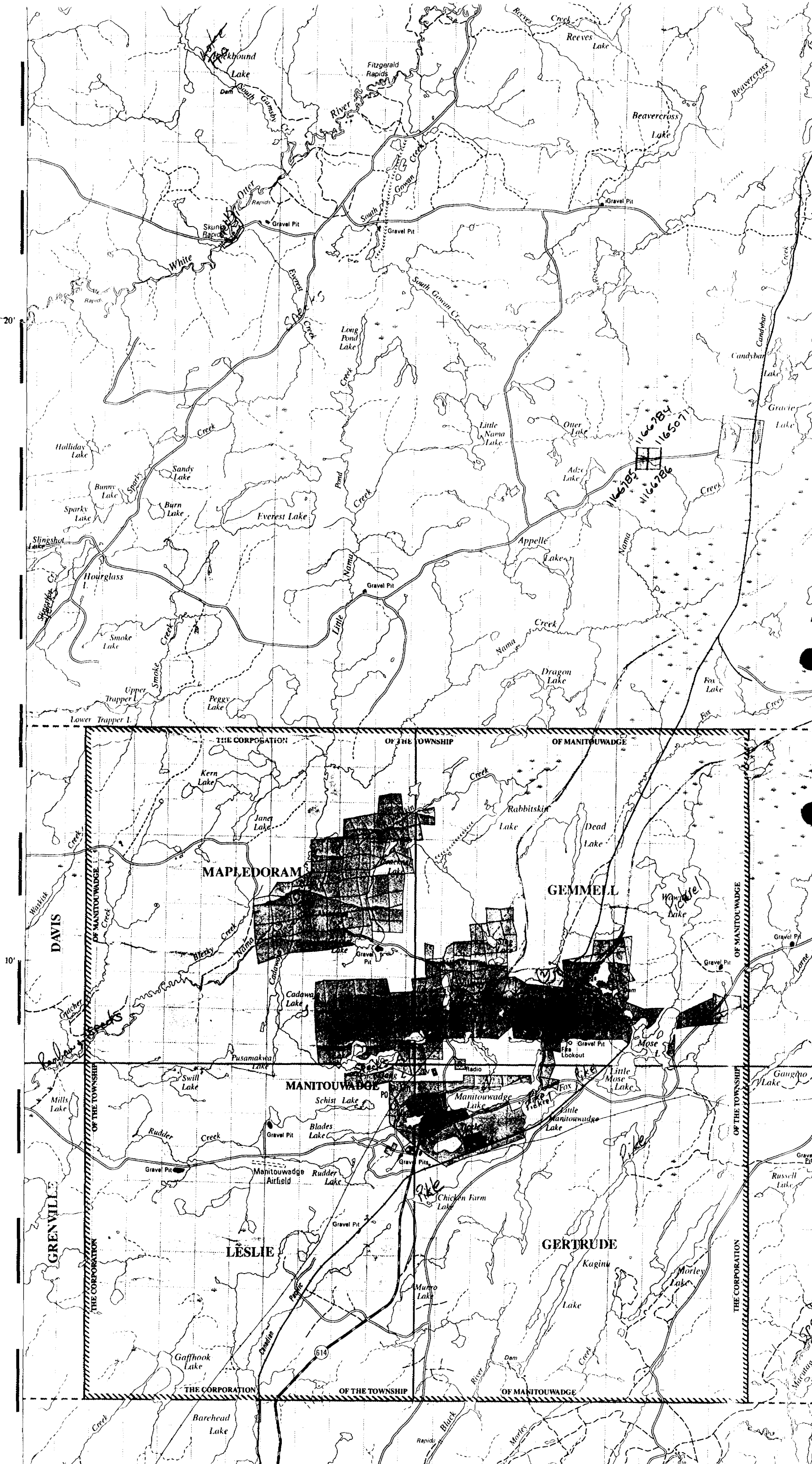

1166785
1166784
1166786
1165071

MAPLEDORAM

GEMMELL

MANITOWADGE

LESLIE

GERTRUDE

20°

10°

614

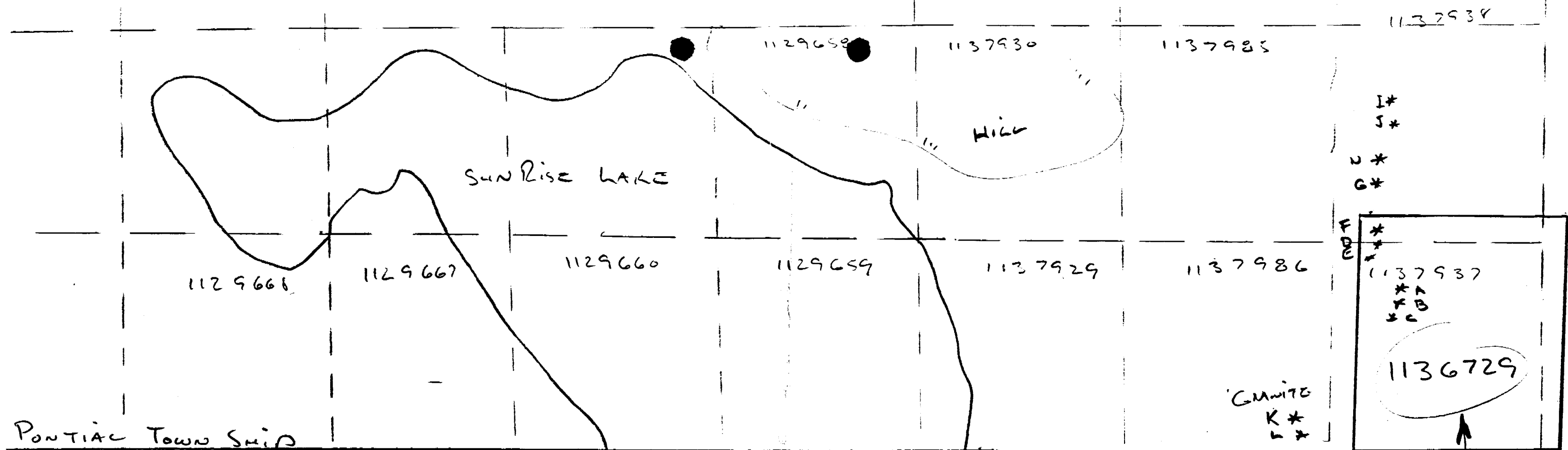

PONTIAC TOWN SHIP
 OSSIAN TOWN SHIP

* SAMPLES

* 16
 * 17

* 12
 * 13
 1152924 * 14
 * 15

* 18
 * 19
 * 20

THIS AREA SHOWS QUARTZ SULPHIDES
 & MAGNETIC IRON FORMATION

I*
 J*
 U*
 G*

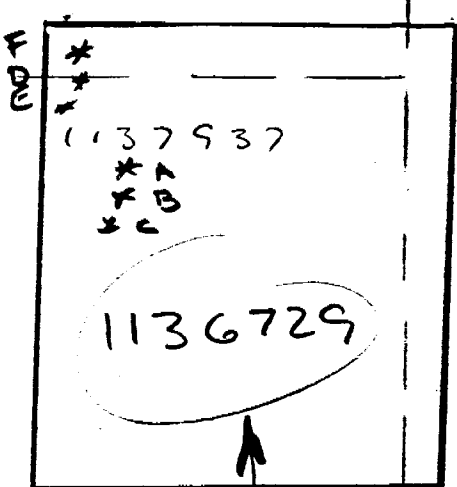

CUMITE
 K*
 L*

THIS CLAIM
 IS THE ONE
 THAT I STAKE
 LAST YEAR.

THIS CLAIM WAS
 STAKED & REGISTERED
 BY D-CULNANE
 THIS FALL
 THIS AREA LOC
 AS GOOD AS AN

PONTIAC Township

Sunrise

QUARTZ on 2nd claim
North of CLAIM.

QUARTZ VIEWS GREEN ROCK with
WHITE veins

FL
O
E

Hill Iron Formation

Red (pink) with white dots.
PEGMATIC

TRAIL from Main Road.

THICK Bush & Swamps

Swamp

CLAIM # 1136789

Large Hill
lots of outcrops.

K
D
L

GRANITE

← TRAIL TO SUNRISE

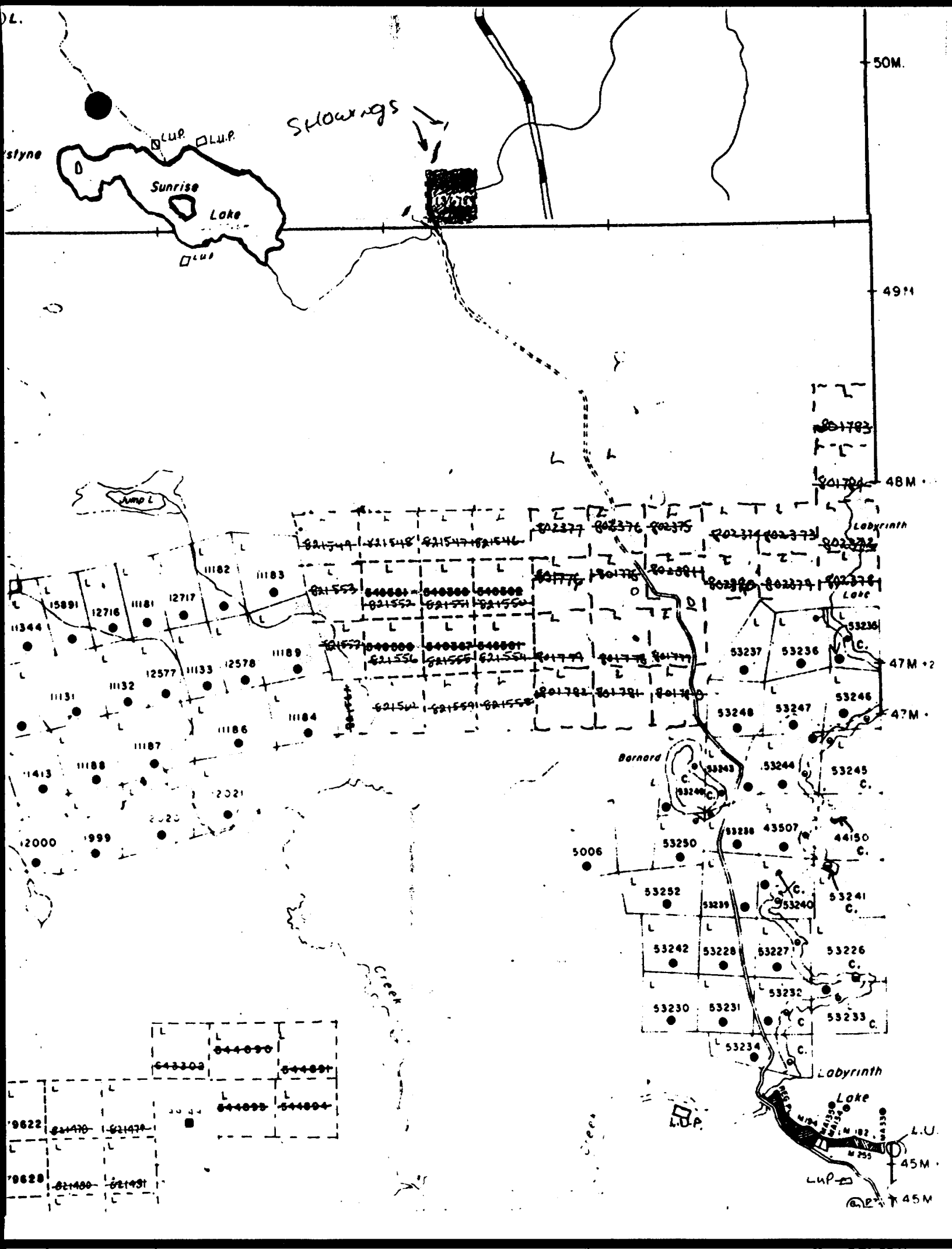

50M.

49M

48M

47M

47M

45M

45M

SHOWINGS

Sunrise Lake

Labyrinth Lake

Bernard

Labyrinth Lake

Lake

styno

L.P. L.U.P.

L.P.

801783

801704

802377 802376 802375

802374 802373 802372

802371 802370 802369

802368 802367 802366

802365 802364 802363

802362 802361 802360

802359 802358 802357

802356 802355 802354

802353 802352 802351

802350 802349 802348

802347 802346 802345

802344 802343 802342

802341 802340 802339

802338 802337 802336

802335 802334 802333

802332 802331 802330

802329 802328 802327

802326 802325 802324

802323 802322 802321

802320 802319 802318

802317 802316 802315

802314 802313 802312

802311 802310 802309

802308 802307 802306

802305 802304 802303

802302 802301 802300

802299 802298 802297

802296 802295 802294

802293 802292 802291

1182 1183 1181 12717 1189 12578 1184 1186 1187 1188 1189 1190 1191 1192 1193 1194 1195 1196 1197 1198 1199 1200 1201 1202 1203 1204 1205 1206 1207 1208 1209 1210 1211 1212 1213 1214 1215 1216 1217 1218 1219 1220 1221 1222 1223 1224 1225 1226 1227 1228 1229 1230 1231 1232 1233 1234 1235 1236 1237 1238 1239 1240 1241 1242 1243 1244 1245 1246 1247 1248 1249 1250 1251 1252 1253 1254 1255 1256 1257 1258 1259 1260 1261 1262 1263 1264 1265 1266 1267 1268 1269 1270 1271 1272 1273 1274 1275 1276 1277 1278 1279 1280 1281 1282 1283 1284 1285 1286 1287 1288 1289 1290 1291 1292 1293 1294 1295 1296 1297 1298 1299 1300

644090 644091 644092 644093 644094 644095 644096 644097 644098 644099 644100 644101 644102 644103 644104 644105 644106 644107 644108 644109 644110 644111 644112 644113 644114 644115 644116 644117 644118 644119 644120 644121 644122 644123 644124 644125 644126 644127 644128 644129 644130 644131 644132 644133 644134 644135 644136 644137 644138 644139 644140 644141 644142 644143 644144 644145 644146 644147 644148 644149 644150 644151 644152 644153 644154 644155 644156 644157 644158 644159 644160 644161 644162 644163 644164 644165 644166 644167 644168 644169 644170 644171 644172 644173 644174 644175 644176 644177 644178 644179 644180 644181 644182 644183 644184 644185 644186 644187 644188 644189 644190 644191 644192 644193 644194 644195 644196 644197 644198 644199 644200 644201 644202 644203 644204 644205 644206 644207 644208 644209 644210 644211 644212 644213 644214 644215 644216 644217 644218 644219 644220 644221 644222 644223 644224 644225 644226 644227 644228 644229 644230 644231 644232 644233 644234 644235 644236 644237 644238 644239 644240 644241 644242 644243 644244 644245 644246 644247 644248 644249 644250 644251 644252 644253 644254 644255 644256 644257 644258 644259 644260 644261 644262 644263 644264 644265 644266 644267 644268 644269 644270 644271 644272 644273 644274 644275 644276 644277 644278 644279 644280 644281 644282 644283 644284 644285 644286 644287 644288 644289 644290 644291 644292 644293 644294 644295 644296 644297 644298 644299 644300

L.P.

L.U.P.

L.P.

L.U.P.

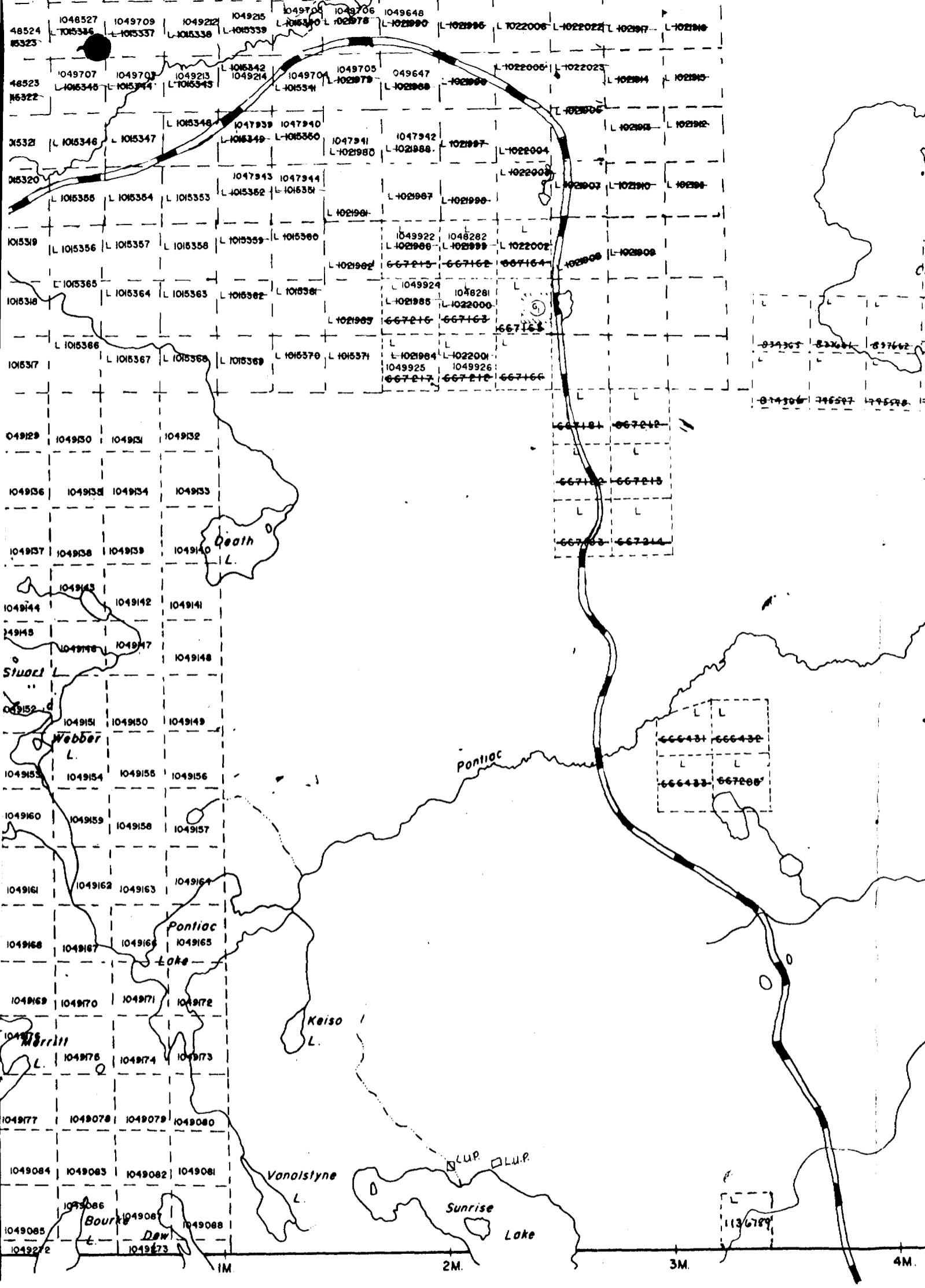

OSSIAN TWP. M-378

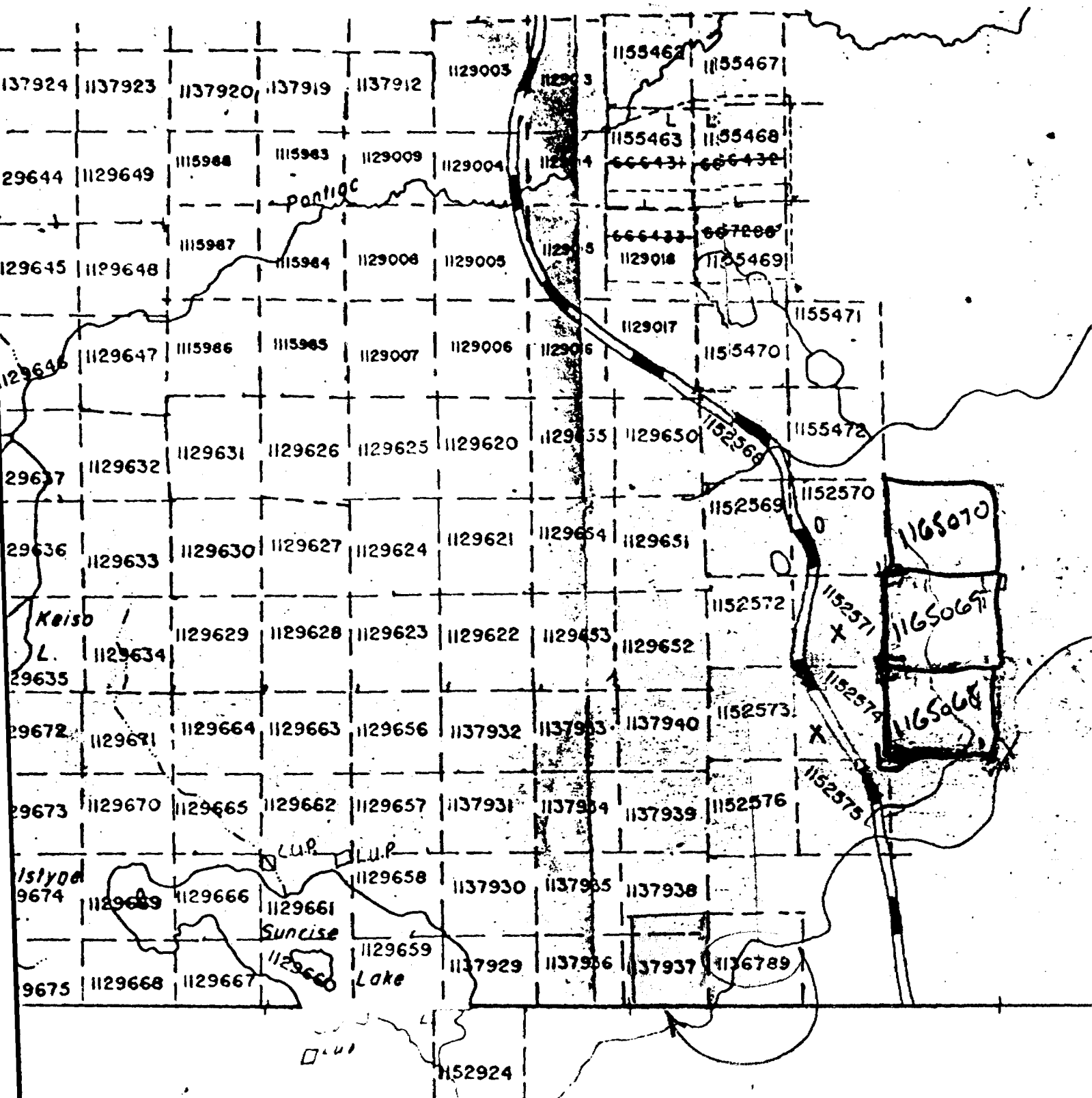

Stump # (X)

