



42F15NW0003 20 SHUEL

010

Diamond Drilling

Township of SHUEL

Report N<sup>o</sup>: 20

Work performed by: Fatima Mining Co. Limited

Claim N <sup>o</sup>	Hole N <sup>o</sup>	Footage	Date	Note
SSM 53009	17	307'	Dec/57	

Notes:

# DIAMOND DRILL RECORD

6-1-209

PROPERTY Patma Mining Co. Ltd. - Savoff Group

S.S.N. 53009, Shuel Twp.

HOLE NO. 17

SHEET NUMBER 1

SECTION FROM \_\_\_\_\_ TO \_\_\_\_\_

STARTED Dec. 16, 1957

LATITUDE 1100' north) of 0 - 0 on

DATUM \_\_\_\_\_

COMPLETED Dec. 18, 1957

DEPARTURE 18000' east) Base Line #2

BEARING N - 161° W (Ast.)

ULTIMATE DEPTH 307'

ELEVATION \_\_\_\_\_

DIP - 45°

PROPOSED DEPTH \_\_\_\_\_

DEPTH FEET	FORMATION	SAMPLE NO.	WIDTH OF SAMPLE	GOLD \$	SLUDGE GOLD \$
0 - 18	Coaling. The vertical depth of overburden is 12.75 feet.				
18 - 93	Amphibole A thin and thick bedded fine grained dark grey rock with varying degrees of chloritization which imparts a green colour to the rock in places. 18 - 70½: There are fine scillica layers between the clay beds and sections of the upper portion of the rock have been weathered red. 42 - 44½: The rock is granitized. 56 - 59½: The rock is arkosic and scattered sulphides coat bedding planes. 73½: Bedding at 65° to core axis. 70½ - 89½: The rock displays a banded appearance due to alternating thin biotite rich beds which are brown and chlorite rich beds which are green. 75½: Bedding at 90° to core axis. 89 - 93½: There is a distinct increase in degree of chloritization, the rock is a deeper green hue, and is mottled with elongated zarnets to 1/3" developed				

N.M.P. TORONTO-STOCK FORM NO. 501 REV. 12/51

DRILLED BY Joy Mfg. Co. Ltd., Galt, nt.

SIGNED R. A. Galt

# DIAMOND DRILL RECORD

PROPERTY \_\_\_\_\_

HOLE NO. 17

SHEET NUMBER 2

SECTION FROM \_\_\_\_\_ TO \_\_\_\_\_

STARTED \_\_\_\_\_

LATITUDE \_\_\_\_\_

DATUM \_\_\_\_\_

COMPLETED \_\_\_\_\_

DEPARTURE \_\_\_\_\_

BEARING \_\_\_\_\_

ULTIMATE DEPTH \_\_\_\_\_

ELEVATION \_\_\_\_\_

DIP \_\_\_\_\_

PROPOSED DEPTH \_\_\_\_\_

DEPTH FEET	FORMATION	SAMPLE NO.	WIDTH OF SAMPLE	GOLD \$	SLUDGE GOLD \$
18 - 93	(continued) along bedding planes. Slip faces are coated with pyrite. The rock tends to be thick bedded.				
93 - 111	Greysacke A light-grey, fine grained thick bedded rock with a slight greenish hue on the fresh surface due to minor chloritization.				
111 - 194	Arzillite Thick bedded and strongly chloritized with local garnetiferous sections as in 89 - 93; e.g. 116 $\frac{1}{2}$ -118; 142 - 147; 154 - 158; 167 - 177 $\frac{1}{2}$ ; 180 - 194; 149; Bedding at 71° to core axis. 177; " at 62° to " "				
194 - 202	Greysacke ditto 93 - 111				
2 - 223	Arzillite There are granitic slips which are usually coated				

N.M.P., TORONTO-STOCK FORM NO. 501 REV. 12/51

DRILLED BY \_\_\_\_\_

SIGNED R.A. Collier







Location and vertical  
projection of Fatima  
Mng. Co. hole 17 in.

Sheet Twp. Out

to link to 304 feet

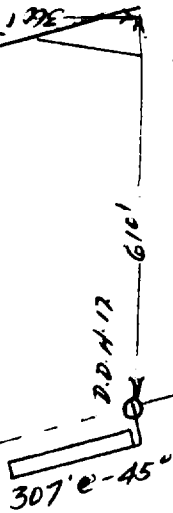
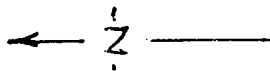

SS M. 53009

