

42G03NW0007 11 RYKERT

DIAMOND DRILLING

TOWNSHIP: RYKERT

REPORT NO: #11

WORK PERFORMED FOR: Golden Trio Minerals Ltd.

RECORDED HOLDER: Same as Above (xx)
: Other ()

<u>Claim No.</u>	<u>Hole No.</u>	<u>Footage</u>	<u>Date</u>	<u>Note</u>
921089	GT0-18	65.2m	Jan/88	(1)
921072	GT0-19	216.1m	Jan/88	(1)
921061				
921083	GT0-22	115.5m	Jan/88	(1)
934630	GT0-26	158.2m	Feb/88	(1)
921072	GT0-27	91.0m	Feb/88	(1)

NOTES: (1) W8906-448 date filed Oct/89

Caithness Twp.

921090

921089

921088

921067

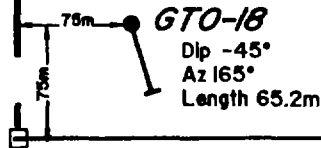

REVISIONS	DURHAM GEOLOGICAL SERVICES INC.		
	<i>For:</i> GOLDEN TRIO MINERALS LTD		
	<i>Title:</i> OBA PROJECT Diamond Drill Hole Location Map GTO-18		
	<i>Date:</i> JUNE 1988	<i>Drawn:</i> CG	<i>Scale:</i> 1:5000
	<i>NTS:</i>	<i>Approved:</i>	<i>Fig.:</i>

DURHAM GEOLOGICAL SERVICES INC.

Box 734
Timmins Ontario
P4N 7G2

DIAMOND DRILL HOLE LOG

PROJECT: Golden Trio Minerals
AREA: Oba Project (Rykert)
CLAIM NUMBER: 921089
CORE SIZE: BQ
DRILLED BY: Falcon Drilling Ltd.
LOGGED BY: S. Rusnak
CORE STORED AT: Camp 95
OBJECTIVE: Test Airborne and Ground
Geophysical Anomalies

HOLE NUMBER: GTO-18
LOCATION: L45+50N/3+10S
AZIMUTH: 180°
DIP: -45°
DATE: January, 1988
CASING: 15.2m
LENGTH: 65.2 m
ACID TEST:

Henry Patterson for S. Rusnak

METERAGE		ROCK TYPE AND DESCRIPTION	Core Angle to Axis	% Sulphides	SAMPLE			ANALYTICAL RESULT									
From	To				Number	From	To	Length (m)	Au ppb	As ppm	Pb ppm	Zn ppm	Cu ppm	Ag ppm			
		24.0-24.2 - 30% quartz, pyrite		1%													
		24.4-24.8 - broken, blocky core															
		25.7-26.3 - broken, blocky core															
		32.7 - 4cm impure quartz 60%															
		33.4 - 2cm impure quartz 70%	30°														
		34.7 - 15cm silicified vein	45°														
35.1	36.8	FELSIC INTRUSIVE - IMPURE QUARTZ			6823	35.2	36.7	1.5	4				74	15		0.3	
		- grey-white colour															
		- medium grained															
		- sugary texture															
		- Pyrite		1%													
		- very siliceous															
36.8	46.1	GRAPHITE			6824	36.9	38.0	1.1	1				315	68		0.6	
		- grey to black colour			6825	38.0	39.5	1.5	4				150	69		0.7	
		- fine grained			6826	39.5	41.0	1.5	2				195	65		0.7	
		- foliated			6827	41.0	42.5	1.5	2				340	148		0.6	
		- py - disseminated and as 1-2mm stringers			6828	42.5	44.0	1.5	5				103	57		0.5	
		- graphite banded with greywacke			6829	44.0	45.5	1.5	2				260	92		0.6	
		43.6-44.0 - 5% quartz			6830	45.5	46.1	0.6	2				180	50		0.8	

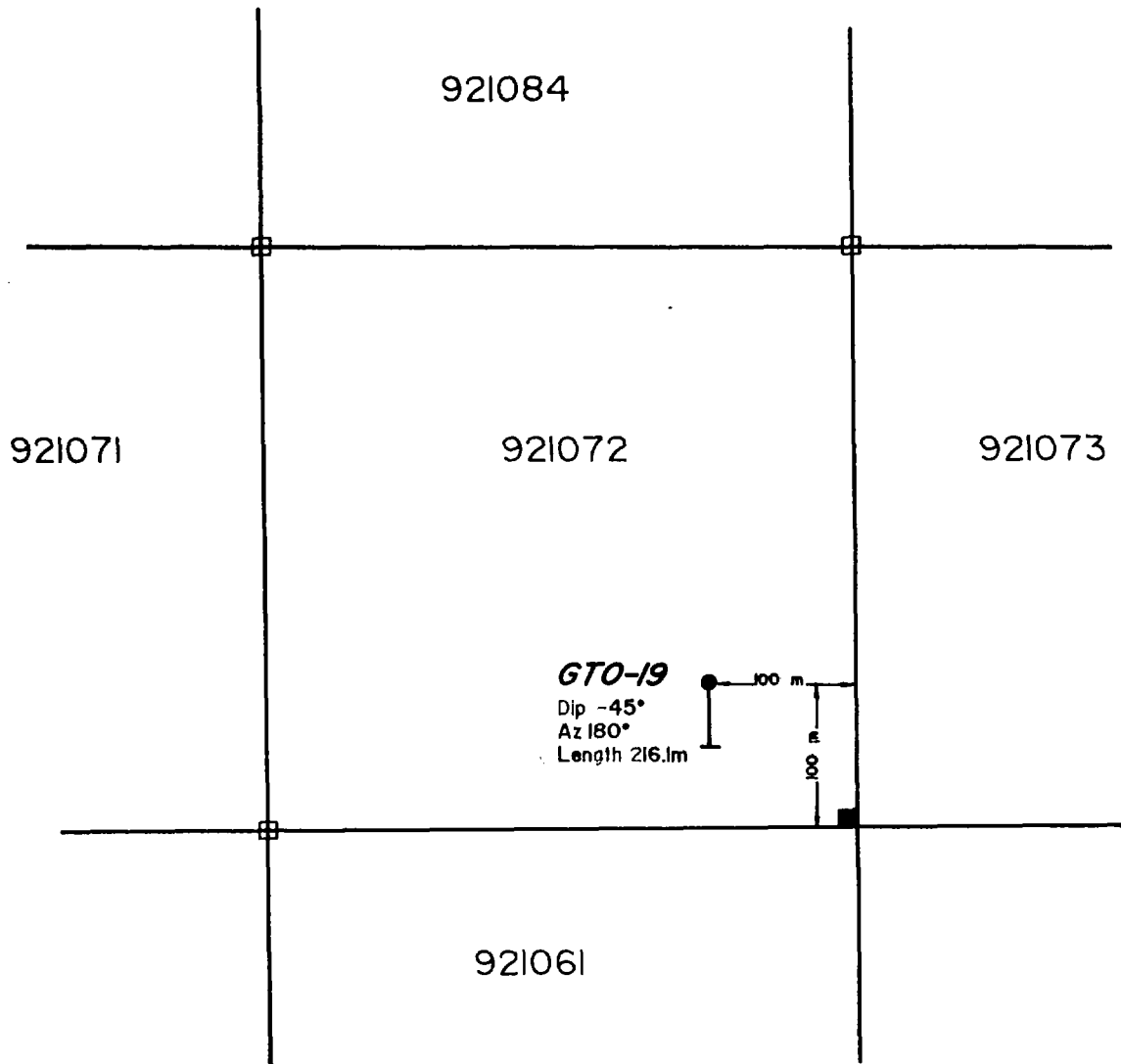

REVISIONS	DURHAM GEOLOGICAL SERVICES INC.		
	<i>For:</i> GOLDEN TRIO MINERALS LTD		
	<i>Title:</i> OBA PROJECT Diamond Drill Hole Location Map GTO-19		
	<i>Date:</i> JUNE 1988	<i>Drawn:</i> CG	<i>Scale:</i> 1:5000
	<i>NTS:</i>	<i>Approved:</i>	<i>Fig.:</i>

DURHAM GEOLOGICAL SERVICES INC.
Box 734
Timmins Ontario
P4N 7G2

DIAMOND DRILL HOLE LOG

PROJECT: Golden Trio

HOLE NUMBER: GTO-19

AREA: Oba Project (Rykert Twp)

LOCATION: L24+00W/17+60S

CLAIM NUMBER: 921072 (Rykert West) (151.1m)
921061 (65m)

AZIMUTH: 180°

CORE SIZE: BQ

DIP: -45°

DRILLED BY: Falcon Drilling

DATE: January, 1988
29-31

LOGGED BY: S. Rusnak

CASING: 6.1m

CORE STORED AT: Camp 95

LENGTH: 216.1m

OBJECTIVE: Test Airborne and Ground
Geophysics anomalies

ACID TEST:

Copy Attached for S. Rusnak

METERAGE		ROCK TYPE AND DESCRIPTION	Core Angle to Axis	% Sulphides	SAMPLE			ANALYTICAL RESULT						
From	To				Number	From	To	Length (m)	Au ppb	As ppm	Pb ppm	Zn ppm	Cu ppm	Ag ppm
0	6.1	CASTING-OVERBURDEN												
6.1	6.9	OVERBURDEN												
6.9	41.0	MAFIC VOLCANIC			6836	10.5	12.0	1.5						
		- green colour												
		- fine grained			6837	16.5	18.0	1.5						
		foliated - 2-3% calcite veinlets	70°		6838	19.5	21.0	1.5						
		- pyrite, disseminated		2-3%	6839	21.0	22.5	1.5						
		10.6-11.0 - chert, grey-purple			6840	22.5	24.0	1.5						
		12.2-12.3 - quartz veining	70°		6841	24.0	25.5	1.5						
		12.4-12.6 - chert, grey-purple			6842	25.5	27.0	1.5						
		15.7-16.1 - broken core			6843	27.0	28.5	1.5						
		18.0-18.1 - broken core			6844	28.5	30.0	1.5						
		21.0-41.8 - py, as stringers 3-4mm wide, po 2-3%	70°	5-10%	6845	30.0	31.5	1.5						
		23.0-24.0 - 2-3% chert			6846	31.5	33.0	1.5						
		24.0-25.0 - 2-3% quartz			6847	33.0	34.5	1.5						
		30.2-43.0 - 3% sphalerite			6848	34.5	36.0	1.5						
		30.8 - 2cm quartz veining	60°		6849	36.0	37.5	1.5						
		35.1 - 2cm quartz veining	60°		6850	37.5	39.0	1.5						
		40.3-41.0 - po 5%, sph 5%		5-10%	6851	39.0	40.0	1.0						
					6852	40.0	41.0	1.0						

METERAGE		ROCK TYPE AND DESCRIPTION	Core Angle to Axis	% Sulphides	SAMPLE			ANALYTICAL RESULT									
From	To				Number	From	To	Length (m)	Au ppb	As ppm	Pb ppm	Zn ppm	Cu ppm	Ag ppm			
		146.5-146.7 - 40% quartz, py		5%	6865	143.5	145.0	1.5									
		148.0-148.1 - 80% quartz			6866	145.0	146.5	1.5									
		148.3 - 2cm quartz veining	60°		6867	146.5	148.0	1.5									
		161.2-161.5 - 40% quartz veining, calcite throughout			6868	148.0	149.5	1.5									
		161.9 - 3cm quartz-calcite vein	75°		6869	161.0	162.5	1.5									
		165.4 - 6cm quartz veining	75°														
		166.2-166.4 - 10% quartz															
		168.7-168.9 - quartz veining	75°		6870	168.0	169.0	1.0									
		173.8-174.0 - 2cm impure quartz veining along C.A.	0-5°														
		179.5 - 15cm silicified vein			6871	179.0	180.5	1.5									
		179.9 - 7cm quartz veining	75°														
		175.0-191.7 - 2-3% sphalerite															
		184.0-187.0 - pyrite		2-3%													
		185.6-186.0 - silicified			6872	185.0	186.5	1.5									
		190.1-190.2 - silicified	80°														
		191.7-203.0 - 5% sphalerite															
		196.0-19.2 - wcm quartz veining	0°		6873	195.5	197.0	1.5	2				79	102		1.1	
		197.7 - 1cm quartz veining	45°														
		199.3 - 6cm quartz veining	60°		6874	201.0	202.5	1.5	4				185	114		1.0	

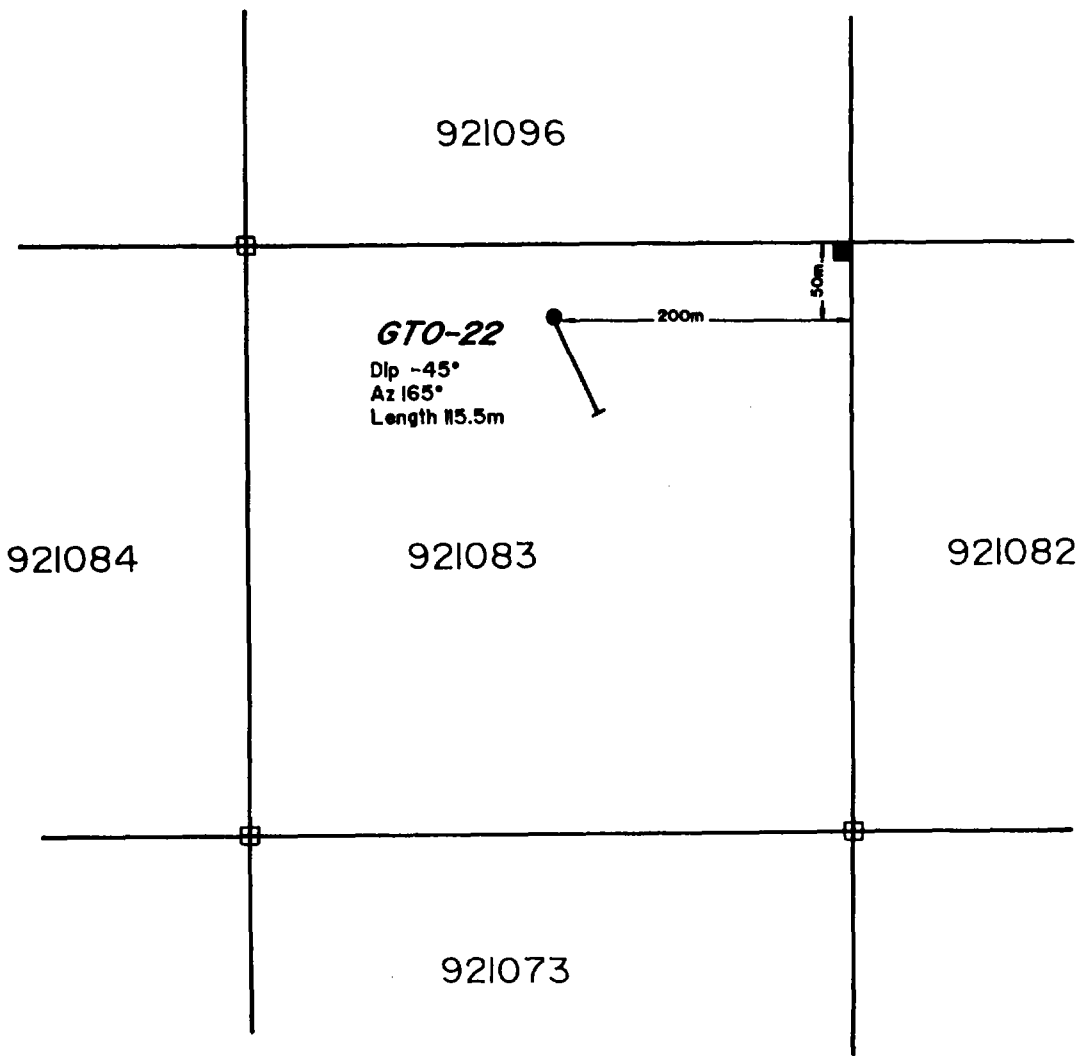

REVISIONS	DURHAM GEOLOGICAL SERVICES INC.		
	<i>For:</i> GOLDEN TRIO MINERALS LTD		
	<i>Title:</i> OBA PROJECT Diamond Drill Hole Location Map GTO-22		
	<i>Date:</i> JUNE 1988	<i>Drawn:</i> CG	<i>Scale:</i> 1:5000
	<i>NTS:</i>	<i>Approved:</i>	<i>Fig.:</i>

DURHAM GEOLOGICAL SERVICES INC.
Box 734
Timmins Ontario
P4N 7G2

DIAMOND DRILL HOLE LOG

PROJECT: Golden Trio Minerals - Oba

HOLE NUMBER: GTO-22

AREA: Rykert (W) Twp.

LOCATION: L24+00W/12+50S

CLAIM NUMBER: 921083

AZMUTH: 165°

CORE SIZE: BQ

DIP: -45°

DRILLED BY: Falcon Drilling Ltd.

DATE: January, 1988 **26-28**

LOGGED BY: S. Rusnak

CASING: 7.6m

CORE STORED AT: Camp 95

LENGTH: 115.5m

OBJECTIVE: Test Airborne and Ground
Geophysical Conductors

ACID TEST:

Smy P. Kestlin for S. Rusnak

METERAGE		ROCK TYPE AND DESCRIPTION	Core Angle to Axis	% Sulphides	SAMPLE				ANALYTICAL RESULTS					
From	To				Number	From	To	Length (m)	Au ppb	As ppm	Pb ppm	Zn ppm	Cu ppm	Ag ppm
		33.0-47.05 - 10% sphalerite py, cpy		<1%	6737	34.0	35.5	1.5	2			44	76	
		39.6 - 4cm impure quartz veining	60°		6738	39.0	40.5	1.5	1			39	51	
		36.0-53.8 - quartz eyes 2-3%												
		41.5 - 8cm quartz veining												
		44.5 - 1cm quartz veining	60°											
		47.8 - 5cm quartz veining	60°		6739	44.0	45.5	1.5	3			43	64	
		50.4 - 2cm quartz veining	60°		6740	49.0	50.5	1.5	2			41		
		51.8-53.8 - 5% quartz as blebs												
		53.7-53.8 - quartz veining, 20% host												
		55.0-59.0 - PY, cpy as stringers	60°	2-3%	6741	55.0	56.5	1.5	4			38	44	
		58.8 - 2cm quartz veining, pyrite	60°	2%	6742	56.5	58.0	1.5	1			40	49	
		60.2-60.6 - quartz veining, pyrite on contacts		2%	6744	58.0	59.5	1.5	2			47	55	
		62.3-62.4 - quartz veining	60°											
		63.0-70.0 - 5% sphalerite			6795	60.0	61.0	1.0						
68.8	70.0	GREYWACKE												
		- grey colour												
		- medium grained												
		- foliated - sphalerite 2-3%	60°											
		69.9-70.0 - garnetiferous			6746	69.0	70.0	1.0	1			72		

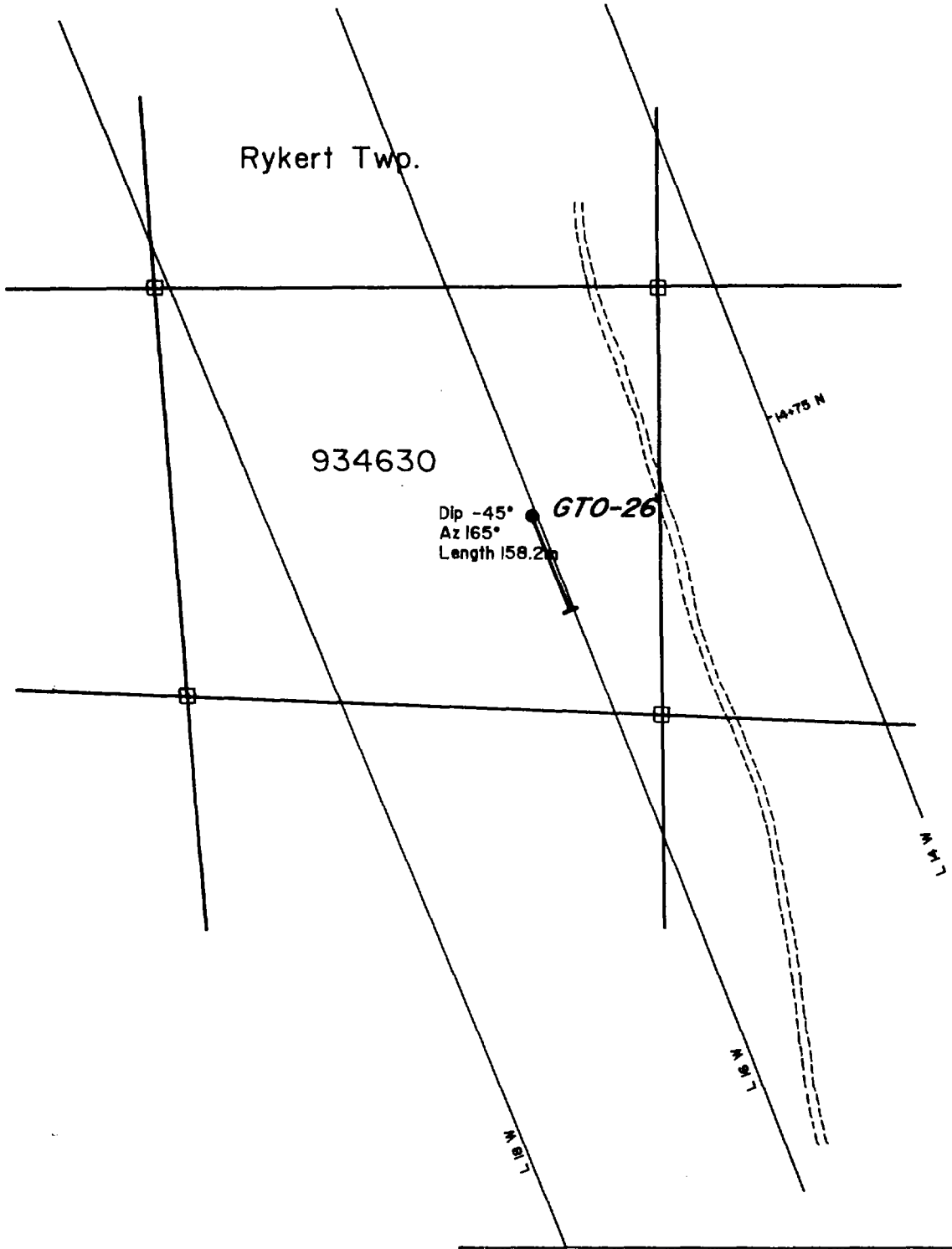

REVISIONS	DURHAM GEOLOGICAL SERVICES INC.		
	<i>For:</i>	GOLDEN TRIO MINERALS LTD	
	<i>Title:</i>	OBA PROJECT Diamond Drill Hole Location Map GTO-26	
	<i>Date:</i> JUNE 1988	<i>Drawn:</i> CG	<i>Scale:</i> 1:5000
	<i>NTS:</i>	<i>Approved:</i>	<i>Fig.:</i> -

DURHAM GEOLOGICAL SERVICES INC.
Box 734
TIMMINS, ONTARIO
P4N 7G2

DIAMOND DRILL HOLE LOG

PROJECT: Golden Trio Oba Project
AREA: Rykert (West) Twp.
CLAIM NUMBER: 934630
CORE SIZE: BQ
DRILLED BY: Falcon Drilling Ltd.
LOGGED BY: B. Barnes
CORE STORED AT: Camp 95
OBJECTIVE: Test Airborne and Ground
Geophysical Conductors

HOLE NUMBER: GTO-26
LOCATION: L16+00W/14+75N
AZIMUTH: 165°
DIP: -45°
DATE: February, 1988
CASING: 26.7m
LENGTH: 158.2m
ACID TEST

Handwritten signature: Harry P. Mathis for B. Barnes

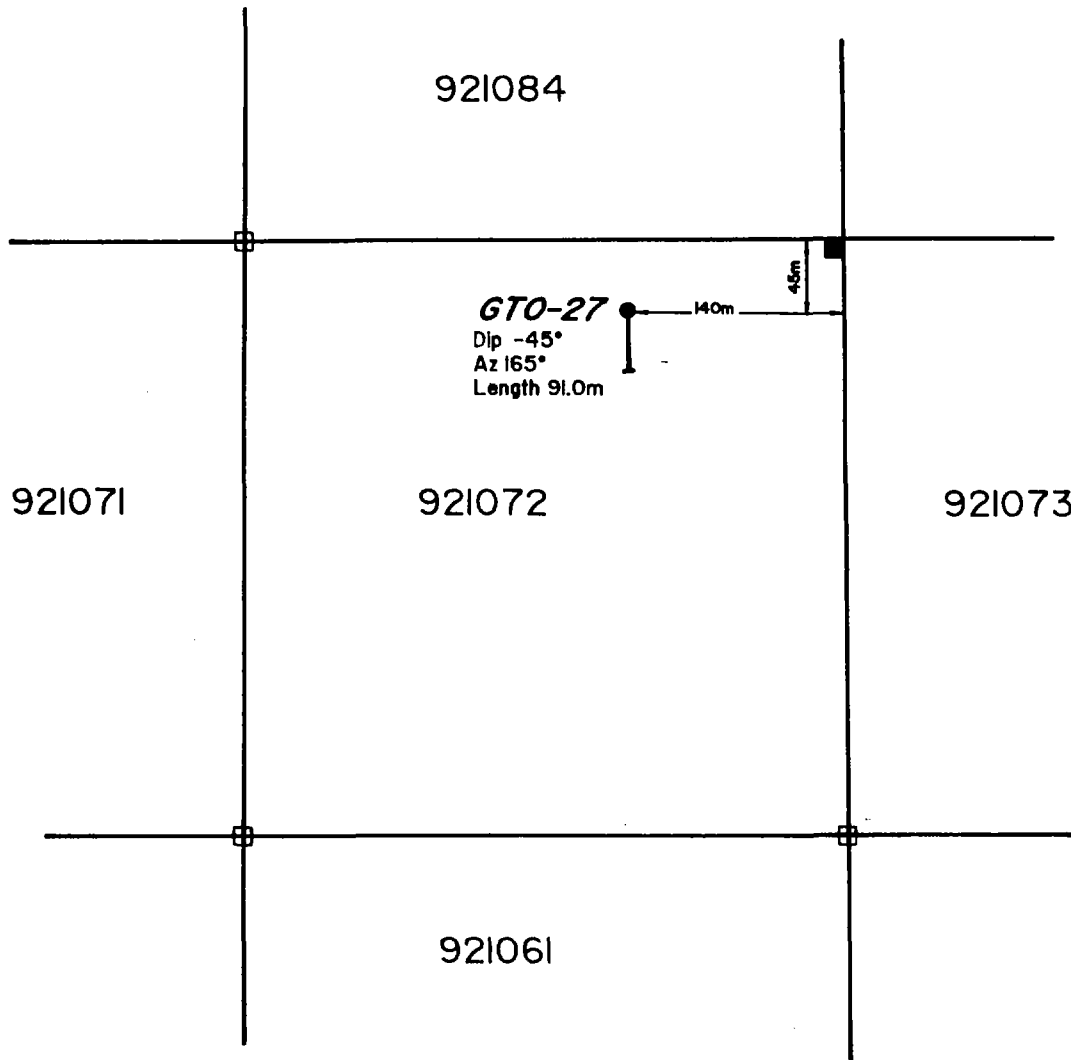

REVISIONS	DURHAM GEOLOGICAL SERVICES INC.		
	For: GOLDEN TRIO MINERALS LTD		
	Title: OBA PROJECT		
	Diamond Drill Hole Location Map		
	GTO-27		
	Date: June 1988	Drawn: CG	Scale: 1:5000
	NTS:	Approved: <i>[Signature]</i>	Fig.:

DUNHAM GEOLOGICAL SERVICES INC.
Box 734
TIMMINS, ONTARIO
P4N 7G2

DIAMOND DRILL HOLE LOG

PROJECT: Golden Trio Oba Project
AREA: Rykert (West) Twp.
CLAIM NUMBER: 921072
CORE SIZE: BQ
DRILLED BY: Falcon Drilling Ltd.
LOGGED BY: S. Rusnak
CORE STORED AT: Camp 95
OBJECTIVE: Test Airborne GE

HOLE NUMBER: GTO-27
LOCATION: L24+00W/14+75S
AZIMUTH: 165°
DIP: -45°
DATE: February, 1988
CASING: 14.6m
LENGTH: 91.0m
ACID TEST

Copy Attached for S. Rusnak



W3906-448

Mining A

Name and Address of Recorded Holder: **Golden Trio Minerals Ltd**
Prospector's Licence No.: **T 720**

1401-141 Adelaide St. W. Toronto, Ont. M5H 3M7

Summary of Work Performance and Distribution of Credits

Total Work Days Cr. claimed	Mining Claim		Work Days Cr.	Mining Claim		Work Days Cr.	Mining Claim		Work Days Cr.
	Prefix	Number		Prefix	Number		Prefix	Number	
2118									
for Performance of the following work. (Check one only)									
<input type="checkbox"/> Manual Work									
<input type="checkbox"/> Shaft Sinking Drifting or other Lateral Work.									
<input type="checkbox"/> Compressed Air, other Power driven or mechanical equip.									
<input type="checkbox"/> Power Stripping									
<input checked="" type="checkbox"/> Diamond or other Core drilling									
<input type="checkbox"/> Land Survey									

ONTARIO GEOLOGICAL SURVEY
ASSESSMENT FILES
OFFICE
OCT 13 1989
RECEIVED

All the work was performed on Mining Claim(s): **921089, 921072, 921083, 934630, 921061**

Required Information eg: type of equipment, Names, Addresses, etc. (See Table Below)

Falcon Drilling Ltd.
Box 578, Prince George, B.C.
V2L 4S8

		Meterage
GTO-18	Jan 24-25, 1988	65.2
GTO-19	Jan 29-31, 1988	216.1
GTO-22	Jan 26-28, 1988	115.5
GTO-26	Feb 3-5, 1988	158.2
GTO-27	Feb 1-2, 1988	91.0
		646m = 2118.8 ft.

RECORDED
MAY -2 1989

RECEIVED
MAY 2 1989

Date of Report: **May 1/89**
Recorded Holder or Agent (Signature): *Henry Hutteri*

Certification Verifying Report of Work **10-45** *JA*

I hereby certify that I have a personal and intimate knowledge of the facts set forth in the Report of Work annexed hereto, having performed the work or witnessed same during and/or after its completion and the annexed report is true.

Name and Postal Address of Person Certifying: **Henry Hutteri 268-6644 (1)**

Box 1330, Timmins, Ont. P4N 7J8
Date Certified: **May 1/89**
Certified by (Signature): *Henry Hutteri*

Table of Information/Attachments Required by the Mining Recorder

Type of Work	Specific information per type	Other information (Common to 2 or more types)	Attachments
Manual Work	Nil	Names and addresses of men who performed manual work/operated equipment, together with dates and hours of employment.	Work Sketch: these are required to show the location and extent of work in relation to the nearest claim post.
Shaft Sinking, Drifting or other Lateral Work			
Compressed air, other power driven or mechanical equip.	Type of equipment	Names and addresses of owner or operator together with dates when drilling/striping	
Power Stripping	Type of equipment and amount expended. Note: Proof of actual cost must be submitted within 30 days of recording.		

