

2.23480

The Fall 2001 stripping and sampling program
on the Lowther property

Lowther Township

Northeastern Ontario
NTS 42B/NW

Lecours Exploration Inc

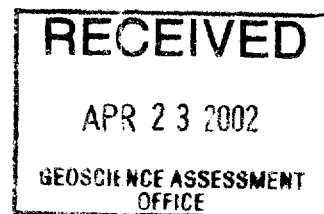

April 2002

Gerald Lecours



Location and Access

The property consists of one 7-unit claim # 1241384 Lowther Township, Ontario. The staked claim covers the southern half of lot 6 & 7 con. 5 & the northern half of lot 6 & 7 con. 4.

Access to the property is by way of Hwy 583 South from Hearst for approximately 20 kms. The last 16 kms is accessible by off-terrain vehicle and two creeks have to be crossed.

Previous Work

Previous work on the property includes minor trenching and diamond drilling of 3 holes totaling 89ft by I. Topaloff in 1957. Magnetics and electromagnetic (VLF-EM) surveys were done by Noranda Exploration Co. Ltd. In 1978.

Regional Geology

The general geology of the area has been described by Bennett et.al (1967). A review of geologic maps shows the area to occur near the contact of a belt of migmatitic meta-sedimentary and meta-volcanic rocks to the north with amphibolite facies metasediments to the south. Near this contact, the migmatitic belt is intruded by a series of elongate granitic stocks. The Lowther Occurrence is located on the western contact of one of these stocks.

Property Geology & Mineralization

The following is taken from a description by S.A. Ferguson, Resident Geologist in Timmins in 1955.

“A large zone of quartz, 60 feet in width, strikes at 70 degrees. On the north side of this band of quartz a zone of pegmatite about 15 feet in width is exposed for about 100 feet. The pegmatite consists of quartz, feldspar, some muscovite crystals four to five inches in diameter and some light greenish spodumene....

Some lepidolite is also present in veins about four inches in width and up to 10 feet in length. Much of the lepidolite is associated with the large quartz vein rather than the pegmatite.”

Ferguson states that the pegmatite is associated with an outcrop of pink granite with irregular patches of pegmatite. The current investigation indicates that the quartz zone represents the inner core of a much larger pegmatite body. The trench mentioned by Ferguson appears to occur at the contact of the quartz zone and a zone of pegmatitic feldspar consisting of potassium feldspar crystals 15 – 30 cm wide containing medium to coarse grain graphic intergrowths of quartz. The feldspar crystals were found to decrease in size to the North, towards an apparent contact. The country rock appears to consist of a medium grain, slightly biotitic granite. Although the contact is not exposed, brownish pink aplitic dikes intrude the granite near the contact and may be similar to the contact zone of the pegmatite. The area south of the quartz zone is poorly exposed at present.

Stripping and sampling results

In Sept 01 Lecours Exploration Inc contracted Cross Country Landscaping to perform manual trenching & stripping on the property. The program uncovered 4 different zones of the pegmatite including lens or pods of spodumene mineral, different zone of quartz ranging in color from light gray to pure white, a zone of moonstone mineral & various other unknown.

Sampling was done using a cut-off saw with a diamond blade cut at 2” width and cut at 2’ intervals.

Lowther top. stripping map

Legend.

 Blasted pit.
 13 X sample location and number
 QZ quartz zone N
 --- pegmatite zone boundary
 0 1m 2m 3m - scale

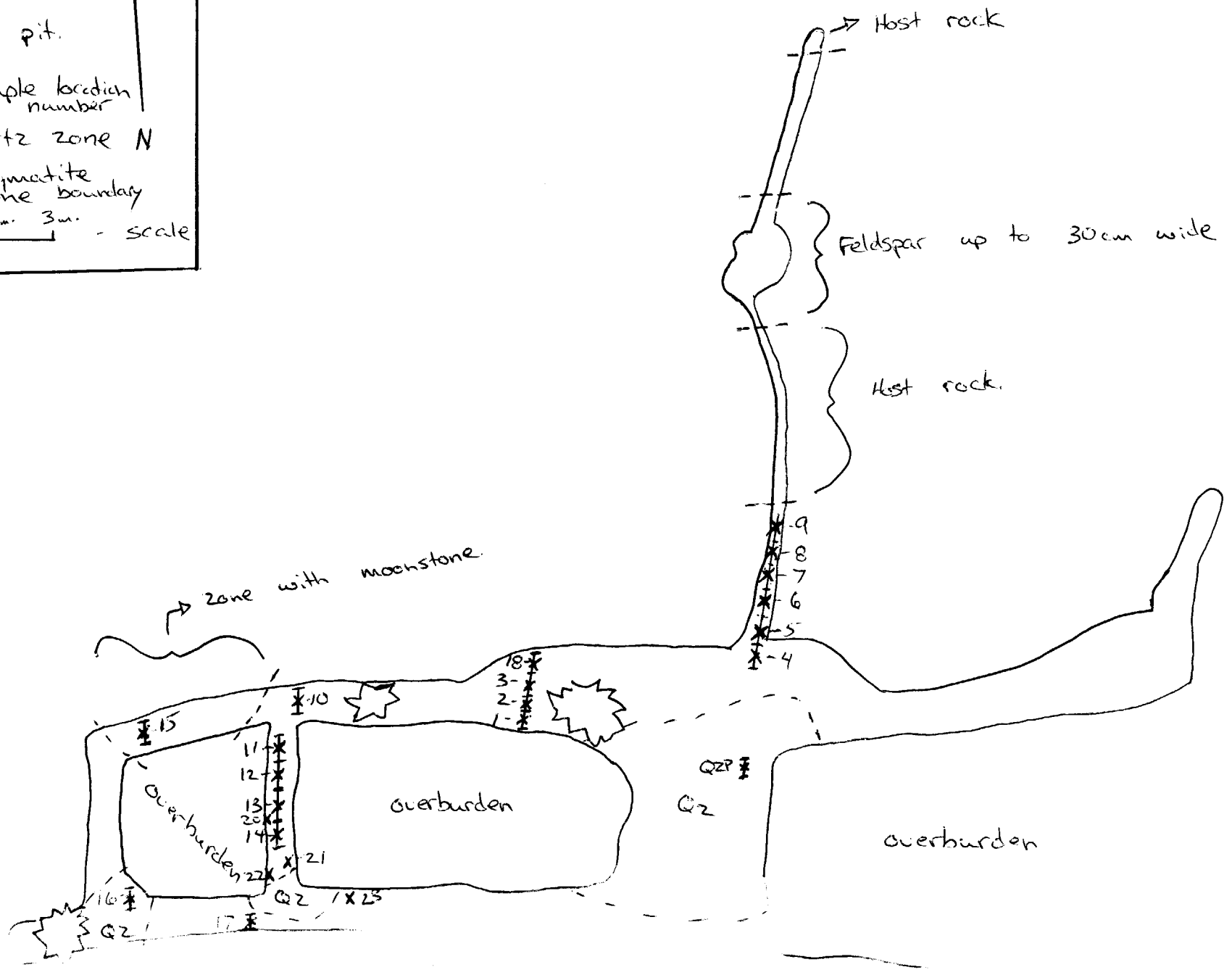

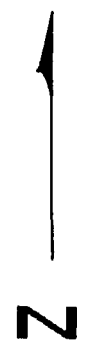
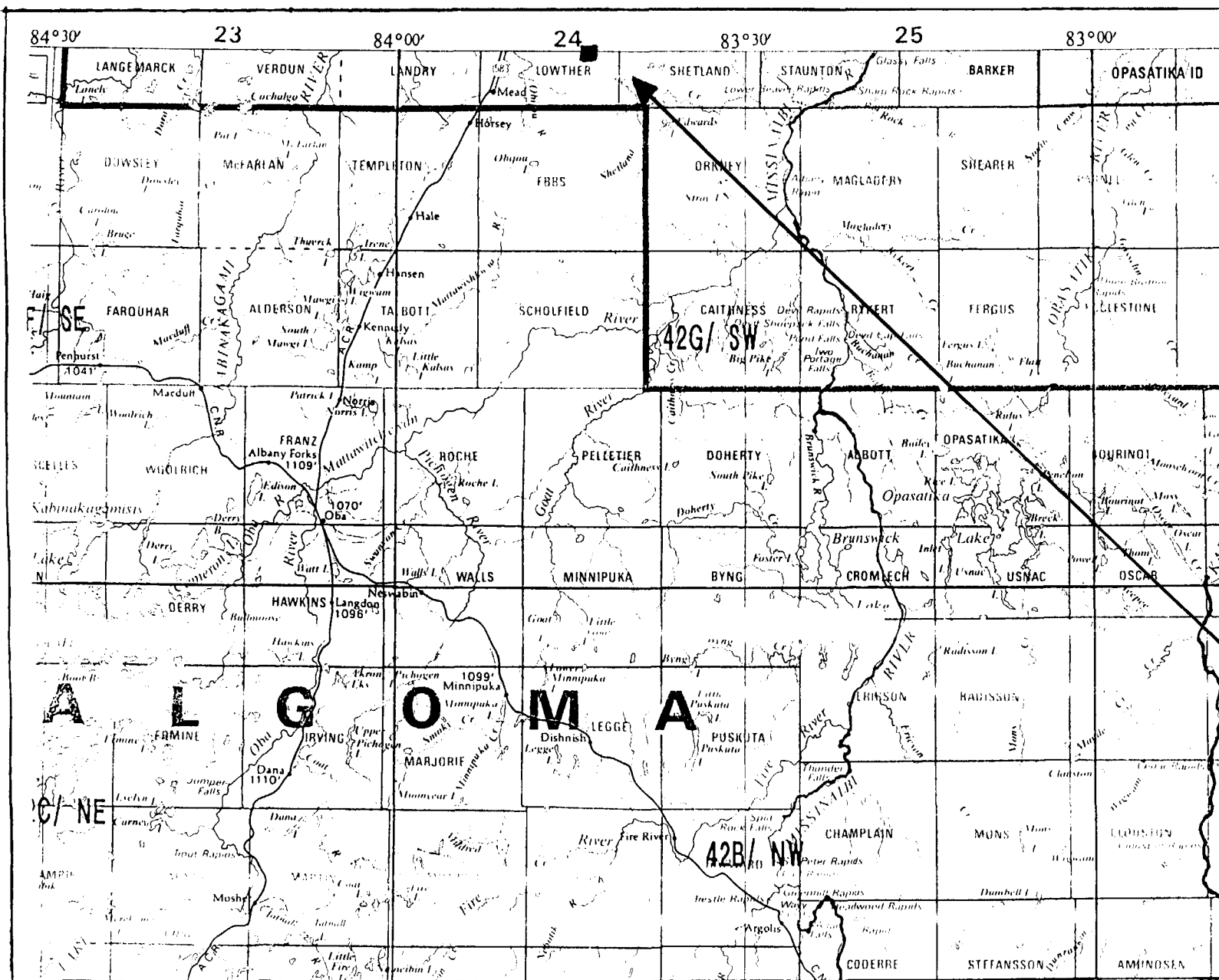

Claim # 1241384

Property Location

NO. 10000

Lawther twp.



Sketch

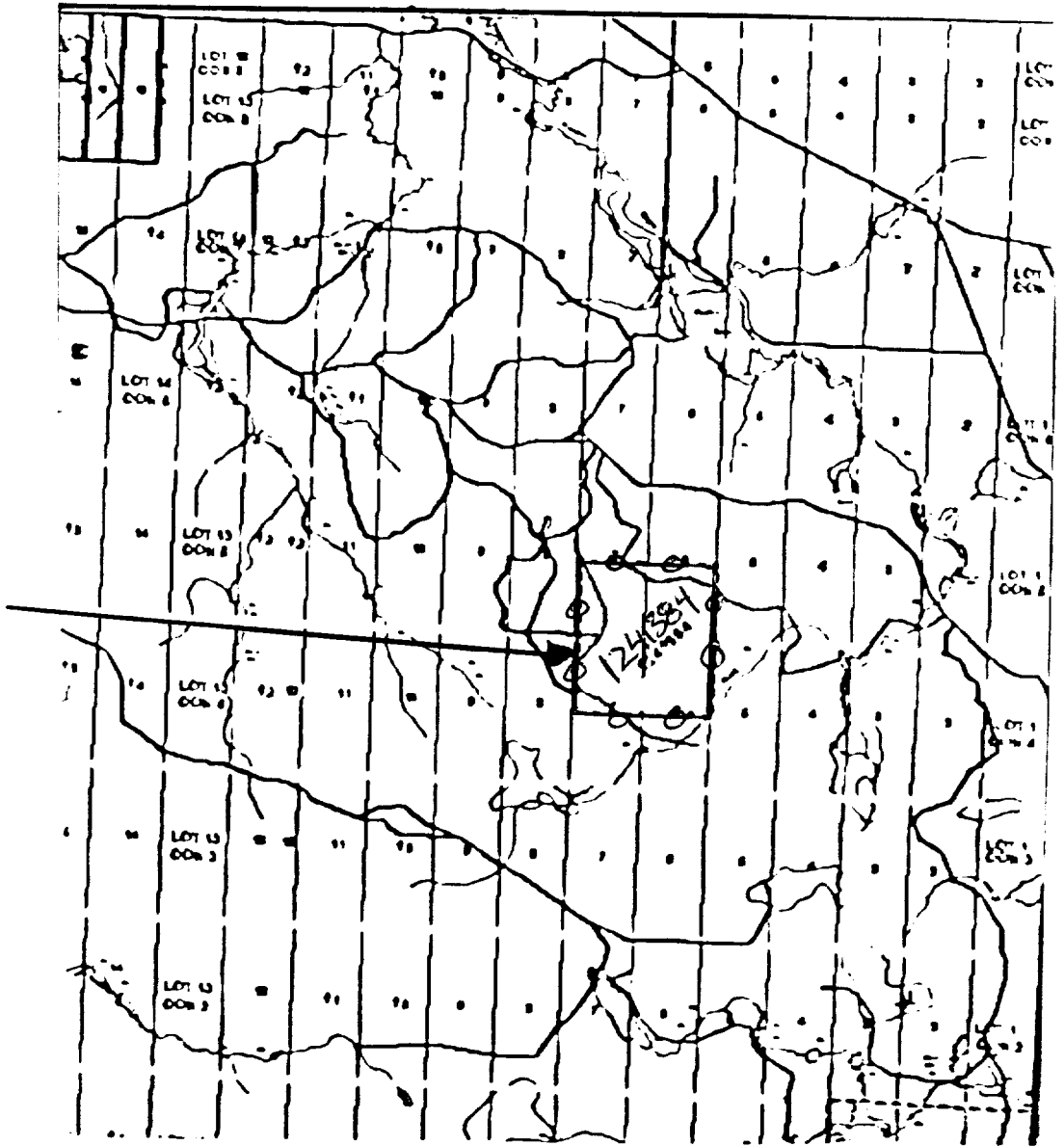

Lowther trap.
Fall 2001 stripping location.

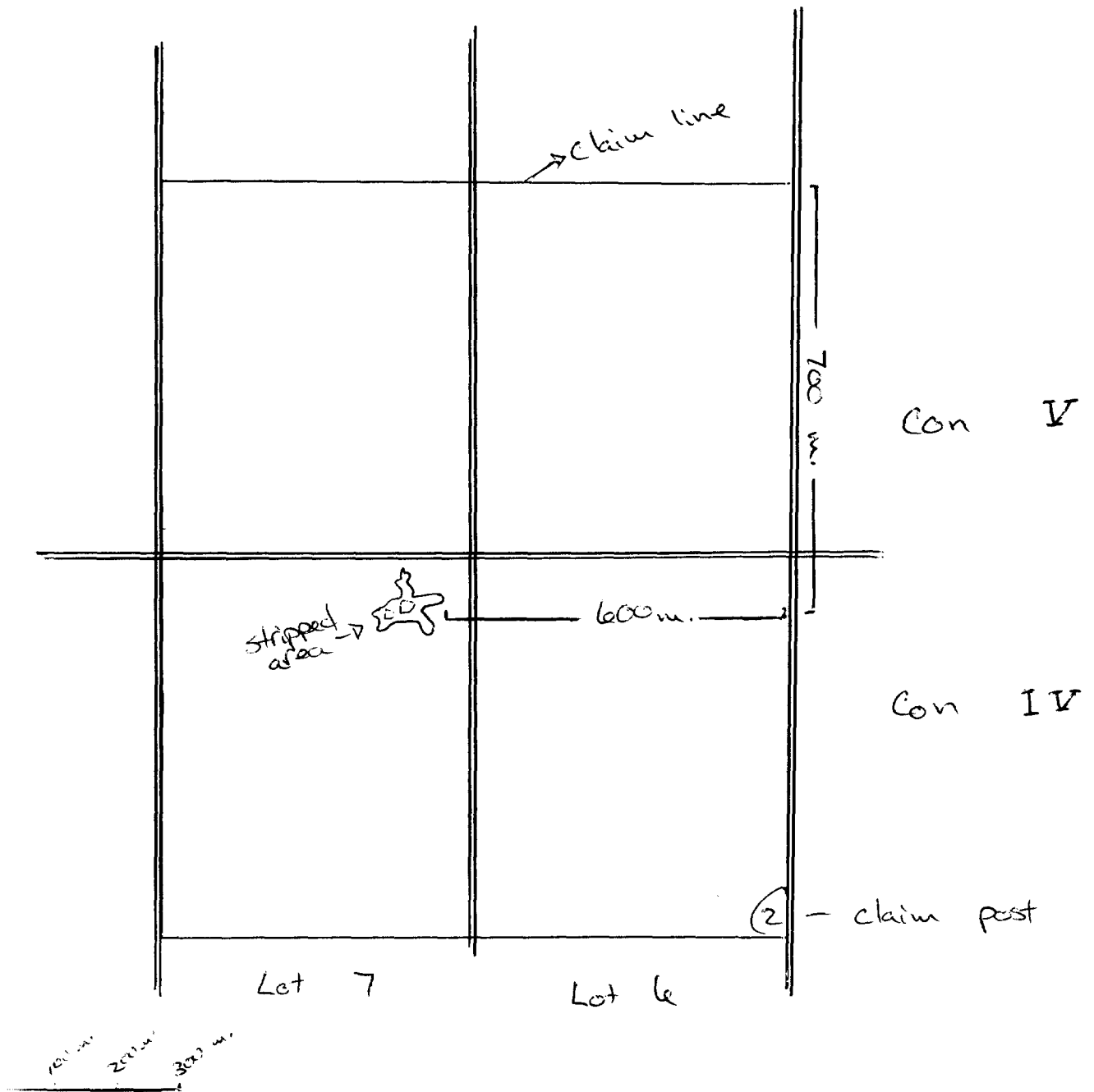

A0126267 - CERTIFIED

CLIENT : "LECOURS RITA " "

of SAMPLES : 8

DATE RECEIVED : 06-OCT-2001

PROJECT : " " "

CERTIFICATE COMMENTS : "ATTN: RITA LECOURS CC: GERALD LECOURS"

	9327	9301	9346	9302	9303	9304	9306
SAMPLE	Ag	Al	As	Ba	Be	Bi	Ca
DESCRIPTION	ppm	%	ppm	ppm	ppm	ppm	%
LOW-01-1	1.14	7.97	1.6	5	8.3	0.33	0.54
LOW-01-2	1.34	7.41	1	3	20.8	1.7	0.16
LOW-01-3	1.06	7.83	1	8.5	3	11.3	0.06
LOW-01-4	1.72	7.7	0.8	2.5	8.35	0.19	0.25
LOW-01-9	0.54	7.41	0.6	104	4.1	0.32	0.76
LOW-01-11	1.72	9.88	0.8	6	5.8	0.92	0.16
LOW-01-17	1.04	5.55	0.6	1.5	6.05	0.25	0.19
LOW-01-18	2.32	8.83	1	42	6.95	0.27	0.28

9305	9307	9310	9309	9308	9311	9315	9312	9313
Cd	Ce	Co	Cr	Cs	Cu	Fe	Ga	Ge
ppm	ppm	ppm	ppm	ppm	ppm	%	ppm	ppm
0.12	4.05	8.2	110	47.1	8.6	0.54	32.3	0.05
0.08	3.37	7.2	87	12.2	20.6	0.31	45	0.05
0.8	0.54	8.7	99	>500	22.8	0.49	70.7	0.2
0.14	3.76	2.5	100	18.9	5.4	0.6	46.75	0.1
0.06	18.15	3.5	135	13.2	9	2.83	29.45	0.05
0.28	1.06	4.7	46	>500	4	0.55	103.85	0.1
0.12	1.78	0.9	142	29.8	3.6	0.43	25.25	0.05
0.12	62.1	8.7	68	42.1	4.8	0.6	50.9	0.15

9347	9348	9325	9316	9318	9319	9320	9321	9328
Hf	In	K	La	Li	Mg	Mn	Mo	Na
ppm	ppm	%	ppm	ppm	%	ppm	ppm	%
9.4	0.01	0.35	2	144	0.03	325	1	6.83
1.3	0.04	0.35	1.5	77.2	0.02	300	1.1	6.47
0.6	<0.005	4.15	<0.5	>500	0.01	4860	1.35	1.73
0.6	0.185	0.75	1.5	464	0.04	1215	0.9	5.31
0.4	0.025	2.34	9	65.6	0.13	275	0.7	4.1
0.4	0.01	5.01	<0.5	>500	0.01	2960	0.55	3.75
1.4	0.055	0.35	0.5	174.5	0.01	725	0.9	4.03
0.6	0.085	0.6	19	171	0.04	1770	0.55	6.59

9323	9322	9324	9317	9326	9349	9351	9341	9350
Nb	Ni	P	Pb	Rb	Re	S	Sb	Se
ppm	ppm	ppm	ppm	ppm	ppm	%	ppm	ppm
36.3	3.4	60	10	123.5	0.004	<0.01	0.2	<1
46.9	3	70	4.5	92.3	0.002	<0.01	0.25	<1
32.7	3.4	<10	8.5	>500	<0.002	<0.01	0.25	<1
66.4	2.8	<10	4.5	297	<0.002	<0.01	0.15	<1
12.1	4	370	10	135	<0.002	0.04	0.1	<1
67.5	1.6	10	10	>500	<0.002	<0.01	0.15	<1
38.4	3.8	<10	4.5	133.5	<0.002	<0.01	0.05	<1
94.1	2.4	120	37.5	301	<0.002	<0.01	0.15	<1

9352	9329	9330	9331	9333	9334	9332	9336	9337
Sn	Sr	Ta	Te	Th	Ti	Tl	U	V
ppm	ppm	ppm	ppm	ppm	%	ppm	ppm	ppm
3.2	29	4.45	0.35	33.2	0.01	0.98	5.8	3
11.8	10.6	18.15	0.2	21.6	0.01	0.56	3.9	1
30.4	16.8	15.95	0.1	12.8	0.01	17.5	0.7	10
38.4	12	11.45	0.05	8.2	0.02	1.2	2.7	1
3.6	329	2.8	0.05	11.2	0.05	0.98	2.8	11
22.6	35	36.1	0.05	3.8	0.02	17.2	1.1	10
11.2	4.8	6.25	<0.05	3.8	<0.01	0.84	1.3	1
23.2	21.8	19.45	0.05	220	0.01	1.34	16.9	1

9335	9338	9339	9353
W	Y	Zn	Zr
ppm	ppm	ppm	ppm
2.3	3.7	58	48.5
1.3	2.1	36	8.5
1	1.7	124	4
0.8	5.8	44	6.5
0.1	4.4	68	7
0.8	2	106	3.5
<0.1	6.3	24	20.5
1.1	17.2	80	8.5

A0126268 - CERTIFIED

CLIENT : "LECOURS RITA

"

of SAMPLES : 8

DATE RECEIVED : 06-OCT-2001

PROJECT : "

"

CERTIFICATE COMMENTS : "ATTN: RITA LECOURS

CC: GERALD LECOURS"

SAMPLE	902 Al2O3	8905 BaO	906 CaO	2590 Cr2O3	903 Fe2O3	908 K2O	905 MgO
DESCRIPTION	% XRF	% XRF	% XRF	% XRF	% XRF	% XRF	% XRF
LOW-01-1	17.3	<0.01	0.81	<0.01	0.94	0.42	<0.01
LOW-01-2	16.71	<0.01	0.25	<0.01	0.59	0.43	<0.01
LOW-01-3	17.46	<0.01	0.08	<0.01	0.72	3.8	<0.01
LOW-01-4	15.2	<0.01	0.36	<0.01	0.89	0.82	<0.01
LOW-01-9	14.06	<0.01	1.06	<0.01	4.2	2.46	0.16
LOW-01-11	21.76	<0.01	0.25	<0.01	0.87	5.85	<0.01
LOW-01-17	10.71	<0.01	0.26	<0.01	0.61	0.37	<0.01
LOW-01-18	17.89	<0.01	0.42	<0.01	0.92	0.74	<0.01

1989	907	909	901	8910	904	910	2540
MnO	Na2O	P2O5	SiO2	SrO	TiO2	LOI	TOTAL
% XRF	% XRF	% XRF	% XRF	% XRF	% XRF	%	%
0.05	8.34	0.03	70.69	<0.01	0.03	0.53	99.14
0.05	8.98	0.04	70.89	<0.01	0.04	0.39	98.37
0.59	1.64	0.01	74.17	<0.01	0.04	0.6	99.11
0.18	6.79	0.01	74.22	<0.01	0.05	0.53	99.05
0.04	5.01	0.11	71.23	0.04	0.11	0.32	98.8
0.43	4.98	0.03	63.87	<0.01	0.06	1.15	99.25
0.11	4.15	0.03	82.39	<0.01	0.04	0.35	99.02
0.27	8.81	0.07	69.33	<0.01	0.04	0.64	99.13

A0127231 - CERTIFIED

CLIENT : "LECOURS RITA

"

of SAMPLES : 2

DATE RECEIVED : 22-OCT-2001

PROJECT : "

"

CERTIFICATE COMMENTS : "ATTN: RITA LECOURS

CC: GERALD LECOURS"

SAMPLE DESCRIPTION	356 Li %	2858 Cs ppm	2864 Rb ppm
LOW-01-3	0.57	599	2390
LOW-01-11	0.11	520	2450

A0127232 - CERTIFIED

CLIENT : "LECOURS RITA "

of SAMPLES : 10

DATE RECEIVED : 23-OCT-2001

PROJECT : " "

CERTIFICATE COMMENTS : "ATTN: RITA LECOURS CC: GERALD LECOURS"

: "*** CORRECTED COPY ** FOR ICP-MS ON ALL SAMPLES. "

	9327	9301	9346	9302	9303	9304	9306
SAMPLE	Ag	Al	As	Ba	Be	Bi	Ca
DESCRIPTION	ppm	%	ppm	ppm	ppm	ppm	%
LOW-01-5	0.5	7.5	0.6	21	8.5	0.13	0.46
LOW-01-6	0.3	4.37	0.2	12.5	6.45	0.19	0.34
LOW-01-7	0.36	5.61	0.4	12.5	8.7	0.15	0.47
LOW-01-8	0.16	5.46	0.8	6.5	6.45	0.23	0.49
LOW-01-10	0.74	7.85	0.2	31.5	7.5	0.1	0.08
LOW-01-12	0.6	9.16	0.2	6.5	4.9	0.07	0.08
LOW-01-13	0.38	9.17	0.2	41	5.35	2.01	0.08
LOW-01-14	0.5	8.7	<2.0	10	16.5	3.6	0.12
LOW-01-15	0.2	7.39	0.2	12.5	8.65	2.42	0.53
LOW-01-16	<0.50	8.65	<2.0	10	3.5	0.5	0.12

9305	9307	9310	9309	9308	9311	9315	9312	9313
Cd	Ce	Co	Cr	Cs	Cu	Fe	Ga	Ge
ppm	ppm	ppm	ppm	ppm	ppm	%	ppm	ppm
0.18	1.93	3.5	50	8.3	<0.2	0.3	33.15	0.05
0.04	23.7	7.1	85	3.55	<0.2	0.3	15.4	0.05
0.06	19.25	8	68	5.45	<0.2	0.31	20.4	0.05
0.02	19.05	8.2	72	4.9	<0.2	0.28	17.2	0.05
<0.02	0.53	4.4	20	>500	<0.2	0.48	92.2	0.15
<0.02	<0.01	6.6	38	>500	<0.2	0.27	106.15	0.15
0.02	<0.01	9.5	28	467	<0.2	0.2	103.7	0.15
0.6	<0.10	8	44	208	<2.0	0.24	89	<0.50
0.28	2.65	1.6	36	47.2	0.8	0.36	38.25	0.05
1.2	<0.10	5	38	354	<2.0	0.24	77.5	<0.50

9347	9348	9325	9316	9318	9319	9320	9321	9328
Hf	In	K	La	Li	Mg	Mn	Mo	Na
ppm	ppm	%	ppm	ppm	%	ppm	ppm	%
1.4	0.005	0.37	1	103	0.03	1130	0.85	6.89
0.6	<0.005	0.21	10	34.2	0.03	115	0.85	3.41
1.3	<0.005	0.27	7.5	31.2	0.03	85	0.9	4.67
1.5	<0.005	0.22	9	39	0.01	50	0.8	4.18
4.8	0.02	5.11	<0.5	266	0.01	900	0.35	4.35
1	<0.005	5.91	<0.5	>500	<0.01	6860	0.5	3.49
0.4	<0.005	5.61	<0.5	>500	<0.01	5110	0.45	3.86
<1.0	<0.050	3.6	<5.0	>500	0.01	>10000	0.5	5.01
1.2	<0.005	0.4	1	77.8	0.01	945	0.75	6.91
<1.0	<0.050	5.78	<5.0	62	0.01	>10000	0.5	3.95

9323	9322	9324	9317	9326	9349	9351	9341	9350
Nb	Ni	P	Pb	Rb	Re	S	Sb	Se
ppm	ppm	ppm	ppm	ppm	ppm	%	ppm	ppm
23.2	5	60	8.5	39.2	<0.002	<0.01	0.15	<1
5.1	3.8	80	7	23.9	<0.002	<0.01	0.35	<1
6.8	3.8	140	10.5	28.6	<0.002	<0.01	0.2	<1
3.3	3.6	80	8.5	24.2	<0.002	<0.01	0.2	<1
78.4	1.8	40	19.5	>500	<0.002	<0.01	1.25	<1
66.9	2.2	40	15	>500	<0.002	<0.01	0.05	<1
42.2	4.4	30	14.5	>500	<0.002	<0.01	0.05	<1
18	2	40	5	>500	<0.020	<0.01	<0.50	<10
23.5	3.4	80	11	119.5	<0.002	0.08	0.65	<1
68	2	30	15	>500	<0.020	<0.01	<0.50	3

9352	9329	9330	9331	9333	9334	9332	9336	9337
Sn	Sr	Ta	Te	Th	Ti	Tl	U	V
ppm	ppm	ppm	ppm	ppm	%	ppm	ppm	ppm
4.8	27.2	7	<0.05	3.2	<0.01	0.3	3.8	1
2	48.6	1.8	<0.05	11	<0.01	0.16	6.3	<1
1.8	66.6	2.65	<0.05	13.2	<0.01	0.2	7.4	1
1.2	63.8	1.2	<0.05	15.2	<0.01	0.16	4.6	<1
25.2	39.8	35	<0.05	22.4	0.01	16.95	4.8	6
26.8	22.2	43.3	<0.05	7.8	0.01	22	1.8	6
23	32.2	31.7	<0.05	8.2	0.01	19.55	2.3	5
22	30	13.5	<0.50	<2.0	0.01	10.8	<1.0	5
5.6	48	4.65	<0.05	4.6	<0.01	0.98	6.9	1
18	62	42.5	<0.50	<2.0	0.01	16.4	2	5

9335	9338	9339	9353
W	Y	Zn	Zr
ppm	ppm	ppm	ppm
4.2	5.3	20	13.5
0.9	10.6	12	11
0.9	7.3	12	24.5
1	9.2	10	21.5
1.3	2.9	74	26
0.9	1.1	72	4
1	1.2	72	2
1	11	52	<5.0
0.4	9.2	80	19
<1.0	29	50	<5.0

A0129050 - CERTIFIED

CLIENT : "LECOURS RITA" "

of SAMPLES : 5

DATE RECEIVED : 19-NOV-2001

PROJECT : " "

CERTIFICATE COMMENTS : "ATTN: RITA LECOURS CC: GERALD LECOURS"

SAMPLE DESCRIPTION	328 MnO %	356 Li %	2858 Cs ppm	2864 Rb ppm
LOW-01-10	----	----	551	2050
LOW-01-12	----	0.33	454	2220
LOW-01-13	----	0.22	----	2260
LOW-01-14	1.87	0.33	----	1310
LOW-01-16	1.57	----	----	1980

A0130710 - CERTIFIED

CLIENT : "LECOURS RITA "

of SAMPLES : 3

DATE RECEIVED : 19-DEC-2001

PROJECT : " "

CERTIFICATE COMMENTS : "ATTN: RITA LECOURS CC: GERALD LECOURS"

	9327	9301	9346	9302	9303	9304	9306
SAMPLE	Ag	Al	As	Ba	Be	Bi	Ca
DESCRIPTION	ppm	%	ppm	ppm	ppm	ppm	%
LOW-01-22	0.4	9.5	0.2	19.5	11.8	0.19	0.03
LOW-01-23	0.58	9.53	0.6	49.5	15.55	9.73	0.04
OZ-P	0.16	0.21	0.2	10.5	0.95	0.19	0.03

9305	9307	9310	9309	9308	9311	9315	9312	9313
Cd	Ce	Co	Cr	Cs	Cu	Fe	Ga	Ge
ppm	ppm	ppm	ppm	ppm	ppm	%	ppm	ppm
0.08	0.14	6.1	158	358	13.4	0.37	94.1	0.2
0.1	0.13	2.5	130	224	12.4	0.4	87.85	0.15
<0.02	0.93	0.9	337	22.5	13.4	0.37	1.15	0.15

9347	9348	9325	9316	9318	9319	9320	9321	9328
Hf	In	K	La	Li	Mg	Mn	Mo	Na
ppm	ppm	%	ppm	ppm	%	ppm	ppm	%
0.3	<0.005	1.92	<0.5	>500	<0.01	985	2.25	0.55
0.3	<0.005	1.92	<0.5	>500	0.01	1040	1.6	1.2
<0.1	<0.005	0.06	<0.5	168.5	0.01	50	3.15	0.05

9323	9322	9324	9317	9326	9349	9351	9341	9350
Nb	Ni	P	Pb	Rb	Re	S	Sb	Se
ppm	ppm	ppm	ppm	ppm	ppm	%	ppm	ppm
4.7	6.8	30	6	>500	<0.002	<0.01	0.25	<1
12.7	6.6	20	6.5	>500	0.002	<0.01	0.35	<1
0.6	10	<10	0.5	8.4	<0.002	0.01	0.15	<1

9352	9329	9330	9331	9333	9334	9332	9336	9337
Sn	Sr	Ta	Te	Th	Ti	Tl	U	V
ppm	ppm	ppm	ppm	ppm	%	ppm	ppm	ppm
24.8	41.4	6.95	0.05	0.2	<0.01	6.92	0.6	10
23	107.5	8.9	<0.05	<0.2	<0.01	5.14	0.6	8
0.2	4.8	0.15	<0.05	<0.2	<0.01	0.08	<0.1	7

9335	9338	9339	9353
W	Y	Zn	Zr
ppm	ppm	ppm	ppm
0.7	0.1	16	2.5
0.6	0.9	14	2.5
0.4	0.1	8	2

A0210361 - CERTIFIED

CLIENT : "LECOURS RITA "

of SAMPLES : 2

DATE RECEIVED : 11-JAN-2002

PROJECT : " "

CERTIFICATE COMMENTS : "ATTN: RITA LECOURS CC: GERALD LECOURS"

: " "

SAMPLE	4077	356
DESCRIPTION	Rb	Li
	ppm	%
LOW-01-22	972	2.39
LOW-01-23	774	2.14

A0130713 - CERTIFIED

CLIENT : "LECOURS RITA "

of SAMPLES : 3

DATE RECEIVED : 19-DEC-2001

PROJECT : " "

CERTIFICATE COMMENTS : "ATTN: RITA LECOURS CC: GERALD LECOURS"

	902	8905	906	2590	903	908	905
SAMPLE	Al2O3	BaO	CaO	Cr2O3	Fe2O3	K2O	MgO
DESCRIPTION	% XRF	% XRF	% XRF	% XRF	% XRF	% XRF	% XRF
LOW-01-22	26.38	<0.01	0.05	0.01	0.75	3.43	0.12
LOW-01-23	26.1	<0.01	0.07	0.01	0.82	3.19	<0.01
OZ-P	0.56	<0.01	0.03	0.01	0.6	0.12	<0.01

1989	907	909	901	8910	904	910	2540
MnO	Na2O	P2O5	SiO2	SrO	TiO2	LOI	TOTAL
% XRF	% XRF	% XRF	% XRF	% XRF	% XRF	%	%
0.19	0.85	<0.01	65.88	<0.01	0.03	0.41	98.1
0.21	2.08	0.03	66.54	0.02	0.01	0.57	99.65
0.01	<0.01	<0.01	97.73	<0.01	0.02	0.08	99.16

Lecours Exploration Inc
Box 1001
Hearst, ON
P0L 1N0

Geoscience Assesment office
933 Ramsey Lake Rd, 6th floor
Sudbury, ON
P3E 6B5

Aug 18, 2002

To whom it may concern;

Here attached is the required revision for our assessment work submission number
2.23480, transaction number w0260.00760. The assay results are included and the dates
worked in the field are as follows.

Stripping – Sept 27 –28 2001
- Oct 01 – 02 2001

Sampling Oct 11, 2001

Sincerely;



Gerald Lecours

GL/cl

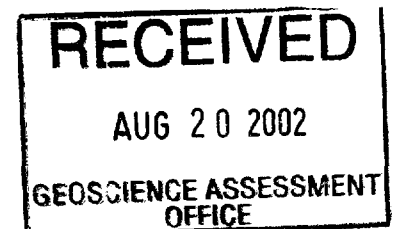



ALS Chemex

Aurora Laboratory Services Ltd.
 Analytical Chemists * Geochemists * Registered Assayers
 5175 Timberlea Blvd., Mississauga
 Ontario, Canada L4W 2S3
 PHONE: 905-624-2806 FAX: 905-624-6163

LECOURS, RITA

P.O. BOX 1001
 HEARST, ON
 POL 1N0

Page Number : 1
 Total Pages : 1
 Certificate Date: 19-OCT-2001
 Invoice No. : 10126267
 P.O. Number :
 Account : MYJ

Project :
 Comments: ATTN: RITA LECOURS CC: GERALD LECOURS

CERTIFICATE OF ANALYSIS A0126267

SAMPLE	PREP CODE	Ag ppm (ICP)	Al % (ICP)	As ppm	Ba ppm (ICP)	Be ppm (ICP)	Bi ppm (ICP)	Ca % (ICP)	Cd ppm (ICP)	Ce ppm (ICP)	Co ppm (ICP)	Cr ppm (ICP)	Cs ppm (ICP)	Cu ppm (ICP)	Fe % (ICP)	Ga ppm (ICP)	Ge ppm (ICP)	Hf ppm	In ppm	K % (ICP)
LOW-01-1	208 226	1.14	7.97	1.6	5.0	8.30	0.33	0.54	0.12	4.05	8.2	110	47.1	8.6	0.54	32.30	0.05	9.4	0.010	0.35
LOW-01-2	208 226	1.34	7.41	1.0	3.0	20.8	1.70	0.16	0.08	3.37	7.2	87	12.20	20.6	0.31	45.00	0.05	1.3	0.040	0.35
LOW-01-3	208 226	1.06	7.83	1.0	8.5	3.00	11.30	0.06	0.80	0.54	8.7	99	>500	22.8	0.49	70.70	0.20	0.6	< 0.005	4.15
LOW-01-4	208 226	1.72	7.70	0.8	2.5	8.35	0.19	0.25	0.14	3.76	2.5	100	18.90	5.4	0.60	46.75	0.10	0.6	0.185	0.75
LOW-01-9	208 226	0.54	7.41	0.6	104.0	4.10	0.32	0.76	0.06	18.15	3.5	135	13.20	9.0	2.83	29.45	0.05	0.4	0.025	2.34
LOW-01-11	208 226	1.72	9.88	0.8	6.0	5.80	0.92	0.16	0.28	1.06	4.7	46	>500	4.0	0.55	103.85	0.10	0.4	0.010	5.01
LOW-01-17	208 226	1.04	5.55	0.6	1.5	6.05	0.25	0.19	0.12	1.78	0.9	142	29.8	3.6	0.43	25.25	0.05	1.4	0.055	0.35
LOW-01-18	208 226	2.32	8.83	1.0	42.0	6.95	0.27	0.28	0.12	62.1	8.7	68	42.1	4.8	0.60	50.90	0.15	0.6	0.085	0.60

CERTIFICATION: _____



ALS Chemex

Aurora Laboratory Services Ltd.
 Analytical Chemists * Geochemists * Registered Assayers
 5175 Timberlea Blvd., Mississauga
 Ontario, Canada L4W 2S3
 PHONE: 905-624-2806 FAX: 905-624-6163

LECOURS, RITA

P.O. BOX 1001
 HEARST, ON
 P0L 1N0

Page Number : 8
 Total Pages :
 Certificate Date: 19-OCT-2001
 Invoice No. : 10126267
 P.O. Number :
 Account : MYJ

Project :
 Comments: ATTN: RITA LECOURS CC: GERALD LECOURS

CERTIFICATE OF ANALYSIS A0126267

SAMPLE	PREP		La ppm	Li ppm	Mg %	Mn ppm	Mo ppm	Na %	Nb ppm	Ni ppm	P ppm	Pb ppm	Rb ppm	Re	S	Sb ppm	Se	Sn ppm	Sr ppm	Ta ppm	Ta ppm
	CODE		(ICP)	(ICP)	(ICP)	(ICP)	(ICP)	(ICP)	(ICP)	(ICP)	(ICP)	(ICP)	(ICP)	ppm	%	(ICP)	ppm	ppm	(ICP)	(ICP)	(ICP)
LOW-01-1	208	226	2.0	144.0	0.03	325	1.00	6.83	36.3	3.4	60	10.0	123.5	0.004	< 0.01	0.20	< 1	3.2	29.0	4.45	0.35
LOW-01-2	208	226	1.5	77.2	0.02	300	1.10	6.47	46.9	3.0	70	4.5	92.3	0.002	< 0.01	0.25	< 1	11.8	10.6	18.15	0.20
LOW-01-3	208	226	< 0.5	>500	0.01	4860	1.35	1.73	32.7	3.4	< 10	8.5	>500	< 0.002	< 0.01	0.25	< 1	30.4	16.8	15.95	0.10
LOW-01-4	208	226	1.5	464	0.04	1215	0.90	5.31	66.4	2.8	< 10	4.5	297	< 0.002	< 0.01	0.15	< 1	38.4	12.0	11.45	0.05
LOW-01-9	208	226	9.0	65.6	0.13	275	0.70	4.10	12.1	4.0	370	10.0	135.0	< 0.002	0.04	0.10	< 1	3.6	329	2.80	0.05
LOW-01-11	208	226	< 0.5	>500	0.01	2960	0.55	3.75	67.5	1.6	10	10.0	>500	< 0.002	< 0.01	0.15	< 1	22.6	35.0	36.1	0.05
LOW-01-17	208	226	0.5	174.5	0.01	725	0.90	4.03	38.4	3.8	< 10	4.5	133.5	< 0.002	< 0.01	0.05	< 1	11.2	4.8	6.25	< 0.05
LOW-01-18	208	226	19.0	171.0	0.04	1770	0.55	6.59	94.1	2.4	120	37.5	301	< 0.002	< 0.01	0.15	< 1	23.2	21.8	19.45	0.05

CERTIFICATION: _____



ALS Chemex

Aurora Laboratory Services Ltd.
 Analytical Chemists * Geochemists * Registered Assayers
 5175 Timberlea Blvd., Mississauga
 Ontario, Canada L4W 2S3
 PHONE: 905-624-2806 FAX: 905-624-6163

To: LECOIRS, RITA

P.O. BOX 1001
 HEARST, ON
 POL 1N0

Page Number : 1-C
 Total Pages : 1
 Certificate Date: 19-OCT-2001
 Invoice No. : 10126267
 P.O. Number :
 Account : MYJ

Project :

Comments: ATTN: RITA LECOIRS CC: GERALD LECOIRS

CERTIFICATE OF ANALYSIS	A0126267
-------------------------	----------

SAMPLE	PREP CODE	Th ppm (ICP)	Ti % (ICP)	Tl ppm (ICP)	U ppm (ICP)	V ppm (ICP)	W ppm (ICP)	Y ppm (ICP)	Zn ppm (ICP)	Zr ppm
LOW-01-1	208 226	33.2	0.01	0.98	5.8	3	2.3	3.7	58	48.5
LOW-01-2	208 226	21.6	0.01	0.56	3.9	1	1.3	2.1	36	8.5
LOW-01-3	208 226	12.8	0.01	17.50	0.7	10	1.0	1.7	124	4.0
LOW-01-4	208 226	8.2	0.02	1.20	2.7	1	0.8	5.8	44	6.5
LOW-01-9	208 226	11.2	0.05	0.98	2.8	11	0.1	4.4	68	7.0
LOW-01-11	208 226	3.8	0.02	17.20	1.1	10	0.8	2.0	106	3.5
LOW-01-17	208 226	3.8	< 0.01	0.84	1.3	1	< 0.1	6.3	24	20.5
LOW-01-18	208 226	220	0.01	1.34	16.9	1	1.1	17.2	80	8.5

CERTIFICATION: _____



ALS Chemex

Aurora Laboratory Services Ltd.
 Analytical Chemists * Geochemists * Registered Assayers
 5175 Timberlea Blvd., Mississauga
 Ontario, Canada L4W 2S3
 PHONE: 905-624-2806 FAX: 905-624-6163

TO: LECOURS, RITA

P.O. BOX 1001
 HEARST, ON
 POL 1N0

Page Number :
 Total Pages :
 Certificate Date: 16-OCT-2001
 Invoice No. : 10126268
 P.O. Number :
 Account : MYJ

Project :
 Comments: ATTN: RITA LECOURS CC: GERALD LECOURS

CERTIFICATE OF ANALYSIS	A0126268
--------------------------------	-----------------

SAMPLE	PREP CODE	Al2O3	BaO	CaO	Cr2O3	Fe2O3	K2O	MgO	MnO	Na2O	P2O5	SiO2	SrO	TiO2	LOI	TOTAL
		% XRF	% XRF	% XRF	% XRF	% XRF	% XRF	% XRF	% XRF	% XRF	% XRF	% XRF	% XRF	% XRF	% XRF	% XRF
LOW-01-1	299 --	17.30	< 0.01	0.81	< 0.01	0.94	0.42	< 0.01	0.05	8.34	0.03	70.69	< 0.01	0.03	0.53	99.14
LOW-01-2	299 --	16.71	< 0.01	0.25	< 0.01	0.59	0.43	< 0.01	0.05	8.98	0.04	70.89	< 0.01	0.04	0.39	98.37
LOW-01-3	299 --	17.46	< 0.01	0.08	< 0.01	0.72	3.80	< 0.01	0.59	1.64	0.01	74.17	< 0.01	0.04	0.60	99.11
LOW-01-4	299 --	15.20	< 0.01	0.36	< 0.01	0.89	0.82	< 0.01	0.18	6.79	0.01	74.22	< 0.01	0.05	0.53	99.05
LOW-01-9	299 --	14.06	< 0.01	1.06	< 0.01	4.20	2.46	0.16	0.04	5.01	0.11	71.23	0.04	0.11	0.32	98.80
LOW-01-11	299 --	21.76	< 0.01	0.25	< 0.01	0.87	5.85	< 0.01	0.43	4.98	0.03	63.87	< 0.01	0.06	1.15	99.25
LOW-01-17	299 --	10.71	< 0.01	0.26	< 0.01	0.61	0.37	< 0.01	0.11	4.15	0.03	82.39	< 0.01	0.04	0.35	99.02
LOW-01-18	299 --	17.89	< 0.01	0.42	< 0.01	0.92	0.74	< 0.01	0.27	8.81	0.07	69.33	< 0.01	0.04	0.64	99.13

CERTIFICATION: _____



ALS Chemex

Aurora Laboratory Services Ltd.
 Analytical Chemists * Geochemists * Registered Assayers
 5175 Timberlea Blvd., Mississauga
 Ontario, Canada L4W 2S3
 PHONE: 905-624-2806 FAX: 905-624-6163

TO: LECOURE, RITA

P.O. BOX 1001
 HEARST, ON
 P0L 1N0

Page Number : 1
 Total Pages : 1
 Certificate Date: 31-OCT-2001
 Invoice No. : 10127231
 P.O. Number :
 Account : MYJ

Project :
 Comments: ATTN: RITA LECOURE CC: GERALD LECOURE

CERTIFICATE OF ANALYSIS

A0127231

SAMPLE	PREP CODE	Li %	Cs ppm	Rb ppm							
LOW-01-3	244 297	0.57	599	2390							
LOW-01-11	244 297	0.11	520	2450							

CERTIFICATION: _____



ALS Chemex

Aurora Laboratory Services Ltd.
 Analytical Chemists * Geochemists * Registered Assayers
 5175 Timberlea Blvd., Mississauga
 Ontario, Canada L4W 2S3
 PHONE: 905-624-2806 FAX: 905-624-6163

To: LECOURS, RITA
 P.O. BOX 1001
 HEARST, ON
 POL 1N0

Page Number : 1
 Total Pages : 1
 Certificate Date: 16-JAN-2002
 Invoice No. : 10130713
 P.O. Number :
 Account : MYJ

Project :
 Comments: ATTN: RITA LECOURS CC: GERALD LECOURS

CERTIFICATE OF ANALYSIS	A0130713
--------------------------------	-----------------

SAMPLE	PREP CODE		Al2O3	BaO	CaO	Cr2O3	Fe2O3	K2O	MgO	MnO	Na2O	P2O5	SiO2	SrO	TiO2	LOI	TOTAL
			% XRF	% XRF	% XRF	% XRF	% XRF	% XRF	% XRF	% XRF	% XRF	% XRF	% XRF	% XRF	% XRF	% XRF	% XRF
LOW-01-22	299	--	26.38	< 0.01	0.05	0.01	0.75	3.43	0.12	0.19	0.85	< 0.01	65.88	< 0.01	0.03	0.41	98.10
LOW-01-23	299	--	26.10	< 0.01	0.07	0.01	0.82	3.19	< 0.01	0.21	2.08	0.03	66.54	0.02	0.01	0.57	99.65
QZ-P	299	--	0.56	< 0.01	0.03	0.01	0.60	0.12	< 0.01	0.01	< 0.01	< 0.01	97.73	< 0.01	0.02	0.08	99.16

CERTIFICATION: _____



ALS Chemex

Aurora Laboratory Services Ltd.
 Analytical Chemists * Geochemists * Registered Assayers
 5175 Timberlea Blvd., Mississauga
 Ontario, Canada L4W 2S3
 PHONE: 905-624-2806 FAX: 905-624-6163

To: LECOURS, RITA

P.O. BOX 1001
 HEARST, ON
 POL 1N0

Project :

Comments: ATTN: RITA LECOURS CC: GERALD LECOURS

Page Number : 1-B
 Total Pages : 1
 Certificate Date: 09-JAN-2002
 Invoice No. : I0130710
 P.O. Number :
 Account : MYJ

CERTIFICATE OF ANALYSIS

A0130710

SAMPLE	PREP		La ppm	Li ppm	Mg %	Mn ppm	Mo ppm	Na %	Nb ppm	Ni ppm	P ppm	Pb ppm	Rb ppm	Re	S Sb ppm	Se	Sn Sr ppm	Ta ppm	Te ppm		
	CODE		(ICP)	(ICP)	(ICP)	(ICP)	(ICP)	(ICP)	(ICP)	(ICP)	(ICP)	(ICP)	(ICP)	ppm	% (ICP)	ppm	ppm (ICP)	(ICP)	(ICP)		
LOW-01-22	208	226	< 0.5	>500	< 0.01	985	2.25	0.55	4.7	6.8	30	6.0	>500	< 0.002	< 0.01	0.25	< 1	24.8	41.4	6.95	0.05
LOW-01-23	208	226	< 0.5	>500	0.01	1040	1.60	1.20	12.7	6.6	20	6.5	>500	0.002	< 0.01	0.35	< 1	23.0	107.5	8.90	< 0.05
QZ-P	208	226	< 0.5	168.5	0.01	50	3.15	0.05	0.6	10.0	< 10	0.5	8.4	< 0.002	0.01	0.15	< 1	0.2	4.8	0.15	< 0.05

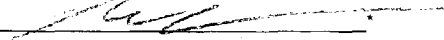
CERTIFICATION: 



ALS Chemex

Aurora Laboratory Services Ltd.
 Analytical Chemists * Geochemists * Registered Assayers
 5175 Timberlea Blvd., Mississauga
 Ontario, Canada L4W 2S3
 PHONE: 905-624-2806 FAX: 905-624-6163

To: LECOURS, RITA

P.O. BOX 1001
 HEARST, ON
 P0L 1N0

Page Number : 1-C
 Total Pages : 1
 Certificate Date: 09-JAN-2002
 Invoice No. : I0130710
 P.O. Number :
 Account : MYJ

Project :

Comments: ATTN: RITA LECOURS CC: GERALD LECOURS

CERTIFICATE OF ANALYSIS

A0130710

SAMPLE	PREP		Th ppm	Ti %	Tl ppm	U ppm	V ppm	W ppm	Y ppm	Zn ppm	Zr
	CODE		(ICP)	(ICP)	(ICP)	(ICP)	(ICP)	(ICP)	(ICP)	(ICP)	ppm
LOW-01-22	208	226	0.2	< 0.01	6.92	0.6	10	0.7	0.1	16	2.5
LOW-01-23	208	226	< 0.2	< 0.01	5.14	0.6	8	0.6	0.9	14	2.5
QZ-P	208	226	< 0.2	< 0.01	0.08	< 0.1	7	0.4	0.1	8	2.0

CERTIFICATION: _____



ALS Chemex

Aurora Laboratory Services Ltd.
 Analytical Chemists * Geochemists * Registered Assayers
 5175 Timberlea Blvd., Mississauga
 Ontario, Canada L4W 2S3
 PHONE: 905-624-2806 FAX: 905-624-6163

To: LECOURS, RITA

P.O. BOX 1001
 HEARST, ON
 POL 1N0

Page Number : 1
 Total Pages : 1
 Certificate Date: 25-JAN-2002
 Invoice No. : 10210361
 P.O. Number :
 Account : MYJ

Project :

Comments: ATTN: RITA LECOURS CC: GERALD LECOURS

CERTIFICATE OF ANALYSIS

A0210361

SAMPLE	PREP CODE	Rb ppm	Li %									
LOW-01-22	244 --	972	2.39									
LOW-01-23	244 --	774	2.14									

CERTIFICATION:



ALS Chemex

Aurora Laboratory Services Ltd.
 Analytical Chemists * Geochemists * Registered Assayers
 5175 Timberlea Blvd., Mississauga
 Ontario, Canada L4W 2S3
 PHONE: 905-624-2806 FAX: 905-624-6163

To: LECOURS, RITA

P.O. BOX 1001
 HEARST, ON
 P0L 1N0

Page Number : 1-A
 Total Pages : 1
 Certificate Date: 09-JAN-2002
 Invoice No. : 10130710
 P.O. Number :
 Account : MYJ

Project :

Comments: ATTN: RITA LECOURS CC: GERALD LECOURS

CERTIFICATE OF ANALYSIS	A0130710
-------------------------	----------

SAMPLE	PREP CODE	Ag ppm (ICP)	Al % (ICP)	As ppm (ICP)	Ba ppm (ICP)	Be ppm (ICP)	Bi ppm (ICP)	Ca % (ICP)	Cd ppm (ICP)	Ce ppm (ICP)	Co ppm (ICP)	Cr ppm (ICP)	Cs ppm (ICP)	Cu ppm (ICP)	Fe % (ICP)	Ga ppm (ICP)	Ge ppm (ICP)	Hf ppm	In ppm	K % (ICP)
LOW-01-22	208 226	0.40	9.50	0.2	19.5	11.80	0.19	0.03	0.08	0.14	6.1	158	358	13.4	0.37	94.10	0.20	0.3	< 0.005	1.92
LOW-01-23	208 226	0.58	9.53	0.6	49.5	15.55	9.73	0.04	0.10	0.13	2.5	130	224	12.4	0.40	87.85	0.15	0.3	< 0.005	1.92
QZ-P	208 226	0.16	0.21	0.2	10.5	0.95	0.19	0.03	< 0.02	0.93	0.9	337	22.5	13.4	0.37	1.15	0.15	< 0.1	< 0.005	0.06

CERTIFICATION: _____



ALS Chemex

Aurora Laboratory Services Ltd.
 Analytical Chemists * Geochemists * Registered Assayers
 5175 Timberlea Blvd., Mississauga
 Ontario, Canada L4W 2S3
 PHONE: 905-624-2806 FAX: 905-624-6163

To: LECOURE, RITA

P.O. BOX 1001
 HEARST, ON
 P0L 1N0

Page Number : 1
 Total Pages : 1
 Certificate Date: 01-NOV-2001
 Invoice No. : I0127233
 P.O. Number :
 Account : MYJ

Project :

Comments: ATTN: RITA LECOURE CC: GERALD LECOURE

CERTIFICATE OF ANALYSIS

A0127233

SAMPLE	PREP CODE	Al2O3	BaO	CaO	Cr2O3	Fe2O3	K2O	MgO	MnO	Na2O	P2O5	SiO2	SrO	TiO2	LOI	TOTAL
		% XRF	% XRF	% XRF	% XRF	% XRF	% XRF	% XRF	% XRF	% XRF	% XRF	% XRF	% XRF	% XRF	% XRF	% XRF
LOW-01-5	299 --	15.86 < 0.01	0.67 < 0.01	0.44	0.42 < 0.01	0.16	8.29	0.01	72.60 < 0.01	0.01	0.29	98.75				
LOW-01-6	299 --	8.85 < 0.01	0.46 < 0.01	0.44	0.26 < 0.01	0.01	4.19	0.04	83.83 < 0.01	0.01	0.30	98.39				
LOW-01-7	299 --	13.32 < 0.01	0.64 < 0.01	0.46	0.27 < 0.01	0.01	4.25	0.03	79.63 < 0.01	0.01	0.37	98.99				
LOW-01-8	299 --	10.90 < 0.01	0.66 < 0.01	0.37	0.26 < 0.01	0.01	5.08	0.04	81.34 < 0.01	0.01	0.26	98.93				
LOW-01-10	299 --	21.08 < 0.01	0.14 < 0.01	1.00	6.62 < 0.01	0.14	5.85	0.03	62.63 < 0.01	0.06	0.88	98.43				
LOW-01-12	299 --	22.23 < 0.01	0.11 < 0.01	0.48	7.26 < 0.01	0.96	4.58	0.02	61.57 < 0.01	0.04	0.95	98.20				
LOW-01-13	299 --	24.73 < 0.01	0.11 < 0.01	0.32	5.40 < 0.01	0.63	3.87	0.03	63.00 < 0.01	0.04	0.96	99.09				
LOW-01-14	299 --	21.85 < 0.01	0.19 < 0.01	0.38	4.13 < 0.01	1.88	6.17	0.01	63.43 < 0.01	0.03	0.78	98.85				
LOW-01-15	299 --	18.47 < 0.01	0.79 < 0.01	0.63	0.46 < 0.01	0.14	7.83	0.03	70.27 < 0.01	0.03	0.39	99.04				
LOW-01-16	299 --	21.29 < 0.01	0.18 < 0.01	0.39	7.35 < 0.01	1.55	5.10	0.01	61.81	0.01	0.04	0.83	98.56			

CERTIFICATION: _____



ALS Chemex

Aurora Laboratory Services Ltd.
 Analytical Chemists * Geochemists * Registered Assayers
 5175 Timberlea Blvd., Mississauga
 Ontario, Canada L4W 2S3
 PHONE: 905-624-2806 FAX: 905-624-6163

To: LECOURS, RITA

P.O. BOX 1001
 HEARST, ON
 P0L 1N0

Page Number : 1-A
 Total Pages : 1
 Certificate Date: 05-NOV-2001
 Invoice No. : I0127232
 P.O. Number :
 Account : MYJ

Project :
 Comments: ATTN: RITA LECOURS CC: GERALD LECOURS

** CORRECTED COPY

CERTIFICATE OF ANALYSIS A0127232

SAMPLE	PREP CODE	Ag ppm (ICP)	Al % (ICP)	As ppm (ICP)	Ba ppm (ICP)	Be ppm (ICP)	Bi ppm (ICP)	Ca % (ICP)	Cd ppm (ICP)	Ce ppm (ICP)	Co ppm (ICP)	Cr ppm (ICP)	Cs ppm (ICP)	Cu ppm (ICP)	Fe % (ICP)	Ga ppm (ICP)	Ge ppm (ICP)	Hf ppm	In ppm	K % (ICP)
LOW-01-5	208 226	0.50	7.50	0.6	21.0	8.50	0.13	0.46	0.18	1.93	3.5	50	8.30	< 0.2	0.30	33.15	0.05	1.4	0.005	0.37
LOW-01-6	208 226	0.30	4.37	0.2	12.5	6.45	0.19	0.34	0.04	23.7	7.1	85	3.55	< 0.2	0.30	15.40	0.05	0.6	0.005	0.21
LOW-01-7	208 226	0.36	5.61	0.4	12.5	8.70	0.15	0.47	0.06	19.25	8.0	68	5.45	< 0.2	0.31	20.40	0.05	1.3	0.005	0.27
LOW-01-8	208 226	0.16	5.46	0.8	6.5	6.45	0.23	0.49	0.02	19.05	8.2	72	4.90	< 0.2	0.28	17.20	0.05	1.5	0.005	0.22
LOW-01-10	208 226	0.74	7.85	0.2	31.5	7.50	0.10	0.08	< 0.02	0.53	4.4	20	>500	< 0.2	0.48	92.20	0.15	4.8	0.020	5.11
LOW-01-12	208 226	0.60	9.16	0.2	6.5	4.90	0.07	0.08	< 0.02	< 0.01	6.6	38	>500	< 0.2	0.27	106.15	0.15	1.0	0.005	5.91
LOW-01-13	208 226	0.38	9.17	0.2	41.0	5.35	2.01	0.08	0.02	< 0.01	9.5	28	467	< 0.2	0.20	103.70	0.15	0.4	0.005	5.61
LOW-01-14	208 226	0.50	8.70	< 2.0	10.0	16.50	3.60	0.12	0.60	< 0.10	8.0	44	208	< 2.0	0.24	89.00	< 0.50	< 1.0	0.050	3.60
LOW-01-15	208 226	0.20	7.39	0.2	12.5	8.65	2.42	0.53	0.28	2.65	1.6	36	47.2	0.8	0.36	38.25	0.05	1.2	0.005	0.40
LOW-01-16	208 226	< 0.50	8.65	< 2.0	10.0	3.50	0.50	0.12	1.20	< 0.10	5.0	38	354	< 2.0	0.24	77.50	< 0.50	< 1.0	0.050	5.78

CERTIFICATION: _____

** FOR MS ON ALL SAMPLES.



ALS Chemex

Aurora Laboratory Services Ltd.
 Analytical Chemists * Geochemists * Registered Assayers
 5175 Timberlea Blvd., Mississauga
 Ontario, Canada L4W 2S3
 PHONE: 905-624-2806 FAX: 905-624-6163

To: LECOURE, RITA

P.O. BOX 1001
 HEARST, ON
 P0L 1N0

Page Number : 1-B
 Total Pages : 1
 Certificate Date: 05-NOV-2001
 Invoice No. : I0127232
 P.O. Number :
 Account : MYJ

Project :

Comments: ATTN: RITA LECOURE CC: GERALD LECOURE

** CORRECTED COPY

CERTIFICATE OF ANALYSIS A0127232

SAMPLE	PREP CODE	La ppm (ICP)	Li ppm (ICP)	Mg % (ICP)	Mn ppm (ICP)	Mo ppm (ICP)	Na % (ICP)	Nb ppm (ICP)	Ni ppm (ICP)	P ppm (ICP)	Pb ppm (ICP)	Rb ppm (ICP)	Re ppm	S % (ICP)	Sb ppm (ICP)	Se ppm	Sn ppm (ICP)	Sr ppm (ICP)	Ta ppm (ICP)	Tc ppm (ICP)
LOW-01-5	208 226	1.0	103.0	0.03	1130	0.85	6.89	23.2	5.0	60	8.5	39.2	< 0.002	< 0.01	0.15	< 1	4.8	27.2	7.00	< 0.05
LOW-01-6	208 226	10.0	34.2	0.03	115	0.85	3.41	5.1	3.8	80	7.0	23.9	< 0.002	< 0.01	0.35	< 1	2.0	48.6	1.80	< 0.05
LOW-01-7	208 226	7.5	31.2	0.03	85	0.90	4.67	6.8	3.8	140	10.5	28.6	< 0.002	< 0.01	0.20	< 1	1.8	66.6	2.65	< 0.05
LOW-01-8	208 226	9.0	39.0	0.01	50	0.80	4.18	3.3	3.6	80	8.5	24.2	< 0.002	< 0.01	0.20	< 1	1.2	63.8	1.20	< 0.05
LOW-01-10	208 226	< 0.5	266	0.01	900	0.35	4.35	78.4	1.8	40	19.5	>500	< 0.002	< 0.01	1.25	< 1	25.2	39.8	35.0	< 0.05
LOW-01-12	208 226	< 0.5	>500	< 0.01	6860	0.50	3.49	66.9	2.2	40	15.0	>500	< 0.002	< 0.01	0.05	< 1	26.8	22.2	43.3	< 0.05
LOW-01-13	208 226	< 0.5	>500	< 0.01	5110	0.45	3.86	42.2	4.4	30	14.5	>500	< 0.002	< 0.01	0.05	< 1	23.0	32.2	31.7	< 0.05
LOW-01-14	208 226	< 5.0	>500	0.01	>10000	0.50	5.01	18.0	2.0	40	5.0	>500	< 0.020	< 0.01	< 0.50	< 10	22.0	30.0	13.50	< 0.50
LOW-01-15	208 226	1.0	77.8	0.01	945	0.75	6.91	23.5	3.4	80	11.0	119.5	< 0.002	0.08	0.65	< 1	5.6	48.0	4.65	< 0.05
LOW-01-16	208 226	< 5.0	62.0	0.01	>10000	0.50	3.95	68.0	2.0	30	15.0	>500	< 0.020	< 0.01	< 0.50	3	18.0	62.0	42.5	< 0.50

CERTIFICATION: 

** FOR I MS ON ALL SAMPLES.



ALS Chemex

Aurora Laboratory Services Ltd.
 Analytical Chemists * Geochemists * Registered Assayers
 5175 Timberlea Blvd., Mississauga
 Ontario, Canada L4W 2S3
 PHONE: 905-624-2806 FAX: 905-624-6163

To: LECOURS, RITA

P.O. BOX 1001
 HEARST, ON
 P0L 1N0

Page Number : 1-C
 Total Pages : 1
 Certificate Date: 05-NOV-2001
 Invoice No. : 10127232
 P.O. Number :
 Account : MYJ

Project :

Comments: ATTN: RITA LECOURS CC: GERALD LECOURS

** CORRECTED COPY

CERTIFICATE OF ANALYSIS A0127232

SAMPLE	PREP CODE	Th ppm (ICP)	Ti % (ICP)	Tl ppm (ICP)	U ppm (ICP)	V ppm (ICP)	W ppm (ICP)	Y ppm (ICP)	Zn ppm (ICP)	Zr ppm
LOW-01-5	208 226	3.2	< 0.01	0.30	3.8	1	4.2	5.3	20	13.5
LOW-01-6	208 226	11.0	< 0.01	0.16	6.3	< 1	0.9	10.6	12	11.0
LOW-01-7	208 226	13.2	< 0.01	0.20	7.4	1	0.9	7.3	12	24.5
LOW-01-8	208 226	15.2	< 0.01	0.16	4.6	< 1	1.0	9.2	10	21.5
LOW-01-10	208 226	22.4	0.01	16.95	4.8	6	1.3	2.9	74	26.0
LOW-01-12	208 226	7.8	0.01	22.0	1.8	6	0.9	1.1	72	4.0
LOW-01-13	208 226	8.2	0.01	19.55	2.3	5	1.0	1.2	72	2.0
LOW-01-14	208 226	< 2.0	0.01	10.80	< 1.0	5	1.0	11.0	52	< 5.0
LOW-01-15	208 226	4.6	< 0.01	0.98	6.9	1	0.4	9.2	80	19.0
LOW-01-16	208 226	< 2.0	0.01	16.40	2.0	5	< 1.0	29.0	50	< 5.0

CERTIFICATION: _____

** FOR MS ON ALL SAMPLES.



ALS Chemex

Aurora Laboratory Services Ltd.
Analytical Chemists * Geochemists * Registered Assayers
5175 Timberlea Blvd., Mississauga
Ontario, Canada L4W 2S3
PHONE: 905-624-2806 FAX: 905-624-6163

To: LECOURS, RITA

P.O. BOX 1001
HEARST, ON
POL 1N0

Page Number : 1
Total Pages : 1
Certificate Date: 26-NOV-2001
Invoice No. : 10129050
P.O. Number :
Account : MYJ

Project :
Comments: ATTN: RITA LECOURS CC: GERALD LECOURS

CERTIFICATE OF ANALYSIS A0129050

SAMPLE	PREP CODE	MnO %	Li %	Cs ppm	Rb ppm													
LOW-01-10	212 297	-----	-----	551	2050													
LOW-01-12	212 297	-----	0.33	454	2220													
LOW-01-13	212 297	-----	0.22	-----	2260													
LOW-01-14	212 297	1.87	0.33	-----	1310													
LOW-01-16	212 297	1.57	-----	-----	1980													

CERTIFICATION: _____

Date: 2002-AUG-28

GEOSCIENCE ASSESSMENT OFFICE
933 RAMSEY LAKE ROAD, 6th FLOOR
SUDBURY, ONTARIO
P3E 6B5

LECOURS EXPLORATIONS INC.
1301 PRINCE STREET
HEARST, ONTARIO
P0L 1N0 CANADA

Tel: (888) 415-9845
Fax: (877) 670-1555

Submission Number: 2.23480
Transaction Number(s): W0260.00760

Dear Sir or Madam

Subject: Approval of Assessment Work

We have approved your Assessment Work Submission with the above noted Transaction Number(s). The attached Work Report Summary indicates the results of the approval.

At the discretion of the Ministry, the assessment work performed on the mining lands noted in this work report may be subject to inspection and/or investigation at any time.

The revisions required for this submission have been corrected. Accordingly, assessment work credit has been approved as outlined on the Declaration of Assessment Work Form that accompanied this submission.

If you have any question regarding this correspondence, please contact LUCILLE JEROME by email at lucille.jerome@ndm.gov.on.ca or by phone at (705) 670-5858.

Yours Sincerely,



Sheila Lessard
Acting Senior Manager, Mining Lands Section

Cc: Resident Geologist

Lecours Explorations Inc.
(Claim Holder)

Assessment File Library

Lecours Explorations Inc.
(Assessment Office)

