



42G05SW0318 13 SCHOLFIELD

010

Diamond Drilling

Township of SCHOLFIELD

Report NO: 13

Work performed by: Northern Canada Mines Limited

Claim NO	Hole NO	Footage	Date	Note
SSM 46448	1-1	451.0'	Apr/56	
SSM 46451	1-2	253.0'	Apr/56	
SSM 46452	1-3	281.0'	May/56	
SSM 46451	1-4	345.0'	July/56	
SSM 46455	1-6	409.0'	July/56	
	<u>5</u>	<u>1739</u>		

Notes:

DIAMOND DRILL RECORD

PROPERTY ..... BLOCK # 1 ..... HOLE NO. .... 1-1 .....  
 STARTED .. APRIL 11 1956 ..... COMPLETED ... APRIL 25 1956 .....  
 LATITUDE ... 12 - 00 N ... DATUM ... LAND LEVEL ... ULTIMATE DEPTH 451' ...  
 DEPARTURE ... 11 - 00 W ... BEARING ... 270° ... DIP ... 45° ...

0 - 16.0		Overburden and casing.	
16.0 - 16.6	Qtz.	Bull quartz zone.	Barren.
16.6 - 41.2	Gneiss	Qtz. biotite actin schistose paragneiss - schistosity 60° to core.	Disseminated pyrite and pyrrhotite 1%.
41.2 - 41.6	Qtz.	Bull quartz zone.	Barren.
41.6 - 87.6	Gneiss	Qtz. biotite actin schistose paragneiss - schistosity 70° to core.	Dissem pyrite & pyrrhotite - 1%.
87.6 - 88.0	Qtz.	Bull quartz zone.	Barren.
88.0 - 102.6	Gneiss	Qtz biotite actin schistose paragneiss - schistosity 80° to core.	Dissem pyrite & pyrrhotite - 1%.
102.6 - 103.0	Qtz.	Bull quartz zone.	Dissem pyr. 0.5%.
103.0 - 121.2	Gneiss	Qtz. biotite actin schistose paragneiss - schistosity 85° to core.	Pyrite 5%.
121.2 - 123.5		Sulphide zone - quartz matrix.	Sample # 38 - 121.2 - 123.5.
123.5 - 125.7	Qtz.	Qtz. zone.	Dissem pyrite 1%.
125.7 - 135.7	Qtz.	Siliceous quartz schistose zone - schistosity 90° to core.	Sulphides vary 10-15% pyrrhotite & pyrite Sample # 39 - 134.2 - 135.0
135.7 - 139.0	Qtz.	White buff siliceous quartz - schistosity 90° to core.	Pyrr. & pyr. 1%.
139.0 - 246.0	Gneiss	Fine grained buff biotite quartz schistose paragneiss - increase grain size to 165' then lessen. schistosity 87° to core.	Barren.
246.0 - 254.2	Qtz.	Silicified quartz zone.	Barren.
254.2 - 377.0	Gneiss	Fine grained buff biotite schistose paragneiss. - schistosity 90° to core.	Barren sulphides. Chl - actin zone 269.0 - 271.0
377.0 - 391.5	Qtz.	V.F.O. qtzite sericite schist - some biotite.	Barren. 40% loss of core 375.0 - 400.0
391.5 - 451.0	Gneiss	F.G. buff biotite diabasic in texture schist. Schistosity 85° to core.	Barren

Note: Drill core stored in core shack in the southwest corner of clay  
 SSM 52683, lot 26, Com. 8, Scholfield Tap.  
 Reporting 51 feet of drilling not previously reported

Mar 25/57  
 ch  
 DJ



46451-2 Schilfield Twp. Drang #1

Block # 1

Diamond Drill Record

Baseline #2  
Location 12-00N 1-00E

Property - OBA - HANSEN

Hole No 1-2

Started April 24th, 1956

Finished May 1st, 1956

Depth 253'  
Proposed Depth 300'

Dip 45°

Dips: 20 ft. 42.5°  
140 ft. 44°  
210 ft. 50°

Azimuth at start 255°

From	To	Description	
0	12.0	Mud and gravel	
12.0	18.0	Gneiss	Qtz. biotite actinolite Schistose paragneiss 70° to core 1% dissem. Pyrr. and pyr.
18.0	18.5	Qtz.	Bull Qtz. barren
18.5	45.0	Gneiss	Qtz. biotite actinolite Schistose paragneiss 70° to core 1% pyrr. 2% pyr.
45.0	47.0	Qtz.	Bull Qtz. barren
47.0	75.6	Gneiss	Qtz. biotite actinolite Schistose Paragneiss 75° to core 5% pyrr. & pyr.
75.6	81.5	Gneiss	Qtzitic actinolitic Paragneiss - small Am't Biotite 5% pyr. 5% pyrr.
81.5	131.5	Gneiss	Qtz. Biotite Actinolite Schistose Paragneiss 75° to core 30% pyr. 10% pyrr. Sample No. 40 122.0-124.0
131.5	137.5	Qtz	Siliceous Qtz Schist-Sulph. Strings. 5% pyrr. in stringers
137.5	148.2	Qtz	White Buff Siliceous Qtz schist 2% pyrr. 1% pyr. Dissem.
148.2	249.0	Gneiss	F.G. Biotite-Sericite Qtz schistose paragneiss 1% dissem pyrr. & pyr.
249.0	249.5	Qtz	Bull Qtz. Zone barren
249.5	253.0	Gneiss	F.G. Biotite-sericite Qtz schistose paragneiss barren

\*\*\*\*\*

Logged by K. Parkinson  
Sampling by K. Parkinson  
Assaying by Bell-White

(Signed)

"K.A. Parkinson."

*K.A. Parkinson*

\*\*\*\*\*

Assay results

Sample No.	From	To	Width	As.	Ni.	Cu.
40	122.0	124.0	2 ft.	.005	nil	.03%

Property - OBA - Hansen

Diamond Drill Record

Location 20-00N 0-50E

Group #

Hole No. 1 - 3

Depth 281' Proposed Depth 300'

Started May 2nd, 1956

Finished - May 5th, 1956.

Dip - 45°

Azimuth at Start 255°

Azimuth at End 255°

Dips - 40 ft. 42°  
140 ft. 45°  
240 ft. 45°

From	To			
0	20.0		Sand and Gravel	
20.0	22.5	Gneiss	Qtz. Biotite Schist 70° to core	2% sulph. Pyr. & pyrr. in stringers
22.5	22.8	Qtz	Bull Qtz.	barren
22.8	24.0	Gneiss	Qtz. Biotite Schist 70 to core - cal along sulph stringers	3% sulph. dissem. & string. pyr. & pyrr. Sample 41
24.0	25.0	Qtz	Bull Qtz	dissem. pyr & pyrr
25.0	37.0	Gneiss	Qtz. Biotite Schist - 70° to core	1% fine dissem. pyr. & pyrr.
37.0	68.0	Gneiss	Qtzite Schist Ghost Remnants of a tuffaceous material - agglom. in effect	15% sulph. lens & dis Sample # 42 # 43 # 44 # 45
68.0	71.5	Qtz	Bull Qtz	1% dissem. pyr. Sample # 46.
71.5	84.5	Gneiss	Qtz Biotite Schistose Para Gneiss 80° to core.	4% sulph. dissem. & str pyr. & pyrr. Sample # 47
84.5	88.0	Qtz	Siliceous Qtz Zone	Rust material very fine ??
88.0	99.8	Gneiss	F.G. Qtz Biotite Schistose Paragneiss	2% sulph. dissem. & stringers pyr. & pyrr.
99.8	117.7	Gneiss	Qtzite Schist 85° to core	1% pyrr. in stringers
117.7	130.0	Gneiss	Siliceous Qtz Schist Biotite Chl. with Sulph	1% sulph. pyr. & pyrr. in veins & stringers Sample # 48.
130.0	135.0		Cave Lost Core	Leached & honeycombed
135.0	136.0	Gneiss	Granular Leached Qtz epidote ? Schist	
136.0	139.3		Cave leached & honeycombed	
139.3	140.2	Gneiss	Qtz. Graphite Schist Round Qtz & pyr Concretions - Banded 55° to core	Round pyr. Concretions replace Qtz.
140.2	141.2		Cave	
141.2	144.0	Gneiss	Qtz graphite schist Round Qtz & pyr. concretions	10% pyr.

144.0	160.0	Gneiss	Qtz siliceous chl schist	5% sulph - stringers pyr. & pyrr. (shattering) Sample # 49
160.0	171.0	Gneiss	Med. grained qtz. biotite paragneiss	2 1/2% dissem pyr (fine) Sample #50-51-52-53-54
171.0	187.0	Gneiss	Qtz graphite schist vein qtz - Pyr concretions	15% sulph. pyr. & pyrr. Sample #55-56
187.0	204.0	Schist	Sericite Schist - Vein Qtz - Mineral replaces sericite	15% sulph. Pyr. & Pyrr. Sample #57-58
204.0	281.0	Schist	Biotite Schist Diorite at 219.0 - 219.2 219.5 - 219.6 227.0 - 227.1 227.5 - 227.6 251.0 - 251.1 269.5 - 269.6 271.0 - 271.1 Schistosity 70° to Core - Qtz vein at 241.1 - 241.2	Pyrrt. stringers & Dissem. 1% to barren Sulphides

.....

Logged by K. Parkinson  
Sampling by K. Parkinson  
Assaying by Bell White

(Signed)

"K.A. Parkinson"

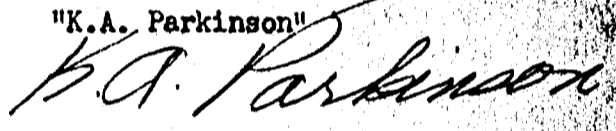

Assay results

Sample No.	From	To	Width	Values		
				Au.	Ni.	Cu.
41	20.0	24.0	4'	.005	nil	.03
42	42.2	45.0	2.8'	.005	nil	.03
43	45.0	49.0	4'	trace	nil	.03
44	60.0	61.5	1 1/2'	trace	nil	.05
45	64.0	67.5	3 1/2'	.005	nil	.05
46	68.0	71.5	3 1/2'	.005	nil	.01
47	77.8	82.0	4 1/6'	.005	nil	.03
48	120.6	124.0	3 1/2'	trace	nil	.03
49	146.2	149.5	3.3'	trace	nil	.04
50	150.0	153.2	3 1/2'	trace	nil	.03
51	153.2	156.6	3.4'	trace	nil	.05
52	156.6	160.0	3.4'	trace	nil	.03
53	170.0	172.5	2.5'	trace	nil	.03
54	172.5	175.0	2.5'	trace	nil	.05
55	175.0	180.0	5.0'	.005	nil	trace
56	180.0	185.0	5.0'	.005	nil	.03
57	185.0	190.0	5.0'	.005	nil	.05
58	190.0	194.2	4.2'	trace	nil	.03

.....





Brought #1 ✓  
 Brought #1 2 0

TILELOT

		45104 ✓	49103 ✓	49102 ✓
	46458 0	46461 0	46462 0	46467 ✓
	46457 0	46460 0	46463 0	46465 ✓
	46453 0	46456 ✓	46459 ✓	46462 ✓
	46449 0	46452 ✓	46455 ✓	
	46445 0	46451 ✓	46454 ✓	
	46447 0	46450 ✓		

SEMI-FIELD

Scale 1" = 200'  
 Location of  
 Holes #1 to #14  
 by horizontal reference  
 A.L. Peterson

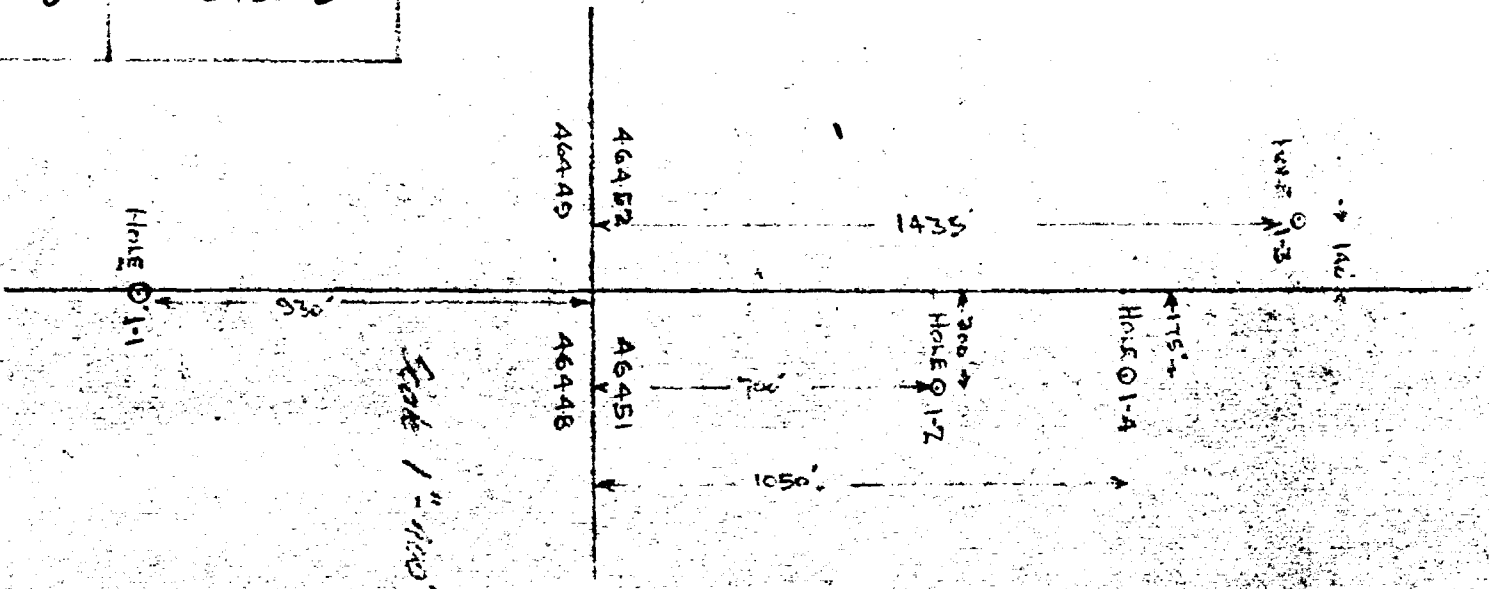

Scale 1" = 100'







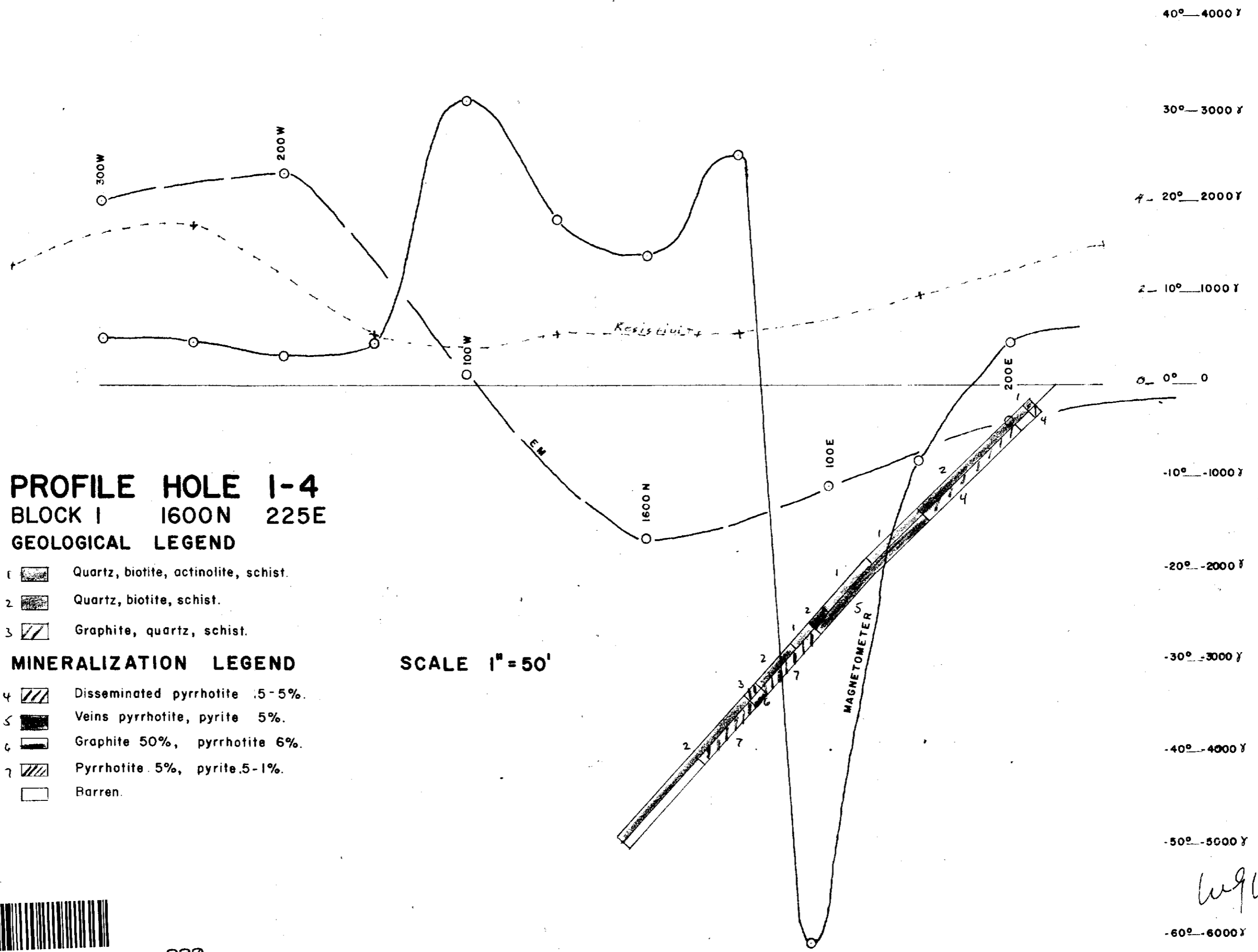

**PROFILE HOLE 1-4**  
**BLOCK I 1600N 225E**  
**GEOLOGICAL LEGEND**

- 1 [Pattern] Quartz, biotite, actinolite, schist.
- 2 [Pattern] Quartz, biotite, schist.
- 3 [Pattern] Graphite, quartz, schist.

**MINERALIZATION LEGEND**

- 4 [Pattern] Disseminated pyrrhotite 15-5%.
- 5 [Pattern] Veins pyrrhotite, pyrite 5%.
- 6 [Pattern] Graphite 50%, pyrrhotite 6%.
- 7 [Pattern] Pyrrhotite 5%, pyrite 5-1%.
- [White] Barren.

SCALE 1" = 50'

40°—4000 Y  
 30°—3000 Y  
 20°—2000 Y  
 10°—1000 Y  
 0°—0  
 -10°—-1000 Y  
 -20°—-2000 Y  
 -30°—-3000 Y  
 -40°—-4000 Y  
 -50°—-5000 Y  
 -60°—-6000 Y

*W. J. Wall*

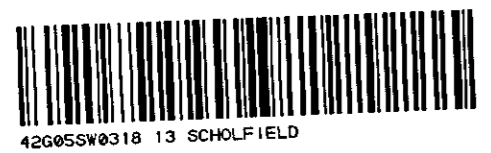

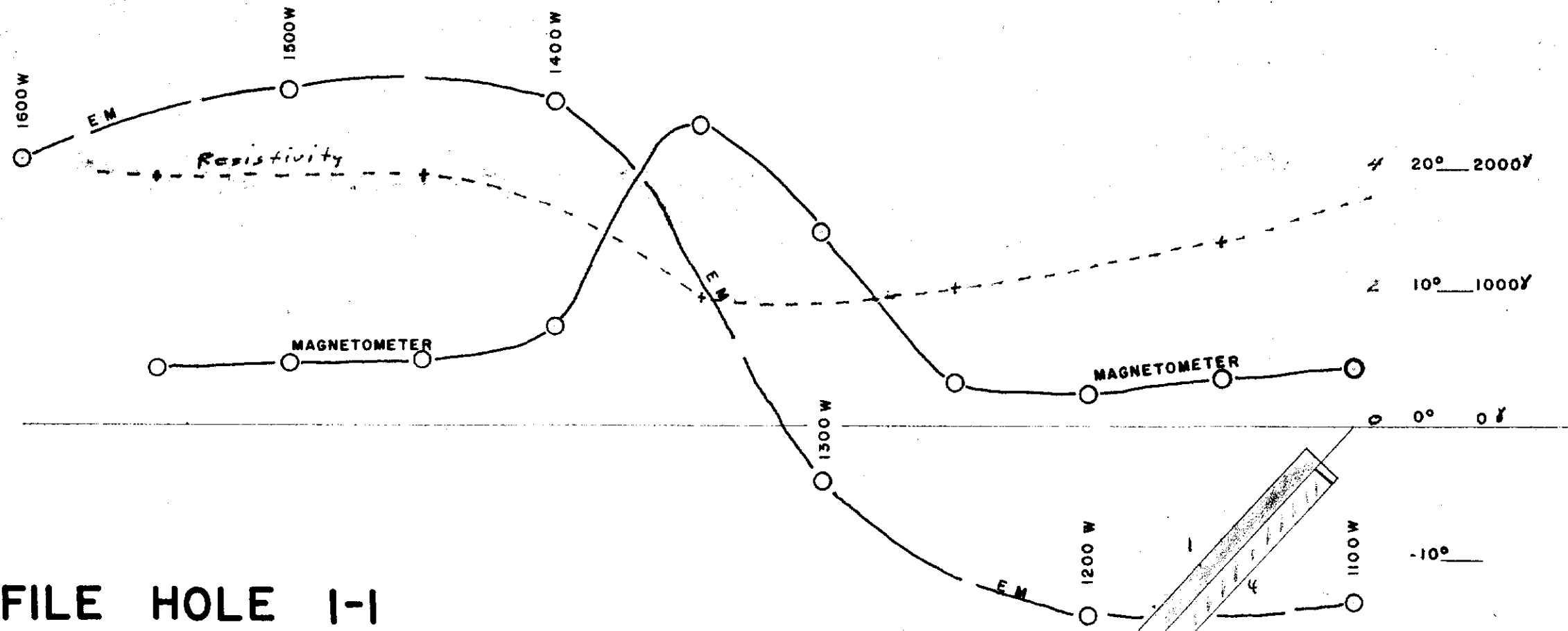

**PROFILE HOLE 1-1**  
**BLOCK I - 1200N 1100W**

**GEOLOGICAL LEGEND**

- 1 Quartz, biotite, actinolite, schistose paragneiss.
- 2 Silicified quartz zone.
- 3 Quartz zone.

**MINERALIZATION KEY**

- 4 Disseminated pyrite, pyrrhotite 1%.
- 5 Pyrite veins 5%.
- Barren zone.

SCALE 1" = 50'

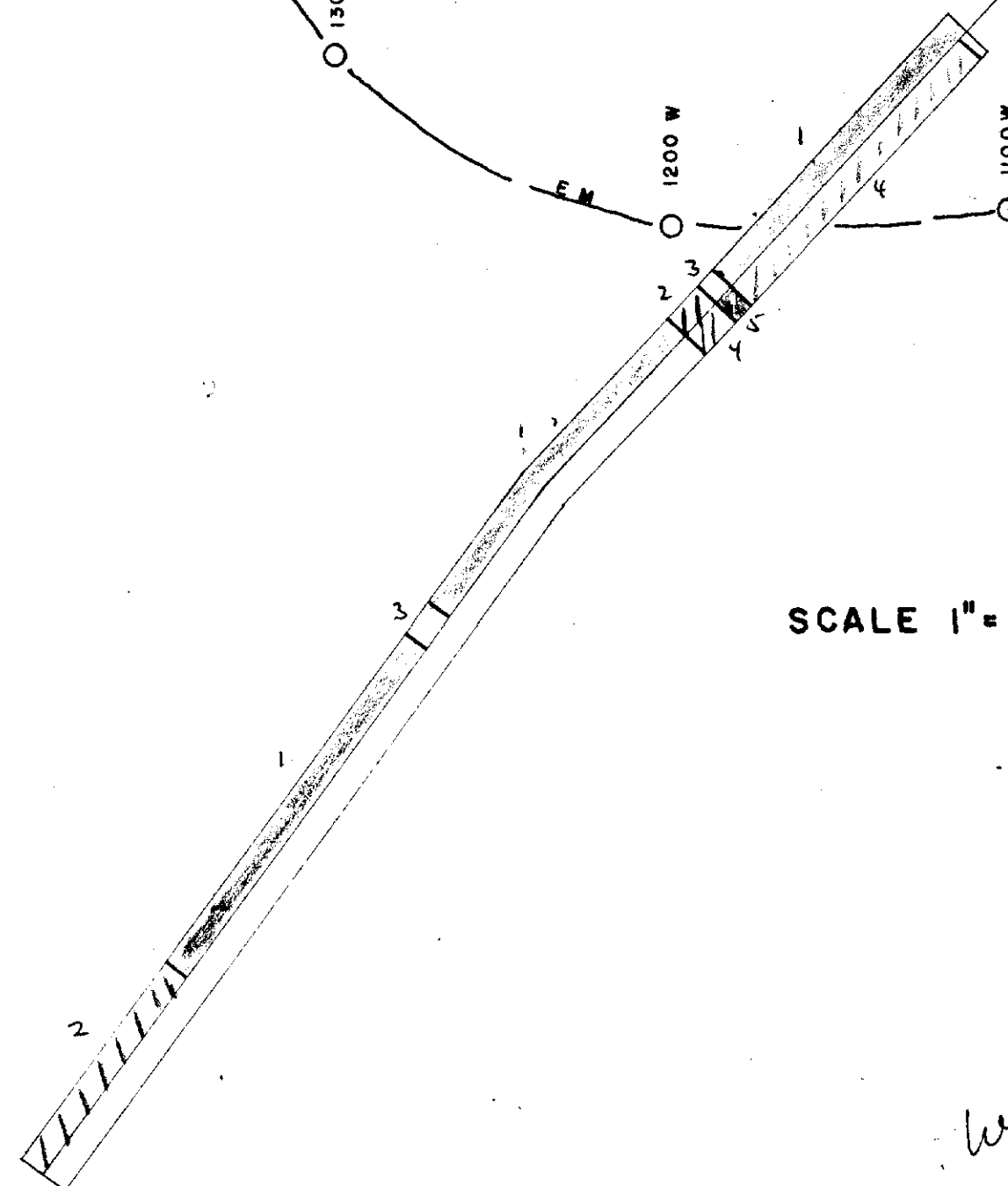

*w.g. Wahl*



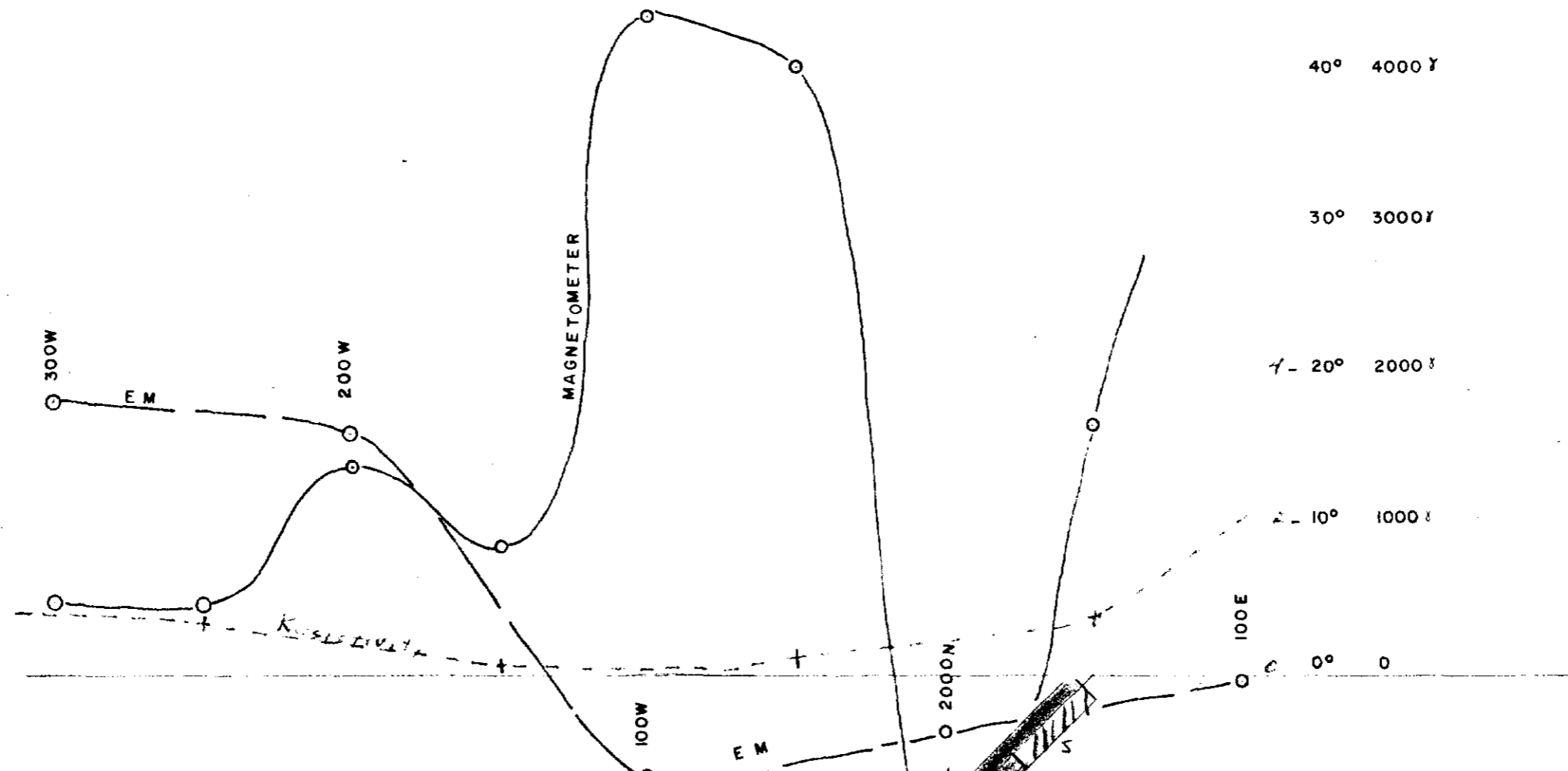

# PROFILE HOLE 1-3

BLOCK I 2000N 50E

## GEOLOGICAL LEGEND

- 1 [Solid black] Quartz, biotite, paragneiss.
- 2 [Diagonal lines /] Siliceous quartz zone.
- 3 [Solid black] Quartz graphite schist.
- 4 [Diagonal lines \] Biotite schist.

## MINERALIZATION KEY

- 5 [Diagonal lines /] Disseminated pyrrhotite pyrite .25-5%.
- 6 [Solid black] Lens pyrrhotite pyrite 5-15%.
- 7 [Diagonal lines \] Pyrite 5-10%.
- [White box] Barren.

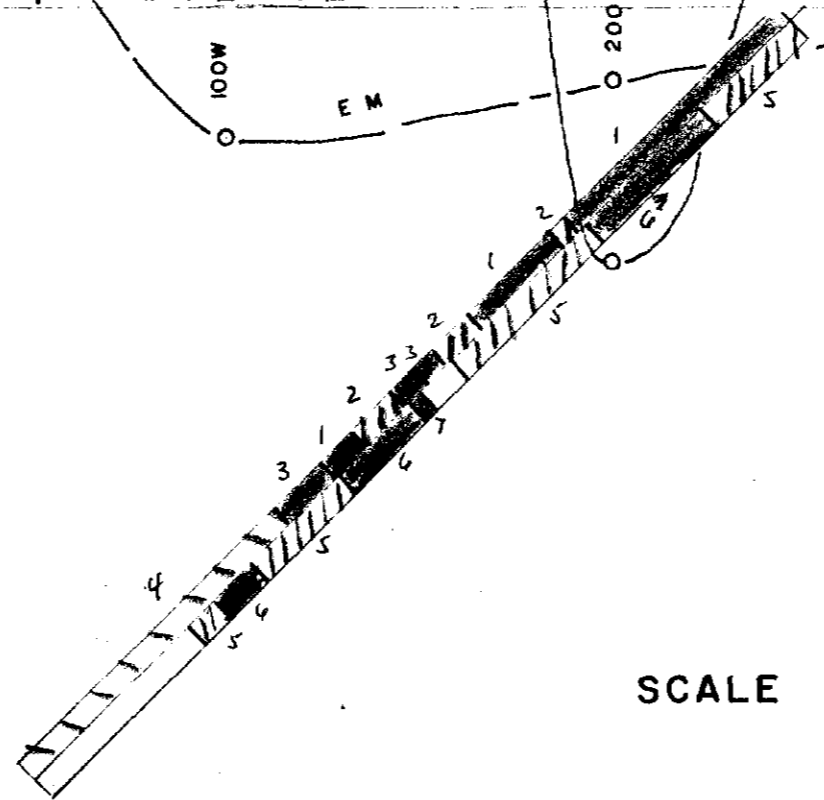

SCALE 1" = 50'



42G05SW0318 13 SCHOLFIELD

240

*wg wall*

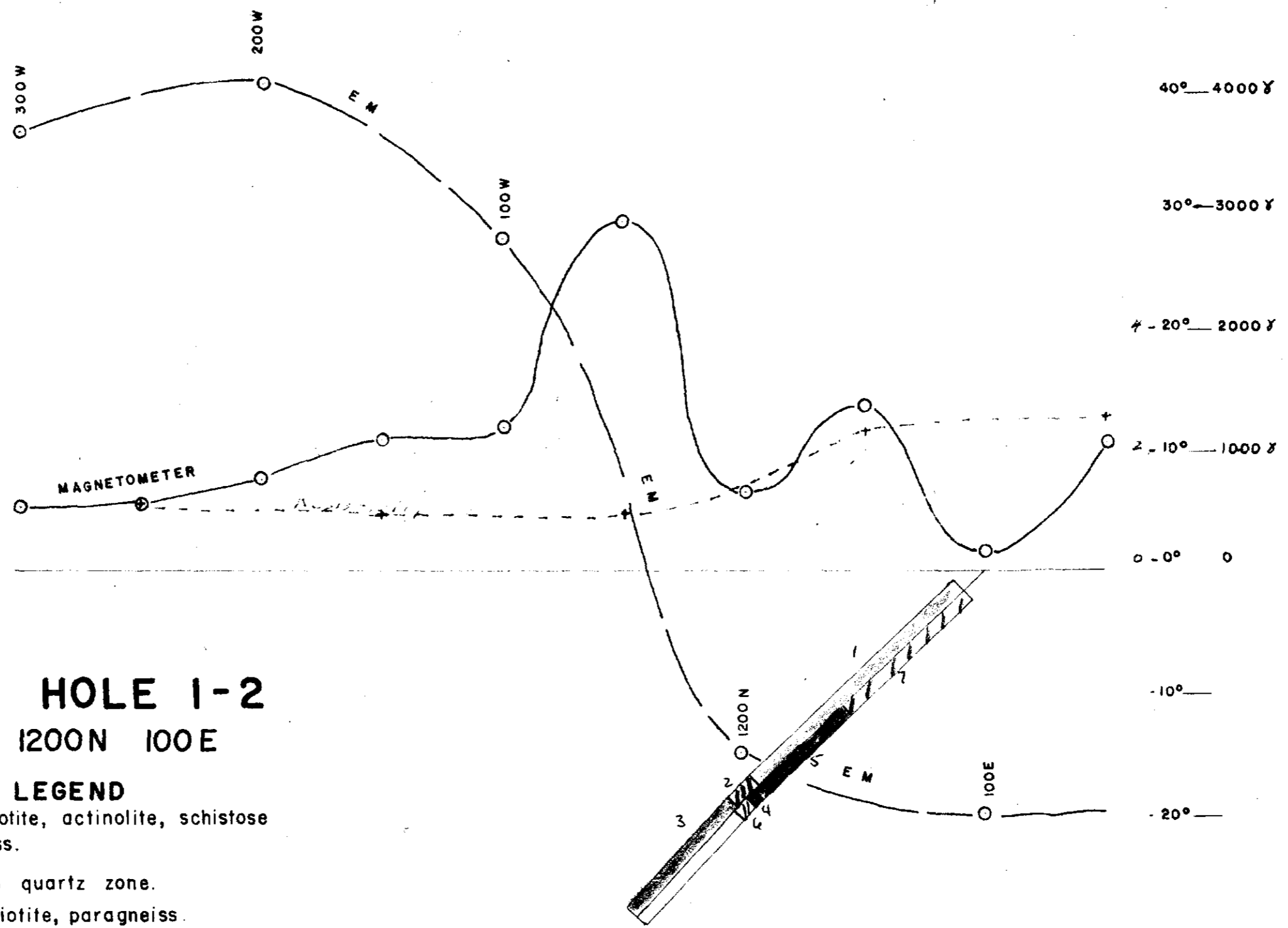

**PROFILE HOLE 1-2**  
**BLOCK 1 - 1200N 100E**

**GEOLOGICAL LEGEND**

- 1 Quartz, biotite, actinolite, schistose paragneiss.
- 2 Siliceous quartz zone.
- 3 Quartz, biotite, paragneiss.

**MINERALIZATION KEY**

- 4 Pyrite - pyrrhotite 10%.
- 5 Pyrite 30% pyrrhotite 10%.
- 6 Disseminated pyrrhotite, pyrite 1-5%.
- 7 Pyrrhotite stringers 1-8%.
- Barren.

SCALE 1" = 50'



42G055W0318 13 SCHOLFIELD

*Weg Wall*

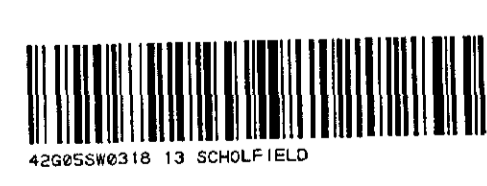
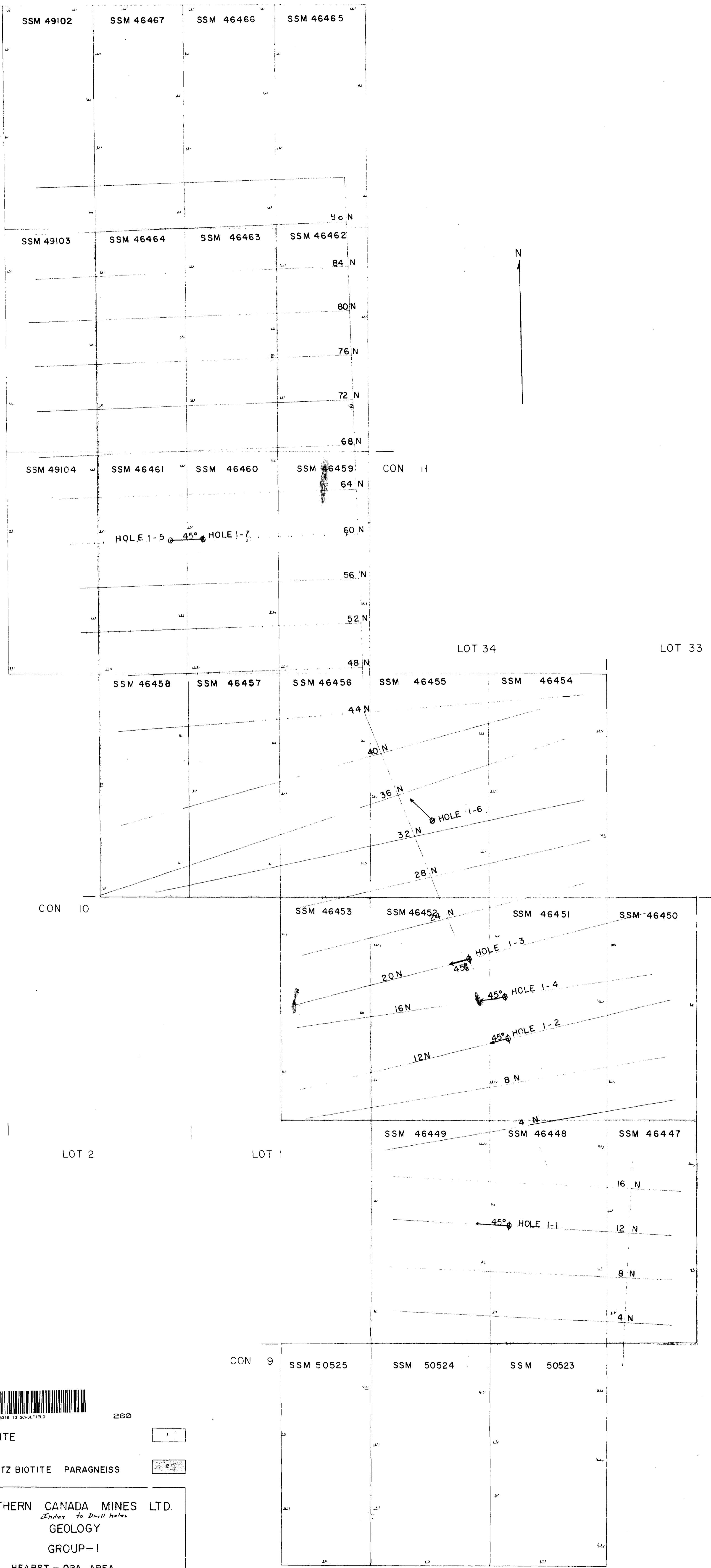

260

- DIORITE 1
- QUARTZ BIOTITE PARAGNEISS 2

NORTHERN CANADA MINES LTD.  
*Index to Drill holes*  
 GEOLOGY  
 GROUP-1  
 HEARST - OBA AREA  
 SAULT STE. MARIE MINING DIVISON  
 SCALE 1" = 400'      FEBRUARY 1957

TALBOTT TWP.

SCHOLFIELD TWP.