



42G06SW0004 10 RYKERT

DIAMOND DRILLING

TOWNSHIP: RYKERT

REPORT NO: #10

WORK PERFORMED FOR: Golden Trio Minerals Ltd.

RECORDED HOLDER: Same as Above (xx)  
: Other ( )

<u>Claim No.</u>	<u>Hole No.</u>	<u>Footage</u>	<u>Date</u>	<u>Note</u>
944606 ✓	GTO-6	72.8m	Feb/88	(1)
920902 ✓	GTO-15	78.9m	Feb/88	(1)
	GTO-16	91.1m	Feb/88	(1)
	GTO-17	182.6m	Feb/88	(1)
934651 ✓	GTO-24	91.1m	Feb/88	(1)
933160 ✓	GTO-24 <sup>25</sup>	61.3m	Feb/88	(1)
945171 ✓	GTO-31	73.5m	Feb/88	(1)
945924 ✓	GTO-35	94.2m	Feb/88	(1)
920932 ✓				

745.5

NOTES: (1) W8906-447 date filed Oct/89

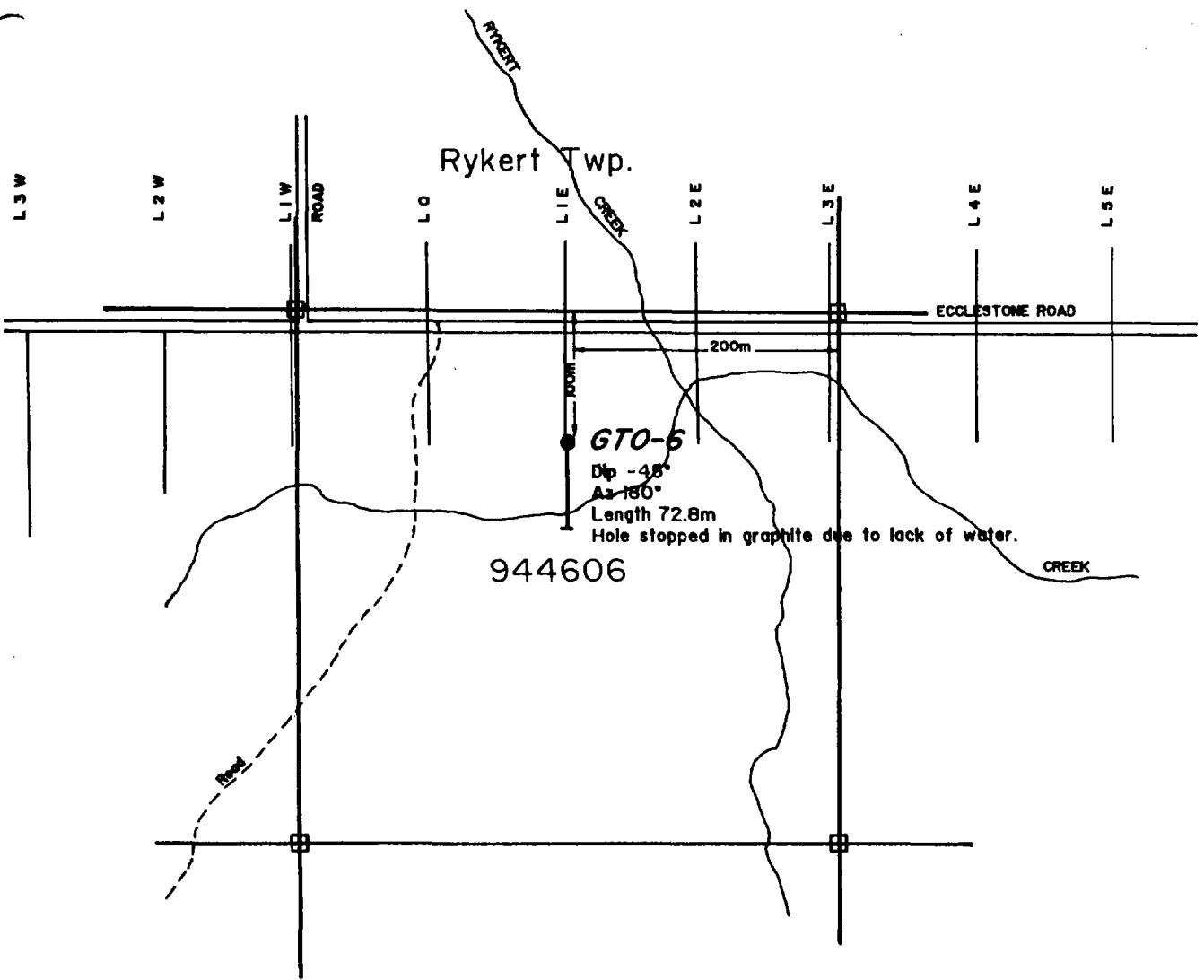

<b>REVISIONS</b>	DURHAM GEOLOGICAL SERVICES INC.		
	For: GOLDEN TRIO MINERALS LTD		
	TMA: OBA PROJECT Diamond Drill Hole Location Map GTO-6		
	Date: JUNE 1988	Drawn: CG	Scale: 1:5000
	NTS:	Approved: <i>[Signature]</i>	Fig.:

DURHAM GEOLOGICAL SERVICES INC.  
Box 734  
Timmins Ontario  
P4N 7G2

DIAMOND DRILL HOLE LOG

PROJECT: Golden Trio - Oba  
AREA: Rykert Twp.  
CLAIM NUMBER: 944606  
CORE SIZE: BQ  
DRILLED BY: Falcon Drilling Ltd.  
LOGGED BY: A. Moore  
CORE STORED AT: Camp 95  
OBJECTIVE: Airborne EM # 2270B

HOLE NUMBER: GTO-6  
LOCATION: 100E, 085S  
AZIMUTH: 180°  
DIP: -45°  
DATE: February 8-9, 1988  
CASING: 9.1m  
LENGTH: 72.8 m  
ACID TEST: -44 @ 72m

*Henry R. ... For A. Moore*







Rykert Twp.

93465I

92090I

GTO-15

Dip -45°

Az 180°

Length 78.9m

920902

920903



REVISIONS	DURHAM GEOLOGICAL SERVICES INC.		
	For:	GOLDEN TRIO MINERALS LTD	
	Title:	OBA PROJECT Diamond Drill Hole Location Map GTO-15	
	Date:	JUNE 1988	Drawn: CG
	NTS:	Approved:	Scale: 1:5000
			Fig.:

DURHAM GEOLOGICAL SERVICES INC.  
Box 734  
TIMMINS, ONTARIO  
P4N 7S2

DIAMOND DRILL HOLE LOG

PROJECT: Golden Trio - Oba Project  
AREA: Rykert East  
CLAIM NUMBER: 920902  
CORE SIZE: BQ  
DRILLED BY: Falcon Drilling Ltd.  
LOGGED BY: B Barnes  
CORE STORED AT: Camp 95  
OBJECTIVE: Test MaxMin Anomaly

HOLE NUMBER: GTO-15  
LOCATION: 4000W, 1450S  
AZIMUTH: 180°  
DIP: -45°  
DATE: February 6-7, 1988  
CASING: 22.9m  
LENGTH: 78.9m  
ACID TEST: -44° @ 78.9m

*Kerry P. Matthews For B. Barnes*









NTS		Approved: <i>[Signature]</i>		Fig.:	
Date: JUNE 1988		Drawn: CG		Scale: 1:5000	
For: GOLDEN TRIO MINERALS LTD		THE OBA PROJECT Diamond Drill Hole Location Map GTO-16			
DURHAM GEOLOGICAL SERVICES INC.					

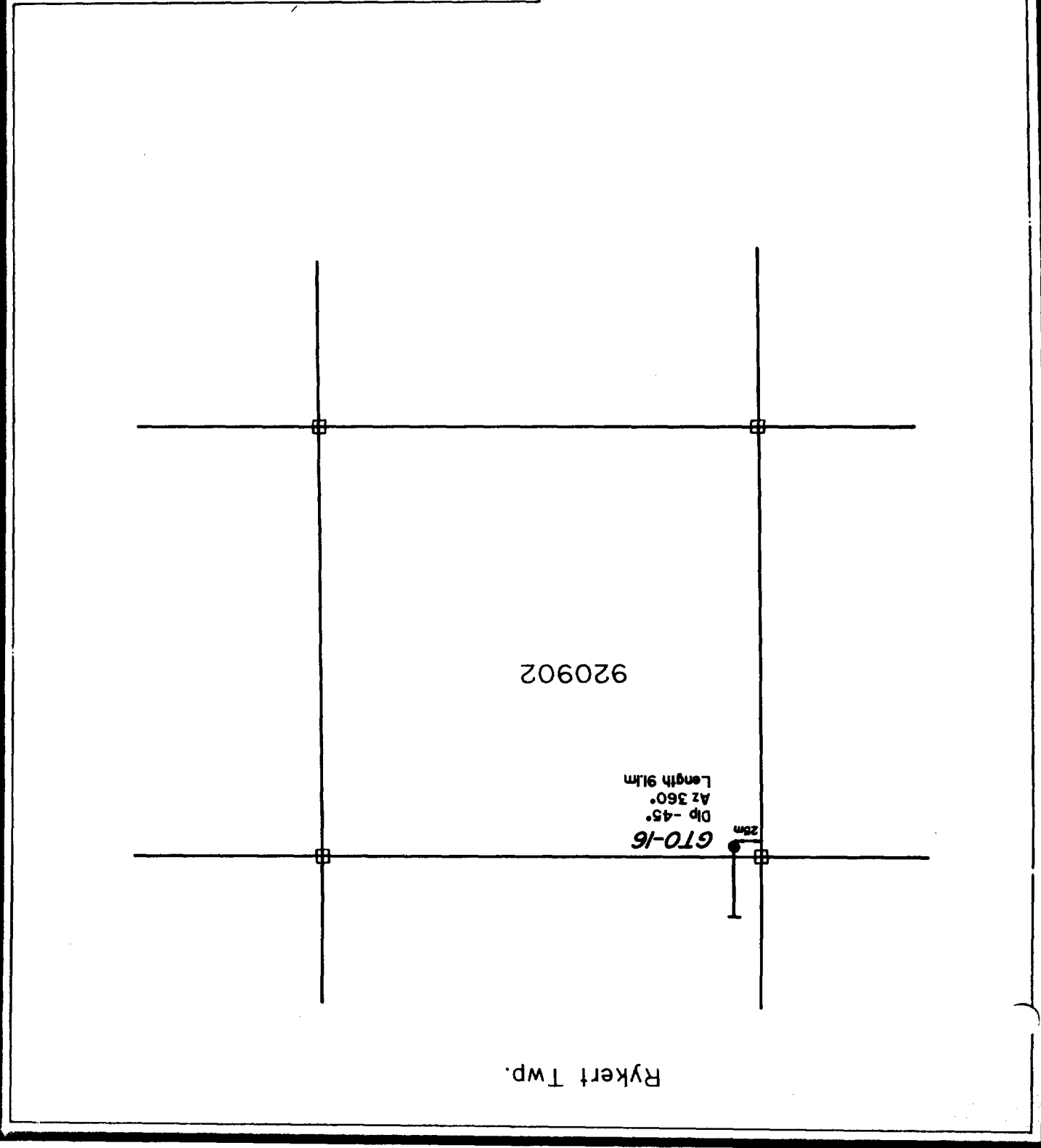

77

DURHAM GEOLOGICAL SERVICES INC.  
Box 734  
Timmins Ontario  
P4N 7G2

DIAMOND DRILL HOLE LOG

PROJECT: Golden Trio Oba Project  
AREA: Rykert East  
CLAIM NUMBER: 920902  
CORE SIZE: BQ  
DRILLED BY: Falcon Drilling Ltd.  
LOGGED BY: B. Barnes  
CORE STORED AT: Camp 95  
OBJECTIVE: Test MaxMin

HOLE NUMBER: GTO-16  
LOCATION: 4000W, 1333S  
AZIMUTH: 360°  
DIP: -45°  
DATE: February 8-9, 1988  
CASING: 13.4 m  
LENGTH: 91.1 m  
ACID TEST: -43° @ 91.1 m

*Kenny Burtens for B. Barnes*





Rykert Twp.

934652

934612

934651

934656

**GTO-17**

Dip -45°  
Az 180°  
Length 182.6m

920902

L 48 W

L 40 W

L 38 W

L 36 W

L 34 W

<b>REVISIONS</b>	DURHAM GEOLOGICAL SERVICES INC.		
	For: GOLDEN TRIO MINERALS LTD		
	Title: OBA PROJECT Diamond Drill Hole Location Map GTO-17		
	Date: JUNE 1988	Drawn: CG	Scale: 1:5000
	NTS:	Approved: <i>[Signature]</i>	Fig.:



DURHAM GEOLOGICAL SERVICES INC.  
Box 734  
Timmins  
Ontario  
P4N 7G2

DIAMOND DRILL HOLE LOG

PROJECT: Golden Trio Oba Project  
AREA: Rykert East  
CLAIM NUMBER: 934651  
CORE SIZE: BQ  
DRILLED BY: Falcon Drilling Ltd.  
LOGGED BY: B. Barnes  
CORE STORED AT: Camp 95  
OBJECTIVE: Test MaxMin Anomaly

HOLE NUMBER: GTO-17  
LOCATION: 4000W, 1125S  
AZIMUTH: 180°  
DIP: -45°  
DATE: February 9-13, 1988  
CASING: 24.4m  
LENGTH: 182.6m  
ACID TEST: -38° @ 182.6

*Handwritten signature: Tony ... for B. Barnes*



METERAGE		ROCK TYPE AND DESCRIPTION	Core Angle to Axis	% Sulphides	SAMPLE				ANALYTICAL RESULT								
From	To				Number	From	To	Length (m)	Au ppb	As ppm	Pb ppm	Zn ppm	Cu ppm	Ag ppm			
30.75	33.1	DIORITE - as from 27.8-29.8			6583	30.75	32.25	1.5	6	4							
					6584	32.25	33.1	0.85	4	5							
33.1	40.5	SEDIMENT - argillaceous wackestone - dark grey, foliated - 1% yellow leucoxene, authophyllite pinhead - garnets - 5% translucent off-white - alteration minced (i.e. silliminite) 33.9 - 10cm massive Po - unit becomes graphitic in various layers between 38.7 to 40.5 with 2-3% pyrite 39.0-39.2 - bleached serateic cherty sediments - graded contact with lower unit															
40.5	42.4	DIORITE - as from 27.8 to 29.8			6588	40.5	42.0	1.5	4	4							







DURHAM GEOLOGICAL SERVICES INC.  
Box 734  
Timmins Ontario  
P4N 7G2

DIAMOND DRILL HOLE LOG

PROJECT: Golden Trio Oba Project  
AREA: Rykert Twp.  
CLAIM NUMBER: 933160  
CORE SIZE: BQ  
DRILLED BY: Falcon Drilling  
LOGGED BY: S. Rusnak  
CORE STORED AT: Camp 95  
OBJECTIVE: To Test Anomaly 2610M

HOLE NUMBER: GTO-24  
LOCATION: Anomaly 2610M L0+00 / 1+75N  
AZIMUTH: 180°  
DIP: -45°  
DATE: February 17-19, 1988  
CASING: 7.6m  
LENGTH: 91.1m  
ACID TEST: -43° @ 91.1m

*S. Rusnak*  
For S. Rusnak













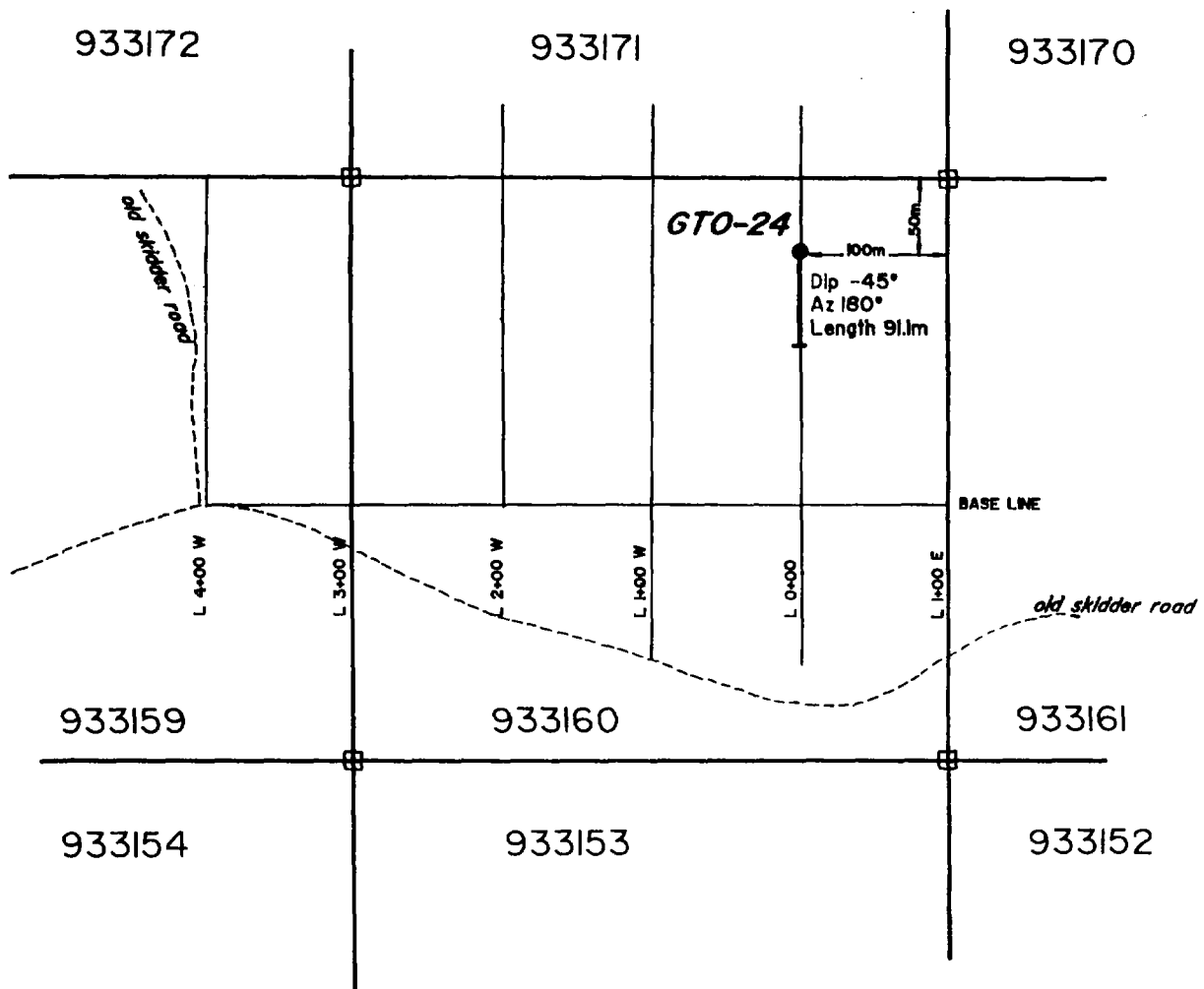

<b>REVISIONS</b>	DURHAM GEOLOGICAL SERVICES INC.		
	<i>For:</i> GOLDEN TRIO MINERALS LTD		
	<i>Title:</i> OBA PROJECT Diamond Drill Hole Location Map GTO-24		
	<i>Date:</i> JUNE 1988	<i>Drawn:</i> CG	<i>Scale:</i> 1:5000
	<i>NTS:</i>	<i>Approved:</i>	<i>Fig.:</i>

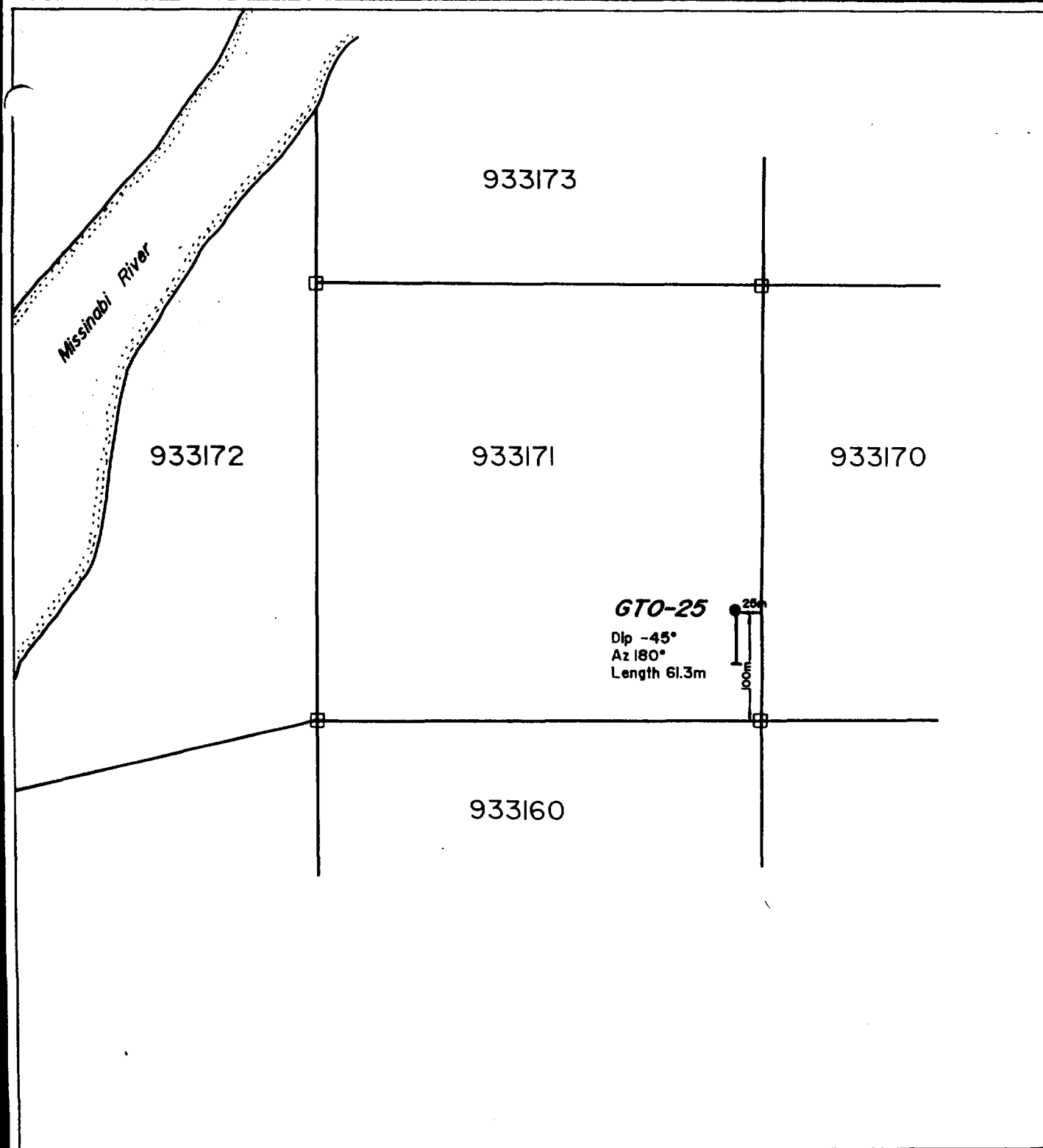

<b>REVISIONS</b>	DURHAM GEOLOGICAL SERVICES INC.		
	<i>For:</i> GOLDEN TRIO MINERALS LTD		
	<i>Title:</i> OBA PROJECT Diamond Drill Hole Location Map GTO-25		
	<i>Date:</i> JUNE 1988	<i>Drawn:</i> CG	<i>Scale:</i> 1:5000
	<i>NTS:</i>	<i>Approved:</i>	<i>Fig.:</i>

DURHAM GEOLOGICAL SERVICES INC.  
Box 734  
Timmins Ontario  
P4N 7G2

DIAMOND DRILL HOLE LOG

PROJECT: Golden Trio Oba Project  
AREA: Rykert Twp.  
CLAIM NUMBER: 933171  
CORE SIZE: BQ  
DRILLED BY: Falcon Drilling Ltd.  
LOGGED BY: S. Rusnak  
CORE STORED AT: Camp 95  
OBJECTIVE: To Test Anomaly 2610K

HOLE NUMBER: CTO-25  
LOCATION: Anomaly 2610K  
LO+00/2+90N  
AZMUTH: 180°  
DIP: -45°  
DATE: February 15-17, 1988  
CASING: 4.6m  
LENGTH: 61.3m  
ACID TEST:

*Henry P. Harkins for S. Rusnak*





R.D.H. LOCATION SHEET

GOLDEN TRIO MINERALS

ORR PROJECT

FILE NO: GTO-31

LOCATION: K0100/13190N

SCALE: 1:5000

DATE: FEB/88

AZIMUTH: 180°

DIP: -60°



934785

Rykert Twp

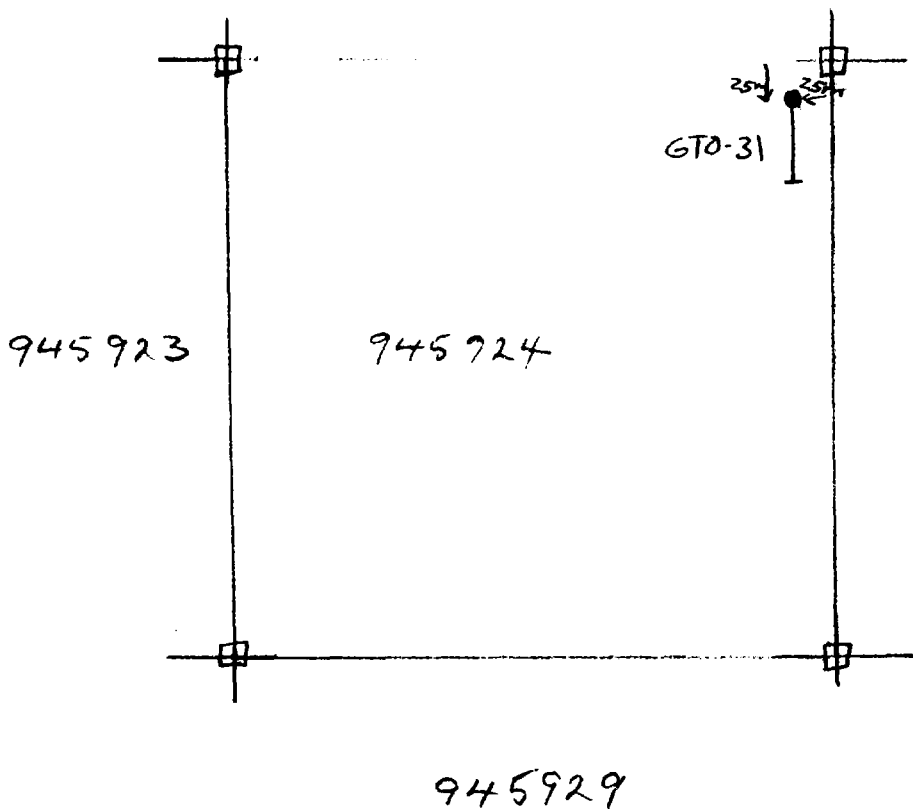

*Handwritten signature or initials.*

# DDH LOCATION SKETCH

Golden Trio Minerals Ltd

OBA PROJECT

Hole No. GTO-35

Location L2+00E / 0+10S

Scale: 1:5000

Date Feb/88

Azimuth 180°

Dip -45°

Rykert Twp

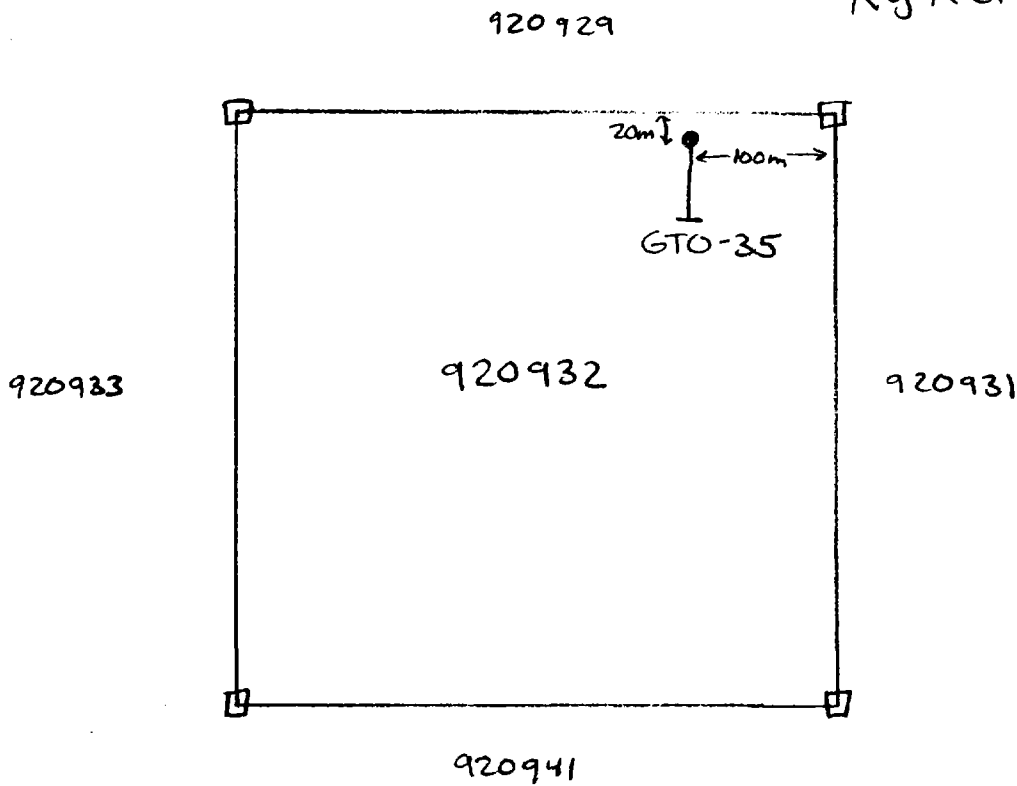

DURHAM GEOLOGICAL SERVICES INC.  
Box 734  
Timmins Ontario  
P4N 7G2

DIAMOND DRILL HOLE LOG

PROJECT: Golden Trio/Oba Project

AREA: Rgkert Twp

CLAIM NUMBER: 945924

CORE SIZE: BQ

DRILLED BY: Falcon Drilling

LOGGED BY: B. Barnes

CORE STORED AT: Camp 95

OBJECTIVE: Maximin Anomaly

HOLE NUMBER: GTO - 31

LOCATION: L0+00/13+90N  
Rgkert East Grid

AZIMUTH: 180°

DIP: -60°

DATE: Feb 6-7, 1988

CASING: 25.0m

LENGTH: 73.5m

ACID TEST:

*Kenny Peterson for B. Barnes*

METERAGE		ROCK TYPE AND DESCRIPTION	Core Angle to Axis	% Sulphides	SAMPLE			ANALYTICAL RESULT									
From	To				Number	From	To	Length (m)	Au ppb	As ppm	Pb ppm	Zn ppm	Cu ppm	Ag ppm			
0	25.0	Casing															
25.0	37.5	Grey waste															
		- a massive to moderately foliated grey, fine grained quartz - feldspar clastic sediment															
		- moderately calcareous with intermittent but pervasive zones throughout unit															
		- fine calcitic fractures throughout															
		- 28.6 - 28.8 m white quartz vein		0	6703	28.6	28.8	0.2									
		- 32.6 m 4cm white quartz vein															
		- 33.9 - 34.5 - well banded graphitic argillite (15% gph) + (10% py)		10	6704	33.9	34.5	0.6									
		- 36.3 - 37.5 m unit becomes cherty to 20% py		20	6705	36.3	37.5	1.2									
37.5	39.7	Graphite, chert, massive sulfides	35°														
		- intermixed chemical sediments		80	6706	37.5	38.5	1.0									
		- massive sulfides 70%, chert		80	6707	38.5	39.5	1.0									
		15% from 37.5 - 39.9 m		15	6708	39.5	40.5	1.0									





DURHAM GEOLOGICAL SERVICES INC.  
Box 734  
Timmins Ontario  
P4N 7G2

DIAMOND DRILL HOLE LOG

PROJECT: Golden Trio/06a Project

HOLE NUMBER: GTO-35

AREA: Rykert Twp.

LOCATION: L 2+00E / 0+10S

CLAIM NUMBER: 920932

AZIMUTH: 180°

CORE SIZE: BQ

DIP: -45°

DRILLED BY: Falcon Drilling

DATE: Feb 13-14, 1988

LOGGED BY: S. Rusnak

CASING: 28.8m

CORE STORED AT: Camp 95

LENGTH: 94.2m

OBJECTIVE: EM Conductor

ACID TEST:

*Kenny Patten* for S. Rusnak









Name and P. Address of Recorded Holder  
**Golden Trio Minerals Ltd. T 720**  
**1401-141 Adelaide St. W., Toronto, Ont. M5H 3M7**

Summary of Work Performance and Distribution of Credits

Total Work Days Cr. claimed <b>2443</b>	Mining Claim		Work Days Cr.	Mining Claim		Work Days Cr.	Mining Claim		Work Days Cr.
	Prefix	Number		Prefix	Number		Prefix	Number	
for Performance of the following work. (Check one only)		<b>see attached list</b>							
<input type="checkbox"/> Manual Work									
<input type="checkbox"/> Shaft Sinking Drifting or other Lateral Work.									
<input type="checkbox"/> Compressed Air, other Power driven or mechanical equip.									
<input type="checkbox"/> Power Stripping									
<input checked="" type="checkbox"/> Diamond or other Core drilling									
<input type="checkbox"/> Land Survey									

**ONTARIO GEOLOGICAL SURVEY  
 ASSESSMENT FILES  
 OFFICE  
 OCT 13 1989  
 RECEIVED**

All the work was performed on Mining Claim(s): **944606, 920902, 934651, 933160, 933171, 920932, 945924**

Required Information eg: type of equipment, Names, Addresses, etc. (See Table Below)

**Falcon Drilling Ltd.**  
**Box 578, Prince George, B.C.**  
**✓ 2 L 458**

**RECORDED**  
**APR 27 1989**

**RECEIVED**  
**APR 27 1989**  
**16:00 PJB**

		Meterage	
GTO-6	Feb 8-9, 1988	72.8	944606
GTO-15	Feb 6-7, 1988	78.9	920902
GTO-16	Feb 8-9, 1988	91.1	920902
GTO-17	Feb 9-13, 1988	182.6	934651
GTO-24	Feb 17-19, 1988	91.1	933160
GTO-25	Feb 15-17, 1988	61.3	930171
GTO-31	Feb 6-7, 1988	73.5	945924
GTO-35	Feb 13-14, 1988	94.2	920932

Work performed  
 Feb. 6<sup>th</sup> to 19<sup>th</sup>, 1988

**745.5m = 2445 feet**

Date of Report **April 27/89** Recorded Holder or Agent (Signature) **Henry Putterli**

Certification Verifying Report of Work

I hereby certify that I have a personal and intimate knowledge of the facts set forth in the Report of Work annexed hereto, having performed the work or witnessed same during and/or after its completion and the annexed report is true.

Name and Postal Address of Person Certifying

**Henry Putterli**

Date Certified **April 27/89**

Certified by (Signature) **Henry Putterli**

**Box 1330, Timmins, Ont. P4N 7J8**

Table of Information/Attachments Required by the Mining Recorder

Type of Work	Specific information per type	Other information (Common to 2 or more types)	Attachments
Manual Work	Nil	Names and addresses of men who performed manual work/operated equipment, together with dates and hours of employment.	Work Sketch: these are required to show the location and extent of work in relation to the nearest claim post.
Shaft Sinking, Drifting or other Lateral Work			
Compressed air, other power driven or mechanical equip.	Type of equipment	Names and addresses of owner or operator together with dates when drilling/stripping	
Power Stripping	Type of equipment and amount expended. Note: Proof of actual cost must be submitted within 30 days of recording.		

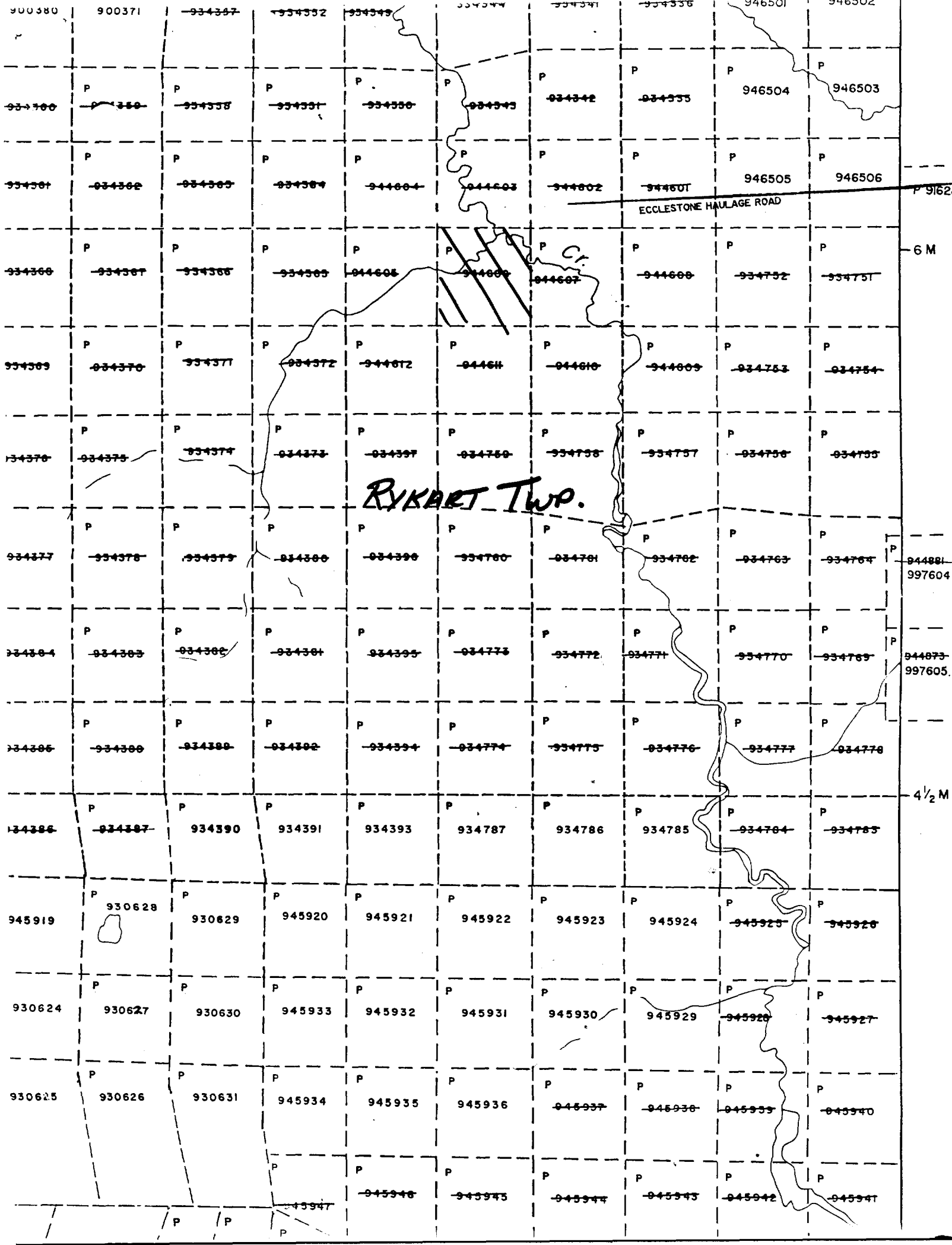

900380 900371 934367 934352 934349 934344 934341 934336 946501 946502

934360 934358 934357 934356 934355 934354 934353 946504 946503

934361 934362 934363 934364 944604 944603 944602 944601 946505 946506 P 9162

ECCLESTONE HAULAGE ROAD

934366 934367 934368 934369 944606 944605 944604 944603 934752 934751 6 M

934369 934370 934371 934372 944612 944611 944610 944609 934753 934754

934376 934375 934374 934373 934397 934759 934758 934757 934756 934755

**RYKARD TWP.**

934377 934378 934379 934380 934398 934760 934761 934762 934763 934764 P 94481 997604

934384 934383 934382 934381 934395 934773 934772 934771 934770 934769 P 944873 997605

934386 934386 934386 934386 934394 934774 934775 934776 934777 934778

934386 934387 934390 934391 934393 934787 934786 934785 934784 934783 4 1/2 M

945919 930628 930629 945920 945921 945922 945923 945924 945925 945926

930624 930627 930630 945933 945932 945931 945930 945929 945928 945927

930625 930626 930631 945934 945935 945936 945937 945938 945939 945940

945941 945942 945943 945944 945945 945946 945947

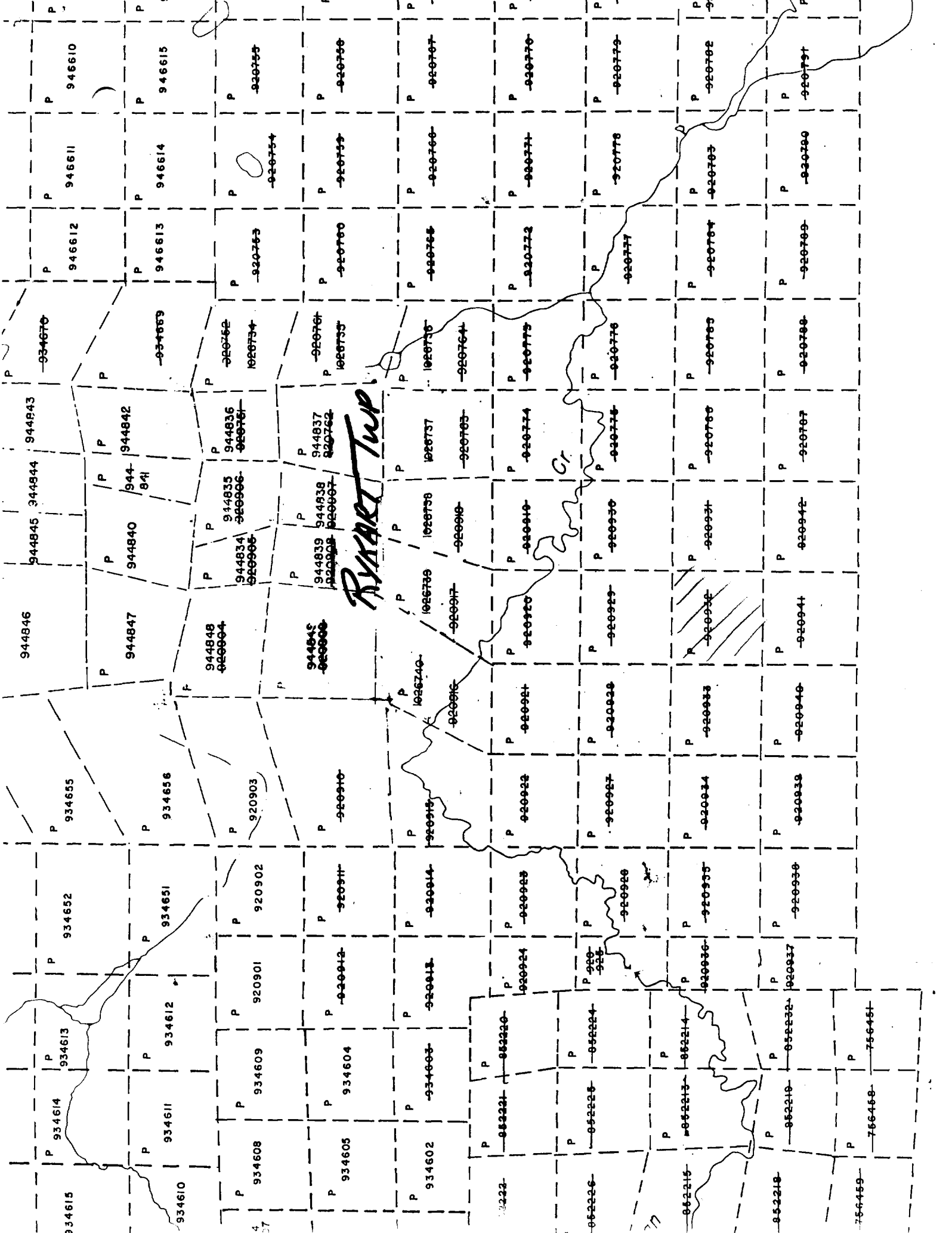

**RYBART TWP.**

Gr.

934615  
934614  
934611  
934610  
934652  
934655  
934656  
934658  
934608  
934605  
934602  
934604  
934603  
934601  
934602  
934603  
934604  
934605  
934606  
934607  
934608  
934609  
934610  
934611  
934612  
934613  
934614  
934615  
934616  
934617  
934618  
934619  
934620  
934621  
934622  
934623  
934624  
934625  
934626  
934627  
934628  
934629  
934630  
934631  
934632  
934633  
934634  
934635  
934636  
934637  
934638  
934639  
934640  
934641  
934642  
934643  
934644  
934645  
934646  
934647  
934648  
934649  
934650  
934651  
934652  
934653  
934654  
934655  
934656  
934657  
934658  
934659  
934660  
934661  
934662  
934663  
934664  
934665  
934666  
934667  
934668  
934669  
934670  
934671  
934672  
934673  
934674  
934675  
934676  
934677  
934678  
934679  
934680  
934681  
934682  
934683  
934684  
934685  
934686  
934687  
934688  
934689  
934690  
934691  
934692  
934693  
934694  
934695  
934696  
934697  
934698  
934699  
934700  
934701  
934702  
934703  
934704  
934705  
934706  
934707  
934708  
934709  
934710  
934711  
934712  
934713  
934714  
934715  
934716  
934717  
934718  
934719  
934720  
934721  
934722  
934723  
934724  
934725  
934726  
934727  
934728  
934729  
934730  
934731  
934732  
934733  
934734  
934735  
934736  
934737  
934738  
934739  
934740  
934741  
934742  
934743  
934744  
934745  
934746  
934747  
934748  
934749  
934750  
934751  
934752  
934753  
934754  
934755  
934756  
934757  
934758  
934759  
934760  
934761  
934762  
934763  
934764  
934765  
934766  
934767  
934768  
934769  
934770  
934771  
934772  
934773  
934774  
934775  
934776  
934777  
934778  
934779  
934780  
934781  
934782  
934783  
934784  
934785  
934786  
934787  
934788  
934789  
934790  
934791  
934792  
934793  
934794  
934795  
934796  
934797  
934798  
934799  
934800  
934801  
934802  
934803  
934804  
934805  
934806  
934807  
934808  
934809  
934810  
934811  
934812  
934813  
934814  
934815  
934816  
934817  
934818  
934819  
934820  
934821  
934822  
934823  
934824  
934825  
934826  
934827  
934828  
934829  
934830  
934831  
934832  
934833  
934834  
934835  
934836  
934837  
934838  
934839  
934840  
934841  
934842  
934843  
934844  
934845  
934846  
934847  
934848  
934849  
934850  
934851  
934852  
934853  
934854  
934855  
934856  
934857  
934858  
934859  
934860  
934861  
934862  
934863  
934864  
934865  
934866  
934867  
934868  
934869  
934870  
934871  
934872  
934873  
934874  
934875  
934876  
934877  
934878  
934879  
934880  
934881  
934882  
934883  
934884  
934885  
934886  
934887  
934888  
934889  
934890  
934891  
934892  
934893  
934894  
934895  
934896  
934897  
934898  
934899  
934900  
934901  
934902  
934903  
934904  
934905  
934906  
934907  
934908  
934909  
934910  
934911  
934912  
934913  
934914  
934915  
934916  
934917  
934918  
934919  
934920  
934921  
934922  
934923  
934924  
934925  
934926  
934927  
934928  
934929  
934930  
934931  
934932  
934933  
934934  
934935  
934936  
934937  
934938  
934939  
934940  
934941  
934942  
934943  
934944  
934945  
934946  
934947  
934948  
934949  
934950  
934951  
934952  
934953  
934954  
934955  
934956  
934957  
934958  
934959  
934960  
934961  
934962  
934963  
934964  
934965  
934966  
934967  
934968  
934969  
934970  
934971  
934972  
934973  
934974  
934975  
934976  
934977  
934978  
934979  
934980  
934981  
934982  
934983  
934984  
934985  
934986  
934987  
934988  
934989  
934990  
934991  
934992  
934993  
934994  
934995  
934996  
934997  
934998  
934999  
935000

944846  
944847  
944848  
944849  
944850  
944851  
944852  
944853  
944854  
944855  
944856  
944857  
944858  
944859  
944860  
944861  
944862  
944863  
944864  
944865  
944866  
944867  
944868  
944869  
944870  
944871  
944872  
944873  
944874  
944875  
944876  
944877  
944878  
944879  
944880  
944881  
944882  
944883  
944884  
944885  
944886  
944887  
944888  
944889  
944890  
944891  
944892  
944893  
944894  
944895  
944896  
944897  
944898  
944899  
944900  
944901  
944902  
944903  
944904  
944905  
944906  
944907  
944908  
944909  
944910  
944911  
944912  
944913  
944914  
944915  
944916  
944917  
944918  
944919  
944920  
944921  
944922  
944923  
944924  
944925  
944926  
944927  
944928  
944929  
944930  
944931  
944932  
944933  
944934  
944935  
944936  
944937  
944938  
944939  
944940  
944941  
944942  
944943  
944944  
944945  
944946  
944947  
944948  
944949  
944950  
944951  
944952  
944953  
944954  
944955  
944956  
944957  
944958  
944959  
944960  
944961  
944962  
944963  
944964  
944965  
944966  
944967  
944968  
944969  
944970  
944971  
944972  
944973  
944974  
944975  
944976  
944977  
944978  
944979  
944980  
944981  
944982  
944983  
944984  
944985  
944986  
944987  
944988  
944989  
944990  
944991  
944992  
944993  
944994  
944995  
944996  
944997  
944998  
944999  
945000

4  
27

7

