

42G07SW2001 2.18530 CARGILL

010

REPORT ON THE CARGILL TOWNSHIP PROPERTY

CARGILL TOWNSHIP

PORCUPINE MINING DIVISION, ONTARIO

OVERBURDEN STRIPPING/GEOLOGICAL MAPPING PROGRAM

for

LEO ALARIE and SONS Limited.

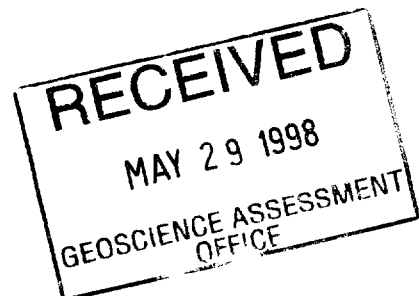

Submitted by: R.J. Meikle
Geophysical Engineering & Surveys Inc.
May, 1998

TABLE OF CONTENTS

<u>CONTENTS</u>	<u>PAGE NO.</u>
INTRODUCTION.....	1
LOCATION AND ACCESS.....	2
CLAIM STATUS.....	2
PERSONNEL.....	3
PREVIOUS WORK.....	3
GENERAL GEOLOGY.....	3
WORK PROGRAM	4
CONCLUSIONS AND RECOMMENDATIONS.....	5
CERTIFICATE.....	6

LIST OF FIGURES

LOCATION MAP	FIG.1
REGIONAL LOCATION MAP.....	FIG.2
CLAIM SKETCH MAP.....	FIG.3
GEOLOGY MAP.....	FIG.4

MAPS

PHASE 1 PLAN MAP AND SECTIONS.....	MAP 1
PHASE 2 GEOLOGICAL PLAN & SAMPLE LOCATIONS.....	MAP 2

APPENDIX

APPENDIX "A"-COST BREAKDOWN-OVERBURDEN TEST HOLES
- PHASE ONE

APPENDIX "B"-COST BREAKDOWN-LEO ALARIE and SONS LTD.
- PHASE TWO

APPENDIX "C"-GEOPHYSICAL ENGINEERING & SURVEYS INC.
- COST BREAKDOWN, PHASE TWO



INTRODUCTION

This report deals with the logistics and results of an overburden stripping and geological mapping program carried out on the "Cargill Township Property", Cargill Township, Porcupine Mining Division, Ontario.

The "Cargill Township Property", is comprised of a 16 unit, unpatented block mining claim, #1224136, recorded in the name of Leo Alarie and Sons Limited., Timmins, Ontario. The mechanical stripping was carried out by Leo Alarie & Sons Ltd., under supervision of Fudge & Associates, North Bay, Ontario, who contracted Geophysical Engineering & Surveys Inc., Timmins, Ontario, to do a geological assessment/mapping survey of the exposed outcrop-area.

The purpose of the program was to determine the overburden thickness and geology of a specific area of higher elevation within the above mining claim. Initially, the program was to determine the suitability of the rock for aggregate purposes. A recent release of O.G.S. information indicates the general area to be highly prospective for both diamond exploration and base metal exploration and the potential of the exposed bedrock geology was subsequently explored for this as well.

LOCATION AND ACCESS

The "Cargill Township Property" is located in the central part of Cargill Township, approximately 30km southwest of the town of Kapuskasing, Ontario (figs. 1,2).

The property is easily accessed by travelling 6km west of Kapuskasing on Hwy. 11n, then south on the secondary gravelled Cargill Road and turning west on the Ecclestone Road for 4.5km at which point an access trail leads south approximately 600 meters to the stripped area (fig.2).

CLAIM STATUS

The property is comprised of 1 unpatented, 256 Hectare, 16 unit block mining claim, #1224136, in the central part of Cargill Township, Porcupine Mining Division, Ontario. The claim is recorded 100% in the name of Leo Alarie and Sons Limited., P.O. Box 912, Highway 101 west, Timmins, Ontario, P4N 7H1 (fig.3).

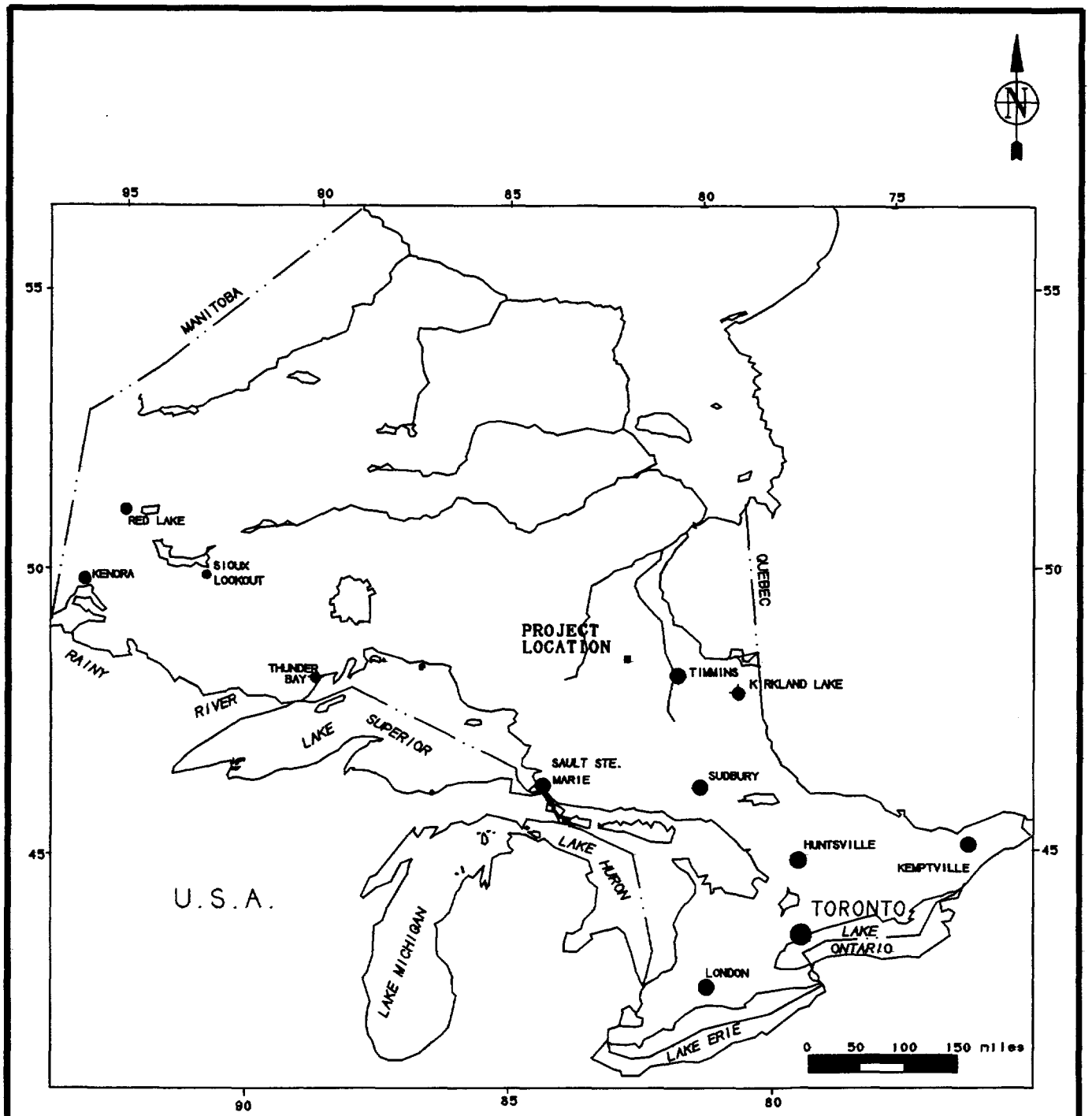

PROVINCE OF ONTARIO

FIG 2

Client: LEO ALARIE AND SONS	
Property: CARGILL PROPERTY	
Title: LOCATION MAP	
Prepared: SDA	Checked: RJM
Date: MAY/98	Ownership: CARGILL
Province: ONT	N.T.S.: 42G/SE
Scale: 1 in = 125 mi	Drawing: SDA

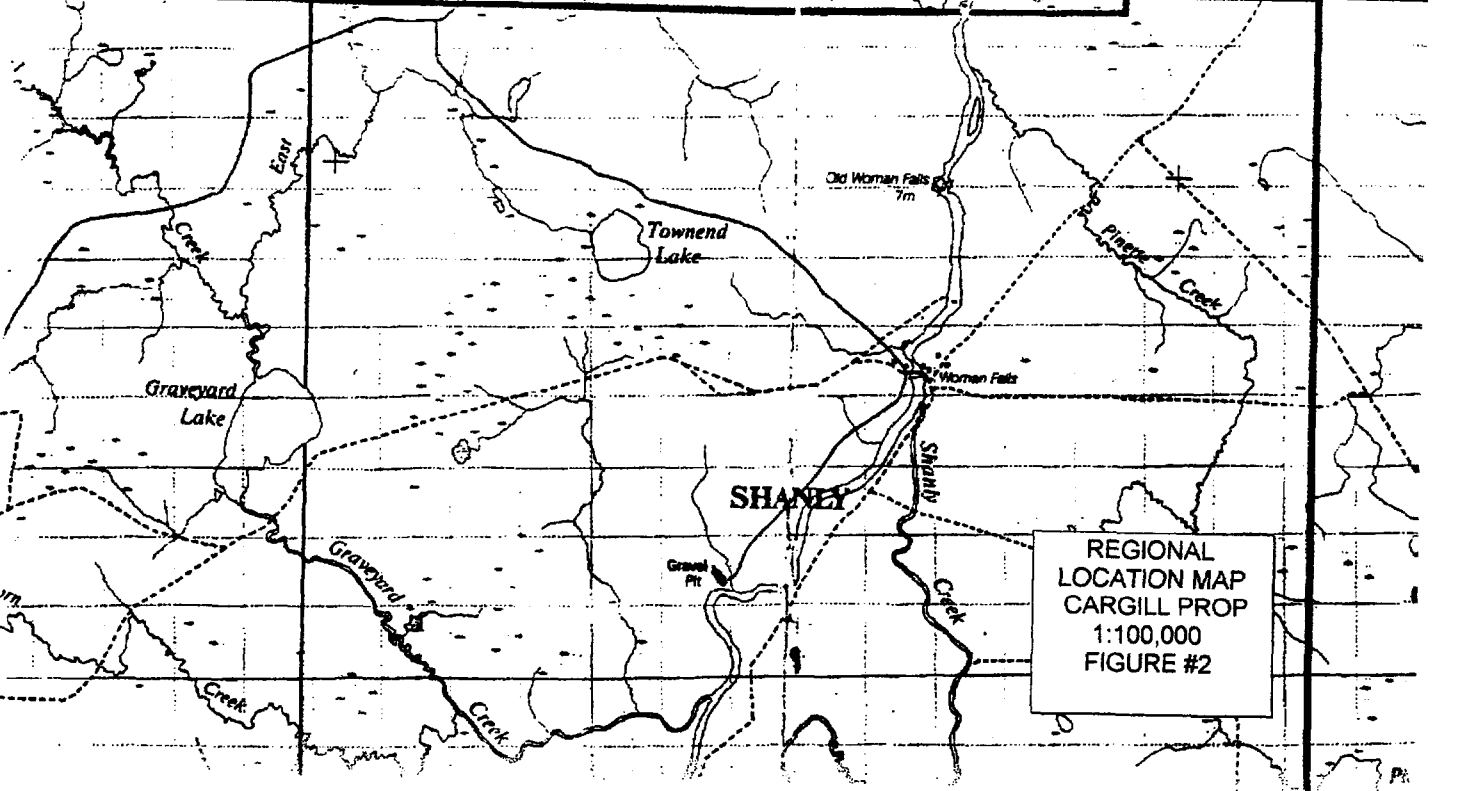
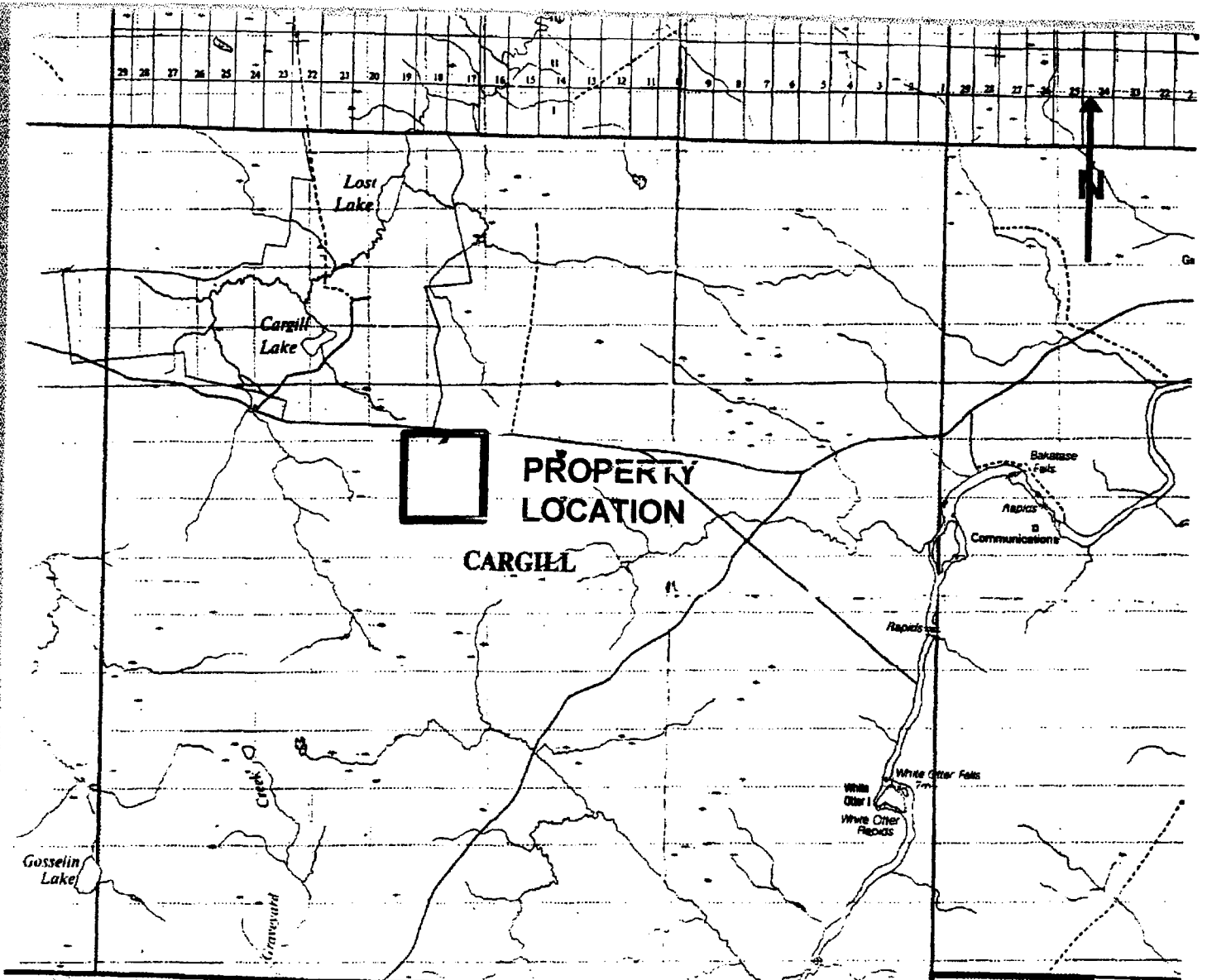

REGIONAL
LOCATION MAP
CARGILL PROP
1:100,000
FIGURE #2

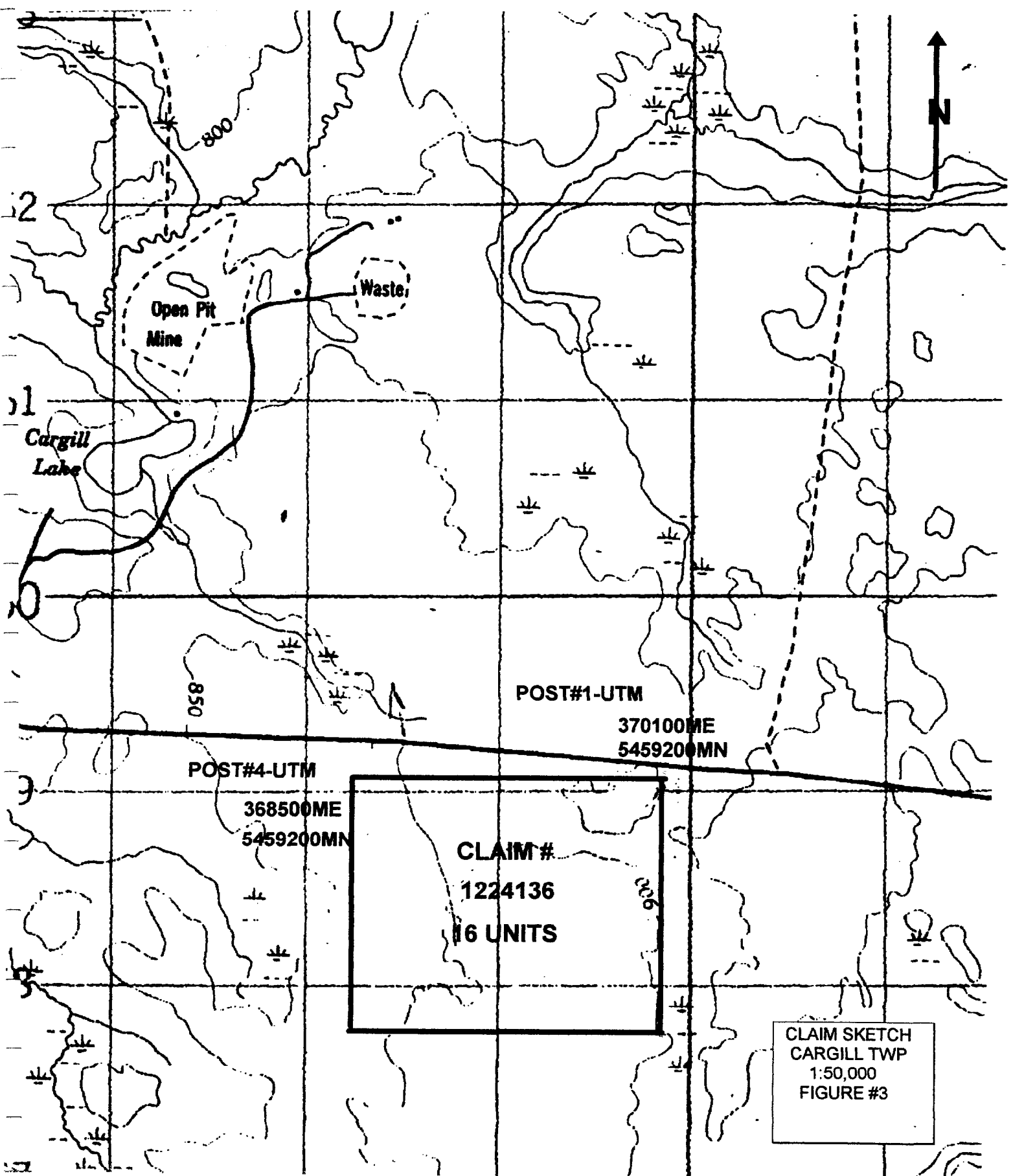

Open Pit Mine

Waste

Cargill Lake

POST#1-UTM

370100ME
5459200MN

POST#4-UTM

368500ME
5459200MN

CLAIM #
1224136
16 UNITS

CLAIM SKETCH
CARGILL TWP
1:50,000
FIGURE #3

LOWER TO UPPER DEVONIAN

- 11c Upper Ashby River Formation: fossiliferous limestone.
- 11b Middle Ashby River Formation (Moose River Formation): non-fossiliferous limestone, shale, gypsum.
- 11a Sartan Formation: sandstone, siltst. argos.
- 11 Undifferentiated.

EROSIONAL INTERVAL

SILURIAN

- 10 Limestone, dolomite, sandstone

UNCONFORMITY

PRECAMBRIAN

ARCHEAN AND PROTEROZOIC

- 9 Diabase (sides).

INTRUSIVE CONTACT

PROTEROZOIC CARBONATITE COMPLEXES

- 8 Undifferentiated.
- 8a Calcarenitic.
- 8b Basaltic-pyroxene-carbonate rock.
- 8c Pyroxenite.
- 8d Syenitic.
- 8e Gabroic.

INTRUSIVE CONTACT

ARCHEAN KAPUSKASING GRANULITE COMPLEX

- 7 Undifferentiated.
- 7a Amphibole-syringite-quartz-feldspar granulite.

FELSIC INTRUSIVE ROCKS

- 6 Undifferentiated.
- 6a Massive granitic rocks.
- 6b Foliated granitic rocks.
- 6c Granite pegmatite.
- 6d Plygmatically folded pegmatite stringers.

INTRUSIVE CONTACT

ULTRAMAFIC INTRUSIVE ROCKS

- 5 Undifferentiated.
- 5a Gabro, metagabro, anorthositic gabro.
- 5b Peridotite, serpentinite.

INTRUSIVE CONTACT

MIGMATITE-METASEDIMENTARY-METAVOLCANIC COMPLEX

- 4 Undifferentiated.
- 4a Biotite-quartz-feldspar gneiss.
- 4b Hornblende-quartz-feldspar gneiss.
- 4c Amphibolite.
- 4d Quartz-mica schist.
- 4e Hybrid granitic gneiss.
- 4f Lit. par. lit. granitic.

Iron Formation

METAMORPHIC CONTACT

METASEDIMENTS

- 3 Undifferentiated.
- 3a Greywacke.
- 3b Arkose.
- 3c Quartzite.
- 3d Amphibolite.
- 3e Pyroclite.

Iron Formation

FELSIC TO INTERMEDIATE METAVOLCANICS

- 2 Undifferentiated.
- 2a Rhyolite, dacite, trachyte: massive to foliated.
- 2b Pyroclastic rocks, agglomerates.
- 2c Felsic tuff.

INTERMEDIATE TO MAFIC METAVOLCANICS

- 1 Undifferentiated.
- 1a Andesite, basalt: massive to foliated.
- 1b Andesite, basalt: pillowed.
- 1c Amphibolite, amphibole schist, amphibole-pyroxene-plagioclase gneiss.
- 1d Chlorite schist.
- 1e Mafic tuff.

Iron Formation

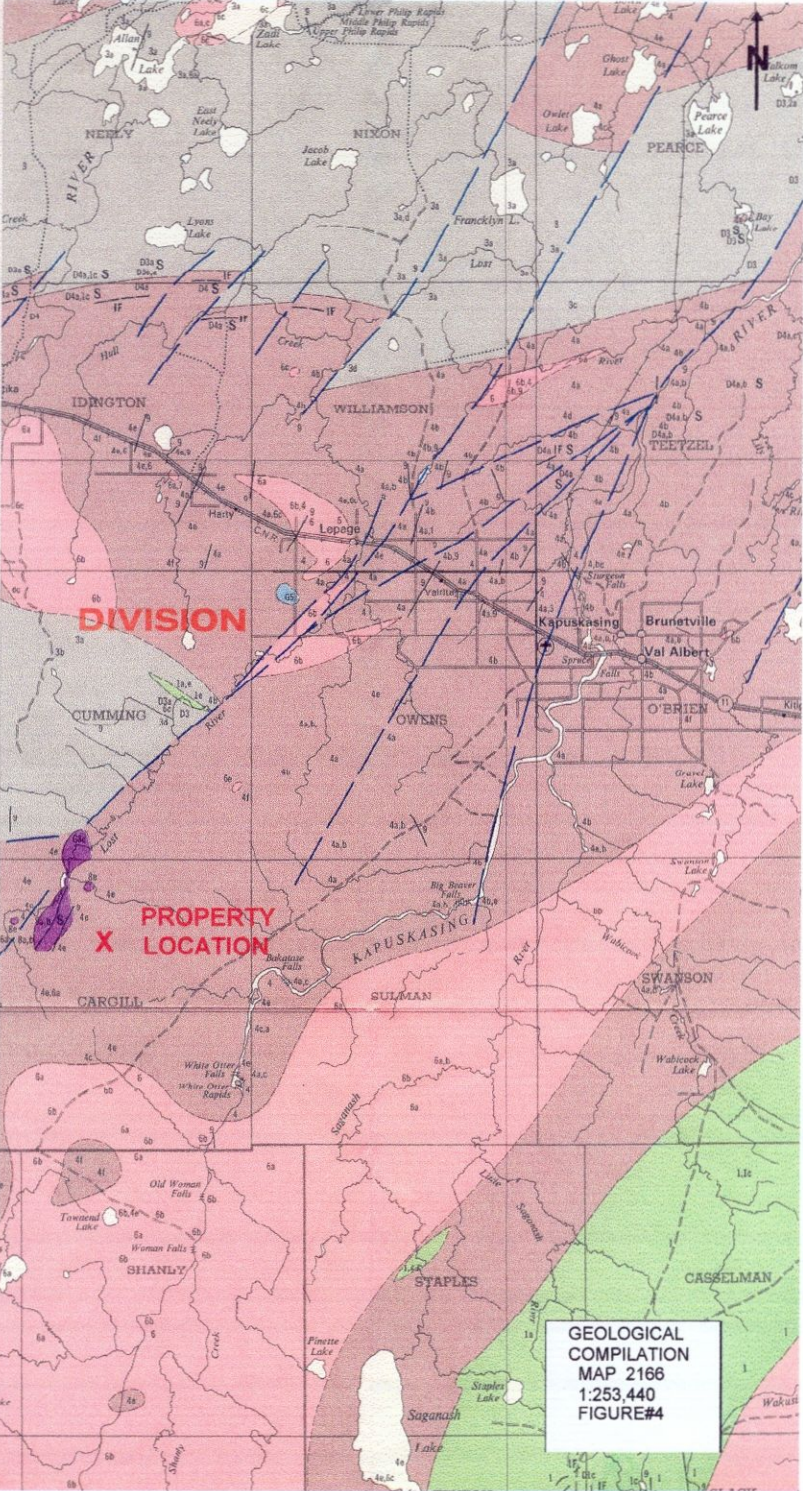

**GEOLOGICAL COMPILATION
MAP 2166
1:253,440
FIGURE#4**

PERSONNEL

The following personnel were directly involved with the Stripping and Geological Mapping program:

R.J. Meikle	Timmins, Ontario
Herve Blais	Timmins, Ontario
Marcel Cheff	Timmins, Ontario
Bob Loranger	Kapuskasing, Ontario
Don Fudge	North Bay, Ontario

PREVIOUS WORK

There is no apparent previous mining exploration work recorded on the property.

GENERAL GEOLOGY

O.G.S. Map No. 2166, Hearst-Kapuskasing Sheet, Geological Compilation Sheet, shows the claim to be underlain by Archean age Hybrid Granitic Gneiss. This map does not show any outcrop within the claim but the current stripping program correlates with Map No. 2166.

WORK PROGRAM

A two phase program was carried out on part of mining claim #1224136, Cargill Township. Phase One consisted of 15 backhoe test holes along 3 sections, to determine the depth of overburden and subsequently the feasibility of stripping the area to facilitate geological mapping and possible future rock excavation for aggregate purposes and or economic mineral potential. A local backhoe and operator (Bob Lorenger), was contracted for a total of 4.5 hrs. under the supervision of Mr. Don Fudge. (appendix 'A'). The results of Phase One are shown in plan and profile form (MAP 1), this report.

Phase Two consisted of constructing an access trail south from the Ecclestone Road, and stripping an area approximately 70mX110m (7,700 sq. meters). The stripped area resulted in virtually 100% exposed bedrock upon completion. A drainage trench had to be excavated to drain standing water from the northwest part of the stripped area northward to the elevation of the swamp area. A total of 5 bedrock samples were taken in the stripped area. A north-south baseline was compassed and chained across the stripped area to provide control for the mapping and sampling. The results are shown in plan form (MAP 2), this report. All of the samples appeared to be of the same rock type, a highly metamorphosed granitic gneiss. All of the stripping and trenching was carried out in the central part of mining claim #1224136.

CONCLUSIONS AND RECOMMENDATIONS

Results of the stripping/geological mapping program, subject of this report indicate a favourable situation for possible future bedrock excavation for aggregate purposes. Crushing and analytical testing should be conducted to determine the suitability of the rock for commercial aggregate.

The bedrock geology of the limited stripped is interpreted to be a granitic gneiss and is not considered favourable for mineral and or diamond potential at this time. However, only a small portion of the claim was mapped and it is recommended that the remainder be mapped and or prospected with follow-up stripping/trenching if warranted.

CERTIFICATION

I, Raymond Joseph Meikle of Timmins, Ontario hereby certify that:

1. I hold a three year Technologist Diploma from the Haileybury School of Mines, Haileybury, Ontario, obtained in May 1975.

2. I have been practising my profession since 1973 in Ontario, Quebec, Nova Scotia, New Brunswick, Newfoundland, NWT, Manitoba, Germany and Chile.

3. I have been employed directly with Teck Corporation, Metallgesellschaft Canada Ltd. Sabina Industries, R.S. Middlêton Exploration Services Ltd., self employed 1979-1997 (Rayan Exploration Ltd.) and currently with Geophysical Engineering & Surveys Inc.

4. I have based conclusions and recommendations contained in this report on knowledge of the area, my previous experience and on the results of the field work conducted on the property May 1998.

5. I hold no interest, directly or indirectly in this property, nor do I expect to receive any interest or considerations from the property, other than for professional fees rendered.

Dated this 25th day of May, 1998
at Timmins, Ontario.

R.J. Meikle

APPENDIX 'A'

**Overburden Test Holes
PHASE ONE**

D.T. Fudge - 1 day supervision on site.....	\$ 400.00
Lachance Lumber -	\$ 802.50

Total	\$1202.50

BOIS A. LACHANCE LUMBER LTD.

C.P. / P.O. Box 3 • HARTY, ONTARIO P0L 1M0 • Tel. 705-335-3066 • FAX 705-335-3066



Date: Mars 12 1998

Vendu à: Ledges Associates
Sold to:

Adresse: 160 Bryan Rd.
Address:

Road Bay Rt PIC102

No Bon de commande: Purchase Order No.:
Date de la commande: Date of Order: <u>Mars 11 198</u>

QUANTITÉ QUANTITY	DESCRIPTION	PRIX UNITÉ UNIT PRICE	MONTANT AMOUNT
	<u>Re. Invoice 11453</u>		
	<u>Att: Don Fudge</u>		
<u>1 Shes.</u>	<u>2x4x8x6 Pine</u> <u>solid West Lake</u> <u>Excellent Imp.</u>	<u>100.00</u>	<u>750.00</u>

*Authorized
Oil
At Lumber*

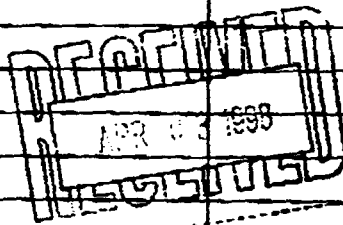

*Paid by Cheque
A 605 APRIL 8/98*

*Please Contact!
No Statement will be issued*

T.P.S. / G.S.T. # R-100-570-134

11461

sous total / sub-total	<u>750.00</u>
T.P.S. / G.S.T.	<u>52.50</u>
T.V.P. / P.S.T.	
TOTAL	<u>802.50</u>

1.5% Interest per month charged on overdue accounts
Intérêt de 1.5% par mois sur les comptes passés dûs

APPENDIX 'B'

Cost Breakdown - LEO ALARIE and SONS Limited
PHASE TWO

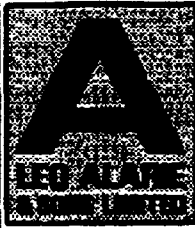

Leo Alarie and Sons Limited

General Contractors

Head Office: P.O. Box 912 Highway 101 West Timmins, ON P4N 7E1
 Phone: (705) 268-2106
 Operation Fax (705) 268-3571
 Administration Fax 268-2541

P.O. Box 130 Highway 11 Matheson, ON P0K 1N0
 Phone (705) 273-2436
 Fax (705) 273-2803

LCL Contracting
 Div. Leo Alarie & Sons Ltd
 P.O. Box 1660 Timmins, ON P4N 7W8
 Phone (705) 267-4020
 Fax (705) 264-0873

Stripping Rock - Mining Claim #1224136 Kapuskasing Access Trail & Mechanical Stripping

Date	Operator	Hours Worked			Total Costs
		Backhoe Operator	Dozer Operator	Rate	
5/6/98	Herve Blais	6.5		\$ 77.00	\$ 500.50
5/7/98	Herve Blais	5.0		\$ 77.00	\$ 385.00
	Herve Blais		6.5	\$ 112.00	\$ 728.00
	Marcel Cheff	9.0		\$ 77.00	\$ 693.00
5/8/98	Herve Blais		11.5	\$ 112.00	\$ 1,288.00
	Marcel Cheff	12.0		\$ 77.00	\$ 924.00
5/11/98	Herve Blais		11.5	\$ 112.00	\$ 1,288.00
	Marcel Cheff	11.5		\$ 77.00	\$ 885.50
5/12/98	Herve Blais		3.0	\$ 112.00	\$ 336.00
	Marcel Cheff	3.0		\$ 77.00	\$ 231.00
	Marcel Cheff		8.5	\$ 112.00	\$ 952.00
5/13/98	Herve Blais		11.5	\$ 112.00	\$ 1,288.00
	Marcel Cheff	11.5		\$ 77.00	\$ 885.50
5/14/98	Herve Blais		11.5	\$ 112.00	\$ 1,288.00
	Marcel Cheff	11.5		\$ 77.00	\$ 885.50
5/15/98	Herve Blais		7.0	\$ 112.00	\$ 784.00
	Marcel Cheff	7.0		\$ 77.00	\$ 539.00

Total Equipment Costs

\$ 13,881.00

6/6/98 Herve Blais Surveying 3.0 \$ 33.00 \$ 99.00

Total Surveying Costs

\$ 99.00

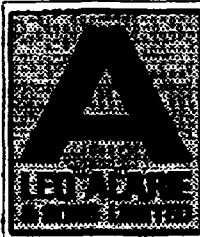

Leo Alarie and Sons Limited

General Contractors

Head Office: P.O. Box 912 P.O. Box 130 LCL Contracting
Highway 101 West Highway 11 Div. Leo Alarie & Sons Ltd
Timmins, ON P4N 7H1 Matheson, ON P.O. Box 1660
Phone: (705) 268-2106 POK 1N0 Timmins, ON P4N 7W8
Operation Fax (705) 268-3571 Phone (705) 273-2436 Phone (705) 267-4020
Administration Fax 268-2541 Fax (705) 273-2803 Fax (705) 264-0873

Stripping Rock - Mining Claim #1224136 Kapuskasing Transportation Costs

<u>Date</u>	<u>Description</u>	<u>Amount</u>
5/5/98	Mobilization & Demobilization - Backhoe	\$ 1,120.00
5/7/98	Mobilization & Demobilization - Dozer	\$ 1,200.00
	Backhoe Operator Travel 8 days @ 2 hrs/day @ \$33.50	\$ 536.00
	Bulldozer Operator Travel & Pick-up #5887 8 days @ 2 hrs/day @ \$38.60	\$ <u>617.60</u>
	Total Transportation Costs	\$ <u>3,473.60</u>

Food & Lodging

5/6/98	Room and Board - Herve Blais & Marcel Cheff 8 days X 2 men @ \$75/day	\$ <u>1,200.00</u>
	Costs (Before Tax)	\$ 18,653.60
	7% G.S.T.	\$ <u>1,305.75</u>
	Total Costs (Claim #1224136)	\$ <u>19,959.35</u>

APPENDIX 'C'

Cost Breakdown

**Geophysical Engineering & Surveys Inc.
PHASE TWO**

GEOPHYSICAL ENGINEERING & SURVEYS INC.

170 Second Avenue
P. O. Box 15
Timmins, Ontario
P4N 7C5

GST #875761264 RT

PHONE: (705) 268-4866

FAX: (705) 360-7733

MAY 26, 1998
JOB #G37
INV. #49-G37-1

**In Account With: FUDGE & ASSOCIATES
160 BRYAN ROAD
NORTH BAY, ONTARIO
P1C 1C2**

Invoice RE: CARGILL TOWNSHIP PROPERTY
CLAIM #1224136

At a Rate of:

GEOLOGICAL MAPPING & STRIPPING:

Ray Meikle - 1 day @ \$350.00/day.....\$ 350.00

TRUCK/GAS RENTAL:

1 DAY @ \$80.00/day.....\$ 80.00

REPORT & PLOTTING:\$ 450.00

Sub-total \$ 880.00

GST 61.60

TOTAL AMOUNT DUE \$ 941.60



Declaration of Assessment Work Performed on Mining Land

Mining Act, Subsection 65(2) and 66(3), R.S.O. 1990

Transaction Number (office use) W98000368 Assessment Files Research Imaging

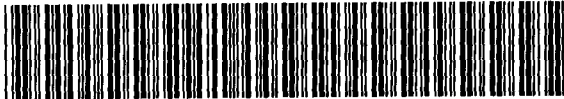

42G07SW2001 2.18530 CARGILL

900

Authority of subsections 65(2) and 66(3) of the Mining Act. Under section 8 of the used to review the assessment work and correspond with the mining land holder. Mining Recorder, Ministry of Northern Development and Mines, 6th Floor.

Instructions: - For work performed on Crown Lands before recording a claim, use form 0240. - Please type or print in ink.

1. Recorded holder(s) (Attach a list if necessary)

Name: Leo Alarie and Sons Limited, Client Number: 159410, Address: P.O. Box 1660 Timmins, Ont P4N-7W8, Telephone Number: 705-267-4020, Fax Number: 705-264-0873

2. Type of work performed: Check (✓) and report on only ONE of the following groups for this declaration.

Geotechnical: prospecting, surveys, assays and work under section 18 (regs) [checked], Physical: drilling, stripping, trenching and associated assays [unchecked], Rehabilitation [unchecked]. Work Type: Mapping & Report, Office Use: \$941, Dates Work Performed: 19 05 98 To 19 05 98, Township/Area: Cargill Twp, Mining Division: Porcupine, Resident Geologist District: Timmins

Please remember to: - obtain a work permit from the Ministry of Natural Resources as required; - provide proper notice to surface rights holders before starting work; - complete and attach a Statement of Costs, form 0212; - provide a map showing contiguous mining lands that are linked for assigning work; - include two copies of your technical report.

3. Person or companies who prepared the technical report (Attach a list if necessary)

Name: Ray Markle, Telephone Number: 705-268-4866, Address: 170 Second Ave Timmins Ont P4N-1G1, Fax Number: 705-360-7733. RECEIVED stamp: MAY 20 1998 11:38 AM GEOSCIENCE ASSESSMENT OFFICE

4. Certification by Recorded Holder or Agent

I, DON FUDGE (Print Name), do hereby certify that I have personal knowledge of the facts set forth in this Declaration of Assessment Work having caused the work to be performed or witnessed the same during or after its completion and, to the best of my knowledge, the annexed report is true.

Signature of Recorded Holder or Agent: [Signature], Date: 28/05/98, Agent's Address: 160 BRYAN ROAD NORTH BAY, ONTARIO, Telephone Number: 705-472-3053, Fax Number: 705-472-9244, Donated Area 23/192

Work to be recorded and distributed. Work can only be assigned to claims that are contiguous (adjoining) to the mining land where work was performed, at the time work was performed. A map showing the contiguous link must accompany this form.

W9800.00568

Mining Claim Number. Or if work was done on other eligible mining land, show in this column the location number indicated on the claim map.	Number of Claim Units. For other mining land, list hectares.	Value of work performed on this claim or other mining land.	Value of work applied to this claim.	Value of work assigned to other mining claims.	Bank. Value of work to be distributed at a future date.
eg TB 7827	16 ha	\$26,825	N/A	\$24,000	\$2,825
eg 1234567	12	0	\$24,000	0	0
eg 1234568	2	\$8,892	\$4,000	0	\$4,892
1 1229136	16	941			941
2					
3					
4					
5					
6					
7					
8					
9					
10					
11					
12					
13					
14					
15					
Column Totals		941			941

I, DON FUDGE (Print Full Name), do hereby certify that the above work credits are eligible under subsection 7 (1) of the Assessment Work Regulation 6/96 for assignment to contiguous claims or for application to the claim where the work was done.

Signature of Recorded Holder or Agent Authorized in Writing: [Signature] AGENT Date: 28/05/98

6. Instructions for cutting back credits that are not approved.
- Some of the credits claimed in this declaration may be cut back. Please check (✓) in the boxes below to show how you wish to prioritize the deletion of credits:
- 1. Credits are to be cut back from the Bank first, followed by option 2 or 3 or 4 as indicated.
 - 2. Credits are to be cut back starting with the claims listed last, working backwards; or
 - 3. Credits are to be cut back equally over all claims listed in this declaration; or
 - 4. Credits are to be cut back as prioritized on the attached appendix or as follows (describe):

RECEIVED
MAY 29 1998
11:38 AM
GEOSCIENCE ASSESSMENT
OFFICE

Note: If you have not indicated how your credits are to be deleted, credits will be cut back from the Bank first, followed by option number 2 if necessary.

For Office Use Only

Received Stamp	Deemed Approved Date	Date Notification Sent
	Date Approved	Total Value of Credit Approved
Approved for Recording by Mining Recorder (Signature)		



Declaration of Assessment Work Performed on Mining Land

Mining Act, Subsection 65(2) and 66(3), R.S.O. 1990

Transaction Number (office use) W 9860 00569 Assessment Files Research Imaging

Personal information collected on this form is obtained under the authority of subsections 65(2) and 66(3) of the Mining Act. Under section 8 of the Mining Act, the information is a public record. This information will be used to review the assessment work and correspond with the mining land holder. Questions about this collection should be directed to the Chief Mining Recorder, Ministry of Northern Development and Mines, 8th Floor, 933 Ramsey Lake Road, Sudbury, Ontario, P3E 6B5.

Instructions: - For work performed on Crown Lands before recording a claim, use form 0240. - Please type or print in ink.

1. Recorded holder(s) (Attach a list if necessary)

Name: Leo Aarve and Sons Limited; Client Number: 15 94 10; Address: P.O. Box 1660 Timmins, Ont P4N-7W8; Telephone Number: 705-267-4020; Fax Number: 705 264-0873

2. Type of work performed: Check (✓) and report on only ONE of the following groups for this declaration.

Geotechnical: [] Physical: [x] Rehabilitation: [] Work Type: Stripping; Office Use: []; Dates Work Performed: From 11/05/98 to 05/05/98; Mining Division: Porcupine; Resident Geologist District: Timmins

Please remember to: - obtain a work permit from the Ministry of Natural Resources as required; - provide proper notice to surface rights holders before starting work; - complete and attach a Statement of Costs, form 0212; - provide a map showing contiguous mining lands that are linked for assigning work; - include two copies of your technical report.

3. Person or companies who prepared the technical report (Attach a list if necessary)

Name: Ray Meikle; Telephone Number: 705-268-4866; Address: 170 Second Ave Timmins, Ont P4N-1G1; Fax Number: 705-360-7733

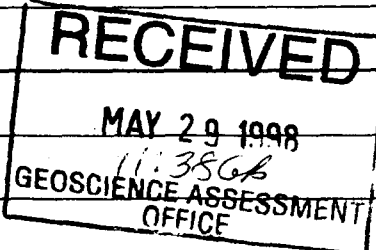

4. Certification by Recorded Holder or Agent

I, DON FUDGE (Print Name), do hereby certify that I have personal knowledge of the facts set forth in this Declaration of Assessment Work having caused the work to be performed or witnessed the same during or after its completion and, to the best of my knowledge, the annexed report is true.

Signature of Recorded Holder or Agent: [Signature] AGENT; Date: 28/05/98; Agent's Address: 160 BRYAN ROAD NORTH BAY, ONTARIO; Telephone Number: 705 477-3053; Fax Number: 705 472 9244

Donned Aug. 31/98

5. Work to be recorded and distributed. Work can only be assigned to claims that are contiguous (adjoining) to the mining land where work was performed, at the time work was performed. A map showing the contiguous link must accompany this form.

W9860. 00569

Mining Claim Number. Or if work was done on other eligible mining land, show in this column the location number indicated on the claim map.	Number of Claim Units. For other mining land, list hectares.	Value of work performed on this claim or other mining land.	Value of work applied to this claim.	Value of work assigned to other mining claims.	Bank. Value of work to be distributed at a future date.
eg TB 7827	16 ha	\$26,825	N/A	\$24,000	\$2,825
eg 1234567	12	0	\$24,000	0	0
eg 1234568	2	\$8,892	\$4,000	0	\$4,892
1 1224136	16	21161	6400		14761
2					
3					
4					
5			2		
6					
7					
8					
9					
10					
11					
12					
13					
14					
15					
Column Totals		21161	6400		14761

I, DON FUDGE, do hereby certify that the above work credits are eligible under subsection 7 (1) of the Assessment Work Regulation 6/96 for assignment to contiguous claims or for application to the claim where the work was done.

Signature of Recorder Holder or Agent Authorized in Writing: [Signature] AGENT Date: 28/05/98

6. Instructions for cutting back credits that are not approved.
- Some of the credits claimed in this declaration may be cut back. Please check (✓) in the boxes below to show how you wish to prioritize the deletion of credits:
- 1. Credits are to be cut back from the Bank first, followed by option 2 or 3 or 4 as indicated.
 - 2. Credits are to be cut back starting with the claims listed last, working backwards; or
 - 3. Credits are to be cut back equally over all claims listed in this declaration; or
 - 4. Credits are to be cut back as prioritized on the attached appendix or as follows (describe):

Note: If you have not indicated how your credits are to be deleted, credits will be cut back from the Bank first, followed by option number 2 if necessary.

For Office Use Only Received Stamp	RECEIVED MAY 29 1998 11:38 AM GEOSCIENCE ASSESSMENT OFFICE	Deemed Approved Date	Date Notification Sent
		Date Approved	Total Value of Credit Approved
Approved for Recording by Mining Recorder (Signature)			

Ministry of
Northern Development
and Mines

Ministère du
Développement du Nord
et des Mines



Geoscience Assessment Office
933 Ramsey Lake Road
6th Floor
Sudbury, Ontario
P3E 6B5

Telephone: (888) 415-9846
Fax: (877) 670-1555

September 9, 1998

LEO ALARIE AND SONS LIMITED
BOX 1660
TIMMINS, Ontario
P4N-7W8

Visit our website at:
www.gov.on.ca/MNDM/MINES/LANDS/mlsmnpge.htm

Dear Sir or Madam:

Submission Number: 2.18530

Status

Subject: Transaction Number(s): W9860.00568 Deemed Approval
W9860.00569 Deemed Approval

We have reviewed your Assessment Work submission with the above noted Transaction Number(s). The attached summary page(s) indicate the results of the review. **WE RECOMMEND YOU READ THIS SUMMARY FOR THE DETAILS PERTAINING TO YOUR ASSESSMENT WORK.**

If the status for a transaction is a 45 Day Notice, the summary will outline the reasons for the notice, and any steps you can take to remedy deficiencies. The 90-day deemed approval provision, subsection 6(7) of the Assessment Work Regulation, will no longer be in effect for assessment work which has received a 45 Day Notice. Allowable changes to your credit distribution can be made by contacting the Geoscience Assessment Office within this 45 Day period, otherwise assessment credit will be cut back and distributed as outlined in Section #6 of the Declaration of Assessment work form.

Please note any revisions must be submitted in **DUPLICATE** to the Geoscience Assessment Office, by the response date on the summary.

If you have any questions regarding this correspondence, please contact Lucille Jerome by e-mail at jeromel2@epo.gov.on.ca or by telephone at (705) 670-5858.

Yours sincerely,

A handwritten signature in black ink, appearing to read "Blair Kite".

ORIGINAL SIGNED BY
Blair Kite
Supervisor, Geoscience Assessment Office
Mining Lands Section

Work Report Assessment Results

Submission Number: 2.18530

Date Correspondence Sent: September 09, 1998

Assessor: Lucille Jerome

Transaction Number	First Claim Number	Township(s) / Area(s)	Status	Approval Date
W9860.00568	1224136	CARGILL	Deemed Approval	August 27, 1998

Section:
12 Geological GEOL

Transaction Number	First Claim Number	Township(s) / Area(s)	Status	Approval Date
W9860.00569	1224136	CARGILL	Deemed Approval	August 27, 1998

Section:
10 Physical PSTRIIP

Correspondence to:
Resident Geologist
South Porcupine, ON

Assessment Files Library
Sudbury, ON

Recorded Holder(s) and/or Agent(s):
Don T. Fudge
NORTH BAY, ON, CAN

LEO ALARIE AND SONS LIMITED
TIMMINS, Ontario

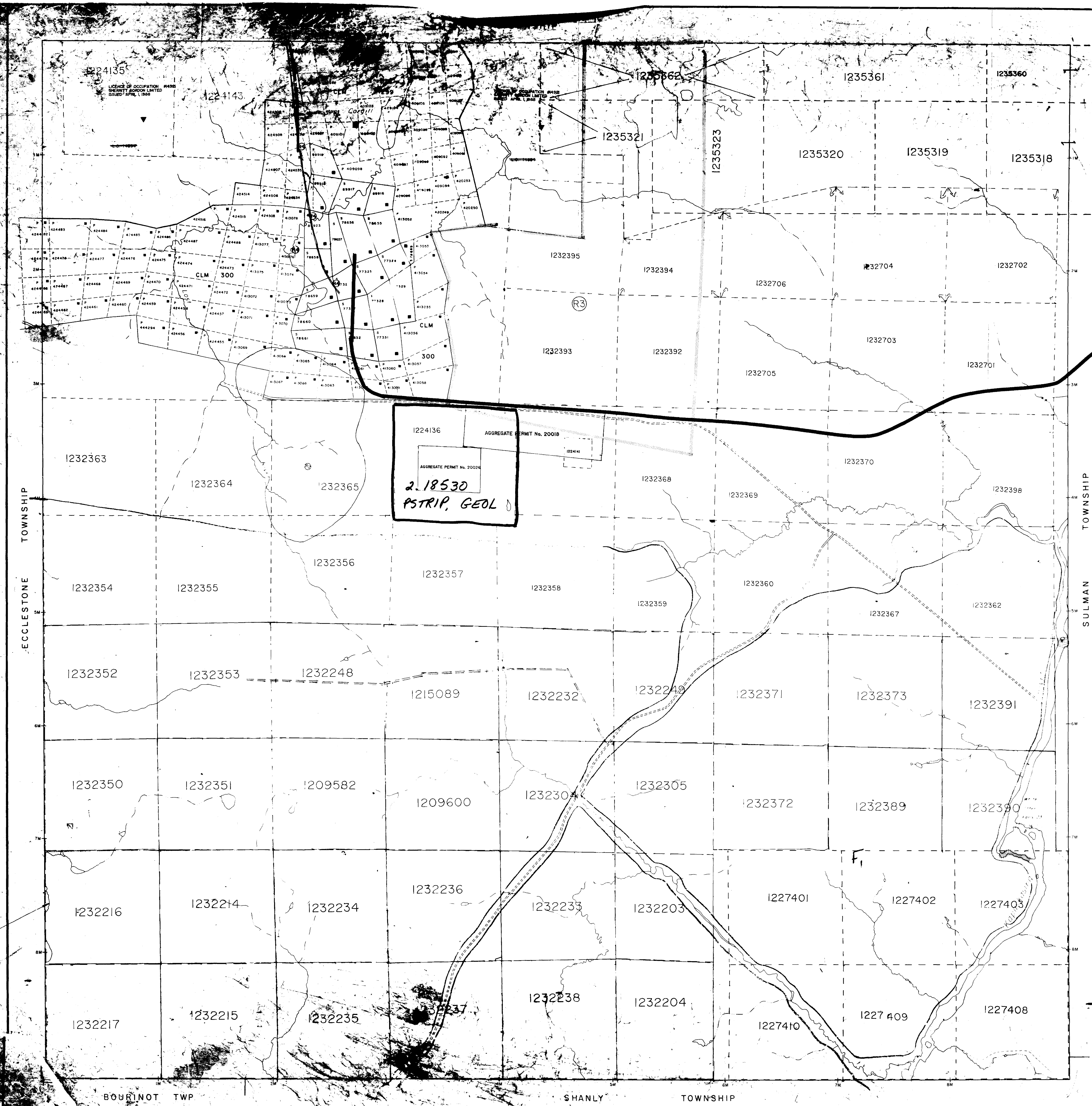

LEGEND

HIGHWAY AND ROUTE NO.
OTHER ROADS
RAILS
SURVEYED LINES
TOWNSHIP BOUNDARIES ETC.
MINE CLAIMS, PARCELS, ETC.
UNSURVEYED LINES
PROPERTY BOUNDARY
MINING CLAIMS ETC.
RAILWAY AND RIGHT OF WAY
UTILITY LINES
NON PERENNIAL STREAM
FLOODING OR FLOODING RIGHTS
SUBDIVISION OR COMPORTE PLAN
RESERVATIONS
ORIGINAL SHORELINE
MARSH OR MUSKEG
MINES
TRAVERSEMENT

DISPOSITION OF CROWN LANDS

TYPE OF DOCUMENT

PATENT, SURFACE & MINING RIGHTS
SURFACE RIGHTS ONLY
MINING RIGHTS ONLY
LEASE SURFACE & MINING RIGHTS
SURFACE RIGHTS ONLY
MINING RIGHTS ONLY
LICENSE OF OCCUPATION
ORDNANCE IN COUNCIL
RESERVATION
CANCELLED
SAND & GRAVEL

NOTE: MINING RIGHTS IN PARCELS PAID FOR BY THE LAND ACT, R.S.O. 1990, CAP. 28, SECTION 11.

10 0 10 20 30 40 50 60 70 80 90 100

100 0 1000 2000 3000 4000

DATE OF ISSUE
JUL 0 6 1988
PROVINCIAL RECORDING
OFFICE - SUDBURY

NO.

IF ACTIVITIES IN
AVAILABLE ON

*F1 - THIS PARCEL
SUBJECT TO FORESTAL
ACTIVITY IN 1974/75
P.C.*

SEC.35 W.P.22/87 MER 3/2/87
SEC.35 W.P.19/88 22/04/88 M.S. 1/88

PENDING APPLICATION UNDER THE P.L.A.
FOR PIPELINE EASEMENT

PENDING APPLICATION UNDER THE P.L.A.
FOR PIPELINE EASEMENT

TOWNSHIP
CARGILL
M.N.R. ADMINISTRATIVE DISTRICT
KAPUSKASING
MINING DIVISION
PORCUPINE
LAND TITLES / REGISTRY DIVISION
COCHRANE

Ministry of
Natural Resources
Ontario

DEC 1988
Checked Feb 08/89 J.P.

Plan of Survey Location
Notice Received 92-Nov-86
Sudbury Falls, Inc.

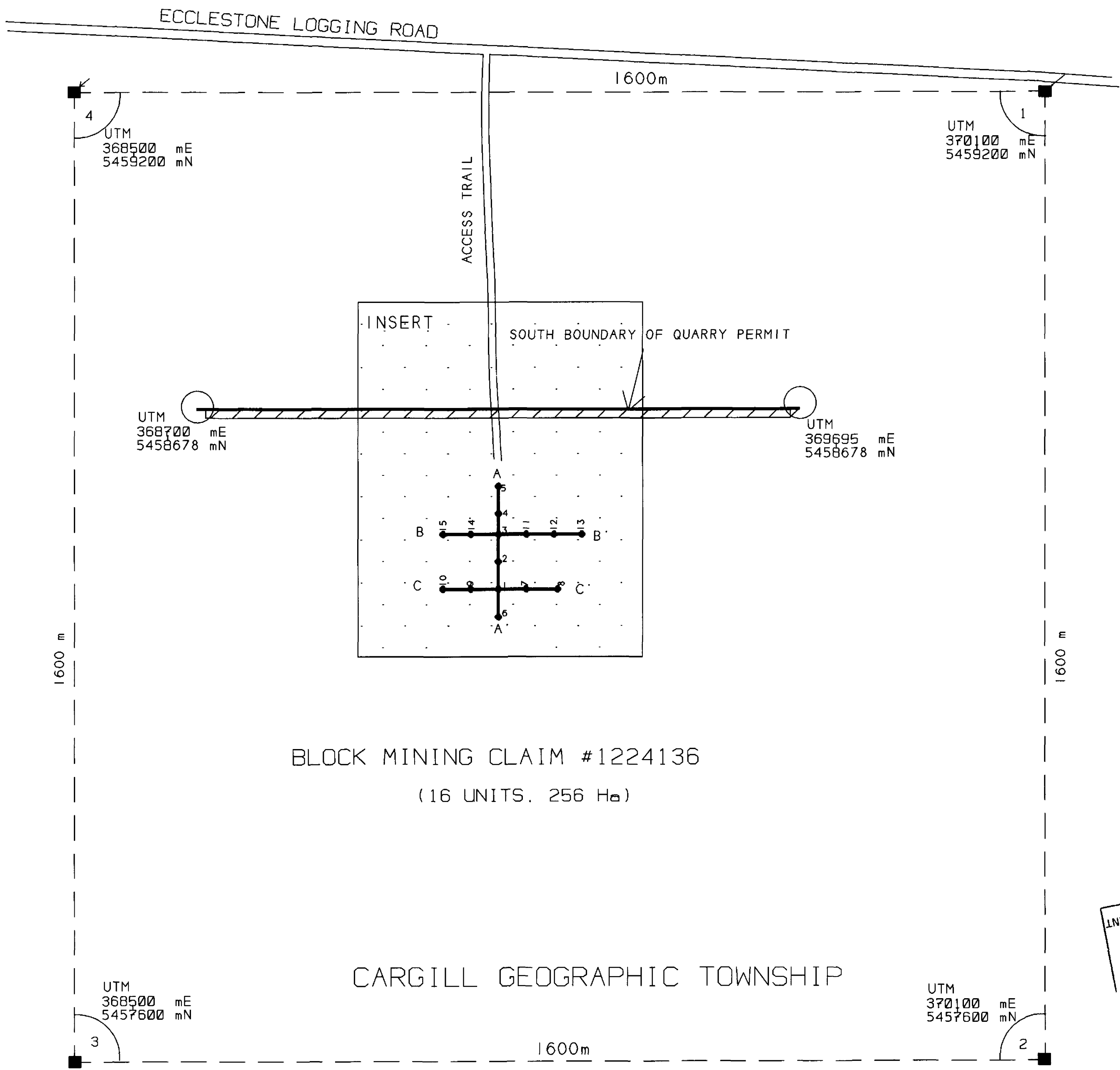

RECEIVED
MAY 29 1998
GEOLOGICAL ASSESSMENT
OFFICE

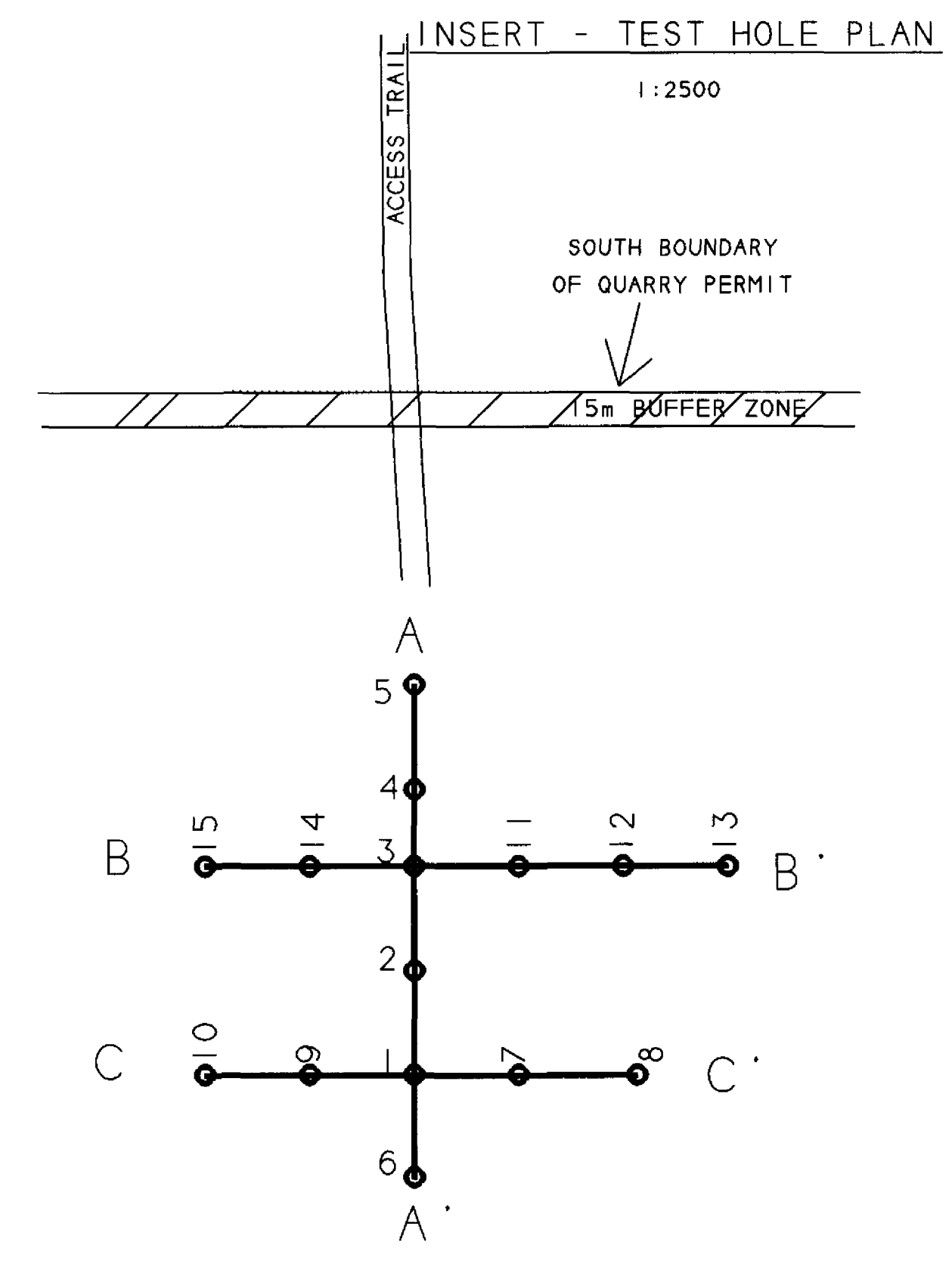

HOLE#	OVB. (m)
1	0.5m
2	0.5m
3	0.5m
4	0.5m
5	2.8(no brk)
6	1.2m
7	1.2m
8	no brk.
9	1.0m
10	2.0m
11	2.0m
12	0.5m
13	0.5m
14	2.0m
15	2.0m

LEGEND

- MINING CLAIM POST ■
- MINING CLAIM BOUNDARY — — —
- SWAMP



Client: LEO ALARIE & SONS LIMITED

Property: CARGILL TOWNSHIP PROPERTY

Title: PHASE ONE
OVERBURDEN TEST HOLE
PLAN MAP MAP NO. 1

Processed: R. J. MEIKLE
Date: MAY 1998
Province: ONTARIO

Scale: 1:5000

GEOLOGICAL ENGINEERING & SURVEYS INC.
TOWNSHIP, ONTARIO

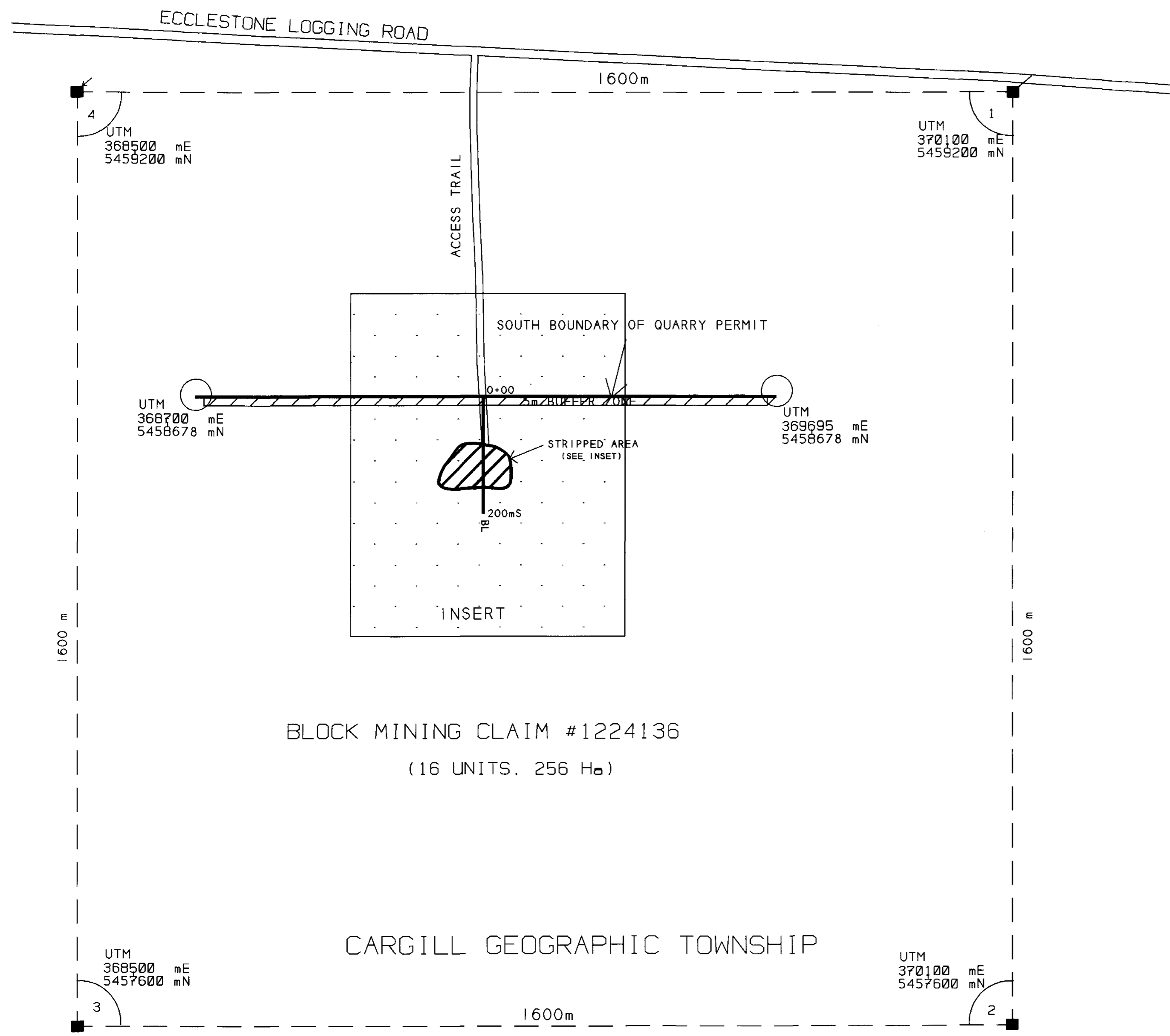

BLOCK MINING CLAIM #1224136
(16 UNITS, 256 Ha)

CARGILL GEOGRAPHIC TOWNSHIP

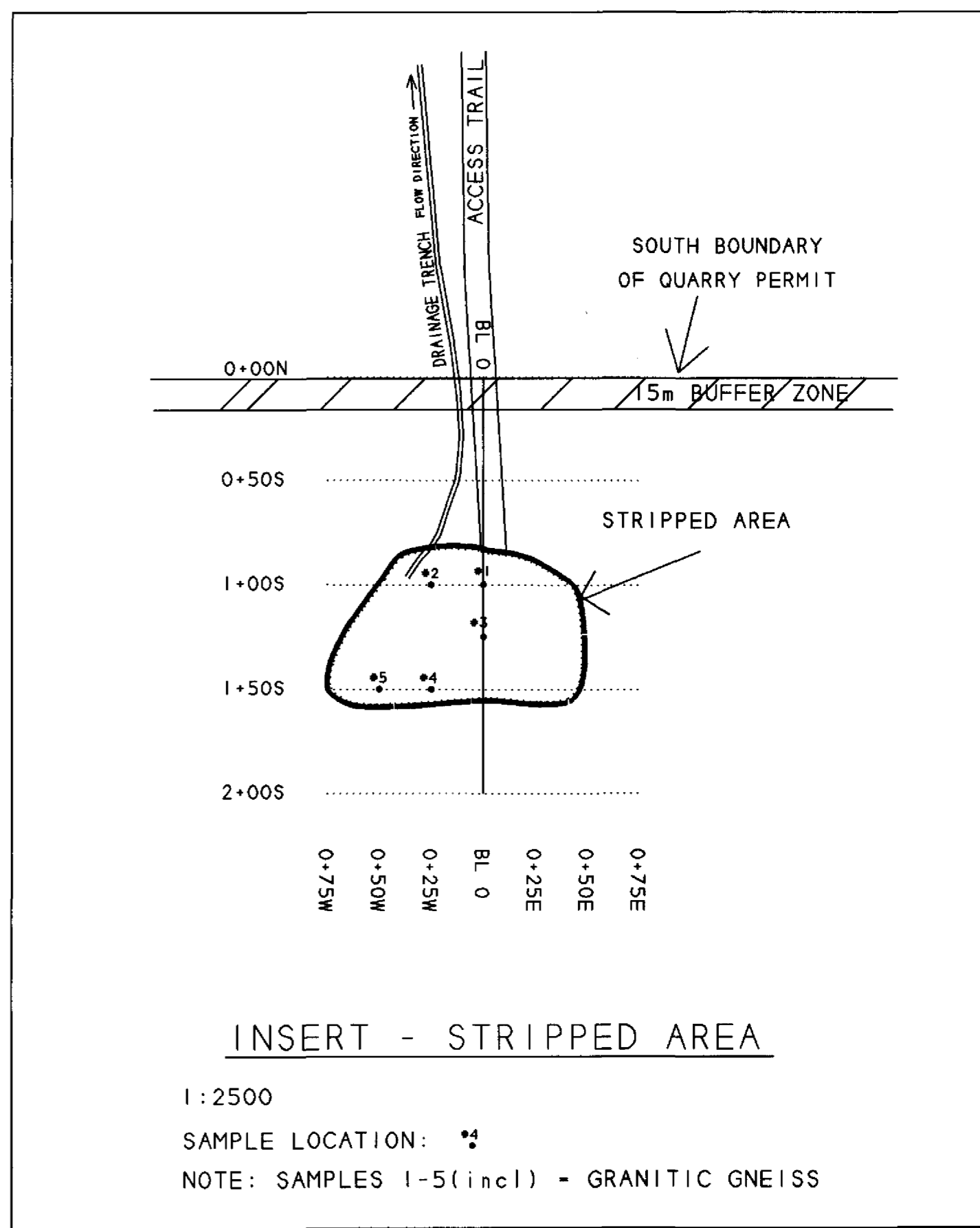

1:2500
SAMPLE LOCATION: *
NOTE: SAMPLES 1-5 (incl) - GRANITIC GNEISS

RECEIVED
MAY 29 1998
GEOLOGICAL ASSESSMENT
OFFICE

LEGEND

- MINING CLAIM POST ■
- MINING CLAIM BOUNDARY
- SWAMP
- STRIPPED AREA:



Client:	LEO ALARIE & SONS LIMITED
Property:	CARGILL TOWNSHIP PROPERTY
Title:	PHASE TWO STRIPPING/GEOLOGICAL MAPPING PLAN MAP MAP NO. 2
Processed:	R. J. MEIKLE
Date:	MAY 1998
Province:	ONTARIO
Scale:	1:5000

GEOLOGICAL ENGINEERING
&
SURVEYS INC.
TIMING, ONTARIO
TEL. (705) 296-8888

