



42G10SE0006 63.3896 MCCOWAN

010

PRELIMINARY REPORT

MILLER CLAIMS, MCCOWAN TOWNSHIP

DISTRICT OF ALGOMA, ONTARIO

PRELIMINARY REPORT

7-723

ON

MILLER CLAIMS, McCOWAN TOWNSHIP

DISTRICT OF ALGOMA, ONTARIO

INTRODUCTION

Examination of this group of claims was made on May 8th, 9th, 10th, and 11th, 1938. The trip was made by highway to a point fourteen miles east of Mattice, on the Ferguson Highway and then on foot to the property.

PROPERTY

The property consists of a group of twenty-nine contiguous mining claims of approximately 37.5 acres each. These claims are designated by the following numbers, S.31333, 31332, 31331, 31392, 31391, 31390, 31429, 31428, 31253, 31216, 31221, 31220, 31217, 31218, 31140, 31219, 31214, 31215, 29333, 28991, 27114, 29033, 29032, 27115, 31321, 31320, and three others which have not yet been recorded but which will tie in the most northerly portion of the claims to the main portion.

LOCATION

This group is located in McCowan township, District of Algoma, Ontario. It is about 3.5 miles north of the Ferguson Highway at a point 14 miles east of Mattice and is in the general locality of lot 12, Concession 2.

ACCESSIBILITY

A wagon road extends to within 2 miles of the property and a well cut trail leads through to the claims from this road.

TOPOGRAPHY

The general relief of the area is low lying with

low sand ridges running in a more or less east to west direction. There are very few outcroppings of rock.

TIMBER AND WATER

Timber for mining and fuel purposes is plentiful. Water for primary development purposes is plentiful at present, in the swamp.

GENERAL GEOLOGY AND DEVELOPMENT

The greater portion of the area is covered by overburden, which seems to vary between a few inches and about 15 feet in depth.

Outcroppings are few and as a result, nearly all geological information had to be gathered from the pits and trenches which have been dug.

The country rock is a greywacke, which on claim S.28991 is very much like a slate in appearance. This greywacke has been intruded by quartz porphyry which is to be found in a pit in the swamp towards the southern portion of claim S.29333 and which outcrops on claims S.27114 and 28991.

On claim 29333, stripping and test-pitting have revealed vein matter, about 4 feet in width, which carries considerable galena, arsenopyrite and pyrite. Samples taken from this pit and assayed by Sims and Suzuki gave \$6.65 in gold and 1.07 ounces of silver per ton. This pit was full of water and no channel sample could be taken.

A channel sample taken from a stringer in the porphyry on claim 28991 gave an assay of 2.65 ounces of gold per ton (\$2.75). This sample was one foot in length.

T-223

Vein material thrown up on the side of a pit on the contact of the porphyry and the greywacke shows a heavy mineralization of pyrite and chalcopryrite but as this pit was also full of water, it was impossible to take a satisfactory sample.

There has also been some work done on the north eastern portion of the group, but due to water in the trench, I was not able to determine the formation at this point.

The porphyries to be found on this group are probably Algoman. The ore minerals are probably genetically related to this porphyry.

SUMMARY AND ADVISEMENT

The combination of sediments and the porphyry as they are to be found here, are very favourable to the deposition of gold and silver.

It is my opinion that this property is well worth a careful examination.

Because of the swampy character of the overburden on the property, a series of shallow diamond drill holes is the only practical method of making such an examination.

(Signed)

P.C.Carter, B.A. Sc.

R. Miller



42G10SE0006 63.3896 MCCOWAN

020

SYLVANITE GOLD
(No Personal Liability)
EXPLORATION DEPARTMENT

Copy filed 69

R. Miller Property
McGowan Township

Location

The Miller group consisting of seventeen claims, 27114 - 15, 28997, 29032 - 33, 29333, 31140, 31214 - 15 - 16 - 17 - 18 - 21, 31936 - 37 - 38, 31653, is situated in McGowan Township, 25 miles west of Kapuskasing.

Geology

The claims being largely overlain by overburden not much development work or prospecting has been carried out.

A 4 to 5-foot shear zone in greywacke striking N 70° E and dipping 80° N has been trenched for a length of 75 feet. The shear has been silicified and is mineralized with pyrite, arsenopyrite with minor galena. Two grab samples of the better looking material returned 2.00 and 0.40 dwts.

Conclusion

The property does not merit further attention.

D. K. Burke.

Kirkland Lake, Ontario,
June 21, 1939.

TIMMINS

Geological - Economic

- (a) Is there more than one "ore zone" or probable "ore zone" on the property? *one*
 Give the claim numbers on which each occurs. *27.8.87*
29.333
- (b) What is the dip and strike of the "ore zone"? *N.E. + W.*
- (c) Is the "ore zone": *DIP 80° S*
 - (i) a quartz vein? *QUARTZ + SEDIMENT*
 - (ii) a series of parallel quartz veins?
 - (iii) a series of relatively short quartz lenses?
 - (iv) a shear zone carrying quartz veins or stringers?
 - (v) a shear zone carrying sulphide bands or lenses?
 - (vi) a shear zone carrying disseminated sulphides?
 - (vii) a carbonate zone carrying disseminated sulphides?
 - (viii) a carbonate zone carrying quartz veinlets?
 - (ix) a mineralized porphyry dyke?
 - (x) a porphyry dyke cut by a stockworks of stringers?
 - (xi) The contact zone between an intrusive dyke or mass and the country rock?
- (d) In a general way what minerals are present in the "ore"? *Arrenopyrite, Galena, Pyrite*
 Is the gold associated with one or more of these minerals and if so, which ones?
 Is there much talc, chlorite, or fine mica in the ore?
 Is there graphite present in appreciable quantities?
- (e) How is the ore developed?
 - (i) by trenching and stripping?
 - (ii) by diamond drilling?
 - (iii) by shaft and underground workings?
 - (iv) what is the depth of the shaft and the footwall on each level?
- (f) Is there a mill on the property and if so what is its capacity?
- (g) Does the ore occur in short or long shoots?
- (h) What are the average grades and widths of the ore shoots developed?
 - (i) What are the lengths of the ore shoots?
 - (j) To what depth is the ore proven?
 - (k) What is the degree of rake of the ore and in what direction?
- (l) Is the ore badly cut up by cross faults?
- (m) Is it interrupted by dykes?
- (n) Is it cut off by strike faulting?
- (o) Is there any peculiar feature to the ore or structure which might unduly influence costs or extraction, if so what?
- (p) What method of mining is used?
- (q) What is the general mill practice?

Swamp CLAIM NO 27887 NORTH

Swamp

Swamp TOILET

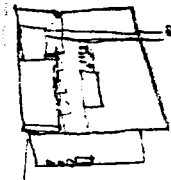

CABIN

TRAIL

BLACKSMITH SHOP

PIT NO 1 8' DEEP

17" / 400

84" / 800

88" / 800

88" / 800

88" / 800

88" / 800

88" / 800

88" / 800

88" / 800

88" / 800

88" / 800

88" / 800

88" / 800

88" / 800

88" / 800

88" / 800

88" / 800

88" / 800

88" / 800

Clearing for contact about here

Drainage TR

outlet of shaft

PIT CLAIM TO BE FOUND PHOSPHRY IN THIS PIT

App 15 chs

5 29333

PIT NO 2 4' DEEP

015 / 36"

014 / 24"

013 / 24"

012 / 18"

016 / 24"

017 / 24"

PICKET LINE

open

open

32042 -

32048 -

31978 ✓

32041 -

31974 -

32040 -

31310 -

31975 -

31309 -

31973 -

31308 -

31976 -

31237 -

31977 -

McManus
27887 ✓

← DP_H Jukis
31218

27115 -

Millers
29333 - ↘ DP_H

↙ DP_H 31217

31215 ✓ ← DP_H

DP_H 31938 ← DP_H

31214 ✓ ↘ DP_H

↙ DP_H 31936

27114 -

31937 ✓ ← DP_H

DP_H 31216
← DP_H Jukis

28991 ✓

31140 ✓ ↘ DP_H

↙ DP_H 31258

Sample No 71001 ^{East side of Pit No 1} Cut from EAST SIDE OF
PIT NO. 1. 30" well Min galena and arseno
Strike E. + W DIP 85° N. QTZ + Sedi
No 71002, 23" cut south of No 001 same
Min formation Dip + Strike
No 003 cut south of 002 24" Dip Strike Min
+ formation Same
^{west side of pit}
No 004 cut on south end of pit 17" same Min
formation Dip + Strike
No 005 24" cut north of No 004 same
Min formation Dip + Strike
No 006, 28" cut north of No 005 same
Min Dip Strike + formations
No 007 Grab from T-2 at north of pit No 1
10' from Pit quartz well Min arseno
No 008 Grab from Hanging wall
sediment some arseno

McMannus

Deep pit

Pit No 2

Sample No 71012, 18" Cut from North end
of pit 70% QTZ 30% sediment Considerable Pb
and arsenopyrites Dip 75° North Strike E. W.

No 71013, 24" Mostly sediments Some QTZ. Some
Arseno Dip 75° N Strike E W.

No 71014, 24" Min Strike Dip & formation
Same as 013

No 71015, 36" Quartz some chlorite and
arseno Dip 75° N Strike E. W.

No 71016, 24" QTZ Min Strike & Dip same as
015

No 71017, 24" Quartz & sediment well Min
Arsenopyrites Strike E. W. DIP 75° N

McNamee

North Pit

527887

- Sample No. 71009. Grab from ^{QTZ} Long Tr well
Min arsenopyrite - Some galena
- No 71010 Grab from Long Tr ^{QTZ} well Min
arseno + Pb
- No 71011 Grab from Long Tr well Min ^{QTZ}
+ Sedi arseno.
- No 71018. 27" Quartz well Min galena +
arsenopyrite surface sample
- No 71019. 24" Quartz + ^{sedi} massive sulphides
- No 71020. 12" Shaded sediment well - Min
arsenopyrites
- No 71021 Grab from Pit at end of Long
Tr ^{QTZ} + Sedi well Min Pb + arseno
- No 71022 Grab from Pit. at end of Long
Tr Quartz well Min arseno + galena

These are from Long Tr on claim

29333

11/10

SYLVANITE GOLD MINES, LIMITED

ASSAY SHEET

From Special Exploration Department Date July 2nd 1941

SAMPLE No.	DESCRIPTION	WIDTH	VALUE PER TON
710 01	Special Ex Dept Ward	✓	2
02	-	✓	2
03	-	✓	2.50
04	-	✓	2
05	-	✓	5.60
06	-	✓	.25
07	-	✓	.40
08	-	✓	.70
09	-	✓	2
10	-	✓	2
11	-	✓	2
12	-	✓	.50
13	-	✓	2
14	-	✓	2
15	-	✓	2
16	-	✓	9.50
17	-	✓	.60
18	-	✓	2
19	-	✓	2
20	-	✓	2
21	-	-	.40
22	-	-	Assayer

NORTHERN NEWS PRINT

[Handwritten Signature]

M-22

SYLVANITE GOLD MINES, LIMITED ASSAY SHEET

From *Special Exploration Department* Date *July 7th 1941*

SAMPLE No.	DESCRIPTION	WIDTH	VALUE PER TON
7207	<i>Special Ex Dept Ward</i>	✓	<i>80</i>
77	-	✓	<i>2</i>
78	-	✓	<i>2</i>
79	-	✓	<i>2</i>
80	-	✓	<i>2</i>
81	-	✓	<i>2</i>
82	-	✓	<i>2</i>
83	-	✓	<i>2</i>
84	-	✓	<i>2</i>
85	-	✓	<i>2</i>
86	-	✓	<i>2</i>
87	-	✓	<i>2</i>
88	-	? *	<i>5.60</i>
89	-	? *	<i>1.20</i>
90	-	✓	<i>2</i>
91	-	✓	<i>1.60</i>
92	-	✓	<i>1.20</i>
93	-	✓	<i>2</i>
94	-	✓	<i>19.40</i>
95	-	✓	<i>2</i>
<small>NORTHERN NEWS PRINT</small>			
96	-	✓	<i>16</i>
97	-	✓	<i>Assayer</i>
98	-	✓	<i>2</i>

[Handwritten signature]



42G10SE0006 63.3896 MCCOWAN

030

MILLER CLAIMS
McCowan Township
Sudbury Mining Division

Introduction:

Examination of the Miller Claims, McCowan Twp., made on September 21, 1948, in company with S. J. Terhune, mining engineer for Aunor Gold Mines Ltd., Dan Fillion of Mattice, prospector, and J. Anderchuck of Timmins, diamond driller. The examination consisted of logging the core from two holes which had been completed, and making a tape and compass survey of the showings.

Two diamond drill holes subsequently drilled were not examined.

Property, Location & Access:

The property consists of a large block of unpatented claims, approximately 40 in number, lying between lots 13 and 20 in concessions I & II of McCowan Twp. Diamond drilling and the surface showings, are all confined to the S.E. $\frac{1}{4}$, S $\frac{1}{2}$ lot 13, Con. II.

The property is reached by a tractor road from No. 11 Highway at a point about 14 miles east of Mattice, and 3 miles east of Lowther. The distance to the property from the highway is approximately 3 $\frac{1}{2}$ miles.

Topography:

The general area is one of low relief, with few rock outcrops. The elevation above sea level at Lowther is 820 feet. Clay soil overlies the rock to varying depths, but in most of the area it is not greater than 20 feet, and in many places, rock can be exposed by trenching.

Geology:

The general geology is shown on maps 411A and 412A, the Hearst-Kapuskasing Area, published by the Department of Mines & Resources at Ottawa. It shows the principal rocks to be granites and ortho-gneisses, with patches of highly altered sediments and basic lavas.

The southern portion of McCowan Township is underlain to a large extent by highly metamorphosed sediments with minor amounts of basic lava.

T-223

MILLER CLAIMS (cont'd)
McCowan Township
Sudbury Mining Division

Page 2.

On the Miller property, exposures of rock are confined to one small outcrop and several pits and trenches, as shown on the accompanying plan. The rock is a metamorphosed, hard, siliceous greywacke, striking about N65°E, and dipping vertically. It is cut by narrow dykes of quartz porphyry, which has no visible feldspar phenocrysts, but occasional "eyes" of quartz. These narrow dykes appear to have a strike and dip roughly parallel to the sediments.

Diamond drill holes 1 and 2 intersected siliceous greywacke, cut by narrow dykes of quartz porphyry.

Description of Showings:

The boundary line between claims S49908, and S27887 (which is not included in the Miller Group) could not be located in the field, and as a result it could not be determined definitely which pits were on the property and which were on the adjoining claim. The boundary line between lots 12 & 13 was found, and the boundary between the east and west halves of lot 13 was established approximately from it, as shown on the plan.

The trenching is mostly old work carried out by previous owners and at the time of the present examination, much of it was covered by caving, or filled with water.

In the east pit, only greywacke with a few minor quartz stringers was visible. This pit was cleaned out, and some recent blasting had been done.

The central pit, 400 feet further west, appears to be on the patented claim, outside the Miller property. In it, a vein of white quartz 4½ feet wide is exposed, striking N80°E. The quartz is very sparsely mineralized with small blebs of chalcopyrite and galena. The wallrock is silicified greywacke, and for a couple of feet on each side of the vein, is well mineralized with pyrite and arsenopyrite in disseminated crystals.

A character sample of the quartz vein, weighing about 20 pounds, and containing some mineralization, assayed a trace in gold. A sample of mineralized wall rock, also weighing about 20 pounds, assayed a trace in gold.

MILLER CLAIMS (cont'd)
McCowan Township
Sudbury Mining Division

The west pit is definitely on the patented claims and is not included in the Miller group. It was filled with water at the time of this examination, but had been previously examined by S. J. Terhune for Aunor Gold Mines. Mr. Terhune's report shows a 6 foot quartz vein striking east-west through the centre of the pit, with silicified greywacke in the walls. 3 channel samples cut along the west wall in the vein are reported to have assayed as follows:

- 1. Tr. / 2.5'
- 2. 0.22 oz. / 2.4 ft. 0.12 oz. / 2.4 ft.
(check).

Timmins, Ont.

Nelson Hogg,
Resident Geologist,
Ontario Department of Mines.

1948

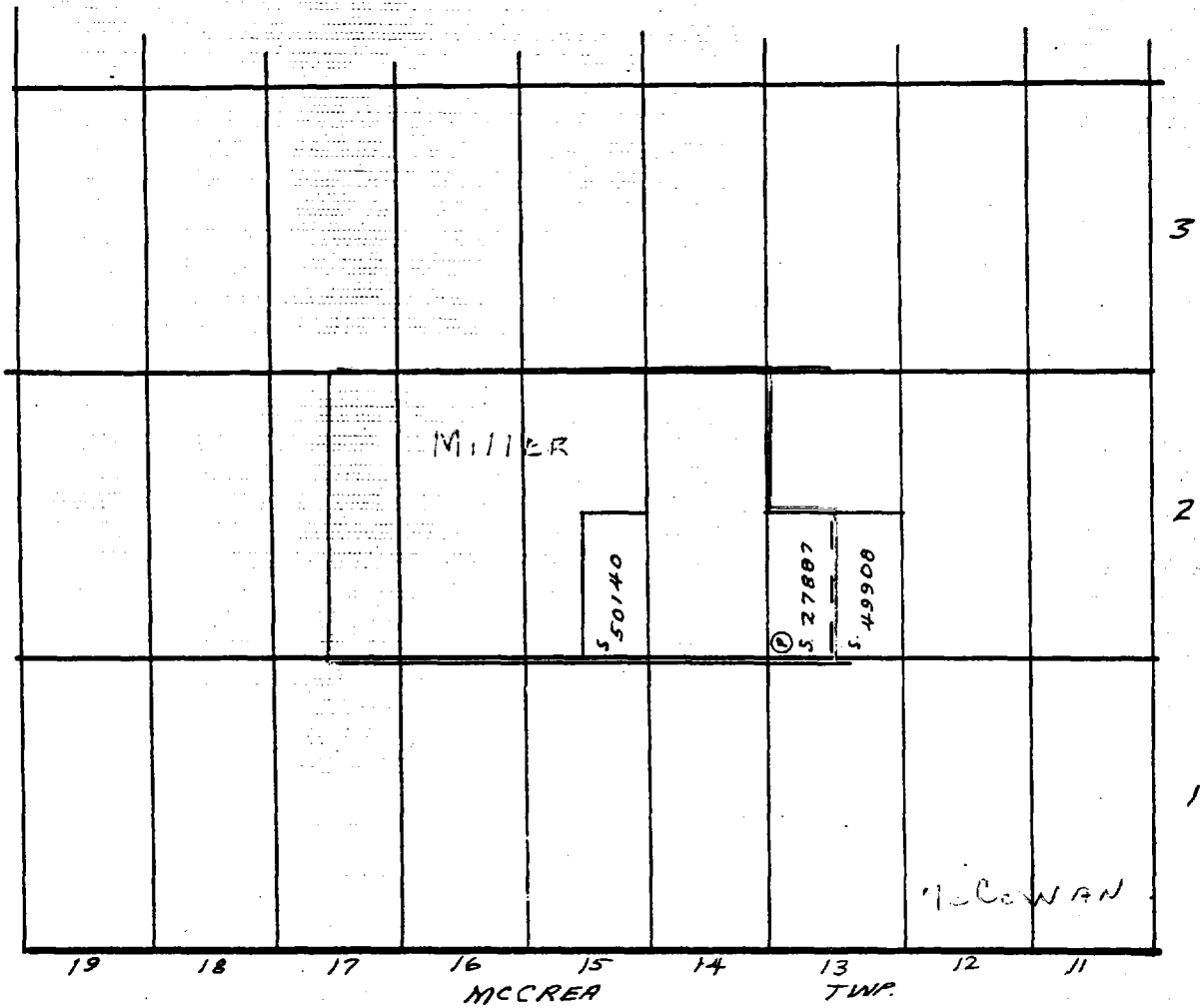

Mineralization: Au

MATTICE PROSPECTING SYNDICATE

McCowan Township

Scale: 1 inch - 40 chains

DRILLING DONE FOR MATTICE PROS
BY J.M. ANDERCHECK. TIMMINS ONT L
OCT 20/48 TOTAL DRILLED 1748 feet.



42G10SE0006 63.3896 MCCOWAN

040

Drilling done on lot X S.E. $\frac{1}{4}$ 13. Con 2. T.P. McCowan

Hole No. 1 bottomed at 227 feet cut ore body at 108 feet 15 feet wide the 108 was in greywacke formation balance of hole was in porphyry and greywacke

Hole No. 2

Bottomed at 200 feet cut two narrow veins quartz porphyry balance hole greywacke general formation greywacke

Hole No. 3

Bottomed at 332 feet greywacke wall rock. Orebody cut from 83 to 95 feet. Orebody cut from 150 to 162 feet carrying Galena porphyry cut from 191 to 216. balance greywacke carrying fine mineralization.

Hole No. 4

Bottomed at 221 feet cut 30 feet porphyry up to 150 feet their was alternate veins of white quartz and porphyry. balance of core was greywack carrying mineral.

Hole No. 5

Bottomed at 268 feet cut 25 feet porphyry then up to 90 feet greywacke mixed with bands of porphyry balance of core some white quartz veins with alternate bands of porphyry and greywacke with fine mineralization.

HOLE NO 6 Lot 15 con 2. Claim 50140

Hole No. 6 bottomed at 500 feet. Mostly greywack with a few narrow quartz stringers Considerable fractured rock and rust.

(signed) R. Miller
Manager

ASSESSMENT WORK

2011

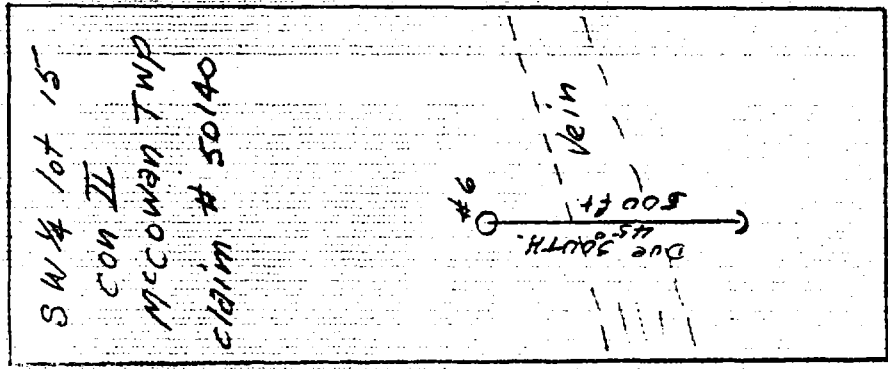
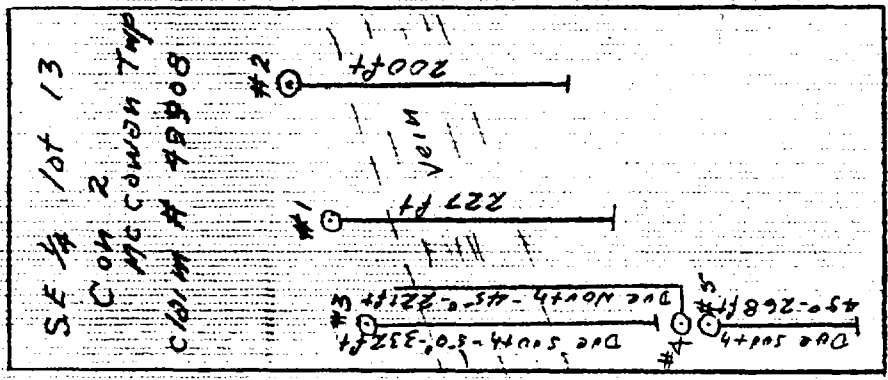
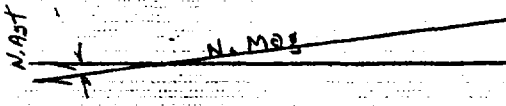

ASSESSMENT WORK

LOWTHER PROSPECTING SYNDICATE
McCOWAN TOWNSHIP

SCALE: 6.58 CHS. = 1 IN.

J.C. ROSEBUSH
T223

T-223

MILLER CLAIMS

McGowan Township

Dec. 15, 1948.

List of Specimens

<u>Spec. No.</u>	<u>DDH</u>	<u>Footage</u>	<u>Description</u>
1	ddh. 1		Sediments.
2	ddh. 1		Quartz Porphyry.











7-223

S 1/2 Lot 12 Con II

S 1/2 Lot 13 Con II

MILLER PROPERTY
MCGOWAN TWP.
SCALE 1" 200'
SEPT. 27/48.

LEGEND

	Pg	Quartz Porphyry		Camp
	Sg	Greywacke		Diamond drill hole
		Boundary of Outcrops		Strike + Dip of Bedding
		Trench - no Rock Exposed		
		Trench & Pit - Rock Exposed		

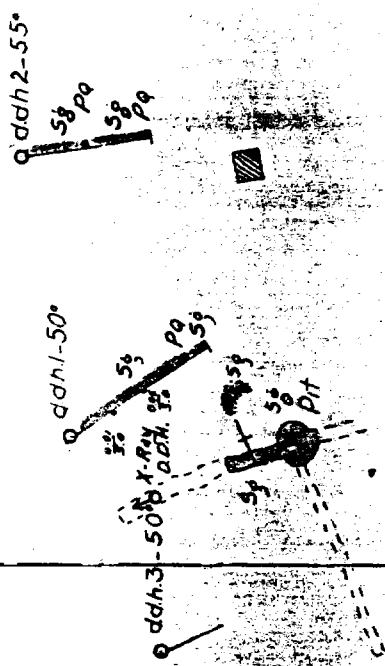

4 1/2 White Qtz
Arsenopyrite in Wells

Gr-265.
Quartz - Tr
Mineralized
Well-rock - Tr

Silicified Gwke.
Tr/25.
0.22/25.
0.00/12
Qtz vein

Samples by
Auror G.M.

Pit filled with water

S W 1/4 Lot 18, Con II (Approximate Loc. 04)
SE 1/4 Lot 13, Con II

63.3896

copy

TELEPHONE
ERLEY 1312

WAKAMI GOLD MINING SYNDICATE LIMITED

(NO PERSONAL LIABILITY)

ROOM 213-414 BAY STREET

TORONTO 2,

ONTARIO, CANADA

Hurst

May, 25th., 1938

Mr. H. C. Rickaby,
Provincial Geologist,
Parliament Buildings,
Toronto, Ont..

Dear Sir,

I am enclosing herewith, copy of report by Mr. P. C. Carter B.A.Sc., on a group of claims situated in McCowan Township, District of Algoma.

I have not been able to secure any geological information on this area, either from the Geological Survey or your Department so I presume that the area has never been checked over.

There seems to be quite a little activity in the area at the present time and at the time Mr. Carter made his examination, a diamond drill was on its way in to check an adjacent property.

This Company expects to diamond drill the property mentioned in the report, ~~some time~~, some time next month.

All claims mentioned in the report have been optioned to the Wakami Gold Mining Syndicate Limited.

Sincerely,

(A.E. Pearce)
President

7-2-38

Dr. D. D. D. D.

M 1944

May 26, 1938.

Dear Sir:

I wish to acknowledge receipt of your letter of May 25th containing a report on claims in McCowan Township, District of Algoma. We shall be interested in obtaining further information on this property as a result of your drilling programme.

Yours very truly,

HCR/C

H. C. Rickaby,
Acting Deputy Minister.

Mr. A. E. Pearce,
President, Wakami Gold Mining
Syndicate, Limited,
Room 213,
414 Bay St., TORONTO 2, Ont.

T-2-2-3