



42G16SE8001 10 CLAY

010

DIAMOND DRILLING

Township: clay

Report No: 10

WORK PERFORMED FOR: C.C Houston/Mettagami Mining Co. Ltd.

RECORDED HOLDER: SAME AS ABOVE [ ]

: OTHER [ ]

<u>CLAIM NO.</u>	<u>HOLE NO.</u>	<u>FOOTAGE</u>	<u>DATE</u>	<u>NOTE</u>	
S 78535	4	224'	620.11'	Mar/55	
	6	310'	580.3'	Mar/55	
	7	304'	633'	Mar/55	
	8	311'	625'	Mar/55	
	9	487'	400'	Mar/55	
	10	632'	620.7'	Mar/55	
	13	555'	657'	May/55	
	S 78536	22	538'	625'	June/55
		23	607'	604'	June/55
		24	594'	1105'	June/55
25		345'	320'	June/55	
26		291'	300'	May/55	

NOTES:

# DIAMOND DRILL RECORD

PROPERTY \_\_\_\_\_

CLAY & JEWELS \_\_\_\_\_

HOLE NO. 4

SHEET NUMBER 1

SECTION FROM 0 TO 324

STARTED 3/9/55

LATITUDE 4 plus 00S

DATUM \_\_\_\_\_

COMPLETED \_\_\_\_\_

DEPARTURE 9 plus 00E

BEARING \_\_\_\_\_

ULTIMATE DEPTH \_\_\_\_\_

ELEVATION \_\_\_\_\_

DIP 90°

PROPOSED DEPTH 600'

DEPTH FEET	FORMATION	SAMPLE NO.	WIDTH OF SAMPLE	GOLD \$	SLUDGE GOLD \$		
0 - 77	Blank						
77 - 89	med. gr. calcitic matrix med. crse gd.						
89 - 101.2	med. gr. calcitic matrix med. crse gd.						
101.2 - 103	hornblende & calcite some finely disseminated pyrite						
103 - 106	med. crse gd calcitic matrix						
106 - 111.5	med. gr. calcitic matrix med. gd.						
111.5 - 112.1	hornblende & pyrite (broken core)						
112.1 - 138.4	med. gr. calcitic matrix med. gd.						
138.4 - 142	hard altered syenitic grading to hornblende green some hematite upper slightly chloritized						
142 - 147	massive med. with minor calcite						
147 - 149.7	fine gr. syenitic porphyry						
149.7 - 152	magnetite (massive)						
152 - 153.7	massive hornblende hornblende chloritized mica minor magnetite						
153.7 - 170	fine gr. syenitic porphyry						
170 - 177.8	massive med. with minor calcitic matrix						
177.8 - 179.4	fine-gr. syenitic porphyry						
179.4 - 191.2	massive med. with minor calcitic matrix 4' hornblende	187.2					
191.2 - 193.5	fine gr. granite with hornblende at extremities.						
193.5 - 224	mixture of mass. med. & hornblende with occasional granitic stringers & fragments.						

# DIAMOND DRILL RECORD

PROPERTY \_\_\_\_\_

 HOLE NO. 4

 SHEET NUMBER 2

 SECTION FROM 224 TO 523.6

STARTED \_\_\_\_\_

LATITUDE \_\_\_\_\_

DATUM \_\_\_\_\_

COMPLETED \_\_\_\_\_

DEPARTURE \_\_\_\_\_

BEARING \_\_\_\_\_

ULTIMATE DEPTH \_\_\_\_\_

ELEVATION \_\_\_\_\_

DIP \_\_\_\_\_

PROPOSED DEPTH \_\_\_\_\_

DEPTH FEET	FORMATION	SAMPLE NO.	WIDTH OF SAMPLE	GOLD \$	SLUDGE GOLD \$		
224 - 225	massive mag. minor calcitic matrix						
228 - 235.3	syenite with some mag.						
235.3 - 239.4	massive mag. with some hornblende syenitic fragments.						
239.4 - 245.2	syenite with occ. mass. mag. bands						
245.2 - 307	med to fine gr. porphyritic granite pinkish gray with odd hornblende bands.						
307 - 317	mag. with some calcitic matrix						
317 - 326.3	fine gr. pinkish gray granite						
326.3 - 347.7	mag. with calcitic matrix						
347.7 - 350.8	mag. + hornblende with calcitic matrix						
350.8 - 361.5	mag. with calcitic matrix						
361.5 - 362.4	hornblende						
362.4 - 376.	mass. mag. black.						
376. - 452.5	mag. calcitic matrix becoming more dolomite (matrix) at 450'						
452.5 - 453.4	dolomite, med. gr. also pink with 10% fine mag.						
453.4 - 457.1	dolomitised porphyry pinkishgreen minor mag.						
457.1 - 469.9	magnetite in heavy calcitic matrix med gr. lt. gray contact						
	at 469.9 - A equals 85°						
469.9 - 523.6	med. gr. granite pinkish gray with some hornblende inclusions minor mag. some biotite at 520.1 - 521.5						
	20% mag. inclusion heavy calcitic matrix						



# DIAMOND DRILL RECORD

PROPERTY CLAY & HOWELLS HOLE NO. 6

SHEET NUMBER 1 SECTION FROM 0 TO 310 STARTED 3/1/55  
 LATITUDE 2 plus 00 S DATUM \_\_\_\_\_ COMPLETED 3/20/55  
 DEPARTURE 5 plus 00 E BEARING \_\_\_\_\_ ULTIMATE DEPTH 310'  
 ELEVATION \_\_\_\_\_ DIP 90° PROPOSED DEPTH 300'

DEPTH FEET	FORMATION	SAMPLE NO.	WIDTH OF SAMPLE	GOLD \$	SLUDGE GOLD \$		
0 - 80	Casing						
86 - 86.7	hornblendite with some syenitic fragments						
86.7 - 89.7	mag. & hornblendite with some syenitic bands						
89.7 - 189.0	syenite becoming granitic greenish pink; some bands of hornblende, odd mag. bands (mass. mag. 186.9 - 186.0)						
189.9 - 222.5	mag. with calcitic matrix with some massive bands						
222.5 - 224.3	porphyritic granite contact at 224.3 - equals 20°						
224.3 - 230.0	mag. with calcitic matrix 226.1 - 226.8 porphyritic inclusion contact 230.0 - equals 45°						
230.6 - 244	porphyritic granite; greyish green contact 244 - equals 85°						
244 - 260.0	mag. calcitic matrix hornblende inclusion at 255.6 - 257.8						
266.6 - 269.7	mag. with dolomitic matrix						
269.7 - 272.5	mass. mag. with sm. hbl. & dolomite fragments						
272.5 - 310	mag. with cal. matrix odd. hbl. fragment						
	NOTE Sample to H. Keller from 277.8 - 278.3 for U <sub>3</sub> O <sub>8</sub>						
	Sample No. 4101 C to H. Keller was 6-7 times background						
	This was hottest price in hole No. 6 therefore not						
	typical. Most of core with magnetite only slightly						
	radioactive.						





# DIAMOND DRILL RECORD

PROPERTY CLAY & HOWELLS HOLE NO. 7 deepened

SHEET NUMBER 2 SECTION FROM 304 TO 597.9 STARTED \_\_\_\_\_  
 LATITUDE \_\_\_\_\_ DATUM \_\_\_\_\_ COMPLETED \_\_\_\_\_  
 DEPARTURE \_\_\_\_\_ BEARING \_\_\_\_\_ ULTIMATE DEPTH \_\_\_\_\_  
 ELEVATION \_\_\_\_\_ DIP \_\_\_\_\_ PROPOSED DEPTH \_\_\_\_\_

DEPTH FEET	FORMATION	SAMPLE NO.	WIDTH OF SAMPLE	GOLD \$	SLUDGE GOLD \$			
304 - 320.5	magnetite calcitic matrix, becoming hornblende 317' on							
320.5 - 389.6	fine to medium grade pink & white syenite with minor alt. along fracture zones.							
389.6 - 398.8	magnetite, calcitic matrix							
398.8 - 400.6	fine grained felsitic zone							
400.6 - 402.8	magnetite calcitic matrix							
402.8 - 404.8	felsitic altered zone occasional hornblendite							
404.8 - 416.6	magnetite calcitic matrix							
416.6 - 422	magnetite calcitic matrix							
422 - 424.3	alt. zone hornblendite & minor magnetite							
424.3 - 425.3	magnetite calcitic matrix							
425.3 - 452.3	Porphyritic syenite, some minor hornblendite							
452.3 - 477.	alt. zone hornblendite & massive magnetite bands at							
	452.3 - 453.3; 454 - 454.6; 455.8 - 457; 460.6 - 462.2; 463 - 464.9.							
477 - 485	magnetite calcitic matrix							
485 - 498.3	alt. zone hornblendite							
498.3 - 546	magnetite minor calcitic matrix some massive magnetite occasional hornblendite zone							
546 - 597.9	Magnetite calcitic matrix							











# DIAMOND DRILL RECORD

PROPERTY \_\_\_\_\_

CLAY &amp; HOWELL'S \_\_\_\_\_

 HOLE NO. 10

 SHEET NUMBER 1

 SECTION FROM 0 TO 139.5

 STARTED 3/27/55

 LATITUDE 0 plus 40 3

DATUM \_\_\_\_\_

 COMPLETED 3/31/55

 DEPARTURE 6 plus 40 3

BEARING \_\_\_\_\_

ULTIMATE DEPTH \_\_\_\_\_

ELEVATION \_\_\_\_\_

 DIP 90°

PROPOSED DEPTH \_\_\_\_\_

DEPTH FEET	FORMATION	SAMPLE NO.	WIDTH OF SAMPLE	GOLD \$	SLUDGE GOLD \$			
0 - 64	casing							
64 - 64.6	syenite crse. (d. pink)							
64.6 - 70.4	hornblendite with some magnetite and odd syenite fragment							
70.4 - 75.7	syenite.							
75.7 - 76.7	hornblendite slightly chloritized with minor mag.							
76.7 - 77.5	ground core							
77.5 - 81.3	hornblendite minor mag. slightly chloritized							
81.3 - 83.9	syenite crse. (d. pink)							
83.9 - 90.1	hornblendite chloritized some pale blue alt. product							
90.1 - 104.5	syen. crse. (d. pink)							
104.5 - 115.0	hornblendite becoming altered							
115.0 - 119	hornblendite highly altered							
119 - 124	ground and lost core							
124 - 129.3	leached, oxidised, breccia vuggy.							
129.3 - 130	ground core							
130 - 130.5	highly altered hornblendite							
130.5 - 136	ground and lost core							
136 - 136.4	hornblendite altered.							
136.4 - 139	ground and lost core.							
139 - 139.5	hornblendite slightly alt. some magnetite							

# DIAMOND DRILL RECORD

PROPERTY \_\_\_\_\_

HOLE NO. 10

SHEET NUMBER 2

SECTION FROM 139.5 TO 213.8

STARTED \_\_\_\_\_

LATITUDE \_\_\_\_\_

DATUM \_\_\_\_\_

COMPLETED \_\_\_\_\_

DEPARTURE \_\_\_\_\_

BEARING \_\_\_\_\_

ULTIMATE DEPTH \_\_\_\_\_

ELEVATION \_\_\_\_\_

DIP \_\_\_\_\_

PROPOSED DEPTH \_\_\_\_\_

DEPTH FEET	FORMATION	SAMPLE No.	WIDTH OF SAMPLE	GOLD \$	SLUDGE GOLD \$			
139.5 - 142	ground and lost core							
142 - 142.4	hornblende and mag.							
142.4 - 143	ground and lost core							
143 - 161.7	hornblende slightly altered with some mag.							
161.7 - 163.3	syenite, coarse, rd. pink							
163.3 - 164.4	hornblende, altered, minor mag.							
164.4 - 169	ground and lost core							
169 - 169.5	highly alt. hornblende with little mag.							
169.5 - 162	ground and lost core							
162 - 162.2	highly alt. hornblende blue alteration product mag.							
162.2 - 163	ground and lost core							
163 - 163.5	altered hornblende chloritized, odd feldspar fragment magnetite.							
163.5 - 164.0	altered felsitic material reddish pink small vugs.							
164.0 - 166.8	hornblende altered feldspar fragments							
166.8 - 167	highly altered and leached felsite vuggy.							
167 - 190	ground and lost core							
190 - 202	highly altered and leached felsite 10% core recovery							
202 - 205	chloritized magnetite							
205 - 213.8	hornblende altered minor magnetite; 1" syen. at 213.8							

# DIAMOND DRILL RECORD

PROPERTY \_\_\_\_\_

HOLE NO. 10

SHEET NUMBER 5

SECTION FROM 213.8 TO 254.8

STARTED \_\_\_\_\_

LATITUDE \_\_\_\_\_

DATUM \_\_\_\_\_

COMPLETED \_\_\_\_\_

DEPARTURE \_\_\_\_\_

BEARING \_\_\_\_\_

ULTIMATE DEPTH \_\_\_\_\_

ELEVATION \_\_\_\_\_

DIP \_\_\_\_\_

PROPOSED DEPTH \_\_\_\_\_

DEPTH FEET	FORMATION	SAMPLE No.	WIDTH OF SAMPLE	GOLD \$	SLUDGE GOLD \$			
213.8 - 216	ground and lost core							
216 - 216.8	hornblende highly alt. mag.							
216.8 - 217	ground and lost core							
217 - 217.8	hornblendite, highly alt. mag.							
217.8 - 220	grd. and lost core							
220 - 222.6	hornblendite; altered; some feldspar fragments							
222.6 - 223	grd. and lost core							
223 - 224.6	hornblendite; altered; odd feldspar fragment							
224.6 - 226	ground and lost core							
226 - 226.8	hornblendite; altered; magnetite							
226.8 - 231	grd. and lost core.							
231 - 232.1	hornblendite becoming highly alt. mag.							
232.1 - 234	grd. and lost core							
234 - 236	hornblendite, very highly altered, vuggy rotten rock							
236 - 237	grd. and lost core.							
237 - 247	hornblendite alt. magnetite 80% core recovery.							
247 - 253.5	hornblendite highly alt. magnetite 10% core recovery.							
253.5 - 254.8	felsite; five gd. dk. gray							

# DIAMOND DRILL RECORD

PROPERTY \_\_\_\_\_

HOLE NO. 10

SHEET NUMBER 4

SECTION FROM 254.8 TO 398.5

STARTED \_\_\_\_\_

LATITUDE \_\_\_\_\_

DATUM \_\_\_\_\_

COMPLETED \_\_\_\_\_

DEPARTURE \_\_\_\_\_

BEARING \_\_\_\_\_

ULTIMATE DEPTH \_\_\_\_\_

ELEVATION \_\_\_\_\_

DIP \_\_\_\_\_

PROPOSED DEPTH \_\_\_\_\_

DEPTH FEET	FORMATION	SAMPLE NO.	WIDTH OF SAMPLE	GOLD \$	SLUDGE GOLD \$			
254.8 - 265	grd. and lost core							
265 - 268	hornblende altered wuggy 50% core recovery magnetite							
268 - 273.5	hornblende altered, some syenitic fragments							
273.5 - 289.5	hornblende, calcitic matrix coarse ground magnetite several syenite bands (285.8 - 286.2) 286.7 - 287.5)							
289.5 - 318.4	hornblende, calcitic matrix and magnetite							
318.4 - 320	granite; fine grained; pink							
320 - 335.1	hornblende and mag. in calcitic matrix							
335.1 - 339.9	hornblende; slightly chloritized some syen. fragments							
339.9 - 341.8	hornblende & mag. in cal. matrix							
341.8 - 347.2	hornblende; coarse gr. odd calcite stringer							
347.2 - 360	hornblende & mag. in calcitic matrix							
360 - 361.4	hornblende coarse gr. green							
361.4 - 364.3	granite fine gr. pinkish gray biotite zone 362.4 - 363.6							
365.3 - 376.3	mag. & hbl. in calcitic matrix coarse to med. gr. becoming massive in last foot.							
376.3 - 384.4	granite; fine gr. grey							
384.4 - 388.3	mass. mag. minor hbl.							
388.3 - 393	mag. & hbl. cal. mat.							
393 - 396.7	mass. mag. hbl. minor cal.							
396.7 - 398.5	hbl. cal. coarse							

N.M.P., TORONTO-STOCK FORM NO. 501 REV. 12/51

DRILLED BY \_\_\_\_\_

SIGNED \_\_\_\_\_





# DIAMOND DRILL RECORD

PROPERTY \_\_\_\_\_

 HOLE NO. 10 Deepened

 SHEET NUMBER 6

 SECTION FROM 467.5 TO 620

STARTED \_\_\_\_\_

LATITUDE \_\_\_\_\_

DATUM \_\_\_\_\_

COMPLETED \_\_\_\_\_

DEPARTURE \_\_\_\_\_

BEARING \_\_\_\_\_

ULTIMATE DEPTH \_\_\_\_\_

ELEVATION \_\_\_\_\_

DIP \_\_\_\_\_

PROPOSED DEPTH \_\_\_\_\_

DEPTH FEET	FORMATION	SAMPLE NO.	WIDTH OF SAMPLE	GOLD \$	SLUDGE GOLD \$		
467.5 - 468.0	Fine grained, pink, syenite.						
468.0 - 472.8	alteration zone; hornblende & magnetite with some syenite remnants.						
472.8 - 507.5	hornblende and magnetite with calcitic matrix; some massive magnetite bands; occasional felsitic stringers less than 1 foot.						
507.5 - 511	felsitic zone fractured; some hornblende						
511 - 512.3	magnetite; calcitic matrix						
512.3 - 516.5	Felsitic zone; fractured; becoming altered some core loss.						
516.5 - 520	Alteration zone; hornblende & magnetite						
520 - 530	Magnetite; calcitic matrix						
530 - 532.8	felsitic zone						
532.8 - 561.9	magnetite predominantly massive with portions in calcitic matrix; felsitic stringer at 544.8 - 545.8 & 550.5 - 552.5						
561.9 - 567	medium grained pink syenite						
567 - 584.5	massive black magnetite						
584.5 - 593.4	magnetite calcitic matrix						
593.4 - 596.5	massive black magnetite						
596.5 - 603.7	magnetite calcitic matrix						
603.7 - 607	dark green to black hornblendite						
607 - 620	mixed massive magnetite & magnetite calcitic matrix syenite stringer at 613.9 - 614.2.						



# DIAMOND DRILL RECORD

PROPERTY CLAY & HOWELL HOLE NO. 13

SHEET NUMBER 1 SECTION FROM 0 TO 555 STARTED 5/13/55  
 LATITUDE 5 plus 008 DATUM \_\_\_\_\_ COMPLETED 5/27/55  
 DEPARTURE 8 plus 60W BEARING \_\_\_\_\_ ULTIMATE DEPTH 657'  
 ELEVATION \_\_\_\_\_ DIP 90° PROPOSED DEPTH 600'

DEPTH FEET	FORMATION	SAMPLE NO.	WIDTH OF SAMPLE	GOLD %	SLUDGE GOLD %
0 - 121	casing (ledge @ 85'; 36' casing in loose ore)				
121 - 153.5	oxidized & leached hbldite and mass. mag. (50%) 145.8 - 148.9 syen. str.				
153.5 - 167.8	gd. & lost core; alt. syen.				
167.8 - 171	mag. cal. mat. 30%				
171 - 175	mass. mag.				
175 - 204.2	mag. cal. mat.				
204.2 - 208.5	mass. mag.				
208.5 - 224.6	mag. cal. mat.				
224.6 - 234	mag. cal. mat.				
234 - 266.7	mag. cal. mat.				
266.7 - 376.3	predom. carbonate zone occ. minor ma. less than 10%				
376.3 - 404					
404 - 423.5	mag. cal. mat.				
423.5 - 433.7	med. gd. syen.				
433.7 - 448.4	blk. mass. mag.				
448.4 - 461.0	med. gd. pink. syen.				
461 - 494.4	mag. cal. mat. felsite str. 466 - 467.4				
494.4 - 517.8	fels. dark zone to 500.8 med. gd. gray granite				
517.8 - 555	mass. mag. gran. str. 536 - 536.5				



# DIAMOND DRILL RECORD

PROPERTY CLAY & HOWELLS

HOLE NO. 22

SHEET NUMBER 1

SECTION FROM 0 TO 522.2

STARTED 6/8/55

LATITUDE 10 plus 00 NW

DATUM \_\_\_\_\_

COMPLETED 6/14/55

DEPARTURE 15 plus 00 NE

BEARING \_\_\_\_\_

ULTIMATE DEPTH \_\_\_\_\_

ELEVATION \_\_\_\_\_

DIP 90°

PROPOSED DEPTH 600'

DEPTH FEET	FORMATION	SAMPLE NO.	WIDTH OF SAMPLE	GOLD \$	SLUDGE GOLD \$
0 - 115	casing.				
115 - 117	fine gr. gray fels. zone.				
117 - 130.5	fine gr. pink syen.				
130.5 - 251	fine gr. gray lamprophyre (pred. dark minerals) some alt.				
251 - 302.1	hbldite cal. mat.				
302.1 - 345	fine gr. dark gray syen. lamprophyre				
345 - 350	hbldite cal. mat. minor mag.				
350 - 357	alteration zone hbldite syen. frags.				
357 - 362	mag. cal. mat.				
362 - 367	fractured felsitic zone con. alteration.				
367 - 375.7	mag. cal. mat.				
375.7 - 397.5	fine gr. gray felsite minor alt.				
397.5 - 409.5	mag. cal. mat. & syen. str. @ 409.5				
409.5 - 414.7	alt. syen. hbldite & chlorite				
414.7 - 420.7	mag. cal. mat.				
420.7 - 425.1	alt. fine gr. syen. chlor & hbldite.				
425.1 - 500	mag. cal. mat.				
500 - 516.5	fine gr. gray slightly alt. syen.				
516.5 - 528	hbldite cal. mat. con. bands alt. fine gr. gray syen. mag.				
528 - 530.8	hbldite mag. cal. mat.				



# DIAMOND DRILL RECORD

PROPERTY CLAY & HOWELLS HOLE NO. 23

SHEET NUMBER 1 SECTION FROM 0 TO 607 STARTED 6/9/55

LATITUDE 11 plus 00 NW DATUM \_\_\_\_\_ COMPLETED \_\_\_\_\_

DEPARTURE 15 plus 00 NE BEARING \_\_\_\_\_ ULTIMATE DEPTH \_\_\_\_\_

ELEVATION \_\_\_\_\_ DIP 90° PROPOSED DEPTH 600

DEPTH FEET	FORMATION	SAMPLE NO.	WIDTH OF SAMPLE	GOLD \$	SLUDGE GOLD \$
0 - 125	ceiling.				
125 - 150.7	mp. cal. mat.				
150.7 - 161	much oxidized zone hematite & limonite; chlorite				
161 - 201.8	mp. cal. mat.				
201.8 - 242.5	mod. gr. gray syon.				
242.5 - 287.4	mp. cal. mat.				
287.4 - 340.5	predominantly mass. blk. mag. occ. hblite. & alt. some (299.4 - 304 hblite)				
340.5 - 352	mp. cal. mat.				
352 - 353.8	fine gr. felsitic zone				
353.8 - 395.3	mp. cal. mat. occ. alt. band hblite. etc. more massive from 378 on.				
395.3 - 411.4	fractured fn. gr. fels. some lost area.				
411.4 - 474.8	mass. blk. mag.				
474.8 - 497.3	hblite cal. mat.				
497.3 - 509	mass. mag.				
509 -	<del>XXXXX</del> 6/15/55				
497.3 - 509.7	mass. mag.				
509.7 - 521.2	mp. hblite. cal. mat.				
521.2 - 607	hblite cal. mat. with syon remnants. altered syon. stringer @				
	591.4 - 596				



# DIAMOND DRILL RECORD

PROPERTY

CLAY &amp; HOWELLS

HOLE NO. 24

SHEET NUMBER

1

SECTION FROM 0

TO

~~594~~

STARTED 6/13/55

LATITUDE

12 plus 00 NW

DATUM

594

COMPLETED 6/20/55

DEPARTURE

15 plus 00 NE

BEARING

ULTIMATE DEPTH 594

ELEVATION

DIP

90°

PROPOSED DEPTH 600

DEPTH FEET	FORMATION	SAMPLE NO	WIDTH OF SAMPLE	GOLD g	SLUDGE GOLD g
0 - 83	casing.				
83 - 113.3	fn. gd. gray syen.				
113.3 - 201.2	altered syen. calcite some hblde.				
201.2 - 231.5	crse. gd. pink syen. some chlorite & minor biotite				
231.5 - 238	med. gd. pink syen.				
238 - 259.3	very crse. gd. pink syen.				
259.3 - 363	alt. syen. predominant hblde & chlorite minor mag. zones				
	266.5 - 274; 295.5 - 296.2; 311.2 - 314;				
363 - 379.2	fn. gd. gray alt. syen. much banded hblde (gneissic)				
379.2 - 384	mass. mag. bands in alt. zone hblde chlorite coarse calcite				
384 - 400	mag. cal. mat.				
400 - 407	hblde with some mass. mag. bands.				
407 - 428.5	alt. syen. hblde etc. some lost core.				
428.5 - 492	mag. cal. mat. some hblde				
492 - 502.7	slightly alt. med. gd. gray syen.				
502.7 - 517	fn. gd. gray syen.				
517 - 525.5	hblde & mass. mag. bands.				
525.5 - 572.2	hblde cal. mat. syen. rema.				
572.2 - 594	alt. med. gd. gray syenite				
	E.O.H.				

N.M.P. TORONTO-STOCK FORM NO. 501 REV. 12/51

DRILLED BY

SIGNED

# DIAMOND DRILL RECORD

*Page 3 (2)*

PROPERTY

Clay - Howells

HOLE NO. 24 (Deepening)

SHEET NUMBER

1

SECTION FROM

TO

STARTED 8/26/55

LATITUDE

1200 NW

DATUM

COMPLETED 9/1/55

DEPARTURE

1500 NE

BEARING

ULTIMATE DEPTH 1105'

ELEVATION

DIP

90°

PROPOSED DEPTH 1100'

DEPTH FEET	FORMATION	SAMPLE NO.	WIDTH OF SAMPLE	GOLD %	SLUDGE GOLD %
694 - 655.2	Med. To Crse. Gd. Pink To Gray Syen.				
655.2 - 688.5	Hblidite & Calcite With Syen Remnants. Some Hematite Assoc. With Fractured Syen				
688.5 - 694	Crse Gd. Pldspar With Hblde				
694 - 794	Hblidite & Calcite; Predom. Calcite 784 - 789				
794 - 796.3	Fn. Gd. Dk. Felsitic Zone				
796.3 - 852.4	Hblidite & Cal. With Syen Remnants				
852.4 - 857.3	Fn Gd. Gray "Gneissic" Syen. (Gneissosity Approx. 20° to Core Axis)				
857.3 - 882.4	Hblidite & Calcite; Occ. Mag. Bands < 6"				
882.4 - 932	Hblidite & Cal. With Minor Mag.	5%			
932 - 984.5	Hblidite & Cal.				
984.5 - 992.3	Hblidite; Cal; Mag.	5%			
992.3 - 994	Hblidite; Cal.				
994 - 994.9	Mag; Cal.	30%	✓		
994.9 - 1008.6	Partially Alt. Fn. Gd. Gray Syen				
1008.6 - 1011.7	Hblde; Chlorite; Mag.	40%	✓		
1011.7 - 1031.3	Hblidite; Cal; Occ. Minor Mag. Band				
1031.3 - 1084.4	Fn. Gd. Gray Gneissic Syen.				
1084.4 - 1090	Hblidite & Calcite (1084.6 - 1085.5 30% Mag. With Cal).				







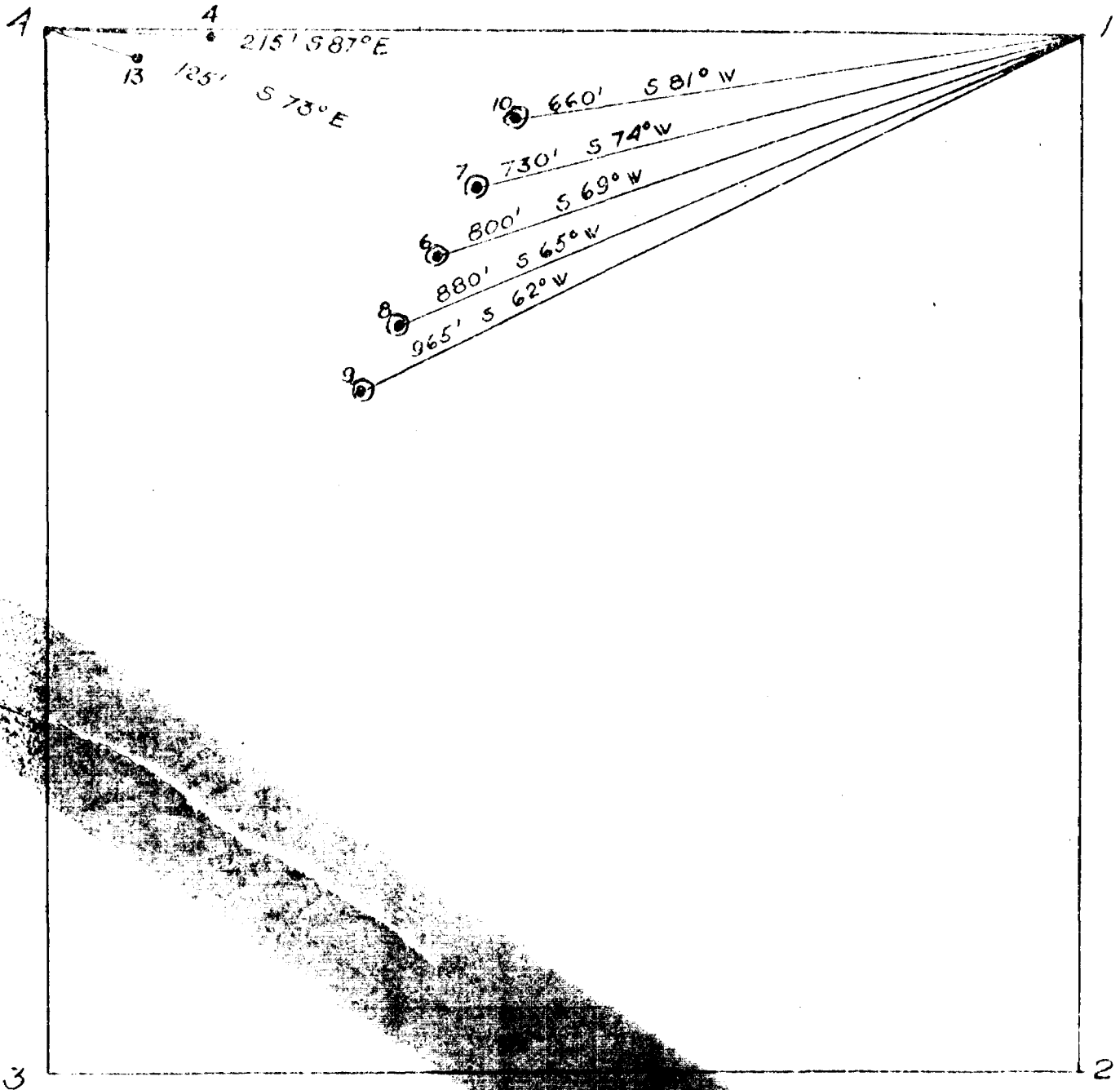

CLAIM 5/35

Clay Twp.

SCALE: 1" = 200'

CERTIFIED  
*[Signature]*

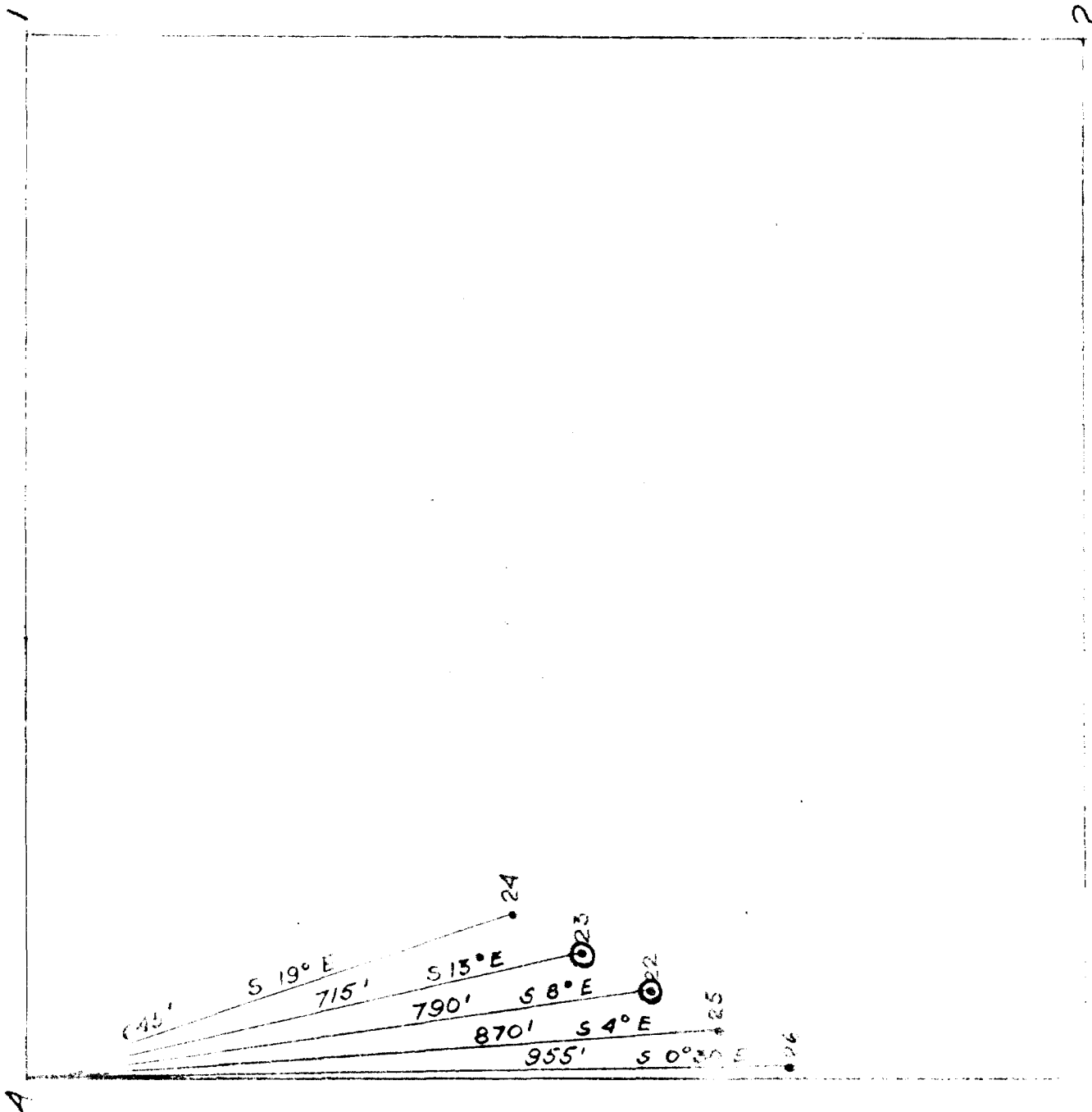

CLAIM S78.536

~~Clay~~ ~~Trig~~

SCALE: 1" = 200'

CERTIFIED  
*[Signature]*



CLAIM 78536

CERTIFIED  
*[Signature]*

SCALE 1" = 200'



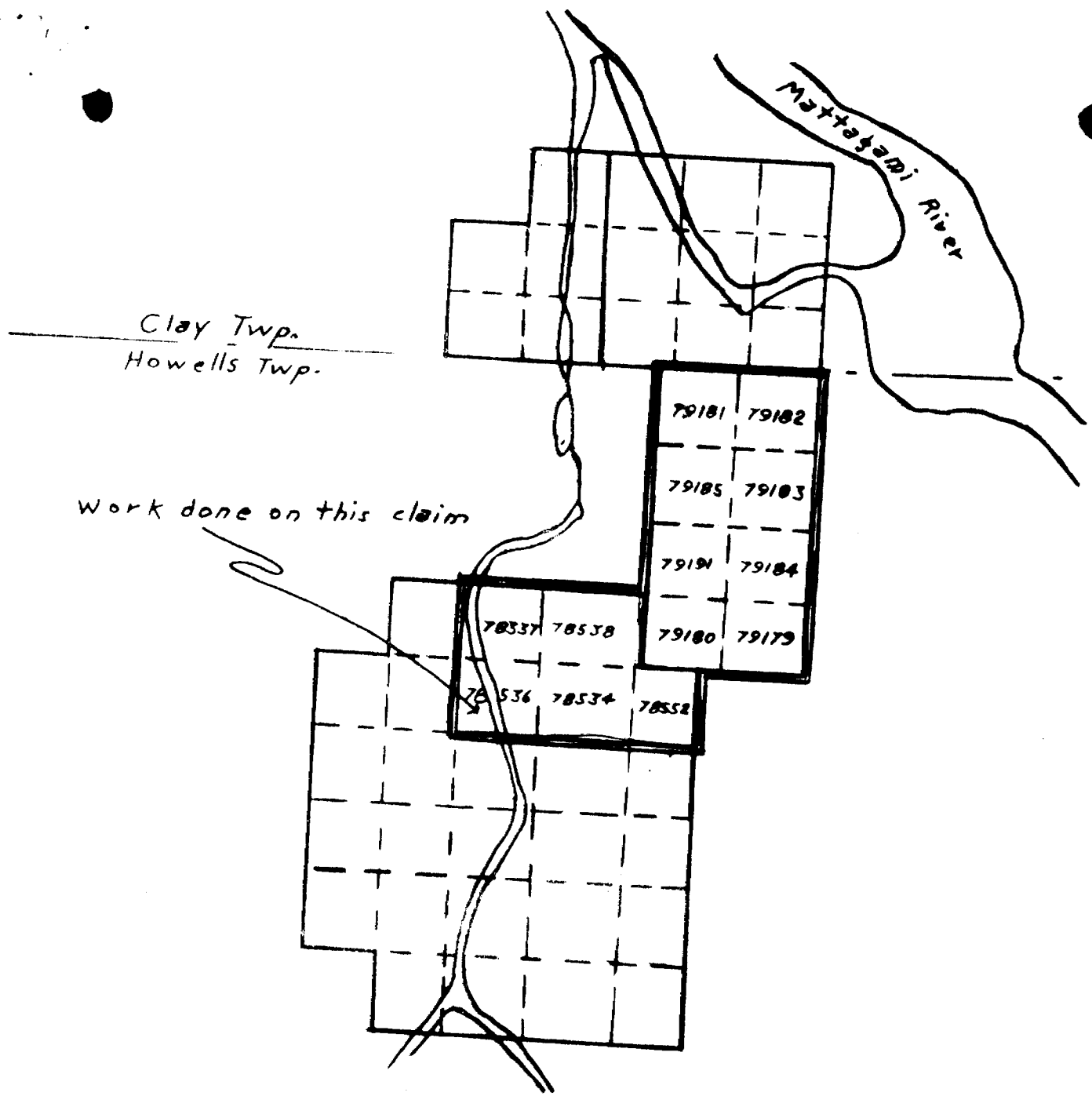

Clay Twp.  
Howells Twp.

Work done on this claim

Sketch Map of Ground Held By C.C. Huston in Clay & Howells Twp's.  
Grouping for assesment declaration in red Scale 1" = 40 chains

Clay Twp.

C.C. Huston

5,000  
 10,000  
 15,000  
 20,000  
 25,000

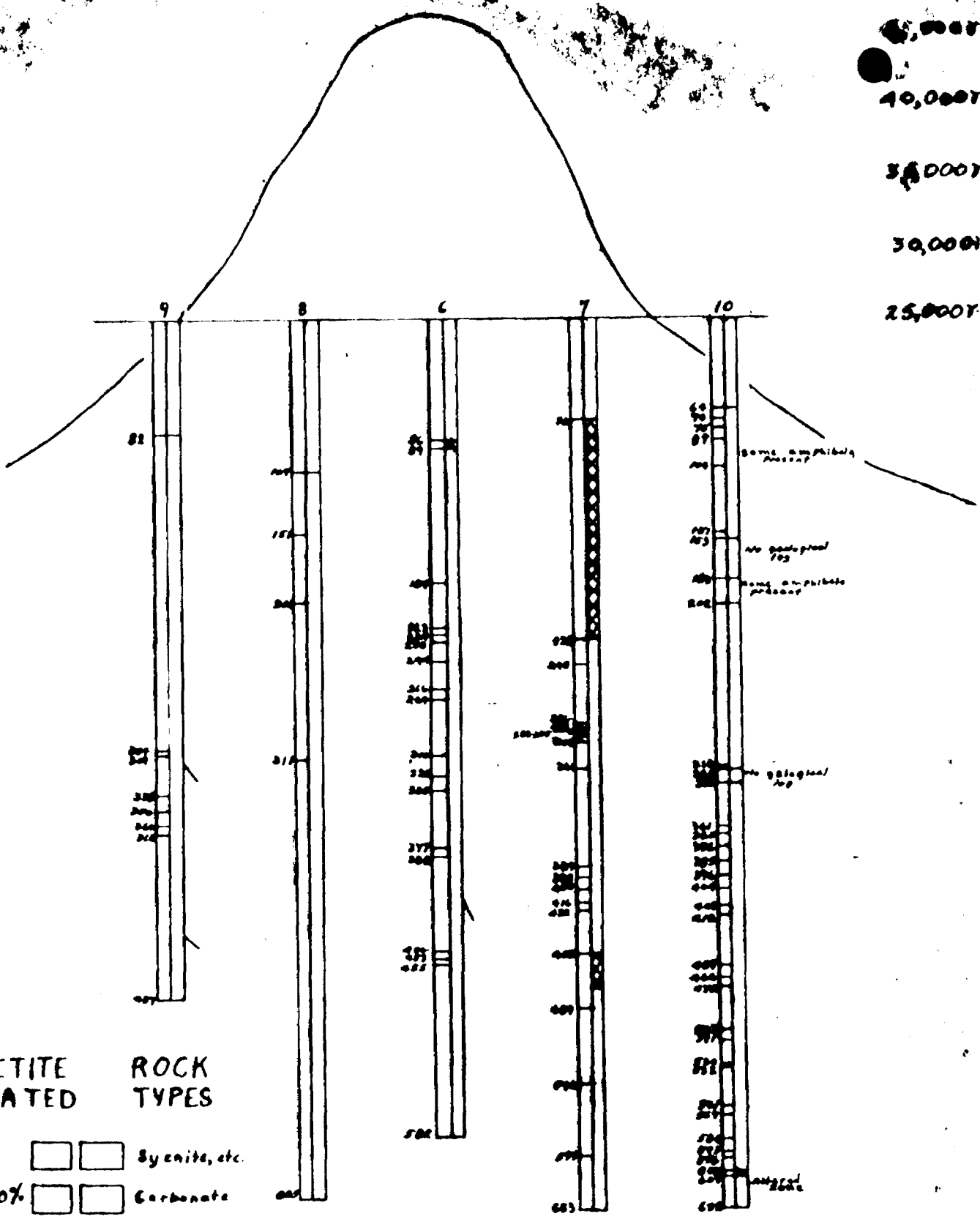

**MAGNETITE ESTIMATED**  
 60% plus   Syenite, etc.  
 10% to 60%   Carbonate  
 Less than 10%   Carbonate with amphibole  
 Amphibolite

SCALE 100 FT. = 1 INCH

SECTION 500 NORTHEAST

Dip of gneissosity

# CLAY-HOWELLS PROSPECT

45,000  
 40,000  
 35,000  
 30,000  
 25,000

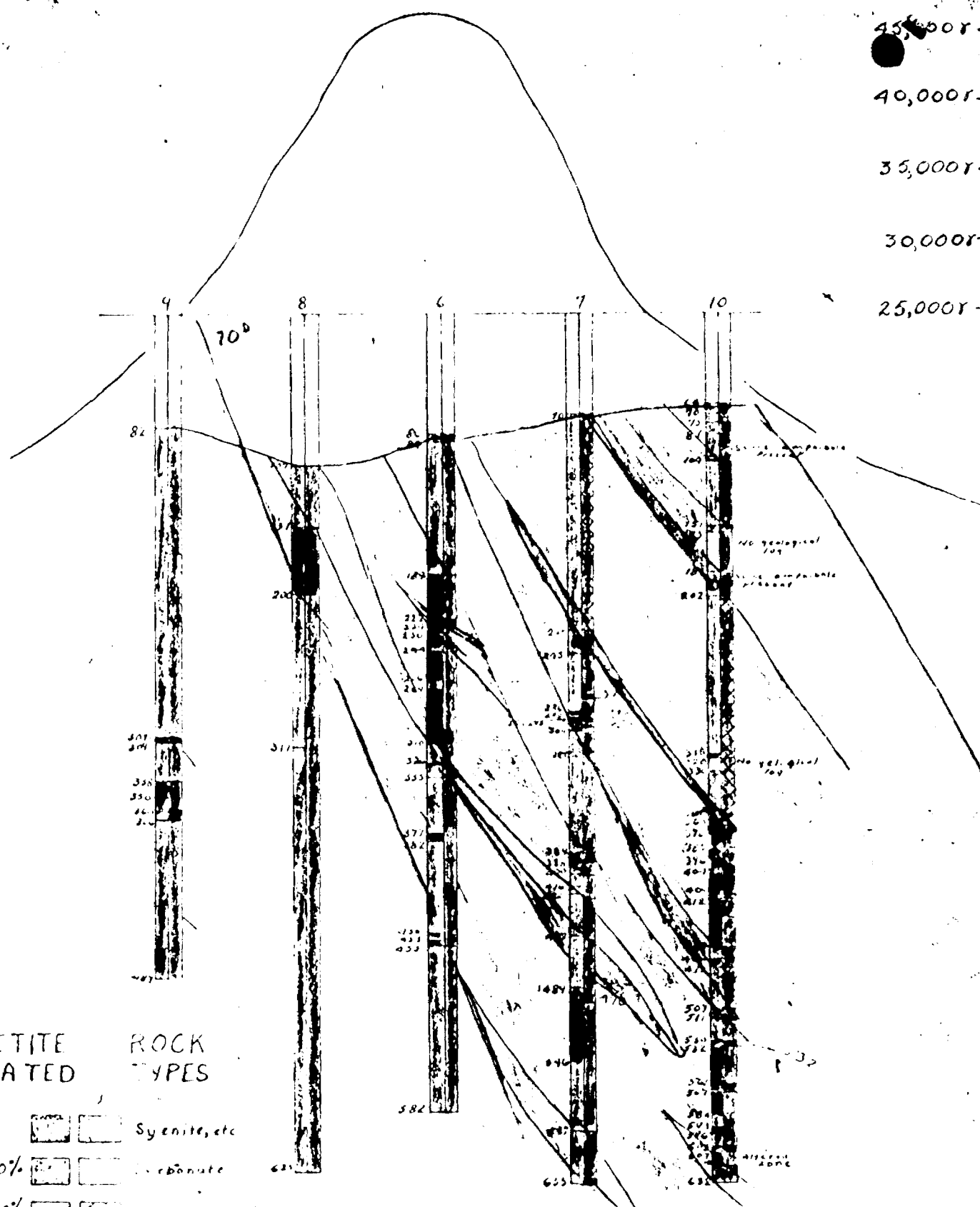

**MAGNETITE ESTIMATED**

60% plus Syenite, etc

10% to 60% Carbonate

Less than 10% gneiss with epidote

Amphibolite

Dip of gneissosity

SCALE 100 FT. = 1 INCH

SECTION 500 NORTHEAST

CLAY-HOWELLS PROSPECT