

BLAKELOCK PROJECT  
GOLDROCK CLAIM BLOCK

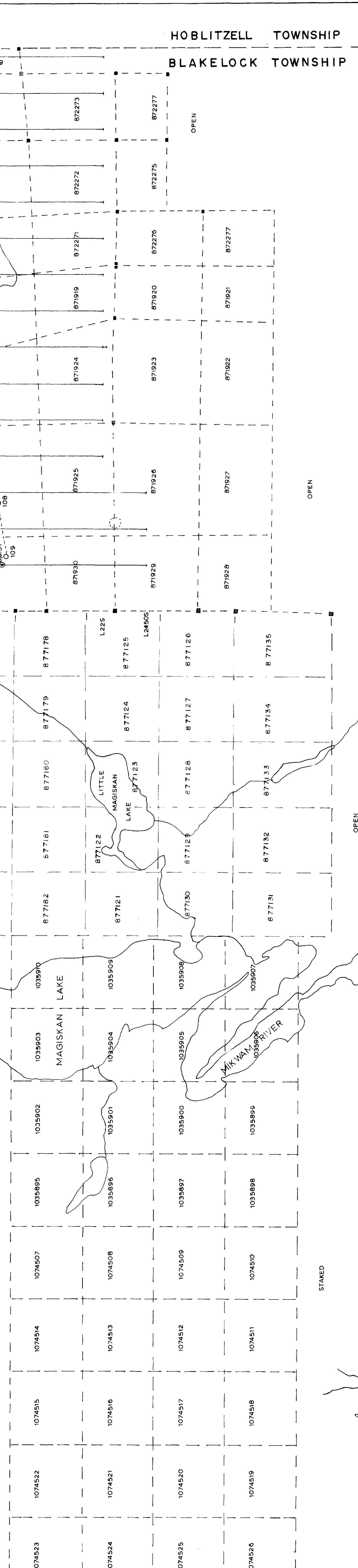

HN PROJECT  
FAR WEST CLAIM BLOCK



**SYMBOLS**

- 93 0 Reverse Circulation Drill Hole (Vertical)
- DDH 88-286 Diamond Drill Hole (inclined - Geology projected to overburden surface at 60°)
- Buildover Road
- Post Located - post as indicated
- Post Located - post and compass
- Trial Post - trial post with wind direction
- Post Assumed - post not located but intersecting block directions noted
- Claim Lines approximate (not located)
- Claim Lines located

**MAP I**

63-53553  
0188-234

**ESSO MINERALS CANADA**  
A DIVISION OF ESSO RESOURCES CANADA LIMITED

PROSPECT: HN (West)  
SUBJECT: Claim and Drill Hole Locations

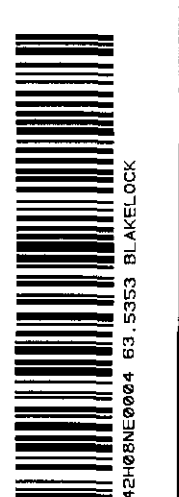

SCALE	1:10,000
DATE	Aug-1988
FILE NO	DWG NO
SURVEY BY	DATE
DRAWN BY	REVISED BY
IN CHARGE	

SCALE 1:10,000

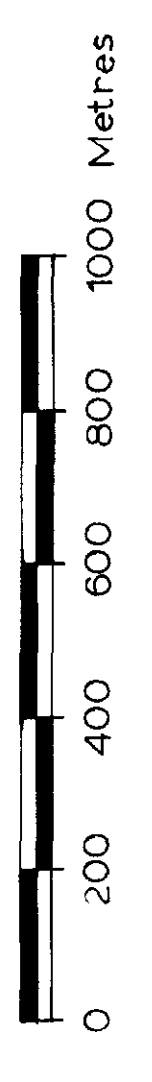

2000

STAKED

OPEN

OPEN

STAKED

OPEN

OPEN

OPEN

OPEN

OPEN

OPEN

Declination 1°W

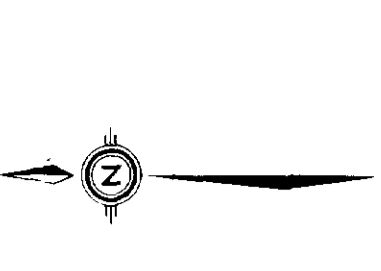

HOBLITZELL TOWNSHIP  
BLAKELOCK TOWNSHIP

BLAKELOCK PROJECT  
GOLDROCK CLAIM BLOCK

HN PROJECT

WEST GRID AREA

HN PROJECT  
FAR WEST CLAIM BLOCK

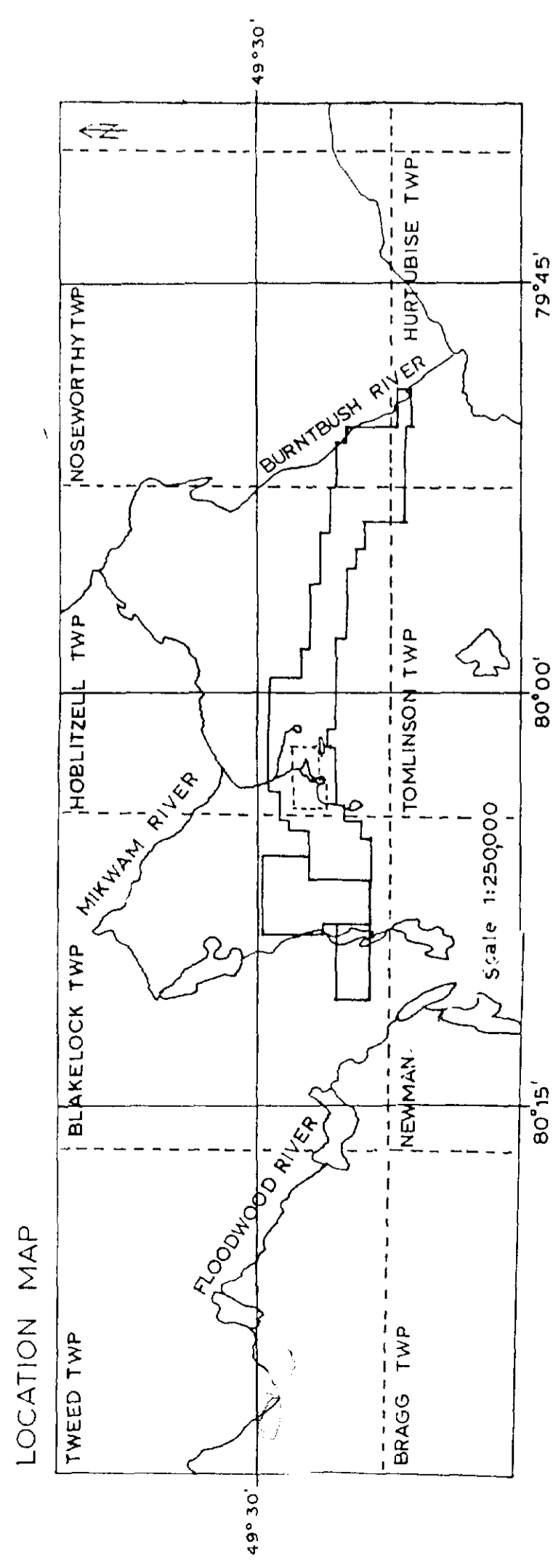
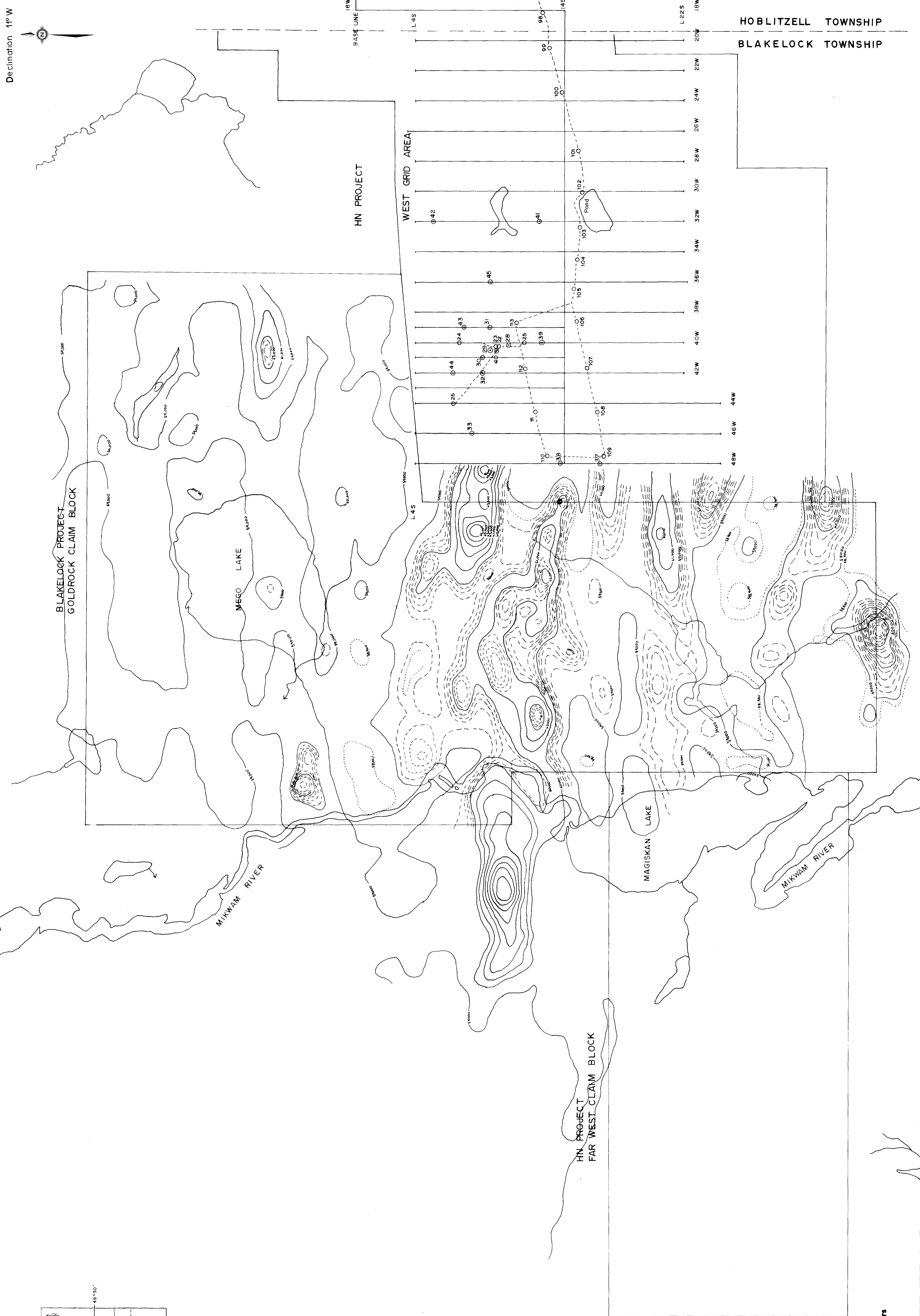

Enhanced Magnetic Contours  
from Digham Survey Job 268 Dated Jan. 1987

MAP 2

63-5355  
01188-236

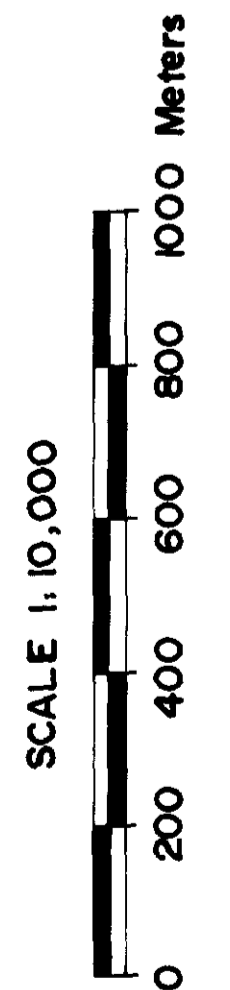

<b>ESSO MINERALS CANADA</b>	
A DIVISION OF ESSO RESOURCES CANADA LIMITED	
PROSPECT	HN (West)
SUBJECT	Mag and Geological Compilation
FILE NO	2110
DWG NO	
SCALE	1:10,000
DRAWN BY	M. H. Lefferts
DATE	Aug. 1988
REVISED BY	NTS 42H/B

WEST GRID

L48W L46W L44W L42W L40W L38W L36W L34W L32W L30W L28W L26W L24W L22W L

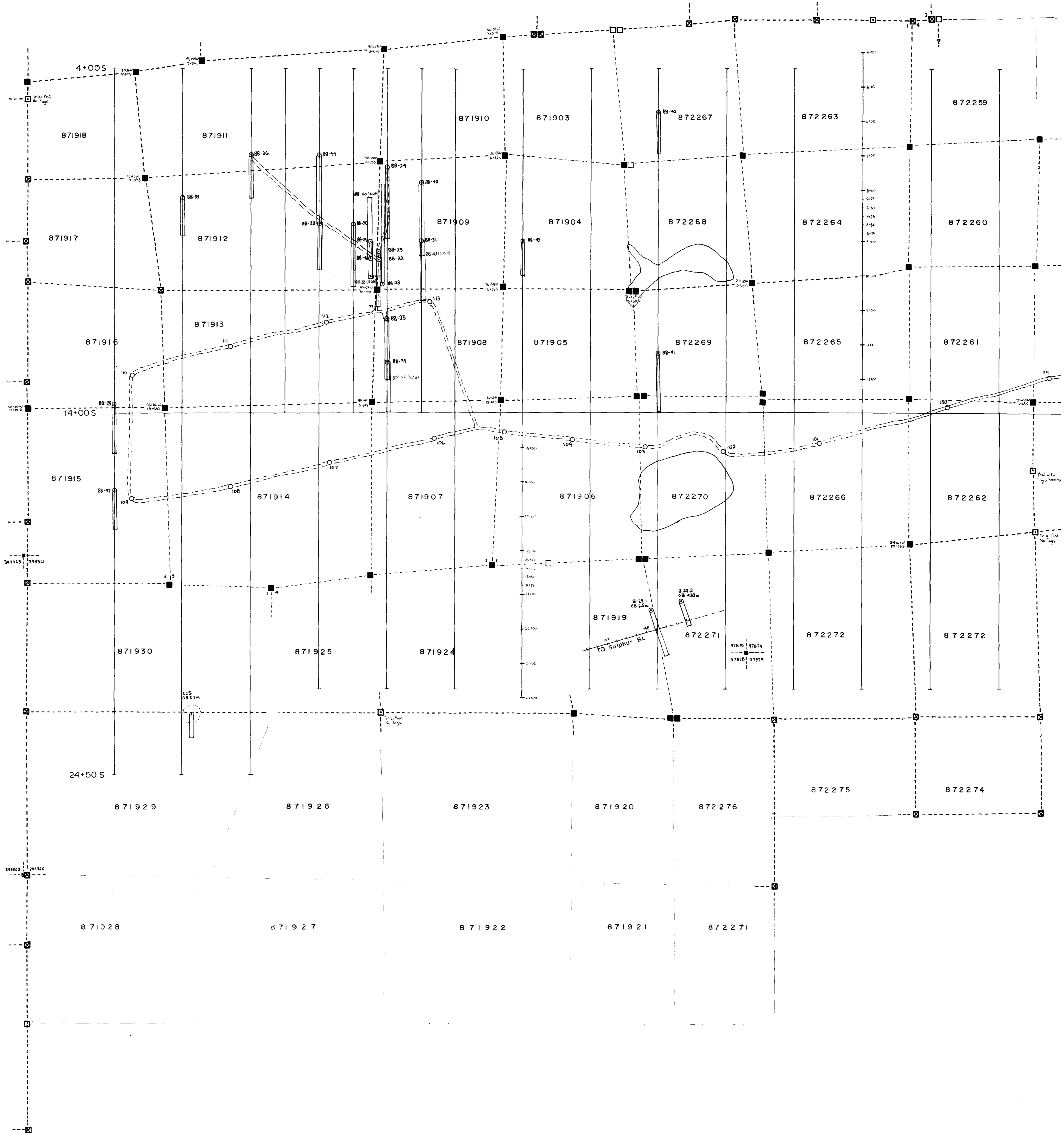

LOCATION MAP

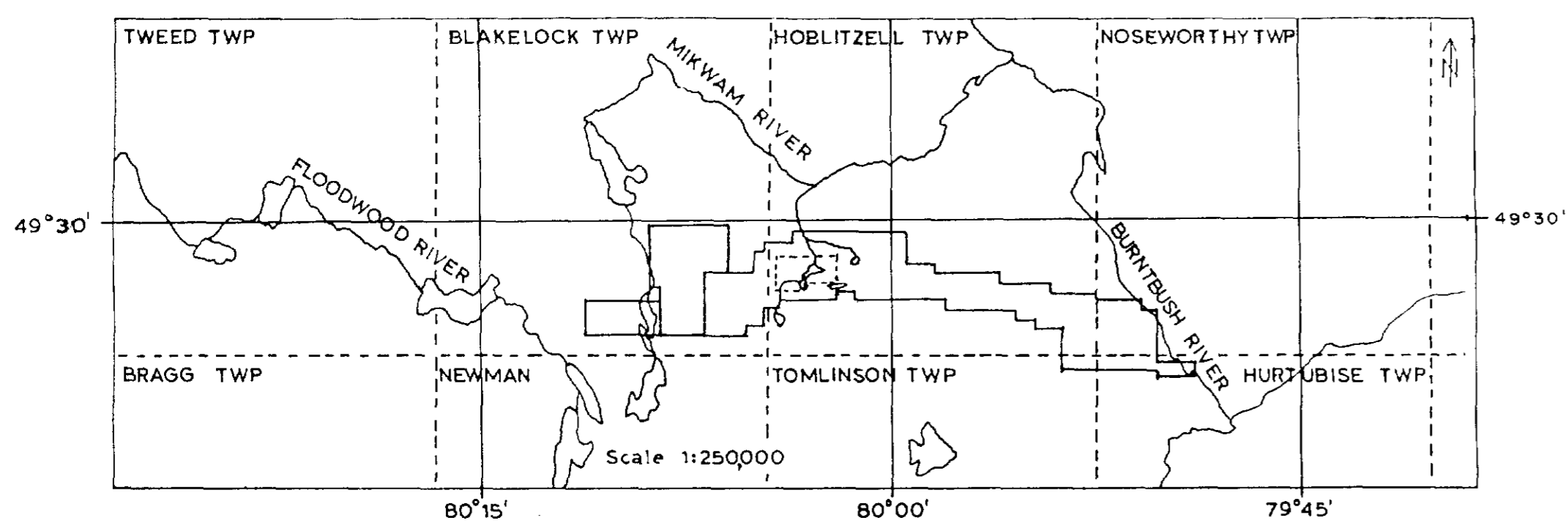

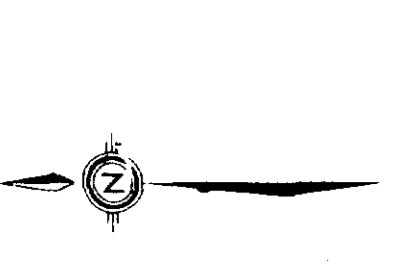

**SYMBOLS**

- 93 ° Reverse Circulation Drill Hole (Vertical)
- ◊ Diamond Drill Hole (inclined - Geology projected to overburden surface at 60°)
- Bulldozer Road
- Post Located - 2nd coordinates
- ⊠ Post Located - pace and compass
- ⊞ Trial Post - trial post with block directions noted
- Post Assumed - post not located but intersecting block directions noted
- Claim Lines approximate (not located)
- - - - - Claim Lines located

HOBLITZELL TOWNSHIP  
NOSEWORTHY TOWNSHIP

TOMLINSON TOWNSHIP  
HURTUBISE TOWNSHIP

NOSEWORTHY TOWNSHIP  
HURTUBISE TOWNSHIP

**MAP 4**

63-5353  
D.V.188-2.36

<b>ESSO MINERALS CANADA</b>			
A DIVISION OF ESSO RESOURCES CANADA LIMITED			
PROSPECT HN (EAST)			
SUBJECT Claim and Drill Hole Location Map			
SURVEY BY	FILE NO	DWG NO	
DRAWN BY MHL	SCALE 1:10000		
REVISED BY	N.T.S. 32E/5	DATE Aug. 1988	



EAST GRID

HOBLITZELL TOWNSHIP  
TOMLINSON TOWNSHIP

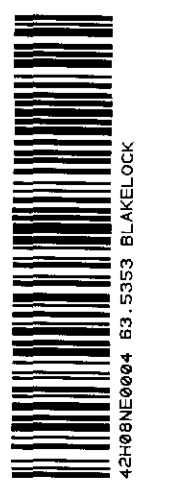
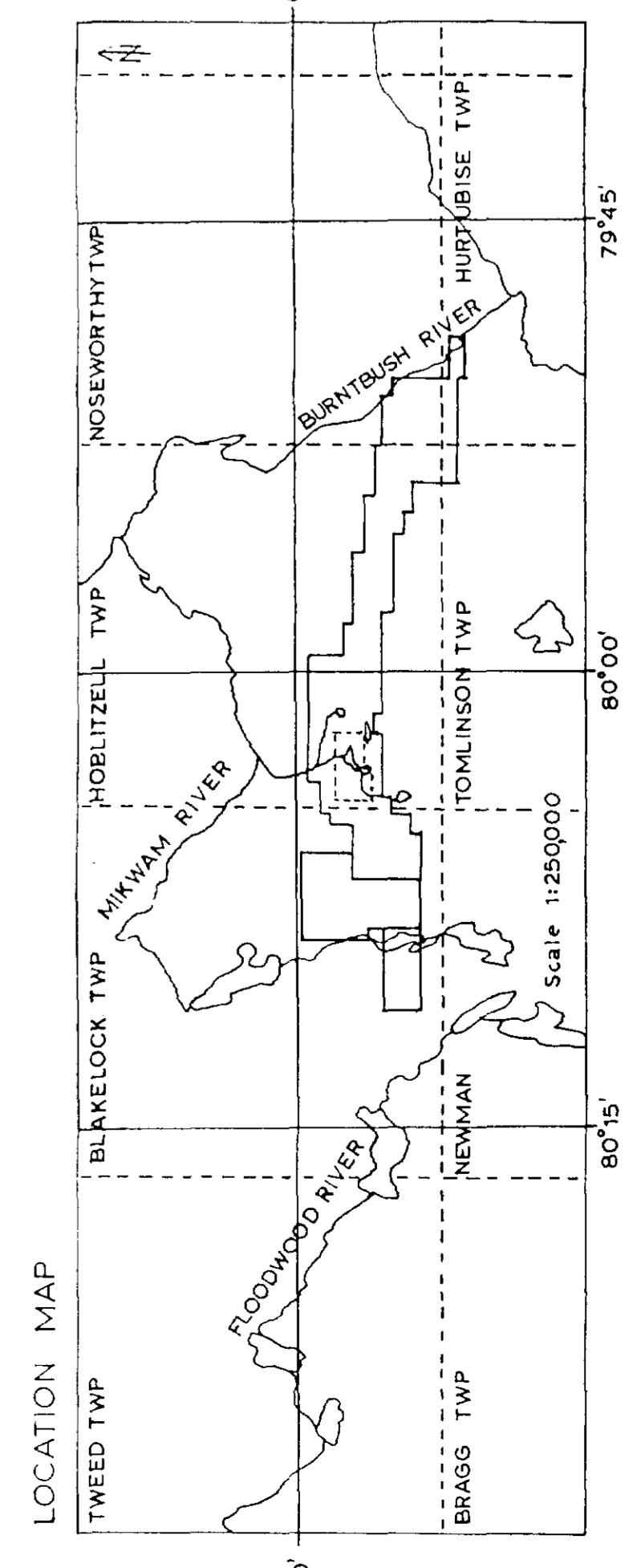

Declination 1°W



**SYMBOLS**

- 33.0 Reverse Circulation Drill Hole (Vertical)
- 33H 85-250 Demand Drill Hole (Inclined - Geology projected to overburden surface at 60°)
- Bulldozer Road

EAST GRID

L62E L64E L66E L68E

L70E L72E L74E L76E L78E L80E L82E L84E

L85

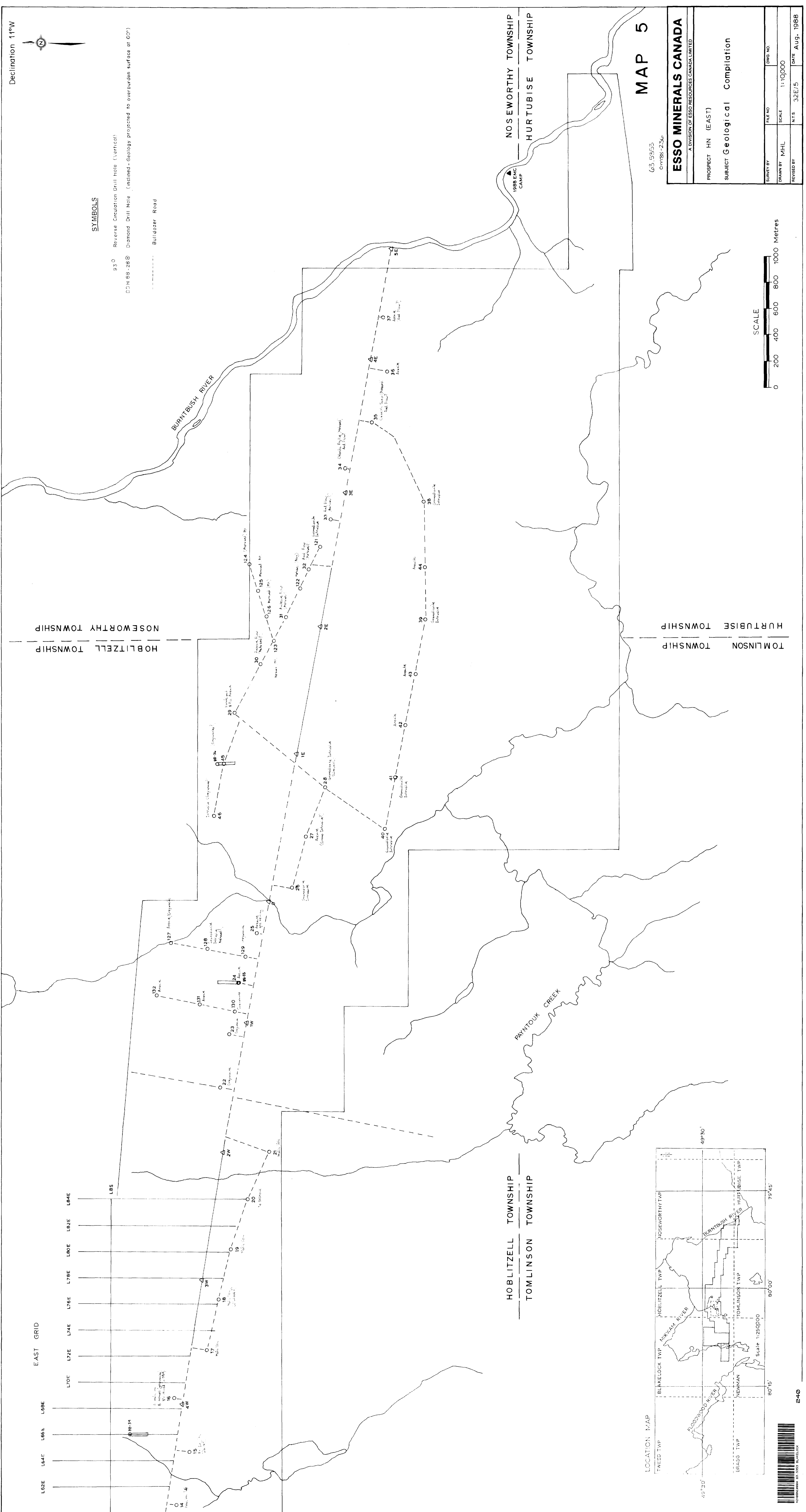

HOBLITZELL TOWNSHIP

TOMLINSON TOWNSHIP

NOSEWORTHY TOWNSHIP

HURTUBISE TOWNSHIP

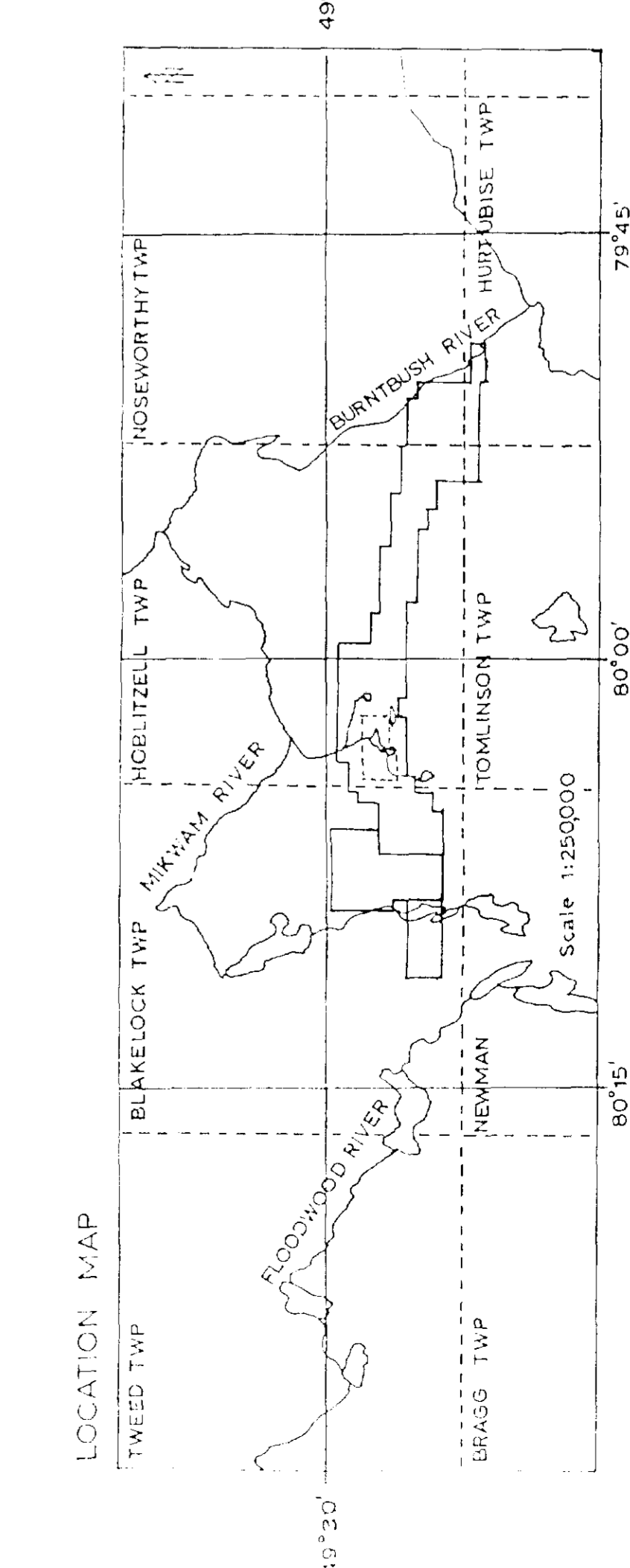

**MAP 5**

63.5553  
01981-236

<b>ESSO MINERALS CANADA</b>			
A DIVISION OF ESSO RESOURCES CANADA LIMITED			
PROSPECT	HN (EAST)	FILE NO	DWG NO
SUBJECT	Geological Compilation	DRAWN BY	MHL
		SCALE	1:10,000
		REVISIONS	NTS 32E/5
		DATE	AUG. 1988

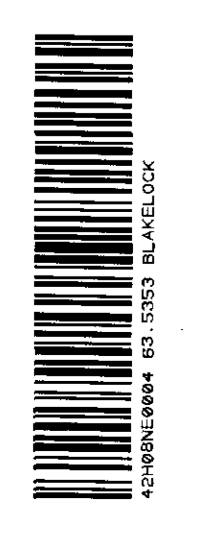
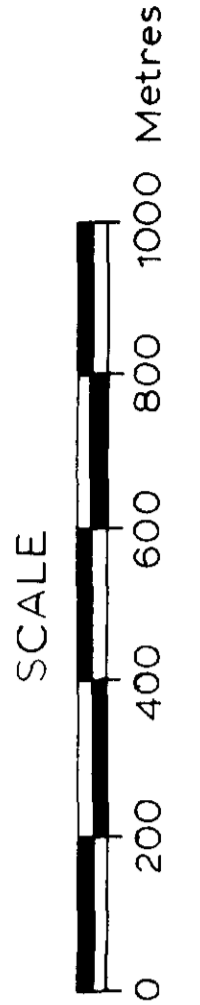



CENTRAL GRID

Newmont Grid

EAST GRID

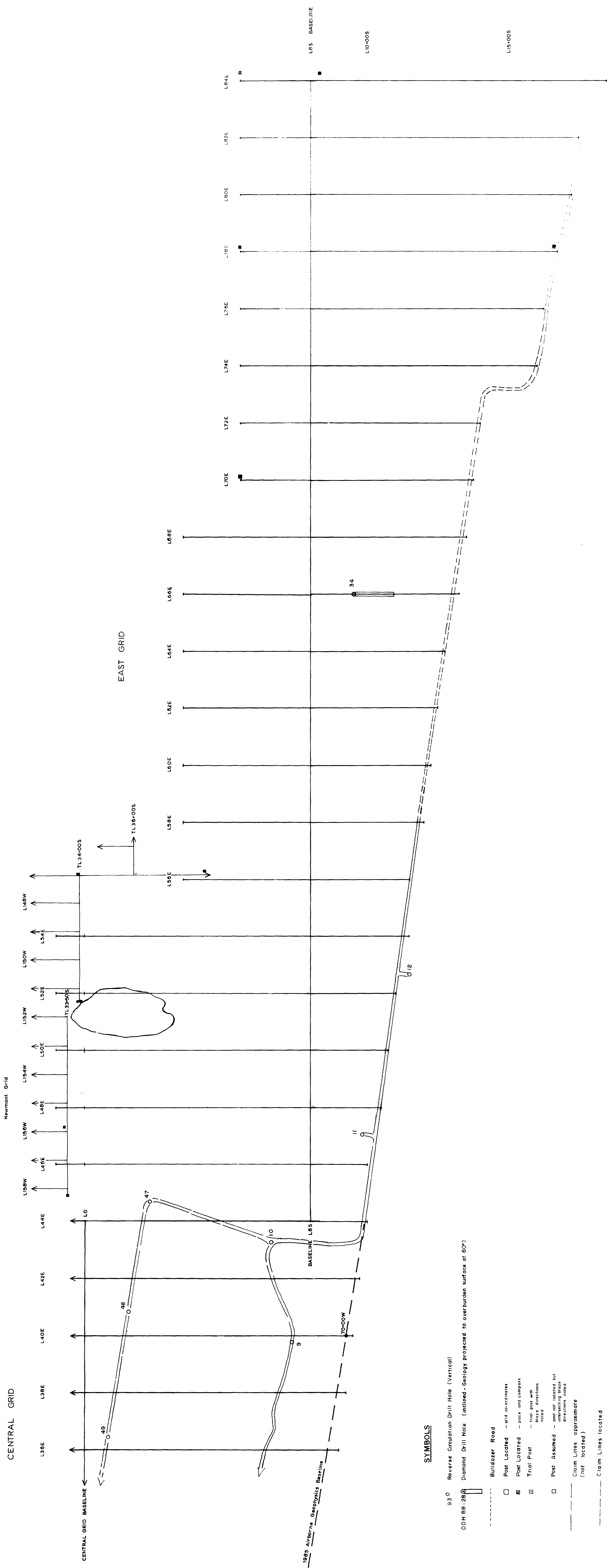

SYMBOLS

- 330 Reverse Circulation Drill Hole (Vertical)
- DDH 88-289 Diamond Drill Hole (inclined - Geology projected to overburden surface at 60°)
- Buildozer Road
- Post Located - grid co-ordinates
- Post Located - pace and compass
- Trial Post - iron post with blaze directions noted
- Post Assumed - post not located but intersecting blaze directions noted
- Claim Lines approximate (not located)
- Claim Lines located

LOCATION MAP

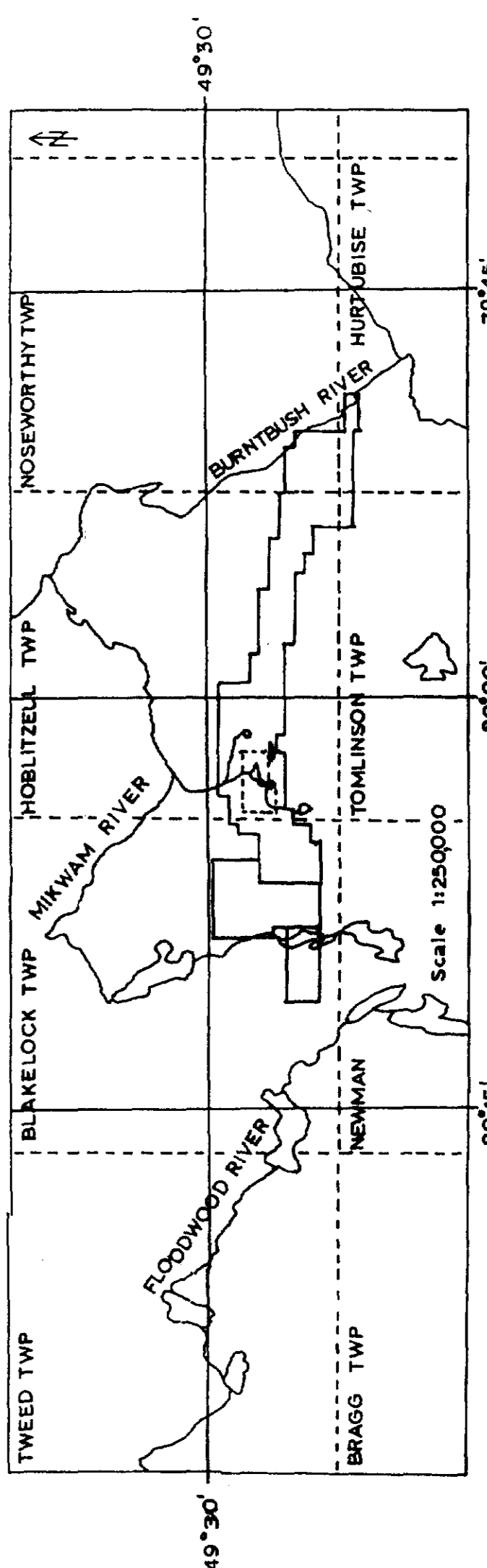

G-3-5-3533  
DMP/88-289g

MAP 6

<b>ESSO MINERALS CANADA</b>			
A DIVISION OF ESSO RESOURCES CANADA LIMITED			
PROSPEC:	HN (EAST GRID)	FILE NO	DWG NO
SUBJECT:	Claim and Drill Hole Location Map	SCALE	1:5000
DRAWN BY:	M-H-L	NTS	32E/5
REVISED BY:		DATE	AUG. 1988





CENTRAL GRID

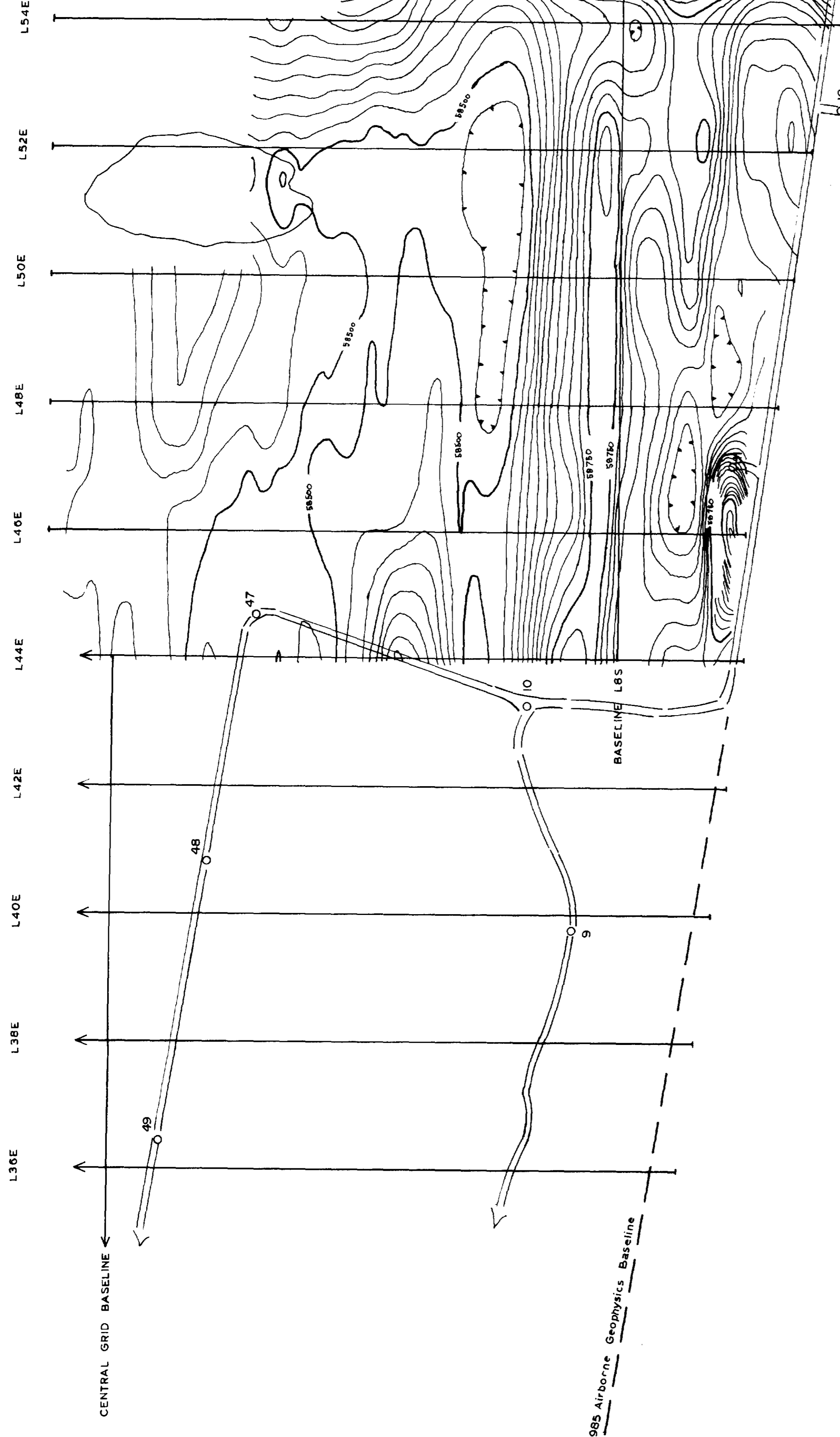

EAST GRID

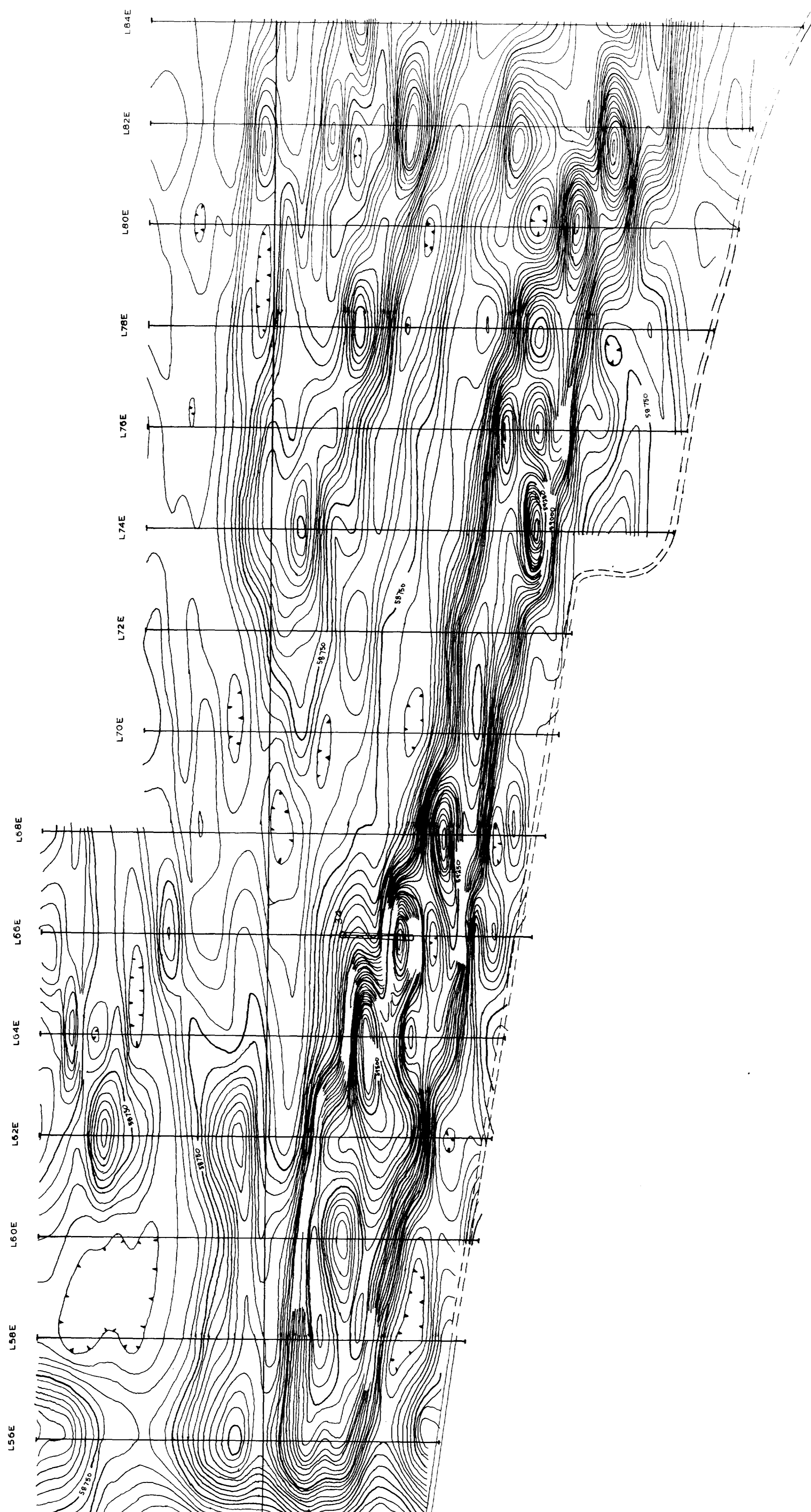

L85 BASELINE

L10\*005

L15\*005

SYMBOLS

- 93 O Reverse Circulation Drill Hole (Vertical)
- DDH 88-28@ Diamond Drill Hole (inclined - Geology projected to overburden surface at 60°)
- Bulldozer Road

LOCATION MAP

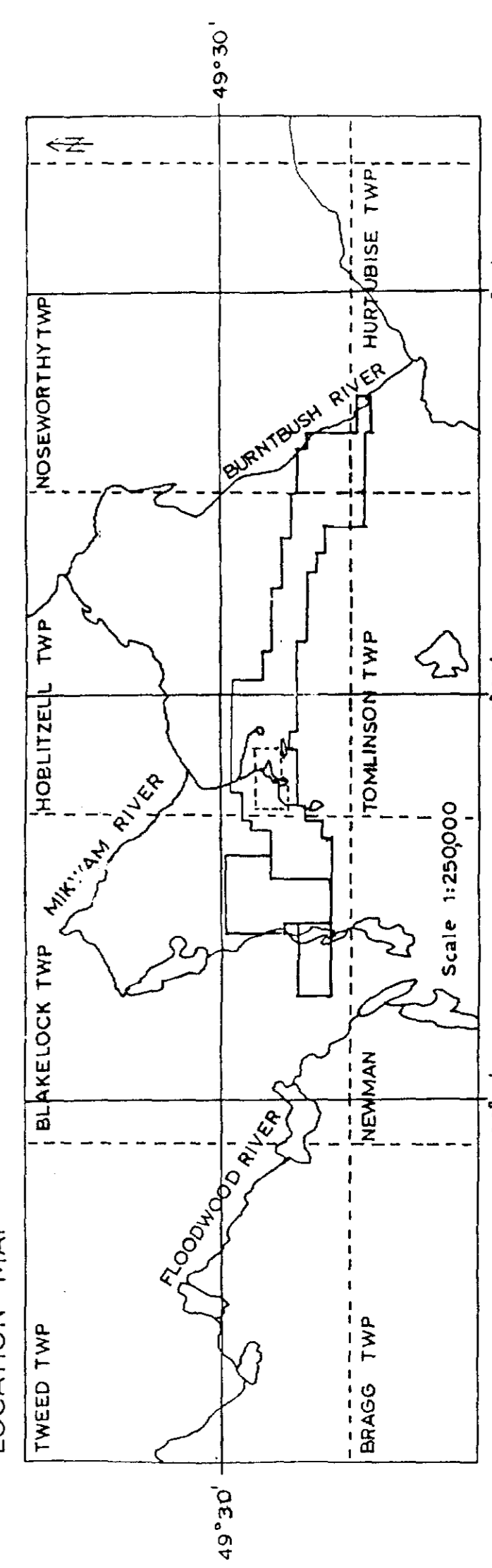

MAP 7

43 5353  
00188-2346

<b>ESSO MINERALS CANADA</b>	
A DIVISION OF ESSO RESOURCES CANADA LIMITED	
PROSPECT HN (EAST GRILL)	FILE NO
SUBJECT TOTAL FIELD MAGNETICS Contour Interval = 25 Gammas Scintrex IGS-MPI4	DATE
SURVEY BY M.H.L. AUG. 1988	DWG NO
DRAWN BY M.H.L. AUG. 1988	SCALE 1:5000
REVISED BY	N.T.S. 32E/5

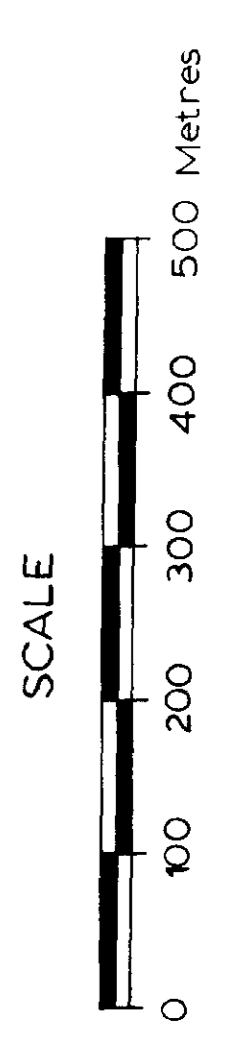

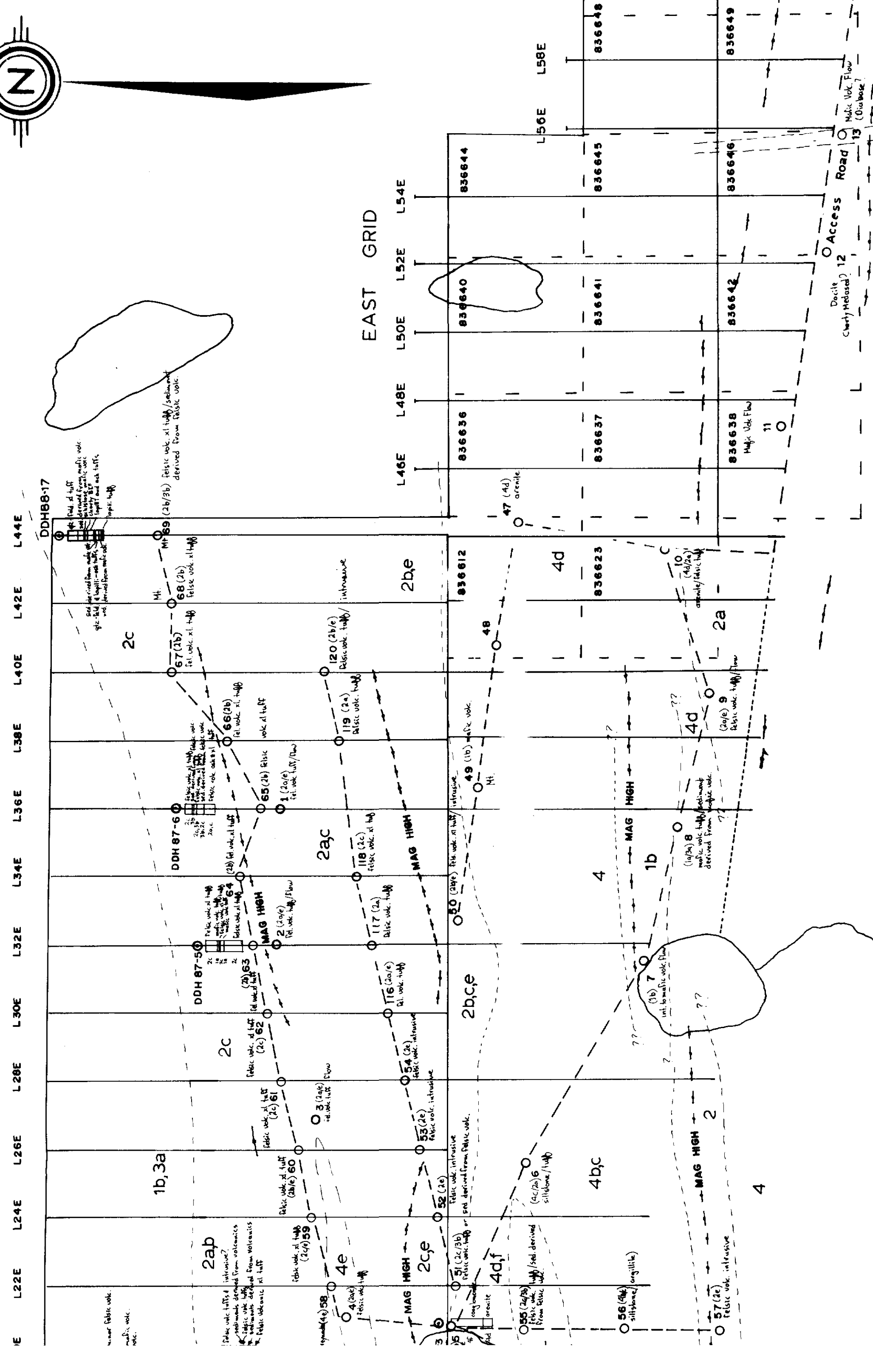
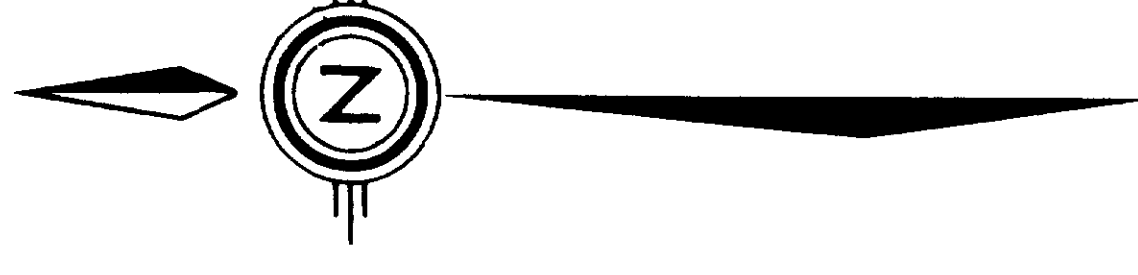

MAF 8

<b>ESSO MINERALS CANADA</b> A DIVISION OF ESSO RESOURCES CANADA LIMITED	
PROSPECT: H-N (Western Half)	
SUBJECT: Geological Map Completion of Outcrop, Diamond Drill Hole and Reverse Circulation Drill Hole Bedrock Samples 22, 53, 53	
SURVEY BY: FILE NO. 22, 53, 53	DWG. NO.
DRAWN BY: MHL	SCALE: 1:10,000
REVISED BY: MHL	DATE: APRIL 1968

**BOILS**

Vertical Drill Hole (Vertical)

Inclined - Geology projected to overburden surface at 60°

Geologic High Axis

Contact (Assumed)

Boundary

Claim Group

