

800-M

M.60800-M
ONTARIO

MINISTRY OF NATURAL RESOURCES
SURVEYS AND MAPPING BRANCH

TWEED

MAY 29 1985

LARDER LAKE MINING DIVISION

DISTRICT OF COCHRANE

Scale - 40 Chains - Inch

NOTE

400' Surface Rights Reservation
around all Lakes and Rivers.

— SRO with reference from state of Surveys, The Mining Act R.S.O. 1970
6-4-1- N.B. 1171 Jan 1977

McQUIBBAN

BLAKELOCK

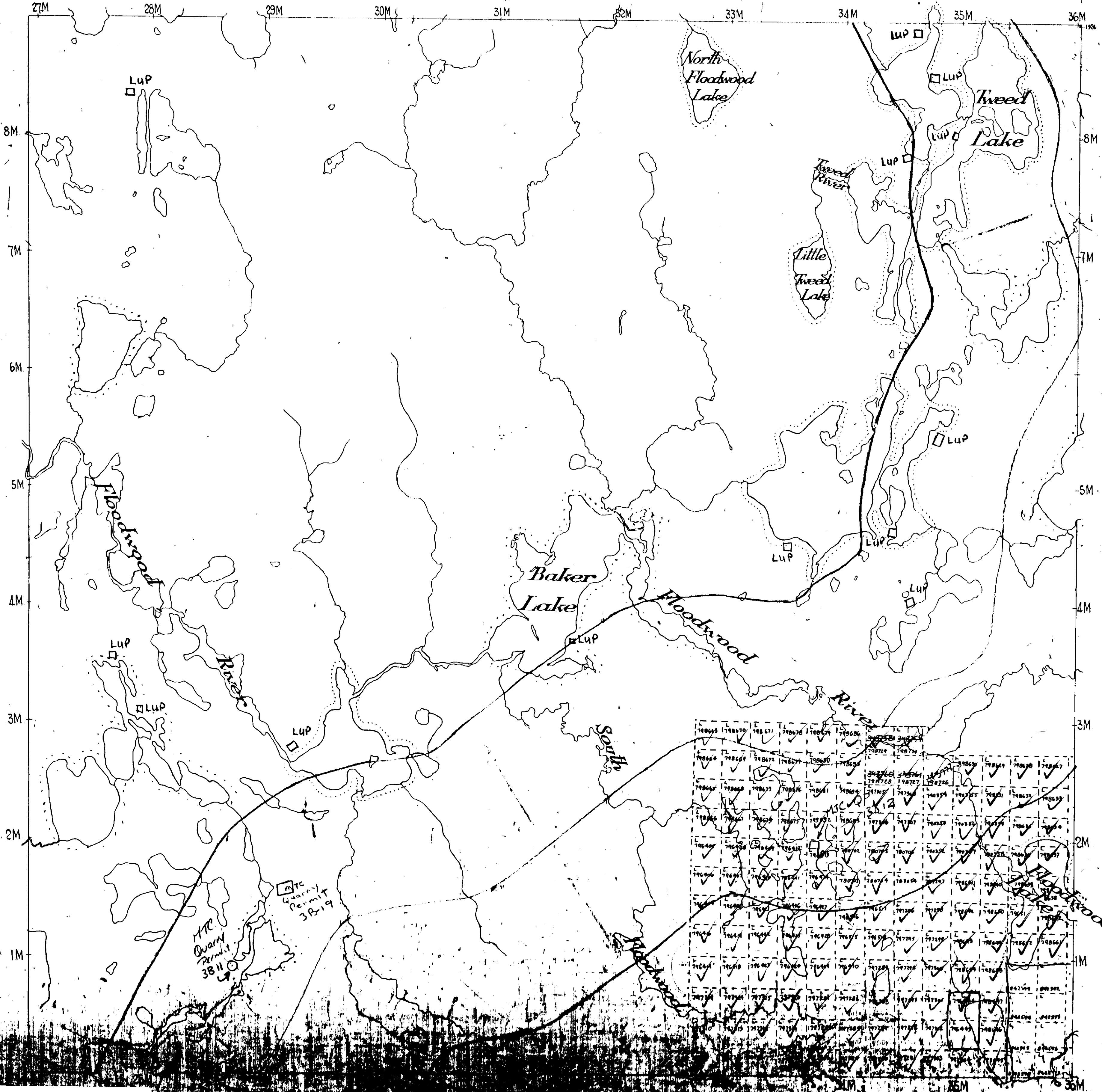

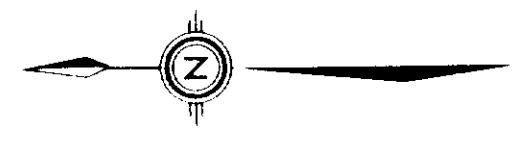
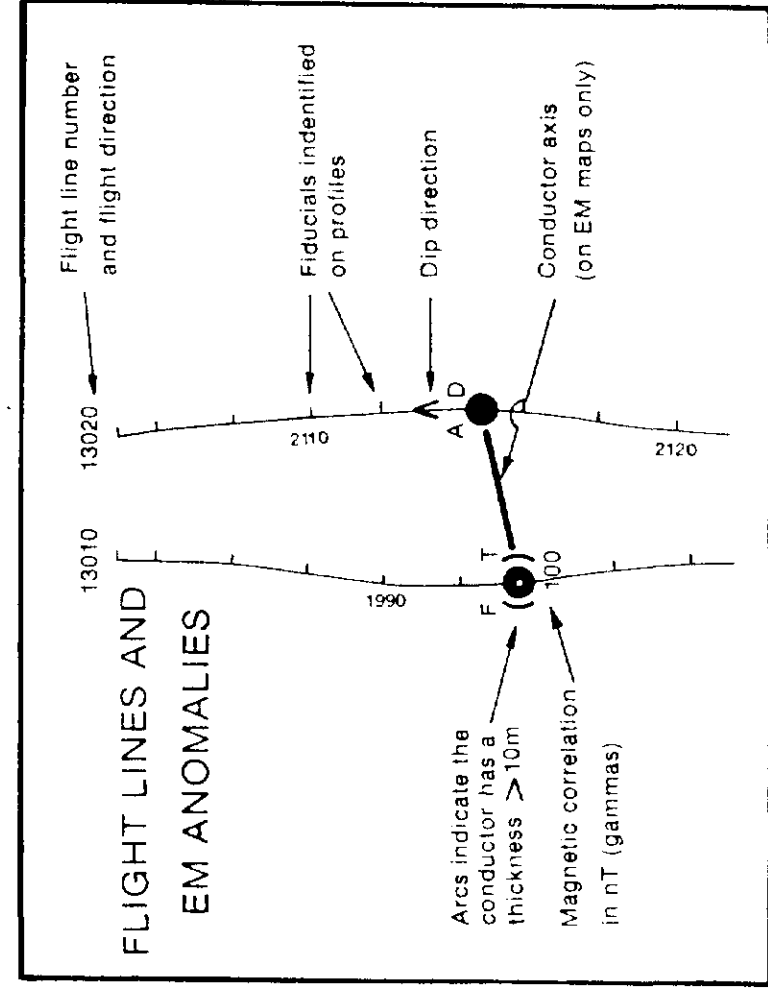
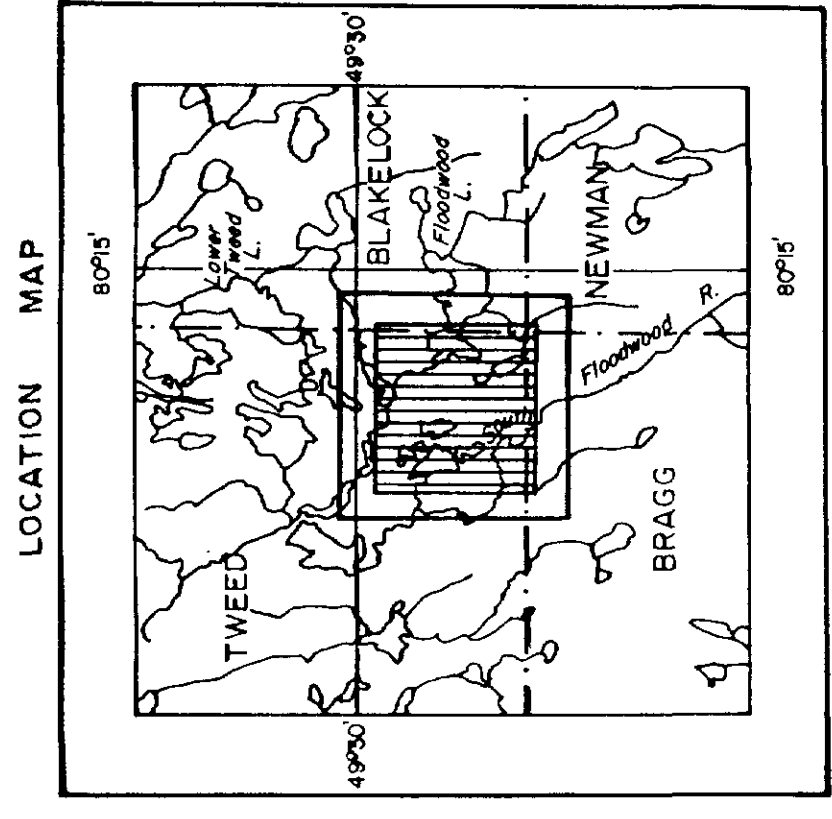

ANOMALY	SYMBOL	DESCRIPTION
1	●	High magnetic intensity
2	○	Low magnetic intensity
3	○	Conductor
4	○	Edge of conductor
5	○	Conductive sheet
6	○	Sheet conductor
7	○	Conductor
8	○	Conductor
9	○	Conductor
10	○	Conductor
11	○	Conductor
12	○	Conductor
13	○	Conductor
14	○	Conductor
15	○	Conductor
16	○	Conductor
17	○	Conductor
18	○	Conductor
19	○	Conductor
20	○	Conductor

28772

GLEN AUDEN RESOURCES LTD.
TWEED TOWNSHIP AREA, ONTARIO

ELECTROMAGNETIC ANOMALIES
BY DIGHEM SURVEYS & PROCESSING INC.

DIGHEM SURVEY GEOPHYSICIST: [Signature]
DATE: NOVEMBER 1995 JOB: 228 DRAFTING BY: [Signature]

Scale 1:100,000
0 0.5 Miles 1 Km

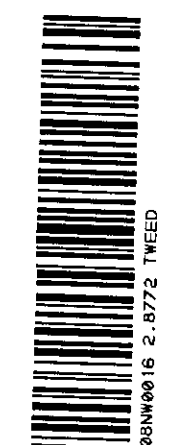
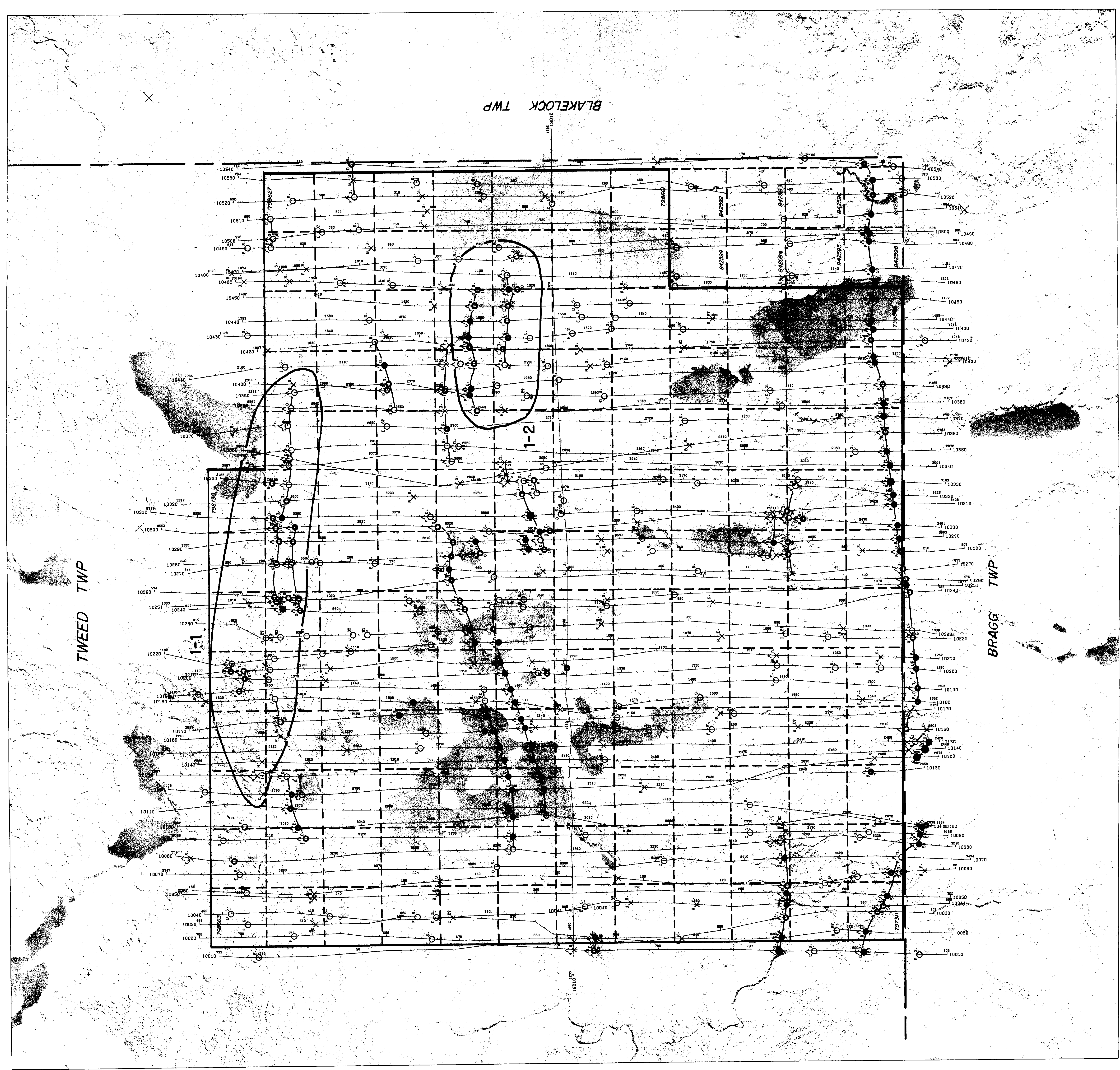

LOCATION MAP

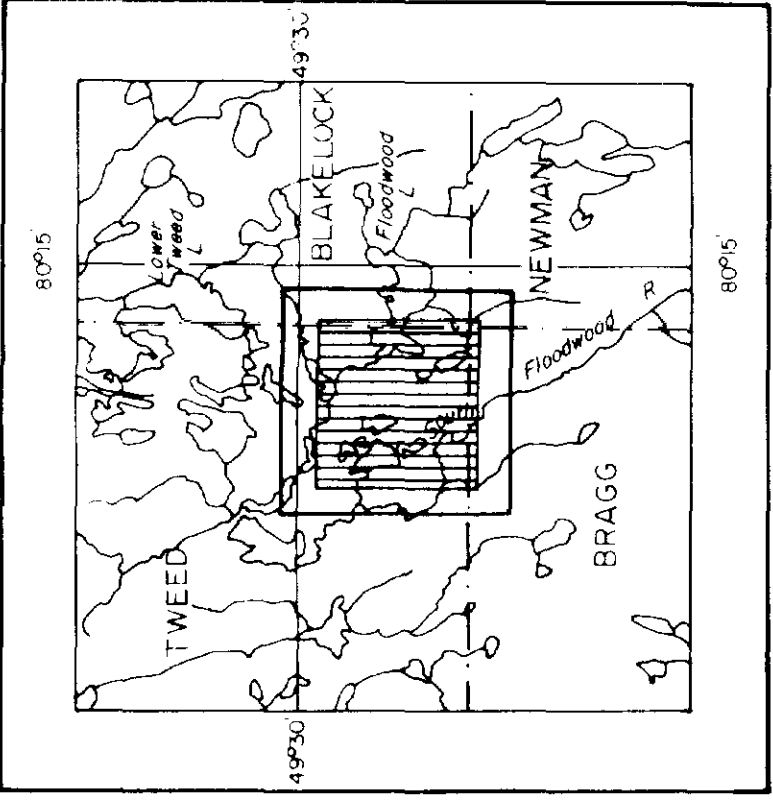

SCALE 1:250,000

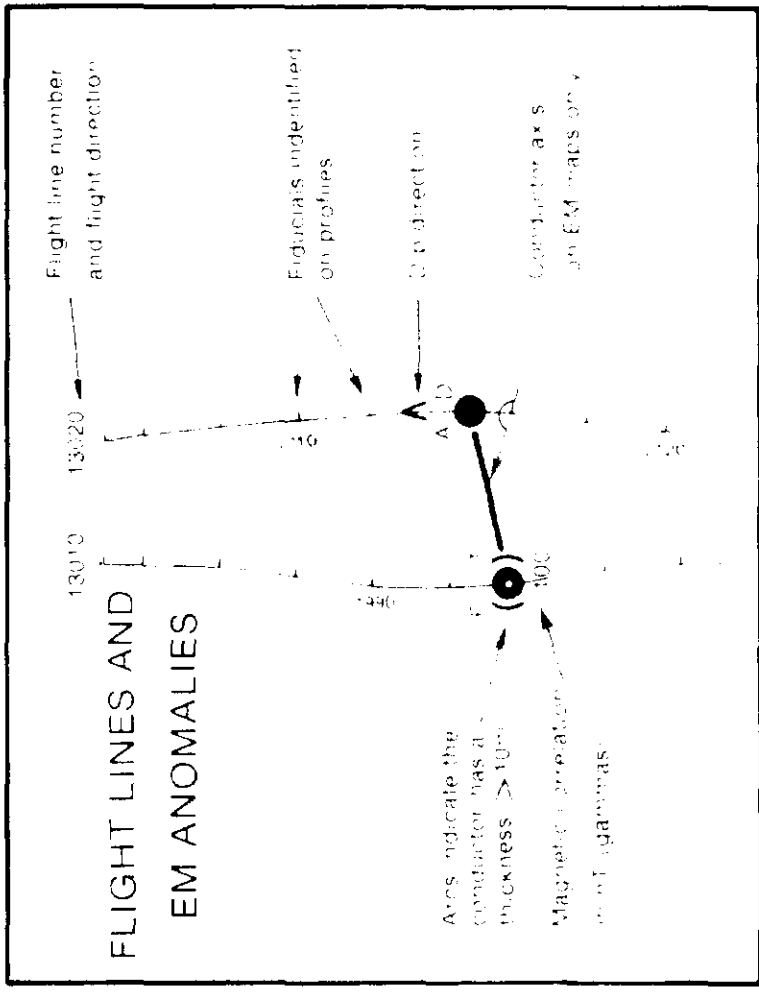

ISOMAGNETIC LINES (total field)

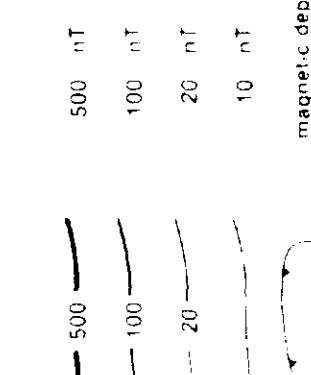

Number indicates value in nT, not 10⁻⁵ nT

ANOMALY	SYMBOL	CONTOUR INTERVAL	DESCRIPTION
1	●	500 nT	500 nT contour interval
2	○	100 nT	100 nT contour interval
3	○	20 nT	20 nT contour interval
4	○	10 nT	10 nT contour interval
5	○	< 10 nT	< 10 nT contour interval

SYMBOL	DESCRIPTION
1	PROBABLE CAUSE
1	1. TYPICAL SURFACE CONDUCTIVITY
2	2. TYPICAL SURFACE CONDUCTIVITY
3	3. TYPICAL SURFACE CONDUCTIVITY
4	4. TYPICAL SURFACE CONDUCTIVITY
5	5. TYPICAL SURFACE CONDUCTIVITY
6	6. TYPICAL SURFACE CONDUCTIVITY
7	7. TYPICAL SURFACE CONDUCTIVITY

2872

GLEN AUDEN RESOURCES LTD.
TWEED TOWNSHIP AREA, ONTARIO

TOTAL FIELD MAGNETICS
BY DIGHEM SURVEYS & PROCESSING INC.

DIGHEM SURVEY GEOPHYSICIST
DATE: NOVEMBER 1985 JOB 228 DRAFTING BY: [Signature]

Scale: 1:100,000
0 1 Km
0 1 Mile

