



42H12NW0001 10 AGATE

010

Diamond Drilling

Township of AGATE

Report No: 10

Work performed by: INCO

Claim No	Hole No	Footage	Date	Note
P 85209	32311	564'	July/66	
P 85210	32314	388'	July/66	
	32316	415'	July/66	
P 85206	32326	459'	Sept/66	
	32328	<u>326'</u>	Sept/66	
		2152		

Notes:

P-85206

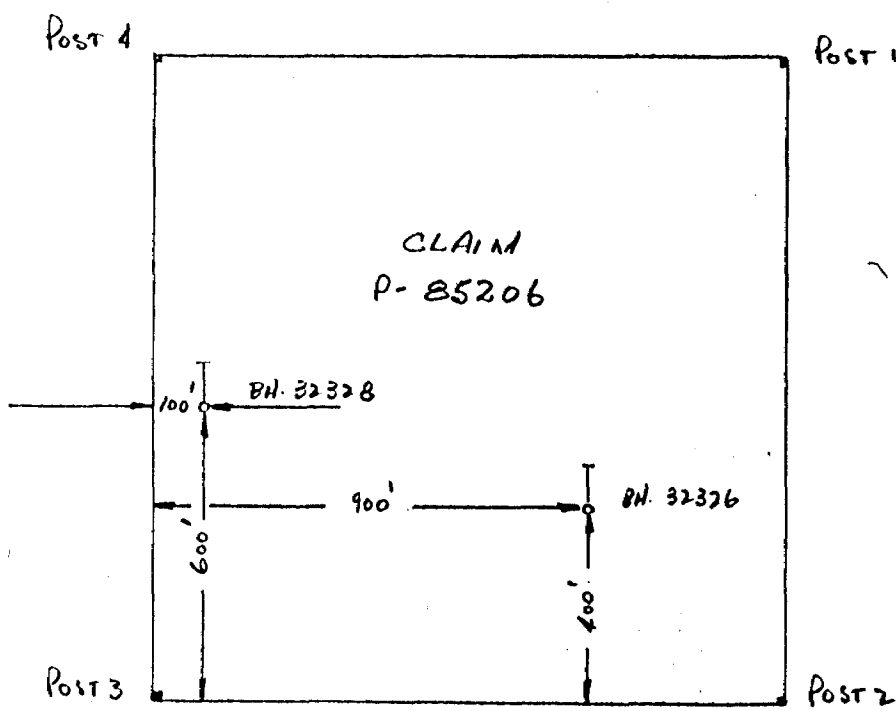

LOCATION SKETCH
of BORE HOLES: 32328; 32326
LOCATED ON CL. P-85206
AGATE TWP.
PORCUPINE MINING DIVISION
SCALE: 1 INCH = 100 FT.

PROPERTY KAP 1 9-04; AGATE TWP SAMPLING RECORD

SHEET NO. 9

CLAIM NO. P 85210; 600' E, 800' S of Post 4

CO-ORDINATES

HOLE NO. 32314 DEPTH 388.0' ANGLE 50° STRIKE S ELEVATION _____

A700E 1450N

DEPTH FEET	FORMATION	SAMPLE NO.	LENGTH FT.	ANALYSIS			LENGTH FEET	PROGRESSIVE TOTALS		
				COPPER %	NICKEL %	CU. & NI. %		FEET X PER CENT		
SUMMARY										
00.0	COLLAR									
190.0	OVERBURDEN									
192.4	MVVW GRAPHITE GNEISS									
	- mass silver grey graphite flakes - conductor									
203.5	QTB. FELDS BIOT. GNEISS									
263.0	GARNET QTB. FELDS BIOT. GNEISS									
374.0	QTB. FELDS BIOT. GNEISS									
388.0	PEGMATITIC GNEISS									
388.0	BOTTOM OF HOLE									
DATE STARTED:- JULY 16, 1966										
DATE COMPLETED:- JULY 27, 1966										
DRILLED BY:- HEATH AND SHERWOOD LTD.										
CORE SIZE:- EXT										
HOLE NOT PLUGGED										
CASING LOST:- NIL										
ACID TESTS:-										
@ 200' - 47°										
300' - 44°										
LOGGED BY:- <i>gm J. Gellish</i>										

THE INTERNATIONAL NICKEL CO. OF CANADA, LIMITED

PROPERTY API, 9-04; AGATE TWP **SAMPLING RECORD**SHEET NO. 3CLAIM NO. P 85210; 600' E & 700' S OF POST P4

CO-ORDINATES

HOLE NO. 32316 DEPTH 415.0' ANGLE 55°STRIKE S ELEVATION _____4100E 2150N

DEPTH FEET	FORMATION	SAMPLE NO.	LENGTH FT.	ANALYSIS			LENGTH FEET	PROGRESSIVE TOTALS		
				COPPER %	NICKEL %	CU. & NI. %		FEET X PER CENT		
SUMMARY										
00.0	COLLAR									
15.0	OVERBURDEN									
28.5	WEATHERED GNEISS - partially consolidated									
241.0	SHEARED QTZ FELDS BIOT. GNEISS									
265.0	GARNET QTZ FELDS BIOT. GNEISS									
276.0	GRAPHITIC GNEISS - concentration of graphite @ 272.0'-273.3'									
415.0	QTZ. FELDS BIOT. GNEISS									
415.0	BOTTOM OF HOLE									
DATE STARTED:- JULY 29, 1966										
DATE COMPLETED:- JULY 31, 1966										
DRILLED BY: HEATH AND SHERWOOD LTD										
CORE SIZE: AX & EX										
HOLE NOT PLUGGED										
CASING LOST:- EX-90'										
ACID TESTS:-										
@ 140'-56.5°										
240'-55.5°										
340'-54.5°										
LOGGED BY:- <i>M. J. Staluck</i>										

THE INTERNATIONAL NICKEL CO. OF CANADA, LIMITED

PROPERTY AP. I. ANOM. 9-03; AGATE TRP. **SAMPLING RECORD**SHEET NO. 6CLAIM P- B5206: 100'E + 600'N of Post 3

CO-ORDINATES

HOLE NO. 32328 DEPTH 326.0 ANGLE 55° STRIKE N ELEVATION20100 W0 + 20.5

DEPTH FEET	FORMATION SUMMARY	SAMPLE NO.	LENGTH FT.	ANALYSIS			LENGTH FEET	PROGRESSIVE TOTALS FEET X PER CENT		
				COPPER %	NICKEL %	CU. & NI. %		COPPER	NICKEL	CU. & NI.
0.0	COLLAR									
94.0	OVERBURDEN									
122.3	QTZ. FELDS. BIOT. GNEISS									
	M.W. - Py, Po blebs.									
122.5	PYRITE VEIN									
	Mass. Py.									
130.1	QTZ. FELDS. BIOT. GNEISS									
	M.W. - Py, Po blebs. @ 122.5' - 128.5'									
145.4	FELDSIC ZONE									
	- minor garnet grains; Tr. Cpy.									
	M.W. - Po, Py @ 130.1' - 139.7'									
	M. - Po, Py @ 144.0' - 145.4'									
167.6	QTZ. FELDS. BIOT. GNEISS									
	M.W. - Po, Py grains; Garnet grains throughout - very minute Cpy. blebs.									
194.6	SILLIMANITE GARNET QTZ. FELDS. BIOT. GNEISS									
197.0	BASALT DYKE									
	fg. diabase - magnetic									
258.5	PERMATIC GNEISS									
288.0	QTZ. FELDS. BIOT. GNEISS									
295.0	DIABASE DYKE - fg.									
326.0	QTZ. FELDS. BIOT. GNEISS									
326.0	BOTTOM OF HOLE									

DATE STARTED: SEPT. 16, 1966DATE COMPLETED: SEPT. 19, 1966DRILLED BY: HEATH AND SHERWOOD DRILLING LTD.CORE SIZE: EXT

HOLE NOT PLUGGED

CASING LOST: NILACID TESTS: @ 100' - 55.5°
200' - 56.5°
300' - 55.5°LOGGED BY: M. J. ADLICKrechecked by W. J. Kidney

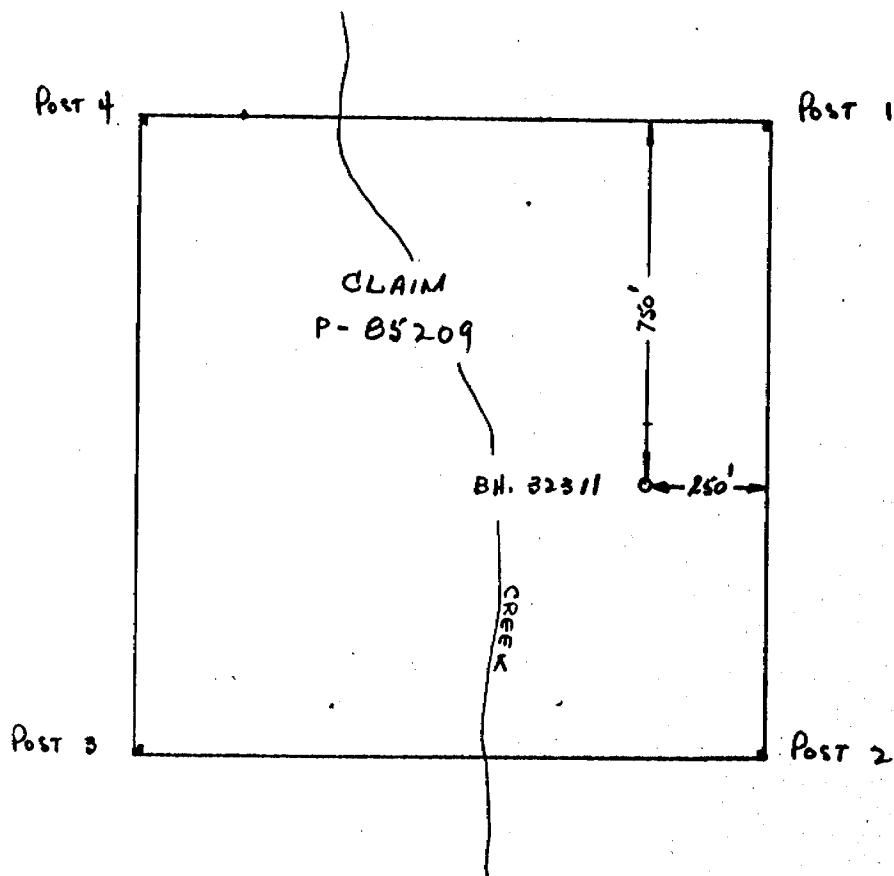

LOCATION SKETCH
 of BORE HOLE: 32311
 LOCATED on CL. P-85209
 AGATE TWP.
 PORCUPINE MINING DIVISION
 SCALE: 1 INCH = 400 FT.

85209

THE INTERNATIONAL NICKEL CO. OF CANADA, LIMITED

PROPERTY CAP I - ANOM 9-05, AGATE TWP. SAMPLING RECORD SHEET NO. 7

CLAIM P. BS209 - 250' W + 750' S of Post 1

CO-ORDINATES

HOLE NO. B2B11 DEPTH 664.0' ANGLE 50° STRIKE N ELEVATION _____

0700 1750 S

DEPTH FEET	FORMATION	SAMPLE NO.	LENGTH FT.	ANALYSIS			LENGTH FEET	PROGRESSIVE TOTALS		
				COPPER %	NICKEL %	CU. & NI. %		FEET X PER CENT		
SUMMARY										
0.0	Collar									
84.0	Overburden									
111.6	Qtz. Felds. Biot. Gneiss.									
151.5	Garnet Magnetite Biot. Gneiss									
170.0	Garnet Qtz. Felds. Biot. Gneiss									
183.3	Garnet Magnetite Biot. Gneiss									
	M.W. Py @ 176.0' - 183.3'									
184.0	Pyrite vein									
	M. Py blebs									
219.0	Garnet Qtz. Felds. Biot. Gneiss									
	M.W. Py @ 192.5' - 198.3'									
231.7	Felds. Phase									
	M. Py. @ 221.2' - 227.1'									
	M.W. Py @ 227.1' - 231.7'									
236.8	Qtz. Felds. Biot. Paragneiss									
246.0	Magmatic Gneiss									
270.0	Qtz. Felds. Biot. Gneiss									
422.0	Magnetiferous Qtz. Felds. Biot. Paragneiss									
467.6	Permatitic Gneiss									
473.4	Felds. Gneiss									
	M.W. Py. @									
493.4	Sillimanite Gneiss									
	M.W. Py. @									
564.0	Qtz. Felds. Biot. Gneiss									
564.0	BOTTOM OF HOLE.									

DATE STARTED: JULY 6, 1966
 DATE COMPLETED: JULY 11, 1966

DRILLED BY: HEATH AND SHERWOOD DRILLING LTD.

HOLE NOT PLUGGED
 CORE SIZE: EXT.
 CASING LOST: AX 20'; EX 10'

ACID TESTS: @ 100' - 49°
 200' - 46°
 300' - 42.5°
 400' - 42°
 500' - 45°

LOGGED BY: M.J. GODLUCK
 RECORDED BY: W.V. Rodney

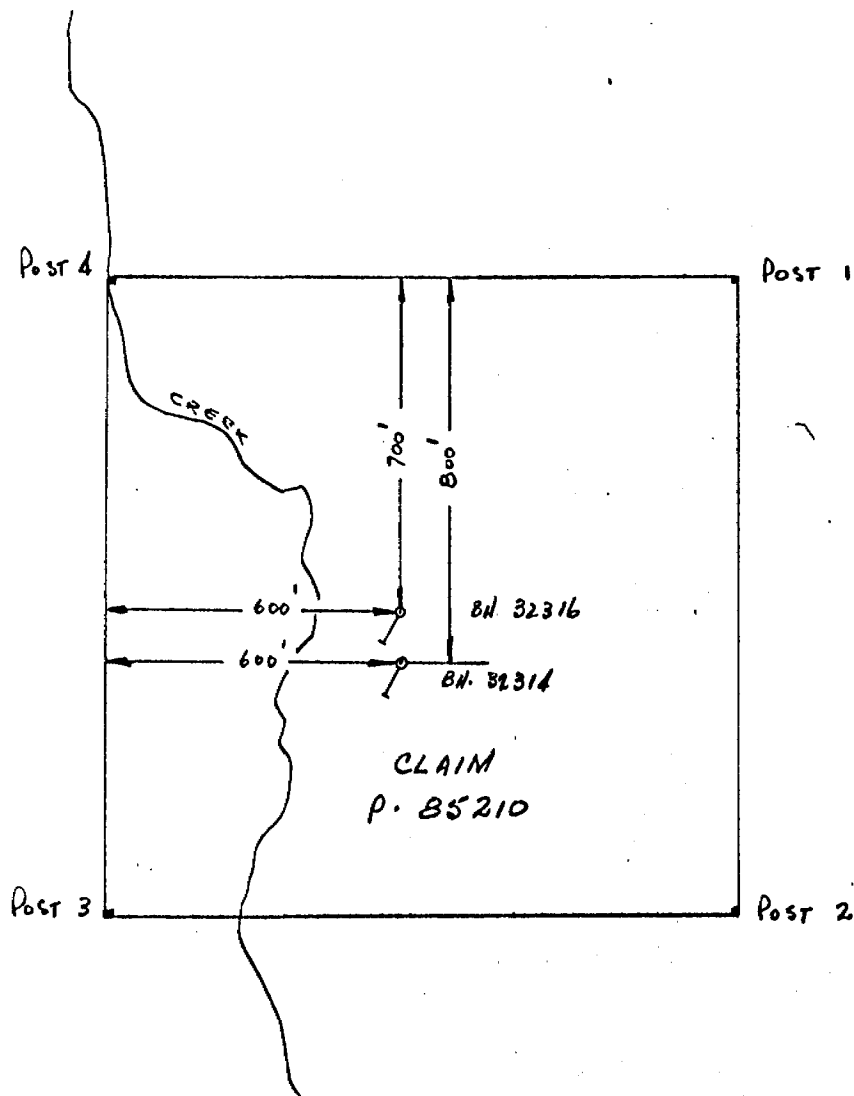

LOCATION SKETCH
 of BORE HOLES: 32314; 32316
 LOCATED on CL. P. 85210
 AGATE TWP.

PORCUPINE MINING DIVISION
 SCALE: 1 INCH = 400 FT.