



42H12SW2001 2.18388

HURDMAN

010

2.18388

Report of work

March -April 1998 -Diamond drill program

Hurdman JV: Baltic Resources Inc.

Garth Pierce , Bclx Consulting Ltd.

April 15 ,1998

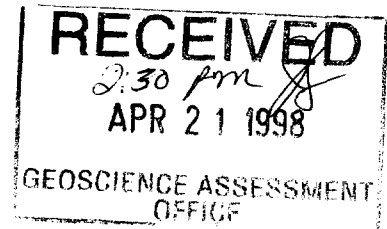

Introduction

This report describes a one week drill program undertaken by Baltic Resources Inc.(Baltic) on a base metal project located in Hurdman township , Ontario. Baltic acquired a 40% interest in the project through an agreement reached in 1997 with Noront Resources Ltd (Noront) and Don McInnon . Baltic then agreed to fund the initial \$75,000 to earn a further ten percent interest in the project which would then be a 50/50 joint venture operated by Baltic.

Baltic retained BCLX Consulting Ltd ,(Bclx), to review the project and propose further work .The drill program described in this report covers the initial phase of drilling proposed by this consulting group. Garth Pierce , president of Bclx , supervised the drill program and logged all drill holes . Site preparation , including reestablishing of a portion of the property grid was carried out by Ed Korba of Silver Spruce Exploration Inc. , a Timmins based exploration services company.

Norex Drilling of Timmins was awarded the drill contract in the last week of March and completed the program between March 30th and April 7th ,1998 . Four drill holes totalling 560 meters were completed in this program.

Bclx recommended that numerous samples be taken and assayed from this program but Baltic requested that no initial sampling be taken until one or more Baltic directors had the opportunity to review the core. As of the date this report was written , no assaying had been done.

Location and Access - (Figure 1& 2)

The Hurdman project is located approximately 25 kilometers northwest of the town of Smooth Rock Falls . Access to the drill site is gained by travelling west from Smooth Rock Falls for 11 kilometers then northward along a winter logging road for 28 kilometers. The first 20 kilometers of the logging road would be useable year round but the last 8 kilometers are strictly winter road although skidder access should be possible for the summer programs.

During the drill program spring break-up made access difficult. As a result Norex crews established a tent camp on site . A geologist and field assistant travelled to and from site daily by six wheel drive vehicle . Core was logged briefly on location then moved to Timmins to be properly examined .

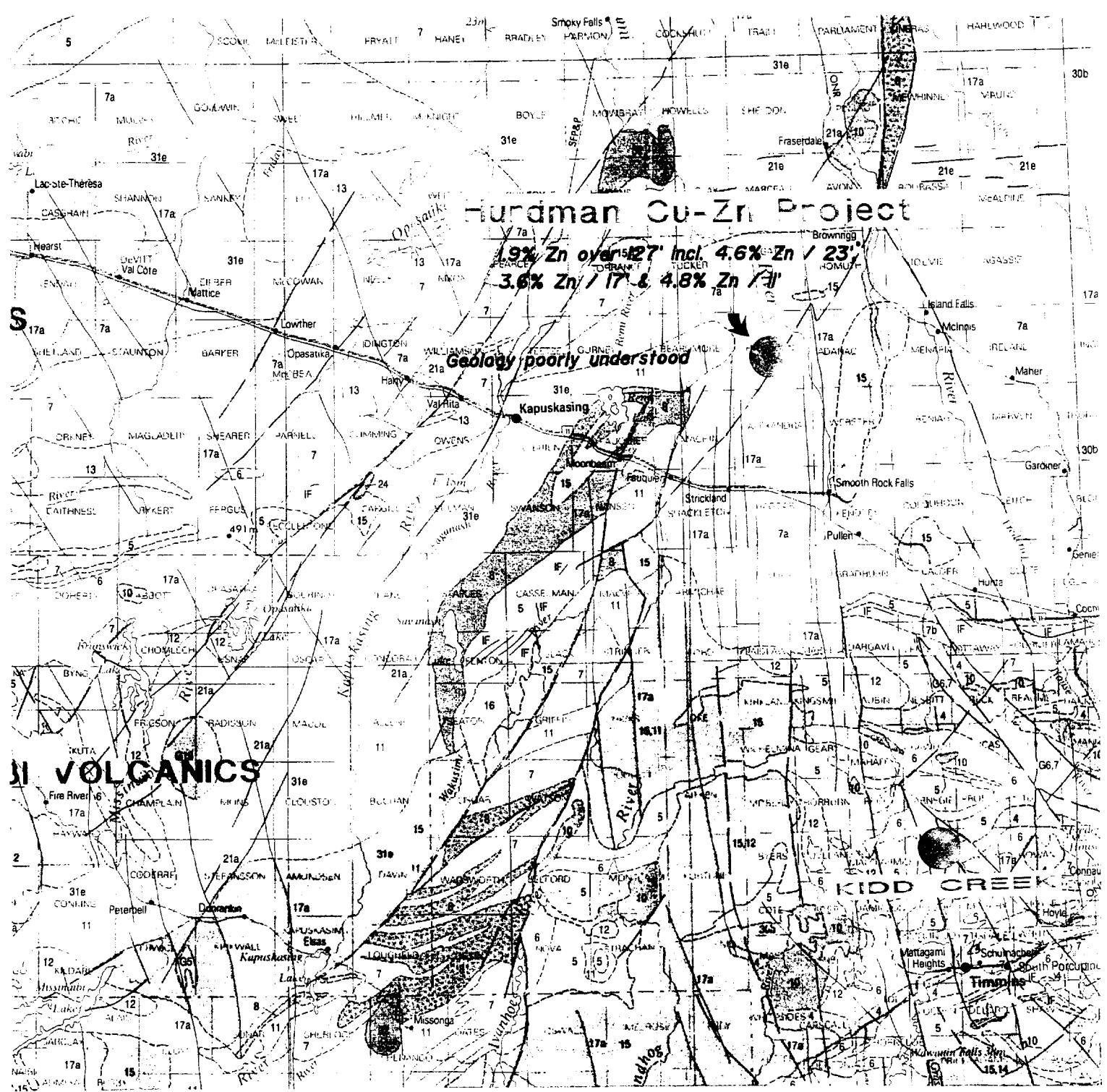

LEGEND

fic to Intermediate Metavolcanic Rocks
 sic to Intermediate Metavolcanic Rocks
 'agneisses and Migmatites
 issic Tonalite Suite with supracrustal inclusions

BCLX CONSULTING LIMITED
 Box 278 N.S.
 BOP 1X
 Fax/Phone 902-542-0819

[Handwritten signature]
 12/4/92

(from MNDM
 Map 2543)

REVISIONS	BALTIC RESOURCES		
	FIGURE 1		
	REGIONAL GEOLOGY		
	MAP		
	Date Feb 1992	Drawn H H	
		Scale 1:1000000	Figure 4

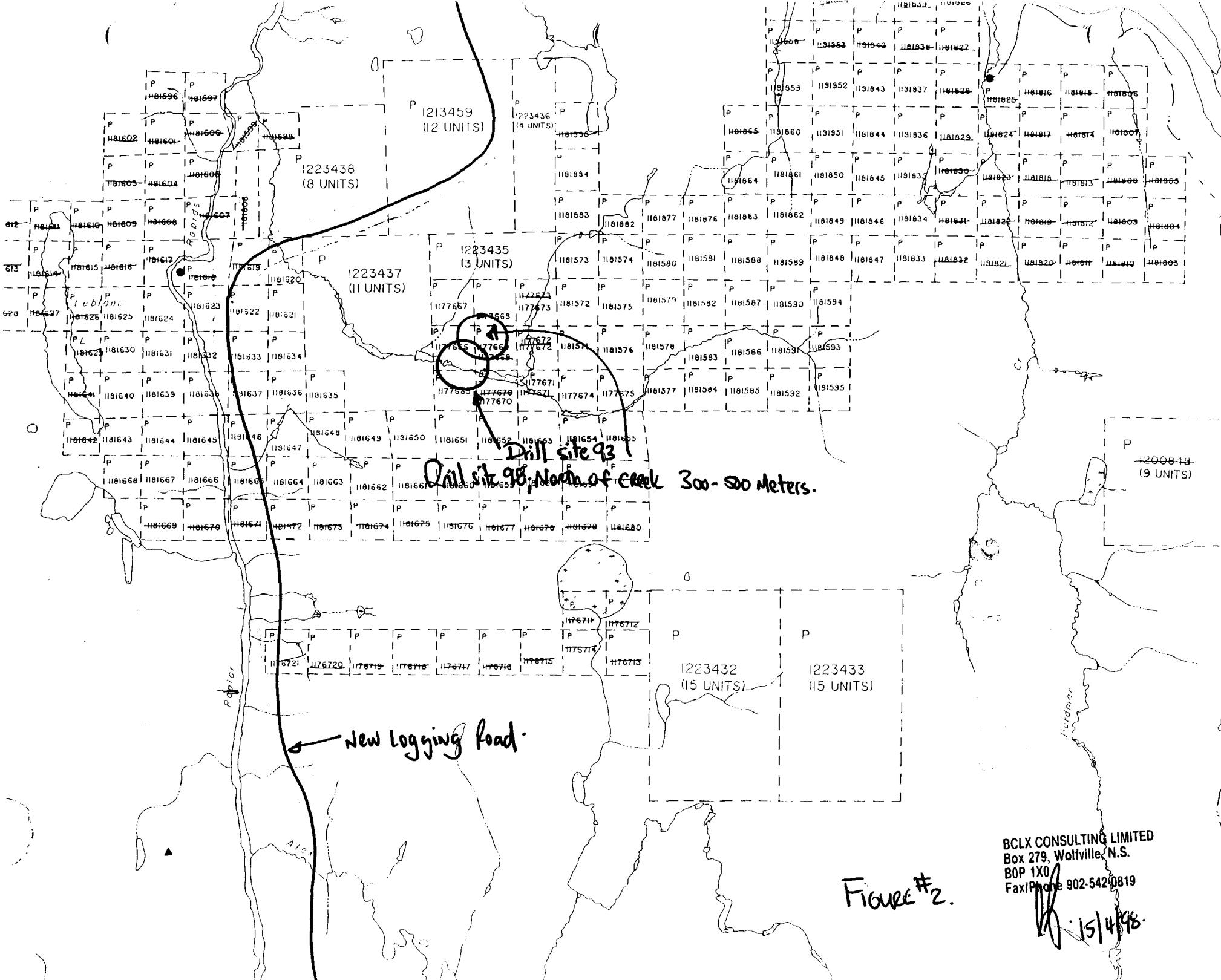

BCLX CONSULTING LIMITED
 Box 279, Wolfville, N.S.
 BOP 1X0
 Fax/Phone 902-542-0819

Figure #2.

15/4/98

amounts of sillimanite , cordierite and spinel were also noted in or below the sulfide zone and magnetite was common throughout the section.

Reccomended assay intervals are indicated on the hand written logs but todote Baltic has not determined which if any of these intervals it will test.

Statement of Costs

This initial pase of drilling excluding any assay or splitting costs totalled \$45,200.97 as follows

1. <u>Geological consulting</u> -----Bclx Consulting Ltd.	
a. Consulting Fees ; logging , reports ,etc.-----	\$8,907.75
b. expenses-----	\$2,537.08
2. <u>Linecutting , Field support</u> -----Silver Spruce Exploration Inc.	
a. linecutting-----	\$2437.75
b.drill support-----	\$2400.00
3. <u>Contract Drilling</u> -----Norex Drilling	
a.1825 (556.4m) feet of BQ drilling-----	\$24,897.56
b. Mob demob,tests,road work-----	\$4,020.83
Total ----	\$25,200.97

Linecutting

After initial reconnaissance by Bclx it was decided that part of the Hurdman grid had to be reestablished prior to any drill program. The original cut lines were obvious but overgrown and few pickets could be located. Silver Spruce Services used two men to reestablish the grid from line 64+00 East to 80+00 East from 24+00 South to 9+00 South. Lines were recut where necessary and pickets with metal tags were established at 50 foot centers.

All previous drill collars tied in well with the new grid and no serious grid discrepancies could be found on this section of the property.

Overview / 1998 Drill Program - (figure # 3)

Drill logs and sections are appended to this report as Appendix 1a, 1b and 1c respectively.

The drill program was designed to test the northeastern extension of a fairly thick north dipping sulfide zone outlined by Noront in 1991 and 1992 drill programs. To test this target, holes ranging from 119 to 149 metres in length were collared on a 400 foot grid spacings. Four holes were completed in total; two holes were drilled on each of lines 72+00 E and 76+00E as shown in figure 3.

All holes cored appreciable widths of sulfide bearing gneiss which were loosely termed the Hurdman Sulfide Horizon. In 1991 and 1992 Noront's drilling cored sulfides in this same horizon grading 1.5 to 4% zinc over widths of 3 to 35 meters. The sulfides in this stratigraphy appear to be stratabound although the strongest sulfide concentrations are spatially related to intervals with abundant coarse Kspar rich pegmatites.

The Hurdman Horizon correlates with the GH airborne anomaly as defined by Noront. The sulfides unit strikes east northeast and dips north at 15 to 20 degrees. The biotite garnet gneisses which host the disseminated pyrite, pyrothite and sphalerite that define this horizon, are typically sericitized, silicified and well banded throughout. Alteration minerals are most common in the sulfide horizon and footwall gneisses while the hanging wall stratigraphy is typically unaltered. Coarse garnet and the most intense sericite are typical of the footwall gneisses. Variable

Conclusions / Recommendations

Baltic should sample the sulfide zone on the assay intervals as indicated on the field logs.

The Hurdman Sulfide Horizon was intercepted in each hole . Of the four intercepts , holes DDH 98-1 through 3 showed the most encouraging sulfide sections . The intercept pattern appears to confirm a shallow northeast rake for the best sulfide zones . The northeast extension of this lense appears to be open at shallow depths ; typically less than 200 meters . Depending on assay results a gravity survey and secondary drill program should be considered northeast of hole 98-2 ; focusing initially on an area from lines 80+00 to 100 +00 east.

The style of mineralization is analogous to the Geco deposit . The gneisses which host the Hurdman Horizon are comparable to the units the author and other workers at Geco recognized as hosts for the 8/2 Zinc Zone at that deposit . Such zinc rich stratigraphy is the most latterly extensive of the many ore types at Geco and occurs at the hanging wall of the main deposit .

BCLX CONSULTING LIMITED
Box 279, Wolfville, N.S.
BOP 1X0
Fax/Phone 902-542-0819

 April 15/98.

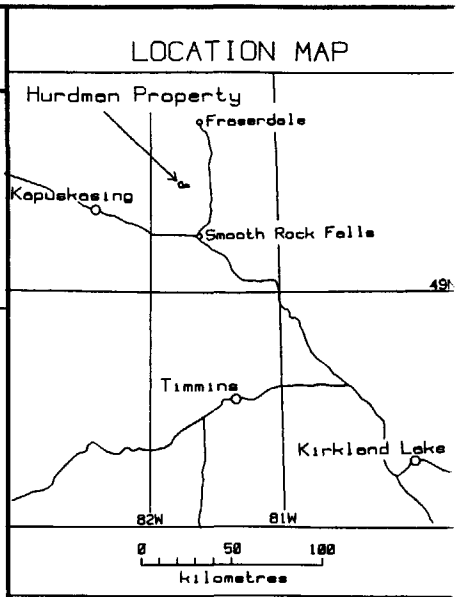
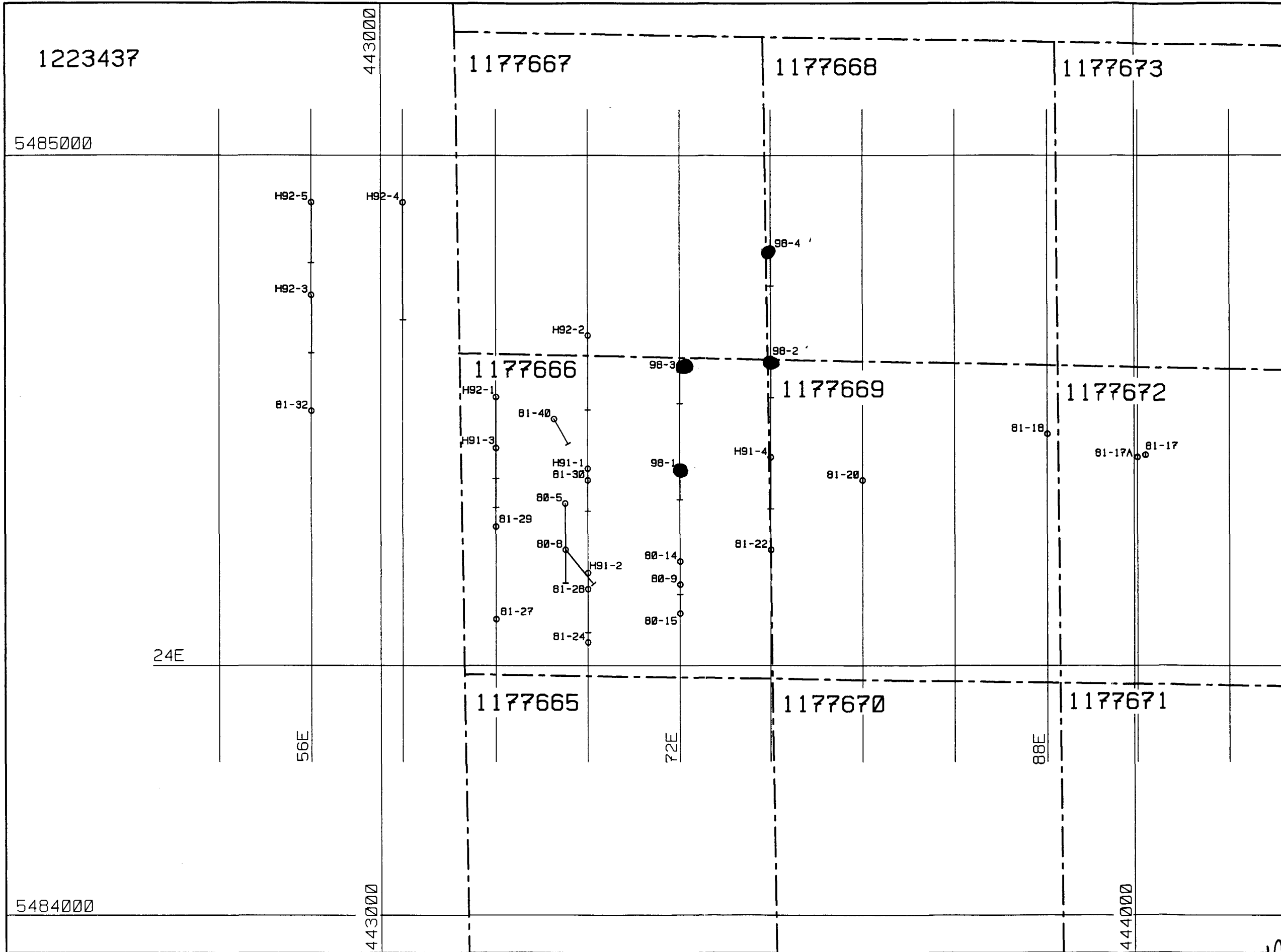

1177672 Claim Block Number
 --- Claim Block Boundary

81-36 Diamond Drill Hole

Drill Grid in Feet
 80- and 81- series drilled by Magnetom Lake Mines Ltd.
 H91- and H92- series drilled by Noront Resources Ltd.
 98- series drilled by Baltic Resources Inc.

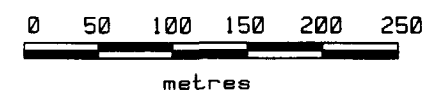

UTM Reference Co-ordinates for UTM Square 42H/12

FIGURE #3

BALTIC RESOURCES INC.
 HURDMAN PROPERTY
 Porcupine Mining Division, Ontario
 G-H ANOMALY
 Drill Hole Location Plan

DATE: 98/04/13 SCALE: 1/500

FIGURE #3.

BCLX CONSULTING LIMITED
 Box 279, Wolfville, N.S.
 BOP 1X0
 Fax/Phone 902-542-0819

15/4/98

Appendix 1A :

Field Logs



Ministry of Northern Development and Mines
Ministère du Développement du Nord et des Mines

Diamond Drilling Log
Journal de forage au diamant

Complete this form and related sketch in duplicate.
Remplir en deux exemplaires la présente formule et le croquis annexé

Fill in on every page
Remplir ces cases à chaque page

Hole No. Forage n°: **A-98-1**
Page No. Page n°: **1/4**

Drilling Company Compagnie de forage: NOREX Drilling.		Collar Elevation Élévation du collier: 5000	Bearing of hole from true North/Position du forage par rapport au nord vrai: Grid 2000	Total Footage Avancement total du forage: 119M.	Dip of Hole at Inclinaison du forage au Collier/collier: -70°	Address/Location where core stored Adresse/endroit où la carotte est stockée: 3130 Airport Rd. Timmins. Ontario	Map Reference No. N° de référence sur la carte	Claim No. N° de concession minière	
Date Hole Started Date de commencement du forage: April 1, 98	Date Completed Date d'achèvement: April 2, 98	Date Logged Date d'inscription au Journal: April 3, 98	Logged by Inscrit par: GARDIN PIERCE		FI (P):		Location (Twp, Lot, Con. or (Lat. and Long.) Emplacement (canton, lot, concession ou latitude et longitude): LINE 72+00 E @ 15+50 S.	Property Name Nom de la propriété: HURDMAN J.V.	
Exploration Co., Owner or Optionee Compagnie d'exploration, propriétaire ou titulaire d'option		Date submitted Date de dépôt	Submitted by (Signature) Déposé par (signature):		FI (P):				
					FI (P):				

Footage/Avancement		Rock type	Description (Colour, grain size, texture, minerals, alteration, etc.)	From/De	To/A	Assays/Analyses minéralogique
From/De	To/A	Type de roche	Description (Couleur, granulométrie, texture, minéraux, transformation, etc.)	From/De	To/A	
0	16	OBD.				
16	31.3 31.3		Biotite Garnet Gneiss fairly mafic unit; well foliated throughout; foliation at 75-85° C.A.			Recommended Samples: 31.3 - 33.0 33.0 - 35.0 35.0 - 37.0
31.3	56.5		HURDMAN Sulfide Horizon. 31.3-32.8 - biotite disseminated sulfides. throughout - 2-3% mainly pyrite.			37.0 - 38.5 38.5 - 40.0 40.0 - 41.5 (continued)

*For features such as foliation, bedding, schistosity, measured from the long axis of the core.
*Exemples de caractéristiques : foliation, schistosité, stratification. L'angle est mesuré par rapport à l'axe longitudinal de la carotte

†Additional credit available. See Assessment Work Regulation.
†Des crédits supplémentaires sont offerts. Consulter les règlements relatifs aux travaux d'évaluation.
Nota : Dans cette formule, lorsqu'il désigne des personnes, le masculin est utilisé au sens neutre.



Ministry of Northern Development and Mines / Ministère du Développement du Nord et des Mines

Diamond Drilling Log / Journal de forage au diamant

Complete this form and related sketch in duplicate. Remplir en deux exemplaires la présente formule et le croquis annexé

Fill in on every page / Remplir ces cases à chaque page

Hole No. Forage n°: 98-1
Page No. Page n°: 2/4

Drilling Company Compagnie de forage		Collar Elevation Élévation du collier	Bearing of hole from true North/Position du forage par rapport au nord vrai	Total Footage Avancement total du forage	Dip of Hole at Inclinaison du forage au Collar/collier	Address/Location where core stored Adresse/endroit où la carotte est stockée	Map Reference No. N° de référence sur la carte	Claim No. N° de concession minière	
Date Hole Started Date de commencement du forage	Date Completed Date d'achèvement	Date Logged Date d'inscription au journal	Logged by Inscrit par	Submitted by (Signature) Déposé par (signature)	Property Name Nom de la propriété	Location (Twp, Lot, Con, or Lat. and Long.) Emplacement (canton, lot, concession ou latitude et longitude)			
Exploration Co., Owner or Optionee Compagnie d'exploration, propriétaire ou titulaire d'option		Date submitted Date de dépôt	Submitted by (Signature) Déposé par (signature)			Property Name Nom de la propriété: HURONIAN			
Footage/Avancement		Rock type	Description (Colour, grain size, texture, minerals, alteration, etc.)			Core Specimen	Assays/Analyses	Assays/Analyses mineralurgiques	
From/De	To/A	Type de roche	Description (Couleur, granulométrie, texture, minéraux, transformation, etc.)			From/De	To/A	Assays/Analyses mineralurgiques	
			32.8 - 37.0 Biotite Garnet Qtz Gneiss. - weakly mineralized, pyrite bands ± disseminated sphalerite. - garnet heavy in bands.					(Samples returned)	
			37.0 - 48.6 - Silicified Gneiss - well mineralized. garnet common; heavy py, ty ± sphalerite and Magnetite.					41.5 - 43.0	
								43.0 - 44.5	52.5 - 54.0
								44.5 - 46.0	54.0 - 55.5
								46.0 - 47.5	55.5 - 56.5
								47.5 - 48.6	56.5 - 58.5
								48.6 - 49.5	
								49.5 - 51.0	
								51.0 - 52.5	

*For features such as foliation, bedding, schistosity, measured from the long axis of the core.
*Exemples de caractéristiques: foliation, schistosité, stratification. L'angle est mesuré par rapport à l'axe longitudinal de la carotte

†Additional credit available. See Assessment Work Regulation.
†Des crédits supplémentaires sont offerts. Consulter les règlements relatifs aux travaux d'évaluation.
Nota: Dans cette formule, lorsqu'il désigne des personnes, le masculin est utilisé au sens neutre.



Ministry of Northern Development and Mines
Ministère du Développement du Nord et des Mines

Diamond Drilling Log
Journal de forage au diamant

Complete this form and related sketch in duplicate.
Remplir en deux exemplaires la présente formule et le croquis annexé

Fill in on every page
Remplir ces cases à chaque page

Hole No. Forage n° **98-1**
Page No. Page n° **3/4**

Drilling Company Compagnie de forage		Collar Elevation Élévation du collier	Heading of hole from true North/Position du forage par rapport au nord vrai	Total Footage Avancement total du forage	Dip of Hole at Inclinaison du forage au Collar/culot	Address/Location where core stored Adresse/endroit où la carotte est stockée	Map Reference No. N° de référence sur la carte	Claim No. N° de concession minière
Date Hole Started Date de commencement du forage	Date Completed Date d'achèvement	Date Logged Date d'inscription au journal	Logged by Inscrit par	FI/PI		Location (Twp, Lot, Con. or Lat. and Long.) Emplacement (canton, lot, concession, ou latitude et longitude)		
Exploration Co., Owner or Optionee Compagnie d'exploration, propriétaire ou titulaire d'option		Date submitted Date de dépôt	Submitted by (Signature) Déposé par (signature)	FI/PI				
				FI/PI				
				FI/PI				
		Property Name Nom de la propriété			HURDMAN			

Footage/Avancement		Rock type Type de roche	Description (Colour, grain size, texture, minerals, alteration, etc.) Description (Couleur, granulométrie, texture, minéraux, transformation, etc.)	Other Features Autres caractéristiques	Core Specimen Forage / Forageur Révisé / Révisé	Test Sample No. N° d'échantillon de laboratoire	Sample Location Niveau de prélèvement L'identification de la carotte	Sample Length Longueur de la carotte	Assays/Analyses mineralogiques
From/De	To/A						From/De	To/A	
			48.6 - 49.5 Brown Pegmatite - magnetite clots.						
			49.5 - 50.5 Mineralized Pegmatite - Py, Po, sph.						
			- heavy remobilized sulfides to 53.5						
			- base of unit - heavy magnetite less sulfide.						
56.5	75.5		56. Weakly altered, Qtz. Biotite Gneiss						
			variable amounts of garnet, weakly sericitized.						

*For features such as foliation, bedding, schistosity, measured from the long axis of the core.

*Exemples de caractéristiques : foliation, schistosité, stratification. L'angle est mesuré par rapport à l'axe longitudinal de la carotte

†Additional credit available. See Assessment Work Regulation.

†Des crédits supplémentaires sont offerts. Consulter les règlements relatifs aux travaux d'évaluation.

Nota : Dans cette formule, lorsqu'il désigne des personnes, le masculin est utilisé au sens neutre.



Ministry of Northern Development and Mines
Ministère du Développement du Nord et des Mines

Diamond Drilling Log
Journal de forage au diamant

Complete this form and related sketch in duplicate.
Remplir en deux exemplaires la présente formule et le croquis annexé

Fill in on every page
Remplir ces cases à chaque page

Hole No. Forage n° **98-1**
Page No. Page n° **4/4**

Drilling Company Compagnie de forage		Collar Elevation Élévation du collier	Bearing of hole from true North/Position du forage par rapport au nord vrai	Total Footage Avancement total du forage	Dip of Hole at Inclinaison du forage au Collar/collier	Address/Location where core stored Adresse/endroit où la carotte est stockée	Map Reference No. N° de référence sur la carte	Claim No. N° de concession minière
Date Hole Started Date de commencement du forage	Date Completed Date d'achèvement	Date Logged Date d'inscription au journal	Logged by Inscrit par	FI/PI		Location (Twp. Lot, Con. or Lat. and Long.) Emplacement (canton, lot, concession, ou latitude et longitude)		
Exploration Co., Owner or Optionee Compagnie d'exploration, propriétaire ou titulaire d'option		Date submitted Date de dépôt	Submitted by (Signature) Déposé par (signature)	FI/PI		Property Name Nom de la propriété HEDMAN.		

Footage/Avancement		Rock type Type de roche	Description (Colour, grain size, texture, minerals, alteration, etc.) Description (Couleur, granulométrie, texture, minéraux, transformation, etc.)	Photo taken Angle of dip Caractéristiques	Core specimen Footage / Longueur en coupe des carottes prélevées	Core Sample No. N° d'échantillon de roches	Surface Footage Mètre de développement de forage sur les parois	Sample Length Longueur de recherche	Assays/Analyses minéralogique
From/De	To/A						From/De	To/A	
75.5	82.7		Coarse biotite dike - barren. Kspgr rich dike.						
82.7	88.0		Qtz Biotite Gneiss (as from 86.5)						
88.0	119.0 119.0		Biotite Garnet Gneiss. - (Marked with A) - Minor pyrite interbeds. - Coarse garnet is typical of this unit.; unit weakly sericitized with secondary pyrite.						

*For features such as foliation, bedding, schistosity, measured from the long axis of the core.
*Exemples de caractéristiques : foliation, schistosité, stratification. L'angle est mesuré par rapport à l'axe longitudinal de la carotte

†Additional credit available. See Assessment Work Regulation.
†Des crédits supplémentaires sont offerts. Consulter les règlements relatifs aux travaux d'évaluation
Nota Dans cette formule, lorsqu'il désigne des personnes, le masculin est utilisé au sens neutre.

119.0 End of hole



Ministry of Northern Development and Mines
Ministère du Développement du Nord et des Mines

Diamond Drilling Log
Journal de forage au diamant

Complete this form and related sketch in duplicate.
Remplir en deux exemplaires la présente formule et le croquis annexé

Fill in on every page
Remplir ces cases à chaque page

Hole No. Forage n° **98-2**
Page No. Page n° **1/4**

Drilling Company Compagnie de forage Norex		Collar Elevation Elevation du collier 5000	Bearing of hole from true North/Position du forage par rapport au nord vrai Sinds	Total Footage Avancement total du forage 149m	Dip of Hole at Collar/Inclinaison du forage au Collier 0 -70	Address/Location where core stored Adresse/endroit où la carotte est stockée	Map Reference No. N° de référence sur la carte	Claim No. N° de concession minière			
Date Hole Started Date de commencement du forage April 3	Date Completed Date d'achèvement April 4	Date Logged Date d'inscription au journal April 4	Logged by Inscrit par G. Piere		F1/P1	Location (Twp, Lot, Con. or Lat and Long) Emplacement (canton, lot, concession ou latitude et longitude) LINE T600E @ 10+75 SOUTH					
Exploration Co., Owner or Optionee Compagnie d'exploration, propriétaire ou titulaire d'option		Date submitted Date de dépôt	Submitted by (Signature) Déposé par (signature) [Signature]		F1/P1				Property Name Nom de la propriété Hurdman		
					F1/P1						
					F1/P1						

Footage/Avancement		Rock type	Description (Colour, grain size, texture, minerals, alteration, etc.)	Core Features Angle des caractéristiques	Core Specimen Forage et échantillon en date des carottes prélevées	Core Sample No. N° d'échantillon du prospecteur	Service Forage Niveau de détail et/ou de forage/sondage en cours	Sample Length Longueur de l'échantillon	Assays/Analyse mineralurgique
From/De	To/A	Type de roche	Description (Couleur, granulométrie, texture, minéraux, transformation, etc.)				From/De	To/A	
0	6.7		OBD.						
6.7	15.5		Biotite Qtz Gneiss. - unaltered, unmineralized. 70-80°C.A.						
15.5	23.0		Gaeret Biotite Gneiss weakly altered, unmineralized.						
23.0	42.8		Biotite Qtz. Gneiss. - sericitic alteration increasing to depth; also sulfides increase with Alteration.						

*For features such as foliation, bedding, schistosity, measured from the long axis of the core.
*Exemples de caractéristiques : foliation, schistosité, stratification. L'angle est mesuré par rapport à l'axe longitudinal de la carotte

†Additional credit available. See Assessment Work Regulation.
†Des crédits supplémentaires sont offerts. Consulter les règlements relatifs aux travaux d'évaluation.
Nota : Dans cette formule, lorsqu'il désigne des personnes, le masculin est utilisé au sens neutre.



Ontario

Ministry of Northern Development and Mines / Ministère du Développement du Nord et des Mines

Diamond Drilling Log

Journal de forage au diamant

Complete this form and related sketch in duplicate. Remplir en deux exemplaires la présente formule et le croquis annexé

Fill in on every page. Remplir ces cases à chaque page

Hole No. Forage n° 98-2, Page No. Page n° 2/4

Form with multiple sections: Drilling Company, Date Hole Started, Expiration Co., Footage/Avancement, Rock type, Description, Dip of Hole, Address/Location, Map Reference No., Claim No., Location, Property Name (HUDMAN), and a detailed table of core samples with columns for From/De, To/A, Description, and Assays/Analyses.

*For features such as foliation, bedding, schistosity, measured from the long axis of the core. *Exemples de caractéristiques : foliation, schistosité, stratification. L'angle est mesuré par rapport à l'axe longitudinal de la carotte

†Additional credit available. See Assessment Work Regulation. †Des crédits supplémentaires sont offerts. Consulter les règlements relatifs aux travaux d'évaluation. Nota : Dans cette formule, lorsqu'il désigne des personnes, le masculin est utilisé au sens neutre.



Ministry of Northern Development and Mines

Ministère du Développement du Nord et des Mines

Diamond Drilling Log

Journal de forage au diamant

Complete this form and related sketch in duplicate. Remplir en deux exemplaires la présente formule et le croquis annexé

Fill in on every page Remplir ces cases à chaque page

Hole No. Forage n° 98-2
Page No. Page n° 3/4

Drilling Company Compagnie de forage		Collar Elevation Élévation du collier	Bearing of hole from true North/Position du forage par rapport au nord vrai	Total Footage Avancement total du forage	Dip of Hole at Inclinaison du forage au Collar/collier	Address/Location where core stored Adresse/endroit où la carotte est stockée	Map Reference No. N° de référence sur la carte	Claim No. N° de concession minière
Date Hole Started Date de commencement du forage	Date Completed Date d'achèvement	Date Logged Date d'inscription au journal	Logged by Inscrit par	FI/PI		Location (Twp, Lot, Con. or Lat. and Long.) Emplacement (canton, lot, concession, ou latitude et longitude)		
Exploitation Co., Owner or Optionee Compagnie d'exploration, propriétaire ou titulaire d'option		Date submitted Date de dépôt	Submitted by (Signature) Déposé par (signature)	FI/PI		Property Name Nom de la propriété HURDMAN.		

Footage/Avancement		Rock type Type de roche	Description (Colour, grain size, texture, minerals, alteration, etc.) Description (Couleur, granulométrie, texture, minéraux, transformation, etc.)	Placer Footage Angle des caractéristiques	Core Specimen Footage / Longueur en pieds de la carotte prélevée	Yield Sample No. N° d'échantillon	Sample Footage Niveau de début et de fin de l'échantillon en pieds	Sample Length Longueur de l'échantillon	Assays/Analyses minéralogique
From/De	To/A						From/De	To/A	
			72.5 72.5 - 75.4 Silicified BT Gneiss with heavy sulfides. py, po sph?				(Samples conti)		
			75.4 - 80.0 Heaviest sulfide in hole unit is heavily pegmatized with coarse sulfides. mainly py, po. ± sph.				68.5 - 70.5		
							70.5 - 72.5		80.0 - 82.0
							72.5 - 74.0		82.0 - 84.0
							74.0 - 75.5		84.0 - 86.2
80	86.2		COARSE pegmatite - minor pyrite, magnetite clots.				75.5 - 77.0		
86.2	97.5		BT Biotite Gneiss - silicified in places with sericite overprinting common, minor pyrite ± garnet.				77.0 - 78.5		
							78.5 - 80.0		

*For features such as foliation, bedding, schistosity, measured from the long axis of the core.

*Exemples de caractéristiques : foliation, schistosité, stratification. L'angle est mesuré par rapport à l'axe longitudinal de la carotte

†Additional credit available. See Assessment Work Regulation.

†Des crédits supplémentaires sont offerts. Consulter les règlements relatifs aux travaux d'évaluation.

Nota : Dans cette formule, lorsqu'il désigne des personnes, le masculin est utilisé au sens neutre.



Ministry of Northern Development and Mines
Ministère du Développement du Nord et des Mines

Diamond Drilling Log
Journal de forage au diamant

Complete this form and related sketch in duplicate.
Remplir en deux exemplaires la présente formule et le croquis annexé

Fill in on every page
Remplir ces cases à chaque page

Hole No. Forage n°	Page No. Page n°
98-2	4/4

Drilling Company Compagnie de forage		Collar Elevation Élévation du collier	Bearing of hole from true North/Position du forage par rapport au nord vrai	Total Footage Avancement total du forage	Dip of Hole at Inclinaison du forage au Collar/collier	Address/Location where core stored Adresse/endroit où la carotte est stockée	Map Reference No. N° de référence sur la carte	Claim No. N° du concession minière
Date Hole Started Date de commencement du forage	Date Completed Date d'achèvement	Date Logged Date d'inscription au journal	Logged by Inscrit par		Fl/Pi	Location (Twp, Lot, Con. or Lat. and Long.) Emplacement (canton, lot, concession ou latitude et longitude)		
Exploration Co., Owner or Optionee Compagnie d'exploration, propriétaire ou titulaire d'option		Date submitted Date de dépôt	Submitted by (Signature) Déposé par (signature)		Fl/Pi			
					Fl/Pi			
					Fl/Pi			
Property Name Nom de la propriété							HARDMAN	

Footage/Avancement		Rock type Type de roche	Description (Colour, grain size, texture, minerals, alteration, etc.) Description (Couleur, granulométrie, texture, minéraux, transformation, etc.)	Other Features Autres caractéristiques	Core Specimen Forage et échantillon en carottes Lithologie	Core Sample No. N° d'échantillon de carottes	Sample Footage Niveau de prélèvement au forage (mètres) From/De To/A	Sample Length Longueur de l'échantillon	Assays/Analyses minéralurgique
99.5	111.0		COARSE-TEXTURED RICH PEGMATITE. epidote common, magnetite and biotite phenocrysts.			Strat.	117.8 - 119.8		
							119.8 - 121.8		
111.0	116.0		Biotite Qtz Gneiss variable sericitized, sillimanite in bands.				121.8 - 123.8		
							123.8 - 125.8		
116.0	149.0		GARNET Biotite Gneiss. - (marker unit A) - sericitized in places. - minor quartz in secondary bands clots.				127.8 - 129.8		
							129.8 - 131.8		
149.0	End of Hole								

*For features such as foliation, bedding, schistosity, measured from the long axis of the core.
*Exemples de caractéristiques : foliation, schistosité, stratification. L'angle est mesuré par rapport à l'axe longitudinal de la carotte

†Additional credit available. See Assessment Work Regulation.
†Des crédits supplémentaires sont offerts. Consulter les règlements relatifs aux travaux d'évaluation.
Nota : Dans cette formule, lorsqu'il désigne des personnes, le masculin est utilisé au sens neutre



Ministry of Northern Development and Mines
Ministère du Développement du Nord et des Mines

Diamond Drilling Log

Journal de forage au diamant

Complete this form and related sketch in duplicate.
Remplir en deux exemplaires la présente formule et le croquis annexé

Fill in on every page
Remplir ces cases à chaque page

Hole No. Forage n° **98-3**
Page No. Page n° **1/3**

Drilling Company Compagnie de forage NOREX Drilling.		Collar Elevation Elevation du collier 5000	Bearing of hole from true North/Position du forage par rapport au nord vrai 180° 64.0	Total Footage Avancement total du forage 149.0M	Dip of Hole at Inclinaison du forage au -70°	Address/Location where core stored Adresse/endroit où la carotte est stockée 3130 Airport Road TIMMINS, ONT.	Map Reference No. N° de référence sur la carte	Claim No. N° de concession minière			
Date Hole Started Date de commencement du forage April 3, 98	Date Completed Date d'achèvement April 4, 98	Date Logged Date d'inscription au jour April 5/98	Logged by Inscrit par G. Pierce		Property Name Nom de la propriété HUDMAN		Location (Twp, Lot, Con. or Lat. and Long.) Emplacement (canton, lot, concession, ou latitude et longitude) LINE 72 TO E / 11400 SOUTH.				
Exploration Co., Owner or Optioned Compagnie d'exploration, propriétaire ou titulaire d'option BALVIC - NUGENT J.V.		Date submitted Date de dépôt April 15/98.	Submitted by (Signature) Déposé par (signature) [Signature]		Property Name Nom de la propriété HUDMAN		Assays/Analyses mineralurgique				
Footage/Avancement		Rock type	Description (Colour, grain size, texture, minerals, alteration, etc.)			Placer Feature Angle Caractéristiques de la veine	Core Specimen Footage / Longueur en pieds des carottes prélevées	True Sample No N° d'échantillon du carottage	Sample Footage Niveau de forage de l'échantillon en pieds From/De To/A	Sample Length Longueur de l'échantillon	Assays/Analyses mineralurgique
From/De	To/A	Type de roche	Description (Couleur, granulométrie, texture, minéraux, transformation, etc.)								
0	7.8		OVERBURDEN								
7.8	63.5		Biotite Garnet Gneiss A - Abundant coarse garnets; fol. 80°C.A								
63.5	68.0		Altered Biotite Garnet Gneiss - sericite but no significant sulfides.								
68.0	83.5		Hudman Sulfide Horizon 68.0-77.3 - weakly mineralized; sericite alteration ore bands 10-20cm wide; garnet still common.								

*For features such as foliation, bedding, schistosity, measured from the long axis of the core.

*Exemples de caractéristiques : foliation, schistosité, stratification. L'angle est mesuré par rapport à l'axe longitudinal de la carotte

†Additional credit available. See Assessment Work Regulation.

†Des crédits supplémentaires sont offerts. Consulter les règlements relatifs aux travaux d'évaluation.

Nota : Dans cette formule, lorsqu'il désigne des personnes, le masculin est utilisé au sens neutre.



Ontario

Ministry of Northern Development and Mines / Ministère du Développement du Nord et des Mines

Diamond Drilling Log

Journal de forage au diamant

Complete this form and related sketch in duplicate. Remplir en deux exemplaires la présente formule et le croquis annexé

Fill in on every page Remplir ces cases à chaque page

Hole No. Forage n° 98-3 Page No. Page n° 2/3

Form header section containing fields for Drilling Company (Norex-Timmins), Collar Elevation (5000), Bearing of hole from true North (180°), Total Footage (149M), Dip of Hole at Inclination (70°), Address/Location where core stored, Map Reference No., Claim No., Date Hole Started (April), Date Completed (April), Date Logged (April), Logged by (G. Pierce), Exploration Co., Owner or Optionee, Date submitted, Submitted by (Signature), Location (Twp, Lot, Con. or Lat. and Long.), Property Name (HURDMAN).

Table with columns: Footage/Avancement (From/De, To/A), Rock type (Type de roche), Description (Colour, grain size, texture, minerals, alteration, etc.) (Description (Couleur, granulométrie, texture, minéraux, transformation, etc.)), and Assays/Analyses minéralurgique. Handwritten entries include: 77.5-81.5 - Heavy sulfide zone in pegmatized gneiss; pale green phenocrysts. Cordierite? spinel? -sulfides py, po, ± sph; 81.5-83.5 Silicified biotite Qtz Gneiss disseminated pyrite throughout but only minor sph.; po; Magnetite; 83.5-104.0 Siliceous biotite Qtz Gneiss. minor sulfides throughout, stampot 98.5-101.0

*For features such as foliation, bedding, schistosity, measured from the long axis of the core. *Exemples de caractéristiques : foliation, schistosité, stratification. L'angle est mesuré par rapport à l'axe longitudinal de la carotte

†Additional credit available. See Assessment Work Regulation. †Des crédits supplémentaires sont offerts. Consulter les règlements relatifs aux travaux d'évaluation. Nota : Dans cette formule, lorsqu'il désigne des personnes, le masculin est utilisé au sens neutre.



Ministry of Northern Development and Mines / Ministère du Développement du Nord et des Mines

Diamond Drilling Log / Journal de forage au diamant

Complete this form and related sketch in duplicate. Remplir en deux exemplaires la présente formule et le croquis annexé

Fill in on every page / Remplir ces cases à chaque page

Hole No. Forage n°: 98-3 / Page No. Page n°: 3/3

Drilling Company / Compagnie de forage: Norex (Timmins)		Collar Elevation / Élévation du collier	Bearing of hole from true North / Position du forage par rapport au nord vrai	Total Footage / Avancement total du forage	Dip of Hole at / Inclinaison du forage au Collar / Collier	Address/Location where core stored / Adresse/endroit où la carotte est stockée	Map Reference No. / N° de référence sur la carte	Claim No. / N° de concession minière
Date Hole Started / Date de commencement du forage: April 4, 98	Date Completed / Date d'achèvement: April 5, 98	Date Logged / Date d'inscription au journal: April 5/98	Logged by / Inscrit par: G. PIERRE		F1/P1	Location (Twp, Lot, Con. or Lat. and Long.) / Emplacement (canton, lot, concession, ou latitude et longitude)	Property Name / Nom de la propriété	
Exploration Co., Owner or Optionee / Compagnie d'exploration, propriétaire ou titulaire d'option		Date submitted / Date de dépôt	Submitted by (Signature) / Déposé par (signature):		F1/P1			
					F1/P1			
					F1/P1			

Footage/Avancement		Rock type / Type de roche	Description (Colour, grain size, texture, minerals, alteration, etc.) / Description (Couleur, granulométrie, texture, minéraux, transformation, etc.)	Dip or Tilt / Angle / Angle des caractéristiques de la ve	Core Specimen / Forage / Longueur en pieds des carottes obtenues	Footage / Longueur en mètres	Sample Length / Longueur de l'échantillon	Assays/Analyses minéralurgique
From/De	To/A					From/De	To/A	
								<u>Recommended Sampling</u>
104.0	124.4		Silicified Biotite Garnet Qtz Gneiss - disseminated sulfides, mainly py, sp throughout; unit variably sericitized			start 107 - 109		
						109 - 111.0		
						111 - 113		
124.4	130.0		Biotite GARNET Gneiss - coarse garnet in matrix (biotite rich) bands; weak sericite and silicification; minor sulfide.			113 - 115		
						115 - 117		
						117 - 119		
						119 - 121		
130.0	149.0		Biotite Gneiss - unaltered, no significant sulfide.			121 - 123	end.	

*For features such as foliation, bedding, schistosity, measured from the long axis of the core.

*Exemples de caractéristiques : foliation, schistosité, stratification. L'angle est mesuré par rapport à l'axe longitudinal de la carotte.

†Additional credit available. See Assessment Work Regulation.

†Des crédits supplémentaires sont offerts. Consulter les règlements relatifs aux travaux d'évaluation.

Nota : Dans cette formule, lorsqu'il désigne des personnes, le masculin est utilisé au sens neutre.

149.0 End of hole.



Ministry of Northern Development and Mines
Ministère du Développement du Nord et des Mines

Diamond Drilling Log

Journal de forage au diamant

Complete this form and related sketch in duplicate. Remplir en deux exemplaires la présente formule et le croquis annexé

Fill in on every page. Remplir ces cases à chaque page

Hole No. Forage n° 98-4
Page No. Page n° 1/4

Drilling Company Compagnie de forage Norex (Timmins)		Collar Elevation Élévation du collier 5000	Bearing of hole from True North/Position du forage par rapport au nord vrai 180° 00'	Total Footage Avancement total du forage 143 M	Dip of Hole at Inclinaison du forage au Collar/collier -70°	Address/Location where core stored Adresse/endroit où la carotte est stockée 3130 Airport Rd. Timmins; Ontario	Map Reference No. N° de référence sur la carte	Claim No. N° de concession minière
Date Hole Started Date de commencement du forage April 4 - 98	Date Completed Date d'achèvement April 5 - 98	Date Logged Date d'inscription au journal April 6 98	Logged by Inscrit par G. Pierce.				Location (Twp, Lot, Con. or Lat. and Long.) Emplacement (canton, lot, concession, ou latitude et longitude) Line 76+00E / 6+00 SOUTH	
Exploration Co., Owner or Optionee Compagnie d'exploration, propriétaire ou titulaire d'option BACTIC - NURENT J.V.		Date submitted Date de dépôt	Submitted by (Signature) Déposé par (signature) G. Pierce.				Property Name Nom de la propriété HURDMAN J.V.	
Footage/Avancement		Rock type Type de roche	Description (Colour, grain size, texture, minerals, alteration, etc.) Description (Couleur, granulométrie, texture, minéraux, transformation, etc.)			From/De	To/À	Assays/Analyses mineralurgique
0	9.0		QUÉBEC					Recommended Sampling
9.0	30.5		Biotite Gneiss unaltered, minor garnet, no sulfides.			78.0	80.0	80.0 - 82.0 94.0 - 96.0
30.5	41.3		Unmineralized pegmatite. K ₂ O rich; magnetite, biotite porphyroblasts			82.0	84.0	82.0 - 84.0 96.0 - 97.5
						84.0	86.0	84.0 - 86.0 97.5 - 99.0 stop
						86.0	88.0	86.0 - 88.0
						88.0	90.0	88.0 - 90.0
41.3	42.7		Biotite Qtz Gneiss; partly migmatized			90.0	92.0	90.0 - 92.0
						92.0	94.0	92.0 - 94.0

*For features such as foliation, bedding, schistosity, measured from the long axis of the core.

*Exemples de caractéristiques : foliation, schistosité, stratification. L'angle est mesuré par rapport à l'axe longitudinal de la carotte

†Additional credit available. See Assessment Work Regulation.

†Des crédits supplémentaires sont offerts. Consulter les règlements relatifs aux travaux d'évaluation.

Nota : Dans cette formule, lorsqu'il désigne des personnes, le masculin est utilisé au sens neutre.



Ministry of Northern Development and Mines
Ministère du Développement du Nord et des Mines

Diamond Drilling Log
Journal de forage au diamant

Complete this form and related sketch in duplicate.
Remplir en deux exemplaires la présente formule et le croquis annexé

Fill in on every page
Remplir ces cases à chaque page

Hole No. Forage n° **984**
Page No. Page n° **2/4**

Drilling Company Compagnie de forage		Collar Elevation Elevation du collier	Bearing of hole from true North/Position du forage par rapport au nord vrai	Total Footage Avancement total du forage	Dip of Hole at Inclinaison du forage au Collar/collier	Address/Location where core stored Adresse/endroit où la carotte est stockée	Map Reference No. N° de référence sur la carte	Claim No. N° de concession minière
Date Hole Started Date de commencement du forage	Date Completed Date d'achèvement	Date Logged Date d'inscription au Journal	Logged by Inscrit par		FI/PI	Location (Twp. Lot, Con. or Lat. and Long.) Emplacement (canton, lot, concession, ou latitude et longitude)		
Exploration Co., Owner or Optionee Compagnie d'exploration, propriétaire ou titulaire d'option		Date submitted Date de dépôt	Submitted by (Signature) Déposé par (signature)		FI/PI			
			<i>Gautier</i>		FI/PI			
					FI/PI			
Property Name Nom de la propriété			HURDMAN.					

Footage/Avancement		Rock type	Description (Colour, grain size, texture, minerals, alteration, etc.)	Dip of Hole at Collar/collier	Core Specimen Footage / Longueur de la carotte en mètres	Core Specimen No. / Numéro de la carotte	Sample No. / Numéro de l'échantillon	Sample Length / Longueur de l'échantillon	Assays/Analyses minéralurgique
From/De	To/À	Type de roche	Description (Couleur, granulométrie, texture, minéraux, transformation, etc.)						
42.7	45.5		Ksp ² rich Pegmatite as at 30.5.						
45.5	59.0		Biotite Qtz. Gneiss partly altered; garnet more common than in biotite gneiss above.						
59.0	63.7		Pegmatized Biotite Qtz Gneiss						
63.7	67.8		Qtz. Biotite Gneiss - progressively more altered to depth.						

*For features such as foliation, bedding, schistosity, measured from the long axis of the core.

*Exemples de caractéristiques : foliation, schistosité, stratification. L'angle est mesuré par rapport à l'axe longitudinal de la carotte

†Additional credit available. See Assessment Work Regulation.

†Des crédits supplémentaires sont offerts. Consulter les règlements relatifs aux travaux d'évaluation.

Nota : Dans cette formule, lorsqu'il désigne des personnes, le masculin est utilisé au sens neutre.

- garnet common in biotite rich mafic beds; gradational into unit below.



Ministry of Northern Development and Mines / Ministère du Développement du Nord et des Mines

Diamond Drilling Log / Journal de forage au diamant

Complete this form and related sketch in duplicate. Remplir en deux exemplaires la présente formule et le croquis annexé

Fill in on every page. Remplir ces cases à chaque page

Hole No. Forage n°: 98-4, Page No. Page n°: 3/4

Drilling Company / Compagnie de forage: NOREX		Collar Elevation / Elevation du collier	Bearing of hole from true North / Position du forage par rapport au nord vrai	Total Footage / Avancement total du forage	Dip of Hole at Inclinaison du forage au Collar / collier: -70°	Address/Location where core stored / Adresse/endroit où la carotte est stockée: 3130 Airport Rd. Timmins.	Map Reference No. / N° de référence sur la carte	Claim No. / N° de concession minière				
Date Hole Started / Date de commencement du forage	Date Completed / Date d'achèvement	Date Logged / Date d'inscription au journal	Logged by / Inscrit par: G. PIERCE			Location (Twp, Lot, Con. or Lat. and Long.) / Emplacement (canton, lot, concession, ou latitude et longitude): HUDMAN TOWNSHIP.	Property Name / Nom de la propriété: HUDMAN.					
Exploration Co., Owner or Optioneer / Compagnie d'exploration, propriétaire ou titulaire d'option		Date submitted / Date de dépôt	Submitted by (Signature) / Déposé par (signature):									
Footage/Avancement		Rock type / Type de roche	Description (Colour, grain size, texture, minerals, alteration, etc.) / Description (Couleur, granulométrie, texture, minéraux, transformation, etc.)				Major Feature / Angle / Angle des caractéristiques	Core Specimen / Footage / Longueur des carottes / Carottes	Yield Sample No. / N° d'échantillon / Échantillons	Surface Footage / Niveau de développement de l'assiette / en mètres / From/De To/À	Surface Length / Longueur de section	Assays / Analyses minéralurgique
From/De	To/À											
67.8	72.5		Banded Garnet Biotite Gneiss.								Recommended Samples	
67.8	98.9		<u>HUDMAN Sulfide Horizon</u>									
			67.8 - 72.5 - Banded Garnet Biotite Gneiss.									
			- first sulfides as pyrite band at contact with overlying gneiss.									
			- with looks like Geco type I.F.									
			72.5 - 80.2 - As Above with limited garnet.									
			80.2 - 98.8 - Banded gneiss as @ 67.8; sulfides disseminated throughout; strongest in lot 12 meters. mainly py, sp									

*For features such as foliation, bedding, schistosity, measured from the long axis of the core. *Exemples de caractéristiques : foliation, schistosité, stratification. L'angle est mesuré par rapport à l'axe longitudinal de la carotte

†Additional credit available. See Assessment Work Regulation. †Des crédits supplémentaires sont offerts. Consulter les règlements relatifs aux travaux d'évaluation. Nota : Dans cette formule, lorsqu'il désigne des personnes, le masculin est utilisé au sens neutre.



Ministry of Northern Development and Mines
Ministère du Développement du Nord et des Mines

Diamond Drilling Log

Journal de forage au diamant

Complete this form and related sketch in duplicate.
Remplir en deux exemplaires la présente formule et le croquis annexé

Fill in on every page
Remplir ces cases à chaque page

Hole No. Forage n°: 98-4
Page No. Page n°: 4/4

Drilling Company Compagnie de forage		Collar Elevation Élévation du collier	Bearing of hole from true North Position du forage par rapport au nord vrai	Total Footage Avancement total du forage	Dip of Hole at Inclinaison du forage au Collar/collier	Address/Location where core stored Adresse/endroit où la carotte est stockée	Map Reference No. N° de référence sur la carte	Claim No. N° de concession minière
Date Hole Started Date de commencement du forage	Date Completed Date d'achèvement	Date Logged Date d'inscription au journal	Logged by Inscrit par	Fl/Pt	Location (Twp, Lot, Con. or Lat. and Long.) Emplacement (canton, lot, concession, ou latitude et longitude) Huron Township			
Exploration Co., Owner or Optionee Compagnie d'exploration, propriétaire ou titulaire d'option		Date submitted Date de dépôt	Submitted by (Signature) Déposé par (signature)	Fl/Pt				
				Fl/Pt			Property Name Nom de la propriété Huron	
				Fl/Pt				

Footage/Avancement		Rock type Type de roche	Description (Colour, grain size, texture, minerals, alteration, etc.) Description (Couleur, granulométrie, texture, minéraux, transformation, etc.)	Core Features Caractéristiques de la carotte	Core Specimen Échantillon de la carotte	Core Sample No. N° d'échantillon de la carotte	Sample Footage Niveau de prélèvement de l'échantillon (en cm)	Sample Length Longueur de l'échantillon	Assays/Analyses minéralurgique
From/De	To/A						From/De	To/A	
98.8	103.9		Biotite Gneiss with numerous garnets.						
106.0	143.0		Biotite Garnet Gneiss - - typical of footwall of other holes. variably bleached and sericitized. with fine disseminated pyrite - narrow sulfides in qtz stringer 118.6-118.9						
143.0		E.O.H.							

*For features such as foliation, bedding, schistosity, measured from the long axis of the core.
*Exemples de caractéristiques : foliation, schistosité, stratification. L'angle est mesuré par rapport à l'axe longitudinal de la carotte

†Additional credit available. See Assessment Work Regulation.
†Des crédits supplémentaires sont offerts. Consulter les règlements relatifs aux travaux d'évaluation.
Nota : Dans cette formule, lorsqu'il désigne des personnes, le masculin est utilisé au sens neutre.

Appendix 1B :

Computer Logs

BALTIC RESOURCES INC.

DIAMOND DRILL LOG

PROPERTY: HURDMAN

HOLE No.: 98-1

Collar Eastings: 2194.56

Collar Northings: -472.44

Collar Elevation: 1000.00

Date: April 1, 1998

Logged by: G. Pierce

Collar Inclination: -70.00

Grid Bearing: 180.00

Final Depth: 119.00 metres

FROM	TO	LITHOLOGICAL DESCRIPTION
0	16.0	<u>Overburden</u>
16.0	31.3	<u>Biotite Garnet Gneiss</u> . Fairly mafic unit; well foliated throughout
31.3	56.5	<u>Hurdman Sulphide Zone</u>
	31.3 32.8	<u>Pegmatite</u> . Disseminated sulphides throughout, 2-3% mainly pyrite
	32.8 37.0	<u>Biotite Garnet Quartz Gneiss</u> . Weakly mineralized, pyrite bands +/- sphalerite, garnet heavy in bands.
	37.0 48.6	<u>Silicified Gneiss</u> . Well mineralized, garnet common; heavy pyrrhotite, pyrite, +/- sphalerite and magnetite.
	48.6 49.5	<u>Barren Pegmatite</u> - magnetite clots.
	49.5 56.5	<u>Mineralized Pegmatite</u> . Pyrite, pyrrhotite, sphalerite; heavy remobilized sulphides to 53.5m, base of unit heavy magnetite, less sulphide.
56.5	75.5	<u>Quartz Biotite Gneiss</u> . Weakly altered, variable amounts of garnet, weakly sericitized.
75.5	82.7	<u>Coarse Pegmatite Dyke</u> . Barren, K-feldspar rich dyke.
82.7	88.0	<u>Quartz Biotite Gneiss</u> . As from 56.5 to 75.5m.
88.0	119.0	<u>Biotite Garnet Gneiss</u> . Minor pyrite interbeds, coarse garnet is typical of this unit; weakly sericitized with secondary pyrite.
		END OF HOLE

BALTIC RESOURCES INC.

DIAMOND DRILL LOG

PROPERTY: HURDMAN

HOLE No.: 98-2

Collar Eastings: 2316.48

Collar Northings: -327.66

Collar Elevation: 1000.00

Date: April 3, 1998

Logged by: G. Pierce

Collar Inclination: -70.00

Grid Bearing: 180.00

Final Depth: 149.00 metres

FROM	TO	LITHOLOGICAL DESCRIPTION
0	6.7	<u>Overburden</u>
6.7	15.5	<u>Biotite Quartz Gneiss</u> . Unaltered, unmineralized. Foliation 70½-80½ C.A.
15.5	23.0	<u>Garnet Biotite Gneiss</u> . weakly altered, unmineralized
23.0	42.8	<u>Biotite Quartz Gneiss</u> - sericitic alteration increasing with depth; also sulphides increase with alteration.
42.8	80.0	<u>Hurdman Sulphide Zone</u>
42.8	45.5	<u>altered Biotite Quartz Gneiss</u> . Disseminated pyrrhotite, pyrite +/- sphalerite throughout.
45.5	47.6	<u>Well Mineralized Pegmatite</u> . Pyrrhotite, pyrite +/- sphalerite, magnetite.
47.6	54.5	<u>Altered Biotite Quartz Gneiss</u> . Disseminated pyrrhotite, pyrite +/- sphalerite throughout.
54.5	60.0	<u>Altered Pegmatite</u> . Heavy sulphides as above.
60.0	72.5	<u>Biotite Quartz Gneiss</u> . Weakly mineralized.
72.5	75.4	<u>Silicified Biotite Quartz Gneiss</u> . Heavier sulphides. Pyrrhotite, pyrite, sphalerite?
75.4	80.0	<u>Pegmatized Gneiss</u> . Strongest sulphide mineralization in hole. Coarse sulphides - mainly pyrite, pyrrhotite +/- sphalerite.
80.8	86.2	<u>Coarse Pegmatite</u> . Minor pyrite, magnetite clots.
86.2	99.5	<u>Quartz Biotite Gneiss</u> - silicified in places with sericite overprinting common; minor pyrite +/- garnet.
99.5	111.0	<u>Coarse Pegmatite</u> . K-spar rich pegmatite, epidote common; magnetite and biotite phenocrysts.
111.0	116.0	<u>Biotite Quartz Gneiss</u> . Variably sericitized,

BALTIC RESOURCES INC.

DIAMOND DRILL LOG

PROPERTY: HURDMAN
HOLE No.: 98-2

Page 2

FROM	TO	LITHOLOGICAL DESCRIPTION
		sillimanite in bands.
116.0	149.0	<u>Garnet Biotite Gneiss</u> . sericitized in places; minor pyrite in secondary bands and clots.
		END OF HOLE.

BALTIC RESOURCES INC.

DIAMOND DRILL LOG

PROPERTY: HURDMAN

HOLE No.: 98-3

Collar Eastings: 2194.56

Collar Northings: -335.28

Collar Elevation: 1000.00

Date: April 3, 1998

Logged by: G. Pierce

Collar Inclination: -70.00

Grid Bearing: 180.00

Final Depth: 149.00 metres

FROM	TO	LITHOLOGICAL DESCRIPTION
0	7.5	<u>Overburden</u>
7.5	63.5	<u>Biotite Garnet Gneiss</u> . Abundant coarse garnets. Foliation 80½ C.A.
63.5	68.0	<u>Altered Biotite Garnet Gneiss</u> . sericite, but no significant sulphides.
68.0	83.5	<u>Hurdman Sulphide Zone</u> .
	68.0 77.3	<u>Weakly Mineralized Gneiss</u> . Sericitic alteration, garnets still common.
	77.3 81.5	<u>Pegmatized Gneiss</u> . Heavy mineralized zone; pale green phenocrysts - cordierite?; sulphides pyrite, pyrrhotite +/- sphalerite.
	81.5 83.5	<u>Silicified Biotite Quartz Gneiss</u> . Disseminated pyrite throughout, but only minor sphalerite; magnetite.
83.5	104.0	<u>Siliceous Biotite Quartz Gneiss</u> . Minor sulphides throughout - strongest 98.5 to 101.0 m.
104.0	124.4	<u>Silicified Biotite Garnet Quartz Gneiss</u> . Disseminated sulphides - mainly pyrite, pyrrhotite throughout; unit variably sericitized.
124.4	130.0	<u>Biotite Garnet Gneiss</u> . Coarse garnets in mafic (biotite rich) bands; weak sericitization and silicification; minor sulphide.
130.0	149.0	<u>Biotite Gneiss</u> . Unaltered; no significant sulphides.

END OF HOLE.

BALTIC RESOURCES INC.

DIAMOND DRILL LOG

PROPERTY: HURDMAN

HOLE No.: 98-4

Collar Eastings: 2316.48

Collar Northings: -182.88

Collar Elevation: 1000.00

Date: April 5, 1998

Logged by: G. Pierce

Collar Inclination: -70.00

Grid Bearing: 180.00

Final Depth: 143.00 metres

FROM	TO	LITHOLOGICAL DESCRIPTION
0	9.0	<u>Overburden</u>
9.0	30.5	<u>Biotite Gneiss</u> . Unaltered, minor garnets, no sulphides.
30.5	41.3	<u>Pegmatite</u> . Unmineralized. K-spar rich; magnetite, biotite phenocrysts.
41.3	42.7	<u>Biotite Quartz Gneiss</u> . Partly migmatized.
42.7	45.5	<u>Pegmatite</u> . K-spar rich as from 30.5 to 41.3m.
45.5	59.0	<u>Biotite Quartz Gneiss</u> . Partly altered; garnet more common than in the biotite gneiss above.
59.0	67.8	<u>Quartz Biotite Gneiss</u> . Progressively more altered with depth; garnets common in biotite rich mafic bands; gradational into unit below.
67.8	98.9	<u>Hurdman Sulphide Zone</u>
	67.8 72.5	<u>Banded Garnet Biotite Gneiss</u> . First sulphides as pyrite band at contact with overlying gneiss. Unit looks like Geco-type Iron Formation.
	72.5 80.2	<u>Biotite Gneiss</u> . Similar to above with less garnets.
	80.2 98.8	<u>Banded Gneiss</u> . As at 67.8 to 72.5m; sulphides disseminated throughout - strongest in last 12 metres - mainly pyrite, pyrrhotite.
98.8	103.9	<u>Biotite Garnet Gneiss</u> . Numerous garnets.
103.9	143.0	<u>Biotite Garnet Gneiss</u> . Typical of footwall in other holes. Variably bleached and sericitized with fine disseminated pyrite. Narrow sulphides in quartz stringer 118.6-118.9m.

END OF HOLE.

Appendix 1 C :

Drill Sections

Lines 72+00E & 76+00E

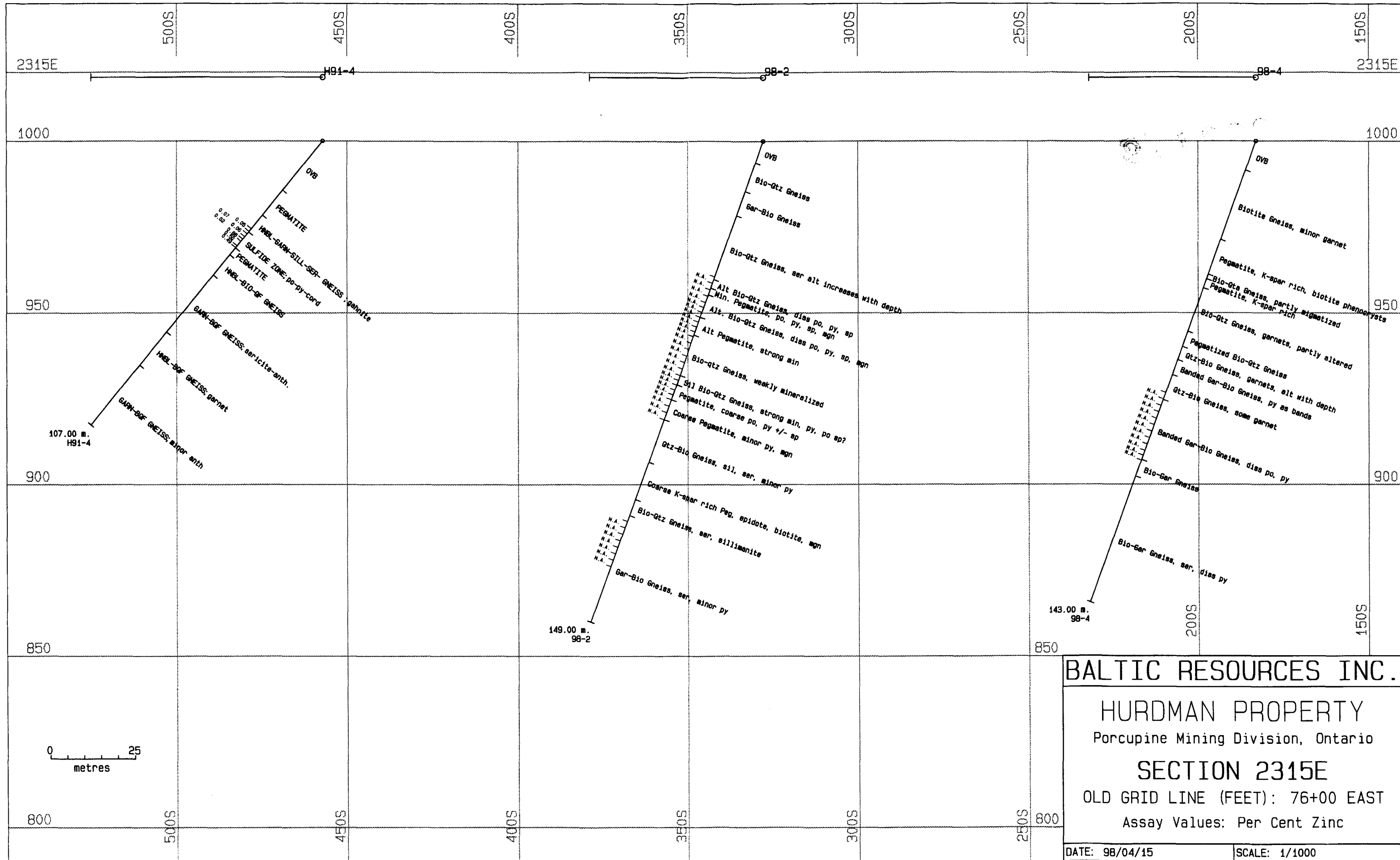

BALTIC RESOURCES INC.

HURDMAN PROPERTY
 Porcupine Mining Division, Ontario

SECTION 2315E
 OLD GRID LINE (FEET): 76+00 EAST
 Assay Values: Per Cent Zinc

DATE: 98/04/15 SCALE: 1/1000



Declaration of Assessment Work Performed on Mining Land

Mining Act, Subsection 65(2) and 66(3), R.S.O. 1990

Transaction Number (office use) 19860-00417 Assessment Files Research Imaging



42H12SW2001 2.18388 HURDMAN

900

ity of subsections 65(2) and 66(3) of the Mining Act. Under section 8 of the d to review the assessment work and correspond with the mining land holder. ning Recorder, Ministry of Northern Development and Mines, 6th Floor,

Instructions: - For work performed on Crown Lands before recording a claim, use form 0240. - Please type or print in ink.

1. Recorded holder(s) (Attach a list if necessary)

Name: Don McMINNEN, Client Number: 168276, Address: Box 1180, Timmins Ontario P4N 7H9, Telephone Number: 705-268-8822, Fax Number: 705 268 5532. Name: Noront Resources Ltd., Client Number: 176367, Address: Ste 1900, 95 Wellington St W., Toronto Ontario, Telephone Number: 416-861-1703, Fax Number: 416-947-0807

2. Type of work performed: Check (✓) and report on only ONE of the following groups for this declaration.

Geotechnical: prospecting, surveys, assays and work under section 18 (regs) Physical: drilling, stripping, trenching and associated assays Rehabilitation

Work Type: Diamond Drilling, Office Use: Commodity, Total \$ Value of Work Claimed: \$45,201, Dates Work Performed: From 30/3/98 To 8/4/98, Township/Area: HURDMAN, M or G-Plan Number: G 3016, Mining Division: Timmins Province, Resident Geologist District: Timmins

Please remember to: - obtain a work permit from the Ministry of Natural Resources as required; - provide proper notice to surface rights holders before starting work; - complete and attach a Statement of Costs, form 0212; - provide a map showing contiguous mining lands that are linked for assigning work; - include two copies of your technical report.

3. Person or companies who prepared the technical report (Attach a list if necessary)

Name: BCIX Consulting Ltd., Telephone Number: 902 542 0972, Address: Box 279 Wabville N.S. B0P 1X0, Fax Number: 902 542 0972. RECEIVED 2:30 pm APR 27 1998 GEOSCIENCE ASSESSMENT OFFICE

4. Certification by Recorded Holder or Agent

I, GARTH PIERCE, do hereby certify that I have personal knowledge of the facts set forth in this Declaration of Assessment Work having caused the work to be performed or witnessed the same during or after its completion and, to the best of my knowledge, the annexed report is true.

Signature of Recorded Holder or Agent: [Signature], Date: April 16, 98, Agent's Address: Box 279 Wabville Nova Scotia, Telephone Number: 902 542 0972, Fax Number: 902 542 0972

Approved T.P. 7/1/98

5. Work to be recorded and distributed. Work can only be assigned to claims that are contiguous (adjoining) to the mining land where work was performed, at the time work was performed. A map showing the contiguous link must accompany this form.

W9860-00417

FINAL REVISION

Mining Claim Number. Or if work was done on other eligible mining land, show in this column the location number indicated on the claim map.	Number of Claim Units. For other mining land, list hectares.	Value of work performed on this claim or other mining land.	Value of work applied to this claim.	Value of work assigned to other mining claims.	Bank Value of work to be distributed at a future date.
eg TB 7827	16 ha	\$26,825	N/A	\$24,000	\$2,825
eg 1234567	12	0	\$24,000	0	0
eg 1234568	2	\$ 8,892	\$ 4,000	0	\$4,892
1					
2 1197666b		22,000	0	22,000	
3 1197668		22,000 22,000	0	22,000	1201
4 1223435	3		1200		
5 1223436	4		1600		
6 1223437	11		4400		
7 1213459	12		4800		
8 1181833	1		640		
9 1181834	1		640		
10 1181835	1		640		
11 1181836	1		640		
12 1181837	1		640		
13 1181843	1		640		
14 1181844	1		640		
15 1181845	1		640		
Column Totals		\$ 45,201 45,201	\$ 17,120	\$ 44,000	1201

I, GARRETT PIERCE (Print Full Name), do hereby certify that the above work credits are eligible under subsection 7 (1) of the Assessment Work Regulation 6/96 for assignment to contiguous claims or for application to the claim where the work was done.

Signature of Recorder Holder or Agent Authorized in Writing: [Signature] Date: April 15, 98

6. Instructions for cutting back credits that are not approved.

Some of the credits claimed in this declaration may be cut back. Please check (✓) in the boxes below to show how you wish to prioritize the deletion of credits:

- 1. Credits are to be cut back from the Bank first, followed by option 2 or 3 or 4 as indicated.
- 2. Credits are to be cut back starting with the claims listed last, working backwards; or
- 3. Credits are to be cut back equally over all claims listed in this declaration; or
- 4. Credits are to be cut back as prioritized on the attached appendix or as follows (describe):

RECEIVED
APR 22 1998
GEOSCIENCE ASSESSMENT OFFICE

Note: If you have not indicated how your credits are to be deleted, credits will be cut back from the Bank first, followed by option number 2 if necessary.

For Office Use Only

Received Stamp	Deemed Approved Date	Date Notification Sent
	Date Approved	Total Value of Credit Approved
Approved for Recording by Mining Recorder (Signature)		

0241 (02/96)

APR 22 '98 09:29

7052685532

PAGE 02

2:30 PM
APR 22 1998
GEOSCIENCE ASSESSMENT OFFICE

Note: If you have not indicated how your credits are to be deleted, credits will be cut back from the Bank first, followed by option number 2 if necessary.

For Office Use Only

Received Stamp	Deemed Approved Date	Date Notification Sent
	Date Approved	Total Value of Credit Approved
Approved for Recording by Mining Recorder (Signature)		

0241 (02/96)

Amended f
P2 @ 008



Schedule for Declaration of Assessment Work on Mining Land

Transaction Number (office use)
W9860.00417

TOTALS Carried over 45,200.00 17,120 44,000 1207

Mining Claim Number. Or if work was done on other eligible mining land, show in this column the location number indicated on the claim map.	Number of Claim Units. For other mining land, list hectares.	Value of work performed on this claim or other mining land.	Value of work applied to this claim.	Value of work assigned to other mining claims.	Bank Value of work to be distributed at a future date.
6 1181846	1	0	640		
17 1181847	1		640		
18 1181848	1		640		
19 1181849	1		640		
20 1181850	1		640		
21 1181851	1		640		
22 1181852	1		640		
23 1181859	1		640		
24 1181860	1		640		
25 1181861	1		640		
26 1181862	1		640		
27 1181863	1		640		
28 1181864	1		640		
29 1181876	1		640		
30 1181877	1		640		
31 1181882	1		640		
32 1181883	1		640		
33 1181884	1		640		
34 1181884	1		640		
35 1181885	1		640		
36 1181885	1		640		
37 1181886	1		640		
38 1181884	1		640		
39 1181821	1		640		
40 1181820	1		640		
41 1181822	1		640		
42 1181833	1		640		
43 1181837	1		640		
44 1181838	1		640		
45 1181832	1		640		
46 1181823	1		640		
47 1181824	1		640		
48 1181831	1		640		
49 1181839	1		640		
50 1181840	1		640		
Column Totals		45,200.00	39,520	94,000	1207

RECEIVED
APR 21 1998
GEOSCIENCE ASSESSMENT OFFICE

0281 (02/98)

48 1181831	1		640		
49 1181839	1		640		
50 1181840	1		640		
Column Totals		45,200.97	39,520	94,000	7

0280 (02/98)



Ministry of Northern Development and Mines

Statement of Costs for Assessment Credit

Transaction Number (office use)

19860.00417

Amended

Personal information collected on this form is obtained under the authority of subsection 6(1) of the Assessment Work Regulation 6/96. Under section 8 of the Mining Act, the information is a public record. This information will be used to review the assessment work and correspond with the mining land holder. Questions about this collection should be directed to the Chief Mining Recorder, Ministry of Northern Development and Mines, 6th Floor, 933 Ramsey Lake Road, Sudbury, Ontario, P3E 6B5.

Work Type	Units of Work <small>Depending on the type of work, list the number of hours/days worked, metres of drilling, kilometres of grid line, number of samples, etc.</small>	Cost Per Unit of work	Total Cost
Diamond Drilling	556.4 m	44.91	24,897.56
Geological Supervision	111.0 hours	* 80.25/hr	8,907.75
Drill Support - Field Assistant	8.5 days	* 267.50/day	2,273.75
Linecutting	8.0 days	* 267.50/day	2,140.00
	↓ include GST		
Associated Costs (e.g. supplies, mobilization and demobilization)			
	Norex - Mob - De Mob		4,020.83
	Misc - 6 wheel rentals		1,376.30
	- GASOLINE		429.98
Transportation Costs			
	Silver Service Mileage	1000km @ 40¢	424.00
Food and Lodging Costs			
			730.80
Total Value of Assessment Work			45,200.97

RECEIVED
APR 22 1998
10:15
GEOSCIENCE ASSESSMENT OFFICE
Calculations of Piling Discounts:

1. Work filed within two years of performance is claimed at 100% of the above Total Value of Assessment Work.
2. If work is filed after two years and up to five years after performance, it can only be claimed at 50% of the Total Value of Assessment Work. If this situation applies to your claims, use the calculation below:

TOTAL VALUE OF ASSESSMENT WORK 45,200.97 × 0.50 = Total \$ value of worked claimed 22,600.48

Note:

- Work older than 5 years is not eligible for credit.
- A recorded holder may be required to verify expenditures claimed in this statement of costs within 45 days of a request for verification and/or correction/clarification. If verification and/or correction/clarification is not made, the Minister may reject all or part of the assessment work submitted.

Certification verifying costs:

I, GARY PIERCE (please print full name), do hereby certify, that the amounts shown are as accurate as may reasonably be determined and the costs were incurred while conducting assessment work on the lands indicated on the accompanying Declaration of Work form as AGENT (recorded holder, agent, or state company position with signing authority) I am authorized to make this certification.

Signature: [Signature] Date: April 16/98

0212 (02/96)

APR 22 '98 10:03

7052685532

PAGE 02

Certification verifying costs:

I, GARY PIERCE (please print full name), do hereby certify, that the amounts shown are as accurate as may reasonably be determined and the costs were incurred while conducting assessment work on the lands indicated on the accompanying Declaration of Work form as AGENT (recorded holder, agent, or state company position with signing authority) I am authorized to make this certification.

Signature: [Signature] Date: _____

0212 (02/96)

Ministry of
Northern Development
and Mines

Ministère du
Développement du Nord
et des Mines



Geoscience Assessment Office
933 Ramsey Lake Road
6th Floor
Sudbury, Ontario
P3E 6B5

June 29, 1998

DONALD MCKINNON
BOX 1130
TIMMINS, Ontario
P4N-7M5

Telephone: (888) 415-9846
Fax: (705) 670-5881

Visit our website at:
www.gov.on.ca/MNDM/MINES/LANDS/mlsmnpge.htm

Dear Sir or Madam:

Submission Number: 2.18388

Status

Subject: Transaction Number(s): W9860.00417 Deemed Approval

We have reviewed your Assessment Work submission with the above noted Transaction Number(s). The attached summary page(s) indicate the results of the review. **WE RECOMMEND YOU READ THIS SUMMARY FOR THE DETAILS PERTAINING TO YOUR ASSESSMENT WORK.**

If the status for a transaction is a 45 Day Notice, the summary will outline the reasons for the notice, and any steps you can take to remedy deficiencies. The 90-day deemed approval provision, subsection 6(7) of the Assessment Work Regulation, will no longer be in effect for assessment work which has received a 45 Day Notice. Allowable changes to your credit distribution can be made by contacting the Geoscience Assessment Office within this 45 Day period, otherwise assessment credit will be cut back and distributed as outlined in Section #6 of the Declaration of Assessment work form.

Please note any revisions must be submitted in DUPLICATE to the Geoscience Assessment Office, by the response date on the summary.

If you have any questions regarding this correspondence, please contact Steve Beneteau by e-mail at benetest@epo.gov.on.ca or by telephone at (705) 670-5855.

Yours sincerely,

A handwritten signature in black ink, appearing to read "Blair Kite".

ORIGINAL SIGNED BY
Blair Kite
Supervisor, Geoscience Assessment Office
Mining Lands Section

Work Report Assessment Results

Submission Number: 2.18388

Date Correspondence Sent: June 29, 1998

Assessor: Steve Beneteau

Transaction Number	First Claim Number	Township(s) / Area(s)	Status	Approval Date
W9860.00417	1177666	HURDMAN	Deemed Approval	June 26, 1998

Section:
16 Drilling PDRILL

Correspondence to:
Resident Geologist
South Porcupine, ON

Assessment Files Library
Sudbury, ON

Recorded Holder(s) and/or Agent(s):
Garth Pierce
WOLFVILLE, NS, CAN

DONALD MCKINNON
TIMMINS, Ontario

NORONT RESOURCES LTD.
TORONTO, ONTARIO

REFERENCES

AREAS WITHDRAWN FROM DISPOSITION

- M.R.O. - MINING RIGHTS ONLY
- S.R.O. - SURFACE RIGHTS ONLY
- M.+S. - MINING AND SURFACE RIGHTS

Description	Order No.	Date	Disposition	File

FLOODING

Flooding rights along Mattagami River to contour elevation 700 ft. reserved to Ontario Hydro.

TWP. OF AGATE G-3008

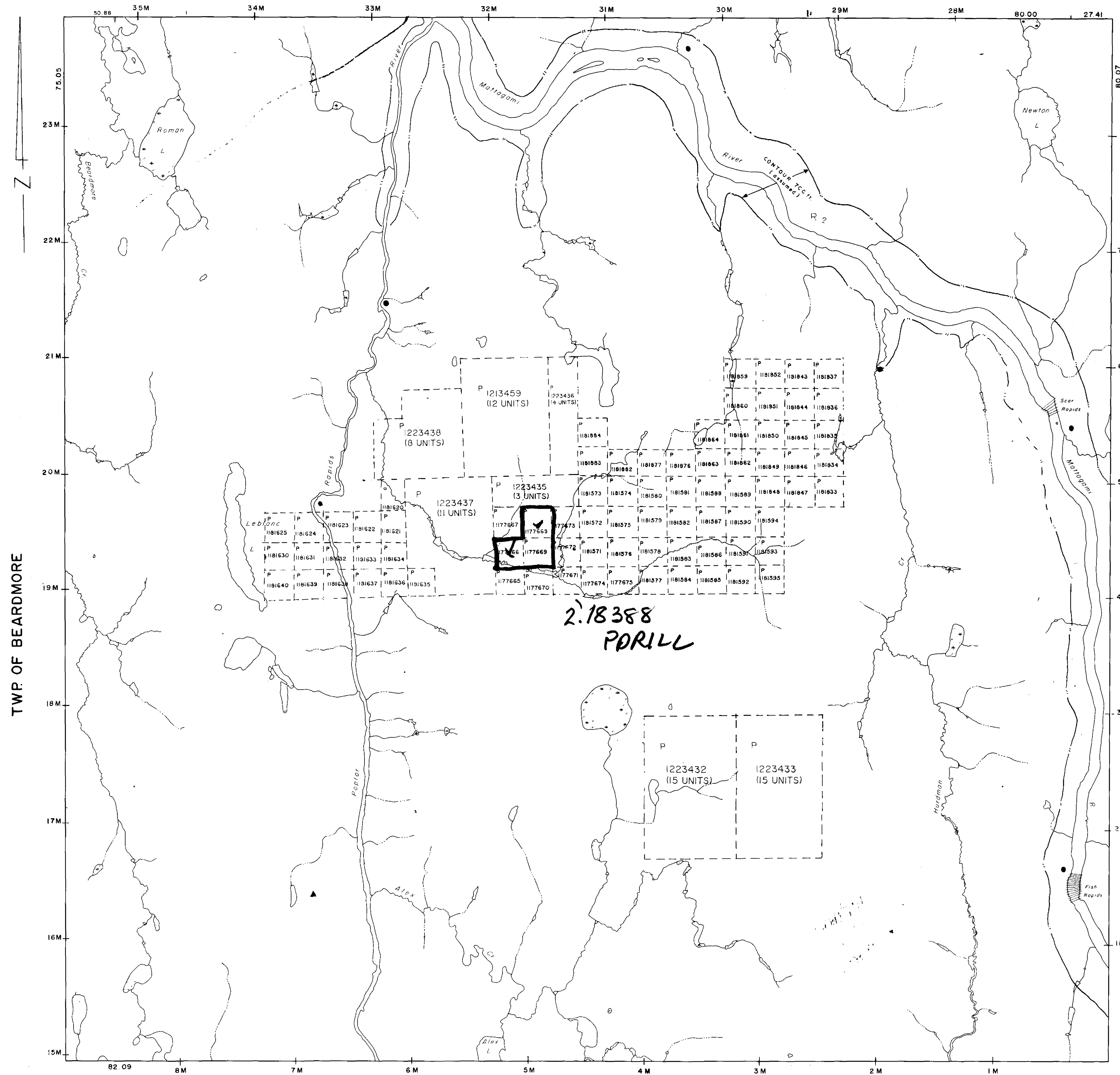

TWP. OF ALEXANDRA

LEGEND

- HIGHWAY AND ROUTE No.
- OTHER ROADS
- TRAILS
- SURVEYED LINES:
 - TOWNSHIPS, BASE LINES, ETC.
 - LOTS, MINING CLAIMS, PARCELS, ETC.
- UNSURVEYED LINES:
 - LOT LINES
 - PARCEL BOUNDARY
 - MINING CLAIMS ETC.
- RAILWAY AND RIGHT OF WAY
- UTILITY LINES
- NON-PERENNIAL STREAM
- FLOODING OR FLOODING RIGHTS
- SUBDIVISION OR COMPOSITE PLAN
- RESERVATIONS
- ORIGINAL SHORELINE
- MARSH OR MUSKEG
- MINES
- TRAVERSE MONUMENT

DISPOSITION OF CROWN LANDS

TYPE OF DOCUMENT	SYMBOL
PATENT, SURFACE & MINING RIGHTS	
" SURFACE RIGHTS ONLY	
" MINING RIGHTS ONLY	
LEASE, SURFACE & MINING RIGHTS	
" SURFACE RIGHTS ONLY	
" MINING RIGHTS ONLY	
LICENCE OF OCCUPATION	
ORDER-IN-COUNCIL	
RESERVATION	
CANCELLED	
SAND & GRAVEL	

NOTE: MINING RIGHTS IN PARCELS PATENTED PRIOR TO MAY 6, 1913, VESTED IN ORIGINAL PATENTEE BY THE PUBLIC LANDS ACT, R.S.O. 1970, CHAP. 380, SEC. 63, SUBSEC. 1.

- THIS TOWNSHIP SUBJECT TO FORESTRY ACTIVITY
- 1981-82 INFORMATION ON FILE
- APPROXIMATE ROAD LOCATION
- TRAPLINE CABIN
- ▲ LAND USE PERMIT

DATE OF ISSUE

JUN 22 1984

PROVINCIAL RECORDING OFFICE - SUDBURY

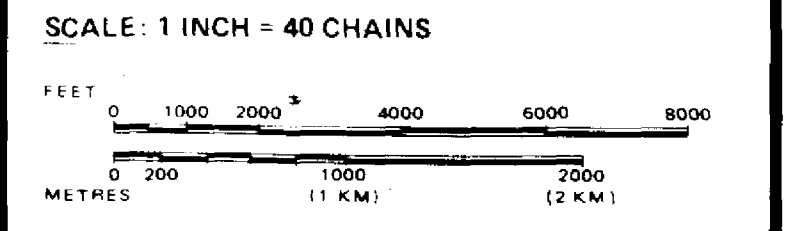

TOWNSHIP
HURDMAN
 M.N.R. ADMINISTRATIVE DISTRICT
COCHRANE
 MINING DIVISION
PORCUPINE
 LAND TITLES / REGISTRY DIVISION
COCHRANE

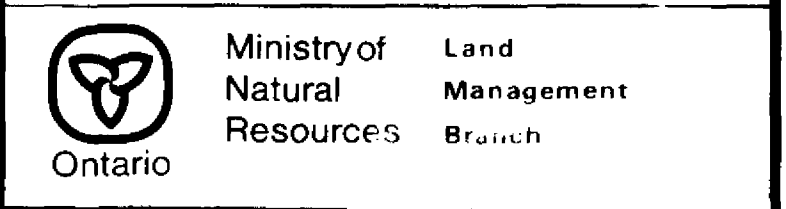

Date MARCH 1984. Number
 ACTIVATED BY: DM NOV. 14/96
 CHECKED BY: G.C. **G-3016**

THE INFORMATION THAT APPEARS ON THIS MAP HAS BEEN COMPILED FROM VARIOUS SOURCES, AND ACCURACY IS NOT GUARANTEED. THOSE WISHING TO STAKE MINING CLAIMS SHOULD CONSULT WITH THE MINING RECORDER, MINISTRY OF NORTHERN DEVELOPMENT AND MINES, FOR ADDITIONAL INFORMATION ON THE STATUS OF THE LANDS SHOWN HEREON.