



42107NW0010 0010C1 BRODER

RECEIVED

DEC 5 1974

010

PROJECTS UNIT

GEOLOGICAL REPORT

on

MINING CLAIM No. 5378703

TOWNSHIP OF BRODER

DISTRICT OF SUDBURY

Lot 11, Concession V, N $\frac{1}{2}$ of SE $\frac{1}{4}$

BY: LEONARD D. SWANSON
GEOLOGIST

INTRODUCTION

One geologist and one assistant spent three days mapping the claim, No.S378703. The work was performed at various times during the month of November, starting November 2, 1974 and completed November 26, 1974.

Pace and Compass geology traverses were run at 400' centres, and frequently closer, as required in order to outline the geology.

The principle geologic features are uncomplicated and the amount of overburden is very limited. Linecutting was unnecessary as vegetation is very sparse.

Runoff is to the east, with two small streams draining the property.

GEOLOGICAL REPORT

The geology is quite uncomplicated with only one geological contact on the property. This contact, between the sediments of the S.W. corner of the claim and the plutonic rock which underlies the rest of the claim, is very well exposed.

The sedimentary rock is impure, pyrite-bearing Wanapitef quartzite. The igneous rock is a dark green, medium-grained Sudbury gabbro.

Both rock types have numerous joint systems and a pervasive EW shearing.

Two EW fault zones traverse the property. The surface expressions of these faults are vertical cliffs up to 40' in height.

These faults, as well as the extensive shearing, are apparently part of, or related to the Murray Fault which they parallel. The Murray Fault is practically adjacent to the southern claim line.

No showings were observed on the claim itself; however, a small previously worked trench containing massive pyrrhotite occurs 250' east of the claim.

CONCLUSIONS & RECOMMENDATIONS

For the most part the property is economically uninteresting, however, the small trench east of the property is on strike with the northern fault zone. As this zone is a narrow topographic low the bedrock is obscured by a thin mantle of glacial overburden.

Two alternatives exist for further work:



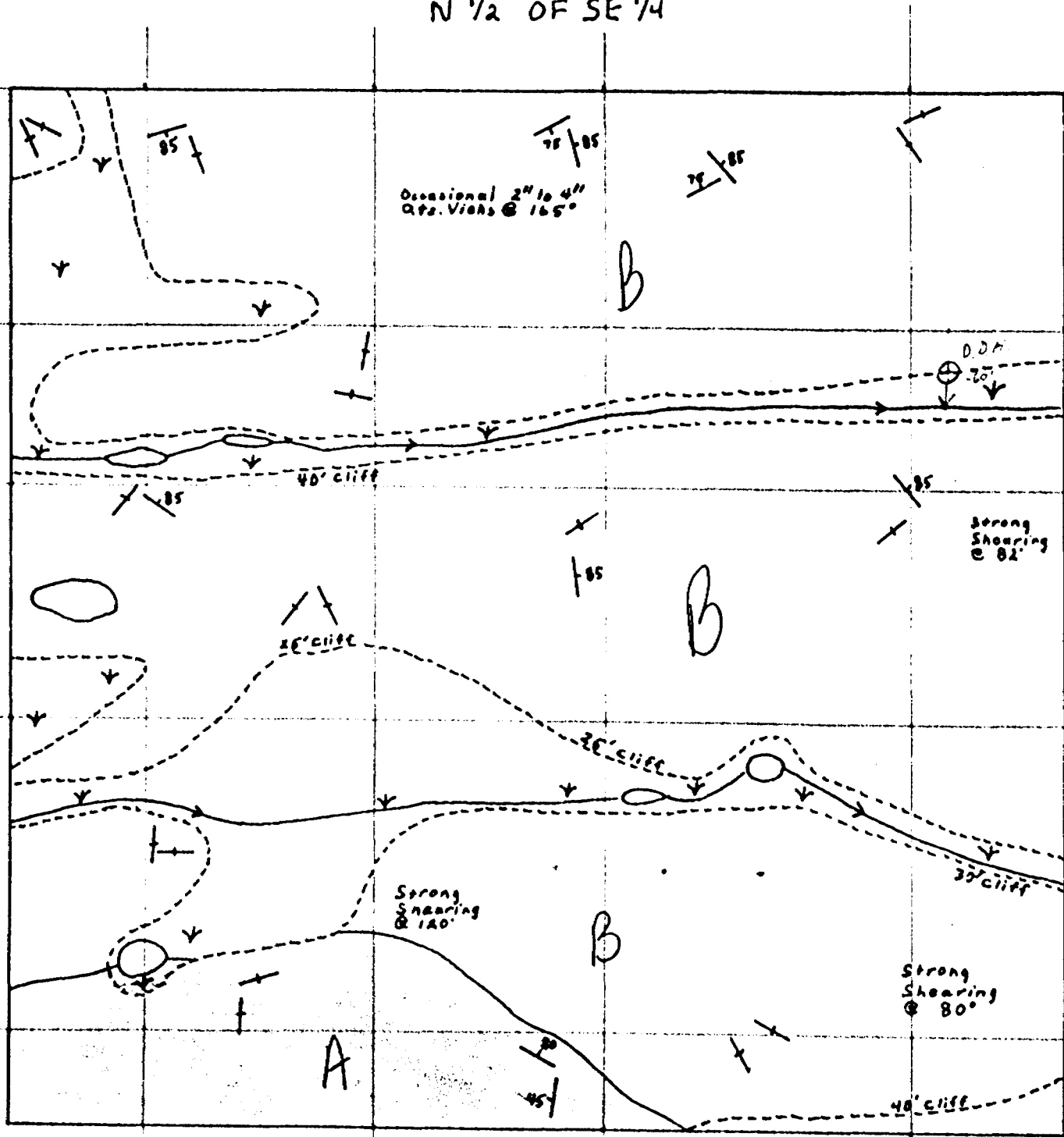

(1) Since the mineralization in the trench is pyrrhotite, a magnetometer survey could be carried out over the claim, to determine whether or not an anomaly does exist, or (2) as the overburden is quite shallow, a trenching operation would be justified. This would readily expose the faulted zone so that samples could be obtained for further evaluation. If the trenching exposed no sulphide mineralization but a magnetic survey did reveal an anomalous zone related to the fault, I would suggest diamond drilling.

As the foliation strikes roughly EW and dips vertically, drilling could be performed either from the north or the south, depending on the geophysical results. i.e. accessibility to the anomaly, if indeed one does exist, and the dip of mineralization assuming it can be interpreted.

GEOLOGICAL SURVEY
OF
MINING CLAIM #378703
TOWNSHIP OF BRODER
DISTRICT OF SUDBURY
LOT 11, CONCESSION V
N 1/2 OF SE 1/4



LEGEND

- | | | | |
|---|-------------------------------|---|------------------|
|  | Strike & Dip of Major joints |  | M.G. Metagabbro |
|  | Pond, stream & flow direction |  | Impure Quartzite |
|  | Swamp | | |

Scale: 1" = 200'

GEOLOGY BY:
L.D. SWANSON
Nov. 25, 1974.

Leonard Swanson

Assessment work completed :

1 Geologist - 3 days Mapping & Plotting	- 21 days
1 Assistant - 3 days Grid work	- <u>3 days</u>
Total	- 24 days
	<hr/>

Dear Sir :

As I was unaware that typing and draughting services qualified as assessment work credits, I have recalculated according to the "assessment work breakdown" forms which you sent me :

i.e. Total Technical days	= 4 X 7 =	28
Total linecutting days	= 3 X 1 =	<u>3</u>
Total		<u>31 days</u>

Sd-/ Leonard Swanson

**DUPLICATE COPY
POOR QUALITY ORIGINAL
TO FOLLOW**

Assessment Work completed:

1 Geologist - 3 days Mapping & Plotting	- 21 days
1 Assistant - 3 days Grid work	- 3 days
	<hr/>
Total	24 days
	<hr/>

Dear Sir,

As I was unaware that typing and draughting services qualified as assessment work credits, I have recalculated according to the "Assessment Work Breakdown" forms which you sent me.

ie. Total Technical days = $4 \times 7 = 28$
 Total Linecutting days = $3 \times 1 = 3$

Total = 31

Leonard Swanson
 Leonard Swanson

ASSESSMENT WORK BREAKDOWN

- 1. Type of Survey GEOLOGICAL
- 2. Township or Area BRODER TWP., SUDBURY DISTRICT
- 3. Numbers of Mining Claims Traversed by Survey S. 378703



900

- 4. Number of Miles of Line Cut NIL Flown
- *5. Number of Stations Established
- *6. Make and type of Instrument Used
- *7. Scale Constant or Sensitivity
- *8. Frequency Used and Power Output

9. Summary of Assessment Credits (details on reverse side)

Total 8 hour Technical Days (Include Consultants, Draughting etc.) FOUR

Total 8 hour Line-Cutting Days THREE

Calculation

$$\frac{4}{\text{Technical}} \times 7 = \frac{28}{\text{Line-cutting}} + \frac{3}{\text{Line-cutting}} = \frac{31}{\text{Line-cutting}} \div \frac{1}{\text{Number of claims}} = \frac{31}{\text{Assessment credits per claim}}$$

The dates listed on this form represent working time spent entirely within the limits of the above listed claims Check
 If otherwise, please explain

Dated: Feb. 19, 1975

Signed: Leonard Anwar

- Note:
- (A) * Complete only if applicable.
 - (B) Complete list of names, addresses and dates on reverse side.
 - (C) Submit separate breakdown for each type of survey.
 - (D) Submit in duplicate.

ASSESSMENT WORK BREAKDOWN

1. FIELD WORK

<u>Type of Work</u>	<u>Name & Address</u>	<u>Dates Worked</u>	<u>Number of 8 hour days</u>
GEOLOGICAL MAPPING	L.D. SWANSON 905 PRETE ST APT. 303 SUD., ONT.	NOV. 2, 9, 23, 24/74	3

2. CONSULTANTS

<u>Name & Address</u>	<u>Dates Worked (specify in field or office)</u>	<u>Number of 8 hour days</u>

3. DRAUGHTSMAN, TYPING, OTHERS (specify)

<u>Name & Address</u>	<u>Type of Work</u>	<u>Dates Worked</u>	<u>Number of 8 hour days</u>
L.D. SWANSON	DRAUGHTING	NOV. 24/74	1/2
C.M. SWANSON 905 PRETE ST SUD., ONT.	TYPIST	NOV. 24/74	1/2

TOTAL 8 HOUR TECHNICAL DAYS 4

4. LINE-CUTTING (CHAINING)

<u>Name</u>	<u>Address</u>	<u>Dates Worked</u>	<u>Number of 8 hour days</u>
J.A. SWANSON	60 STRATHMERE CR. SILDBURY, ONT.	NOV. 29, 23, 24/74	3

TOTAL 8 HOUR LINE-CUTTING DAYS 3



GEOPHYSICAL - GEOLOGICAL - GEOCHEMICAL
TECHNICAL DATA STATEMENT

TO BE ATTACHED AS AN APPENDIX TO TECHNICAL REPORT
FACTS SHOWN HERE NEED NOT BE REPEATED IN REPORT
TECHNICAL REPORT MUST CONTAIN INTERPRETATION, CONCLUSIONS ETC.

RECEIVED

DEC 5 1974

PROJECTS UNIT

Type of Survey(s) Geological

Township or Area Broder

Claim Holder(s) Malcolm J. Fielding

Survey Company _____

Author of Report Leonard D. Swanson

Address of Author 905 Prete St., Apt 303, Sudbury

Covering Dates of Survey November 2, 1974 - November 26/74
(linecutting to office)

Total Miles of Line Cut none

MINING CLAIMS TRAVERSED
List numerically

S
(prefix)

378703
(number)

SPECIAL PROVISIONS
CREDITS REQUESTED

ENTER 40 days (includes
line cutting) for first
survey.

ENTER 20 days for each
additional survey using
same grid.

Geophysical

DAYS
per claim

--Electromagnetic _____

--Magnetometer _____

--Radiometric _____

--Other _____

Geological 24

Geochemical _____

AIRBORNE CREDITS (Special provision credits do not apply to airborne surveys)

Magnetometer _____ Electromagnetic _____ Radiometric _____
(enter days per claim)

DATE: November 26/74 SIGNATURE: Leonard D. Swanson
Author of Report or Agent

Res. Geol. _____ Qualifications _____

Previous Surveys

File No.	Type	Date	Claim Holder

TOTAL CLAIMS 1

If space insufficient, attach list



Ministry of
Natural
Resources

April 23, 1975

Mr. J. M. Hughes
Regional Director
Ministry of Natural Resources
Box 1900
Sault Ste. Marie, Ontario
P6A 5N9

Our file number 2.1651

Your file number

Dear Sir:

Re: Mining Claim S. 378703, Broder Township
File 2.1651

The Geological assessment work credits as shown on the attached statement have been approved as of the above date.

A copy of this letter should be sent to the Mining Recorder who should inform the recorded holder of these mining claims and so indicate on his records.

Yours very truly,

for
J. R. McGinn
Director
Lands Administration Branch

Whitney Block, Room 1617
Queen's Park
Toronto, Ontario
M7A 1X1
Phone: 416-965-6918

DN/mw

- cc: Mr. Malcolm J. Fielding
Sudbury, Ontario
- cc: Mr. Leonard D. Swanson
Copper Cliff, Ontario
- * cc: Mining Recorder
Sudbury, Ontario
- cc: Deputy Regional Director
Sudbury, Ontario
Attn: Resident Geologist
- cc: Mr. Leonard D. Swanson
Sudbury, Ontario

Recorded Holder <p style="text-align: center;">Malcolm James Fielding</p>
Township or Area <p style="text-align: center;">Broder Township</p>

Type of survey and number of Assessment days credit per claim	Mining Claims
Geophysical Electromagnetic _____ days Magnetometer _____ days Radiometric _____ days Induced polarization _____ days Section 86 (18) _____ days Geological <u>27.5</u> days Geochemical _____ days Man days <input checked="" type="checkbox"/> Airborne <input type="checkbox"/> Special provision <input type="checkbox"/> Ground <input type="checkbox"/>	S. 378703
Notice of Intent to be issued: <input type="checkbox"/> Credits have been reduced because of partial coverage of claims <input checked="" type="checkbox"/> Credits have been reduced because of corrections to work dates and figures of applicant. <input type="checkbox"/> No credits have been allowed for the following mining claims as they were not sufficiently covered by the survey: _____ _____ _____ _____ _____	

A separate form is required for each type of work to be recorded.

THE MINING ACT REPORT OF WORK

To the Recorder of Sudbury Mining Division
 I, Malcolm James Fielding 3075156
 name of Recorded Holder Prospector's Licence
Box 1000, Copper Cliff, Ontario
 Post Office Address

do hereby report the performance of 6 days of Logging core specimens
 type of work
 not before reported to be applied on the following contiguous claims

Claim No.	Days	Claim No.	Days	Claim No.	Days
8 378703	6				

RECEIVED
 378703
 DEC 10 1975

All the work was performed on Mining Claim (s) 378703
 (In the case of geological and/or geophysical survey (s) where more than 18 claims are involved attach a schedule)

READ CAREFULLY: THE FOLLOWING INFORMATION IS REQUIRED BY THE MINING RECORDER.

- For Manual Work, Stripping or Opening up of Mines, Sinking Shafts or Other Actual Mining Operations - Names and addresses of the men who performed the work and the dates and hours of their employment.
- For Diamond and other Core Drilling - Footage, No. and angle of holes and diameter of core. Name and address of owner or operator of drill. Dates when drilling was done. Signed core log and sketch in duplicate.
- For Compressed Air or Other Power Driven or Mechanical Equipment
 Type of drill or equipment. Names and addresses of men engaged in operating equipment and the dates and hours of their employment.
- For Power Stripping - Type of equipment. Name and address of owner or operator. Amount expended. Dates on which work was done. Proof of actual cost must be submitted within 30 days of recording.
- With each of the above types of work sketches are required to show the location and extent of the work in relation to the nearest claim post. In the case of diamond or other core drilling the sketch must be submitted in duplicate.
- For Geophysical, Geological, Geochemical Surveys and Expenditure Credits - the name of author of report. Covering dates of survey (linecutting & office). Type of instrument used. Total amount of expenditure. Technical reports, maps, expenditure breakdown, receipts must be filed in duplicate with the Minister within 60 days of recording.
- For Land Survey - the name and address of Ontario Land surveyor.

The Required Information is as Follows: (Attach a list if this space is insufficient)

Core Logged by Leonard Swanson, Geologist, 186 Eyre St., 8
 Logging Report attached Sudbury, Ontario
 Sketch attached.
 6 Specimens included

RECEIVED
 MINING DIVISION
 DEC 10 1975
 7:18 AM

Date Dec. 10/75

Malcolm James Fielding
 Signature of Recorded Holder or Agent

The Mining Act
 Certificate Verifying Report of Work

I, Naomi Swanson, 60 Strathmere Cr., Sudbury, Ontario
 (Post Office Address)

- hereby certify:
1. That I have a personal and intimate knowledge of the facts set forth in the report of work annexed hereto, having performed the work or witnessed same during and/or after its completion.
 2. That the annexed report is true.

Dated Dec. 10 19 75 Signature



APR 28 1975

This form is required for each type of work to be recorded.

PROJECTS UNIT THE MINING ACT REPORT OF WORK PROJECTS UNIT

To the Recorder of Sudbury District Mining Division
Malcolm James Fielding C-31407
name of Recorded Holder Prospector's Licence
699 Ripple Road, Sudbury, Ontario
Post Office Address

do hereby report the performance of 24 days of geological work
not before reported to be applied on the following contiguous claims

Table with 6 columns: Claim No., Days, Claim No., Days, Claim No., Days. Row 1: S 378703, 24,,,,

All the work was performed on Mining Claim (s) S 378703
(In the case of geological and/or geophysical survey (s) where more than 18 claims are involved attach a schedule)

READ CAREFULLY: THE FOLLOWING INFORMATION IS REQUIRED BY THE MINING RECORDER.

- For Manual Work, Stripping or Opening up of Mines, Sinking Shafts or Other Actual Mining Operations - Names and addresses of the men who performed the work and the dates and hours of their employment.
For Diamond and other Core Drilling - Footage, No. and angle of holes and diameter of core. Name and address of owner or operator of drill. Dates when drilling was done. Signed core log and sketch in duplicate.
For Compressed Air or Other Power Driven or Mechanical Equipment
Type of drill or equipment. Names and addresses of men engaged in operating equipment and the dates and hours of their employment.
For Power Stripping - Type of equipment. Name and address of owner or operator. Amount expended. Dates on which work was done. Proof of actual cost must be submitted within 30 days of recording.
With each of the above types of work sketches are required to show the location and extent of the work in relation to the nearest claim post. In the case of diamond or other core drilling the sketch must be submitted in duplicate.
For Geophysical, Geological, Geochemical Surveys and Expenditure Credits - the name of author of report. Covering dates of survey (linecutting & office). Type of instrument used. Total amount of expenditure. Technical reports, maps, expenditure breakdown, receipts must be filed in duplicate with the Minister within 60 days of recording.
For Land Survey - the name and address of Ontario Land surveyor.

The Required Information is as Follows: (Attach a list if this space is insufficient)

Name of Author - Leonard D. Swanson - Geologist
Dates of Survey - November 2, 1974 to November 26, 1974
Technical reports
Geological Map

Date November 26, 1974

Signature of Recorded Holder or Agent

The Mining Act Certificate Verifying Report of Work

I, Leonard D. Swanson
905 Prete St., Apt. 303, Sudbury, Ontario
(Post Office Address)

hereby certify:

- 1. That I have a personal and intimate knowledge of the facts set forth in the report of work annexed hereto, having performed the work or witnessed same during and/or after its completion.
2. That the annexed report is true.

Dated November 26 19 74 Leonard D. Swanson
Signature

THE PENALTY FOR MAKING A FALSE STATEMENT IN THIS REPORT AND/OR CERTIFICATE IS \$500. OR SIX MONTHS IMPRISONMENT OR BOTH

WATERS TWR

VI

V

IV

III

II

I

DILL TWR

St. Charles L.

Kelly L.

Hannah L.

Middle L.

Silver Lake

Lake

McFarlane Lake

Raft Lake

Long L.

Lohi L.

Crawley L.

Clearwater L.

Chief's L.

Linton L.

Crooked Lake

BRODER
M-0682

1" = 40 chains

1" = 40 chains

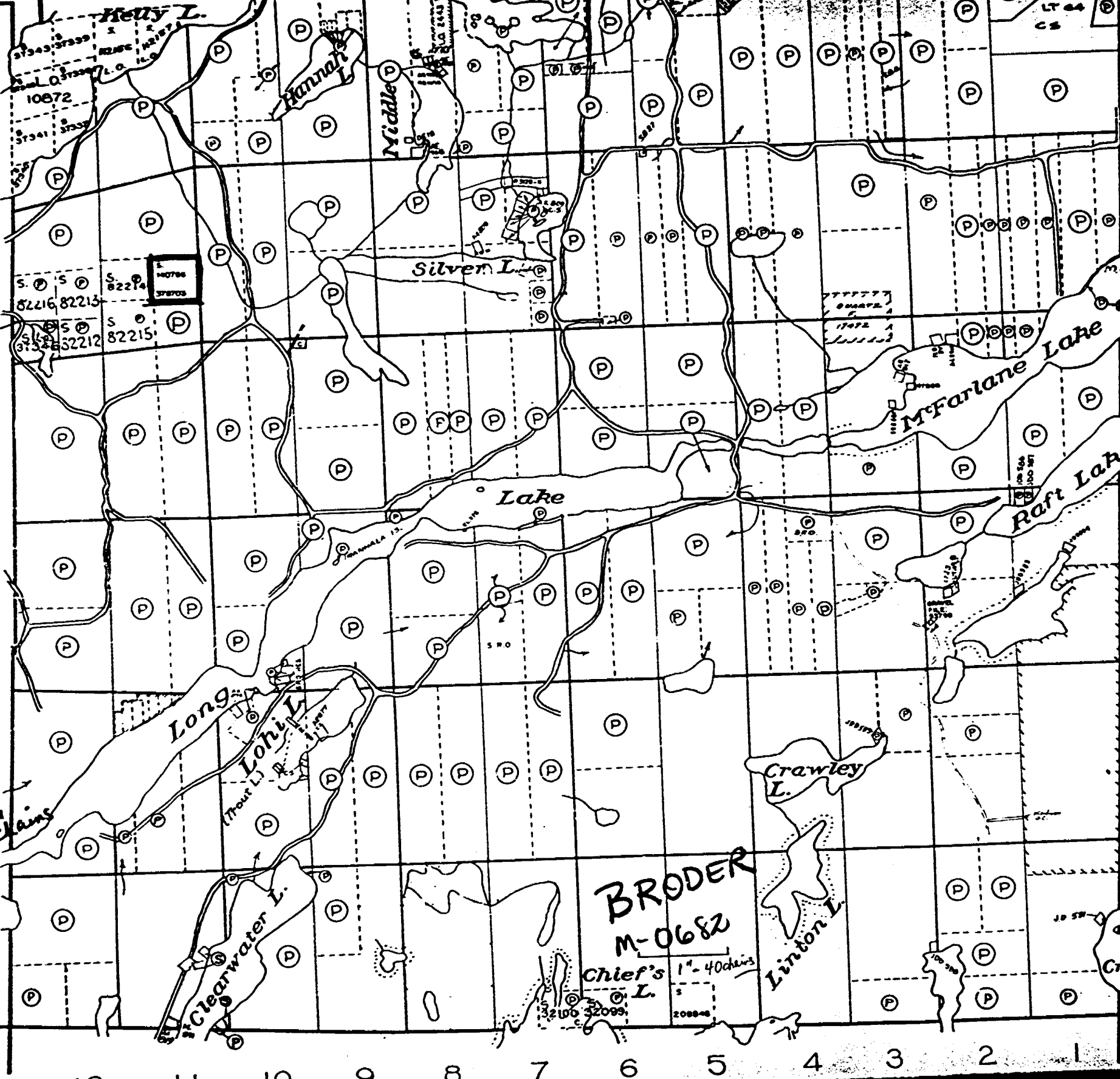

12 11 10 9 8 7 6 5 4 3 2 1