



02/26/86 210

Mining Lands Section

File No 28863

Control Sheet

TYPE OF SURVEY           GEOPHYSICAL  
       GEOLOGICAL  
       GEOCHEMICAL  
  ✓   EXPENDITURE

MINING LANDS COMMENTS:

no duplicate ✓  
\_\_\_\_\_  
\_\_\_\_\_  
\_\_\_\_\_  
\_\_\_\_\_  
\_\_\_\_\_  
\_\_\_\_\_  
\_\_\_\_\_  
\_\_\_\_\_  
< Brecker Twp >  
\_\_\_\_\_

*Legh.  
H.S.*

*Demo K.*

Signature of Assessor

*Mar. 12/86*

Date



# SWASTIKA LABORATORIES LIMITED

P.O. BOX 10, SWASTIKA, ONTARIO P0K 1T0 TELEPHONE: (705) 642-3244

1987 11707

**SOLD TO**

Ethier Sand & Gravel Limited  
2859 Ida Street  
Sudbury, Ontario  
P3E 4W9

**S  
H  
I  
P  
T  
O**

1.5% late charge over 30 days  
(annual rate 18%)

DATE	SHIPPED	FED LICENCE NO	PROV LICENCE NO	YOUR ORDER NO	OUR ORDER NO	TERMS	SALESMAN
Sept. 6/85							

QUANTITY	DESCRIPTION	UNIT PRICE	AMOUNT
11	Au Assays PPB	\$ 8.50	\$ 93.50
11	Ag Assays PPM	4.20	46.20
6	Cu Assays	4.20	25.20
5	Ni Assays	4.20	21.00
3	Zn Assays	4.20	12.60
1	Co Assay	4.20	4.20
11	Sample handling Cert. No. 60849 Aug.28/85	2.75	30.25
4	Spectrographic analysis Cert. No. 60849A ASept.3/85	30.00	120.00
5	SiO <sub>2</sub> Assays Cert. No. 60849B Sept.3/85 Mining Claim # 831344	18.50	92.50
<b>Total</b>			<b>\$ 445.45</b>

Rec'd SEP 11 1985

Prices

Ext./Add.

App'd.

Chk. No. 119

Charged to

Net No.

MOORE BUSINESS FORMS 3 7060E

ANALYTICAL CHEMISTS • ASSAYERS • CONSULTANTS  
ESTABLISHED 1928

FACTURE / INVOICE

SUDBURY  
MINING DIV.  
**RECEIVED**  
JAN 29 1986  
A.M. P.M.  
7|8|9|10|11|12|1|2|3|4|5|6



11767

# SWASTIKA LABORATORIES LIMITED

P.O. BOX 10, SWASTIKA, ONTARIO P0K 1T0 TELEPHONE: (705) 642-3244

**SOLD TO**

Ethier Sand & Gravel Limited  
2589 Ida St.  
Sudbury, Ontario  
P3E 4W9  
Att'n: Mr. M. Ethier

**S H I P T O**

S A M E

1.5% late charge over 30 days  
(annual rate 18%)

DATE	SHIPPED VIA	FED LICENCE NO	PROV LICENCE NO	YOUR ORDER NO	OUR ORDER NO	TERMS	SALESMAN
Sept. 11/85							

QUANTITY	DESCRIPTION	UNIT PRICE	AMOUNT
3	Au Assays PPB	\$ 8.50	\$ 25.50
3	Sample handling Cert. No. 60964 Sept. 10/85	2.75	8.25
3	SiO <sub>2</sub> Assays Cert. No. 60964 A Sept. 11/85	18.50	55.50
MINING CLAIM 831344			
Job No.		Tota.	\$ 89.25

Rec'd SEP 30 1985  
 Ext./Add. M...  
 App'd. [Signature]  
 Chk. No. 119  
 Charged to MINING CLAIMS

MOORE BUSINESS FORMS 3 7060E

FACTURE / INVOICE

ANALYTICAL CHEMISTS • ASSAYERS • CONSULTANTS  
ESTABLISHED 1928



SUDBURY  
MINING DIV.  
**RECEIVED**  
JAN 29 1985  
A.M. 7|8|9|10|11|12|1|2|3|4|5|6 P.M.



11784

# SWASTIKA LABORATORIES LIMITED

P.O. BOX 10, SWASTIKA, ONTARIO P0K 1T0 TELEPHONE: (705) 642-3244

**SOLD TO**

Ethier Sand & Gravel Limited  
2859 Ida St.  
Sudbury, Ontario  
P3E 4W9

**S  
H  
I  
P  
T  
O**

1.5% late charge over 30 days  
(annual rate 18%)

DATE	SHIPPED VIA	FED LICENCE NO	PROV LICENCE NO	YOUR ORDER NO	OUR ORDER NO	TERMS	SALESMAN
Sept. 20/85							
QUANTITY	DESCRIPTION					UNIT PRICE	AMOUNT
5	special Pt Pd					\$ 17.00	\$ 85.00
3	special Pt					8.50	25.50
5	Sn Assays PPM					6.50	32.50
3	As Assays PPM					6.00	18.00
	Cert. No. 60849C Sept. 13/85						
	MINING CLAIM						
	831344						
	<div data-bbox="795 657 1177 1207" data-label="Text"> <p>Rec'd SEP 30 1985</p> <p>Prices .....</p> <p>Ext./Add. <i>u.2</i></p> <p>App'd. <i>one</i></p> <p>Ck. No. <i>119</i></p> <p>Charged to <i>MINING CLAIMS</i></p> <p>Job No. ....</p> </div>						
	Total						\$ 161.00

MOORE BUSINESS FORMS 3 7060E

FACTURE / INVOICE

ANALYTICAL CHEMISTS • ASSAYERS • CONSULTANTS  
ESTABLISHED 1928



SUDBURY  
MINING DIV.  
**RECEIVED**

JAN 29 1985

A.M. 7|8|9|10|11|12|1|2|3|4|5|6 P.M.



11962

# SWASTIKA LABORATORIES LIMITED

P.O. BOX 10, SWASTIKA, ONTARIO P0K 1T0 TELEPHONE: (705) 642-3244

**SOLO TO**

Ethier Sand & Gravel Limited  
2589 Ida Street  
Sudbury, Ontario  
P3E 4W9

**S  
H  
I  
P  
T  
O**

\$ A.M.T.

1.5% late charge over 30 days  
(annual rate 18%)

DATE	SHIPPED VIA	FED LICENCE NO	PROV LICENCE NO	YOUR ORDER NO	OUR ORDER NO	TERMS	SALESMAN
Oct. 11/85							
QUANTITY	DESCRIPTION					UNIT PRICE	AMOUNT
3	Spectrographic analysis Cert. No. 60964B Sept. 26/85					\$ 30.00	\$ 90.00
	Mining Claim # 831344						
	<div data-bbox="665 711 1031 1196" data-label="Text"> <p>Rec'd OCT 31 1985..... Prices ..... Est./Add. <i>119</i>..... App'd. <i>gml</i>..... Job No. <i>119 SK</i>..... Charged to <i>Guan</i>.....</p> </div>						
	Total .....					\$ 90.00	

MOORE BUSINESS FORMS 3 7080E

Job ANALYTICAL CHEMISTS • ASSAYERS • CONSULTANTS

FACTURE / INVOICE

ESTABLISHED 1928



SUDBURY  
MINING DIV.  
**RECEIVED**  
JAN 29 1985  
A.M. 7|8|9|10|11|12|1|2|3|4|5|6 P.M.



12041

# SWASTIKA LABORATORIES LIMITED

P.O. BOX 10, SWASTIKA, ONTARIO P0K 1T0 TELEPHONE: (705) 642-3244

**SOLD TO**

Ethier Sand & Gravel Limited  
2589 Ida St.  
Sudbury, Ontario  
P3E 4V9

**S  
H  
I  
P  
T  
O**

**S A M E**

1.5% late charge over 30 days  
(annual rate 18%)

DATE	SHIPPED VIA	FED LICENCE NO	PROV LICENCE NO	YOUR ORDER NO	OUR ORDER NO	TERMS	SALESPERSON
Oct. 18/85							
QUANTITY	DESCRIPTION				UNIT PRICE	AMOUNT	
8	Au Assays PPB				\$ 8.50	\$ 68.00	
8	Ag Assays PPM				4.20	33.60	
1	Cu Ni Assay PPM				8.40	8.40	
1	Zn Assay PPM				4.20	4.20	
8	Sample handling				2.75	22.00	
	Cert. No. 61306 Oct. 16/85						
	Mining Claim # 831344						
	<div style="border: 1px solid black; padding: 5px;"> <p style="text-align: center;">OCT 31 1985</p> <p>Rec'd .....</p> <p>Ext./Add. <i>Mr</i> .....</p> <p>App'd. <i>[Signature]</i> .....</p> <p>Chk. No. <i>111</i> .....</p> <p>Charged to <i>Quarry</i> .....</p> <p>Job No. ....</p> </div>						
	Total .....				\$	136.20	

MOORE BUSINESS FORMS 3 7360E

ANALYTICAL CHEMISTS • ASSAYERS • CONSULTANTS  
ESTABLISHED 1928

FACTURE / INVOICE



**SUDBURY  
MINING DIV.  
RECEIVED**

JAN 29 1986

A.M. P.M.  
7|8|9|10|11|12|1|2|3|4|5|6



12082

# SWASTIKA LABORATORIES LIMITED

P.O. BOX 10, SWASTIKA, ONTARIO P0K 1T0 TELEPHONE: (705) 642-3244

**SOLD TO**  
Ethier Sand & Gravel  
2589 Ida Street  
Sudbury, Ontario  
P3E 4V9

**S H I P T O**  
S A M L  
1.5% late charge over 30 days  
(annual rate 18%)

DATE	SHIPPED VIA	FED LICENCE NO	PROV LICENCE NO	YOUR ORDER NO	OUR ORDER NO	TERMS	SALESMAN
Oct. 25/85							
QUANTITY	DESCRIPTION					UNIT PRICE	AMOUNT
2	SiO <sub>2</sub> Assays					\$ 18.50	\$ 37.00
2	Sample handling Cert. No. 61398 Oct. 23/85					2.75	5.50
1	Pt. Pd Assay PPM Cert. No. 61306A Oct. 25/85					17.00	17.00
	Mining Claim # 831344						
Total .....						\$	59.50

Rec'd 10 OCT  
 Prices .....  
 Ext./Add. mr  
 App'd. gml  
 Ck. No. 111 E4  
 Charged to Quang  
 Job No. ....

MOORE BUSINESS FORMS 3 7060L

ANALYTICAL CHEMISTS • ASSAYERS • CONSULTANTS ESTABLISHED 1928

FACTURE / INVOICE

SUDBURY  
MINING DIV.  
**RECEIVED**  
JAN 29 1986  
A.M. 7|8|9|10|11|12|1|2|3|4|5|6 P.M.



12208

# SWASTIKA LABORATORIES LIMITED

P.O. BOX 10, SWASTIKA, ONTARIO P0K 1T0 TELEPHONE: (705) 642-3244

**SOLD TO**

Ethier Sand & Gravel Limited  
2589 Ida St.  
Sudbury, Ontario  
P3E 4W9

**S  
H  
I  
P  
T  
O**

**S A M E**  
1.5% late charge over 30 days  
(annual rate 18%)

DATE	SHIPPED VIA	FED LICENCE NO	PROV LICENCE NO	YOUR ORDER NO	OUR ORDER NO	TERMS	SALESMAN
Nov. 8/85							
QUANTITY	DESCRIPTION					UNIT PRICE	AMOUNT
2	Au Assays PPB					\$ 8.50	\$ 17.00
2	Sample handling					2.75	5.50
	Cert. No. 61599 Nov. 7/85						
	Mining Claim # 831344						
<div data-bbox="771 700 1153 1239" data-label="Text"> <p>Rec'd DEC - 2 1985            Prices.....            Ext./Add.....            App'd. <i>and</i>            Sk. No. <i>1118K</i>            Charged to <i>Quarry</i></p> </div>							
						Total .....	\$ 22.50

MOORE BUSINESS FORMS 3 7060E

ANALYTICAL CHEMISTS • ASSAYERS • CONSULTANTS  
ESTABLISHED 1928

FACTURE / INVOICE

SUDBURY  
MINING DIV.  
**RECEIVED**  
JAN 29 1986  
A.M. P.M.  
7|8|9|10|11|12|1|2|3|4|5|6





12266

# SWASTIKA LABORATORIES LIMITED

P.O. BOX 10, SWASTIKA, ONTARIO POK 1T0 TELEPHONE: (705) 642-3244

**SOLD TO**

Ethier Sand & Gravel Limited  
2589 Ida Street  
Sudbury, Ontario  
P3E 4W9

**S  
H  
I  
P  
T  
O**

1.5% late charge over 30 days  
(annual rate 18%)

DATE	SHIPPED VIA	FED LICENCE NO	PROV LICENCE NO	YOUR ORDER NO	OUR ORDER NO	TERMS	SALESMAN
Nov. 25/85							
QUANTITY	DESCRIPTION					UNIT PRICE	AMOUNT
2	SiO <sub>2</sub> Assays Cert. No. 61599-A Nov. 12/85					\$ 18.50	\$ 37.00
7	Au Assays PPB					8.50	59.50
7	Ag Assays PPM					4.20	29.40
1	Cu Pb Ni Assay PPM					12.60	12.60
1	Pt Pd Assay					17.00	17.00
7	Sample handling Cert. No. 61696 Nov. 20/85					2.75	19.25
	Mining Claim # 831344						
Total .....						\$	174.75

Rec'd **DEC 11 1985**  
 Prices .....  
 Ext./Add. *m.r.* .....  
 App'd. *[Signature]* .....  
 Ck. No. *119* .....  
 Charged to *Quam* .....  
 Job No. ....

MOORE BUSINESS FORMS 3 7080E

ANALYTICAL CHEMISTS • ASSAYERS • CONSULTANTS  
ESTABLISHED 1928

FACTURE / INVOICE



SUDBURY  
MINING DIV.  
**RECEIVED**  
JAN 20 1986  
A.M. 7|8|9|10|11|12|1|2|3|4|5|6 P.M.



12366

# SWASTIKA LABORATORIES LIMITED

P.O. BOX 10, SWASTIKA, ONTARIO P0K 1T0 TELEPHONE: (705) 642-3244

**SOLD TO**

Ethier Sand & Gravel Ltd.,  
2489 Ida St.  
Sudbury, Ontario  
P3E 1W9

**S  
H  
I  
P  
T  
O**

**S A M E**

1.5% late charge over 30 days  
(annual rate 18%)

DATE	SHIPPED VIA	FED LICENCE NO	PROV LICENCE NO	YOUR ORDER NO	OUR ORDER NO	TERMS	SALESMAN
Dec.13/85							
QUANTITY	DESCRIPTION					UNIT PRICE	AMOUNT
1	Au Assay PPB					\$ 8.50	\$ 8.50
1	Ag Assay PPM					4.20	4.20
1	Cu Ni Assay					14.50	14.50
1	Sample handling					2.75	2.75
	Cert. No. 61828 Dec.4/85						
2	As Assays FPM					6.00	12.00
	Cert. No. 61696-B Dec.5/85						
1	SiO <sub>2</sub> Assay					18.50	18.50
	Cert. No. 61696A Dec.9/85						
	Bus charges -- X192781						6.55
	Mining Claim # 831344						
	Total						\$67.00

Rec'd DEC 31 1985

Prices .....

Ext./Add. ....

App'd. ....

Ch. No. ....

Charged to... *Quang*

MOORE BUSINESS FORMS 3 7060E

ANALYTICAL CHEMISTS • ASSAYERS • CONSULTANTS

FACTURE / INVOICE

ESTABLISHED 1928



SUDBURY  
MINING DIV.  
**RECEIVED**  
JAN 20 1986  
A.M. 7|8|9|10|11|12|1|2|3|4|5|6 P.M.



12452

# SWASTIKA LABORATORIES LIMITED

P.O. BOX 10, SWASTIKA, ONTARIO P0K 1T0 TELEPHONE: (705) 642-3244

**SOLD TO**

Ethier Sand & Gravel Limited  
2589 Ida St.  
Sudbury, Ontario  
P3E 4W9

**S  
H  
I  
P  
T  
O**

SALE

1.5% late charge over 30 days  
(annual rate 18%)

DATE	SHIPPED VIA	FED LICENCE NO	PROV LICENCE NO	YOUR ORDER NO	OUR ORDER NO	TERMS	SALESMAN
Dec. 23/85							
QUANTITY	DESCRIPTION					UNIT PRICE	AMOUNT
3	SiO <sub>2</sub> Assays					\$ 18.50	\$ 55.50
3	Sample handling Cert. No. 61980 Dec. 19/85					2.75	8.25
	Bus charges -- as per attached						6.20
Total .....							\$ 69.95

MOORE BUSINESS FORMS 3 7060E

ANALYTICAL CHEMISTS • ASSAYERS • CONSULTANTS

FACTURE / INVOICE

ESTABLISHED 1928



SUDBURY  
MINING DIV.  
RECEIVED

JAN 29 1986

A.M. P.M.

7|8|9|10|11|12|1|2|3|4|5|6

*Handwritten note*



2589 IDA ST. PH. 705-522-8340  
SUDBURY, ONT. P3E 4W9

0119  
Oct 25 1985

PAY TO THE ORDER OF

Swastika Laboratories Ltd.

**THE SUM 395 DOLS 70 CTS**

395.70

\$ 395.70

SUM OF

DOLLARS 100

CANADIAN IMPERIAL BANK OF COMMERCE  
CEDAR AND LISGAR  
SUDBURY, ONT.

ETHIER SAND & GRAVEL LIMITED

Per: [Signature]

Per: [Signature]

⑆00692⑈010⑆

34⑈13411⑈

⑈0000039570⑈

### MEMO



**SWASTIKA LABORATORIES LIMITED**

P.O. BOX 10, SWASTIKA, ONTARIO, POK 1T0  
PHONE 705-642-3244

September 9 1985

# 11707	445.45
11784	161.00
11767	89.25

<u>695.70</u>
<u>300.00</u>
<u>395.70</u>

Pd - Oct 25/85

# 119

Dear Mr. Ethier:

Please find attached invoice #11707 in the amount of \$445.45. Your deposit of \$300.00 leaves a balance due of \$145.45.

There is also more invoicing to be done on this group of samples, and also another smaller group of samples.

Thank you

E. Keith

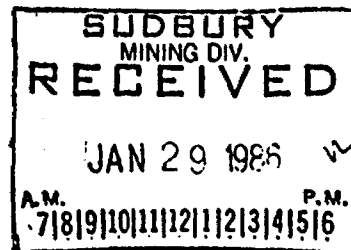

REFERENCE OR INVOICE NUMBER	REFERENCE DATE	REFERENCE AMOUNT	DISCOUNT	NET AMOUNT	VENDOR NUMBER
11962 <i>11962</i>	10/11/85	90.00	<i>90.</i> .00	90.00	<i>90</i>
12041 <i>12041</i>	10/18/85	136.20	<i>136.20</i> .00	136.20	<i>136.20</i>
12082 <i>12082</i>	10/25/85	59.50	<i>59.50</i> .00	59.50	<i>59.50</i>
12208 <i>12208</i>	11/08/85	22.50	<i>22.50</i> .00	22.50	<i>22.50</i>
12266 <i>12266</i>	11/25/85	174.75	<i>174.75</i> .00	174.75	<i>174.75</i>

TOTAL AMOUNT		482.95	.00	482.95	1917
--------------	--	--------	-----	--------	------



2589 IDA STREET  
SUDBURY, ONT. P3E 4W9  
TEL 522-6340

DATE	CHEQUE NO.	AMOUNT
12/23/85	848	\$482.95

*-\$482.95*

PAY EXACTLY \*\*\*\*\* 482 DOLLARS AND 95 CENTS

PAY TO SWASTIKA LABORATORIES LTD  
P.O. BOX 10,  
  
SWASTIKA ONT POK 1T0

ETHIER SAND & GRAVEL LIMITED

AUTHORIZED SIGNING OFFICER  
*[Signature]*  
**NOT NEGOTIABLE**  
*[Signature]*  
AUTHORIZED SIGNING OFFICER

CANADIAN IMPERIAL BANK OF COMMERCE, CEDAR & LISGAR STS., SUDBURY, ONTARIO

SUDBURY.  
MINING DIV.  
**RECEIVED.**  
  
JAN 29 1986 ✓  
A.M. P.M.  
7|8|9|10|11|12|1|2|3|4|5|6



2589 IDA ST. PH. 705-522-6340  
SUDBURY, ONT. P3E 4W9

0495  
Jan 30 1986

PAY TO THE ORDER OF Swastika Laboratories Ltd.

SUM OF THE SUM 136 DOLS 95 CTS \$ 136.95  
DOLLARS 100

RE Invoice # 12366, 12452

CANADIAN IMPERIAL BANK OF COMMERCE  
CEDAR AND LISGAR  
SUDBURY, ONT.

ETHIER SAND & GRAVEL LIMITED

Per: M. Ethier

Per: M. Ethier

⑆00692⑆010⑆

34⑆13411⑆

SUDBURY  
MINING DIV.  
RECEIVED  
JAN 29 1986 ✓  
A.M. P.M.  
7|8|9|10|11|12|1|2|3|4|5|6

Assay Results

1. Au: Nil Ag: Nil - M.E.\*
2. Au: Nil Ag: Nil - M.E.
3. Au: Nil Ag: Nil - M.E.
4. Au: Nil Ag: Nil - M.E.
5. Au: Nil SiO<sub>2</sub>: 87.14% - M.E.
6. Au: Nil SiO<sub>2</sub>: 86.70% - M.E.
7. Au: Nil SiO<sub>2</sub>: 87.06% - M.E.
8. SiO<sub>2</sub>: 83.40%
9. SiO<sub>2</sub>: 74.08%
10. Au: Nil SiO<sub>2</sub>: 82.21%
11. Au: Nil SiO<sub>2</sub>: 76.36%
12. Au: Nil Ag: Nil As: 112 ppm
13. Au: Nil Ag: Nil As: 30 ppm
14. Au: Nil Ag: Nil SiO<sub>2</sub>: 82.30%
15. Au: 93.6 ppm, 91.54 ppm, 106.63 ppm  
 Ag: 13.6 ppm, Cu: 0.59%, Ni: 0.10%  
 As: < 1 ppm, SiO<sub>2</sub>: 74.51% Pt: < 0.05 ppm  
 Pd: < 0.002 ppm

\* M.E. - Multi-Element Analysis

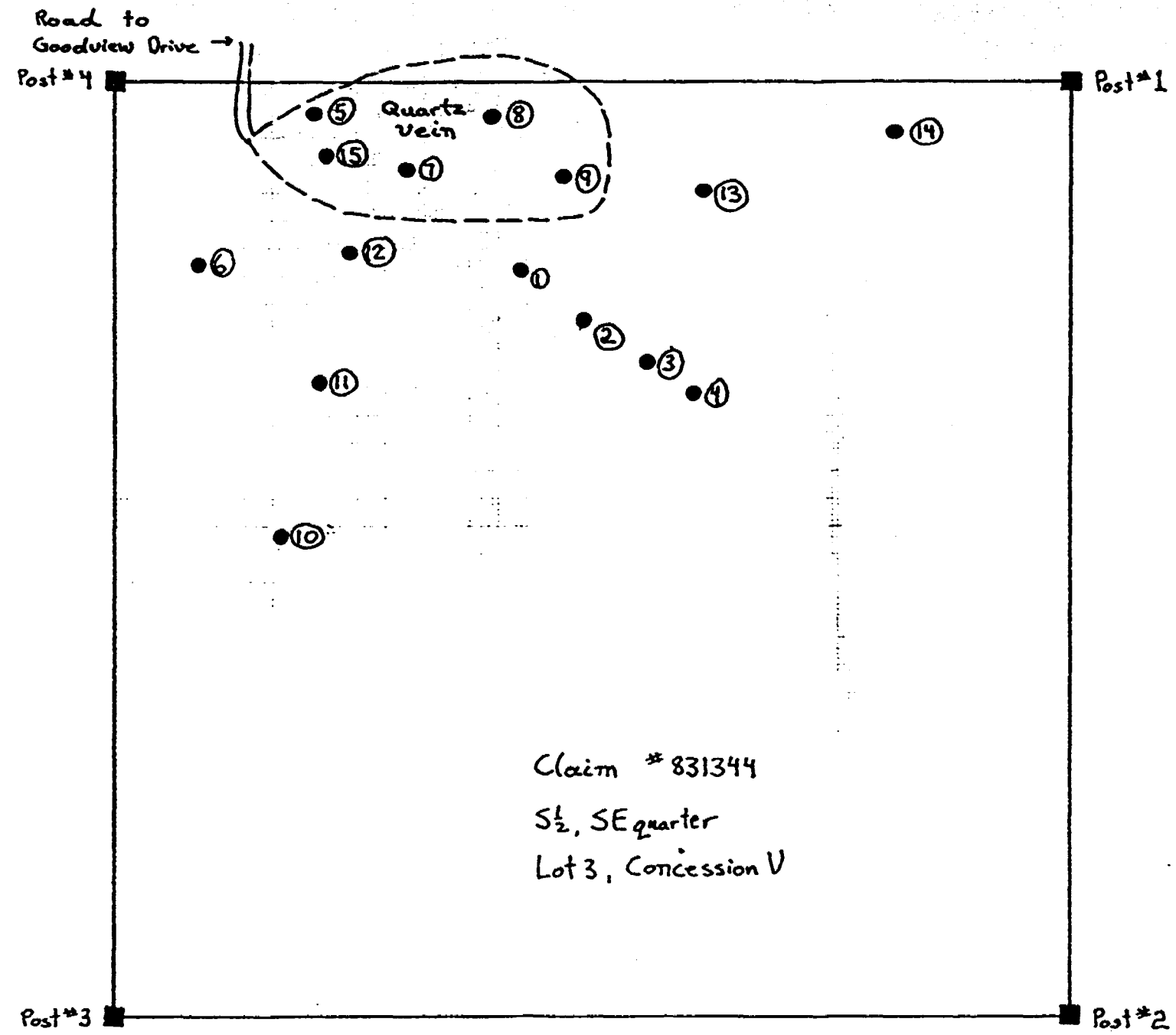

Symbols

● 5	Sample Location
Au.	Gold
Ag.	Silver
As.	Arsenic
SiO <sub>2</sub> .	Silica
Cu	Copper
Ni.	Nickel
Pt.	Platinum
Pd.	Palladium

Marsden Investments Ltd.  
 Claim # 831344 - Broder Twp.  
 Assay Plan  
 1" = 200"  
 February 25, 1986  
 E. Ludwig + Associates



900

McKIM TWP.

# THE TOWNSHIP OF BRODER

DISTRICT of SUDBURY  
SUDBURY MINING  
DIVISION

SCALE: 1 INCH TO 40 CHAINS

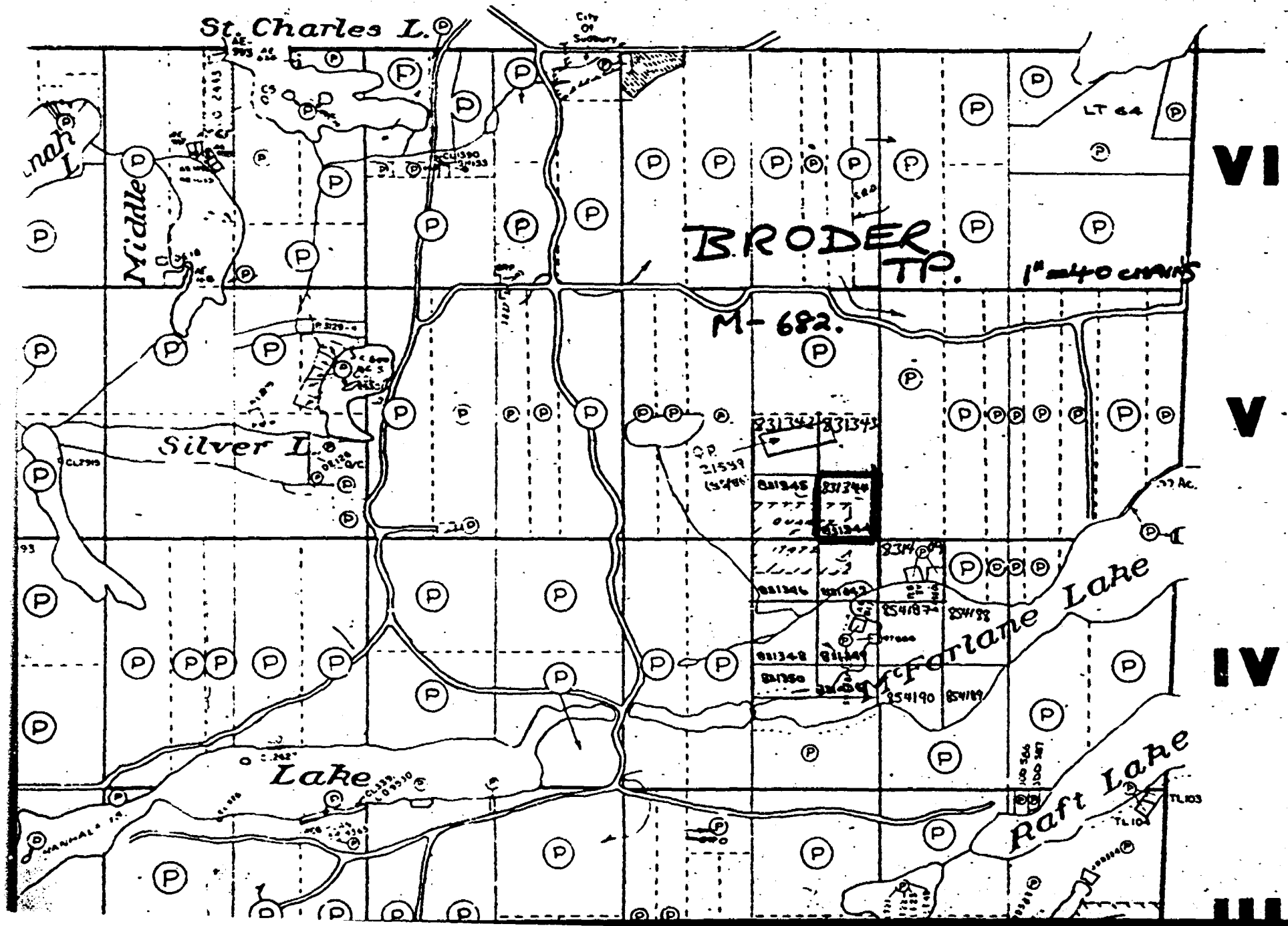

VI

V

IV

2.8863

DILL TWP.

### LEGEND

- PATENTED LAND ..... ● or (P)
- CROWN LAND SALE ..... (S)
- LICENSE OF OCCUPATION ..... L.O.
- LOCATED LAND ..... Loc
- IMPROVED ROAD ..... ==
- ROAD ..... ==
- PATENTED FOR S.R.O. ..... ○

*Jan 31/82  
M/T*

### NOTES

Reserve to the Dept. of National Defence for training site.

FILE 95029 8 145729

400' Surface Rights Reservation around all Lakes and Rivers.

AREA SHOWN THUS: ANNEXED TO THE CITY OF SUDBURY.

Q.P. No 21589 Part of Lot 3 Con. IV 1/4





# 86-6 Broder Twp.  
 Report of Work  
 (Geophysical, Geological,  
 Geochemical and Expenditures)  
 (M. 682)  
 28963  
 Mining Act

File No. 831344

Instructions: - Please type or print  
 - If number of mining claims traversed exceeds space on this form, attach a list.  
 Note: - Only days credits calculated in the "Expenditures" section may be entered in the "Expend. Days Cr." columns.  
 - Do not use shaded areas below.

Type of Survey(s) Assays - Geological Examination Township or Area Broder Twp.  
 Claim Holder(s) Marsden Investments Ltd. Prospector's Licence No. T-1971  
 Address 2589 Ida Street, Sudbury, Ontario P3E 4W9  
 Survey Company E. Ludwig + Associates Date of Survey (from & to) 01 09 85 30 12 85 Total Miles of line Cut  
 Name and Address of Author (of Geo-Technical report) E. Ludwig - RR#2, Red Deer Lake Rd. N. - Wahnapique, Ontario - P0M 3C0

Credits Requested per Each Claim in Columns at right

Special Provisions	Geophysical	Days per Claim
	For first survey: Enter 40 days. (This includes line cutting)  For each additional survey using the same grid: Enter 20 days (for each)	• Electromagnetic • Magnetometer • Radiometric • Other  Geological Geochemical
Man Days	Geophysical	Days per Claim
	Complete reverse side and enter total(s) here	• Electromagnetic • Magnetometer • Radiometric • Other  Geological Geochemical
Airborne Credits	Geophysical	Days per Claim
	Note: Special provisions credits do not apply to Airborne Surveys.	• Electromagnetic • Magnetometer • Radiometric

Mining Claims Traversed (List in numerical sequence)

Prefix	Mining Claim Number	Expend. Days Cr.	Prefix	Mining Claim Number	Expend. Days Cr.
<p>Only * 60 days allowed / claim            Sect. 77(19) Chap 262            of the Mining Act            R.S.O. 1986            J.C.M.B.L.            Mining Recorder</p>					

RECEIVED  
 FEB 04 1986

MINING LANDS SECTION

Expenditures (excludes power stripping)

Type of Work Performed Assaying  
 Performed on Claim(s) #831344

Calculation of Expenditure Days Credits

Total Expenditures	+	Total Days Credits	=	
<u>\$ 1315.60</u>		<u>15</u>		<u>87.7</u>

Instructions  
 Total Days Credits may be apportioned at the claim holder's choice. Enter number of days credits per claim selected in columns at right.

For Office Use Only

Total Days Cr. recorded	Date Recorded	Mining Recorder
<u>60</u>	<u>Jan 31 1986</u>	<u>[Signature]</u>
Date Approved as Recorded	Branch Director	
<u>86.3.11</u>	<u>[Signature]</u>	

Date January 27/86 Recorded (holder or Agent) (Signature) [Signature]

Certification Verifying Report of Work

I hereby certify that I have a personal and intimate knowledge of the facts set forth in the Report of Work annexed hereto, having performed the work or witnessed same during and/or after its completion and the annexed report is true.

Name and Postal Address of Person Certifying E. Ludwig - RR#2 Red Deer Lake Rd. N. Wahnapique, Ont. P0M 3C0

Date Certified January 27/86 Certified by (Signature) [Signature]

February 14, 1986

File: 2.8863

Marslen Investments Ltd  
2589 Ida Street  
Sudbury, Ontario  
P3E 4W9

Dear Sirs:

RE: Data for Assaying submitted  
on Mining Claim S 831344 in  
Bloder Township

---

In order to complete your submission, please provide plans, in duplicate; showing the sample locations and corresponding assay results. The claim lines and posts should be shown.

When returning this material, please quote file 2.8863.

For further information, please contact Dennis Kinvig at (416) 965-4888.

Yours sincerely,

S.E. Yundt, Director  
Land Management Branch

Mining Lands Section  
Whitney Block, 6th Floor  
Queen's Park  
Toronto, Ontario  
M7A 1W3

Telephone: (416) 965-4888

DK/mc

cc: Mining Recorder  
Sudbury, Ontario  
File: 86-6

E. Ludwig & Associates  
R.R.#2  
Red Deer Lake Road North  
Wahnapitae, Ontario  
POH 3C0

E. LUDWIG AND ASSOCIATES  
GEOLOGICAL CONSULTING

S.

RR #2, Red Deer Lake Road North  
Wahnapitae, Ontario  
POM 3C0  
1-705-694-4444

February 25, 1986

RECEIVED

MAR 06 1986

MINING LANDS SECTION

Mr. Dennis Kinvig  
Mining Lands Section  
Whitney Block, 6th Floor  
Queen's Park  
Toronto, Ontario  
M7A 1W3

RE: File: 2.8863

Dear Mr. Kinvig;

As per your request of February 14, 1986, please find enclosed  
the assay plan; in duplicate.

Yours truly

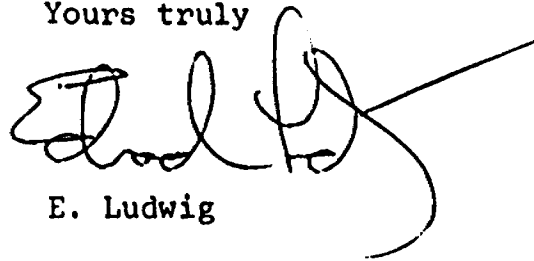

E. Ludwig

BRODER-0012-A1

LOAD: 16 mm

WORK RPT