



42J01NE0019 63 6349 KIPLING

010

MINERAL RESEARCH CANADA Inc.

Mineral Processing Facility
Tel. (705) 378 - 2416
Fax. (705) 378 - 5123

1 Industrial Blvd. R. R. # 2
Parry Sound, Ontario
Canada P2A 2W8

LOCATION AND ACCESS TO PROPERTY

The kaolin/silica project claims are located in the townships of Kipling and Emerson in the area of and comprising the claims historically known as the Douglas property. The claims are on the Mattagami River in the area of the Kipling Hydro dam approximately 100 miles southwest of James Bay in Ontario.

The claims are accessible by driving north on highway 634 from Smooth Rock Falls to Fraserdale (approximately 45.0 miles). Then a private Ontario Hydro road may be taken west for 40 miles to the Smoky Falls dam. A road then continues north for approximately 6 miles to the Kipling dam.

CLAIM NUMBERS

The kaolin/silica property consists of 367 claims (as of Aug. 17, 1993) as well as 8 patented and one leased claim. The claim numbers are P 900001 - P 900100, P1089038 - 1089073, 1089078 - 1809111, 1090037 - 1090044, 1112282 to 1112306, 1112317 - 1112351, 825792 - 825811, 880001 - 880016, 970070 - 970104, 970168 - 970200 & 983551 - 983566.

The claim numbers that this work is to be filed on are P900001 - 900100.

OWNERSHIP

The claims are wholly owned by Great Lakes Kaolin Inc.

PREVIOUS WORK

The property history as compiled by A. Gourley (1989) cites Robert Bell of the GSC as the first person to document the presence to clay and lignite in the James Bay Lowlands on Coal Brook in 1875. Borron (1891) reported extensive deposits of silica and clay on the Missinaibi River. In 1925, a report was produced by H. S. Hancock for McCarthy & Douglas regarding nine claims held on the bank of the Mattagami River and a company was formed (Northern Ontario China Clay Corporation).

In 1934 Minefinders Ltd financed the drilling of 18 holes on the west side of the Mattagami, directly across from the Douglas property, which became known as the General Refractory Products Ltd.

Fifteen holes were drilled in 1959 - 1960 by American Nepheline Ltd. with nine of these being in Kipling township.

The China Clay Syndicate comprised of New Calumet and Crang Securities drilled one hole to a depth of 163.0' north of the Douglas property in 1962. This hole is now known as C-1 after ownership transferal to the Chesterfield Mining & Exploration Co. Ltd.

Exploration in this areas continued in 1970, when Indusmin Ltd. drilled nine holes. The overburden depth in this area was approximately 100.0'.

Six hole were drilled by Geocon Ltd. on the Douglas claims in 1972. These claims were being leased by Brascan and a report was issued by C. Norman Simpson Consultants Ltd.

Ontario Geological Survey from 1975 - 1978 performed a drilling, geophysical, laboratory and field mapping study to determine Mesozoic stratigraphy.

Drilling was again conducted during 1981 by Selco Ltd. after a airborne magnetometer survey was completed. The seven holes were drilled into the anomalous magnetic areas.

Carlson Mines Ltd. optioned the Douglas property in 1985, and drilled five additional holes into the property. At this time a bulk sample was taken from the Douglas on which test work was performed by the Ontario Research Foundation (now Ortech International) and Lakefield Research. Carlson Mines Ltd. failed to complete option payments on the property resulting in forfeiture.

In 1989 the Douglas property was acquired by 798839 Ontario Ltd. (under the management of James Bay Kaolin Corp.), as well adjoining claims were staked to bring the total to 380 claims. An exhaustive drilling program of 168 holes was undertaken in which WRA, XRD, STEM, viscosity, abrasion, particle size distributions were done on core samples. Various separation techniques were developed as well as construction of a pilot plant begun.

In 1990 James Bay Kaolin Corporation was relieved of its managerial duties due to an improper rendering of accounts. The testing work continued, a 13 000 tonne bulk sample extracted and a 15 hole drilling program was completed in 1992 under the name of Mineral Research Canada Inc. for its associated company Great Lakes Kaolin Inc.. Mineral Research Canada Inc. currently operates a small scale pilot producing kaolin materials in Parry Sound and continues with the testing work.

5.0 PRICING

RE: OUR QUOTATION NUMBER 930101T

CHEMEX CODE	DESCRIPTION	MINERAL RESEARCH CANADA INC. PRICE PER SAMPLE
226/208	Crush/split (up to 5 lbs material) Ring, pulverize to -150 mesh (>90%) (200-250 gram material)	\$ 3.51
217	Dry and pulverize the sample (up to 200 gram material) to -150 mesh (>90%)	\$1.76
214/225	Handling charge for pulps not prepared in house	NO CHARGE
A12	Majors only - whole rock package includes major oxides as well as loss on ignition	\$18.00

Please include our reference number 930101T on all sample shipments related to this project.

PREPARED FOR MINERALS RESEARCH CANADA INC.

JANUARY 6, 1993

Yours truly,



Adriana Alexanru
Analytical Lab Manager

AA/tmn

MINERAL RESEARCH CANADA INC.
1 INDUSTRIAL BLVD., R.R. 2 FOLEY
PARRY SOUND, ONTARIO P2A 2W8

ROYAL BANK OF CANADA
MAIN BRANCH
32 DUKE STREET WEST
KITCHENER, ONTARIO N2H 6L7

CHEQUE 814

PAY TO THE ORDER OF **3,222.20**

DATE July 22, 1993 AMOUNT \$3,222.20

Chemex Labs Ltd.
212 Brooksbank Avenue
North Vancouver, B.C.
V7J 2C1

MINERAL RESEARCH CANADA INC.
PER 
AUTHORIZED SIGNATURE

⑆02482003⑆ 1182237⑆ ⑆000032220⑆

Handwritten scribbles at the bottom of the page.

J R DRILLING LTD.

Hadashville, Manitoba ROE OXO

Phone (204) 426-5597

Fax (204) 426-5458 (Manual)

Invoice No. 92-101-1

March 6th, 1992

Sold To: Mineral Research Canada Inc.
 1 Industrial Blvd. RR 2
 Parry Sound, Ontario P2A 2W8

Atten:

Contract: Rotasonic Drilling Program in N.E. Ont. Kipling Township
 Purchase Order No. 0038

J R Drilling Contract No. 92-101

DRILLING SERVICES SUPPLIED From February 21, 1992 to March 5, 1992
 (inclusive)

Mobilization and Demobilization		\$ 8,000.00
Moving and Standby hours: 101 hours @ \$200.00 per hour		\$ 20,200.00
Footage drilled 1,978 feet @ \$30.00 per foot		\$ 59,340.00
Travel time: 174.5 man hours @ \$30.00 per man hour		\$ 5,235.00
	Subtotal	\$ 92,775.00
	G.S.T. # 102727286	\$ 6,494.25
	Total Due	\$ 99,269.25
LESS ADVANCE DEPOSITS on	Feb. 19/92	(\$ 8,000.00)✓
	Feb. 21/92	(\$ 60,000.00)✓
	Feb. 28/92	(\$ 60,000.00)✓
BALANCE OF ADVANCE DEPOSIT		(\$ 28,730.75)

J R DRILLING LTD.

Hadashville, Manitoba R0E 0X0

Phone (204) 426-5597

Fax (204) 426-5458 (Manual)

Invoice No. 92-101-2

March 13th, 1992

Sold To: Mineral Research Canada Inc.
1 Industrial Blvd. RR 2
Parry Sound, Ontario P2A 2W8

Atten: Marcus Martin

Contract: Rotasonic Drilling Program in N.E. Ont. Kipling Township
Purchase Order No. 0038

J R Drilling Contract No. 92-101

DRILLING SERVICES SUPPLIED From March 6th, 1992 to March 12th, 1992
(inclusive)

Moving and Standby hours:

56 hours @ \$200.00 per hour \$ 11,200.00

Footage drilled 1,250 feet @ \$30.00 per foot \$ 37,500.00

Travel time:

59 man hours @ \$30.00 per man hour \$ 1,770.00

Subtotal \$ 50,470.00

G.S.T. # 102727286 \$ 3,532.90

Total Due \$ 54,002.90

LESS ADVANCE DEPOSITS

Carried forward from Invoice # 92-101-1 (\$ 28,730.75)

BALANCE DUE IMMEDIATELY BY BANK TRANSFER \$ 25,272.15
AS PER AGREEMENT

Hadashville, Manitoba ROE OXO

Phone (204) 426-5597

Fax (204) 426-5458 (Manual)

Invoice No. 92-101-3

March 16th, 1992

Sold To: Mineral Research Canada Inc.
1 Industrial Blvd. RR 2
Parry Sound, Ontario P2A 2W8

Atten: Marcus Martin

Contract: Rotasonic Drilling Program in N.E. Ont. Kipling Township
Purchase Order No. 0038

J R Drilling Contract No. 92-101

DRILLING SERVICES SUPPLIED From March 13th, 1992 to March 15th, 1992
(inclusive)

Moving and Standby hours: 22 hours @ \$200.00 per hour	\$ 4,400.00
Footage drilled 500 feet @ \$30.00 per foot	\$ 15,000.00
Travel time: 34.5 man hours @ \$30.00 per man hour	\$ 1,035.00
	<hr/>
Subtotal	\$ 20,435.00
G.S.T. # 102727286	\$ 1,430.45
	<hr/>
Total Due	\$ 21,865.45

Carried forward from Invoice # 92-101-2 \$ 25,272.15

BALANCE DUE IMMEDIATELY BY BANK TRANSFER
AS PER AGREEMENT

MAR 24 1992
MDM

REC'D	\$ 47,137.60
CHKG	

JR DRILLING LTD.

FOOTAGE STATEMENT

Customer ALH 292 R. J. ...

Location _____ Contract No. 12-121

Province/State _____ Period March 1977

HOLE NUMBER	HOLE SIZE	FOOTAGE / METRES			REMARKS	OTHER			
		START OF MONTH	END OF MONTH	FOOTAGE / METRES		MACHINE NUMBER	DISTANCE OF HOLE FROM CAMP	MOVING DIST BETWEEN HOLES	WATERLINE DISTANCE
30	6"	0	250	250					
29	6"	0	250	250					
29	6"	0	250	250					
28	6"	0	250	250					
27	6"	0	250	250					
26	6"	0	250	250					
3	6"	0	250	250					
TOTAL FOOTAGE				1750					

REMARKS: _____

WE THE UNDERSIGNED CERTIFY THIS TO BE CORRECT





CUSTOMER SIGNATURE

DATE

JR DRILLING LTD.

JR DRILLING LTD.

FOOTAGE STATEMENT

Customer MINERAL RESEARCH CANADA

Location KIPLING TOWNSHIP

Contract No. 92-101

Province/State ONT.

Period FEB 22 - MARCH 5, 1992

HOLE NUMBER	HOLE SIZE	FOOTAGE / METRES			REMARKS	OTHER			
		START OF MONTH	END OF MONTH	FOOTAGE / METRES		MACHINE NUMBER	DISTANCE OF HOLE FROM CAMP	MOVING DIST. BETWEEN HOLES	WATERLINE DISTANCE
7	6"	0	248	248					
8	6"	0	250	250					
10	6"	0	240	240					
13	6"	0	250	250					
15	6"	0	240	240					
14	6"	0	250	250					
17	6"	0	250	250					
11	6"	0	250	250					

TOTAL FOOTAGE 1978

REMARKS: _____

WE THE UNDERSIGNED CERTIFY THIS TO BE CORRECT

[Signature] CUSTOMER SIGNATURE March 2, 1992 DATE [Signature] JR DRILLING LTD.



THE ROYAL BANK OF CANADA

32 DUKE STREET WEST
KITCHENER ONT

FEB 28 1992

CA	FEA	SA	ACCOUNT NUMBER	DATE OF DEPOSIT	AMT OF DEPOSIT	<input type="checkbox"/> ERROR BANKING TOTAL FORWARD	<input type="checkbox"/> CHEQUE MISSING
			1118-1223-715		\$	<input type="checkbox"/> LISTED AS	<input type="checkbox"/> CORRECT
				<input type="checkbox"/> ERROR SUPPLY AGENT	<input type="checkbox"/> U.S. LISTED AS CANADIAN AS U.S.	\$	\$

PARTICULARS	AMOUNT	ADJUSTMENT
Wire transfer TO J.R. Drilling	60,000	-

Mineral Research

DEBIT

MADE UP BY	TOTAL OF PAGES ATTACHED		
\$	SUB-TOTAL		
CHECKED BY	PLUS CHARGES	30	-
U	TOTAL	60,030	-

⑆02482⑆003⑆ 118⑆223⑆715 15 ⑆0006003000⑆

SONIC DRILL HOLE RECORD

Drilling Started: Mar. 2, 1992
 Drilling Finished: Mar. 3, 1992
 Drilling Co.: J. R. Drilling
 Dip: -90°
 Hole Length: 250.0'
 Overburden Depth: 39.0'
 Claim No. P 825806
 Easting: 5640 E
 Northing: 520 N
 Azimuth: 50° 09' 00" W. 82° 08' 48" N.
 Location: 1000.0' at 242° To Claim Post No. 1
 Property: Kipling

Logged By: A. Casselman
 Logged: Mar. 3, 1992
 Core Size: 3.5"
 Core Storage:
 Mineral Research Canada
 R. R. # 2
 Parry Sound, ON
 P2A 2W8
 Hole No.: 92-14

SUMMARY FIELD LOG ONLY

From	To	Description
0.0'	10.0'	Recent Fluvial Sediments
10.0'	39.0'	Glacial Clay Till Overburden - Pleistocene
39.0'	62.0'	Kaolin Silica Sand (Kss) Cretaceous
62.0'	77.25'	Clay
77.25'	93.0'	Sandy Clay
93.0'	124.0'	Kss
124.0'	136.0'	Clay
136.0'	149.5'	Kss
149.5'	151.5'	Clay
151.5'	154.0'	Kss
154.0'	164.0'	Sandy Clay
164.0'	178.5'	Kss
178.5'	183.0'	Sandy Clay
183.0'	208.0'	Kss
208.0'	237.0'	Clay
237.0'	250.0'	Sandy Clay

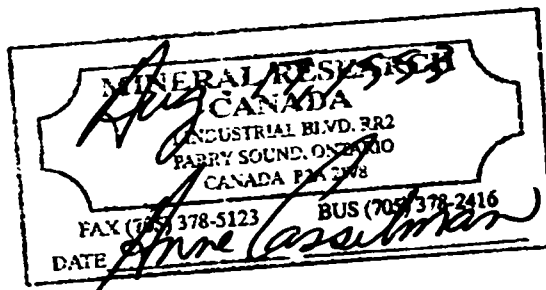

EOH - 250.0'

Detail Log - 92-14

From	To	Sample No.	Description
0.0'	10.0'		Recent Fluvial Sediments - very fine grain silty sediment with minor amounts of clay, medium brown.
10.0'	37.0'		Glacial Clay Till - dark green, frequent gneissic and carbonate clasts, calcareous, competent, fissile.
37.0'	41.0'		Kss - highly calcareous, dark green, medium grain, unsampled due to amount of contamination.
41.0'	45.0'	16901	Kss - as above, slightly calcareous, light brown, minor illite and heavies, Devonian, medium to dark buff, pitted, no fossils, angular siltstone.
45.0'	49.0'	16902	Kss - as above, white, two garnetiferous hematitic siliceous conglomerates at 46.0', drill cut, prolate, 90° to core, rusty staining.
49.0'	53.0'	16903	Kss - as above.
53.0'	57.0'	16904	Kss - as above, at 56.0' - 4.0" of sandy clay, clay and kss interbedded, medium brown, pliable, illitic, then coarse grain vari-coloured silica.
57.0'	62.0'	16905	Kss - coarse grain, vari-coloured silica, minor illite and heavies, much exterior yellow/brown contamination.
62.0'	67.75'	16906	Clay - competent, drill core gouging, weakly fissile, yellow, some grey mottling, becoming predominantly grey with some yellow mottling.
67.75'	72.0'	16907	Clay - chocolate brown, lightening downsection and becoming silty and illitic in areas, weakly pliable, competent, more competent downsection.
72.0'	77.25'	16908	Clay - grey sandy clay (high clay content) grading into and becoming mottled with yellow/green and red clay, weakly pliable, competent.
77.25'	81.0'	16909	Sandy Clay - chocolate brown, lightening downsection to buff,

illitic, silty grading to and becoming fine grain weakly pliable to pliable sandy clay, some purple.

81.0'	85.0'	16910	Sandy Clay - as above, grey.
85.0'	89.0'	16911	Sandy Clay - as above.
89.0'	93.0'	16912	Sandy Clay - as above, less clay-rich.
93.0'	97.0'	16913	Kss - white, fine grain, minor heavies and illite, some purple and yellow areas.
97.0'	102.0'	16914	Kss - as above.
102.0'	107.0'	16915	Kss - medium grain, white, minor illite and heavies.
107.0'	111.0'	16916	Kss - as above, centrally finer grain.
111.0'	115.0'	16917	Kss - as above, area containing coarser clasts and red powdery areas, fine grain.
115.0'	119.0'	16918	Kss - as above, becoming coarse grain in a medium grain matrix, light brown, vari-coloured silica, minor illite and heavies.
119.0'	124.0'	16919	Kss - as above, coarse grain in a medium grain matrix, drill core gouging, last 1.0' sulphureous smell, with chocolate brown and yellow exterior contamination.
124.0'	128.0'	16920	Clay & Sandy Clay - alternating, chocolate brown, competent, disc-like, fissile, single large highly competent piece of lignite at upper contact, illitic, drill core gouging.
128.0'	134.0'	16921	Clay - as above, no sandy clay.
134.0'	136.0'	16922	Clay - as above, silty, pliable, illitic, lightening downsection, last 0.75', medium brown, sandy clay, extremely pliable, yellow areas.
136.0'	143.0'	16923	Kss - medium brown, medium grain, yellow and chocolate brown contamination, becoming coarse vari-coloured silica in a medium grain matrix, light brown, medium grain to fine grain clay-rich, near sandy clay, minor illite and heavies.
143.0'	149.5'	16924	Kss - fine grain, light brown, as above, 143.0' - 148.5', coarse grain, vari-

coloured silica in a white clay matrix.

149.5'	151.5'	16925	Clay - medium brown, highly competent, weakly fissile, lighter and darker discontinuous laminations.
151.5'	154.0'	16926	Kss - medium grain, slightly coarser downsection, light brown, minor illite and heavies.
154.0'	159.0'	16927	Sandy Clay - competent, buff, illitic, some purple areas, pliable, large muscovite flakes.
159.0'	164.0'	16928	Sandy Clay - as above.
164.0'	171.0'	16929	Kss - medium grain, white, minor illite and heavies, some sandy clay clotting especially at 170.75'.
171.0'	178.5'	16930	Kss - as above, becoming clay-rich downsection, light brown, slightly calcareous.
178.5'	183.0'	16931	Sandy Clay - as previous, drill core gouging.
183.0'	189.0'	16932	Kss - as above, slightly brown, minor illite and heavies.
189.0'	193.0'	16933	Kss - as above, slightly brown, heavies banding in the form of garnet.
193.0'	198.0'	16934	Kss - coarse grain, vari-coloured silica in a medium grain matrix becoming medium grain, white, minor illite and heavies.
198.0'	202.0'	16935	Kss - medium grain, white, minor illite and heavies, much exterior chocolate contamination on 200.0' - 202.0', large number of very large angular smoky quartz, chocolate brown, and yellow areas, sulphureous smell, one area of carbonaceous material.
202.0'	206.0'	16936	Kss - chocolate brown as above, 204.5' - 206.0' - extremely coarse grain in a medium brown clay matrix, some lighter buff areas.
206.0'	208.0'	16937	Kss - medium grain, chocolate brown, some yellow areas, sulphureous smell, large, lignitic fragments, one pyritic cementing of silica grains to form a clast at lower contact.

208.0'	211.0'	16938	Clay - black, fissile, disc-like, becoming chocolate brown, carbonaceous, sulphureous smell, silty and illitic in areas.
211.0'	215.0'	16939	Clay - chocolate brown, some lighter and darker laminations, weakly pliable, competent, 4.0" of lignite (one solid piece) at 213.0', darker before lignite.
215.0'	220.0'	16940	Clay - as above, carbonaceous.
220.0'	223.0'	16941	Clay - as above, pliable.
223.0'	226.0'	16942	Clay - silty, chocolate brown with buff areas and laminations - silty and illitic red & yellow laminations - hematite, fissile, much material crumbled.
226.0'	228.0'	16943	Clay - as above.
228.0'	232.0'	16944	Clay - as above.
232.0'	235.0'	16945	Clay - as above, highly competent.
235.0'	237.0'	16946	Clay - as above, chocolate brown, highly competent, carbonaceous.
237.0'	239.0'	16947	Sandy Clay - medium brown, competent, drill core gouging, fine grain, illitic.
239.0'	243.0'	16948	Sandy Clay - pliable, competent, illitic, fine grain, medium brown, some yellow and red hematitic areas.
243.0'	246.0'	16949	Sandy Clay - as above.
246.0'	250.0'	16950	Sandy Clay - as above, 248.0' - 250.0' - crumbly.

EOH - 250.0'

Section 92-14

Claim No.: P 825806

Hole Length: 250.0'

Overburden Depth: 39.0'

Astronomic Azimuth: $50^{\circ} 09' 00''$ W. $82^{\circ} 08' 48''$ N

Location: 1000.0' at 242° to claim post no. 1

Scale: 1.0" = 50.0'

Northing: 520 N

Easting: 5640 E

Dip: -90°

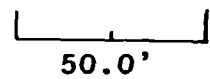

Gridline 5700

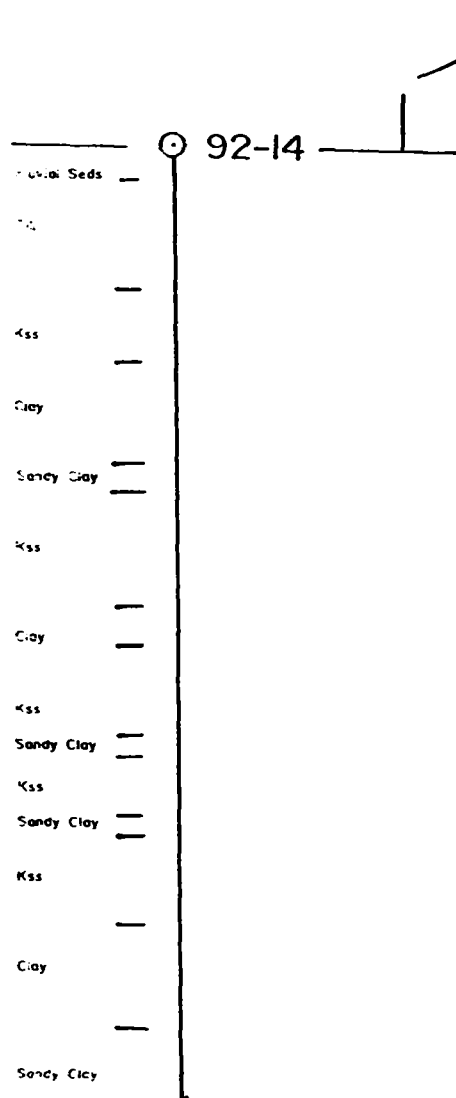

SONIC DRILL HOLE RECORD

Drilling Started: Mar. 11, 1992
 Drilling Finished: Mar. 12, 1992
 Drilling Co.: J. R. Drilling
 Dip: -90°
 Hole Length: 250.0'
 Overburden Depth: 53.0'
 Claim No.: P900048
 Easting: 3450 E
 Northing: 1050 N
 Azimuth: 50° 08' 59" W. 82° 10' 15" N.
 Location: 1950.0' at 242° To Claim Post No. 1
 Property: Kipling

Logged By: A. Casselman
 Logged: Jan. 14, 1993
 Core Size: 3.5"
 Core Storage:
 Mineral Research Canada
 R. R. # 2
 Parry Sound, ON
 P2A 2W8
 Hole No.: 92-27

SUMMARY

From	To	Description
0.0'	45.0'	Glacial Clay Till
45.0'	79.0'	Sand Overburden - Pleistocene
79.0'	89.0'	Kaolin Silica Sand (Kss) Cretaceous
89.0'	93.0'	Clay
93.0'	97.0'	Clay & Sandy Clay - alternating
97.0'	140.0'	Clay
140.0'	146.0'	Kss
146.0'	148.0'	Clay
148.0'	153.0'	Kss & Sandy Clay - alternating
153.0'	172.25'	Kss
172.75'	177.0'	Sandy Clay
177.0'	182.0'	Kss & Sandy Clay
182.0'	243.25'	Kss
243.25'	250.0'	Clay

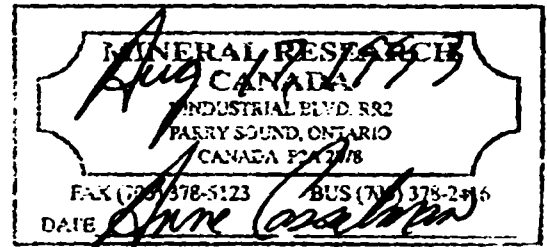

EOH - 250.0'

Pallet containing hole fell off truck - many boxes split & damaged.
 "Earl's Corner" - peat may have been scraped off long ago - old road way.

Detail Log - 92-27

From	To	Sample No.	Description
0.0'	45.0'		Glacial Clay Till - dark green/brown, competent, calcareous, frequent carbonate and gneissic clasts.
45.0'	79.0'		Sand - true sand, medium grain, dark green due to minor clay content, primarily silica, some feldspar, biotite etc.
79.0'	89.0'		Contact - kss - medium grain, predominantly silica, some feldspar, normal granitic material, rare larger Precambrian clast, non-calcareous, medium grain, much biotite and chlorite.
89.0'	93.0'	16251	Clay - red & grey mottled, competent, weakly pliable, much exterior kss coating due to drilling action, almost entirely grey downsection, some yellow and purple, 77.44% kaolin.
93.0'	97.0'	16252	Clay & Sandy Clay - light grey, some minor red mottling, alternating clay and sandy clay, competent, fissile, exterior red and kss coating, red/brown mottling last 1.0', 59.09% kaolin.
97.0'	100.0'	16253	Clay - medium red/brown, pliable, highly mangled, appears slightly carbonaceous, last 1.0', more silty, chocolate brown, 67.97% kaolin.
100.0'	103.0'	16254	Clay - chocolate brown, as above, first 0.5" dried due to air exposure, fissile, carbonaceous, 57.14% kaolin.
103.0'	106.0'	16255	Clay - as above, 67.85% kaolin.
106.0'	109.0'	16256	Clay - as above, highly carbonaceous, fissile at 108.0' - 109.0', remainder highly pliable, 67.82% kaolin.
109.0'	112.0'	16257	Clay - as above, at 111.0' clay containing rusty aggregates with hematite and pyrite, less carbonaceous and more pliable after 111.0', 56.53% kaolin.

112.0'	116.0'	16258	Clay - chocolate brown, carbonaceous, pliable, grading to grey with minor red and yellow mottling at 115.5', some silty and highly illitic sections, 63.49% kaolin.
116.0'	120.0'	16259	Clay - medium brown, some yellow mottling, competent, weakly pliable, carbonaceous, area of rusty silica, last 1.0' medium grey, 69.19% kaolin.
120.0'	124.0'	16260	Clay - chocolate brown, carbonaceous, competent, pliable, last 1.0' orange and yellow mottling, 75.29% kaolin.
124.0'	128.0'	16261	Clay - as above, first 1.0' yellow and red mottling, drill core gouging, 71.62% kaolin.
128.0'	132.0'	16262	Clay - as above, increasing carbonaceous content, fissility and darkening downsection, illitic with rusty staining, a 3.0" section of light grey at 131.0', 62.25% kaolin.
132.0'	136.0'	16263	Clay - chocolate brown, carbonaceous, competent, weakly pliable, 54.03% kaolin.
136.0'	140.0'	16264	Clay - as above, dried, 54.76% kaolin.
140.0'	144.0'	16265	Kss - white, alternating fine, medium and coarse grain, vari-coloured silica, low clay content, heavies banding, minor illite, yellow crust-like deposit on core exterior, 5.87% kaolin.
144.0'	146.0'	16266	Kss - buff, coarse grain vari-coloured silica, some medium grain matrix, some clay clotting, highly competent, minor illite and heavies, 12.76% kaolin.
146.0'	148.0'	16267	Clay - highly competent, light yellow/brown, finely laminated, weakly fissile, 55.92% kaolin.
148.0'	153.0'	16268	Kss & Sandy Clay - alternating, sandy clay - from 148.0' - 150.5' & 151.5' - 153.0' - light buff, pliable, illitic, kss - medium grain, buff, minor illite and heavies, 19.85% kaolin.
153.0'	157.0'	16269	Kss - medium grain, white, rare larger vari-coloured silica, minor illite and heavies, some minor clay mottling from 153.0' - 154.0', 5.75% kaolin.

157.0'	161.0'	16270	Kss - as above, no mottling, 7.72% kaolin.
161.0'	165.0'	16271	Kss - as above, 6.46% kaolin.
165.0'	167.0'	16272	Kss - light grey, medium grain, minor illite and heavies as banding, 6.03% kaolin.
167.0'	172.25'	16273	Kss - light buff, medium grain, minor illite and heavies, heavies as banding, one emerald green lamination of 2.0" at 167.75', first 0.5' containing rare larger smoky quartz, purple at lower contact, 7.11% kaolin.
172.25'	177.0'	16274	Sandy Clay - buff, competent, pliable, some purple clotting, finer and more clay-rich than normal, minor illite, 39.32% kaolin.
177.0'	182.0'	16275	Sandy Clay & Kss - sandy clay - as above, with fine grain kss, 179.0' - 181.0' - dark to medium grey, high illite and heavies content, some purple clotting, 17.54% kaolin.
182.0'	187.0'	16276	Kss - fine grain, light grey, minor illite and heavies, clay enriched section areas, 13.62% kaolin.
187.0'	191.0'	16277	Kss - as above, dried, 6.48% kaolin.
191.0'	196.0'	16278	Kss - medium grain, white, minor illite and heavies, 5.29% kaolin.
196.0'	201.0'	16279	Kss - as above, low clay content, drilling debris & rust staining, 1.90% kaolin.
201.0'	206.0'	16280	Kss - as above, dried, 5.11% kaolin.
206.0'	211.0'	16281	Kss - as above, moist, 7.59% kaolin.
211.0'	215.0'	16282	Kss - as above, some finer sections, 6.81% kaolin.
215.0'	219.0'	16283	Kss - as above, predominantly fine grain, 6.34% kaolin.
219.0'	223.0'	16284	Kss - fine grain, white, minor illite and heavies, partially dried, 6.68% kaolin.
223.0'	227.0'	16285	Kss - medium grain, as above, 5.14% kaolin.
227.0'	229.0'	16286	Kss - medium grain, rusty staining, clay-poor, drilling debris, minor heavies and illite, 4.48% kaolin.

229.0'	234.0'	16287	Kss - medium grain, white, dried, minor illite and heavies, 6.33% kaolin.
234.0'	239.0'	16288	Kss - as above, 8.71% kaolin.
239.0'	243.25'	16289	Kss - nearly sandy clay, first 1.0' and last 0.25', pliable, buff, kss - fine grain, minor illite and heavies, some purple in near sandy clay, 14.13% kaolin.
243.25'	250.0'	16290	Clay - medium brown, greasy, competent, fissile, highly moulded, 79.90% kaolin.

EOH - 250.0'

Section 92-27

Claim No.: P 900048

Hole Length: 250.0'

Overburden Depth: 53.0'

Astronomic Azimuth: $50^{\circ} 08' 59''$ W. $82^{\circ} 10' 15''$ N

Location: 1950.0' at 242° to claim no. 1

Scale: 1.0" = 50.0' or 1:600

Northing: 1050 N

Easting: 3450 E

Dip: -90°

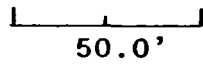

Gridline 3500

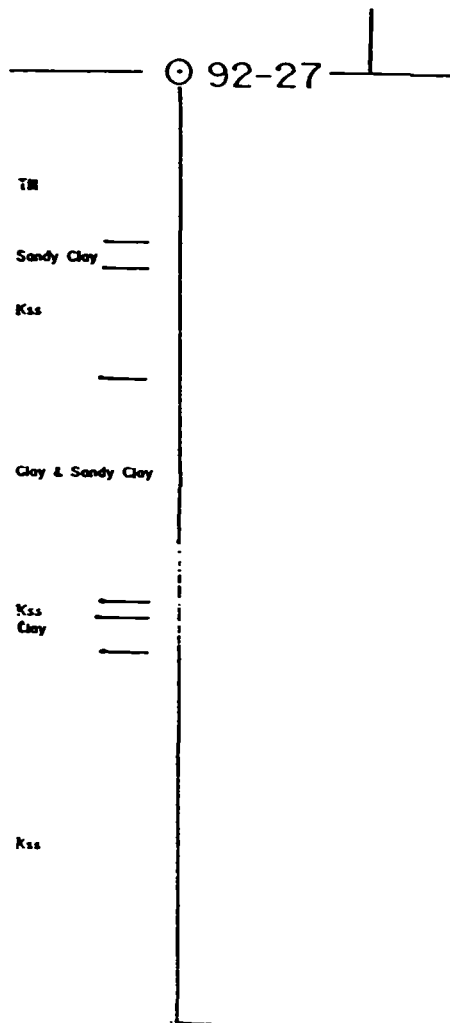

Section 92-27

Claim No.: P 900048

Hole Length: 250.0'

Overburden Depth: 53.0'

Astronomic Azimuth: 50° 08' 59" W. 82° 10' 15" N

Location: 1950.0' at 242° to claim no. 1

Scale: 1.0" = 50.0' or 1:600

Northing: 1050 N

Easting: 3450 E

Dip: -90°

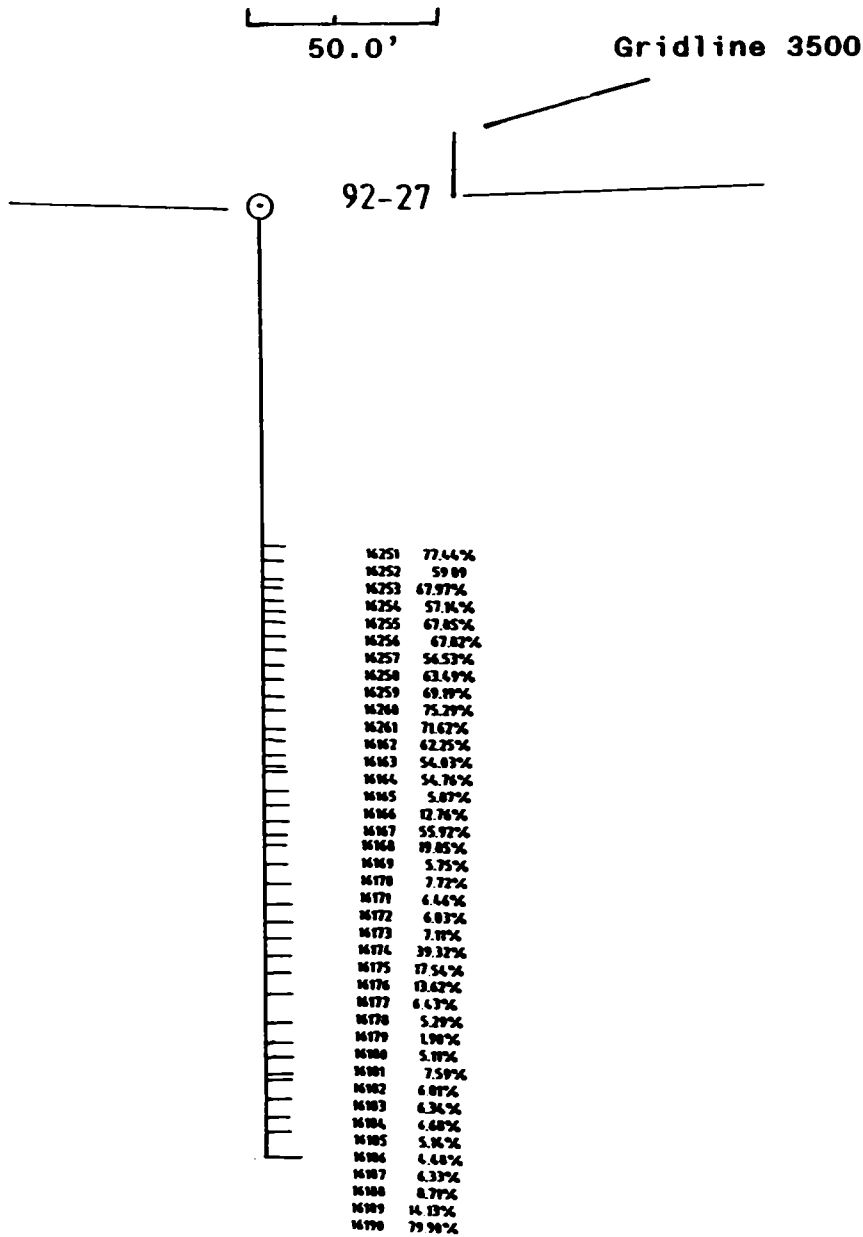

SONIC DRILL HOLE RECORD

Drilling Started: Mar. 10, 1992
 Drilling Finished: Mar. 11, 1992
 Drilling Co.: J. R. Drilling
 Dip: -90°
 Hole Length: 255.0'
 Overburden Depth: 79.0'
 Claim No.: P900045
 Easting: 3605 E
 Northing: BL00
 Azimuth: 50° 08' 56" W. 82° 10' 21" N.
 Location: 1060.0' at 183° To Claim Post No. 1
 Property: Kipling

Logged By: A. Casselman
 Logged: Dec. 22, 1992
 Core Size: 3.5"
 Core Storage:
 Mineral Research Canada
 R. R. # 2
 Parry Sound, ON
 P2A 2WB
 Hole No.: 92-28

SUMMARY

From	To	Description
0.0'	79.0'	Glacial Clay Till
79.0'	83.0'	Sand Overburden - Pleistocene
79.0'	97.0'	Kaolin Silica Sand (Kss) Cretaceous
97.0'	107.0'	Clay & Kss
107.0'	112.0'	Kss
112.0'	117.0'	Clay & Kss
117.0'	180.0'	Kss
180.0'	183.0'	Sandy Clay
183.0'	255.0'	Kss

EOH - 255.0'

N.B. - Peat partially removed.

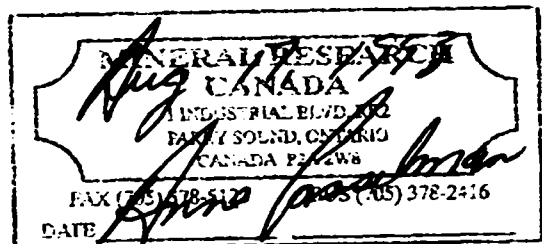

Detail Log - 92-28

From	To	Sample No.	Description
0.0'	79.0'		Glacial Clay Till - competent, calcareous, dark green, rare carbonate and gneissic clast.
79.0'	83.0'		Sand - (true) medium grain, frequent coarse clasts, some dark green/brown clay, slightly calcareous, predominantly silica and chert.
83.0'	87.0'	16201	Kss - light brown, crumbly, dried, bag open, much sample contamination, 5.59% kaolin.
87.0'	92.0'	16202	Kss - buff, lightening downsection, medium grain with clay mottling, grading to coarse grain at 90.0', then becoming medium grain, vari-coloured silica, 7.82% kaolin.
92.0'	97.0'	16203	Kss - buff, lightening downsection, medium grain matrix, vari-coloured silica, 10.99% kaolin.
97.0'	102.0'	16204	Kss & Clay - 97.0' - 99.0' - kss - as above, then chocolate brown clay, fissile to weakly pliable some kss interbedding, 43.72% kaolin.
102.0'	107.0'	16205	Kss & Clay - 102.0' - 103.5' - kss - medium grain, light brown, some clay mottling, clay - 103.5' - 105.0' - pliable, light, medium and chocolate brown alternating laminations, 105.0' - 107.0' - kss - as previous, 24.46% kaolin.
107.0'	112.0'	16207	Kss - white, medium grain, coarsening downsection to coarse, vari-coloured silica, minor heavies and illite, 8.03% kaolin.
112.0'	117.0'	16209	Kss & Clay - medium brown/yellow, medium grain kss - 112.0' - 113.0', 113.0' - 114.0' - clay - medium and light brown, discontinuous laminations, 114.0' - 117.0' - coarse grain kss in a medium grain matrix, vari-coloured silica, minor heavies and illite, 15.32% kaolin.
117.0'	122.0'	16211	Kss - white, medium grain, fining

			downsection to fine grain, minor illite and heavies, 8.51% kaolin.
122.0'	127.0'	16213	Kss - medium grain, coarsening downsection to coarse, white, minor illite and heavies, 5.62% kaolin.
127.0'	128.0'	16214	Kss - medium grain, with frequent coarse clasts, vari-coloured silica, minor illite and heavies, 6.00% kaolin.
128.0'	133.0'	16215	Kss - white, medium grain, minor illite and heavies, box & bag split, material dried, soluble salts creating a yellow crust, 6.23% kaolin.
133.0'	138.0'	16216	Kss - white, medium grain, coarsening downsection to coarse grain in a medium grain matrix to coarse grain in a light grey clay matrix, pliable, vari-coloured silica, minor illite and heavies, 12.68% kaolin.
138.0'	143.0'	16217	Kss - some sandy clay and clay mottling from 138.0' - 140.0' - buff, silica embedded, coarse grain, vari-coloured silica, kss becoming medium grain, white, minor illite and heavies, 15.09% kaolin.
143.0'	148.0'	16218	Kss - white, medium grain, minor illite and heavies, 6.66% kaolin.
148.0'	153.0'	16219	Kss - as above, 5.70% kaolin.
153.0'	158.0'	16220	Kss - as above, rare larger silica, heavies concentrations in bands, 7.47% kaolin.
158.0'	163.0'	16221	Kss - as above, 4.0" sandy clay seam at 158.0' - buff, pliable, minor illite, some darker sections, 9.82% kaolin.
163.0'	168.0'	16222	Kss - as above, slight coarsening downsection, 5.39% kaolin.
168.0'	173.0'	16223	Kss - as above, 9.23% kaolin.
173.0'	178.0'	16224	Kss - coarse grain, light brown, vari-coloured silica, clay-rich, minor illite and heavies, sandy clay clot at 177.5' - 177.75' - pliable, medium brown, illitic, 14.61% kaolin.
178.0'	180.0'	16225	Kss - as above, 8.99% kaolin.
180.0'	183.0'	16226	Sandy Clay grading to Clay grading to Sandy

clay - buff, illitic sandy clay with purple areas, competent, fissile, clay - medium brown, many sandy clay laminations, 57.97% kaolin.

- | | | | |
|--------|--------|-------|--|
| 183.0' | 188.0' | 16227 | Kss - medium yellow/brown, medium grain, two hematitic/garnetiferous siliceous clasts at 183.0' - 0.5", minor illite and heavies, 1.0" of medium brown clay, silica embedded at 185.75', competent, weakly pliable, 12.35% kaolin. |
| 188.0' | 193.0' | 16228 | Kss - white, medium and fine grain alternating, minor illite and heavies, heavies as concentration banding, rare larger silica clasts, light grey pliable clay clotting, 7.16% kaolin. |
| 193.0' | 198.0' | 16229 | Kss - as above, entirely dried, partially contaminated, 6.35% kaolin. |
| 198.0' | 203.0' | 16230 | Kss - coarse grain in a medium grain matrix, medium brown, fissile clay clotting, light brown, vari-coloured silica, one rounded medium grey - 1.5" - containing pyrite, with <i>in situ</i> growth of haematitic nodules cementing silica clasts, areas of red/pink staining as a result of jasper decomposition, 9.82% kaolin. |
| 203.0' | 208.0' | 16206 | Kss - medium grain, grading to coarse grain, white, grading to light buff, minor illite and heavies, vari-coloured silica, 7.54% kaolin. |
| 208.0' | 214.0' | 16208 | Kss - white, fine grain, with large angular to sub-angular vari-coloured silica, up to 2.5" located along a horizon of 0.5' at 110.0', heavies concentrating, high percentage illite, 8.46% kaolin. |
| 214.0' | 218.0' | 16210 | Kss - fine grain grading to medium grain, frequent larger sub-rounded vari-coloured silica, minor illite and heavies, low clay content, somewhat dried, 7.59% kaolin. |
| 218.0' | 223.0' | 16212 | Kss - medium grain, white, minor illite and heavies, vari-coloured silica, 122.0' - 123.5' - coarse grain in a medium grain matrix, some white clay mottling, heavies concentrations, 5.67% kaolin. |
| 223.0' | 229.0' | 16231 | Kss - coarse grain in a medium grain matrix, light brown, some clay clotting, vari- |

coloured silica, 9.37% kaolin.

- 229.0' 232.5' 16232 Kss - medium grain, predominantly white, some rusty stained sections containing black and yellow areas, apparent rusty heavies, minor illite, rare larger silica clasts up to 2.0", rusty section containing very small amount of clay, possibly due to drilling action, heavies concentration, especially near large vari-coloured silica, some coarsening downsection, 7.01% kaolin.
- 232.5' 235.5' 16233 Kss - medium grain, white, minor illite and heavies, 237.25' - 238.0' - coarse grain, vari-coloured silica in a medium grey, medium grain matrix, heavies concentration, 8.91% kaolin.
- 235.5' 239.0' 16234 Kss - as above, coarse grain, white, minor illite and heavies, 8.05% kaolin.
- 239.0' 241.0' 16235 Kss - as above, fossiliferous clast containing silica replacement of a porous material, 8.35% kaolin.
- 241.0' 244.0' 16236 Kss - as above, medium grain, white, dried, minor illite and heavies, 8.0% kaolin.
- 244.0' 247.0' 16237 Kss - coarse grain, in a medium grain matrix, one Devonian sandstone clast and one black coquina, well rounded 0.5", vari-coloured silica, white, drill core gouging, 7.59% kaolin.
- 247.0' 251.0' 16238 Kss - extremely coarse grain vari-coloured silica in a medium grey clay matrix alternating with coarse grain vari-coloured silica in a medium grain matrix, last 0.75' - medium grain, low clay content, high percentage heavies, drill core gouging, 8.51% kaolin.
- 251.0' 255.0' 16239 Kss - coarse grain as above, red disseminated jasper areas, 9.06% kaolin.

EOH - 255.0'

Section 92-28

Claim No.: P 900045
 Hole Length: 255.0'
 Overburden Depth: 79.0'
 Astronomic Azimuth: 50° 08' 56" W. 82° 10' 21" N
 Location: 1060.0' at 183° to claim post no. 1
 Scale: 1.0" = 50.0'
 Northing: BL 00
 Easting: 3605 E
 Dip: -90°

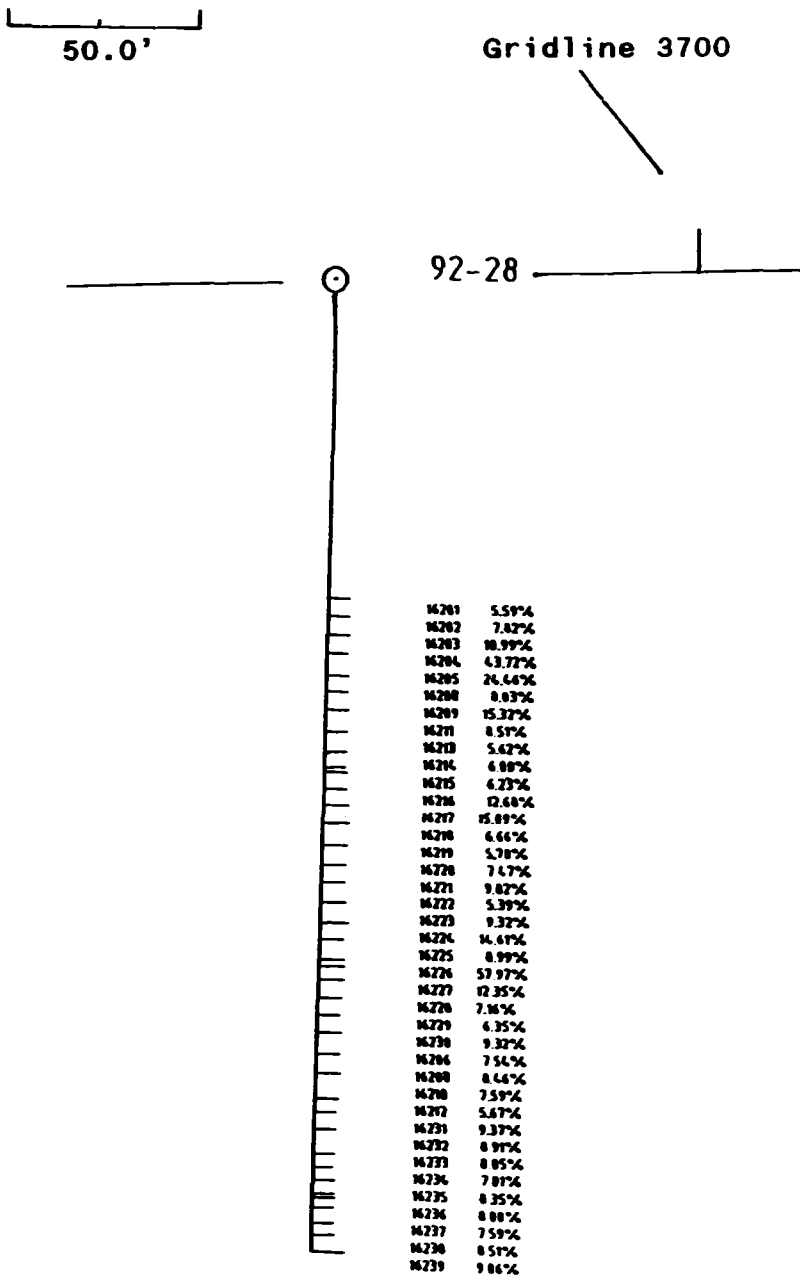

Section 92-28

Claim No.: P 900045
Hole Length: 255.0'
Overburden Depth: 79.0'
Astronomic Azimuth: $50^{\circ} 08' 56''$ W. $82^{\circ} 10' 21''$ N
Location: 1060.0' at 183° to claim post no. 1
Scale: 1.0" = 50.0'
Northing: BL 00
Easting: 3605 E
Dip: -90°

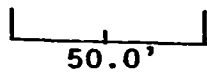

Gridline 3700

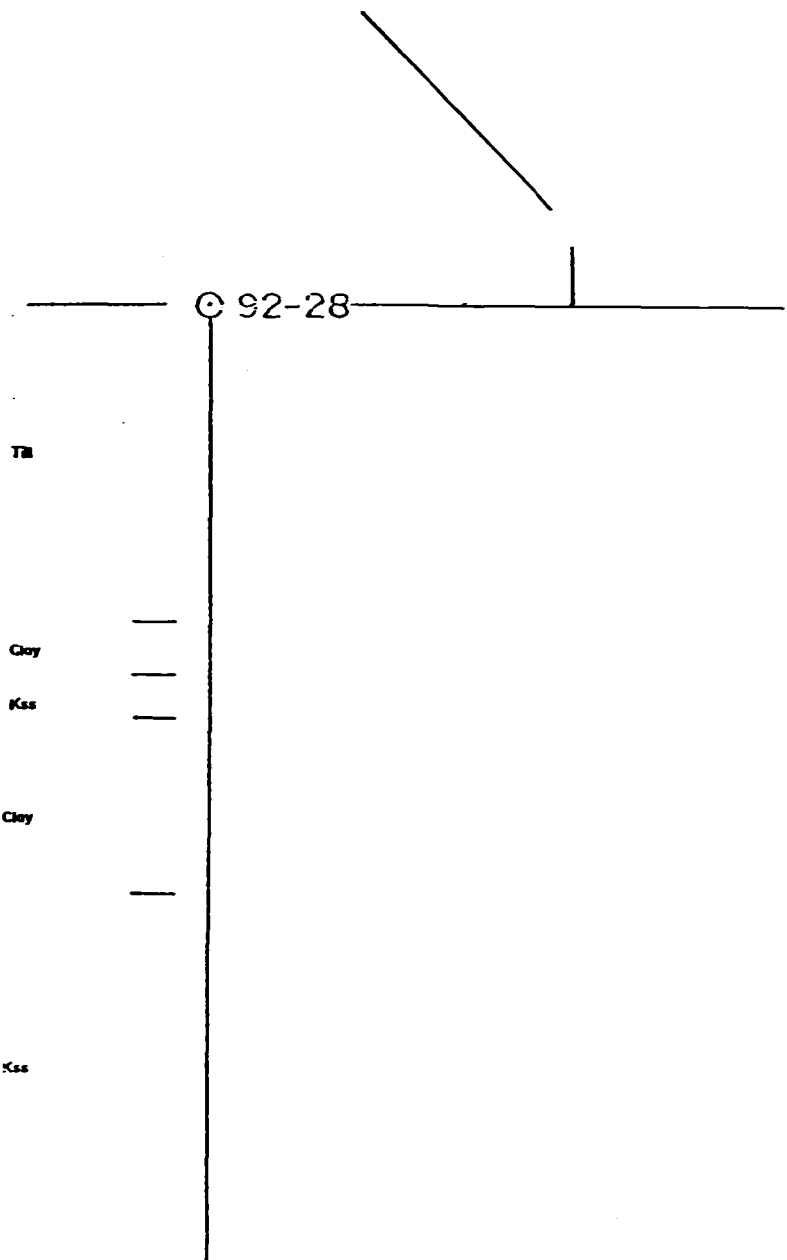



Chemex Labs Ltd.

Analytical Chemists • Geochemists • Registered Assayers
212 Brooksbank Ave., North Vancouver
British Columbia, Canada V7J 2C1
PHONE: 604-984-0221

To: MINERAL RESEARCH CANADA INC.

1 INDUSTRIAL BLVD.
PARRY SOUND, ON
P2A 2W8

INVOICE NUMBER

I 9 3 1 5 4 7 2

BILLING INFORMATION

Date: 25-JUN-93
Project: KIPLING
P.O. No.: 0054
Account: KJE
Comments: 930101T

Billing: For analysis performed on
Certificate A9315472

Terms: Payment due on receipt of invoice
1.25% per month (15% per annum)
charged on overdue accounts

Please Remit Payments to:

CHEMEX LABS LTD.
212 Brooksbank Ave.,
North Vancouver, B.C.
Canada V7J 2C1

# OF SAMPLES	ANALYSED FOR CODE - DESCRIPTION	UNIT PRICE	SAMPLE PRICE	AMOUNT
24	A-12 W.R.A ICP O-5 lb prep quote	18.00 3.51	21.51	516.24
		Total Cost \$		516.24
		(Reg# R10093885) GST \$		36.14
TOTAL PAYABLE (CDN) \$				552.38

Handwritten notes and signatures in the bottom right corner of the invoice table area.



Chemex Labs Ltd.

Analytical Chemists * Geochemists * Registered Assayers
212 Brookbank Ave., North Vancouver
British Columbia, Canada V7J 2C1
PHONE: 604-984-0221

To: MINERAL RESEARCH CANADA INC. *

1 INDUSTRIAL BLVD.
PARRY SOUND, ON
P2A 2W8

INVOICE NUMBER

I 9 3 1 5 4 7 4

BILLING INFORMATION

Date: 25-JUN-93
Project: KIPLING
P.O. No.: 0054
Account: KJE

Comments: 930101T

Billing: For analysis performed on
Certificato A9315474

Terms: Payment due on receipt of invoice
1.25% per month (15% per annum)
charged on overdue accounts

Please Remit Payments to:

CHEMEX LABS LTD.
212 Brookbank Ave.,
North Vancouver, B.C.
Canada V7J 2C1

# OF SAMPLES	ANALYSED FOR CODE - DESCRIPTION	UNIT PRICE	SAMPLE PRICE	AMOUNT
44	A-12 W.R.A ICP 0-5 lb prep quote	18.00 3.51	21.51	946.44
		Total Cost \$		946.44
		(Reg# R100938885) GST \$		66.25
		TOTAL PAYABLE (CDN) \$		1012.69

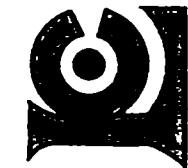

Chemex Labs Ltd.

Analytical Chemists * Geochemists * Registered Assayers
5175 Timberlea Blvd., Mississauga,
Ontario, Canada L4W 2S3
PHONE: 416-624-2806

To: MINERAL RESEARCH CANADA INC.

1 INDUSTRIAL BLVD.
PARRY SOUND, ON
P2A 2W8

Project: KIPLING
Comments: ATTN: A. CASSELMAN

Page Number : 1
Total Pages : 2
Certificate Date: 25-JUN-93
Invoice No. : 19315474
P.O. Number : 0054
Account : KJE

CERTIFICATE OF ANALYSIS A9315474

SAMPLE	PREP CODE	Al2O3 %	CaO %	Cr2O3 %	Fe2O3 %	K2O %	MgO %	MnO %	Na2O %	P2O5 %	SiO2 %	TiO2 %	LOI %	TOTAL %
16201	208 226	2.47	0.16	0.16	1.30	0.05	0.09	0.01	0.15	0.06	93.74	0.18	1.22	99.59
16202	208 226	3.09	0.09	0.12	0.72	0.07	0.06	< 0.01	0.08	0.04	94.23	0.13	1.28	99.92
16203	208 226	4.34	0.11	0.12	0.64	0.09	0.07	< 0.01	0.10	0.04	92.14	0.16	1.80	99.62
16204	208 226	17.27	0.26	0.10	1.02	0.35	0.16	< 0.01	0.07	0.03	72.26	0.82	8.52	100.85
16205	208 226	9.66	0.14	0.07	0.89	0.18	0.11	< 0.01	0.07	0.03	84.17	0.46	4.33	100.15
16206	208 226	2.98	0.07	0.09	0.70	0.03	0.05	< 0.01	0.03	0.02	94.81	0.10	1.32	100.20
16207	208 226	3.17	0.09	0.07	0.62	0.03	0.05	< 0.01	0.10	0.04	94.69	0.07	1.24	100.20
16208	208 226	3.34	0.09	0.08	0.69	0.04	0.05	< 0.01	0.09	0.05	93.70	0.19	1.34	99.67
16209	208 226	6.05	0.22	0.20	1.11	0.09	0.14	< 0.01	0.25	0.12	88.79	0.26	2.29	99.53
16210	208 226	3.00	0.11	0.07	0.70	0.03	0.07	< 0.01	0.09	0.04	95.03	0.16	1.21	100.50
16211	208 226	3.36	0.09	0.03	0.38	0.05	0.06	< 0.01	0.09	0.04	94.72	0.19	1.31	100.35
16212	208 226	2.44	0.10	0.06	0.63	0.04	0.05	< 0.01	0.08	0.04	95.17	0.15	0.97	99.74
16213	208 226	2.22	0.08	0.02	0.36	0.03	0.04	< 0.01	0.07	0.03	95.59	0.07	0.90	99.42
16214	208 226	2.37	0.07	0.03	0.50	0.04	0.03	< 0.01	0.07	0.03	95.71	0.09	0.95	99.90
16215	208 226	2.46	0.09	0.05	0.55	0.03	0.04	< 0.01	0.09	0.05	95.14	0.10	0.91	99.52
16216	208 226	5.01	0.09	0.04	0.53	0.06	0.06	< 0.01	0.06	0.03	92.09	0.12	1.91	100.00
16217	208 226	5.96	0.17	0.13	0.64	0.09	0.11	< 0.01	0.21	0.09	89.74	0.27	2.18	99.60
16218	208 226	2.63	0.08	0.04	0.41	0.05	0.04	< 0.01	0.09	0.03	95.24	0.12	0.95	99.69
16219	208 226	2.25	0.07	0.01	0.28	0.04	0.04	< 0.01	0.08	0.03	96.74	0.08	0.82	100.45
16220	208 226	2.95	0.07	0.02	0.30	0.05	0.04	< 0.01	0.08	0.03	95.17	0.12	1.00	99.84
16221	208 226	3.88	0.09	0.07	0.65	0.06	0.06	< 0.01	0.09	0.03	93.25	0.19	1.69	100.05
16222	208 226	2.13	0.09	0.03	0.30	0.04	0.04	< 0.01	0.10	0.04	95.79	0.03	0.93	99.53
16223	208 226	3.64	0.10	0.04	0.43	0.07	0.06	< 0.01	0.10	0.03	94.13	0.08	1.53	100.20
16224	208 226	5.77	0.12	0.05	0.84	0.09	0.06	< 0.01	0.09	0.03	89.92	0.19	2.58	99.75
16225	208 226	3.55	0.08	0.07	0.76	0.06	0.04	< 0.01	0.13	0.04	93.37	0.11	1.60	99.82
16226	208 226	22.90	0.15	0.05	1.03	0.42	0.14	< 0.01	0.15	0.04	65.25	0.82	9.87	100.85
16227	208 226	4.88	0.16	0.08	1.87	0.08	0.05	< 0.01	0.10	0.03	90.06	0.31	2.63	100.25
16228	208 226	2.83	0.03	0.03	0.53	0.04	0.01	< 0.01	0.05	0.02	95.46	0.12	1.33	100.45

Handwritten mark



Chemex Labs Ltd.
 Analytical Chemists * Geochemists * Registered Assayers
 5175 Timberlea Blvd., Mississauga,
 Ontario, Canada L4W 2S3
 PHONE: 416-624-2806

To: MINERAL RESEARCH CANADA INC.

1 INDUSTRIAL BLVD.
 PARRY SOUND, ON
 P2A 2W8

Page Number : 1
 Total Pages : 1
 Certificate Date: 25-JUN-93
 Invoice No. : 19315472
 P.O. Number : 0054
 Account : JE

Project : KIPLING
 Comments: ATTN: A. CASSELMAN

CERTIFICATE OF ANALYSIS A9315472

SAMPLE	PREP CODE	Al2O3 %	CaO %	Cr2O3 %	Fe2O3 %	K2O %	MgO %	MnO %	Na2O %	P2O5 %	SiO2 %	TiO2 %	LOI %	TOTAL %
16229	208 226	2.51	0.16	0.12	0.82	0.04	0.08	< 0.01	0.17	0.08	95.29	0.30	1.12	100.70
16230	208 226	3.88	0.15	0.13	1.09	0.06	0.09	< 0.01	0.18	0.09	92.30	0.18	1.83	99.99
16231	208 226	3.70	0.07	0.04	0.68	0.06	0.02	< 0.01	0.04	0.04	94.01	0.12	1.61	100.40
16232	208 226	2.77	0.07	0.07	0.68	0.03	0.03	< 0.01	0.07	0.05	95.02	0.34	1.17	100.30
16233	208 226	3.52	0.07	0.05	0.55	0.05	0.03	< 0.01	0.08	0.06	94.69	0.06	1.40	100.55
16234	208 226	3.18	0.09	0.07	0.59	0.05	0.06	< 0.01	0.12	0.07	94.32	0.16	1.29	100.00
16235	208 226	3.30	0.09	0.06	0.69	0.05	0.04	< 0.01	0.10	0.05	95.00	0.17	1.37	100.95
16236	208 226	3.16	0.01	< 0.01	0.53	0.05	< 0.01	< 0.01	<	0.02	95.58	0.10	1.28	100.75
16237	208 226	3.00	0.06	0.02	0.57	0.05	0.02	< 0.01	0.01	0.03	95.63	0.14	1.20	100.75
16238	208 226	3.36	0.04	0.01	0.54	0.05	0.12	< 0.01	0.01	0.03	95.07	0.12	1.37	100.75
16239	208 226	3.58	0.08	0.04	0.66	0.05	0.13	< 0.01	0.04	0.04	93.98	0.12	1.48	100.20

--	--	--	--	--	--	--	--	--	--	--	--	--	--	--	--	--	--	--	--	--

CERTIFICATION: *David P. ...*

SONIC DRILL HOLE RECORD

Drilling Started: Mar. 6, 1992
 Drilling Finished: Mar. 7, 1992
 Drilling Co.: J. R. Drilling
 Dip: -90°
 Hole Length: 250.0'
 Overburden Depth: 187.0'
 Claim No.: P 900095
 Easting: 3590 E
 Northing: BL 00
 Azimuth: 50° 08' 56" W. 82° 11' 00" N.
 Location: 1150.0' at 184° To Claim Post No. 1
 Property: Kipling

Logged By: A. Casselman
 Logged: Nov. 30, 1992
 Core Size: 3.5"
 Core Storage:
 Mineral Research Canada
 R. R. # 2
 Parry Sound, ON
 P2A 2W8
 Hole No.: 92-30

SUMMARY

From	To	Description
0.0'	3.0'	Peat
3.0'	187.5'	Glacial Clay Till
187.5'	193.5'	Sand
193.5'	195.0'	Glacio-lacustrine Clay
195.5'	196.0'	Glacial Clay Till - Overburden - Pleistocene
196.0'	206.5'	Kss
206.5'	210.0'	Clay
210.0'	213.0'	Kss & Sandy Clay
213.0'	250.0	Kss

EOH - 250.0'

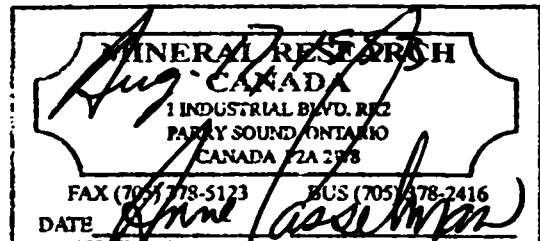

Detail Log - 92-30

From	To	Sample No.	Description
0.0'	3.0'		Peat
3.0'	187.5'		Glacial Clay Till - competent, dark green/brown, high percentage (up to 45.0%) carbonate, Precambrian, and silica clasts, calcareous, from 186.25' - 187.5' - glacio-lacustrine clay - non-calcareous, highly pliable, dark green/brown, few small carbonate clasts.
187.5'	193.5'		Glacial Sand - medium grain, predominantly silica, a true sand, minor amount of clay, green/brown.
193.5'	195.5'		Glacio-lacustrine Clay - as previous, areas of rusty staining, some incorporation of Cretaceous clay, buff with darker laminations, competent, pliable.
195.5'	196.0'		Glacial Clay Till - as previous.
196.0'	199.0'	16301	Kss - white, coarse grain, vari-coloured silica, external contamination from overburden, minor illite and heavies, kaolin.
199.0'	203.0'	16302	Kss - coarse grain, fining downsection to fine grain, white, minor illite and heavies, lightening downsection from light grey, kaolin.
203.0'	206.5'	16303	Kss - fine grain, white, minor illite and heavies, buff at lower contact, kaolin.
206.5'	208.0'	16304	Clay - competent, pliable, 206.5' - 307.0' - fragmented into little irregular sections but still highly pliable, slightly moulded (white), illitic, medium brown, 2.0" at 207.75' of yellow/orange clay, drill gouging, kaolin.
208.0'	210.0'	16305	Clay - highly competent, weakly pliable, medium brown, discontinuous laminations, sandy laminations, drill gouging, illitic increasingly sandy downsection, kaolin.

210.0'	213.0'	16306	Kss & Sandy Clay - alternating, kss - medium grain, white, much yellow/green/brown external contamination throughout, sandy clay - buff, minor illite, pliable, darker laminations, kaolin.
213.0'	217.0'	16307	Kss - medium grain, white, high moisture content, highly illitic, minor heavies, kaolin.
217.0'	222.0'	16308	Kss - as above, not as much clay, some grey areas, some purple, rare larger clasts up to 2.0", a tri-coloured silica - white, black and yellow, kaolin.
222.0'	227.0'	16309	Kss - white, medium grain, minor illite and heavies, rare larger rounded silica, smoky quartz at 226.0', 3.0" of extremely large vari-coloured silica in a light buff matrix, kaolin.
227.0'	231.0'	16310	Kss - coarse grain, vari-coloured silica in a medium grain matrix, then becoming coarse grain in a white clay matrix, kaolin.
231.0'	235.0'	16311	Kss - vari-coloured silica, light buff clay surrounding a coarse grain to very coarse grain silica, kaolin.
235.0'	238.0'	16312	Kss - as above at 236.5', grey siltstone/dolostone, differential weathering, mottled light and dark spherical patterns, sub-angular, angularly drill fractured, Devonian, some purple clots, kaolin.
238.0'	241.0'	16313	Kss - as above, alternating with medium grain kss, white, minor illite and heavies, kaolin.
241.0'	244.0'	16314	Kss - medium grain, white, minor illite and heavies, rare coarse clasts, kaolin.
244.0'	247.0'	16315	Kss - as above, 244.0' - 245.0' - frequent coarse clasts in a medium grain matrix, 1.0" of coarse grain in a grey clay matrix, pink kaolin staining around pink clasts, kaolin.
247.0'	250.0'	16316	Kss - as above, medium grain,

kaolin.

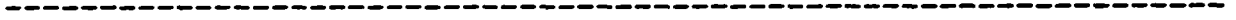

EOH - 250.0'

Section 92-30

Claim No.: P 900095

Hole Length: 250.0'

Overburden Depth: 187.0'

Astronomic Azimuth: $50^{\circ} 08' 56''$ W. $82^{\circ} 11' 00''$ N

Location: 1150.0' at 184° to claim post no. 1

Scale: 1.0" = 50.0' or 1:600

Northing: BL 00

Easting: 3590 E

Dip: -90°

50.0'

Gridline 3600

Section 92-30

Claim No.: P 900095
Hole Length: 250.0'
Overburden Depth: 187.0'
Astronomic Azimuth: 50° 08' 56" W. 82° 11' 00" N
Location: 1150.0' at 184° to claim post no. 1
Scale: 1.0" = 50.0' or 1:600
Northing: BL 00
Easting: 3590 E
Dip: -90°

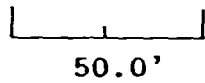

Gridline 3600

92-30

TK

Sandy Clay
Grey
Kss
Clay
Sandy Clay
Kss

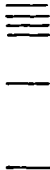

Chemex Labs Ltd.

Analytical Chemists * Geochemists * Registered Assayers
212 Brooksbank Ave., North Vancouver
British Columbia, Canada V7J 2C1
PHONE: 604-984-0221

To: MINERAL RESEARCH CANADA INC.

1 INDUSTRIAL BLVD.
PARRY SOUND, ON
P2A 2W8

INVOICE NUMBER I 9 3 1 0 1 4 0

BILLING INFORMATION

Date: 21-JAN-93
Project: 0054
P.O. No.: KJE
Account: KJE
Comments: 930101T

Billing: For analysis performed on
Certificate A9310140

Terms: Payment due on receipt of invoice
1.25% per month (15% per annum)
charged on overdue accounts

Please Remit Payments to:

CHEMEX LABS LTD.
212 Brooksbank Ave.,
North Vancouver, B.C.
Canada V7J 2C1

# OF SAMPLES	ANALYSED FOR CODE - DESCRIPTION	UNIT PRICE	SAMPLE PRICE	AMOUNT
102	A-12 W.R.A ICP Prep Quote	18.00 3.51	21.51	2194.02
		Total Cost \$		2194.02
		(Reg# R100938885) GST \$		153.58
		TOTAL PAYABLE (CDN) \$		2347.60



Chemex Labs Ltd.
 Analytical Chemists * Geochemists * Registered Assayers
 5175 Timberlea Blvd., Mississauga,
 Ontario, Canada L4W 2S3
 PHONE: 416-624-2806

To: MINERAL RESEARCH CANADA INC
 1 INDUSTRIAL BLVD
 PARRY SOUND, ON
 P2A 2W8

Page Number 1
 Total Pages 4
 Certificate Date 21-JAN-93
 Invoice No. 19310140
 P.O. Numbr. 0054
 Account KJE

Project:
 Comments: ATN: A. CASSELMAN

CERTIFICATE OF ANALYSIS A9310140

SAMPLE	PREP CODE	Al2O3 %	CaO %	Cr2O3 %	Fe2O3 %	K2O %	MgO %	MnO %	Na2O %	P2O5 %	SiO2 %	TiO2 %	LOI %	TOTAL %
16181	208 226	4.02	< 0.01	0.07	0.53	0.06	< 0.01	< 0.01	< 0.01	0.09	94.13	0.18	1.51	100.65
16182	208 226	3.25	< 0.01	0.07	0.53	0.05	< 0.01	< 0.01	< 0.01	0.09	94.64	0.11	1.18	99.96
16183	208 226	4.12	< 0.01	0.09	0.53	0.05	< 0.01	< 0.01	< 0.01	0.11	94.00	0.20	1.50	100.70
16184	208 226	4.13	< 0.01	0.07	0.48	0.07	< 0.01	< 0.01	< 0.01	0.10	93.69	0.09	1.58	100.25
16185	208 226	4.04	< 0.01	0.05	0.45	0.08	< 0.01	< 0.01	< 0.01	0.09	93.61	0.25	1.56	100.15
16186	208 226	4.23	< 0.01	0.07	0.45	0.08	< 0.01	< 0.01	< 0.01	0.09	93.25	0.22	1.63	100.05
16187	208 226	3.35	< 0.01	0.09	0.51	0.06	< 0.01	< 0.01	< 0.01	0.10	93.96	0.10	1.78	99.99
16188	208 226	9.73	0.01	0.04	0.59	0.15	0.04	< 0.01	< 0.01	0.11	95.98	0.10	3.90	101.10
16189	208 226	23.36	0.19	0.03	1.11	0.36	0.16	< 0.01	< 0.03	0.16	65.36	1.10	10.16	101.05
16190	208 226	3.67	< 0.01	0.09	0.61	0.06	0.01	< 0.01	< 0.01	0.10	94.16	0.13	1.53	100.40
16191	208 226	20.00	0.23	0.01	1.10	0.35	0.16	< 0.01	< 0.01	0.14	66.18	1.08	9.90	99.18
16192	208 226	23.85	0.26	< 0.01	1.12	0.45	0.19	< 0.01	< 0.01	0.15	60.37	1.15	11.28	98.85
16193	208 226	14.52	0.03	0.05	0.86	0.15	0.06	< 0.01	< 0.01	0.12	78.18	0.64	6.15	100.80
16194	208 226	8.90	< 0.01	0.07	0.60	0.08	0.03	< 0.01	< 0.01	0.12	86.60	0.60	3.64	100.65
16195	208 226	4.29	< 0.01	0.06	0.54	0.04	< 0.01	< 0.01	< 0.01	0.10	92.83	0.54	1.84	100.30
16196	208 226	16.29	0.19	0.08	0.91	0.16	0.08	< 0.01	< 0.01	0.11	72.80	0.77	8.99	100.45
16197	208 226	4.72	0.01	0.12	0.71	0.04	0.02	< 0.01	< 0.02	0.14	91.97	0.36	2.12	100.20
16198	208 226	20.29	0.31	0.01	1.15	0.22	0.11	< 0.01	< 0.01	0.13	61.48	0.94	14.80	99.46
16199	208 226	20.55	0.31	< 0.01	1.21	0.23	0.12	< 0.01	< 0.01	0.13	60.97	0.95	14.83	99.33
16200	208 226	22.44	0.36	0.04	1.07	0.27	0.15	< 0.01	< 0.10	0.15	58.10	1.02	15.79	99.50
16201	208 226	2.48	0.04	0.01	0.60	0.04	< 0.01	< 0.01	< 0.01	0.07	95.65	0.14	1.09	100.15
16202	208 226	3.83	< 0.01	0.03	0.57	0.04	< 0.01	< 0.01	< 0.01	0.07	93.95	0.25	1.50	100.30
16203	208 226	4.44	< 0.01	< 0.01	0.44	0.05	< 0.01	< 0.01	< 0.01	0.07	93.43	0.17	1.89	100.55
16204	208 226	27.28	0.12	< 0.01	1.09	0.43	0.14	< 0.01	< 0.01	0.15	59.19	1.26	11.50	101.20
16205	208 226	25.15	0.07	0.01	0.97	0.32	0.09	< 0.01	< 0.01	0.15	63.34	1.16	10.04	101.30
16206	208 226	8.75	< 0.01	0.05	0.76	0.09	0.02	< 0.01	< 0.01	0.11	87.34	0.51	3.55	101.20
16207	208 226	4.05	< 0.01	0.06	0.44	0.04	< 0.01	< 0.01	< 0.01	0.09	94.02	0.24	1.67	100.65
16208	208 226	3.33	< 0.01	0.06	0.49	0.04	< 0.01	< 0.01	< 0.01	0.09	95.37	0.12	1.28	100.80
16209	208 226	2.76	< 0.01	0.07	0.42	0.03	< 0.01	< 0.01	< 0.01	0.09	95.48	0.10	0.99	99.98
16210	208 226	4.93	< 0.01	0.07	0.45	0.03	0.01	< 0.01	< 0.01	0.10	92.18	0.09	2.01	99.90
16211	208 226	5.10	< 0.01	0.08	0.44	0.02	0.01	< 0.01	< 0.01	0.10	92.25	0.09	2.13	100.25
16212	208 226	9.91	< 0.01	0.08	0.46	0.03	0.01	< 0.01	< 0.01	0.12	86.30	0.24	4.07	101.25
16213	208 226	4.35	< 0.01	0.08	0.55	0.03	< 0.01	< 0.01	< 0.01	0.10	93.42	0.21	1.76	100.55
16214	208 226	4.06	< 0.01	0.08	0.58	0.04	0.01	< 0.01	< 0.01	0.10	93.18	0.15	1.74	99.97
16215	208 226	4.71	< 0.01	0.10	0.58	0.04	0.01	< 0.01	< 0.01	0.10	92.48	0.15	2.00	100.20
16216	208 226	4.31	0.02	0.11	0.69	0.05	0.03	< 0.01	< 0.03	0.10	92.47	0.13	1.80	99.75
16217	208 226	3.62	0.01	0.10	0.61	0.11	0.03	< 0.01	< 0.01	0.10	93.61	0.31	1.54	100.05
16218	208 226	4.73	< 0.01	0.11	0.66	0.10	0.02	< 0.01	< 0.01	0.10	92.74	0.31	1.77	100.55
16219	208 226	6.41	0.01	0.10	0.59	0.12	0.03	< 0.01	< 0.01	0.11	90.56	0.42	2.81	101.20
16220	208 226	5.29	< 0.01	0.09	0.55	0.11	0.02	< 0.01	< 0.01	0.11	91.64	0.34	2.24	100.40

CERTIFICATION:

B. Campbell

SONIC DRILL HOLE RECORD

Drilling Started: Mar. 6, 1992
Drilling Finished: Mar. 7, 1992
Drilling Co.: J. R. Drilling
Dip: -90°
Hole Length: 250.0'
Overburden Depth: 187.0'
Claim No.: P 900095
Easting: 3590 E
Northing: BL 00
Azimuth: 50° 08' 56" W. 82° 11' 00" N.
Location: 1150.0' at 184° To Claim Post No. 1
Property: Kipling

Logged By: A. Casselman
Logged: Nov. 30, 1992
Core Size: 3.5"
Core Storage:
Mineral Research Canada
R. R. # 2
Parry Sound, ON
P2A 2W8
Hole No.: 92-30

SUMMARY

From	To	Description
0.0'	3.0'	Peat
3.0'	187.5'	Glacial Clay Till
187.5'	193.5'	Sand
193.5'	195.0'	Glacio-lacustrine Clay
195.5'	196.0'	Glacial Clay Till - Overburden - Pleistocene
196.0'	206.5'	Kss
206.5'	210.0'	Clay
210.0'	213.0'	Kss & Sandy Clay
213.0'	250.0	Kss

EOH - 250.0'

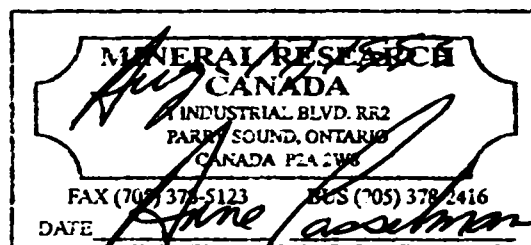

Detail Log - 92-30

From	To	Sample No.	Description
0.0'	3.0'		Peat
3.0'	187.5'		Glacial Clay Till - competent, dark green/brown, high percentage (up to 45.0%) carbonate, Precambrian, and silica clasts, calcareous, from 186.25' - 187.5' - glacio-lacustrine clay - non-calcareous, highly pliable, dark green/brown, few small carbonate clasts.
187.5'	193.5'		Glacial Sand - medium grain, predominantly silica, a true sand, minor amount of clay, green/brown.
193.5'	195.5'		Glacio-lacustrine Clay - as previous, areas of rusty staining, some incorporation of Cretaceous clay, buff with darker laminations, competent, pliable.
195.5'	196.0'		Glacial Clay Till - as previous.
196.0'	199.0'	16301	Kss - white, coarse grain, vari-coloured silica, external contamination from overburden, minor illite and heavies, kaolin.
199.0'	203.0'	16302	Kss - coarse grain, fining downsection to fine grain, white, minor illite and heavies, lightening downsection from light grey, kaolin.
203.0'	206.5'	16303	Kss - fine grain, white, minor illite and heavies, buff at lower contact, kaolin.
206.5'	208.0'	16304	Clay - competent, pliable, 206.5' - 307.0' - fragmented into little irregular sections but still highly pliable, slightly moulded (white), illitic, medium brown, 2.0" at 207.75' of yellow/orange clay, drill gouging, kaolin.
208.0'	210.0'	16305	Clay - highly competent, weakly pliable, medium brown, discontinuous laminations, sandy laminations, drill gouging, illitic increasingly sandy downsection, kaolin.

210.0'	213.0'	16306	Kss & Sandy Clay - alternating, kss - medium grain, white, much yellow/green/brown external contamination throughout, sandy clay - buff, minor illite, pliable, darker laminations, kaolin.
213.0'	217.0'	16307	Kss - medium grain, white, high moisture content, highly illitic, minor heavies, kaolin.
217.0'	222.0'	16308	Kss - as above, not as much clay, some grey areas, some purple, rare larger clasts up to 2.0", a tri-coloured silica - white, black and yellow, kaolin.
222.0'	227.0'	16309	Kss - white, medium grain, minor illite and heavies, rare larger rounded silica, smoky quartz at 226.0', 3.0" of extremely large vari-coloured silica in a light buff matrix, kaolin.
227.0'	231.0'	16310	Kss - coarse grain, vari-coloured silica in a medium grain matrix, then becoming coarse grain in a white clay matrix, kaolin.
231.0'	235.0'	16311	Kss - vari-coloured silica, light buff clay surrounding a coarse grain to very coarse grain silica, kaolin.
235.0'	238.0'	16312	Kss - as above at 236.5', grey siltstone/dolostone, differential weathering, mottled light and dark spherical patterns, sub-angular, angularly drill fractured, Devonian, some purple clots, kaolin.
238.0'	241.0'	16313	Kss - as above, alternating with medium grain kss, white, minor illite and heavies, kaolin.
241.0'	244.0'	16314	Kss - medium grain, white, minor illite and heavies, rare coarse clasts, kaolin.
244.0'	247.0'	16315	Kss - as above, 244.0' - 245.0' - frequent coarse clasts in a medium grain matrix, 1.0" of coarse grain in a grey clay matrix, pink kaolin staining around pink clasts, kaolin.
247.0'	250.0'	16316	Kss - as above, medium grain,

kaolin.



EOH - 250.0'

Section 92-30

Claim No.: P 900095

Hole Length: 250.0'

Overburden Depth: 187.0'

Astronomic Azimuth: 50° 08' 56" W. 82° 11' 00" N

Location: 1150.0' at 184° to claim post no. 1

Scale: 1.0" = 50.0' or 1:600

Northing: BL 00

Easting: 3590 E

Dip: -90°

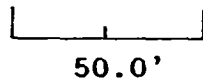

Gridline 3600

92-30

TR

Sandy Clay
Clay
Kss
Clay
Sandy Clay
Kss





Chemex Labs Ltd.

Analytical Chemists * Geochemists * Registered Assayers
212 Brooksbank Ave., North Vancouver
British Columbia, Canada V7J 2C1
PHONE: 604-884-0221

To: MINERAL RESEARCH CANADA INC.

1 INDUSTRIAL BLVD.
PARRY SOUND, ON
P2A 2W8

INVOICE NUMBER

I 9 3 1 5 4 7 2

BILLING INFORMATION

Date: 25-JUN-93
Project: KIPLING
P.O. No.: 0054
Account: KJE

Comments: 930101T

Billing: For analysis performed on
Certificate A9315472

Terms: Payment due on receipt of invoice
1.25% per month (15% per annum)
charged on overdue accounts

Please Remit Payments to:

CHEMEX LABS LTD.
212 Brooksbank Ave.,
North Vancouver, B.C.
Canada V7J 2C1

# OF SAMPLES	ANALYSED FOR CODE - DESCRIPTION	UNIT PRICE	SAMPLE PRICE	AMOUNT
24	A-12 W.R.A ICP 0-5 lb prep quote	18.00 3.51	21.51	516.24
				Total Cost \$ 516.24
				(Reg# R100938885) GST \$ 36.14
TOTAL PAYABLE (CDN) \$				552.38



Chemex Labs Ltd.

Analytical Chemists • Geochemists • Registered Assayers
212 Brookbank Ave., North Vancouver
British Columbia, Canada V7J 2C1
PHONE: 604-984-0221

To: MINERAL RESEARCH CANADA INC.

1 INDUSTRIAL BLVD.
PARRY SOUND, ON
P2A 2W8

INVOICE NUMBER

I 9 3 1 5 4 7 3

BILLING INFORMATION

Date: 28-JUN-93
Project: KIPLING
P.O. No.: 0054
Account: KJE

Comments: 930101T

Billing: For analysis performed on
Certificate A9315473

Terms: Payment due on receipt of invoice
1.25% per month (15% per annum)
charged on overdue accounts

Please Remit Payments to:

CHEMEX LABS LTD.
212 Brookbank Ave.,
North Vancouver, B.C.
Canada V7J 2C1

# OF SAMPLES	ANALYSED FOR CODE - DESCRIPTION	UNIT PRICE	SAMPLE PRICE	AMOUNT
27	A-12 W.R.A ICP 0-5 lb prep quote	18.00 3.51	21.51	580.77
		Total Cost \$		580.77
		(Reg# R10093885) GST \$		40.65
TOTAL PAYABLE (CDN) \$				621.42



Chemex Labs Ltd.

Analytical Chemists * Geochemists * Registered Assayers
212 Brooksbank Ave., North Vancouver
British Columbia, Canada V7J 2C1
PHONE: 604-884-0221

To: MINERAL RESEARCH CANADA INC.

1 INDUSTRIAL BLVD.
PARRY SOUND, ON
P2A 2W8

INVOICE NUMBER I 9 3 1 5 4 7 5

BILLING INFORMATION

Date: 2-JUL-93
Project: KIPLING
P.O. No.: 0054
Account: KJE
Comments: 930101T

Billing: For analysis performed on
Certificate A9315475

Terms: Payment due on receipt of invoice
1.25% per month (15% per annum)
charged on overdue accounts

Please Remit Payments to:

CHEMEX LABS LTD.
212 Brooksbank Ave.,
North Vancouver, B.C.
Canada V7J 2C1

# OF SAMPLES	ANALYSED FOR CODE - DESCRIPTION	UNIT PRICE	SAMPLE PRICE	AMOUNT
131	A-12 W.R.A ICP O-5 lb prep quote	18.00 3.51	21.51	2817.81
		Total Cost \$		2817.81
		(Reg# R100938885) GST \$		197.25
		TOTAL PAYABLE (CDN) \$		3015.06



Chemex Labs Ltd.

Analytical Chemists * Geochemists * Registered Assayers
5175 Timberlea Blvd., Mississauga,
Ontario, Canada L4W 2S3
PHONE: 416-624-2806

To: MINERAL RESEARCH CANADA INC.
1 INDUSTRIAL BLVD
PARRY SOUND, ON
P2A 2W8

Project: KIPLING
Comments: ATTN: A. CASSELMAN

Page Number : 1
Total Pages : 1
Certificate Date: 25-JUN-93
Invoice No. : 19315472
P.O. Numbr : 0054
Account : KJE

CERTIFICATE OF ANALYSIS A9315472

SAMPLE	PREP CODE	Al2O3 %	CaO %	Cr2O3 %	Fe2O3 %	K2O %	MgO %	MnO %	Na2O %	P2O5 %	SiO2 %	TiO2 %	LOI %	TOTAL %
16229	208 226	2.51	0.16	0.12	0.82	0.04	0.08	< 0.01	0.17	0.08	95.29	0.30	1.12	100.70
16230	208 226	3.88	0.15	0.13	1.09	0.06	0.09	< 0.01	0.18	0.09	92.30	0.18	1.83	99.99
16231	208 226	3.70	0.07	0.04	0.68	0.03	0.02	< 0.01	0.04	0.04	94.01	0.12	1.61	100.40
16232	208 226	2.77	0.07	0.04	0.68	0.03	0.03	< 0.01	0.07	0.05	95.02	0.34	1.17	100.30
16233	208 226	3.52	0.07	0.05	0.55	0.05	0.03	< 0.01	0.08	0.06	94.69	0.06	1.40	100.55
16234	208 226	3.18	0.09	0.07	0.59	0.05	0.06	< 0.01	0.12	0.07	94.32	0.16	1.29	100.00
16235	208 226	3.30	0.09	0.06	0.69	0.05	0.04	< 0.01	0.10	0.05	95.00	0.17	1.37	100.95
16236	208 226	3.16	0.01	< 0.01	0.53	0.05	< 0.01	< 0.01	< 0.01	0.02	95.58	0.10	1.28	100.75
16237	208 226	3.00	0.06	0.02	0.57	0.05	0.01	< 0.01	0.01	0.03	95.63	0.14	1.20	100.75
16238	208 226	3.36	0.04	0.01	0.54	0.05	0.12	< 0.01	0.01	0.03	95.07	0.12	1.37	100.75
16239	208 226	3.58	0.08	0.04	0.66	0.05	0.13	< 0.01	0.04	0.04	93.98	0.12	1.48	100.20
16241	208 226	30.59	0.28	< 0.01	3.37	0.36	0.32	0.01	0.08	0.19	50.50	1.08	14.06	100.85
16242	208 226	23.34	0.18	< 0.01	1.44	0.38	0.22	< 0.01	0.08	0.16	64.07	0.91	10.30	101.10
16243	208 226	26.85	0.32	0.01	2.79	0.34	0.37	0.02	0.12	0.15	55.17	1.25	13.04	100.45
16244	208 226	22.57	0.37	< 0.01	2.78	0.46	0.36	0.06	0.10	0.13	61.74	1.39	11.22	101.10
16255	208 226	26.80	0.38	0.02	4.47	0.48	0.43	0.04	0.15	0.16	52.06	1.30	14.33	100.60
16256	208 226	26.79	0.43	0.04	1.96	0.50	0.44	0.01	0.19	0.17	52.75	1.28	16.76	101.30
16257	208 226	22.33	0.52	0.02	2.22	0.45	0.44	0.02	0.13	0.14	51.72	1.19	21.98	101.15
16258	208 226	25.08	0.39	0.04	4.90	0.40	0.36	0.04	0.15	0.17	53.28	1.17	14.66	100.65
16259	208 226	27.33	0.41	0.02	8.65	0.25	0.31	0.14	0.13	0.17	44.37	1.12	16.38	99.28
16260	208 226	29.74	0.45	0.05	4.15	0.15	0.32	0.06	0.15	0.19	47.54	1.14	16.60	100.55
16261	208 226	28.29	0.30	< 0.01	2.57	0.45	0.34	< 0.01	0.09	< 0.01	53.29	1.33	14.10	100.80
16262	208 226	24.59	0.39	0.01	1.52	0.37	0.23	< 0.01	0.09	< 0.01	58.54	1.23	13.97	100.85
16263	208 226	21.34	0.32	0.02	1.22	0.38	0.21	< 0.01	0.06	< 0.01	59.90	1.26	15.56	100.30

CERTIFICATION: *[Signature]*

Chemex Labs Ltd.

Analytical Chemists • Geochemists • Registered Assayers
 5175 Timberlea Blvd., Mississauga,
 Ontario, Canada
 PHONE: 416-624-2806



Certificate Date: 25-JUN-93
 Invoice No.: 19315473
 P.O. Number : 0054
 Account : KJE

TO: MINERAL RESEARCH CANADA
 1 INDUSTRIAL BLVD.
 PARRY SOUND, ON
 PZA 2W8

Project: KIPLING
 Comments: ATTN: A. CASSELMAN

CERTIFICATE OF ANALYSIS A9315473

PREP	AL2O3	CaO	Fe2O3	FeO	MgO	MnO	SiO2	TiO2	LOI	TOTAL			
16264	208 226	21.63	0.33	< 0.01	1.13	0.57	0.19	0.09	0.01	60.70	1.27	15.09	100.80
16265	208 226	2.32	0.15	0.02	0.65	0.03	0.09	0.22	0.09	94.61	0.48	0.96	99.63
16266	208 226	5.04	0.19	0.05	0.66	0.04	0.12	0.23	0.11	91.34	0.25	2.06	100.10
16267	208 226	22.09	0.11	< 0.01	1.15	0.21	0.11	0.07	< 0.01	65.57	1.35	9.52	100.20
16268	208 226	7.84	0.18	0.02	0.85	0.11	0.12	0.20	0.11	87.02	0.50	3.21	100.15
16269	208 226	2.27	0.15	0.01	0.43	0.03	0.09	0.20	0.09	94.59	0.13	0.88	98.88
16270	208 226	2.97	0.16	0.02	0.43	0.03	0.10	0.23	0.09	94.50	0.14	1.19	99.87
16271	208 226	2.55	0.04	< 0.01	0.48	0.03	0.04	< 0.01	0.04	95.70	0.10	0.99	100.00
16272	208 226	2.38	0.17	0.01	0.74	0.03	0.09	0.19	0.08	94.59	0.18	1.00	99.47
16273	208 226	2.81	0.16	0.01	1.95	0.03	0.08	0.19	0.08	93.09	0.19	1.51	99.51
16274	208 226	15.53	0.04	< 0.01	1.17	0.26	0.07	< 0.01	< 0.01	76.10	0.88	7.04	101.15
16275	208 226	6.93	0.18	0.03	0.91	0.09	0.11	0.20	0.11	87.65	0.66	2.80	99.68
16276	208 226	5.38	0.20	0.04	0.78	0.07	0.12	0.25	0.11	90.11	0.30	2.20	99.57
16277	208 226	2.56	0.04	< 0.01	0.41	0.05	0.03	0.01	0.03	95.38	0.10	1.07	99.70
16278	208 226	2.09	0.13	0.03	0.76	0.04	0.08	0.17	0.08	95.36	0.04	0.77	99.56
16279	208 226	0.75	0.06	< 0.01	0.30	0.02	0.03	0.14	0.03	97.50	0.06	0.24	99.15
16280	208 226	2.02	0.01	< 0.01	0.75	0.03	0.01	0.07	0.02	96.59	0.03	0.70	100.25
16281	208 226	3.00	< 0.01	< 0.01	0.22	0.04	< 0.01	< 0.01	< 0.01	95.60	0.07	1.20	100.20
16282	208 226	2.69	< 0.01	< 0.01	0.22	0.03	< 0.01	0.01	0.01	95.59	0.07	1.04	99.70
16283	208 226	2.72	< 0.01	< 0.01	0.41	0.04	< 0.01	0.02	0.02	96.58	0.14	1.13	101.10

David Zucker

CERTIFICATION:



Chemex Labs Ltd.

Analytical Chemists * Geochemists * Registered Assayers
5175 Timberlea Blvd., Mississauga,
Ontario, Canada L4W 2S3
PHONE: 416-624-2806

To: MINERAL RESEARCH CANADA INC.

1 INDUSTRIAL BLVD.
PARRY SOUND, ON
P2A 2W8

Project: KIPLING
Comments: ATTN: A. CASSELMAN

Page Number : 1
Total Pages : 4
Certificate Date: 30-JUN-93
Invoice No. : 19315475
P.O. Num: 0054
Account : KJE

CERTIFICATE OF ANALYSIS A9315475

SAMPLE	PREP CODE	Al2O3 %	CaO %	Cr2O3 %	Fe2O3 %	K2O %	MgO %	MnO %	Na2O %	P2O5 %	SiO2 %	TiO2 %	LOI %	TOTAL %
13221	208 226	10.71	0.25	0.09	1.95	0.24	0.14	0.01	0.11	< 0.01	81.40	0.64	5.58	101.15
13222	208 226	5.21	< 0.01	0.04	0.60	0.12	0.02	< 0.01	0.01	0.01	91.67	0.42	2.25	100.35
13223	208 226	7.26	< 0.01	0.03	0.85	0.17	0.03	< 0.01	< 0.01	< 0.01	88.66	0.61	3.27	100.70
13224	208 226	10.30	< 0.01	0.02	0.89	0.22	0.06	< 0.01	0.02	< 0.01	83.99	0.75	4.63	100.70
13225	208 226	3.12	< 0.01	0.02	0.42	0.07	< 0.01	< 0.01	< 0.01	< 0.01	94.76	0.31	1.49	100.25
13773	208 226	6.73	< 0.01	0.10	1.91	0.16	< 0.01	< 0.01	0.01	< 0.01	87.56	0.28	3.54	100.35
13774	208 226	19.58	0.01	0.01	1.26	0.34	0.07	< 0.01	< 0.01	< 0.01	68.12	0.90	10.59	100.90
13775	208 226	25.76	0.32	< 0.01	1.37	0.54	0.24	< 0.01	0.05	< 0.01	51.67	1.22	18.81	99.91
13776	208 226	26.18	0.14	< 0.01	1.23	0.42	0.11	< 0.01	< 0.01	< 0.01	59.35	1.13	12.71	101.30
13777	208 226	27.10	0.39	< 0.01	1.18	0.44	0.23	< 0.01	0.04	< 0.01	48.31	1.16	20.88	99.76
13778	208 226	25.36	0.39	< 0.01	1.46	0.55	0.28	< 0.01	0.02	< 0.01	45.57	1.13	24.67	99.46
13779	208 226	23.68	0.56	< 0.01	1.17	0.48	0.28	< 0.01	< 0.01	0.09	41.66	0.99	30.90	99.84
13780	208 226	23.93	0.46	< 0.01	1.10	0.66	0.28	< 0.01	< 0.01	0.11	51.42	1.19	20.42	99.60
13781	208 226	23.46	0.45	< 0.01	1.71	0.59	0.24	< 0.01	0.01	0.10	49.22	1.16	22.09	99.05
13782	208 226	2.64	0.07	0.01	0.83	0.07	< 0.01	< 0.01	< 0.01	< 0.01	95.27	0.26	1.51	100.70
13783	208 226	3.66	0.02	0.04	0.79	0.06	< 0.01	0.01	< 0.01	0.03	93.61	1.05	1.72	101.00
13784	208 226	4.51	0.08	0.02	0.82	0.08	< 0.01	< 0.01	< 0.01	0.02	92.92	0.50	2.05	101.15
13785	208 226	4.06	0.01	0.01	0.95	0.07	< 0.01	< 0.01	< 0.01	0.02	94.51	0.16	1.71	101.15
13786	208 226	3.04	< 0.01	0.01	0.47	0.08	< 0.01	< 0.01	< 0.01	0.01	95.47	0.14	1.33	100.60
13787	208 226	3.79	< 0.01	0.01	0.87	0.08	< 0.01	< 0.01	< 0.01	0.02	94.90	0.17	1.58	101.05
13788	208 226	4.81	0.04	0.03	1.01	0.10	0.01	0.01	< 0.01	0.03	90.45	0.89	2.14	99.53
13789	208 226	2.81	< 0.01	0.01	0.85	0.07	< 0.01	< 0.01	< 0.01	< 0.01	95.29	0.07	1.16	100.00
13790	208 226	2.87	< 0.01	< 0.01	0.36	0.06	< 0.01	< 0.01	< 0.01	< 0.01	96.39	0.11	1.18	101.00
13791	208 226	2.47	< 0.01	< 0.01	0.43	0.06	< 0.01	< 0.01	< 0.01	< 0.01	96.46	0.09	1.00	100.55
13792	208 226	2.99	< 0.01	< 0.01	0.42	0.06	< 0.01	< 0.01	< 0.01	< 0.01	93.44	0.22	1.26	98.45
13793	208 226	2.92	< 0.01	0.03	0.52	0.06	< 0.01	< 0.01	< 0.01	0.02	95.82	0.09	1.18	100.70
13794	208 226	1.65	< 0.01	0.02	0.47	0.03	< 0.01	< 0.01	< 0.01	0.02	97.95	0.06	0.64	100.90
13795	208 226	1.32	0.01	0.03	0.43	0.03	< 0.01	< 0.01	< 0.01	0.02	98.01	0.04	0.53	100.45
13796	208 226	1.58	0.06	0.08	0.52	0.03	0.02	< 0.01	0.07	0.06	96.75	0.06	0.58	99.82
13797	208 226	1.05	0.02	0.05	0.44	0.02	< 0.01	< 0.01	0.02	0.03	97.41	0.04	0.38	99.48
13798	208 226	1.14	0.01	0.03	0.36	0.03	< 0.01	< 0.01	< 0.01	0.02	96.98	0.04	0.44	99.08
13799	208 226	4.83	0.01	0.03	0.57	0.06	< 0.01	< 0.01	< 0.01	0.02	91.39	0.30	2.08	99.32
16284	208 226	2.64	< 0.01	0.04	0.95	0.01	< 0.01	< 0.01	0.04	0.03	95.65	0.11	1.10	100.25
16285	208 226	2.03	< 0.01	0.06	0.54	0.02	< 0.01	< 0.01	< 0.01	0.02	96.60	0.05	0.80	100.10
16286	208 226	1.77	0.09	0.04	0.59	0.03	0.02	< 0.01	0.02	0.03	96.50	0.07	0.79	100.05
16287	208 226	2.50	< 0.01	0.01	0.47	0.02	< 0.01	< 0.01	< 0.01	0.01	95.43	0.07	1.12	99.67
16288	208 226	3.44	0.03	0.05	0.44	0.04	0.01	< 0.01	0.04	0.04	94.21	0.11	1.54	99.96
16289	208 226	5.58	0.06	0.05	0.61	0.06	0.02	< 0.01	0.02	0.04	88.95	0.32	2.41	98.13
16290	208 226	31.56	0.21	0.02	1.33	0.54	0.18	< 0.01	0.07	0.16	13.18	1.14	13.18	101.35
16701	208 226	8.37	0.56	0.03	0.82	0.24	0.21	< 0.01	0.08	0.06	83.95	0.44	4.23	99.00

Janet Backler

CERTIFICATION:



Chemex Labs Ltd.

Analytical Chemists * Geochemists * Registered Assayers
 5175 Timberlea Blvd., Mississauga,
 Ontario, Canada L4W 2S3
 PHONE: 416-624-2806

To: MINERAL RESEARCH CANADA INC.

1 INDUSTRIAL BLVD.
 PARRY SOUND, ON
 P2A 2W8

Page Number : 2
 Total Pages : 4
 Certificate Date: 21-JAN-93
 Invoice No. 9310140
 P.O. Number 054
 Account .KJE

Project :
 Comments: ATN: A. CASSELMAN

CERTIFICATE OF ANALYSIS A9310140

SAMPLE	PREP CODE	Al2O3 %	CaO %	Cr2O3 %	Fe2O3 %	K2O %	MgO %	MnO %	Na2O %	P2O5 %	SiO2 %	TiO2 %	LOI %	TOTAL %
16355	208 226	8.09	0.01	0.08	0.68	0.15	0.04	< 0.01	< 0.01	0.10	87.77	0.46	3.36	100.75
16356	208 226	15.35	0.04	0.06	0.75	0.25	0.08	< 0.01	< 0.01	0.13	77.32	0.76	6.42	101.20
16357	208 226	3.58	< 0.01	0.02	0.34	0.12	< 0.01	< 0.01	< 0.01	0.08	94.26	0.22	1.46	100.10
16358	208 226	3.52	< 0.01	0.04	0.47	0.19	< 0.01	< 0.01	< 0.01	0.08	94.33	0.13	1.29	100.10
16359	208 226	13.69	< 0.01	0.03	0.74	0.22	0.04	< 0.01	< 0.01	0.11	79.57	0.88	5.56	100.65
16360	208 226	2.60	< 0.01	0.06	0.62	0.21	< 0.01	< 0.01	< 0.01	0.08	95.58	0.17	0.98	100.35
16361	208 226	3.35	0.03	0.04	1.34	0.35	< 0.01	< 0.01	< 0.01	0.08	92.88	0.11	1.65	99.66
16362	208 226	32.76	0.16	< 0.01	1.29	0.45	0.17	< 0.01	< 0.01	0.16	50.75	1.38	13.68	100.85
16363	208 226	32.62	0.13	< 0.01	1.51	0.47	0.24	< 0.01	< 0.01	0.17	51.53	1.37	13.25	101.30
16364	208 226	32.76	0.15	< 0.01	3.59	0.58	0.28	< 0.01	< 0.01	0.19	47.96	1.30	13.53	100.35
16365	208 226	31.52	0.12	< 0.01	5.45	0.55	0.25	0.01	< 0.01	0.20	46.87	1.16	13.33	99.48
16366	208 226	25.31	0.04	< 0.01	6.24	0.33	0.19	0.03	< 0.01	0.15	53.93	0.98	12.55	99.77
16367	208 226	28.06	0.07	< 0.01	11.84	0.57	0.23	0.10	< 0.01	0.16	39.77	0.90	16.29	98.01
16368	208 226	28.34	0.06	< 0.01	6.60	0.55	0.23	0.06	< 0.01	0.15	47.92	1.04	14.00	98.97
16369	208 226	22.04	0.06	0.01	3.06	0.45	0.21	0.04	< 0.01	0.14	63.33	0.97	10.24	100.55
16370	208 226	24.10	0.08	< 0.01	8.37	0.43	0.25	0.13	< 0.01	0.14	50.22	0.95	13.91	98.60
16371	208 226	27.58	0.13	0.01	3.35	0.65	0.28	0.04	< 0.01	0.19	54.35	0.98	13.51	101.10
16372	208 226	28.35	0.36	< 0.01	1.22	0.36	0.26	< 0.01	< 0.01	0.20	52.03	1.18	16.97	100.95
16373	208 226	23.08	0.53	0.02	1.39	0.57	0.32	< 0.01	0.10	0.15	49.32	1.16	22.40	99.05
16374	208 226	24.37	0.43	< 0.01	1.39	0.61	0.31	< 0.01	< 0.01	0.14	49.36	1.17	23.56	101.35
16376	208 226	24.01	0.43	< 0.01	1.35	0.61	0.31	< 0.01	< 0.01	0.15	51.90	1.15	21.16	101.10
16377	208 226	3.54	0.07	0.06	1.62	0.09	0.01	< 0.01	< 0.01	0.09	92.85	0.16	1.99	100.50
16378	208 226	3.46	< 0.01	0.07	0.46	0.08	< 0.01	< 0.01	< 0.01	0.12	94.36	0.20	1.37	100.20
16379	208 226	3.77	< 0.01	0.07	0.56	0.08	< 0.01	< 0.01	< 0.01	0.09	94.34	0.09	1.41	100.45
16380	208 226	8.00	0.24	0.22	1.01	0.09	0.14	< 0.01	0.21	0.17	86.61	0.29	3.35	100.35
16381	208 226	2.90	0.16	0.16	0.76	0.04	0.07	< 0.01	0.14	0.12	94.60	0.14	1.16	100.45
16382	208 226	3.20	0.14	0.13	0.59	0.05	0.08	< 0.01	0.15	0.13	94.23	0.15	1.19	100.05
16383	208 226	5.02	0.20	0.14	0.89	0.09	0.10	< 0.01	0.15	0.13	91.32	0.46	2.13	100.65
16384	208 226	4.54	0.17	0.16	0.68	0.06	0.10	< 0.01	0.16	0.13	92.24	0.45	1.83	100.55
16385	208 226	20.78	0.26	0.09	0.98	0.35	0.19	< 0.01	0.13	0.17	68.09	1.40	8.69	101.15
16386	208 226	7.01	0.15	0.14	0.67	0.13	0.10	< 0.01	0.14	0.13	88.49	0.27	2.74	99.98
16388	208 226	3.13	0.11	0.12	0.53	0.05	0.06	< 0.01	0.11	0.11	94.22	0.17	1.19	99.61
16389	208 226	3.97	0.12	0.11	0.51	0.05	0.06	< 0.01	0.11	0.11	93.40	0.11	1.59	100.15
16390	208 226	2.61	0.12	0.12	0.48	0.03	0.07	< 0.01	0.11	0.11	95.62	0.21	1.08	100.55
16391	208 226	3.07	0.09	0.09	0.45	0.03	0.05	< 0.01	0.09	0.09	95.25	0.12	1.30	100.65
16392	208 226	3.45	0.08	0.09	0.49	0.04	0.04	< 0.01	0.07	0.08	93.77	0.25	1.37	99.74
16393	208 226	3.59	0.09	0.08	0.48	0.04	0.05	< 0.01	0.06	0.09	94.11	0.08	1.35	100.05
16394	208 226	2.56	0.12	0.09	0.59	0.03	0.07	< 0.01	0.08	0.09	95.28	0.07	1.08	100.05

[Handwritten signature]



Ministry of Northern Development and Mines

Report of Work Conducted After Recording Claim

Mining Act

Transaction Number: W9460.00011

AMENDED

1.3.1.349

Personal information collected on this form is obtained under the authority of the Mining Act. This information will be used for correspondence. Questions about its collection should be directed to the Provincial Manager, Mining Lands, Ministry of Northern Development and Mines, Fourth Floor, 150 Cedar Street, Sudbury, Ontario, P3E 6A5, telephone (705) 670-7284.

- Instructions: - Please type or print and submit in duplicate. - Refer to the Mining Act and the Regulatory Recorder. - A separate copy of this form must be submitted. - Technical reports and maps must accompany. - A sketch, showing the claims the work was performed on.



42J01NE0019 63.6349 KIPLING

900

Recorded Holder: Great Lakes Kipling Inc. Client No: 221553. Address: 100 Shirley Ave. Kitchener, ON N2B 2E1. Telephone No: (519) 744-8754. Mining Division: Porcupine. Township/Area: Kipling. Date Work Performed: From: Mar. 2, 1952 To: June 25, 1953.

Work Performed (Check One Work Group Only)

Table with columns: Work Group, Type. Includes rows for Geotechnical Survey, Physical Work (Rotasank), Rehabilitation, Other Authorized Work, Assays, and Assignment from Reserve. Includes stamps: ONTARIO GEOLOGICAL SURVEY ASSESSMENT FILES MAY 30 1994, RECEIVED JAN 25 1994, RECEIVED.

Total Assessment Work Claimed on the Attached Statement of Costs \$ 740,102.00

Note: The Minister may reject for assessment work credit all or part of the assessment work submitted if the recorded holder cannot verify expenditures claimed in the statement of costs within 30 days of a request for verification.

Persons and Survey Company Who Performed the Work (Give Name and Address of Author of Report)

Table with columns: Name, Address. Includes entries for Anne Casselman (Mineral Research Canada Inc.), J.B. Dillings (Gen. Del. Hadesville MB), and Chemex Labs Ltd. (51.75 Timbeler Blvd. Mississauga, ON).

Certification of Beneficial Interest * See Note No. 1 on reverse side

I certify that at the time the work was performed, the claims covered in this work report were recorded in the current holder's name or held under a beneficial interest by the current recorded holder. Date: Jan. 17/94. Recorder Holder or Agent Signature: [Signature]

Certification of Work Report

I certify that I have a personal knowledge of the facts set forth in this Work report, having performed the work or witnessed same during and/or after its completion and annexed report is true. Name and Address of Person Certifying: Anne Casselman, Mineral Research Canada Inc. Date: Jan. 24, 1994. Certified By (Signature): Anne Casselman.

For Office Use Only

Total Value Cr. Recorded: \$40,102. Date Recorded: JAN. 25, 1994. Mining Recorder: [Signature]. Deemed Approval Date: APR. 25, 1994. Date Approved: MAY 3, 1994. Date Notice for Amendment Sent: APR. 12, 1994. RECEIVED (issued) JAN 25 1994. PORCUPINE MINING DIVISION.

Numéro de rapport sur les travaux exécutés pour l'affectation de la réserve	Numéro de claim	Nombre d'unités
N/A	P900016	1
N/A	P900017	1
N/A	P900018	1
N/A	P900019	1
N/A	P900020	1
N/A	P900021	1
N/A	P900022	1
N/A	P900023	1
N/A	P900024	1
N/A	P900025	1
N/A	P900026	1
N/A	P900027	1
N/A	P900028	1
N/A	P900029	1
N/A	P900030	1
N/A	P900031	1
N/A	P900032	1
Nombre total de claims		

Valeur des travaux d'évaluation exécutés sur ce claim	Valeur affectée à ce claim
0	\$ 400.00
0	\$ 400.00
0	400.00
0	400.00
0	400.00
0	400.00
0	400.00
0	400.00
0	400.00
0	400.00
0	400.00
0	400.00
0	400.00
0	400.00
0	400.00
0	400.00
Valeur totale des travaux exécutés	Valeur totale des travaux qui a été affectée

Valeur transférée de ce claim	Réserve : travaux à réclamer à une date ultérieure	Total transféré	Réserve totale
0	0	0	0
0	0	0	0
0	0	0	0
0	0	0	0
0	0	0	0
0	0	0	0
0	0	0	0
0	0	0	0
0	0	0	0
0	0	0	0
0	0	0	0
0	0	0	0
0	0	0	0
0	0	0	0
0	0	0	0
Total transféré	Réserve totale		

Les crédits que vous réclamez dans le présent rapport peuvent être réduits. Afin de diminuer les conséquences défavorables de telles réductions, veuillez indiquer l'ordre dans lequel vous désirez au'elles soient appliquées à vos claims. Veuillez cocher (✓) l'une des options suivantes :

- Les crédits doivent être réduits en commençant par le dernier claim sur la liste.
- Les crédits doivent être réduits également entre tous les claims figurant dans le présent rapport.
- Les crédits doivent être réduits selon l'ordre donné en annexe.

Si vous n'avez pas choisi d'option, la première sera appliquée.

Note 1 : Exemples d'intérêts bénéficiaires : cessions non enregistrées, ententes sur des options, protocoles d'entente, etc. relatifs aux claims.

Note 2 : Si des travaux ont été exécutés sur un terrain faisant l'objet de lettres patentes ou d'un bail, veuillez remplir ce qui suit

Je certifie que le titulaire enregistré possédait un intérêt bénéficiaire sur le terrain faisant l'objet de lettres patentes ou d'un bail, au moment où les travaux ont été exécutés.	Signature	Date
---	-----------	------

Work Report Number for Applying Reserve	Claim Number (see Note 2)	Number of Claim Units
N/A	P900050	1
N/A	P900051	1
N/A	P900052	1
N/A	P900053	1
N/A	P900054	1
N/A	P900055	1
N/A	P900056	1
N/A	P900057	1
N/A	P900058	1
N/A	P900059	1
N/A	P900060	1
N/A	P900061	1
N/A	P900062	1
N/A	P900063	1
N/A	P900064	1
N/A	P900065	1
N/A	P900066	1
Total Number of Claims		

Value of Assessment Work Done on this Claim	Value Applied to this Claim	
0	\$ 400.00	
0	\$ 400.00	
0	400.00	
0	400.00	
0	400.00	
0	400.00	
0	400.00	
0	400.00	
0	400.00	
0	400.00	
0	400.00	
0	400.00	
0	400.00	
0	400.00	
0	400.00	
0	400.00	
0	400.00	
Total Value Work Done		
Total Value Work Applied		

Value Assigned from this Claim	Reserve: Work to be Claimed at a Future Date	
0	0	
0	0	
0	0	
0	0	
0	0	
0	0	
0	0	
0	0	
0	0	
0	0	
0	0	
0	0	
0	0	
0	0	
0	0	
0	0	
0	0	
Total Assigned From		
Total Reserve		

Credits you are claiming in this report may be cut back. In order to minimize the adverse effects of such deletions, please indicate from which claims you wish to prioritize the deletion of credits. Please mark (✓) one of the following:

- Credits are to be cut back starting with the claim listed last, working backwards.
- Credits are to be cut back equally over all claims contained in this report of work.
- Credits are to be cut back as prioritized on the attached appendix.

In the event that you have not specified your choice of priority, option one will be implemented.

Note 1: Examples of beneficial interest are unrecorded transfers, option agreements, memorandum of agreements, etc., with respect to the mining claims.

Note 2: If work has been performed on patented or leased land, please complete the following:

I certify that the recorded holder had a beneficial interest in the patented or leased land at the time the work was performed.	Signature	Date
---	-----------	------

Work Report Number for Applying Reserve	Claim Number (see Note 2)	Number of Claim Units
N/A	P900067	1
N/A	P900068	1
N/A	P900069	1
N/A	P900070	1
N/A	P900071	1
N/A	P900072	1
N/A	P900073	1
N/A	P900074	1
N/A	P900075	1
N/A	P900076	1
N/A	P900077	1
N/A	P900078	1
N/A	P900079	1
N/A	P900080	1
N/A	P900081	1
N/A	P900082	1
N/A	P900083	1
Total Number of Claims		

Value of Assessment Work Done on this Claim	Value Applied to this Claim	
0	\$ 400.00	
0	\$ 400.00	
0	400.00	
0	400.00	
0	400.00	
0	400.00	
0	400.00	
0	400.00	
0	400.00	
0	400.00	
0	400.00	
0	400.00	
0	400.00	
0	400.00	
0	400.00	
0	400.00	
0	400.00	
0	400.00	
0	400.00	
Total Value Work Done		Total Value Work Applied

Value Assigned from this Claim	Reserve Work to be Claimed at a Future Date	
0	0	
0	0	
0	0	
0	0	
0	0	
0	0	
0	0	
0	0	
0	0	
0	0	
0	0	
0	0	
0	0	
0	0	
0	0	
0	0	
0	0	
0	0	
0	0	
Total Assigned From		Total Reserve

Credits you are claiming in this report may be cut back. In order to minimize the adverse effects of such deletions, please indicate from which claims you wish to prioritize the deletion of credits. Please mark (✓) one of the following:

- Credits are to be cut back starting with the claim listed last, working backwards.
- Credits are to be cut back equally over all claims contained in this report of work.
- Credits are to be cut back as prioritized on the attached appendix.

In the event that you have not specified your choice of priority, option one will be implemented.

Note 1: Examples of beneficial interest are unrecorded transfers, option agreements, memorandum of agreements, etc., with respect to the mining claims.

Note: If work has been performed on patented or leased land, please complete the following:

Signature	I certify that the recorded holder had a beneficial interest in the patented or leased land at the time the work was performed.
Date	

AMENDED

Report Number Reserve	Claim Number (see No. 2)	Number of Claim Units	Value of Assessment Work Done on this Claim	Value Applied to this Claim	Value Assigned from this Claim	Reserve: Work to be Claimed at Future Date
N1A	P900033	1	0	\$400.00	0	0
N1A	P900034	1	0	400.00	0	0
N1A	P900035	1	0	400.00	0	0
N1A	P900036	1	0	400.00	0	0
N1A	P900037	1	0	400.00	0	0
N1A	P900038	1	0	400.00	0	0
N1A	P900039	1	0	400.00	0	0
N1A	P900040	1	0	400.00	0	0
N1A	P900041	1	0	400.00	0	0
N1A	P900042	1	0	400.00	0	0
N1A	P900043	1	0	400.00	0	0
N1A	P900044	1	0	400.00	0	0
N1A	P900045	1	0	400.00	0	0
N1A	P900046	1	0	400.00	0	0
N1A	P900047	1	0	400.00	0	0
N1A	P900048	1	0	400.00	0	0
N1A	P900049	1	0	400.00	0	0
Total Number of Claims			Total Value Work Done		Total Reserve	

Credits you are claiming in this report may be cut back. In order to minimize the adverse effects of such deletions, please indicate from which claims you wish to prioritize the deletion of credits. Please mark (✓) one of the following:

- Credits are to be cut back starting with the claim listed last, working backwards.
- Credits are to be cut back equally over all claims contained in this report of work.
- Credits are to be cut back as prioritized on the attached appendix.

In the event that you have not specified your choice of priority, option one will be implemented.

Note 1: Examples of beneficial interest are unrecorded transfers, option agreements, memorandum of agreements, etc., with respect to the mining claims.

Note 2: If work has been performed on patented or leased land, please complete the following:

I certify that the recorded holder had a beneficial interest in the patented or leased land at the time the work was performed.

Signature: _____ Date: _____

AMENDED.

Work Report Member Applying Reserve	Claim Number (See Note 2)	Member of Claim List	Value of Assessment Work Done on this Claim	Value Applied to this Claim	Value Assigned to this Claim	Reserve Work to be Claimed at a Future Date
N/A	P25866	1	7500.00	0	7500.00	0
N/A	P25793	1	0	0	0	0
N/A	P20001	1	0	400.00	0	0
N/A	P20002	1	0	400.00	0	0
N/A	P20003	1	0	400.00	0	0
N/A	P20004	1	0	400.00	0	0
N/A	P20005	1	0	400.00	0	0
N/A	P20006	1	0	400.00	0	0
N/A	P20007	1	0	400.00	0	0
N/A	P20008	1	0	400.00	0	0
N/A	P20009	1	0	400.00	0	0
N/A	P20010	1	0	400.00	0	0
N/A	P20011	1	0	400.00	0	0
N/A	P20012	1	0	400.00	0	0
N/A	P20013	1	0	400.00	0	0
N/A	P20014	1	0	400.00	0	0
N/A	P20015	1	0	400.00	0	0
Total Number of Claims			6	2400.00	2400.00	0
Total Value Work Done			7500.00	2400.00	2400.00	0
Total Value Work Applied			2400.00	2400.00	2400.00	0
Total Assigned From			2400.00	2400.00	2400.00	0
Total Reserve			0	0	0	0

\$ 70,102.09

Credits you are claiming in this report may be cut back. In order to minimize the adverse effects of such deletions, please indicate from which claims you wish to prioritize the deletion of credits. Please mark (✓) one of the following:

- 1. Credits are to be cut back starting with the claim listed last, working backwards.
- 2. Credits are to be cut back equally over all claims contained in this report of work.
- 3. Credits are to be cut back as prioritized on the attached appendix.

In the event that you have not specified your choice of priority, option one will be implemented.

Note 1: Examples of beneficial interest are unrecorded transfers, option agreements, memorandum of agreements, etc., with respect to the mining claims.

Note 2: If work has been performed on patented or leased land, please complete the following:

certify that the recorded holder had a beneficial interest in the patented or leased land at the time the work was performed.

Signature _____ Date _____



Ministry of Northern Development and Mines

Ministère du Développement du Nord et des mines

Statement of Costs for Assessment Credit

État des coûts aux fins du crédit d'évaluation

Mining Act/Loi sur les mines

AMENDED

Transaction No./N° de transaction

W9460.000

Personal information collected on this form is obtained under the authority of the Mining Act. This information will be used to maintain a record and ongoing status of the mining claim(s). Questions about this collection should be directed to the Provincial Manager, Mining Lands, Ministry of Northern Development and Mines, 4th Floor, 159 Cedar Street, Sudbury, Ontario P3E 6A5, telephone (705) 670-7264.

Les renseignements personnels contenus dans la présente formule sont recueillis en vertu de la Loi sur les mines et serviront à tenir à jour en regard des concessions minières. Adressez toute question sur la collecte de renseignements au chef provincial des terrains miniers, ministère Développement du Nord et des Mines, 159, rue Cedar, 4^e étage, Sudbury (Ontario) P3E 6A5, Téléphone (705) 670-7264.

1. Direct Costs/Coûts directs

Table with 4 columns: Type, Description, Amount/Montant, Totals/Total global. Rows include Wages/Spéaires, Labour/Main-d'oeuvre, Field Supervision/Supervision sur le terrain, Contractor's and Consultant's Fees/Droits de l'entrepreneur et de l'expert-conseil, Supplies Used/Fournitures utilisées, and Equipment Rental/Location de matériel.

Total Direct Costs / Total des coûts directs

40,102.00

2. Indirect Costs/Coûts indirects

Note: When claiming Rehabilitation work indirect costs are not allowable as assessment work. Pour le remboursement des travaux de réhabilitation, les coûts indirects ne sont pas admissibles en tant que travaux d'évaluation.

Table with 4 columns: Type, Description, Amount/Montant, Totals/Total global. Rows include Transportation/Transport, Food and Lodging/Nourriture et hébergement, and Mobilization and Demobilization/Mobilisation et démobilité.

Sub Total of Indirect Costs / Total partiel des coûts indirects

Amount Allowable (not greater than 20% of Direct Costs) / Montant admissible (n'excédant pas 20 % des coûts directs)

Total Value of Assessment Credit (Total of Direct and Allowable Indirect Costs) / Valeur totale du crédit d'évaluation (Total des coûts directs et indirects admissibles)

Note: The recorded holder will be required to verify expenditures claimed in this statement of costs within 30 days of a request for verification. If verification is not made, the Minister may reject for assessment work all or part of the assessment work submitted.

Note: Le titulaire enregistré sera tenu de vérifier les dépenses déclarées dans le présent état des coûts dans les 30 jours suivant une demande de vérification. Si la vérification n'est pas faite, le ministre peut rejeter pour évaluation tout ou une partie des travaux d'évaluation présentés.

Filing Discounts

- 1. Work filed within two years of completion is claimed at 100% of the above Total Value of Assessment Credit.
2. Work filed three, four or five years after completion is claimed at 50% of the above Total Value of Assessment Credit. See calculations below:

Calculation table: Total Value of Assessment Credit x 0.50 = Total Assessment Claimed

Remises pour dépôt

- 1. Les travaux déposés dans les deux ans suivant leur achèvement sont remboursés à 100 % de la valeur totale du crédit d'évaluation.
2. Les travaux déposés trois, quatre ou cinq ans après leur achèvement sont remboursés à 50 % de la valeur totale du crédit d'évaluation mentionné. Voir les calculs ci-dessous.

Calculation table: Valeur totale du crédit d'évaluation x 0,50 = Evaluation totale demandée

RECEIVED JAN 25 1994 FOR THE MINISTER DIVISION

Certification Verifying Statement of Costs

I hereby certify that the amounts shown are as accurate as possible and these costs were incurred while conducting assessment work on the lands shown on the accompanying Report of Work form.

that as [Signature] I am authorized (Recorded Holder, Agent, Position in Company)

to make this certification

Attestation de l'état des coûts

J'atteste par la présente que les montants indiqués sont le plus exact possible et que ces dépenses ont été engagées pour effectuer les travaux d'évaluation sur les terrains indiqués dans la formule de rapport de travail ci-joint.

Et qu'à titre de [Signature] je suis autorisé (titulaire enregistré, représentant, poste occupé dans la compagnie)

à faire cette attestation.

[Signature] Date: JAN. 19/94

SANBORN TWP.

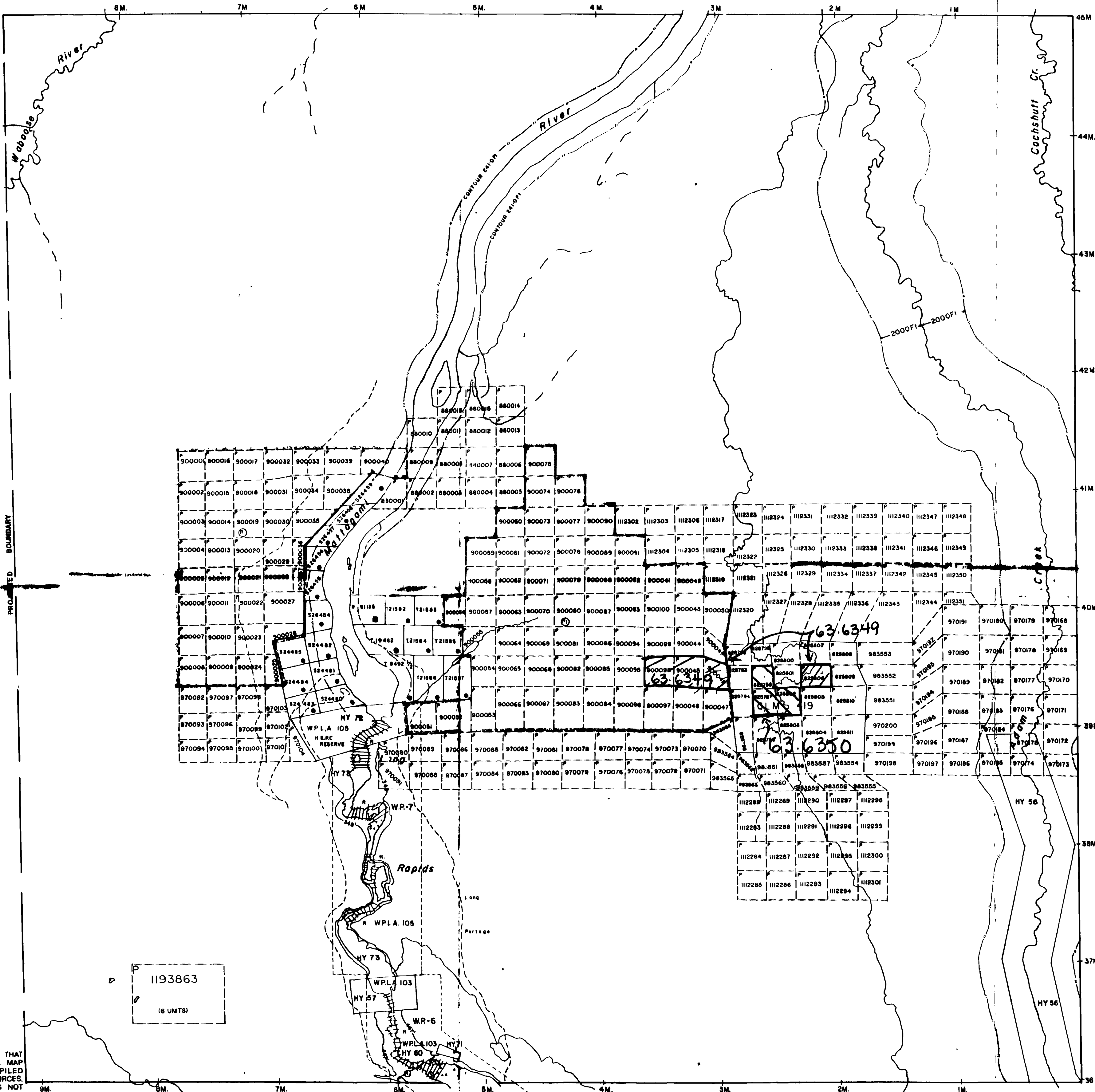

LEGEND

HIGHWAY AND ROUTE No.	
OTHER ROADS	
TRAILS	
SURVEYED LINES	
TOWNSHIPS, BASE LINES, ETC.	
LOTS, MINING CLAIMS, PARCELS, ETC.	
UNSURVEYED LINES	
LOT LINES	
PARCEL BOUNDARY	
MINING CLAIMS ETC.	
RAILWAY AND RIGHT OF WAY	
UTILITY LINES	
NON PERENNIAL STREAM	
FLOODING OR FLOODING RIGHTS	
SUBDIVISION OR COMPOSITE PLAN	
RESERVATIONS	
ORIGINAL SHORELINE	
MARSH OR MUSKEG	
MINES	
TRAVERSE MONUMENT	

DISPOSITION OF CROWN LANDS

TYPE OF DOCUMENT	SYMBOL
PATENT, SURFACE & MINING RIGHTS	
" SURFACE RIGHTS ONLY	
" MINING RIGHTS ONLY	
LEASE SURFACE & MINING RIGHTS	
" SURFACE RIGHTS ONLY	
" MINING RIGHTS ONLY	
LICENCE OF OCCUPATION	
ORDER-IN-COUNCIL	
RESERVATION	
CANCELLED	
SAND & GRAVEL	

NOTE: MINING RIGHTS IN PARCELS PATENTED PRIOR TO MAY 6, 1913, VESTED IN ORIGINAL PATENTEE BY THE PUBLIC LANDS ACT, R.S.O. 1970, CHAP. 380, SEC. 63, SUBSEC. 1.

NOTES:

FLOODING RESERVATION TO CONTOUR ELEVATION 241.0 FT. FROM GRAND RAPIDS TO TAILWATER OF KIPLING G.S.T. RESERVED FOR ONTARIO HYDRO.

FLOODING RESERVATION ON ADAM CREEK EXTENDED TO 200' EACH SIDE OF CENTERLINE OF CREEK, RESERVED FOR ONTARIO HYDRO.

AREAS WITHDRAWN FROM DISPOSITION

SYMBOL	DESCRIPTION
	M.R.O. - MINING RIGHTS ONLY
	S.R.O. - SURFACE RIGHTS ONLY
	M.+S. - MINING AND SURFACE RIGHTS

LAND NOT OPEN FOR STAKING, SEC. 3(1) OF THE MINING ACT R.S.O. 1980

ISSUED

MAY 03 1994

PORCUPINE MINING DIVISION

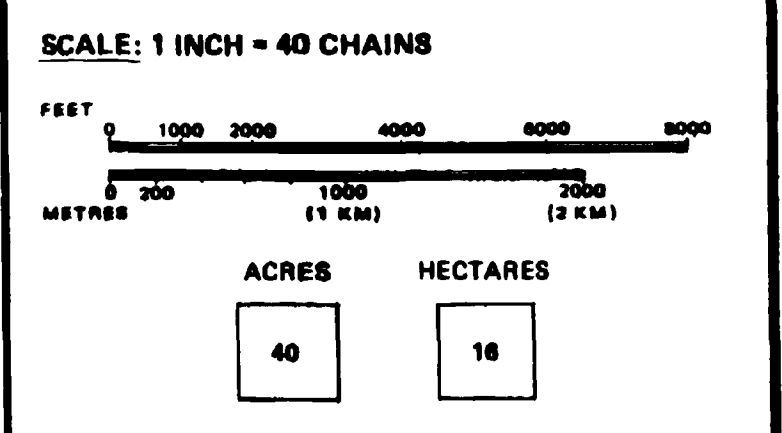

TOWNSHIP OF

KIPLING

DISTRICT 63,6349

COCHRANE 63,6350

MINING DIVISION

PORCUPINE

Ontario Ministry of Natural Resources / Ministry of Northern Development and Mines

ACTIVATED AUG. 18/93 BY D.C. / CHECKED BY L.K.

Date JULY 1986 Plan No. G-896

National Topographic Series

THE INFORMATION THAT APPEARS ON THIS MAP HAS BEEN COMPILED FROM VARIOUS SOURCES AND ACCURACY IS NOT GUARANTEED. THOSE WISHING TO STAKE MINING CLAIMS SHOULD CONSULT WITH THE MINING RECORDER, MINISTRY OF NORTHERN DEVELOPMENT AND MINES, FOR ADDITIONAL INFORMATION ON THE STATUS OF THE LANDS SHOWN HEREON.





• LEASED ELAYS
 ■ PATENTED ELAYS

Work ASSIGNED TO
 Work ASSIGNED FROM



MINERAL RESEARCH CANADA INC.

DRILL HOLE PLAN

63 6349

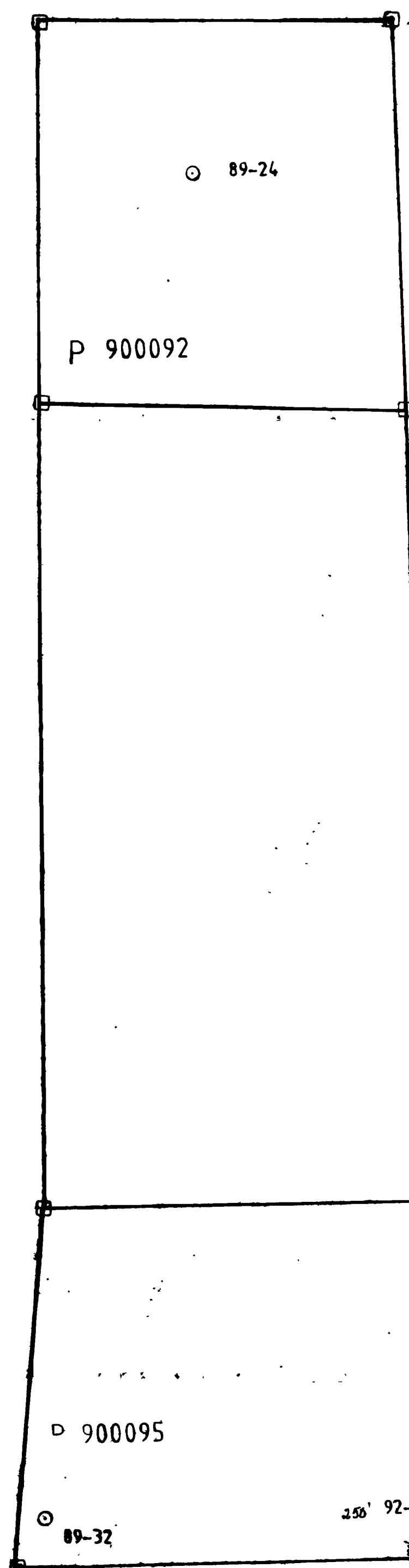

RISING OF MINING CLAIMS
 P 825792, P 825793, P 825794, P 825795, P 825796, P 825797, P 825798,
 P 825799, P 825800, P 825801, P 825802, P 825803, P 825804, P 825805,
 P 825806, P 825807, P 825808, P 825809, P 825810, P 825811
TOWNSHIP OF KIPLING
 DISTRICT OF COCHRANE
 SCALE - 1 inch = 400 feet
 1" = 400'

400.0'

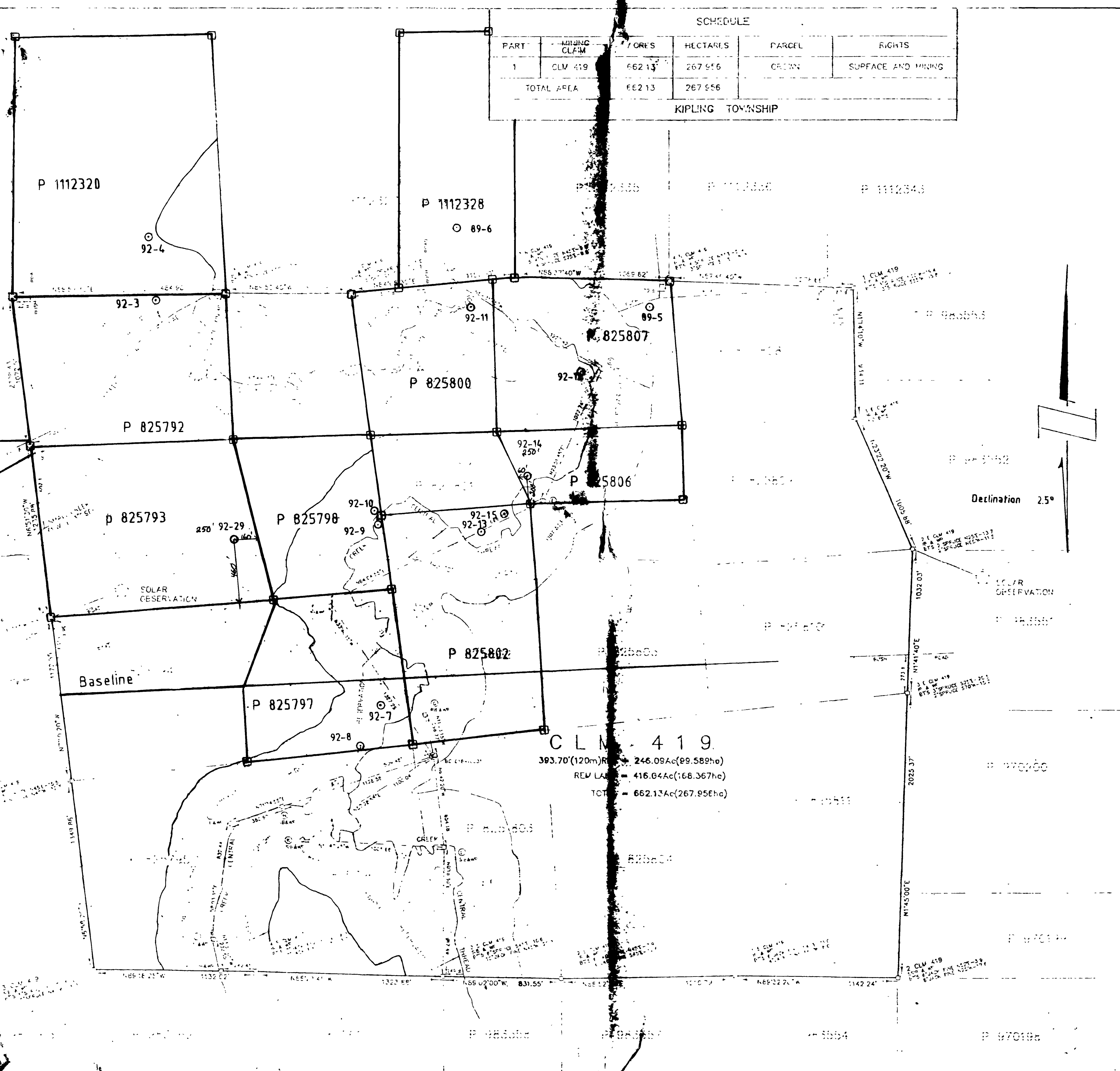

SCHEDULE				
PART	MINING CLAIM	ACRES	HECTARES	RIGHTS
1	CLM 419	662.13	267.556	SURFACE AND MINING
TOTAL AREA		662.13	267.556	

KIPLING TOWNSHIP

CLM 419
 393.70(170-m)² = 246.09Ac(99.589ha)
 REM. L.A. = 416.64Ac(168.367ha)
 TOTAL = 662.13Ac(267.956ha)

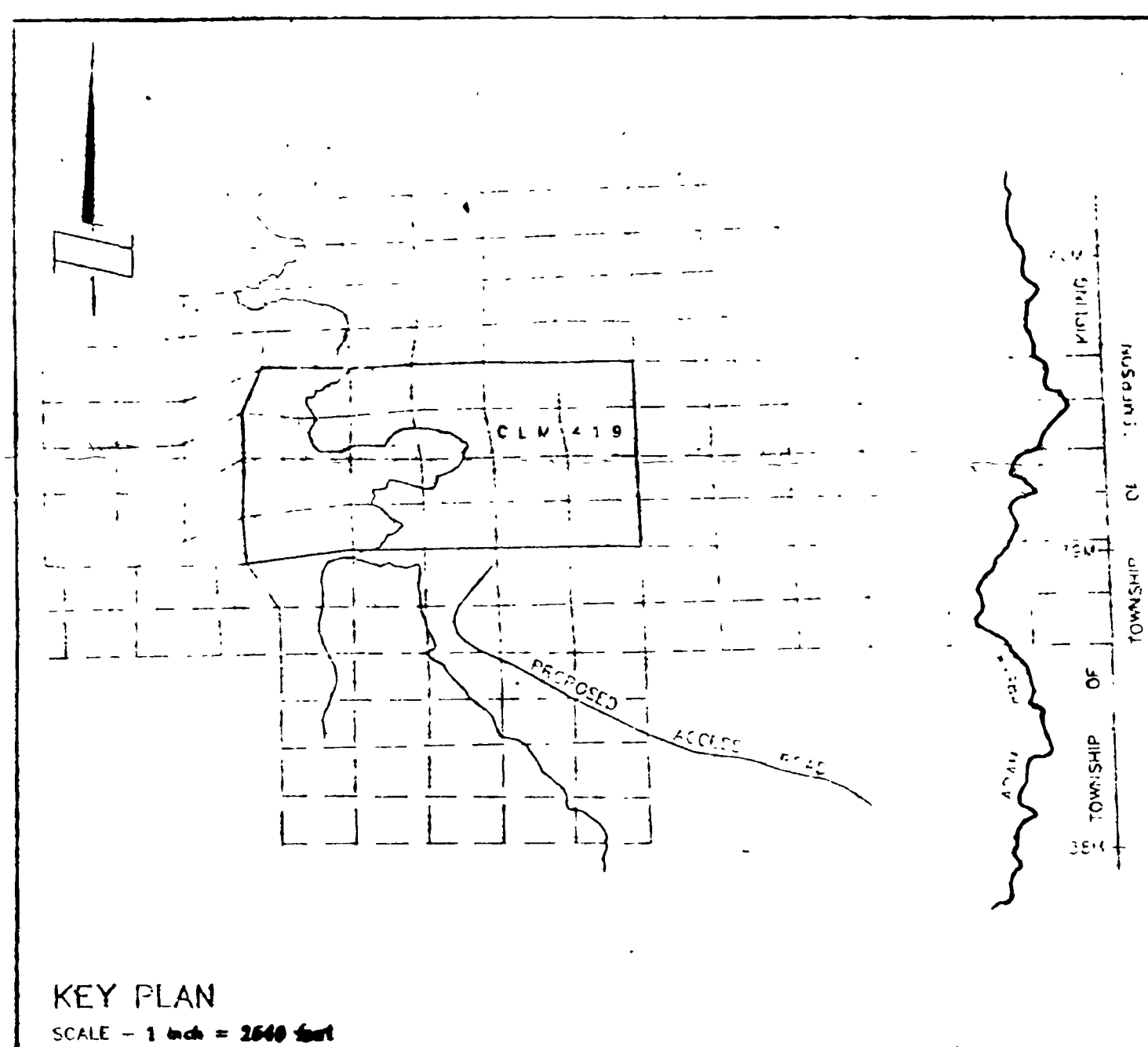

- LEGEND**
- DENOTES PLANTED MONUMENT (CLAIM POST)
 - DENOTES FOUND MONUMENT (CLAIM POST)
 - IS DENOTES 5/8" IN SQ IRON BAR 2.0 FT LONG
 - SB DENOTES 1" IN SQ IRON BAR 4.0 FT LONG
 - SB DENOTES 1" IN SQ IRON BAR 2.0 FT LONG
 - MC DENOTES BRASS CAP
 - WT DENOTES WITNESS
 - WP DENOTES WOODEN GLUE POST
 - BT DENOTES BEARING TREE
 - PT DENOTES PLANTED
 - FD DENOTES FOUND
 - ALL HANDING LINES HAVE BEEN VERIFIED
 - ALL DRILL HOLES ARE AT 20'

KIPLING DRILL PLAN

BEARING NOTE
 BEARINGS ARE ASTROMONIC AND ARE DERIVED FROM
 SOLAR OBSERVATIONS AT CORNER OF CLM 419
 (LONGITUDE 82°06'50" AND REFERRED TO THE MERIDIAN
 THROUGH THE CENTRE OF KIPLING TOWNSHIP
 (LONGITUDE 82°10'30")

MINERAL RESEARCH
 CANADA
 1 INDUSTRIAL ESTATE
 MISSISSAUGA, ONTARIO
 CANADA L4X 1L7
 FAX (905) 278-4123
 DATE 2/24/94 BY [Signature]

63.6349



COMPRISING OF MINING CLAIMS

P 825792, P 825793, P 825794, P 825795, P 825796, P 825797, P 825798,
 P 825799, P 825800, P 825801, P 825802, P 825803, P 825804, P 825805,
 P 825807, P 825808, P 825809, P 825810, P 825811, P 825812

TOWNSHIP OF KIPLING

DISTRICT OF COCHRANE

SCALE - 1 Inch = 400 Feet
 1 : 4200

400 0'

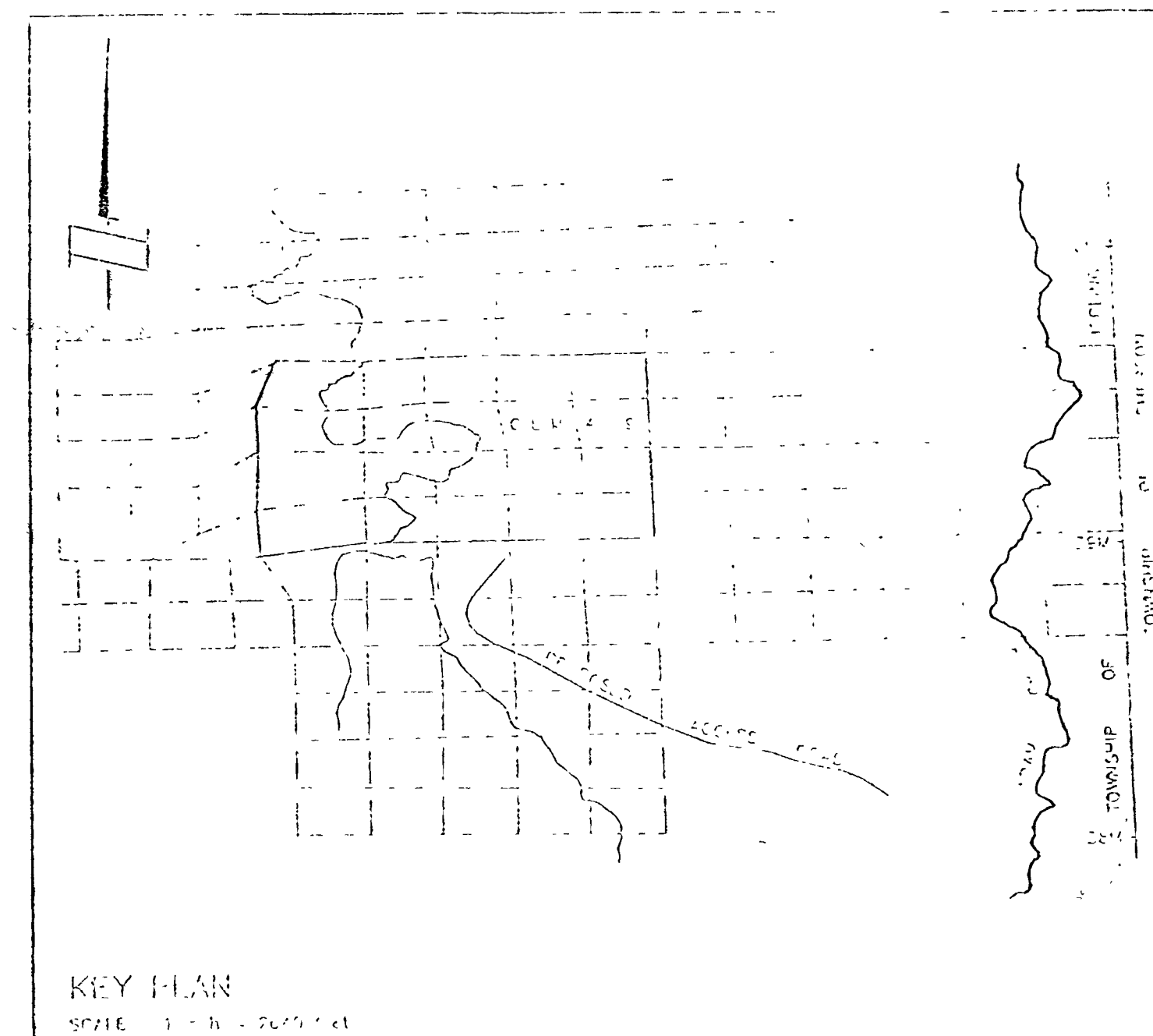
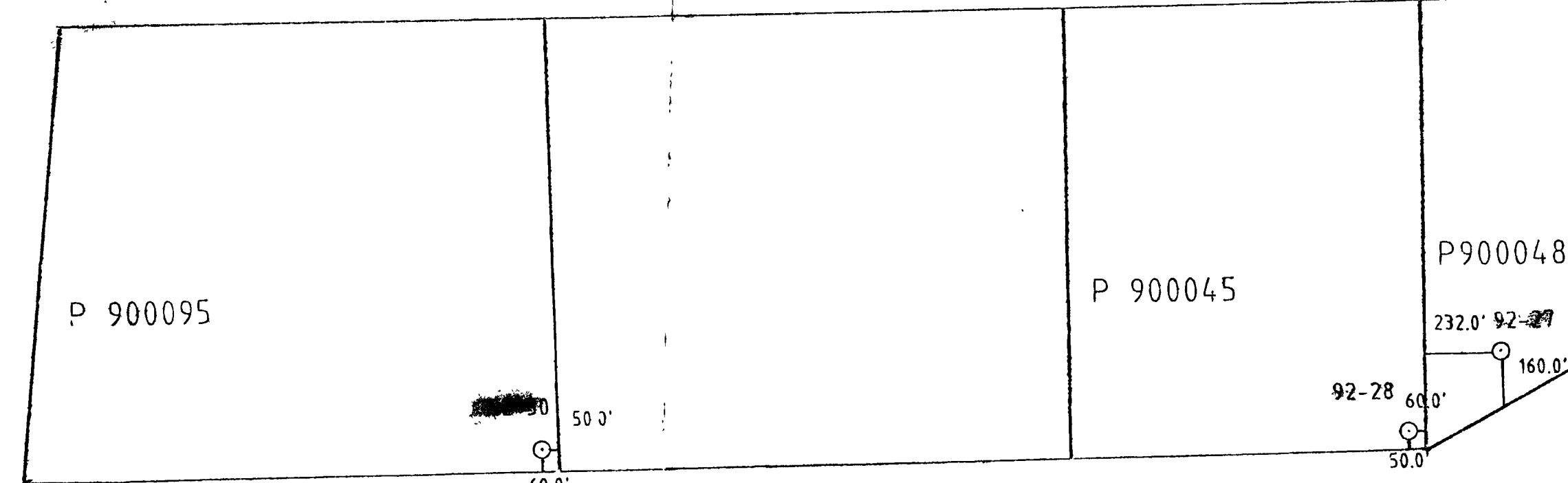

SCHEDULE			
PART	MINING CLAIM	ACRES	HECTARES
1	CLM 419	162.13	267.916
TOTAL AREA		162.13	267.956

KIPLING TOWNSHIP

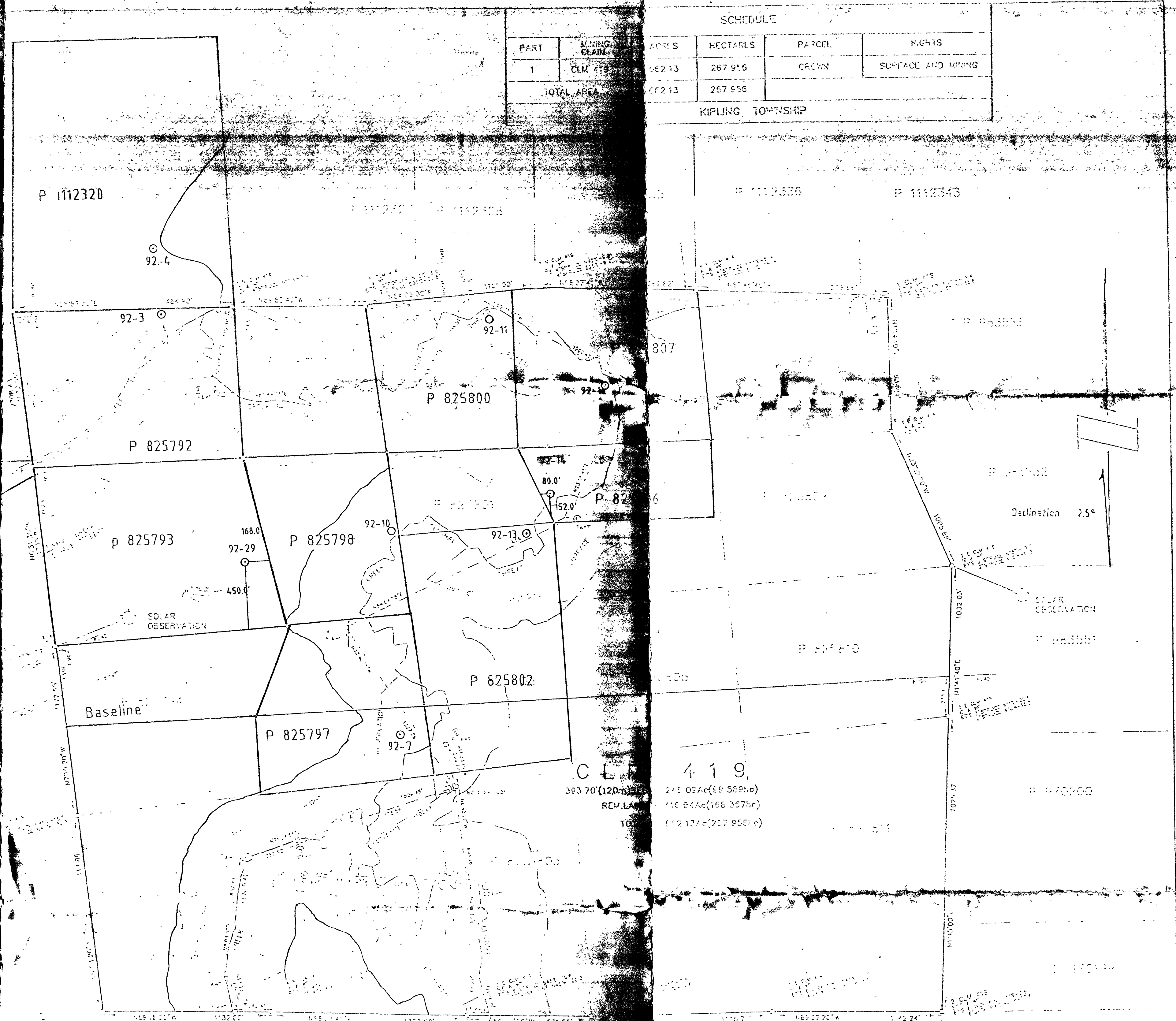

KIPLING DRILL PLAN

DRILLING NOTE
 BEARING AND DISTANCE TO ALL POINTS FROM SOLAR OBSERVATION AT COORDINATE C 419. ALL DISTANCES ARE IN METERS AND DISTANCES TO 2 DECIMAL PLACES ONLY.
 (SEE TABLE 2.1.1.1)

- LEGEND**
- DENOTES PLANTED MONUMENT
 - DENOTES FOUND MONUMENT
 - ⊕ DENOTES 1/2" x 1/2" x 50 IRON BAR 2.0 FT LONG
 - ⊕ DENOTES 1" x 1" x 50 IRON BAR 4.0 FT LONG
 - ⊕ DENOTES 1" x 1" x 50 IRON BAR 2.0 FT LONG
 - ⊕ DENOTES TREE CAP
 - W1 DENOTES WELLS
 - WD DENOTES WELLS WITH DEPTH
 - ET DENOTES EROSION TREE
 - HT DENOTES HAZARD
 - RD DENOTES ROAD
 - 71 DENOTES 1" x 1" x 50 IRON BAR 2.0 FT LONG

63.6349