

MINERAL RESEARCH CANADA Inc.

Mineral Processing Facility
Tel. (705) 378 - 2416
Fax. (705) 378 - 5123

1 Industrial Blvd. R. R. # 2
Parry Sound, Ontario
Canada P2A 2W8

LOCATION AND ACCESS TO PROPERTY

The kaolin/silica project claims are located in the townships of Kipling and Emerson in the area of and comprising the claims historically known as the Douglas property. The claims are on the Mattagami River in the area of the Kipling Hydro dam approximately 100 miles southwest of James Bay in Ontario.

The claims are accessible by driving north on highway 634 from Smooth Rock Falls to Fraserdale (approximately 45.0 miles). Then a private Ontario Hydro road may be taken west for 40 miles to the Smoky Falls dam. A road then continues north for approximately 6 miles to the Kipling dam.

CLAIM NUMBERS

The kaolin/silica property consists of 367 claims (as of Jan. 13, 1994) as well as 8 patented and one leased claim. The claim numbers are P 900001 - P 900100, P1089038 - 1089073, 1089078 - 1809111, 1090037 - 1090044, 1112282 to 1112306, 1112317 - 1112351, 825792 - 825811, 880001 - 880016, 970070 - 970104, 970168 - 970200 & 983551 - 983566.

The claim numbers that this work is to be filed on are P 1112282 - 1112306 & 1112317 - 1112351.

OWNERSHIP

The claims are wholly owned by Great Lakes Kaolin Inc.

PREVIOUS WORK

The property history as compiled by A. Gourley (1989) cites Robert Bell of the GSC as the first person to document the presence to clay and lignite in the James Bay Lowlands on Coal Brook in 1875. Borron (1891) reported extensive deposits of silica and clay on the Missinaibi River. In 1925, a report was produced by H. S. Hancock for McCarthy & Douglas regarding nine claims held on the bank of the Mattagami River and a company was formed (Northern Ontario China Clay Corporation).

In 1934 Minefinders Ltd financed the drilling of 18 holes on the west side of the Mattagami, directly across from the Douglas property, which became known as the General Refractory Products Ltd.

Fifteen holes were drilled in 1959 - 1960 by American Nepheline Ltd. with nine of these being in Kipling township.

The China Clay Syndicate comprised of New Calumet and Crang Securities drilled one hole to a depth of 163.0' north of the Douglas property in 1962. This hole is now known as C-1 after ownership transferal to the Chesterfield Mining & Exploration Co. Ltd.

Exploration in this areas continued in 1970, when Indusmin Ltd. drilled nine holes. The overburden depth in this area was approximately 100.0'.

Six hole were drilled by Geocon Ltd. on the Douglas claims in 1972. These claims were being leased by Brascan and a report was issued by C. Norman Simpson Consultants Ltd.

Ontario Geological Survey from 1975 - 1978 performed a drilling, geophysical, laboratory and field mapping study to determine Mesozoic stratigraphy.

Drilling was again conducted during 1981 by Selco Ltd. after a airborne magnetometer survey was completed. The seven holes were drilled into the anomalous magnetic areas.

Carlson Mines Ltd. optioned the Douglas property in 1985, and drilled five additional holes into the property. At this time a bulk sample was taken from the Douglas on which test work was performed by the Ontario Research Foundation (now Ortech International) and Lakefield Research. Carlson Mines Ltd. failed to complete option payments on the property resulting in forfeiture.

In 1989 the Douglas property was acquired by 798839 Ontario Ltd. (under the management of James Bay Kaolin Corp.), as well adjoining claims were staked to bring the total to 380 claims. An exhaustive drilling program of 168 holes was undertaken in which WRA, XRD, STEM, viscosity, abrasion, particle size distributions were done on core samples. Various separation techniques were developed as well as construction of a pilot plant begun.

In 1990 James Bay Kaolin Corporation was relieved of its managerial duties due to an improper rendering of accounts. The testing work continued, a 13 000 tonne bulk sample extracted and a 15 hole drilling program was completed in 1992 under the name of Mineral Research Canada Inc. for it's associated company Great Lakes Kaolin Inc.. Mineral Research Canada Inc. currently operates a small scale pilot producing kaolin materials in Parry Sound and continues with the testing work.

J R DRILLING LTD.

Hadashville, Manitoba R0E 0X0

Phone (204) 426-5597

Fax (204) 426-5458 (Manual)

Invoice No. 92-101-1

March 6th, 1992

Sold To: Mineral Research Canada Inc.
1 Industrial Blvd. RR 2
Parry Sound, Ontario P2A 2W8

Atten:

Contract: Rotasonic Drilling Program in N.E. Ont. Kipling Township
Purchase Order No. 0038

J R Drilling Contract No. 92-101

DRILLING SERVICES SUPPLIED From February 21, 1992 to March 5, 1992
(inclusive)

Mobilization and Demobilization \$ 8,000.00

Moving and Standby hours:
101 hours @ \$200.00 per hour \$ 20,200.00

Footage drilled 1,978 feet @ \$30.00 per foot \$ 59,340.00

Travel time:
174.5 man hours @ \$30.00 per man hour \$ 5,235.00

Subtotal \$ 92,775.00

G.S.T. # 102727286 \$ 6,494.25

Total Due \$ 99,269.25

LESS ADVANCE DEPOSITS on Feb. 19/92 (\$ 8,000.00)✓
Feb. 21/92 (\$ 60,000.00)✓
Feb. 28/92 (\$ 60,000.00)✓

BALANCE OF ADVANCE DEPOSIT (\$ 28,730.75)

J R DRILLING LTD.

Radashville, Manitoba R0E 0X0

Phone (204) 426-5597

Fax (204) 426-5455 (Manual)

Invoice No. 92-101-2

March 13th, 1992

Sold To: Mineral Research Canada Inc.
1 Industrial Blvd. RR 2
Parry Sound, Ontario P2A 2W8

Atten:

Contract: Rotasonic Drilling Program in N.E. Ont. Kipling Township
Purchase Order No. 0038

J R Drilling Contract No. 92-101

DRILLING SERVICES SUPPLIED From March 6th, 1992 to March 12th, 1992
(inclusive)

Moving and Standby hours:

56 hours @ \$200.00 per hour \$ 11,200.00

Footage drilled 1,250 feet @ \$30.00 per foot \$ 37,500.00

Travel time:

59 man hours @ \$30.00 per man hour \$ 1,770.00

Subtotal \$ 50,470.00

G.S.T. # 102727286 \$ 3,532.90

Total Due \$ 54,002.90

LESS ADVANCE DEPOSITS

Carried forward from Invoice # 92-101-1 (\$ 28,730.75)

BALANCE DUE IMMEDIATELY BY BANK TRANSFER
AS PER AGREEMENT

\$ 25,272.15 ✓

village gate

J R DRILLING LTD.

631 P01

Hadashville, Manitoba ROE OXO

Phone (204) 426-5597

Fax (204) 426-5458 (Manual)

Invoice No. 92-101-3

March 16th, 1992

Sold To: Mineral Research Canada Inc.
1 Industrial Blvd. RR 2
Parry Sound, Ontario P2A 2W8

Atten: Marcus Martin

Contract: Rotasonic Drilling Program in N.E. Ont. Kipling Township
Purchase Order No. 0038

J R Drilling Contract No. 92-101

DRILLING SERVICES SUPPLIED From March 13th, 1992 to March 15th, 1992
(inclusive)

Moving and Standby hours:

22 hours @ \$200.00 per hour \$ 4,400.00

Footage drilled 500 feet @ \$30.00 per foot \$ 15,000.00

Travel time:

34.5 man hours @ \$30.00 per man hour \$ 1,035.00

Subtotal \$ 20,435.00

G.S.T. # 102727286 \$ 1,430.45

Total Due \$ 21,865.45

Carried forward from Invoice # 92-101-2

\$ 25,272.15

BALANCE DUE IMMEDIATELY BY BANK TRANSFER
AS PER AGREEMENT

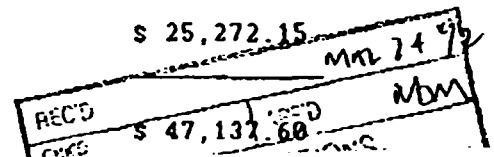

FOOTAGE STATEMENT

Period FEB 22 - MARCH 5, 1992

JR DRILLING LTD.

FOOTAGE STATEMENT

Period

1750

REMARKS:

JR DRILLING LTD.

SONIC DRILL HOLE RECORD

Drilling Started: Feb. 26, 1992	Logged by: A. Casselman
Drilling Finished: Feb. 27, 1992	Logged: Nov. 24, 1992
Drilling Co.: J. R. Drilling	Core Size: 3.5"
Dip: -90°	Core Storage:
Hole Length: 251.0'	Mineral Research Canada Inc.
Overburden Depth: 56.0'	R. R. # 2
Claim No.: P 825797	Parry Sound, ON
Easting: 5100 E	P2A 2W8
Northing: 250 S	Hole No.: 92-8
Azimuth: 50° 08' 41" W. 82° 09' 41" N.	
Location: 1150.0' at 214° To Claim Post No. 1	
Property: Kipling	

SUMMARY

From	To	Description
0.0'	9.5'	Recent Fluvial Sediments
9.5'	12.0'	Gravel
12.0'	13.0'	Glacial Clay Till
13.0'	15.5'	Gravel
15.5'	56.25'	Glacial Clay Till Overburden - Pleistocene
56.25'	118.5'	Kaolin Silica Sand (Kss) Cretaceous
118.5'	127.0'	Clay
127.0'	144.0'	Kss
144.0'	155.0'	Clay
155.0'	211.5'	Kss
211.5'	212.75'	Sandy Clay
212.75'	215.25'	Clay
215.25'	216.25'	Kss
216.25'	223.0'	Clay
223.0'	224.0'	Kss
224.0'	228.0'	Sandy Clay
228.0'	232.0'	Kss
232.0'	236.0'	Clay, Kss & Sandy Clay
236.0'	238.0'	Kss
238.0'	251.0'	Clay

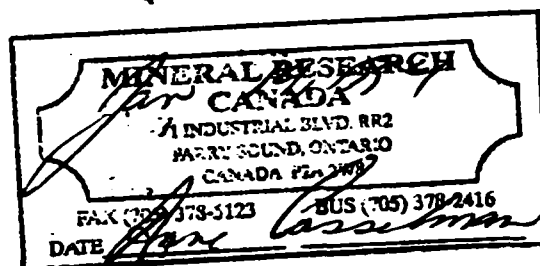

EOH - 251.0'

Detail Log - 92-8

From	To	Sample No.	Description
0.0'	9.5'		Recent Fluvial Sediments - hole drilled in the bed of Pike Creek, green/grey to yellow/brown silty clay sediments, pliable, some organic material (cleared tag alders), some material scraped.
9.5'	12.0'		Gravel - some clay content, coarse grain, mixed lithology, angular.
12.0'	13.0'		Glacial Clay Till - highly competent, dark green/grey, calcareous.
13.0'	15.5'		Gravel - as above.
15.5'	56.25'		Glacial Clay Till - as previous, fissile, some sandy sections, some clast content, angular carbonate & gneissic clasts, from 23.0' - 28.0' - very light coloured section, pinkish, disseminated or decomposed feldspar material.
56.25'	60.0'	16151	Kss - white, medium grain, minor illite and heavies, much external contamination from overburden, 7.16% kaolin.
60.0'	64.0'	16152	Kss - as above, 8.61% kaolin.
64.0'	68.0'	16153	Kss - medium grain, white from 64.0' - 66.25' - then coarse grain & medium to dark grey, vari-coloured silica, minor illite and heavies, some clay clotting in the coarse portion, 8.10% kaolin.
68.0'	73.0'	16154	Kss - white, coarse grain, vari-coloured silica from 68.0' - 69.0', 69.0' - 73.0' - medium grain, yellow/brown, grey/brown, banded with white, minor illite and heavies, less kaolin than 68.0' - 69.0', 6.51% kaolin.
73.0'	78.0'	16155	Kss - fine grain, buff, heavies as banding as well as dispersed, clay clots, 12.41% kaolin.
78.0'	83.0'	16156	Kss - as above, sharp contact with medium grain at 82.25', 11.95% kaolin.
83.0'	88.0'	16157	Kss - light brown, medium grain, minor heavies and illite, slight coarsening downsection at 84.0', concentration of

heavies and garnet/haematite, extremely small and brittle, 9.62% kaolin.

88.0'	91.5'	16158	Kss - as above, 7.92% kaolin.
91.5'	95.0'	16159	Kss - buff, fine grain, much heavies banding, minor illite, buff clay mottling with fine purple laminations, pliable, competent, darker clay laminations, 94.0' - 95.0' - buff sandy clay, grading to clay - medium brown, competent, pliable with lighter and darker discontinuous laminations, 27.80% kaolin.
95.0'	98.0'	16160	Kss - medium grain, light brown, minor illite and heavies, higher illite than normal, 8.53% kaolin.
98.0'	102.0'	16161	Kss - medium grain, white, minor illite and heavies, rare larger smoky quartz, 6.96% kaolin.
102.0'	107.0'	16162	Kss - as above, slightly darker, coarser sections that appear yellow/brown, 7.47% kaolin.
107.0'	112.0'	16163	Kss - areas of yellow/brown, medium grey and white, high percentage heavies, minor illite, medium grain, 6.38% kaolin.
112.0'	117.0'	16164	Kss - white, some areas of light grey in slightly coarser portions, minor illite and heavies, vari-coloured silica, heavies banding, clay clotting, some areas of coarse grain in medium grain matrix, 4.0" at beginning very competent, grey clay with silica clasts imbedded with purple laminations, 8.08% kaolin.
117.0'	118.5'	16165	Kss - medium grain, white, minor heavies and illite, some large flake large pliable clay clot, light grey at lower contact, 9.32% kaolin.
118.25'	121.0'	16166	Clay - very pliable, competent, gooey, buff with red & yellow mottling from 118.25' - 119.25', then buff with varying amounts of medium grain silica, probably due to drilling action, 58.68% kaolin.
121.0'	125.0'	16167	Clay - buff from 121.0' - 121.25', 121.25' - 122.25' - red, yellow and buff grading to yellow and buff, 123.5' - 125.0' - grey and buff mottled, some purple, rare silty

sections, competent, weakly pliable to weakly fissile, 67.72% kaolin.

- | | | | |
|--------|--------|-------|---|
| 125.0' | 127.0' | 16168 | Clay - light grey, some yellow mottling, some sandy content in sections, competent, weakly pliable to weakly fissile, minor illite, 50.71% kaolin. |
| 127.0' | 130.0' | 16169 | Kss - medium grain, poor clay content, light brown, some yellow brown, minor illite and heavies, some clay mottling, 11.95% kaolin. |
| 130.0' | 136.0' | 16170 | Kss - medium grain, white, some grey laminations, yellow sections and clay clot, rare larger smoky quartz and yellow chert, red/orange tinge near clay clot, 10.84% kaolin. |
| 136.0' | 142.0' | 16171 | Kss - medium grain, light brown, some sections of light grey, minor illite and heavies, 5.27% kaolin. |
| 142.0' | 144.0' | 16172 | Kss - medium grain, white, minor illite and heavies, 3.0" of sandy clay at 143.0' - medium brown, with lighter and darker laminations, minor illite, kss after the sandy clay is slightly darker in colour, similar 2.0" of sandy clay at lower contact, 8.30% kaolin. |
| 144.0' | 147.0' | 16173 | Clay - buff, darkening to medium brown, discontinuously laminated, fissile, competent, one area of medium grain, white kss, probable drilling introduction, 61.16% kaolin. |
| 147.0' | 149.0' | 16174 | Clay & Lignite - lignite occurring as large fissile fragments within dark brown pliable clay from 147.0' - 147.5', then chocolate brown silty clay, illitic, 2.0" buff, medium grain clay-rich kss grading to black clay with lignite fragments from 148.0' - 149.0', pliable competent clay, lignite frequently has a rusty film, 55.39% kaolin. |
| 149.0' | 155.0' | 16175 | Clay & Lignite - as above, highly competent, large lignite fragments, some entirely composed of tiny shards of lignite, 57.16% kaolin. |
| 155.0' | 161.0' | 16176 | Kss - medium grain, light brown, minor illite and heavies, 8.15% kaolin. |
| 161.0' | 167.0' | 16177 | Kss - white, medium grain, areas of coarse |

grain in a medium grain matrix, medium grey, minor illite and heavies, concentrations as banding of haematite or garnet nodules, some areas of yellow brown, rusty, perhaps drilling introduction, vari-coloured silica, minor clay clotting, light grey, 10.96% kaolin.

- | | | | |
|--------|--------|-------|---|
| 167.0' | 172.0' | 16178 | Kss - white, medium grain, with frequent coarse vari-coloured silica clasts, 8.33% kaolin. |
| 172.0' | 177.0' | 16179 | Kss - medium grain, white, 172.0' - 173.0' - light grey, coarse clasts in a medium grain matrix, 3.0" rounded Devonian siliceous dolostone, pitted, buff, slightly darker weathered surface, some differential weathering, some faces angular due to drill fragmenting, <i>in situ</i> sulphide formation on surface of clast, iridescent sheen, at 172.0' - vari-coloured silica, one clast half yellow and half white, some apparent kaolin cementing on the surface of clast, clay enrichment on coarse portion, 8.43% kaolin. |
| 177.0' | 182.0' | 16180 | Kss - buff, areas of clay enrichment, heavies concentration as banding, minor illite, 14.89% kaolin. |
| 182.0' | 188.0' | 16181 | Kss - as above, 10.18% kaolin. |
| 188.0' | 194.0' | 16182 | Kss - as above, 8.23% kaolin. |
| 194.0' | 197.0' | 16183 | Kss - medium grain grading to fine grain grading to coarse grain in a medium grain matrix, 196.0' - 197.0' - buff grading to grey in coarse portion, minor illite and heavies, heavies banding, vari-coloured silica, 10.43% kaolin. |
| 197.0' | 201.0' | 16184 | Kss - as above, alternating medium and coarse grain in a medium grain matrix, white and light brown respectively, 10.46% kaolin. |
| 201.0' | 205.0' | 16185 | Kss - coarse grain in a medium grain matrix grading to coarse grain in a buff clay matrix to coarse grain in a medium grain matrix, vari-coloured silica, rounded, jasper and yellow chert, as well as smoky & milky quartz, large percentage heavies, minor illite, 10.23% kaolin. |
| 205.0' | 208.0' | 16186 | Kss - as above, less coarse material, 10.68% |

kaolin.

- 208.0' 211.5' 16187 Kss - as above, 211.0' - 211.5' - coarse grain in a buff clay matrix, 8.48% kaolin.
- 211.5' 212.75' 16188 Sandy Clay - medium brown with lighter and darker laminations, highly illitic, competent, pliable, some kss, medium grain, interbedding at upper contact, carbonaceous, almost tiger striped from 212.0' - 212.75', 24.63% kaolin.
- 212.75' 215.25' 16189 Clay - pliable, chocolate brown, carbonaceous, darkening downsection from medium to chocolate brown, minor illite, 56.61% kaolin.
- 215.25' 216.25 16190 Kss - medium grain, light brown, minor illite and heavies, much exterior brown contamination, 9.29% kaolin.
- 216.25' 220.0' 16191 Clay - chocolate brown, highly competent, weakly pliable, carbonaceous, becoming sandy in some sections appearing lighter, external crystal growth, some yellow/green limonitic stained areas, 50.63% kaolin.
- 220.0' 223.0' 16192 Clay - as above, lightening downsection, 60.38% kaolin.
- 223.0' 224.0' 16193 Kss - buff clay with coarse silica clasts, smoky quartz rounded, then 2.0" chocolate clay, as above, then kss - medium grain, buff, minor illite and heavies, 36.76% kaolin.
- 224.0' 228.0' 16194 Sandy Clay grading to kss - 224.0' - 225.0' - sandy clay - medium brown with lighter and darker laminations, pliable, illitic, kss - white, fine grain, minor illite and heavies, heavies concentration, high clay content, 22.53% kaolin.
- 228.0' 232.0' 16195 Kss - as above, less clay content downsection, 10.86% kaolin.
- 232.0' 236.0' 16196 Clay, Sandy Clay & Kss - clay - chocolate brown to kss to sandy clay to chocolate brown clay - competent, pliable, minor illite and carbonaceous material, kss - chocolate brown becoming white, medium grain, minor illite and heavies, sandy clay - carbonaceous, medium brown, laminated, minor illite, 41.24% kaolin.

236.0' 238.0' 16197 Kss - chocolate brown, areas of white, clay
clots, light grey up to 2.0", pliable,
medium grain, minor illite and heavies,
11.95% kaolin.

238.0' 243.0' 16198 Clay - 238.0' - 239.0' - very dark brown,
pliable, competent, illitic, carbonaceous,
then highly competent and fissile, some
sandy sections, highly moulded, 51.37%
kaolin.

243.0' 247.0' 16199 Clay - as above, highly competent and
fissile, some brown sandy laminations,
highly moulded, 52.03% kaolin.

247.0' 251.0' 16200 Clay - as above, 56.81% kaolin.

EOH - 251.0'

Section 92-8

Claim No.: P 825797

Hole Length: 251.0'

Overburden Depth: 56.0'

Astronomic Azimuth: $50^{\circ} 08' 41''$ W. $82^{\circ} 09' 41''$ N

Location: 1150.0' at 214° to claim post no. 1

Scale: 1.0" = 50.0' or 1:600

Northing: 250 S

Easting: 5100 E

Dip: -90°



50.0'

Gridline 5100 E

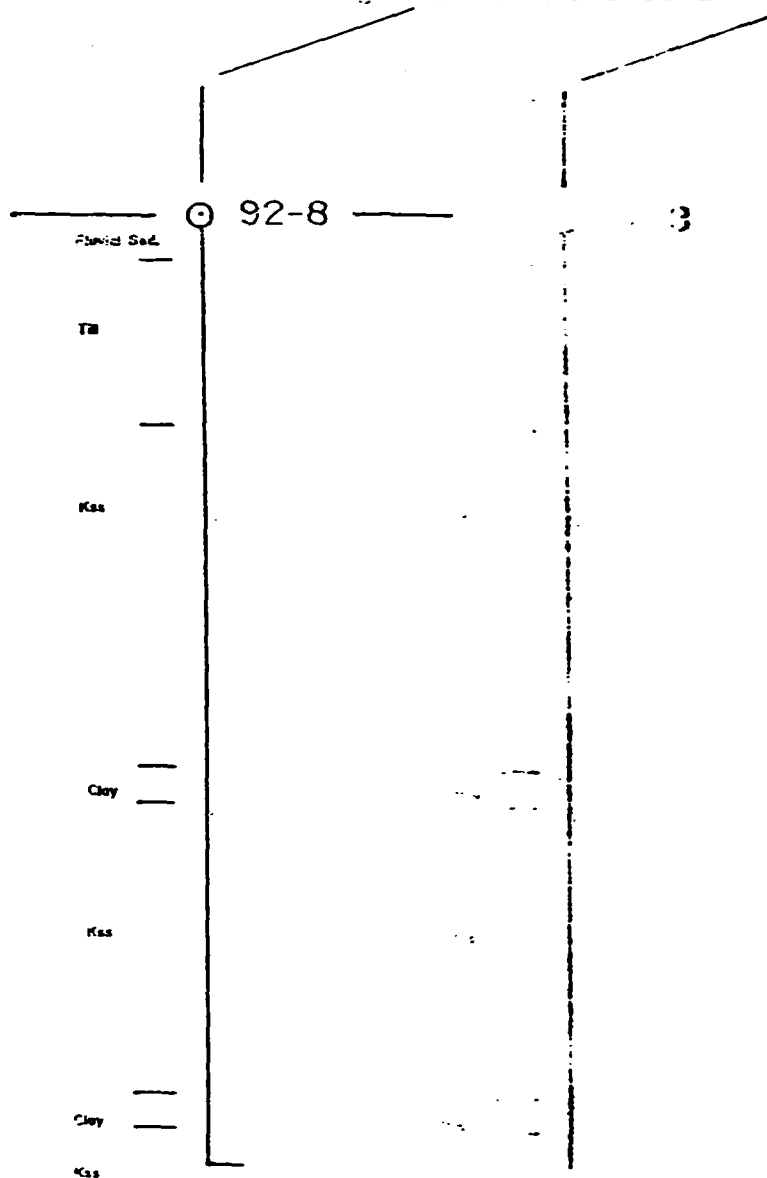

Section 92-8

Claim No.: P 825797

Hole Length: 251.0'

Overburden Depth: 56.0'

Astronomic Azimuth: 50° 08' 41" W. 82° 09' 41" N

Location: 1150.0' at 214° to claim post no. 1

Scale: 1.0" = 50.0' or 1:600

Northing: 250 S

Easting: 5100 E

Dip: -90°



50.0'

Gridline 5100 E

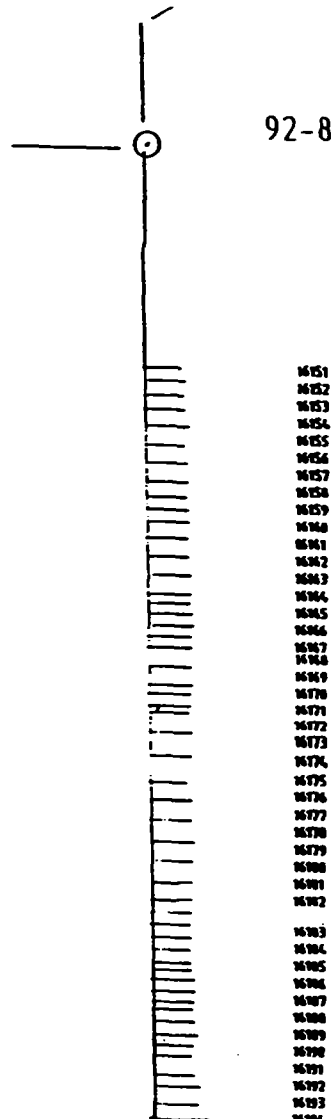

16151	7.16%
16152	6.87%
16153	6.80%
16154	6.57%
16155	12.61%
16156	11.95%
16157	9.67%
16158	7.97%
16159	77.80%
16160	6.53%
16161	6.96%
16162	7.17%
16163	6.30%
16164	8.80%
16165	9.32%
16166	56.68%
16167	67.72%
16168	58.71%
16169	11.95%
16170	10.86%
16171	5.27%
16172	6.30%
16173	61.10%
16174	35.39%
16175	57.16%
16176	6.15%
16177	10.96%
16178	6.33%
16179	6.63%
16180	16.89%
16181	10.10%
16182	6.73%
16183	10.43%
16184	10.46%
16185	10.23%
16186	10.68%
16187	6.68%
16188	26.63%
16189	56.69%
16190	9.29%
16191	56.63%
16192	48.30%
16193	36.70%
16194	22.57%
16195	10.86%
16196	61.76%
16197	11.95%
16198	51.37%
16199	52.83%
16200	56.97%



Chemex Labs Ltd.

Analytical Chemists • Geochemists • Registered Assayers
5175 Timberlea Blvd., Mississauga,
Ontario, Canada L4W 2S3
PHONE: 416-624-2806

To: MINERAL RESEARCH CANADA INC.

1 INDUSTRIAL BLVD.
PARRY SOUND, ON
P2A 2W8

Project: ATN: A. CASSELMAN
Comments:

Page Number :2
Total Pages :2
Certificate Date: 21-JAN-93
Invoice No. :19310139
P.O. Number :0054
Account :KJE

CERTIFICATE OF ANALYSIS A9310139

SAMPLE	PREP CODE	Al2O3 %	CaO %	Cr2O3 %	Fe2O3 %	K2O %	MgO %	MnO %	Na2O %	P2O5 %	SiO2 %	TiO2 %	LOI %	TOTAL %
16131	208 226	3.00	0.01	0.12	0.57	0.05	0.06	< 0.01	0.02	0.10	95.09	0.31	1.10	100.45
16132	208 226	1.83	< 0.01	0.07	0.47	0.03	0.04	< 0.01	< 0.01	0.09	97.43	0.15	0.65	100.80
16133	208 226	0.90	< 0.01	0.11	0.54	0.01	0.03	< 0.01	0.01	0.08	98.50	0.12	0.36	100.70
16134	208 226	22.86	0.24	0.03	1.03	0.26	0.13	< 0.01	0.01	0.15	64.81	1.13	10.57	101.25
16135	208 226	10.52	0.11	0.06	0.79	0.13	0.09	< 0.01	< 0.01	0.11	82.23	0.46	5.98	100.50
16136	208 226	16.95	0.21	0.03	0.97	0.22	0.16	< 0.01	< 0.01	0.12	71.90	0.81	9.90	101.30
16137	208 226	7.35	0.09	0.09	0.81	0.10	0.10	< 0.01	0.03	0.10	87.43	0.38	4.24	100.75
16138	208 226	15.31	0.21	0.07	0.97	0.19	0.13	< 0.01	0.03	0.13	74.08	0.74	9.25	101.10
16139	208 226	20.35	0.31	0.02	1.03	0.37	0.13	< 0.01	< 0.01	0.13	62.41	0.98	13.85	99.50
16140	208 226	20.03	0.34	0.02	1.01	0.25	0.13	< 0.01	< 0.01	0.13	65.59	0.94	11.47	99.93
16151	208 226	2.83	0.03	0.10	0.49	0.12	0.07	< 0.01	0.06	0.10	95.26	0.09	1.04	100.20
16152	208 226	3.40	0.05	0.08	0.44	0.13	0.13	< 0.01	0.04	0.09	94.56	0.07	1.30	100.30
16153	208 226	3.20	0.02	0.08	0.43	0.13	0.02	< 0.01	0.04	0.10	94.74	0.09	1.19	100.05
16154	208 226	2.97	0.27	0.07	0.52	0.13	0.13	< 0.01	0.06	0.09	94.72	0.06	1.17	99.80
16155	208 226	4.90	0.03	0.08	0.54	0.11	0.04	< 0.01	0.03	0.10	91.76	0.19	1.95	99.74
16156	208 226	4.72	0.02	0.09	0.53	0.11	0.03	< 0.01	0.03	0.11	92.24	0.54	1.79	100.20
16157	208 226	3.80	< 0.01	0.06	0.39	0.13	0.02	< 0.01	0.02	0.09	94.06	0.10	1.41	100.10
16158	208 226	3.13	< 0.01	0.08	0.42	0.13	0.02	< 0.01	0.02	0.09	94.81	0.13	1.16	99.99
16159	208 226	10.98	0.07	0.07	0.67	0.22	0.09	< 0.01	0.04	0.12	83.37	0.80	4.33	100.75
16160	208 226	3.37	< 0.01	0.04	0.35	0.10	0.01	< 0.01	< 0.01	0.08	94.89	0.16	1.29	100.30
16161	208 226	2.75	< 0.01	0.04	0.34	0.08	< 0.01	< 0.01	< 0.01	0.09	95.93	0.10	1.00	100.35
16162	208 226	2.95	0.02	0.05	0.63	0.11	0.04	< 0.01	< 0.01	0.08	95.18	0.14	1.18	100.40
16163	208 226	2.52	0.05	0.05	0.77	0.09	0.01	< 0.01	< 0.01	0.09	95.33	0.06	1.16	100.15
16164	208 226	3.19	0.02	0.07	0.58	0.12	0.02	< 0.01	0.02	0.10	94.61	0.14	1.27	100.15
16165	208 226	3.68	0.01	0.07	0.44	0.09	0.02	< 0.01	0.03	0.10	94.12	0.13	1.41	100.10
16166	208 226	23.18	0.14	0.02	1.39	0.52	0.14	< 0.01	< 0.01	0.14	63.44	0.91	9.46	99.26
16167	208 226	26.75	0.10	0.03	1.63	0.53	0.19	< 0.01	< 0.01	0.17	60.41	1.08	10.39	101.30
16168	208 226	20.03	0.05	0.01	1.06	0.37	0.12	< 0.01	< 0.01	0.14	70.31	1.03	7.85	101.00
16169	208 226	4.72	< 0.01	0.04	0.45	0.09	0.02	< 0.01	0.01	0.10	92.64	0.24	1.84	100.15
16170	208 226	4.28	< 0.01	0.05	0.44	0.09	0.01	< 0.01	0.01	0.09	93.78	0.21	1.67	100.65
16171	208 226	2.08	< 0.01	0.06	0.39	0.04	0.01	< 0.01	0.01	0.09	96.75	0.10	0.80	100.35
16172	208 226	3.28	< 0.01	0.03	0.50	0.06	0.01	< 0.01	0.02	0.09	94.31	0.17	1.22	99.71
16173	208 226	24.16	0.09	< 0.01	0.96	0.35	0.10	< 0.01	0.02	0.15	64.88	0.98	9.48	101.20
16174	208 226	21.88	0.39	< 0.01	1.34	0.35	0.17	< 0.01	0.06	0.16	58.28	1.05	17.59	101.30
16175	208 226	22.58	0.47	0.09	1.26	0.44	0.31	< 0.01	0.16	0.20	52.14	1.07	21.52	100.25
16176	208 226	3.22	0.06	0.10	0.55	0.09	0.08	< 0.01	0.10	0.13	94.25	0.22	1.39	100.10
16177	208 226	4.33	0.06	0.13	0.53	0.09	0.06	< 0.01	0.12	0.14	92.22	0.22	1.71	99.62
16178	208 226	3.29	0.04	0.11	0.47	0.09	0.04	< 0.01	0.11	0.13	94.53	0.09	1.16	100.05
16179	208 226	3.33	0.02	0.09	0.48	0.07	0.04	< 0.01	0.09	0.13	94.49	0.24	1.30	100.20
16180	208 226	5.87	0.09	0.08	0.81	0.09	0.04	< 0.01	0.08	0.12	90.18	0.23	2.31	99.91

CERTIFICATION:

B. Casp.



Chemex Labs Ltd.

Analytical Chemists * Geochemists * Registered Assayurs
5175 Timberlea Blvd., Mississauga,
Ontario, Canada L4W 2S3
PHONE: 416-624-2806

To: MINERAL RESEARCH CANADA INC.

1 INDUSTRIAL BLVD.

PARRY SOUND, ON

P2A 2W8

Project :

Comments: ATN: A. CASSELMAN

Page Number : 1
Total Pages : 4
Certificate Date: 21-JAN-93
Invoice No. : 19310140
P.O. Number : 0054
Account : KJE

CERTIFICATE OF ANALYSIS A9310140

SAMPLE	PREP CODE	Al2O3 %	CaO %	Cr2O3 %	Fe2O3 %	K2O %	MgO %	MnO %	Na2O %	P2O5 %	SiO2 %	TiO2 %	LOI %	TOTAL %
16181	208 226	4.02	< 0.01	0.07	0.53	0.06	< 0.01	< 0.01	< 0.01	0.09	94.13	0.18	1.51	100.65
16182	208 226	3.25	< 0.01	0.07	0.53	0.05	< 0.01	< 0.01	< 0.01	0.09	94.64	0.11	1.18	99.96
16183	208 226	4.12	< 0.01	0.09	0.53	0.05	< 0.01	< 0.01	< 0.01	0.11	94.04	0.20	1.50	100.70
16184	208 226	4.13	< 0.01	0.07	0.48	0.07	< 0.01	< 0.01	< 0.01	0.10	93.69	0.09	1.58	100.25
16185	208 226	4.04	< 0.01	0.05	0.45	0.08	< 0.01	< 0.01	< 0.01	0.09	93.61	0.25	1.56	100.15
16186	208 226	4.22	< 0.01	0.07	0.45	0.08	< 0.01	< 0.01	< 0.01	0.09	93.25	0.22	1.63	100.05
16187	208 226	3.35	< 0.01	0.09	0.51	0.06	< 0.01	< 0.01	< 0.01	0.10	93.96	0.10	1.78	99.99
16188	208 226	9.73	0.01	0.04	0.59	0.15	0.04	< 0.01	< 0.01	0.11	85.98	0.51	3.90	101.10
16189	208 226	22.36	0.19	0.03	1.11	0.36	0.16	< 0.01	0.03	0.16	65.36	1.10	10.16	101.05
16190	208 226	3.67	< 0.01	0.09	0.61	0.06	0.01	< 0.01	< 0.01	0.10	94.16	0.13	1.53	100.40
16191	208 226	20.00	0.23	0.01	1.10	0.36	0.16	< 0.01	< 0.01	0.14	66.18	1.08	9.90	99.18
16192	208 226	23.85	0.26	< 0.01	1.12	0.45	0.19	< 0.01	< 0.01	0.15	60.37	1.15	11.28	98.85
16193	208 226	14.52	0.03	0.05	0.86	0.15	0.06	< 0.01	< 0.01	0.12	78.18	0.64	6.15	100.80
16194	208 226	8.90	< 0.01	0.07	0.60	0.08	0.03	< 0.01	0.01	0.12	86.60	0.60	3.64	100.65
16195	208 226	4.29	< 0.01	0.06	0.54	0.04	< 0.01	< 0.01	< 0.01	0.10	92.83	0.54	1.84	100.30
16196	208 226	16.29	0.19	0.08	0.91	0.16	0.08	< 0.01	0.01	0.14	72.80	0.77	8.99	100.45
16197	208 226	4.72	0.02	0.12	0.71	0.04	0.02	< 0.01	0.02	0.11	91.97	0.36	2.12	100.20
16198	208 226	20.29	0.31	0.01	1.15	0.22	0.11	< 0.01	< 0.01	0.13	61.48	0.94	14.80	99.46
16199	208 226	20.55	0.31	< 0.01	1.21	0.23	0.12	< 0.01	< 0.01	0.13	60.97	0.95	14.83	99.33
16200	208 226	22.44	0.36	0.04	1.07	0.27	0.15	< 0.01	0.10	0.15	58.10	1.02	15.79	99.50
16301	208 226	2.48	0.04	0.01	0.60	0.04	< 0.01	< 0.01	< 0.01	0.07	95.65	0.14	1.09	100.15
16302	208 226	3.83	< 0.01	0.03	0.57	0.04	< 0.01	< 0.01	< 0.01	0.07	93.95	0.25	1.50	100.30
16303	208 226	4.44	< 0.01	< 0.01	0.44	0.05	< 0.01	< 0.01	< 0.01	0.07	93.43	0.17	1.89	100.55
16304	208 226	27.28	0.12	< 0.01	1.09	0.43	0.14	< 0.01	< 0.01	0.15	59.19	1.26	11.50	101.20
16305	208 226	25.15	0.07	0.01	0.97	0.32	0.09	< 0.01	< 0.01	0.15	63.54	1.16	10.04	101.30
16306	208 226	8.75	< 0.01	0.05	0.76	0.09	0.02	< 0.01	< 0.01	0.11	87.34	0.51	3.55	101.20
16307	208 226	4.05	< 0.01	0.06	0.44	0.04	< 0.01	< 0.01	< 0.01	0.09	94.02	0.24	1.67	100.65
16308	208 226	3.33	< 0.01	0.06	0.49	0.04	< 0.01	< 0.01	< 0.01	0.09	95.37	0.12	1.28	100.80
16309	208 226	2.76	< 0.01	0.07	0.42	0.03	< 0.01	< 0.01	< 0.01	0.09	95.48	0.10	0.99	99.98
16310	208 226	4.93	< 0.01	0.07	0.45	0.03	0.01	< 0.01	< 0.01	0.10	92.18	0.09	2.01	99.90
16311	208 226	5.10	< 0.01	0.08	0.44	0.02	0.01	< 0.01	< 0.01	0.10	92.25	0.09	2.13	100.25
16312	208 226	9.91	< 0.01	0.08	0.46	0.03	0.01	< 0.01	< 0.01	0.12	86.30	0.24	4.07	101.25
16313	208 226	4.35	< 0.01	0.08	0.55	0.03	< 0.01	< 0.01	< 0.01	0.10	93.42	0.21	1.76	100.55
16314	208 226	4.06	< 0.01	0.08	0.58	0.04	0.01	< 0.01	0.01	0.10	93.16	0.15	1.74	99.97
16315	208 226	4.71	< 0.01	0.10	0.58	0.04	0.01	< 0.01	0.01	0.10	92.48	0.15	2.00	100.20
16316	208 226	4.31	0.02	0.11	0.69	0.05	0.03	< 0.01	0.03	0.10	92.47	0.13	1.80	99.75
16351	208 226	3.62	0.01	0.10	0.61	0.11	0.02	< 0.01	0.01	0.10	93.61	0.31	1.54	100.05
16352	208 226	4.73	< 0.01	0.11	0.66	0.10	0.02	< 0.01	0.01	0.10	92.74	0.31	1.77	100.55
16353	208 226	6.41	0.01	0.10	0.59	0.12	0.03	< 0.01	0.01	0.11	90.56	0.42	2.81	101.20
16354	208 226	5.29	< 0.01	0.09	0.55	0.11	0.02	< 0.01	< 0.01	0.11	91.64	0.34	2.24	100.40

CERTIFICATION:

P. C. Taylor



Chemex Labs Ltd.

Analytical Chemists • Geochemists • Registered Assayers
212 Brooksbank Ave., North Vancouver
British Columbia, Canada V7J 2C1
PHONE: 604-984-0221

To: MINERAL RESEARCH CANADA INC.

1 INDUSTRIAL BLVD.
PARRY SOUND, ON
P2A 2W8

INVOICE NUMBER

I 9 3 1 0 1 3 9

BILLING INFORMATION

Date: 21-JAN-93
Project:
P.O. No.: 0054
Account: KJE
Comments: 930101T

Billing: For analysis performed on
Certificate A9310139

Terms: Payment due on receipt of invoice
1.25% per month (15% per annum)
charged on overdue accounts

Please Remit Payments to:

CHEMEX LABS LTD.
212 Brooksbank Ave.,
North Vancouver, B.C.
Canada V7J 2C1

OF SAMPLES ANALYSED FOR CODE - DESCRIPTION

80 A-12 W.R.A ICP
Prep Quote

UNIT PRICE	SAMPLE PRICE	AMOUNT
------------	--------------	--------

18.00		
3.51	21.51	1720.80

Total Cost \$		1720.80
(Reg# R10093885)	GST \$	120.46

TOTAL PAYABLE (CDN) \$ 1841.26



Chemex Labs Ltd.

Analytical Chemists * Geochemists * Registered Assayers
212 Brooksbank Ave., North Vancouver
British Columbia, Canada V7J 2C1
PHONE: 604-984-0221

To: MINERAL RESEARCH CANADA INC.

1 INDUSTRIAL BLVD.
PARRY SOUND, ON
P2A 2W8

INVOICE NUMBER I 9 3 1 0 1 4 0

BILLING INFORMATION

Date: 21-JAN-93

Project:

P.O. No.: 0054

Account: KJE

Comments: 930101T

Billing:

For analysis performed on
Certificate A9310140

Terms:

Payment due on receipt of invoice
1.25% per month (15% per annum)
charged on overdue accounts

Please Remit Payments to:

CHEMEX LABS LTD.
212 Brooksbank Ave.,
North Vancouver, B.C.
Canada V7J 2C1

# OF SAMPLES	ANALYSED FOR CODE - DESCRIPTION	UNIT PRICE	SAMPLE PRICE	AMOUNT
102	A-12 W.R.A ICP Prep Quote	18.00 3.51	21.51	2194.02
		Total Cost \$		2194.02
		(Reg# R10093885) GST \$		153.58
		TOTAL PAYABLE (CDN) \$		2347.60

SONIC DRILL HOLE RECORD

Drilling Started: Mar. 8, 1992	Logged By: A. Casselman
Drilling Finished: Mar. 9, 1992	Logged: Mar. 29, 1993
Drilling Co.: J. R. Drilling	Core Size: 3.5"
Dip: -90°	Core Storage:
Hole Length: 250.0'	Mineral Research Canada
Overburden Depth: 52.0'	R. R. # 2
Claim No.: P825798	Parry Sound, ON
Easting: 5250 E	P2A 2W8
Northing: 290 N	Hole No.: 92-9
Azimuth: 50° 08' 57" W. 82° 09' 05" N.	
Location: 850.0' at 175° To Claim Post No. 1	
Property: Kipling	

SUMMARY

From	To	Description
0.0'	42.0'	Glacial Clay Till Overburden - Pleistocene
42.0'	47.0'	Kaolin Silica Sand (Kss) Cretaceous
47.0'	50.0'	Kss & Clay
50.0'	57.0'	Kss
57.0'	67.0'	Clay
67.0'	79.0'	Sandy Clay
79.0'	98.0'	Kss
98.0'	102.0'	Sandy Clay
102.0'	106.0'	Kss
106.0'	109.5'	Sandy Clay
109.5'	142.0'	Kss
142.0'	150.0'	Kss & Sandy Clay
150.0'	160.5'	Kss
160.5'	163.0'	Clay
163.0'	178.5'	Kss
178.5'	183.0'	Sandy Clay
183.0'	201.0'	Kss
201.0'	212.5'	Sandy Clay
212.5'	244.5'	Kss
244.5'	250.0'	Clay

EOH - 250.0'

N.B. - severe labelling problem by drillers from 36.0' - 97.0'.

Detail Log - 92-9

From	To	Sample No.	Description
0.0'	42.0'		Glacial Clay Till - competent, fissile, calcareous, dark green/brown, frequent gneissic and carbonate clasts.
42.0'	44.0'	17001	Kss - white, medium grain, minor illite and heavies, calcareous exterior at upper footage, 7.34% kaolin.
44.0'	47.0'	17002	Kss - as above, 8.00% kaolin.
47.0'	50.0'	17003	Kss & Clay - 47.0' - 47.5' - kss - as above, 47.5' - 48.0' - clay - highly pliable, competent, yellow/brown, some medium brown and purple mottling, 48.0' - 49.0' - coarse grain, vari-coloured silica, 49.0' - 50.0' - fine grain, white, minor illite and heavies, 19.24% kaolin.
50.0'	57.0'	17004	Kss - as above, coarser with some clay clotting at lower bag contact, 10.18% kaolin.
57.0'	62.0'	17005	Clay - competent, pliable, grey first 4.0", then light yellow, minor grey mottling, some dried, fissile due to ariel exposure, becoming grey after 59.0' - some yellow mottling, red & buff mottled from 61.0' - 61.25', then grey, silty & illitic, 70.41% kaolin.
62.0'	67.0'	17006	Clay - competent, weakly pliable, grey & yellow mottled, grading to yellow/green, grey & red mottled to grey, 67.72% kaolin.
67.0'	72.0'	17007	Sandy Clay - light grey, competent, illitic, some darker purple laminations, 47.14% kaolin.
72.0'	75.0'	17008	Sandy Clay - as above, lower clay content, 45.95% kaolin.
75.0'	79.0'	17009	Sandy Clay - as above, 7.47% kaolin.
79.0'	85.0'	17010	Kss - white, medium grain, minor illite and heavies, 9.34% kaolin.

85.0'	91.0'	17011	Kss - as above, 10.03% kaolin.
91.0'	98.0'	17012	Kss - as above, slightly coarser, 6.13% kaolin.
98.0'	102.0'	17013	Sandy Clay - light grey, minor illite and heavies, 17.04% kaolin.
102.0'	106.0'	17014	Kss - fine grain, light grey, minor illite and heavies, 15.57% kaolin.
106.0'	109.5'	17015	Sandy Clay - as previous, 29.44% kaolin.
109.5'	115.0'	17016	Kss - medium grain, white, minor illite and heavies, 13.24% kaolin.
115.0'	120.0'	17017	Kss - medium grain, as above, coarsening downsection to coarse grain vari-coloured silica, white, minor illite and heavies, drill core gouging, 7.92% kaolin.
120.0'	124.0'	17018	Kss - as above from 120.0' - 123.0', 123.0' - 124.0' - medium grain, some yellow staining, as previous, Devonian clast at 122.5', pitted dolostone, buff, 2.0", angular, fossiliferous, crinoid, 13.65% kaolin.
124.0'	128.0'	17019	Kss - medium grain, as above, 7.52% kaolin.
128.0'	132.0'	17020	Kss - as above.
132.0'	137.0'	17021	Kss - as above, some drilling debris, fining downsection to fine grain.
137.0'	142.0'	17022	Kss - as above, medium grain.
142.0'	150.0'	17023	Kss - as above from 142.0' - 144.0', sandy clay from 144.0' - 150.0' - fine grain, light grey, illitic, very pliable, competent, heavies concentrations, becoming finer grain downsection.
150.0'	155.0'	17024	Kss - as above, fine grain.
155.0'	160.5'	17025	Kss - drill core gouging, medium grain, white, minor illite and heavies, 159.0' - 160.5' - coarse grain, vari-coloured silica, buff, pliable, clay clotting.
160.5'	163.0'	17026	Clay - competent, fragmented, medium yellow/brown, pliable, highly moulded.

163.0'	169.0'	17027	Kss - coarse grain, vari-coloured silica in a medium grain matrix from 163.0' - 164.0', becoming medium grain, white, minor illite and heavies.
169.0'	171.0'	17028	Kss - medium grain, white, minor illite and heavies, heavies banding.
171.0'	175.0'	17029	Kss - as above, at 171.5' large clast, drill cut Devonian, 5.5", fossiliferous, corals, crinoids, brachipods, stylolitic-like laminations, darker grey sections, light grey overall, cherty area, 174.0' - banded chert/dolostone, grey, sub-rounded, chert as rip up clasts and well as laminations yellow/brown.
175.0'	178.5'	17030	Kss - as above.
178.5'	181.0'	17031	Sandy Clay - fine grain, illitic, grey becoming buff, more clay-rich downsection.
181.0'	189.0'	17032	Kss - white, becoming light grey, minor illite and heavies, fine grain.
189.0'	193.0'	17033	Kss - white, as above.
193.0'	196.0'	17034	Kss - as above.
196.0'	201.0'	17035	Kss - as above.
201.0'	203.0'	17036	Sandy Clay - buff, illitic, pliable, competent, darker more clay-rich sections.
203.0'	207.0'	17037	Sandy Clay - as above, drill core gouging.
207.0'	212.5'	17038	Sandy Clay - as above.
212.5'	215.0'	17039	Kss - fine grain, white, minor illite and heavies.
215.0'	218.0'	17040	Kss - medium grain, light grey, minor illite and heavies, high liquid content, washed out, drilling debris with some rusty staining, less pliable downsection, sulphureous smell, some hematitic laminations.
218.0'	222.0'	17041	Kss - as above, becoming white, Devonian clast at 221.5' - 1.5", angular convolute laminations, darker upper surface lighter lower surface bonded silica grains on exterior as well as <i>in situ</i> hematite nodules on the exterior.

222.0'	225.0'	17042	Kss - medium grain, as above, white, high percentage heavies, 0.5' sandy clay at 223.5', dark buff, illitic, competent, pliable, kss fine grain 224.0' - 225.0'.
225.0'	228.0'	17043	Kss - fine grain, light brown to white, minor illite and heavies, clay-rich in areas.
228.0'	231.0'	17044	Kss - as above, heavies concentrations.
231.0'	234.0'	17045	Kss - as above.
234.0'	237.0'	17046	Kss - as above.
237.0'	239.5'	17047	Kss - as above, light brown, yellow & grey at lower contact.
239.5'	243.0'	17048	Clay - chocolate brown, competent, pliable, illitic, some lighter sandy sections, carbonaceous, less pliable downsection, sulphureous smell, some hematitic laminations.
243.0'	244.5'	17049	Kss - fine grain, minor illite and heavies for first third, second third clay-rich chocolate brown, sandy clay, last third yellow and medium brown laminated.
244.5'	250.0'	17050	Clay - chocolate brown, competent, very pliable, carbonaceous, illitic.

EOH - 250.0'

Section 92-9

Claim No.: P825798

Hole Length: 250.0'

Overburden Depth: 42.0'

Astronomic Azimuth: 50° 08' 57" W. 82° 09' 05" N

Location: 850.0' at 175° to claim post no. 1

Scale: 1.0" = 50.0' or 1:600

Northing: 290 N

Easting: 5250 E

Dip: -90°

50.0'

Gridline 5300

Section 92-9

Claim No.: P825798

Hole Length: 250.0'

Overburden Depth: 42.0'

Astronomic Azimuth: $50^{\circ} 08' 57''$ W. $82^{\circ} 09' 05''$ N

Location: 850.0' at 175° to claim post no. 1

Scale: 1.0" = 50.0' or 1:600

Northing: 290 N

Easting: 5250 E

Dip: -90°

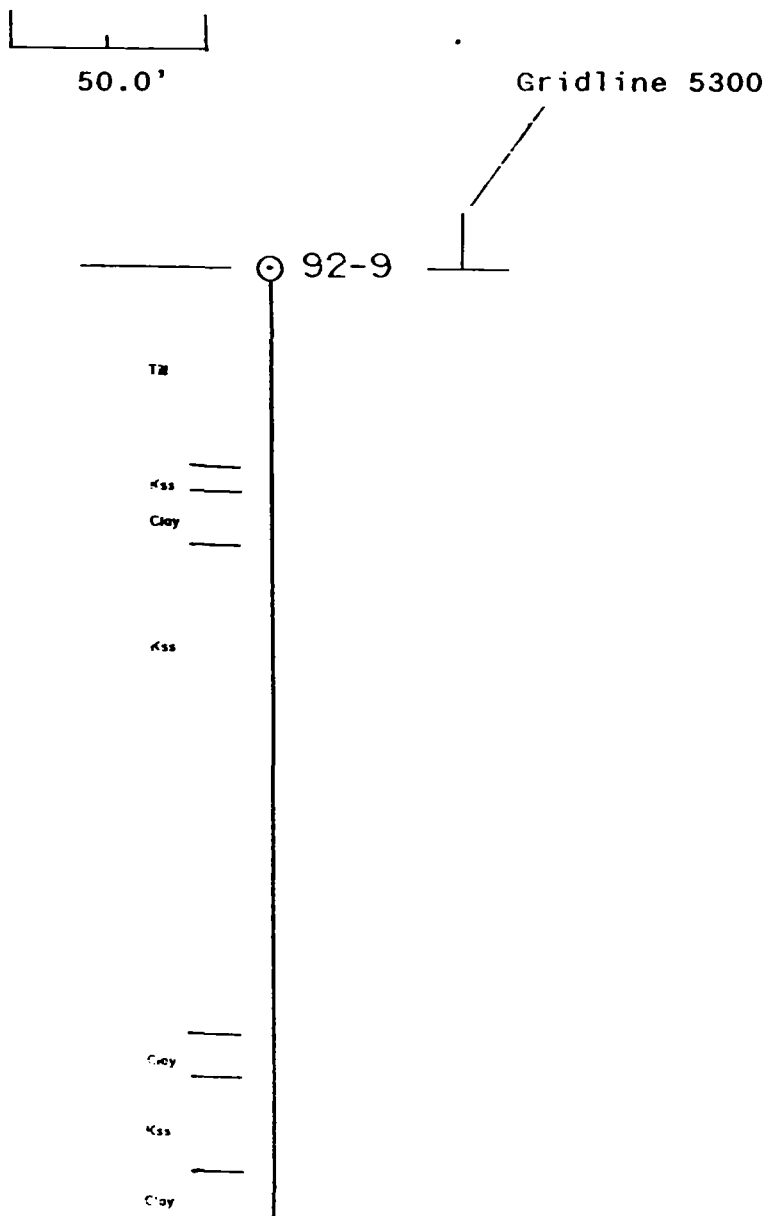

SONIC DRILL HOLE RECORD

Drilling Started: Mar. 1, 1992	Logged By: A. Casselman
Drilling Finished: Mar. 1, 1992	Logged: Mar. 23, 1993
Drilling Co.: J. R. Drilling	Core Size: 3.5"
Dip: -90°	Core Storage:
Hole Length: 240.0'	Mineral Research Canada
Overburden Depth: 55.0'	R. R. # 2
Claim No.: P 825802	Parry Sound, ON
Easting: 5500 E	P2A 2W8
Northing: 360 N	
Azimuth: 50° 08' 59" W. 82° 08' 49" N.	
Location: 500.0' at 269° To Claim Post No. 1	
Property: Kipling	Hole No.: 92-15

SUMMARY

From	To	Description
0.0'	55.0'	Glacial Clay Till Overburden - Pleistocene
55.0'	60.0'	Contact Zone - Kaolin S. S. - Glacial/Cretaceous
60.0'	61.5'	Clay
61.5'	78.0'	Kaolin Silica Sand (Kss)
78.0'	86.25'	Clay
86.25'	96.0'	Sandy Clay
96.0'	101.0'	Kss/Sandy Clay
101.0'	137.0'	Kss
137.0'	142.0'	Clay & Kss - alternating
142.0'	147.0'	Kss
147.0'	152.0'	Kss & Clay
152.0'	157.0'	Kss
157.0'	163.0'	Clay & Kss
161.0'	163.0'	Clay
163.0'	167.0'	Sandy Clay
167.0'	176.5'	Kss
176.5'	184.0'	Sandy Clay
184.0'	235.5'	Kss
235.5'	240.0'	Clay

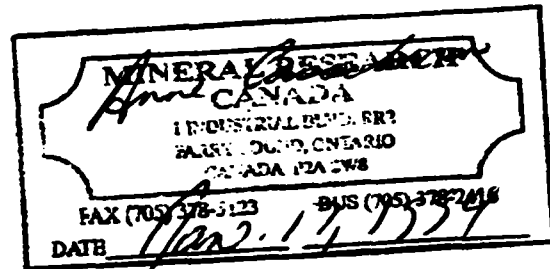

EOH - 240.0'

Detail Log - 92-15

From	To	Sample No.	Description
0.0'	55.0'		Glacial Clay Till - competent, calcareous, dark green/brown, frequent gneissic and carbonate clasts - angular up to 3.5", some sandy areas.
55.0'	60.0'	16951	Contact Zone Kss - calcareous, dark green/brown, medium grain, 4.0% kaolin.
60.0'	61.5'	16952	Clay - chocolate brown with lighter brown discontinuous laminations, pliable, competent, external kss contamination, 58.33% kaolin.
61.5'	65.0'	16953	Kss - medium grain, light brown, minor illite and heavies, a finer, darker more clay-rich portion from 63.0' - 64.0', 7.32% kaolin.
65.0'	69.0'	16954	Kss - white, medium grain, minor illite and heavies, one area of yellow more clay-rich material, 6.91% kaolin.
69.0'	73.0'	16955	Kss - as above, some fine grain areas, 6.03% kaolin.
73.0'	78.0'	16956	Kss - as above, slightly coarser grain, 7.01% kaolin.
78.0'	81.0'	16957	Clay - drill core gouging, fragmented, medium brown with yellow discontinuous laminations, pliable, 74.61% kaolin.
81.0'	86.25'	16958	Clay - competent, silty, less so downsection, buff & yellow mottled to buff, red and yellow mottled to red and buff mottled to red, yellow & buff to buff & yellow with some purple areas to red & buff mottled, weakly pliable, 53.72% kaolin.
86.25'	91.0'	16959	Sandy Clay - buff, fine grain, grading downsection to clay-rich, fine grain, kss, some purple areas, some heavies, high percentage illite and large flake muscovite, 19.92% kaolin.
91.0'	96.0'	16960	Sandy Clay - as above, 15.54% kaolin.
96.0'	101.0'	16961	Kss/Sandy Clay - as above, less clay-rich, nearly kss, 16.0% kaolin.

101.0'	106.0'	16962	Kss - as above, 7.39% kaolin.
106.0'	111.0'	16963	Kss - fine grain, white, heavies banding in grey areas, minor illite and heavies, 8.94% kaolin.
111.0'	114.0'	16964	Kss - medium grain, white, minor illite and heavies, 4.81% kaolin.
114.0'	117.0'	16965	Kss - as above, large percentage heavies as garnet - some banding, 6.08% kaolin.
117.0'	122.0'	16966	Kss - medium grain, white, minor illite and heavies (garnet), rare larger smoky quartz clasts, 9.29% kaolin.
122.0'	127.0'	16967	Kss - white, medium grain grading downsection to coarse grain, vari-coloured silica, minor illite and heavies, 13.29% kaolin.
127.0'	132.0'	16968	Kss - as above, 9.01% kaolin.
132.0'	137.0'	16969	Kss - as above from 132.0' - 136.0', 136.0' - 137.0' - medium grain, yellow/brown with 3.0" of pliable light and medium brown discontinuous laminations, 13.70% kaolin.
137.0'	142.0'	16970	Clay & Kss - buff, pliable, competent, clay with some purple from 137.0' - 138.0', kss mottling first 3.0", 138.0' - 139.0' - kss/sandy clay - medium grain, yellow/brown, 139.0' - 140.0' - light yellow, medium grain kss, 140.0' - 142.0' - competent, pliable, buff with discontinuous medium brown laminations and coarse grain kss mottling at lower contact, 36.28% kaolin.
142.0'	147.0'	16971	Kss - clay-rich, with some light brown clay mottling at upper contact becoming medium grain, white, with minor heavies and illite, 11.98% kaolin.
147.0'	152.0'	16972	Kss & Clay - kss - 147.0' - 149.5' - medium grain, light brown, some clay mottling, clay-rich, larger clasts, 149.5' - 150.5' - clay - chocolate brown, fragmented, drill core gouging, pliable, 150.5' - 152.0' - kss - medium grain white, minor illite and heavies, rare larger sub-rounded vari-coloured silica,

23.32% kaolin.

152.0'	157.0'	16973	Kss - medium grain, white, some yellow/brown contamination, frequent larger vari-coloured silica, minor illite and heavies, some finer grain grey areas, 6.25% kaolin.
157.0'	161.0'	16974	Clay & Kss - alternating - kss - medium brown, coarse grain in a medium grain matrix, some clay mottling from 157.0' - 158.0', 158.0' - 158.5' - clay - highly pliable, competent, medium brown with chocolate brown mottling, 158.5' - 159.5' - kss - medium grain, medium brown, minor illite and heavies, 159.5' - 160.5' - first 3/4 medium brown, pliable, competent chocolate brown, last 0.5' kss coarse grain, light brown with clay mottling, 34.30% kaolin.
161.0'	163.0'	16975	Clay - chocolate brown, competent, weakly pliable, more so downsection, illitic, some lighter silty laminations alternating, 50.10% kaolin.
163.0'	167.0'	16976	Sandy Clay - grading to Kss - light brown, fine grain, illitic, 18.28% kaolin.
167.0'	171.0'	16977	Kss - light brown, medium grain, minor illite and heavies, 9.70% kaolin.
171.0'	176.5'	16978	Kss - medium grain, white, minor illite and heavies, some clay clotting, buff, pliable at 171.0', last 1.5', clay-rich, light brown, 7.92% kaolin.
176.5'	184.0'	16979	Sandy Clay - buff, competent, weakly pliable, illitic, some chocolate clay mottling, fine grain, drill core gouging, fragmented in areas, 47.16% kaolin.
184.0'	191.0'	16980	Kss - medium grain, white, minor illite and heavies, 4.76% kaolin.
191.0'	196.0'	16981	Kss - as above, 5.39% kaolin.
196.0'	199.0'	16982	Kss - medium grain, becoming coarse grain in a medium grain matrix, vari-coloured silica, minor illite and heavies, 198.0' - 199.0' - buff, pliable illitic sandy clay, 22.33% kaolin.
199.0'	203.0'	16983	Kss - fine grain, light grey, minor illite and heavies, 16.33% kaolin.

203.0'	208.0'	16984	Kss - as above, high percentage heavies, drilling debris, 7.14% kaolin.
208.0'	212.0'	16985	Kss - medium grain, grading to coarse grain, minor illite and high percentage heavies, white, 8.53% kaolin.
212.0'	216.0'	16986	Kss - white, coarse grain, vari-coloured silica, Devonian siltstone clast, light grey, <i>in situ</i> hematite formation on surface, fossiliferous, unidentifiable, coral? at 213.0', 7.06% kaolin.
216.0'	220.0'	16987	Kss - as above from 216.0' - 217.0', 217.0' - 220.0' - medium grain, white, minor illite and heavies, 6.71% kaolin.
220.0'	225.0'	16988	Kss - as above, medium grain, high percentage heavies, garnet, some finer areas, 8.08% kaolin.
225.0'	230.0'	16989	Kss - light brown, medium grain, with frequent larger clasts, minor illite and heavies, sulphureous smell, 9.42% kaolin.
230.0'	235.0'	16990	Kss - as above, medium brown and grey, some yellow areas, 8.71% kaolin.
235.0'	237.5'	16991	Kss - chocolate brown, some yellow as above, some chocolate brown clay mottling, 13.04% kaolin.
237.5'	240.0'	16992	Clay - competent, chocolate brown, weakly pliable, yellow mottling, some sandy laminations, sulphureous smell, 59.19% kaolin.

EOH - 240.0'

Section - 92-15

Claim No.: P 825802

Hole Length: 240.0'

Overburden Depth: 55.0'

Astronomic Azimuth: $50^{\circ} 08' 59''$ W. $82^{\circ} 08' 49''$ N

Location: 500.0' at 269° to claim post no. 1

Scale: 1.0" = 50.0'

Northing: 360 N

Easting: 5500 E

Dip: -90°

50.0'

Gridline 5500

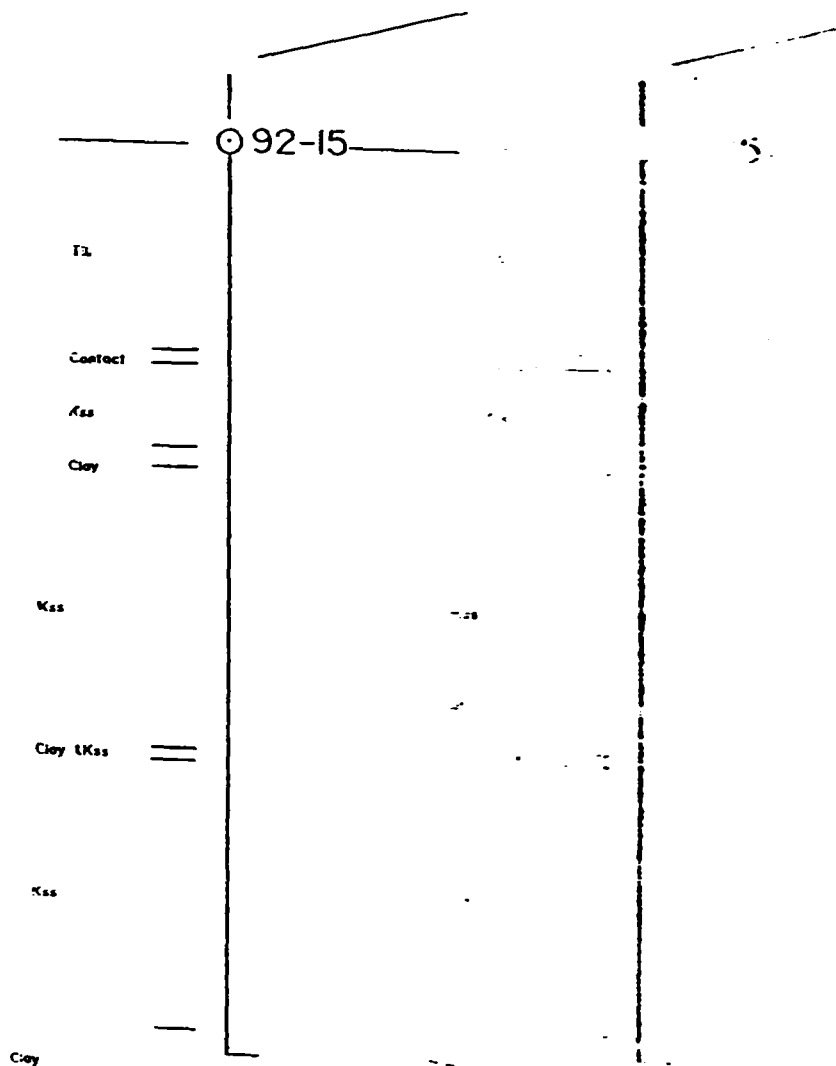

Section - 92-15

Claim No.: P 825802

Hole Length: 240.0'

Overburden Depth: 55.0'

Astronomic Azimuth: 50° 08' 59" W. 82° 08' 49" N

Location: 500.0' at 269° to claim post no. 1

Scale: 1.0" = 50.0'

Northing: 360 N

Easting: 5500 E

Dip: -90°

50.0'

Gridline 5500

92-15

10951	4.80%
10952	54.33%
10953	2.37%
10954	4.97%
10955	6.83%
10956	7.87%
10957	76.87%
10958	53.72%
10959	91.92%
10960	15.54%
10961	11.88%
10962	2.39%
10963	8.94%
10964	4.80%
10965	4.88%
10966	1.29%
10967	13.27%
10968	9.17%
10969	13.20%
10970	34.30%
10971	11.98%
10972	71.37%
10973	6.23%
10974	34.30%
10975	58.87%
10976	11.20%
10977	9.78%
10978	7.12%
10979	47.16%
10980	4.76%
10981	5.30%
10982	22.33%
10983	11.33%
10984	7.14%
10985	15.37%
10986	7.85%
10987	4.77%
10988	4.88%
10989	14.27%
10990	4.77%
10991	13.84%
10992	54.88%



Chemex Labs Ltd.

Analytical Chemists * Geochemists * Registered Assayers
212 Brooksbank Ave., North Vancouver
British Columbia, Canada V7J 2C1
PHONE: 804-984-0221

TO: MINERAL RESEARCH CANADA INC.

1 INDUSTRIAL BLVD.
PARRY SOUND, ON
P2A 2W8

INVOICE NUMBER

I 9 3 1 9 9 8 9

BILLING INFORMATION

Date: 10-SEP-93
Project: KIPLING
P.O. No.: 0054
Account: KJE
Comments: 930101T

Billing:

For analysis performed on
Certificate A9319989

Terms:

Payment due on receipt of invoice
1.25% per month (15% per annum)
charged on overdue accounts

Please Remit Payments to:

CHEMEX LABS LTD.
212 Brooksbank Ave.,
North Vancouver, B.C.
Canada V7J 2C1

# OF SAMPLES	ANALYSED FOR CODE - DESCRIPTION	UNIT PRICE	SAMPLE PRICE	AMOUNT
-----------------	------------------------------------	---------------	-----------------	--------

42	A-12 W.R.A ICP	18.00		
	0-5 lb prep quote	3.51	21.51	903.42

(Reg# R100938885)		Total Cost \$	903.42
		GST \$	63.24
TOTAL PAYABLE (CDN) \$			966.66



Chemex Labs Ltd.
Analytical Chemists * Geochemists * Registered Assayers
5175 Timberlea Blvd., Mississauga,
Ontario, Canada L4W 2S3
PHONE: 416-624-2808

To: MINERAL RESEARCH CANADA INC.
1 INDUSTRIAL BLVD.
PARRY SOUND, ON
P2A 2W8
Project: KIPLING
Comments: ATTN: ANNE CASSELMAN

Page Number: 11
Total Pages: 12
Certificate Date: 08-SEP-93
Invoice No.: 19319989
P.O. Number: 0054
Account: KJE

CERTIFICATE OF ANALYSIS A9319989

SAMPLE	PREP CODE	Al2O3 %	CaO %	Cr2O3 %	Fe2O3 %	K2O %	MgO %	MnO %	Na2O %	P2O5 %	SiO2 %	TiO2 %	LOI %	TOTAL %
2130	208 226	19.00	0.32	0.08	1.20	0.33	0.17	< 0.01	0.13	0.10	69.76	0.88	8.73	100.70
2131	208 226	3.12	0.16	0.06	0.43	0.11	0.06	< 0.01	0.13	0.06	94.77	0.15	1.29	100.35
2132	208 226	4.17	0.17	0.09	0.65	0.13	0.07	< 0.01	0.14	0.07	92.29	0.24	1.53	99.86
2133	208 226	7.76	0.19	0.13	0.78	0.18	0.10	< 0.01	0.16	0.09	87.51	0.49	3.08	100.50
2134	208 226	16.46	0.24	0.10	0.93	0.40	0.16	< 0.01	0.18	0.09	77.17	0.89	5.99	100.65
2135	208 226	3.39	0.19	0.15	0.58	0.11	0.09	< 0.01	0.22	0.10	93.24	0.31	1.31	99.80
2136	208 226	6.28	0.32	0.16	1.02	0.17	0.14	< 0.01	0.23	0.12	85.58	0.32	3.48	99.83
2137	208 226	5.04	0.22	0.14	0.74	0.11	0.09	< 0.01	0.21	0.10	91.64	0.19	1.89	100.40
2138	208 226	14.19	0.43	0.19	1.14	0.19	0.15	< 0.01	0.24	0.11	74.11	0.76	8.78	100.30
2139	208 226	3.97	0.24	0.18	0.56	0.11	0.11	< 0.01	0.29	0.12	93.37	0.16	1.42	100.55
2140	208 226	5.10	0.21	0.16	0.75	0.10	0.08	< 0.01	0.20	0.09	91.08	0.34	1.85	99.80
2141	208 226	3.16	0.17	0.09	0.51	0.08	0.06	< 0.01	0.13	0.07	94.45	0.32	0.29	99.24
2142	208 226	4.22	0.17	0.07	0.64	0.09	0.06	< 0.01	0.11	0.06	92.41	0.25	1.72	100.00
2143	208 226	3.77	0.24	0.10	1.16	0.14	0.06	< 0.01	0.11	0.06	92.43	0.10	1.86	100.15
2144	208 226	3.33	0.13	0.04	0.37	0.10	0.04	< 0.01	0.11	0.06	93.90	0.11	1.30	99.50
2145	208 226	3.47	0.22	0.08	0.80	0.17	0.06	< 0.01	0.12	0.05	93.87	0.16	1.48	100.30
2146	208 226	16.19	0.45	0.08	0.94	0.22	0.13	< 0.01	0.14	0.08	73.00	0.80	9.63	100.65
2147	208 226	24.03	0.45	0.07	1.24	0.30	0.17	< 0.01	0.16	0.07	55.68	0.98	17.08	100.25
2148	208 226	20.00	0.25	0.09	1.18	0.15	0.15	< 0.01	0.16	0.07	67.14	0.88	11.16	100.55
2149	208 226	20.60	0.44	0.06	1.12	0.33	0.25	< 0.01	0.18	0.07	63.44	1.32	11.99	99.81
2150	208 226	24.34	0.53	0.05	1.21	0.67	0.39	< 0.01	0.17	0.05	53.79	1.20	10.40	100.80
2151	208 226	18.95	0.24	0.02	1.16	0.52	0.22	< 0.01	0.10	0.04	70.08	1.20	8.11	100.65
2152	208 226	8.01	0.15	0.05	0.56	0.24	0.05	< 0.01	0.06	0.03	92.10	0.26	2.04	100.55
2153	208 226	8.12	0.15	0.06	0.72	0.20	0.06	< 0.01	0.08	0.04	87.17	0.37	3.27	100.25
2154	208 226	29.47	0.23	0.06	1.11	0.40	0.13	< 0.01	0.09	0.04	56.36	0.99	12.01	100.90
2155	208 226	5.22	0.14	0.04	0.55	0.18	0.04	< 0.01	0.05	0.04	91.46	0.29	2.23	100.25
2156	208 226	3.46	0.14	0.06	0.50	0.08	0.04	< 0.01	0.07	0.04	94.50	0.11	1.44	100.45
2157	208 226	8.24	0.19	0.09	0.89	0.24	0.11	< 0.01	0.11	0.07	85.59	0.89	3.47	99.90
2158	208 226	3.14	0.14	0.04	0.51	0.11	0.06	< 0.01	0.06	0.04	95.07	0.12	1.32	100.60
2159	208 226	4.90	0.16	0.09	0.66	0.12	0.07	< 0.01	0.12	0.06	91.21	0.40	2.07	99.89
2160	208 226	5.09	0.15	0.03	0.49	0.11	0.04	< 0.01	0.06	0.04	90.72	0.19	2.06	98.99
2161	208 226	8.82	0.18	0.06	0.69	0.15	0.07	< 0.01	0.11	0.04	85.94	0.47	3.54	100.10
2162	208 226	6.45	0.26	0.09	1.07	0.13	0.08	< 0.01	0.16	0.07	89.10	0.60	2.65	100.65
2163	208 226	2.82	0.16	0.13	0.93	0.09	0.06	< 0.01	0.14	0.08	93.33	0.83	1.26	99.82
2164	208 226	3.37	0.15	0.10	0.46	0.15	0.06	< 0.01	0.15	0.07	94.62	0.33	1.30	100.80
2165	208 226	2.79	0.18	0.08	0.77	0.15	0.06	< 0.01	0.16	0.06	94.40	0.10	1.24	100.00
2166	208 226	2.65	0.20	0.14	0.70	0.10	0.09	< 0.01	0.22	0.11	94.86	0.38	1.09	100.55
2167	208 226	3.19	0.20	0.13	0.81	0.13	0.08	< 0.01	0.20	0.09	94.09	0.19	1.29	100.40
2168	208 226	3.72	0.21	0.16	0.69	0.17	0.11	< 0.01	0.24	0.10	92.78	0.13	1.43	99.75
2169	208 226	3.44	0.11	0.03	0.59	0.18	0.03	< 0.01	0.09	0.03	93.70	0.22	1.63	100.05

CERTIFICATION:

Ann B. Borden



Chemex Labs Ltd.

Analytical Chemists * Geochemists * Registered Assayers
212 Brooksbank Ave., North Vancouver
British Columbia, Canada V7J 2C1
PHONE: 604-984-0221

To: MINERAL RESEARCH CANADA INC.

1 INDUSTRIAL BLVD.
PARRY SOUND, ON
P2A 2W8

INVOICE NUMBER

I 9 3 1 9 9 8 9

BILLING INFORMATION

Date: 10-SEP-93
Project: KIPLING
P.O. No.: 0054
Account: KJE
Comments: 930101T

Billing: For analysis performed on
Certificate A9319989

Terms: Payment due on receipt of invoice
1.25% per month (15% per annum)
charged on overdue accounts

Please Remit Payments to:

CHEMEX LABS LTD.
212 Brooksbank Ave.,
North Vancouver, B.C.
Canada V7J 2C1

# OF SAMPLES	ANALYSED FOR CODE - DESCRIPTION	UNIT PRICE	SAMPLE PRICE	AMOUNT
-----------------	------------------------------------	---------------	-----------------	--------

42	A-12 W.R.A ICP 0-5 lb prep quote	18.00 3.51	21.51	903.42
----	-------------------------------------	---------------	-------	--------

Total Cost \$ 903.42
(Reg# R100938885) GST \$ 63.24

TOTAL PAYABLE (CDN) \$ 966.66



Chemex Labs Ltd.

Analytical Chemists • Geochemists • Registered Assayers
5175 Timberlea Blvd., Mississauga,
Ontario, Canada L4W 2S3
PHONE: 416-624-2808

To: MINERAL RESEARCH CANADA INC.

1 INDUSTRIAL BLVD.
PARRY SOUND, ON
P2A 2W8

Project: KIPLING
Comments: ATTN: ANNE CASSELMAN

Page Number : 1
Total Pages : 2
Certificate Date: 08-SEP-93
Invoice No.: 19319989
P.O. Number : 0054
Account : KJE

CERTIFICATE OF ANALYSIS A9319989

SAMPLE	PREP CODE	Al2O3 %	CaO %	Cr2O3 %	Fe2O3 %	K2O %	HgO %	MnO %	Na2O %	P2O5 %	SiO2 %	TiO2 %	LOI %	TOTAL %
2130	208 226	19.00	0.32	0.08	1.20	0.33	0.17	< 0.02	0.13	0.10	69.76	0.88	8.73	100.70
2131	208 226	3.12	0.16	0.06	0.63	0.11	0.06	< 0.01	0.13	0.06	94.77	0.15	1.53	100.35
2132	208 226	4.17	0.17	0.09	0.65	0.13	0.07	< 0.01	0.14	0.07	92.29	0.24	1.53	99.56
2133	208 226	7.76	0.19	0.13	0.78	0.18	0.10	< 0.01	0.16	0.09	87.51	0.49	3.08	100.50
2134	208 226	14.46	0.24	0.10	0.93	0.40	0.18	< 0.01	0.18	0.09	77.17	0.89	5.99	100.65
2135	208 226	3.39	0.19	0.15	0.58	0.11	0.09	< 0.01	0.22	0.10	93.24	0.21	1.31	99.60
2136	208 226	8.28	0.32	0.16	1.02	0.17	0.14	< 0.01	0.23	0.12	85.58	0.32	3.48	99.83
2137	208 226	5.04	0.22	0.14	0.74	0.11	0.09	< 0.01	0.21	0.10	91.64	0.19	1.89	100.40
2138	208 226	14.19	0.43	0.19	1.14	0.19	0.15	< 0.01	0.24	0.11	74.11	0.76	8.78	100.30
2139	208 226	3.97	0.24	0.18	0.56	0.11	0.11	< 0.01	0.29	0.12	93.37	0.16	1.42	100.55
2140	208 226	5.10	0.21	0.16	0.75	0.10	0.08	< 0.01	0.20	0.09	91.08	0.24	1.85	99.87
2141	208 226	3.16	0.17	0.09	0.51	0.08	0.06	< 0.01	0.13	0.07	94.45	0.22	0.29	99.24
2142	208 226	4.22	0.17	0.07	0.64	0.09	0.06	< 0.01	0.11	0.06	92.61	0.25	1.71	100.00
2143	208 226	3.77	0.24	0.10	1.16	0.14	0.06	< 0.01	0.11	0.06	92.53	0.10	1.86	100.15
2144	208 226	3.33	0.13	0.04	0.37	0.10	0.04	< 0.01	0.11	0.06	93.90	0.11	1.30	99.50
2145	208 226	3.47	0.22	0.08	0.80	0.17	0.06	< 0.01	0.12	0.05	93.87	0.16	1.48	100.50
2146	208 226	16.19	0.45	0.08	0.94	0.22	0.13	< 0.01	0.14	0.08	72.00	0.80	9.63	100.65
2147	208 226	24.03	0.45	0.07	1.24	0.30	0.17	< 0.01	0.16	0.07	55.68	0.88	17.08	100.25
2148	208 226	20.00	0.25	0.09	1.18	0.40	0.15	< 0.01	0.16	0.07	67.18	0.88	10.16	100.55
2149	208 226	20.60	0.44	0.06	1.12	0.33	0.25	< 0.01	0.18	0.07	63.44	1.32	11.99	99.81
2150	208 226	24.34	0.53	0.05	1.21	0.67	0.39	< 0.01	0.17	0.05	53.79	1.20	18.40	100.80
2151	208 226	16.95	0.24	0.02	1.16	0.52	0.22	< 0.01	0.10	0.04	70.08	1.20	8.11	100.65
2152	208 226	5.01	0.15	0.05	0.56	0.24	0.05	< 0.01	0.06	0.03	92.10	0.26	2.04	100.55
2153	208 226	8.12	0.15	0.06	0.72	0.20	0.06	< 0.01	0.08	0.04	87.17	0.37	3.27	100.25
2154	208 226	29.47	0.23	0.06	1.11	0.40	0.13	< 0.01	0.09	0.04	56.36	0.89	12.01	100.90
2155	208 226	5.22	0.14	0.04	0.55	0.18	0.04	< 0.01	0.05	0.04	91.46	0.29	2.23	100.25
2156	208 226	3.46	0.14	0.06	0.50	0.08	0.04	< 0.01	0.07	0.04	94.50	0.11	1.44	100.45
2157	208 226	8.24	0.19	0.09	0.89	0.24	0.11	< 0.01	0.11	0.07	85.59	0.39	3.47	99.90
2158	208 226	3.14	0.14	0.04	0.51	0.11	0.06	< 0.01	0.06	0.04	95.07	0.12	1.32	100.60
2159	208 226	4.90	0.18	0.09	0.66	0.12	0.07	< 0.01	0.12	0.06	91.21	0.40	2.07	99.89
2160	208 226	5.09	0.15	0.03	0.49	0.11	0.04	< 0.01	0.06	0.04	90.72	0.19	3.06	99.99
2161	208 226	8.82	0.18	0.06	0.69	0.15	0.07	< 0.01	0.11	0.04	85.94	0.47	3.54	100.10
2162	208 226	6.45	0.26	0.09	1.07	0.12	0.08	< 0.01	0.16	0.07	89.10	0.60	2.65	100.65
2163	208 226	2.82	0.16	0.13	0.93	0.09	0.06	< 0.01	0.14	0.08	93.33	0.83	1.24	99.82
2164	208 226	3.37	0.15	0.10	0.48	0.15	0.06	< 0.01	0.15	0.07	94.62	0.33	1.30	100.80
2165	208 226	2.79	0.18	0.08	0.70	0.15	0.06	< 0.01	0.16	0.06	94.40	0.10	1.24	100.55
2166	208 226	2.65	0.20	0.14	0.77	0.10	0.09	< 0.01	0.22	0.11	94.86	0.38	1.09	100.99
2167	208 226	3.19	0.20	0.13	0.81	0.13	0.08	< 0.01	0.20	0.09	94.09	0.19	1.29	100.40
2168	208 226	3.72	0.21	0.16	0.69	0.17	0.11	< 0.01	0.24	0.10	92.78	0.13	1.43	99.75
2169	208 226	3.44	0.11	0.03	0.59	0.18	0.03	< 0.01	0.09	0.03	93.70	0.22	1.63	100.05

CERTIFICATION:

David B. Borden



Ministry of
Northern Development
and Mines

Report of Work Conducted After Recording Claim

Mining Act

Transaction Number

W9460.00036

Personal information collected
this collection should be
Sudbury, Ontario, P3E 6A

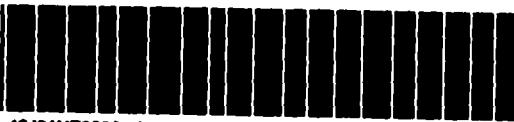

42J01NE0020 63.6350 KIPLING

900

will be used for correspondence. Questions about
and Mines, Fourth Floor, 359 Cedar Street

63.6350

assessment work or consult the Mining

Instructions:

- Please
- Ref.
- Rec.
- A separate copy of this form must be completed for each Work Group.
- Technical reports and maps must accompany this form in duplicate.
- A sketch, showing the claims the work is assigned to, must accompany this form.

Recorded Holder(s)

Great Lakes Kipling Inc.

Client No.

221553

Address

100 Shirley Ave. Kitchener, ON N2B 2E1

Telephone No.

(519) 744-8756

Mining Division

Township/Area

Easton Kipling

M or G Plan No.

Date Work Performed

From:

FEB. 26, 1992

To:

MAR. 9, 1992

AS PER M. MARTIN

Work Performed (Check One Work Group Only)

Work Group	Type
Geotechnical Survey	
Physical Work, including Drilling	
Rehabilitation	
Other Authorized Work	
Assays	
Assignment from Reserve	

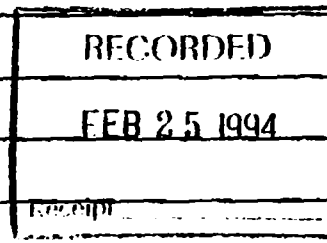
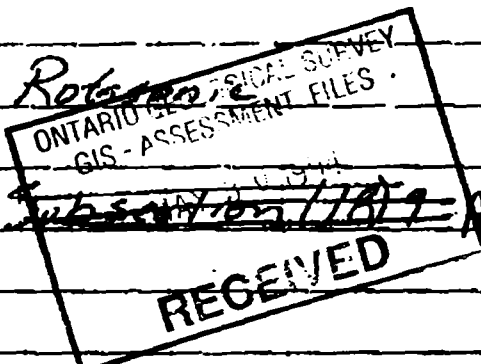

Total Assessment Work Claimed on the Attached Statement of Costs \$ 22,200

Note: The Minister may reject for assessment work credit all or part of the assessment work submitted if the recorded holder cannot verify expenditures claimed in the statement of costs within 30 days of a request for verification.

Persons and Survey Company Who Performed the Work (Give Name and Address of Author of Report)

Name	Address
Anne Casselman	Mineral Research Canada Inc.
Kenneth Malmstrom	P.O. #2, Pary, Saskatchewan S4A 0A3
J.R. Drilling	Gen. Del. Harknessville, MB R0X 0X0

(attach a schedule if necessary)

Certification of Beneficial Interest * See Note No. 1 on reverse side

I certify that at the time the work was performed, the claims covered in this work report were recorded in the current holder's name or held under a beneficial interest by the current recorded holder.	Date	Recorded Holder or Agent (Signature)
	JAN. 17/94	[Signature]

Certification of Work Report

I certify that I have a personal knowledge of the facts set forth in this Work report, having performed the work or witnessed same during and/or after its completion and annexed report is true.		
Name and Address of Person Certifying	Date	Certified By (Signature)
Anne Casselman - Mineral Research Canada Inc.	Jan. 24, 1994	Anne Casselman

For Office Use Only

Total Value Cr. Recorded	Date Recorded	Mining Recorder	RECEIVED (1st Rec'd) FEB 25 1994 TB
\$22,200	FEB. 25, 1994	[Signature]	
	Deemed Approval Date	Date Approved	
	MAY 26, 1994	MAY 3, 1994	
	Date Notice for Amendments Sent		
	APR. 12, 1994		

Numéro de rapport sur les travaux exécutés pour l'affectation de la réserve	Numéro de claim	Nombre d'unités
N/A	1112295	1
N/A	1112296	1
N/A	1112297	1
N/A	1112298	1
N/A	1112299	1
N/A	1112300	1
N/A	1112301	1
N/A	1112302	1
N/A	1112303	1
N/A	1112304	1
N/A	1112305	1
N/A	1112306	1
N/A	1112317	1
N/A	1112318	1
N/A	1112319	1
N/A	1112320	1
N/A	1112321	1
Nombre total de claims		

Valeur des travaux d'évaluation exécutés sur ce claim	Valeur affectée à ce claim
0	400
0	400
0	400
0	400
0	400
0	400
0	400
0	400
0	400
0	400
0	400
0	400
0	400
0	400
0	400
0	400
0	400
Valeur totale des travaux exécutés	
Valeur totale des travaux qui a été affectée	

Valeur transférée de ce claim	Réserve : travaux à réclamer à une date ultérieure
0	0
0	0
0	0
0	0
0	0
0	0
0	0
0	0
0	0
0	0
0	0
0	0
0	0
0	0
0	0
0	0
Total transféré	
Réserve totale	

Les crédits que vous réclamez dans le présent rapport peuvent être réduits. Afin de diminuer les conséquences défavorables de telles réductions, veuillez indiquer l'ordre dans lequel vous désirez qu'elles soient appliquées à vos claims. Veuillez cocher (✓) l'une des options suivantes :

1. ☐ Les crédits doivent être réduits en commençant par le dernier claim sur la liste.

2. ☐ Les crédits doivent être réduits également entre tous les claims figurant dans le présent rapport.

3. ☐ Les crédits doivent être réduits selon l'ordre donné en annexe.

Si vous n'avez pas choisi d'option, la première sera appliquée.

Note 1 : Exemples d'intérêts bénéficiaires : cessions non enregistrées, ententes sur des options, protocoles d'entente, etc. relatifs aux claims.

Note 2: Si des travaux ont été exécutés sur un terrain faisant l'objet de lettres patentes ou d'un bail, veuillez remplir ce qui suit:

J'é certifie que le titulaire enregistré possédait un intérêt bénéficiaire sur le terrain faisant l'objet de lettres patentes ou d'un bail, au moment où les travaux ont été exécutés.	Signature	Date
--	-----------	------

Work Report Number for Applying Reserve	Claim Number (see Note 2)	Number of Claim Units
N/A	1112322	1
N/A	1112323	1
N/A	1112324	1
N/A	1112325	1
N/A	1112326	1
N/A	1112327	1
N/A	1112328	1
N/A	1112329	1
N/A	1112330	1
N/A	1112331	1
N/A	1112332	1
N/A	1112333	1
N/A	1112334	1
N/A	1112335	1
N/A	1112336	1
N/A	1112337	1
N/A	1112338	1
Total Number of Claims		

Value of Assessment Work Done on this Claim	Value Applied to this Claim
0	400
0	400
0	400
0	400
0	400
0	400
0	400
0	400
0	400
0	400
0	400
0	400
0	400
0	400
0	400
0	400
0	400
Total Value Work Done	
Total Value Work Applied	

Value Assigned from this Claim	Reserve: Work to be Claimed at a Future Date
0	0
0	0
0	0
0	0
0	0
0	0
0	0
0	0
0	0
0	0
0	0
0	0
0	0
0	0
0	0
0	0
Total Assigned From	
Total Reserve	

Credits you are claiming in this report may be cut back. In order to minimize the adverse effects of such deletions, please indicate from which claims you wish to prioritize the deletion of credits. Please mark (✓) one of the following:

1. ☐ Credits are to be cut back starting with the claim listed last, working backwards.
2. ☐ Credits are to be cut back equally over all claims contained in this report of work.
3. ☐ Credits are to be cut back as prioritized on the attached appendix.

In the event that you have not specified your choice of priority, option one will be implemented.

Note 1: Examples of beneficial interest are unrecorded transfers, option agreements, memorandum of agreements, etc., with respect to the mining claims.

Note 2: If work has been performed on patented or leased land, please complete the following:

I certify that the recorded holder had a beneficial interest in the patented or leased land at the time the work was performed.	Signature	Date
---	-----------	------

Work Report Number for Applying Reserve	Claim Number (see Note 2)	Number of Claim Units	Value of Assessment Work Done on this Claim	Value Applied to this Claim	Value Assigned from this Claim	Reserve Work to be Claimed at a Future Date
N/A	825797	1	7500.00	0	7500.00	0
N/A	825798	1	7500.00	0	7500.00	0
N/A	825802	1	7200.00	0	7200.00	0
N/A	900095	1	1885.00	0	1800.00	85.00
N/A	112282	1	0	400.00	0	0
N/A	112283	1	0	400.00	0	0
N/A	112284	1	0	400.00	0	0
N/A	112285	1	0	400.00	0	0
N/A	112286	1	0	800.00 AC	0	0
N/A	112287	1	0	400.00	0	0
N/A	112288	1	0	400.00	0	0
N/A	112289	1	0	400.00	0	0
N/A	112290	1	0	400.00	0	0
N/A	112291	1	0	400.00	0	0
N/A	112292	1	0	400.00	0	0
N/A	112293	1	0	400.00	0	0
N/A	112294	1	0	400.00	0	0
Total Value			24000.00	24000.00	24000.00	85.00

Credits you are claiming in this report may be cut back. In order to minimize the adverse effects of such deletions, please indicate from which claims you wish to prioritize the deletion of credits. Please mark (✓) one of the following:

- ☐ Credits are to be cut back starting with the claim listed last, working backwards.
- ☒ Credits are to be cut back equally over all claims contained in this report of work.
- ☐ Credits are to be cut back as prioritized on the attached appendix.

In the event that you have not specified your choice of priority, option one will be implemented.

Note 1: Examples of beneficial interest are unrecorded transfers, option agreements, memorandum of agreements, etc., with respect to the mining claims.

Note 2: If work has been performed on patented or leased land, please complete the following:

certify that the recorder holder had a beneficial interest in the patented or leased land at the time the work was performed.	Signature	Date
---	-----------	------

Work Report Number for Applying Reserve	Claim Number (see Note 2)	Number of Claim Units
N/A	1112339	1
N/A	1112340	1
N/A	1112341	1
N/A	1112342	1
N/A	1112343	1
N/A	1112344	1
N/A	1112345	1
N/A	1112346	1
N/A	1112347	1
N/A	1112348	1
N/A	1112349	1
N/A	1112350	1
N/A	1112351	1
Total Number of Claims		

Value of Assessment Work Done on this Claim	Value Applied to this Claim
0	400
0	400
0	400
0	400
0	400
0	400
0	400
0	400
0	400
0	400
0	400
0	400
Total Value Work Done	
Total Value Work Applied	

Value Assigned from this Claim	Reserve: Work to be Claimed at a Future Date
0	0
0	0
0	0
0	0
0	0
0	0
0	0
0	0
0	0
0	0
0	0
Total Assigned From	
Total Reserve	

Credits you are claiming in this report may be cut back. In order to minimize the adverse effects of such deletions, please indicate from which claims you wish to prioritize the deletion of credits. Please mark (✓) one of the following:

1. ☐ Credits are to be cut back starting with the claim listed last, working backwards.
2. ☐ Credits are to be cut back equally over all claims contained in this report of work.
3. ☐ Credits are to be cut back as prioritized on the attached appendix.

In the event that you have not specified your choice of priority, option one will be implemented.

Note 1: Examples of beneficial interest are unrecorded transfers, option agreements, memorandum of agreements, etc., with respect to the mining claims.

Note 2: If work has been performed on patented or leased land, please complete the following:

I certify that the recorded holder had a beneficial interest in the patented or leased land at the time the work was performed.

Signature

Date



Ministry of
Northern Development
and Mines

Ministère du
Développement du Nord
et des mines

Statement of Costs
for Assessment Credit

État des coûts aux fins
du crédit d'évaluation

Mining Act/Loi sur les mines

Transaction No./N° de transaction

W9460.00036

Page (1)

Personal information collected on this form is obtained under the authority of the Mining Act. This information will be used to maintain a record and ongoing status of the mining claim(s). Questions about this collection should be directed to the Provincial Manager, Minings Lands, Ministry of Northern Development and Mines, 4th Floor, 159 Cedar Street, Sudbury, Ontario P3E 6A5, telephone (705) 670-7264.

Les renseignements personnels contenus dans la présente formule sont recueillis en vertu de la Loi sur les mines et serviront à tenir à jour un registre des concessions minières. Adresser toute question sur la collecte de ces renseignements au chef provincial des terrains miniers, ministère du Développement du Nord et des Mines, 159, rue Cedar, 4^e étage, Sudbury (Ontario) P3E 6A5, téléphone (705) 670-7264.

1. Direct Costs/Coûts directs

Type	Description	Amount Montant	Totals Total global
Wages Salaires	Labour Main-d'œuvre		
	Field Supervision Supervision sur le terrain		
Contractor's and Consultant's Fees Droits de l'entrepreneur et de l'expert- conseil			
	Rehabilitation drilling 7 10' x 12 30.00 = 22,200		
Supplies Used Fournitures utilisées	Type		
Equipment Rental Location de matériel	Type		

Total Direct Costs
Total des coûts directs

22,200

See page (2) *

+ 1885.00
= 24085

Note: The recorded holder will be required to verify expenditures claimed in this statement of costs within 30 days of a request for verification. If verification is not made, the Minister may reject for assessment work all or part of the assessment work submitted.

2. Indirect Costs/Coûts indirects

** Note: When claiming Rehabilitation work Indirect costs are not allowable as assessment work.
Pour le remboursement des travaux de réhabilitation, les coûts indirects ne sont pas admissibles en tant que travaux d'évaluation.

Type	Description	Amount Montant	Totals Total global
Transportation Transport	Type		
Food and Lodging Nourriture et hébergement			
Mobilization and Demobilization Mobilisation et démobilisation			

Sub Total of Indirect Costs
Total partiel des coûts indirects

Amount Allowable (not greater than 20% of Direct Costs)
Montant admissible (n'excedant pas 20 % des coûts directs)

Total Value of Assessment Credit
(Total of Direct and Allowable
Indirect costs)

Valeur totale du crédit
d'évaluation
(Total des coûts directs
et indirects admissibles)

Note : Le titulaire enregistré sera tenu de vérifier les dépenses demandées dans le présent état des coûts dans les 30 jours suivant une demande à cet effet. Si la vérification n'est pas effectuée, le ministre peut rejeter tout ou une partie des travaux.

Filing Discounts

- Work filed within two years of completion is claimed at 100% of the above Total Value of Assessment Credit.
- Work filed three, four or five years after completion is claimed at 50% of the above Total Value of Assessment Credit. See calculations below:

Total Value of Assessment Credit	Total Assessment Claimed
x 0.50 =	

Certification Verifying Statement of Costs

I hereby certify:

that the amounts shown are as accurate as possible and these costs were incurred while conducting assessment work on the lands shown on the accompanying Report of Work form.

that as President I am authorized
(Recorded Holder, Agent, Position in Company)

to make this certification

Remises pour dépôt

- Les travaux déposés dans les deux ans suivant leur achèvement sont remboursés à 100 % de la valeur totale susmentionnée du crédit d'évaluation.
- Les travaux déposés trois, quatre ou cinq ans après leur achèvement sont remboursés à 50 % de la valeur totale du crédit d'évaluation susmentionné. Voir les calculs ci-dessous.

Valeur totale du crédit d'évaluation	Évaluation totale demandée
x 0,50 =	

Attestation de l'état des coûts

J'atteste par la présente :

que les montants indiqués sont le plus exact possible et que ces dépenses ont été engagées pour effectuer les travaux d'évaluation sur les terrains indiqués dans la formule de rapport de travail ci-joint.

Et qu'à titre de President je suis autorisé
(titulaire enregistré, représentant, poste occupé dans la compagnie)

à faire cette attestation.

Signature	Date
<u>[Signature]</u>	JAN. 17/94

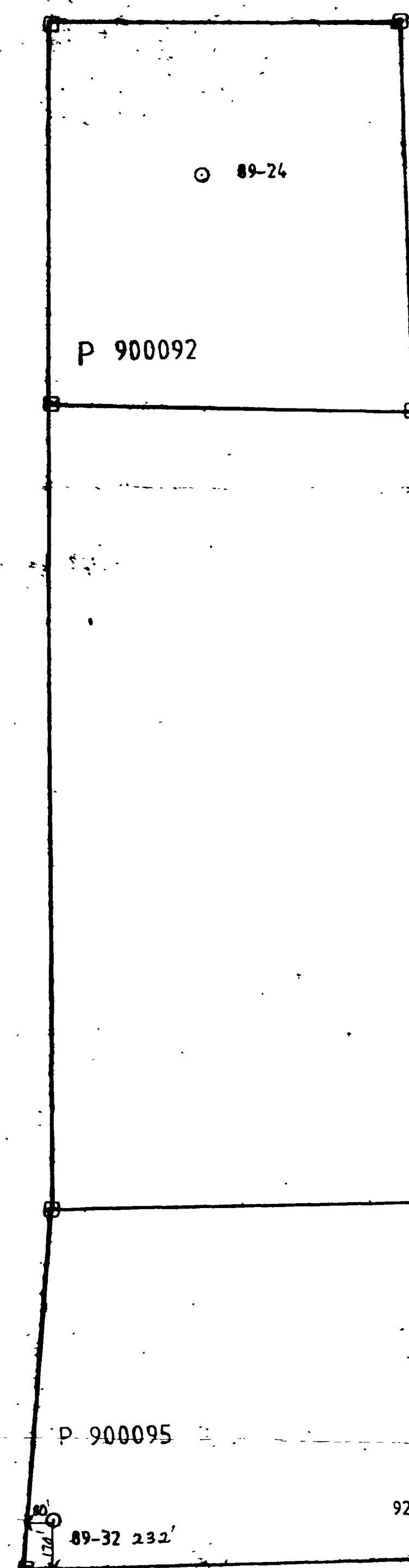

RISE OF MINING CLAIMS
P 825792, P 825793, P 825794, P 825795, P 825796, P 825797, P 825798,
P 825799, P 825800, P 825801, P 825802, P 825803, P 825804, P 825805,
P 825806, P 825807, P 825808, P 825809, P 825810 AND P 825811
TOWNSHIP OF KIPLING
DISTRICT OF COCHRANE
SCALE - 1 inch = 400 feet
1 : 4200

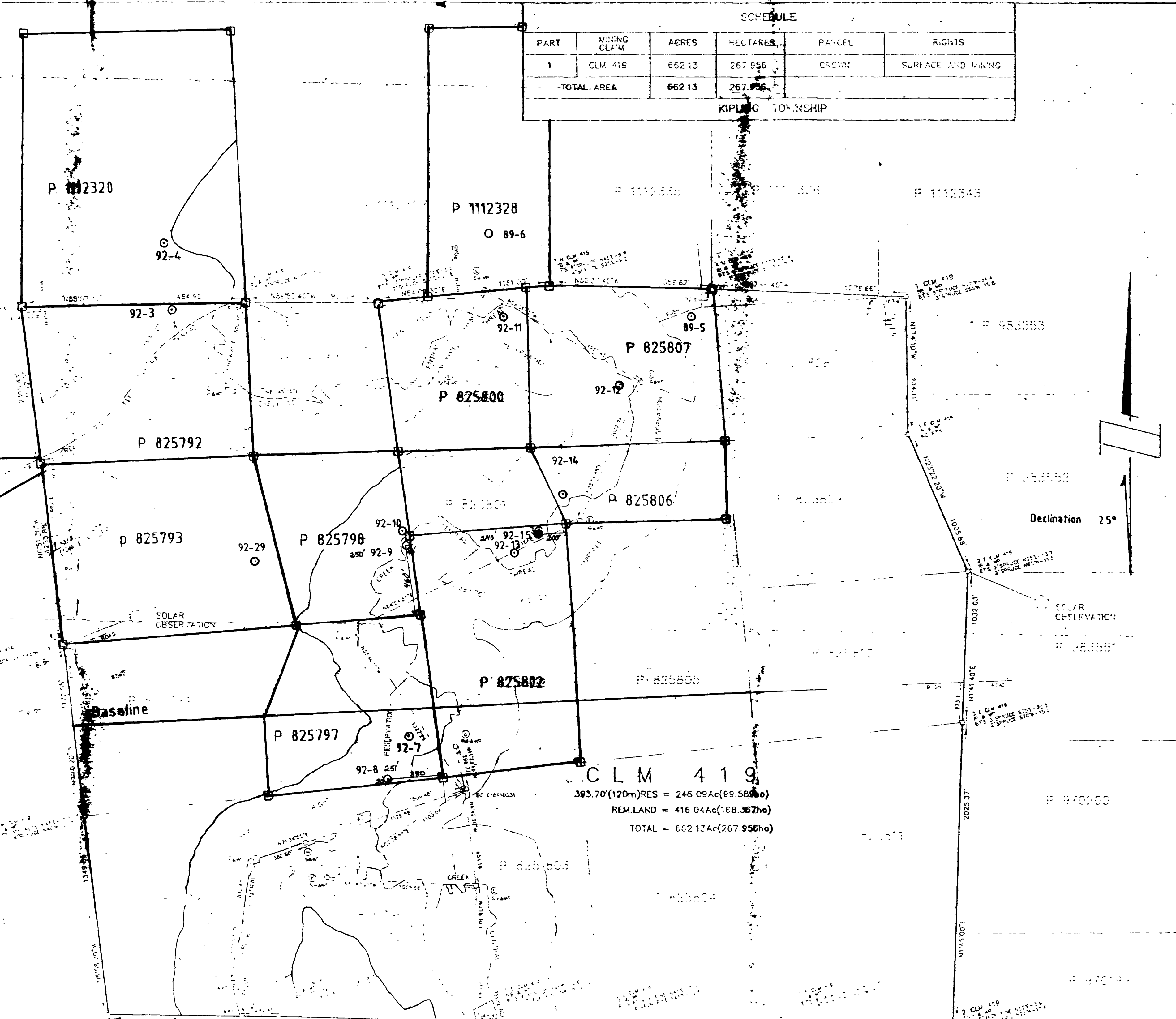
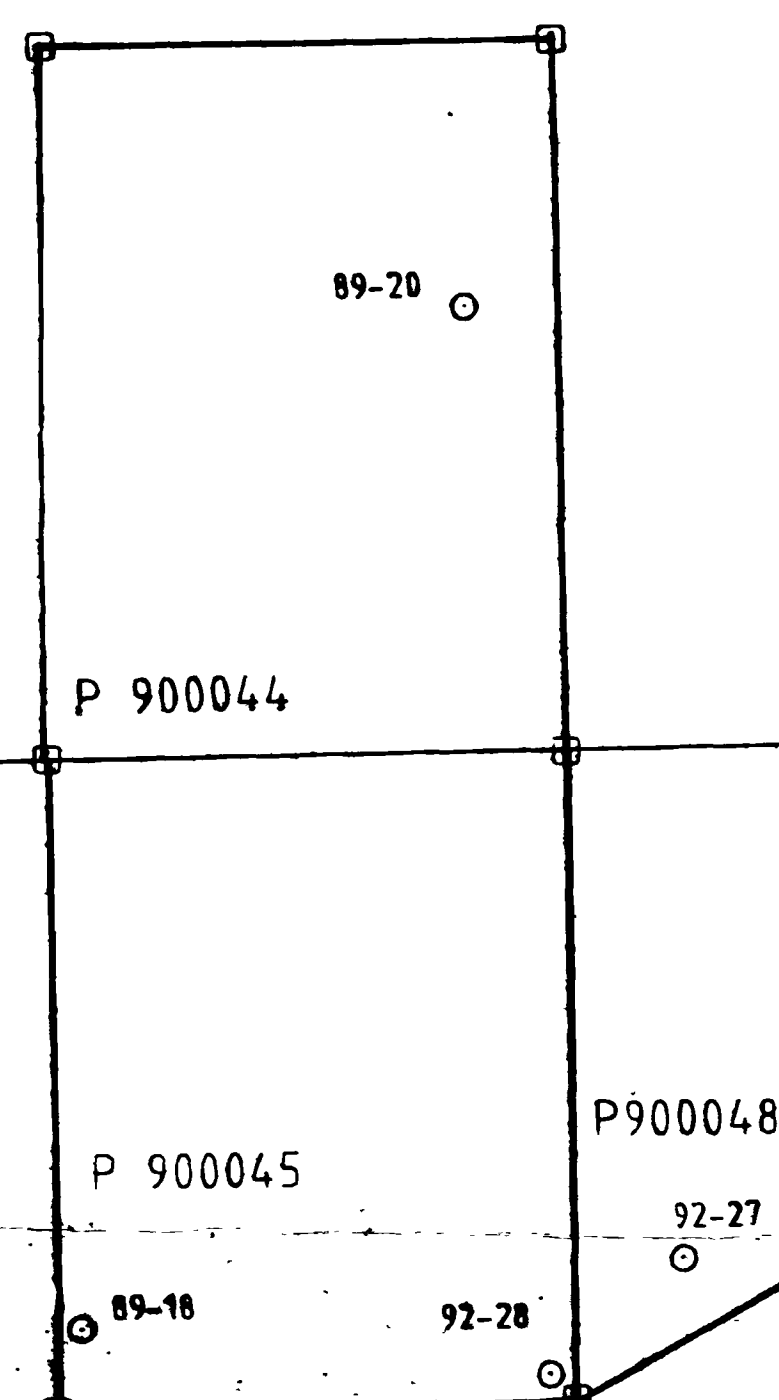

SCHEDULE				
PART	MINING CLAIM	ACRES	HECTARES	RIGHTS
1	CLM 419	662.13	267.956	GRANT, SURFACE AND MINING
TOTAL AREA		662.13	267.956	

CLM 419
393.70(120m) RES = 246.09Ac(99.58ha)
REM. LAND = 416.04Ac(168.36ha)
TOTAL = 662.13Ac(267.956ha)

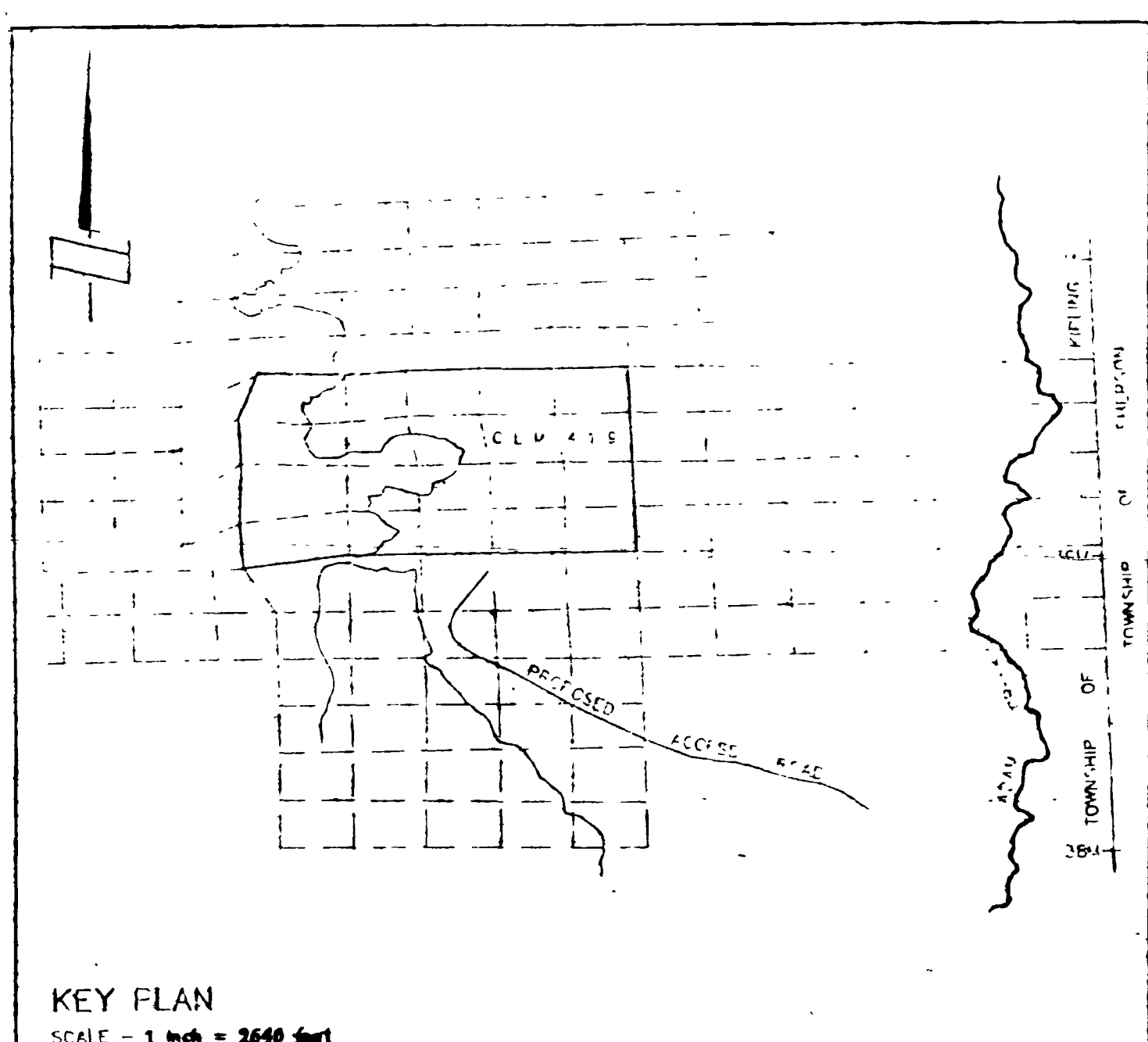

LEGEND
P DENOTES PLANTED MONUMENT (CLAM POSTS)
M DENOTES FOUND MONUMENT (CLAM POSTS)
S DENOTES 5/8 IN. SQ. IRON BAR 2.0 FT. LONG
SB DENOTES 1 IN. SQ. IRON BAR 4.0 FT. LONG
SMB DENOTES 1 IN. SQ. IRON BAR 2.0 FT. LONG
BC DENOTES BRASS CAP
WCT DENOTES WITNESS
WP DENOTES WOODEN GUIDE POST
BT DENOTES BEARING TREE
PLT DENOTES PLANTED
FD DENOTES FOUND
ALL HANGING LINES HAVE BEEN VERIFIED
ALL DRILL HOLES ARE AT 90°

KIPLING DRILL PLAN

BEARING NOTE
BEARINGS ARE ASTROMONIC AND ARE DERIVED FROM
SOLAR OBSERVATIONS AT CORNER OF CLM 419
(LONGITUDE 82°06'30") AND REFERRED TO THE MERIDIAN
THROUGH THE CENTRE OF KIPLING TOWNSHIP
(LONGITUDE 82°03'30")