

*Kipling Sup*

7206.007



#211

THE

010

To the Recorder of Porcupine Mining Division  
I, Mikas Oil Company Ltd. T-492.  
name of Recorded Holder Miner's Licence  
703 Fifth Street S.W. Calgary, Alberta.

do hereby report the performance of 28 Days Post Office Address days of Lateral work & Shaft sinking  
type of work  
not before reported to be applied on the following contiguous claims

Claim No.	Days	Claim No.	Days	Claim No.	Days
P.91135	28 Days	.....	.....	.....	.....
.....	.....	.....	.....	.....	.....
.....	.....	.....	.....	.....	.....
.....	.....	.....	.....	.....	.....
.....	.....	.....	.....	.....	.....
.....	.....	.....	.....	.....	.....

All the work was performed on Mining Claim (s) P.91135  
(In the case of geological and/or geophysical survey (s) where more than 18 claims are involved attach a schedule)

**READ CAREFULLY: THE FOLLOWING INFORMATION IS REQUIRED BY THE MINING RECORDER.**

- For Manual Work, Stripping or Opening up of Mines, Sinking Shafts or Other Actual Mining Operations - Names and addresses of the men who performed the work and the dates and hours of their employment.
- For Diamond and other Core Drilling - Footage, No. and angle of holes and diameter of core. Name and address of owner or operator of drill. Dates when drilling was done. Signed core log and sketch in duplicate.
- For Compressed Air or Other Power Driven or Mechanical Equipment  
Type of drill or equipment. Names and addresses of men engaged in operating equipment and the dates and hours of their employment.
- For Power Stripping - Type of equipment. Name and address of owner or operator. Amount expended. Dates on which work was done. Proof of actual cost must be submitted within 30 days of recording.
- With each of the above types of work sketches are required to show the location and extent of the work in relation to the nearest claim post. In the case of diamond or other core drilling the sketch must be submitted in duplicate.
- For Geological and Geophysical Survey - The names and addresses of men employed as well as dates. Type of instrument used in the case of geophysical survey. Reports and maps in duplicate must be filed with the Minister within 60 days of recording.
- For Land Survey - the name and address of Ontario Land surveyor.

The Required Information is as Follows: (Attach a list if this space is insufficient)

Lucien Truchon, Kapuskasing, Ontario -- 12th Sept Hours 8 am to 7 pm -- 11 hours  
 " " " " 13th. Sept. " 8 am to 6 pm -- 10 hours  
 Luc Bergeron, Kapuskasing, Ontario -- 12th Sept. hours 8am to 7 pm -- 11 hours.  
 " " " " -- 13th. Sept. " 8 am to 6pm -- 10 hours.  
 Total of 42 hours work = 28 days.

*MIKAS Oil Co. Ltd.*

*per H. Sherry (Secretary)*  
Signature of Recorded Holder or Agent

Date ..... 15th. Sept. 1972 .....

The Mining Act  
Certificate Verifying Report of Work

I, Bruce Douglas  
36 Wimpole Drive Willowdale, Ontario.  
(Post Office Address)

hereby certify:

1. That I have a personal and intimate knowledge of the facts set forth in the report of work annexed hereto, having performed the work or witnessed same during and/or after its completion.
2. That the annexed report is true.

Dated 23rd. Sept. 1972

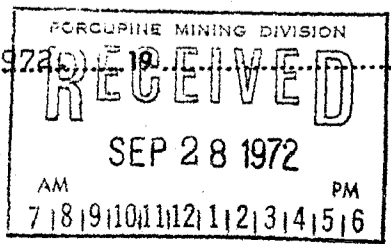

*Bruce Douglas*  
Signature

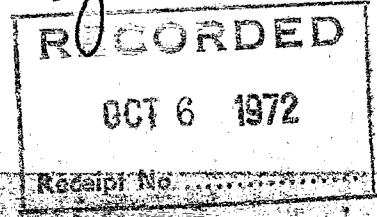

THE PENALTY FOR MAKING A FALSE STATEMENT IN THIS REPORT AND/OR CERTIFICATE IS \$500. OR SIX MONTHS IMPRISONMENT OR BOTH

KEY MAP

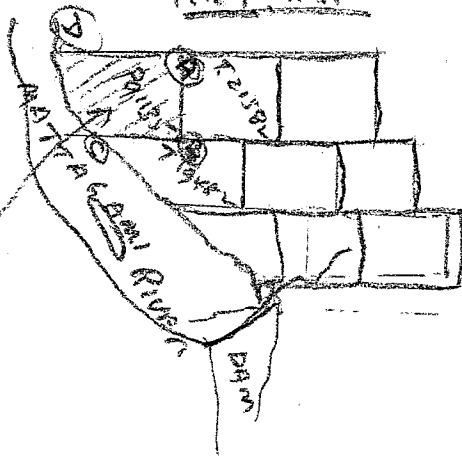

*Lucas Jackson*

PORCUPINE MINING DIVISION  
**RECEIVED**  
 OCT 6 1972  
 AM 78910112123456



900

18<sup>th</sup> July 1972  
 19 " "  
 20 " "

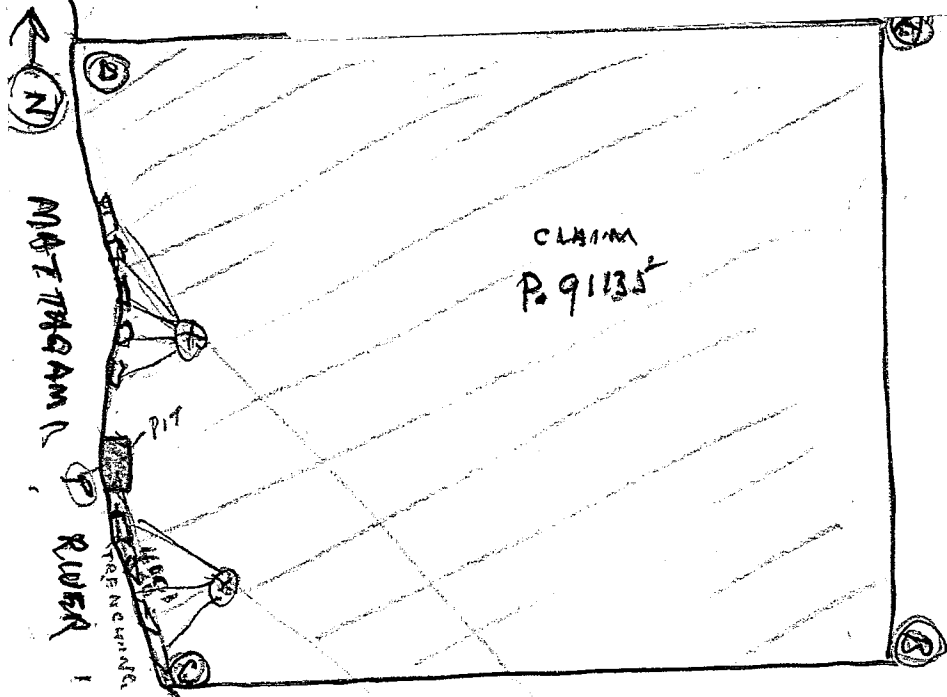

MATA GABRIEL RIVER

RIVER

LOT 100  
LATERAL  
WORK

T. 19482  
CLAIM

CLAIM  
P. 91135

PIT 4' x 10' long  
15' deep  
ON RIVER  
EDGE

400' from

Samples 200 to 1000  
from

LATERAL TRENCH  
DIGGING IN  
12 LOCATIONS  
ON RIVER BANK  
14 SAMPLES  
REMOVED FOR  
TESTING

WORK DONE