



42J01NE8089 17 KIJLING

010

TOWNSHIP: Kipling

REPORT NO: 17

WORK PERFORMED FOR: Mineral Research Canada

RECORDED HOLDER: SAME AS ABOVE

OTHER

<u>CLAIM NO.</u>	<u>HOLE NO.</u>	<u>FOOTAGE</u>	<u>DATE</u>	<u>NOTE</u>
P825792	92-3	250	Mar 92	(1)
P112320	92-4	252	Mar 92	"
P825797	92-5	248	Feb 92	"

NOTES:

Filed Mar 93

(1) Report of Work # 9260 00171

SONIC DRILL HOLE RECORD

Drilling Started: Mar. 14, 1992 Drilling Finished: Mar. 15, 1992 Drilling Co.: J. R. Drilling Dip: -90° Hole Length: 250.0' Overburden Depth: 145.5' Claim No: P 825792 Easting: 4900 E Northing: 840 N Property: Kipling	Logged By: A. Casselman Logged: Mar. 15, 1992 Core Size: 3.5" Core Storage: Mineral Research Canada R. R. # 2 Parry Sound, ON P2A 2W8 Hole No.: 92-3
--	--

SUMMARY

From	To	Description
0.0'	145.5'	Glacial Clay Till - Overburden - Pleistocene
145.5'	165.0'	Clay Cretaceous
165.0'	177.5'	Kaolin Silica Sand (Kss)
177.5'	182.0'	Clay
182.0'	186.0'	Sandy Clay
186.0'	240.0'	Kss
240.0'	242.75'	Sandy Clay
242.75'	250.0'	Kss

EOH - 250.0'

Hole located: 91 m due west of Pike Creek (Kipling Township)
 : 4900 m E of point 00 on the baseline
 : 840 m N of the baseline
 : 164.5 m at 263.25° from claim post 1 of P 825792

Detail Log - 92-3

From	To	Sample No.	Description
0.0'	134.0'		Glacial Clay Till - highly competent, calcareous, 129.0' - 130.0' - interlayered red & medium grey, 130.0' - dark green, highly calcareous, up to 35.0% clasts, predominantly carbonate, some gneissic angular, red, highly calcareous also, pieces of drill bit, medium grey sandy clay, red exterior coating - kaolin based - non-calcareous, competent, weakly pliable, 130.0' - 134.0' - predominantly red, mould in exposed sections.
134.0'	141.5'	16401	Glacial Clay Till - red as above.
141.5'	146.5'	16402	Glacial Clay Till - interbedded red & dark green (typical till) from 141.5 - 145.5', at 145.5' - a 0.5" kss seam centre white, red exterior coating and contacts, lower contact with 1.0" dark green till contacting with medium grey/brown Cretaceous clay, finely laminated with light grey, dark brown & red.
146.5'	152.0'	16403	Clay - pliable, competent, 145.5' - 149.0' - red and light grey mottled - predominantly red, kss - 0.25" at 146.25' - medium grain, red, some black with the light grey, 149.0 - 151.0' - light to medium grey mottled, high illite content, grey alternating with grey to red to buff mottled then yellow/brown (red & yellow/brown) together in a wavy pattern, 0.5" wider band of 1.0" medium and light grey to yellow brown, 0.5" of medium & light grey with some mottling, to red with minor buff mottling 0.25', then 0.25' of grey with minor red mottling, 151.0' - 152.0' - 0.75' of red with minor buff mottling, last 0.25' - medium grey with minor red, much darker, minor carbonaceous pieces.
152.0'	155.0'	16404	Clay - competent, pliable, more goeey than above, medium grey, some

carbonaceous material, red/brown, mottling, not as strong as above, predominantly grey, 154.5' - 154.75' - mottling with light yellow/green/red/grey.

- | | | | |
|--------|--------|-------|---|
| 155.0' | 159.0' | 16405 | Clay - competent, weakly pliable, somewhat fissile, carbonaceous material increasing downsection, chocolate brown grading to black, fissility increasing downsection, chocolate brown containing darker discontinuous laminations, lignite fragments at 158.0' - black after 158.0' - 159.0'. |
| 159.0' | 163.0' | 16406 | Clay - black, fissile, competent, some dark brown discontinuous laminating, carbonaceous. |
| 163.0' | 165.0' | 16407 | Clay - black, highly fissile, becoming more pliable, downsection, at contact with kss, there is approximately 5.0" of black sandy clay with high illite content, relatively sharp contact with kss, disc-like greasy conchoidal-like fracture. |
| 165.0' | 167.0' | 16408 | Kss - first 0.75' hematite/limonite stained rusty yellow colour, then a dark grey band - bimodal distribution medium grain, in a fine grain matrix with some coarser smoky quartz and yellow chert - well rounded to white at 166.0' - 2.0" chocolate brown kss under finer grain grading to previous material from yellow/brown to white. |
| 167.0' | 172.0' | 16409 | Kss - white, medium grain, frequent larger rounded smoky quartz & yellow chert, minor illite and heavies, some purple sections - especially in clay-rich lower section, chocolate brown exterior coating, clasts up to 1.0", lower section has a large percentage chocolate brown, probably due to drill action, lower section is coarse grain in a white clay matrix, Devonian sandstone angular fragment at 169.0', powdery limonite areas as contacts with yellow chert. |
| 172.0' | 177.5' | 16410 | Kss - medium grey, very coarse grain, in a fine grain matrix, grading downsection to a medium grain matrix, rounded larger clasts of smoky quartz and yellow chert up to 1.0", minor clay clots, pliable buff, red exterior coating, minor illite and |

heavies, sharp contact with underlying clay.

- | | | | |
|--------|--------|-------|---|
| 172.0' | 181.0' | 16411 | Clay - medium grey with red and yellow mottling, red centrally, yellow exterior and yellow bands, some purple from 177.5' - 179.0', 5.0" of kss - white medium grain, red exterior coating at 179.0', 179.0' - 181.0' - red with light buff mottling, more buff downsection - 2.0" of buff & yellow at upper contact with kss, some green with upper yellow, highly competent, fissile becoming predominantly mouldy, red most pliable. |
| 181.0' | 182.0' | 16412 | Clay - red, some buff mottling at lower sandy clay contact, competent, and fissile, illitic. |
| 182.0' | 184.0' | 16413 | Sandy Clay - buff, illitic, darker discontinuous laminations, some purple and yellow areas, 182.5' - clay seam of 4.0" - weakly red & yellow - one very fine concord purple lamination at the lower contact, very fine grain silica. |
| 184.0' | 186.0' | 16414 | Sandy Clay - buff, pliable, illitic, as above, no yellow. |
| 186.0' | 190.0' | 16415 | Kss - reddish at upper contact, white, minor illite and heavies, one sandy clay seam - buff, pliable with purple sections at 187.0' - 1.5", exterior red and yellow coating. |
| 190.0' | 196.0' | 16416 | Kss - as above, upper 2.0', more illite-rich. |
| 196.0' | 198.0' | 16417 | Kss - white, medium grain, rare larger smoky quartz clasts, minor illite and heavies, increasing percentage downsection. |
| 198.0' | 203.0' | 16418 | Kss - medium grain, light buff, frequent larger smoky quartz, coarser grain, in a medium grain matrix, high percentage heavies, minor illite, 198.0' - 201.0' - from 201.0' - 202.25' 0 white, medium grain, much lower percentage of heavies and illite, no larger clasts, 202.25' - 203.0' - as previous, extremely high concentration of heavies, dark grey clay, yellow chert. |
| 203.0' | 208.0' | 16419 | Kss - at 203.0' - 233.25' - dark grey extremely high percentage heavies with large rounded smoky quartz and yellow chert in |

medium grain, 203.25' - 203.75' - medium grain, white, minor illite and heavies, 203.75' - 204.0' - dark grey as previous, 204.0' - 205.0' - white, fine grain, coarsening downsection to medium grain, minor illite and heavies, some heavies banding causing grey sections, at 204.5' - 2.0" band of coarse clasts - up to 1.5" rounded vari-coloured silicas with a buff clay coating.

- 208.0' 211.0' 16420 Kss - medium grain, white, minor illite and heavies banding creating darker sections.
- 211.0' 217.0' 16421 Kss - coarse grain, white, some medium grey sections, especially at 213.5', 4 Devonian fragments found, angular, dark grey, coral, bryozoans, crinoids, brachiopods, quite pitted, vari-coloured rounded to sub-rounded silica, bi-modal very coarse in a coarse grain matrix.
- 217.0' 221.0' 16422 Kss - coarse grain, as above, grading to less clay-rich rusty buff, coarse grain with fewer very large clasts, minor illite and heavies, vari-coloured silicas.
- 221.0' 225.0' 16423 Kss - coarse grain, clasts up to 1.5", light buff, minor illite and heavies, 2.0" sandstone clast, fine grain, sub-rounded dark brown, weathered surface, lighter interior, pitted, one aster-like brown section, some darker laminations, apparent exterior *in situ* sulphide formation - pyrite crust in certain areas as well as some pits, Devonian.
- 225.0' 229.25' 16424 Kss - extremely coarse grain in a medium grain matrix, light grey, minor illite and heavies, sub-rounded to rounded vari-coloured silicas.
- 229.25' 233.0' 16425 Kss - medium grain, white, minor illite and heavies, higher than normal percentage illite, larger flake than normal, minor heavies banding, clay-enrichments in bands, garnet banding, very fine grain garnet.
- 233.0' 237.0' 16426 Kss - as above.
- 237.0' 240.0' 16427 Kss - medium grain, white, minor illite and heavies, 2.0" buff pliable clay clot at lower contact with sandy clay, heavies as banding, coarse at contact.

240.0' 242.75' 16428 Sandy Clay - buff, pliable, minor purple sections, minor illite and heavies.

242.75' 245.0' 16429 Kss - light grey, fine grain, high percentage heavies, minor illite.

245.0' 250.0' 16430 Kss - fine grain, as above, coarsening downsection to medium grain portion, minor illite and heavies, & heavies as banding.

EOH - 250.0'

Section 92-3

Claim No.: P 825792

Hole length: 250.0'

Overburden Depth: 145.0'

Astromomic Asimuth: 263.25° from claim post 1 of 825792 82°10'15" S 58°10'85" E

Scale: 1.0" = 50.0' or 1:600

Northing: 840 m N

Easting: 4900 m E

Dip: -90°

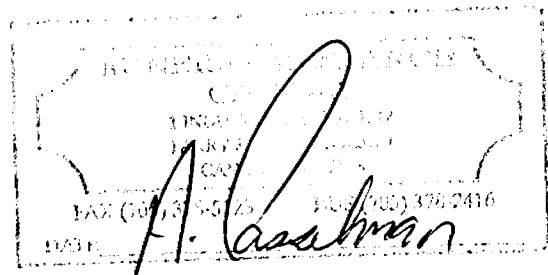
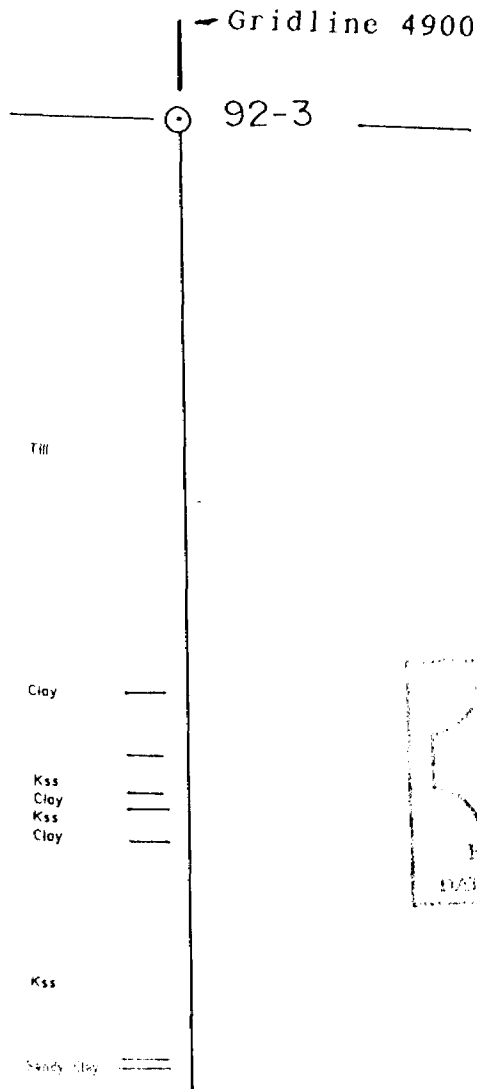

50.0'

SONIC DRILL HOLE RECORD

Drilling Started: Mar. 14, 1992
 Drilling Finished: Mar. 14, 1992
 Drilling Co.: J. R. Drilling
 Dip: -90°
 Hole Length: 252.0'
 Overburden Depth: 140.0'
 Claim No.: P 1112320
 Easting: 4970 E
 Northing: 1006 N
 Property: Kipling

Logged By: A. Casselman
 Logged: Mar. 14, 1992
 Core Size: 3.5"
 Core Storage:
 Mineral Research Canada
 R. R. # 2
 Parry Sound, ON
 P2A 2W8
 Hole No.: 92-4

SUMMARY

From	To	Description
0.0'	0.5'	Peat
0.5'	140.0'	Glacial Clay Till Overburden - Pleistocene
140.0'	172.0'	Kaolin Silica Sand (Kss) Cretaceous
172.0'	174.5'	Sandy Clay, Kss, & Clay
174.5'	177.0'	Kss
177.0'	187.0'	Kss & Sandy Clay
187.0'	208.0'	Kss
208.0'	213.0'	Kss & Clay
213.0'	252.0'	Kss

A. Casselman

EOH - 252.0'

Hole Location : 30.5 m due west of Pike Creek (Kipling Township)
 : 4970 m E of baseline point 00
 : 1006 m N of baseline
 : 650 m at 306° from claim post number 2 of P 1112320

Detail Log - 92-4

From	To	Sample No.	Description
0.0'	0.5'		Peat
0.5'	137.0'		Glacial Clay Till - highly competent, calcareous, rare carbonate and gneissic angular clasts.
137.0'	140.0'		Glacial Clay Till/Kss - contact zone- 137.0' - 139.5' - till with external kss contamination, 139.5' - 140.0' - dark grey highly calcareous medium grain kss.
140.0'	143.0'	16451	Kss - medium grey, with lighter sections, much contamination, medium grain, one larger rounded orange chert.
143.0'	147.0'	16452	Kss - medium grain, alternating dark brown/yellow & white sections, white containing more clay.
147.0'	152.0'	16453	Kss - medium grain, some slightly coarser areas, 151.0' - 152.0', coarse grain, light buff, more clay in coarse grain sections, minor illite and heavies, increasing in coarse grain sections, prevalent yellow chert.
152.0'	157.0'	16454	Kss - as above, coarse sections and medium grain sections alternating throughout, light grey clay clots up to 0.5", oblate siltstone angular fragments, white with silicas clasts imbedded at 154.0' - 0.5".
157.0'	162.0'	16455	Kss - as above.
162.0'	166.0'	16456	Kss - as above, medium grain, grading downsection, 2.0', to coarse 2.0" sharp contact with fine grain.
166.0'	172.0'	16457	Kss - fine grain, medium grey, high percentage illite, more heavies banding - 168.5' - 169.5' - sandy clay - dark buff, fine grain, pliable, minor illite and heavies, areas of dark grey inside, rare large sub-rounded smoky quartz, 0.25".
172.0'	174.5'	16458	Sandy Clay, Kss, & Clay - buff, sandy

clay - pliable, high illite content, large flake, chocolate brown pliable clay, 4.0" buff with dark brown laminations, kss - buff, fine grain, 2.0" to light brown, pliable sandy clay, to medium grain, medium brown clay 5.0", pliable, high illite, to kss, medium grain light brown, rare larger sub-rounded smoky quartz 0.25", to sandy clay - pliable, buff, darker laminations, purple laminations, minor illite, some medium grain kss mottling.

- 174.5' 177.0' 16459 Kss - medium grain, light brown, rare larger sub-rounded smoky quartz up to 0.25", minor illite and heavies.
- 177.0' 182.0' 16460 Kss & Sandy Clay - all medium grain, light brown, minor illite and heavies, some heavies banding, large flake illite in sandy clay.
- 182.0' 187.0' 16461 Kss & Sandy Clay - as above, rusty coloured exterior contamination, 0.5" band at 183.0' - containing large rounded jasper and clay clots 0.25" and high percentage heavies - garnet?.
- 187.0' 188.0' 16462 Kss - medium grain with larger clasts grading to fine grain, light brown, minor illite and heavies.
- 188.0' 193.0' 16463 Kss - fine grain grading downsection to coarse grain, then medium grain, with coarser clasts, minor illite, high percentage heavies in bands as well as dispersed, extremely large sub-rounded milky quartz in fine grain at 188.5', 2.5", medium to dark grey where heavies banding occurs, vari-coloured silicas.
- 193.0' 199.0' 16464 Kss - medium grain, with frequent larger clasts alternating with coarse grain in a white (light grey in some areas) clay matrix, minor heavies & illite, vari-coloured silica, dark concord purple clay horseshoeshaped clot at 198.0'.
- 199.0' 203.0' 16465 Kss - coarse grain in a medium grain matrix, light grey, clasts up to 2.5", sub-rounded vari-coloured silica, minor illite and heavies, one area of black-like purple,

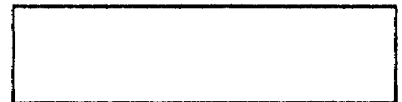

minor clay clotting
near larger clasts.



203.0' 208.0' 16466 Kss - coarse grain, in a medium grain matrix, as above, 203.0' - 205.5' - last 0.5" dark grey, higher percentage of heavies, banded, after 205.5' - 208.0', white, clay depleted, rust staining due to drilling debris, very small percentage illite and heavies, some clay-rich bands, close to clay matrix, purple clots.

208.0' 213.0' 16467 Kss & Clay - kss - 208.0' - 210.0' - clay-rich medium grain, frequent coarse clasts, buff with some yellowish areas, one area of sherbet clay surrounded an orange chert, 210.0' - 211.0' - clay - pliable, buff with medium grain, buff kss mottling at 210.0', clay is dark green, some black with dark yellow/green contact with kss, pliable, some purple laminations at contact with buff clay, 211.0' - 213.0' - kss - medium grain, light brown, frequent large smoky quartz and yellow chert up to 2.0", minor heavies and heavies banding, garnet?, minor illite.

213.0' 218.0' 16468 Kss - medium grain grading to coarse grain in a medium grain matrix to coarse grain in a light grey clay matrix, vari-coloured silicas, sub-angular to rounded, 7 Devonian clasts found from 214.0' - 217.75' - 1. - siliceous dolostone highly irregular weathering, very pitted, sub-angular, 2.0" x 1.0", highly fossiliferous, 33.0% colonial coral, brachiopods, crinoids etc., dark grey, nearly black in some areas, *in situ* crystal growth, very small



spheres are orange brown, 2. - clast is 3.0" x 2.5" dark grey sandstone, extremely fine grain, chatter marks, no apparent fossils, sub-angular, 3. is as 2. but oval in cross section, no apparent fossils, but itself a possible large crinoid section or solitary coral, 4.&5. - small, oblate clasts, black,

has very pitted surface, no fossils - other similar but centrally grey, apparent zaphrenis, 6. & 7. - 2 pieces of the same rock possibly split by the action of the drill although not likely, light grey, very pitted, same exterior & interior colour together 3.5", adjoining flat surface shows a solitary horn coral, green around the fossil, one piece shows a purple section near a fossil, angular, *in situ* pyritic growth, silica clasts as part of the rock, dolostone.

- 218.0' 223.0' 16469 Kss - coarse grain in a white clay matrix, some purple near heavies bandings, grading to medium grain, to fine grain, clay-rich, vari-coloured silica, after 219.0' - buff, minor heavies and illite, frequent coarse clasts at 221.0' - large no. of granular clasts, angular - prolate generally red/brown, entirely composed of silica and garnet, garnets as heavies, banding of garnets, some faceted orange/brown.
- 223.0' 228.0' 16470 Kss - extremely coarse grain in a buff sandy clay matrix, minor illite - 223.0' - 224.0', 224.0' - 228.0' - kss - fine grain, light brown, minor illite and heavies, some clay enrichment, mottling and heavies banding.
- 228.0' 232.0' 16471 Kss - white, medium grain, small clay clots, minor heavies and illite, half of the core out of the box, not sampled, heavies as laminations, dark banding.
- 232.0' 237.0' 16472 Kss - as above.
- 237.0' 242.0' 16473 Kss - as above from 237.0' - 241.0', 241.0' - 242.0' - higher clay content, very light brown/red, 0.25" clay seam - medium brown, some black laminations at 241.75' - minor heavies - dispersed and as banding, minor illite, coarser grain, green/yellow band at 238.75' of 2.0".
- 242.0' 246.75' 16474 Kss - as at 237.0' - 241.0' - clay clot - medium brown, pliable at lower contact, large clasts at lower contact, more red/brown than above.
- 246.75' 252.0' 16475 Kss - nearly sandy clay, buff, fine grain, chocolate & medium brown mottled, some illite seams, large flake illite in seams,

minor heavies.

EOH - 252.0'

Section 92-4

Claim No.: P 1112320
Hole Length: 252.0'
Overburden Depth: 140.0'
Astronomic Azimuth: 306° from claim post 2 of P 1112320 82°10'80" 331°05"
Scale: 1.0" = 50.0' or 1:600
Northing: 1470 N
Easting: 4970 E
Dip: -90°

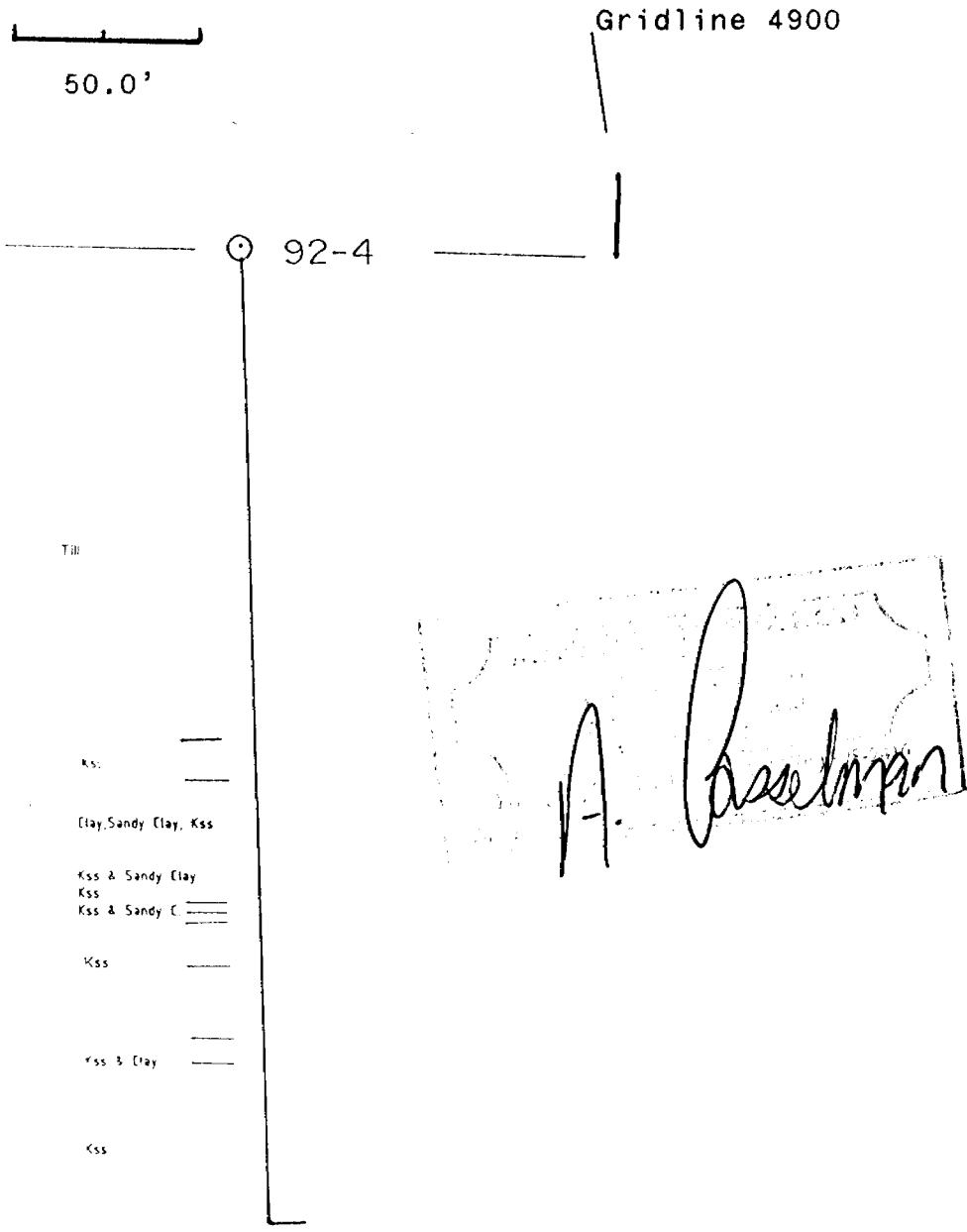

SONIC DRILL HOLE RECORD

Drilling Started: Feb. 25, 1992
 Drilling Finished: Feb. 26, 1992
 Drilling Co.: J. R. Drilling
 Dip: -90°
 Hole Length: 248.0'
 Overburden Depth: 77.0'
 Claim No.: P825797
 Easting: 5050 E
 Northing: 050 S
 Property: Kipling

Logged By: A. Casselman
 Logged: Oct. 2, 1992
 Core Size: 3.5"
 Core Storage:
 Mineral Research Canada
 R. R. # 2
 Parry Sound, ON
 P2A 2W8
 Hole No.: 92-7

SUMMARY

From	To	Description	
0.0'	0.25'	Peat	
0.25'	7.0'	Lacustrine Clay	
7.0'	77.0'	Glacial Clay Till	Overburden - Pleistocene
77.0'	92.0'	Kaolin Silica Sand (Kss)	Cretaceous
92.0'	97.5'	Kss & Sandy Clay	
97.5'	102.0'	Sandy Clay	
102.0'	107.0'	Kss & Sandy Clay	
107.0'	110.0'	Clay	
111.0'	113.0'	Kss & Sandy Clay	
113.0'	118.0'	Clay	
118.0'	127.0'	Sandy Clay, Clay & Kss	
127.0'	130.0'	Sandy Clay	
130.0'	139.0'	Kss	
139.0'	145.0'	Sandy Clay	Hole Location: 85 m due west of Pike Creek (Kipling Township) : 5050 m East of baseline point 00 : 050 m South of Baseline : 97.5 m at 326° from claim post 2 of P 825797
145.0'	193.0'	Kss	
193.0'	198.25'	Sandy Clay	
198.25'	207.0'	Kss	
207.0'	210.5'	Clay	
210.5'	227.5'	Kss	
227.5'	230.0'	Clay	
230.0'	245.0'	Kss & Clay	
245.0'	248.0'	Clay & Sandy Clay	

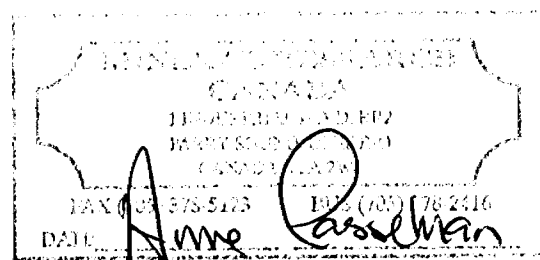

EOH -248.0'

Hole Cave in - causing much kss contamination at the end of the hole.

Detail Log - 92-7

From	To	Sample No.	Description
0.0'	0.25'		Peat - had been scraped during set up, on hill near road probably only another 6.0" would have been there naturally.
0.25'	7.0'		Lacustrine Clay - pliable, yellow/brown, some silty content, massive.
7.0'	77.0'		Glacial Clay Till - green/grey, pliable at upper contact (4.0") then becoming increasingly competent and fissile, 33.0' - 52.0' - disc-like and highly competent. 20.75' - 27.0' - containing clasts. gneissic and carbonate. angular, up to 2.0".
77.0'	81.0'		Silica Sand - rusty, no kaolin, weakly calcareous, rare Precambrian clast, some poor kaolin clotting.
81.0'	86.0'	16101	Kss - medium grain, somewhat kaolin depleted, white, some yellow and purple banding, large 3.5" granitic clast at 81.0', very fresh appearance.
86.0'	92.0'	16102	Kss - medium grain, white. clay-poor, some yellow chert, minor heavies and illite.
92.0'	97.5'	16103	Kss & Sandy Clay alternating, sandy clay, pliable mottled light and medium brown, some yellow kss, medium grain, light brown, minor illite and heavies, 2.0" or coarse grain. at contact with sandy clay at 196.0'. sandy clay moulded.
97.5'	102.0'	16104	Sandy Clay - mottled with medium brown clay, competent, drill gouging, weakly pliable in sections, minor illite.
102.0'	107.0'	16105	Sandy Clay & kss - sandy clay - as above, buff, kss - medium grain, light brown, minor heavies and illite.
107.0'	110.0'	16106	Clay - pliable, competent, very light yellow/grey, some darker yellow sections.
110.0'	113.0'	16107	Sandy Clay & Kss - very light grey, medium grain, some purple sections, minor illite and heavies, competent, pliable, then kss medium grain, white, minor

illite and heavies then sandy clay as above, to kss - 3.0" with very large flake muscovite.

- 113.0' 115.0' 16108 Clay - pliable, competent, buff, becoming chocolate brown, to black (extremely lignite rich) to chocolate, more fissile after buff, buff has red and yellow laminations, minor illite and carbonaceous material.
- 115.0' 118.0' 16109 Clay grading to Sandy Clay - very small amount of material for footage, dark buff, some yellow laminations, non-competent, highly pliable clay, less pliable downsection, carbonaceous, last 0.25' sandy clay - buff pliable, highly illitic, lighter and darker laminations throughout.
- 118.0' 127.0' 16110 Kss & Sandy Clay, Clay - 1.0' of kss - medium grain, white, minor illite and heavies, to sandy clay, buff, competent, pliable, very fine grain, to clay competent, pliable, buff, minor red and yellow laminations, to sandy clay as above.
- 127.0' 130.0' 16111 Sandy Clay - medium grain, pliable, light grey, minor illite and heavies, one yellow sandstone clast with smoky quartz - 0.5", at 128.5'.
- 130.0' 135.0' 16112 Kss - medium grain, white, minor illite and heavies, interior of bag greasy, dead animal in box.
- 135.0' 139.0' 16113 Kss - very small amount in box, very soupy, highly contaminated, as above, a 3.0" clot of sandy clay, highly pliable, very illitic, buff.
- 139.0' 145.0' 16114 Sandy Clay - competent, weakly pliable, light grey, minor illite and heavies.
- 145.0' 150.0' 16115 Kss - 1.0' - fine grain, medium grey, minor illite and heavies, 1.0' - sandy clay, highly pliable, buff, high illite, 3.0' - medium grain kss - light buff, minor illite and heavies, high water retention, heavies, high amount of contamination.
- 150.0' 154.0' 16116 Kss - white, medium grain, minor illite and heavies, poor sorting.
- 154.0' 159.0' 16117 Kss - medium grain, as above, to coarse grain, last 1.0' light grey, vari-coloured

silica.

- 159.0' 163.0' 16118 Kss - coarse and medium grain, alternating, clay clotting in coarse portion, minor illite and heavies, light brown.
- 163.0' 167.0' 16119 Kss - coarse grain in a medium grain matrix alternating with coarse grain in a buff clay matrix, 160.0' - 161.0' - sandy clay mottling, almost pure buff, pliable, kss containing many large 2.0" well rounded yellow chert clasts, generally medium grey and buff, also small purple clots.
- 167.0' 172.0' 16120 Kss - dark grey, coarse grain in a medium grain matrix to coarse grain in a light grey clay matrix, vari-coloured silicas, very small amount of material.
- 172.0' 177.0' 16121 Kss - as above, alternating medium extremely coarse grain, in a medium grey clay matrix, some hematite staining, minor illite and heavies, drill gouging, at 172.25' - large 3.5" pitted fossiliferous dolostone (siliceous), light grey, crinoids, brachiopods, *in situ* formation of black crystals, perhaps haematite roses as at 92-4.
- 177.0' 180.0' 16122 Kss - coarse grain, vari-coloured silicas in a buff clay matrix.
- 180.0' 183.0' 16123 Kss - medium grain, light grey, fining downsection, minor illite, rare larger clasts, vari-coloured silica up to 1.0", 2.0" clay clots at 182.0' - pliable, centrally medium grey (half) exterior buff.
- 183.0' 188.0' 16124 Kss - medium grain, light brown, minor illite and heavies, very homogeneous.
- 188.0' 193.0' 16125 Kss - as above, until last 1.0', coarse grain, slightly darker, gradational contact, some light buff pliable clay clots of 2.0".
- 193.0' 198.25' 16126 Sandy Clay - (actually kss & clay mottled on a fine scale), kss - coarse grain, vari-coloured, clay buff, pliable, drill gouging.
- 198.25' 203.0' 16127 Kss - medium grain, with frequent larger clasts, white, vari-coloured silica.
- 203.0' 207.0' 16128 Kss - coarse grain, in a medium grain matrix, rounded to sub-angular vari-coloured

silicas, progressively more brown, downsection, some clay mottling, 3.0" at 206.0', buff, then a band of dark grey clay impurity, kss - medium grain after clay mottling, clay-poor buff, rare larger clasts.

- | | | | |
|--------|--------|-------|--|
| 207.0' | 210.5' | 16129 | Clay - light to medium brown, yellow at lower contact, first foot fissile, fragmented, after extremely pliable, some silty content, competent. |
| 210.5' | 214.0' | 16130 | Kss - medium grain, coarse 3.0" at upper contact, other coarse sections of 1.0 - 2.0", upper 1.0' highly contaminated yellow/brown, grey banding, minor heavies and illite, vari-coloured silica, one piece angular Devonian fragment, medium grey dolostone with white areas, brachiopods & crinoids. |
| 214.0' | 219.0' | 16131 | Kss - extremely coarse grain, in a medium grain matrix, medium yellow/brown, to blue/grey, vari-coloured silica, large, up to 2.0" sub-rounded to well rounded, minor illite and heavies. |
| 219.0' | 225.0' | 16132 | Kss - as above, lighter in colour after first half of box, minor illite and heavies. |
| 225.0' | 227.5' | 16133 | Kss - as above, clay-poor yellow/brown, rounded pitted dolostone clast. |
| 227.5' | 230.0' | 16134 | Clay - chocolate brown, silty, pliable, minor illite, carbonaceous, decreasing silt downsection, darkening downsection. |
| 230.0' | 235.0' | 16135 | Clay & Kss - 230.0' - 231.0' - kss - as previous, 231.0' - 232.0' - chocolate brown clay, lighter silty areas with yellow chert large, up to 2.0" , sub-rounded to well rounded, at 232.0' - gritty tiny clay balls some kss, chocolate brown, 232.0 - 233.0' - as above, clay unit, then 4.0" kss unit - chocolate brown, coarse grain in a medium grain matrix, some small areas of white, 234.25' - 235.0', chocolate brown clay as previous up to 3.0", more milky quartz, some irregular grapestone features. |
| 235.0' | 237.0' | 16136 | Clay & Kss - as above, clay is clast-free, kss containing yellow chert. |
| 237.0' | 241.0' | 16137 | Clay & Kss - as above, last 2.0' kss, first |

2.0" is clast-free pliable sandy clay; chocolate brown, highly illitic, one clast an apparent conglomerate and another a very mottled multi-coloured chert (green, white, red, yellow).

- 241.0' 245.0' 16138 Clay & Kss - as above, alternating kss with clast-free (nearly) silty clay, highly illitic, one rounded siltstone fragment.
- 245.0' 247.0' 16139 Clay & Sandy Clay - alternating, carbonaceous, chocolate brown, competent, fissile, highly illitic, at 245.75', *in situ* sulphide formation, 2.0" round, pyrite.
- 247.0' 248.0' 16140 Clay grading to Sandy Clay - clay as above, larger yellow cherts as previous present but much fewer, buff sandy clay, last quarter of the box, large amount of material for one foot.

EOH - 248.0'

Section 92-7

Claim No.: P 825797

Hole Length: 248.0'

Overburden Depth: 77.0'

Astronomic Azimuth: 326.0° from claim post 2 of P 825797 $82^{\circ}08'75''$ $50^{\circ}08'15''$

Scale: 1.0" = 50.0' or 1:600

Northing: 050 S

Easting: 5050 E

Dip: -90°



50.0'

Pipe Creek

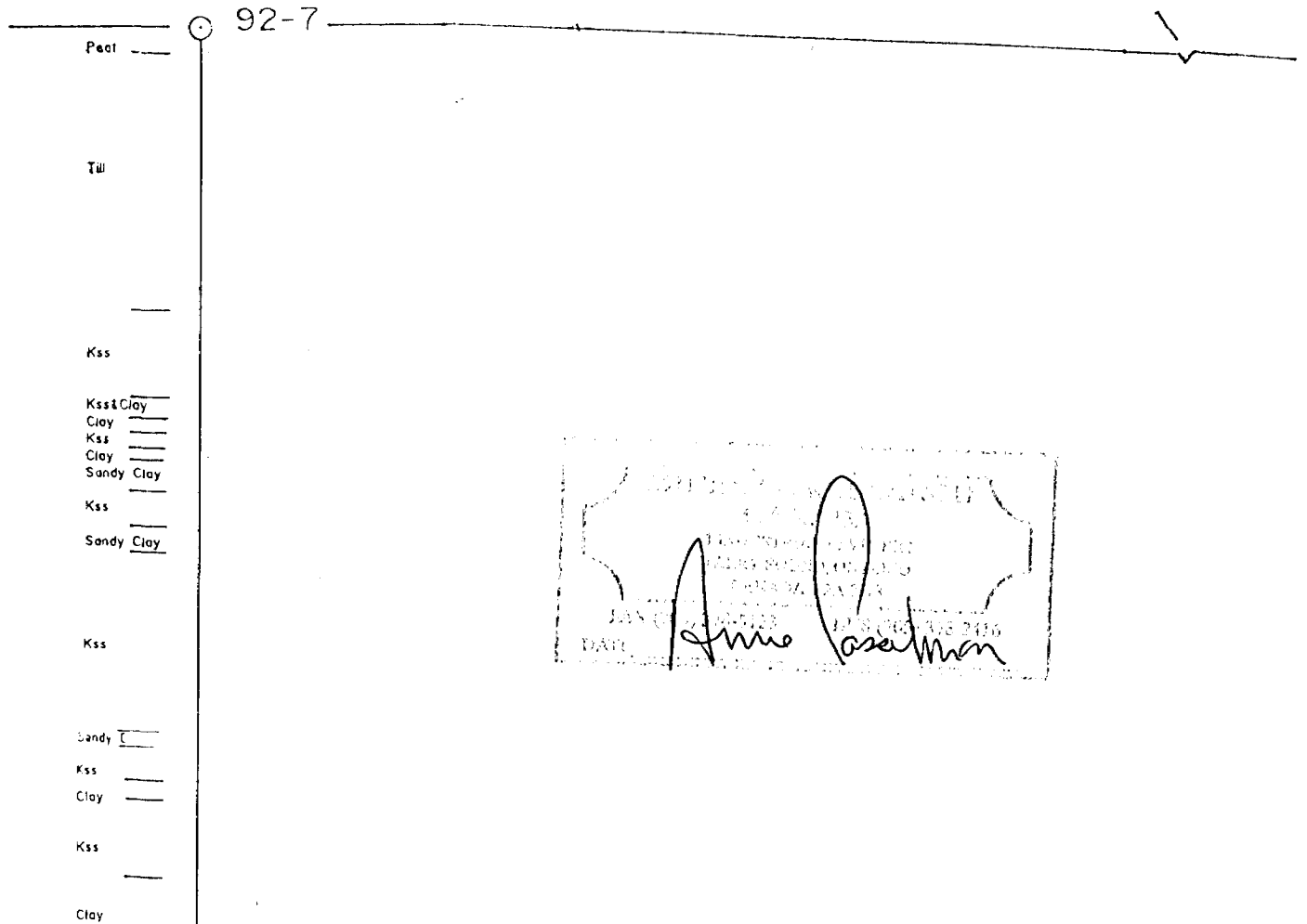

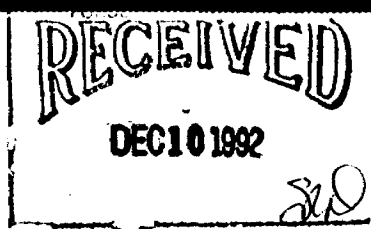

MINERAL RESEARCH CANADA Inc.

Mineral Processing Facility
Tel. (705) 378 - 2416
Fax. (705) 378 - 5123

1 Industrial Blvd. R. R. # 2
Parry Sound, Ontario
Canada P2A 2W8

LOCATION AND ACCESS TO PROPERTY

The kaolin/silica project claims are located in the townships of Kipling and Emerson in the area of and comprising the claims historically known as the Douglas property. The claims are on the Mattagami River in the area of the Kipling Hydro dam approximately 100 miles southwest of James Bay in Ontario.

The claims are accessible by driving north on highway 634 from Smooth Rock Falls to Fraserdale (approximately 45.0 miles). Then a private Ontario Hydro road may be taken west for 40 miles to the Smoky Falls dam. A road then continues north for approximately 6 miles to the Kipling dam.

CLAIM NUMBERS

The kaolin/silica property consists of 367 claims (as of Dec. 3, 1992) as well as 8 patented and one leased claim. The claim numbers are P 900001 - P 900100, P1089038 - 1089073, 1089078 - 1809111, 1090037 - 1090044, 1112282 to 1112306, 1112317 - 1112351, 825792 - 825811, 880001 - 880016, 970070 - 970104, 970168 - 970200 & 983551 - 983566.

The claim numbers that this work is to be filed on are P 900001 - 900100.

OWNERSHIP

The claims are wholly owned by Great Lakes Kaolin Inc.

PREVIOUS WORK

The property history as compiled by A. Gourley (1989) cites Robert Bell of the GSC as the first person to document the presence to clay and lignite in the James Bay Lowlands on Coal Brook in 1875. Borron (1891) reported extensive deposits of silica and clay on the Missinaibi River. In 1925, a report was produced by H. S. Hancock for McCarthy & Douglas regarding nine claims held on the bank of the Mattagami River and a company was formed (Northern Ontario China Clay Corporation).

In 1934 Minefinders Ltd financed the drilling of 18 holes on the west side of the Mattagami, directly across from the Douglas property, which became known as the General Refractory Products Ltd.

Fifteen holes were drilled in 1959 - 1960 by American Nepheline Ltd. with nine of these being in Kipling township.

The China Clay Syndicate comprised of New Calumet and Crang Securities drilled one hole to a depth of 163.0' north of the Douglas property in 1962. This hole is now known as C-1 after ownership transferal to the Chesterfield Mining & Exploration Co. Ltd.

Exploration in this areas continued in 1970, when Indusmin Ltd. drilled nine holes. The overburden depth in this area was approximately 100.0'.

Six hole were drilled by Geocon Ltd. on the Douglas claims in 1972. These claims were being leased by Brascan and a report was issued by C. Norman Simpson Consultants Ltd.

Ontario Geological Survey from 1975 - 1978 performed a drilling, geophysical, laboratory and field mapping study to determine Mesozoic stratigraphy.

Drilling was again conducted during 1981 by Selco Ltd. after a airborne magnetometer survey was completed. The seven holes were drilled into the anomalous magnetic areas.

Carlson Mines Ltd. optioned the Douglas property in 1985, and drilled five additional holes into the property. At this time a bulk sample was taken from the Douglas on which test work was performed by the Ontario Research Foundation (now Ortech International) and Lakefeild Research. Carlson Mines Ltd. failed to complete option payments on the property resulting in forfeiture.

In 1989 the Douglas property was acquired by 798839 Ontario Ltd. (under the management of James Bay Kaolin Corp.), as well adjoining claims were staked to bring the total to 380 claims. An exhaustive drilling program of 168 holes was undertaken in which WRA, STEM, viscosity, abrasion, particle size distributions, and various separation techniques were develop[ed as well as construction of a pilot plant begun.

In 1990 James Bay Kaolin Corp. was relieved of its managerial duties due to an improper rendering of accounts. The testing work continued, a 13 000 tonne bulk sample extracted and a 15 hole drilling program was completed in 1992 under the name of Mineral Research Canada Inc. for its associated company Great Lakes Kaolin Inc.

Mineral Research Canada Inc.

NO. 180

January 17, 1992

\$ 8,000.00

CERTIFIED
FEB 17 1992
THE ROYAL BANK OF CANADA
MAIN BRANCH, KITCHENER, ONT.

THE ORDER OF THE ROYAL BANK OF CANADA
Drilling Ltd.

8,000.00

/100 DOLLARS

ROYAL BANK OF CANADA
MAIN BRANCH
32 DUKE STREET WEST
KITCHENER, ONTARIO N2H 6L7

FOR agreement deposit

PER

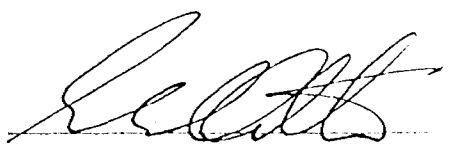

118-2237

⑆02482⑆003⑆

991⑆633⑆9⑆ 75

⑆0000800000⑆

Mineral Research Canada Inc.

NO. 220

March 19, 19 92

PAY TO THE ORDER OF J. R. Drilling Ltd.

\$ 25,272.15

⑆0002527215⑆

/100 DOLLARS

ROYAL BANK OF CANADA
MAIN BRANCH
32 DUKE STREET WEST,
KITCHENER, ONT. N2H 6L7

FOR _____

PER



⑆02482⑆003⑆

118⑆223⑆7⑆

⑆0002527215⑆

J R DRILLING LTD.

Madashville, Manitoba ROE OXO

Phone (204) 426-5597

Fax (204) 426-5458 (Manual)

Invoice No. 92-101-1

March 6th, 1992

Sold To: Mineral Research Canada Inc.
 1 Industrial Blvd. RR 2
 Parry Sound, Ontario P2A 2W8

Atten: XXXXXXXXXX

Contract: Rotasonic Drilling Program in N.E. Ont. Kipling Township
 Purchase Order No. 0038

J R Drilling Contract No. 92-101

DRILLING SERVICES SUPPLIED From February 21, 1992 to March 5, 1992
 (inclusive)

Mobilization and Demobilization		\$ 8,000.00
Moving and Standby hours: 101 hours @ \$200.00 per hour		\$ 20,200.00
Footage drilled 1,978 feet @ \$30.00 per foot		\$ 59,340.00
Travel time: 174.5 man hours @ \$30.00 per man hour		\$ 5,235.00
	Subtotal	\$ 92,775.00
	G.S.T. # 102727286	\$ 6,494.25
	Total Due	\$ 99,269.25
LESS ADVANCE DEPOSITS on	Feb. 19/92	(\$ 8,000.00)
	Feb. 21/92	(\$ 60,000.00)
	Feb. 28/92	(\$ 60,000.00)
BALANCE OF ADVANCE DEPOSIT		(\$ 28,730.75)

Report of Work Conducted After Recording Claim Mining Act

Transaction Number W9260.00171

Personal information collected on this form is obtained under the authority of the Mining Act. This information will be used for correspondence. Questions about this collection should be directed to the Provincial Manager, Mining Lands, Ministry of Northern Development and Mines, Fourth Floor, 159 Cedar Street, Sudbury, Ontario, P3E 6A5, telephone (705) 670-7264.

- Instructions: - Please type or print and submit in duplicate. - Refer to the Mining Act and Regulations for requirements of filing assessment work or consult the Mining Recorder. - A separate copy of this form must be completed for each Work Group. - Technical reports and maps must accompany this form in duplicate. - A sketch, showing the claims the work is assigned to, must accompany this form.

Recorded Holder(s) Great Lakes Kaolin Inc. Client No. 22-1553 Address 145 Columbia Street West, Waterloo, ON Telephone No. (519) 746-3101 Mining Division Percupine Township/Area Kipling Dates Work Performed From: Feb. 25, 1992 To: Mar. 15, 1992

Work Performed (Check One Work Group Only)

Table with columns: Work Group, Type. Includes checkboxes for Geotechnical Survey, Physical Work, Rehabilitation, Assays, etc. Includes a 'RECORDED' stamp dated DEC 10 1992.

Total Assessment Work Claimed on the Attached Statement of Costs \$ 24,040

Note: The Minister may reject for assessment work credit all or part of the assessment work submitted if the recorded holder cannot verify expenditures claimed in the statement of costs within 30 days of a request for verification.

Persons and Survey Company Who Performed the Work (Give Name and Address of Author of Report)

Name: Anne Casselman Address: Mineral Research Canada Inc, R.R.#2, Perry Sound, ON P2A 2W8

(attach a schedule if necessary)

Certification of Beneficial Interest * See Note No. 1 on reverse side

I certify that at the time the work was performed, the claims covered in this work report were recorded in the current holder's name or held under a beneficial interest by the current recorded holder. Date: DEC. 4/92 Recorded Holder or Agent (Signature): [Signature]

Certification of Work Report

I certify that I have a personal knowledge of the facts set forth in this Work report, having performed the work or witnessed same during and/or after its completion and annexed report is true. Name and Address of Person Certifying: Anne Casselman (Perry Sound address given above) Telephone No. (705) 378-2416 Date: Dec. 3, 1992 Certified By (Signature): Anne Casselman

For Office Use Only

Total Value Cr. Recorded: \$24,040 Date Recorded: DEC. 10/92 Mining Recorder: [Signature] Deemed Approval Date: MAR. 10/93 Date Approved: [Signature] RECEIVED stamp dated DEC 10 1992

AMENDED

Work Report Number Applying Reserve	Claim Number (see Note 2)	Number of Claim Units	Value of Assessment Work Done on this Claim	Value Applied to this Claim	Value Assigned from this Claim	Reserve Work to be Claimed at a Future Date
N/A	P825752	1	8033	0	8033	0
N/A	P1112320	1	8035	0	8035	0
N/A	P825757	1	7972	0	7932	40
N/A	PS00001	1	0	240	0	0
N/A	PS00002	1	0	240	0	0
N/A	PS00003	1	0	240	0	0
N/A	PS00004	1	0	240	0	0
N/A	PS00005	1	0	240	0	0
N/A	PS00006	1	0	240	0	0
N/A	PS00007	1	0	240	0	0
N/A	PS00008	1	0	240	0	0
N/A	PS00009	1	0	240	0	0
N/A	PS00010	1	0	240	0	0
N/A	PS00011	1	0	240	0	0
N/A	PS00012	1	0	240	0	0
N/A	PS00013	1	0	240	0	0
N/A	PS00014	1	0	240	0	0
<u>100</u>			<u>24,040</u>	<u>24,000</u>	<u>24,000</u>	<u>40</u>
Total Number of Claims		+3	Total Value Work Done	Total Value Work Applied	Total Assigned From	Total Reserve

Credits you are claiming in this report may be cut back. In order to minimize the adverse effects of such deletions, please indicate from which claims you wish to prioritize the deletion of credits. Please mark (✓) one of the following:

- Credits are to be cut back starting with the claim listed last, working backwards.
- Credits are to be cut back equally over all claims contained in this report of work.
- Credits are to be cut back as prioritized on the attached appendix.

In the event that you have not specified your choice of priority, option one will be implemented.

Note 1: Examples of beneficial interest are unrecorded transfers, option agreements, memorandum of agreements, etc., with respect to the mining claims.

Note 2: If work has been performed on patented or leased land, please complete the following:

I certify that the recorded holder had a beneficial interest in the patented or leased land at the time the work was performed.	Date
Signature	Date

Work Report Number for Applying Reserve	Claim Number (see Note 2)	Number of Claim Units
NIA	P900066	1
NIA	P900067	1
NIA	P900068	1
NIA	P900069	1
NIA	P900070	1
NIA	P900071	1
NIA	P900072	1
NIA	P900073	1
NIA	P900074	1
NIA	P900075	1
NIA	P900076	1
NIA	P900077	1
NIA	P900078	1
NIA	P900079	1
NIA	P900080	1
NIA	P900081	1
NIA	P900082	1
Total Number		

Value of Assessment Work Done on this Claim	Value Applied to this Claim
0	240
0	240
0	240
0	240
0	240
0	240
0	240
0	240
0	240
0	240
0	240
0	240
0	240
0	240
0	240
0	240
0	240
Total Value Work	Total Value

Value Assigned from this Claim	Reserve: Work to be Claimed at a Future Date
0	0
0	0
0	0
0	0
0	0
0	0
0	0
0	0
0	0
0	0
0	0
0	0
0	0
0	0
0	0
0	0
0	0
Total Assigned	Total Reserve

Credits you are claiming in this report may be cut back. In order to minimize the adverse effects of such deletions, please indicate from which claims you wish to prioritize the deletion of credits. Please mark (✓) one of the following:

1. Credits are to be cut back starting with the claim listed last, working backwards.
2. Credits are to be cut back equally over all claims contained in this report of work.
3. Credits are to be cut back as prioritized on the attached appendix.

In the event that you have not specified your choice of priority, option one will be implemented.

Note 1: Examples of beneficial interest are unrecorded transfers, option agreements, memorandum of agreements, etc., with respect to the mining claims.

Note 2: If work has been performed on patented or leased land, please complete the following:

I certify that the recorded holder had a beneficial interest in the patented or leased land at the time the work was performed.

Signature

Date



Ministry of
Northern Development
and Mines

Ministère du
Développement du Nord
et des mines

**Statement of Costs
for Assessment Credit**

**État des coûts aux fins
du crédit d'évaluation**

Mining Act/Loi sur les mines

Transaction No./N° de transaction
W9260.00171

Personal information collected on this form is obtained under the authority of the Mining Act. This information will be used to maintain a record and ongoing status of the mining claim(s). Questions about this collection should be directed to the Provincial Manager, Minings Lands, Ministry of Northern Development and Mines, 4th Floor, 159 Cedar Street, Sudbury, Ontario P3E 6A5, telephone (705) 670-7264.

Les renseignements personnels contenus dans la présente formule sont recueillis en vertu de la Loi sur les mines et serviront à tenir à jour un registre des concessions minières. Adresser toute question sur la collecte de ces renseignements au chef provincial des terrains miniers, ministère du Développement du Nord et des Mines, 159, rue Cedar, 4^e étage, Sudbury (Ontario) P3E 6A5, téléphone (705) 670-7264.

1. Direct Costs/Coûts directs

Type	Description	Amount Montant	Totals Total global
Wages Salaires	Labour Main-d'oeuvre		
	Field Supervision Supervision sur le terrain		
Contractor's and Consultant's Fees Droits de l'entrepreneur et de l'expert- conseil	Type Rotasonic Drilling		
	748h x \$30.00 =	\$ 22,440	
Supplies Used Fournitures utilisées	Type		
Equipment Rental Location de matériel	Type		
Total Direct Costs Total des coûts directs			22,440

2. Indirect Costs/Coûts indirects

** Note: When claiming Rehabilitation work Indirect costs are not allowable as assessment work.
Pour le remboursement des travaux de réhabilitation, les coûts indirects ne sont pas admissibles en tant que travaux d'évaluation.

Type	Description	Amount Montant	Totals Total global
Transportation Transport	Type		
	RECEIVED 11 FEB 1992 12:00 P.M. 840		
Food and Lodging Nourriture et hébergement			
Mobilization and Demobilization Mobilisation et démobilisation	J.R. Drilling From Manitoba 8000.00		
Sub Total of Indirect Costs Total partiel des coûts indirects			8000.00
Amount Allowable (not greater than 20% of Direct Costs) Montant admissible (n'excédant pas 20 % des coûts directs)			4500.00
Total Value of Assessment Credit (Total of Direct and Allowable indirect costs)			24,940
Valeur totale du crédit d'évaluation (Total des coûts directs et indirects admissibles)			

Note: The recorded holder will be required to verify expenditures claimed in this statement of costs within 30 days of a request for verification. If verification is not made, the Minister may reject for assessment work all or part of the assessment work submitted.

Note : Le titulaire enregistré sera tenu de vérifier les dépenses demandées dans le présent état des coûts dans les 30 jours suivant une demande à cet effet. Si la vérification n'est pas effectuée, le ministre peut rejeter tout ou une partie des travaux d'évaluation présentés.

Filing Discounts

1. Work filed within two years of completion is claimed at 100% of the above Total Value of Assessment Credit.
2. Work filed three, four or five years after completion is claimed at 50% of the above Total Value of Assessment Credit. See calculations below:

Total Value of Assessment Credit	Total Assessment Claimed
	× 0.50 =

Remises pour dépôt

1. Les travaux déposés dans les deux ans suivant leur achèvement sont remboursés à 100 % de la valeur totale susmentionnée du crédit d'évaluation.
2. Les travaux déposés trois, quatre ou cinq ans après leur achèvement sont remboursés à 50 % de la valeur totale du crédit d'évaluation susmentionné. Voir les calculs ci-dessous.

Valeur totale du crédit d'évaluation	Evaluation totale demandée
	× 0,50 =

Certification Verifying Statement of Costs

I hereby certify:
that the amounts shown are as accurate as possible and these costs were incurred while conducting assessment work on the lands shown on the accompanying Report of Work form.

that as Resident I am authorized
(Recorded Holder, Agent, Position in Company)

to make this certification

Attestation de l'état des coûts

J'atteste par la présente :
que les montants indiqués sont le plus exact possible et que ces dépenses ont été engagées pour effectuer les travaux d'évaluation sur les terrains indiqués dans la formule de rapport de travail ci-joint.

Et qu'à titre de _____ je suis autorisé
(titulaire enregistré, représentant, poste occupé dans la compagnie)

à faire cette attestation.

Signature 	Date Dec. 4/92
---------------	-------------------

C-88E

KIPLING TWP

C-88E

THE INFORMATION THAT APPEARS ON THIS MAP HAS BEEN COMPILED FROM VARIOUS SOURCES AND ACCURACY IS NOT GUARANTEED. THOSE WISHING TO STAKE MINING CLAIMS SHOULD CONSULT WITH THE MINING RECORDER, MINISTRY OF NORTHERN DEVELOPMENT AND MINES, FOR ADDITIONAL INFORMATION ON THE STATUS OF THE LANDS SHOWN HEREON.

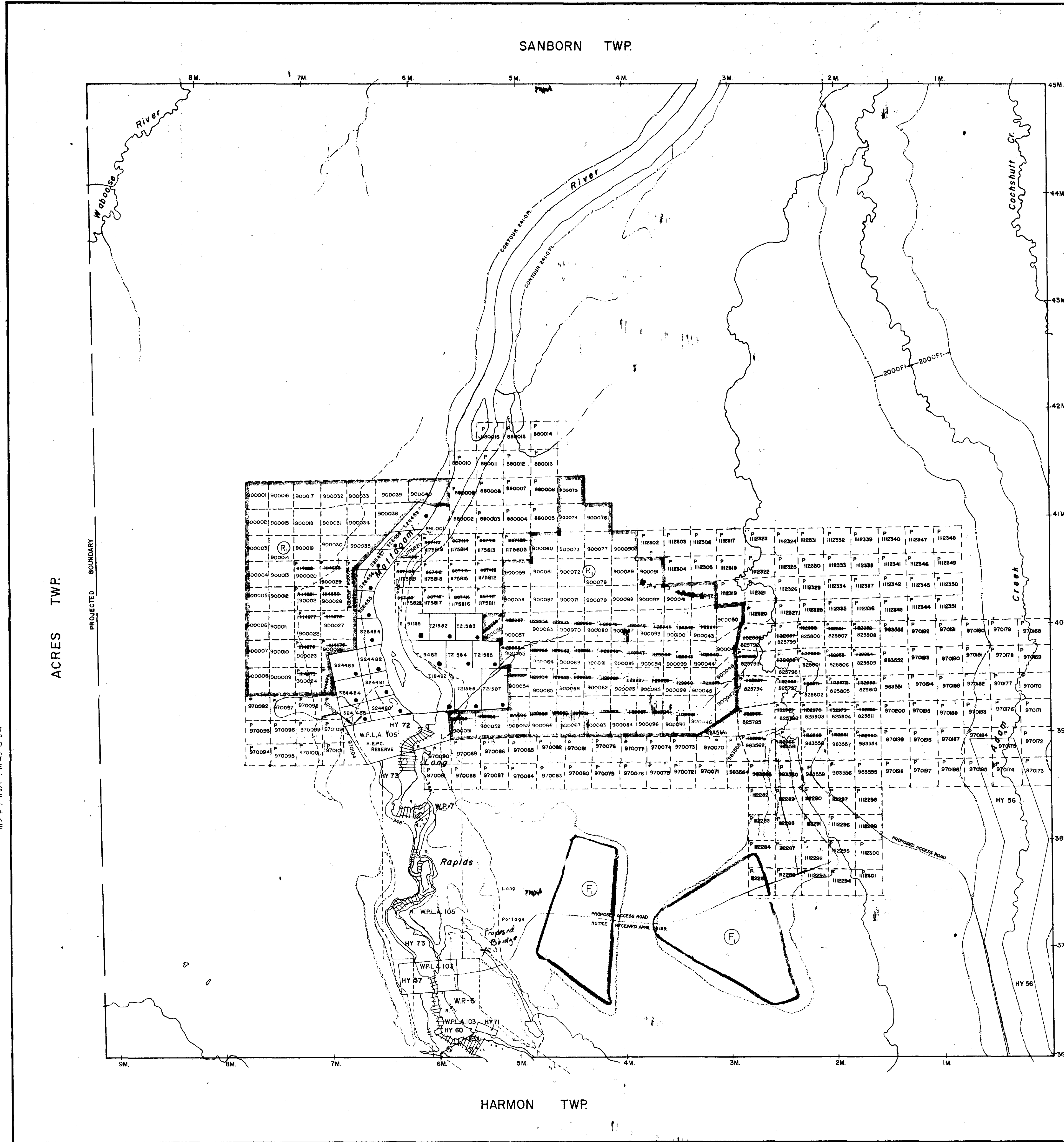

LEGEND

HIGHWAY AND ROUTE No.

OTHER ROADS

TRAILS

SURVEYED LINES: TOWNSHIPS, BASE LINES, ETC.

LOTS, MINING CLAIMS, PARCELS, ETC.

UNSURVEYED LINES: LOT LINES

PARCEL BOUNDARY

MINING CLAIMS ETC.

RAILWAY AND RIGHT OF WAY

UTILITY LINES

NON-PERENNIAL STREAM

FLOODING OR FLOODING RIGHTS

SUBDIVISION OR COMPOSITE PLAN

RESERVATIONS

ORIGINAL SHORELINE

MARSH OR MUSKEG

MINES

TRAVERSE MONUMENT

DISPOSITION OF CROWN LANDS

TYPE OF DOCUMENT	SYMBOL
PATENT, SURFACE & MINING RIGHTS	
" SURFACE RIGHTS ONLY	
" MINING RIGHTS ONLY	
LEASE SURFACE & MINING RIGHTS	
" SURFACE RIGHTS ONLY	
" MINING RIGHTS ONLY	
LICENCE OF OCCUPATION	
ORDER-IN-COUNCIL	
RESERVATION	
CANCELLED	
SAND & GRAVEL	

NOTE: MINING RIGHTS IN PARCELS PATENTED PRIOR TO MAY 5, 1915, VESTED IN ORIGINAL PATENTEE BY THE PUBLIC LANDS ACT, R.S.O. 1970, CHAP. 380, SEC. 63, SUBSEC. 1.

NOTES

FLOODING RESERVATION TO CONTOUR ELEVATION 2410 FT. FROM GRAND RAPIDS TO TAILWATER OF KIPLING G.S.T. RESERVED FOR ONTARIO HYDRO.

FLOODING RESERVATION ON ADAM CREEK EXTENDED TO 2000' EACH SIDE OF CENTERLINE OF CREEK, RESERVED FOR ONTARIO HYDRO.

AREAS WITHDRAWN FROM DISPOSITION

M.R.O. - MINING RIGHTS ONLY

S.R.O. - SURFACE RIGHTS ONLY

M.+S. - MINING AND SURFACE RIGHTS

Description	Order No.	Date	Disposition	File
(R)			LAND NOT OPEN FOR STAKING	SECTION 303 OF THE MINING ACT R.S.O. 1980

NOTES

(F) THIS TWP IS SUBJECT TO FORESTRY ACTIVITIES IN 1990. FURTHER INFORMATION AVAILABLE ON FILE.

SCALE: 1 INCH = 40 CHAINS

FEET 0 1000 2000 4000 6000 8000

METRES 0 200 1000 2000 (2 KM)

ACRES 40 HECTARES 16

TOWNSHIP OF

KIPLING

DISTRICT

COCHRANE

MINING DIVISION

PORCUPINE

RECEIVED

JAN 22 1986

Ministry of Natural Resources Ontario

Ministry of Northern Development and Mines

Date JULY 1986 Plan No. **G-896**

National Topographic Series
PLATED MAY 1985
 PLACED IN ACTIVE FILE 3/20/86

C-88E

KIPLING TWP

C-88E



■ PAVED LANE
 ■ UNPAVED LANE

A. [Signature]

KIPLING PROJECT
 DRILL HOLE PLAN - Regional Sketch
 C. [Signature]
 S.C. 118348 T-1000
 DRAWING NO. _____
 DATE: JULY 1991



COMPRISING OF MINING CLAIMS

P 825792, P 825793, P 825794, P 825795, P 825796, P 825797, P 825798,
 P 825799, P 825800, P 825801, P 825802, P 825803, P 825804, P 825805,
 P 825806, P 825807, P 825808, P 825809, P 825810 AND P 825811

TOWNSHIP OF KIPLING

DISTRICT OF COCHRANE

SCALE - 1 inch = 400 feet
 1 : 4200

400 0'

SCHEDULE					
PART	MINING CLAIM	ACRES	HECTARES	PARCEL	RIGHTS
1	CLM 419	662.13	267.956	CROWN	SURFACE AND MINING
TOTAL AREA		662.13	267.956		

KIPLING TOWNSHIP

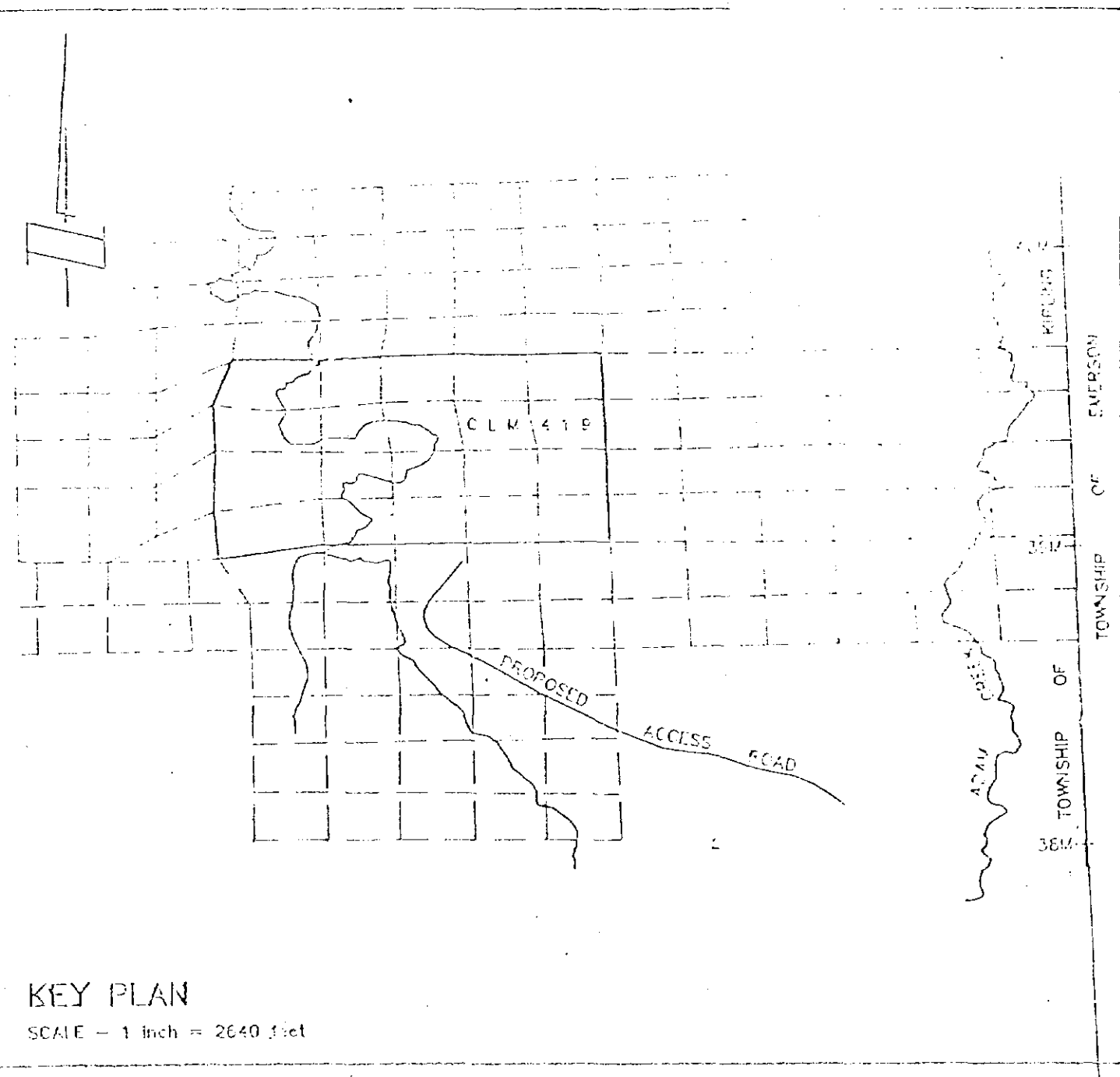
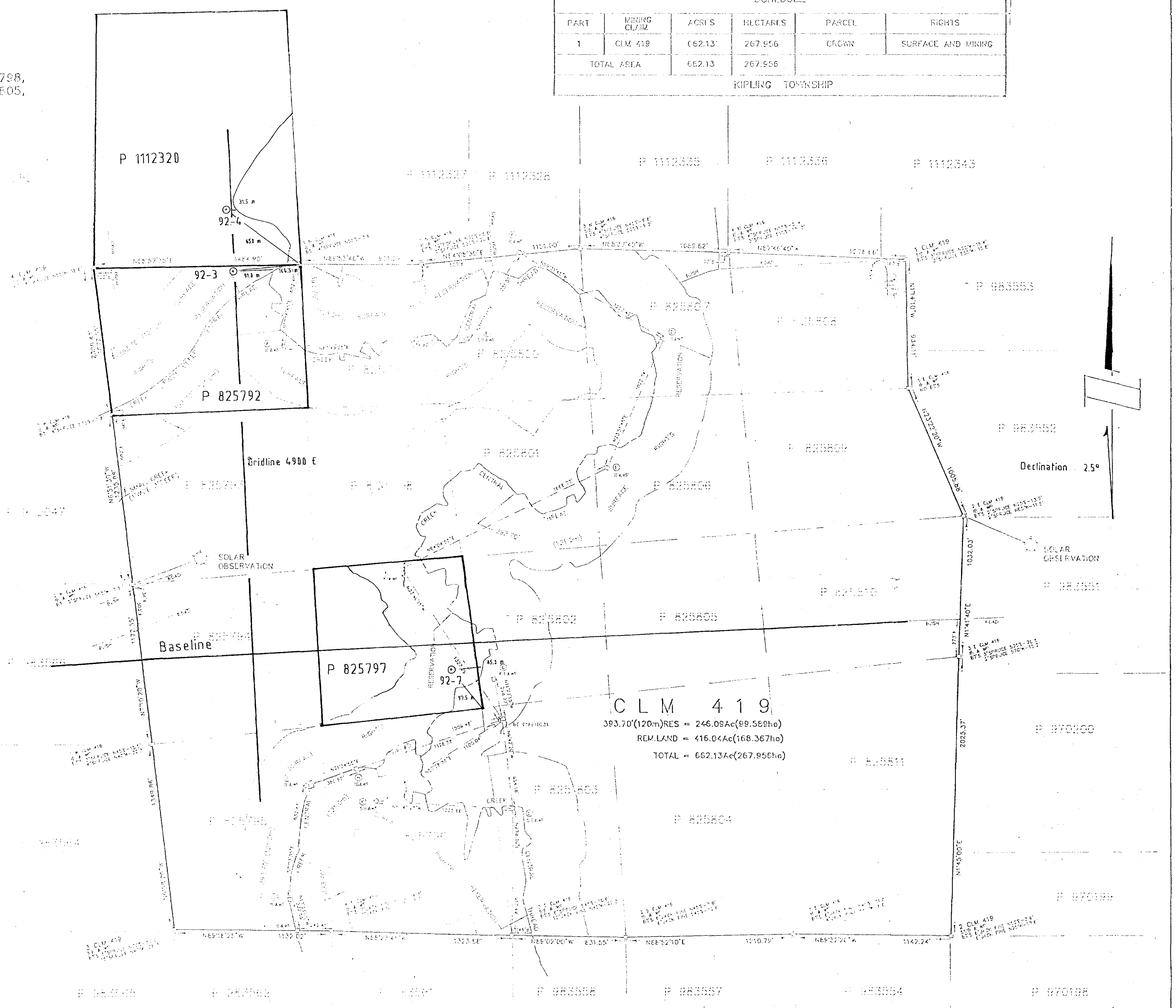

KEY PLAN
 SCALE - 1 inch = 2640 feet

- LEGEND**
- DENOTES PLANTED MONUMENT
 - DENOTES FOUND MONUMENT
 - IB DENOTES 5/8 IN SQ IRON BAR 2.0 FT LONG
 - SIB DENOTES 1 IN SQ IRON BAR 4.0 FT LONG
 - .SIB DENOTES 1 IN SQ IRON BAR 2.0 FT LONG
 - BC DENOTES BRASS CAP
 - WT DENOTES WITNESS
 - WP DENOTES WOODEN GUIDE POST
 - BT DENOTES BEARING TREE
 - PLT DENOTES PLANTED
 - FD DENOTES FOUND
 - ALL HANGING LINES HAVE BEEN VERNIERED

KIPLING DRILL PLAN

BEARING NOTE
 BEARINGS ARE ASTROGNOMIC AND ARE DERIVED FROM SOLAR OBSERVATIONS AT CORNER 2E CLM 419 (LONGITUDE 82°06'50") AND REFERRED TO THE MERIDIAN THROUGH THE CENTRE OF KIPLING TOWNSHIP (LONGITUDE 82°10'33")

DATE: *A. Osabian*



Report of Work Conducted After Recording Claim

Mining Act

Transaction Number
W9260.00171

ASSM'T FILES

Personal information collected on this form is obtained under the authority of the Mining Act. This collection should be directed to the Provincial Manager, Mining Lands, Ministry of Northern Development and Mines, Sudbury, Ontario, P3E 6A5, telephone (705) 670-7284.



- Instructions:**
- Please type or print and submit in duplicate.
 - Refer to the Mining Act and Regulations for requirements of filing assessment work of certain mining recorders.
 - A separate copy of this form must be completed for each Work Group.
 - Technical reports and maps must accompany this form in duplicate.
 - A sketch, showing the claims the work is assigned to, must accompany this form.

Recorded Holder(s) <i>Great Lakes Kaelin Inc.</i>		Client No. <i>221553</i>
Address <i>145 Columbia Street West, Waterloo, ON</i>		Telephone No. <i>(519) 746-8101</i>
Mining Division <i>Poccupine</i>	Township/Area <i>Kipling</i>	M or G Plan No.
Dates Work Performed From: <i>Feb. 25, 1992</i>		To: <i>Mar. 15, 1992</i>

Work Performed (Check One Work Group Only)

Work Group	Type
Geotechnical Survey	
Physical Work, Including Drilling	<i>Rotasonic Drilling</i>
Rehabilitation	
Other Authorized Work	
Assays	
Assignment from Reserve	

RECORDED
DEC 10 1992
Receipt _____

Total Assessment Work Claimed on the Attached Statement of Costs \$ *24,040*

Note: The Minister may reject for assessment work credit all or part of the assessment work submitted if the recorded holder cannot verify expenditures claimed in the statement of costs within 30 days of a request for verification.

Persons and Survey Company Who Performed the Work (Give Name and Address of Author of Report)

Name <i>Anne Casselman</i>	Address <i>Mineral Research Canada Inc R.R. #2 Tarry Sand, ON P2A 2W8</i>
-------------------------------	--

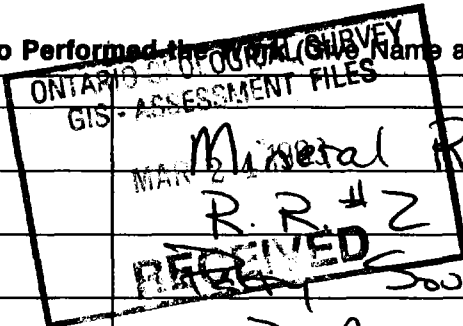

(attach a schedule if necessary)

Certification of Beneficial Interest * See Note No. 1 on reverse side

I certify that at the time the work was performed, the claims covered in this work report were recorded in the current holder's name or held under a beneficial interest by the current recorded holder.	Date <i>Dec. 4/92</i>	Recorded Holder or Agent (Signature) <i>[Signature]</i>
--	--------------------------	--

Certification of Work Report

I certify that I have a personal knowledge of the facts set forth in this Work report, having performed the work or witnessed same during and/or after its completion and annexed report is true.		
Name and Address of Person Certifying <i>Anne Casselman (Tarry Sand address given above)</i>		
Telephone No. <i>(705) 378-2416</i>	Date <i>Dec. 3, 1992</i>	Certified By (Signature) <i>Anne Casselman</i>

For Office Use Only

Total Value Cr. Recorded <i>\$24,040</i>	Date Recorded <i>DEC. 10/92</i>	Mining Recorder <i>[Signature]</i>	
	Deemed Approval Date <i>MAR. 10/93</i>	Date Approved	
	Date Notice for Amendments Sent		

AMENDED

Work Report Number (Applying Reserve)	Claim Number (see Note 2)	Number of Claim Units	Value of Assessment Work Done on this Claim	Value Applied to this Claim	Value Assigned from this Claim	Reserve Workable Claimed at a Future Date
N/A	P825752	1	8033	0	8033	0
N/A	P1112320	1	8035	0	8035	0
N/A	P825757	1	7972	0	7932	40
N/A	P500001	1	0	240	0	0
N/A	P500002	1	0	240	0	0
N/A	P500003	1	0	240	0	0
N/A	P500004	1	0	240	0	0
N/A	P500005	1	0	240	0	0
N/A	P500006	1	0	240	0	0
N/A	P500007	1	0	240	0	0
N/A	P500008	1	0	240	0	0
N/A	P500009	1	0	240	0	0
N/A	P500010	1	0	240	0	0
N/A	P500011	1	0	240	0	0
N/A	P500012	1	0	240	0	0
N/A	P500013	1	0	240	0	0
N/A	P500014	1	0	240	0	0
	100		24,040	24,000	24,000	40

Total Value Work Done 24,040 Total Value Applied 24,000 Total Reserve 40

Notes:
 1: Examples of beneficial interest are unrecorded transfers, option agreements, memorandum of agreements, etc., with respect to the mining claims.
 2: If work has been performed on patented or leased land, please complete the following:
 I certify that the recorded holder had a beneficial interest in the patented or leased land at the time the work was performed.
 Signature _____
 Date _____

Credits you are claiming in this report may be cut back. In order to minimize the adverse effects of such deletions, please indicate from which claims you wish to prioritize the deletion of credits. Please mark (✓) one of the following:
 Credits are to be cut back starting with the claim listed last, working backwards.
 Credits are to be cut back equally over all claims contained in this report of work.
 Credits are to be cut back as prioritized on the attached appendix.
 In the event that you have not specified your choice of priority, option one will be implemented.

Numéro de rapport sur les travaux exécutés pour l'affectation de la réserve	Numéro de claim	Nombre d'unités
N/A	P900015	1
N/A	P900016	1
N/A	P900017	1
N/A	P900018	1
N/A	P900019	1
N/A	P900020	1
N/A	P900021	1
N/A	P900022	1
N/A	P900023	1
N/A	P900024	1
N/A	P900025	1
N/A	P900026	1
N/A	P900027	1
N/A	P900028	1
N/A	P900029	1
N/A	P900030	1
N/A	P900031	1
Nombre total de claims		

Valeur des travaux d'évaluation exécutés sur ce claim	Valeur affectée à ce claim
0	240
0	240
0	240
0	240
0	240
0	240
0	240
0	240
0	240
0	240
0	240
0	240
0	240
0	240
0	240
0	240
Valeur totale des travaux exécutés	Valeur totale des travaux qui a été affectée

Valeur transférée de ce claim	Réserve : travaux à réclamer à une date ultérieure
0	0
0	0
0	0
0	0
0	0
0	0
0	0
0	0
0	0
0	0
0	0
0	0
0	0
0	0
0	0
0	0
Total transféré	Réserve totale

Les crédits que vous réclamez dans le présent rapport peuvent être réduits. Afin de diminuer les conséquences défavorables de telles réductions, veuillez indiquer l'ordre dans lequel vous désirez qu'elles soient appliquées à vos claims. Veuillez cocher (✓) l'une des options suivantes :

- Les crédits doivent être réduits en commençant par le dernier claim sur la liste.
- Les crédits doivent être réduits également entre tous les claims figurant dans le présent rapport.
- Les crédits doivent être réduits selon l'ordre donné en annexe.

Si vous n'avez pas choisi d'option, la première sera appliquée.

Note 1 : Exemples d'intérêts bénéficiaires : cessions non enregistrées, ententes sur des options, protocoles d'entente, etc. relatifs aux claims.

Note 2 : Si des travaux ont été exécutés sur un terrain faisant l'objet de lettres patentes ou d'un bail, veuillez remplir ce qui suit:

Je certifie que le titulaire enregistré possédait un intérêt bénéficiaire sur le terrain faisant l'objet de lettres patentes ou d'un bail, au moment où les travaux ont été exécutés.	Signature	Date
---	-----------	------

Work Report Number for Assigning Reserve	Claim Number (see Note 2)	Number of Claim Units
NIA	P900032	1
NIA	P900033	1
NIA	P900034	1
NIA	P900035	1
NIA	P900036	1
NIA	P900037	1
NIA	P900038	1
NIA	P900039	1
NIA	P900040	1
NIA	P900041	1
NIA	P900042	1
NIA	P900043	1
NIA	P900044	1
NIA	P900045	1
NIA	P900046	1
NIA	P900047	1
NIA	P900048	1
Total Number		

Value of Assessment Work Done on this Claim	Value Applied to this Claim	Total Value Work	Total Value
0	240	0	240
0	240	0	240
0	240	0	240
0	240	0	240
0	240	0	240
0	240	0	240
0	240	0	240
0	240	0	240
0	240	0	240
0	240	0	240
0	240	0	240
0	240	0	240
0	240	0	240
0	240	0	240
0	240	0	240
0	240	0	240
0	240	0	240
0	240	0	240
Total Value Work			Total Value

Value Assigned from this Claim	Reserve: Work to be Claimed at a Future Date	Total Assigned	Total Reserve
0	0	0	0
0	0	0	0
0	0	0	0
0	0	0	0
0	0	0	0
0	0	0	0
0	0	0	0
0	0	0	0
0	0	0	0
0	0	0	0
0	0	0	0
0	0	0	0
0	0	0	0
0	0	0	0
0	0	0	0
0	0	0	0
0	0	0	0
0	0	0	0
Total Assigned			Total Reserve

Credits you are claiming in this report may be cut back. In order to minimize the adverse effects of such deletions, please indicate from which claims you wish to prioritize the deletion of credits. Please mark (✓) one of the following:

- Credits are to be cut back starting with the claim listed last, working backwards.
- Credits are to be cut back equally over all claims contained in this report of work.
- Credits are to be cut back as prioritized on the attached appendix.

In the event that you have not specified your choice of priority, option one will be implemented.

Note 1: Examples of beneficial interest are unrecorded transfers, option agreements, memorandum of agreements, etc., with respect to the mining claims.

Note 2: If work has been performed on patented or leased land, please complete the following:

Signature	Date
-----------	------

I certify that the recorded holder had a beneficial interest in the patented or leased land at the time the work was performed.

Work Report Number for Applying Reserve	Claim Number (see Note 2)	Number of Claim Units
N/A	P900049	1
N/A	P500050	1
N/A	P500051	1
N/A	P500052	1
N/A	P500053	1
N/A	P500054	1
N/A	P500055	1
N/A	P500056	1
N/A	P900057	1
N/A	P500058	1
N/A	P500059	1
N/A	P500060	1
N/A	P500061	1
N/A	P500062	1
N/A	P500063	1
N/A	P500064	1
N/A	P500065	1

Total Number of Claims

Value of Assessment Work Done on this Claim	Value Applied to this Claim
0	240
0	240
0	240
0	240
0	240
0	240
0	240
0	240
0	240
0	240
0	240
0	240
0	240
0	240
0	240
0	240
0	240

Total Value Work Done

Total Value Work Applied

Value Assigned from this Claim	Reserve: Work to be Claimed at a Future Date
0	0
0	0
0	0
0	0
0	0
0	0
0	0
0	0
0	0
0	0
0	0
0	0
0	0
0	0
0	0
0	0
0	0

Total Assigned From

Total Reserve

Credits you are claiming in this report may be cut back. In order to minimize the adverse effects of such deletions, please indicate from which claims you wish to prioritize the deletion of credits. Please mark (✓) one of the following:

1. Credits are to be cut back starting with the claim listed last, working backwards.
2. Credits are to be cut back equally over all claims contained in this report of work.
3. Credits are to be cut back as prioritized on the attached appendix.

In the event that you have not specified your choice of priority, option one will be implemented.

Note 1: Examples of beneficial interest are unrecorded transfers, option agreements, memorandum of agreements, etc., with respect to the mining claims.

Note 2: If work has been performed on patented or leased land, please complete the following:

I certify that the recorded holder had a beneficial interest in the patented or leased land at the time the work was performed.	Signature	Date
---	-----------	------

Work Report Number for Applying Reserve	Claim Number (see Note 2)	Number of Claim Units
N/A	P900066	1
N/A	P900067	1
N/A	P900068	1
N/A	P900069	1
N/A	P900070	1
N/A	P900071	1
N/A	P900072	1
N/A	P900073	1
N/A	P900074	1
N/A	P900075	1
N/A	P900076	1
N/A	P900077	1
N/A	P900078	1
N/A	P900079	1
N/A	P900080	1
N/A	P900081	1
N/A	P900082	1
Total Number		

Value of Assessment Work Done on this Claim	Value Applied to this Claim	Total Value Work	Total Value
0	240		
0	240		
0	240		
0	240		
0	240		
0	240		
0	240		
0	240		
0	240		
0	240		
0	240		
0	240		
0	240		
0	240		
0	240		
0	240		
0	240		
0	240		
0	240		
0	240		
Total Value Work			

Value Assigned from this Claim	Reserve: Work to be Claimed at a Future Date	Total Assigned	Total Reserve
0	0		
0	0		
0	0		
0	0		
0	0		
0	0		
0	0		
0	0		
0	0		
0	0		
0	0		
0	0		
0	0		
0	0		
0	0		
0	0		
0	0		
0	0		
0	0		
0	0		
Total Assigned			

Credits you are claiming in this report may be cut back. In order to minimize the adverse effects of such deletions, please indicate from which claims you wish to prioritize the deletion of credits. Please mark (✓) one of the following:

- Credits are to be cut back starting with the claim listed last, working backwards.
- Credits are to be cut back equally over all claims contained in this report of work.
- Credits are to be cut back as prioritized on the attached appendix.

In the event that you have not specified your choice of priority, option one will be implemented.

note 1: Examples of beneficial interest are unrecorded transfers, option agreements, memorandum of agreements, etc., with respect to the mining claims.

note 2: If work has been performed on patented or leased land, please complete the following:

I certify that the recorded holder had a beneficial interest in the patented or leased land at the time the work was performed.

Signature _____ Date _____

Work Report Number for Applying Reserve	Claim Number (see Note 2)	Number of Claim Units
N/A	P900083	1
N/A	P900084	1
N/A	P900085	1
N/A	P900086	1
N/A	P900087	1
N/A	P900088	1
N/A	P900089	1
N/A	P900090	1
N/A	P900091	1
N/A	P900092	1
N/A	P900093	1
N/A	P900094	1
N/A	P900095	1
N/A	P900096	1
N/A	P900097	1
N/A	P900098	1
N/A	P900099	1
Total Number of Claims		

Value of Assessment Work Done on this Claim	Value Applied to this Claim
0	240
0	240
0	240
0	240
0	240
0	240
0	240
0	240
0	240
0	240
0	240
0	240
0	240
0	240
0	240
0	240
0	240
Total Value Work Done	
Total Value Work Applied	

Value Assigned from this Claim	Reserve: Work to be Claimed at a Future Date
0	0
0	0
0	0
0	0
0	0
0	0
0	0
0	0
0	0
0	0
0	0
0	0
0	0
0	0
0	0
0	0
0	0
Total Assigned From	
Total Reserve	

Credits you are claiming in this report may be cut back. In order to minimize the adverse effects of such deletions, please indicate from which claims you wish to prioritize the deletion of credits. Please mark (✓) one of the following:

1. Credits are to be cut back starting with the claim listed last, working backwards.
2. Credits are to be cut back equally over all claims contained in this report of work.
3. Credits are to be cut back as prioritized on the attached appendix.

In the event that you have not specified your choice of priority, option one will be implemented.

Note 1: Examples of beneficial interest are unrecorded transfers, option agreements, memorandum of agreements, etc., with respect to the mining claims.

Note 2: If work has been performed on patented or leased land, please complete the following:

I certify that the recorded holder had a beneficial interest in the patented or leased land at the time the work was performed.	Signature	Date
---	-----------	------



Ministry of
Northern Development
and Mines

Ministère du
Développement du Nord
et des mines

**Statement of Costs
for Assessment Credit**

**État des coûts aux fins
du crédit d'évaluation**

Mining Act/Loi sur les mines

Transaction No./N° de transaction

W9260.00171

Personal information collected on this form is obtained under the authority of the Mining Act. This information will be used to maintain a record and ongoing status of the mining claim(s). Questions about this collection should be directed to the Provincial Manager, Minings Lands, Ministry of Northern Development and Mines, 4th Floor, 159 Cedar Street, Sudbury, Ontario P3E 6A5, telephone (705) 670-7264.

Les renseignements personnels contenus dans la présente formule sont recueillis en vertu de la Loi sur les mines et serviront à tenir à jour un registre des concessions minières. Adresser toute question sur la collecte de ces renseignements au chef provincial des terrains miniers, ministère du Développement du Nord et des Mines, 159, rue Cedar, 4^e étage, Sudbury (Ontario) P3E 6A5, téléphone (705) 670-7264.

1. Direct Costs/Coûts directs

Type	Description	Amount Montant	Totals Total global
Wages Salaires	Labour Main-d'oeuvre		
	Field Supervision Supervision sur le terrain		
Contractor's and Consultant's Fees Droits de l'entrepreneur et de l'expert- conseil	Type Rotasonic Drilling		
	748h x \$30.00 =	\$	
Supplies Used Fournitures utilisées	Type		
Equipment Rental Location de matériel	Type		
Total Direct Costs Total des coûts directs			

2. Indirect Costs/Coûts indirects

** Note: When claiming Rehabilitation work Indirect costs are not allowable as assessment work.
Pour le remboursement des travaux de réhabilitation, les coûts indirects ne sont pas admissibles en tant que travaux d'évaluation.

Type	Description	Amount Montant	Totals Total global
Transportation Transport	Type		
Food and Lodging Nourriture et hébergement			
Mobilization and Demobilization Mobilisation et démobilisation	J.R. Drilling From Manitoba	\$0000	
Sub Total of Indirect Costs Total partiel des coûts indirects			
Amount Allowable (not greater than 20% of Direct Costs) Montant admissible (n'excédant pas 20 % des coûts directs)			
Total Value of Assessment Credit (Total of Direct and Allowable indirect costs)		Valeur totale du crédit d'évaluation (Total des coûts directs et indirects admissibles)	

Note: The recorded holder will be required to verify expenditures claimed in this statement of costs within 30 days of a request for verification. If verification is not made, the Minister may reject for assessment work all or part of the assessment work submitted.

Note : Le titulaire enregistré sera tenu de vérifier les dépenses demandées dans le présent état des coûts dans les 30 jours suivant une demande à cet effet. Si la vérification n'est pas effectuée, le ministre peut rejeter tout ou une partie des travaux d'évaluation présentés.

Filing Discounts

1. Work filed within two years of completion is claimed at 100% of the above Total Value of Assessment Credit.
2. Work filed three, four or five years after completion is claimed at 50% of the above Total Value of Assessment Credit. See calculations below:

Total Value of Assessment Credit	Total Assessment Claimed
	× 0.50 =

Remises pour dépôt

1. Les travaux déposés dans les deux ans suivant leur achèvement sont remboursés à 100 % de la valeur totale susmentionnée du crédit d'évaluation.
2. Les travaux déposés trois, quatre ou cinq ans après leur achèvement sont remboursés à 50 % de la valeur totale du crédit d'évaluation susmentionné. Voir les calculs ci-dessous.

Valeur totale du crédit d'évaluation	Évaluation totale demandée
	× 0,50 =

Certification Verifying Statement of Costs

I hereby certify:
that the amounts shown are as accurate as possible and these costs were incurred while conducting assessment work on the lands shown on the accompanying Report of Work form.

that as Resident I am authorized
(Recorded Holder, Agent, Position in Company)

to make this certification

Attestation de l'état des coûts

J'atteste par la présente :
que les montants indiqués sont le plus exact possible et que ces dépenses ont été engagées pour effectuer les travaux d'évaluation sur les terrains indiqués dans la formule de rapport de travail ci-joint.

Et qu'à titre de _____ je suis autorisé
(titulaire enregistré, représentant, poste occupé dans la compagnie)

à faire cette attestation.

Signature 	Date Dec. 4/92
---------------	-------------------