

COMPANY China Clay Syndicate

DIAMOND DRILL RECORD

HOLE NO. _____

PROPERTY _____

SHEET NO. 3

DATE _____

DIP ANGLES		BEARING	LATITUDE	STARTED				
		LENGTH	DEPARTURE	STOPPED				
		LOCATION	ELEVATION	LOGGED BY G.R.C-Dunlop				
ROCK			CORE SAMPLES					
FOOTAGE	NAME OF ROCK	DESCRIPTION	SAMPLE NO.	WIDTH	FOOTAGE	ASSAY	ASSAY	ASSAY
99.0 - 100.5		No sample - probably same as above.						
100.5 - 100.8	China Clay	Cream-white kaolin in fine micaceous silica sand, with some silica and dark pebbles to $\frac{1}{2}$ " diameter.						
100.8 - 103.6	Fire Clay	Cream-buff colour, no grit, very fine and plastic.						
103.6 - 106		No core.						
106 - 110	China Clay	Silica sand with kaolin, buff coloured, average grain size 2 mm. Quartz and dark pebbles up to $\frac{1}{4}$ " diam. Narrow sections of plastic clay at 108'.						
110 - 117.6	China Clay	Silica sand banded with clay. Fine grained white silica sand and muscovite, very few pebbles, fairly cohesive with apparently good kaolin content. No dark or rusty bands.						
117.6 - 118.6		Darker grey than above, higher clay content.						
118.6 - 121.5		White silica sand with kaolin and numerous quartz pebbles up to $\frac{1}{2}$ ".						
121.5 - 124.5		Grey mixture of silica sand and clay, with high kaolin content, dark grey bands at 121.5 and 124'.						

KIPLING TWP.

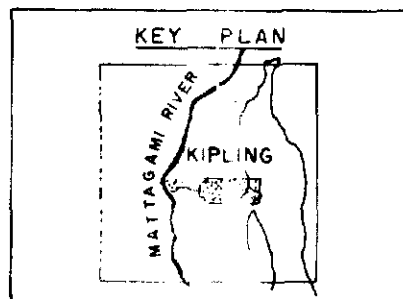
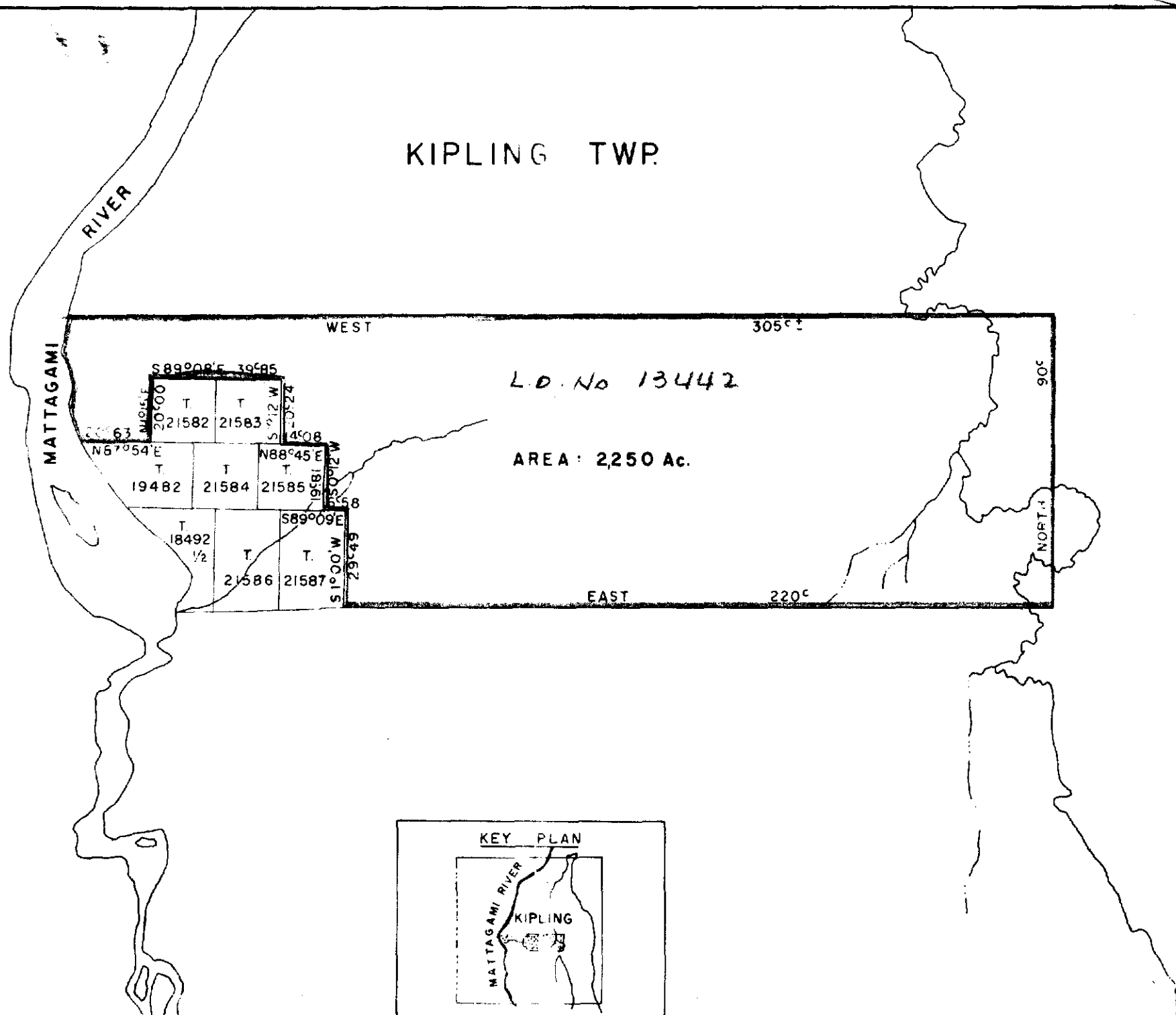

PLAN SHOWING
 EXPLORATORY LICENCE
 IN THE TWP OF KIPLING
 DISTRICT OF COCHRANE



42J01NE8100 83.1-37 KIPLING

200

SCALE 1 Inch : 40 Ch.

PREPARED BY THE ONTARIO DEPARTMENT OF MINES
 1962

5

LEGEND

- 1 ■ 30% - 40% CLAY
- 2 □ 20% - 30% CLAY
- 3 ■ 10% - 20% CLAY
- 4 □ 5% - 10% CLAY
- 5 □ 0% - 5% CLAY

SURFACE

O
Y
E
R
E
B
E
R
E
D
D
E
N
L
I
G
H
T
B
R
O
W
N
F
I
N
E
S
A
N
D
Y
S
I
L
T
;
L
I
G
H
T
B
R
O
W
N
-
G
E
Y
S
I
L
T
.
N
U
M
E
R
O
U
S
P
E
B
B
L
E
S
A
N
D
B
O
U
L
D
E
R
S
U
P
T
O
9"
D
I
A
M
E
T
E
R.

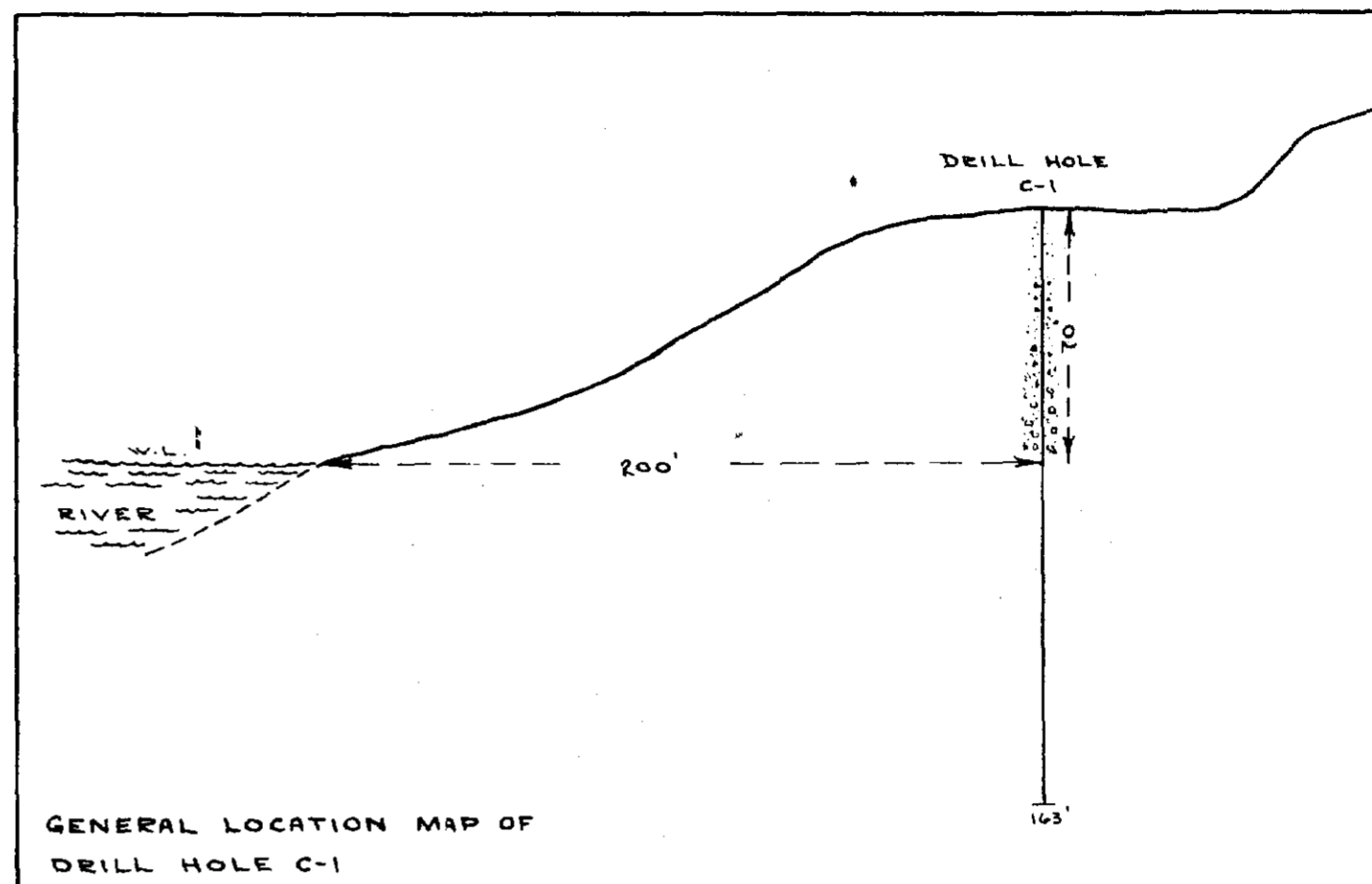

DESCRIPTIONS & ASSAYS OF SAMPLES BY -
ENGLISH CLAYS LOVERING POCHIN & CO. LTD.
ST. RUSTELL, CORNWALL
ENGLAND.

69.0	VERY SANDY GREY CLAY RECOVERY OF CLAY 22% COLOUR LIGHT BROWN-GREY RESIDUE WHITE SAND & SMALL STONES	5	VERY FINE PURE SILICA SAND WITH ABUNDANT WHITE KAOLIN RATIO PROBABLY 50-50. OCCASIONAL NARROW GREY LAYERS. SAMPLE NO. 3-875. 62.5% SAND; 37.5% CLAY.
77.0			
80.0	PALE BROWN SAND	4	SILICA SAND WITH MINOR KAOLIN, DEIVE SAMPLES, KAOLIN MOSTLY WASHED OUT. SOME CONTAMINATION FROM DRILLING MUD. SAMPLE NO. 3-876. 93.9% SAND; 4.1% CLAY.
84.0			
88.0	PALE BROWN SAND	5	COARSE BROWN MOTTLED SILICA SAND AND SOME KAOLIN PARTIALLY CONTAMINATED BY RUST AND DRILLING MUD. MOST OF KAOLIN WASHED OUT IN DRILLING. NO SAMPLE 90-94. SAMPLE NO. 3-877. 98.3% SAND; 1.7% CLAY.
96.0			
97.0	BROWN SAND	5	SLUDGE SAMPLE, FINE SILICA SAND WITH SOME BLACK MINERAL IMPURITIES. PRACTICALLY ALL KAOLIN WASHED OUT. SAMPLE NO. 3-878. 99.5% SAND; 0.5% CLAY.
101.0			
103.0	1/4" WHITE ROUNDED SILICA SAND DOWN, MOSTLY LESS THAN 1/20"	5	SLUDGE SAMPLE, FINE SILICA SAND WITH SOME BLACK MINERAL IMPURITIES. PRACTICALLY ALL KAOLIN WASHED OUT. SAMPLE 3-879. 99.5% SAND; 0.5% CLAY.
105.0	BROWNISH CLAY & SAND RECOVERY OF CLAY 8% COLOUR BROWN	5	DEIVE SAMPLE, DRILLING MUD IN HOLE. MATERIAL IS FINE TO COARSE SILICA -MUSCOVITE SAND, CONTAINING ABUNDANT WHITE KAOLIN BUT SAMPLE IS BADLY CONTAMINATED WITH MUD. SAMPLE 3-880. 88.4% SAND; 11.6% CLAY.
110.0			
114.0	FINE GREY SAND RECOVERY OF CLAY 6% COLOUR DARK GREY-BROWN	4	SLUDGE SAMPLE, FINE TO COARSE SILICA SAND WITH MUSCOVITE AND BLACK MINERAL IMPURITIES. ALL KAOLIN WASHED OUT. ORIGINALLY CONTAINED ABUNDANT WHITE KAOLIN. SAMPLE NO. 3-881. 99.9% SAND; 0.1% CLAY.
118.0			
118.0	PALE BUFF SAND AND GREY CLAY	2	UNCONTAMINATED CORE SILICA SAND, MUSCOVITE & VARYING AMOUNTS OF WHITE TO PALE BROWN CLAY MINERALS. SAMPLE NO. 3-882. 92.8% SAND; 7.2% CLAY.
124.0	PALE BROWN SAND RECOVERY OF CLAY 5% COLOUR VERY DARK BROWN	5	FINE TO COARSE SILICA SAND WITH MUSCOVITE & WHITE TO GREY & BROWN KAOLIN. CONTAINS 3 2" LAYERS OF MEDIUM GREY FINE CLAY UNCONTAMINATED EXCEPT FOR MINOR DRILL ROD RUST. SAMPLE NO. 3-883. 75.9% SAND; 24.1% CLAY.
130.0	LIGHT BROWN SAND WITH LITTLE CLAY, SOME BLUE CLAY	4	FINE TO MEDIUM SILICA SAND & MUSCOVITE WITH VARYING AMOUNT OF WHITE TO PALE BROWN KAOLIN. MOST OF CLAY MINERALS REMOVED BY WATER IN DRILL HOLE. SAMPLE NO. 3-884. 97.1% SAND; 2.9% CLAY.
136.0	COARSE WHITE SAND		FINE TO COARSE SILICA SAND & MUSCOVITE WITH VARYING AMOUNT OF WHITE TO MEDIUM BROWN CLAY MINERALS PROBABLY CONTAINS SOME SAND FROM HIGHER IN HOLE. SAMPLE NO. 3-885. 91.5% SAND; 8.5% CLAY.
143.0	DARK BROWN CLAY		NO CORE OBTAINED BUT KAOLINIZED SILICA SAND IN THE FORM OF SLUDGE. SAMPLE NO. 3-885A
145.0	BUFF CLAY		WELL CORED FIRE-CLAY-PLASTIC. SAMPLE NO. 3-885-B
146.0	GREY, VERY SANDY CLAY RECOVERY 25%, COLOUR LIGHT GREY- BROWN, RESIDUE GREY-MICA	2	FIRE CLAY, LIGHT BUFF, PLASTIC NO GRIT. SAMPLE NO. 3-886
149.0	VERY SANDY GREY CLAY RECOVERY 27%, COLOUR DARK GREY-BROWN	2	FIRE CLAY WITH FINE GRAINED SILICA SAND AND KAOLIN SAMPLE NO. 3-887.
152.0	VERY SANDY GREY CLAY RECOVERY 14%, COLOUR DARK GREY-BROWN	5	INTERBEDDED FIRE CLAY & SILICA SAND WITH KAOLIN SAMPLE NO. 3-888.
154.5	VERY SANDY WITH LITTLE CLAY		SILICA SAND WITH KAOLIN & MINOR BANDS OF FIRE CLAY. SAMPLE NO. 3-889.
161.5			CREAM TO WHITE SILICA SAND & KAOLIN WITH 5" FIRE CLAY AT 159.0'. SAMPLE NO. 3-890.
163.0			

DESCRIPTION OF SAMPLES BY -
NEW CALUMET MINES LIMITED

ASSAYS OF SAMPLES BY
LAKEFIELD RESEARCH
OF CANADA LTD.

83.1-37

CHESTERFIELD MINING & EXPLORATION
COMPANY LIMITED

KIPLING TOWNSHIP - ONTARIO

VERTICAL SECTION - DRILL HOLE C-1

SCALE: 1 INCH = 10 FEET

MAR. 1, 1963.



42J01NE8100 83.1-37 KIPLING

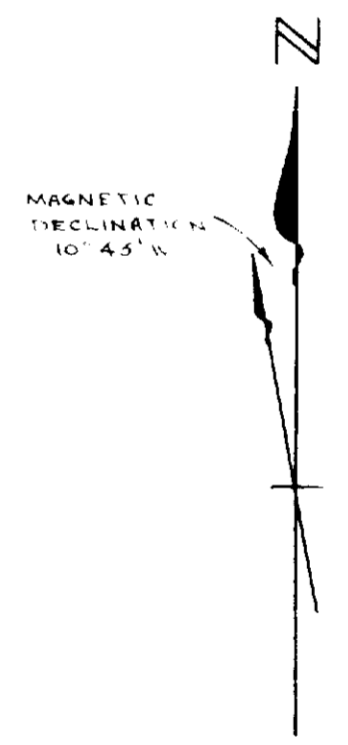
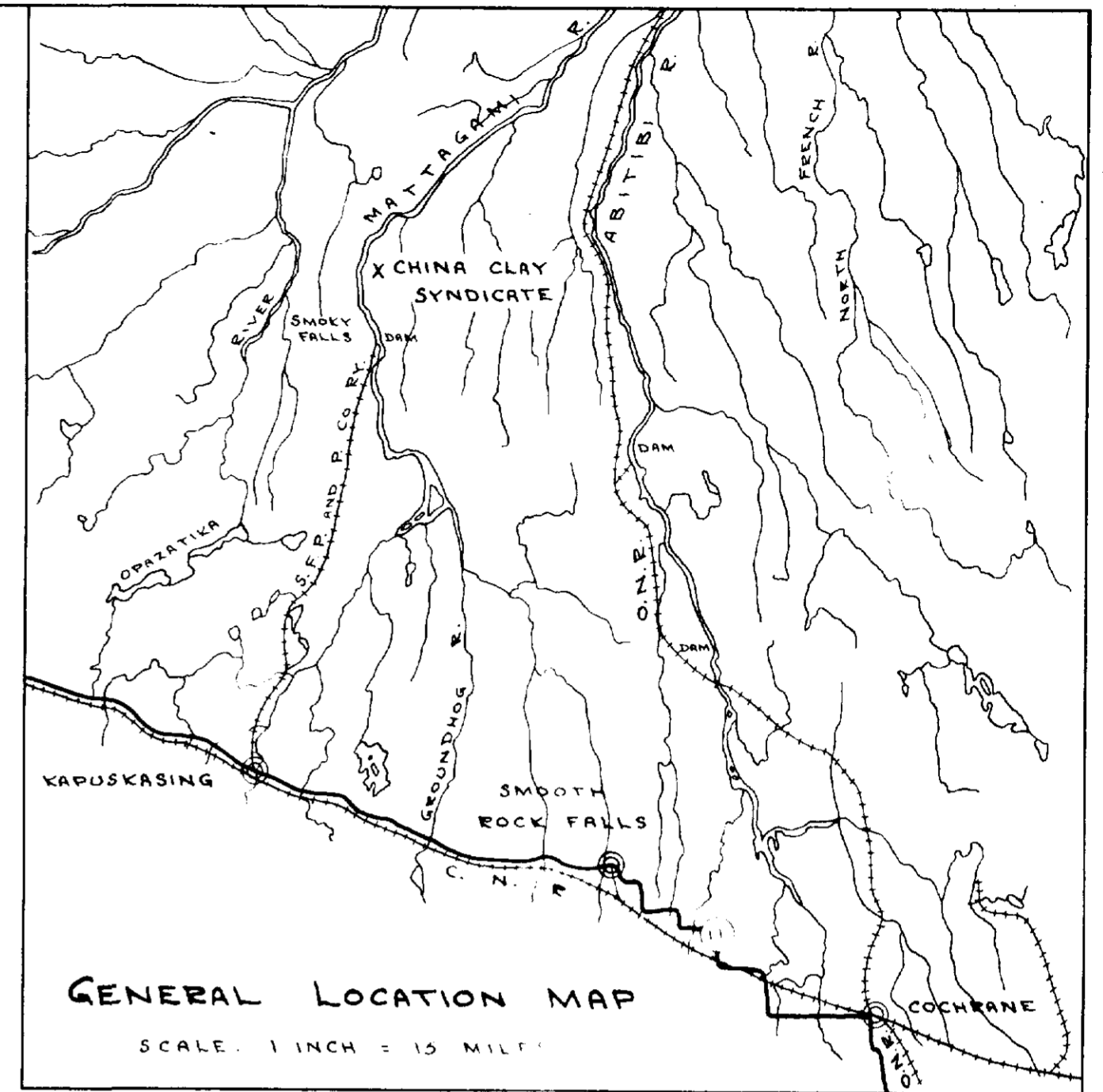
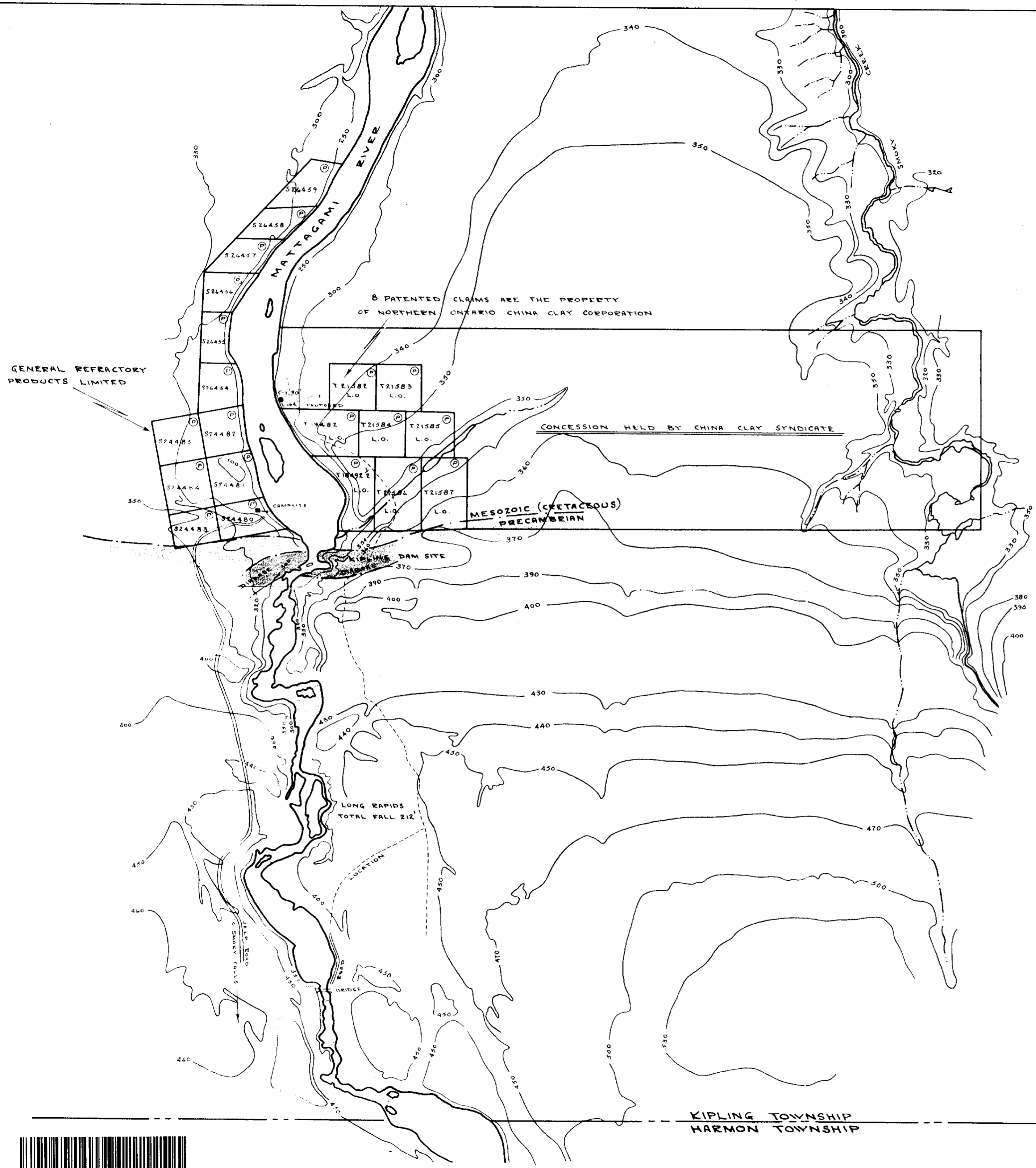

CHINA CLAY SYNDICATE
 KIPLING TWP., ONTARIO
MATTAGAMI RIVER CONCESSION
 SHOWING
GEOLOGY AND DIAMOND DRILLING
 SCALE: 1 INCH = 2000 FEET FEBRUARY 18, 1963.



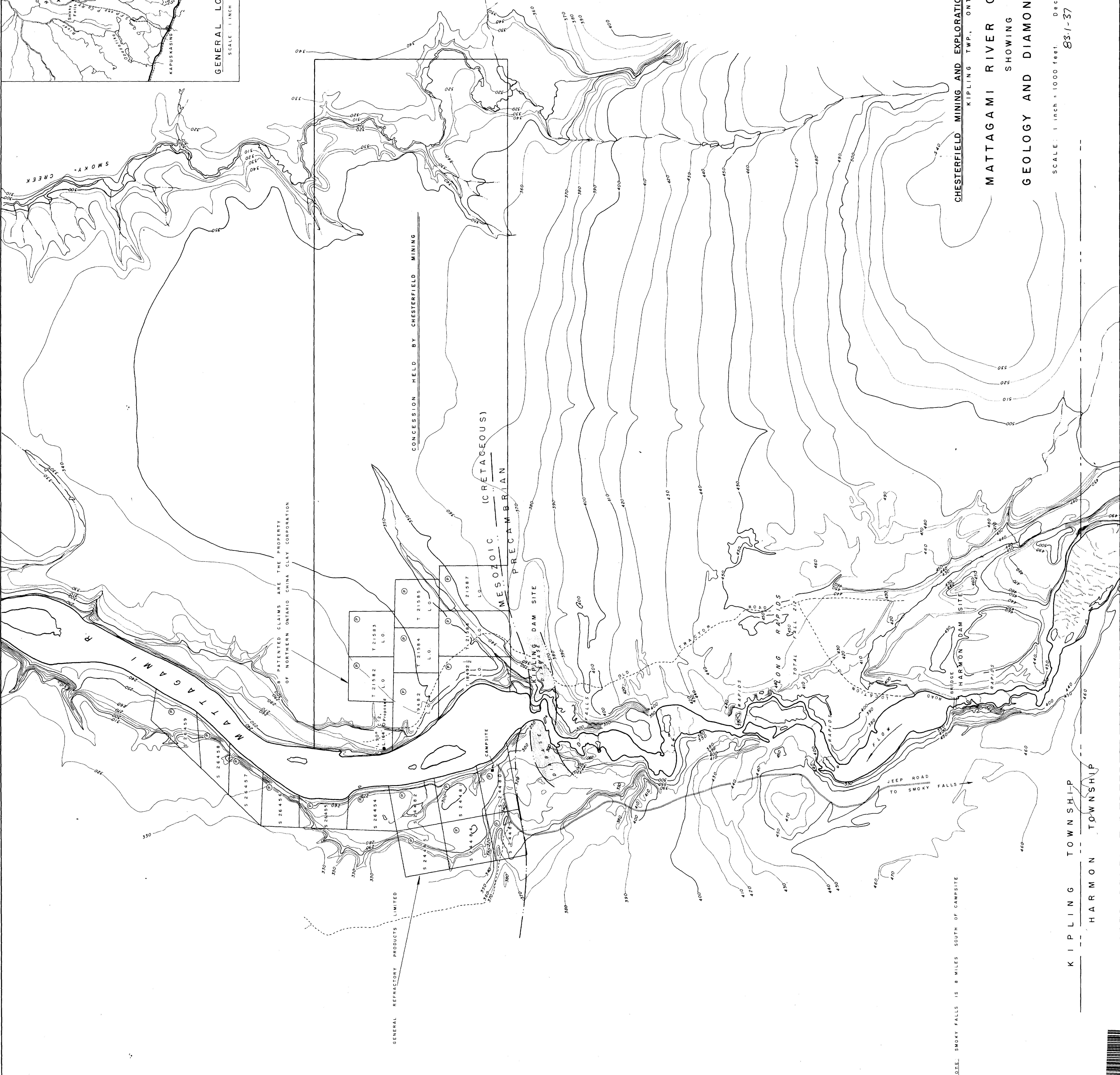
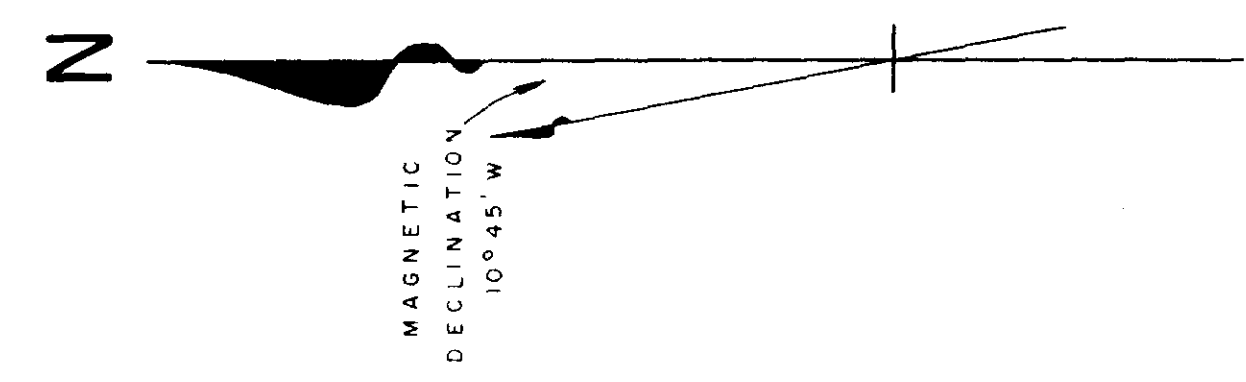
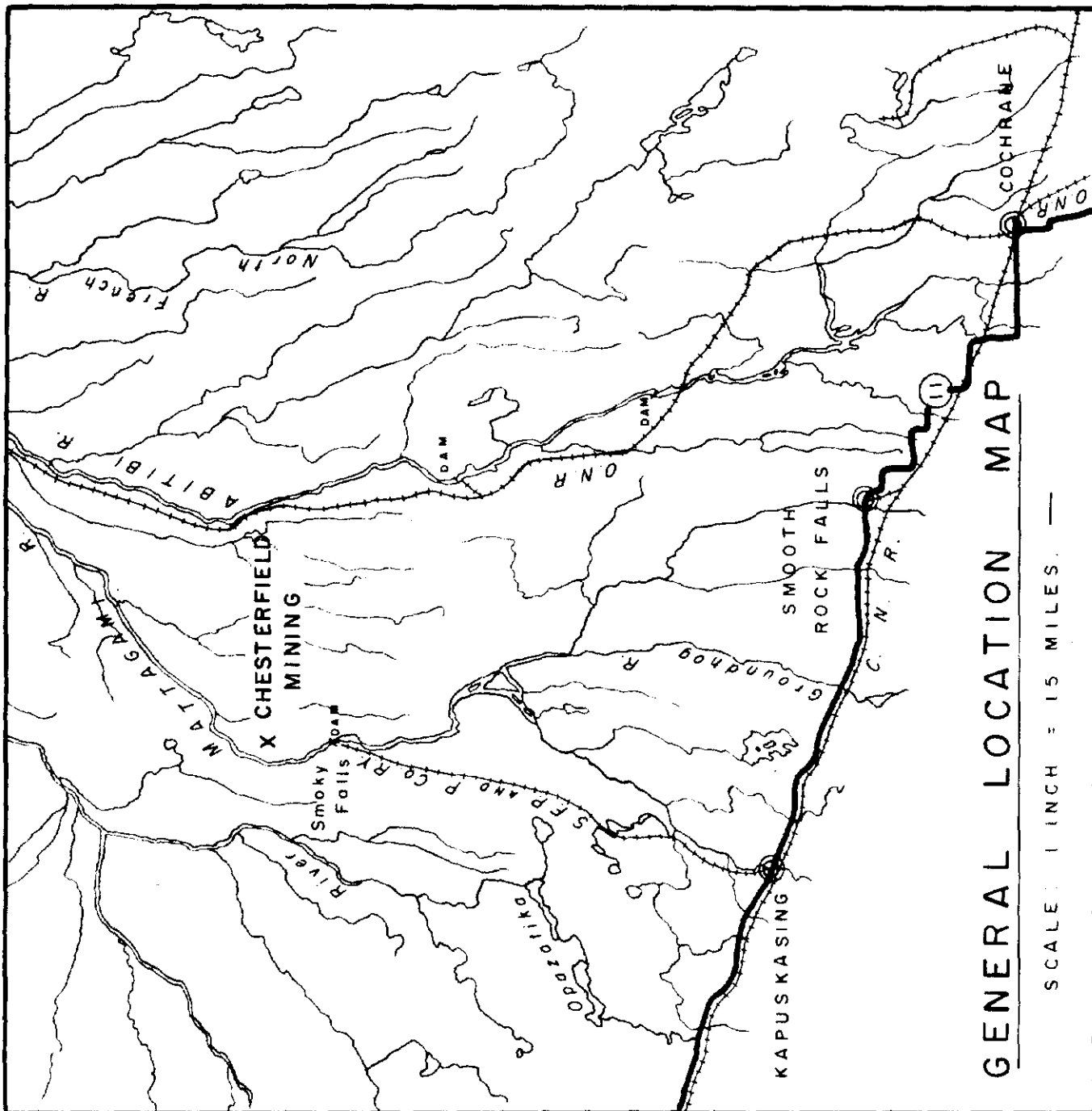

CHESTERFIELD MINING AND EXPLORATION COMPANY LIMITED
KIPLING TWP., ONTARIO.

MATTAGAMI RIVER CONCESSION
SHOWING
GEOLOGY AND DIAMOND DRILLING

SCALE: 1 inch = 1000 feet. December 10, 1962.
831-37

KIPLING TOWNSHIP
HARMON TOWNSHIP

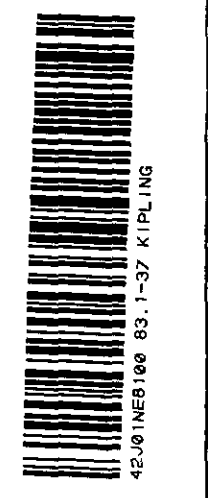

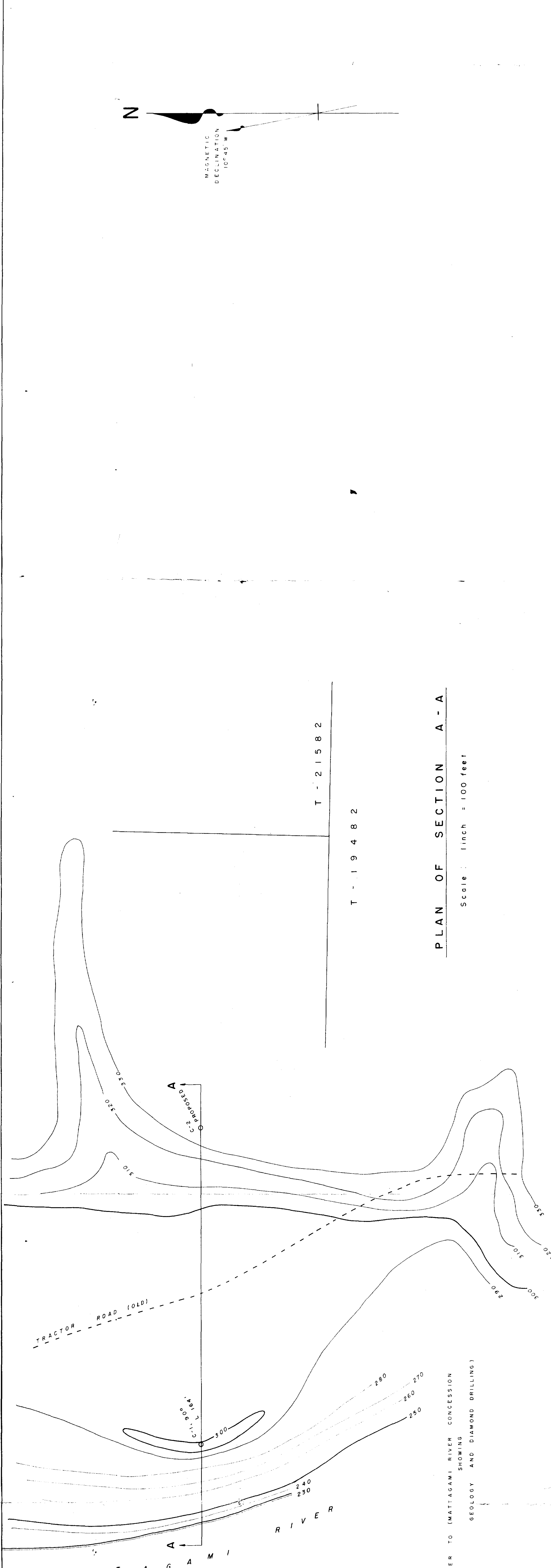
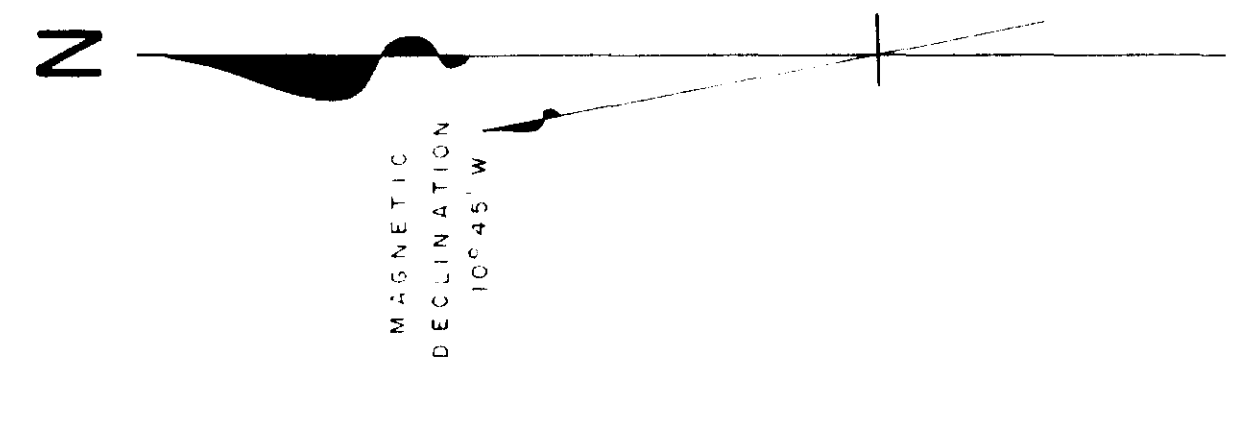

PLAN OF SECTION A-A
Scale: 1 inch = 100 feet

NOTE: REFER TO MATTAGAMI RIVER CONCESSION SHOWING GEOLOGY AND DIAMOND DRILLING

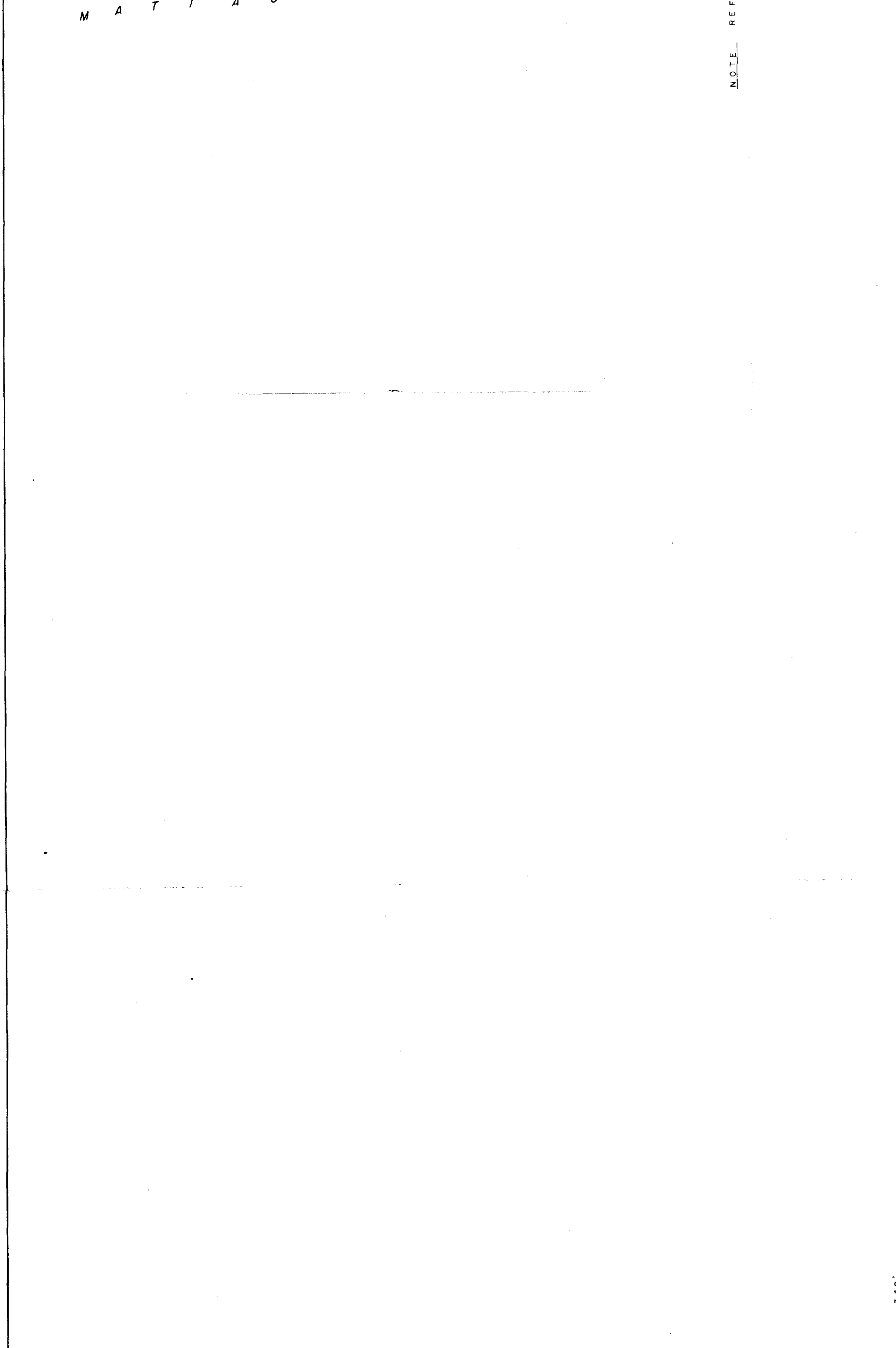

C-1, VERTICAL LENGTH 164'
 1 100' 250'
 2 100' 250'
 3 100' 250'
 4 100' 250'
 5 100' 250'
 6 100' 250'
 7 100' 250'
 8 100' 250'
 9 100' 250'
 10 100' 250'
 11 100' 250'
 12 100' 250'
 13 100' 250'
 14 100' 250'
 15 100' 250'
 16 100' 250'
 17 100' 250'
 18 100' 250'
 19 100' 250'
 20 100' 250'
 21 100' 250'
 22 100' 250'
 23 100' 250'
 24 100' 250'
 25 100' 250'
 26 100' 250'
 27 100' 250'
 28 100' 250'
 29 100' 250'
 30 100' 250'
 31 100' 250'
 32 100' 250'
 33 100' 250'
 34 100' 250'
 35 100' 250'
 36 100' 250'
 37 100' 250'
 38 100' 250'
 39 100' 250'
 40 100' 250'
 41 100' 250'
 42 100' 250'
 43 100' 250'
 44 100' 250'
 45 100' 250'
 46 100' 250'
 47 100' 250'
 48 100' 250'
 49 100' 250'
 50 100' 250'

LEGEND
 1 OVERBURDEN (SANDY SILT WITH BOULDERS)
 2 CHINA CLAY (SILICA SAND AND KAOLIN)
 FINE CLAY

83-1-37
 CHESTERFIELD MINING AND EXPLORATION COMPANY LIMITED
 KIPLING TWP., ONTARIO

VERTICAL SECTION THROUGH C-1 AND C-2 (PROPOSED)

SCALE 1 INCH = 20 FEET

