



CREEK DD Rpt II

This file contains work performed by Algoma Ore Property on Claims:

P.49292 Hole # 1 July, 1961
 Hole # 2 July, 1961
 Hole # A-2-62 March, 1962
 Hole # A-3-62 March, 1962
 Hole # A-4-62 March, 1962
 Hole # A-5-62 March, 1962
 Hole # A-6-62 March, 1962

P.49291 Hole # 3 July, 1961
 Hole # 4 July, 1961
 Hole # A-7-62 March, 1962
 Hole # A-8-62 April, 1962
 Hole # A-9-62 April, 1962
 Hole # A-9-62 April, 1962
 Hole # A-10-62 April, 1962

P.49298 Hole # 5 July, 1961

P.49293 Hole # A-1-62 March, 1962

P.51561 Hole # D-1-62 June, 1962
 Hole # D-2-62 June, 1962
 Hole # D-3-62 June, 1962
 Hole # D-4-62 July, 1962

P.51568 Hole # Del-1-62 June, 1962

P.62428 Hole # Del-2-62 June, 1962

Penesig Creek Area

DIP TESTS: 30' - 42%
230' - 42%

ALGOMA ORE PROPERTIES

DIVISION OF

THE ALGOMA STEEL CORPORATION, LIMITED

EXPLORATION DEPARTMENT

DIAMOND DRILL HOLE NO. A-1-62 PROPERTY PIVABISKA MAGNETITE
LOCATION OF COLLAR 0+00; 1+23 S. ELEV
AZIMUTH AT COLLAR South
DIP AT COLLAR 45°
VERTICAL SECTION NO LENGTH 237' CORE SIZE Ax
REC. IN MIN ZONE LOGGED BY V.R.V. STARTED March 26/62 FINISHED.

FOOTAGE	DESCRIPTION	SAMPLING			ANALYSES	
		FROM	TO	REC		
0 - 30'	Casing					
30.0- 31.0	Banded I.F. 30% mag.					
31.5 - 38.0	Qtz., biot, schist, 15% mag.					
38.0- 48.8	Banded I.F., 30% mag.					
48.8- 54.5	do. 25% mag.					
54.5- 58.6	Qtz., biot, schist, minor banding 20% mag.					
58.6- 68.0	Qtz., muskovite schist, 0% mag. (see A-2 351.5-355)					
68.0- 88.0	Qtz., biot, schist, 25% mag. (85'-98') silicious particles causing mottled appearance					
88.0-107.0	Garnetiferrous qtz., biot, schist, 15% mag.					
107.0-122.0	Qtz., biot schist, 15% mag.					
122.0-125.0	Qtz., biot, schist 5% mag.					
125.0-126.0	Qtz., biot, schist 25% mag.					
126.0-130.0	Pale grey qtz., schist 0% mag.					
130.0-131.0	Qtz., biot, schist, 20% mag.					
131.0-134.5	Qtz., biot, schist 0% mag.					
134.5-145.0	Qtz., biot, schist 25% mag.					
145.0-174.2	" " " with minor magnetite banding, 15% mag.					
174.2-183.7	Qtz., biot, schist, 25% mag.					

ALGOMA ORE PROPERTIES

DIVISION OF

THE ALGOMA STEEL CORPORATION, LIMITED
EXPLORATION DEPARTMENT

DIAMOND DRILL HOLE NO. A-1-62

PROPERTY PIVABISKA MAGNETITE

CONTINUED - Page 2

FOOTAGE	DESCRIPTION	SAMPLING			ANALYSES				
		FROM	TO	REC.					
187.3-219.6	Garnetiferrous, qtz., biot, schist 15% mag. 200-201 grey green iron silicates								
219.6-223.9	Garnetiferrous, qtz., biot, schist 0% mag. (minor green amphibole bands)								
223.9-225.0	Lost core								
225.0-235.0	Garnetiferrous, qtz., biot, schist with minor green bands of amphibole 0% mag.								
235.0-237.0	Lost core								
	<u>Core Angles</u> 41 - 45° 117 - 52° 201 - 52° 220 - 46° 235 - 47°								

[Handwritten signature]

DIP TESTS: 100' - 38°
 200' - 35.5°
 400' - no mark

ALGOMA ORE PROPERTIES

DIVISION OF

THE ALGOMA STEEL CORPORATION, LIMITED

EXPLORATION DEPARTMENT

DIAMOND DRILL HOLE NO. A-2-62

PROPERTY PIVABISKA MAGNETITE

LOCATION OF COLLAR 2+00; 4+51' S.

ELEV.

AZIMUTH AT COLLAR North

DIP AT COLLAR 45°

VERTICAL SECTION NO

LENGTH 402'

CORE SIZE Ax.

REC. IN MIN. ZONE

LOGGED BY V.R.V. STARTED March 22 FINISHED March 25/6

FOOTAGE	DESCRIPTION	SAMPLING			ANALYSES			
		FROM	TO	REC.				
0 - 38.0	Casing							
38.0- 48.0	Garnetiferrous, qtz., biot, schist 0% mag.							
48.0- 51.0	Qtz., biot, schist, 15% mag.							
51.0- 54.5	do. 20% mag.							
54.5 - 56.0	Lost core							
56.0- 77.5	Qtz., biot, schist, 25% mag.							
77.5-102.2	Garnetiferrous, qtz., biot, schist 5% mag. @ 78.0 - minor seams of ankerite							
102.2-183.5	Qtz., biot, schist 25% mag.							
183.5-194.2	do. 15% mag.							
194.2-209.0	do. 20% mag.							
209.0-224.5	do. 10% mag.							
224.5-225.0	Bull qtz. 0% mag.							
225.0-226.0	Lost core							
226.0-239.2	Qtz., biot, schist 20% mag.							
239.2-240.0	Lost core							
240.0-283.0	Qtz., biot, schist 20% mag. 250 - 265 - garnetiferrous 273 - 283 - do. 274 - 275 - silicious mottling							
283.0-292	Qtz., biot, schist, 30% mag.							
292.0-303.0	Qtz., biot, schist, 20% mag. 300-303 - garnetiferrous							
303-308.5	Garnetiferrous, qtz., biot, schist 30% mag.							

ALGOMA ORE PROPERTIES

DIVISION OF

THE ALGOMA STEEL CORPORATION, LIMITED
EXPLORATION DEPARTMENT

DIAMOND DRILL HOLE NO. A-2-62

PROPERTY PIVABISKA PROPERTY

CONTINUED - Page 2

FOOTAGE	DESCRIPTION	SAMPLING			ANALYSES				
		FROM	TO	REC.					
308.5-323.0	Garnetiferrous, qtz., biot, schist 15% mag.								
323.0-326.0	Garnetiferrous, qtz., biot, schist 20% mag.								
	313-321 - silicious mottling								
326.0-335.0	Qtz., biot, schist, 30% mag.								
335.0-346.5	Qtz., biot, schist, 15% mag.								
346.5-354.2	Qtz., biot, schist, 5% mag.								
354.2-383.0	do. 25% mag.								
383.0-393.0	Garnetiferrous, qtz., biot, schist, plus minor green iron silicates 15% mag.								
393.0-402.0	Qtz., biot, schist 0% mag.								
	<u>Core Angles</u>								
	52' - 40°								
	103' - 44°								
	167' - 49°								
	203' - 45°								
	308' - 48°								
	400' - 57°								

Handwritten signature

DIP TESTS: 34' - 43°
 200' - 41½°
 259' - 46°

ALGOMA ORE PROPERTIES

DIVISION OF

THE ALGOMA STEEL CORPORATION, LIMITED

EXPLORATION DEPARTMENT

DIAMOND DRILL HOLE NO. A-3-62 PROPERTY PIVABISKA MAGNETITE
 LOCATION OF COLLAR 6+00E; 2+65 S ELEV.
 AZIMUTH AT COLLAR. South
 DIP AT COLLAR 45°
 VERTICAL SECTION NO. LENGTH 259' CORE SIZE Ax
 REC. IN MIN. ZONE LOGGED BY V.R.V. STARTED March 20 FINISHED March 21/1

FOOTAGE	DESCRIPTION	SAMPLING			ANALYSES			
		FROM	TO	REC.				
0 - 34'	Casing							
34.0- 38.0	Finely banded qtz., biot, schist, 25% mag.							
38.0- 65.5	Qtz., biot, schist with some magnetite bands 2"-3" long 15% mag.							
65.5-171.0	Qtz., biot, schist becoming banded in places, 20% mag.							
171.0-182.6	Garnetiferous qtz., biot, schist with siliceous mottling, 15% mag.							
182.6-201.6	Qtz., biot, schist, 20% mag.							
201.6-210.8	Qtz., biot, schist with I.F. banding 30% mag.							
210.8-225.0	Qtz., biot, schist, 25% mag.							
225.0-243.5	Finely banded qtz., biot, schist and magnetite, 25%							
243.5-259.0	Garnetiferous qtz., biot, schist with minor amphibole							
	<u>Core Angles</u>							
	125' - 52°							
	217' - 54°							
	243' - 42°							

DIP TESTS: 100' - 37^o₀₀
 200' - 37^o₀₀
 280' - 38^o₀₀

ALGOMA ORE PROPERTIES

DIVISION OF
 THE ALGOMA STEEL CORPORATION, LIMITED
 EXPLORATION DEPARTMENT

DIAMOND DRILL HOLE NO. A-4-62 PROPERTY PIVABISKA MAGNETITE
 LOCATION OF COLLAR 8+00E; 2+59 S. ELEV.
 AZIMUTH AT COLLAR South
 DIP AT COLLAR 45^o
 VERTICAL SECTION NO. LENGTH 280' CORE SIZE Ax
 REC. IN MIN. ZONE LOGGED BY V.R.V. STARTED March 18 FINISHED March 20/62

FOOTAGE	DESCRIPTION	SAMPLING			ANALYSES			
		FROM	TO	REC.				
0 - 36'	Casing							
35.0- 46.0	Qtz., biot, schist							
46.0- 47.0	do. silicious particles causing a mottled effect							
47.0- 56.0	Qtz., biot, schist							
	54.0-55.0 - garnetiferrous							
56.0- 65.0	Qtz., biot, schist, 10% mag.							
65.0- 70.6	do. 15% mag.							
70.6- 77.0	do. 25% mag.							
77.0- 78.0	do. 15% mag.							
78.0- 80.0	Lost core							
80.0-105.0	Qtz., biot, schist 15% mag.							
105.0-107.5	do. 25% mag.							
107.5-112.0	do. 10% mag.							
112.0-117.0	do. 30% mag.							
117.0-124.8	do. 15% mag.							
124.8-137.0	do. 20% mag.							
137.0-138.0	Lost core							
138.0-174.5	Qtz., biot, schist 20% mag.							
174.5-178.0	do. 15% mag.							
178.0-194.0	Qtz., biot, schist, 20% mag.							
194.0-212.0	do. 20% mag.							
212.0-230.0	do. 15% mag.							
230.0-253.5	do. 25% mag.							
253.5-258.0	do. 10% mag.							

ALGOMA ORE PROPERTIES

DIVISION OF

THE ALGOMA STEEL CORPORATION, LIMITED

EXPLORATION DEPARTMENT

DIAMOND DRILL HOLE NO. A-4-62

PROPERTY PIVABISKA MAGNETITE

CONTINUED - Page 2.

FOOTAGE	DESCRIPTION	SAMPLING			ANALYSES			
		FROM	TO	REC.				
258.0-264.0	Garnetiferrous qtz., biot, schist with minor iron silicates (amphibole) 10% mag.							
264.0-274.5	Garnetiferrous qtz., biot, schist and iron silicates 0% mag.							
274.5-280.0	Qtz., biot, schist with silicious particles							

H. Lem

DIP TESTS: 100' - 30°
 200' - 41.5°
 245' - 43°

ALGOMA ORE PROPERTIES

DIVISION OF
 THE ALGOMA STEEL CORPORATION, LIMITED
 EXPLORATION DEPARTMENT

DIAMOND DRILL HOLE NO. A-5-62 PROPERTY PIVABISKA MAGNETITE
 LOCATION OF COLLAR 10+00E ELEV.
 AZIMUTH AT COLLAR South
 DIP AT COLLAR 45°

VERTICAL SECTION NO LENGTH 245' CORE SIZE Ax
 REC. IN MIN. ZONE LOGGED BY V.R.V. STARTED March 16 FINISHED. March 18/6.

FOOTAGE	DESCRIPTION	SAMPLING			ANALYSES			
		FROM	TO	REC.				
0 - 32'	Casing							
32.0 - 34.0	Qtz., biot, schist							
34.5- 36.0	Garnetiferrous Qtz., biot, schist, 10% mag.							
36.0- 45.0	Qtz., biot, schist, 10% mag.							
45.0- 51.0	Qtz., biot, schist, 30% mag.							
51.0- 62.0	do. 15% mag.							
62.0- 65.0	Lost core							
65.0- 80.5	Qtz., biot, schist, 15% mag.							
68.0-75.0	- garnets and mottling (sil. particles)							
80.5-101.0	Qtz., biot, schist, 30% mag.							
101.0-118.0	do. 20% mag.							
118.0-147.0	do. 25% mag.							
147.0-152.0	do. 20% mag.							
152.0-166.0	Garnetiferrous Qtz., biot, schist (sil. particles, mottling) 20% mag.							
116.0-176.5	do. 10% mag.							
176.5-179.0	Lost core							
179.0-211.0	Qtz., biot, schist, 15% mag.							
211.0-232.0	do. 25% mag.							
232.0-233.0	Garnetiferrous Qtz., amphibole schist 0% mag.							
233.0-245.0	Intensity garnetiferrous, chloritized in places							
	<u>Hematite Zone</u>							
	125' - 150' (not strong)							

OK Cum

ALGOMA ORE PROPERTIES

DIVISION OF

THE ALGOMA STEEL CORPORATION, LIMITED
EXPLORATION DEPARTMENT

DIAMOND DRILL HOLE NO. A-5-62

PROPERTY PIVABISKA MAGNETITE

CONTINUED - Page 2

FOOTAGE	DESCRIPTION	SAMPLING			ANALYSES			
		FROM	TO	REC.				
	<u>Core Angles</u> 41' - 41° 105' - 44° 200' - 50° 232' - 48°							

DIP TESTS: 100' - 45°
200' - 42.5°

ALGOMA ORE PROPERTIES

DIVISION OF

THE ALGOMA STEEL CORPORATION, LIMITED

EXPLORATION DEPARTMENT

DIAMOND DRILL HOLE NO A-6-62 PROPERTY PIVABISKA MAGNETITE
 LOCATION OF COLLAR 12+00E; 3+50 S. ELEV.
 AZIMUTH AT COLLAR. South
 DIP AT COLLAR 45°
 VERTICAL SECTION NO LENGTH 259' CORE SIZE AX
 REC IN MIN. ZONE LOGGED BY V.R.V. STARTED March 13 FINISHED March 15/62

FOOTAGE	DESCRIPTION	SAMPLING			ANALYSES			
		FROM	TO	REC.				
0 - 27'	Casing							
27.0- 35.5	Qtz., biot, schist, 30% mag.							
35.5- 50.0	do. 10% mag.							
50.0- 51.0	Lost core							
51.0- 53.0	Qtz., biot, schist, 10% mag.							
53.0- 60.5	do. 20% mag.							
60.5- 68.0	do. 10% mag. (silicious particles)							
68.0- 76.5	Qtz., biot, schist, 15% mag.							
76.5 - 79.0	Lost core							
79.0- 93.0	Qtz., biot, schist, 15% mag.							
93.0-138.0	do. 25% mag.							
138.0-170.0	do. 15% mag.							
170.0-176.0	Qtz., biot, schist with silicious mottling - 5% mag.							
176.0-193.0	Qtz., biot, schist, 15% mag.							
193.0-195.0	Lost core							
195.0-196.0	Qtz., biot, schist, 15% mag.							
196.0-198.1	Lost core							
198.1-210.0	Qtz., biot, schist, 15% mag.							
210.0-212.8	do. 30% mag.							
212.8-215.0	Lost core							
215.0-231.0	Qtz., biot, schist, 30% mag.							
231.0-232.0	Lost core							
232.0-248.2	Qtz., biot, schist, 30% mag.							

ALGOMA ORE PROPERTIES

DIVISION OF

THE ALGOMA STEEL CORPORATION, LIMITED
EXPLORATION DEPARTMENT

DIAMOND DRILL HOLE NO. A-6-62

PROPERTY PIVABISKA MAGNETITE

CONTINUED - Page 2

FOOTAGE	DESCRIPTION	SAMPLING			ANALYSES					
		FROM	TO	REC.						
248.2-254.8	Garnetiferrous qtz., biot, schist, 10% mag.									
254.8-259.0	do. (garnets very intense) 0% mag.									

B.H. Cum

ALGOMA ORE PROPERTIES

DIVISION OF

THE ALGOMA STEEL CORPORATION, LIMITED

EXPLORATION DEPARTMENT

DIAMOND DRILL HOLE NO. A-7-62

PROPERTY Pivabiska Magnetite

LOCATION OF COLLAR 16+00E 4+13S.

ELEV.

AZIMUTH AT COLLAR. 180°

DIP AT COLLAR 45°

VERTICAL SECTION NO.

LENGTH 133'

CORE SIZE. A x T

REC. IN MIN. ZONE.

LOGGED BY V. Venn STARTED Mar. 28/62 FINISHED Mar. 30/62

FOOTAGE	DESCRIPTION	SAMPLING			ANALYSIS	
		FROM	TO	REC.	Estimated Fe (Mag.)	
0 - 24'	Overburden				0 - 24	Casing
24 -133.0	Iron formation - Quartz biot, schist carrying varying percentages of magnetite. At 92.5-117 the zone carries specular hematite. The zone is garnetiferous from 52.5-54 61 -74 66-71 white silicious particles $\frac{1}{4}$ "- $\frac{1}{2}$ " diameter 93-100 noticable green iron silicates 26-29 pale grey quartz muscovite schist	Hematite	92'	-117'	24 - 26	10%
					26 - 29.2	Waste
					29.2 - 33.3	20%
					33.3 - 36.3	L.C.
					36.3 - 45	15%
					45 - 49.6	30%
					49.6 - 57.9	15%
					57.9 - 60	L.C.
					60 - 71.2	15%
					71.2 - 73	L.C.
					73 - 78	15%
					78 - 80	25%
					80 - 81.5	L.C.
					81.5 - 81.9	25%
					81.9 - 83	L.C.
83 - 83.6	Waste					
83.6 - 88	25%					
88 - 90	L.C.					
90 - 122	25%					
122 - 126.5	20%					
126.5 - 130	20%					
130 - 133	15%					

V. Venn

DIP TESTS: 28 - no good 300 - 35.5
 100 - 40.5 400 - 35.5
 200 - 37.5 455 - 34.5

ALGOMA ORE PROPERTIES

DIVISION OF

THE ALGOMA STEEL CORPORATION, LIMITED
 EXPLORATION DEPARTMENT

DIAMOND DRILL HOLE NO. A-8 PROPERTY PIVABISKA MAGNETITE
 LOCATION OF COLLAR 18+00E; 4+10 S. REEF.
 AZIMUTH AT COLLAR. South Test: 28 - no good 400 - 35.5
 DIP AT COLLAR 45° 100 - 40.5 455 - 34.5
 200 - 37.5
 300 - 35.5
 CORE SIZE. Ax
 VERTICAL SECTION NO. LENGTH 455'
 REC. IN MIN. ZONE. LOGGED BY N. Reid STARTED April 4 FINISHED April 7/62
 V.R.V.

FOOTAGE	DESCRIPTION	SAMPLING			ANALYSES			
		FROM	TO	REC.				
0 - 28'	Casing							
28.0- 56.5	Qtz., biot, schist, 0% mag.							
56.5- 57.0	Iron formation 25% mag.							
57.0- 60.0	Qtz., biot, schist 0% mag.							
60.0- 61.0	Iron formation 25% mag.							
61.0- 71.0	Qtz., biot, schist 0%							
71.0- 90.0	Iron formation 20% mag.							
90.0-92.5	" " 10% mag.							
92.5-101.0	" " 25% mag.							
101.0-108.0	Qtz., biot, schist 0% mag.							
108.0-140.0	Iron formation 20% mag.							
140.0-147.0	Qtz., biot, schist 0% mag.							
147.0-147.2	Iron formation 30% mag.							
147.2-147.8	Qtz., biot, schist 0% mag.							
147.8-175.0	Iron formation 25% mag.							
175.0-200.0	" " 20% mag.							
	(180.5-182.5 L.C.)							
	(192.0-193.0 L.C.)							
200.0-206.5	Qtz., biot, schist 0% mag.							
206.5-213.0	Iron formation 15% mag.							
	208-208.7 L.C.							
213.0-214.7	Qtz., biot, schist 0% mag.							
214.7-219.0	Iron formation 30% mag.							
219.0-223.0	Qtz., biot, schist 0% mag.							
223.0-224.0	Iron formation 20% mag.							

ALGOMA ORE PROPERTIES

DIVISION OF

THE ALGOMA STEEL CORPORATION, LIMITED
EXPLORATION DEPARTMENT

DIAMOND DRILL HOLE NO. A-8

PROPERTY PIVABISKA MAGNETITE

CONTINUED - Page 2

FOOTAGE	DESCRIPTION	SAMPLING			ANALYSES		
		FROM	TO	REC.			
224.0-225.0	Qtz., biot, schist, 0% mag.						
225.0-247.5	Iron formation 25% mag.						
247.5-252.0	Lost core						
252.0-254.0	Iron formation 25% mag.						
254.0-258.0	" " 10% mag.						
258.0-260.0	" " 30% mag.						
260.0-261.0	Qtz., biot, schist 0% mag.						
261.0-263.5	Iron formation 20% mag.						
263.5-267.0	Qtz., biot, schist 0% mag.						
267.0-275.0	Iron formation 15% mag.						
275.0-307.5	" " 20% mag.						
307.5-328.0	" " 15% mag.						
328.0-374.7	" " 20% mag.						
374.7-376.0	" " 15% mag.						
376.0-380.0	" " 10% mag.						
380.0-455.0	Qtz., biot, schist 0% mag.						

Ch. Lem

DIP TESTS: 25'-44.5 300'-38
 100'-43.5 400'-35.5
 200'-41.5

ALGOMA ORE PROPERTIES

DIVISION OF

THE ALGOMA STEEL CORPORATION, LIMITED

EXPLORATION DEPARTMENT

DIAMOND DRILL HOLE NO. A-9 PROPERTY PIVABISKA MAGNETITE

LOCATION OF COLLAR L-20+00E; 4+37 S. ELEV.

AZIMUTH AT COLLAR. South

DIP AT COLLAR 45°

VERTICAL SECTION NO. LENGTH 447' CORE SIZE. Ax

REC. IN MIN. ZONE. LOGGED BY N. Reid STARTED. April 8 FINISHED. April 11/6

FOOTAGE	DESCRIPTION	SAMPLING			ANALYSES			
		FROM	TO	REC.				
0 - 25'	Casing							
25.0- 74.0	Qtz., biot, schist 0% mag.							
74.0- 77.5	Iron formation, 15% mag.							
77.5-101.0	" " 25% mag.							
101.0-104.8	Qtz., biot, schist 0% mag.							
104.8-106.5	Iron formation 25% mag.							
106.5-108.0	Qtz., biot, schist 0% mag.							
108.0-115.0	Iron formation 30% mag.							
115.0-117.8	" " 15% mag.							
117.8-135.0	" " 20% mag.							
135.0-156.0	" " 15% mag.							
156.0-168.0	" " 25% mag.							
168.0-312.0	" " 20% mag.							
<u>NOTE:</u>	281-285 L.C.							
312.0-314.0	Qtz., biot, schist 0% mag.							
314.0-315.5	Iron formation 20% mag.							
315.5-317.5	Qtz., biot, schist 0% mag.							
317.5-340.3	Iron formation 20% mag.							
340.3-342.0	Qtz., biot, schist 0% mag.							
342.0-345.5	Iron formation 15% mag.							
345.5-347.0	Qtz., biot, schist 0% mag.							
347.0-348.0	Iron formation 30% mag.							
348.0-350.0	Iron formation 10% mag.							
350.0-353.0	" " 15% mag.							

ALGOMA ORE PROPERTIES

DIVISION OF

THE ALGOMA STEEL CORPORATION, LIMITED
EXPLORATION DEPARTMENT

DIAMOND DRILL HOLE NO. A-9

PROPERTY PIVABISKA MAGNETITE

CONTINUED - Page 2

FOOTAGE	DESCRIPTION	SAMPLING			ANALYSES			
		FROM	TO	REC.				
353.0-356.0	Iron formation 10% mag.							
356.0-359.0	" " 15% mag.							
359.0-364.0	" " 10% mag.							
364.0-365.0	" " 10% mag.							
365.0-365.6	Qtz., biot, schist 0% mag.							
365.6-366.0	Iron formation 25% mag.							
366.0-368.0	Qtz., biot, schist 0% mag.							
368.0-370.0	Iron formation 25% mag.							
370.0-372.0	Qtz., biot, schist 0% mag.							
372.0-373.0	Iron formation 20% mag.							
373.0-374.5	" " 25% mag.							
374.5-377.0	Qtz., biot, schist 0% mag.							
377.0-378.0	Iron formation 30% mag.							
378.0-380.0	Qtz., biot, schist 0% mag.							
380.0-384.0	Iron formation 20% mag.							
(381-383.6)	Lost core							
384.0-388.0	Iron formation 15% mag.							
388.0-389.5	Qtz., biot, schist 0% mag.							
389.5-394.5	Iron formation 10% mag.							
394.5-397.5	" " 15% mag.							
397.5-399.8	" " 20% mag.							
399.8-401.5	Qtz., biot, schist 0% mag.							
401.5-403.0	Iron formation 25% mag.							
403.0-405.0	" " 15% mag.							
405.0-416.0	" " 20% mag.							
416.0-419.0	Qtz., biot, schist 0% mag.							
419.0-420.0	Iron formation 15% mag.							
420.0-422.0	Qtz., biot, schist 0% mag.							

ALGOMA ORE PROPERTIES

DIVISION OF
THE ALGOMA STEEL CORPORATION, LIMITED
EXPLORATION DEPARTMENT

DIAMOND DRILL HOLE NO. A-9

PROPERTY PIVABISKA MAGNETITE

CONTINUED - Page 3

FOOTAGE	DESCRIPTION	SAMPLING			ANALYSES			
		FROM	TO	REC.				
422.0-423.5	Iron formation 25% mag.							
423.5-425.0	Qtz., biot, schist 0% mag.							
425.0-430.0	Iron formation 20% mag.							
430.0-437.0	Qtz., biot, schist, 0% mag.							
437.0-438.0	Iron formation 20% mag.							
438.0-447.0	Qtz., biot, schist 0% mag.							
	<u>Hematite Zone</u>							
	200' - 260'							

W. H. Clem

ALGOMA ORE PROPERTIES

DIVISION OF
THE ALGOMA STEEL CORPORATION, LIMITED
EXPLORATION DEPARTMENT

Dip Tests:
26' - 43
100' - 41
200' - 40
300' - 39
400' - 38.5
485' - 38.5

DIAMOND DRILL HOLE NO. **A-10-62** PROPERTY **PIVABISKA MAGNETITE**

LOCATION OF COLLAR **L - .22 + 00E; 8 + 72S** ELEV.

AZIMUTH AT COLLAR **North**

DIP AT COLLAR **45°**

VERTICAL SECTION NO. LENGTH **488'** CORE SIZE **Ax**

REC. IN MIN. ZONE. LOGGED BY **N. Ried** STARTED **Apr. 12/62** FINISHED **Apr. 17/62**
V.R.V.

FOOTAGE	DESCRIPTION	SAMPLING			ANALYSES			
		FROM	TO	REC.				
0-26	Casing							
26-49.8	Qtz., Biot., Schist, 0% Mag.							
49.8-65.5	Iron Formation 15% Mag.							
65.5-70.0	" " 25% Mag.							
70.0-74.0	" " 15% Mag.							
74.0-75.5	" " 10% Mag.							
75.5-81.5	" " 20% Mag.							
81.5-82.5	Lost core							
82.5-123.0	Iron Formation 20% Mag.							
123.0-127.0	Qtz., Biot., Schist 0% Mag.							
127.0-130.0	Iron Formation 10% Mag.							
130.0-150.3	" " 25% Mag.							
150.3-153.0	Qtz., Biot., Schist 0% Mag.							
153.0-162.0	Iron Formation 15% Mag.							
162.0-163.0	" " 20% Mag.							
163.0-163.5	Lost core							
163.5-175.0	Iron Formation 20% Mag. (1730 - 174.5 - lost core)							
175.0-176.0	Iron Formation 25% Mag.							
176.0-177.3	Lost core							
177.3-179.0	Iron Formation 25% Mag.							
179.0-181.0	Lost core							
181.0-192.0	Iron Formation 25% Mag.							
192.0-193.0	Lost core							
193.0-195.0	Iron Formation 25% Mag.							
195.0-195.7	Lost core							
195.7-219.0	Iron Formation 25% Mag.							

ALGOMA ORE PROPERTIES

DIVISION OF

THE ALGOMA STEEL CORPORATION, LIMITED
EXPLORATION DEPARTMENT

DIAMOND DRILL HOLE NO. A-10-62

PROPERTY PIVABISKA MAGNETITE

CONTINUED Page 2

FOOTAGE	DESCRIPTION	SAMPLING			ANALYSES			
		FROM	TO	REC.				
219.0-221.0	Iron Formation 10% Mag.							
221.0-224.0	" " 25% Mag.							
224.0-225.0	Lost core							
225.0-235.0	Iron Formation 25% Mag.							
235.0-242.0	" " 15% Mag. (240 - 240.8 - L.C.)							
242.0-257.0	Iron Formation 25% Mag.							
257.0-263.0	" " 15% Mag.							
263.0-264.2	Qtz., Biot., Schist 0% Mag.							
264.2-266.0	Iron Formation 15% Mag.							
266.0-267.0	Qtz., Biot., Schist 0% Mag.							
267.0-273.0	Iron Formation 15% Mag.							
273.0-282.0	" " 25% Mag.							
282.0-293.5	" " 15% Mag.							
293.5-319.0	" " 25% Mag.							
319.0-320.0	Lost core							
320.0-322.0	Iron Formation 25% Mag.							
322.0-324.5	Qtz., Biot., Schist, 0% Mag.							
324.5-325.3	Iron Formation 30% Mag.							
325.3-329.8	" " 10% Mag.							
329.8-335.0	" " 30% Mag.							
335.0-336.0	Qtz., Biot., Schist 0% Mag.							
336.0-345.0	Iron Formation 25% Mag.							
345.0-347.5	Qtz., Biot., Schist 0% Mag.							
347.5-350.0	Iron Formation 30% Mag.							
350.0-351.0	" " 10% Mag.							
351.0-366.2	" " 15% Mag.							
366.2-369.8	" " 25% Mag.							
369.2-371.0	Qtz., Biot., Schist 0% Mag.							
371.0-372.0	Iron Formation 30% Mag.							
372.0-372.5	" " 15% Mag.							
372.5-374.0	Lost core							

ALGOMA ORE PROPERTIES

DIVISION OF

THE ALGOMA STEEL CORPORATION, LIMITED
EXPLORATION DEPARTMENT

DIAMOND DRILL HOLE NO. A-10-62

PROPERTY PIVABISKA MAGNETITE

CONTINUED Page 3

FOOTAGE	DESCRIPTION	SAMPLING			ANALYSES			
		FROM	TO	REC.				
374.0-382.5	Iron Formation 15% Mag.							
382.5-387.0	" " 10% Mag.							
387.0-400.0	" " 15% Mag.							
400.0-400.5	" " 35% Mag.							
400.5-401.7	Qtz., Biot., Schist 0% Mag.							
401.7-403.0	Iron Formation 25% Mag.							
403.0-407.0	Qtz., Biot., Schist 0% Mag.							
407.0-412.0	Iron Formation 25% Mag.							
412.0-413.0	" " 10% Mag.							
413.0-418.5	" " 25% Mag.							
418.5-420.0	" " 20% Mag.							
420.0-422.0	" " 10% Mag.							
422.0-427.3	" " 20% Mag.							
427.3-445.0	" " 30% Mag.							
445.0-447.0	" " 20% Mag.							
447.0-450.0	" " 10% Mag.							
450.0-458.7	Qtz., Biot., Schist 0% Mag.							
458.7-459.0	Iron Formation 30% Mag.							
459.0-488.0	Qtz., Biot., Schist 0% Mag.							
<u>HEMATITE ZONES:</u>								
202 - 257.5								
292 - 305								

[Handwritten Signature]

DIP TEST: 48' - 44°
 100' - 42.5°
 200' - 41.5°
 300' - 38.5°

ALGOMA ORE PROPERTIES

DIVISION OF

THE ALGOMA STEEL CORPORATION, LIMITED
 EXPLORATION DEPARTMENT

DIAMOND DRILL HOLE NO. D-1-62

PROPERTY Pivabiska Magnetite

LOCATION OF COLLAR 44+39W 6+23N

ELEV.

AZIMUTH AT COLLAR 180°

DIP AT COLLAR 45°

VERTICAL SECTION NO.

LENGTH 319

CORE SIZE A x T

REC. IN MIN. ZONE

LOGGED BY V. Venn STARTED June 8/62 FINISHED June 10/62

FOOTAGE	DESCRIPTION	SAMPLING			ANALYSES				
		FROM	TO	REC.	Estimated Fe (Mag.)				
0 - 41	Overburden				0 - 48	Casing			
41 - 294.0	Iron formation - Qtz. biot schist carrying disseminated magnetite. 41-50 green iron silicates inter-mixed with iron formation Garnets occur at both the beginning and the end of the section 63- 68 Garnets 82-105 " 225-243 " 264.5-275.5 Rock becomes lighter in colour and less schistose	Garnet Zone				41 - 45	15% "B"		
						45 - 47.8	15% "A"		
						47.8 - 74.6	10%		
				63 - 68		74.6 - 75.6	L.O.		
						75.6 - 81.5	15%		
				81.5-105		81.5-112	10%		
						112 - 113	L.O.		
				225 - 243		113 - 122.8	15%		
						122.8-123.7	L.O.		
						123.7-125	20%		
						125 - 125.5	L.O.		
						125.5-126.3	20%		
						126.3-127.2	L.O.		
						127.2-130.7	10%		
						130.7-195.5	20%		
			294.0-319	Waste - Qtz. biot schist 293-295 minor seams of sulphides				195.5-203	5%
								203 - 203.5	L.O.
					203.5-205.6	Waste			
					205.6-210	15%			
					210 - 211	Waste			
					211 - 214.2	L.O.			
					214.2-217.2	Waste			
					217.2-223	15%			
					223 - 255	10%			
					255 - 256	25%			
					256 - 256.6	5%			
			256.6-259.3	L.O.					
			259.3-262.3	10%					
			262.3-265.3	25%					
			265.3-268.7	5%					
			268.7-275	Waste					
			275 - 294	15%					
			294 - 319	Waste					

END OF HOLE

DIP TEST: 45' - 45.5°
 100' - 43.5°
 200' - 42.5°
 300' - 40.5°

ALGOMA ORE PROPERTIES

DIVISION OF

THE ALGOMA STEEL CORPORATION, LIMITED

EXPLORATION DEPARTMENT

DIAMOND DRILL HOLE NO. D-2-62 PROPERTY
 LOCATION OF COLLAR 48+39W 7+35N ELEV.
 AZIMUTH AT COLLAR. 180°
 DIP AT COLLAR 45°
 VERTICAL SECTION NO. LENGTH 303' CORE SIZE. A X
 REC. IN MIN. ZONE. LOGGED BY V. Venn STARTED. June 11/62 FINISHED. June 12/62

FOOTAGE	DESCRIPTION	SAMPLING			ANALYSES	
		FROM	TO	REC.	Estimated Fe	(Mag.)
0 - 43'	Overburden				0 - 43	Casing
43 - 61.3	Waste - white impure quartzite becoming schistose toward the bottom of the section. The bottom of the section is garnetiferous				43 - 61.3	Waste
					61.3 - 66.3	10%
					66.3 - 73	20%
					73 - 80	10%
	51-62 pink garnets @ 61-4" of disseminated pyrite		Garnet Zone		80 - 81.5	Waste
					81.5 - 90	10%
					90 - 98.5	5%
61.3-292.8	Iron formation - Qtz. biot amphibole schist containing disseminated magnetite. This section appears darker than previously seen - because of the abundance of iron silicates - the section becomes garnetiferous toward the bottom with an increase in iron silicates (278-297)				89 - 112	15%
					107 - 177	5%
					277.5 - 295	15%
					103 - 124.3	15%
					124.3 - 125	L.C.
					125 - 130.5	15%
					130.5 - 150	20%
					150 - 161.5	10%
					161.5 - 162.5	Waste
					162.5 - 166	L.C.
					166 - 177.5	10%
					177.5 - 184.5	15%
					184.5 - 192	20%
					192 - 195.3	Waste
					195.3 - 207.8	15%
					207.8 - 209	5%
					209 - 211.5	20%
					211.5 - 213.3	L.C.
					213.3 - 216.7	20%
					216.7 - 273	15%
					273 - 277.5	10%
					277.5 - 284.5	Waste
					284.5 - 285	25%
					285 - 292.8	5%
292.8-303	Waste - Qtz. biot schist				292.8 - 303	Waste

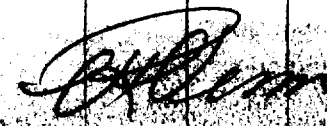

ALGOMA ORE PROPERTIES

DIVISION OF

THE ALGOMA STEEL CORPORATION, LIMITED

EXPLORATION DEPARTMENT

DIAMOND DRILL HOLE NO. D-3-62

PROPERTY

LOCATION OF COLLAR 46+38W 6+73 NORTH

ELEV.

AZIMUTH AT COLLAR. 180°

DIP AT COLLAR 45°

VERTICAL SECTION NO.

LENGTH 300'

CORE SIZE. Ax

REC. IN MIN. ZONE.

LOGGED BY V. Venn STARTED. June 29/62 FINISHED. June 30/62

FOOTAGE	DESCRIPTION	SAMPLING			ANALYSIS			
		FROM	TO	REC.	Estimated Fe (Mag.)			
0 - 65'	Overburden				0 - 65	Casing		
65 - 294	Iron formation - Qtz. biot schist carrying disseminated magnetite specular hematite (100'-111') The top of this section is garnetiferous. It is similar to Hole D-2- in that it contains greater amounts of amphibole				65 - 90	10%		
					90 - 111.4	20%		
					111.4 - 133.6	15%		
					133.6 - 134.8	L.C.		
				Garnet Zone	134.8 - 137	15%		
					137 - 138.7	L.C.		
				65 - 82	138.7 - 141	15%		
				180 - 194	141 - 142.3	L.C.		
					142.3 - 153.7	15%		
					153.7 - 155	L.C.		
					155 - 193	10%		
					193 - 196	15%		
					196 - 198.2	L.C.		
					198.2 - 205	10%		
					205 - 213.6	20%		
		294 - 300.0	Waste - Qtz. biot schist				213.6 - 215	L.C.
							215 - 218.5	20%
					218.5 - 222.5	Waste		
					222.5 - 225.6	20%		
					225.6 - 228	10%		
					228 - 233	Waste		
					233 - 237.5	20%		
					237.5 - 240	5%		
					240 - 241.2	25%		
					241.2 - 250	Waste		
					250 - 255	20%		
					255 - 256.8	25%		
			256.8 - 260.7	10%				
			260.7 - 263	25%				
			263 - 291.2	20%				
			291.2 - 292.4	L.C.				
			292.4 - 294	10%				
			294 - 300	Waste				

V. Venn

DIP TEST: 52'
 100' - 23'
 200' - 28'
 300' - 40'

ALGOMA ORE PROPERTIES

DIVISION OF
 THE ALGOMA STEEL CORPORATION, LIMITED
 EXPLORATION DEPARTMENT

DIAMOND DRILL HOLE NO. D-4-62 PROPERTY
 LOCATION OF COLLAR 42+34W 6+00N ELEV.
 AZIMUTH AT COLLAR 180°
 DIP AT COLLAR 45°
 VERTICAL SECTION NO. LENGTH 303.5 CORE SIZE. Ax
 REC. IN MIN. ZONE. LOGGED BY. V.Venn STARTED. July 1/62 FINISHED. July 2/62

FOOTAGE	DESCRIPTION	SAMPLING			ANALYSIS	
		FROM	TO	REC.	Estimated Fe	(Mag.)
0 - 53	Overburden				0 - 53	Casing
53 - 88.0	Waste - qtz. biot schist containing garnets and white phenocrysts				53 - 63.6	Waste
	65-92 garnets		Garnet Zone		63.6 - 65	L.C.
					65 - 88	Waste
					88 - 98	10%
			65-92		98 - 121	20%
88.0-327	Iron formation		163-186		121 - 122	10%
	Garnets 165-185		308-315		122 - 129	Waste
	309-315				129 - 140.5	15%
	The section is garnetiferous at both the top and bottom. The latter grading into qtz. biot, amphibole schist				140.5 - 143	Waste
					143 - 144.5	15%
					144.5 - 149.4	Waste
					149.4 - 153.5	15%
					153.5 - 156	Waste
					156 - 235	15%
327 - 343	Waste - qtz. biot amphibole schist				235 - 239	Waste
					239 - 249.5	15%
					249.5 - 252	Waste
					252 - 269	20%
					269 - 327	15%
					327 - 343	Waste

END OF HOLE

V.Venn



No 4 Post

No 1 Post

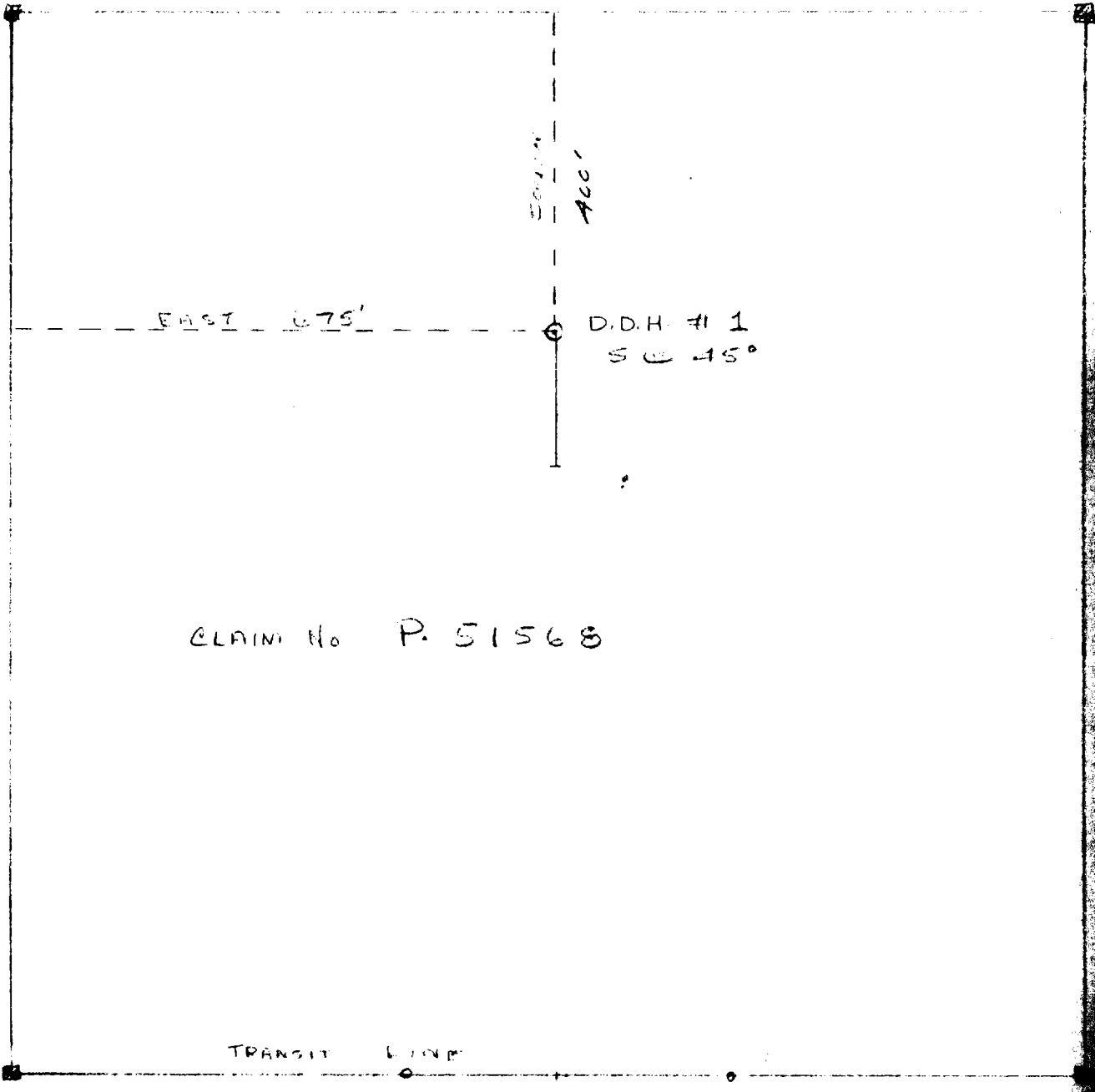

CLAIM No P. 51568

No 3 Post

No 2

TRANSIT LINE

6700W

4412W

2700W

SCALE: 1" = 7'

ALGOMA ORE PROPERTIES

DIVISION OF

THE ALGOMA STEEL CORPORATION, LIMITED

EXPLORATION DEPARTMENT

51568

DIAMOND DRILL HOLE NO. Del-1-62

PROPERTY Pivabiska Magnetite

LOCATION OF COLLAR 60+13W 400S of N. base line

ELEV.

AZIMUTH AT COLLAR 180°

DIP AT COLLAR 45°

VERTICAL SECTION NO.

LENGTH 221'

CORE SIZE AXI

REC. IN MIN. ZONE.

LOGGED BY V. Vein STARTED June 14/62 FINISHED June 21/62

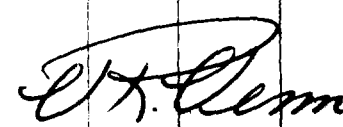
FOOTAGE	DESCRIPTION	SAMPLING			ANALYSIS		
		FROM	TO	REC.	Estimated Fe	(Mag.)	
0 - 73'	Overburden				0 - 73	Casing	
73 - 185.5	Iron formation - grey quartz biot schist carrying varying percentages of disseminated magnetite. Specular hematite is noticable throughout most of the zone. The zone is garnetiferous at the top and bottom. At the bottom of the zone there is an increase in iron silicates.				73 - 90	5%	
					90 - 180	15%	
					180 - 186	5%	
					186 - 221	0%	
					221 -	END OF HOLE	
	Hematite zone - 95'-158' (5% hematite)						
185.5-221	Waste - Garnetiferous quartz amphibole biot schist grading into quartz biot schist toward the end of the hole.						
	Garnet zones - 73 - 85 181 - 217						
	Mottled zones - 204 - 208 212 - 213						
	Amphibolite @ 174.5-6"						
	<p>CORE STORED ON CLAIM P 49245 ABOUT 100' N. of S. BOUNDARY AND 600' E of W. "</p>						
							



R. 51567

No 4 Post

No 1 Post

CLAIM No. R. 5 M. 62428

500'

D.O.H 112
N. @ 45°

100'

Traverse line

No 3 Post

No 2 Post

SCALE 1" = 200'

DIP TEST: 52' - 42.5°
 100' - 41.5°
 200' - 38.5°
 300' - 36.5°

ALGOMA ORE PROPERTIES

DIVISION OF

THE ALGOMA STEEL CORPORATION, LIMITED
 EXPLORATION DEPARTMENT

~~51560~~
 2428

DIAMOND DRILL HOLE NO. Del.-2-62 PROPERTY Pivabiska Magnetite
 LOCATION OF COLLAR 104+00W 3+00N ELEV.
 AZIMUTH AT COLLAR 180°
 DIP AT COLLAR 45°
 VERTICAL SECTION NO LENGTH 323' CORE SIZE. A x T
 REC. IN MIN. ZONE LOGGED BY V.Venn STARTED June 22/62 FINISHED June 28/62

FOOTAGE	DESCRIPTION	SAMPLING			ANALYSIS	
		FROM	TO	REC.	Estimated	Fe (Mag.)
0 - 52	Casing (overburden)					
52 -259.6	Waste - qtz. biot schist					Casing
	51.5 - 99 minor drag folds	257.2	260.5		52 -259.6	Waste
	63' - 2" garnets				259.6-298	15%
	70' - 1" "				298 -322	Waste
	85' - garnets in Fe silicates					END
	92' - 8" garnets					
	94 - 99.5 large bands of qtz.					
	Toward the bottom of this section the schist becomes more massive grading in places into impure quartzite					
	252.5-253.5 - mottled (sil. particles)					
259.6-298.0	Iron formation - qtz. biot schist carrying 15% magnetite (257-260 garnets)					
298.0-323	Waste - qtz. biot schist					
<p>CORE STORED ON CLAIM 49285 ABOUT 100' N. OF S. Boundary AND 600' E. OF W. "</p>						

Renosig Creek Area

Hole No. 1 Sheet No. 1

DIAMOND DRILL RECORD

Property Pivabiska Magnetite

Location Plan M.2317

P.49292

Collar

100'

300'

Dip

45°

41°

39°

Latitude 130° South

Departure 250° East

Bearing 180°

Total Footage 408

Elev. Collar

Datum

Date Started July 8, 1961

Date Completed July 12, 1961

Drilled by Canadian Longyear Ltd.

Logged by J. V. Huddart

Footage		Formation	Sample Number	Sample Footage	Sample Width	Gold Sample	Gold Sludge	Remarks
From	To							
9	28	Casing						
28	64	Quartz-biotite-garnet, schist						
64	66	Quartz-biotite-schist, minor magnetite						
66	70	Quartz-biotite-schist						
70	361	Interlamination of quartz-biotite-schist and fine magnetite bands						
361	408	Quartz-biotite-garnet schist.						
		core stored in boxes on North shore of small lake 1/2 mile south of P.49293						

J. V. Huddart

Date of Examination July 13, 1961.

DIAMOND DRILL RECORD

Property Pivabiska Magnetite
 Location Plan M.2317
P.49292
 Latitude 390° South
 Departure 10° West
 Bearing 180°

Collar 45°
 Dip 41°
300'
 Total Footage 351.5

Elev. Collar _____
 Datum _____
 Date Started July 14, 1961
 Date Completed July 17, 1961
 Drilled by Canadian Longyear Ltd.
 Logged by J. V. Huddart

Footage		Formation	Sample Number	Sample Footage	Sample Width	Gold Sample	Gold Sludge	Remarks
From	To							
0	22	Casing						
22	37	Quartz-biotite-schist						
37	80	Quartz-biotite-garnet schist						
80	344.5	Interlamination of quartz-biotite-schist and magnetite						
344.5	351.5	Garnetiferous biotite schist						

Core stored in boxes on North shore of small lake ½ mile south of P.49293



DIAMOND DRILL RECORD

Hole No. 3 Sheet No. 1

Property Pivabiska Magnetite
 Location Plan M. 2317
 P. 49291

Collar Dip 45°
 100' 44°
 300' 42°
 500' 44°

Latitude 150° South
 Departure 280° West
 Bearing 180°

Elev. Collar
 Datum July 18, 1961
 Date Started July 21, 1961
 Date Completed Canadian Longyear Ltd.
 Drilled by J. V. Huddart
 Logged by

Total Footage 524

Footage		Formation	Sample Number	Sample Footage	Sample Width	Gold Sample	Gold Sludge	Remarks
From	To							
0	23	Casing						
23	92	Quartz-biotite schist, garnetiferous in places						
92	503	Interlaminations of quartz-biotite schist and magnetite - minor specularite						
503	508.5	Quartz-biotite schist						
508.5	524	Quartzite schist						
		Core stored in boxes on North shore of small lake $\frac{1}{2}$ mile South of P. 49293						

Date of Examination

July 20, 1961.

J. V. Huddart

DIAMOND DRILL RECORD

Hole No. **4** Sheet No. **1**

Property Location	Pivabiska Magnetite Plan M. 2317 P. 49291	Dip	45° 45° 46°
Latitude	350' South	Elev. Collar	
Departure	270' West	Date Started	July 22, 1961
Bearing	180°	Date Completed	July 24, 1961
		Drilled by	Canadian Longyear Ltd.
		Logged by	J. V. Huddart
Total Footage	251		

Footage		Formation	Sample Number	Sample Footage	Sample Width	Gold Sample	Gold Sludge	Remarks
From	To							
0	21	Casing						
21	229	Interlaminations of quartz-biotite schist and magnetite. Some specular hematite						
229	232.5	Quartz-chlorite schist. 10% pyrite						
232.5	251	Quartzite schist						
		Core stored in boxes on North shore of small lake ½ mile South of P. 49293						

J. V. Huddart

Date of Examination July 25, 1961.

DIAMOND DRILL RECORD

Hole No. 5 Sheet No. 1

Property Pivabiska Magnetite
 Location Plan M. 2317
P. 49298

Latitude 1030' South
 Departure 470' East
 Bearing 180°

Collar 45°
100'
205'

Dip 45°
44°
44

Total Footage 227

Elev. Collar
 Datum July 26, 1961
 Date Started July 28, 1961
 Date Completed Canadian Longyear Ltd.
 Drilled by J. V. Huddart
 Logged by

From	To	Footage	Formation	Sample Number	Sample Footage	Sample Width	Gold Sample	Gold Sludge	Remarks
0	31		Casing						
31	72		Quartz-biotite schist						
72	215		Interlaminations of quartz-biotite schist and magnetite with many barren sections						
215	217		Quartz-biotite-garnet schist						
217	227		Quartz-biotite schist						
			Core stored in boxes on North shore of small lake 1/2 mile South of P.49293						

Date of Examination July 30, 1961.

J. V. Huddart

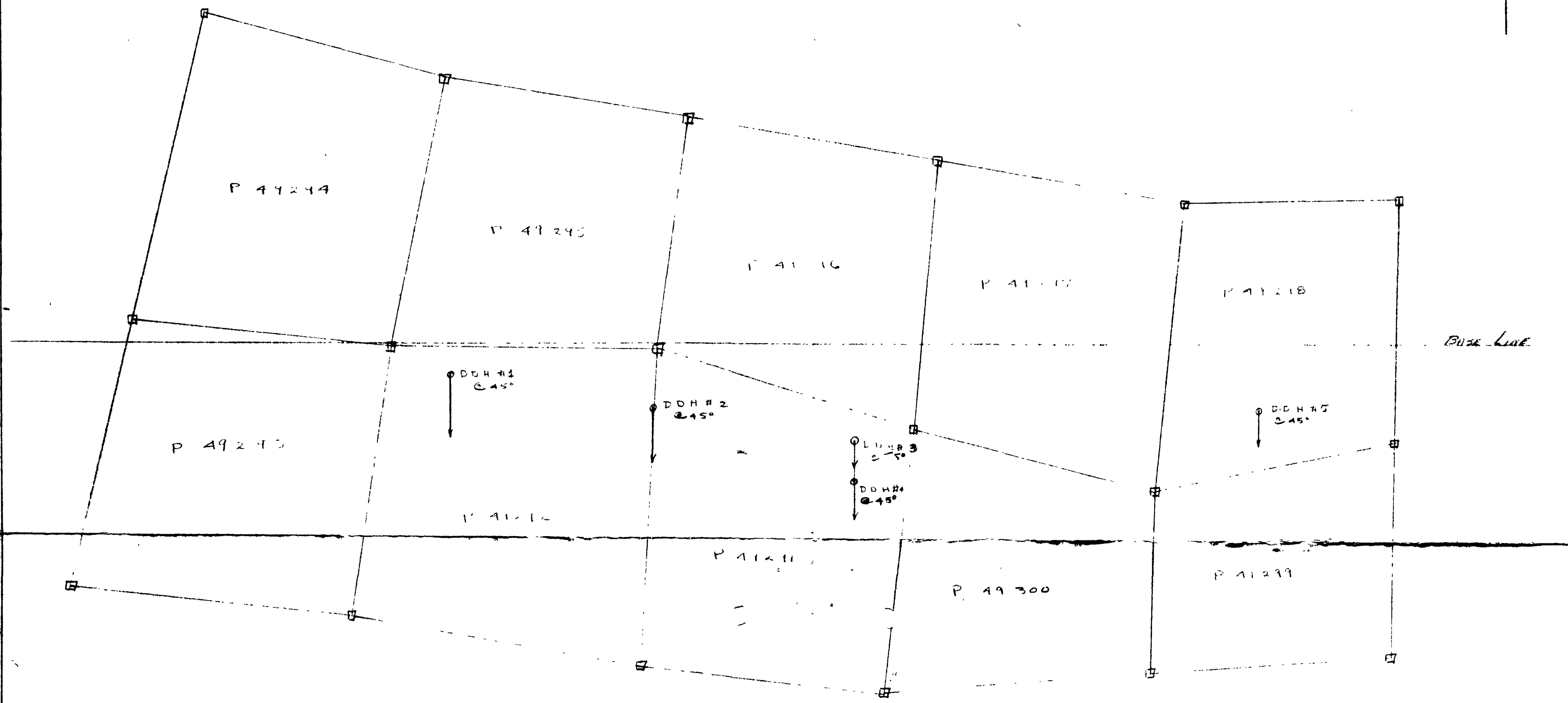

SCALE: 1" = 400'

Map 5/105 (10/61)

**ALGOMA ORE PROPERTIES LIMITED
EXPLORATION DEPARTMENT**

PIVABISKA MAGNETITE PROPERTY

PLAN NO. M-2317

SCALE: 1" = 400' OCT. 31, 1961



Holes D-1
D-2
D-3
D-4

scale 1 inch = 200 feet



Post #4

Post #1

Claim No. P-51561

Post #3

Post #2

Picket
Base line

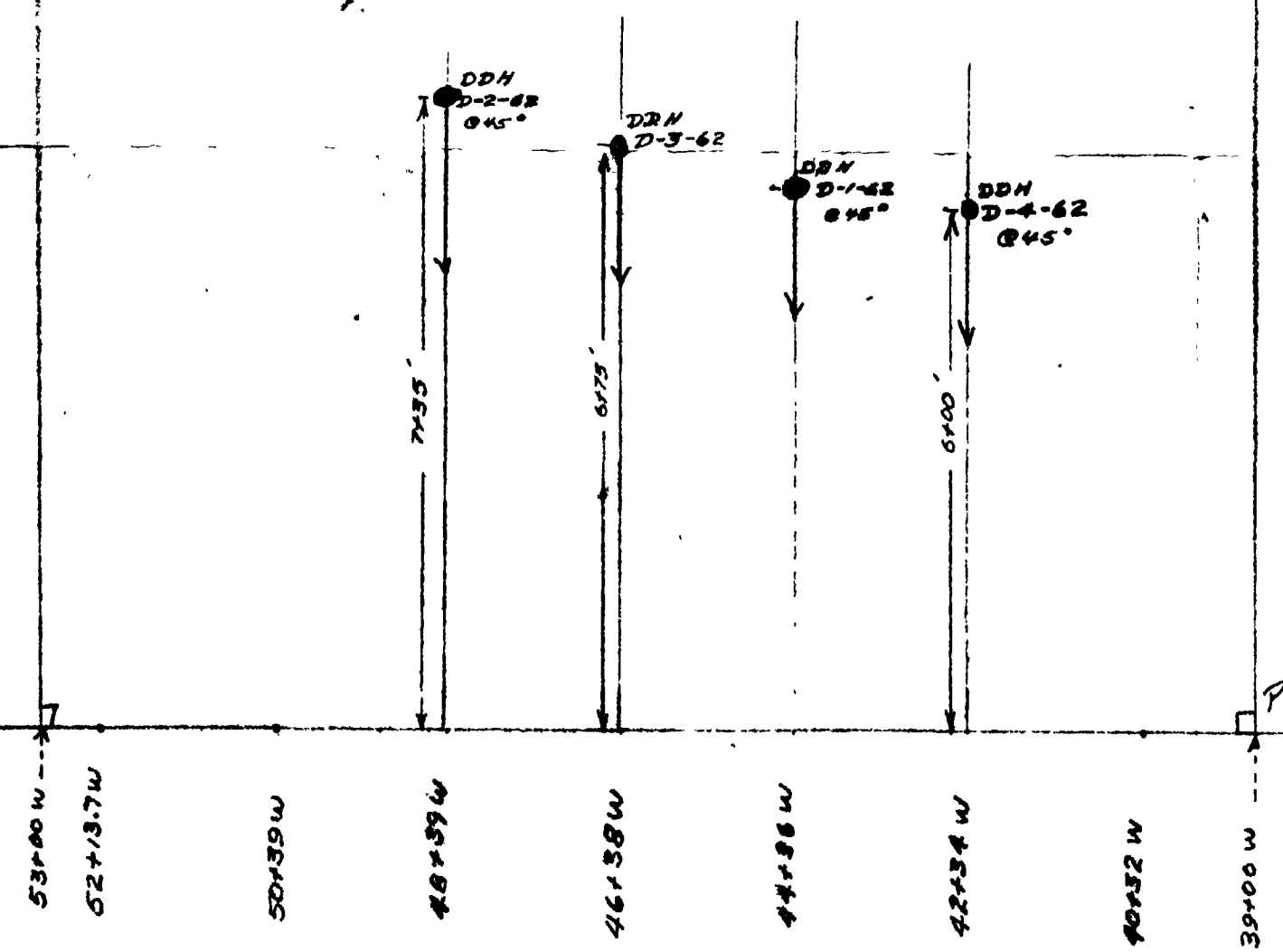

FILE A-1-62



scale 1 inch = 200 feet

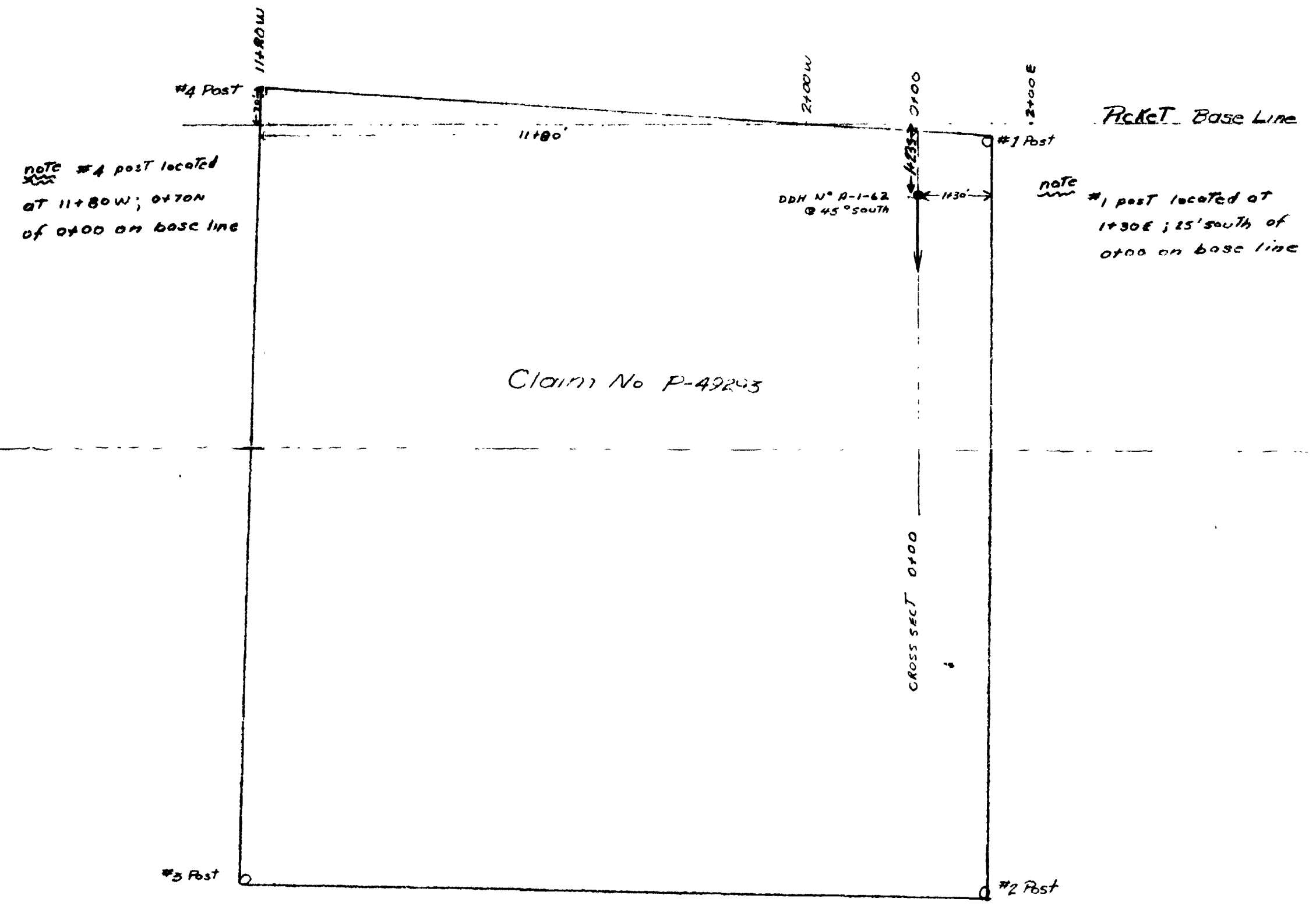

1/12/62: H-7-62
H-8-62
A-9-62
H-11-62



scale 1 inch = 200 feet

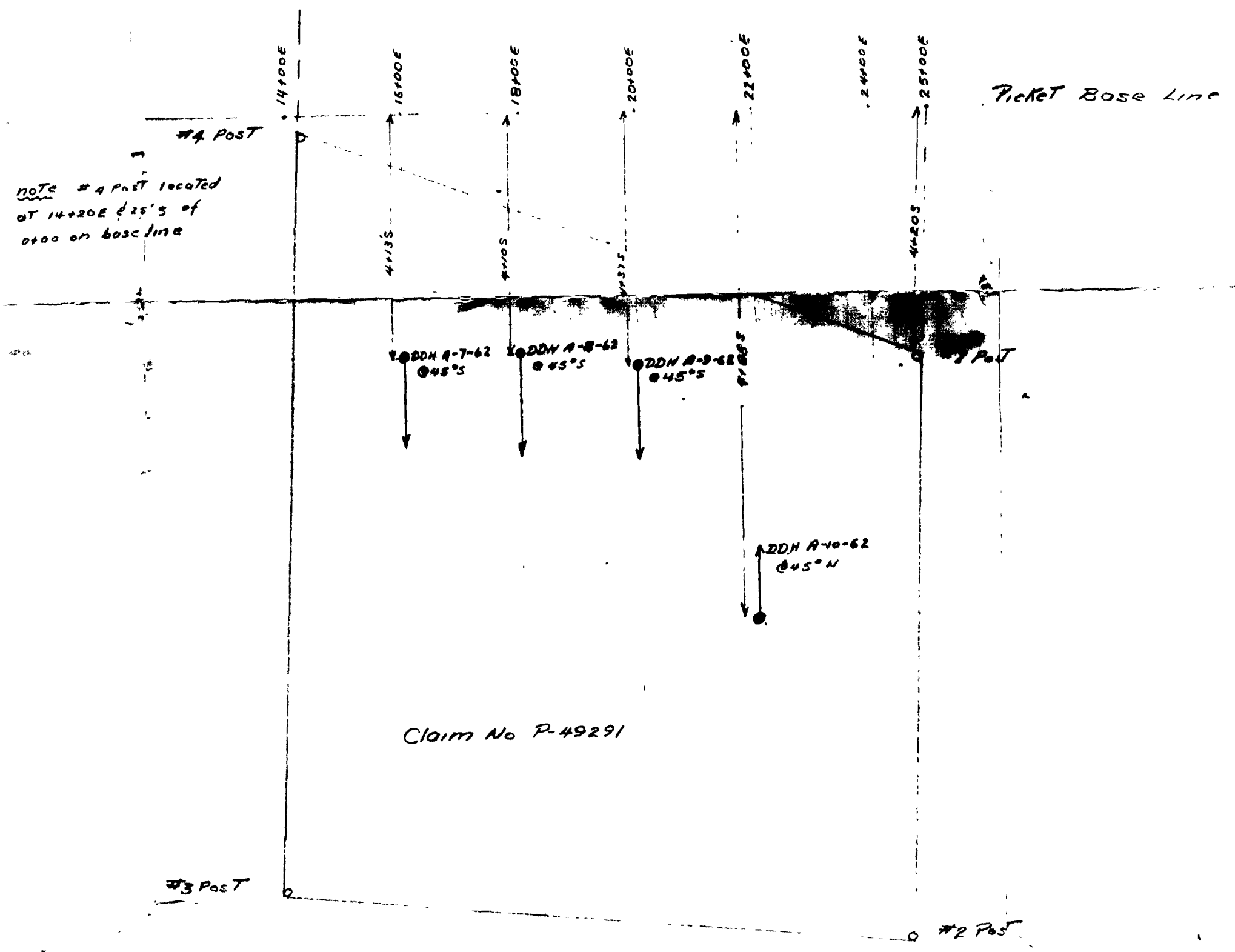

HILLS: H-2-62
 A-3-62
 A-4-62
 A-5-62
 A-6-62



scale 1 inch = 200 feet

