



42J03SW0009 63.755 RENESIG CREEK

October 17th, 1956.

GROUND MAGNETOMETER SURVEY

PIVABISKA EXPLORATION SYNDICATE CLAIMS

HEARST ONTARIO

INTRODUCTION

The Pivabiska Exploration Syndicate staked 80 unpatented mining claims in the Renesig Creek area of the District of Cochrane, lying to the west of the Township of Burstall and Scovil, partly in the Porcupine Mining Division, and partly in the Sault Ste. Marie Mining Division of Ontario.

The claims are:-

Numbers S-84596 - S-84667 inclusive in the Porcupine Mining Division, and

Numbers SSM-1616 - SSM-1623 inclusive in the Sault Ste. Marie Mining Division.

The claims were staked mainly for iron, as magnetite was reported on an old test pit on the property, and because of anomalous magnetic intensity indications.

The property was subsequently held under option by G. C. Huston & Associates, 2001-80 Richmond Street West, Toronto, from April 6th to July 6th 1956.

The ground magnetometer survey was carried out prior to the signing of the option agreement, and was under the direction of G. C. Huston & Associates, Toronto.

The area is accessible by float or ski equipped aircraft.

GROUND MAGNETOMETER SURVEY AREA

A total of 10 claims were covered by the ground magnetometer survey, and they are the following:

- S-84597 and S-84598,
- S-84606 and S-84607,
- S-84615 and S-84616,
- S-84620, and S-84625,
- S-84633 and S-84634.

### GROUND MAGNETOMETRIC SURVEY

This magnetometer survey was done under the direction of G. G. Huston & Associates between February 9th and February 25th, 1956.

The instrument used was a "Sharpe" vertical intensity magnetometer with a sensitivity of 1/6 gammas per scale division. In this survey, approximately 6.5 miles of line were cut and 426 stations were established.

Most of the readings were taken at 100 foot intervals along lines cut at 400 foot spacing.

### GEOLOGY

No rock outcrops were observed as the area is relatively flat and swampy with extensive overburden. Therefore, no geological report or interpretation is included with this report.

### MAGNETICS

The contoured magnetic intensity data shows a maximum intensity relief of approximately 48000 gammas within the survey area.

Two strongly magnetic anomalous parallel zones were disclosed in an overall length of 58000 feet, and with widths varying from approximately 200 to 600 feet.

The southerly zone was the more intense with a calculated area of 201,300 square feet containing off scale readings or over 50,000 gammas.

The anomalous zones were interpreted to reflect highly magnetic iron formations striking approximately East-West and although not outcropping, being close to the surface. (Estimated overburden between 15 and 20 feet).

Diamond drilling on the continuation of the same magnetic zone to the east and on the ground held by the "Ross Syndicate" disclosed a fine grained siliceous banded magnetic iron formation which corroborate the above interpretation.

### BREAKDOWN OF MAN-DAYS REQUIRED FOR SURVEY

#### a) Line Cutters

R. Content, Fauquier, Ontario February 9th - February 16th	8 days
M. Beauvais, Moonbeam, Ontario February 9th - February 16th	8 days
	16 days

C. C. HUSTON & ASSOC.  
TORONTO

KEY MAP

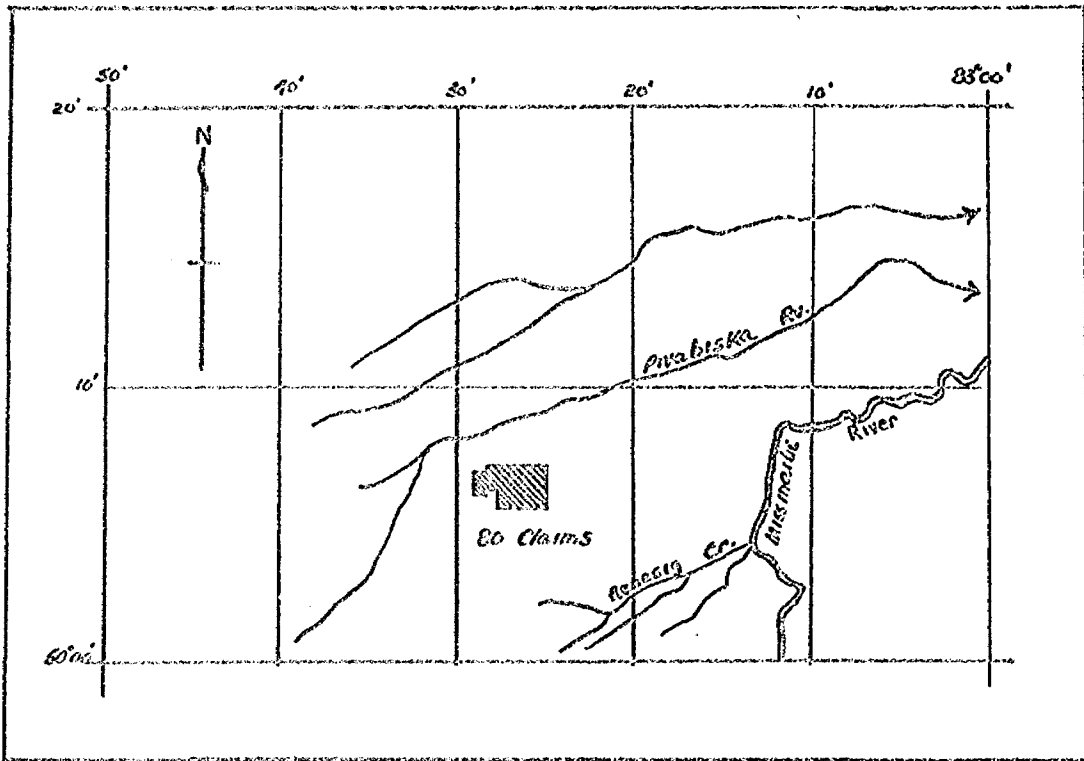

GEOGRAPHIC LOCATION

PIVABISKA EXPLORATION SYND.

SCALE : 1" = 8 MILES

Oct., 1956

ON  
PIMBISKA EXPLORATION SYND. CLAIMS  
HEARST ONT.

From file - 63.755

RENESIG CREEK AREA

Scale 1" = 200'

Contour Interval - 500'

X - holes drilled in 1962

X 4-61 - holes drilled in 1961

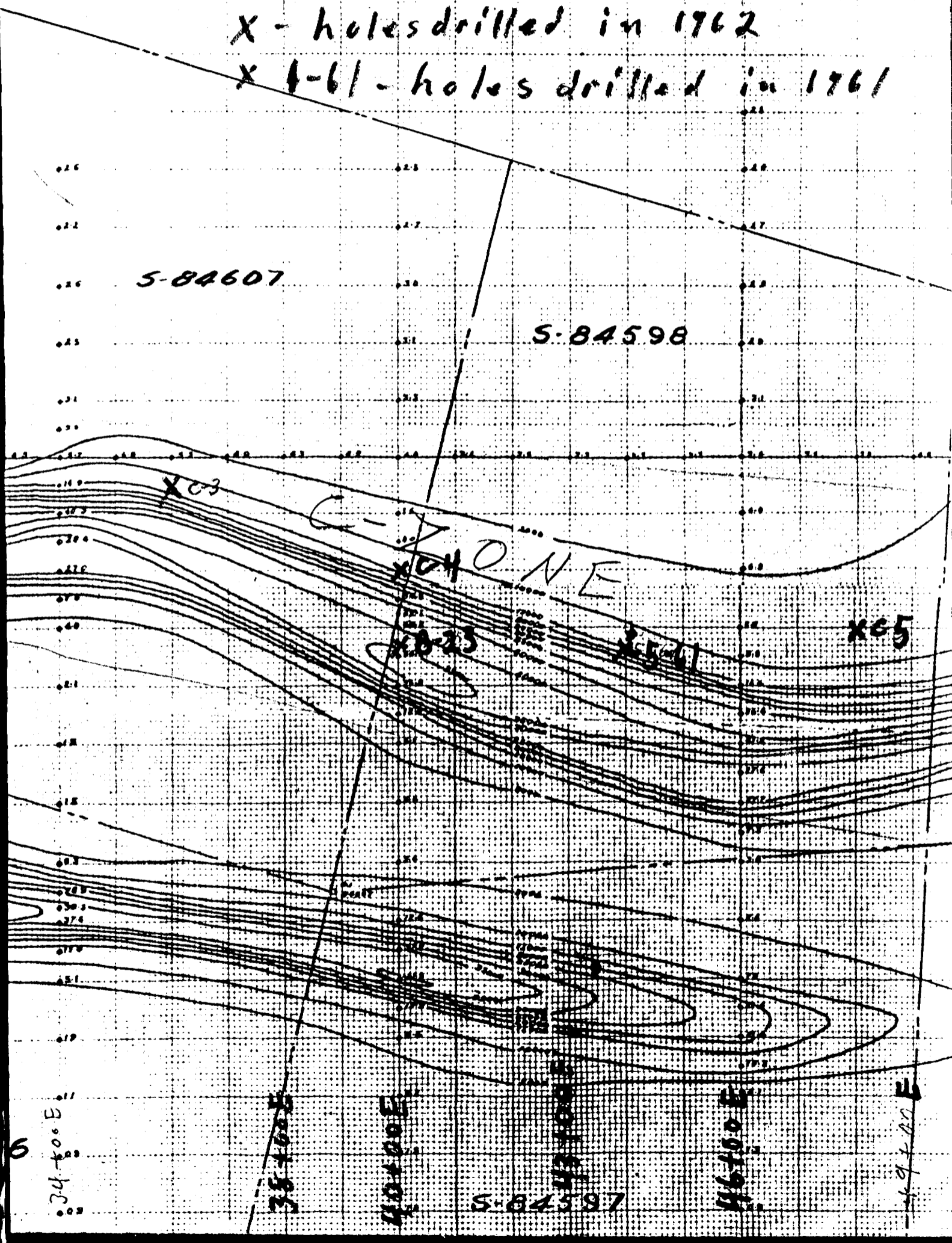

S-84607

S-84598

C-ZONE

S-84597

34-600 E

35-600 E

36-600 E

37-600 E

38-600 E



S-84616

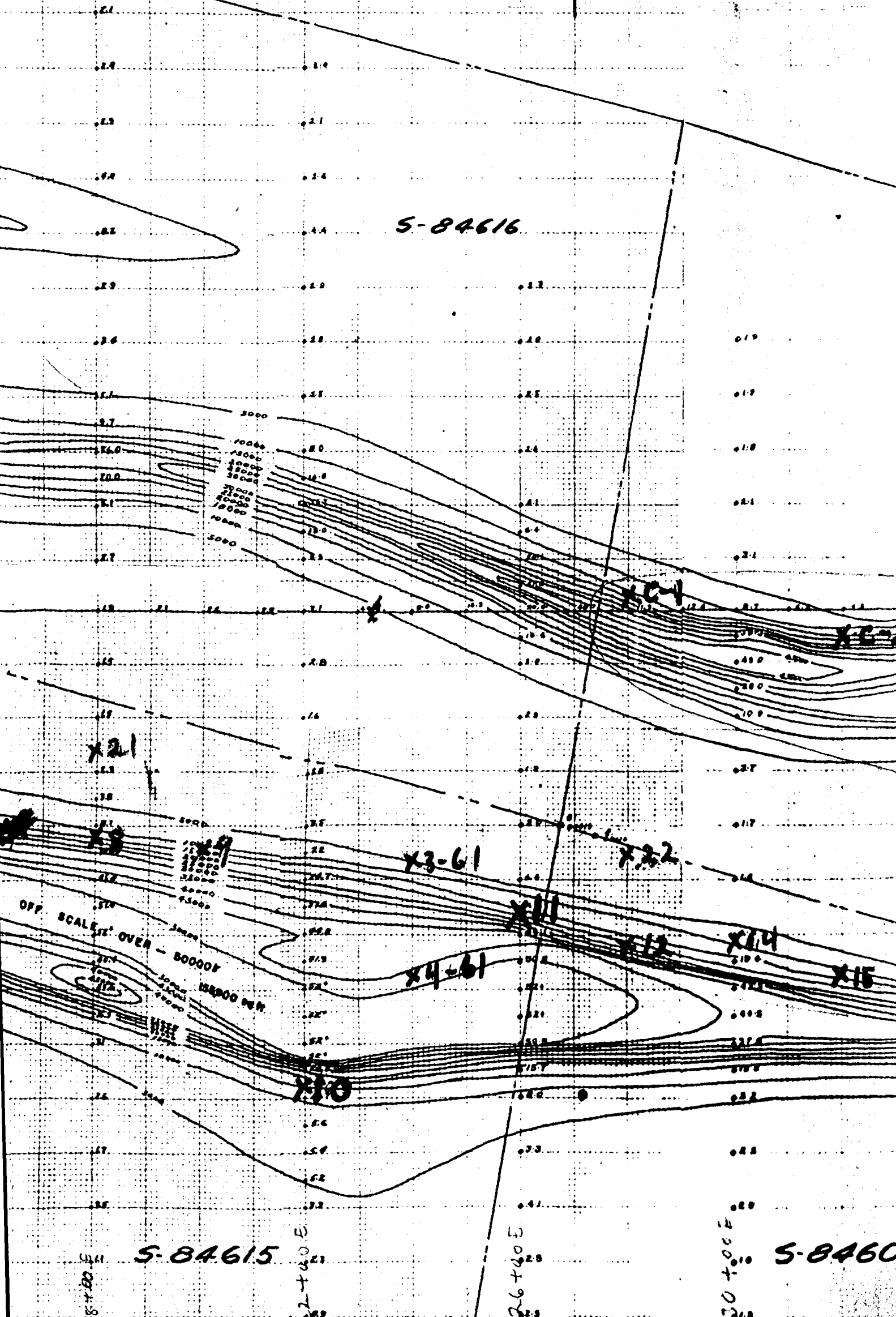

S-84615

S-8460

18+00 E

22+00 E

26+00 E

30+00 E

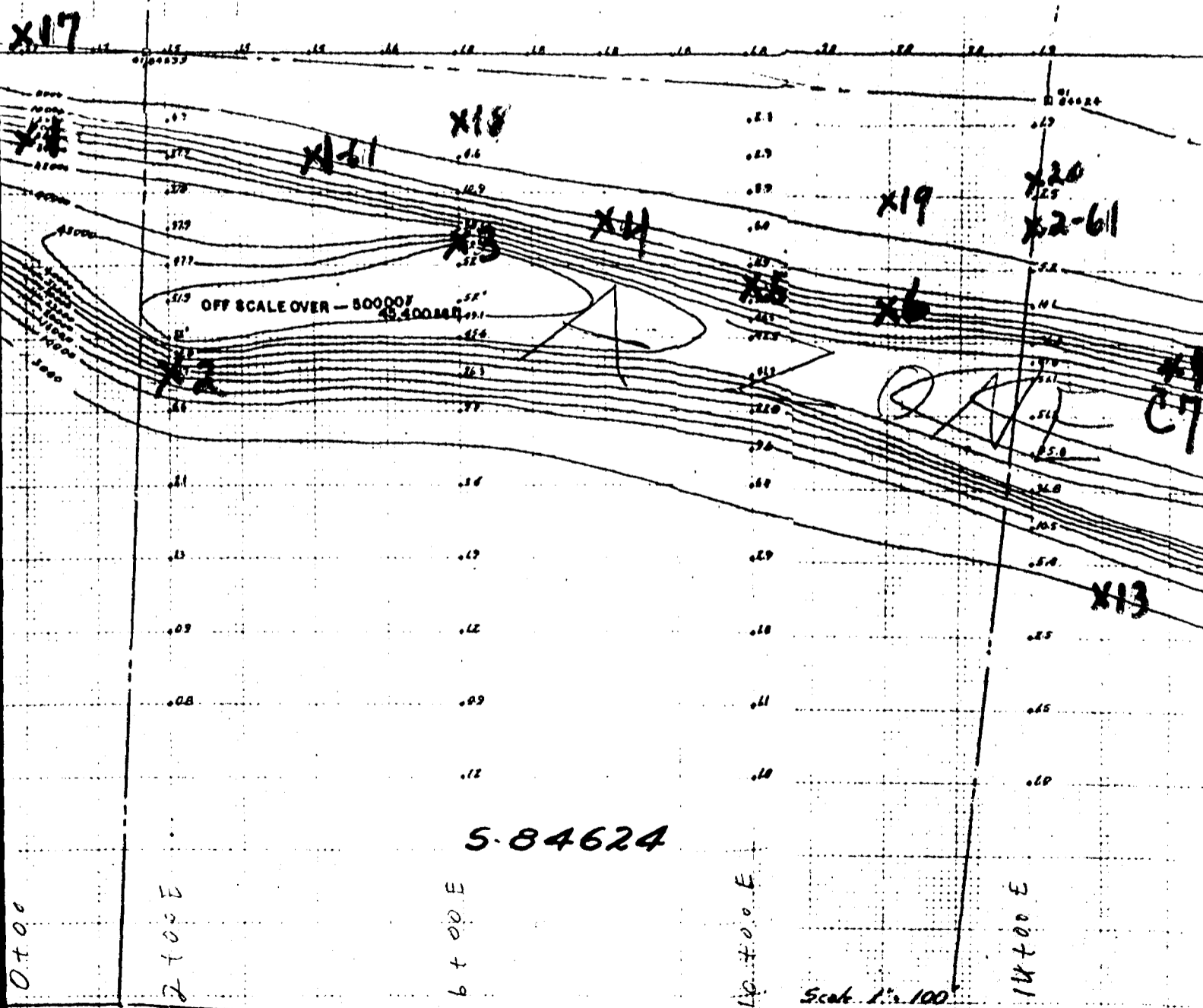
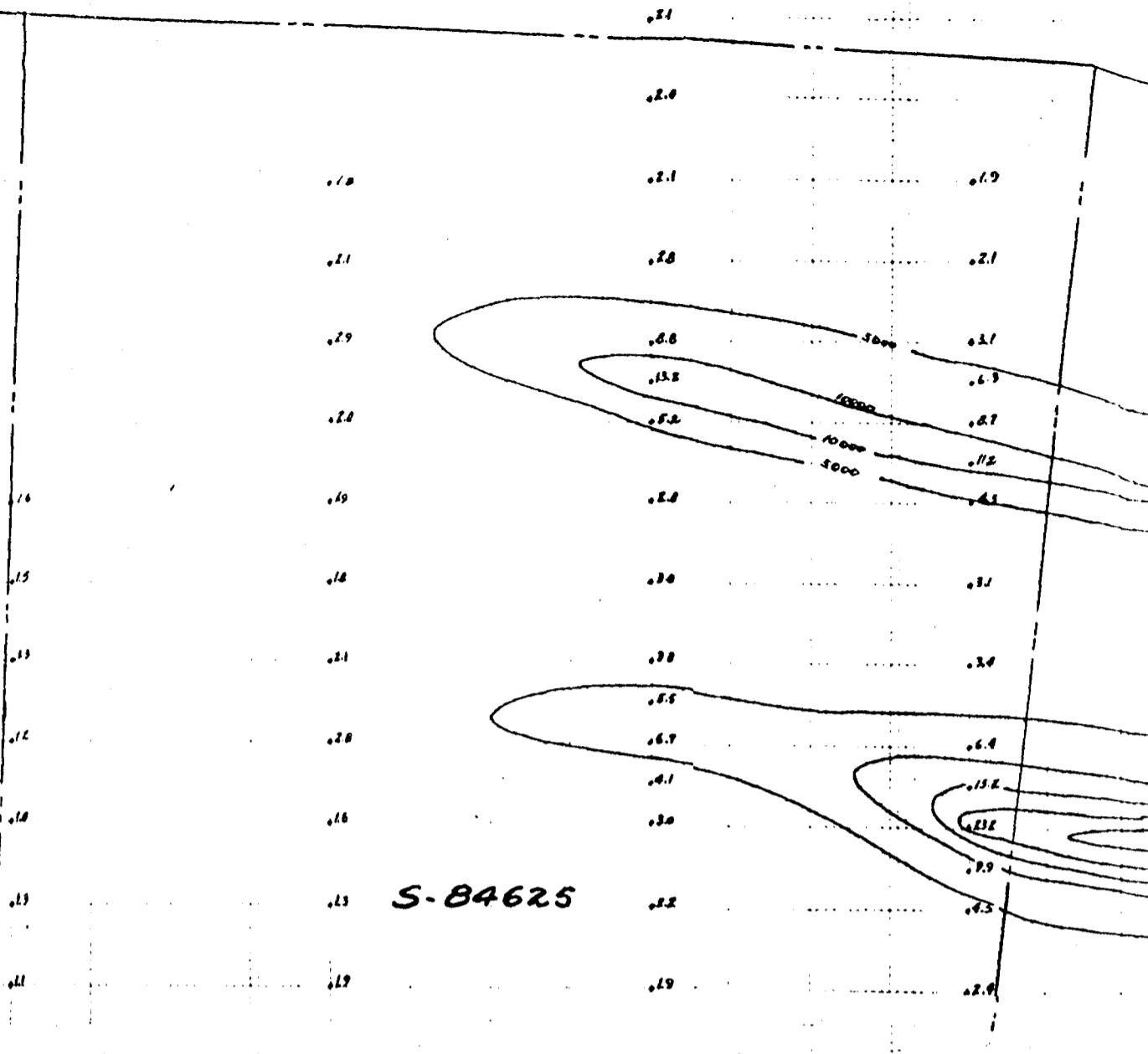

0 to 0  
 2 to 0 E  
 6 to 00 E  
 10 to 00 E  
 14 to 00 E  
 Scale 1" = 100'  
 Contour Interval 5000'

121004

8100H

4100H

4100S

3100S

2100S

S-84634

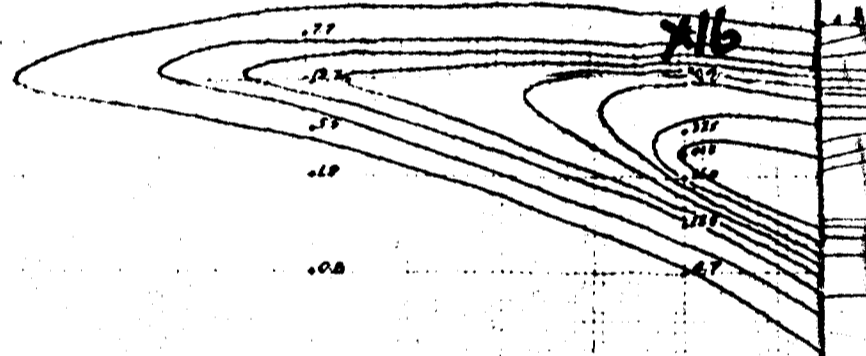
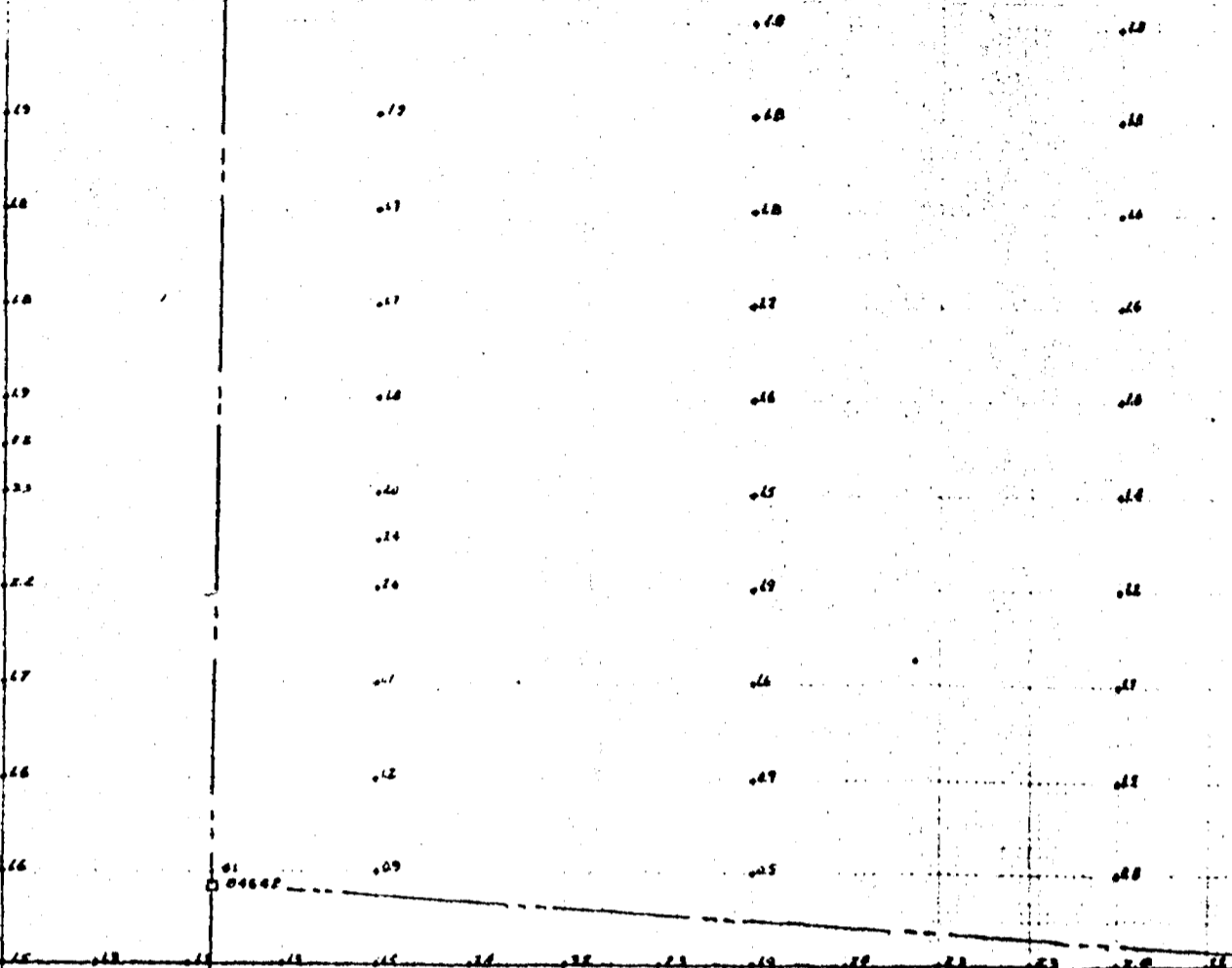

14100W

10100W

6100W

S-84633

2100W

63775

GROUND MAGNETOMETER SURVEY  
BY  
C.C. HUSTON & ASSOCIATES  
ON  
PINABISKA EXPLORATION SYND. CLAIMS  
HEARST, ONT.

Scale 1" = 200'  
Contour Interval - 5000 V



16000  
12000  
8000  
4000  
0  
4000  
8000  
12000  
16000

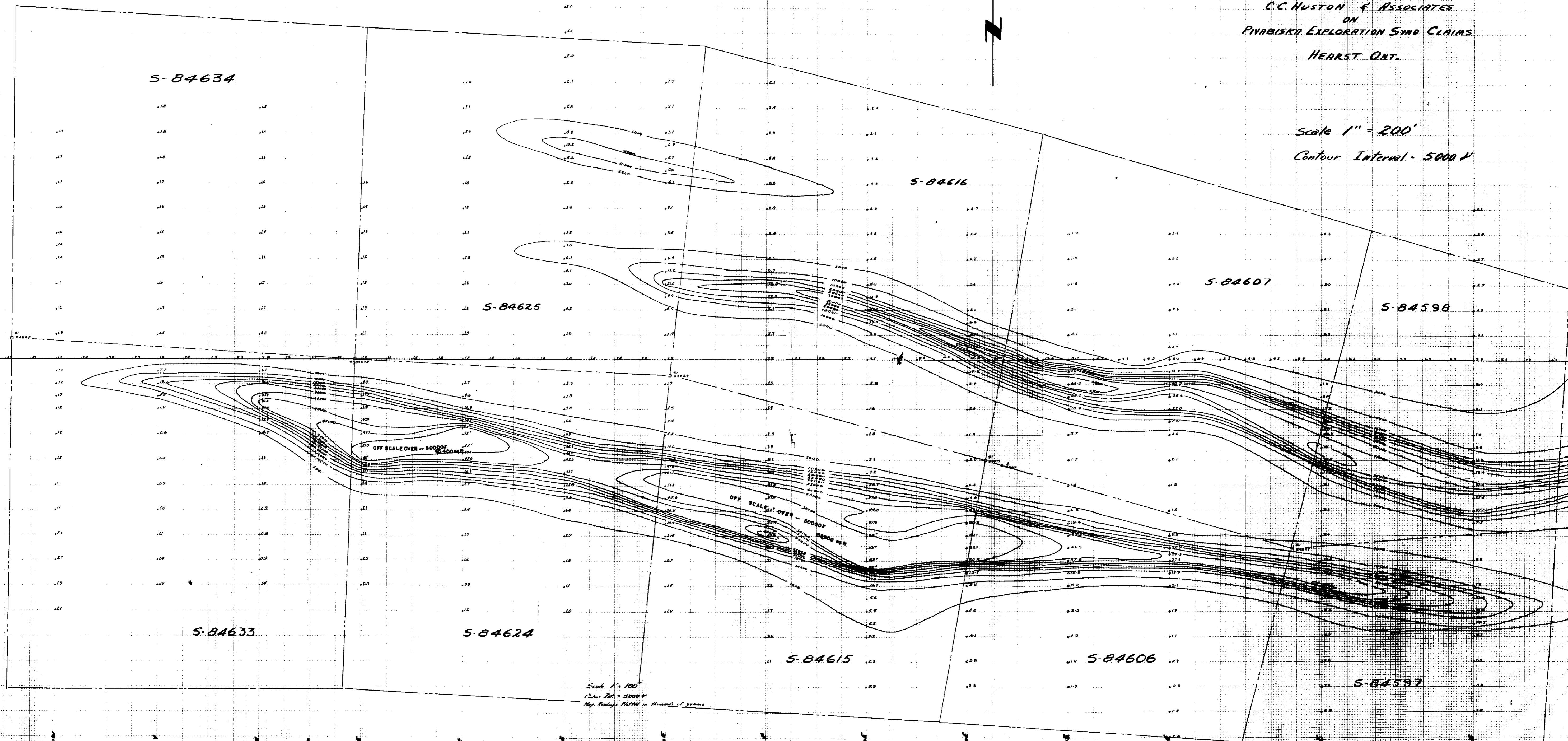

Scale 1" = 100'  
Cont. Int. = 5000 V  
Mag. Reduc'd. 10000 in Millions of gamma

