

010

### Diamond Drilling

Area 0'Sullivan Lake

Report N<sup>o</sup> 16

Work performed by: Sulmac Expl. Serv. Ltd.

Claim N <sup>o</sup>	Hole N <sup>o</sup>	Footage	Date	Note
KK 21001	26D-1	252'	Mar/59	
	26D-2	228'	Mar/59	
KK 20999	26D-3	248'	Mar/59	

Notes:

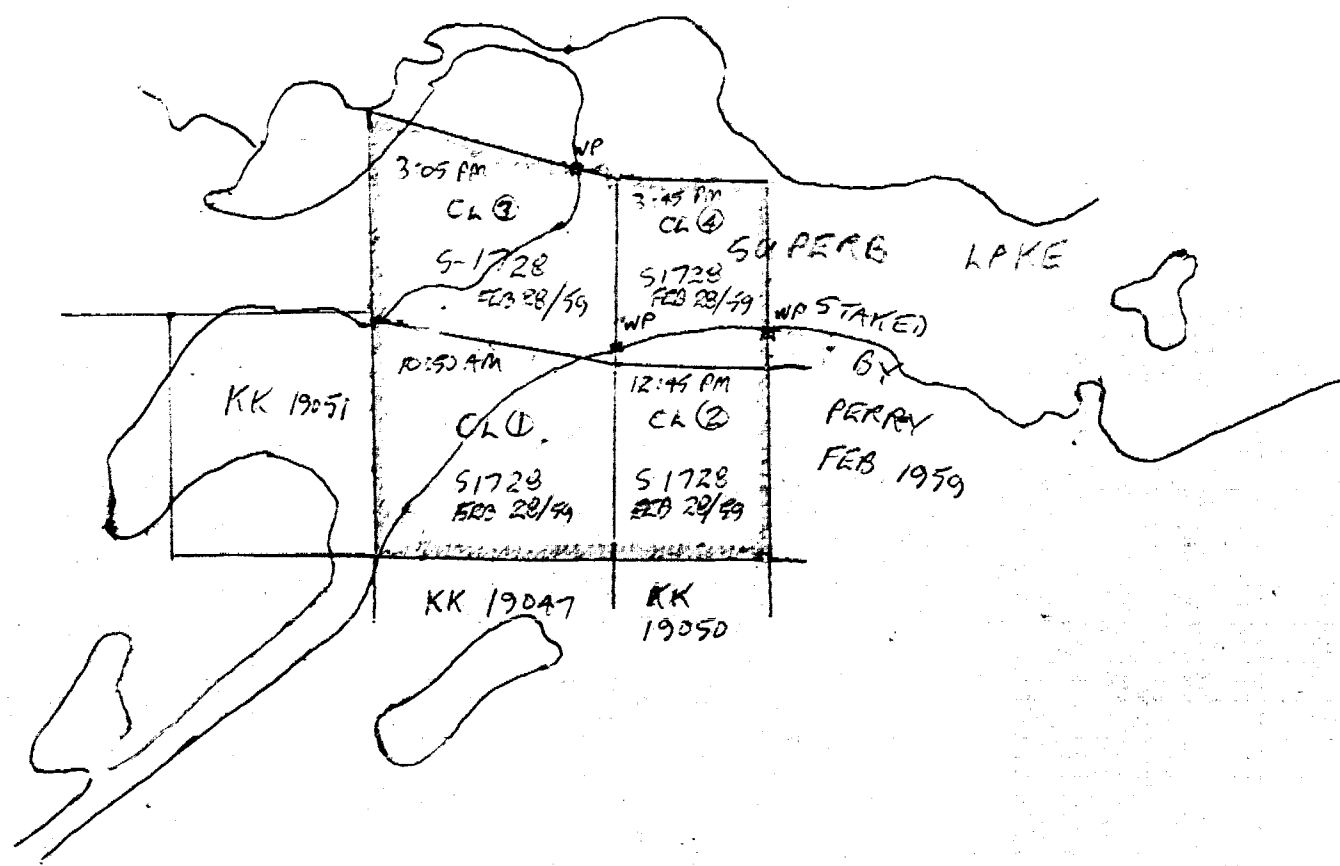

4 CLAIMS  
 STAKED BY K WUST LIC 51728  
 FEBRUARY 28, 1959  
 SUPERB LAKE  
 AREA OF D'SULLIVAN LAKE  
 KOWKASH MINING DIVISION  
 SCALE 1" = 20ch = 1320' APPROX

BORE HOLE LOCATION NO - 26D.1,2,3  
DIAGRAMATIC

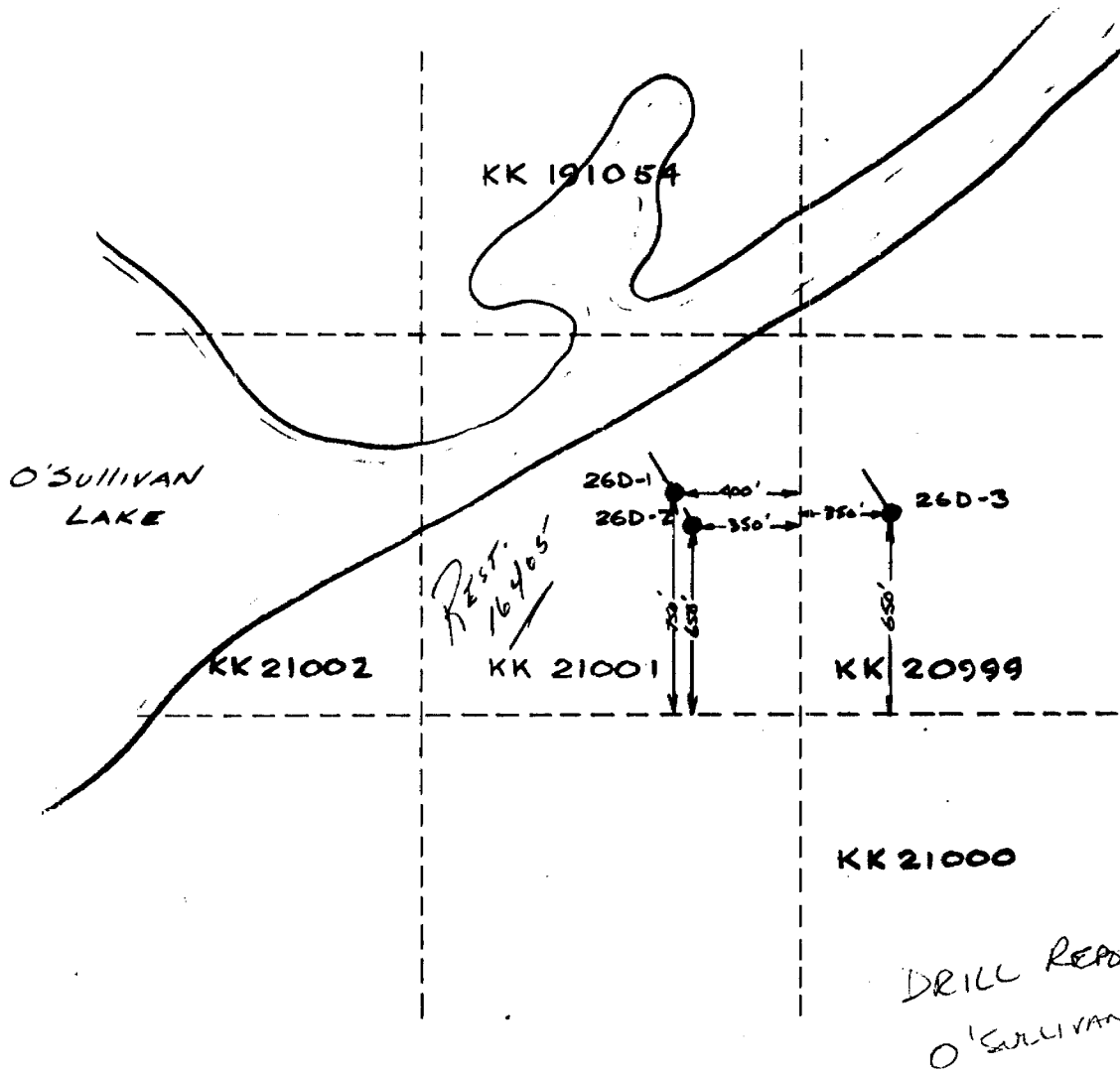

8-2-143

SULMAC EXPLORATION SERVICES LIMITED

KK21001

PROPERTY Polpond Mining Company

SAMPLING RECORD

SHEET NO. \_\_\_\_\_

HOLE NO. 26D-1 DEPTH 252 ANGLE -45 STRIKE N 20° W ELEVATION \_\_\_\_\_

4+00W

CO-ORDINATES

1+20E

DEPTH FEET	FORMATION	SAMPLE NO.	LENGTH FT.	ANALYSIS			LENGTH FEET	PROGRESSIVE TOTALS		
				Cu %	Mn %	%		FEET X PER CENT		
0	Surface									
25.0	Casing									
170.0	Sediments - strongly @ 40°-45° to core - slight contortion due to folding or shearing - garnets @ 52'-53' - overall very siliceous									
170.2	Graphite-massive - 2 inches wide @ 40° to core									
173.5	Sediments - same as 25.0 - 170.5									
174.5	Graphite - almost massive - massive sulphides Po, Py, minor chalcopyrite very narrow bands of siliceous sediments interbedded.	0239A	1.0	.15	.01					
177.0	Mineralized, fracture or sheared zone - 20% Pyrrhotite with a few specks of chalcopyrite and trace of pyrite	0238A	2.5	.15	.05					
252.0	Sediments - same as 25.0 - 170.0									
END OF HOLE 252.0'										
Midwest Diamond Drilling Company										
AK Core										
Drilled on claim #3										
licence 8-1728										
K. West										
March 7 1959										
KK 21001										













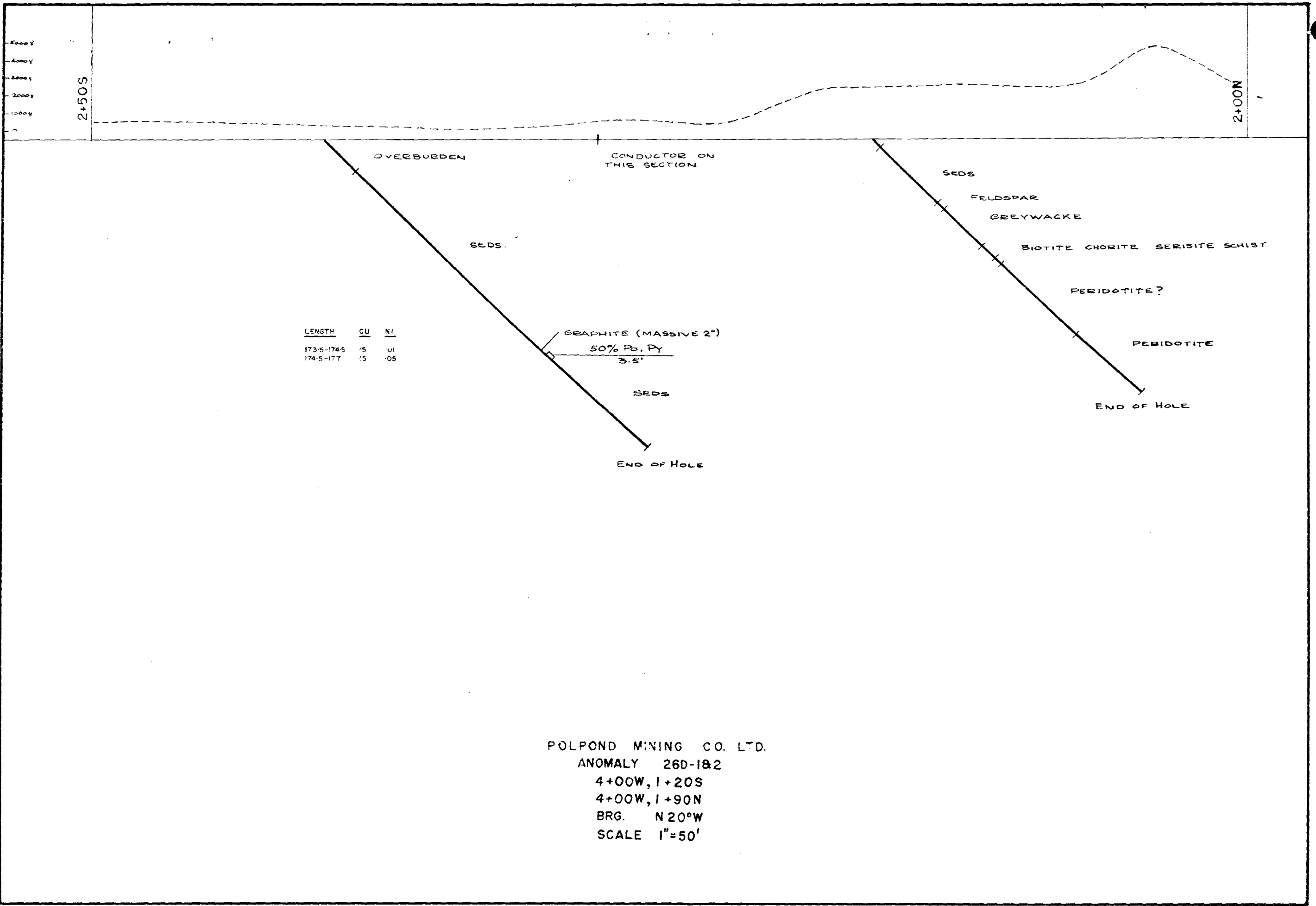

POLPOND MINING CO. LTD.  
 ANOMALY 260-182  
 4+00W, 1+20S  
 4+00W, 1+90N  
 BRG. N 20°W  
 SCALE 1"=50'