



43A03NW5003 W7006-00073 MUSGROVE

010

ONTARIO

THE MINING ACT REPORT OF WORK

Required type of work to be recorded. 1970. Mining Division

To the Recorder of Porcupine. Alcide Henri Dumoulin name of Recorded Holder. 22 Elm St. South; Timmins, Ont. Post Office Address. M 16440 Miner's Licence

do hereby report the performance of 464 days of TRENCING (PLUGGER) type of work

not before reported to be applied on the following contiguous claims

MUSGROVE TWI.

Table with columns: Claim No., Days, Claim No., Days, Claim No., Days. Includes handwritten entries for P. 97107, P. 97110, P. 97113 and handwritten notes like 'DUMOULIN 248 64 352'.

All the work was performed on Mining Claim (s) ... P. 97107, P. 97110, A. P. 97113. (In the case of geological and/or geophysical survey (s) where more than 10 claims are involved attach a schedule)

READ CAREFULLY: THE FOLLOWING INFORMATION IS REQUIRED BY THE MINING RECORDER.

- For Manual Work, Stripping or Opening up of Mines, Sinking Shafts or Other Actual Mining Operations - Names and addresses of the men who performed the work and the dates and hours of their employment.
For Diamond and other Core Drilling - Footage, No. and angle of holes and diameter of core. Name and address of owner or operator of drill. Dates when drilling was done. Signed core log and sketch in duplicate.
For Compressed Air or Other Power Driven or Mechanical Equipment Type of drill or equipment. Names and addresses of men engaged in operating equipment and the dates and hours of their employment.
For Power Stripping - Type of equipment. Name and address of owner or operator. Amount expended. Dates on which work was done. Proof of actual cost must be submitted within 30 days of recording.
With each of the above types of work sketches are required to show the location and extent of the work in relation to the nearest claim post. In the case of diamond or other core drilling the sketch must be submitted in duplicate.
For Geological and Geophysical Survey - The names and addresses of men employed as well as dates. Type of instrument used in the case of geophysical survey. Reports and maps in duplicate must be filed with the Recorder within 60 days of recording.
For Land Survey - the name and address of Ontario Land surveyor.

The Required Information is as Follows: (Attach a list if this space is insufficient)

TRENCING (Plugger):- Refer to attached SCHEDULE "A" for details.

Summary table: Mining Claim No. P. 97107 48 days, P. 97110 352, P. 97113 64, Total: 464 days

Date March 30, 1970

Signature of Recorded Holder or Agent A.H. Dumoulin

The Mining Act Certificate Verifying Report of Work

Norman C. Lawson Timmins, Ont. (Post Office Address)

RECORDED APR 29 1970 Receipt No.

hereby certify:

1. That I have a personal and intimate knowledge of the facts set forth in the report of work annexed hereto, having performed the work or witnessed same during and/or after its completion.

report is true.

RECEIVED MAR 31 1970 stamp

1970

Signature of Norman C. Lawson

Norman C. Lawson

THE PENALTY FOR MAKING A FALSE STATEMENT IN THIS REPORT IS FIVE DOLLARS PER MONTHS IMPROPERLY REPORTED OR BOTH



MUSGROVE TOWNSHIP, ONTARIO PROPERTY;
A.H. Dumoulin; Miner's License M 16440;

Timmins, Ont.
 March 30, 1970

SCHEDULE "A" (Pioneer Work):- to be attached to THE MINING ACT REPORT OF WORK.

		<u>Assessment Work</u>
		<u>Days</u>
1. <u>Miner's Claim No. P. 97107</u>		
J. Lambert:	Sept. 20-25/69; 6 days x 12 hrs/day x 1 man-day/3 hrs	24 ✓
R. Gauthier:	Sept. 20-25/69; 6 days " "	24 ✓
Sub Total:		48 ✓
2. <u>Miner's Claim No. P. 97110</u>		
J. Lambert:	Sept. 26-30/69; 5 days x 12 hrs/day x 1 man-day/3 hrs	20 ✓
R. Gauthier:	Sept. 26-30/69; 5 days " "	20 ✓
A. Dumoulin:	Oct. 5-30/69; 26 days " "	104 ✓
M.C. Lawson:	Oct. 5-30/69; 26 days " "	104 ✓
E. Larose:	Oct. 5-22/69; 18 days " "	72 ✓
J. Roy:	Oct. 15-22/69; 8 days " "	32 ✓
Sub Total:		352 ✓
3. <u>Miner's Claim No. P. 97113</u>		
E. Larose:	Oct. 23-30/69; 8 days x 12 hrs/day x 1 man-day/3 hrs	32 ✓
J. Roy:	Oct. 23-30/69; 8 days " "	32 ✓
Sub Total:		64 ✓

ADDRESSES:

J. Lambert: 2908 Patricia Blvd.; Timmins, Ont.
 R. Gauthier: 299 Teke St.; Timmins, Ont.
 A.H. Dumoulin: 22 Elm St. South; Timmins, Ont.
 M.C. Lawson: 566 Bartlemen; Timmins, Ont.
 E. Larose: Kirkland Lake, Ont.
 J. Roy: 1631 Riverside Drive; Mountjoy Township, Ont.

A.H. Dumoulin

MUSGROVE TOWNSHIP, ONTARIO
 Porcupine Mining Division

GEOLOGICAL SKETCH PLAN
A. H. DUMOULIN MOLYBDENITE PROSPECT

Showing "B" Area

LOCATION OF TRENCHES B-1 to 5

Scale: 1 inch = 40 feet

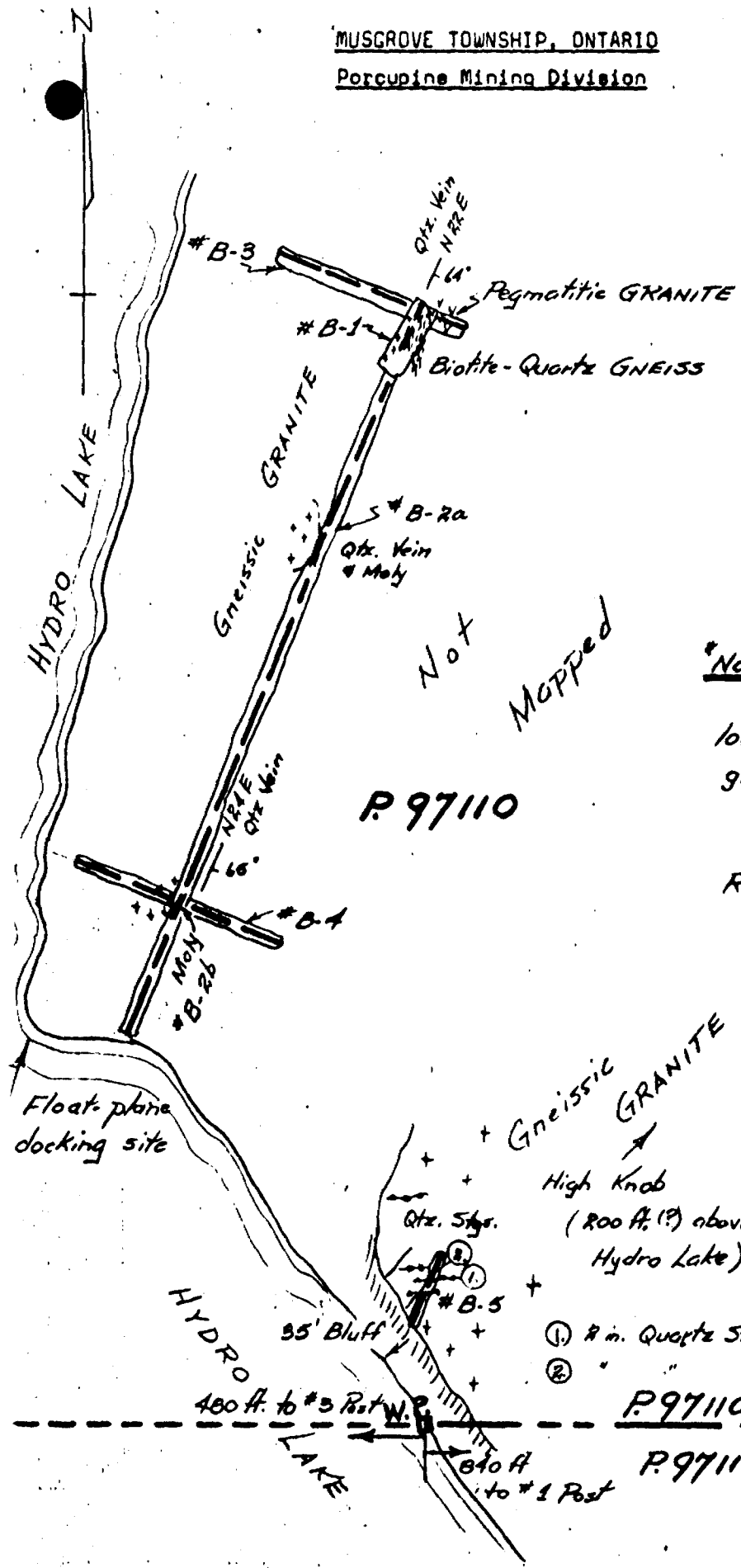
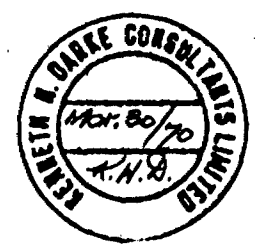

Note: All distances shown are pace & compass; location of Trenches B-3, 4 & 5 given by A. H. Dumoulin, Mar. /70

Rock Ridges

LEGEND

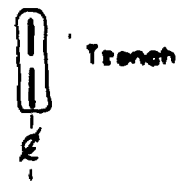

- ① 2 in. Quartz Stringer @ N 49 W / Vertical; Moly. & Py
- ② " " " @ N 49 W / Vertical; barren

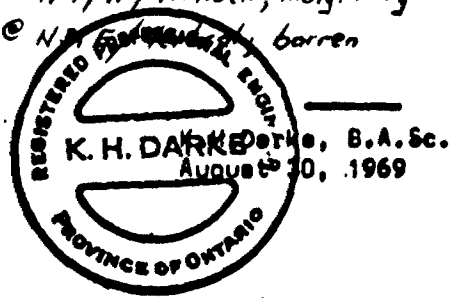

P. 97110

NOT EXAMINED
TO NORTH

MUSGROVE TOWNSHIP, ONTARIO

Porcupine Mining Division

A.H. Dumoulin Mo-Bi Prospect

Geological Sketch & Sample Plan

Scale: 1 inch = 40 feet

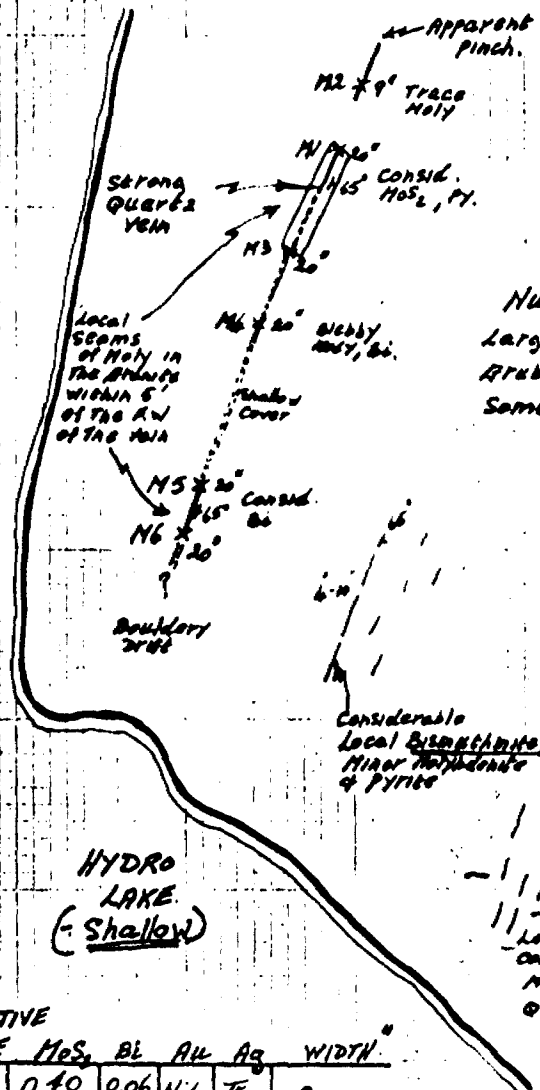

Numerous extensive stannic outcrops largely obscured in detail by lignite. Limited grubbing revealed local lensy quartz stringers, some well mineralized with Py, Si, Mo.

In general, mineralization is more prolific to the west, and the lake may hide economic deposits.

Strike trend 22°
Dip trend 65° E

REPRESENTATIVE

SAMPLE	MoS ₂	Bi	Pb	Ag	WIDTH"
M1	0.40	0.06	Nil	Tr.	20
M2	0.01	0.005	Nil	Tr.	9
M3	0.14	0.05	.005	Nil	20
M4	0.14	0.15	Nil	Nil	20
M5	0.06	0.26	.005	Tr.	20
M6	0.11	0.08	Nil	Nil	20

(SAMPLE WEIGHTS ≈ 10 lbs. EACH)

P. 97110

P. 97113

MUSGROVE TWP.
DUMOULIN MO-BI
PROSPECT

Scale 1" = 40'
Sept. 25 '69

R.J. Graham

Geophysical Engineering Services
(Keveil Mining Group)

A. DUMOULIN
MOLYBDENITE PROSPECT
MUSGROVE TWP.

MUSGROVE TOWNSHIP, ONTARIO

Porcupine Mining Division

GROUP SKETCH

Scale: 1 inch = 660 feet

NOT TO BE USED FOR MORE THAN 18 CLAIMS

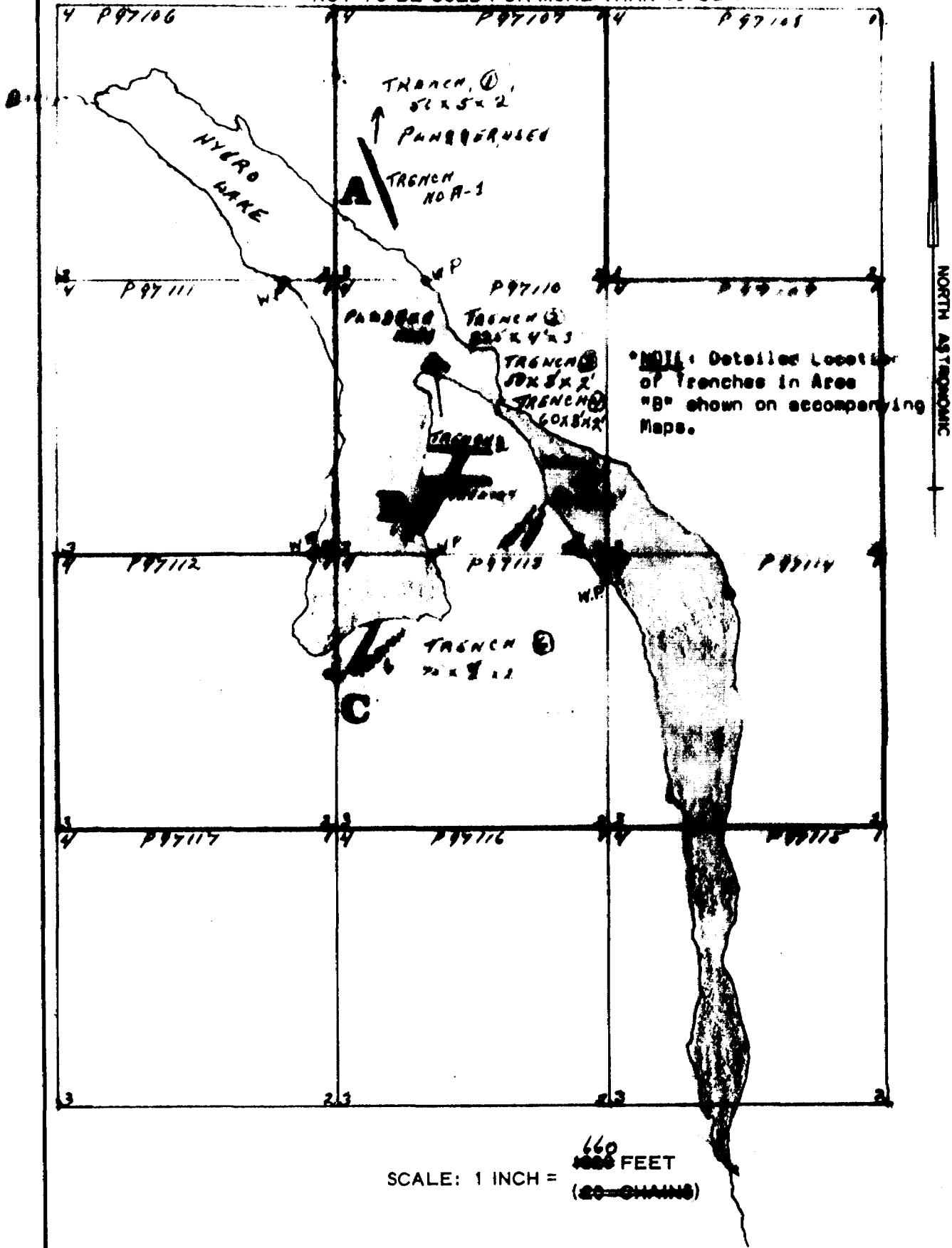

*NOTE: Detailed Location of Trenches in Area "B" shown on accompanying Maps.

SHOW ALL CLAIM LINES, POSTS, DISTANCE BETWEEN POSTS, TIE ONS, WATER, WITNESS DISTANCES, HYDRO LINES, ROADS, RAILROADS, BUILDINGS, THAT ARE APPLICABLE.

March 30/70
DATE

Morrison Lawson
SIGNATURE
Morrison C. Lawson
Agent, A.H. Dumoulin