



S2A05SE0029 15 SCOBLE

010

Diamond Drilling

Township of Scoble

Report N^o: 15

Work performed by: Nanglora Mining and Exploration Co. Ltd.

Claim N ^o	Hole N ^o	Footage	Date	Note
TB 64759	3	602'	Sept/55	
TB 42881	4	245'	Sept/55	

Notes:

Diamond Drilling

Township of *Seoble*

Report No: 15

Work performed by: *Nangora Mining and Exploration Co. Ltd.*

Claim No	Hole No	Footage	Date	Note
<i>TB 64759</i>	<i>3</i>	<i>602'</i>	<i>Sept/55</i>	
<i>TB 42881</i>	<i>4</i>	<i>245'</i>	<i>Sept/55</i>	

Notes:

B 42881 & TB 64759

DIAMOND DRILL LOG

4-2-41

COLLAR:-

~~XX~~ 200' S 40° W of zero on B.L.

502' N 50° W of B.L.

ELEVATION

AZIMUTH Bearing S 50° E

DIP TEST		
FOOTAGE	ANGLE	
	READING	CORRECTED
0	0	
	50	

PROPERTY Nanglora Mining & Exploration Co.Ltd.
 HOLE NO. 3
 COMMENCED Sept. 20, 1955
 FINISHED Sept. 29, 1955
 PURPOSE OF HOLE Test of Main & Junior Veins
 LOGGED BY: P.S. Broadhurst

N.M.P.

FOOTAGE	DESCRIPTION	CORE SAMPLES											
		SAMPLE NO.	FROM	TO	WIDTH	ASSAY	WIDTH X ASSAY	SAMPLE NO.	FROM	TO	ASSAY		
0 - 35	Casing												
35 - 132.6	Diabase - Calcite vein between 61.3 - 63.2 no mineralization												
132.6 - 572.2	Slate - Typical fine grained black coloured with bands of lighter coloured material. 560.2 - 572.2 calcite vein. Minor pyrite 425.2 - 428.4 calcite vein with consid- erable brecciation.												
572.2 - 602	Iron formation -												
	End of hole.												

Thomas Walker

MAGNETIC NORTH

TB 42881

TB 64759

TB 9920

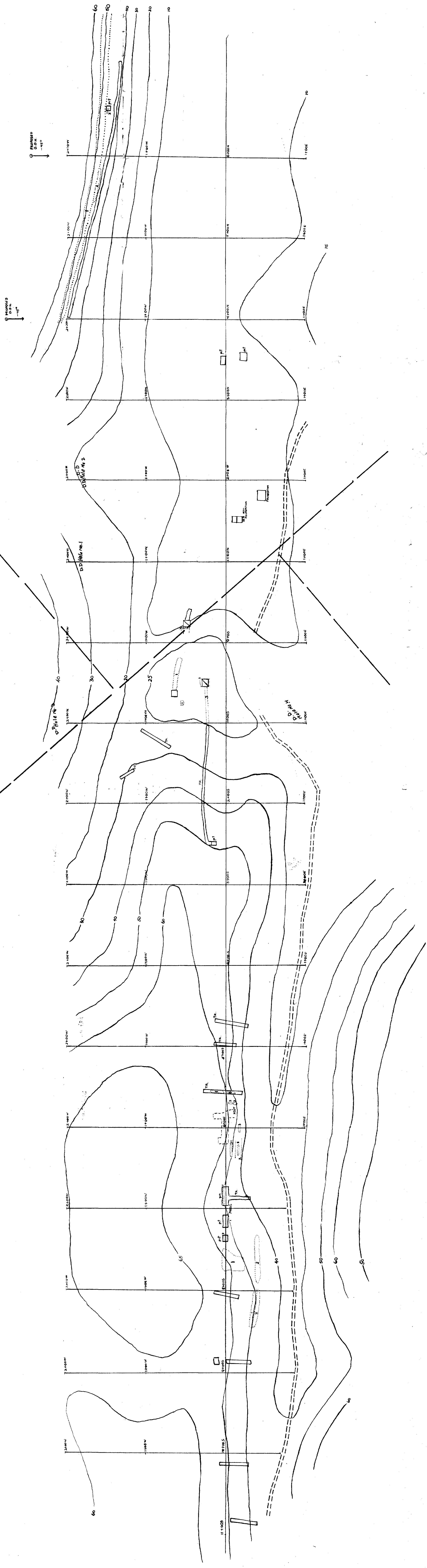

Exploration
 NANGLORA MINING AND DEVELOPMENT CO. LTD.
 RABBIT MOUNTAIN PROPERTY
 SURFACE PLAN
 SCALE : 1 IN = 40 FT.
 JULY 30, 1955

LEGEND

DIABASE	1
SLATE	2
VEIN	3

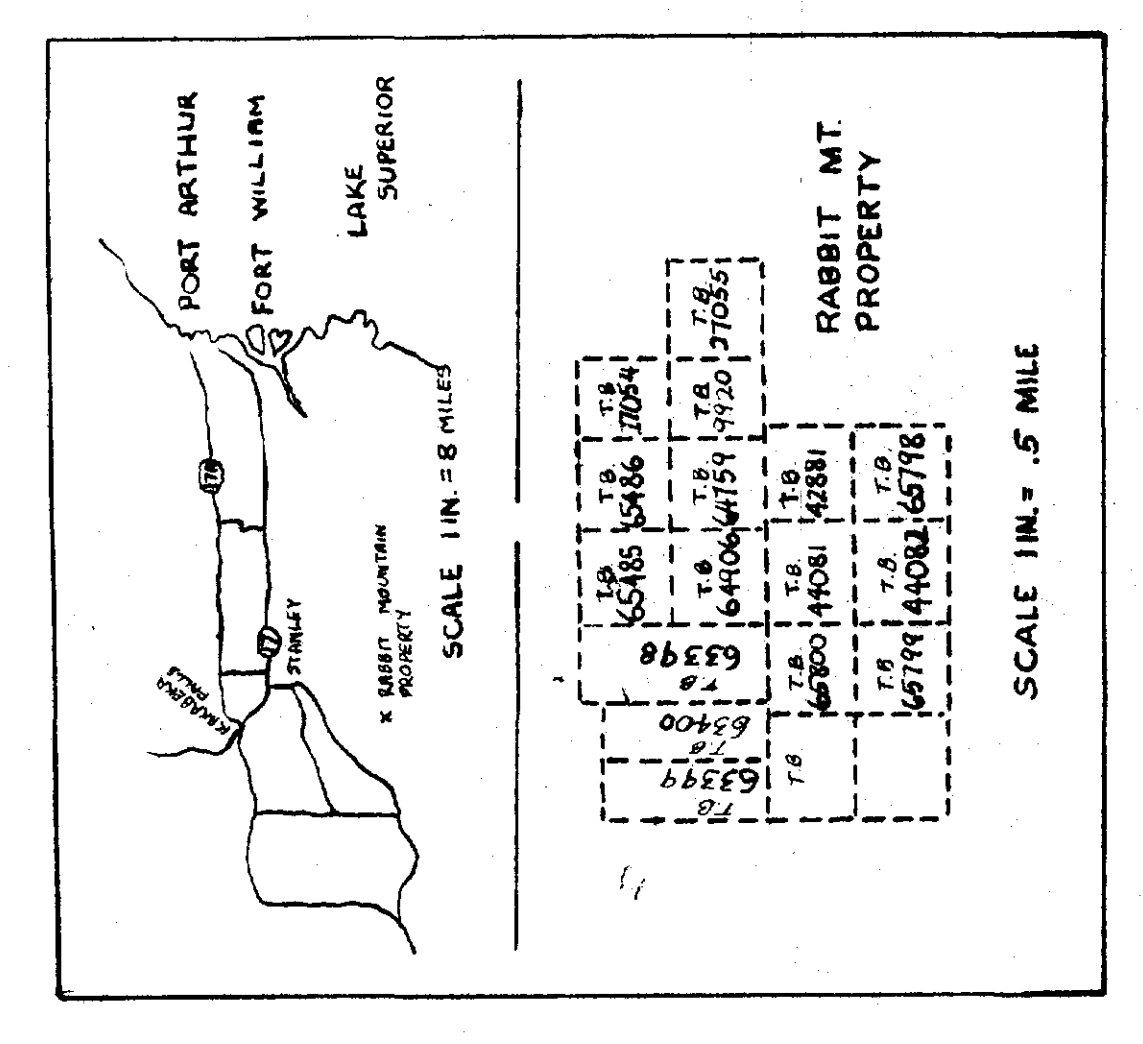

KEY MAP

