



52A10NE2001 OP93-290 MCTAVISH

010

1

OPAP I993 FINAL REPORT  
STARLIGHT AMETHYST PROPERTY  
McTAVISH TWP..  
THUNDER BAY ONTARIO  
FILE # OP93 290

DOUGLAS THIBAUT

PROJECT LOCATION:

The property is located approximately 50 kilometres east of Thunder Bay, Ontario. The centre of the property is located at Latitude 48 40' 10" and Longitude 88 39'45" in McTavish Twp; Concession IV, southwest 1/4 of the south half of Lot A on NTS Sheet 52-A-10.

Access to the property from Thunder Bay is via the Trans Canada Highway II-I7 travelling east towards Nipigon for 48 Kilometres and turning south onto the old Dorion Mine Road towards the Ontario Gem Mine. Approximately a kilometre down this road the road spits in two with the left branch going to the Mine and the right branch onto the pipeline right-of-way towards the property. Follow the pipeline right-of-way for approximately two kilometres to the claim boundary.

PROPERTY DESCRIPTION:

The property consists of a single unpatented mining claim of 16 ha. and is located in the Thunder Bay Mining Division.

<u>CLAIM NO.</u>	<u>MINING DIVISION</u>	<u>CLAIM MAP SHET</u>	<u>RECORDED</u>
II9475I	Thunder Bay	McTavish Twp.	G-675 Dec. 22, 1992

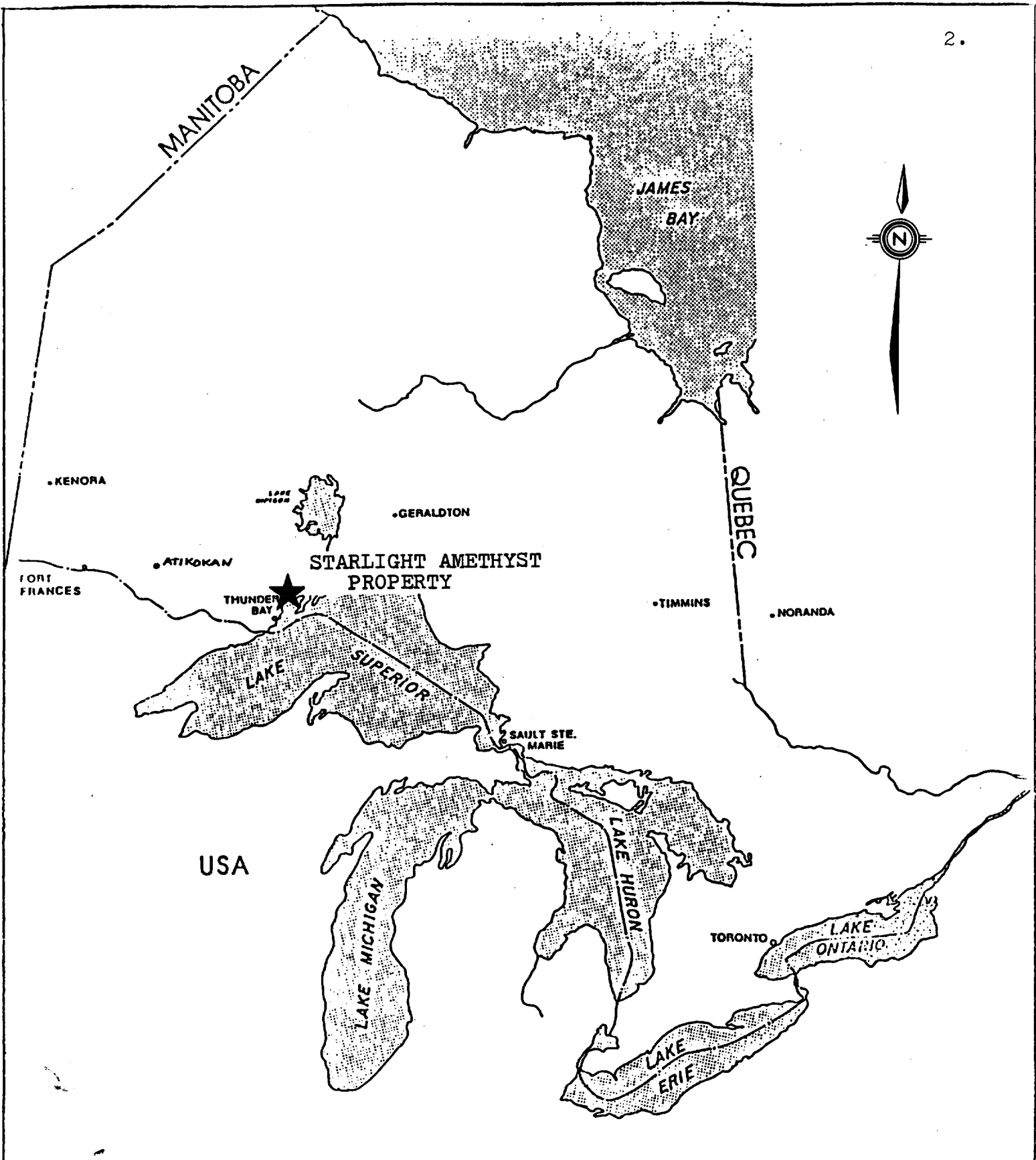

REGIONAL LOCATION MAP

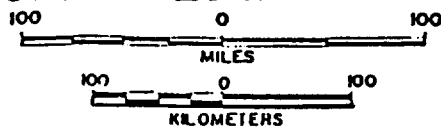

FIGURE 1

PHASE I

Phase I began with traversing east, west and south of claim II9475I. Traveling through this area was quite time consuming and difficult. The underbrush was very thick and sometimes impossible to get through. Because the overburden was very thick, very little outcrop was seen. Some float of sandstone, and mudstone was noticed south west on the pipe line. On the south east corner of claim II9475I an outcrop of sandstone with pegmatite stringers were encountered. East of the north east corner of the claim II9475I pink granite bluffs flow north easterly with a mudstone, sandstone contact on the southerly side. Detailed mapping of claim II9475I uncovered old pits just west of the east boundary of the claim', on the contact between the granite and mudstone. The contact between the northerly granites and the southerly mudstone runs 60 degrees east and 240 degrees west cutting the claim 50 meters east of # 3 post, and 75 meters south of # I post. North of the claim II9475I was visited by this writer late in the fall of 1992. Massive pink granite covers the area with minor stringers of amyethst veins, too small to be of any significant,

PHASE 2

Phase 2 began with pumping out the old shallow pits. Trenching was done by plugger, dynamite and man power. The trench was increased considerably, and the width of the amyethst vein increased at depth. The vein is made up of amyethst, galena, sphalerite, calcite, and barite with inclusions of Sibley mudstone. Chalcopyrite was also observed. The amyethst itself ranges in color from a light blue to a dark purple. Black amyethst is also present. 20,000 square feet of mechanical stipping by a D6 was carried out surrounding the trench. This uncovered another 50 more feet of amyethst veining to the east. Old pits located while detail mapping of the claim, also shows good quality dark purple amyethst. With some work we were able to link the two showings together, thus giving us a strike length between 375 to 400 feet.

CONCLUSION

The vein on the average is about  $3\frac{1}{2}$  to 9 feet wide, narrow in standurds to other amyethst mines in the area. Never the less it's quality and quantity is sufficient enough for a small scale amyethst operation, which I will persue in the spring of 1994, creating I or 2 part time jobs.

Without the OPAP program this would not be possible. I beleave that the OPAP program is a great help to the pros pecter, and will continue on.

One's again my thanks to you and all for the 1993 OPAP GRANT.

Yours truly

*Douglas Hubbard*

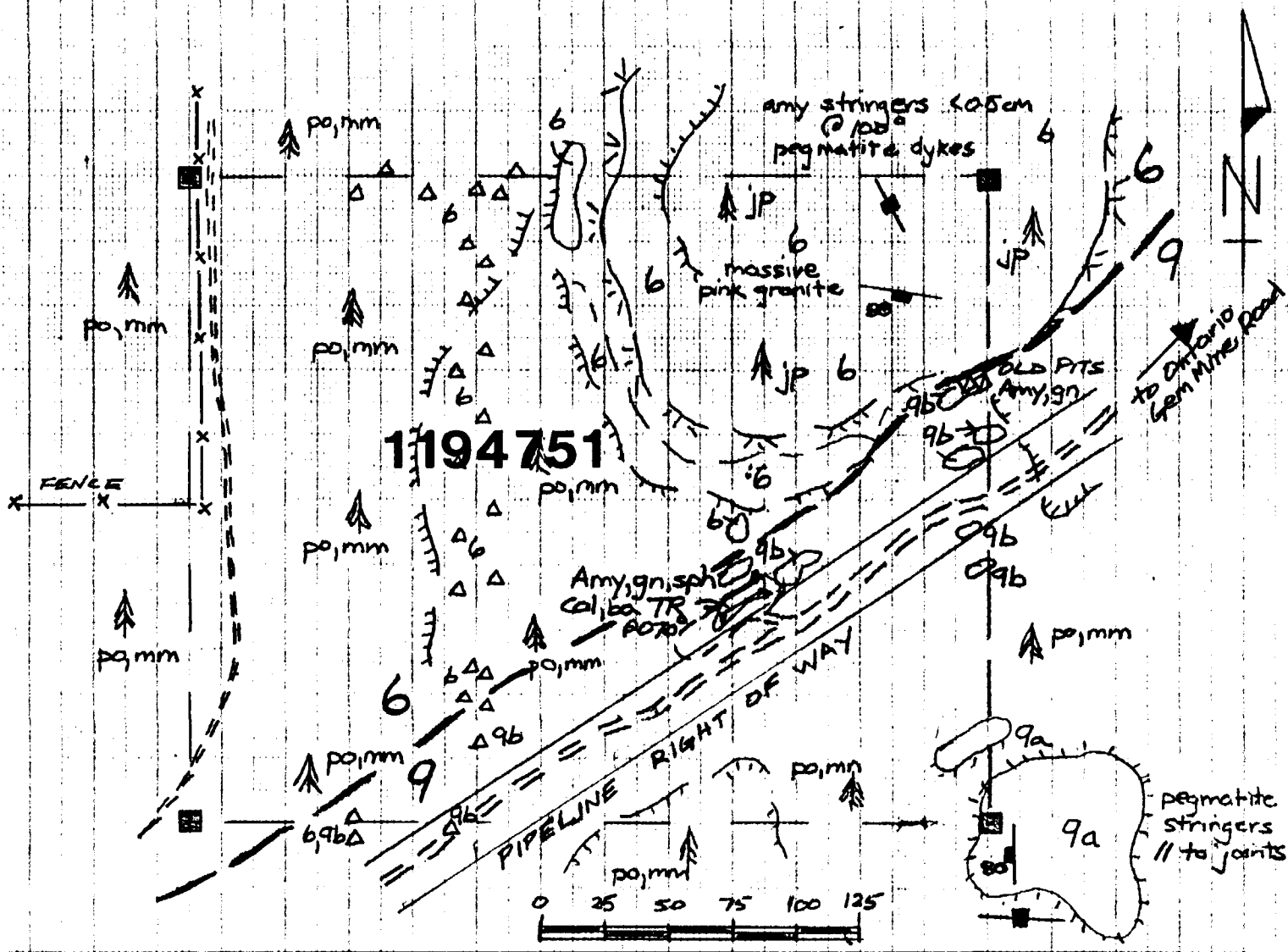

## LEGEND

### SIBLEY GROUP

- 9 9a SANDSTONE
- 9 9b MUDSTONE

### UNCONFORMITY

- 6 PINK GRANITE

### ABBREVIATIONS

- Amy Amyethst
- gn Galena
- sph Sphalerite
- cal calcite
- ba barite

- TRENCH
- PIT
- OUTCROP
- JOINT (INCLINED, VERTICAL)

### MATAVISH TWP.

### STARLIGHT AMETHYST PROPERTY GEOLOGY MAP

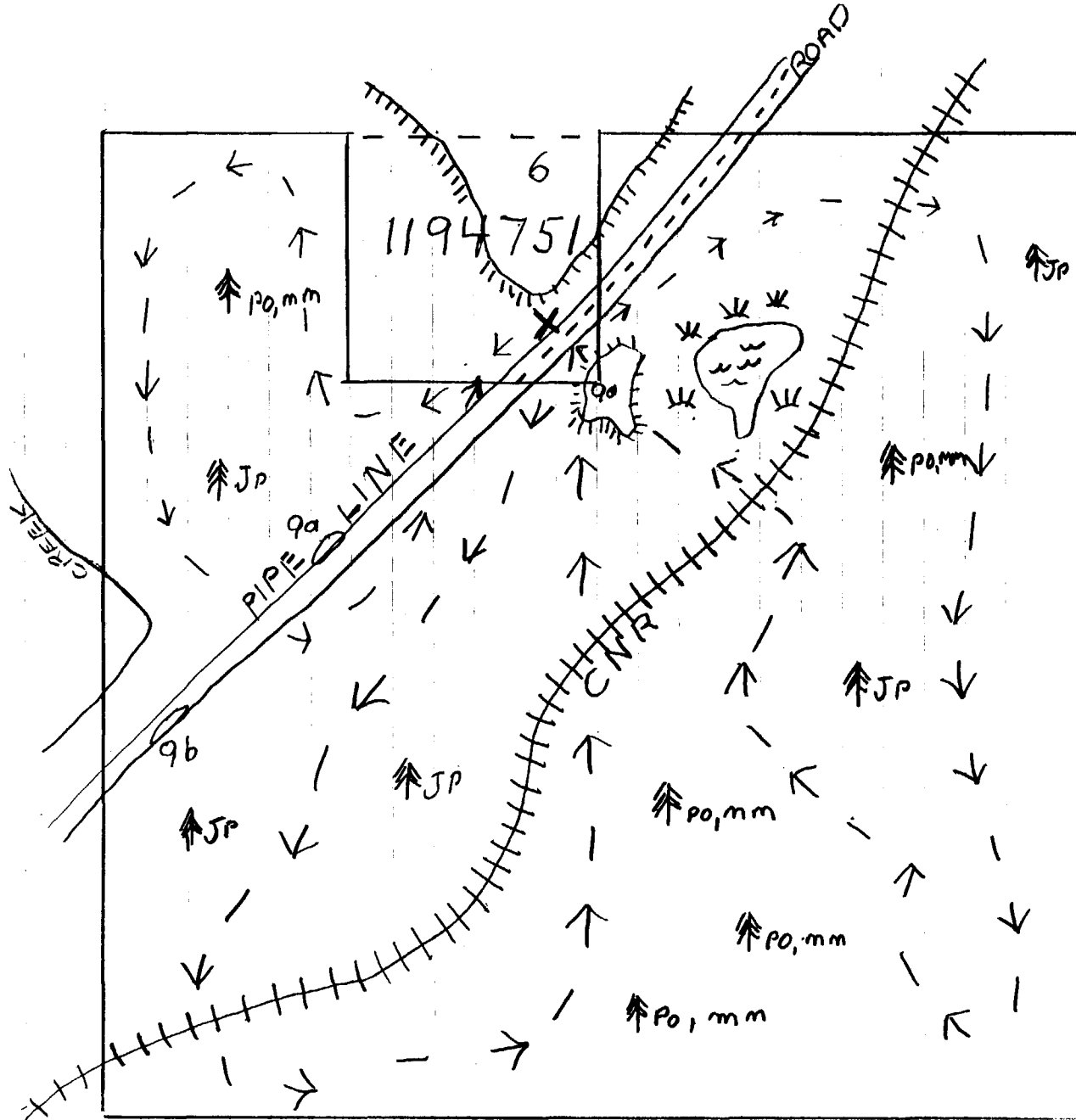

- ### LEGEND
- 9 9a SANDSTONE  
9b MUDSTONE
  - 6 PINK GRANITE
  - TRAVERSE LINE
  - ⋈ SWAMP
  - W WATER
  - ☀ OUTCROP
  - FLOAT
  - ✕ STARTING POINT
  - 🌲 TREES
- McTAVISH  
TWP.

STARLIGHT  
AMETHYST PROPERTY  
1194751

1 1/2 IN. TO 1/4 MILE

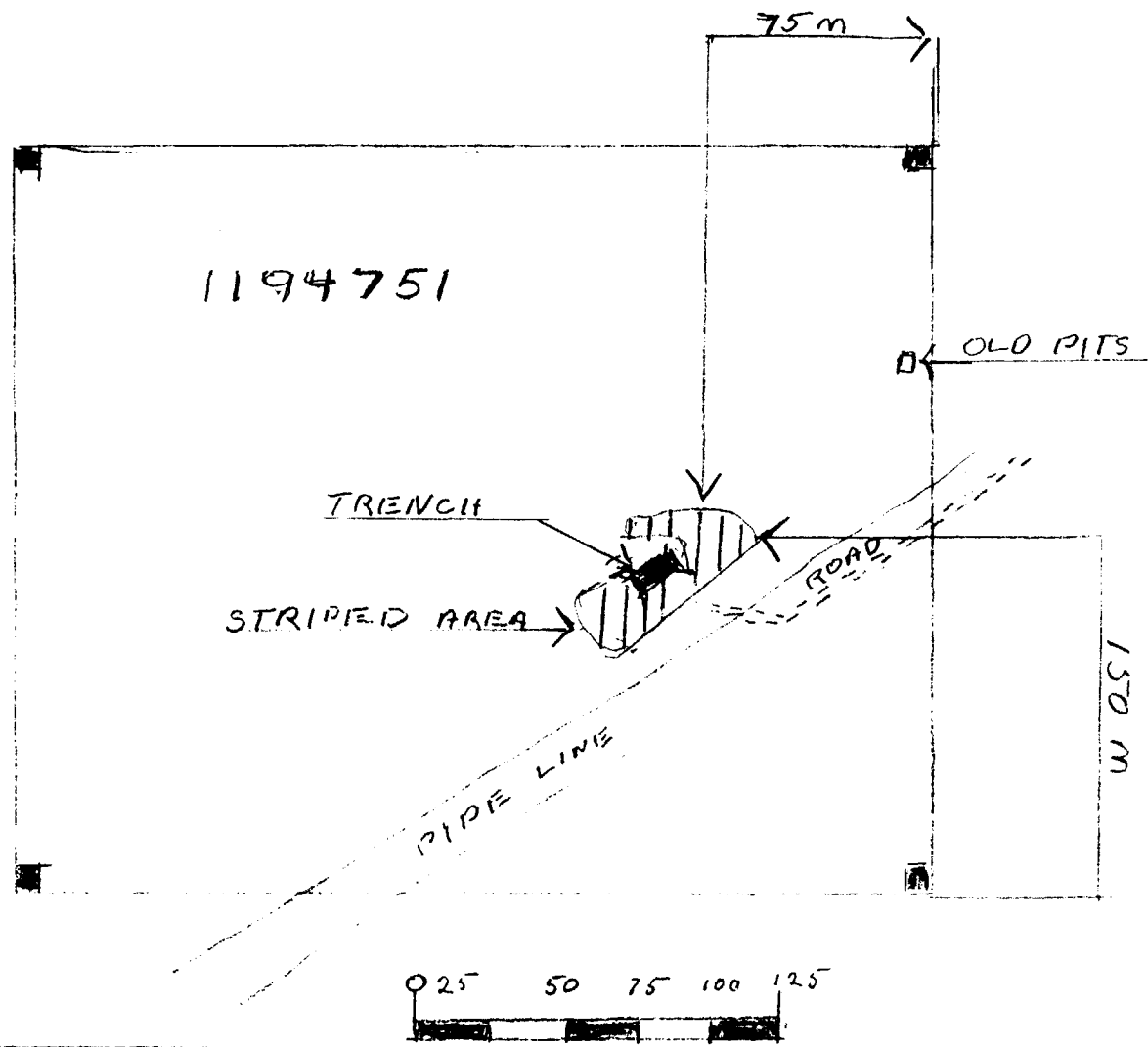

McTAVISH Twp.

STARLIGHT

AMETHYST

TRENCH LOCATION  
MAP



1194751

Location of Stripping  
AND Trenching

TRENCH 9' X 20' X 6' DEEP

MECHANICAL STRIPPING

20000 SQUARE FEET

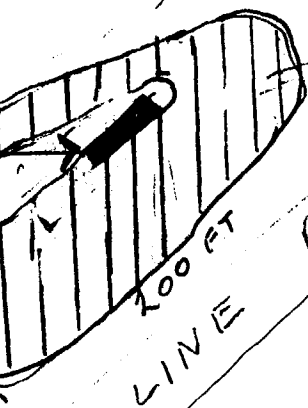

100 FT  
200 FT  
PIPE LINE  
RIGHT OF WAY



REFERENCES

DRAWN FROM DISPOSITION:  
 RIGHTS MR. MINING RIGHTS  
 Date Disposition File  
 WNE 16/83 S.R.O. A: DRAWN  
 BY: IN REG. PENDING UNDER SECTION 318  
 OF THE R.S.O. 1980

SAND AND GRAVEL  
 C/2472 FILE 109061  
 NTC PIT N° CE - 26 FILE 09063  
 GRAVEL FILE 21379  
 34756  
 106372  
 MTC PIT A9 635  
 C/2472 FILE 109061  
 NTC PIT N° CE - 26 FILE 09063  
 GRAVEL FILE 21379  
 34756  
 106372  
 MTC PIT A9 635  
 C/2472 FILE 109061  
 NTC PIT N° CE - 26 FILE 09063  
 GRAVEL FILE 21379  
 34756  
 106372  
 MTC PIT A9 635

THE SURFACE RIGHTS LYING WITHIN 40.25 m OF THE CENTER LINE OF THE TRANS CANADA PIPELINE RIGHT OF WAY ARE WITHDRAWN FROM STAKING OUT PROSPECTING, SALE OR LEASE BY ORDER W 0191/ONT. DATED SEPT. 20, 1991. SECTION 112 OF THE NATIONAL ENERGY ACT APPLIES TO THIS AREA.

THE INFORMATION THAT APPEARS ON THIS MAP HAS BEEN COMPILED FROM VARIOUS SOURCES AND ACCURACY IS NOT GUARANTEED. THOSE WISHING TO STAKE MINING CLAIMS SHOULD CONSULT WITH THE MINING RECORDER, MINISTRY OF NORTHERN DEVELOPMENT AND MINES FOR ADDITIONAL INFORMATION ON THE STATUS OF THE LANDS SHOWN HEREON.

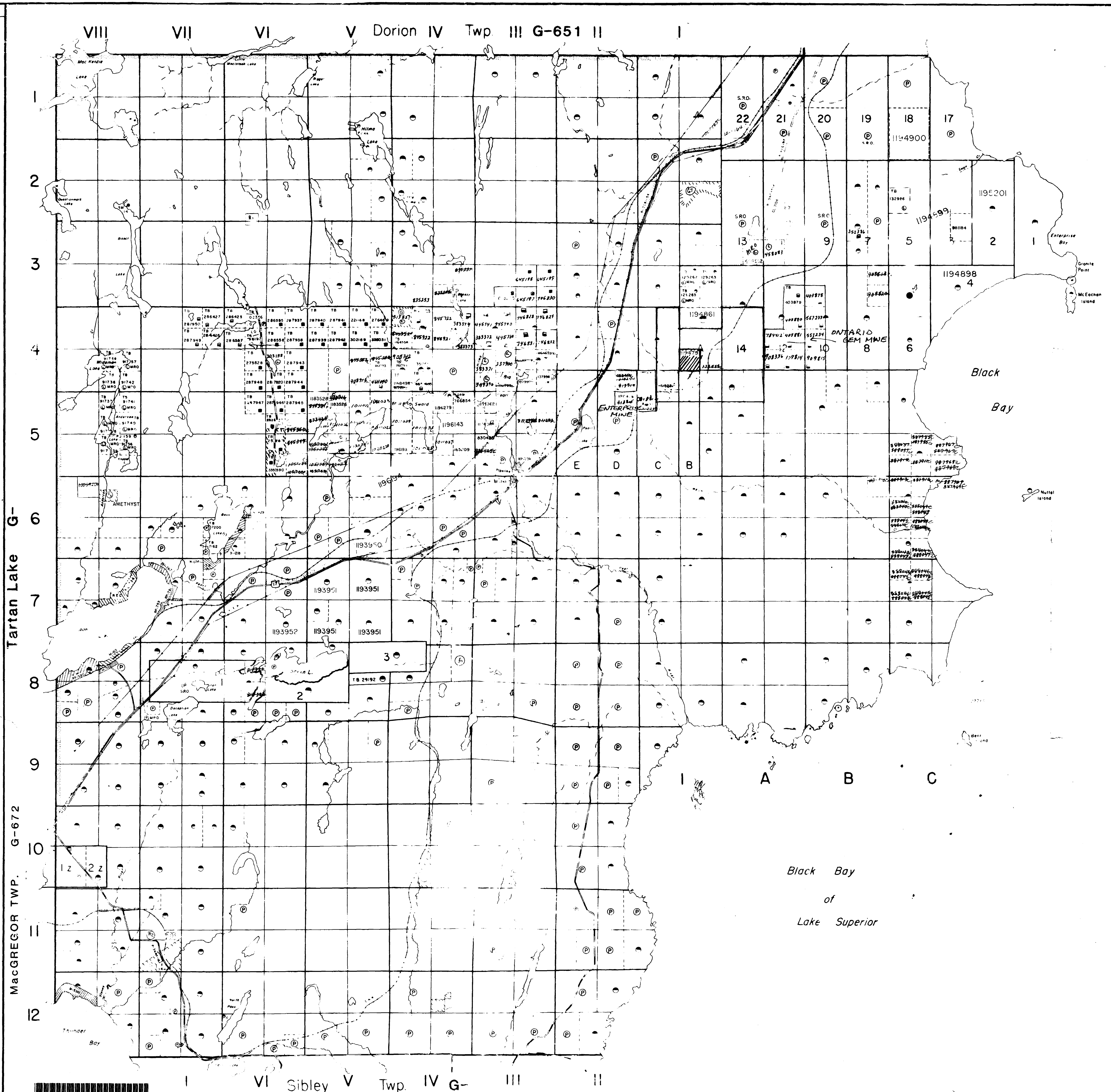

REFEREN

LAND UNDER WATER OF LAKE SUPERIOR WITHDRAWN FROM STAKING BY ORDER IN COUNCIL DATED SEP 1, 1991  
 AREA SHOWN THIS SUBJECT OF THE MINING ACT 1970  
 DAM AND PIPELINE SHOWN IN SECTION 112 OF THE PATENTED SURFACE RIGHTS OF THE

**LEGEND**

MINISTRY AND ROUTE No	---
ROADS	---
TRAILS	---
SURVEYED LINES	---
TOWNSHIP, BACE LINES, ETC	---
LOTS, MINING CLAIMS, PARCELS ETC	---
UNSURVEYED LINES	---
LOT LINES	---
PARCEL BOUNDARY	---
MINING CLAIMS ETC	---
RAILWAY AND RIGHT OF WAY	---
UTILITY LINES	---
NON PERENNIAL STREAM	---
FLOODING OR FLOODING RIGHTS	---
SUBDIVISION OR COMPOSITE PLAN	---
RESERVATIONS	---
ORIGINAL SHORELINE	---
MARSH OR MUSKEG	---
MINES	---
TRAVERSE MONUMENT	---

**DISPOSITION OF CROWN LANDS**

TYPE OF DOCUMENT	SYMBOL
PATENT, SURFACE & MINING RIGHTS	●
SURFACE RIGHTS ONLY	○
MINING RIGHTS ONLY	○
LEASE SURFACE & MINING RIGHTS	○
SURFACE RIGHTS ONLY	○
MINING RIGHTS ONLY	○
LICENCE OF OCCUPATION	○
ORDER IN COUNCIL	○
RESERVATION	○
CANCELLED	○
SAND & GRAVEL	○
LAND USE PERMITTED FOR COMMERCIAL TOURISM ONLY	○

NOTE: MINING RIGHTS IN PARCELS PATENTED PRIOR TO 1970, WHICH WERE IN ORIGINAL PATENTS BY THE PATENT ACT R.S.O. 1970 CHAP 300 SEC 43, ARE NOT

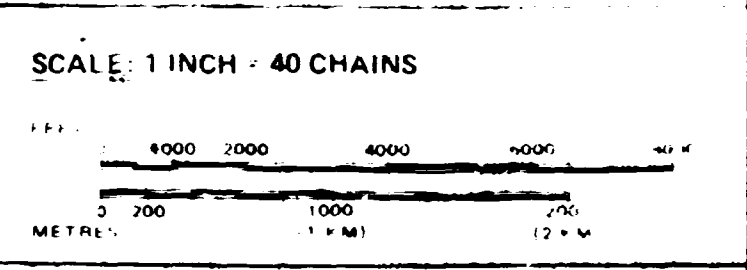

**TOWNSHIP**  
**McTAVISH**  
 M.N.R. ADMINISTRATIVE DISTRICT  
**THUNDER BAY**  
 MINING DIVISION  
**THUNDER BAY**  
 LAND TITLES / REGISTRY DIVISION  
**THUNDER BAY**

Ministry of Natural Resources  
 Land Management Branch  
 Ontario  
 1986  
**G-672**

