

Cover Page 2.24488

Declaration of Assessment Work for Claim #  
1247005

By C W Anderson Client # 102313

Page 1 Declaration of Assessment Work

Page 2 Statement of Costs

Page 3 Schedule for Declaration of Assessment  
Work on Mining Levels

Page 4 Map of Amcliff occurrence

Page 5 Location of claim

Page 6 Dimensions of area stripped

Page 7 Report on stripping

C W Anderson

5/11/02

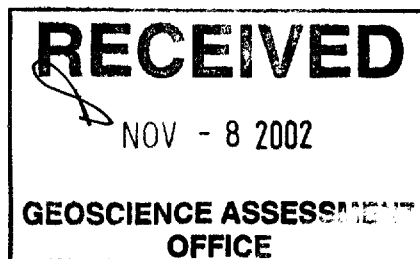
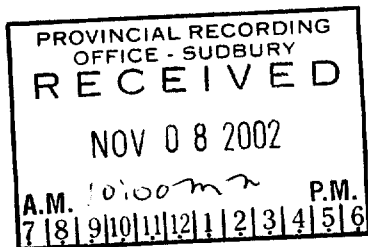

010

52A10NE2012 2.24488 MCTAVISH

Pg 4

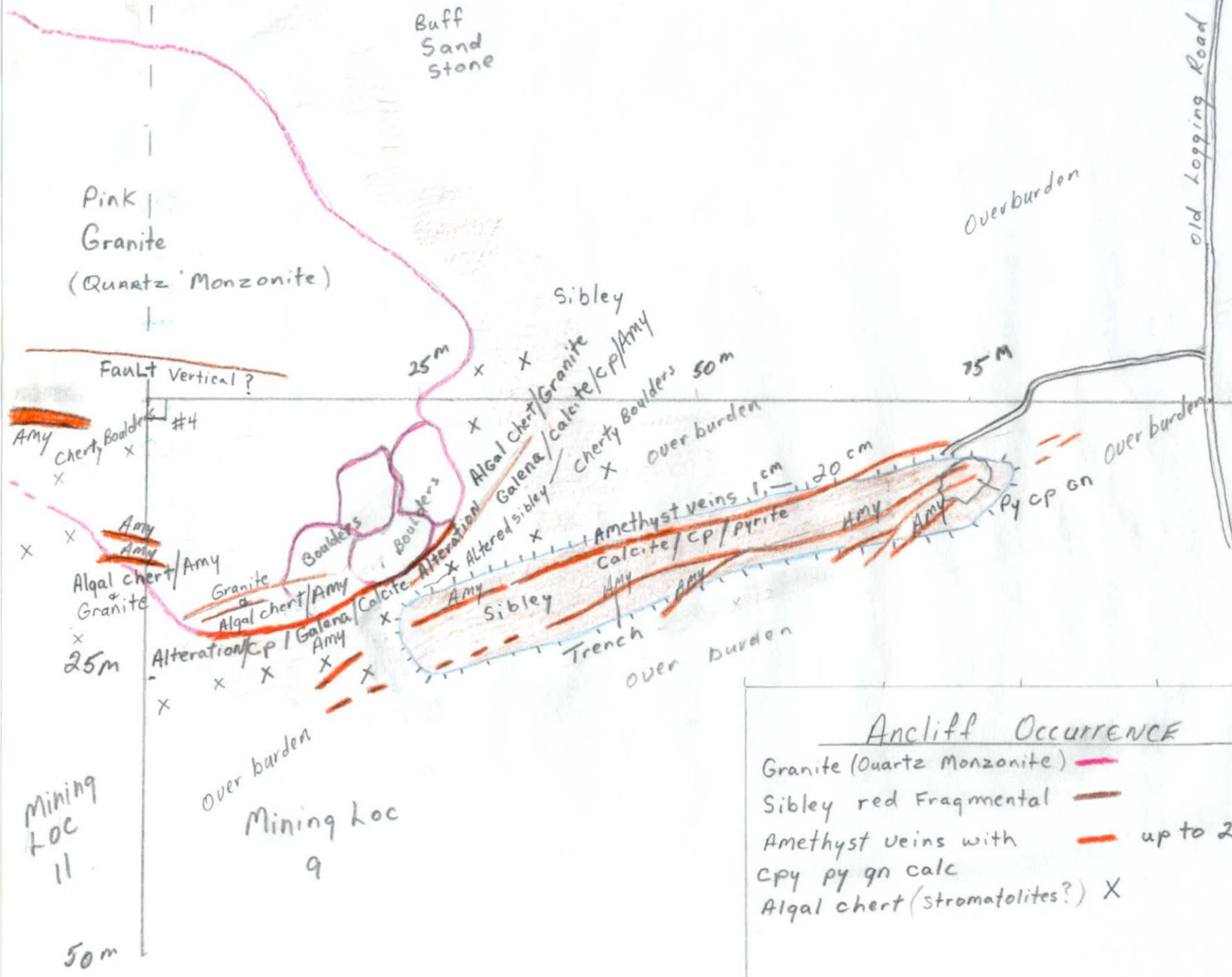
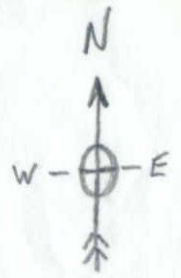

Ancliff Occurrence

Granite (Quartz monzonite) ———

Sibley red Fragmental ———

Amethyst veins with ——— up to 2" at base  
 cpy py gn calc

Algal chert (stromatolites?) X

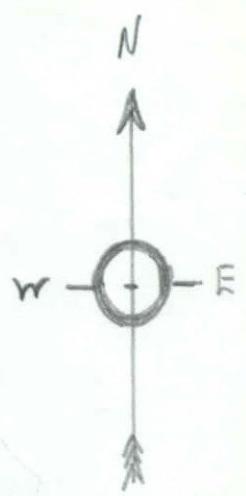

11/17 East -

Superior Shores

Trans Canada Pipeline

13

11

9

7

Ancliff LK

400 M

1217876  
Anderson

404862  
Dzuba

458089  
Dzuba

12147005  
Anderson

352386  
Dzuba

PS

129263  
Williamson

CANADIAN National Railway

P6



Mining Location 11 McTavish Twp  
Mining Location 9

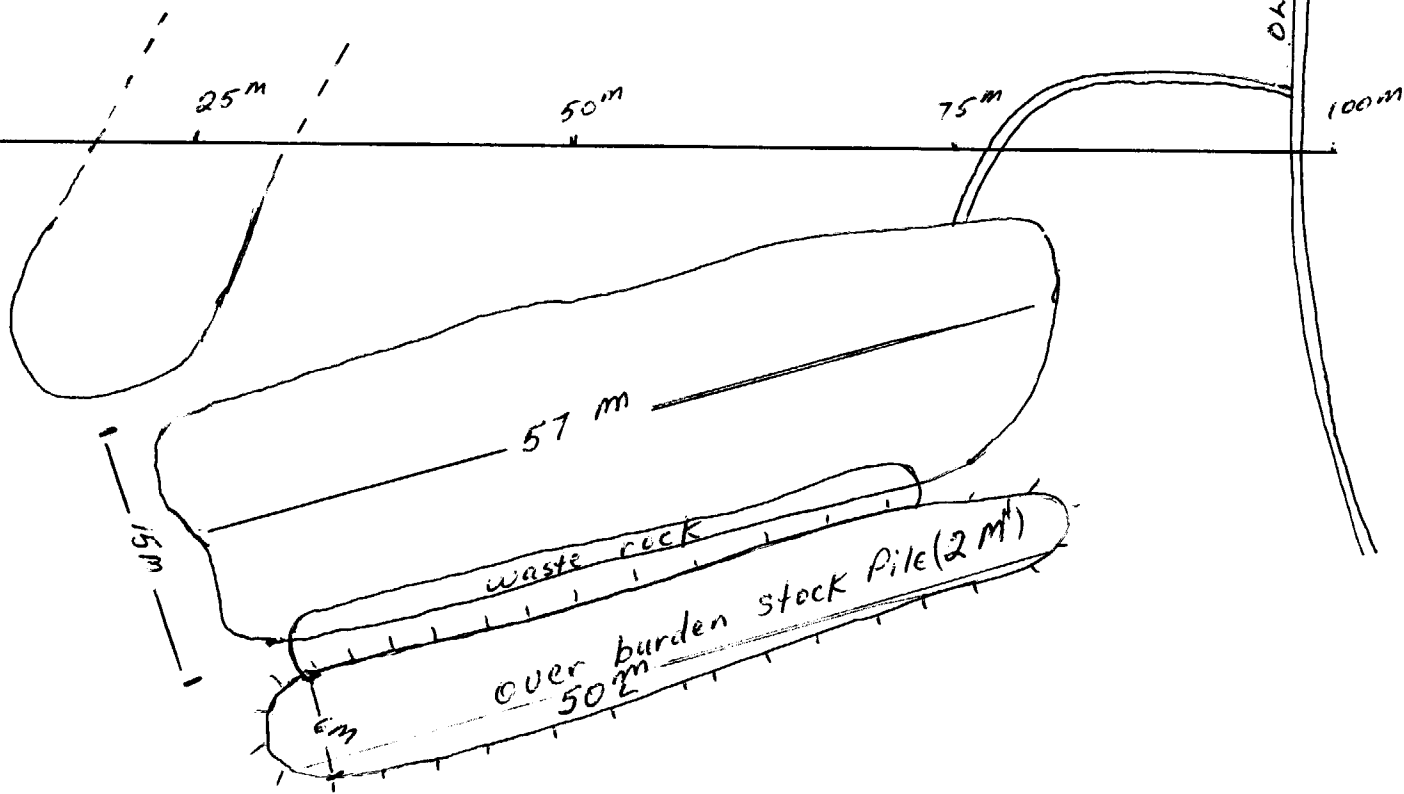

P7

Amliff Occurrence. claim #1247005

On Nov 10<sup>th</sup> A 225 Hitachi hoe was brought on the property and exposed veins of amethyst which has minor amounts of associated mineralization. Some holes were drilled and at this time further development has been advised. At this time we will be submitting only the stripping portion of the ~~assessment~~ <sup>assessment</sup> work.

CW Anderson.  
5/1/02



Date: 2002-NOV-20

GEOSCIENCE ASSESSMENT OFFICE  
933 RAMSEY LAKE ROAD, 6th FLOOR  
SUDBURY, ONTARIO  
P3E 6B5

CHARLES WALLACE ANDERSON  
36 TRILLIUM WAY  
THUNDER BAY, ONTARIO  
P7B 2M1 CANADA

Tel: (888) 415-9845  
Fax:(877) 670-1555

**Submission Number:** 2.24488  
**Transaction Number(s):** W0240.01710

Dear Sir or Madam

**Subject: Approval of Assessment Work**

We have approved your Assessment Work Submission with the above noted Transaction Number(s). The attached Work Report Summary indicates the results of the approval.

At the discretion of the Ministry, the assessment work performed on the mining lands noted in this work report may be subject to inspection and/or investigation at any time.

If you have any question regarding this correspondence, please contact BRUCE GATES by email at [bruce.gates@ndm.gov.on.ca](mailto:bruce.gates@ndm.gov.on.ca) or by phone at (705) 670-5856.

Yours Sincerely,



Ron Gashinski  
Senior Manager, Mining Lands Section

**Cc:** Resident Geologist

Charles Wallace Anderson  
(Claim Holder)

Robert Marcy Boyd  
(Claim Holder)

Assessment File Library

Charles Wallace Anderson  
(Assessment Office)





MINISTRY OF  
NORTHERN DEVELOPMENT  
AND MINES  
PROVINCIAL SURVEY  
AND RECORDS OFFICE

**MINING LAND TENURE  
MAP**

Date / Time of Issue Nov 19 2002 14:20h Eastern  
TOWNSHIP / AREA PLAN  
MCTAVISH G-0675

ADMINISTRATIVE DISTRICTS / DIVISIONS  
Mining Division Thunder Bay  
Land Titles/Registry Division THUNDER BAY  
Ministry of Natural Resources District THUNDER BAY

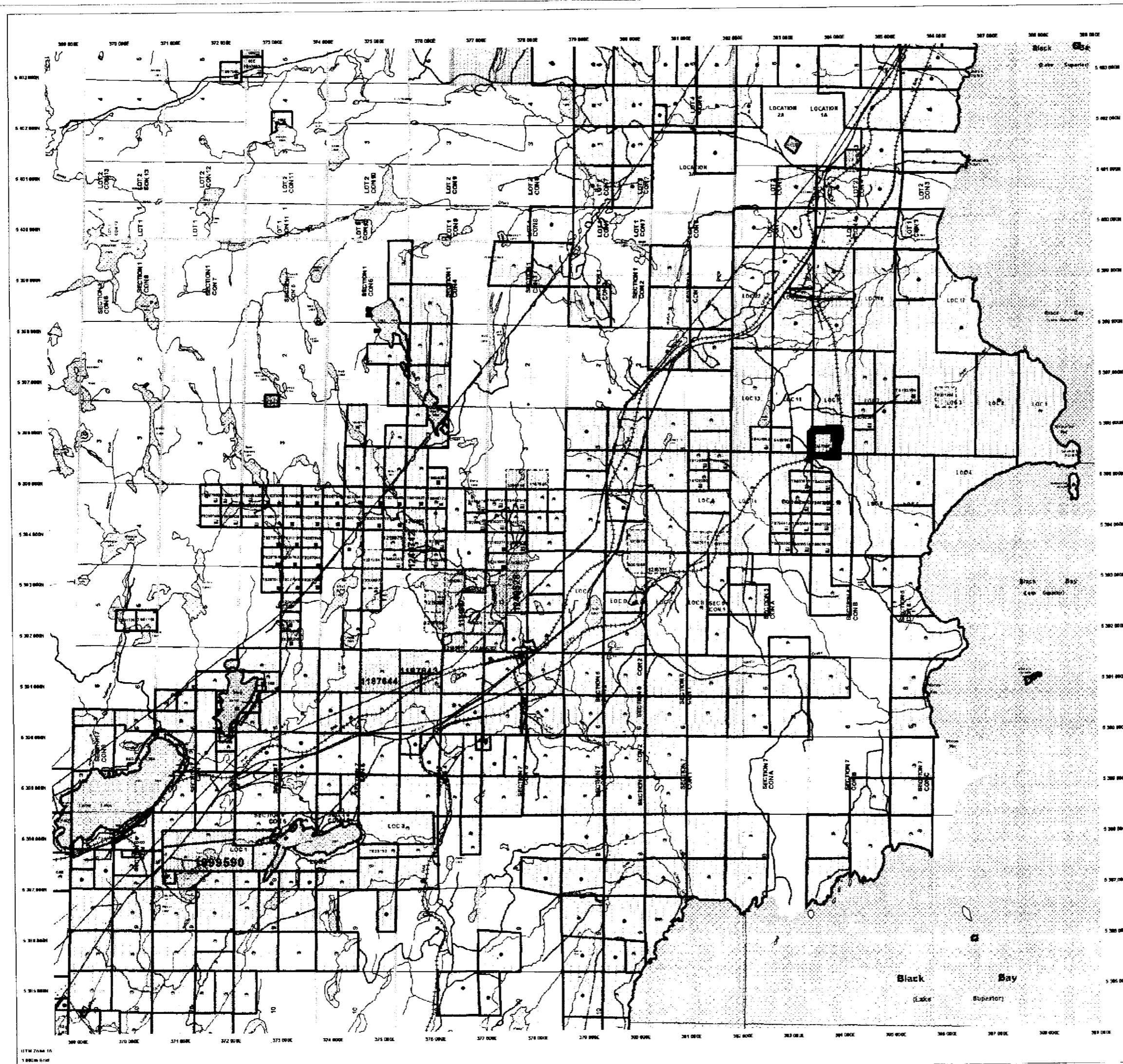

**TOPOGRAPHIC**

- Administrative Boundaries
- Township
- Contour Line
- Foundation Plan
- Inland Reserve
- C.R., R.R. and P.R.
- Contour
- Contour, Approx. Aerial Photo Projection
- Shore
- Mine Headframe
- Access
- Road
- Trail
- Irregular Dike Profile
- Pipeline
- Communication Line
- Wetland Area
- Impervious / Mineral Reservoir / Core

**LAND TENURE**

- Freehold Patent**
  - Surface and Mining Rights
  - Surface Rights Only
  - Mining Rights Only
- Leasehold Patent**
  - Surface and Mining Rights
  - Surface Rights Only
  - Mining Rights Only
- Licence of Occupancy**
  - Users Not Specified
  - Surface and Mining Rights
  - Surface Rights Only
  - Mining Rights Only
- Land Use Permit**
- Order in Council**
- Water Power Lease Agreement**
- Mining Claim**

**LAND TENURE WITHDRAWALS**

- Area Withdrawal from Disposition**
  - Mining Act 2001 (M.A. 2001)
  - Surface and Mining Rights Withdrawal
  - Surface Rights Only Withdrawal
  - Mining Rights Only Withdrawal
  - Order in Council Withdrawal Types
  - Surface and Mining Rights Withdrawal
  - Surface Rights Only Withdrawal
  - Mining Rights Only Withdrawal

**IMPORTANT NOTICES**



**LAND TENURE WITHDRAWAL DESCRIPTIONS**

Number	Type	Date	Description
2827	When	Jan 1 2001	LAND UNDER LEASE SUSPENDED WITHDRAWAL FROM STAKING BY O.C. DATED APRIL 26 1912 S.E.S. 1.00000000
3248	When	Jan 1 2001	LAND UNDER LEASE SUSPENDED WITHDRAWAL FROM STAKING BY O.C. DATED APRIL 26 1912 S.E.S. 1.00000000
WLC207	Wa	Feb 28 1982	SEC 26.00000000 W-207/1674 FEB 20 1974 R.O. 1.00000000
WLC1147	When	Jul 1 1985	SEC 26.00000000 W-1147/1674 JUL 1 1985 R.O. 1.00000000
WLC12683	When	Jul 1 2001	SHARES ACCE 2683/1674 ONLY WITHDRAWAL FROM STAKING ORDER IN COUNCIL 2001/1674
WLC12226	When	Nov 21 2001	Mining and Surface Rights Withdrawal Section 35 of the Mining Act RSD 1985 Order in Council 2001/1674 Nov 21 2001 No. 1674/01 This boundary clearly represents the area that is being proposed for reclamation and may be subject to further change.

**IMPORTANT NOTICES**

Areas in which special requirements, conditions or covenants exist that affect mineral production, including mineral development activities.

2. 24488  
PSTRIP



**General Information and Limitations**  
 This map is a summary of the information contained in the Provincial Mining Records Office of the Ministry of Northern Development and Mines for the administrative purposes of the Province of Ontario. It is not intended to be used as a legal document. The information shown is derived from data obtained from the Provincial Mining Records Office. The information shown is derived from data obtained from the Provincial Mining Records Office. The information shown is derived from data obtained from the Provincial Mining Records Office.