

2 . 27606

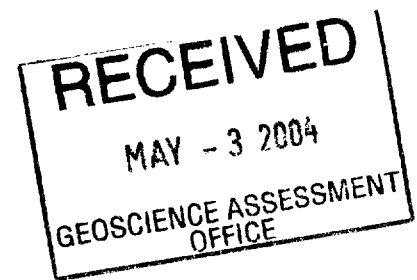

**REPORT ON STRIPPING
AND PROSPECTING
BIG PEARL LAKE AMETHYST MINE,
THUNDER BAY MINING DIVISION
NTS 52 A/10**

Balmertown, Ontario
April 15, 2004

Timothy J. Twomey
H.BSc. Geology



52A10NE2017 2.27606 MCTAVISH

TABLE OF CONTENTS

	Page
INTRODUCTION.....	1
LOCATION AND ACCESS.....	1
PROPERTY DESCRIPTION.....	1
STRIPPING	1
PROSPECTING.....	6
CONCLUSIONS AND RECOMMENDATIONS.....	6
CERTIFICATE OF QUALIFICATIONS.....	7
REFERENCES CITED.....	8

LIST OF FIGURES

1) GENERAL GEOLOGY MAP OF McTAVISH TWP.....	2
2) CLAIM MAP OF PROPERTY (1" = 1/4 mi.).....	3
3) GPS MAP of TRAVERSES (1:10,000).....	4
4) GEOLOGY MAP McTAVISH TWP (1" = 1/2 mi.).....	5
5) GEOLOGY SURVEY (1:2,000).....	BACK POCKET

INTRODUCTION

The property contains an amethyst mine nearby to Big Pearl Lake within the prolific amethyst belt of the north half of McTavish Township in Northern Ontario. It is a good-grade deposit of amethyst in a quartz vein up to 6 feet wide (2 m) which is ready to mine. The author prospected the property and stripped one of the showings on August 3rd and 4th, 2003.

LOCATION AND ACCESS

The property is located within McTavish Township, claim map G-175, latitude 48° 40' 45", longitude 88° 40' 37". It is approximately 30 miles (50 km) east of the City of Thunder Bay, Ontario. The property is located 0.6 miles (1 km) north of Highway 11-17 via No. 5 Road North at Pearl, Ontario. Access to the property is provided by an all-weather gravel road, the Diamond Willow Mine/Blue Points Mine road, which connects five amethyst mines with Highway 11-17, for 0.6 miles (1.0 km). Then, one proceeds on a narrow bush road, controlled by the property for 800 feet (250 m) to the mine-site.

PROPERTY DESCRIPTION

The property consists of six contiguous unpatented mining claims containing nine units within Lot 5, Concession III and IV, in McTavish Township, Thunder Bay Mining Division. It contains approximately 144 hectares (360 acres). The original amethyst occurrence was staked in 1985, and unpatented mining claims require \$400 assessment work per unit per year to remain in good standing. No other taxes are applicable. The assessment work due are listed below:

TB.830425	40 acres	assessment \$400 due February 8, 2006
TB.1165209	40 acres	assessment \$400 due October 15, 2006
TB.1238077	40 acres	assessment \$400 due August 21, 2005
TB.1238078	80 acres	assessment \$800 due August 6, 2005
TB.1249528	80 acres	assessment \$800 due March 7, 2005
TB.1249532	80 acres	assessment \$800 due July 12, 2004

STRIPPING

Stripping was conducted on TB.1249532 by an old trench designated the "Far East Pit". It occurs 80 m (260 ft) at azimuth 055° from an old pit in the hydro field on an amethyst vein. The trench is 1 m wide by 10 m long (3 ft by 30 ft) perpendicular to the vein strike. It is badly overgrown and exposed a quartz vein less than 1 m wide containing amethyst and galena. The galena is euhedral and coarse-grained and comprises about 1% of the vein. The amethyst is druzy and deep purple, black and white in color. There is no documentation remaining of this old work (from the 1920's, judging from the trees growing in the trench), from the author's research of Tanton, 1931 and assessment files.

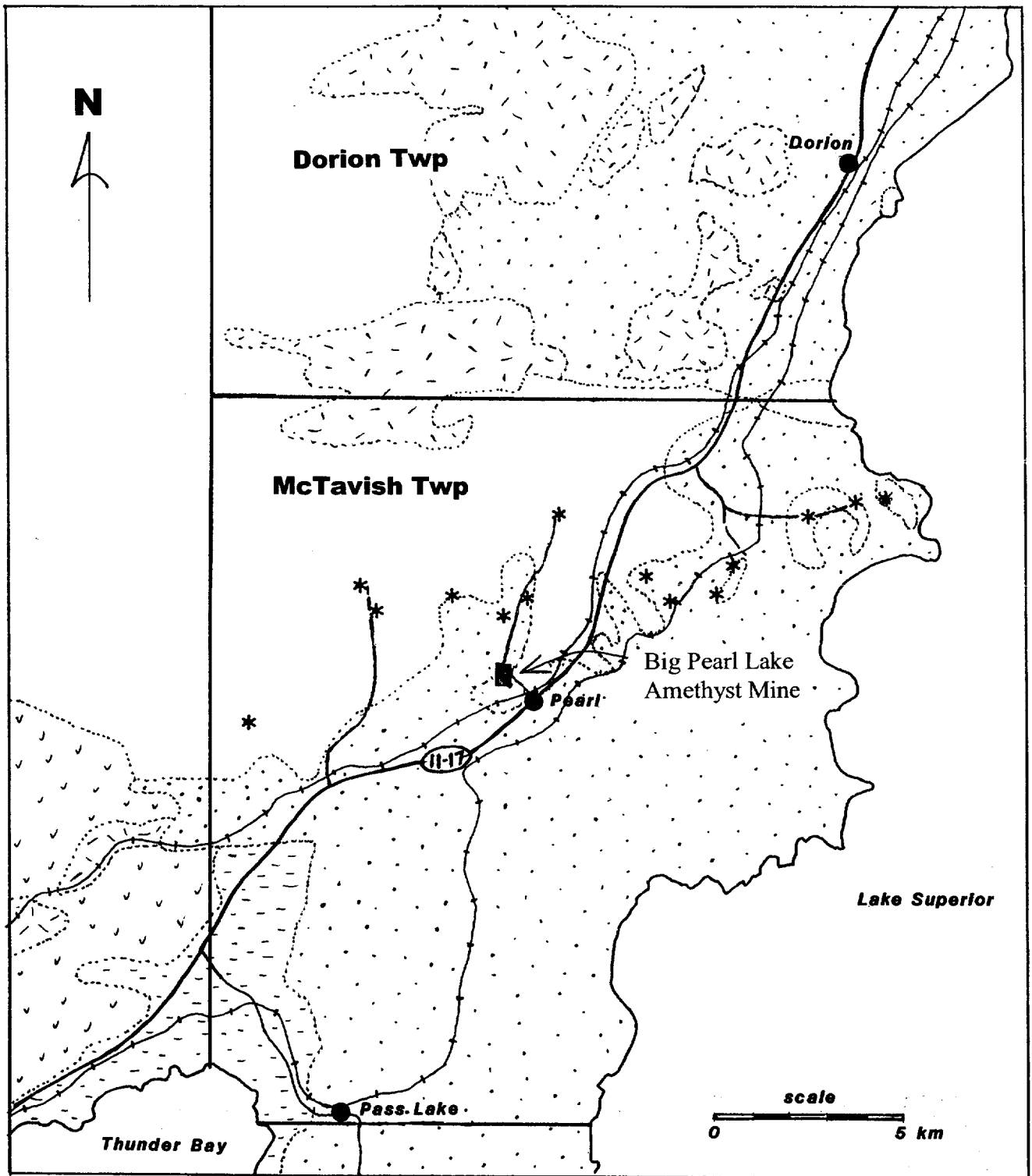

Property Location

Legend

-  **Diabase**
-  **Sibley Group**
-  **Animikie Group**
-  **Metavolcanic Rocks**
-  **Granitic Rocks**
- * Amethyst Occurrence**

Figure 1



Figure 2: Claim Map of Big Pearl Lake Amethyst Mine, McTavish Township, G-0675, Thunder Bay Mining Division.

2.27606

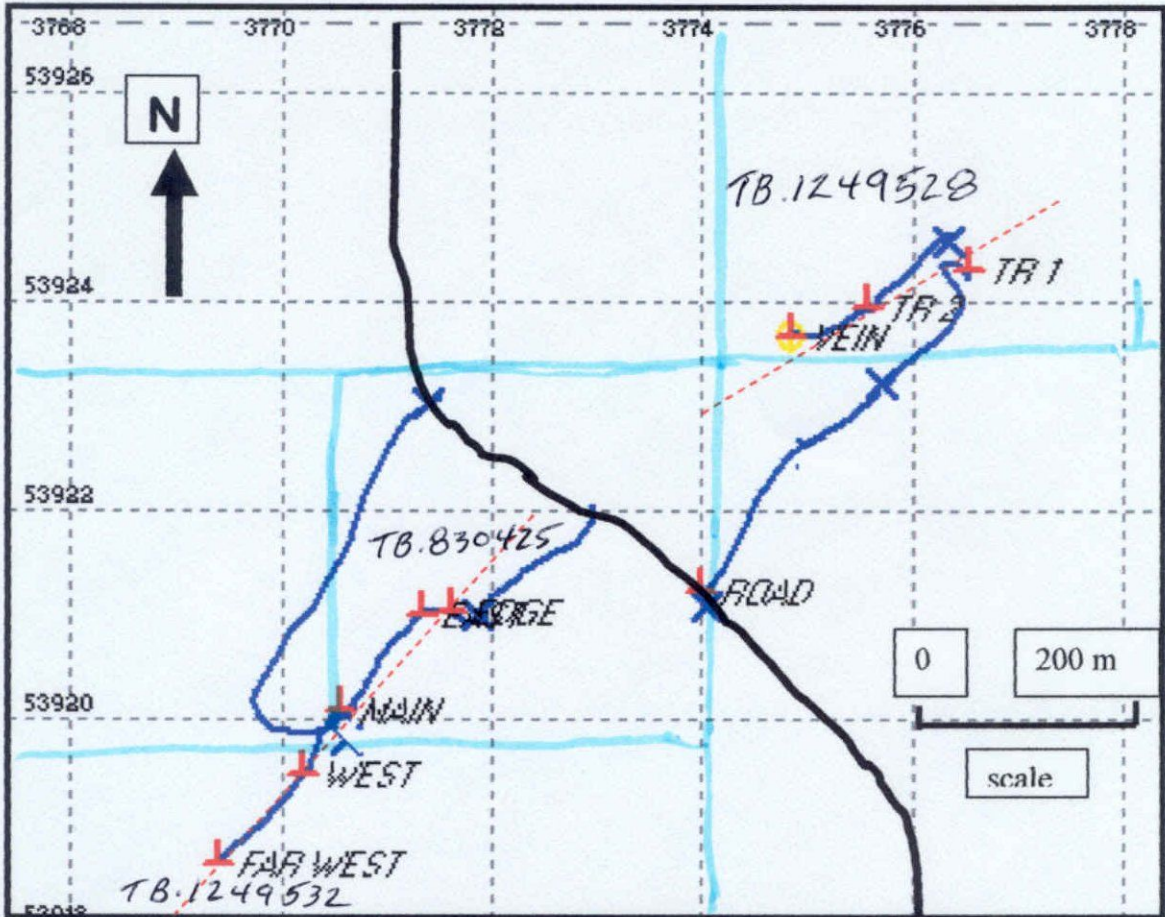
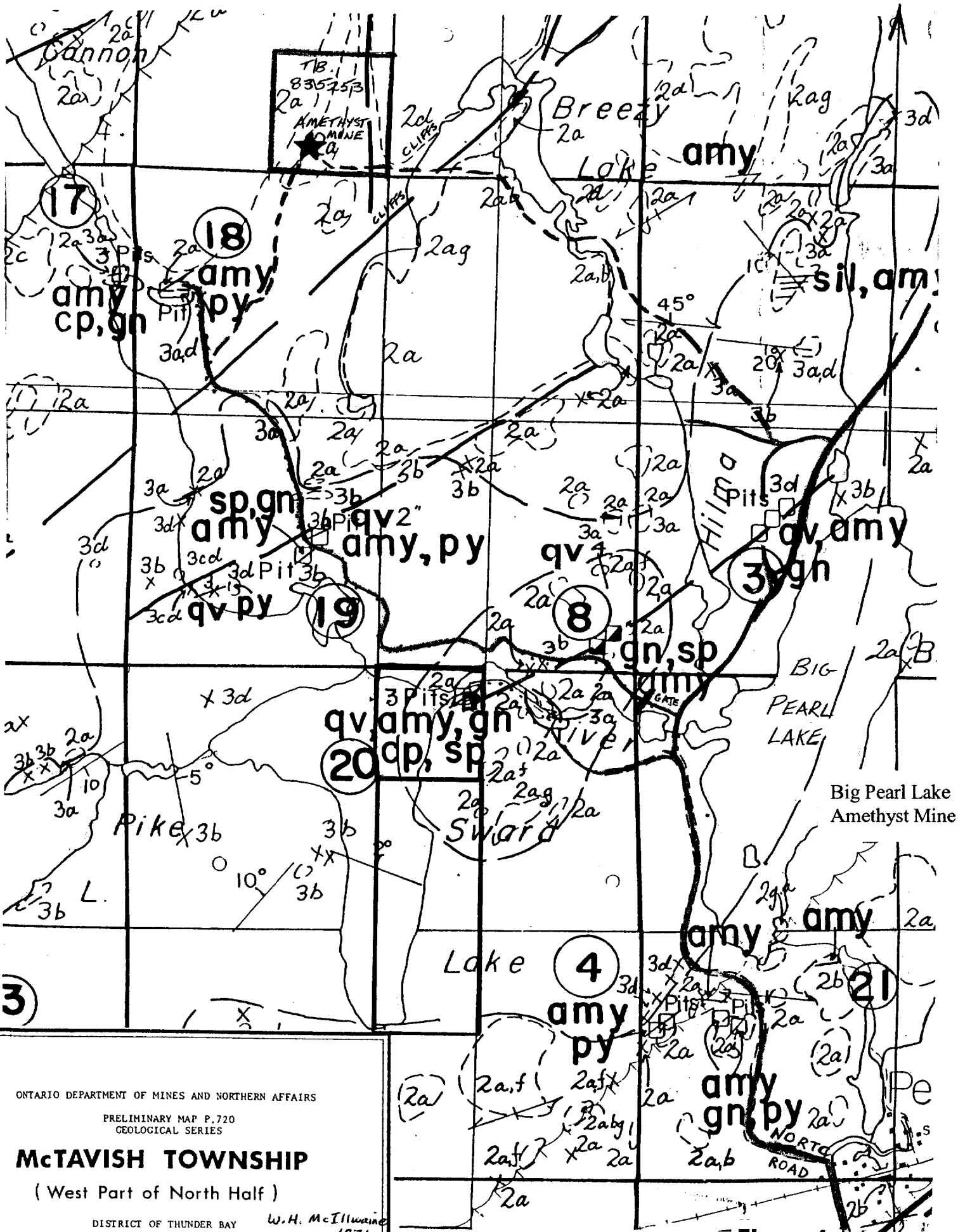

Figure 3: Map of GPS Co-ordinates showing pits and trenches on amethyst vein, Big Pearl Lake Amethyst Mine, UTM co-ordinates 16U, NAD 27 Canada.



ONTARIO DEPARTMENT OF MINES AND NORTHERN AFFAIRS
 PRELIMINARY MAP P.720
 GEOLOGICAL SERIES

McTAVISH TOWNSHIP
 (West Part of North Half)

DISTRICT OF THUNDER BAY *W.H. McIlwaine*
 1971

Scale 1 inch to 1/2 mile

Figure 4

2 . 27606

The vein north-east of the trench was exposed and overburden was removed by hand and shovel. The stripping was plotted by GPS and drafted into a local grid (see Figure 4). Locations by UTM co-ordinates 16U (NAD 27 Canada) are as follows:

“Far East Pit” old Trench: 0377653mE, 5392215mN

PROSPECTING

The vein system was prospected east of the showing on the end of Frenchman’s road, on claim TB.1249528, towards an un-named lake. All of veins observed so far are spatially related to a single trend at azimuth 045° to 055°, therefore are one amethystine vein system. Mapping and prospecting were conducted at an azimuth of 055° for 300 m. Minor granite outcrops were observed but no quartz veining or old trenches were recognized.

CONCLUSIONS AND RECOMMENDATIONS

The vein system that hosts the amethyst is strong and continues past the mined areas. This vein system is at least 1 km (0.6 miles) in strike length. Good quality purple amethyst is seen east of the Far East Pit extending up to the overburden. It is recommended that the area be stripped with a rubber-tired backhoe, using the “Frenchman’s” road for access, in order to evaluate this new area. This could be done with relative ease for more than 50 m on-strike to the north-east.

CERTIFICATE OF QUALIFICATIONS

I, Timothy J. Twomey, of Box 88, Balmertown, Ontario, P0V 1C0, do hereby certify as follows concerning my Report on Stripping, Big Pearl Lake Amethyst Mine, dated April 15, 2004:

1. I am a 1983 graduate of Lakehead University, Thunder Bay, Ontario, holding a Bachelor of Science (Honours) degree in Geology.
2. Breezy Mountain Amethyst Mines Ltd., of which I am sole owner, has a 100% interest in the Big Pearl Lake Amethyst Mine.
3. This report is based on my own work on the property as well as literature review of Assessment Files, Resident Geologists Office, Ministry of Northern Development and Mines, Thunder Bay, Ontario.

April 15, 2004
Balmertown, Ontario

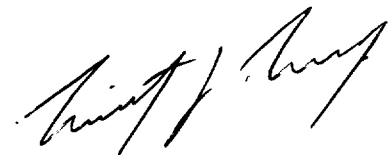

Timothy J. Twomey
B.Sc (Hons) Geology

REFERENCES

Assessment Files, Resident Geologists Office, MNDM, Thunder Bay, Ontario.

McIlwaine, W.H.

1971: McTavish Township (North Half), District of Thunder Bay; Ontario Dept. of Mines and Northern Affairs, Prelim. Geol. Ser. Map P.720, scale 1 inch to 1/4 mile.

Tanton, T.L.

1931: Fort William and Port Arthur, and Thunder Cape Map Areas, Thunder Bay District, Ontario; Canada Department of Mines, Memoir 167.

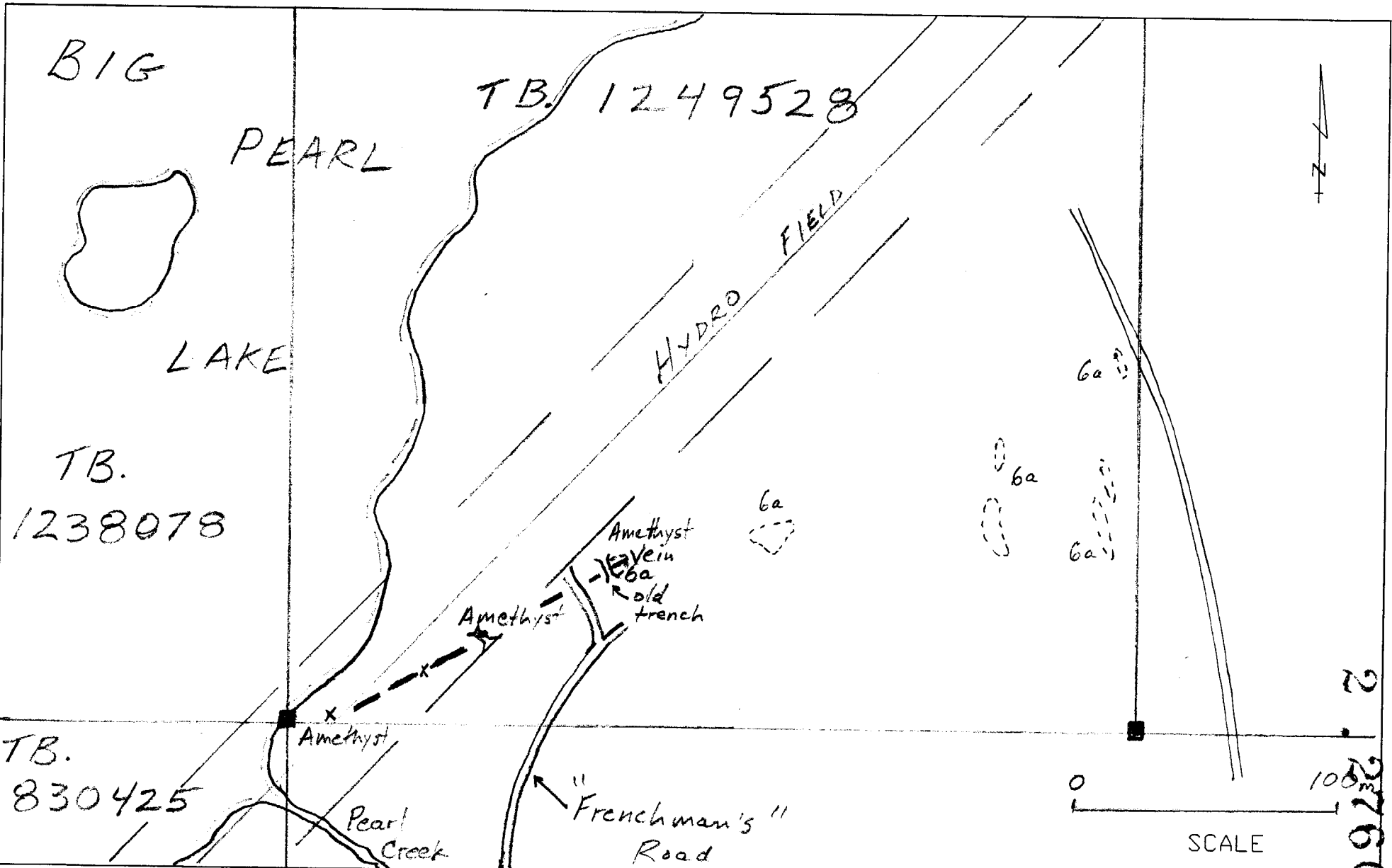

LEGEND

PROTEROZOIC

7 SIBLEY GROUP SEDIMENTARY ROCKS
7a sandstone

ARCHEAN

6 GRANDIORITIC TO GRANITIC
6a Undeformed and deformed granitoid

qu Quartz Vein

Geological contact (observed, interpreted)

- Shear
- Foliation (inclined)
- Joint (inclined, vertical)
- Z-fold with plunge
- Outcrop
- Small outcrop
- Boulder

SYMBOLS

- Ledge, Cliff
- Swamp
- Drainage direction
- Lineament
- Claim post

Big Pearl Lake Amethyst Mine

SCALE: 1 : 2,500 | DRAWN BY: TJT | DATE: April 2004

McAVISH TOWNSHIP, G-0675
NTS 52 A/10

GEOLOGY SURVEY

Handwritten signature

2127606

Date: 2004-MAY-05

GEOSCIENCE ASSESSMENT OFFICE
933 RAMSEY LAKE ROAD, 6th FLOOR
SUDBURY, ONTARIO
P3E 6B5

TIMOTHY J TWOMEY
BREEZY MOUNTAIN AMETHYST MINES LTD.
BOX 88
BALMERTOWN, ONTARIO
P0V 1C0 CANADA

Tel: (888) 415-9845
Fax: (877) 670-1555

Submission Number: 2.27606
Transaction Number(s): W0440.00671

Dear Sir or Madam

Subject: Approval of Assessment Work

We have approved your Assessment Work Submission with the above noted Transaction Number(s). The attached Work Report Summary indicates the results of the approval.

At the discretion of the Ministry, the assessment work performed on the mining lands noted in this work report may be subject to inspection and/or investigation at any time.

If you have any question regarding this correspondence, please contact STEVEN BENETEAU by email at steve.beneteau@ndm.gov.on.ca or by phone at (705) 670-5855.

Yours Sincerely,



Ron C. Gashinski
Senior Manager, Mining Lands Section

Cc: Resident Geologist
Breezy Mountain Amethyst Mines Ltd.
(Claim Holder)

Assessment File Library
Breezy Mountain Amethyst Mines Ltd.
(Assessment Office)



52A10NE2017 2.27606 MCTAVISH

200

ONTARIO CANADA

MINISTRY OF NORTHERN DEVELOPMENT AND MINES
PROVINCIAL MINING RECORDERS' OFFICE

Mining Land Tenure Map

Date / Time of Issue: Fri Jun 04 10:51:48 EDT 2004

TOWNSHIP / AREA
MCTAVISH

PLAN
G-0675

ADMINISTRATIVE DISTRICTS / DIVISIONS

Mining Division
Land Titles/Registry Division
Ministry of Natural Resources District

Thunder Bay
THUNDER BAY
THUNDER BAY

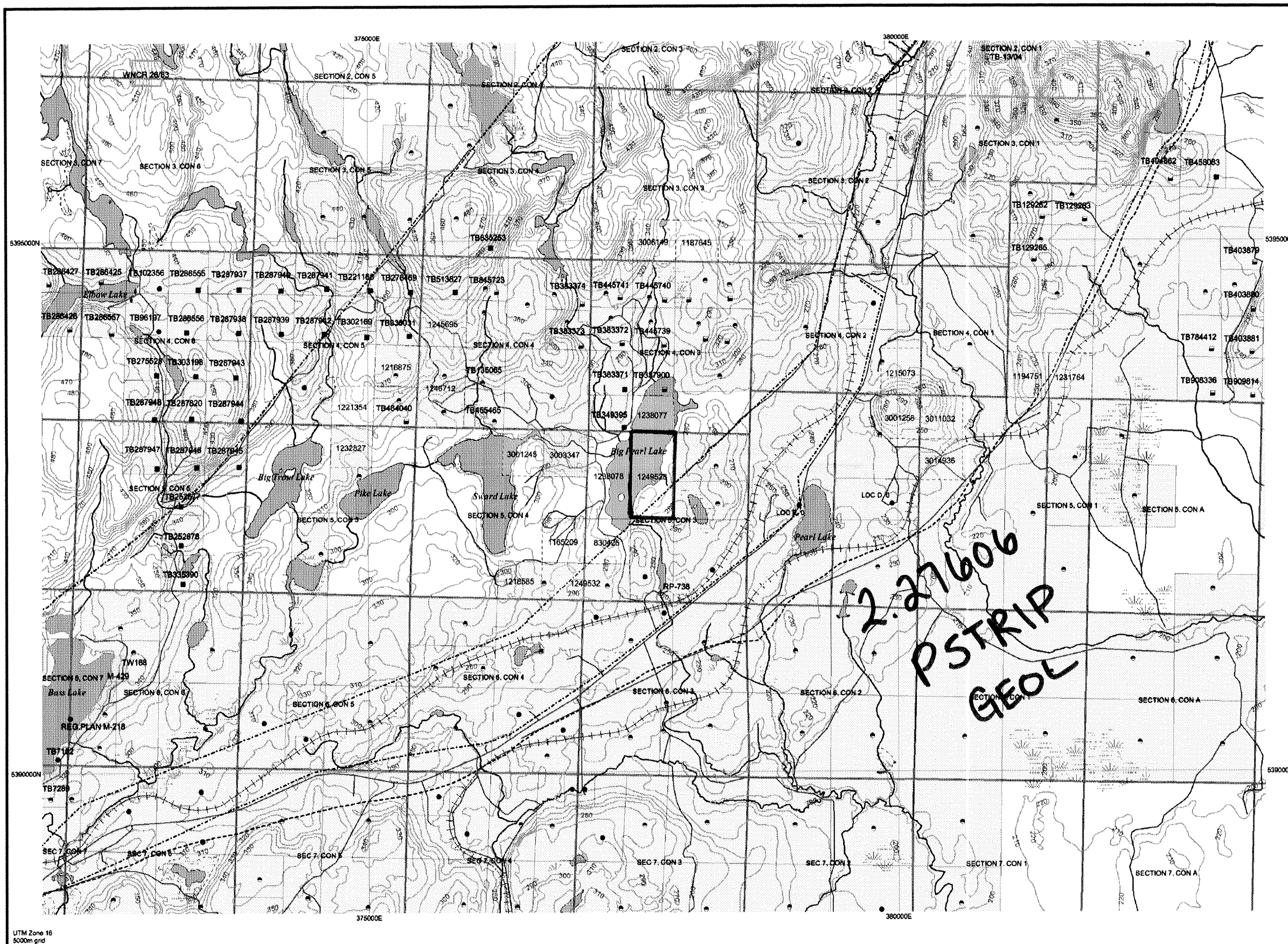

TOPOGRAPHIC

- Administrative Boundaries
- Township
- Concession, Lot
- Provincial Park
- Indian Reserve
- Cliff, Pit & Pile
- Contour
- Mine Shafts
- Mine Headframe
- Railway
- Road
- Trail
- Natural Gas Pipeline
- Utilities
- Tower

Land Tenure

- Freehold Patent
 - Surface And Mining Rights
 - Surface Rights Only
 - Mining Rights Only
- Leasehold Patent
 - Surface And Mining Rights
 - Surface Rights Only
 - Mining Rights Only
- Licence of Occupation
 - Uses Not Specified
 - Surface And Mining Rights
 - Surface Rights Only
 - Mining Rights Only
- Land Use Permit
- Order In Council (Not open for staking)
- Water Power Lease Agreement
- Mining Claim
- Filed Only Mining Claims

LAND TENURE WITHDRAWALS

- 1234 Area Withdrawn from Disposition
 - Mining Acts Withdrawal Types
 - Surface And Mining Rights Withdrawn
 - Surface Rights Only Withdrawn
 - Mining Rights Only Withdrawn
 - Order In Council Withdrawal Types
 - Surface And Mining Rights Withdrawn
 - Surface Rights Only Withdrawn
 - Mining Rights Only Withdrawn

IMPORTANT NOTICES

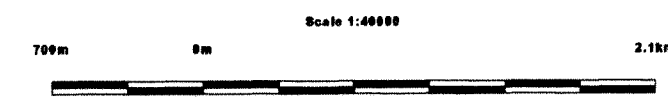
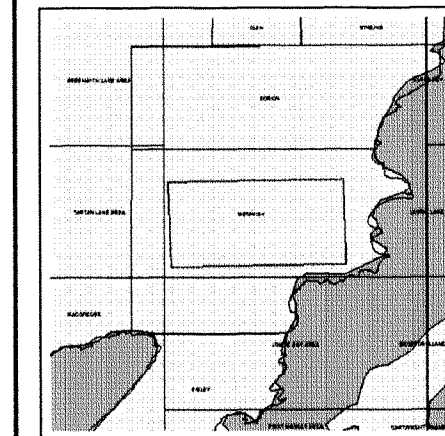

LAND TENURE WITHDRAWAL DESCRIPTIONS

Identifier	Type	Date	Description
TB-13/04	Wm	Feb 23, 2004	TB-13/04 M.R.O. Feb 23, 2004 Withdrawn for MTO to allow for evalu aggregate potential.
WNCR 26/83	We	Jan 1, 2001	SURFACE RIGHTS ONLY WITHDRAWN FROM STAKING ORDER W/ 26/83 POSSIBLE TOWER SITE
W-LL-C2245	Wam	Feb 28, 2004	W-LL-2004/04 ONT M&S withdrawal S.35 Mining Act RSO 1999, 28/02/04 Boundary generally depicts area withdrawn Click to view actu area

Those wishing to stake mining claims should consult with the Provincial Mining Recorders' Office of the Ministry of Northern Development and Mines for additional information on the status of the lands shown hereon. This map is not intended for navigational, survey, or land title determination purposes as the information shown on this map is compiled from various sources. Completeness and accuracy are not guaranteed. Additional information may also be obtained through the local Land Titles or Registry Office, or the Ministry of Natural Resources.

The information shown is derived from digital data available in the Provincial Mining Recorders' Office at the time of downloading from the Ministry of Northern Development and Mines web site.

General Information and Limitations

Contact Information:
Provincial Mining Recorders' Office
Willet Green Miller Centre 933 Ramsey Lake Road
Sudbury ON P3E 6B5
Home Page: www.mndm.gov.on.ca/MNDM/MINESLANDS/mimnpgp.htm

Toll Free
Tel: 1 (888) 415-9845 ext 57
Fax: 1 (877) 670-1444

Map Datum: NAD 83
Projection: UTM (6 degree)
Topographic Data Source: Land Information Ontario
Mining Land Tenure Source: Provincial Mining Recorders' Office

This map may not show unregistered land tenure and interests in land including certain patents, leases, easements, right of ways, flooding rights, licences, or other forms of disposition of rights and interest from the Crown. Also certain land tenure and land uses that restrict or prohibit free entry to stake mining claims may not be illustrated.