



52A10NW0005 10 MCTAVISH

010

Diamond Drilling

Township of MCTAVISH

Report No: 10

Work performed by: LINDSAY EXPLORATIONS

Claim No	Hole No	Footage	Date	Note
TB 91738	1	300.0'	Apr/59	
	2	140.0'	Apr/59	
	3	130.0'	Apr/59	
	4	100.0'	Apr/59	
	5	104.0'	Apr/59	
	6	55.0'	Apr/59	
	7	57.0'	Apr/59	
	8	189.0'	Apr/59	
	9	97.0'	Apr/59	
	10	96.0'	Apr/59	
	11	100.0'	Apr/59	
	18	322.0'	May/59	
	A-1	72.0'	Aug/67	
	A-2	77.6'	Aug/67	
	B-1	69.5'	Aug/67	
	B-2	51.5'	Aug/67	
	B-3	31.5'	Aug/67	
	B-4	64.8'	Aug/67	
B-5	52.0'	Aug/67		
TB 91737	12	84.0'	Apr/59	
	17	75.0'	May/59	
TB 91741	13	75.0'	Apr/59	
	14	67.0'	Apr/59	
	15	92.0'	Apr/59	
	16	150.0'	May/59	
TB 91740	C-1	43.0'	Aug/67	
	C-2	44.8'	Aug/67	
	C-3	36.0'	Aug/67	

Notes:

Diamond Drilling

Township of MCTAVISH

Report NO: 10

Work performed by:

Claim NO	Hole NO	Footage	Date	Note
TB 91740	C-4	30.0'	Aug/67	
	C-5	35.0'	Aug/67	
	C-6	47.0'	Aug/67	
	C-7	26.0'	Aug/67	
	C-8	47.0'	Aug/67	
	C-9	64.0'	Aug/67	
	E-1	46.0'	Aug/67	
	E-2	42.0'	Aug/67	
	E-3	41.0'	Aug/67	
	D-1	82.0'	Aug/67	

10

Notes:

MINIWA  
0a

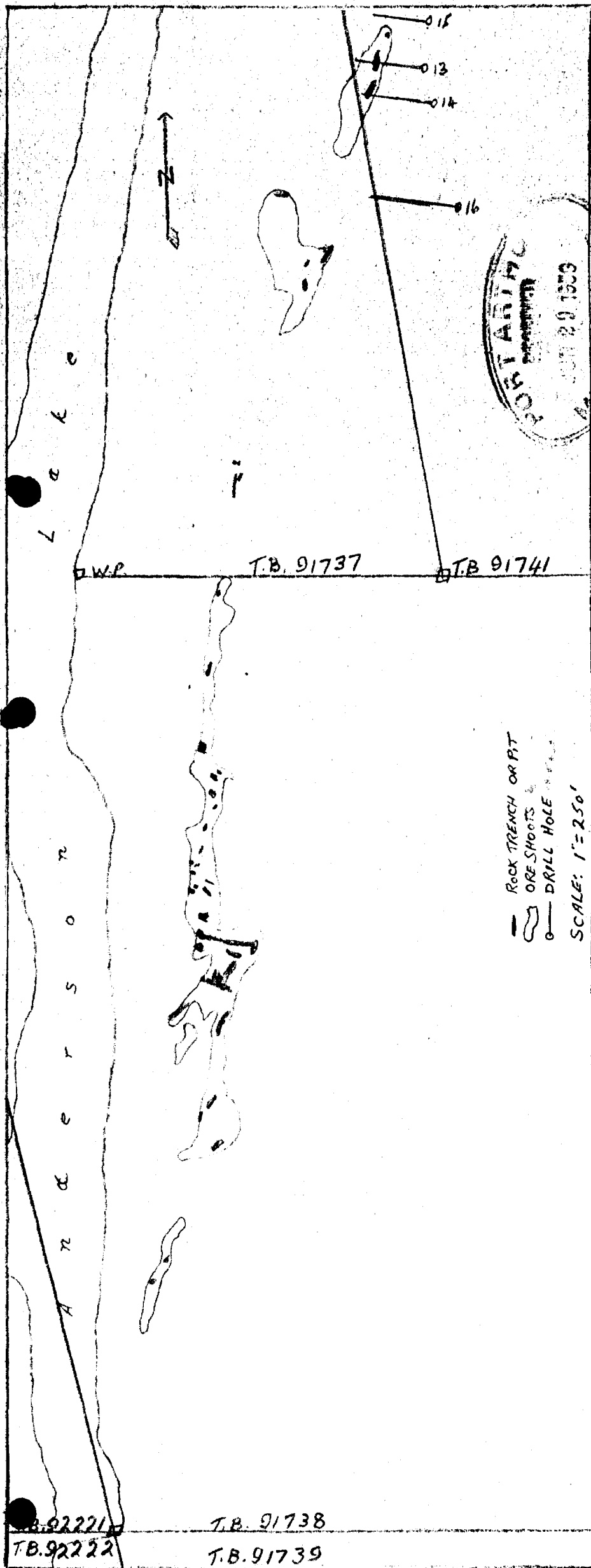

ECONOMIC GEOLOGY DIVISION  
JUN 29 1953

— ROCK TRENCH OR PIT  
- - - ORE SHOOTS  
○ DRILL HOLE  
SCALE: 1" = 250'

T.B. 92221  
T.B. 92222

T.B. 91738  
T.B. 91739

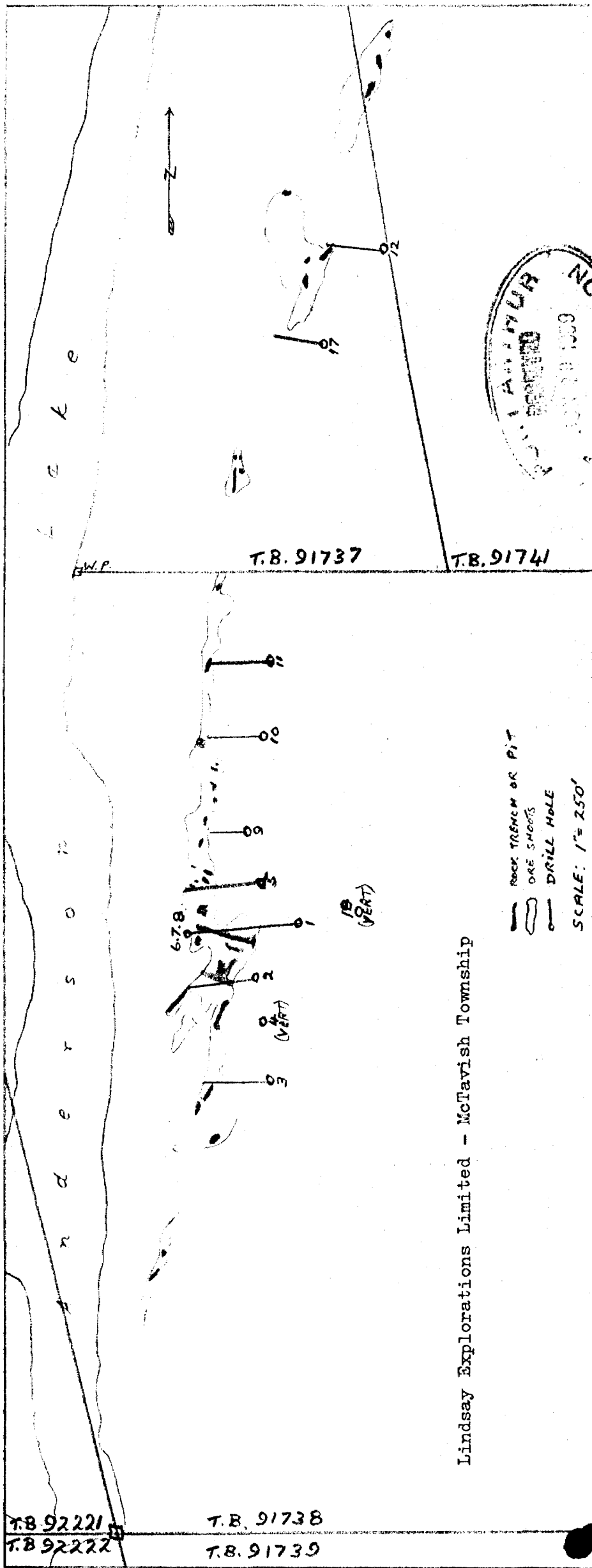

Lindsay Explorations Limited - McTavish Township

ROCK TRENCH OR PIT  
 ORE SHOOTS  
 DRILL HOLE  
 SCALE: 1" = 250'

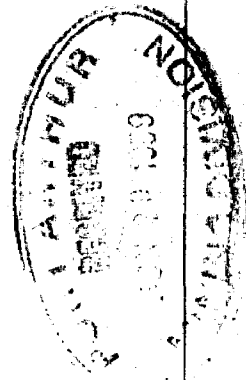

T.B. 92221  
 T.B. 92222

T.B. 91738  
 T.B. 91739

TERRAIN PROPERTY Lindsay Explorations Limited McTavish Township

MINISTÈRE DES MINES, QUÉBEC - DEPARTMENT OF MINES, QUEBEC

JOURNAL DES SONDAGES AU DIAMANT - DIAMOND DRILL RECORD

TROU No. 111  
HOLE No. 1  
FEUILLE No. 1  
SHEET No. 1  
SECTION

COORDONNÉES ORIFICE  
CO-ORDINATES COLLAR

ORIENTATION BEARING W. 4° S.

COMMENCÉ LE DATE BEGUN April 1, 1959

LAT. 450 N. DEP. 150 E.

ANGLE 45

TERMINÉ LE DATE FINISHED April 5, 1959

ELEVATION, ORIFICE  
ELEVATION, COLLAR 5 ft. below dyke

PROFONDEUR TOTALE  
TOTAL DEPTH 300

JOURNAL PAR LOGGED BY W. N. Ingham

CAROTTE CORE FOOTAGE		DESCRIPTION	ECHANTILLON NO SAMPLE NO	DE FROM	A TO	LONGUEUR LENGTH	AN D'G 45 GO
DE FROM	A TO						
0	3	Casing					
3	28.5	Greywacke, Dark grey, biotite rich					
28.5	92	Pegmatite and pegmatitic granite. 82-83 molybdenite along fracture					
92	102	Greywacke					
102	145	Pegmatite and pegmatitic granite. Molybdenite at 131 Main zone is 106 feet wide					
145	300	Greywaycke, Numerous quartz stringers and veinlets up to 0.5 foot wide.  213 - 214 ; Grey granite 270 - 272: Pegmatite 275 - 280; Pegmatite 287 - 289 : Grey Granite 290 - 291: Grey granite  300 - end Hole					

*W. N. Ingham*

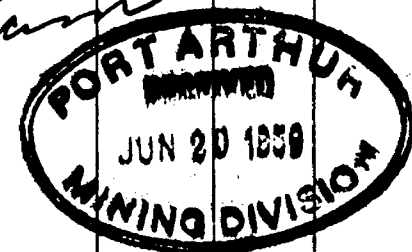

TERRAIN PROPERTY Lindsay Explorations Limited McTavish Township

111-6  
 TROU No. 2  
 FEUILLE No. 1  
 SHEET No. \_\_\_\_\_  
 SECTION \_\_\_\_\_

MINISTÈRE DES MINES, QUÉBEC - DEPARTMENT OF MINES, QUÉBEC

**JOURNAL DES SONDAGES AU DIAMANT - DIAMOND DRILL RECORD**

COORDONNÉES ORIFICE  
 CO-ORDINATES COLLAR

ORIENTATION  
 BEARING W. 2° S.

COMMENCÉ LE  
 DATE BEGUN April 5, 1959

LAT. 350 N. DEP. 150 E.

ANGLE 45

TERMINÉ LE  
 DATE FINISHED April 7, 1959

ELEVATION, ORIFICE  
 ELEVATION, COLLAR 7 feet below dyke

PROFONDEUR TOTALE  
 TOTAL DEPTH 140

JOURNAL PAR  
 LOGGED BY W. N. Ingham

CAROTTE CORE FOOTAGE		DESCRIPTION	ECHANTILLON NO SAMPLE NO	DE FROM	A TO	LONGUEUR LENGTH	ANALYSE, ONCES D'OR PAR TONNE ASSAY, OUNCES GOLD PER TON	
DE FROM	A TO							
0	34	Casing						
34	60	Greywacke						
60	118	Pegmatite and pegmatitic granite ( 58 Ft. ) 87 - 93 greywacke						
118	140	Greywacke  140 End Hole						

*W. N. Ingham*

THE BASIN  
PROPERTY

Lindsay Explorations Limited      McTavish Township

TROU No. 111-6  
HOLE No. 3  
FEUILLE No. \_\_\_\_\_  
SHEET No. 1  
SECTION \_\_\_\_\_

MINISTÈRE DES MINES, QUÉBEC - DEPARTMENT OF MINES, QUEBEC

**JOURNAL DES SONDAGES AU DIAMANT - DIAMOND DRILL RECORD**

COORDONNÉES OFFICE  
CO-ORDINATES COLLAR

ORIENTATION  
BEARING West

COMMENCÉ LE  
DATE BEGUN April 8, 1959

150 N. DEP.      150 E.

ANGLE 45

TERMINÉ LE  
DATE FINISHED April 10, 1959

ELEVATION, OFFICE  
ELEVATION, COLLAR

PROFONDEUR TOTALE  
TOTAL DEPTH 130

JOURNAL PAR  
LOGGED BY W. N. Ingham

CAROTTE CORE FOOTAGE		DESCRIPTION	ECHANTILLON NO SAMPLE NO	DE FROM	A TO	LONGUEUR LENGTH	ANALYSE, ONCES D'OR PAR TONNE ASSAY, OUNCES GOLD PER TON	
DE FROM	A TO							
0	11	Casing						
11	18	Pegmatite. 17.0 - 17.5. Molybdenite in fracture along core						
18	81	Greywacke. Several dykelets of grey granite						
81	118	Pegmatite and pegmatitic granite (37 Feet)						
		83: Molybdenite in fracture along core						
		88: " " " " "						
		91.5 " " " " "						
		97.5 " " " " "						
		106 Scattered flakes of molybdenite						
118	130	Greywacke						

*W. N. Ingham*

TROU No. 111-6  
HOLE No. 4

FEUILLE No. 1  
SHEET No. 1

SECTION

McTavish Explorations Limited McTavish Township

MINISTÈRE DES MINES, QUÉBEC - DEPARTMENT OF MINES, QUEBEC

**JOURNAL DES SONDAGES AU DIAMANT - DIAMOND DRILL RECORD**

COORDONNÉES ORIFICE  
COLLIER COLLAR

ORIENTATION  
BEARING Vertical

COMMENCÉ LE  
DATE BEGUN April 11, 1959

DAT. 250 N. DEP. 100 E.

ANGLE Vertical

TERMINÉ LE  
DATE FINISHED April 12, 1959

ELEVATION, ORIFICE  
ELEVATION, COLLAR

PROFONDEUR TOTALE  
TOTAL DEPTH 100

JOURNAL PAR  
LOGGED BY W. N. Ingham

CAROTTE CORE FOOTAGE		DESCRIPTION	ECHANTILLON NO SAMPLE NO	DE FROM	A TO	LONGUEUR LENGTH	ANALYSE, ONCES D'OR PAR TONNE ASSAY, OUNCES GOLD PER TON
DE ROM	A TO						
0	20	Casing					
20	55	Greywacke					
55	91	Pegmatitic granite and pegmatite (36 Feet) 58.5: Splash of molybdenite 60: Fine grained molybdenite Fracturing along core coated with fine pyrite and minor chalcopyrite.					
91	100	Greywacke 93: Fracture in greywacke coated with chalcopyrite 100 - end hole					

*W. N. Ingham*



TERRAIN PROPERTY Lindsay Explorations Limited McTavish Township

MINISTÈRE DES MINES, QUÉBEC - DEPARTMENT OF MINES, QUEBEC

**JOURNAL DES SONDAGES AU DIAMANT - DIAMOND DRILL RECORD**

TROU No. 111-4  
 HOLE No. 5  
 FEUILLE No. 1  
 SHEET No. 1  
 SECTION

COORDONNÉES ORIFICE  
 CO-ORDINATES COLLAR

ORIENTATION BEARING West

COMMENCÉ LE DATE BEGUN April 13, 1959

LAT. 550 N. DEP. 100 E.

ANGLE 45

TERMINÉ LE DATE FINISHED April 14, 1959

ELEVATION, ORIFICE  
 ELEVATION, COLLAR

PROFONDEUR TOTALE  
 TOTAL DEPTH 104

JOURNAL PAR  
 LOGGED BY W. N. Ingham

CAROTTE CORE FOOTAGE		DESCRIPTION	ECHANTILLON NO SAMPLE NO	DE FROM	A TO	LONGUEUR LENGTH	ANALYSE, ONCES D'OR PAR TONNE ASSAY, OUNCES GOLD PER TON	
DE FROM	A TO							
0	10	Casing						
10	69	Greywacke, Numerous quartz stringers, some with pyrite						
69	95	Pegmatite and pegmatitic granite						
		71 - 75: Scattered flakes molybdenite mainly in a vuggy quartz along core						
		78: Small splash of molybdenite						
		83.5 " " " "						
		84.5 " " " "						
95	104	Greywacke						
		104 - End hole						

*W. N. Ingham*

TERRAIN  
PROPERTY Lindsay Explorations Limited, McTavish Township

MINISTÈRE DES MINES, QUÉBEC - DEPARTMENT OF MINES, QUEBEC

**JOURNAL DES SONDAGES AU DIAMANT - DIAMOND DRILL RECORD**

TROU No. 111-4  
HOLE No. 6  
FEUILLE No.  
SHEET No. 1  
SECTION \_\_\_\_\_

COORDONNÉES ORIFICE  
CO-ORDINATES COLLAR

LAT. 45° N. DEP. 50 W.

ELEVATION, ORIFICE  
ELEVATION, COLLAR

ORIENTATION  
BEARING E. 4° N.

ANGLE 40°

PROFONDEUR TOTALE  
TOTAL DEPTH 55

COMMENCÉ LE  
DATE BEGUN April 15, 1959

TERMINÉ LE  
DATE FINISHED April 16, 1959

JOURNAL PAR  
LOGGED BY W. N. Ingham

CAROTTE CORE FOOTAGE		DESCRIPTION	ECHANTILLON NO SAMPLE NO	DE FROM	A TO	LONGUEUR LENGTH	ANALYSE, ONCES D'OR PAR TONNE ASSAY, OUNCES GOLD PER TON
DE FROM	A TO						
0	3	Casing					
3	33	Pegmatite and pegmatitic granite 13 - 15.5 Greywacke 24 Little molybdenite in quartz stringer					
33	55	Greywacke Hole entered greywacke intrusion in the pegmatite so was stopped 55 End hole					

W. N. Ingham

TERRAIN PROPERTY Lindsay Explorations Limited McTavish Township

TROU No. 111-6  
 HOLE No. 7  
 FEUILLE No. 1  
 SHEET No. 1  
 SECTION

MINISTÈRE DES MINES, QUÉBEC - DEPARTMENT OF MINES, QUEBEC

**JOURNAL DES SONDAGES AU DIAMANT - DIAMOND DRILL RECORD**

COORDONNÉES ORIFICE  
 CO-ORDINATES COLLAR

ORIENTATION  
 BEARING E. 4° S.

COMMENCÉ LE  
 DATE BEGUN April 16, 1959

LAT. 450 N. DEP. 49 W.

ANGLE 35

TERMINÉ LE  
 DATE FINISHED April 16, 1959

ELEVATION, ORIFICE  
 ELEVATION, COLLAR

PROFONDEUR TOTALE  
 TOTAL DEPTH 57

JOURNAL PAR  
 LOGGED BY W. N. Ingham

CAROTTE CORE FOOTAGE		DESCRIPTION	ECHANTILLON NO SAMPLER NO	DE FROM	A TO	LONGUEUR LENGTH	ANALYSE, ONCES D'OR PAR TONNE ASSAY, OUNCES GOLD PER TON	
DE FROM	A TO							
0	3	Casing						
3	34	Pegmatite and pegmatitic granite. 13.5 - 15.0 - Greywacke						
34	57	Greywacke.  Hole entered greywacke intrusion in the pegmatite so was stepped.  57 - End Hole						

*W. N. Ingham*

TERRAIN  
PROPERTY

Lindsay Explorations Limited McTavish Township

MINISTÈRE DES MINES, QUÉBEC - DEPARTMENT OF MINES, QUEBEC

**JOURNAL DES SONDAGES AU DIAMANT - DIAMOND DRILL RECORD**

111-6  
TROU No. \_\_\_\_\_  
HOLE No. 8  
FEUILLE No. \_\_\_\_\_  
SHEET No. 1  
SECTION \_\_\_\_\_

COORDONNÉES ORIFICE  
CO-ORDINATES COLLAR

ORIENTATION  
BEARING E. 4° S.

COMMENCÉ LE  
DATE BEGUN April 17, 1959

LAT. 450 N DEP. 48. E.

ANGLE 28°

TERMINÉ LE  
DATE FINISHED April 18, 1959

ELEVATION, ORIFICE  
ELEVATION, COLLAR

PROFONDEUR TOTALE  
TOTAL DEPTH 189

JOURNAL PAR  
LOGGED BY W. N. Ingham

CAROTTE CORE FOOTAGE		DESCRIPTION	ECHANTILLON NO SAMPLE NO	DE FROM	A TO	LONGUEUR LENGTH	ANALYSE, ONCES D'OR PAR TONNE ASSAY, OUNCES GOLD PER TON
DE FROM	A TO						
0	4	Casing					
4	38	Pegmatite and pegmatitic granite 24: Little molybdenite 37.5 " "					
38	78	Greywacke intrusion					
78	82.5	Pegmatite, Few flakes of molybdenite					
82.5	89	Greywacke intrusion					
89	160	Pegmatite and pegmatitic granite 89-93: Few flakes of molybdenite 93-97: About 50% vein, 35% pegmatite, and 15% massive  <u>Molybdenite 7.0 feet assays 16.63% molybdenite at footage 93 to 100</u>  97 - 100: Few Splashes molybdenite 100-110 : Few splashes molybdenite 110 - 118.5 Few splashes molybdenite					

*W. N. Ingham*

Lindsay Explorations Limited McEavish Township  
 MINISTÈRE DES MINES, QUÉBEC - DEPARTMENT OF MINES, QUEBEC  
**JOURNAL DES SONDAGES AU DIAMANT - DIAMOND DRILL RECORD**

111-6  
 TROU No. ....  
 HOLE No. .... 8  
 FEUILLE No. ....  
 SHEET No. .... 2  
 SECTION .....

COORDONNÉES ORIFICE  
 CO ORDINATES COLLAR

ORIENTATION  
 BEARING

COMMENCÉ LE  
 DATE BEGUN

LAT. .... DEP. ....

ANGLE .....

TERMINÉ LE  
 DATE FINISHED

ELEVATION, ORIFICE  
 ELEVATION, COLLAR

PROFONDEUR TOTALE  
 TOTAL DEPTH ..... 189

JOURNAL PAR  
 LOGGED BY W. N. Ingham

CAROTTE CORE FOOTAGE		DESCRIPTION	ECHANTILLON NO SAMPLE NO	DE FROM	A TO	LONGUEUR LENGTH	ANALYSE, ONCE D'OR PAR TONNI ASSAY, OUNCE GOLD PER TON
DE FROM	A TO						
		126.5: Splashes of molybdenite in quartz stringers					
160	182	Greywacke, Stringers of pegmatite					
182	184	Pegmatite					
184	189	Greywacke with stringers of pegmatite along core.					
		Hole entered open seam at 184, and caving prevented further drilling unless cemented so stopped					
		189 - End Hole					
			W. N. Ingham				

TERRAIN  
PROPERTY

Lindsay Explorations Limited McTevish Township

MINISTÈRE DES MINES, QUÉBEC - DEPARTMENT OF MINES, QUEBEC

**JOURNAL DES SONDAGES AU DIAMANT - DIAMOND DRILL RECORD**

111-4  
TROUGH No. \_\_\_\_\_  
HOLE No. 9

FEUILLE No. \_\_\_\_\_  
SHEET No. 1

SECTION \_\_\_\_\_

COORDONNÉES ORIFICE  
CO-ORDINATES COLLAR

LAT. 650 N. DEP. 90 E.

ELEVATION, ORIFICE  
ELEVATION, COLLAR

ORIENTATION  
BEARING

W. 4° N.

ANGLE 65

PROFONDEUR TOTALE  
TOTAL DEPTH

97

COMMENCÉ LE  
DATE BEGUN

April 19, 1959

TERMINÉ LE  
DATE FINISHED

April 20, 1959

JOURNAL PAR  
LOGGED BY

W. N. Ingham

CAROTTE CORE FOOTAGE		DESCRIPTION	ECHANTILLON NO SAMPLE NO	DE FROM	A TO	LONGUEUR LENGTH	ANALYSE, ONCES D'OR PAR TONNE ASSAY, OUNCES GOLD PER TON	
DE FROM	A TO							
0	13	Casing						
13	31	Greywacke						
31	84	Pegmatite and pegmatitic granite						
		51: Several flakes molybdenite						
		73-74; Lost core						
		71-75: Core along quartz veinlet.						
84	97	Greywacke.						
		97 - End Hole						

*W. N. Ingham*



Lindsay Explorations Limited McTavish Township

MINISTÈRE DES MINES, QUÉBEC - DEPARTMENT OF MINES, QUEBEC

**JOURNAL DES SONDAGES AU DIAMANT - DIAMOND DRILL RECORD**

TROU No. 111-4  
HOLE No. 11  
FEUILLE No. 1  
SHEET No. 1  
SECTION

COORDONNÉES ORIFICE  
COORDINATES COLLAR

EAT. 1000N. DEP. 100 F.

ELEVATION, ORIFICE  
ELEVATION, COLLAR

ORIENTATION  
BEARING W. 4° N.

ANGLE 45

PROFONDEUR TOTALE  
TOTAL DEPTH 100

COMMENCÉ LE  
DATE BEGUN April 23, 1959

TERMINÉ LE  
DATE FINISHED April 25, 1959

JOURNAL PAR  
LOGGED BY W. N. Ingham

CAROTTE CORE FOOTAGE		DESCRIPTION	ECHANTILLON NO SAMPLE NO	DE FROM	A TO	LONGUEUR LENGTH	ANALYSE, ONCES D'OR PAR TONNE ASSAY, OUNCES GOLD PER TON	
DE FROM	A TO							
0	6	Casing						
6	67	Greywacke, Several six inch quartz veinlets with sparse pyrite						
67	89	Pegmatite						
		68 - 69: Fair Molybdenite						
89	100	Greywacke						
		100 - End Hole						

*W. N. Ingham*



TERRAIN  
PROPERTY Lindsay Explorations Limited, , McTavish Township

MINISTÈRE DES MINES, QUÉBEC - DEPARTMENT OF MINES, QUEBEC

**JOURNAL DES SONDAGES AU DIAMANT - DIAMOND DRILL RECORD**

TROU No. 1114  
HOLE No. 12  
FEUILLE No. 1  
SHEET No. 1

SECTION

COORDONNÉES ORIFICE  
CO-ORDINATES COLLAR

ORIENTATION  
BEARING N. 85. W.

COMMENCÉ LE  
DATE BEGUN April 26, 1959

EAT. 1850 N. DEP. 100 E.

ANGLE 45

TERMINÉ LE  
DATE FINISHED April 27, 1959

ELEVATION, ORIFICE  
ELEVATION, COLLAR

PROFONDEUR TOTALE  
TOTAL DEPTH 84

JOURNAL PAR  
LOGGED BY W. N. Ingham

CAROTTE CORE FOOTAGE		DESCRIPTION	ECHANTILLON NO SAMPLE NO	DE FROM	A TO	LONGUEUR LENGTH	ANALYSE, ONCES D'OR PAR TONNE ASSAY, OUNCES GOLD PER TON
DE FROM	A TO						
0	20	Casing					
20	52	Greywacke					
52	64	Pegmatite and pegmatitic granite at 62 and 63 molybdenite in fractures					
64	84	Greywacke 72 - 73 pegmatite  End Hole					

W. N. Ingham

TERRAIN  
PROPERTY Lindsay Explorations Limited McTavish Township

MINISTÈRE DES MINES, QUÉBEC - DEPARTMENT OF MINES, QUEBEC

### JOURNAL DES SONDAGES AU DIAMANT - DIAMOND DRILL RECORD

TROU No. 111-4  
HOLE No. 13  
FEUILLE No.  
SHEET No. 1

SECTION

COORDONNÉES ORIFICE  
CO-ORDINATES COLLAR

LAT. 2250 N. DEP. 100E.

ELEVATION, ORIFICE  
ELEVATION, COLLAR 10 Ft. below outcrop  
of dyke

ORIENTATION  
BEARING N. 79 W.

ANGLE 45

PROFONDEUR TOTALE  
TOTAL DEPTH 75

COMMENCÉ LE  
DATE BEGUN April 27, 1959

TERMINÉ LE  
DATE FINISHED April 28, 1959

JOURNAL PAR  
LOGGED BY W. N. Ingham

CAROTTE CORE FOOTAGE		DESCRIPTION	ECHANTILLON NO SAMPLE NO	DE FROM	A TO	LONGUEUR LENGTH	ANALYSE, ONCES D'OR PAR TONNE ASSAY, OUNCES GOLD PER TON
DE FROM	A TO						
0	21	Casing					
21	23	Greywacke					
23	34	Pegmatite ( 11 ) at 28.5 - 33.5 - Few molybdenite flakes					
34	38	Granite					
38	41	Pegmatite ( 3 )					
41	55	Granite					
55	66	Pegmatite ( 11 )					
66	75	Greywacke					

End Hole

W. N. Ingham

Ingham



TERRAIN  
PROPERTY

Lindsay Explorations Limited McTavish Township

MINISTÈRE DES MINES, QUÉBEC - DEPARTMENT OF MINES, QUEBEC

**JOURNAL DES SONDAGES AU DIAMANT - DIAMOND DRILL RECORD**

111-4  
TROU No. \_\_\_\_\_  
HOLE No. 14  
FEUILLE No. \_\_\_\_\_  
SHEET No. 1

SECTION \_\_\_\_\_

COORDONNÉES ORIFICE  
CO-ORDINATES COLLAR

LAT. 2175N DEP. 100E

ÉLÉVATION, ORIFICE  
ELEVATION, COLLAR 12 feet below outcrop of  
dyke

ORIENTATION  
BEARING

N. 69° W.

ANGLE 45°

PROFONDEUR TOTALE  
TOTAL DEPTH

67

COMMENCÉ LE  
DATE BEGUN

April 28, 1959

TERMINÉ LE  
DATE FINISHED

April 30, 1959

JOURNAL PAR  
LOGGED BY

W. N. Ingham

CAROTTE CORE FOOTAGE		DESCRIPTION	ECHANTILLON NO SAMPLE NO	DE FROM	A TO	LONGUEUR LENGTH	ANALYSE, ONCES D'OR PAR TONNE ASSAY, OUNCES GOLD PER TON	
DE FROM	A TO							
0	20	Casing						
20	21	Greywacke schist						
21	29	Pegmatite						
29	39	Granite						
39	51	Pegmatite						
51	67	Greywacke						
		End Hole						

W. N. Ingham

TERRAIN  
PROPERTY

Lindsay Explorations Limited,, McTavish Township

MINISTÈRE DES MINES, QUÉBEC - DEPARTMENT OF MINES, QUEBEC

**JOURNAL DES SONDAGES AU DIAMANT - DIAMOND DRILL RECORD**

111-6  
TROU No. \_\_\_\_\_  
HOLE No. 15  
FEUILLE No. \_\_\_\_\_  
SHEET No. 1  
SECTION \_\_\_\_\_

COORDONNÉES ORIFICE  
CO ORDINATES COLLAR

LAT. 2450 N. DEP. 100 E.

ELEVATION, ORIFICE  
ELEVATION, COLLAR

ORIENTATION  
BEARING

N. 79° W.

ANGLE 45°

PROFONDEUR TOTALE  
TOTAL DEPTH

92

COMMENCÉ LE  
DATE BEGUN

April 30, 1959

TERMINÉ LE  
DATE FINISHED

May 3, 1959

JOURNAL PAR  
LOGGED BY

W. N. Ingham

CAROTTE CORE FOOTAGE		DESCRIPTION	ECHANTILLON NO SAMPLE NO	DE FROM	A TO	LONGUEUR LENGTH	ANALYSE, ONCES D'OR PAR TONNE ASSAY, OUNCES GOLD PER TON
DE FROM	A TO						
0	22	Casing					
22	25	Grey Granite					
25	29	Grey Pegmatite					
29	92	Greywacke Schist					
		Several stringers and dykelets of pegmatite and vein quartz with sparse pyrite.					
		End Hole					

*W. N. Ingham*

TERRAIN PROPERTY Lindsay Explorations Limited McTavish Township

111-4  
 TROU No. \_\_\_\_\_  
 HOLE No. 16  
 FEUILLE No. \_\_\_\_\_  
 SHEET No. 1  
 SECTION \_\_\_\_\_

MINISTÈRE DES MINES, QUÉBEC - DEPARTMENT OF MINES, QUEBEC

JOURNAL DES SONDAGES AU DIAMANT - DIAMOND DRILL RECORD

COORDONNÉES ORIFICE  
 CO-ORDINATES COLLAR

ORIENTATION  
 BEARING N. 79° W.

COMMENCÉ LE  
 DATE BEGUN May 4, 1959

LAT. 2000 N. DEP. 100 E.

ANGLE 45

TERMINÉ LE  
 DATE FINISHED May 7, 1959

ELEVATION, ORIFICE  
 ELEVATION, COLLAR \_\_\_\_\_

PROFONDEUR TOTALE  
 TOTAL DEPTH 150

JOURNAL PAR  
 LOGGED BY W. N. Ingham

CAROTTE CORE FOOTAGE		DESCRIPTION	ECHANTILLON NO SAMPLE NO	DE FROM	A TO	LONGUEUR LENGTH	ANALYSE, ONCES D'OR PAR TONNE ASSAY, OUNCES GOLD PER TON
DE FROM	A TO						
0	18	Casing					
18	47	Greywacke Schist					
47	90	Pegmatite and pegmatitic granite ( 43 feet )  Includes 54 - 58 greywacke at 85.5 : Patch of molybdenite flakes.					
90	150	Greywacke Schist  124 - 127 : Grey Pegmatite  146 - 147 : Grey Granite  End Hole					

*W. N. Ingham*

TERRAIN PROPERTY Lindsey Explorations Limited McTavish Township

TROU No. 111-4  
HOLE No. 17

MINISTÈRE DES MINES, QUÉBEC - DEPARTMENT OF MINES, QUÉBEC

FEUILLE No. 1  
SHEET No. 1

**JOURNAL DES SONDAGES AU DIAMANT - DIAMOND DRILL RECORD**

SECTION \_\_\_\_\_

COORDONNÉES ORIFICE  
CO-ORDINATES COLLAR

ORIENTATION  
BEARING N. 75 W.

COMMENCÉ LE  
DATE BEGUN May 9, 1959

LAT. 1650 N. DEP. 75 E.

ANGLE 45°

TERMINÉ LE  
DATE FINISHED May 12, 1959

ELEVATION, ORIFICE  
ELEVATION, COLLAR \_\_\_\_\_

PROFONDEUR TOTALE  
TOTAL DEPTH 75

JOURNAL PAR  
LOGGED BY W. N. Ingham

CAROTTE CORE FOOTAGE		DESCRIPTION	ECHANTILLON NO SAMPLE NO	DE FROM	A TO	LONGUEUR LENGTH	ANALYSE, ONCES D'OR PAR TONNE ASSAY, OUNCES GOLD PER TON
DE FROM	A TO						
0	7	Casing					
7	44	Greywacke					
44	59	Pegmatite					
		46: Flakes of molybdenite in quartz-rich section					
59	75	Greywacke					
		End Hole					

*W. N. Ingham*

TERRAIN PROPERTY Lindsay Explorations Limited McTavish Township

111-6  
TROU No. HOLE No. 18  
FEUILLE No. SHEET No. 1  
SECTION

MINISTÈRE DES MINES, QUÉBEC - DEPARTMENT OF MINES, QUÉBEC

JOURNAL DES SONDAGES AU DIAMANT - DIAMOND DRILL RECORD

COORDONNÉES ORIFICE  
CO-ORDINATES COLLAR

ORIENTATION  
BEARING Vertical

COMMENCÉ LE  
DATE BEGUN May 13, 1959

LAT. 450 N. DEP. 275 E.

ANGLE Vertical

TERMINÉ LE  
DATE FINISHED May 16, 1959

ELEVATION, ORIFICE  
ELEVATION, COLLAR

PROFONDEUR TOTALE  
TOTAL DEPTH 322

JOURNAL PAR  
LOGGED BY W. N. Ingham

CAROTTE CORE FOOTAGE		DESCRIPTION	ECHANTILLON NO SAMPLE NO	DE FROM	A TO	LONGUEUR LENGTH	ANALYSE, ONCES D'OR PAR TONNE ASSAY, OUNCES GOLD PER TON
DE FROM	A TO						
0	3	Casing					
3	112	Greywacke					
112	176	Pegmatite, pegmatitic granite					
		112: Molybdenite in quartz rich section.					
		163: " " " " "					
176	216	Greywacke					
216	227	Pegmatite. 223 - 225 : Quartz vein.					
227	322	Greywacke					
		296 - 297 : Pegmatitic quartz.					
		End Hole					

*W. N. Ingham*

APPENDIX

DIAMOND DRILL LOGS OF 1967 DRILL HOLES

- A1-2
- B1-5
- C1-8
- D1
- E1-3

All of the core from the above 19 holes is NX in size and was logged by D.D. Campbell on Aug. 9, 1967. The following logs are grouped by the showings on which they were located.



DIAMOND DRILLING  
CLAIM # TB 91738

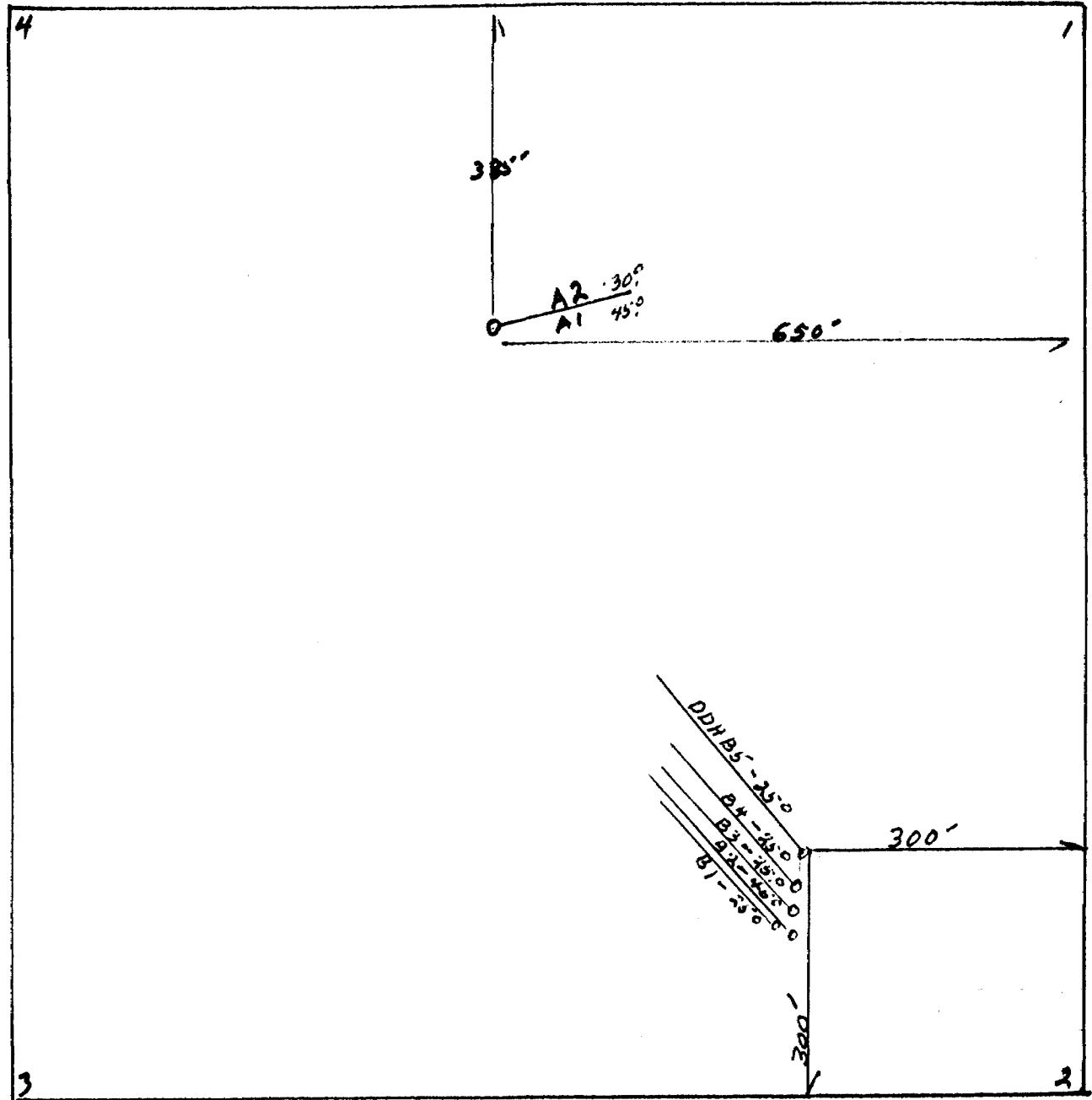

WESTERN PEGMATITE

DDH A1-A2

Location: 11 + 50N, 25E

Bearing: 80°

Inclination: A1 = -45°, A2 = -30°.

From	To	Formation	Description
<u>DH A1</u>			
0	6	GREENSTONE	Dark green, hard, foliated (20° to core), fine-medium crystalline biotite-hornblende phyllite. Contact @ 6' broken up.
6	70 ✓ END	PEGMATITE	Pink and brick red, hard, fresh, coarsely crystalline pegmatite and granitic phases gradational into one another. White and pink feldspar, watery quartz and minor muscovite, all holocrystalline. (45-55) - Zone of irregular 4"-6" quartz veins. Fractures - Mn-stained fractures @ 45° every 6" to 2'. Recovery - Generally good but core ground every 5 ft. or so and all fractures open. Molybdenite - None visible. (60-70) - Split and sampled = Trace.
<u>DH A2</u>			
0 10	10 50.5	CASING GREENSTONE	Finely foliated, (0° - 45° to core), biotite-hornblende rock gradational with fine grained, massive, gray-green, hard, siliceous arkosic rock. Pegmatitic quartz vein @ 20-20.5 Contact at 50.5 is sharp @ 35° to core.

From	To	Formation	Description
50.5	77.6	GRANITIC PEGMATITE	Pink and deep red, intergradational pegmatite and coarse granite. As hole A1.
	END		Core not as broken and ground as in A1 but still ground. Fractures - Generally open and black coated @ 45° - 60°. Molybdenite - Fine specks on fracture (45°) @ 73'. Otherwise none visible. (55-60) - Trace. (65-70) - Trace.

MIDDLE BELT SHOWING

DDH B1-B5

Location: 3 + 50 - 4 + 00N, 550E.

Bearing: (All holes) 325°

Inclination: ( " " ) -25°

From	To	Formation	Description
<u>DH B1</u>			
0	5	CASING	
5	25	PEGMATITIC GRANITE	Mostly pink, hard, coarsely crystalline quartz-orthoclase granite, with gradational (minor) pegmatitic phases. No quartz veins. Fractures - Mostly open @ 45° and widely spaced. Molybdenite - None visible but more fractures @ 15'-20'. 10-15 - 0.01 MoS2 15-20 - 0.07 " 20-25 - 0.02 "
25	69.5	GREENSTONE	As in DH A2. Foliation at 30° - 45°. Contact @ 25 ft. frozen tight @ 20° to core.
		END	
<u>DH B2</u>			
0	12	CASING	
12	13	GREENSTONE	Foliated biotite-hornblende
13	31.5	GRANITE	Mostly coarsely crystalline, uniform, granite (pink) with isolated nests of pegmatitic phases. No significant fractures. No visible molybdenite. (13-31.5) = Trace.
31.5	51.5	GREENSTONE	Fairly consistently foliated (35°-45° to core), biotite-hornblende rock. Isolated patches and stringers of pegmatite along foliation.
		END	

From	To	Formation	Description
<u>DH B3</u>			
0	8	CASING	
8	15.5	GREENSTONE	Finely banded (50°) and foliated hornblende-biotite rock. Contact broken.
15.5	31.5	PEGMATITE GRANITE	About 1/2 coarse, pink granite and 1/2 gradational pegmatite, (pink and white, not brick red). Core broken 6" core lost (26.2 - 26.7). <u>Molybdenite</u> - coarse rosettes @ 26.2' Core = (14-20) - Trace. (20-25) - 0.04% MoS2 (25-26.2)-0.34 (26.7-30)-0.02 (30-31.7)-0.22
31.5	37	GREENSTONE	As (8-15.5).
		END	
<u>DH B4</u>			
0	7	CASING	
7	21	GREENSTONE	Finely crystalline, finely foliated (45° to core), biotite-hornblende metasediment with scattered narrow bands of black-green hornblendite.
21	30	PEGMATITE-GRANITE	Coarse granite and gradational pegmatite bands which comprise about 20% of rock. Contacts are broken but appear to be about 20°. Core unfractured. Molybdenite - None visible. (20-21) - Trace, (21-25) = 0.08% MoS2, (25-30) = 0.04% MoS2, - Sludge - (21-30) = 0.08, (30-40) = Trace.
30	64.8	GREENSTONE	As (7-21)
		END	

From	To	Formation	Description
<u>DH B5</u>			
0	8.7	CASING	
8.7	20	GREENSTONE	Foliated and fine banded (20°), hard, feldspathic metasediment.
20	22.5	GRANITE	Uniform, massive, pink, coarse crystalline granite.
22.5	30	GREENSTONE	As (8.7-20)
30	42.5	PEGMATITE-GRANITE	About 1/2 coarse pink pegmatite gradational with coarse granite. Contacts broken. Few scattered fractures @ 70°. <u>Molybdenite</u> - None visible, but black wisps are common. Core - (30-35) = 0.17, (35-40) = 0.03, (40-42.3) = Trace, 6" quartz vein @ 32°. Sludge - 30.-36.6 = 0.27 26.6-40.5 = 0.03 40.5-52 = Nil
42.5	52	GREENSTONE	As (8.7-20)

END

DIAMOND DRILLING  
CLAIM #TB912KA

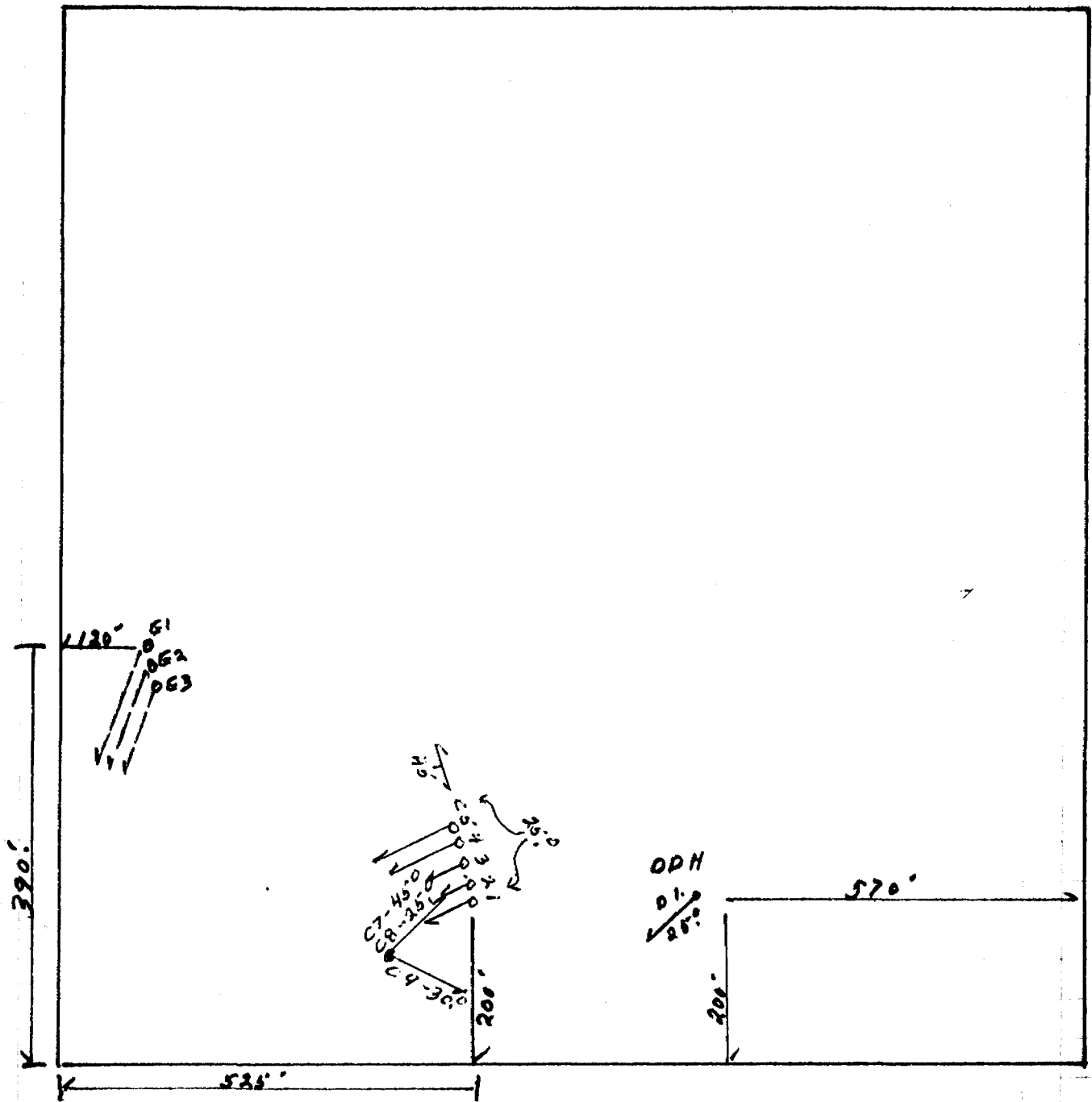

EASTERN SHOWINGS

DDH's C1 - C6

Location: 3+50N - 4+00N, 1450E

Bearing: (All holes): 245°

Inclination: ( " " ): -25°.

From	To	Formation	Description
------	----	-----------	-------------

DH C1

0	8	CASING	
8	34	PEGMATITE	

Pale pink, fine and very coarse crystalline orthoclase-quartz-muscovite pegmatite with minor granitic phases. No significant fractures.

Molybdenite - Fairly commonly disseminated as small books and flakes in or with quartz nests or veinlets.

Visible moly @ 11, 22, rest has fine black wisps.

<u>Core-</u>	(7-10)	Trace
	(10-15)	0.03 % MoS2
	(15-20)	0.02 " "
	(20-21.3)	Trace
	(21.3-25)	0.08 " "
	(25-26.7)	0.03 " "
	(26.7-34.2)	Trace

<u>Sludge-</u>	(7-10)	0.02 % MoS2
	(10-20)	0.04
	(20-30)	0.06
	(30-40)	0.01

34	43	GREENSTONE	
----	----	------------	--

Vaguely foliated, dense, solid, fine crystalline hornblende-biotite rock.

DH C2

0	7	CASING	
7	9	GREENSTONE	
9	32.5	PEGMATITE	

(Mostly pegmatite)

Medium crystalline hornblende-biotite.

Pale pink, uniform, medium crystalline pegmatite to very coarse granite. Not significantly fractured.

Molybdenite - Few scattered small books.

Visible @ 20<sup>x</sup>.

<u>Core</u>	(12.3-17.3)	Trace	<u>Sludge</u> (7-19)	0.02
	(17.3-20)	0.04	(19-30)	0.03
	(20-25)	0.02	(30-40)	Trace
	(25-32.4)	Trace.		



From	To	Formation	Description
32.5	44.8	GREENSTONE	As (7-9)
		END	
<u>DH C3</u>			
0	5	PEGMATITE	Pale pink, coarse-fine crystalline pegmatite. Hard, unbroken with very sparse quartz patches. Fracture parallel to hole from 25' to 27' appears to have fine moly coating with manganese. Core (15-17) 0.01% MoS <sub>2</sub> Sludge ( 5-15) 0.02 (17-20) 0.22 (15-26) 0.15 (20-30) Trace (26-36) Nil
27	36	GREENSTONE	Fine to medium crystalline, black green, massive hornblendic rock.
		END	
<u>DH C4</u>			
0	4	CASING	
4	25	PEGMATITE-GRANITE	About 50% fine crystalline pale pink granite and 50% gradational coarse pegmatite. Scattered fractures @ 90° to core. Contact @ 25' broken and rusty. Molybdenite - None visible. Core - ( 4-27.5) Trace Sludge ( 5-10 ) 0.02 (10-35 ) Trace
25	30	GREENSTONE	Generally massive, finely crystalline, hard, hornblende-biotite.
		END	

From	To	Formation	Description																								
<u>DH C5</u>																											
0	2	CASING																									
2	25.5	PEGMATITE-GRANITE	<p>Pale pink to bright pink, coarse pegmatite and fine granite, 50/50. Contact at 45°                      Few fractures at 45° are rusty.                      Molybdenite - Few tiny specks visible.</p> <table border="0"> <tr> <td>Core ( 2.9-22.8</td> <td>Trace</td> <td></td> <td></td> </tr> <tr> <td>(22.8-25.5)</td> <td>Nil</td> <td></td> <td></td> </tr> <tr> <td>Sludge ( 0-10</td> <td>Trace</td> <td></td> <td></td> </tr> <tr> <td>(10-20)</td> <td>0.02</td> <td></td> <td></td> </tr> <tr> <td>(20-30)</td> <td>Nil</td> <td></td> <td></td> </tr> </table>	Core ( 2.9-22.8	Trace			(22.8-25.5)	Nil			Sludge ( 0-10	Trace			(10-20)	0.02			(20-30)	Nil						
Core ( 2.9-22.8	Trace																										
(22.8-25.5)	Nil																										
Sludge ( 0-10	Trace																										
(10-20)	0.02																										
(20-30)	Nil																										
25.5	35	GREENSTONE	Very massive, hard, fine crystalline hornblende-biotite rock impregnated by fine red veinlets of pink orthoclase.																								
	END																										
<u>DH C6</u>																											
0	8.5	CASING																									
8.5	35	PEGMATITE	<p>Fairly coarse, uniform, pale pink orthoclase-quartz. Muscovite pegmatite with minor granite. Frozen contact @ 35 ft. @ 70°.                      No significant fractures.                      Molybdenite - Few fine flakes at 18 ft.                      Black wisps to 25'.</p> <table border="0"> <tr> <td>Core (8.5-12.1)</td> <td>Trace</td> <td>Sludge (9-20)</td> <td>0.05</td> </tr> <tr> <td>(12.1-17.2)</td> <td>0.03</td> <td>(20-30)</td> <td>0.07</td> </tr> <tr> <td>(17.2-22.1)</td> <td>Nil</td> <td>(30-40)</td> <td>Trace</td> </tr> <tr> <td>(22.1-25)</td> <td>0.08</td> <td></td> <td></td> </tr> <tr> <td>(25-27.5)</td> <td>0.12</td> <td></td> <td></td> </tr> <tr> <td>(27.5-35)</td> <td>0.01</td> <td></td> <td></td> </tr> </table>	Core (8.5-12.1)	Trace	Sludge (9-20)	0.05	(12.1-17.2)	0.03	(20-30)	0.07	(17.2-22.1)	Nil	(30-40)	Trace	(22.1-25)	0.08			(25-27.5)	0.12			(27.5-35)	0.01		
Core (8.5-12.1)	Trace	Sludge (9-20)	0.05																								
(12.1-17.2)	0.03	(20-30)	0.07																								
(17.2-22.1)	Nil	(30-40)	Trace																								
(22.1-25)	0.08																										
(25-27.5)	0.12																										
(27.5-35)	0.01																										
35	47	GREENSTONE	Black green, medium crystalline hornblendic rock with faint red feldspar banding @ 35° to core.																								
	END																										

EASTERN SHOWINGS

DDH's C7 - C9

Location: 2+80N, 1440E.  
Bearing: C7-8, 135°; C9, 45°.  
Inclination: C7, -45°; C8, -25°; C9, -30°.

From	To	Formation	Description
<u>DH C7</u>			
0	4	CASING	
4	26 ✓	GREENSTONE	Medium-fine crystalline, vaguely foliated (40°), hornblende-biotite-pink feldspar.
		END	
<u>DH C8</u>			
0	7	CASING	
7	47 ✓	GREENSTONE	As in DH C7 with foliation at 20°.
		END	
<u>DH C9</u>			
0	3.5	CASING	
3.5	20	GREENSTONE	Medium to coarse crystalline, black green, vaguely foliated (45°) hornblendic rock.
20	33	PEGMATITE	Pale pink, uniform, coarse crystalline, feldspar-quartz-muscovite pegmatite. Unfractured. Greenstone (26-27). Contact broken. <u>Molybdenite</u> - not sampled but fine grains @ 32'.
33	64 ✓	GREENSTONE	Well banded and foliated, (30°-45°), medium to fine crystalline hornblende-biotite rock.
		END .	

EASTERN SHOWINGS

DDH's E1 - E3

Location: 6:00N, 975E.

Bearing: (All holes): 210°

Inclination: (" " ): -25°.

From	To	Formation	Description
<u>DH E1</u>			
0	5	CASING	
5	33	PEGMATITE-GRANITE	Gray to bright pink coarse pegmatite and medium crystalline granite. Very solid, unfractured core. Sharp contact @ 45°. <u>Molybdenite</u> - Small specks @ 13.5 ft. and 24 ft.
33	46 ✓	GREENSTONE	Finely banded (20°), hard, fine crystalline, hornblende-biotite rock.
END			
<u>DH E2</u>			
0	5	CASING	
5	30	PEGMATITE-GRANITE	About 3/4 coarse pegmatite and rest is gradational granite. Grayish pink. Practically unfractured. Visible molybdenite in granite @ 16 ft., 18 ft.
30	42 ✓	GREENSTONE	As in DH E1.
END			
<u>DH E3</u>			
0	7	CASING	
7	30	PEGMATITE	Very uniform, solid, pale to deep pink, coarse crystalline pegmatite. Broken contact. <u>Molybdenite</u> - One speck in pegmatite @ 21.5'. None split.
30	41 ✓	GREENSTONE	As in DH E1.
END			

EASTERN SHOWINGS

DDH D1

Location: 3+30N

Bearing: 215°

Inclination: -25°.

From	To	Formation	Description
0	5	CASING	
5	28	PEGMATITE	Very good, pale pink, coarse pegmatite (orthoclase, muscovite, quartz). No significant fractures. Split but not assayed. No visible moly.
28	82	GREENSTONE	Feldspathic, foliated hornblende-rock.

END