

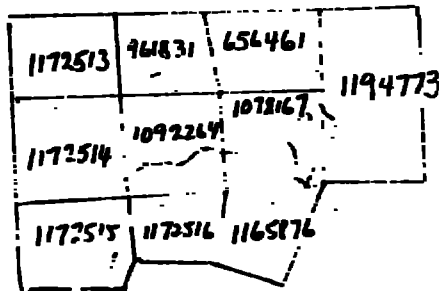

2.15719

MY BLOCK OF CLAIMS IS SHOWN HERE.  
WORK ON 656461 DESCRIBED  
IN THIS REPORT IS ASSIGNED  
TO 1172516 1172515 1172514 1172513



THIS LINE IS THE NORTHERN  
BOUNDARY OF SHUNAH



SCALE 1/2" = 1/4 MILE

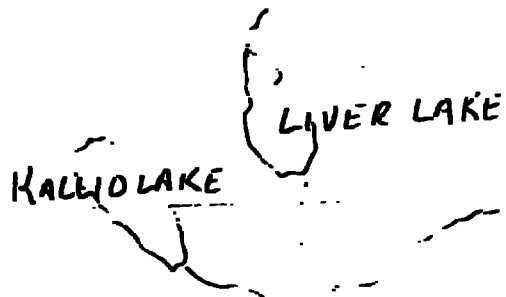

SCHEDULE OF PERSONS WHO WORKED  
 COMPILED BY MICHAEL GRIEVE, 22 KNIGHT ST  
 SEPT 19 TO SEPT 29 1994, ON TB656461,  
 SHOWN ON ATTACHED MAP

DATE	HOURS WORKED	WORKERS	TOTAL VALUE	TYPE OF WORK	EQUIPMENT USED
SEPT 24	8 AM - 5 PM	MICHAEL GRIEVE	\$ 200.	PREP. FOR STRIPPING	CHAINSAW HAND TOOLS, RIBBON
"	"	MICHAEL GRIEVE JR			
SEPT 25	8 AM - 5 PM	MICHAEL GRIEVE	\$ 200.	"	"
"	"	MICHAEL GRIEVE JR			
SEPT 28	8 AM - 6 PM	MICHAEL GRIEVE	\$ 225	FIELD SUPERVISION	"
"	"	MICHAEL GRIEVE JR			
"	"	BEN PYTHILA *			
SEPT 29	7 AM - 7 PM	MICHAEL GRIEVE	\$ 275	FIELD SUPERVISION	HAND TOOLS
"	"	MICHAEL GRIEVE JR			
"	"	BEN PYTHILA *			

\* HIS COST IS INCLUDED  
 IN CONTRACTOR FEE  
 FOR TWO DAYS, WHICH  
 TOTALLED \$ 1819.

CLAIM TR 656461

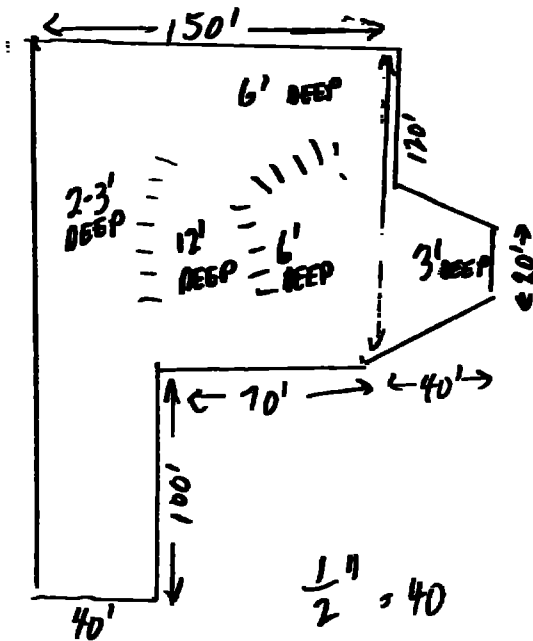
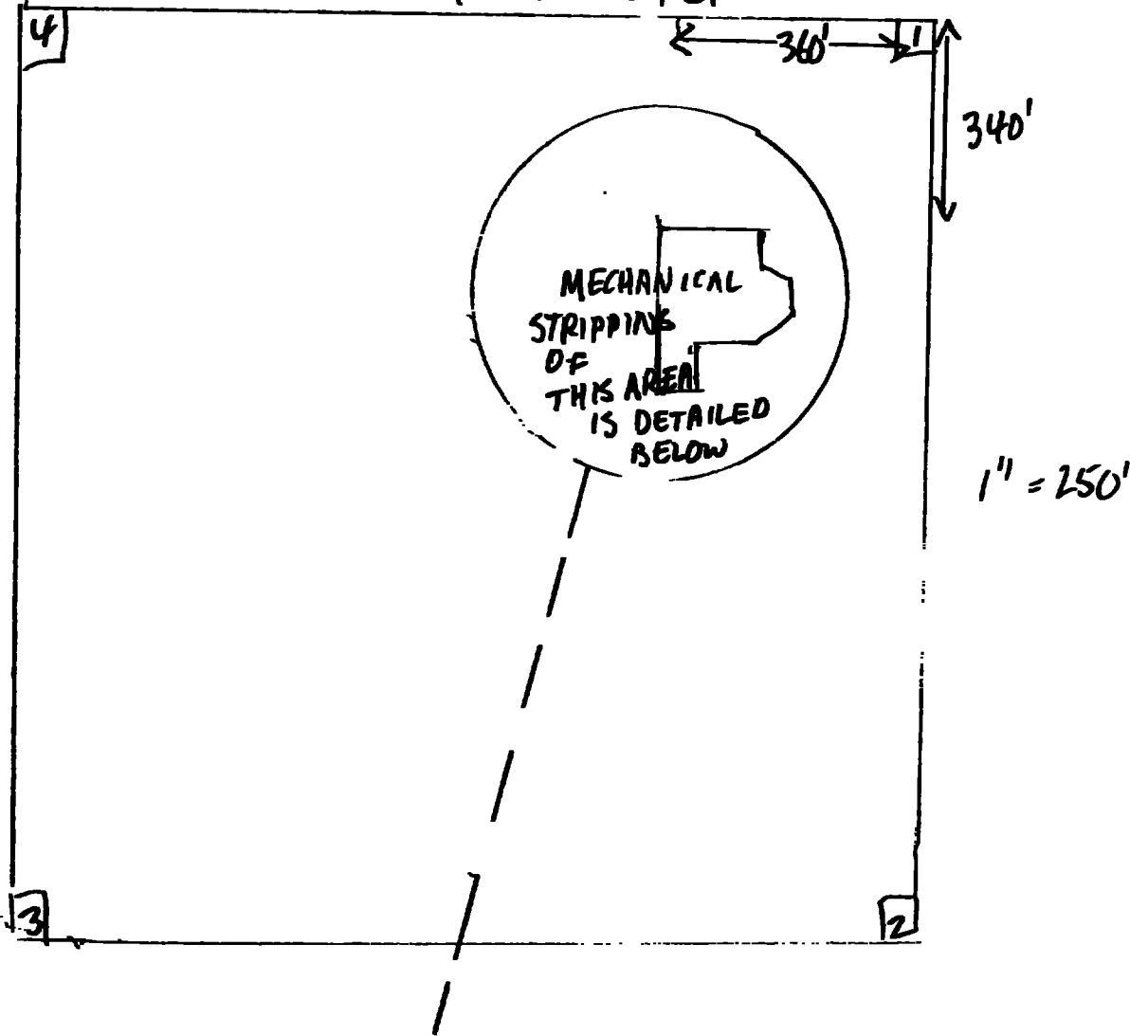

## NATURE OF ROCKS, TERRAIN :

AMETHYST IS FOUND IN GRANITE BENEATH  
LIGHT OVERBURDEN. TERRAIN FEATURES  
STEEP, RUGGED HILLS.



**SHUNIAH FOREST  
PRODUCTS LIMITED**

1450 WEST WALSH STREET, THUNDER BAY, ONTARIO P7E 6H6 PHONE (807) 475-7029

October 4, 1994

Michael and Sandra Grieve  
22 Knight Street  
Thunder Bay, Ontario  
P7A 5M2

**\*\* INVOICE \*\***

Bulldozer & Operator 20 hrs @ \$75.00/hr	\$ 1,500.00
Freighting	\$ 200.00
G.S.T. (R104845896)	\$ 119.00
<b>TOTAL CHARGES</b>	<b><u>\$ 1,819.00</u></b>

*Paid in full  
P. Munnick*

**Report of Work Conducted After Recording Claim**

Transaction Number  
**W9440-298**

**Mining Act**

Personal information collected on this form is obtained under the authority of the Mining Act. This information will be used for correspondence. Questions about this collection should be directed to the Provincial Manager, Mining Lands, Ministry of Northern Development and Mines, Fourth Floor, 159 Cedar Street, Sudbury, Ontario, P3E 6A5, telephone (705) 670-7264.

- Instructions:**
- Please type or print and submit in duplicate.
  - Refer to the Mining Act and Regulations for Recorder.
  - A separate copy of this form must be complete.
  - Technical reports and maps must accompany this form in duplicate.
  - A sketch, showing the claims the work is assigned to, must accompany this form.



52A10NW0016 2.15719 NORTH OF MCGREGOR

900

Recorded Holder(s) <b>MICHAEL D. GRIEVE</b>		Client No. <b>139553</b>
Address <b>22 KNIGHT ST THUNDER BAY ONT P7A5M2</b>		Telephone No. <b>345-6444</b>
Mining Division <b>THUNDER BAY</b>	Township/Area <b>NORTH OF MCGREGOR</b>	M or G Plan No.
Dates Work Performed From: <b>SEPT 19 1994</b>		To: <b>SEPT 29 1994</b>

**Work Performed (Check One Work Group Only)**

Work Group	Type
Geotechnical Survey	
Physical Work, Including Drilling	<b>MECHANICAL STRIPPING + RELATED LABOR AND SUPERVISION</b>
Rehabilitation	
Other Authorized Work	
Assays	
Assignment from Reserve	



Total Assessment Work Claimed on the Attached Statement of Costs \$ **2837.00**

**Note:** The Minister may reject for assessment work credit all or part of the assessment work submitted if the recorded holder cannot verify expenditures claimed in the statement of costs within 30 days of a request for verification.

**Persons and Survey Company Who Performed the Work (Give Name and Address of Author of Report)**

Name	Address
<b>MICHAEL D. GRIEVE</b>	<b>22 KNIGHT ST THUNDER BAY P7A5M2</b>
<b>MICHAEL D. GRIEVE JR.</b>	" " "
<b>BEN PYHTILA</b>	<b>SHUNIAH FOREST PRODUCTS, 1450 W. WALSH THUNDER BAY P7E6H6</b>

(attach a schedule if necessary)

**Certification of Beneficial Interest \* See Note No. 1 on reverse side**

I certify that at the time the work was performed, the claims covered in this work report were recorded in the current holder's name or held under a beneficial interest by the current recorded holder.	Date <b>NOV 8 1994</b>	Recorded Holder or Agent (Signature) <i>M. D. Grieve</i>
--	---------------------------	---

**Certification of Work Report**

I certify that I have a personal knowledge of the facts set forth in this Work report, having performed the work or witnessed same during and/or after its completion and annexed report is true.

Name and Address of Person Certifying <b>MICHAEL D. GRIEVE</b>		
Telephone No. <b>345-6444</b>	Date <b>NOV 8 1994</b>	Certified by (Signature) <i>M. D. Grieve</i>

**For Office Use Only**

Total Value Cr. Recorded <b>\$2837</b>	Date Recorded	Mining Recorder <i>A. G. Weer</i>	
Deemed Approval Date <b>Feb 6/95</b>	Date Approved		
Date Notice for Amendments Sent			

Work Report Number for Applying Reserve	Claim Number (see Note 2)	Number of Claim Units
	TR 656461	1
	TR 1172513	1
	TR 1172514	1
	TR 1172515	1
	TR 1172516	1
Total Number of Claims		

Value of Assessment Work Done on this Claim	Value Applied to this Claim
\$ 2837	0
0	200.
0	200.
0	200.
0	200.
Total Value Work Done	
Total Value Work Applied	

Value Assigned from this Claim	Reserve: Work to be Claimed at a Future Date
800	\$ 2037
Total Assigned From	
Total Reserve	

Credits you are claiming in this report may be cut back. In order to minimize the adverse effects of such deletions, please indicate from which claims you wish to prioritize the deletion of credits. Please mark (✓) one of the following:

- Credits are to be cut back starting with the claim listed last, working backwards.
- Credits are to be cut back equally over all claims contained in this report of work.
- Credits are to be cut back as prioritized on the attached appendix.

In the event that you have not specified your choice of priority, option one will be implemented.

Note 1: Examples of beneficial interest are unrecorded transfers, option agreements, memorandum of agreements, etc., with respect to the mining claims.

Note 2: If work has been performed on patented or leased land, please complete the following:

I certify that the recorded holder had a beneficial interest in the patented or leased land at the time the work was performed.

Signature W. J. ...

Date NDU 8 1994

*COPY OF TITLE FOR LEASED CLAIM WAS FILED SEPT 8 1992 WITH A WORK*



Statement of Costs for Assessment Credit

État des coûts aux fins du crédit d'évaluation

Mining Act/Loi sur les mines

Transaction No./N° de transaction

Personal information collected on this form is obtained under the authority of the Mining Act. This information will be used to maintain a record and ongoing status of the mining claim(s). Questions about this collection should be directed to the Provincial Manager, Minings Lands, Ministry of Northern Development and Mines, 4th Floor, 159 Cedar Street, Sudbury, Ontario P3E 6A5, telephone (705) 670-7264.

Les renseignements personnels contenus dans la présente formule sont recueillis en vertu de la Loi sur les mines et serviront à tenir à jour un registre des concessions minières. Adresser toute question sur la collecte de ces renseignements au chef provincial des terrains miniers, ministère du Développement du Nord et des Mines, 159, rue Cedar, 4<sup>e</sup> étage, Sudbury (Ontario) P3E 6A5, téléphone (705) 670-7264.

1. Direct Costs/Coûts directs

Type	Description	Amount Montant	Totals Total global
Wages Salaires	Labour Main-d'oeuvre	400	
	Field Supervision Supervision sur le terrain	500	900
Contractor's and Consultant's Fees Droits de l'entrepreneur et de l'expert-conseil	Type 20 HOURS WITH JOHN DEERE 850	1819	
			1819.
Supplies Used Fournitures utilisées	Type		
Equipment Rental Location de matériel	Type		
Total Direct Costs Total des coûts directs			2719.

2. Indirect Costs/Coûts indirects

\*\* Note: When claiming Rehabilitation work indirect costs are not allowable as assessment work. Pour le remboursement des travaux de réhabilitation, les coûts indirects ne sont pas admissibles en tant que travaux d'évaluation.

Type	Description	Amount Montant	Totals Total global
Transportation Transport	Type FOUR TRIPS BY TRUCK OF 79 KM EACH @ 25 CENTS PER KM	79.	
			79.
Food and Lodging Nourriture et hébergement	6 MEALS x 5	30.	30
Mobilization and Demobilization Mobilisation et démobiliation			
Sub Total of Indirect Costs Total partiel des coûts indirects			118
Amount Allowable (not greater than 20% of Direct Costs) Montant admissible (n'excédant pas 20 % des coûts directs)			118
Total Value of Assessment Credit (Total of Direct and Allowable indirect costs) Valeur totale du crédit d'évaluation (Total des coûts directs et indirects admissibles)			2837

Note: The recorded holder will be required to verify expenditures claimed in this statement of costs within 30 days of a request for verification. If verification is not made, the Minister may reject for assessment work all or part of the assessment work submitted.

Note : Le titulaire enregistré sera tenu de vérifier les dépenses demandées dans le présent état des coûts dans les 30 jours suivant une demande à cet effet. Si la vérification n'est pas effectuée, le ministre peut rejeter tout ou une partie des travaux d'évaluation présentés.

Filing Discounts

- Work filed within two years of completion is claimed at 100% of the above Total Value of Assessment Credit.
- Work filed three, four or five years after completion is claimed at 50% of the above Total Value of Assessment Credit. See calculations below:

Total Value of Assessment Credit	Total Assessment Claimed
x 0.50 =	

Remises pour dépôt

- Les travaux déposés dans les deux ans suivant leur achèvement sont remboursés à 100 % de la valeur totale susmentionnée du crédit d'évaluation.
- Les travaux déposés trois, quatre ou cinq ans après leur achèvement sont remboursés à 50 % de la valeur totale du crédit d'évaluation susmentionné. Voir les calculs ci-dessous.

Valeur totale du crédit d'évaluation	Evaluation totale demandée
x 0,50 =	

Certification Verifying Statement of Costs

I hereby certify that the amounts shown are as accurate as possible and these costs were incurred while conducting assessment work on the lands shown on the accompanying Report of Work form.

that as RECORDED HOLDER I am authorized (Recorded Holder, Agent, Position in Company)

to make this certification

Attestation de l'état des coûts

J'atteste par la présente que les montants indiqués sont le plus exact possible et que ces dépenses ont été engagées pour effectuer les travaux d'évaluation sur les terrains indiqués dans la formule de rapport de travail ci-joint.

Et qu'à titre de \_\_\_\_\_ je suis autorisé (titulaire enregistré, représentant, poste occupé dans la compagnie)

à faire cette attestation.

Signature <u>[Signature]</u>	Date NOV 8, 1994
---------------------------------	---------------------



Ministry of  
Northern Development  
and Mines

Ministère du  
Développement du Nord  
et des Mines

**Geoscience Approvals Office**  
933 Ramsey Lake Road  
6th Floor  
Sudbury, Ontario  
P3E 6B5

Telephone: (705) 670-5853  
Fax: (705) 670-5863

January 6, 1995

Our File: 2.15719  
Transaction #W9440.00298

**Mining Recorder**  
Ministry of Northern  
Development and Mines  
435 James Street South  
Suite B003  
Thunder Bay, Ontario

Dear Mr. Weirmeir:

**RE: Approval of Assessment work on mining claim 656461 in the Tartan Lake Area.**

The assessment credits for Physical Work (PSTRIP), section 10 of the Mining Act Regulations, as listed on the original Report of Work, have been approved as of January 6, 1995.

Please indicate this approval on the claim record sheets.

If you have any questions concerning this correspondence please contact Bruce Gates at 670-5856.

ORIGINAL SIGNED BY:

Yours sincerely,

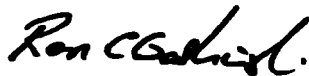

Ron C. Gashinski  
Senior Manager, Mining Lands Section  
Mining and Land Management Branch  
Mines and Minerals Division

 BIG/dl  
Enclosures:

cc: Assessment Files Office ✓  
Sudbury, Ontario

Resident Geologist  
Thunder Bay, Ontario

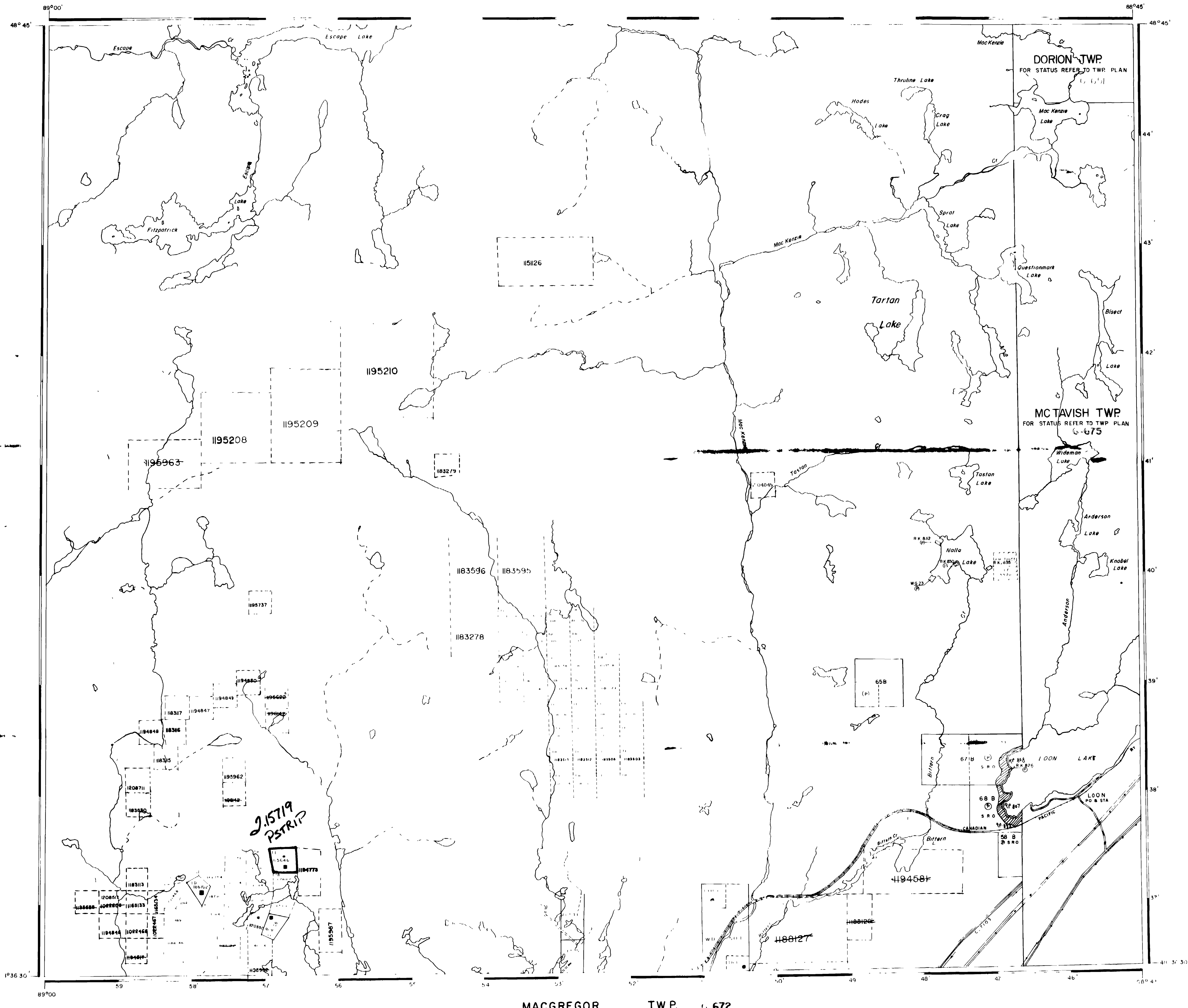

**NOTICE:**  
The information that appears on this map has been compiled from various sources, and accuracy is not guaranteed. Those wishing to stake mining claims should consult with the Mining Recorder, Ministry of Northern Development and Mines, for additional information on the status of the lands shown hereon.

**LEGEND**

PATENTED LAND	Ⓢ
CROWN LAND SALE	CS
LEASES	Ⓛ
LOCATED LAND	LOC
LICENSE OF OCCUPATION	LO
MINING RIGHTS ONLY	MRO
SURFACE RIGHTS ONLY	SRO
ROADS	—
IMPROVED ROADS	—
KING'S HIGHWAYS	—
RAILWAYS	—
POWER LINES	—
MARSH OR MUSKEG	—
MINES	—
CANCELLED AND USE PERMITS FOR COMMERCIAL TOURISM, OUTPOST CAMPS	—

**REFERENCES**

**AREAS WITHDRAWN FROM DISPOSITION**

Description	Order No.	Date	Disposition	File
M.R.O. - MINING RIGHTS ONLY				
S.R.O. - SURFACE RIGHTS ONLY				
M.+S. - MINING AND SURFACE RIGHTS				

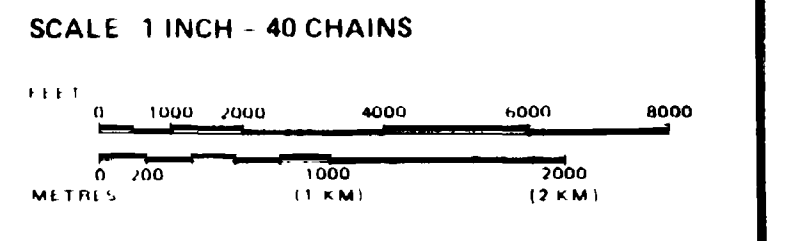

**TARTAN LAKE**  
M.N.R. ADMINISTRATIVE DISTRICT  
THUNDER BAY  
MINING DIVISION  
THUNDER BAY  
LAND TITLES / REGISTRY DIVISION  
THUNDER BAY

Ministry of Natural Resources  
Ontario  
Ministry of Northern Development and Mines

Date: JULY, 1991  
In Service July 23/93.

