

430/8



The Miner

52801NE5030 W8406-00438 KEITH

010

Name and Postal Address of Recorded Holder: **Gerald Sanford**
 Prospector's Licence No.: **M-21110**
 Location: **W 8406-438**
KEITH TOWNSHIP /

Summary of Work Performance and Distribution of Credits

Total Work Days Cr. claimed 40	Mining Claim			Mining Claim			Mining Claim		
	Prefix	Number	Work Days Cr.	Prefix	Number	Work Days Cr.	Prefix	Number	Work Days Cr.
for Performance of the following work. (Check one only) <input type="checkbox"/> Manual Work <input type="checkbox"/> Shaft Sinking Drifting or other Lateral Work. <input checked="" type="checkbox"/> Compressed Air, other Power driven or mechanical equip. <input type="checkbox"/> Power Stripping <input type="checkbox"/> Diamond or other Core drilling <input type="checkbox"/> Land Survey	P	753420	40						

All the work was performed on Mining Claim(s): **P752148**

Required Information eg: type of equipment, Names, Addresses, etc. (See Table Below)

COBRA GAS PLUGGER

G. Sanford, Box 913, Schumacher, Ont
 L. Sanford, 190 Ban nerman, Timmins, Ont.

plugger - $144 \div 3 = 48$ days (carrying 8 days remaining)

PORCUPINE MINING DIVISION
RECEIVED
OCT 5 1984
A.M. 7 8 9 10 11 12 1 2 3 4 5 6 P.M.

RECORDED
OCT - 5 1984
Receipt No. *[Signature]*

Date of Report: **Oct 4 / 84**
 Recorded Holder or Agent (Signature): *Gerald Sanford*

I hereby certify that I have a personal and intimate knowledge of the facts set forth in the Report of Work annexed hereto, having performed the work or witnessed same during and/or after its completion and the annexed report is true.

Name and Postal Address of Person Certifying: **Gerald Sanford,**
P.O. Box 913, Schumacher, Ont.
 Date Certified: **Oct 5 / 84**
 Certified by (Signature): *Gerald Sanford*

Table of Information/Attachments Required by the Mining Recorder

Type of Work	Specific information per type	Other information (Common to 2 or more types)	Attachments
Manual Work	Nil	Names and addresses of men who performed manual work/operated equipment, together with dates and hours of employment.	Work Sketch: these are required to show the location and extent of work in relation to the nearest claim post.
Shaft Sinking, Drifting or other Lateral Work			
Compressed air, other power driven or mechanical equip.	Type of equipment	Names and addresses of owner or operator together with dates when drilling/stripping done.	Work Sketch (as above) in duplicate
Power Stripping	Type of equipment and amount expended. Note: Proof of actual cost must be submitted within 30 days of recording.		
Diamond or other core drilling	Signed core log showing; footage, diameter of core, number and angles of holes.	Nil	Nil
Land Survey	Name and address of Ontario land surveyor.		



52B01NE5030 W8406-00438 KEITH

900

5A W.

23.	8	8	- Plugger - $144 \div 3 = 48$ days
24.	8	8	
25.	8	8	
26.	8	8	
27.	8	8	
28.	8	8	
29.	8	8	
30.	8	8	
31.	8	8	
	rota 1-72	total - 72	

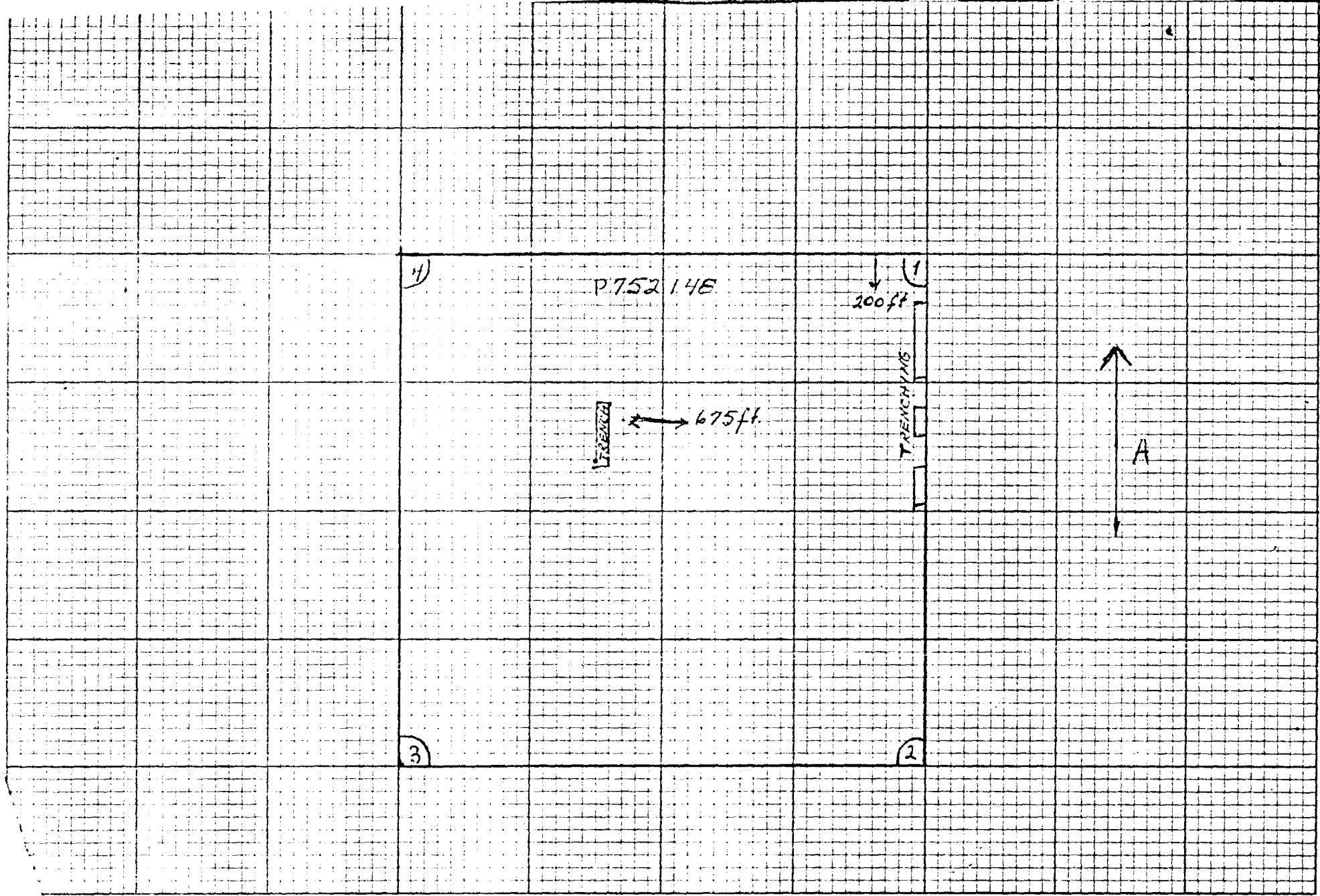

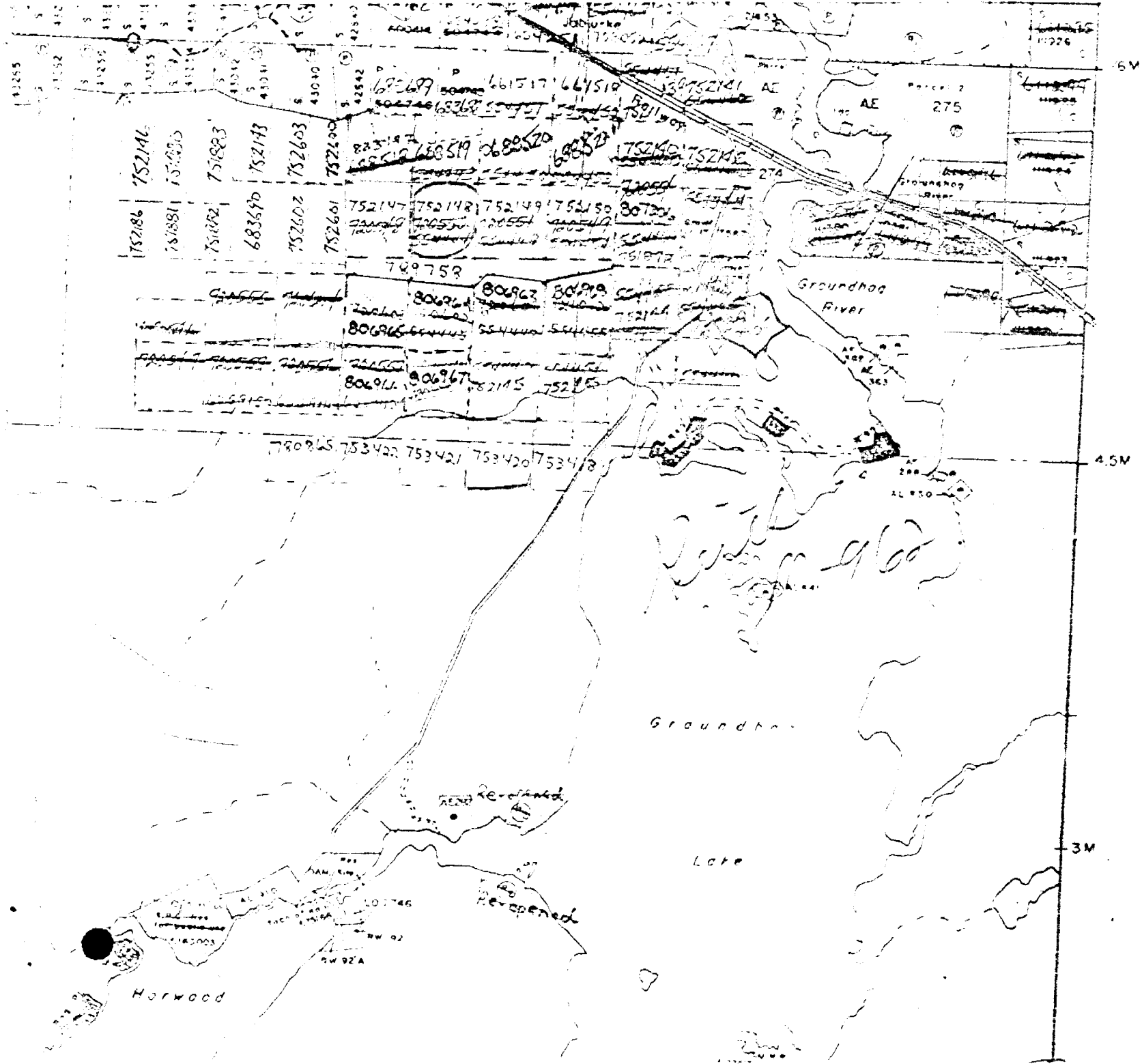

Penhorwood Twp. (M-10555)

IMPROVED ROADS
 KING'S HIGHWAYS
 RAILWAYS
 POWER LINES
 MARSH OR MUSKEG
 MINES
 CANCELLED
 PATENTED S.R.O.
 REGISTERED PLAN OF

N

400' Surface Rights
 shores of all lakes

Survey lines marked
 control only. Claims &
 unsubdivided territory.

Flooding
 Flooded areas along
 and tributaries to
 under L.O. 7746.

Areas withdrawn from
 43 of the Mining Act
 Order No. File

⊙	135263
⊙	130750
⊙	130750
⊙	130750

RS Withdrawn - S.R.O.
 130750
 130750 S.R.O. O

REPRODUCED BY THE REGISTRAR OF THE LANDS AND MINES DEPARTMENT, OTTAWA, ONTARIO, CANADA, FROM THE ORIGINAL RECORDS OF THE REGISTRAR OF THE LANDS AND MINES DEPARTMENT, OTTAWA, ONTARIO, CANADA.