



52B10SE0036 2.16792 MOSS

010

REPORT ON THE EXPLORATION WORK
COMPLETED FROM MAY TO DECEMBER 1994
ON THE MOSS LAKE PROPERTY
BY
COSTY BUMBU (OPAP 94-049)

January 11th, 1995

Final 2.10.95
Report by: Claude Larouche
Ovalbay Geological Services Inc.
1070 Lithium drive, unit # 6
Thunder Bay, Ontario
P7B 6G3
Tel: (807) 623-3770 Fax: (807) 623-2335

2.16792

Updated by:

Andreas Lichtblau

Feb. 14, 1996

Andreas Lichtblau

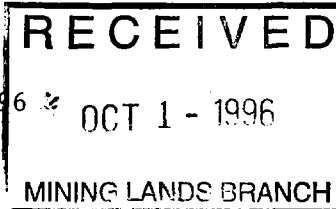



52B10SE0036 2.16792 MOSS

010C

Table of Contents

Introduction	3
Location and Access	4
Claims	6
Previous Work	8
Regional Geology	10
Recent Work	12
Conclusions and Recommendations	16

List of Figures:

Figure 1: Location Map	5
Figure 2: Sketch of claims.....	7
Figure 3: Regional Geology	11
Figure 4: Detail South trench	15

Appendix 1: copy of assay certificates

List of Maps (in pocket)

Map 1: Compilation North Block
Map 2: Compilation South Block

INTRODUCTION

A surface exploration program was conducted on the Moss Lake property from May to December 1994. The program included prospecting, mechanical stripping, trenching and sampling. The stripping and trenching was completed of favourable targets identified during reconnaissance prospecting.

Claude Larouche of Ovalbay Geological Services Inc. visited the property at a few occasions and completed a sketch of the two trenched areas.

This program was financed by the approval of an Opap grant to Costy Bumbu, prospector of Thunder Bay, Ontario, for the summer of 1994. Costy Bumbu completed most of the prospecting himself.

Sampling on surface of mineralized zones returned significant gold assays and defined areas having an excellent potential for further exploration work and diamond drilling.

LOCATION AND ACCESS

The Moss Lake project consists of 33 claims divided into two groups, the North and South claim Blocks. The property covers approximately 1,320 acres within the central part of Moss township, Thunder Bay Mining Division, NTS sheet 52B/10 at latitude 48 40' and longitude 90 50'.

Access to the property is via a number of secondary logging roads branching off from the Swamp Lake road which meets highway # 11, 23 kilometres west of Kashabowie. Kashabowie is a small town off highway 11, along the CNR, some 112 kilometres west of Thunder Bay.

The mining property is located within the Shebandowan Greenstone Belt which is the object of serious investigation for gold mineralization. Since the early 1980's, a large tonnage low grade deposit has been located north east of Snodgrass Lake and diamond drilling south east of North Coldstream Mines also outlined a deposit of lower tonnage but of higher grade material. The Snodgrass deposit is located less than 4 miles to the east of the Ardeen Mine and the property under study.

Figure 1: LOCATION MAP

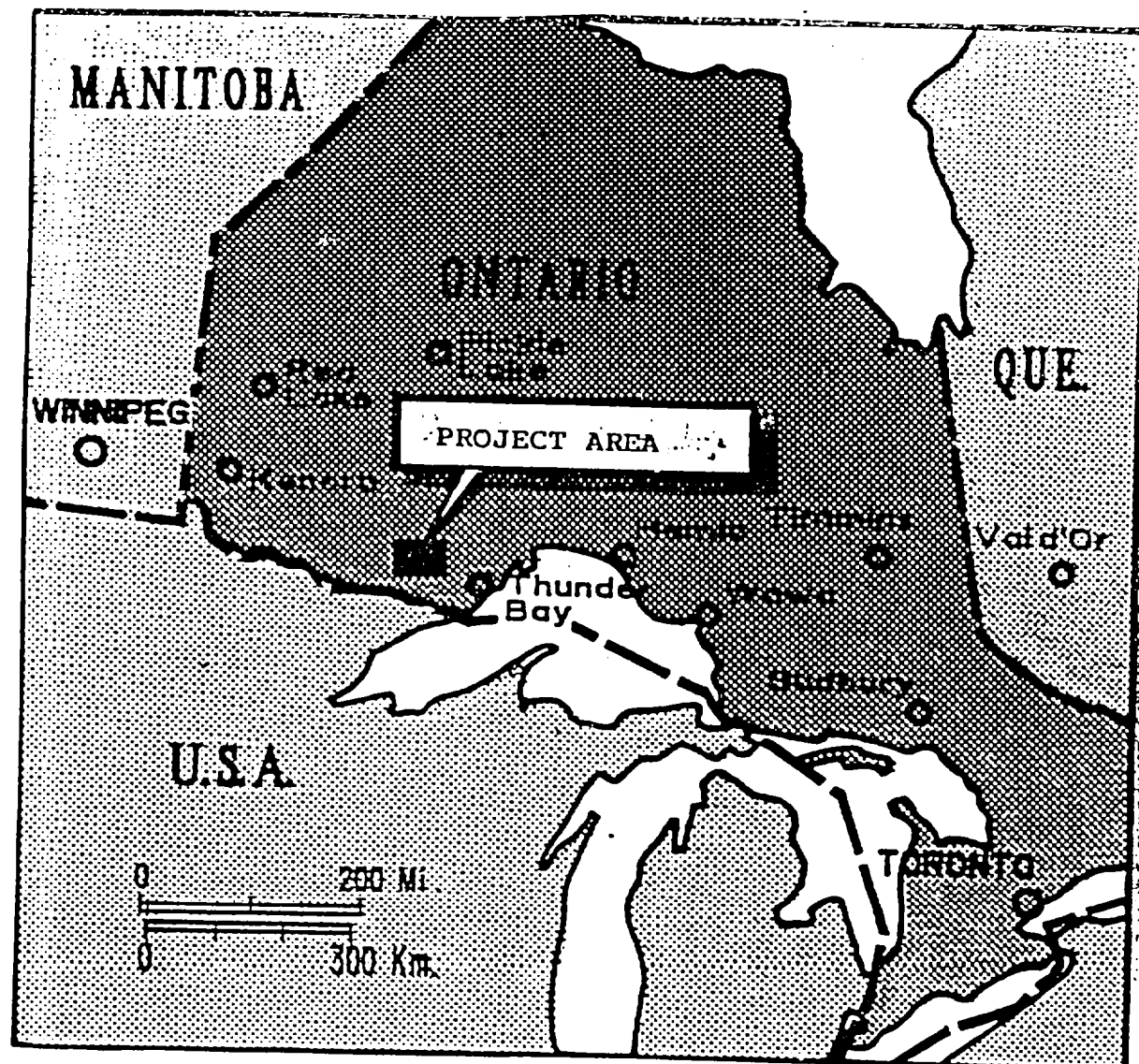

CLAIMS

All 33 16-hectares mining claims of the Moss Lake project are in good standing. They form two groups, the north and the south group.

The claims are located within the central part of Moss Township and their numbers are as follows:

South Block:	TB-1172350	1172349	1172348
	1157666	1157667	1157668
	1157670	1157671	
North Block:	TB-1172387	1172388	1172369
	1172368	1172367	1172366
	1172375	1172356	1172386
	1172355	1172396	1172385
	1172347	1172395	1172345
	1172346	1172317	1172315
	1172316	1157496	1157497
	1172365	1172340	1135466
	1135465		

After the termination of an option agreement with Akiko Lori Gold Resources and Goldfields Canadian Mining Limited, the claims were transferred back to:

Jim Martin
Costy Bumbu
Dave Petrunka

as equal partners, and all prospectors from Thunder Bay, Ontario. Dave Petrunka is acting as an agent for the other partners.

Dave Petrunka
540 Oliver Road, App. # 207
Thunder Bay, Ontario
P7B 5T8

Figure 2: SKETCH OF CLAIMS

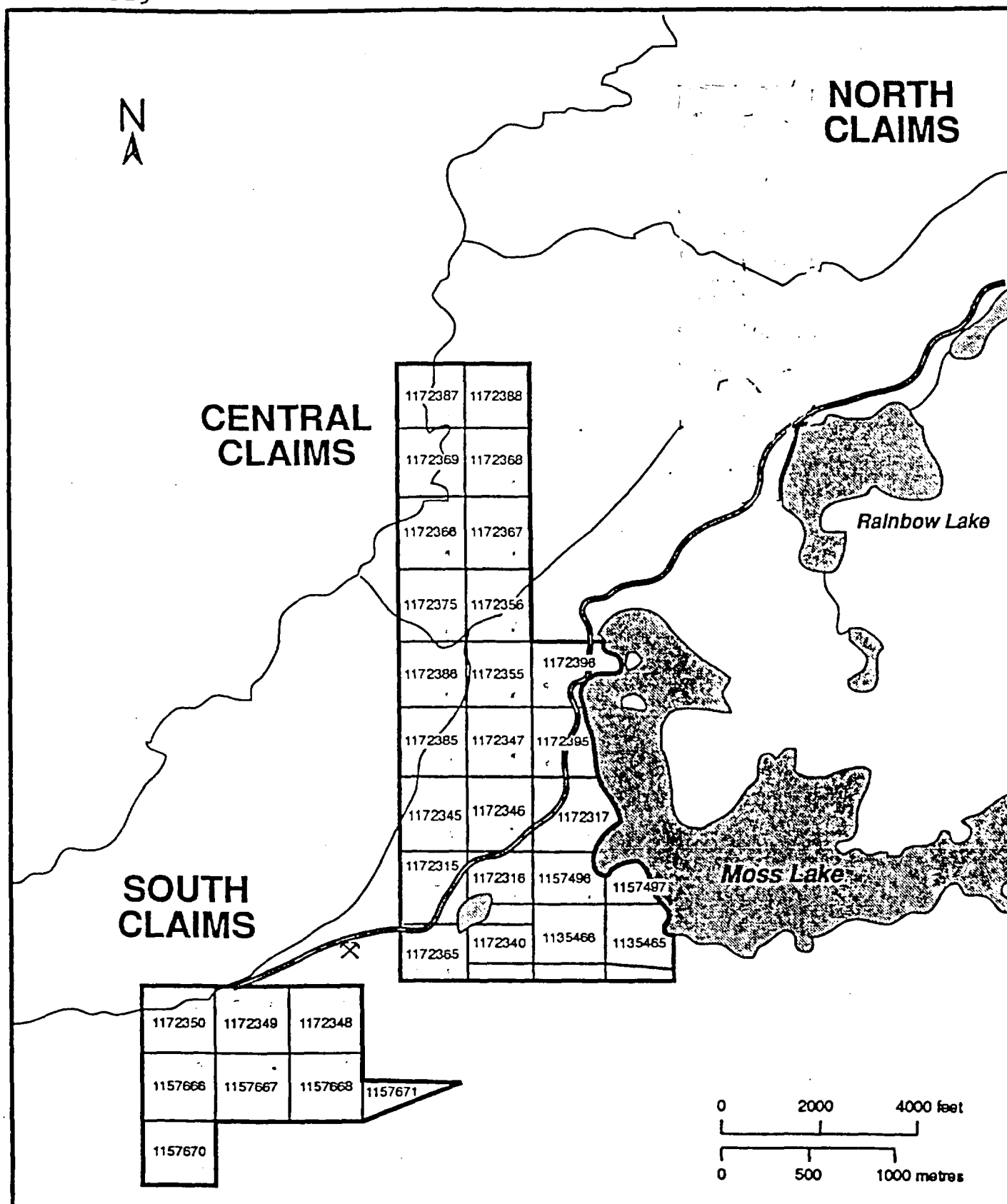

PREVIOUS WORK

The following description of previous work has been derived largely from Akiko Lori Gold Resources's previous reports on the mining property.

The Shebandowan area already hosts a number of important gold and base metal deposits. The Coldstream Mine produced 2.7 million tons grading 1.9% copper with accessory gold and silver. The Coldstream Main Gold Zone to the south east of the mining operations, has contained reserves of 5.1 million tons grading 0.05 opt Au. In addition, the Moss Lake deposit, 4 miles east of the property, has outlined reserves of 80,000,000 tons grading 0.032 opt Au. This deposit has a core of much higher grade material, which is a similar situation at the Coldstream Main Gold Zone.

Gold was first discovered near the property in 1871. At this time, the mining claims encompassing the Ardeen deposit were staked and surveyed. This discovery is recognized as being the first gold deposit found in Northern Ontario. Production from the Ardeen Mine amounted to 143,724 tons of ore which yielded 29,678 ounces of gold and 172,617 ounces of silver. The recovered grade for gold was 0.17 opt and the silver was 1.20 opt.

During the brief operating life of this deposit, down strike extensions of the deposit were investigated. It is reported that the grade and the width of the structure were improving with depth. On surface, to the southwest of the mine, the McKellar vein, believed to be the southern extension of the Ardeen vein, was trenched at a number of locations.

In 1957, Noranda Exploration conducted exploration on portions of the claims. This program was targeted at base metal. A grid was established and work consisted of geological mapping and geophysical surveys. Three diamond drill holes were completed and intersected mainly graphitic schists.

During the period of 1973 to 1974, Dome Exploration held the ground under option from Belore Mines which took over the Ardeen Gold Mine. Dome conducted a program of mapping and geophysics followed by diamond drilling. Seventeen holes were drilled totalling 5,567 linear feet. Drilling was concentrated east and southeast of the old mine workings. A number of the holes intersected economic gold mineralization within iron formation south of the mine workings. This was

the first time that gold in iron formation has been tested on the property.

From 1976 to 1982, the ground was held by the Provincial Government as a potential park location.

Matt Berry Mines conducted a drill program during the period 1986 to 1988. This program primarily investigated the down dip and strike extensions to the west of the Ardeen deposit. One hole intersected 1.20 opt Au over 5 feet within an iron formation.

During a regional geological reconnaissance program Goldfields Canadian Mining Limited identified a number of exploration targets on the property. The ground was subsequently staked by Goldfields in October 1990. An airborne geophysical survey consisting of magnetometer and VLF-Em was then conducted over the area.

In October of 1991, Akiko - Lori Gold Resources entered into a joint venture agreement with Goldfields Canadian Mining limited. Akiko - Lori completed geochemical (humus) surveys, prospecting, sampling, mapping, trenching and very limited diamond drilling.

Akiko Lori terminated their option agreement in 1992.

REGIONAL GEOLOGY

The Shebandowan Greenstone Belt is predominantly underlain by metavolcanic rocks (figure 3), which forms part of the Wawa Subprovince of the Superior Structural Province of the Canadian Shield. The area under study is occupied by two contrasting suites of older metavolcanic rocks composed of mafic to intermediate lavas, iron formations and intermediate ash flow rocks in the west and predominantly felsic metavolcanic rocks in the east. Metadiabase (gabbro) sills emplaced into the mafic metavolcanic terrain are considered the oldest intrusions exposed.

Metadiabase and both mafic and felsic metavolcanic rocks are cut by dykes and stocks of feldspar and quartz - feldspar porphyry, hornblende lamprophyre, quartz syenite dykes of the Moss Lake syenite stock and larger bodies of hornblende gabbro to diorite.

The deformation is very heterogeneous, partitioned mainly along narrow very schistose, northeasterly striking high strain zones which are closely spaced in the Ardeen Mine area. These zones are characterized by a strong lineation which mainly plunges gently southwest. Carbonate and sericite schists are characteristics of segment of some of the shears.

The various shear zones in the Ardeen Mine area and the intersection of brittle fracture zones with one of the northeast trending carbonatized shear zone at Snodgrass Lake appear to exert the most significant influence on the localization of gold.

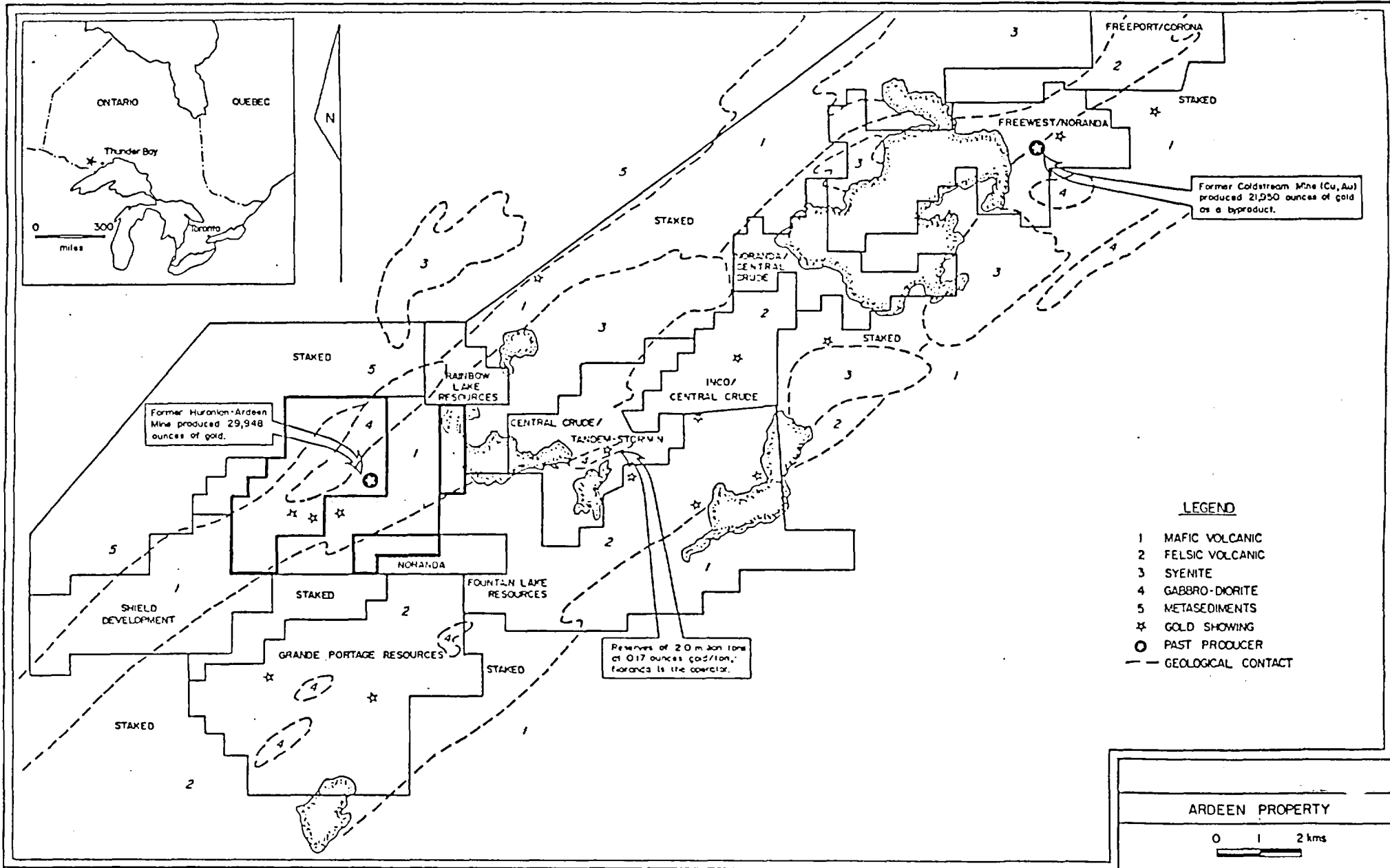

FIGURE 3: REGIONAL GEOLOGY

RECENT WORK

During the period of May 01, 1994 to December 15 th, 1994. Prospecting work was conducted in four different areas:

- The north trench
- The Ardeen Creek area
- The east Fisher Lake area
- The Mckellar pits area (south trench)

These areas are located on two compilation maps at the scale of 1 = 2,400 in pocket. These compilation maps contain much informations from work completed on certain claims by Costy Bumbu, other portions of the claims were worked by Eino Ranta and some information was derived from previous pertinent information. The claims prospected by Costy Bumbu were not covered by Eino Ranta's OPAP work. For the program, assays were sent to commercial laboratories: Accurassay Labs in Thunder Bay and Chemex. Reference lines were also cut for the prospecting.

To facilitate the discussions, the four areas will be discussed separately. The geology of each area is described along with the sampling. Each sample collected for assay is described in Appendix 1 and a copy of the assay certificate is presented in Appendix 2.

- THE NORTH TRENCH

The north trench area was discovered by prospecting along the newly constructed logging roads. North of claim posts # 1172345-4, 873520-1, 873519-2 and 1172385-3 (about 150 feet) and straddling the property line, rusty overburden was exposed. Hand stripping exposed a small outcrop of sericite schist with graphite. Mechanical stripping was conducted to gain a better exposure of the zone. The stripping has been completed by Burstrom of Shebandowan with a D-7 bulldozer. The stripped area was washed with high pressure water pumps and two trenches were drilled and blasted and later sampled. This work was completed by Costy Bumbu and the help of A. Vatamanelu. A gaz plugger permitted to drill shallow holes for blasting the trenches. The trenches were subsequently hand cleaned and most of the broken rock was piled close to the trenches. Sampling was completed from the fresh exposure at the botton of the pits.

The zone (map 1 in pocket, window to the top left hand side of the map) has been mapped and is described as a horizon highly sericitized and sheared with fragments of

lapilli size and rounded block of chert with massive pyrite which locally may represent along certain beds up to 35 % of the volume of the rock.

The trenched area is approximately 140 feet by 120 feet. Two areas have been drilled and blasted for 2 feet deep, 4 feet wide and roughly 20 feet long (north - south). The north part of the trench area is underlain mainly by gabbro and mafic volcanics. Few horizons of graphitic - sericite - chlorite schists are present and are visibly folded (bedding passes from 044 degrees to 024 degrees). Some horizons within the graphitic schist are composed of chert fragments within a pyrite matrix. The graphitic schist also host minor pyrrhotite along with the pyrite, as stringers and blebs. Immediately to the south east of the trenched area, and also to the east, felsic to intermediate volcanics are present which tend to indicate that the sericite - graphite - chlorite schists is located at the contact between the felsic to intermediate volcanics and the mafic volcanics to the north west.

Sampling in order to evaluate the gold potential of this structure was deceptive (samples # 14, 15, 16 and 17).

Prospecting to the north east of the trenched area encountered mainly felsic to intermediate volcanics and grabbro. Two samples (# 3c and 5e) of the felsic to intermediate volcanics returned only trace of gold.

- THE ARDEEN CREEK AREA

The second area prospected located to the northeast of the Ardeen Mine mainly along the Ardeen creek was selected based on numerous geochem (humus) anomalies located in the area by the work of Akiko Lori. Very few outcrops are present are the work confirmed that zones carrying economic gold values are closely associated to these geochem anomalies.

From the Akiko Lori grid, at station 7+00N, on line L-18+00E, felsic to intermediate volcanics dominate. Locally large blocks of felsic volcanics are present within a chloritic matrix. In other places, the felsic to intermediate volcanics are chloritized with chlorite ribbons. They are usually highly fractured more or less parallel to few quartz veins which are oriented at 193 degrees with dip of 60 degrees to the south east. The veins vary from 2 inches to 8 inches in width and are exposed for lengths of 15 feet before they pinch out. In the area the bedding is oriented at 184 degrees with sub vertical dip; this orientation differs from the more

northeasward trending present further to the south east. Sampling of a quartz vein returned significant gold values but over narrow width (sample # 31778, 0.321 opt Au).

In the area of line L-12+00E at station 7+00N, a fine grained grey diorite is in contact with mafic tuffs and fragmentals. The diorite is present over 5.5 feet and is oriented at 157 degrees. It contains 0.5 to 5% disseminated pyrite and grey rusty quartz veins cut the diorite. They carry minor amount of pyrite. Sampling returned highly anomalous gold values which will have to be followed up with more details (sample #31779, 0.066 opt Au over 5.5 feet).

Along Akiko Lori's base line, at station 7+00E, and old trench was seen with a band of rusty chert within the trench oriented at 040 degrees. Onother old trench was located 80 feet northeast of claim post 1172315-3. This trench is exposed over a length of 40 feet, and the area just east of it, has been trenched by Akiko Lori in 1991.

Some 200 meters north of claim post 1172315-3 and straddling the claim line, two outcrops were sampled. One outcrop is composed of porphyry cut by an irregular quartz vein of variable orientation. The vein is grey to white in colour and carries minor pyrite and chalcopyrite. Assays on the vein returned anomalous gold values (samples # 1a, 2b and 4d). To the north east, about 150 feet, a zone of shearing is present with minor sericite, chlorite and quartz stringers and veins. The zone is oriented at 050 degrees. Sampling the wall rock around this zone which was previously sample (Fogen 1990, Akiko Lori 1991) returned anomalous gold values (samples # 6f, 7g, 8, 9 and 10)

- THE EAST FISHER LAKE AREA

The third area prospected was located just around Fisher Lake in order to locate the eastern extension of the Fisher Lake Gold Zone and also the presence of iron formations. This area east of Fisher Lake is covered mainly with swamp and it is believed that detailed geophysical surveys will be more usefull to locate the possible extension of the Fisher Lake Gold zone. No sampling was completed in this area. To the west of Fisher Lake, prospecting encountered minor iron formations. The iron formation is locally fractured with minor quartz veining. Sampling (sample # 11) returned trace of golg.

-THE MCKELLAR PITS AREA (SOUTH TRENCH)

The fourth area explored is located to the southwest of the Ardeen Mines. Some prospecting has been carried out approximately 100 feet south of the claim posts 1157667-1, 1172349-2, 1172348-3 and 1157668-4. Previous sampling by Akiko - Lori Gold Resources (1992) of block of quartz on surface returned values of up to 0.99 opt Au. The sources of the quartz blocks was found under 6 inches of overburden. The vein varies from 6 inches to 12 inches in width and is oriented roughly east - west. The veining is more pronounced at the east end of the prospected area. To the west, the vein has been exposed by minor hand stripping by Akiko - Lori, the vein goes down to a few inches in width. Grab samples of the highly mineralized east end of the vein returned the following results:

Sample #	opt Au	opt Ag	% Cu
217343	1.988	5.219	> 1.00%
217344	2.763	12.828	> 1.00%
217345	1.021	4.985	0.453%
217346	0.649	1.721	0.069%
217347	0.035	0.117	0.025%
217348	1.435	4.373	> 1.00%
217349	0.329	0.554	0.180%

The sampling was completed over a length of 10 feet along the vein and it appears that the wall - rock is also sillicified. Some of the samples carry up to 60 % sulphides, mainly pyrite and chalcopyrite. Adjacent to the vein, the volcanics are highly fractured with abundant sulphide. Stripping and trenching is required to further evaluate this structure.

Still part of this area (the McKellar pits area) but one claim to the north, stripping was completed over an area of 140 feet in length and 80 feet in width. This is referred to as the "south trench" which covers 11,200 square feet (figure 4). A representative section of the iron formation has been exposed. 3 trenches have been drilled and blasted. The dominant rock type is a chert breccia composed of chert fragments within a chloritic matrix. The fragments vary in size from from 5 cm to 30 cm and appears to decrease in volume toward the north side of the exposed outcrop. Interbedded with the chert breccia, is at least two horizons of well thinly bedded chert with minor magnetite. Some pyrite is located within this rock formation mainly along fractures. To the north of the outcrop, a strong rusty shear zone is present and is oriented at 80 degrees. It is characterized by chlorite - carbonate schists injected with quartz -

carbonate stringers.

Within the blasted pit at the east end of the trenched area, a shear zone oriented at 100 degrees shows a dextral displacement of roughly 2 feet. This shear is also filled with quartz - carbonate stringers.

To the south of the outcrop, within one of the thinly bedded chert horizon, a better defined chert bed dips at 45 degrees to the north, it shows "boudinage" and has been fractured. The fractures host minor amount of pyrite and chalcopyrite.

Sampling in the area returned the following values:

Sample #	Au	Sample	Rock unit
4762	47 ppb	grab	Shear zone
# 19	40 ppb	grab	Chert breccia
# 20	100 ppb	grab	Chert
4763	94 ppb	Chip (0.5')	Chert

CONCLUSIONS AND RECOMMENDATIONS

The area has potential for locating more gold showings. Numerous gold showings have already been located and the detailed study of these gold showings will generate exploration model for more prospecting.

On the Fisher Lake Gold zone, an east - west shear zone host a quartz vein which carries values of up to 43.00 opt Au from grab sampling. Channel sampling also returned significant gold assays over an average width of 5 feet. At this location it is interesting to note that the east - west shear zone cut and displace and iron formation.

It is recommended to concentrate the future prospecting in the areas where east - west or northeast - southwest trending shear zones would intersect the iron formations.

It is also recommended to cover the claims with a systematic grid of lines and carry out a complete ground geophysical surveys. The lines and the stations for the survey readings should be very close as to locate minor folding and or displacement.

Diamond drilling is recommended on the known gold bearing structures as to identify their depth extension.



Chemex Labs Ltd.

Analytical Chemists * Geochemists * Registered Assayers
5175 Timberlea Blvd., Mississauga,
Ontario, Canada L4W 2S3
PHONE: 905-624-2806

To: BUMBU, COSTY

2816 RIDGEWAY E.
THUNDER BAY, ON
P7E 5K3

Project :
Comments: ATTN: COSTY BUMBU

Page Number : 1
Total Pages : 1
Certificate Date: 28-JUN-94
Invoice No. : 19418757
P.O. Number :
Account : LWI

CERTIFICATE OF ANALYSIS A9418757

SAMPLE	PREP CODE		Au oz/T	Cu	Ag ppm						
			FA+AA	ppm	Aqua R						
1 A	205	226	0.0565	4220	18.4						
2 B	205	226	0.0055	-----	-----						
3 C	205	226	<0.0005	-----	-----						
4 D	205	226	0.0285	-----	-----						
5 E	205	226	0.0015	-----	-----						

Adriana Secundo
CERTIFICATION:



Chemex Labs Ltd.

Analytical Chemists * Geochemists * Registered Assayers
5175 Timberlea Blvd., Mississauga,
Ontario, Canada L4W 2S3
PHONE: 905-624-2806

To: BUMBU, COSTY

2816 RIDGEWAY E.
THUNDER BAY, ON
P7E 5K3

Project :
Comments: ATTN: COSTY BUMBU

Page Number : 1
Total Pages : 1
Certificate Date: 28-JUL-94
Invoice No. : 19421088
P.O. Number :
Account : LWI

CERTIFICATE OF ANALYSIS A9421088

SAMPLE	PREP CODE	Au g/t FA+AA	Ag oz/T	Zn %							
SAMPLE 6 F.	208 226	0.010	< 0.01	< 0.01							
SAMPLE 7 G.	208 226	0.010	< 0.01	< 0.01							
SAMPLE 8	208 226	< 0.005	< 0.01	< 0.01							
SAMPLE 9	208 226	0.010	< 0.01	0.06							

CERTIFICATION: *Adriana Stancu*



Chemex Labs Ltd.

Analytical Chemists * Geochemists * Registered Assayers
5175 Timberlea Blvd., Mississauga,
Ontario, Canada L4W 2S3
PHONE: 905-624-2806

To: BUMBU, COSTY

2816 RIDGEWAY E.
THUNDER BAY, ON
P7E 5K3

Project :
Comments: ATTN: COSTY BUMBU

Page Number : 1
Total Pages : 1
Certificate Date: 15-AUG-94
Invoice No. : 19422502
P.O. Number :
Account : LWI

CERTIFICATE OF ANALYSIS A9422502

SAMPLE	PREP CODE		Au oz/T FA+AA	Ag oz/T	Cu %	Zn %						
10	208	226	0.0050	0.05	0.04	0.09						
11	208	226	<0.0005	< 0.01	< 0.01	0.02						

CERTIFICATION: _____



Chemex Labs Ltd.

Analytical Chemists * Geochemists * Registered Assayers
5175 Timberlea Blvd., Mississauga,
Ontario, Canada L4W 2S3
PHONE: 905-624-2806

To: BUMBU, COSTY

2816 RIDGEWAY E.
THUNDER BAY, ON
P7E 5K3

Project :
Comments: ATTN: COSTY BUMBU

Page Number : 1
Total Pages : 1
Certificate Date: 26-AUG-9
Invoice No. : 19423865
P.O. Number :
Account : LWI

CERTIFICATE OF ANALYSIS A9423865

SAMPLE	PREP CODE		Au oz/T FA+AA	Ag oz/T	Cu %							
SAMPLE 12	208	226	0.0325	0.26	0.15							
SAMPLE 13	208	226	0.0820	0.16	0.02							

CERTIFICATION: *[Signature]*



Chemex Labs Ltd.

Analytical Chemists * Geochemists * Registered Assayers
5175 Timberlea Blvd., Mississauga,
Ontario, Canada L4W 2S3
PHONE: 905-624-2806

To: BUMBU, COSTY

2816 RIDGEWAY E.
THUNDER BAY, ON
P7E 5K3

Project: RUSH
Comments: ATTN: COSTY BUMBU

Page Number : 1
Total Pages : 1
Certificate Date: 21-SEP-94
Invoice No. : I9426590
P.O. Number :
Account : LWI

CERTIFICATE OF ANALYSIS

A9426590

SAMPLE	PREP CODE	Au ppb FA+AA										
14	205	226	40									
15	205	226	< 5									

CERTIFICATION *[Signature]*



ACCURASSAY LABORATORIES

A DIVISION OF ASSAY LABORATORY SERVICES INC.

1070 LITHIUM DRIVE, UNIT 2
THUNDER BAY, ONTARIO P7B 6G3
PHONE (807) 623-6448
FAX (807) 623-6820

Page 1

COSTY BUMBU
2816 Ridgeway Street
Thunder Bay, Ontario
P7E 5K7

September 26, 1994

Job #9441065

Accurassay	Sample #	Customer	Gold ppb	Gold Oz/t
	1	16	30	<0.001
	2 Check	16	30	<0.001

Certified By: _____

Ch. Benu



ACCURASSAY LABORATORIES

A DIVISION OF ASSAY LABORATORY SERVICES INC.

1070 LITHIUM DRIVE, UNIT 2
THUNDER BAY, ONTARIO P7B 6G3
PHONE (807) 623-6448
FAX (807) 623-6820

Page 1

COSTY BUMBU
2816 Ridgeway Street
Thunder Bay, Ontario
P7E 5K7

September 29, 1994

Job #9441077

Accurassay	Sample #	Customer	Gold ppb	Gold Oz/t
	1	17	45	0.001
	2 Check	17	54	0.002

Certified By: _____



Chemex Labs Ltd.

Analytical Chemists * Geochemists * Registered Assayers
5175 Timberlea Blvd., Mississauga,
Ontario, Canada L4W 2S3
PHONE: 905-624-2806

To: BUMBU, COSTY
2816 RIDGEWAY E.
THUNDER BAY, ON
P7E 5K3

Project :
Comments: ATTN: COSTY BUMBU

Page Number : 1
Total Pages : 1
Certificate Date: 13-OCT-9
Invoice No. : 19428118
P.O. Number :
Account : LWI

CERTIFICATE OF ANALYSIS

A9428118

SAMPLE	PREP CODE		Au ppb	Ag ppm								
			FA+AA	Aqua R								
18	205	226	30	< 0.2								
19	205	226	40	1.0								
20	205	226	100	0.4								

Adriana Alexandra
CERTIFICATION:



ACCURASSAY LABORATORIES

A DIVISION OF ASSAY LABORATORY SERVICES INC.

1070 LITHIUM DRIVE, UNIT 2
THUNDER BAY, ONTARIO P7B 6G3
PHONE (807) 623-6448
FAX (807) 623-6820

Page 1

June 10, 1994

Job #944528

COSTY BUMBA
2816 Ridgeway Street
Thunder Bay, Ontario
P7E 5K7

Accurassay	Sample #	Customer	Gold ppb	Gold Oz/t
	1	217343	68158	1.988
	2	217344	94737	2.763
	3	217345	35000	1.021
	4	217346	22252	0.649
	5	217347	1199	0.035
	6	217348	49211	1.435
	7	217349	11285	0.329
	8 Check	217349	12636	0.369

Certified By: Chris Beer



ACCURASSAY LABORATORIES

A DIVISION OF ASSAY LABORATORY SERVICES INC.

1070 LITHIUM DRIVE, UNIT 2
THUNDER BAY, ONTARIO P7B 6G3
PHONE (807) 623-6448
FAX (807) 623-6820

Page 1

COSTY BUMBA
2816 Ridgeway Street
Thunder Bay, Ontario
P7E 5K7

June 10, 1994

Job #944528

Accurassay	Sample #	Customer	Silver ppm	Copper ppm
	1	217343	179	>10000
	2	217344	440	>10000
	3	217345	171	4528
	4	217346	59	696
	5	217347	4	246
	6	217348	150	>10000
	7	217349	19	1800

Certified By:





ACCURASSAY LABORATORIES

A DIVISION OF ASSAY LABORATORY SERVICES INC.

1070 LITHIUM DRIVE, UNIT 2
THUNDER BAY, ONTARIO P7B 6G3
PHONE (807) 623-6448
FAX (807) 623-6820

Page 1

OVAL BAY RESOURCES
1070 Lithium Drive
Thunder Bay, Ontario
P7B 6G3

August 31, 1994

Job #944919

Attention: Claude Larouche

Accurassay	Sample # Customer	Gold ppb	Gold Oz/t
1	31776	*****	*****
2	31777	957	0.020
3	31778	11020	0.321
4	31779	2272	0.066
5	31780	7	<0.001
6	31781	9	<0.001
7	31782	<5	<0.001
8	31801	23	<0.001
9	31802	6	<0.001
10	31803	546	0.016
11	Check 31803	464	0.014
12	31804	540	0.016
13	31805	290	0.008
14	31806	168	0.005
15	31807	85	0.002
16	31808	57	0.002
17	31809	22	<0.001
18	31810	21	<0.001
19	31811	18	<0.001
20	31812	40	0.001

Costy Bumbu

Certified By: Bundy Sill



ACCURASSAY LABORATORIES

A DIVISION OF ASSAY LABORATORY SERVICES INC.

1070 LITHIUM DRIVE, UNIT 2
THUNDER BAY, ONTARIO P7B 6G3
PHONE (807) 623-6448
FAX (807) 623-6820

Page 1

OVAL BAY RESOURCES
1070 Lithium Dr.
Thunder Bay, Ontario
P7B 6G3

November 17, 1994

Job #9441385

Accurassay	Sample # Customer	Palladium ppb	Gold ppb	Platinum ppb
	1 4751		1821	
	2 4752		42	
	3 4753		940	
	4 4754		520	
	5 4755		136	
	6 4756		2599	
	7 4757		15	
	8 4758		18	
	9 4759	556	116	
	10 4760	481	97	
	11 Check 4760		96	
	12 4761	1112	235	
	13 Check 4761	1231		
	14 4762		47	
	15 4763		94	
	16 4764		14	
	17 31783		19	
	18 31784		26	
	19 31785		102	

Costy Bumby

McKELLAR AREA
TRENCH

Certified By: Costy Bumby

TOTAL COST OF WORK:

MOSS LK. PROJECT

By COSTY BUMBU

PROSPECTING, LINECUTTING, SAMPLING:

34 DAYS \$150⁰⁰ PER DAY

5,100⁰⁰

HELPER: 4 DAYS \$150⁰⁰ PER DAY

600⁰⁰

DRILLING & BLASTING -

13 DAYS \$150⁰⁰ PER DAY

1,950⁰⁰

BURNSTROM'S D7 BULLDOZER

250⁰⁰

PLUGGER

550⁰⁰

FIRE PUMP

272⁰⁰

GENERATOR

126⁰⁰

2.16792

EXPLOSIVES

338⁰⁰

ASSAYS

706⁰⁰

FOOD & ACCOMMODATION

1,679⁰⁰

OVALBAY - MAPPING (PROPERTY REPORT)

1,167⁰⁰

TRANSPORTATION: 5464 KM. X 30⁰⁰

1,639⁰⁰

FOTO COPIES - REPRODUCTION:

52⁰⁰

TOTAL COST:

14,429.00

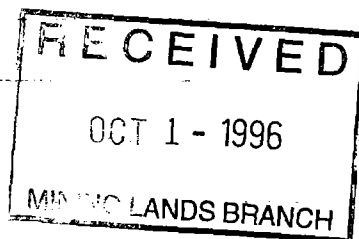

IV. REGISTRES QUOTIDIENS (Résumez les travaux de la Partie I)

Jour	Volet du projet	Date	Travail effectué
1	Moss Lk.	MAY 29/94	PROSPECTING:
2	-1-	- 30/94	CLAIM # 1172348-1157668
3	-1-	- 31/94	1172349-1157667
4	Moss Lk.	JUNE 18/94	PROSPECTING & SAMPLING
5	-1-	- 19/94	NEST BLOCK - MCKELPIT PITS
6	-1-	- 20/94	SEE REPORT PAGE 15
7	-1-	- 21/94	
8	Moss Lk.	JUNE 28/94	PROSPECTING:
9	-1-	- 29/94	CLAIM # 1157496-1157497
10	-1-	- 30/94	1172317-1172395-1196921
11	Moss Lk.	JULY 11/94	PROSPECTING & CUT LINES
12	-1-	- 12/94	NEW BASELINE: CLAIM # 1172385
13	-1-	- 13/94	1172386-873519-873520
14	-1-	- 19/94	
15	-1-	- 20/94	
16	-1-	- 21/94	OLD BASELINE: CLAIM # 1172315
17	-1-	- 27/94	1172345-1172346-1172347
18	-1-	- 28/94	1172395
19	-1-	AUG. 4/94	
20	-1-	- 5/94	
21	-1-	- 6/94	
22	Moss Lk.	AUG. 16/94	PROSPECTING:
23	-1-	- 17/94	MAIN ROADS AND
24	-1-	- 18/94	CLAIM # 1172365
25	-1-	- 21/94	1172315-1172316-1172346
26	-1-	- 22/94	1172345-
27	-1-	- 23/94	
28	-1-	- 24/94	
29	Moss Lk.	SEPT. 8/94	SAMPLING OLD TRENCHES
30	-1-	- 9/94	# 1-2-3
31	Moss Lk.	- 22/94	PROSPECTING: CLAIM #
32	-1-	- 23/94	1157496-1135466
33	-1-	- 24/94	1172346-1172316
34	-1-	- 25/94	
35			
36			
37		34 DAYS	PROSPECTING 10 HRS. PER DAY
38			LINE CUTTING \$ 15 ⁰⁰ PER HR.
39			SAMPLING
40			
41			

Ajoutez des feuilles additionnelles au besoin

IV. REGISTRES QUOTIDIENS (Résumez les travaux de la Partie I)

Jour	Volet du projet	Date	Travail effectué
1	Moss Lk.	OCT 5/94	PLUGGER: STRIPPING
2	-H-	-H- 6/94	DRILLING
3	-H-	-H- 7/94	BLASTING
4	-H-	-H- 8/94	MUCKING
5	-H-	-H- 10/94	WASHING
6	-H-	-H- 11/94	
7	-H-	-H- 12/94	TRENCH # 1
8	-H-	-H- 16/94	
9	-H-	-H- 17/94	
10	-H-	-H- 18/94	
11	-H-	-H- 20/94	
12	-H-	-H- 21/94	
13	-H-	-H- 22/94	
14			
15			
16			
17	13 DAYS: 10 HRS. PER DAY \$ 15.00 PER HR.		
18			
19			
20			STRIPPING - DRILLING - BLASTING
21			PLUGGER "COBRA"
22			
23			
24			
25			
26			
27			
28			
29			
30			
31			
32			
33			
34			
35			
36			
37			
38			
39			
40			
41			

Ajoutez des feuilles additionnelles au besoin

IV. REGISTRES QUOTIDIENS (Résumez les travaux de la Partie I)

Jour	Volet du projet	Date	Travail effectué
1	Moss Lk.	MAY 29/94	PROSPECTING:
2	-1-	- 30/94	CLAIM # 1172348-1157668
3	-1-	- 31/94	1172349-1157667
4	Moss Lk.	JUNE 18/94	PROSPECTING & SAMPLING
5	-1-	- 19/94	NEST BLOCK - MCKELLAR PITS
6	-1-	- 20/94	SEE REPORT PAGE 15
7	-1-	- 21/94	
8	Moss Lk.	JUNE 28/94	PROSPECTING:
9	-1-	- 29/94	CLAIM # 1157996-1157497
10	-1-	- 30/94	1172317-1172395-1196921
11	Moss Lk.	JULY 11/94	PROSPECTING & CUT LINES
12	-1-	- 12/94	NEW BASELINE: CLAIM # 1172385
13	-1-	- 13/94	1172386-873519-873520
14	-1-	- 19/94	
15	-1-	- 20/94	
16	-1-	- 21/94	OLD BASELINE: CLAIM # 1172315
17	-1-	- 27/94	1172345-1172346-1172347
18	-1-	- 28/94	1172395
19	-1-	AUG. 4/94	
20	-1-	- 5/94	
21	-1-	- 6/94	
22	Moss Lk.	AUG. 16/94	PROSPECTING:
23	-1-	- 17/94	MAIN ROADS AND
24	-1-	- 18/94	CLAIM # 1172365
25	-1-	- 21/94	1172315-1172316-1172346
26	-1-	- 22/94	1172345-
27	-1-	- 23/94	
28	-1-	- 24/94	
29	Moss Lk.	SEPT. 8/94	SAMPLING OLD TRENCHES
30	-1-	- 9/94	# 1-2-3
31	Moss Lk.	- 22/94	PROSPECTING: CLAIM #
32	-1-	- 23/94	1157496-1135466
33	-1-	- 24/94	1172346-1172316
34	-1-	- 25/94	
35			
36			
37		34 DAYS	PROSPECTING 10 HRS. PER DAY
38			LINE CUTTING \$ 15 ⁰⁰ PER HR.
39			SAMPLING
40			
41			

Ajoutez des feuilles additionnelles au besoin

STATEMENT OF COSTS:

PROSPECTING:

MAY 1/94 DECE. 15/94

By COSTY BUMBUBU

PROSPECTING - LINE CUTTING - SAMPLING \$ 5100

34 DAYS \$150 PER DAY \$15⁰⁰ PER HR.

HELPER 7 DAYS \$150 PER DAY 300

ASSAYS .500

MAPPING & REPORT RY OVALBAY SERV. 800

GENERATOR 126

FOTO COPIES, ETC. 30

TRANSPORTATION 3333 Km. 30⁰⁰ P. Km. 1000

FOOD 1000

Total Costs \$ 8856⁰⁰

STATEMENT OF COSTS:

PROSPECTING:

MAY 1/94 DECE. 15/94

By COSTY BUMBU

PROSPECTING - LINE CUTTING - SAMPLING \$ 5100

34 DAYS \$150 PER DAY \$15⁰⁰ PER HR.

HELPER 7 DAYS \$150 PER DAY 300

ASSAYS .500

MAPPING & REPORT BY OVAUBAY SERV. 800

GENERATOR 126

FOTO COPIES, ETC. 30

TRANSPORTATION 3333 Km. 30⁰⁰ P. Km. 1000

FOOD 1000

Total Costs \$ 8856⁰⁰

IV. REGISTRES QUOTIDIENS (Résumez les travaux de la Partie I)

Jour	Volet du projet	Date	Travail effectué
1	Moss Lk.	MAY 29/94	PROSPECTING:
2	-1-	- 30/94	CLAIM # 1172348-1157668
3	-1-	- 31/94	1172349-1157667
4	Moss Lk.	JUNE 18/94	PROSPECTING & SAMPLING
5	-1-	- 19/94	NEST BLOCK - MCKELLAR PITS
6	-1-	- 20/94	SEE REPORT PAGE 15
7	-1-	- 21/94	
8	Moss Lk.	JUNE 23/94	PROSPECTING:
9	-1-	- 29/94	CLAIM # 1157996-1157497
10	-1-	- 30/94	1172317-1172395-1196921
11	Moss Lk.	JULY 11/94	PROSPECTING & CUT LINES
12	-1-	- 12/94	NEW BASELINE: CLAIM # 1172385
13	-1-	- 13/94	1172386-873519-873520
14	-1-	- 19/94	
15	-1-	- 20/94	
16	-1-	- 21/94	OLD BASELINE: CLAIM # 1172315
17	-1-	- 27/94	1172345-1172346-1172347
18	-1-	- 28/94	1172395
19	-1-	AUG. 4/94	
20	-1-	- 5/94	
21	-1-	- 6/94	
22	Moss Lk.	AUG. 16/94	PROSPECTING:
23	-1-	- 17/94	MAIN ROADS AND
24	-1-	- 18/94	CLAIM # 1172365
25	-1-	- 21/94	1172315-1172316-1172346
26	-1-	- 22/94	1172345-
27	-1-	- 23/94	
28	-1-	- 24/94	
29	Moss Lk.	SEPT. 8/94	SAMPLING OLD TRENCHES
30	-1-	- 9/94	# 1-2-3
31	Moss Lk.	- 22/94	PROSPECTING: CLAIM #
32	-1-	- 23/94	1157496-1135466
33	-1-	- 24/94	1172348-1172316
34	-1-	- 25/94	
35			
36			
37		34 DAYS PROSPECTING 10 HRS. PER DAY	
38		LIVE CUTTING \$ 15 PER HR.	
39		SAMPLING	
40			
41			

Ajoutez des feuilles additionnelles au besoin



Ontario

Ministry of Northern Development and Mines

Report of Work Conducted After Recording Claim

Mining Act

Transaction Number

W9640-135

MINING LANDS

Personal information collected on this form is obtained under the authority of the Mining Act. This information will be used for correspondence. Questions about this collection should be directed to the Provincial Manager, Mining Lands, Ministry of Northern Development and Mines, Fourth Floor, 159 Cedar Street, Sudbury, Ontario, P3E 6A5, telephone (705) 670-7284.

2.16792

Instructions:



52B10SE0036 2.16792 MOSS

900

ing assessment work or consult the Mining

< Group.
icate. *mti Geo.*
company this form.
3901 T.D. CENTRE,
Box 94,
TORONTO, ON
M5K 1G8

Recorded Holder(s) <i>MIKE FUGEN (13245) 508 HALTON ST. / SOFIA JEFFS (14887) 417 ST. CLAIR AVE. E. TORONTO, ON. M4T 1P6</i>	Client No. <i>113427</i>
Address <i>COSTY BUMBU 2816 RIDGEWAY ST. E. THUNDER BAY ONT. P7E5K3</i>	Telephone No. <i>807-622-1871</i>
Mining Division <i>THUNDER BAY</i>	M or G Plan No. <i>6.676</i>
Township/Area <i>MOSS</i>	
Dates Work Performed From: <i>MAY 1/94</i>	To: <i>DEC. 15/94</i>

Work Performed (Check One Work Group Only)

Work Group	Type
Geotechnical Survey	
Physical Work, including Drilling	<i>PROSPECTING: (W10) (PROSP)</i>
Rehabilitation	
Other Authorized Work	
Assays	
Assignment from Reserve	

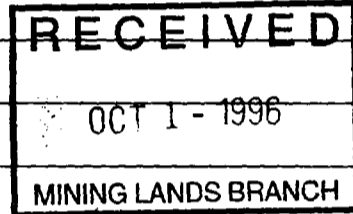

Total Assessment Work Claimed on the Attached Statement of Costs \$ *\$ 8227⁰⁰*

Note: The Minister may reject for assessment work credit all or part of the assessment work submitted if the recorded holder cannot verify expenditures claimed in the statement of costs within 30 days of a request for verification.

Persons and Survey Company Who Performed the Work (Give Name and Address of Author of Report)

Name	Address

Attach a schedule if necessary)

certification of Beneficial Interest * See Note No. 1 on reverse side

I certify that at the time the work was performed, the claims covered in this work report were recorded in the current holder's name or held under a beneficial interest by the current recorded holder.	Date <i>FEB. 20/96</i>	Recorded Holder or Agent (Signature) <i>C. Fuguen</i>
--	---------------------------	--

certification of Work Report

I certify that I have a personal knowledge of the facts set forth in this Work report, having performed the work or witnessed same during and/or after its completion and annexed report is true.		
Name and Address of Person Certifying <i>COSTY BUMBU 2816 RIDGEWAY ST. E. THUNDER BAY, ONT. P7E5K3</i>		
Telephone No. <i>807-622-1871</i>	Date <i>FEB. 20/96</i>	Certified By (Signature) <i>C. Fuguen</i>

Office Use Only

Total Value Cr. Recorded <i>\$8227</i>	Date Recorded	Mining Recorder <i>e. Gallen</i>	Received Stamp <i>HS 8 MH 12 07 96</i> MINING DIVISION THUNDER BAY ONTARIO
	Deemed Approval Date <i>APRIL 21, 1996</i>	Date Approved	
	Date Notice for Amendments Sent		

Page 10
 (cont.)

Work Report Number for Applying Reserve	Claim Number (see Note 2)	Number of Claim Units
	1122315	1
	1122316	1
	1122317	1
	1122340	1
	1122345	1
	1122346	1
	1122347	1
	1122348	1
	1122349	1
	1122365	1
	1122385	1
	1122386	1
	1122395	1
	1135466	1
	1157667	1
	1157668	1
	1172996	1
Total Number of Claims	17	

Value of Assessment Work Done on this Claim	Value Applied to this Claim
433	
433	
433	
433	
433	
433	
433	
433	
433	
433	
433	
433	
433	
433	
433	
433	
Total Value Work Done	7361
Total Value Work Applied	

Value Assigned from this Claim	Reserve: Work to be Claimed at a Future Date
433	
433	
433	
433	
433	
433	
433	
433	
433	
433	
433	
433	
433	
433	
433	
433	
Total Assigned From	0

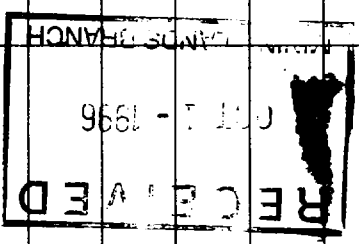

Credits you are claiming in this report may be cut back. In order to minimize the adverse effects of such deletions, please indicate from which claims you wish to prioritize the deletion of credits. Please mark (✓) one of the following:

- Credits are to be cut back starting with the claim listed last, working backwards.
- Credits are to be cut back equally over all claims contained in this report of work.
- Credits are to be cut back as prioritized on the attached appendix.

In the event that you have not specified your choice of priority, option one will be implemented.

Note 1: Examples of beneficial interest are unrecorded transfers, option agreements, memorandum of agreements, etc., with respect to the mining claims.

Note 2: If work has been performed on patented or leased land, please complete the following:

I certify that the recorded holder had a beneficial interest in the patented or leased land at the time the work was performed.	Signature	Date
---	-----------	------

Page 18
 of 18 pages

Work Report Number for Applying Reserve	Claim Number (see Note 2)	Number of Claim Units
	873519	1
	873520	1
	1196923	1
	196924	1
	1196921	4
	1202302	6
	1196239	2
	1196240	4
	1209440	2
Total Number of Claims		9

Value of Assessment Work Done on this Claim	Value Applied to this Claim	
433	418	
433	411	
	1644	
	2466	
	822	
	1644	
	822	
	822	
Total Value Work Done		8227
Total Value Work Applied		8227

Value Assigned from this Claim	Reserve: Work to be Claimed at a Future Date	
433		
433		
Total Assigned From		8227
Total Reserve		0

Credits you are claiming in this report may be cut back. In order to minimize the adverse effects of such deletions, please indicate from which claims you wish to prioritize the deletion of credits. Please mark (✓) one of the following:

- Credits are to be cut back starting with the claim listed last, working backwards.
- Credits are to be cut back equally over all claims contained in this report of work.
- Credits are to be cut back as prioritized on the attached appendix.

In the event that you have not specified your choice of priority, option one will be implemented.

Note 1: Examples of beneficial interest are unrecorded transfers, option agreements, memorandum of agreements, etc., with respect to the mining claims.

Note 2: If work has been performed on patented or leased land, please complete the following:

I certify that the recorded holder had a beneficial interest in the patented or leased land at the time the work was performed.	Signature	Date
---	-----------	------

Statement of Costs for Assessment Credit

État des coûts aux fins du crédit d'évaluation

Mining Act/Loi sur les mines

Transaction No./N° de transaction

119640-135

2.16792

Personal information collected on this form is obtained under the authority of the Mining Act. This information will be used to maintain a record and ongoing status of the mining claim(s). Questions about this collection should be directed to the Provincial Manager, Minings Lands, Ministry of Northern Development and Mines, 4th Floor, 159 Cedar Street, Sudbury, Ontario P3E 6A5, telephone (705) 670-7264.

Les renseignements personnels contenus dans la présente formule so recueillis en vertu de la Loi sur les mines et serviront à tenir à jour un regist. des concessions minières. Adresser toute question sur la collece de ce renseignements au chef provincial des terrains miniers, ministère d Développement du Nord et des Mines, 159, rue Cedar, 4^e étage, Sudbur (Ontario) P3E 6A5, téléphone (705) 670-7264.

1. Direct Costs/Coûts directs

PROSPECTING

Type	Description	Amount Montant	Totals Total global
Wages Salaires	Labour 34 UNYS Main-d'oeuvre \$150 PER UNY		
	Field Supervision Supervision sur le terrain		5100
Contractor's and Consultant's Fees Droits de l'entrepreneur et de l'expert-conseil	Type HELPER	300	
	ASSAYS	500	
	DUALBAY SERV. (MAPPING & REPORT)	800	1600
Supplies Used Fournitures utilisées	Type		
	FOTO COPIES	30	
			30
Equipment Rental Location de matériel	Type GENERATOR	126	
			126
Total Direct Costs Total des coûts directs			6856

2. Indirect Costs/Coûts indirects

** Note: When claiming Rehabilitation work Indirect costs are not allowable as assessment work. Pour le remboursement des travaux de réhabilitation, les coûts indirects ne sont pas admissibles en tant que travaux d'évaluation.

Type	Description	Amount Montant	Totals Total global
Transportation Transport	Type FEED 1/2 TON TRUCK		
	2222 LBS. OF FEED 900		
	RECEIVED		
	OCT 1 - 1996		
	MINING LANDS BRANCH		999
Food and Lodging Nourriture et hébergement	Food		
Mobilization and Demobilization Mobilisation et démoblisation			1000
Sub Total of Indirect Costs Total partiel des coûts indirects			1999
Amount Allowable (not greater than 20% of Direct Costs) Montant admissible (n'excédant pas 20 % des coûts directs)			1371
Total Value of Assessment Credit (Total of Direct and Allowable indirect costs)			8227

Note: The recorded holder will be required to verify expenditures claimed in this statement of costs within 30 days of a request for verification. If verification is not made, the Minister may reject for assessment work all or part of the assessment work submitted.

Note: Le titulaire enregistré sera tenu de vérifier les dépenses demandées dans le présent état des coûts dans les 30 jours suivant une demande à cet effet. Si la vérification n'est pas effectuée, le ministre peut rejeter tout ou une partie des travaux d'évaluation présentés.

Filing Discounts

- Work filed within two years of completion is claimed at 100% of the above Total Value of Assessment Credit.
- Work filed three, four or five years after completion is claimed at 50% of the above Total Value of Assessment Credit. See calculations below:

Total Value of Assessment Credit	Total Assessment Claimed
	x 0.50 =

Remises pour dépôt

- Les travaux déposés dans les deux ans suivant leur achèvement sont remboursés à 100 % de la valeur totale susmentionnée du crédit d'évaluation.
- Les travaux déposés trois, quatre ou cinq ans après leur achèvement sont remboursés à 50 % de la valeur totale du crédit d'évaluation susmentionné. Voir les calculs ci-dessous.

Valeur totale du crédit d'évaluation	Évaluation totale demandée
	x 0,50 =

Certification Verifying Statement of Costs

I hereby certify: that the amounts shown are as accurate as possible and these costs were incurred while conducting assessment work on the lands shown on the accompanying Report of Work form.

I as COSTY BUMBURU I am authorized (Recorded Holder, Agent, Position in Company)

I make this certification

Attestation de l'état des coûts

J'atteste par la présente: que les montants indiqués sont le plus exact possible et que ces dépenses ont été engagées pour effectuer des travaux d'évaluation sur les terrains indiqués dans la formule de rapport de travail ci-joint.

Et qu'à titre de _____ je suis autorisé (titulaire enregistré, représentant, poste occupé dans la compagnie)

I make this attestation.

Signature C. Bumburu Date FEB. 20/96

Ministry of
Northern Development
and Mines

Ministère du
Développement du Nord
et des Mines



October 17, 1996

Geoscience Assessment Office
933 Ramsey Lake Road
6th Floor
Sudbury, Ontario
P3E 6B5

Michael Weirmeir
Mining Recorder
435 James Street South
Suite B003
Thunder Bay, ON
P7E 6E3

Telephone: (705) 670-5853
Fax: (705) 670-5863

Dear Sir or Madam:

Submission Number: 2.16792

Subject: Transaction Number(s): W9640.00135

After reviewing the Work Report(s) we have prepared this letter and the attached summary, which lists the results of our review. Requirements of the Assessment Work Regulation may not have been fully met. Please examine the summary to determine the next course of action concerning the identified Work Report(s).

NOTE: The 90 day deemed approval provision, subsection 6(7) of the Assessment Work Regulation, is no longer in effect for this submission.

PLEASE NOTE ANY REQUESTED REVISIONS MUST BE SUBMITTED IN DUPLICATE.

If the anniversary dates for the mining claims affected by this correspondence have not passed, a number of options are available. Please contact the Mining Recorder to discuss these options.

If you have any questions regarding this correspondence, please contact Bruce Gates at (705)670-5856.

Yours sincerely,

A handwritten signature in black ink, appearing to read "Ron C. Gashinski".

ORIGINAL SIGNED BY
Ron C. Gashinski
Senior Manager, Mining Lands Section
Mines and Minerals Division

Work Report Assessment Results

Submission Number: 2.16792

Date Correspondence Sent: October 17, 1996

Assessor: Bruce Gates

Transaction Number	First Claim Number	Township(s) / Area(s)	Status	Approval Date
W9640.00135	873519	MOSS	Deemed Approval	May 21, 1996

Section:

9 Prospecting PROSP

Correspondence to:

Mining Recorder
Thunder Bay, ON

Resident Geologist
Thunder Bay, ON

Assessment Files Library
Sudbury, ON

Recorded Holder(s) and/or Agent(s):

Costy Bumbu
THUNDER BAY, ONTARIO, CANADA

MICHAEL N FOGEN
THUNDER BAY, Ontario

ZOFIA ELIZA JEFFS
TORONTO, Ontario

COSTY BUMBU
THUNDER BAY, Ontario

REFERENCES

REFERENCES

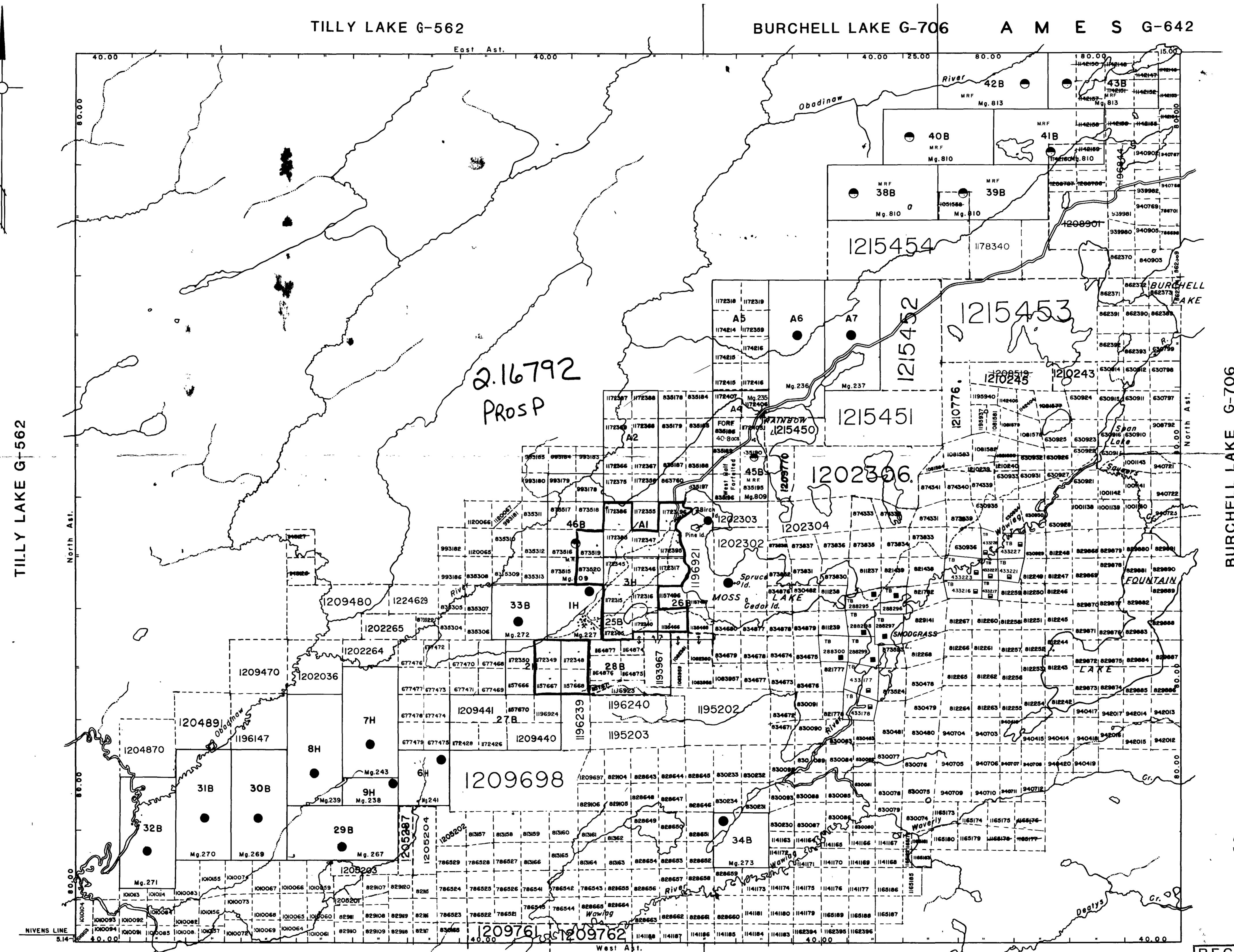
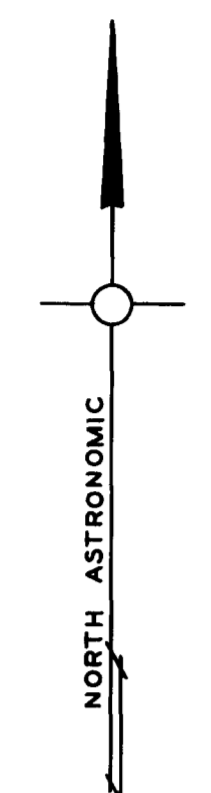

NOTICE:
The information that appears on this map has been compiled from various sources, and accuracy is not guaranteed. Those wishing to stake mining claims should consult with the Mining Recorder, Ministry of Northern Development and Mines, for additional information on the status of the lands shown hereon.

LEGEND

- HIGHWAY AND ROUTE No.
- OTHER ROADS
- TRAILS
- SURVEYED LINES
- TOWNSHIPS, BASE LINES, ETC.
- LOTS, MINING CLAIMS, PARCELS, ETC.
- UNSURVEYED LINES
- LOT LINES
- PARCEL BOUNDARY
- MINING CLAIMS, ETC.
- RAILWAY AND RIGHT OF WAY
- UTILITY LINES
- NON PERENNIAL STREAM
- FLOODING OR FLOODING RIGHTS
- SUBDIVISION OR COMPOSITE PLAN
- RESERVATIONS
- ORIGINAL SHORELINE
- MARSH OR MUSKEG
- MINES
- TRAVERSE MONUMENT

DISPOSITION OF CROWN LANDS

TYPE OF DOCUMENT	SYMBOL
PATENT, SURFACE & MINING RIGHTS	●
SURFACE RIGHTS ONLY	○
MINING RIGHTS ONLY	◐
LEASE, SURFACE & MINING RIGHTS	■
SURFACE RIGHTS ONLY	◼
MINING RIGHTS ONLY	◻
LICENCE OF OCCUPATION	○
ORDER-IN-COUNCIL	OC
RESERVATION	○
CANCELLED	○
SAND & GRAVEL	○
TOWNSHIPS FOR COMMERCIAL TOURISM OUTPOST CAMPS	○

NOTE: MINING RIGHTS IN PARCELS PATENTED PRIOR TO MAY 4, 1913, VESTED IN ORIGINAL PATENTEE BY THE PUBLIC LANDS ACT R.S.O. 1970, CHAP. 380, SEC. 63, SUBSEC. 1

SCALE: 1 INCH = 40 CHAINS

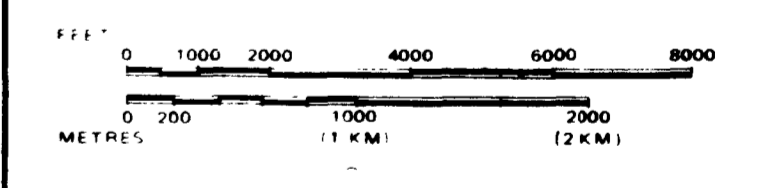

TOWNSHIP
MOSS
M.N.R. ADMINISTRATIVE DISTRICT
THUNDER BAY
MINING DIVISION
THUNDER BAY
LAND TITLES / REGISTRY DIVISION
THUNDER BAY

2.16792

RECEIVED
OCT 1 - 1996
MINING LANDS BRANCH

Ministry of Natural Resources
Land Management Branch
Ontario

Date: MARCH 1982
Number: G-676
In Service Sep. 27/94.



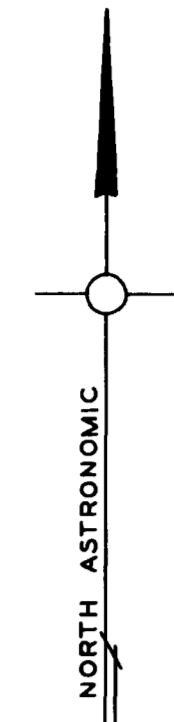

TILLY LAKE G-562

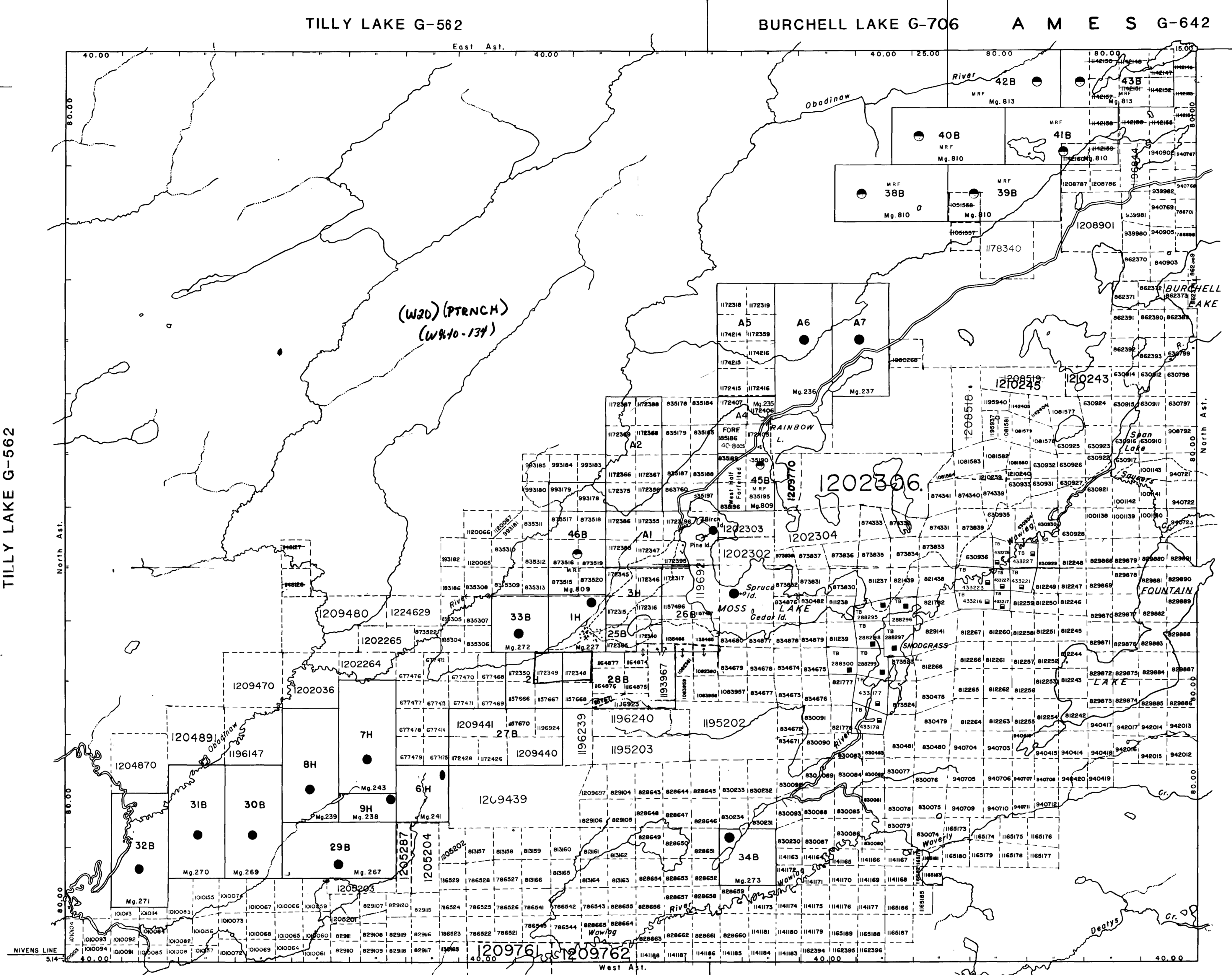

TILLY LAKE G-562

BURCHELL LAKE G-706

A M E S G-642

POWELL LAKE G-549

NELSON LAKE G-745

Thunder Bay
Mining Division
JUN - 6 1996
RECEIVED

NOTICE:
The information that appears on this map has been compiled from various sources, and accuracy is not guaranteed. Those wishing to stake mining claims should consult with the Mining Recorder, Ministry of Northern Development and Mines, for additional information on the status of the lands shown hereon.

LEGEND

- HIGHWAY AND ROUTE No.
- OTHER ROADS
- TRAILS
- SURVEYED LINES
- TOWNSHIPS, BASE LINES ETC.
- LOTS, MINING CLAIMS, PARCELS, ETC.
- UNSURVEYED LINES
- LOT LINES
- PARCEL BOUNDARY
- MINING CLAIMS, ETC.
- RAILWAY AND RIGHT OF WAY
- UTILITY LINES
- NON PERENNIAL STREAM
- FLOODING OR FLOODING RIGHTS
- SUBDIVISION OR COMPOSITE PLAN
- RESERVATIONS
- ORIGINAL SHORELINE
- MARSH OR SHELVEG
- MINES
- TRAVERSE MONUMENT

DISPOSITION OF CROWN LANDS

TYPE OF DOCUMENT	SYMBOL
PATENT, SURFACE & MINING RIGHTS	
... SURFACE RIGHTS ONLY	
... MINING RIGHTS ONLY	
LEASE, SURFACE & MINING RIGHTS	
... SURFACE RIGHTS ONLY	
... MINING RIGHTS ONLY	
LICENCE OF OCCUPATION	
ORDER IN COUNCIL	
RESERVATION	
CANCELLED	
SAND & GRAVEL	

SCALE: 1 INCH = 40 CHAINS

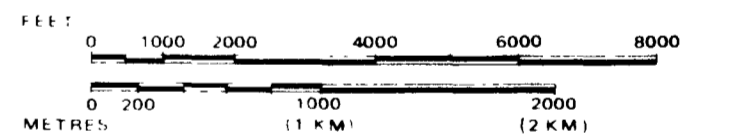

TOWNSHIP
MOSS
M.N.R. ADMINISTRATIVE DISTRICT
THUNDER BAY
MINING DIVISION
THUNDER BAY
LAND TITLES / REGISTRY DIVISION
THUNDER BAY

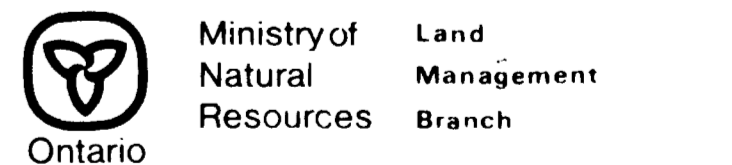

Date MARCH 1982 Number
In Service Sep. 27/94. **G-676**

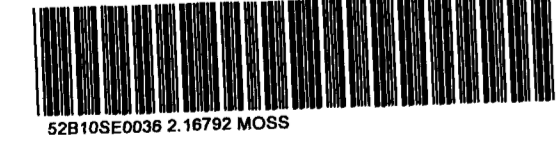

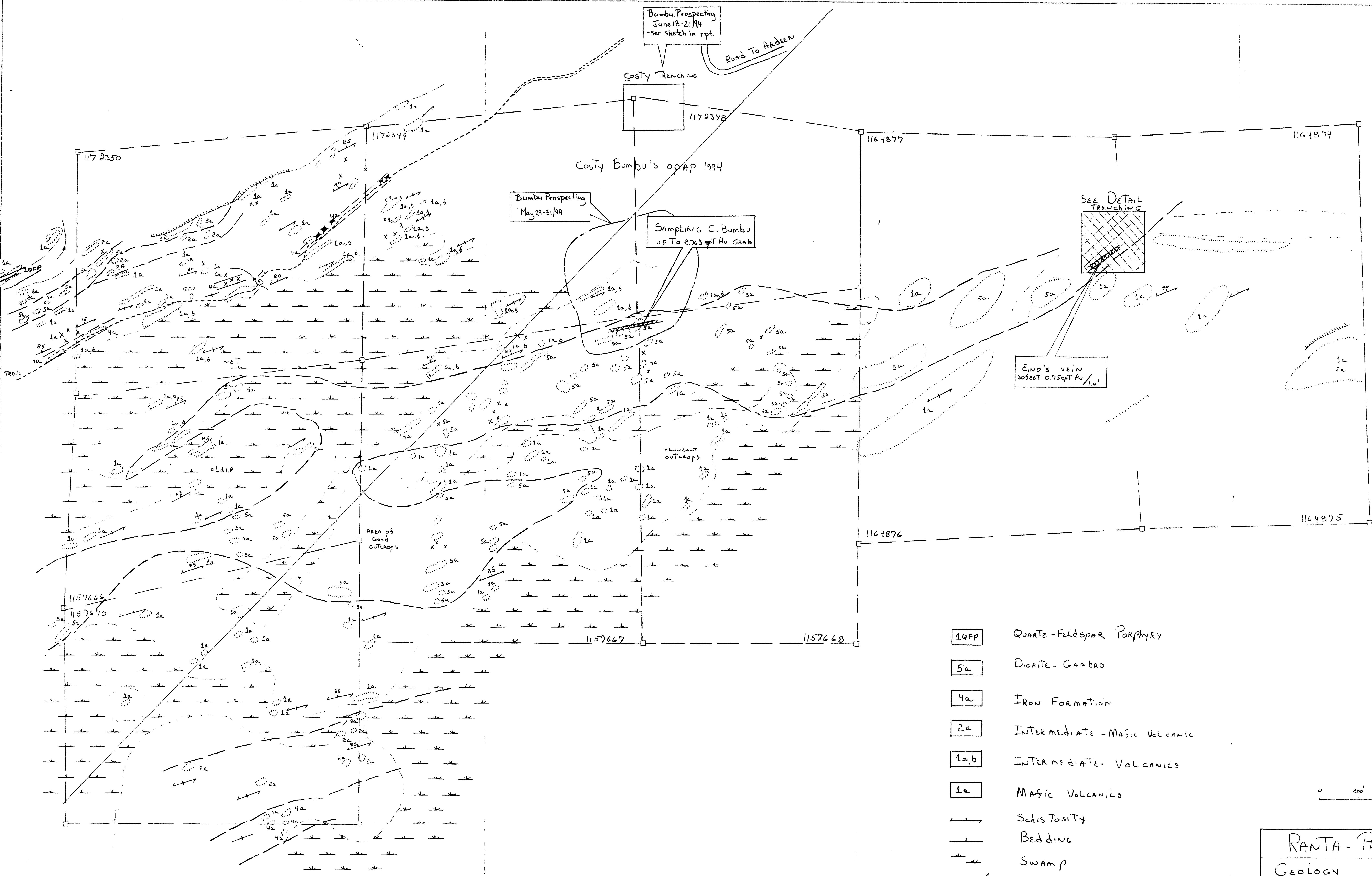

Bumbu Prospecting
June 18-21/94
-see sketch in rpt.

COSTY TRENCHING
1172348

Bumbu Prospecting
May 29-31/94

SAMPLING C. Bumbu
UP TO 2.763 gPT Au GRAB

SEE DETAIL
TRENCHING

EINO'S VEIN
305667 0.75 gPT Au / 1.0'

Road To ARDEN

COSTY Bumbu's OPAP 1994

AREA OF
Good
outcrops

MINOR
OUTCROPS

- 1QFP QUARTZ-FELDSPAR PORPHYRY
- 5a DIORITE-GABBRO
- 4a IRON FORMATION
- 2a INTERMEDIATE-MAFIC VOLCANIC
- 1a,b INTERMEDIATE-VOLCANICS
- 1a MAFIC VOLCANICS
- Schistosity
- Bedding
- Swamp
- Geological contact
- Zone of outcrops
- x Outcrop
- Area Prospected

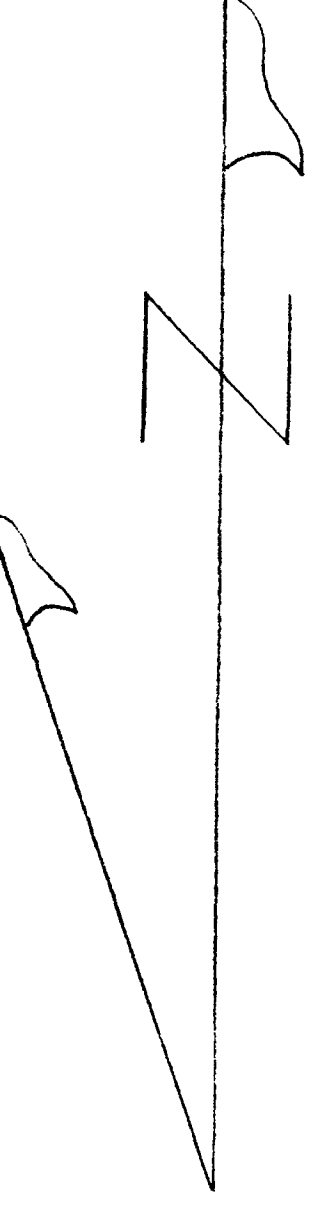
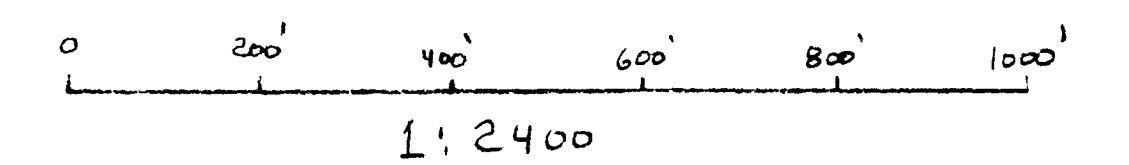

RANTA-PETRUNKA AND ASS	
Geology	OPAP 1994
TOWNSHIP: Moss Township	SCALE: 1:2,400
EXECUTED BY C. LAROCHE DATE Jan 95	
INTERPRETED BY _____ DATE _____	
APPROVED BY _____ DATE _____	
DRAWN BY _____ DATE _____	
MAP No.	N.T.S.



RECEIVED
OCT 1 1996
MINING LANDS BRANCH

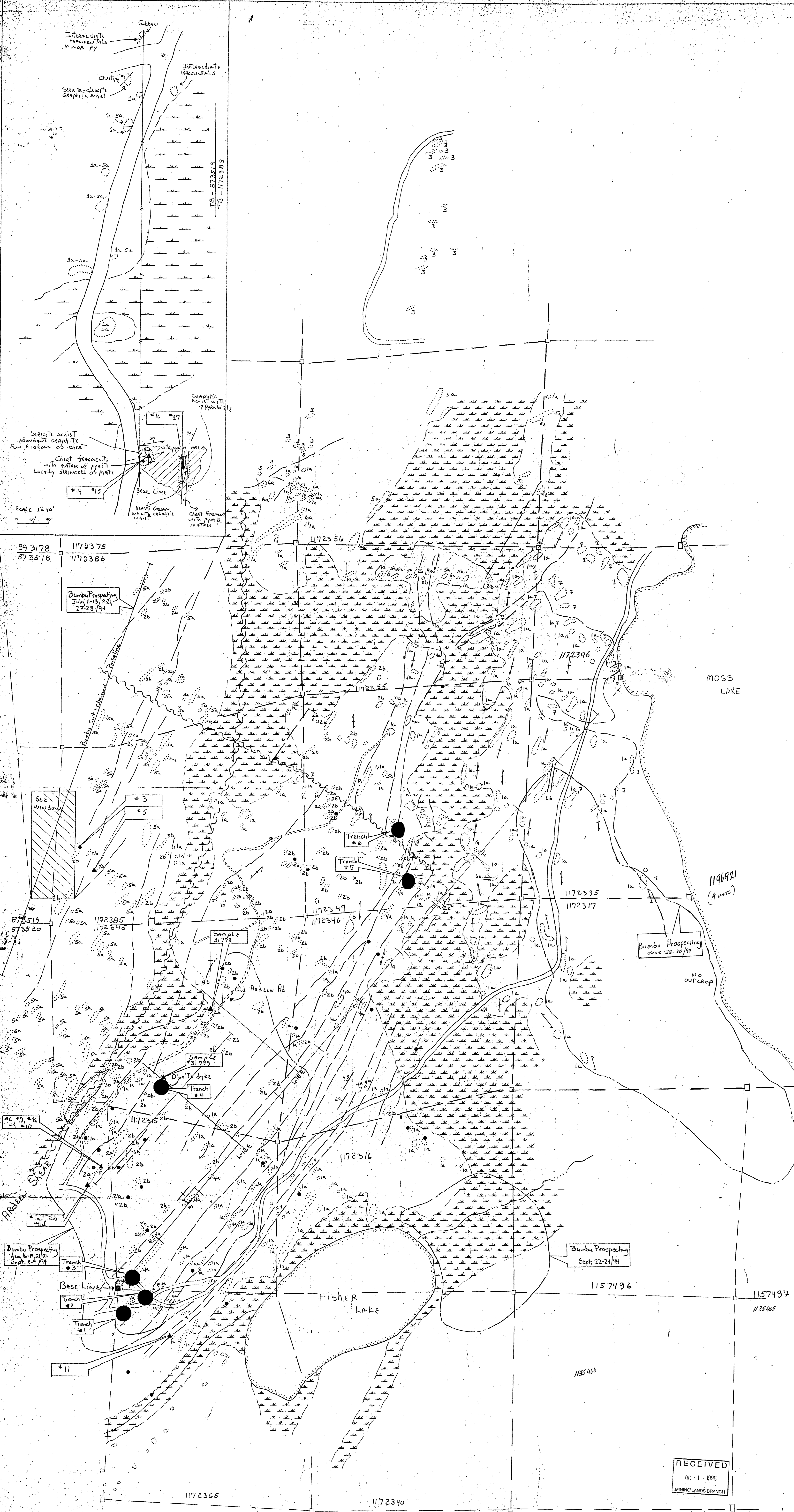
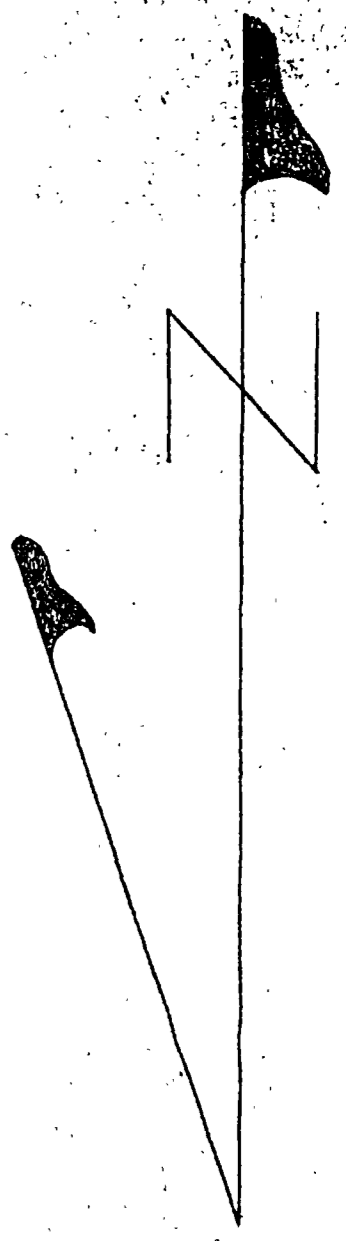

2.16792

RECEIVED
OCT 1 1996
MINING LANDS BRANCH

- LEGEND**
- 2a Mafic Volcanics
 - 2b Felsic to Intermediate Volcanics
 - 3 Sediments
 - 4a Iron Formation, Chert Breccia
 - 5a Gabbro - Diorite
 - 6a Felsic Intrusion
 - 7 Porphyry
 - 8 Syenite
 - Swamp
 - Zone of Outcrops
 - Geological Contact
 - Zone of Shearing
 - Humus Gold Values (Anomalous)
 - Single Outcrop
 - Road
 - Claim Post
 - Lake
 - Bedding
 - Trench
 - Sample Location Number
 - Areas Prospected

2.16792

RECEIVED
OCT 1 1996
MINING LANDS BRANCH

RANTA-PETRUNKA Moss Lake Property
 Compilation Map North Block
 TOWNSHIP: Moss Township SCALE: 1:2400
 EXECUTED BY: DATE: _____
 INTERPRETED BY: DATE: _____
 APPROVED BY: DATE: _____
 DRAWN BY: DATE: _____
 MAP No. N.T.S.