

52B10SW0031 W9640.00603 MOSS

010

RESULTS OF THE EXPLORATION PROGRAM  
( PROSPECTING AND TRENCHING )  
COMPLETED ON THE MOSS LAKE PROPERTY  
BY  
EINO RANTÄ, OPAP-95-299

Thunder Bay, January 1996

By:

Claude Larouche  
Ovalbay Geological Services Inc.  
1070 Lithium Drive, Unit # 3  
Thunder Bay, Ontario  
P7B 6G3  
Tel: (807) 623-3770 Fax: (807) 623-2335



52E10SW0031 W9640.00603 MOSS

010C

2

## TABLE OF CONTENTS

Table of contents .....	2
Introduction .....	3
Location and Access .....	4
Claims .....	7
Previous Work .....	9
Regional Geology .....	11
Recent Work.....	14
Conclusions and Recommendations .....	15
Costs of Work .....	16
Certificate of Qualifications .....	17
Description of Samples .....	18

### List of Figures

Figure 1: Location Map .....	5
Figure 2: Access roads .....	6
Figure 3: Sketch of claims ...	8
Figure 4: Regional Geology ...	13
Figure 5: Trench # 1	
Figure 6: Trench # 2	
Figure 7: Trench # 3	
Figure 8: Trench # 4	
Figure 9: Trench # 5	
Figure 10:Trench # 6	
Figure 11:Prospecting south zone	

### List of Maps ( in pocket )

Map 1: Compilation map	
------------------------	--

## INTRODUCTION

Ovalbay Geological Services Inc. was commissioned to complete a report on the Moss Township gold mining property located within the Thunder Bay Mining District, Ontario, Canada. The following report discusses the results of the exploration programs carried out recently on the group of claims along with a general overview of all pertinent information contained within previous reports. The recent exploration program included prospecting and trenching following the results of diamond drilling completed the previous year.

Supplies, qualified manpower and all types of equipment and contractors are readily and economically available from Thunder Bay and the surrounding areas. Abundant water is available from the lakes and streams which cross the claim group. This water would easily satisfy a mining operation and exploration needs. Hydro electric power exists along Highway # 11 some 18 kilometers to the north and a gravel pit lies within 5 kilometers of the property.

#### LOCATION AND ACCESS

The Moss Lake property is located (figure 1) within the central part of Moss Township, approximately 285 kilometres by road, west of Thunder Bay, within the Thunder Bay Mining District, Northwestern Ontario, Canada.

Access to the claim block ( figure 2) is via Highway # 11 and road #802 south (Burchell Lake Road) which branches from Highway # 11, 1.5 kilometres past Kashabowie, a small town off Highway # 11, some 110 kilometres west of Thunder Bay. From road # 802 south, Great Lakes Pulp and Paper logging roads give access to the area around the Old Ardeen Mine.

The topography is relatively flat with gently rolling hills. Most of the claim block is still covered by a mature forest of black spruce, jack pine, poplar, aspen and birch in the well drained areas and swamps are also abundant in the small valleys. The overburden, sand, gravel and clay, is relatively thin and rock exposures is fair. A small lake ( Fisher Lahe ), Moss Lake and numerous creeks would supply abundant fresh water for any mining operation.

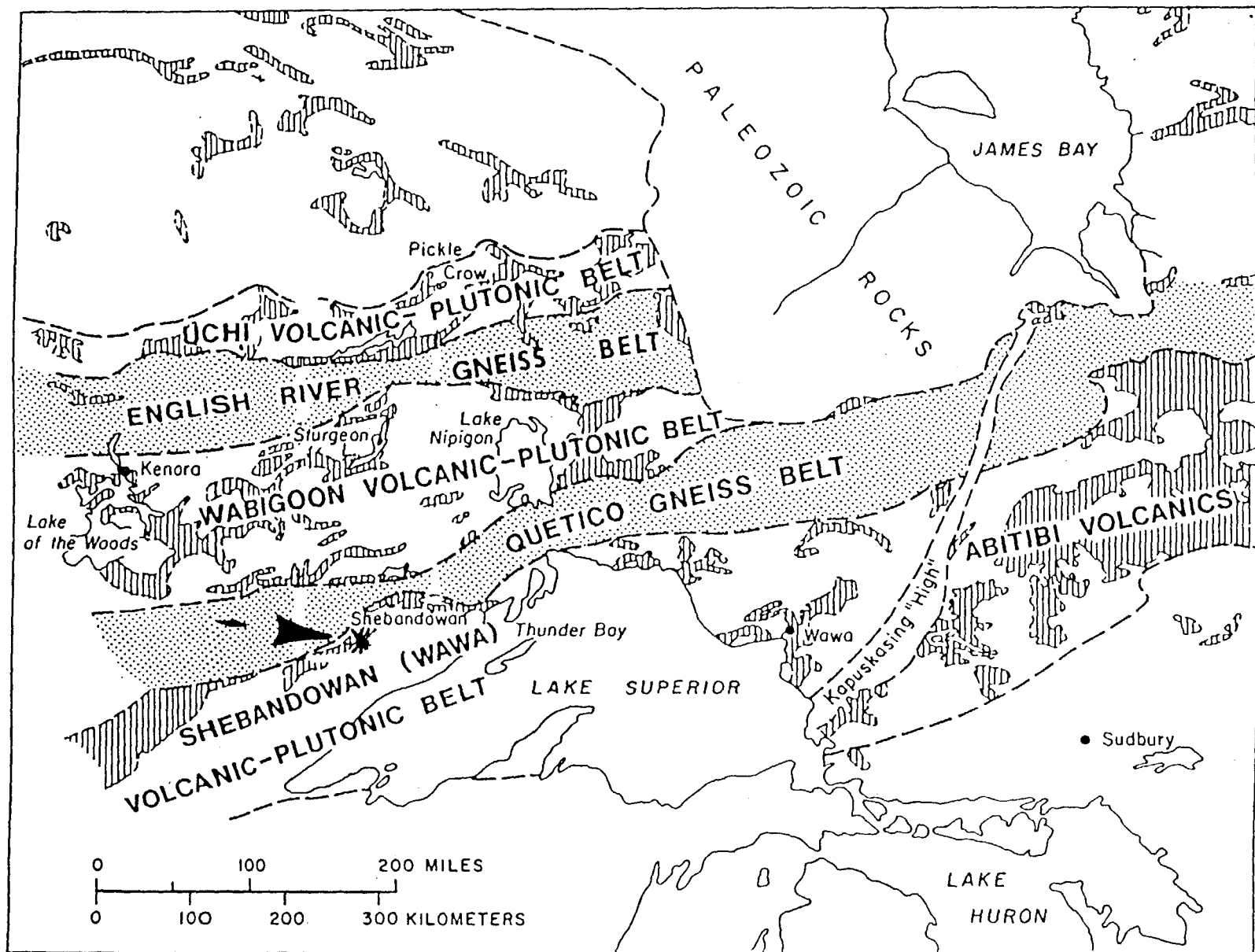

Figure 1: Location Map

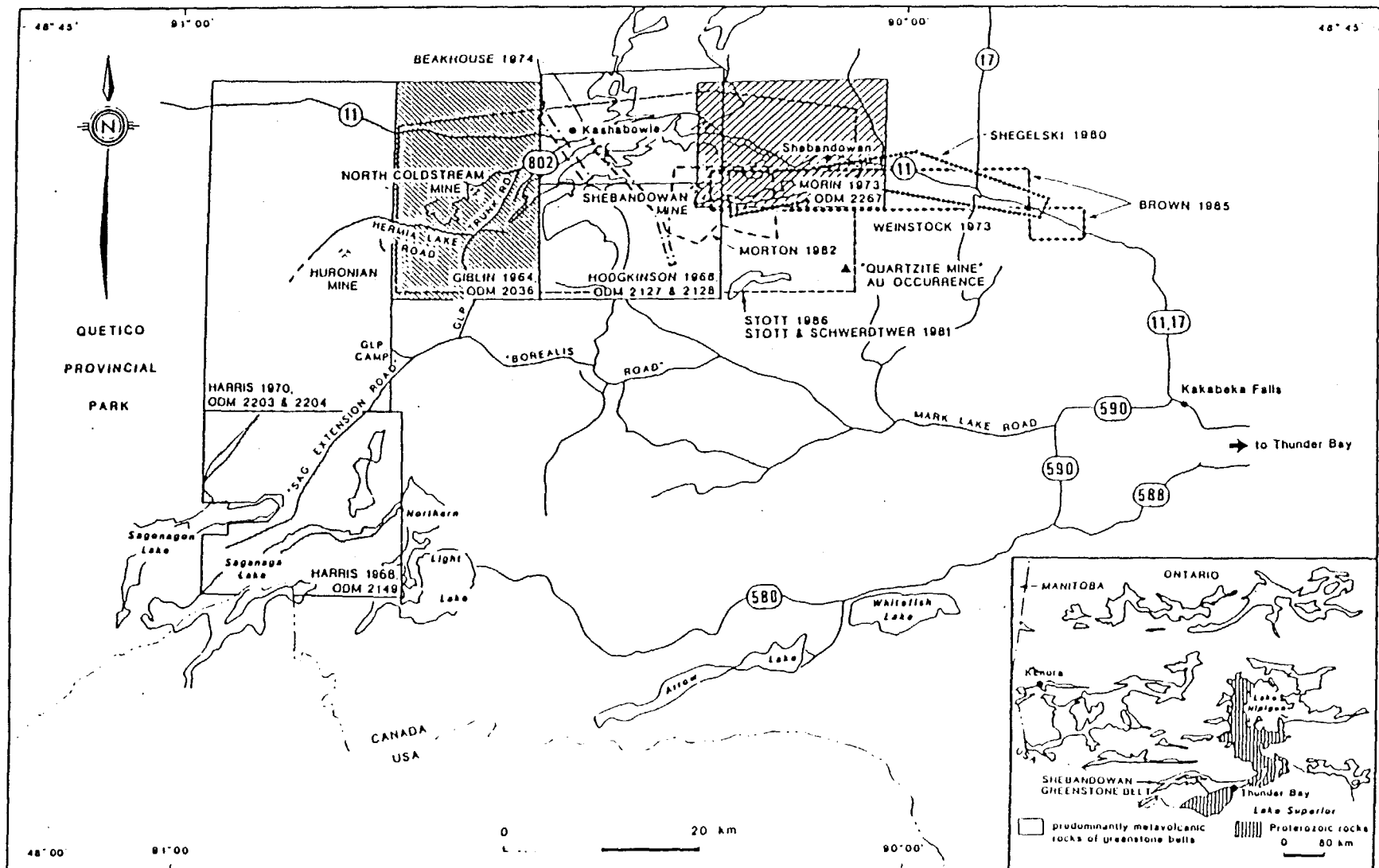

Figure 2: Access to the Study Area

### CLAIMS

The mining property comprises four blocks of claims which were united together by an agreement dated June 1994 by which D. Petrunka and Ass. and E. Ranta and Ass. joined their properties in order to negotiate an option agreement with a junior or major exploration company.

A sketch of the claims is presented on figure 3; all claims are recorded with the office of the Mining Recorder in Thunder Bay and are all in good standing.

Claim number:

1164874  
1164875  
1164876  
1164877

Claims number:

1141231	1141232	1141233
1141234	1141235	1141236
1141237	1141238	1141239
1141240	1122750	1122751
1122752	1122753	1122754

Claims number

1172348	1172349	1172350	1157666	1157667
1177668	1157670	1157671	1172315	1172316
1172317	1172340	1172345	1172346	1172347
1172355	1172356	1172385	1172386	1172375
1172366	1172369	1172397	1172398	1172368
1172367	1172396	1172395	1157496	1157497
1135458	1135465	1172305	1196921	1202302

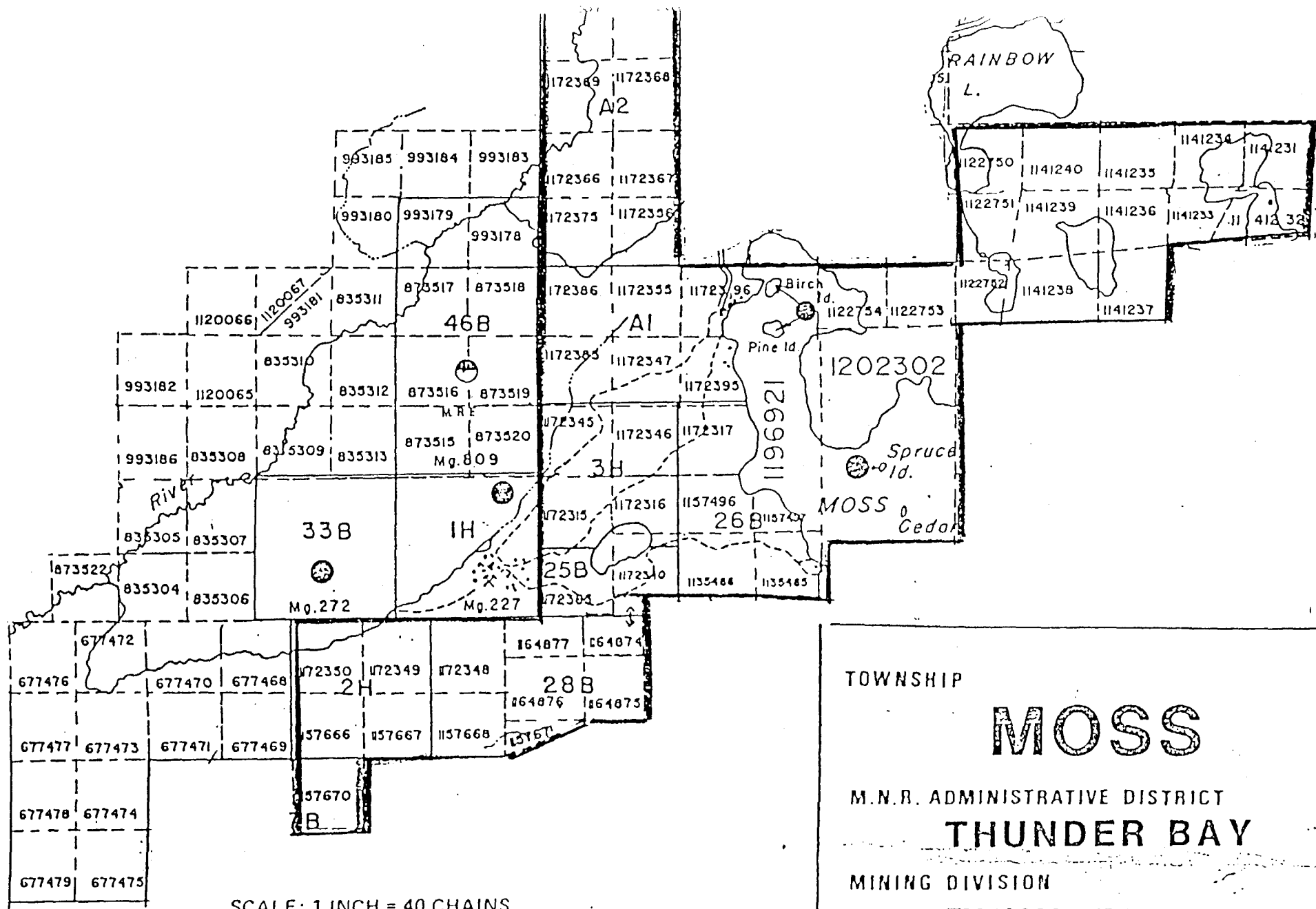

SCALE: 1 INCH = 40 CHAINS

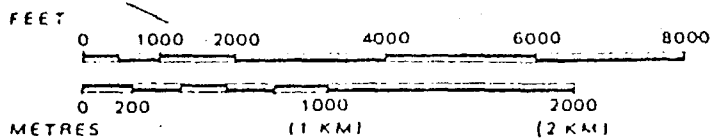

TOWNSHIP

**MOSS**

M.N.R. ADMINISTRATIVE DISTRICT

**THUNDER BAY**

MINING DIVISION

**THUNDER BAY**

LAND TITLES / REGISTRY DIVISION

**THUNDER BAY**



## PREVIOUS WORK

The Shebandowan area hosts a number of important gold and base metal deposits. The Coldstream mine produced 2.7 millions tons grading 1.9 % copper with accessory gold and silver. The Coldstream Main Gold Zone to the southeast of the underground workings has contained reserves of 3.0 million tons grading 0.15 opt Au. In addition the Moss Lake deposit 4 miles to the east of the study property has outlined reserves of 100 million tons grading 0.032 opt Au.

Gold was first discovered near the property in 1971. At this time, the mining claims encompassing the Ardeen deposit were staked and surveyed. This discovery is recognized as being the first gold deposit found in Northern Ontario. Production from the mine amounted to 143,724 tons of ore which yielded 29,678 ounces of gold and 172,617 ounces of silver.

During the brief operating life of this deposit, down strike extensions of the deposit were investigated. The McKellar vein which lies on the southern claims of the study area, was trenched at a number of locations.

In 1957, Noranda conducted exploration on portions of the claims. This program was targeted at base metals. A grid was established and subsequent work consisted of geological mapping and geophysical surveys.

In 1971 and 1972, Belore Mines conducted Geophysics and diamond drilling on the Ardeen Mine property. Two drill holes 72-05 and 09 intersected 1.12 opt Au over 12.54 feet and 0.15 opt Au over 15 feet respectively. These holes were drilled on the southern extension of the Mine shear, near the north boundary of the west claims under study.

During 1973-74, Dome exploration held the ground under option from Belore Mines. Dome conducted a programme of mapping and geophysics followed by diamond drilling. Seventeen holes were drilled totalling 5,567 feet. Drilling was concentrated in and around the old mine workings. A number of the holes intersected economic gold mineralization within iron formation south of the mine workings. This was the first time that gold in iron formation had been tested on the property.

From 1976 until 1982, the ground was held from staking by the provincial government.

Matt Berry Mines conducted a drill programme during 1986 - 1988. This programme primarily investigated the down dip and strike extensions to the south west of the Ardeen deposit. One hole intersected 1.2 opt Au over 5 feet within an iron formation.

During a regional geological reconnaissance programme Gold Fields Canadian Mining Limited identified a number of exploration targets on the property. The ground was subsequently staked in October of 1990. An airborne geophysical survey consisting of magnetometer and VLF-Em was then conducted over the land package.

In October of 1991, Akiko Lori Gold Resources entered into a joint venture agreement with Gold Fields Canadian Mining Limited, whereby Akiko Lori would earn a 50% interest in the property by exploration expenditures on the claims over a three year period.

A reconnaissance mapping and mechanical trenching programmes were conducted on the claims by Akiko Lori during October of 1991. These programmes identified a number of high grade gold occurrences on the claims which were deemed to warrant further evaluation. A limited drilling programme was completed in 1992.

## REGIONAL GEOLOGY

Taken from I. A. Osmani (1991), Miscellaneous paper # 157, p. 268 - 275.

All rocks, except diabase dikes, are Archean in age (Corfu and Scott 1986). The map area includes part of the western Shebandowan greenstone belt of the Wawa Subprovince and metasedimentary rocks of the Quetico Subprovince. The Shebandowan belt is an arcuate supracrustal mass which forms the northern margin of the Wawa Subprovince in Northwestern Ontario. The greenstone belt is bounded to the north by the metasedimentary rocks and associated granitic intrusions of the Quetico Subprovince and to the south by a granitoid batholithic complex. To the north, the contact with the Quetico metasedimentary rocks is both conformable and fault-bounded (Giblin 1964; Harris 1970; Scott 1985).

Within the study area, the Shebandowan greenstone belt is bounded to the northwest by metasedimentary rocks of the Quetico Subprovince. The northern contact of the belt with the metasedimentary rocks, where exposed, is sheared; elsewhere the contact zone is underlain by regional topographic linear features.

The Shebandowan belt, within the study area, is chiefly comprised of mafic to felsic metavolcanic units, which have been intruded by numerous syn- to post-tectonic mafic to felsic intrusive rocks. The metavolcanic rocks of the belt, in general, form a homoclinal, north-younging sequence. The supracrustal rocks are informally subdivided into four units, namely:

- 1-) a northern mafic to intermediate metavolcanic unit;
- 2-) a southern mafic to intermediate metavolcanic unit;
- 3-) a central felsic to intermediate metavolcanic unit;
- 4-) a central mafic to intermediate metavolcanic unit.

Narrow slivers ( from a few metres up to 2 kilometres long ) of mafic metavolcanics are also found within the Quetico metasedimentary belt.

Figure 4: Regional Geology

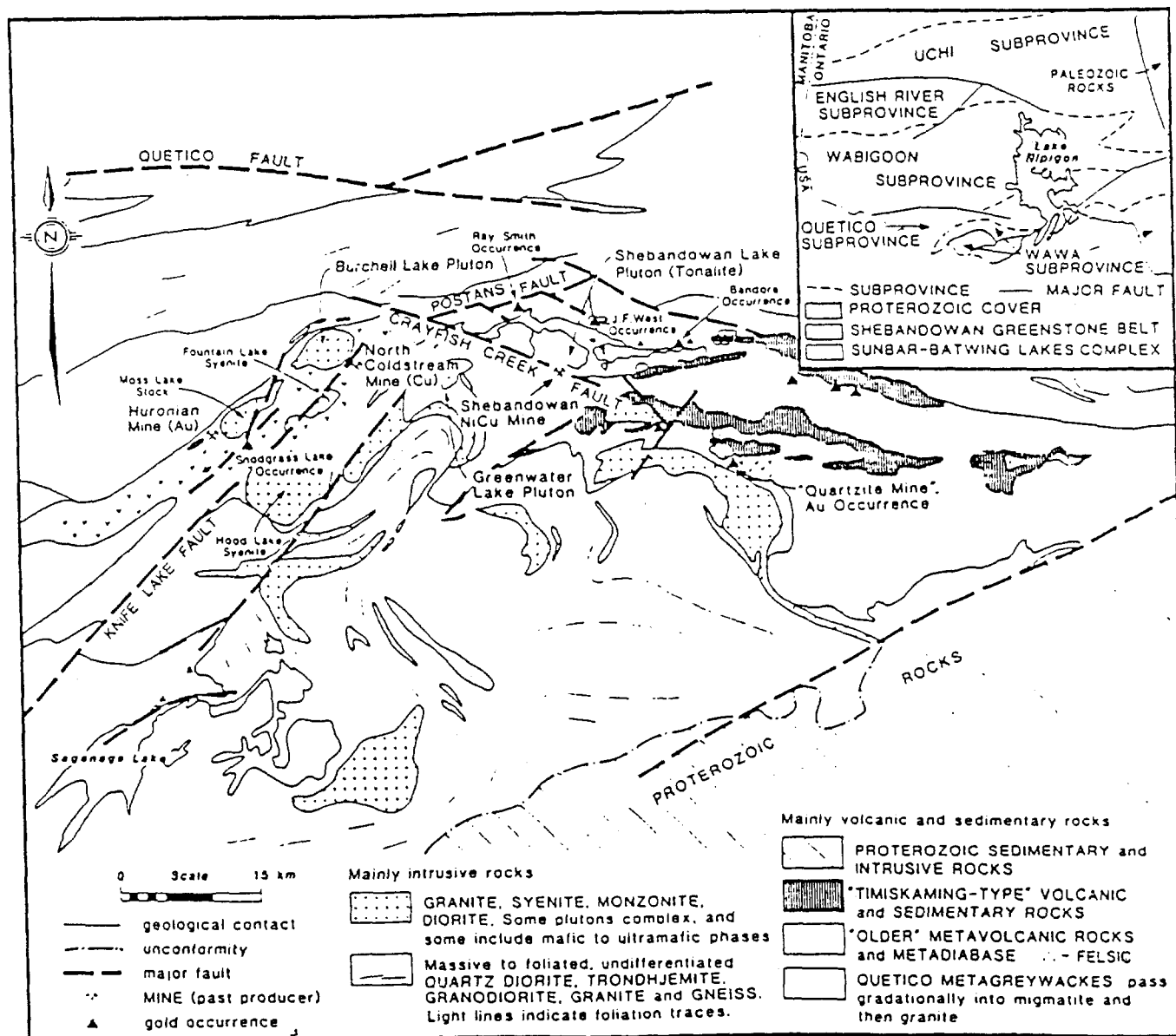

## RECENT WORK

During the summer of 1995 ( from May 15 to December 31, 1995, an exploration program was undertaken on the Moss township property by Eino Ranta, prospector of Thunder Bay, Ontario following the approval of an Opap grant. The exploration work included general prospecting and trenching at 6 different locations.

A total of 15 days were spent prospecting in the general areas of the new trenches. The prospecting was oriented at locating the most promising places for the trenches.

The areas prospected are present on the compilation map ( Map 1 ) accompanying the present report. The locations of the different trenches is also indicated by a dot.

While prospecting in the southwestern portion of the claim block, a new gold showing was discovered ( figure 11 ). This 8 inches wide quartz vein carries a significant amount of chalcopyrite and assays are up to 2.90 opt Au. The structure is oriented roughly east - west, parallel to another high grade gold structure previously discovered some 110 meters to the north.

A series of 6 trenches were located on the property and some 9 days were spent on the trenching. A backhoe from R. Methot of Thunder Bay Ontario was contracted for a total of 29 hours including mobilisation and demobilisation. The areas trenched have been cleaned with high pressure pumps and sampled using a gas plugger. A helper ( Riley Sabourin ) was hired for a period of 12 days for the trenching.

Trench # 1 ( figure 5 ) is located along the southwest extension of an iron formation which is cut by an east - west shear zone which grades 0.75 opt Au, over an average width of 5.0 feet and for a length of 100 feet. The trenched area did not exposed the western extension of the shear zone.

Trench # 2 ( figure 6 ) is located close to a drill hole completed by Akiko Lori in 1992. The trench was aimed at investigating another possible east west shear zone crossing the iron formation.

Trench # 3 ( figure 7 ) was completed in order to exposed an old trench in an area where gold values are reported



# ACCURASSAY LABORATORIES

A DIVISION OF ASSAY LABORATORY SERVICES INC.

1070 LITHIUM DRIVE, UNIT 2  
THUNDER BAY, ONTARIO P7B 6G3  
PHONE (807) 623-6448  
FAX (807) 623-6820

Page 1

EINO RANTA  
P.O. BOX 2448  
THUNDER BAY, ONTARIO  
P7B 5E9

October 11, 1995

Job #9541548

Accurassay	Sample # Customer	Gold ppb	Gold Oz/t
	1 101	<5	<0.001
	2 102	33	<0.001
	3 Check 102	31	<0.001

Certified By: \_\_\_\_\_

*[Handwritten Signature]*



# ACCURASSAY LABORATORIES

A DIVISION OF ASSAY LABORATORY SERVICES INC.

1070 LITHIUM DRIVE, UNIT 2  
THUNDER BAY, ONTARIO P7B 6G3  
PHONE (807) 623-6448  
FAX (807) 623-6820

Page 1

EINO RANTA  
P.O. BOX 2448  
THUNDER BAY, ONTARIO  
P7B 5E9

November 6, 1995

Job #9541734

Accurassay	SAMPLE # Customer	Gold ppb	Gold Oz/t
1	M-203	1778	0.052
2	M-204A	25	<0.001
3	M-204B	9	<0.001
4	M-205	9	<0.001
5	Check M-205	9	<0.001

Certified By: 



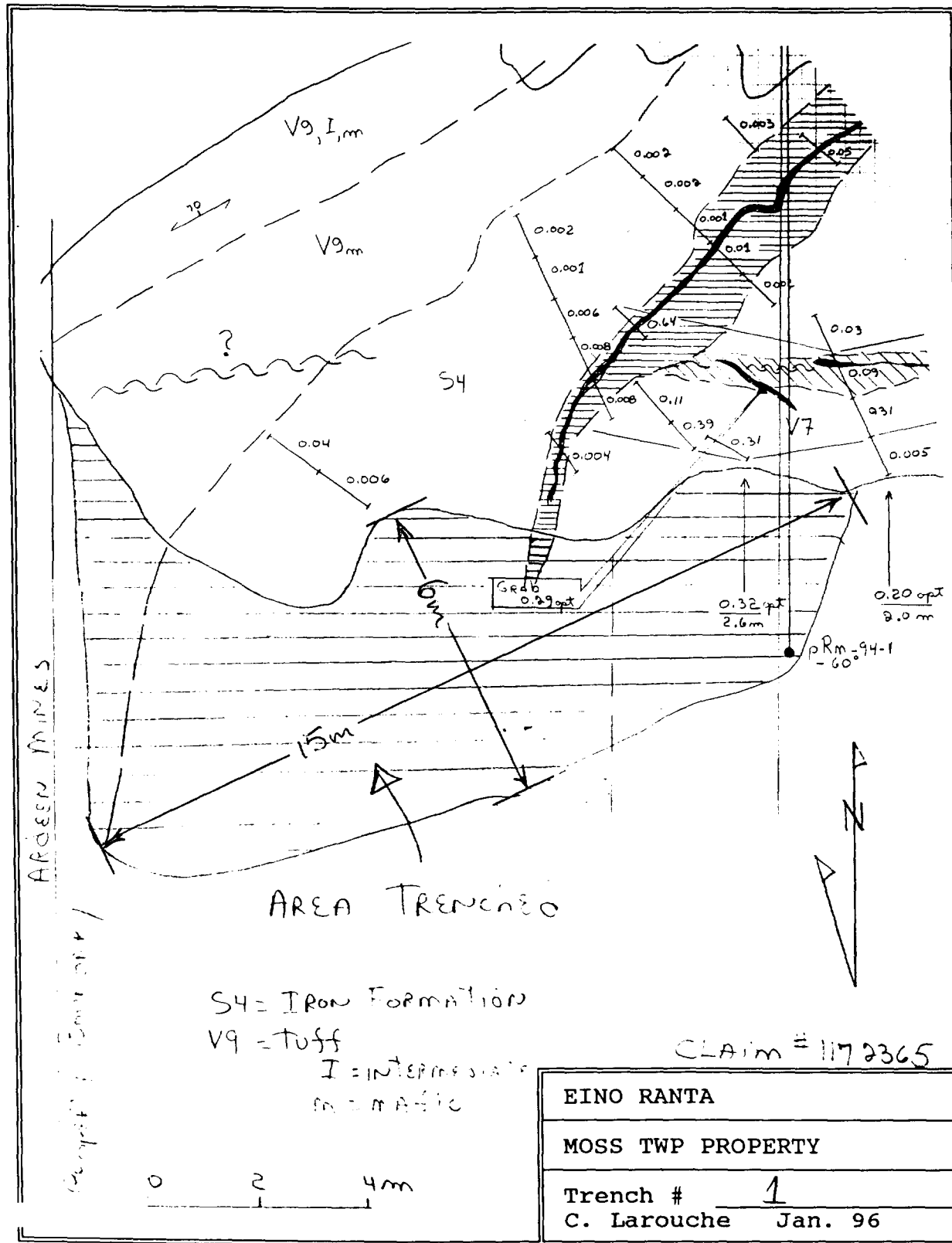

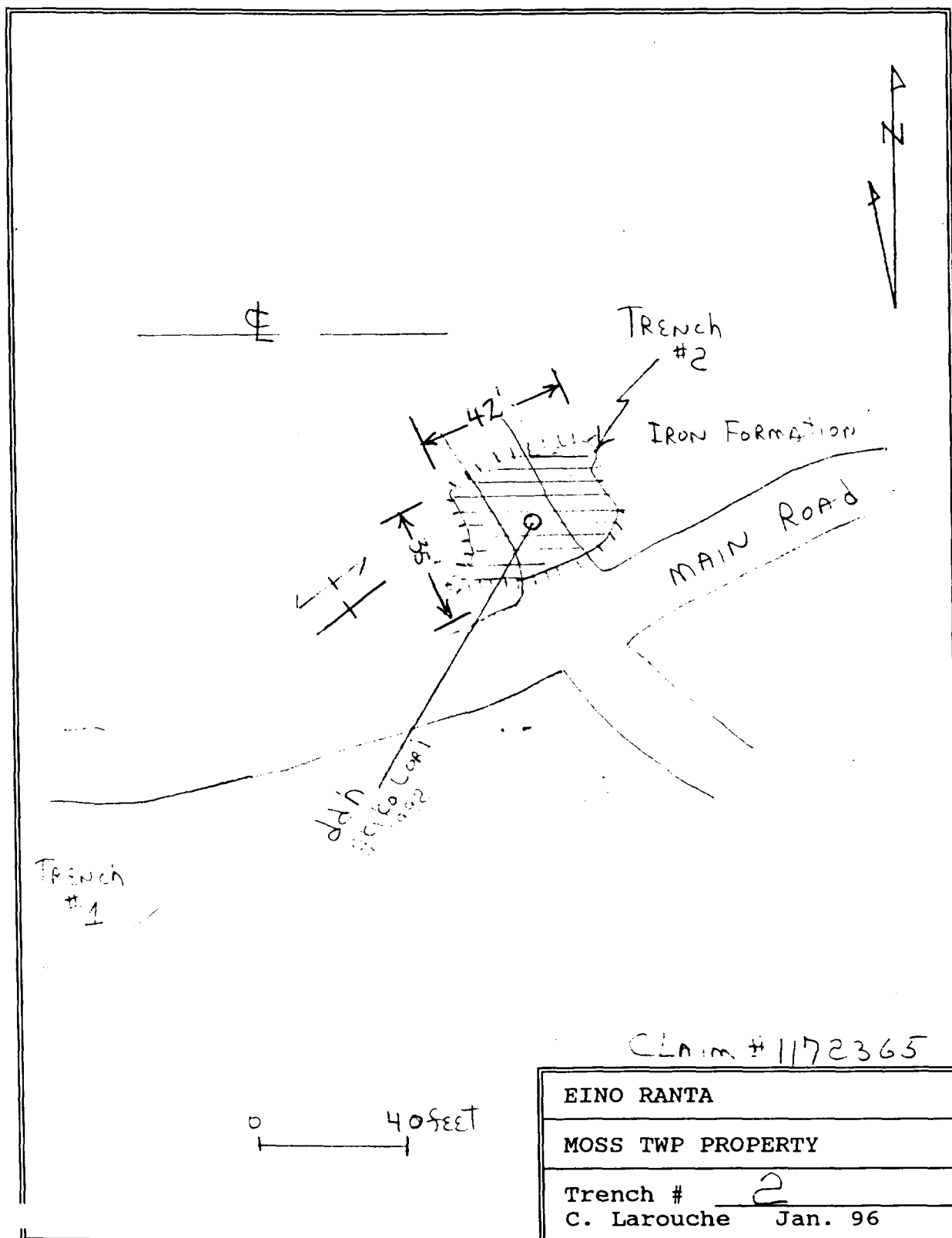

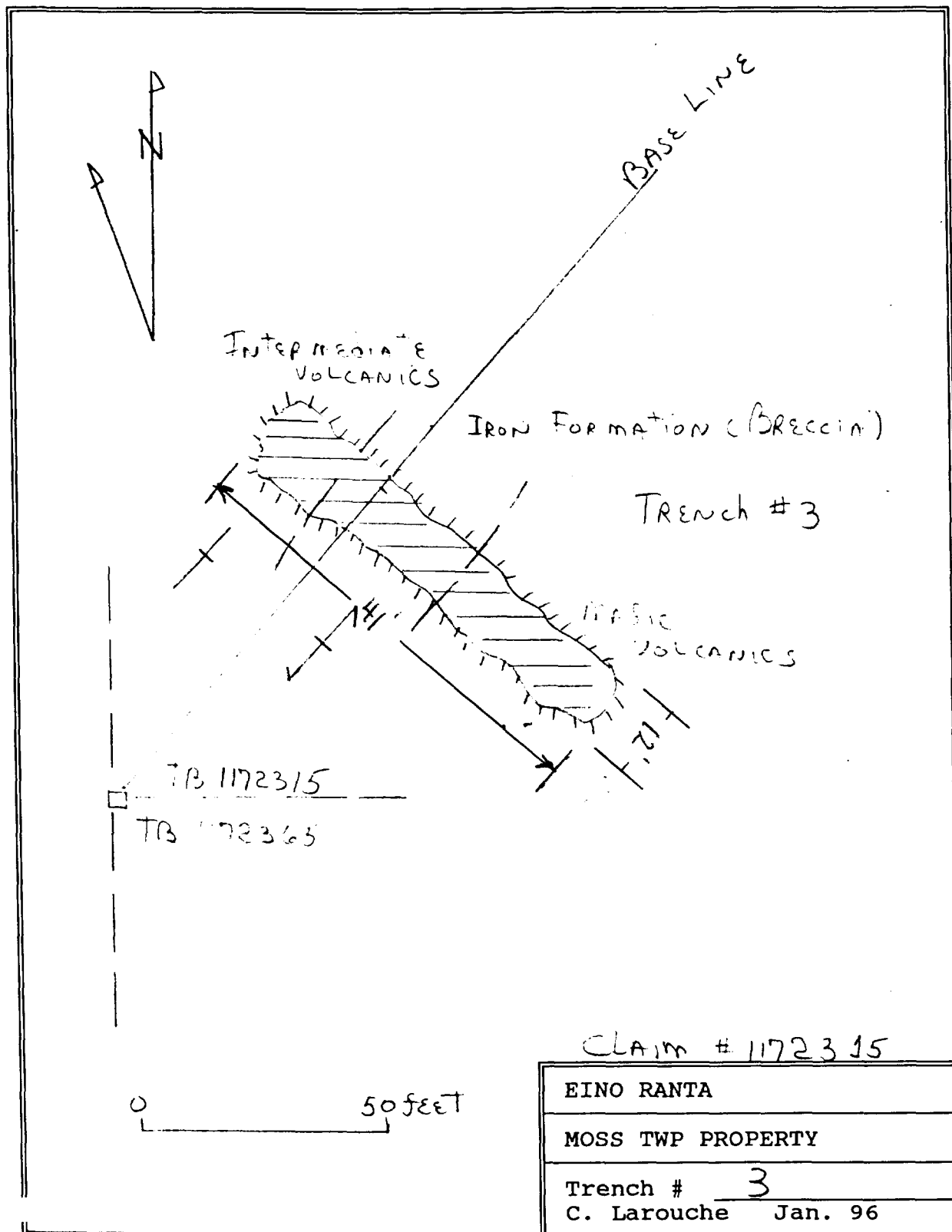

GLASS

0.1

INTERMEDIATE

RUSTY HEAP + PY

VOLCANICS

70'

SAMPLE # M-203

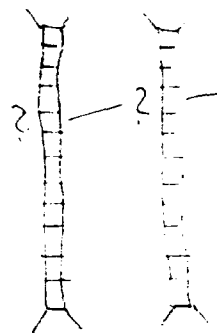

0 20 40 meters

EINO RANTA

MOSS TWP PROPERTY

Trench #

4

C. Larouche

Jan. 96

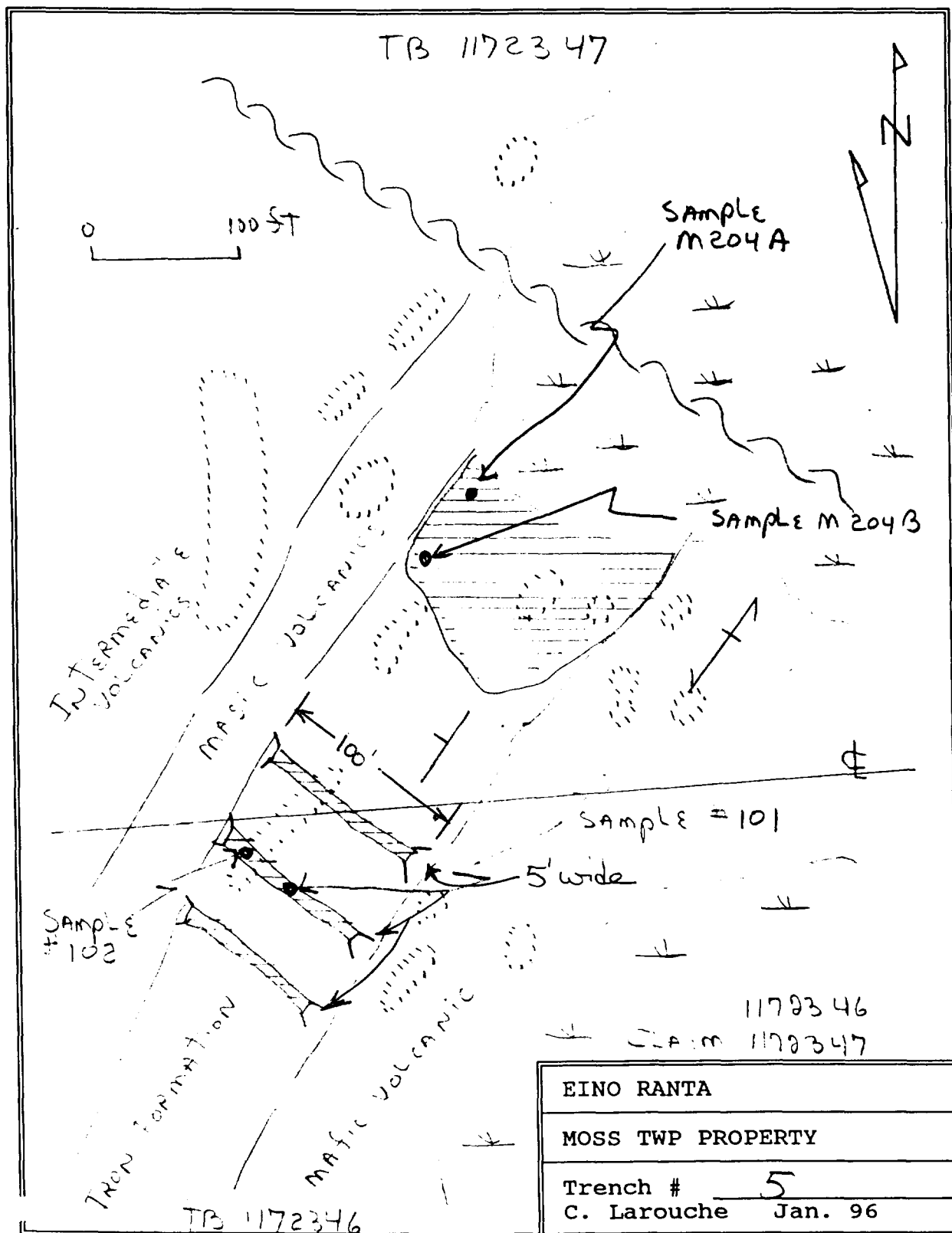

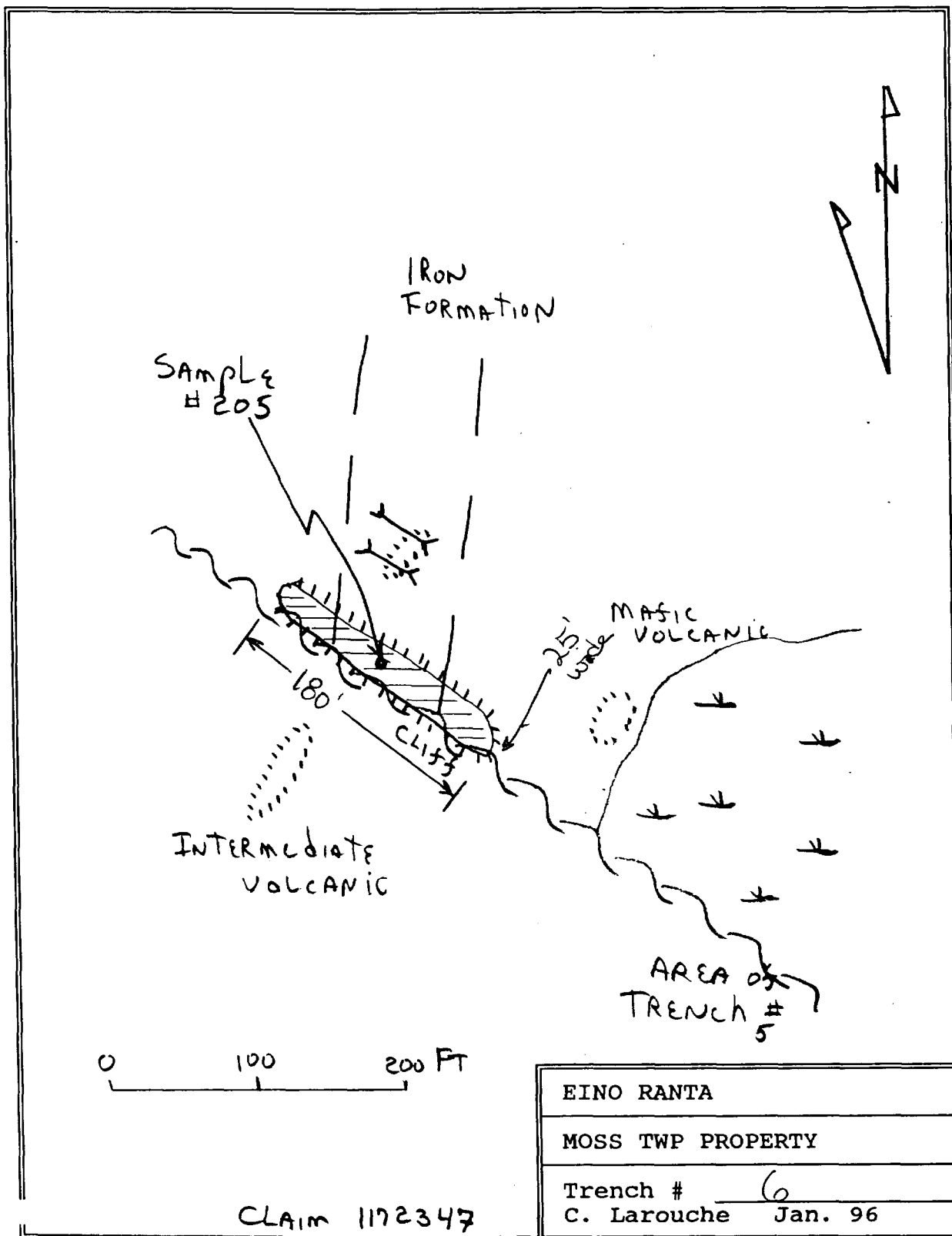



by previous operators.

Trench # 4 ( figure 8 ) is located on a new gold showing discovered in the past few years. A rusty and sheared zone was believed to be associated to a diorite oriented roughly north south. The trenching indicates that the zone is oriented more east west and follows the north side of a small cliff.

Trenches # 5 and 6 ( figures 9 and 10 ) are located in an area where a major shear zone appears to displace the main iron formation. These areas are believed to represent good targets for gold exploration in the general area. No gold values of economic interest were returned from sampling trenches # 5 and # 6.

#### CONCLUSIONS AND RECOMMENDATIONS

The results of the prospecting and trenching permitted to obtain more information on the geology and the structure in the immediate area. A new gold showing has been discovered in the southwestern part of the claims under study.

It is recommended to continue the systematic exploration of the area under study.

Trenching and diamond drilling are recommended for a total of \$ 100,000.



## COSTS OF WORK

Prospecting, stripping, washing and sampling 24 days @ \$100.00/day .....	\$ 2,400.00 -
Helper ( Riley Sabourin ) 12 days @ \$100.00/day .....	\$ 1,200.00 -
Backhoe ( Rene Methot Excavation ) mobilisation and demobilisation 9 hr at \$80.25/ hr.....	\$ 722.25 -
Trenching 20 hr at \$96.30/hr' .....	\$ 1,926.00 -
Assays .....	\$ 170.13 -
Supplies	
Chaltrek .....	\$ 50.60
Gear Up for Outdoor .....	\$ 17.25
Bole's Feeds Ltd .....	\$ 47.12 *
Explosives .....	\$ 207.41 -
Rental Gas plugger Thunder Bay Comp. ....	\$ 103.50 -
Food 24 + 12 days @ \$15.00/day .....	\$ 540.00 -
Transportation 24 trips at 285 km 6,840 km @ \$0.30/km .....	\$ 2,052.00 -
Report, drafting and property visit 3 days @ \$350.00/day .....	\$ 1,050.00
Photocopies and reproductions .....	\$ 132.50 -
Total	<u>\$ 10,618.76</u>

**THIS IS TO CERTIFY THAT;**

- I am a resident of Thunder Bay, Province of Ontario, Canada ( 385 Riviera Drive, Thunder Bay, Ontario, P7B 6K2).
- I have been engaged in mining exploration since 1974 and have been consulting as a professional geological engineer since 1980.
- I am a graduate of Quebec University, Chicoutimi ( B. Sc. Eng., 1974) and Carleton University ( M. Sc. Geol., 1979).
- I am a member of the Order of Engineers of the Province of Quebec.
- This report is based on pertinent informations from previous data and the author personal supervision of the project along with the execution of some of the exploration works.

**Signed in Thunder Bay, January 1996**



**Claude Larouche, P. Eng.**

## SAMPLES DESCRIPTION

101 Grab sample, iron formation  
 Au: < 5 ppb

102 Grab sample, iron formation  
 Au: 33/31 ppb

M 203 Grab sample, rusty shear zone, disseminated pyrite  
 Au: 1778 ppb

M 204 A Grab sample, iron formation  
 Au: 25 ppb

M 204 B Grab sample, iron formation  
 Au: 9 ppb

M 205 Grab sample same as M 204 B  
 Au: 9 ppb

9676 Grab sample, quartz vein rich in pyrite and  
 chalcopyrite  
 Au: 101126 ppb 2.950 opt Au  
 70182 ppb 2.046 opt Au

9677 Grab sample, same as 9676, 4 feet east  
 Au: 5175 ppb 0.151 opt

9678 Grab sample, same as 9677, 4 feet east  
 Au: 3278 ppb 0.096 opt

9679 Grab sample, same as 9678, 4 feet east  
 Au: 2305/2391 ppb 0.067/0.070 opt



# ACCURASSAY LABORATORIES

A DIVISION OF ASSAY LABORATORY SERVICES INC.

1070 LITHIUM DRIVE, UNIT 2  
THUNDER BAY, ONTARIO P7B 6G3  
PHONE (807) 623-6448  
FAX (807) 623-6820

Page 1

EINO RANTA  
P.O. BOX 2448  
THUNDER BAY, ONTARIO  
P7B 5E9

July 12, 1995

Job #954900

Accurassay	Sample #	Customer	Gold ppb	Gold Oz/t
	1	9676	101126	2.950
	2 CHECK	9676	70132	2.046

Certified By: \_\_\_\_\_

*Chris Bever*



# ACCURASSAY LABORATORIES

A DIVISION OF ASSAY LABORATORY SERVICES INC.

1070 LITHIUM DRIVE, UNIT 2  
THUNDER BAY, ONTARIO P7B 6G3  
PHONE (807) 623-6448  
FAX (807) 623-6820

Page 1

EINO RANTA  
P.O. BOX 2448  
THUNDER BAY, ONTARIO  
P7B 5E9

July 26, 1995

Job #954976

Accurassay	Sample #	Customer	Gold ppb	Gold Oz/t
	1	9677	5175	0.151
	2	9678	3278	0.096
	3	9679	2305	0.067
	4 CHECK	9679	2391	0.070

Certified By: \_\_\_\_\_



Declaration of Assessment Work Performed on Mining Land

Mining Act, Subsection 65(2) and 66(3), R.S.O. 1990

ERLIS Transaction Number (office use) N7640.603 Assessment Files Research Imaging

Personal information collected on this form is obtained under the authority of subsection 65(2) of the Mining Act, the information is a public record. This information will be used for the purposes of the Mining Act. Questions about this collection should be directed to the Chief Information Officer, 933 Ramsey Lake Road, Sudbury, Ontario, P3E 6B5.



900

Instructions: - For work performed on Crown Lands by the Ministry of Northern Development and Mines, please type or print in ink.

1. Recorded holder(s) (Attach a list if necessary)

Form with fields for Name, Address, Client Number, Telephone Number, and Fax Number. Handwritten entry: 1200157 ONTARIO INC. 10 TICHESTER ROAD SUITE 307 TORONTO, ONT. M5P 3M4

2. Type of work performed: Check (✓) and report on only ONE of the following groups for this declaration.

Form with checkboxes for Geotechnical, Physical, and Rehabilitation work. Includes fields for Work Type (STRIPPING, TRENCHING, ASSAYS), Dates Work Performed (15/5/95 to 31/12/95), Township/Area (MOSS TWP.), and Mining Division (Thunder Bay).

Please remember to: - obtain a work permit from the Ministry of Natural Resources as required; - provide proper notice to surface rights holders before starting work; - complete and attach a Statement of Costs, form 0212; - provide a map showing contiguous mining lands that are linked for assigning work; - include two copies of your technical report.

3. Person or companies who prepared the technical report (Attach a list if necessary)

Form with fields for Name, Address, Telephone Number, and Fax Number. Handwritten entry: ONI BAY GEOLOGICAL SERVICES 1070 LITHIUM DR THUNDER BAY, ONT. P7B 4G3

4. Certification by Recorded Holder or Agent

I, COSTY BUMBUL (Print Name), do hereby certify that I have personal knowledge of the facts set forth in this Declaration of Assessment Work having caused the work to be performed or witnessed the same during or after its completion and, to the best of my knowledge, the annexed report is true.

Form with fields for Signature of Recorded Holder or Agent, Date (Nov 24/96), Agent's Address (2816 RIDGEWAY ST. E. T. BAY ONT. P7E5X3), Telephone Number (622-1871), and Fax Number.

RECEIVED

5. **Work to be recorded and distributed.** Work can only be assigned to claims that are contiguous (adjoining) to the mining land where work was performed, at the time work was performed. A map showing the contiguous link must accompany this form.

Mining Claim Number. Or if work was done on other eligible mining land, show in this column the location number indicated on the claim map.	Number of Claim Units. For other mining land, list hectares.	Value of work performed on this claim or other mining land.	Value of work applied to this claim.	Value of work assigned to other mining claims.	Bank. Value of work to be distributed at a future date.
eg TB 7827	16 ha	\$26,825	N/A	\$24,000	\$2,825
eg 1234567	12	0	\$24,000	0	0
eg 1234568	2	\$8,892	\$4,000	0	\$4,892
1 1157667		440		440	
2 1157668		440		440	
3 1172365		530		530	
4 1172315		361		361	
5 1172345		440		440	
6 1172347		6500		6500	
7					
8 1196234			778		
9 1196240			1556		
10 1196921			1456		
11 1196923			351		
12 1196924			364		
13 1202302			1420		
14 1209440			1178		
15 1209441			1600		
<b>Column Totals</b>		8709	8709	8709	0

I, \_\_\_\_\_, do hereby certify that the above work credits are eligible under subsection 7 (1) of the Assessment Work Regulation 6/96 for assignment to contiguous claims or for application to the claim where the work was done.

Signature of Recorded Holder or Agent Authorized in Writing: [Signature] Date: Nov 24/96

6. **Instructions for cutting back credits that are not approved.**

Some of the credits claimed in this declaration may be cut back. Please check (✓) in the boxes below to show how you wish to prioritize the deletion of credits:

- 1. Credits are to be cut back from the Bank first, followed by option 2 or 3 or 4 as indicated.
- 2. Credits are to be cut back starting with the claims listed last, working backwards; or
- 3. Credits are to be cut back equally over all claims listed in this declaration; or
- 4. Credits are to be cut back as prioritized on the attached appendix or as follows (describe):

CONTACT C. BLUMBERG IF THERE ARE CUT BACKS.

Note: If you have not indicated how your credits are to be deleted, credits will be cut back from the Bank first, followed by option number 2 if necessary.

**For Office Use Only**

Received Stamp	Deemed Approved Date	Date Notification Sent
	Date Approved <u>JANUARY 15, 1997</u>	Total Value of Credit Approved <u>\$8709</u>
Approved for Recording by Mining Recorder (Signature) <u>[Signature]</u>		



**Statement of Costs  
for Assessment Credit**

**État des coûts aux fins  
du crédit d'évaluation**

**Mining Act/Loi sur les mines**

Transaction No./N° de transaction

**N9640.603**

Personal information collected on this form is obtained under the authority of the Mining Act. This information will be used to maintain a record and ongoing status of the mining claim(s). Questions about this collection should be directed to the Provincial Manager, Minings Lands, Ministry of Northern Development and Mines, 4th Floor, 159 Cedar Street, Sudbury, Ontario P3E 6A5, telephone (705) 670-7264.

Les renseignements personnels contenus dans la présente formule sont recueillis en vertu de la Loi sur les mines et serviront à tenir à jour un registre des concessions minières. Adresser toute question sur la collecte de ces renseignements au chef provincial des terrains miniers, ministère du Développement du Nord et des Mines, 159, rue Cedar, 4<sup>e</sup> étage, Sudbury (Ontario) P3E 6A5, téléphone (705) 670-7264.

**1. Direct Costs/Coûts directs**

Type	Description	Amount Montant	Totals Total global
Wages Salaires	Labour 36 DAYS Main-d'oeuvre	3600	
	Field Supervision Supervision sur le terrain		3600
Contractor's and Consultant's Fees Droits de l'entrepreneur et de l'expert- conseil	Type REPORT DRAFTING SUPERVISION @ 350/DAY 1450		
	TRENCHING BACKHOE	1926	
	ASSAYS	170.13	3146.13
Supplies Used Fournitures utilisées	Type PHOTO COPIES & REPAIRS	132.50	
	CHARITREK	50.60	
	GEAR UP FOR OUTDOOR	17.25	
	EXPENSIVES	207.41	477.16
Equipment Rental Location de matériel	Type PLUGGER RENTAL	103.50	
			103.50
<b>Total Direct Costs Total des coûts directs</b>			<b>7257.34</b>

**2. Indirect Costs/Coûts indirects**

\*\* Note: When claiming Rehabilitation work Indirect costs are not allowable as assessment work.  
Pour le remboursement des travaux de réhabilitation, les coûts indirects ne sont pas admissibles en tant que travaux d'évaluation.

Type	Description	Amount Montant	Totals Total global
Transportation Transport	Type 6.840 KM. @ 0.70		
	DAILY TRAVEL TO SITE	2052	
			2052.00
Food and Lodging Nourriture et hébergement	\$15/day x 36	540.00	540.00
Mobilization and Demobilization Mobilisation et démobilisation		722.25	722.25
<b>Sub Total of Indirect Costs Total partiel des coûts indirects</b>			<b>3314.25</b>
Amount Allowable (not greater than 20% of Direct Costs) Montant admissible (n'excedant pas 20 % des coûts directs)			1451.50
<b>Total Value of Assessment Credit (Total of Direct and Allowable Indirect costs)</b>			<b>8708.87</b>
Valeur totale du crédit d'évaluation (Total des coûts directs et Indirects admissibles)			

Note: The recorded holder will be required to verify expenditures claimed in this statement of costs within 30 days of a request for verification. If verification is not made, the Minister may reject for assessment work all or part of the assessment work submitted.

Note : Le titulaire enregistré sera tenu de vérifier les dépenses demandées dans le présent état des coûts dans les 30 jours suivant une demande à cet effet. Si la vérification n'est pas effectuée, le ministre peut rejeter tout ou une partie des travaux d'évaluation présentés.

**Filing Discounts**

1. Work filed within two years of completion is claimed at 100% of the above Total Value of Assessment Credit.
2. Work filed three, four or five years after completion is claimed at 50% of the above Total Value of Assessment Credit. See calculations below:

Total Value of Assessment Credit	Total Assessment Claimed
	x 0.50 =

**Remises pour dépôt**

1. Les travaux déposés dans les deux ans suivant leur achèvement sont remboursés à 100 % de la valeur totale susmentionnée du crédit d'évaluation.
2. Les travaux déposés trois, quatre ou cinq ans après leur achèvement sont remboursés à 50 % de la valeur totale du crédit d'évaluation susmentionné. Voir les calculs ci-dessous.

Valeur totale du crédit d'évaluation	Evaluation totale demandée
	x 0,50 =

**Certification Verifying Statement of Costs**

I hereby certify:  
that the amounts shown are as accurate as possible and these costs were incurred while conducting assessment work on the lands shown on the accompanying Report of Work Form.

that as Richard Henry Agent I am authorized  
(Recorded Holder, Agent, Position in Company)

to make this certification

**Attestation de l'état des coûts**

J'atteste par la présente :  
que les montants indiqués sont le plus exact possible et que ces dépenses ont été engagées pour effectuer les travaux d'évaluation sur les terrains indiqués dans la formule de rapport de travail ci-joint.

Et qu'à titre de \_\_\_\_\_ je suis autorisé  
(titulaire enregistré, représentant, poste occupé dans la compagnie)

à faire cette attestation.

Signature <u>Richard Henry</u>	Date <u>Nov. 14/96</u>
-----------------------------------	---------------------------



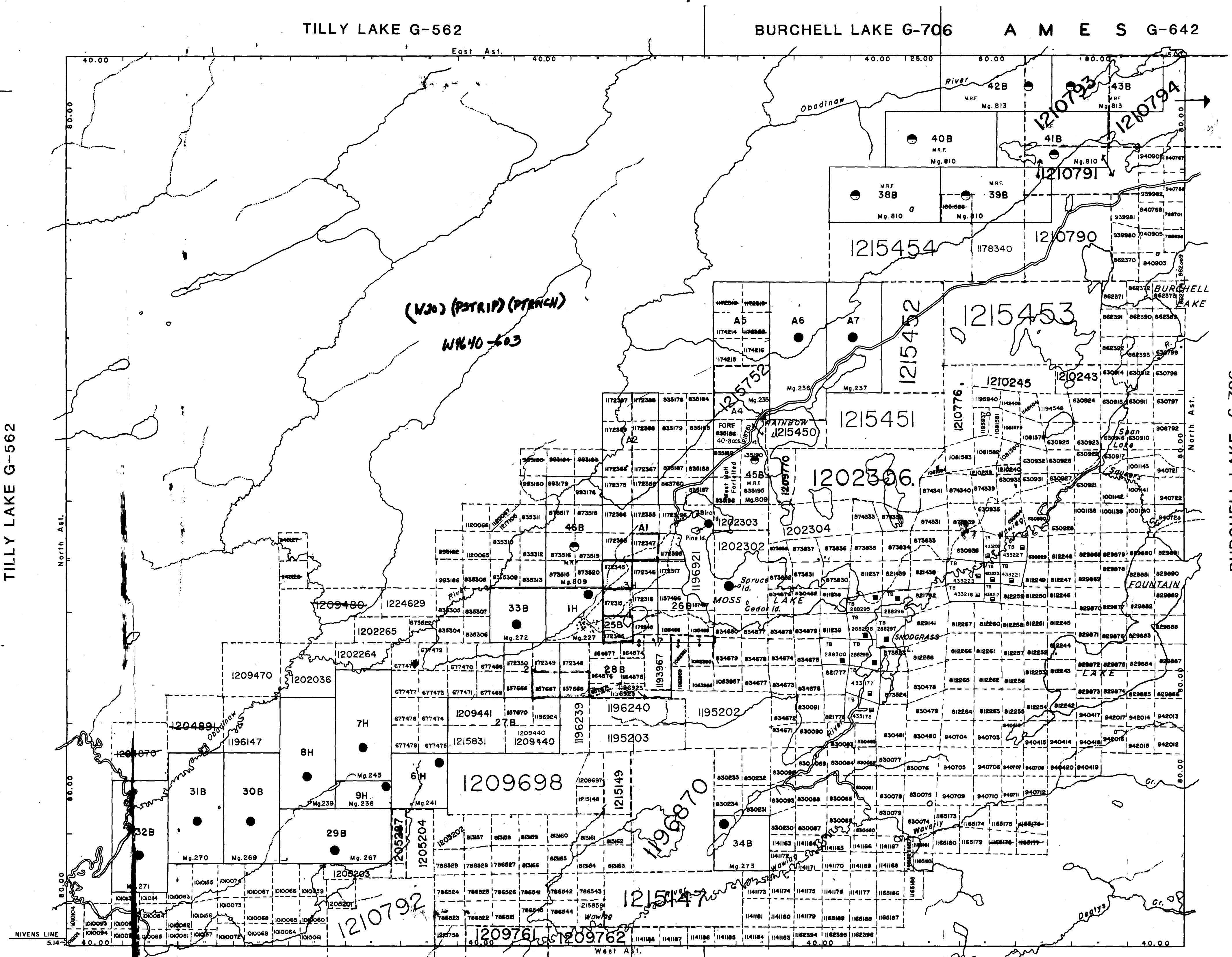
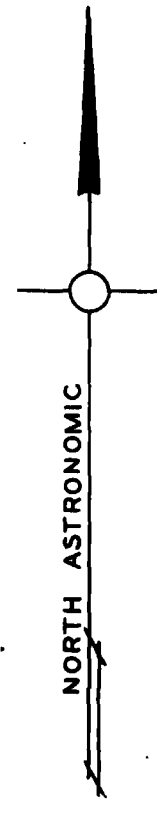

TILLY LAKE G-562

BURCHELL LAKE G-706

TILLY LAKE G-562

BURCHELL LAKE G-706 A M E S G-642

POWELL LAKE G-549

NELSON LAKE G-745

NOTICE:  
The information that appears on this map has been compiled from various sources, and accuracy is not guaranteed. Those wishing to stake mining claims should consult with the Mining Recorder, Ministry of Northern Development and Mines, for additional information on the status of the lands shown hereon.

LEGEND

- HIGHWAY AND ROUTE No. [Symbol]
- OTHER ROADS [Symbol]
- TRAILS [Symbol]
- SURVEYED LINES [Symbol]
- TOWNSHIPS, BASE LINES ETC. [Symbol]
- LOTS, MINING CLAIMS, PARCELS ETC. [Symbol]
- UNSURVEYED LINES [Symbol]
- LOT LINES [Symbol]
- PARCEL BOUNDARY [Symbol]
- MINING CLAIMS ETC. [Symbol]
- RAILWAY AND RIGHT OF WAY [Symbol]
- UTILITY LINES [Symbol]
- NON-PERENNIAL STREAM [Symbol]
- FLOODING OR FLOODING RIGHTS [Symbol]
- SUBDIVISION OR COMPOSITE PLAN [Symbol]
- RESERVATIONS [Symbol]
- ORIGINAL SHORELINE [Symbol]
- MARSH OR MUSKEG [Symbol]
- MINES [Symbol]
- TRAVERSE MONUMENT [Symbol]

DISPOSITION OF CROWN LANDS

TYPE OF DOCUMENT	SYMBOL
PATENT, SURFACE & MINING RIGHTS	●
SURFACE RIGHTS ONLY	○
MINING RIGHTS ONLY	○
LEASE, SURFACE & MINING RIGHTS	■
SURFACE RIGHTS ONLY	■
MINING RIGHTS ONLY	■
LICENCE OF OCCUPATION	□
ORDER-IN-COUNCIL	□
RESERVATION	□
CANCELLED	□
SAND & GRAVEL	□

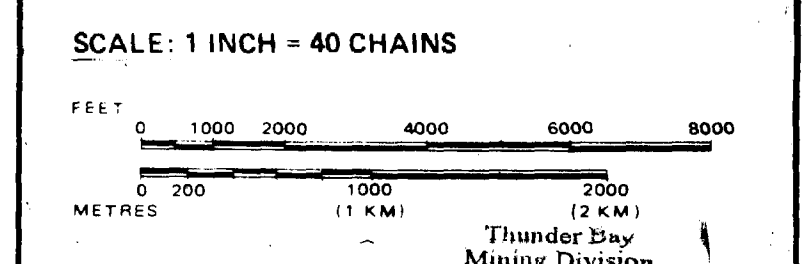

TOWNSHIP  
**MOSS** RECEIVED  
M.N.R. ADMINISTRATIVE DISTRICT  
**THUNDER BAY**  
MINING DIVISION  
**THUNDER BAY**  
LAND TITLES / REGISTRY DIVISION  
**THUNDER BAY**

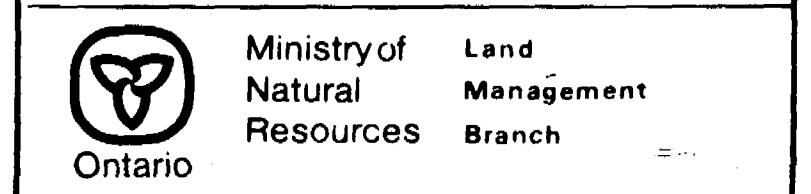

Date: MARCH 1982  
In Service Sep. 27/94.  
Number: **G-676**

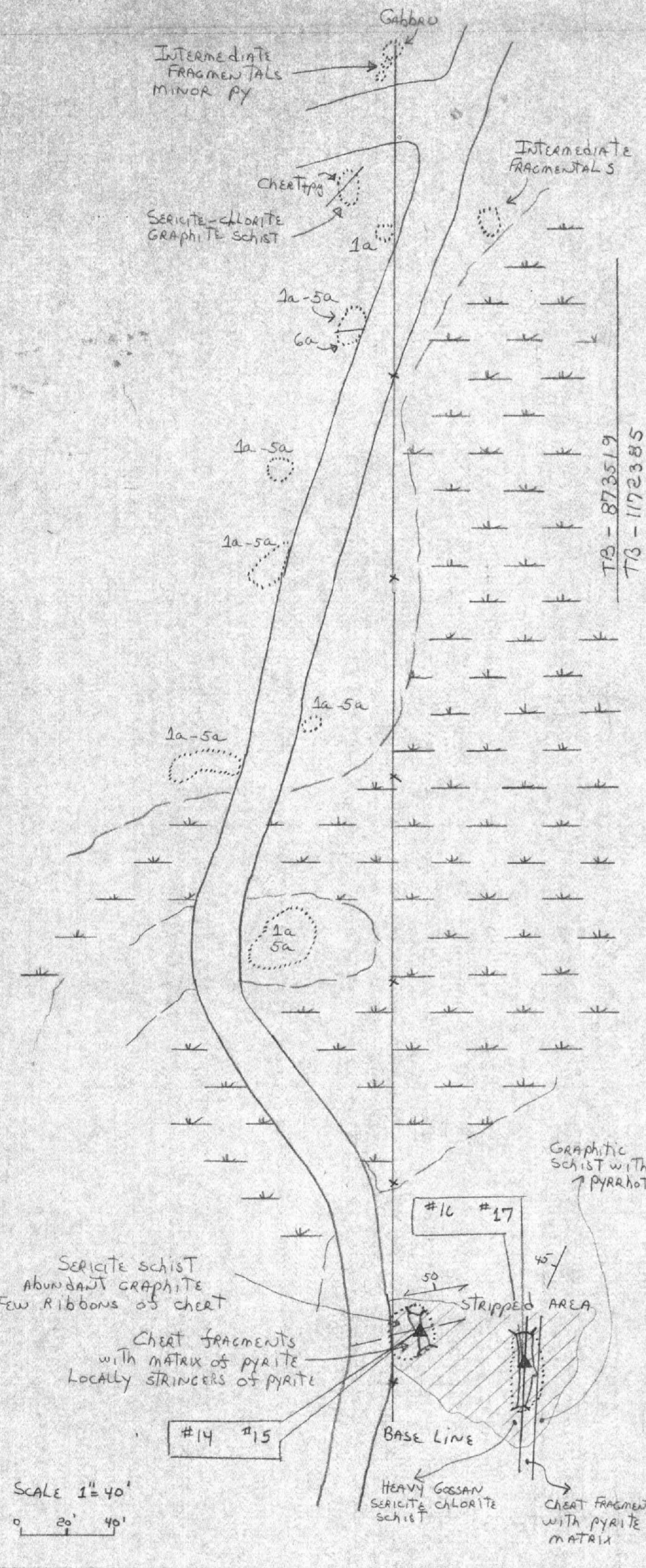

99 3178  
87 3518

1172375  
1172386

Bumbu Prospecting  
July 11-13, 19-21,  
27-28/94

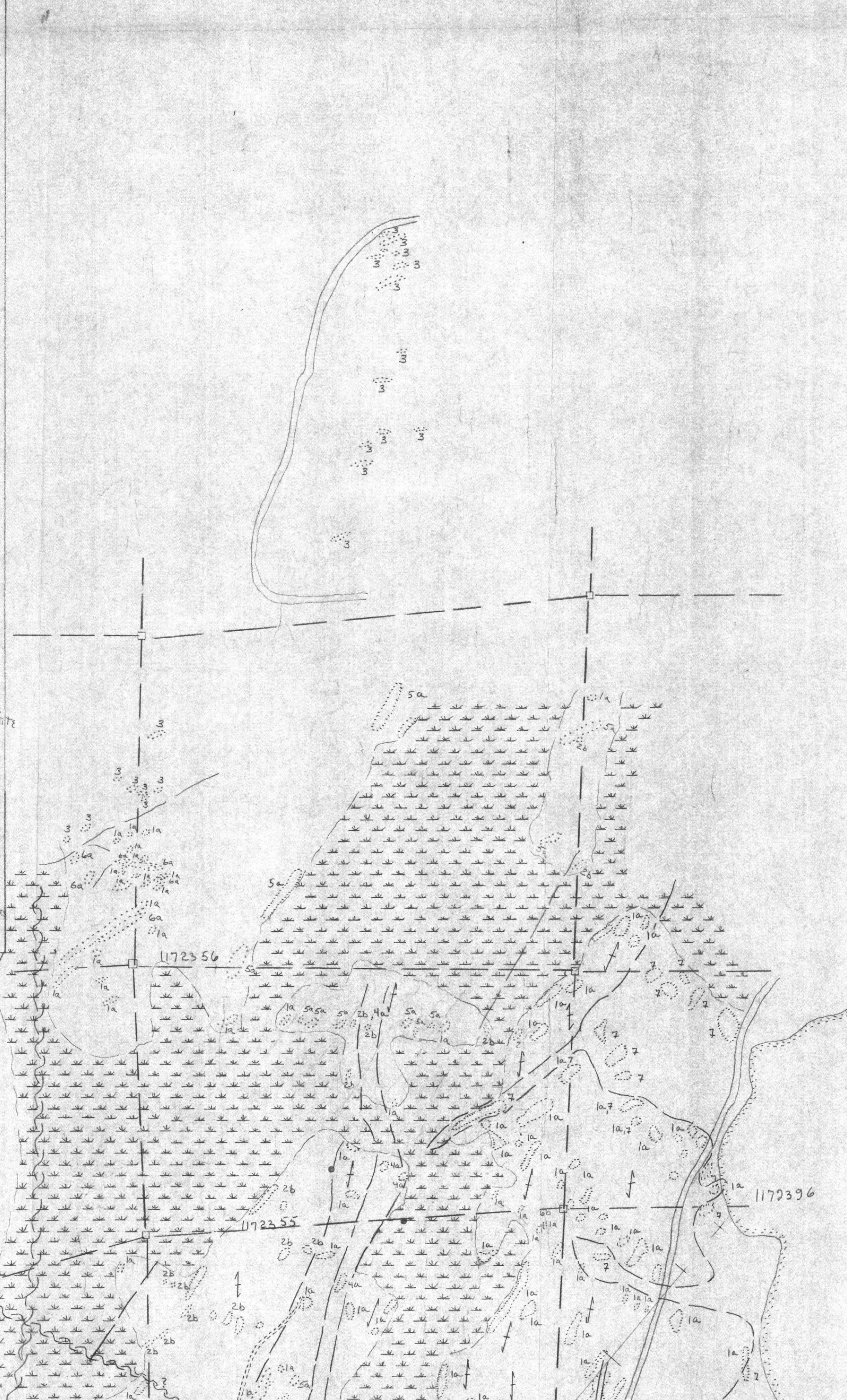

MOSS  
LAKE

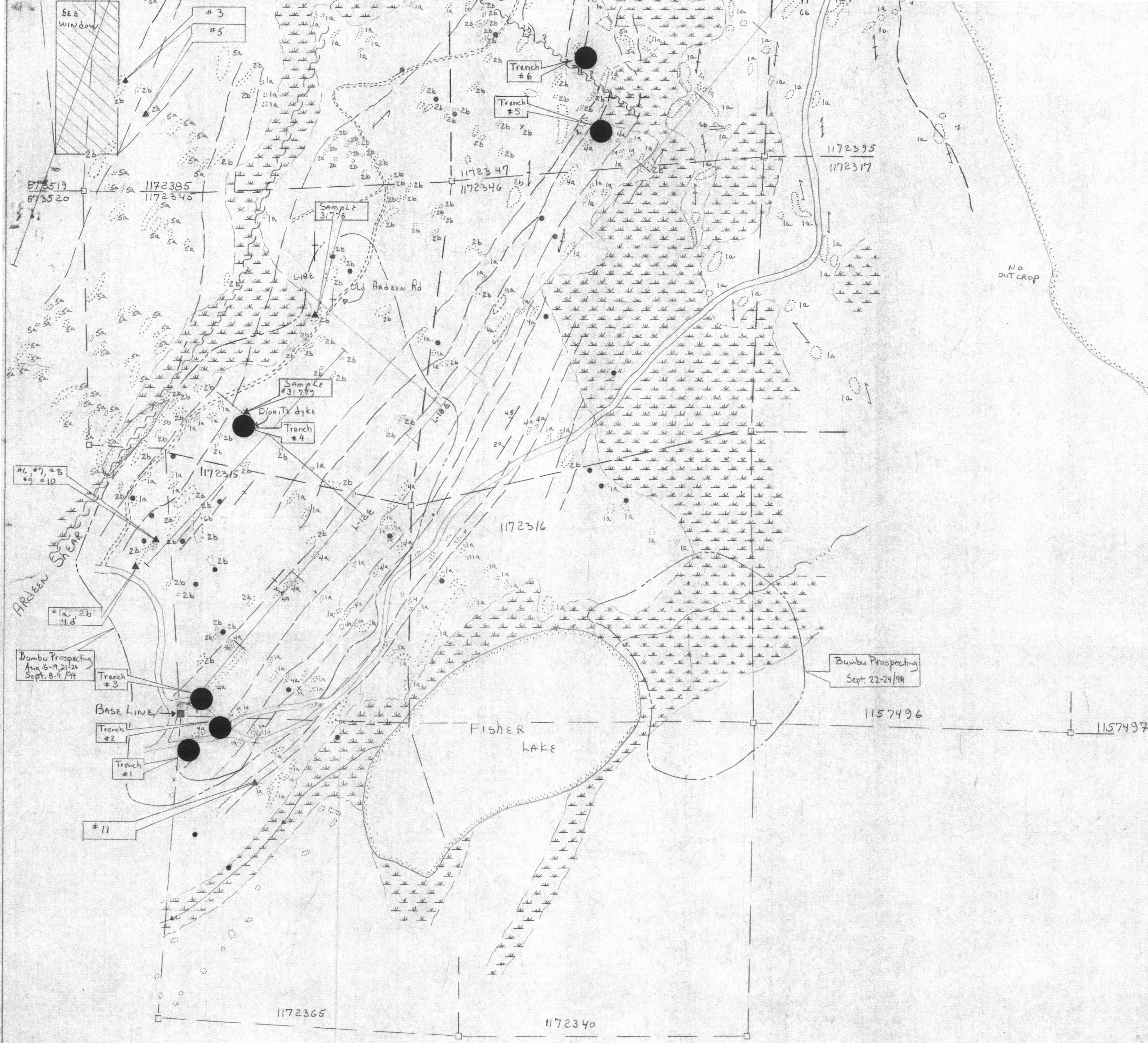

LEGEND

- 1a Mafic Volcanics
- 2b Felsic to Intermediate Volcanics
- 3 Sediments
- 4a Iron Formation, Chert Breccia
- 5a Gabbro - Diorite
- 6a Felsic Intrusion
- b Porphyry
- 7 Syenite
- Swamp
- Zone of Outcrops
- Geological Contact
- Zone of Shearing
- Humus Gold Values (Anomalous)
- X Single Outcrop
- Road
- □ Claim Post
- Lake
- Bedding
- Trench
- # 5 Sample Location NUMBER
- Areas Prospected

**RANTA - PETRUNKA** Moss Lake Property

Compilation Map North Block

TOWNSHIP: Moss Township SCALE: 1:2400

EXECUTED BY \_\_\_\_\_ DATE \_\_\_\_\_

INTERPRETED BY \_\_\_\_\_ DATE \_\_\_\_\_

APPROVED BY \_\_\_\_\_ DATE Jan/95

DRAWN BY \_\_\_\_\_ DATE Jan/96

MAP No. \_\_\_\_\_ N.T.S.

