



52B11NE0004 11 PICKEREL LAKE (NORTH)

010

DIAMOND DRILLING

AREA: PICKEREL LAKE(NORTH PART) REPORT No.: 1 1

WORK PERFORMED BY: ALBERT CARRUTHERS

<u>CLAIM No.</u>	<u>HOLE No.</u>	<u>FOOTAGE</u>	<u>DATE</u>	<u>NOTE</u>
K 385516	1	20.0	Sept/76	(3)
	2	200.0	Sept/76	(1)
	3	161.0	Oct/76	(2)
		<u>381'</u>		

NOTES:

(3) from cancelled claims, rec'd June/81

(1) #168 - 76

(2) #36 -77

A

Albert CARRUTHERS

H 9509

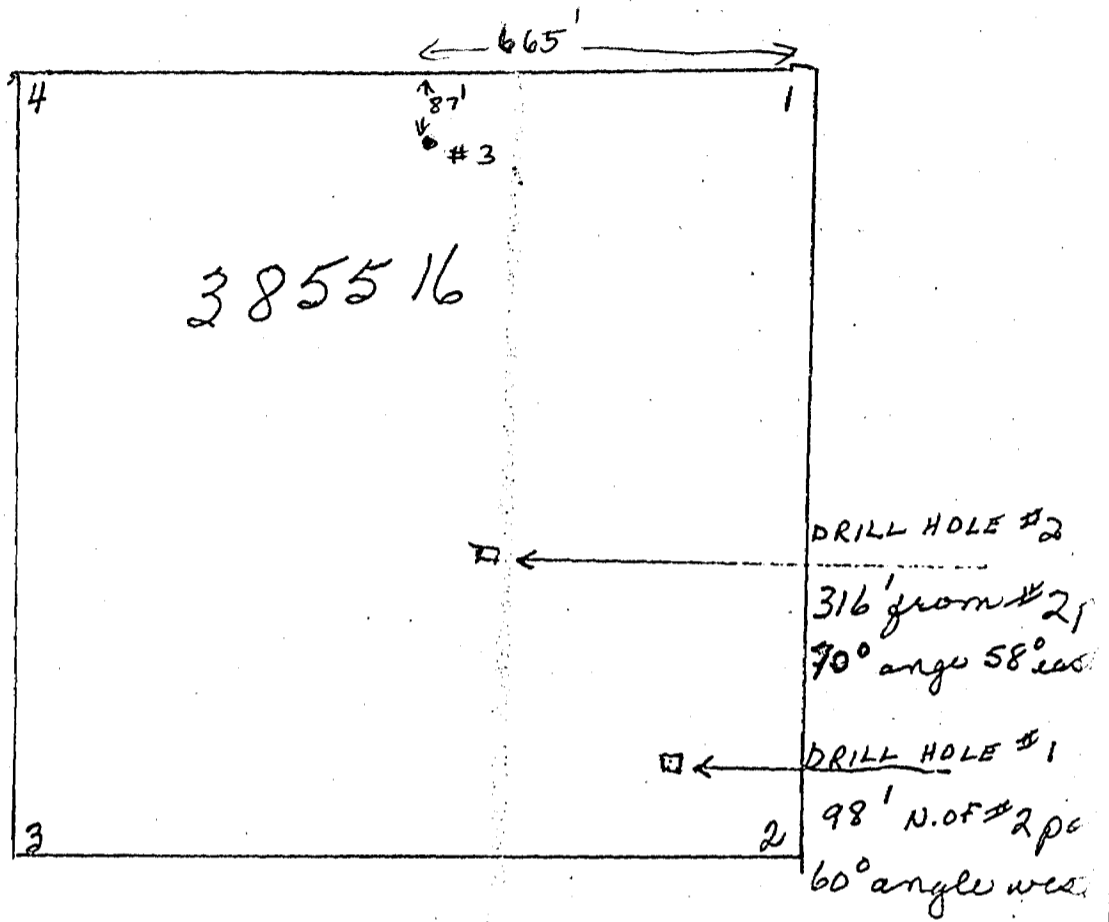

#2 HOLE - 200 Feet 1 1/4" CO

#1 HOLE - 20 Feet 1 1/4" CO



THE MINING ACT - DEPARTMENT OF MINES
DIAMOND DRILLING LOG

Start a new page for every new hole, but fill in top portion of form only on first page for each hole.

FILL IN ON EVERY PAGE

HOLE NO. **2** PAGE NO. **1**

DRILLING COMPANY <i>Albert & Carruthers Box 2 Toronto</i>		COLLAR ELEVATION <i>Surface</i>	BEARING OF HOLE FROM TRUE NORTH <i>58° east</i>	TOTAL FOOTAGE <i>200 feet</i>	DIP OF HOLE AT collar	LOCATION OF HOLE IN RELATION TO A FIXED POINT ON THE CLAIM <i>316' from no 2 post at 30' west of north drilled at a 70° angle 58° east of north.</i>	MAP REFERENCE NO. <i>M 2366</i>	CLAIM NO. <i>385516</i>	
DATE HOLE STARTED <i>Sept 19, 1976</i>	DATE COMPLETED <i>Sept 29, 1976</i>	DATE LOGGED <i>Oct 20/76</i>	LOGGED BY <i>Raymond Bernatchez</i>		ft		LOCATION (T.P., Lot, Con. OR Lat. and Long.)	PROPERTY NAME	
EXPLORATION CO., OWNER OR OPTIONEE <i>Albert & Carruthers</i>		DATE SUBMITTED <i>NOV 4, 1976</i>	SUBMITTED BY (Signature) <i>A. Carruthers</i>		ft				
					ft				

FOOTAGE		ROCK TYPE	DESCRIPTION Colour, grain size, texture, minerals, alteration, etc.	PLANAR FEATURE ANGLE	CORE SPECIMEN FOOTAGE †	YOUR SAMPLE NUMBER	SAMPLE FOOTAGE		SAMPLE LENGTH	ASSAYS †	
FROM	TO						FROM <i>25'</i>	TO <i>10'</i>			
0	23'		Overburden.								
23'	29.5'	Gabbro	Greenish gray, coarse grain (3-5 mm) equigranular, slightly chloritic carbonated, occasional seams of calcite, rock slightly magnetic								
29.5	30.5		Fractured core and partly ground.								
29.5	30.5	Gabbro	Greenish gray, c.g., equigranular, slightly chloritic, carbonated.								
30.5	31.0	Gabbro	greenish gray, c.g., equigranular, chlorite and carbonate alteration								
31.0	46.0	Gabbro	occasional calcite seams, fracturing or jointing 35° to core length.								
46.0	47.0		ground core.								
47.0	51.0	Gabbro	Same as above								
51.0	55.0	Gabbro	Same as above								
55.0	58.0	Gabbro	Same as above								
58.0	66.0	Gabbro	greenish-black, coarse grain (3-5 mm), equigranular								
66.0	88.6	Gabbro	chlorite, carbonate, magnetic, occasional grain of pyrite and calcite seams, fracture or joints 40° and 70° to core length.								
88.6	111.6	Gabbro	Same as above								
111.6	139.0	Gabbro	Same as above								
139.0	159.5	Gabbro	Same as above								
159.5	184.5	Gabbro	Same as above with 1/4 inch calcite vein at 167.5 with grains of pyrite and chalcoppyrite.								
184.5	200.0	Gabbro	Same as above with occasional seam of calcite END OF HOLE								

RECEIVED
 THUNDER BAY
 MINING DIVISION
 NOV 4 1976
 AM 11:23:14 PM 15

† Additional credit available. See Assessment Work Regulation

N
A
↓

Albert CARRUTHERS

H 9509

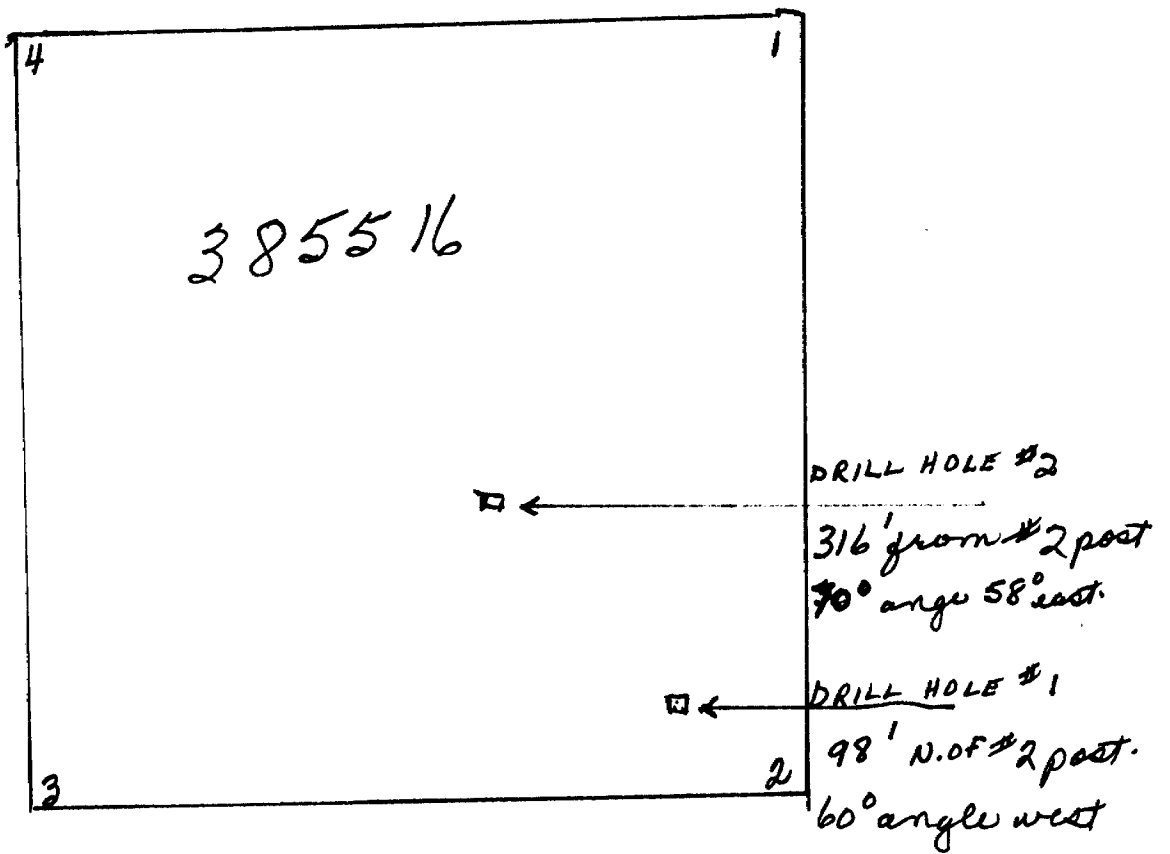

#2 HOLE - 200 Feet 1 1/4" core
#1 HOLE - 20 Feet 1 1/4" core.



THE MINING ACT - DEPARTMENT OF MINES
DIAMOND DRILLING LOG

Start a new page for every new hole, but fill in top portion of form only on first page for each hole.

FILL IN ON EVERY PAGE

HOLE NO. 3 PAGE NO. 1

DRILLING COMPANY <i>A. E. Carruthers, Box 2, Emo</i>		COLLAR ELEVATION <i>Surface</i>	BEARING OF HOLE FROM TRUE NORTH <i>220° Az</i>	TOTAL FOOTAGE <i>161 ft.</i>	DIP OF HOLE AT COLLAR <i>70°</i>	LOCATION OF HOLE IN RELATION TO A FIXED POINT ON THE CLAIM <i>665' west of rd post at 87' off north claim line</i>	MAP REFERENCE NO.	CLAIM NO. <i>385516</i>
DATE HOLE STARTED <i>Oct 5/76</i>	DATE COMPLETED <i>Nov 6/76</i>	DATE LOGGED <i>Nov 13 1976</i>	LOGGED BY <i>Raymond Bernatchez</i>				LOCATION (Tp., Lot, Con. OR Lat. and Long.)	
EXPLORATION CO., OWNER OR OPTIONEE <i>A. E. Carruthers Licence no H9509</i>		DATE SUBMITTED	SUBMITTED BY (Signature) <i>A. E. Carruthers</i>			PROPERTY NAME		

FOOTAGE FROM	TO	ROCK TYPE	DESCRIPTION Colour, grain size, texture, minerals, alteration, etc.	PLANAR FEATURE ANGLE	CORE SPECIMEN FOOTAGE +	YOUR SAMPLE NUMBER	SAMPLE FOOTAGE		SAMPLE LENGTH	ASSAYS +
							FROM	TO		
0	16	Grey wacke	quartz mica schist, grey, fine grain, laminated, qtz stringers 1/16 to 3/8" thick, rusty gossan along fracture, pyrite, cone fractured considerably		2'		25'	161'	up 3"	
16	24	"	quartz mica schist, grey, fine grain, few narrow quartz stringers, pyrite along fractures, rusty patches along fractures.							
24	46	"	grey-black quartz mica schist, chloritic (24'-27') fine grain pyrite along fractures, slightly magnetic							
46	65.3	"	grey, quartz mica schist, chloritic, fine grain, mass and laminated pyrite along fractures, disseminated pyrite at 62'-62.5'							
65.3	67.5	diomite.	med. grain, equiaxial.							
67.5	91	Quartz-mica schist	-dark green, chloritic, med fine to med. grain, foliated quartz lens, some dissem. pyrite.	70°						
91	96.6	"	-grey-green, chloritic, fine to med grained, foliated pyrite dissemination.	75°						
96.6	102.7	Quartz-mica schist	greyish, siliceous, quartz stringers (1/4" - 1") chalcopyrite, pyrrhotite blebs at 102.5'							
102.7	127.0	"	grey-green, chloritic, foliated, fine to med grain, some pyrite along fractures at 125.3'							
127	150	Quartz-mica schist	grey, foliated, med fine grain massive and laminated, some pyrite along fractures, 6" quartz lens at 145' some pyrrhotite blebs	50°						
150	161	Quartz-mica schist	grey-green, foliated, med to fine grain, chloritic in sections, pyrite along fractures.	70°						

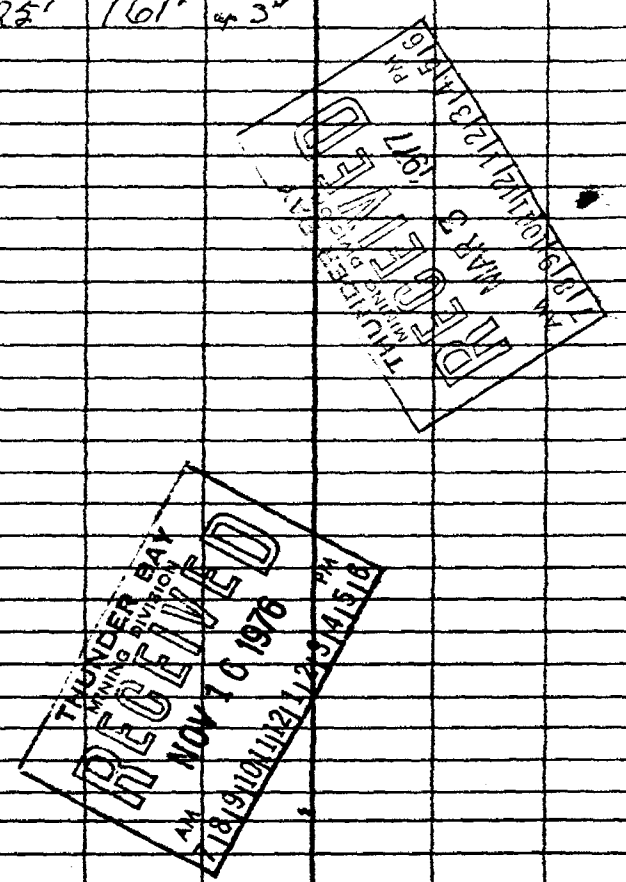

+ Additional credit available. See Assessment Work Regulation.