



52B12NW0001 10 MCQUAT LAKE

010

DIAMOND DRILLING

AREA: McQUAT LAKE

REPORT NO: 10

WORK PERFORMED FOR: Blue Regal Resources

RECORDED HOLDER: Same as Above [xx]
: Other []

<u>Claim No.</u>	<u>Hole No.</u>	<u>Footage</u>	<u>Date</u>	<u>Note</u>
940895	BR-88-2	502'	Dec/88	(1)

NOTES: (1) W8904.194, date filed May/89

BLUE REGAL RESOURCES LTD.
DIAMOND DRILL LOG

BR-88-2

04-11-1989 :: 10:35

PROPERTY : Banning Lake	PROJECT # :	
NTS MAP # : 52B/12	TOWNSHIP : <i>McQuat Jr.</i>	CLAIM # : 940895
LINE/STATION: 3+00W / 3+00S	EASTINGS/NORTHINGS:	ELEVATION : Surface
LENGTH : 502.00 ft	INCLINATION : -50.0 degrees	AZIMUTH : 285.0 degrees
OVERBURDEN : 25.00 ft	CASING : Removed	
LOGGED BY : E. Canova	DRILLED BY : Alexander Drilling	ASSAYING BY : Accurassay Lab, Thunder Bay, Ont.
DATE LOGGED : 1988/12/04	DATE DRILLED : 1988/12/02 to 1988/12/03	CORE LOCATION: Kashabowie, Ont.

<u>Acid Tests</u>	
<u>Depth</u>	<u>Dip</u>
250.00	48.0
486.00	42.0

ONTARIO GEOLOGICAL SURVEY
ASSESSMENT FILES
OFFICE
APR 25 1989
RECEIVED

BLUE REGAL RESOURCES LTD.

BR-88-2

04-11-1989 :: 10:35

SUMMARY LOG

Page 2

From(ft)	To(ft)	Field Name (Legend)
0.00	25.00	Overburden
25.00	343.20	Deformed Meta Basalt Foliation , occassionally sheared, magnetite
343.20	350.00	Meta Diorite Massive to weak foliation
350.00	484.80	Intermediate Volcanic , Quartz Andesites to Dacites Massive to weak foliation , recrystallized & metamorphosed, moderately hard.
484.80	502.00	Mafic Meta Volcanic - Meta Basalt to Meta Andesite Massive
502.00		END OF HOLE.

BLUE REGAL RESOURCES LTD.
DIAMOND DRILL LOG

BR-88-2
Page 3

04-11-1989 :: 10:36

From(ft)	To(ft)	Description	Sample#	From (ft)	To (ft)	Width (ft)	Au (ppb)
0.00	25.00	Overburden					
25.00	343.20	<p>Deformed Meta Basalt Colour: green Grain Size: Medium to Coarse. Fracturing: High (7-9)/ft. Magnetic Response: Weak to Moderate.</p> <p>Composition Mafic: Mainly Feldspar: Mainly</p> <p>Structure Foliation: 52 to 54 deg. cax. Shearing: 42 to 59 deg. cax. Highly fracturing 15/m, broken core & fault gouging with green chlorite mud. At 29-31, 40-41, 44-46.5, 67.5, 87-90, 101-102, 119-121, 122-123.5, 161.3, 181.4-182. Fracturing: 22 to 54 deg. cax. 15/m Foliation: to 20 deg. cax. Kinking at 51'</p> <p>Alteration Carbonate: Weak to Moderate. 2-3% carbonate veining Chlorite: to Moderate. Shear zones, & form darker bands</p> <p>Mineralisation Pyrite: 2 to 3%. Dessiminated</p> <p>Veins and Sub-Intervals Carbonate Veining. Width 0.20in. Core axis angle 25 to 52 degrees. 2-3% carbonate veining (31.00)-(36.80): Gabbro dyke?, green, medium grained, massive (190.40)-(196.00): Mafic tuff to lapelli tuff or fragmental volcanic: green, flattened and elongate fragments, foliation 38 degrees deg. cax, fragments 1-3cm, mafic fragments. 2% pyrite (205.10)-(220.00): Same as above (229.50)-(250.20): " " " (255.80)-(265.40): " " " (270.90)-(310.20): " " " (299.30)-(310.90): Zone of shearing & faulting, with some brecciated, foliation 39 degrees deg. cax (324.70)-(343.20): " " "</p>					

BLUE REGAL RESOURCES LTD.
DIAMOND DRILL LOG

BR-88-2
Page 4

04-11-1989 :: 10:36

From(ft)	To(ft)	Description	Sample#	From (ft)	To (ft)	Width (ft)	Au (ppb)
343.20	350.00	<p>Meta Diorite Colour: Dark green. Grain Size: Coarse to . Composition Mafic: to 35%. Mainly Feldspar: Mainly Alteration Chlorite: to Weak. Carbonate: to Weak. Mineralisation Pyrite: to 3%.</p>					
350.00	484.80	<p>Intermediate Volcanic , Quartz Andesites to Dacites Colour: Grey light-green. Grain Size: Medium to Coarse. Fracturing: Weak (1- 3)/ft. Composition Feldspar: Mainly Mafic: Fewer Structure Foliation: 58 deg. cax. Weak Fracturing: 15 to 58 deg. cax. 6/m Alteration Carbonate: Weak. Mineralisation Pyrite: to 1%. Chalcopryrite: to Trace. Veins and Sub-Intervals Quartz-carbonate Veining. Width 1.00in. Core axis angle 38 to 52 degrees. 3-4% veining , tremolite of pyrite & chalcopryrite (464.50)-(484.80): Volcanic flow brecciated : size of 4cm, 20%, subangular, fragments of intermediate volcanic</p>					
484.80	502.00	<p>Mafic Meta Volcanic - Meta Basalt to Meta Andesite Colour: Green . Grain Size: Medium to Coarse.</p>					

BLUE REGAL RESOURCES LTD.

BR-88-2

04-11-1989 :: 10:37

DIAMOND DRILL LOG

Page 5

From(ft)	To(ft)	Description	Sample#	From (ft)	To (ft)	Width (ft)	Au (ppb)
		Fracturing: Weak (1- 3)/ft.					
		Composition					
		Mafic: Mainly					
		Feldspar: Mainly					
		Structure					
		Fracturing: 43 to 52 deg. cax. 6/m					
		Alteration					
		Carbonate: to Weak.					
		Mineralisation					
		Pyrite: to 1%.					
502.00		END OF HOLE.					



Ministry of
Natural
Resources

Report
of Work

DOCUMENT NO.
W8904-194

Instructions - Supply required data on a separate form for each

Ontario

MR. OWEN

The Mining



52B12NW0001 10 MCQUAT LAKE

900

Name Postal Address of Recorded Holder

BLUE REGAL RESOURCES

500 - 67 RICHMOND ST WEST, TORONTO, ONTARIO M5H 1L5

Summary of Work Performance and Distribution of Credits

Total Work Days Cr. claimed 1985	Mining Claim			Work Days Cr.	Mining Claim			Work Days Cr.	
	Prefix	Number	Work Days Cr.		Prefix	Number	Work Days Cr.		
for Performance of the following work. (Check one only) <input type="checkbox"/> Manual Work <input type="checkbox"/> Shaft Sinking Drifting or other Lateral Work. <input type="checkbox"/> Compressed Air, other Power driven or mechanical equip. <input type="checkbox"/> Power Stripping <input checked="" type="checkbox"/> Diamond or other Core drilling <input type="checkbox"/> Land Survey	TB	940895	85	TB	940939	85		9896.50	95
		940896	85		974196	85		1000621	95
		940897	85		974197	85		1000622	85
		940898	85		974198	85		1000623	85
		940899	85		974199	120		1000624	140
		940900	85		974200	95			
		940901	85		989648	120			
	940938	85		989649	130				

All the work was performed on Mining Claim(s): 1000624, 940895, 940899, 940900

Required Information eg: type of equipment, Names, Addresses, etc. (See Table Below)

CREDITS AVAILABLE ~~2151~~ 2141 + 2th. Assignment (Cover)

CREDITS USED 1985 1985

CREDIT BALANCE 166 156

ALEXANDER DIAMOND DRILLING
VAL D'OR, QUEBEC
NOV 28, 1988 - DEC 6, 1988

ONTARIO GEOLOGICAL SURVEY
ASSESSMENT FILES
OFFICE
APR 25 1989
RECEIVED

89 APR 17

Date of Report APR 11 / 89 Recorded Holder or Agent (Signature) [Signature]

Certification Verifying Report of Work

I hereby certify that I have a personal and intimate knowledge of the facts set forth in the Report of Work annexed hereto, having performed the work or witnessed same during and/or after its completion and the annexed report is true.

Name and Postal Address of Person Certifying

W. HOLMSTEAD, 1074 DILLINGHAM ST, KINGSTON

ONTARIO, K7P 2P4

Date Certified

APR 11, 1989

Certified by (Signature)

Table of Information/Attachments Required by the Mining Recorder

Type of Work	Specific Information per type	Other Information (Common to 2 or more types)	Attachments
Manual Work	NII	Names and addresses of men who performed manual work /operated equipment, together with dates and hours of employment.	Work Sketch: these are required to show the location and extent of work in relation to the nearest claim post.
Shaft Sinking, Drifting or other Lateral Work			
Compressed air, other power driven or mechanical equip.	Type of equipment		
Power Stripping	Type of equipment and amount expended. Note: Proof of actual cost must be submitted within 30 days of recording.	Names and addresses of owner or operator together with dates when drilling/stripping done.	Work Sketch (as above) in duplicate
Diamond or other core drilling	Signed core log showing: footage, diameter of core, number and angles of holes.		
Land Survey	Name and address of Ontario land surveyor.	NII	NII

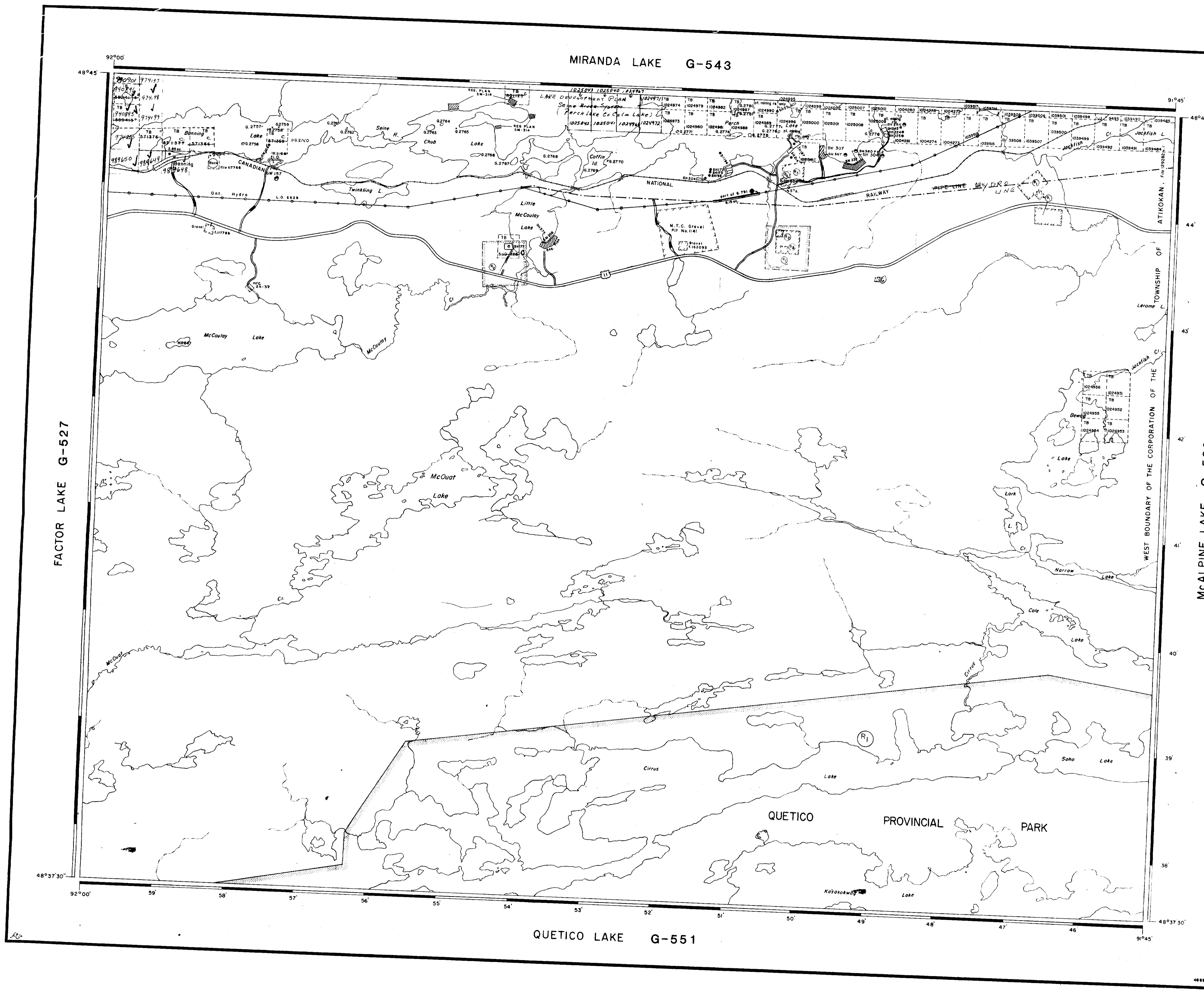

REFERENCES

AREAS WITHDRAWN FROM DISPOSITION

S.R. - SURFACE RIGHTS		M.R. - MINING RIGHTS	
Description	Order No.	Date	Disposition File
Sec. 43 Mt. Act. (R.S.O. 1970)	W. 41/73	31/8/73	S.R.A.M.R. 180216
"	W. 21/80NCR	30/6/80	S.R.O. 165472
QUARRY PERMIT			

SAND AND GRAVEL

- ① M.T.C. Gravel Reserve Oct. 16, 1979
- ② " " Pt. 197 2A-B
- ③ Gravel File 162093
- ④ M.T.C. Gravel Reserve 2A-B, File 162093

Area within the Quetico Provincial Park withdrawn from staking.

LEGEND

- HIGHWAY AND ROUTE No.
- OTHER ROADS
- TRAILS
- SURVEYED LINES:
 - TOWNSHIPS, BASE LINES, ETC.
 - LOTS, MINING CLAIMS, PARCELS, ETC.
- UNSURVEYED LINES:
 - LOT LINES
 - PARCEL BOUNDARY
 - MINING CLAIMS ETC.
 - RAILWAY AND RIGHT OF WAY
 - UTILITY LINES
 - NON-PERENNIAL STREAM
 - FLOODING OR FLOODING RIGHTS
 - SUBDIVISION OR COMPOSITE PLAN
 - RESERVATIONS
 - ORIGINAL SHORELINE
 - MARSH OR MUSKEG
 - MINES
 - TRAVERSE MONUMENT

DISPOSITION OF CROWN LANDS

TYPE OF DOCUMENT	SYMBOL
PATENT, SURFACE & MINING RIGHTS	
" SURFACE RIGHTS ONLY	
" MINING RIGHTS ONLY	
LEASE, SURFACE & MINING RIGHTS	
" SURFACE RIGHTS ONLY	
" MINING RIGHTS ONLY	
LICENCE OF OCCUPATION	
ORDER-IN-COUNCIL	
RESERVATION	
CANCELLED	
SAND & GRAVEL	

NOTE: MINING RIGHTS IN PARCELS PATENTED PRIOR TO MAY 4, 1913, VESTED IN ORIGINAL PATENTEE BY THE PUBLIC LANDS ACT, R.S.O. 1970, CHAP. 380, SEC. 63, SUBSEC. 1.

SCALE: 1 INCH = 40 CHAINS

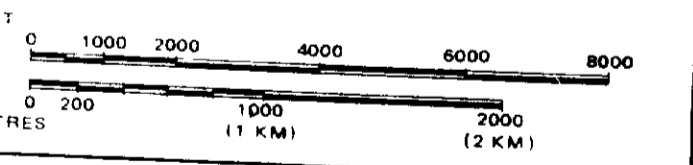

AREA
McOUATT LAKE

M.N.R. ADMINISTRATIVE DISTRICT
ATIKOKAN
MINING DIVISION
THUNDER BAY
LAND TITLES / REGISTRY DIVISION
RAINY RIVER

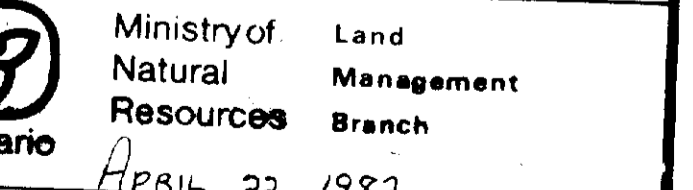

Date: **APRIL 22 1982**
DECEMBER, 1981

Number: **G-542**

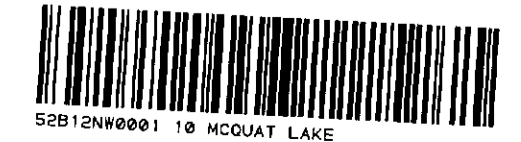

CROWROCK LAKE G-520

HEPBURN LAKE G-532

STEEPROCK LAKE G-560

FREEBORN TWP.
FOR STATUS REFER TO TWP PLAN G-570

McOUAT LAKE G-542

REFERENCES

AREAS WITHDRAWN FROM DISPOSITION

S.R. - SURFACE RIGHTS M.R. - MINING RIGHTS

Description Order No. Date Disposition File

SAND AND GRAVEL
G Quarry Permit 483

LEGEND

- HIGHWAY AND ROUTE NO.
- OTHER ROADS
- TRAILS
- SURVEYED LINES:
TOWNSHIPS, BASE LINES, ETC.
- LOTS, MINING CLAIMS, PARCELS, ETC.
- UNSURVEYED LINES.
- LOT LINES
- PARCEL BOUNDARY
- MINING CLAIMS (T)
- RAILWAY AND RIGHT OF WAY
- UTILITY LINES
- NON PERENNIAL STREAM
- FLOODING OR FLOODING RIGHTS
- SUBDIVISION OR COMPOSITE PLAN
- RESERVATIONS
- ORIGINAL SHORLINE
- MARSH OR MUSKEG
- MINES
- TRAVERSE MONUMENT

DISPOSITION OF CROWN LANDS

TYPE OF DOCUMENT	SYMBOL
PATENT, SURFACE & MINING RIGHTS	●
SURFACE RIGHTS ONLY	○
MINING RIGHTS ONLY	◐
LEASE, SURFACE & MINING RIGHTS	◑
SURFACE RIGHTS ONLY	◒
MINING RIGHTS ONLY	◓
LICENCE OF OCCUPATION	○
ORDER-IN-COUNCIL	OC
RESERVATION	○
CANCELLED	○
SAND & GRAVEL	○

NOTE: MINING RIGHTS IN PARCELS PATENTED PRIOR TO MAY 8, 1913, VESTED IN ORIGINAL PATENTEES BY THE PUBLIC LANDS ACT, R.S.O. 1970, CHAP. 380, SEC. 63, SUBSEC. 1.

SCALE: 1 INCH = 40 CHAINS

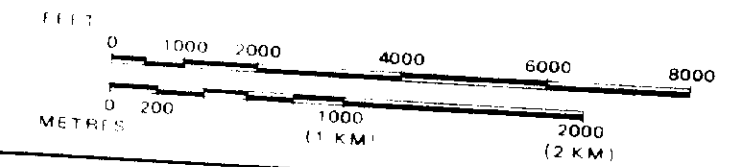

AREA
MIRANDA LAKE
M.N.R. ADMINISTRATIVE DISTRICT
ATIKOKAN
MINING DIVISION
THUNDER BAY
LAND TITLES / REGISTRY DIVISION
RAINY RIVER

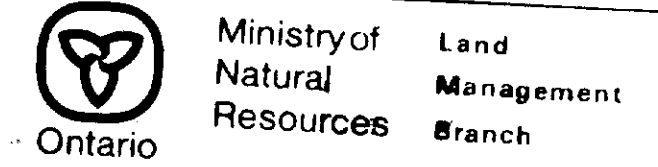

Date: August 15, 1985
Number: **G-543**



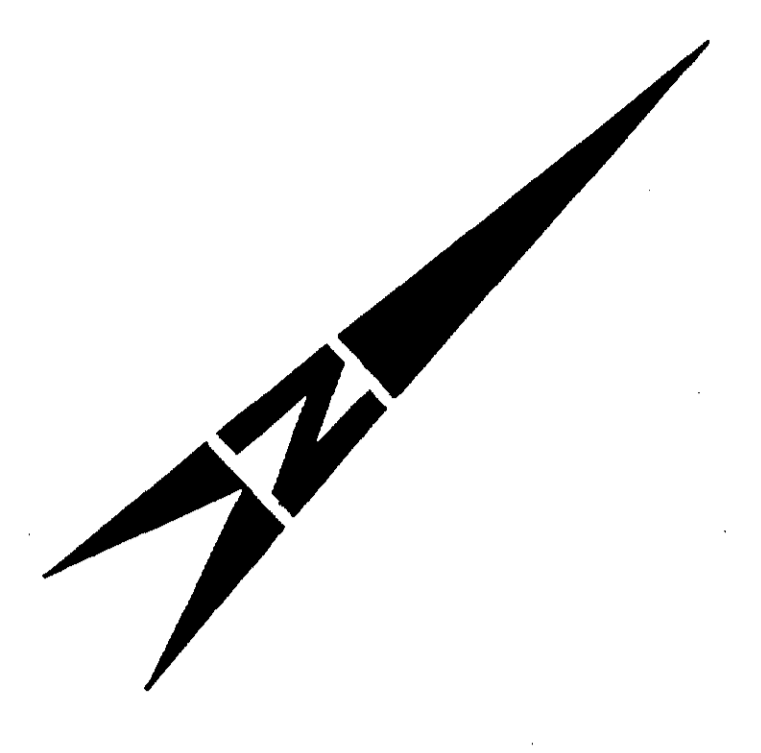
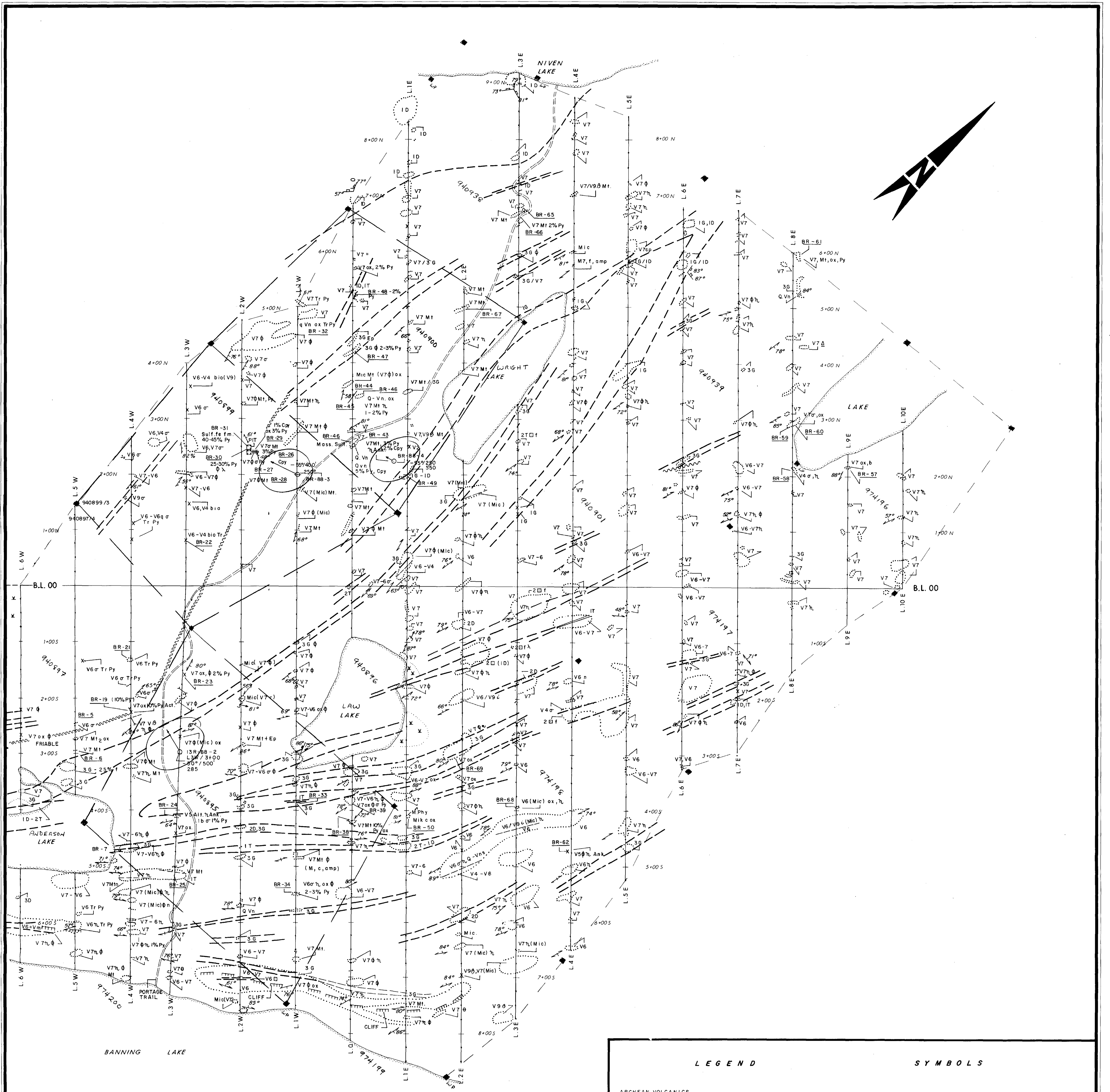

LEGEND

- ARCHEAN VOLCANICS**
 V4 (lo, lof) DACITE
 V5 (lo, lof) INTERMEDIATE VOLCANICS UNDIFFERENTIATED
 V6 (lo, lof) ANDESITES
 V7 (lo, lof) BASALTS
 V9β-4 (ib) MAFIC TO INTERMEDIATE TUFF
- ARCHEAN METAMORPHIC ROCKS**
 Mic (1c) CHLORITE, SCHIST (MAFIC TO INTERMEDIATE)
 Mik (2c) SERICITE SCHIST (FELSIC)
 M1,phy PHYLITES
- MAFIC ARCHEAN INTRUSIVES**
 2D (3b) DIORITES
 3G (3a) GABBROS
- FELSIC TO INTERMEDIATE ARCHEAN INTRUSIVES**
 1G (4a) GRANITE
 1D (4c) GRANODIORITE
 1T (4d) TONALITE
 2T (3c) QUARTZ DIORITE
 2 (4c) UNDETERMINED INTERMEDIATE INTRUSIVES

- SYMBOLS**
- OUTCROPS X
 GEOLOGICAL CONTACT (CONFIRMED, ASSUMED) ---
 BEDDING / BONDING / CONTACTS 30°
 FOLIATION 80°
 JOINTING 73° FRACTURES 82°
 FOLDING (AXIAL PLANE) 81° SHEARING
 FAULTING CLIFF (TOPOGRAPHIC DROP) mmm
 SWAMP, ALDERS X X X PIT TRENCHES
 BR-88-02 SITE OF DIAMOND DRILL HOLE
 BR-52 ROCK SAMPLE SITE

SYMBOLS

- TRAIN TRACK ---
 CLAIM LINE AND CLAIM POST 100062
- Act ACTINOLITE Ana ANKERITE M1 MAGNETITE
 Py PYRITE K SERICITE c CHLORITE
 ox OXIDIZED f FELDSPARS Q QUARTZ
 bio BIOTITE phy PHYLITE 7 CARBONATIZED
 ChL CHLORITIZED s SILICIFIED 0 PILLOWED
 P PORPHYRITIC

GEOCOM CONSULTING
 110 Niagara St. KIRKLAND Qc H9J 3B6 Tel: 514-696-2321

BLUE REGAL RESOURCES INC.
GEOLOGICAL COMPILATION MAP

BANNING LAKE PTY.
 NORTH-EAST SHEET

DATE NOV. 88
 Compilation by E.C.
 Interpretation by
 Drafting by G.B., P.L.

SCALE 1:2500
 Drawing N/T
 0 50 100 m