



52B135W0012 2.12019 MIRANDA LAKE

010

PLATE RECAL RESOURCES LIMITED

THE LAW SPENCE OCCURRENCE PROPERTY

SIBBERTON OF RAYNY RIVER

ONTARIO

RECEIVED

JAN 6 1989

MINING LANDS SECTION

By: Wayne K. Beland

January 4, 1989

*Deal  
2.5/87*

GEORGE CONSULTING



52B135W0012 P.12019 MIRANDA LAKE

010C

TABLE OF CONTENTS

INTRODUCTION . . . . . 1

HISTORY . . . . . 2

LINE CUTTING AND GEOLOGICAL MAPPING. . . . . 4

GEOLOGY AND MINERALIZATION . . . . . 5

REFERENCES . . . . . 7

CERTIFICATE . . . . . 8

## INTRODUCTION

The Law-Spence Occurrence property is owned by Blue Regal Resources Ltd. It consists of 22 contiguous, unpatented mining claims in the Calm Lake and Righteye Lake areas in the District of Rainy River, Ontario. The claims were staked by Rick Angove and Matt Stewardson.

The following report describes the history, geology and mineralization of the Law Occurrence and the Spence Occurrence and the immediate vicinity and geological mapping of the property.

The claim numbers listed below are 100% owned by Blue Regal Resources Ltd.;

940895	940939	989649
940896	974196	989650
940897	974197	1000621
940898	974198	1000622
940899	974199	1000623
940900	974200	1000624
940901	989648	1000625
940938		

The Law Occurrence and Spence Occurrence are located between Banning and Niven lakes south of Asmussen Township and about 30 kilometers west of Atikokan, Ontario (latitude 48 44', longitude 92 00'). Access is via Highway 11, one kilometre north and by boat across Banning Lake and by foot trail across the claims. Most services are available in Atikokan or Thunder Bay.

## HISTORY

The Law Occurrence was first described in a Geological Survey of Canada report by Tanton (1927). He reported that "Mr Law of Banning reported discovering gold-bearing vein material visibly mineralized with chalcopyrite at a locality 650 feet south of Niven Lake along the portage to Seine river near Banning. Two grab samples taken by him from this vicinity are said to have shown, upon assay, gold values at the rate of \$28(1.33 oz.) and \$33(1.57 oz.) per ton, respectively."

The Spence Occurrence was first described in 1928 in a letter written by Frank Spence of Fort William to Mr. Watson of the Mining Corporation in Toronto (Resident Geologist's Files, Thunder Bay). In the letter he reported a quartz porphyry dike "that varies from 300 to 500 feet in width and extends over one mile in length. There has been no work on this and only surface assays which run \$0.20 (0.01 oz), \$1.92 (0.09 oz), \$13.40 (0.64 oz) and \$18.00 (0.86 oz), in gold with a 5% copper content."

The Law Syndicate was formed and in 1929 conducted prospecting, trenching and stripping (Schnieders and Dutka, 1985). Results were not available at the time of writing.

In 1956, Moneta Porcupine Mines conducted geological mapping and ground electromagnetic surveys (Schnieders and Dutka, 1985).

John Heilman, a former owner of the property of no known affiliation, drilled two short holes (212 feet) on the Law Occurrence in 1960. He intersected greenstone, diorite and occasional quartz veining all mineralized with pyrite. Some chalcopyrite was detected in the quartz veining. No assay values were included.

Cominco carried out geological and geophysical surveys and 150 metres of diamond drilling in 1966. The holes were drilled to intersect electromagnetic conductors. The mineralized rocks encountered consisted of silicified and graphitic zones up to 3 meters thick with massive pyrite, pyrrhotite and trace amounts of chalcopyrite (Fumerton, 1985).

In 1981, the property was staked by Fern Elizabeth Gold Mining Company Limited (Schnieders and Dutka, 1985).

Phantom Exploration conducted a property visit for Strike Exploration Limited in 1982 (Schnieders and Dutka, 1985).

In 1987, Matt Stewardson, a former owner of the property, took 10 grab samples from the Law Occurrence and had them assayed for gold and silver by Geoscience Laboratories in Toronto. The best gold results were; 0.04 oz/ton from a mineralized quartz vein on claim 940899, 0.03 oz/ton in quartz vein with up to 20% sulphides and 0.01 oz/ton in massive pyrite (70%) containing siliceous fragments (possibly sheared quartz vein material).

No further exploration work was done on the property in 1987.

## LINE CUTTING AND GEOLOGICAL MAPPING

An east-west trending baseline with cross-lines spaced at 100 meters were cut over the entire property. A total of 24 km of lines were cut on the property in June, 1988.

Geological mapping was done by Mr Eddy Canova in August, 1988 at a scale of 1:2500. The results of the mapping are presented in the accompanying maps.

## GEOLOGY AND MINERALIZATION

The Blue Regal property is mineralized by a series of sulphide showings that occur within quartz veins or minor shear zones in mafic metavolcanics intercalated with banded ironstone and felsic metavolcanics. These rocks have been folded and the occurrence is in the core of a large fold which occurs primarily east of the present map area (Calm Lake area). The metavolcanics have been intruded by a number of mafic dikes, and felsic dikes and stocks. The rocks around the showings have been cut by shear zones.

In the northern group of trenches near Wright Lake the host rocks consist of compositionally banded and homogeneous tuffs which are strongly foliated or sheared parallel to the banding where present. Quartz veins, mineralized with chalcopyrite and pyrite are parallel to the foliation, but are discontinuous, and are up to 25 cm thick. The total sulphide concentrations range from trace amounts to 2 percent, and the veins tend to be concentrated into 1 m thick bands. In the southern group of trenches sparsely disseminated pyrite and pyrrhotite, and trace amounts of chalcopyrite occur in bands of highly sheared and altered rock which trend north. The shear zones are up to 3 m thick and contain unmineralized quartz veins less than 2 cm thick that parallel the shear zones. Abundant disseminated carbonate occurs throughout the shear zones. Laterally these shear zones grade into unsheared, fine-grained basalts."

Little (1928) described the Spence Occurrence as follows; "The chief rock exposures are basic lavas which have been altered to sericite, chlorite and in some places andalusite schist. There appear to be two distinct lines of weakness. Two claims are crossed by a large porphyry dike striking N35E, the schisting following the dike. On the claims to the north of this the schisting is north and south corresponding with a pronounced "burn". Small intrusions of diabase were seen but no porphyry was noted in the northern group, but on account of the small amount of work that has been done and the large extent of the property nothing definite can be stated about this. A siliceous quartz porphyry dike striking N35E contains quartz veins striking in the same direction and dipping about 70 degrees to the north. From what shows in the only pit on this vein, the quartz is widening downwards and the south wall still shows stringers of quartz. There is a good deal of mineral in the quartz. A chipped sample taken over a width of 7 feet gave trace gold. The owner claims to have got over 3% copper here, which seems doubtful. The porphyry plunges into the swamp to the west; it is stated on reliable authority to be traceable for half a mile further, but work which has only been done this year has been concentrated in the pit which owing to the slope of the hill exposes the vein well. Fifty feet south another pit has been

started on a similar quartz vein in the porphyry. Conditions here appear similar but there is not much mineral in evidence and only a small amount of work has been done. Half a mile north of the porphyry dike and striking almost north and south is a pronounced "burn" which can be traced for several hundred feet (Law Occurrence). Several old test pits were sunk on this exposing a good deal of pyrrhotite and some pyrite, no chalcopyrite was seen in the older pits at the south end. The width probably averages six feet. The pits were not cleaned out and sampling was impossible. The strike at the south end was N5E. The strike has not been followed straight through owing to low ground, but what is supposed to be the same vein outcrops half a mile further north. It is doubtful if this is the same thing as its strike is N10W and its appearance is very different. There is a fair amount of chalcopyrite in one pit where most of the work has been done, in the centre of a quartz vein. A sample here gave 1.66% copper. One claim east there is another pronounced "burn" striking north and south, which can be traced across two claims, but as absolutely no work has been done on it very little can be said about it." (Resident Geologists Files, Thunder Bay)



## REFERENCES

- Ferguson, S. A., Groen, B. A., Hayes, R.  
1971: Gold Deposits of Ontario, Part 1, Ontario Department of Mines and Northern Affairs, Mineral Resources Circular 13, 315 p.
- Fumerton, S. L.  
1985: Geology of the Calm Lake Area, District of Rainy River; Ontario Geological Survey Report 226, 72 p.
- Fumerton, S. L.  
1986: Geology of the Righteye Lake Area, District of Rainy River; Ontario Geological Survey Report 239, 57 p.
- Little, W. C. B.  
1928: Private Report to Mining Corporation of Canada Limited, Resident Geologist's Files, Thunder Bay, 5 p.
- Schmieders, E. R., and Dutka, R. J.  
1985: Property Visits and Reports of the Atikokan Economic Geologists, 1979-1983, Atikokan Geological Survey; Ontario Geological Survey Open File Report 5539, 512 p.
- Spence, F.  
1928: Letter to Mr Watson of Mining Corporation, Resident Geologist's Files, Thunder Bay, 1 p.
- Sullivan, A.  
1908: Extracts from Reports of Engineers on Elizabeth Gold Mines, Resident Geologist's Files, Thunder Bay.
- Tanton, T. L.  
1927: Mineral Deposits of the Steeprock Lake Map Area, Ontario; Geological Survey of Canada, Summary Report for 1925, Part C, p. 1-11.
- Wilkinson S. J.  
1982: Gold Deposits of the Atikokan Area; Ontario Geological Survey, Mineral Deposits Circular 24, 54 p.

CERTIFICATE

I, Wayne E. Holmstead, of the City of Kingston in the Province of Ontario, DO HEREBY CERTIFY THAT:

1. I am a Consulting Geologist with address at 1074 Dillingham Street, Kingston, Ontario, Canada.

2. I graduated from the University of Toronto with a Bachelor of Science in Geology in 1976 and have been practicing my profession since.

3. I am a fellow in good standing of the Geological Association of Canada.

4. I have no interest, directly or indirectly, nor do I expect to receive any interest, directly or indirectly, in the mining property described in this report or in the securities of Blue Regal Resources Ltd.

5. This report is based upon the sources listed on Page 7, and upon several visits to the property.

6. I permit Blue Regal Resources Ltd. to use this report or portions of this report in the prospectus or other documents of the company.

Dated at Kingston, Ontario, this 4th day of January, 1988.

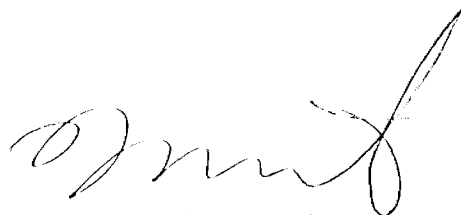

Wayne E. Holmstead, B.Sc., F.G.A.C.



Report of Work  
(Geophysical, Geological  
Geochemical and Expenditures)

DOCUMENT NO.

W8804590

2.120 Mini



52B13SW0012 2.12019 MIRANDA LAKE

900

Type of Survey(s) **GEOLOGICAL / M'QUAT LAKE, FACTOR LAKE, MIRANDA LAKE G-543**

Claim Holder **BLUE REGAL RESOURCES** Prospector's Licence No. **T5003**

Address **500-67 RICHMOND ST. WEST, TORONTO, M5H 1Z5**

Survey Company **GEOCOM CONSULTING** Date of Survey (from & to) **1 8 88 31 8 88** Total Miles of line Cut **33 KM**

Name and Address of Author for Geo-Technical report **WAYNE HOLMSTEAD, 116 NIAGARA ST., KIRKLAND, QUEBEC H9J 3B6**

Credits Requested per Each Claim in Columns at right

Mining Claims Traversed (List in numerical sequence)

Special Provisions	Geophysical	Days per Claim
For first survey: Enter 40 days. (This includes line cutting)	- Electromagnetic	
	- Magnetometer	
	- Radiometric	
	- Other	
For each additional survey: using the same grid: Enter 20 days (for each)	Geological	<b>40</b>
	Geochemical	
Man Days Complete reverse side and enter total(s) here	Geophysical	
	- Electromagnetic	
	- Magnetometer	
	- Radiometric	
	- Other	
	Geological	
	Geochemical	
Airborne Credits Note: Special provisions credits do not apply to Airborne Surveys.	Electromagnetic	
	Magnetometer	
	Radiometric	

Mining Claim		Expend. Days Cr.	Mining Claim		Expend. Days Cr.
Prefix	Number		Prefix	Number	
TB	940895	✓			
	940896	✓			
	940897	✓			
	940898				
	940899				
	940900				
	940901				
	940938	✓			
	940939	✓			
	<del>940</del>				
	974196	✓			
	974197				
	974198				
	974199				
	974200				
	989648				
	989649				
	989650				
	1000621				
	1000622				
	1000623				
	1000624				
	1000625				

RECEIVED

NOV 3 1988

MINING LANDS SECTION

RECEIVED  
MINING DIVISION  
SEP 11 1988

Expenditures (excludes power stripping)

Total Expenditures	Total Days Credits
\$	15 =

Instructions  
Total Days Credits may be apportioned at the claim holder's choice. Enter number of days credits per claim selected in columns at right.

Date **SEPT 27, 1988** Recorded Holder or Agent (Signature) *[Signature]*

For Office Use Only  
Total Days Cr. Recorded **880** Date Recorded **October 3/88** Mining Recor *Catherine J. Allison*  
Date Approved as Recorded **SEP 27 1988** Branch Director *[Signature]*

Total number of mining claims covered by this report of work. **22**

Certification Verifying Report of Work

I hereby certify that I have a personal and intimate knowledge of the facts set forth in the Report of Work annexed hereto, having performed the work or witnessed same during and/or after its completion and the annexed report is true.

Name and Postal Address of Person Certifying **WAYNE HOLMSTEAD, AS ABOVE**

Date Certified **SEP 27 1988** Certified by (Signature) *[Signature]*



Recorded Holder  
Blue Regal Resources

Township or Area  
Factor, Hepburn, McQuat and Miranda Lakes

Type of survey and number of Assessment days credit per claim	Mining Claims Assessed
Geophysical	TB 940895 to 901 inclusive 940938-39 974196-97-98 974200 989650 1000621-22-23
Electromagnetic ..... days	
Magnetometer ..... days	
Radiometric ..... days	
Induced polarization ..... days	
Other ..... days	
Section 77 (19) See "Mining Claims Assessed" column	
Geological ..... 35 ..... days	
Geochemical ..... days	
Man days <input type="checkbox"/>	Airborne <input type="checkbox"/>
Special provision <input checked="" type="checkbox"/>	Ground <input checked="" type="checkbox"/>
<input checked="" type="checkbox"/> Credits have been reduced because of partial coverage of claims. <input type="checkbox"/> Credits have been reduced because of corrections to work dates and figures of applicant.	

Special credits under section 77 (16) for the following mining claims

No credits have been allowed for the following mining claims

not sufficiently covered by the survey       insufficient technical data filed

TB 974199  
989648-49  
1000624-25

880 Bay Street  
3rd Floor  
Toronto, Ontario  
M5S 1Z8

(416) 965-4888

March 1, 1989

Your File: W3804-540  
Our File : 2.12019

Mining Recorder  
Ministry of Northern Development and Mines  
435 James Street South  
P.O. Box 5000  
Thunder Bay, Ontario  
P7C 5G6

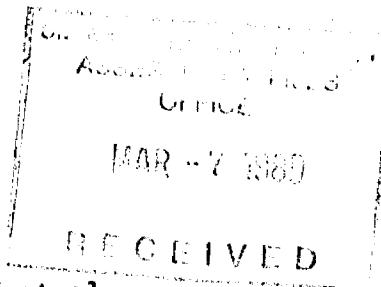

Dear Sir:

RE: Notice of Intent dated January 30, 1989.  
Geological Survey on Mining Claims 940895 et al  
in Factor, Hepburn, McQuat and Miranda Lakes

---

The assessment work credits, as listed with the above-mentioned Notice of Intent, have been approved as of the above date.

Please inform the recorded holder of these mining claims and so indicate on your records.

Yours sincerely,

W.R. Cowan  
Provincial Manager, Mining Lands  
Mines & Minerals Division

Encls:

AB:sc

cc: Blue Regal Resources  
Suite 500  
67 Richmond Street West  
Toronto, Ontario  
M5H 1Z5

cc: Mr. Wayne Holmstead  
1074 Dillingham St.  
Kingston, Ontario  
K1P 2P4

cc: Mr. G.H. Ferguson  
Mining & Lands Commissioner  
Toronto, Ontario

cc: Resident Geologist  
Thunder Bay, Ontario

SANDBEACH LAKE G-556

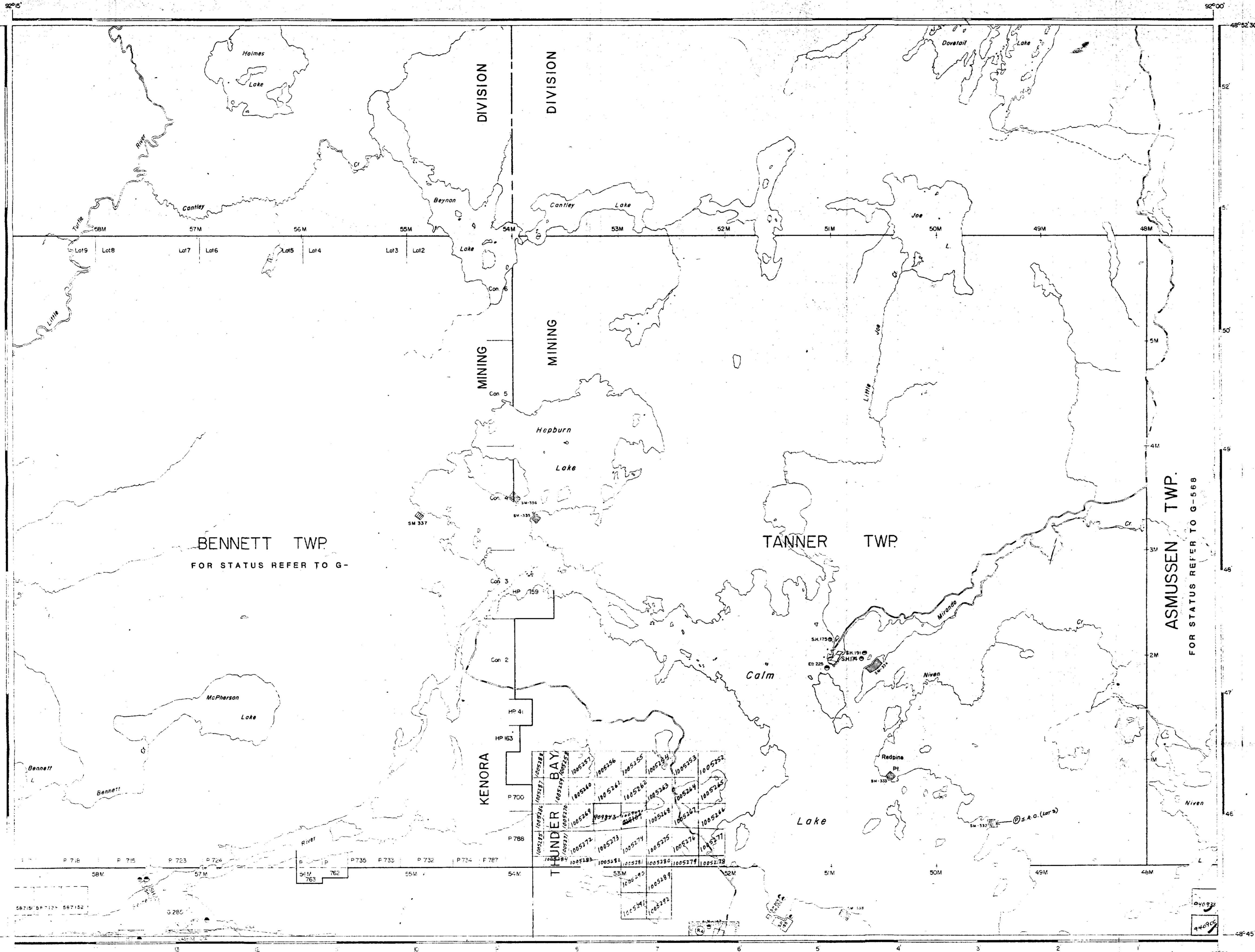

NOTES

AREAS WITHDRAWN FROM DISPOSITION

S.R. - SURFACE RIGHTS		M.R. - MINING RIGHTS	
Description	Order No.	Date	Disposition File
SEC 42, 44 Act	W2/90BCR	30/6/80	S.R.O. 163472

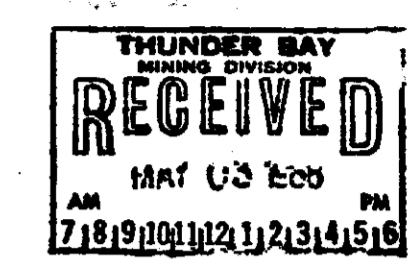

Flooding Rights in connection with water power sites at Sturgeon Falls & Calm Lake to an elev. of 1173' & 1255' L.O. 6626 File 16799

LEGEND

HIGHWAY AND ROUTE No.	
UTHER ROADS	
TRAILS	
SURVEYED LINES	
TOWNSHIP'S BASE LINES ETC.	
LOTS MINING CLAIMS PARCELS ETC.	
UNSURVEYED LINES	
LOT LINES	
PARCEL BOUNDARY	
MIN. CLAIMS ETC.	
RAILWAY AND RIGHT OF WAY	
UTILITY LINES	
NON PERENNIAL STREAM	
FLOODING OR FLOODING RIGHT	
SURFACE OR COMPOSITE PLAN	
RESERVATIONS	
ORIGINAL SHORELINE	
MARSH OR MURKED	
MINES	
TRAVERSE MONUMENT	

DISPOSITION OF CROWN LANDS

TYPE OF DOCUMENT	SYMBOL
PATENT SURFACE & MINING RIGHTS	
SURFACE RIGHTS ONLY	
MINING RIGHTS ONLY	
LEASE SURFACE & MINING RIGHTS	
SURFACE RIGHTS ONLY	
MINING RIGHTS ONLY	
LICENCE OF OCCUPATION	
ORDER IN COUNCIL	
RESERVATION	
CANCELLED	
SAND & GRAVEL	

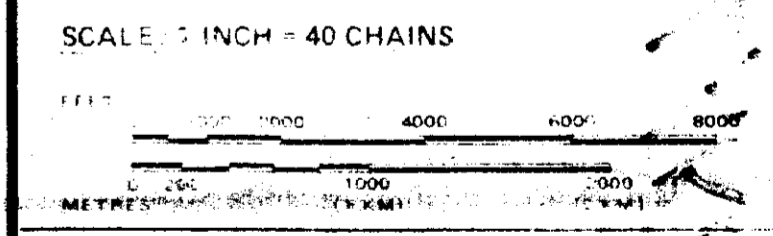

AREA  
**HEPBURN LAKE**  
 M.N.R. ADMINISTRATIVE DISTRICT  
**ATIKOKAN**  
 MINING DIVISION  
**THUNDER BAY/KENORA**  
 LAND TITLES / REGISTRY DIVISION  
**RAINY RIVER**

Ministry of Natural Resources  
 Land Management Branch  
 Ontario  
 Date: *Feb 6 1986*

DECEMBER 1981  
 Number: **G-532**



MIRANDA LAKE G-543

ASMUSSEN TWP.  
 FOR STATUS REFER TO G-568

BENNETT TWP.  
 FOR STATUS REFER TO G-

TANNER TWP.

KENORA

THUNDER BAY

HEPBURN LAKE G-532

NOTES

AREAS WITHDRAWN FROM DISPOSITION

S.R. - SURFACE RIGHTS M.R. - MINING RIGHTS

Description	Order No.	Date	Disposition	File
W 21/80 NCR	63476	30/1/80	S.R.	
R/L W/O 1/87 202	590	W/O 1/87 202	SR	W/O 1/87 202
R/L W/O 1/87 202	590	W/O 1/87 202	SR	W/O 1/87 202

LEGEND

HIGHWAY AND ROUTE No	
OTHER ROADS	
TRAILS	
SURVEYED LINES:	
TOWNSHIPS, BASE LINES, ETC.	
LOTS, MINING CLAIMS, PARCELS, ETC.	
UNSURVEYED LINES	
LOT LINES	
PARCEL BOUNDARY	
MINING CLAIMS ETC	
RAILWAY AND RIGHT OF WAY	
UTILITY LINES	
NON-PERENNIAL STREAM	
FLOODING OF FLOODING RIGHTS	
SUBDIVISION OF COMPOSITE PLAN	
RESERVATIONS	
ORIGINAL SHORELINE	
MARSH OR MUSKEG	
MINES	
TRAVERSE MONUMENT	

DISPOSITION OF CROWN LANDS

TYPE OF DOCUMENT	SYMBOL
PATENT SURFACE & MINING RIGHTS	
SURFACE RIGHTS ONLY	
MINING RIGHTS ONLY	
LEASE SURFACE & MINING RIGHTS	
SURFACE RIGHTS ONLY	
MINING RIGHTS ONLY	
LICENCE OF OCCUPATION	
ORDER IN COUNCIL	
RESERVATION	
CANCELLED	
SAND & GRAVEL	

NOTE: MINING RIGHTS IN PARCELS PATENTED PRIOR TO MAY 1 1930 VESTED IN ORIGINAL PATENTEE BY THE PUBLIC LANDS ACT, R.S.C. 1930 CHAP. 380, SEC. 63, SUBSEC. 1

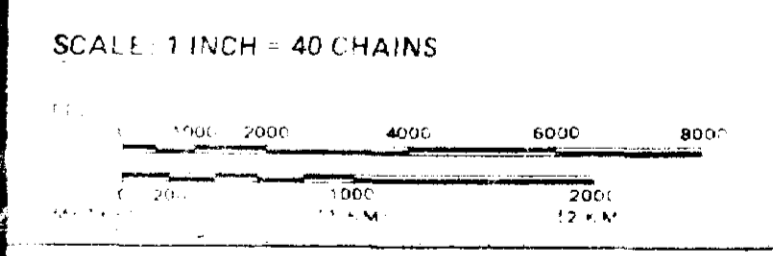

AREA  
**FACTOR LAKE**  
 M.N.R. ADMINISTRATIVE DISTRICT  
**ATIKOKAN & FORT FRANCES**  
 MINING DIVISION  
**THUNDER BAY & KENORA**  
 LAND TITLES / REGISTRY DIVISION  
**RAINY RIVER**

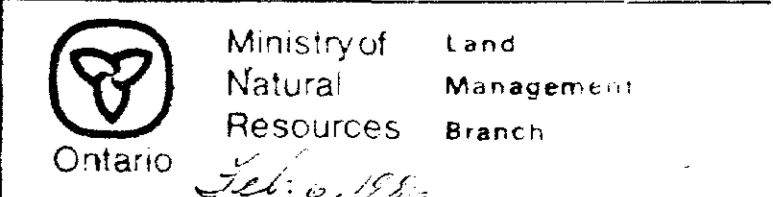

Date: NOVEMBER 1981  
 Number: G-527

WILD POTATO LAKE G-565

MCQUAT LAKE G-542

BEAVERHOUSE LAKE G-510





MIRANDA LAKE G-543

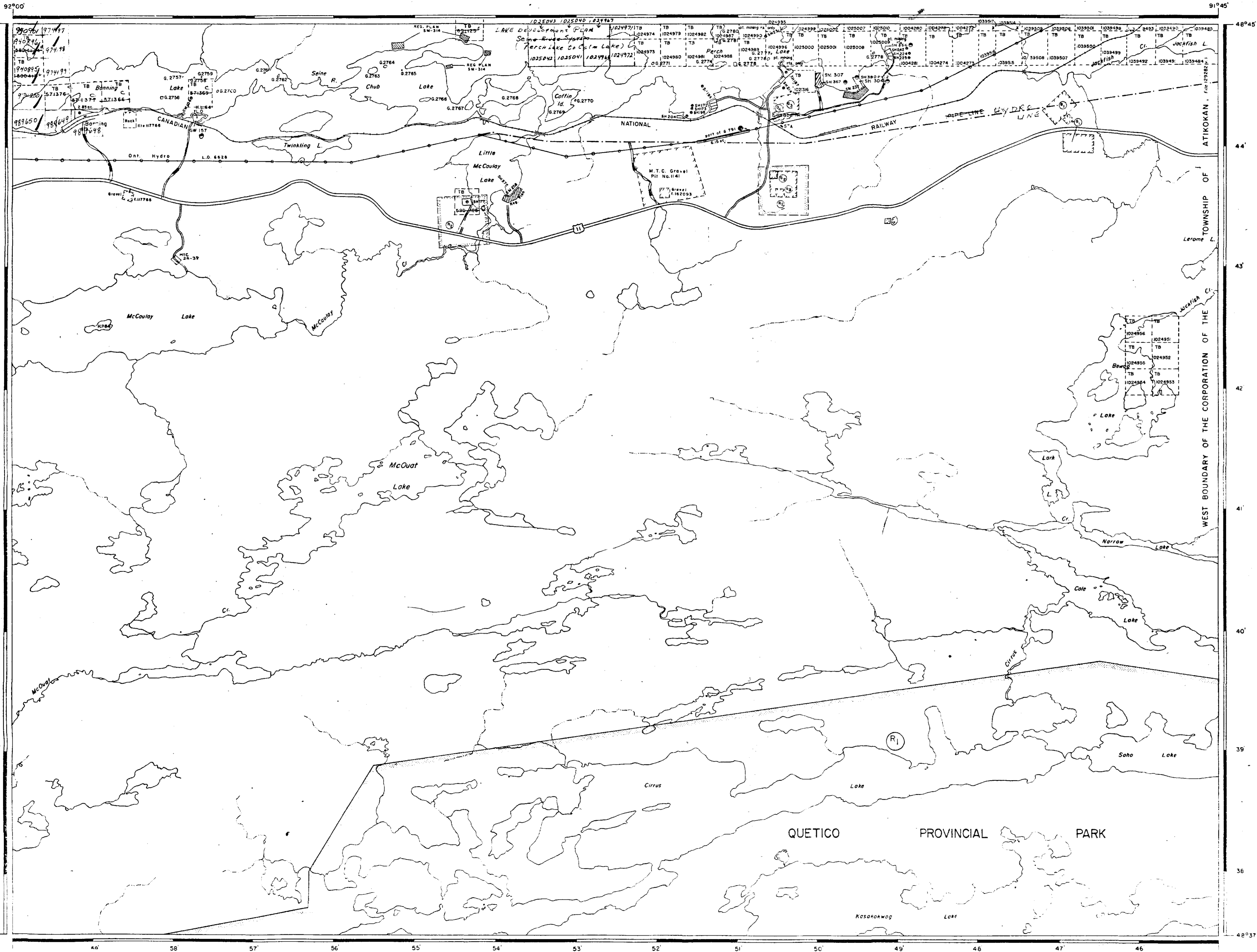

FACTOR LAKE G-527

McALPINE LAKE G-539

QUETICO LAKE G-551

REFERENCES

AREAS WITHDRAWN FROM DISPOSITION

S.R. - SURFACE RIGHTS M.R. - MINING RIGHTS

Description	Order No.	Date	Disposition	File
Sec. 43, M.A.C. (R.S.O. 1970)	W 41/73	31/8/73	S.R.A.M.R.	180216
	W 21/BONCR 30/6/80		S.R.O.	163472

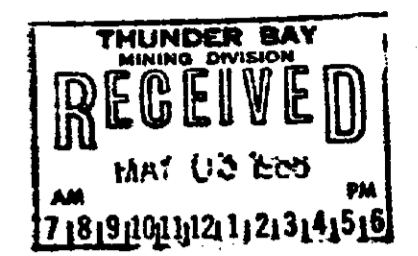

**SAND AND GRAVEL**

M.T.C. Gravel Reserve Oct. 16, 1979

Gravel File: 1522383

M.T.C. Gravel Reserve 2A-8, File 162093

Area within the Quetico Provincial Park withdrawn from staking.

**LEGEND**

HIGHWAY AND ROUTE No.	
OTHER ROADS	
TRAILS	
SURVEYED LINES	
TOWNSHIP BASE LINES, ETC.	
LOTS, MINING CLAIMS, PARCELS, ETC.	
UNSURVEYED LINES	
LOT LINES	
PARCEL BOUNDARY	
MINING CLAIMS ETC.	
RAILWAY AND RIGHT OF WAY	
UTILITY LINES	
NON-PERENNIAL STREAM	
FLOODING OR FLOODING RIGHTS	
SUBDIVISION OF COMPOSITE PLAN	
RESERVATIONS	
ORIGINAL SHORELINE	
MARSH OR MUDFLAT	
MINES	
TRAVERSE MEASUREMENT	

**DISPOSITION OF CROWN LANDS**

TYPE OF DOCUMENT	SYMBOL
PATENT, SURFACE & MINING RIGHTS	
" SURFACE RIGHTS ONLY	
" MINING RIGHTS ONLY	
LEASE, SURFACE & MINING RIGHTS	
" SURFACE RIGHTS ONLY	
" MINING RIGHTS ONLY	
LICENCE OF OCCUPATION	
ORDER-IN-COUNCIL	
RESERVATION	
CANCELLED	
SAND & GRAVEL	

NOTE: MINING RIGHTS IN PARCELS PATENTED PRIOR TO MAY 6, 1913, VESTED IN ORIGINAL PATENTEE BY THE PUBLIC LANDS ACT, R.S.O. 1970, CHAP. 380, SEC. 63, SUBSEC. 14.

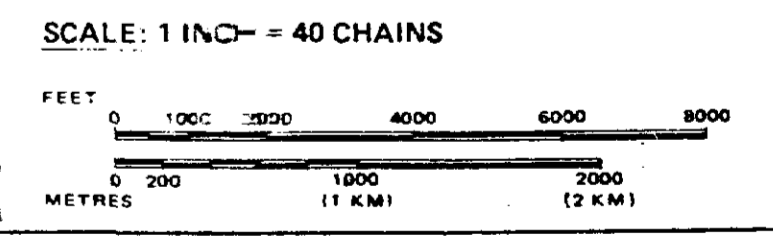

**AREA**

**McOUAT LAKE**

M.N.R. ADMINISTRATIVE DISTRICT  
**ATIKOKAN**

MINING DIVISION  
**THUNDER BAY**

LAND TITLES REGISTRY DIVISION  
**RAINY RIVER**

Ministry of Natural Resources  
Land Management Branch  
Ontario

Date: DECEMBER, 1981  
Number: **G-542**





CROWROCK LAKE G-520

REFERENCES

AREAS WITHDRAWN FROM DISPOSITION

S.R. - SURFACE RIGHTS M.R. - MINING RIGHTS

Description Order No. Date Disposition File

SAND AND GRAVEL  
 (C) Quarry Permit 483

LEGEND

- HIGHWAY AND ROUTE No.
- OTHER ROADS
- TRAILS
- SURVEYED LINES:
  - TOWNSHIPS BASE LINES, ETC.
  - LOTS, MINING CLAIMS, PARCELS, ETC.
- UNSURVEYED LINES:
  - LOT LINES
  - PARCEL BOUNDARY
  - MINING CLAIMS ETC.
- RAILWAY AND RIGHT OF WAY
- UTILITY LINES
- NON-PERENNIAL STREAM
- FLOODING OR FLOODING RIGHTS
- SUBDIVISION OR COMPOSITE PLAN RESERVATIONS
- ORIGINAL SHORELINE
- MARSH OR MUSKEG
- MINES
- TRAVERSE MONUMENT

DISPOSITION OF CROWN LANDS

TYPE OF DOCUMENT	SYMBOL
PATENT, SURFACE & MINING RIGHTS	●
" SURFACE RIGHTS ONLY	○
" MINING RIGHTS ONLY	◐
LEASE, SURFACE & MINING RIGHTS	■
" SURFACE RIGHTS ONLY	◼
" MINING RIGHTS ONLY	◻
LICENCE OF OCCUPATION	▼
ORDER-IN-COUNCIL	OC
RESERVATION	○
CANCELLED	○
SAND & GRAVEL	⊙

NOTE: MINING RIGHTS IN PARCELS PATENTED PRIOR TO MAY 6, 1913, VESTED IN ORIGINAL PATENTEE BY THE PUBLIC LANDS ACT, R.S.O. 1970, CHAP. 380, SEC. 63, SUBSEC. 1.

SCALE: 1 INCH = 40 CHAINS

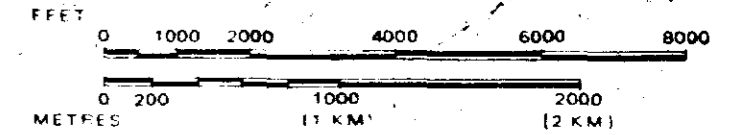

AREA

MIRANDA LAKE

M.N.R. ADMINISTRATIVE DISTRICT  
 ATIKOKAN  
 MINING DIVISION  
 THUNDER BAY  
 LAND TITLES / REGISTRY DIVISION  
 RAINY RIVER

Ministry of Natural Resources  
 Land Management Branch  
 Ontario

Date: August 15, 1985  
 Number: G-543

HEPBURN LAKE G-532

STEEPCROCK LAKE G-560

FREEBORN TWP. G-570

STEEPCROCK LAKE G-560

ASMUSSEN TWP.  
 FOR STATUS REFER TO TWP. PLAN  
 G-568

BAKER TWP.  
 FOR STATUS REFER TO TWP. PLAN  
 G-570

McOUAT LAKE G-542



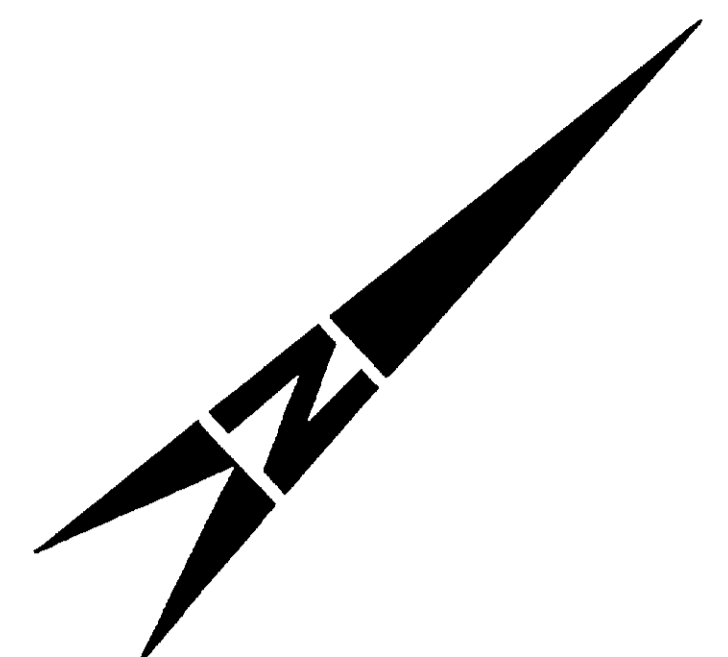
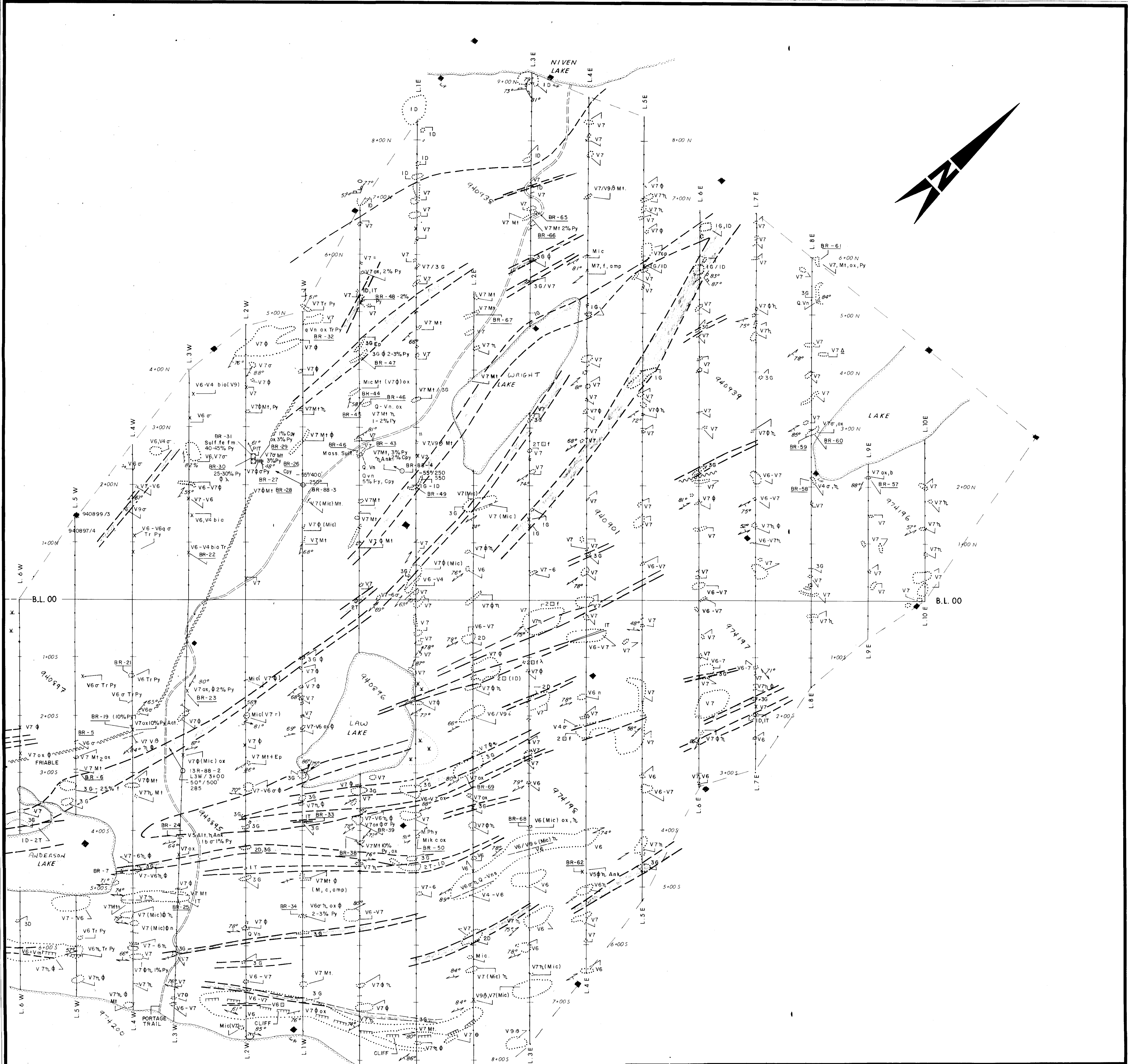

LEGEND		SYMBOLS	
<b>ARCHEAN VOLCANICS</b> V4 (1a, 1af) DACITE V5 (1a, 1af) INTERMEDIATE VOLCANICS UNDIFFERENTIATED V6 (1a, 1af) ANDESITES V7 (1a, 1af) BASALTS V9b-c (1b) MAFIC TO INTERMEDIATE TUFF		TRAIN TRACK CLAIM LINE AND CLAIM POST	
<b>ARCHEAN METAMORPHIC ROCKS</b> Mic (1c) CHLORITE, SCHIST (MAFIC TO INTERMEDIATE) Msk (2c) SERICITE SCHIST (FELSIC) Miphy PHYLITES		Act ACTINOLITE    Ank ANKERITE    Mt MAGNETITE Py PYRITE        K SERICITE        c CHLORITE ox OXIDIZED       f FELDSPARS       q QUARTZ bio BIOTITE       phy PHYLITE       r CARBONATIZED φ CHLORITIZED    σ SILICIFIED       g FOLLOWS □ PORPHYRITIC	
<b>MAFIC ARCHEAN INTRUSIVES</b> 2D (3b) DIORITES 3G (3a) GABBROS		<b>MASSIVELY FOLIATED</b>	
<b>FELSIC TO INTERMEDIATE ARCHEAN INTRUSIVES</b> 1G (4a) GRANITE 1D (4c) GRANDIORITE 1T (4d) TONALITE 2T (3c) QUARTZ DIORITE 2 (4c) INDETERMINED INTERMEDIATE INTRUSIVES		<b>SYMBOLS</b> OUTCROPS  X GEOLOGICAL CONTACT (CONFIRMED, ASSUMED) BEDDING / BONDING / CONTACTS  30° FOLIATION  81° JOINTING  73°    FRACTURES  82° FOLDING (AXIAL PLANE)  81° SHEARING FAULTING  CLIFF (TOPOGRAPHIC DROP) SWAMP; ALDERS X X X PIT TRENCHES BR-88-02 SITE OF DIAMOND DRILL HOLE BR-52 ROCK SAMPLE SITE	

**GEOCOM CONSULTING**

116 Niagara St. KIRKLAND Qc. H9J 3B6 Tel: 514-696-2327

**BLUE REGAL RESOURCES INC.**

**GEOLOGICAL COMPILATION MAP**

**BANNING LAKE PTY.**

NORTH-EAST SHEET

DATE *mt*

Compilation by E.C.    NOV. 88'

Interpretation by \_\_\_\_\_

Drafting by G.B., P.L.

Township \_\_\_\_\_ N.T.S.    Drawing No. \_\_\_\_\_

SCALE 1:2500    0 50 100 m





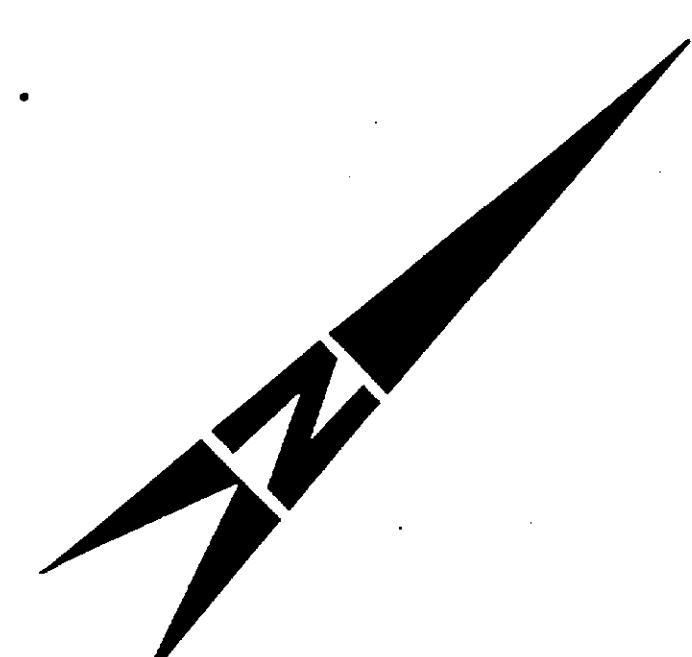

**LEGEND**

- ARCHEAN VOLCANICS**
- V4 (1a,1of) DACITE
  - V5 (1a,1of) INTERMEDIATE VOLCANICS UNDIFFERENTIATED
  - V6 (1a,1of) ANDESITES
  - V7 (1a,1of) BASALTS
  - V9β-2 (1b) MAFIC TO INTERMEDIATE TUFF
- ARCHEAN METAMORPHIC ROCKS**
- Mic (1c) CHLORITE, SCHIST (MAFIC TO INTERMEDIATE)
  - Mik (2c) SERICITE SCHIST (FELSIC)
  - M,phy PHYLLITES
- MAFIC ARCHEAN INTRUSIVES**
- 20 (3b) DIORITES
  - 33 (3a) GABBROS
- FELSIC TO INTERMEDIATE ARCHEAN INTRUSIVES**
- 1G (4a) GRANITE
  - 1D (4c) GRANODIORITE
  - 1T (4d) TONALITE
  - 2T (3c) QUARTZ DIORITE
  - 2 (4c) INDETERMINED INTERMEDIATE INTRUSIVES
- SYMBOLS**
- OUTCROPS
  - GEOLOGICAL CONTACT (CONFIRMED, ASSUMED)
  - BEDDING / BONDING / CONTACTS
  - FOLIATION
  - JOINTING
  - FRACTURES
  - FOLDING (AXIAL PLANE)
  - SHEARING
  - FAULTING
  - CLIFF (TOPOGRAPHIC DROP)
  - SWAMP, ALDERS
  - PIT
  - TRENCHES
  - BR-BB-02 SITE OF DIAMOND DRILL HOLE
  - BR-52 ROCK SAMPLE SITE
- TRAIN TRACK**
- CLAIM LINE AND CLAIM POST**
- ACT ACTINOLIT**    Ank ANKERITE    M1 MAGNETITE
- Py PYRITE**        k SERICITE        c CHLORITE
- ox OXIDIZED**     f FELDSPARS     Q QUARTZ
- bio BIOTITE**     phy PHYLLITE    n CARBONATIZED
- φ CHLORITIZED**    σ SILICIFIED     θ PILLOWED
- PORPHYRITIC**

**GEOCOM CONSULTING**  
 116 Niagara St. KIRKLAND Qc H9J 3B6 Tel 514-596-2321

**BLUE REGAL RESOURCES INC.**  
**GEOLOGICAL COMPILATION MAP**  
**BANNING LAKE PTY.**  
 SOUTH-WEST SHEET

Compilation by E.C. DATE NOV. 88

Interpretation by \_\_\_\_\_

Drafting by G.B., P.L.

Township \_\_\_\_\_ N.T.S. Drawing No. \_\_\_\_\_

SCALE 1:2500

2.12019